



COUNTY OF ALAMEDA  
**Assessor's Office**

[Help](#)

[New Query](#)

**Property Value System**

<a href="#">History</a>	<a href="#">Value</a>	<a href="#">Transfer</a>	<a href="#">Map</a>	<a href="#">Glossary</a>
-------------------------	-----------------------	--------------------------	---------------------	--------------------------

Parcel Number: **428-56-37** Inactive: **N** Lien Date: **01/01/2017** Owner: **WEINSTEIN FAMILY GENERAL PTP**

Property Address: **964 A ST, HAYWARD, CA 94541-4104**

Current Mailing Address as of 08/01/2016: **WEINSTEIN FAMILY GENERAL PTP, 425 15TH ST , OAKLAND, CA 94612-2801**

Mailing Name		Historical Mailing Address	Document Date	Document Number	Value From Trans Tax	Parcel Count	Use
WEINSTEIN FAMILY GENERAL PTP c/o WEINSTEIN RICHARD	<a href="#">List</a> <a href="#">Owners</a>	360 17TH ST # 204, OAKLAND, CA 94612-3340	06/22/2012	2012-202782		2	8100
WEINSTEIN RICHARD L & LINDA M TRS	<a href="#">List</a> <a href="#">Owners</a>	360 17TH ST STE 204, OAKLAND, CA 94612-3340	08/31/2010	2010-251262		2	8100
WEINSTEIN RICHARD L & LINDA M TRS	<a href="#">List</a> <a href="#">Owners</a>	360 17TH ST STE 204, OAKLAND, CA 94612-3340	09/03/2003	2003-521212		2	8100
WEINSTEIN RICHARD & LINDA	<a href="#">List</a> <a href="#">Owners</a>	360 17TH ST , OAKLAND, CA 94612-3340	08/01/2002	2002-327267		2	8100
WEINSTEIN RICHARD ETAL c/o RICHARD WEINSTEIN	<a href="#">List</a> <a href="#">Owners</a>	360 17TH ST STE 204, OAKLAND, CA 94612-3340	07/31/2002	2002-325926		2	8100
FOOTHILL BUILDING LLC c/o RICHARD WEINSTEIN	<a href="#">List</a> <a href="#">Owners</a>	360 17TH ST , OAKLAND, CA 94612-3340	06/25/1998	1998-220261		2	8100
WEINSTEIN RICHARD L & LINDA C ETAL	<a href="#">List</a> <a href="#">Owners</a>	PO BOX 3554 , MORAGA, CA 94575-3554	06/25/1998	1998-220259		2	8100
ST MARY'S COLLEGE OF CALIFORNIA c/o WILLIAM MCLEOD	<a href="#">List</a> <a href="#">Owners</a>	1928 SAINT MARYS RD , MORAGA, CA 94556-2715	11/24/1997	1997-310545		1	8100
MASSA JUANITA T TR c/o WILLIAM MCLEOD	<a href="#">List</a> <a href="#">Owners</a>	1928 SAINT MARYS RD , MORAGA, CA 94556-2715	07/25/1997	TRAN-164206		1	8100
MASSA JUANITA T TR c/o JAMES DYE	<a href="#">List</a> <a href="#">Owners</a>	PO BOX 3085 , DANVILLE, CA 94526-8085	10/12/1989	1989-279251		8	8100
MASSA JUANITA	<a href="#">List</a> <a href="#">Owners</a>	1611 ORCHARD LN , WALNUT CREEK, CA 94595-2329	09/11/1989	1989-245464		7	8100
MASSA NEVILLE T	<a href="#">List</a> <a href="#">Owners</a>	1611 ORCHARD LN , WALNUT CREEK, CA 94595-2329	02/10/1965	AX-19004		6	8100

All information on this site is to be assumed accurate for property assessment purposes only, and is based upon the Assessor's knowledge of each property. Caution is advised for use other than its intended purpose.

The Alameda County Intranet site is best viewed in Internet Explorer Version 5.5 or later.  
Click [here](#) for more information regarding supported browsers.

Copyright © 2001 Alameda County

# ASSESSOR'S MAP 428

Code Area Nos. 25-001  
25-051  
25-222

56

Scale: 1"=100'

RANCHO SAN LORENZO - G. CASTRO (Bk. A. Pat. Pg. 142)  
ANSPACHER TRACT (Bk. 17 Pg. 63)  
HAMPTON TERRACE (Bk. 5 Pg. 37)  
TOWN OF HAYWOOD (Bk. 6 Pg. 17)

Drn 7, 63 AM  
Corrected:  
3-16-76 UP  
2-0-86 CS  
9-29-86 RW  
4-7-00 UJW  
9-16-00 JT  
4-16-00 ZC

Fmly Bk. 78 - Bk. 6, 7, 8, 15 & Por. 5, 9.

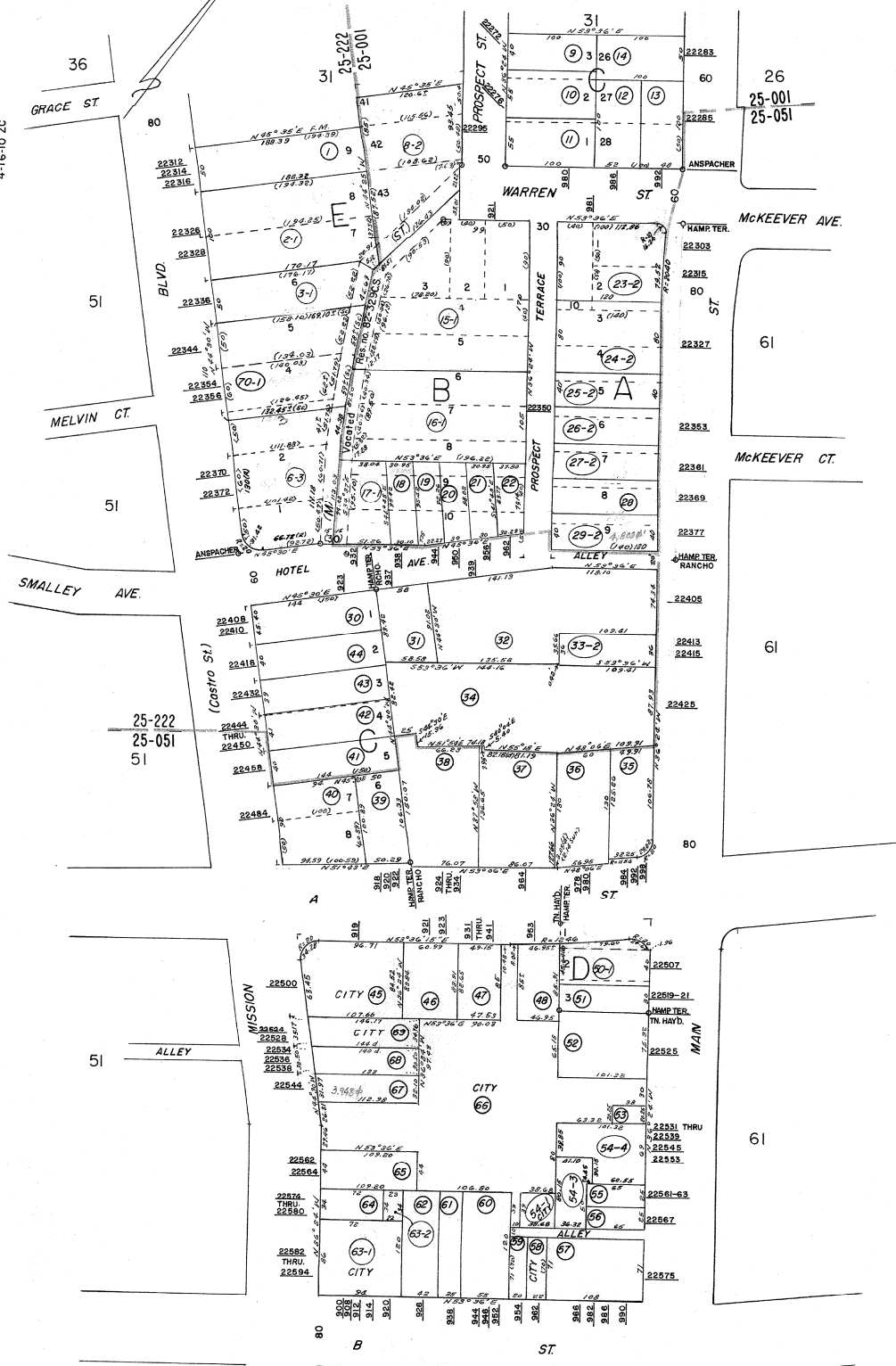

AC. M. 15

71

Reference: R/S (R.S. Bk. 3 Pg. 53) 66 R/S (R.S. Bk. 3 Pg. 45)

66

HPN- 77