



Construction Services, Inc.

1550 Wallace Avenue, San Francisco, CA 94124, Phone (415) 822-4555 FAX (415) 822-5290
Corporate Offices 5200 Redwood Highway South, Petaluma, CA 94952 Phone (707) 766-9511 FAX (707) 766-9049

UNDERGROUND STORAGE TANK REMOVAL

1244 2nd AVENUE
OAKLAND, CALIFORNIA

January 18, 2016

LWCS 15-232

Prepared for:

1244 – 2nd Avenue LLC

Prepared by:

George Wilson

www.lw-construction.com

General Engineering Contractors License No. 507442
Certified for Hazardous Substances Removal and Remedial Actions



Construction Services, Inc.

1550 Wallace Avenue, San Francisco, CA 94124, Phone (415) 822-4555 FAX (415) 822-5290
Corporate Offices 5200 Redwood Highway South, Petaluma, CA 94952 Phone (707) 766-9511 FAX (707) 766-9049

January 18, 2016

LWCS 15-232

UNDERGROUND STORAGE TANK REMOVAL 1244 2nd AVENUE OAKLAND, CALIFORNIA

INTRODUCTION

At the request of Trent Moore, Managing Member, 1244 2nd Avenue LLC, L & W Construction Services, Inc. (L&W) removed one 1000-gallon Underground Storage Tank (UST) from 1244 2nd Avenue, Oakland, California (Figure 1- Vicinity Map). The 1000-gallon UST was used to store heating oil. UST removal activities were performed in accordance with the UST Removal Regulations of the Alameda County Department of Environmental Health – Certified Unified Program Agency (ACDEH-CUPA) and the Oakland Fire Prevention Bureau (OFPB). The UST was dismantled, decontaminated and transported to a recycling facility.

BACKGROUND

This mixed use residential/commercial structure is located on the southeast side of 2nd Avenue in Oakland, California. The 1000-gallon UST was located beneath the sidewalk on International Boulevard on the southeast side of the Site structure. The UST dimensions were four feet in diameter by ten feet in length. The top of the UST was approximately eight feet below surface grade.

Installation date of this UST is unknown. The building was constructed in the 1910's. The UST that was removed appears to have been abandoned for a very long time. The vent pipe had been removed and natural gas was made available to the neighborhood in the 1950's. It is therefore assumed that the UST has not been used for over 50 years. No known prior investigations have been conducted pertaining to the site UST.

UST REMOVAL

The Underground Storage Tank Closure Permit Application was approved by the Alameda County Division of Hazardous Materials of ACDEH-CUPA on October 22, 2015 and received by L&W on November 2, 2015. Excavation Permit Number X1502527, dated November 4, 2015, was obtained from the City of Oakland Building and Planning Department for excavation of the tank. Permit copies are found in Appendix A.

During the process of excavation to uncover the UST, contaminated soil was encountered approximately three feet above the tank. Dark black oil was seeping in from the sides of the excavation not resembling the light diesel oil contained in the tank.

www.lw-construction.com

General Engineering Contractors License No. 507442
Certified for Hazardous Substances Removal and Remedial Actions

Covered debris bins were utilized for temporary storage of this contaminated soil on site.

On November 20, 2015, 950 gallons of light oil were pumped out of the tank. The tank was triple rinsed. The piping to the tank was opened and rinsed with soap and water under high pressure during tank cleaning. The piping rinsate was flushed back into the UST. The product and rinsate were removed from the UST under State Waste Manifest Document Number 014378668 by NRC Environmental Services of Alameda, California. A copy of this manifest is found in Appendix B.

The UST site was inspected on December 7, 2015 and it was discovered that groundwater had intruded into the excavation submerging the tank by three feet. Soil was caving into the excavation due to groundwater intrusion. The timber shoring originally installed in the excavation was removed and an aluminum trench box installed due to this intrusion of groundwater and caving soil.

A vacuum truck was scheduled for the morning of the tank removal, December 8, 2015, to remove groundwater to allow for sample collection and tank removal. During the removal of the groundwater it was documented that heavy petroleum was floating on the water in small areas. Heavy petroleum was commonly used at the time the building was constructed. It is assumed this was from the groundwater passing through contaminated soil beneath and on the sides of the UST. After approximately two hours of vacuuming water from the excavation, the UST was removed from the excavation with the approval of Steven Plunkett (ACDEH-CUPA) and in the presence of Sheryl Skillern, inspector with the Oakland Fire Prevention Bureau.

The UST was subsequently transported to Circosta Iron and Metal Company of San Francisco, California, for recycling. A copy of the weighmaster certificate documenting the recycling of the UST is provided in Appendix B. The piping was cut and capped and the vent line was removed.

It appears that contaminated soil is present outside of the shoring box paralleling International Boulevard.

As a corrective action, a total of 60 to 90 tons of over-excavated soil was removed during tank excavation activities and transported to Newby Island Landfill for disposal. The exact tonnage will be verified upon receipt of the weight tickets from the landfill. An additional 600 gallons of impacted groundwater was vacuumed from the excavation to secure the site on December 9, 2015. A total of 2800 gallons of impacted groundwater was transported to River Bank Oil Transfer of Riverbank, California under State Waste Manifest Document Number 014378654 by NRC Environmental Services of Alameda, California. A copy of this manifest is found in Appendix B. A groundwater sample was collected after additional groundwater removal. A soil sample was collected to profile the material for off-site disposal to eliminate a nuisance condition.

SAMPLING ACTIVITIES

Initial groundwater sampling was performed on December 8, 2015. After the UST was removed, groundwater continued to be vacuumed from the excavation. Steven Plunkett of ACDEH-CUPA pointed out an area where water was intruding and a water sample was collected under his supervision in a VOA vial. The inspector did not direct the collection of soil samples at this time due to very shallow water conditions.

A second groundwater sample was collected on December 9, 2015 after removal of additional groundwater from the excavation.

The water samples were collected in a 40 ml glass vials. Following collection, the water samples were properly labeled and placed in a chilled cooler to preserve the samples until delivery to the analytical laboratory. Chain of Custody protocol was followed during sampling procedures and transport to the selected testing laboratory.

LABORATORY ANALYSIS

The water samples were sent to A&R Laboratories of Ontario, California, a state certified laboratory, for analysis.

The water samples were analyzed for:

- Diesel Range Hydrocarbons TPHd, TPHg and Motor Oil by Method 8015M
- BTEX & Naphthalene by EPA Method 8260B
- VOCs & Oxygenates by EPA Method 8260B
- Semi-VOCs by EPA Method 8270C
- PCBs by EPA Method 8082
- LUFT 5 Metals by EPA Method 6010B

LABORATORY ANALYTICAL RESULTS

The laboratory analytical results are presented in Table 1. Copies of the Chain of Custody forms and all laboratory data sheets are presented in Appendix C. Positive results are as follows:

Analysis of the water sample (15-232GW) collected on December 8, 2015 from the UST excavation indicated no detection of BTEX above minimum laboratory reporting limits. Naphthalene was reported at a concentration of 380 micrograms per liter (ug/L). TPHd was reported at a concentration of 50,000 ug/L and TPHg was reported at a concentration of 280,000 ug/L. Chromium was reported at a concentration of 0.19 mg/L, Nickel was reported at a concentration of 0.38 mg/L and Zinc was reported at a concentration of 1.8 mg/L.

Analysis of the water sample (15-232GW-2) collected on December 9, 2015 after pumping of groundwater from the UST excavation indicated no detection of BTEX, TPH as Motor Oil or Naphthalene above minimum laboratory reporting limits. TPHd was reported at a concentration of 20,000 ug/L and TPHg was reported at a concentration of 120,000 ug/L. Chromium was reported at a

concentration of 0.15 mg/L, Nickel was reported at a concentration of 0.2 mg/L and Zinc was reported at a concentration of 1.5 mg/L.

BACKFILL

Based on Pangea's soil and groundwater excavation and the statement from Bob Clark-Riddell, consulting Professional Engineer, after his conversations with Alameda County Environmental Health personnel that no further excavation would be required due to fluctuations in groundwater and the potential to increase soil fluffing. To mitigate the potential for further problems, 24.34 tons of pea gravel was placed in the excavation up to the groundwater high water mark. 15.5 yards of control density fill (CDF) was then used to backfill the remainder of the excavation to achieve 100% compaction.

CONCLUSION

L&W concludes that a release of heavy petroleum hydrocarbons used as heating oil has occurred at this site at the UST location. L&W understands that ACDEH-CUPA will forward the UST Removal Report to the ACDEH-Local Oversight Program (ACDEH-LOP). This appears to be a very old release of a relatively immobile heavy petroleum substance.

EXCLUSION

L&W assumes no responsibility or liability for the reliance hereon or hereof of the information contained in this report by anyone other than the party to whom it is addressed.

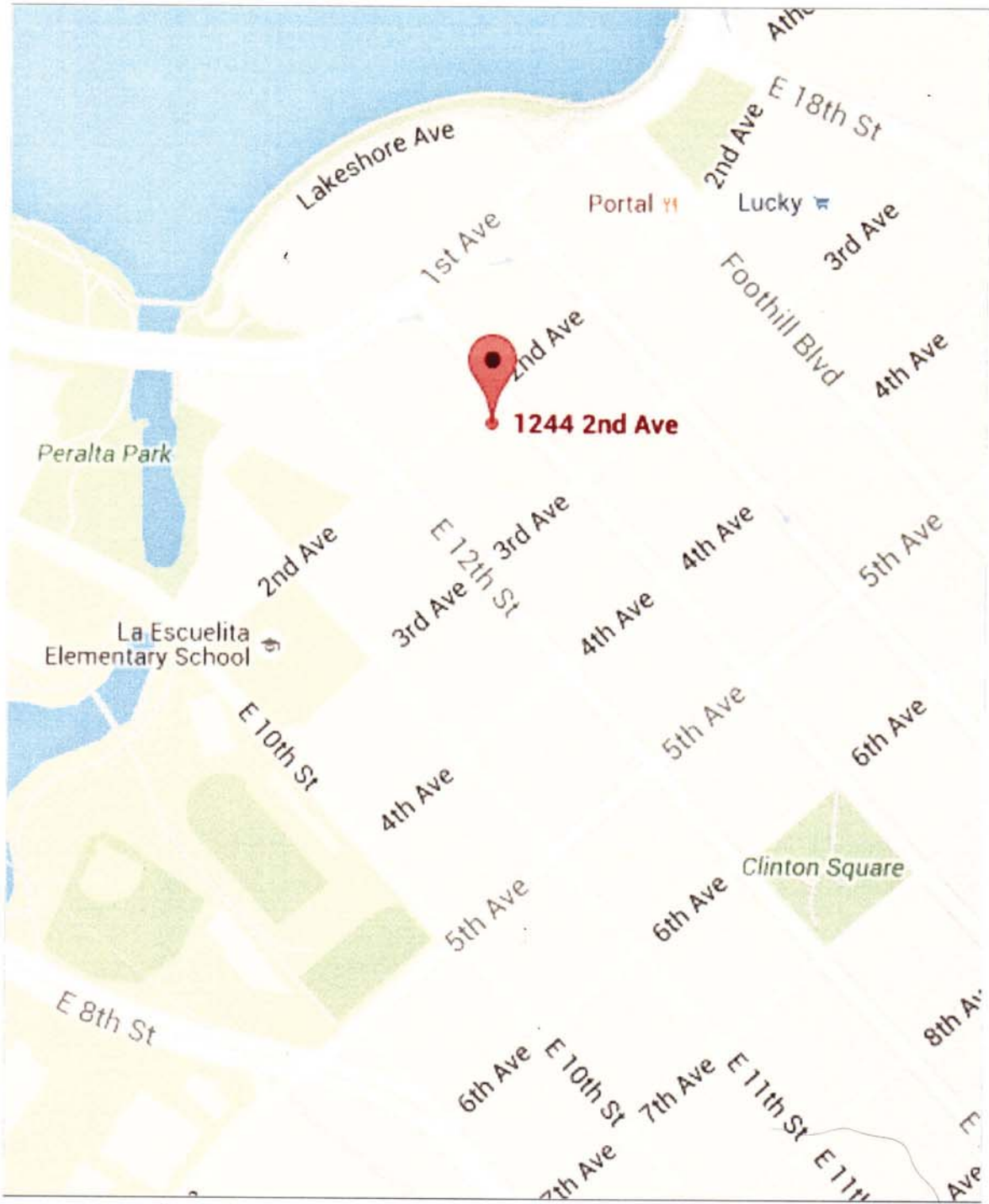

L&W Construction Services, Inc.
1550 Wallace Avenue
San Francisco, CA 94124

Job #15-232
Date: 9/17/15xp
JML

Figure: One
Site: 1244 2nd Avenue
Oakland, CA

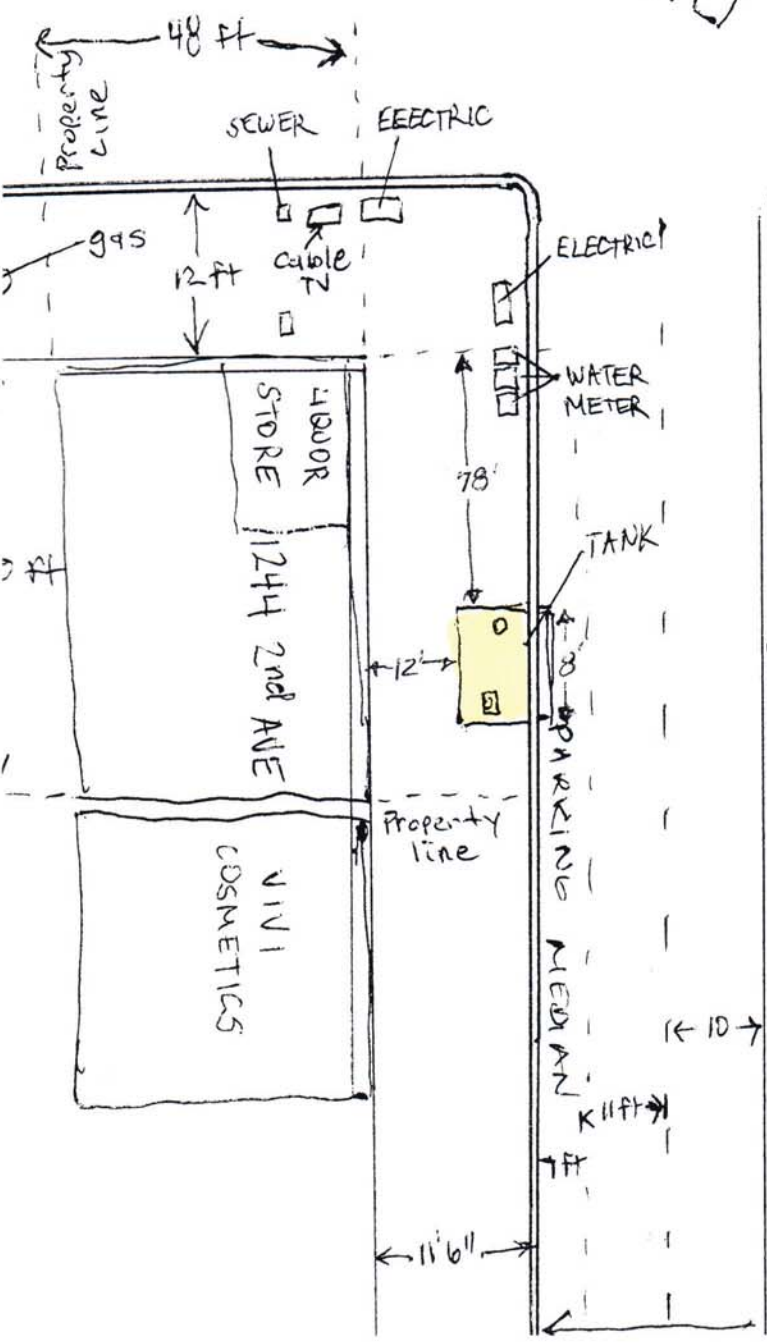
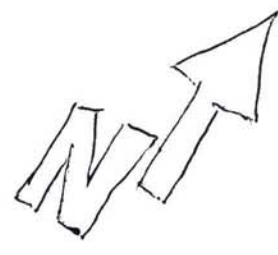
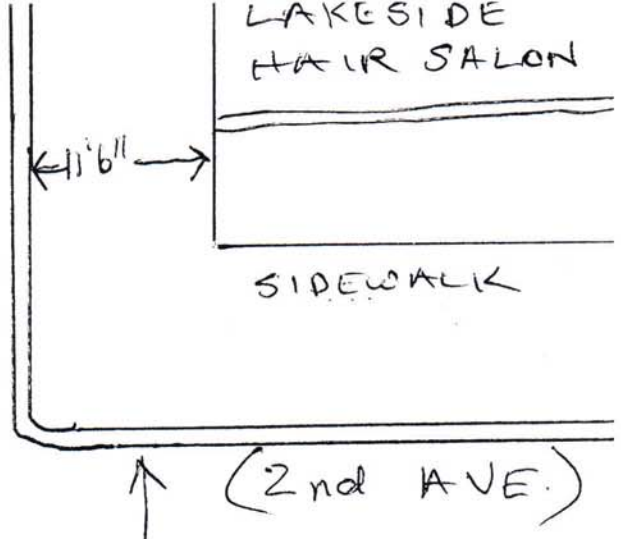
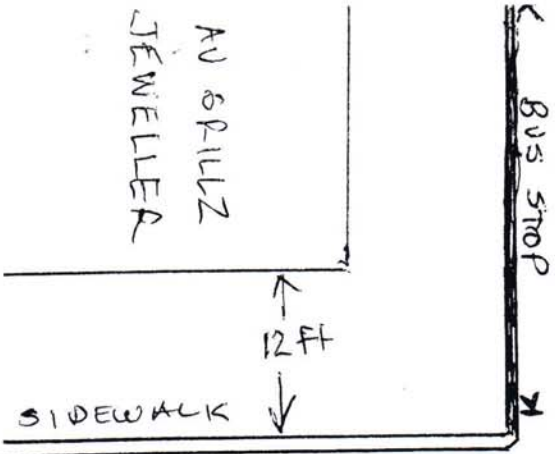

(INTERNATIONAL BLVD)

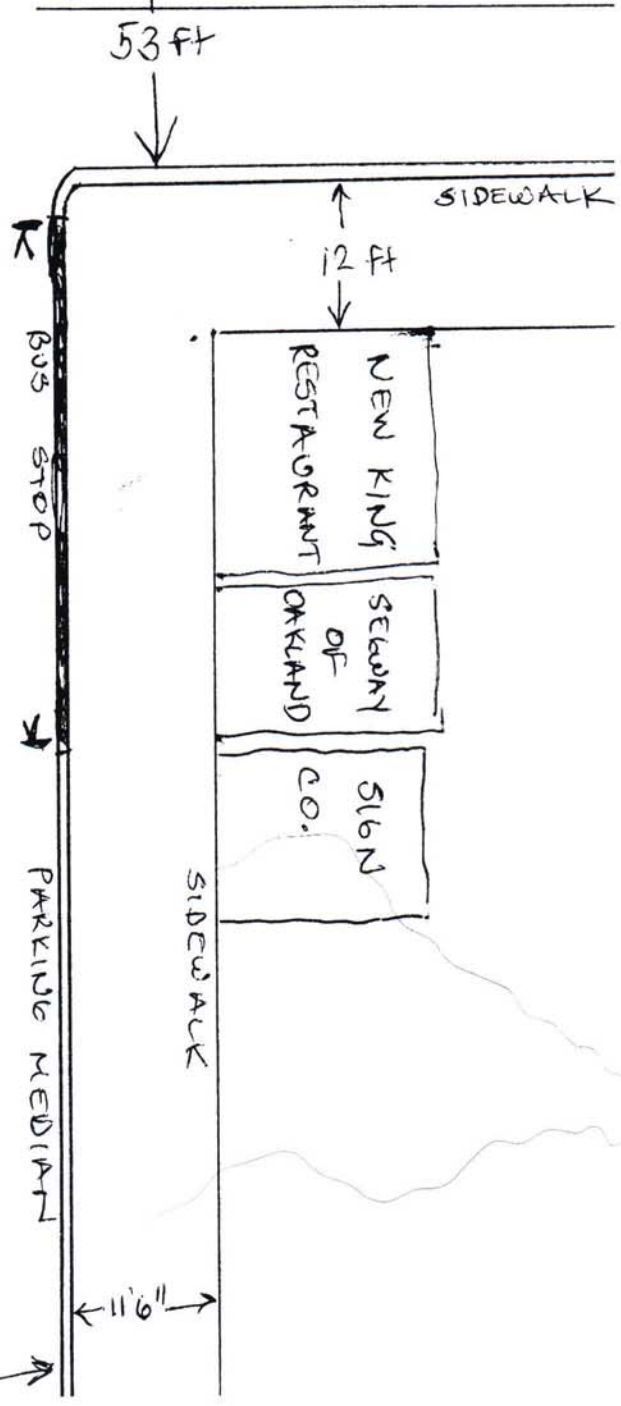

APPENDIX A

PERMITS

ALAMEDA COUNTY
 DEPARTMENT OF ENVIRONMENTAL HEALTH
 1131 HARBOR BAY PARKWAY
 ALAMEDA, CA 94502-6577
 PHONE (510) 567-6700

ACCEPTED

Underground Storage Tank Closure Permit Applications
 Alameda County Division of Hazardous Materials
 1131 Harbor Bay Parkway, Suite 250
 Alameda, CA 94502-6577

These closure/removal plans have been received and found to be acceptable and essentially meet the requirements of State and Local Health Laws. Changes to your closure plans indicated by this Department are to assure compliance with State and local laws. The project proposed herein is now released for issuance of any required building permits for construction/destruction.

One copy of the accepted plans must be on the job and available to all contractors and craftsmen involved with the removal.

Any changes or alterations of these plans and specifications must be submitted to this Department and to the Fire and Building Inspections Department to determine if such changes meet the requirements of State and local laws. Notify this Department at least 72 hours prior to the following required inspections:

- ✓ Removal of Tank(s) and Piping
- ✓ Sampling
- ✓ Final Inspection

Issuance of a) permit to operate, b) permanent closure, is dependent on compliance with accepted plan and all applicable laws and regulations.

***THERE IS A FINANCIAL PENALTY FOR NOT OBTAINING THESE INSPECTIONS:**

Contact Specialist

Approved by Steven Punkoff 

on 10/27/2015

email: Steven.Punkoff@acgov.org

UNDERGROUND STORAGE TANK CLOSURE PLAN

***** Complete closure plan according to instructions *****

1. Name of Business 1244 2nd Avenue LLC
 Business Owner or Contact Person (PRINT) Trent Moore
 2. Site Address 1244 2nd Avenue
 City, State Oakland, CA Zip 94606 Phone 415-359-2400
 3. Mailing Address c/o Trent Moore, 2655 Van Ness Ave., Ste. 2
 City, State San Francisco, CA Zip 94109 Phone 415-359-2400
 4. Property Owner 1244 2nd Avenue LLC
 Business Name (if applicable) 1244 2nd Avenue LLC
 Address c/o Trent Moore, 2655 Van Ness Ave., Ste. 2
 City, State San Francisco, CA Zip 94109 Phone 415-359-2400
 5. Generator name under which tank will be manifested
1244 2nd Avenue LLC
- EPA I.D. No. under which tank(s) will be manifested C A C 0 0 2 8 3 0 3 1 3

SR#0028723

Permits for which no major inspection has been approved within 180 days shall expire by limitation. No refund more than 180 days after expiration of final. Applications for which no permit is issued within 90 days shall expire by limitation. No refund more than 180 days after expiration of final.



CITY OF OAKLAND

250 FRANK H. OGAWA PLAZA • 2ND FLOOR • OAKLAND, CA 94612

Planning and Building Department
www.oaklandnet.com

PH: 510-238-3891
FAX: 510-238-2263
TDD: 510-238-3254



Permit No: X1502527 OPW - Excavation

Filed Date: 11/4/2015

Job Site: 1244 2ND AVE

Schedule Inspection by calling: 510-238-3444

Parcel No: 020 012700100

For SL; X; and CGS permits see **SPECIAL NOTE** below

District:

Project Description: Remove UG storage tank in SIDEWALK AREA ONLY on International Blvd.
Please coordinate tank removal with Ms. Sheryl Skillern, MS - Supervising HazMat Inspector.
Soils report and related permits will be handled through her and/or Alameda County Department of Health.
If working within 25' feet of a monument you must comply with State Law 8771, contact the Inspector prior to starting excavation: minimum \$5,800.00 fine for non-compliance.

FIRE MARSHAL review required. 3rd FLOOR.
Call PWA INSPECTION prior to start: 510-238-3651. 4th FLOOR.

Related Permits:

	<u>Name</u>	<u>Applicant</u>	<u>Address</u>	<u>Phone</u>	<u>License #</u>
Owner:	1244 2ND AVE LLC		2655 VAN NESS AVE #2 SAN FRANCISCO, CA	415-254-4638	
Contractor:	LINDSAY & WILSON CONSTRUCTION SERVICES INC	X	5200 REDWOOD HIGHWAY SOUTH PETALUMA, CA	(707) 766-9511	
Contractor:	LINDSAY & WILSON CONSTRUCTION SERVICES INC		5200 REDWOOD HIGHWAY SOUTH PETALUMA, CA	(707) 766-9511	507442

PERMIT DETAILS: Building/Public Infrastructure/Excavation/NA

General Information

Excavation Type: Private Party
Date Street Last Resurfaced:
Worker's Compensation Company Name:
Worker's Compensation Policy #:
Special Paving Detail Required:
Tree Removal Involved:
Holiday Restriction (Nov 1 - Jan 1):
Limited Operation Area (7AM-9AM) And (4PM-6PM):

Key Dates

Approximate Start Date:
Approximate End Date:

TOTAL FEES TO BE PAID AT FILING: \$434.91

Application Fee	\$70.00	Excavation - Private Party Type	\$309.00	Records Management Fee	\$36.01
Technology Enhancement Fee	\$19.90				

Plans Checked By _____ Date _____ Permit Issued By _____ Date 11.4

SPECIAL NOTE

- For SL; X; and CGS permits Call PWA INSPECTION prior to start 510-238-3651 or visit 4th FLOOR.
- SL and X permits valid 90 days; CGS permits valid 30 days

ADDRESS: _____
DIST: _____

CITY OF OAKLAND
FIRE PREVENTION BUREAU
250 Frank Ogawa Plaza, Suite 3341
Oakland, California 94612-2032
(510) 238-3851

APPLICATION for PERMIT to INSTALL, REMOVE or REPAIR TANKS
In the CITY OF OAKLAND

Request Submittal Date: 9/24/15

PLEASE CIRCLE APPROPRIATE ACTIONS: Application is hereby made for permit to:

(a) Remove (b) Install (c) Repair (d) Modify (e) Abandon/Close in Place A

(a) Gasoline (b) Fuel oil (c) Diesel (d) _____ tank(s) and excavate, commencing:

(a) four feet inside the curb line*; (b) inside the property line; (c) aboveground; (d) underground tank(s)
*inside curb line, please attach copy of sidewalk/excavation permit from PLANNING AND BUILDING

on the west side of International Blvd St.Ave. 36 feet south of 2nd St./Ave.

Site Address: 1244 2nd Avenue Present storage diesel

Owner: 1244 2nd Avenue LLC Address c/o Trent Moore
2655 Van Ness Ave, Ste. 2 Phone 415-359-2400
San Francisco, CA 94109

Applicant: L&W Construction Serv. Address 5200 Redwood Hwy. S. Phone 707-766-9511
Petaluma, CA 94952

Sidewalk surface to be disturbed 3' X 12' Number of Tanks 1 Capacity 1500 Gallons ea.

Remarks _____

Signature George Wilson

PLEASE ATTACH/SUBMIT: (All applicants must have a City Business License Permit)

- (2) Copies of Closure Plans for underground tank removal (s)
- (2) Sets of plans and (1) copy of specifications for above ground tank removal
- (2) Sets of plans and (2) sets of application packets for underground tank installation/modifications
- (2) Sets of plans for aboveground tank installation and specifications
- copy or prepare to show Planning and Building approval for aboveground tank removal and tank repair

NOTE: FOR TANK INSTALLATION PLEASE SUBMIT THIS APPLICATION FORM ALONG WITH A APPLICATION FOR PERMIT TO OPERATE, MAINTAIN OR STORE

FOR OFFICE USE ONLY

Permit No. _____ Amt. Recv'd _____ Date Issued: _____

Copies to: Electrical Inspection ck# _____ Cash _____

Receipt# _____ Recv'd by: _____

APPENDIX B

MANIFESTS

WEIGHT TICKETS

RECEIPT FROM METAL RECYCLER

UNIFORM HAZARDOUS WASTE MANIFEST		1. Generator ID Number C 4 1 0 0 2 8 2 0 3 1 0	2. Page 1 of 1	3. Emergency Response Phone MPC 510 749 1300	4. Manifest Tracking Number 014378668 JJK		
5. Generator's Name and Mailing Address MPC ENVIRONMENTAL SERVICES INC 1244 DND AVE CONCORD, CA 94509				Generator's Site Address (if different than mailing address) 1244 DND AVE CONCORD, CA 94509			
Generator's Phone: 925 259 2400				6. Transporter 1 Company Name MPC ENVIRONMENTAL SERVICES INC		U.S. EPA ID Number C 4 1 0 0 2 8 2 0 3 1 0	
7. Transporter 2 Company Name				U.S. EPA ID Number			
8. Designated Facility Name and Site Address MPC ENVIRONMENTAL SERVICES INC 1244 DND AVE CONCORD, CA 94509				U.S. EPA ID Number C 4 1 0 0 2 8 2 0 3 1 0			
Facility's Phone: 925 259 2400							
9a. HM	9b. U.S. DOT Description (including Proper Shipping Name, Hazard Class, ID Number, and Packing Group (if any))	10. Containers		11. Total Quantity	12. Unit Wt./Vol.	13. Waste Codes	
		No.	Type				
X	1. HAZARDOUS WASTE UNIDENTIFIED	3	DRUM	950	KG	251	UN001
	2.						
	3.						
	4.						
14. Special Handling Instructions and Additional Information WEAR APPROPRIATE PERSONAL PROTECTIVE EQUIPMENT FOR USE DURING CONSTRUCTION 1605 FERRY POINT ALAMEDA, CA 94501							
15. GENERATOR'S/OFFEROR'S CERTIFICATION: I hereby declare that the contents of this consignment are fully and accurately described above by the proper shipping name, and are classified, packaged, marked and labeled/placarded, and are in all respects in proper condition for transport according to applicable international and national governmental regulations. If export shipment and I am the Primary Exporter, I certify that the contents of this consignment conform to the terms of the attached EPA Acknowledgment of Consent. I certify that the waste minimization statement identified in 40 CFR 262.27(a) (if I am a large quantity generator) or (b) (if I am a small quantity generator) is true.							
Generator's/Offeror's Printed/Typed Name				Signature		Month Day Year	
16. International Shipments <input type="checkbox"/> Import to U.S. <input type="checkbox"/> Export from U.S. Port of entry/exit: _____ Date leaving U.S.: _____							
17. Transporter Acknowledgment of Receipt of Materials							
Transporter 1 Printed/Typed Name				Signature		Month Day Year	
Transporter 2 Printed/Typed Name				Signature		Month Day Year	
18. Discrepancy							
18a. Discrepancy Indication Space <input type="checkbox"/> Quantity <input type="checkbox"/> Type <input type="checkbox"/> Residue <input type="checkbox"/> Partial Rejection <input type="checkbox"/> Full Rejection							
Manifest Reference Number: _____							
18b. Alternate Facility (or Generator)						U.S. EPA ID Number	
Facility's Phone: _____							
18c. Signature of Alternate Facility (or Generator)						Month Day Year	
19. Hazardous Waste Report Management Method Codes (i.e., codes for hazardous waste treatment, disposal, and recycling systems)							
1.		2.		3.		4.	
20. Designated Facility Owner or Operator: Certification of receipt of hazardous materials covered by the manifest except as noted in Item 18a							
Printed/Typed Name				Signature		Month Day Year	

GENERATOR

INT'L

TRANSPORTER

DESIGNATED FACILITY

UNIFORM HAZARDOUS WASTE MANIFEST		1. Generator ID Number 0740002030313	2. Page 1 of 1	3. Emergency Response Phone HRC 610 749 1300	4. Manifest Tracking Number 014378654 JJK			
5. Generator's Name and Mailing Address 1244 2ND AVENUE LLC 2655 VAN NESS AVE STE 2 SAN FRANCISCO CA 94109 Generator's Phone: 415 350 2400				Generator's Site Address (if different than mailing address) 1244 2ND AVENUE LLC 1244 2ND AVE OAKLAND CA 94609				
6. Transporter 1 Company Name HRC ENVIRONMENTAL SERVICES INC				U.S. EPA ID Number 074000030313				
7. Transporter 2 Company Name				U.S. EPA ID Number				
8. Designated Facility Name and Site Address Haverbank Oil Transfer, LLC 2300 Claus Road Bldg 11 Haverbank CA 95037 Facility's Phone: 925 863 8184				U.S. EPA ID Number 074000030313				
GENERATOR	9a. HM	9b. U.S. DOT Description (including Proper Shipping Name, Hazard Class, ID Number, and Packing Group (if any))	10. Containers		11. Total Quantity	12. Unit Wt./Vol.	13. Waste Codes	
			No.	Type				
	X	1. NON-PCFA HAZARDOUS WASTE LIQUID - UNCL - WASTE	001	11	200	G	220	
		2.						
		3.						
	4.							
14. Special Handling Instructions and Additional Information WEAR APPROPRIATE PERSONAL PROTECTIVE EQUIPMENT (JOB# - P08.0095) IN CONSTRUCTION NOTES: 1805 PERMIT POINT ALAMEDA, CA 94503								
15. GENERATOR'S/OFFEROR'S CERTIFICATION: I hereby declare that the contents of this consignment are fully and accurately described above by the proper shipping name, and are classified, packaged, marked and labeled/placarded, and are in all respects in proper condition for transport according to applicable international and national governmental regulations. If export shipment and I am the Primary Exporter, I certify that the contents of this consignment conform to the terms of the attached EPA Acknowledgment of Consent. I certify that the waste minimization statement identified in 40 CFR 262.27(a) (if I am a large quantity generator) or (b) (if I am a small quantity generator) is true.								
Generator's/Offoror's Printed/Typed Name SAITE ALAPA 71				Signature 		Month Day Year 12 8 15		
INT'L	16. International Shipments <input type="checkbox"/> Import to U.S. <input type="checkbox"/> Export from U.S. Port of entry/exit: _____ Transporter signature (for exports only): _____ Date leaving U.S.: _____							
	17. Transporter Acknowledgment of Receipt of Materials							
TRANSPORTER	Transporter 1 Printed/Typed Name S...				Signature 		Month Day Year 12 8 15	
	Transporter 2 Printed/Typed Name				Signature		Month Day Year	
DESIGNATED FACILITY	18. Discrepancy							
	18a. Discrepancy Indication Space <input type="checkbox"/> Quantity <input type="checkbox"/> Type <input type="checkbox"/> Residue <input type="checkbox"/> Partial Rejection <input type="checkbox"/> Full Rejection Manifest Reference Number: _____							
	18b. Alternate Facility (or Generator)				U.S. EPA ID Number			
	Facility's Phone:						Month Day Year	
	18c. Signature of Alternate Facility (or Generator)						Month Day Year	
19. Hazardous Waste Report Management Method Codes (i.e., codes for hazardous waste treatment, disposal, and recycling systems)								
1.		2.		3.		4.		
20. Designated Facility Owner or Operator: Certification of receipt of hazardous materials covered by the manifest except as noted in Item 18a								
Printed/Typed Name				Signature		Month Day Year		



NON-HAZARDOUS SPECIAL WASTE & ASBESTOS MANIFEST

2878636

If waste is asbestos waste, complete Sections I, II, III and IV
If waste is NOT asbestos waste, complete Sections I, II and III

I. GENERATOR (Generator completes la-r)

Form I: Generator information including US EPA ID Number, Manifest Document Number, Generator Name and Location, Mailing Address, Phone numbers, and Waste Profile # (51271520398).

GENERATOR'S CERTIFICATION: I hereby certify that the above named material is not a hazardous waste as defined by 40 CFR 261 or any applicable state law, has been properly described, classified and packaged, and is in proper condition for transportation according to applicable regulations; AND, if this waste is a treatment residue of a previously restricted hazardous waste subject to the Land Disposal Restrictions, I certify and warrant that the waste has been treated in accordance with the requirements of 40 CFR 268 and is no longer a hazardous waste as defined by 40 CFR 261.

Form I continued: Generator Authorized Agent Name (SAITE ALAPATI), Signature, and Date (12-9-15).

II. TRANSPORTER (Generator completes IIa-b and Transporter completes IIc-e)

Form II: Transporter information including Name and Address (NRC ENVIRONMENTALS), Phone (510-749-1390), Driver Name (Felipe Aravalo), Signature, and Date (12/9/15).

III. DESTINATION (Generator complete IIIa-c and Destination Site completes III d-g)

Form III: Destination information including Disposal Facility and Site Address (Newby Island Landfill), US EPA Number (408-262-1401), Discrepancy Indication Space (1210857), and Authorized Agent Signature/Date.

IV. ASBESTOS (Generator completes IVa-f and Operator complete IVg-i)

Form IV: Asbestos information including Operator's Name and Address, Responsible Agency Name and Address, Special Handling Instructions, Friable/Non-Friable checkboxes, and Operator Signature/Date.



NON-HAZARDOUS SPECIAL WASTE & ASBESTOS MANIFEST

2878639

If waste is asbestos waste, complete Sections I, II, III and IV
If waste is NOT asbestos waste, complete Sections I, II and III

I. GENERATOR (Generator completes Ia-f)

Form I: Generator information including US EPA ID Number, Manifest Document Number, Generator's Name and Location, Mailing Address, Phone, and Owner's Name.

II. TRANSPORTER (Generator completes IIa-b and Transporter completes IIc-e)

Form II: Transporter information including Name and Address, Phone, Driver Name, Signature, and Date.

III. DESTINATION (Generator complete IIIa-c and Destination Site completes III d-g)

Form III: Destination information including Disposal Facility and Site Address, US EPA Number, Discrepancy Indication Space, Name of Authorized Agent, Signature, and Date.

IV. ASBESTOS (Generator completes IVa-f and Operator complete IVg-i)

Form IV: Asbestos information including Operator's Name and Address, Responsible Agency Name and Address, Special Handling Instructions, Friable/Non-Friable status, Operator's Certification, Operator's Name and Title, Signature, and Date.



REPUBLIC SERVICES

NON-HAZARDOUS SPECIAL WASTE & ASBESTOS MANIFEST

2878637

If waste is asbestos waste, complete Sections I, II, III and IV
If waste is NOT asbestos waste, complete Sections I, II and III

I. GENERATOR (Generator completes Ia-r)

Form I: Generator information including EPA ID Number, Manifest Document Number, Generator Name and Location, Mailing Address, Phone, and Waste Profile table.

II. TRANSPORTER (Generator completes IIa-b and Transporter completes IIc-e)

Form II: Transporter information including Name and Address, Phone, Driver Name, Signature, and Date.

III. DESTINATION (Generator complete IIIa-c and Destination Site completes III d-g)

Form III: Destination information including Disposal Facility and Site Address, US EPA Number, Discrepancy Indication Space, and Authorized Agent details.

IV. ASBESTOS (Generator completes IVa-f and Operator complete IVg-i)

Form IV: Asbestos information including Operator's Name and Address, Responsible Agency Name and Address, Special Handling Instructions, and Operator's Certification.



NON-HAZARDOUS SPECIAL WASTE & ASBESTOS MANIFEST

2874042

If waste is asbestos waste, complete Sections I, II, III and IV
 If waste is NOT asbestos waste, complete Sections I, II and III

I. GENERATOR (Generator completes la-r)

a. Generator's US EPA ID Number N/A		b. Manifest Document Number		c. Page 1 of	
d. Generator's Name and Location: 1244 2nd Avenue LLC 1244 2nd Avenue Oakland, CA 94608			e. Generator's Mailing Address: 1244 2nd Avenue LLC 2855 Van Ness Ave, Ste 2 San Francisco, CA 94109		
f. Phone: 415-359-2400		g. Phone: 415-359-2400			
If owner of the generating facility differs from the generator, provide:					
h. Owner's Name:			i. Owner's Phone No.:		
j. Waste Profile #	k. Exp. Date	l. Waste Shipping Name and Description	m. Containers No. Type		n. Total Quantity
51271520388	12/2/2016	Soil	001	CM	10 CY
GENERATOR'S CERTIFICATION: I hereby certify that the above named material is not a hazardous waste as defined by 40 CFR 261 or any applicable state law, has been properly described, classified and packaged, and is in proper condition for transportation according to applicable regulations; AND, if this waste is a treatment residue of a previously restricted hazardous waste subject to the Land Disposal Restrictions. I certify and warrant that the waste has been treated in accordance with the requirements of 40 CFR 268 and is no longer a hazardous waste as defined by 40 CFR 261.					
p. Generator Authorized Agent Name (Print) SAITE KUMARI		q. Signature <i>[Signature]</i>		r. Date 12-8-15	

II. TRANSPORTER (Generator completes IIa-b and Transporter completes IIc-e)

a. Transporter's Name and Address: NRC Environmental 1005 FRING PT Alameda Ca 94501		
b. Phone: <i>[Phone Number]</i>		Biz # 3332
c. Driver Name (Print) <i>[Name]</i>	d. Signature <i>[Signature]</i>	e. Date 12/8/15

III. DESTINATION (Generator complete IIIa-c and Destination Site completes IIId-g)

a. Disposal Facility and Site Address: Newby Island Landfill 1601 Dixon Landing Rd Milpitas, CA 95035		c. US EPA Number 408-262-1401	d. Discrepancy Indication Space: 1210458
b. I hereby certify that the above named material has been accepted and to the best of my knowledge the foregoing is true and accurate.			
e. Name of Authorized Agent (Print) <i>[Name]</i>		f. Signature <i>[Signature]</i>	g. Date 12/8/15

IV. ASBESTOS (Generator completes IVa-f and Operator complete IVg-i)

a. Operator's Name and Address:		c. Responsible Agency Name and Address:	
b. Phone:		d. Phone:	
e. Special Handling Instructions and Additional Information:			
f. <input type="checkbox"/> Friable <input type="checkbox"/> Non-Friable <input type="checkbox"/> Both % Friable % Non-Friable			
OPERATOR'S CERTIFICATION: I hereby declare that the contents of this consignment are fully and accurately described above by the proper shipping name and are classified, packaged, marked and labeled/placarded, and are in all respects in proper condition for transport according to applicable international and national governmental regulations.			
g. Operator's Name and Title (Print)		h. Signature	
		i. Date	
*Operator refers to the company which owns, leases, operates, controls, or supervises the facility being demolished or renovated, or the demolition or renovation operation or both			



NON-HAZARDOUS SPECIAL WASTE & ASBESTOS MANIFEST

2874043

If waste is asbestos waste, complete Sections I, II, III and IV
If waste is NOT asbestos waste, complete Sections I, II and III

Job # 99956

I. GENERATOR (Generator completes Ia-r)

Form I: Generator information including US EPA ID Number, Manifest Document Number, Generator Name and Location, Mailing Address, Phone, and Waste Profile table.

II. TRANSPORTER (Generator completes IIa-b and Transporter completes IIc-e)

Form II: Transporter information including Name and Address, Phone, Driver Name, Signature, and Date.

III. DESTINATION (Generator complete IIIa-c and Destination Site completes IIId-g)

Form III: Destination information including Disposal Facility and Site Address, US EPA Number, Discrepancy Indication Space, and Authorized Agent details.

IV. ASBESTOS (Generator completes IVa-f and Operator complete IVg-i)

Form IV: Asbestos information including Operator's Name and Address, Responsible Agency Name and Address, Special Handling Instructions, and Operator's Certification.

5342



NON-HAZARDOUS SPECIAL WASTE & ASBESTOS MANIFEST

2874044

If waste is asbestos waste, complete Sections I, II, III and IV
If waste is NOT asbestos waste, complete Sections I, II and III

I. GENERATOR (Generator completes Ia-r)

a. Generator's US EPA ID Number N/A		b. Manifest Document Number		c. Page 1 of	
d. Generator's Name and Location: 1244 2nd Avenue LLC 1244 2nd Avenue Oakland, CA 94606			e. Generator's Mailing Address: 1244 2nd Avenue LLC 2655 Van Ness Ave, Ste 2 San Francisco, CA 94109		
f. Phone: 415-359-2400			g. Phone: 415-359-2400		
If owner of the generating facility differs from the generator, provide:					
h. Owner's Name:			i. Owner's Phone No.:		
j. Waste Profile #	k. Exp. Date	l. Waste Shipping Name and Description	m. Containers No. Type		n. Total Quantity
51271520388	12/2/2016	Soil	001	CM	10
					CY
GENERATOR'S CERTIFICATION: I hereby certify that the above named material is not a hazardous waste as defined by 40 CFR 261 or any applicable state law, has been properly described, classified and packaged, and is in proper condition for transportation according to applicable regulations; AND, if this waste is a treatment residue of a previously restricted hazardous waste subject to the Land Disposal Restrictions. I certify and warrant that the waste has been treated in accordance with the requirements of 40 CFR 268 and is no longer a hazardous waste as defined by 40 CFR 261.					
p. Generator Authorized Agent Name (Print) JAITE MURATI			q. Signature <i>[Signature]</i>		r. Date 12-8-15

II. TRANSPORTER (Generator completes IIa-b and Transporter completes IIc-e)

a. Transporter's Name and Address: ARC Environmental 1605 Finna St Alameda CA			Bin 3244		
b. Phone:					
c. Driver Name (Print) RUFUS BROWN		d. Signature <i>[Signature]</i>		e. Date 12-8-15	

III. DESTINATION (Generator complete IIIa-c and Destination Site completes IIId-g)

a. Disposal Facility and Site Address: Newby Island Landfill 1801 Dixon Landing Rd Milpitas, CA 95035		c. US EPA Number 408-262-1401	d. Discrepancy Indication Space: 1210467
I hereby certify that the above named material has been accepted and to the best of my knowledge the foregoing is true and accurate.			
e. Name of Authorized Agent (Print) MDC		f. Signature <i>[Signature]</i>	
		g. Date 12/8/15	

IV. ASBESTOS (Generator completes IVa-f and Operator complete IVg-i)

a. Operator's Name and Address:		c. Responsible Agency Name and Address:	
b. Phone:		d. Phone:	
e. Special Handling Instructions and Additional Information:			
f. <input type="checkbox"/> Friable <input type="checkbox"/> Non-Friable <input type="checkbox"/> Both % Friable % Non-Friable			
OPERATOR'S CERTIFICATION: I hereby declare that the contents of this consignment are fully and accurately described above by the proper shipping name and are classified, packaged, marked and labeled/placarded, and are in all respects in proper condition for transport according to applicable international and national governmental regulations.			
g. Operator's Name and Title (Print)		i. Date	
h. Signature			
*Operator refers to the company which owns, leases, operates, controls, or supervises the facility being demolished or renovated, or the demolition or renovation operation or both			

Circosta Iron and Metal Company Inc.

415-282-8568
1801 Evans Avenue
San Francisco CA 94124
RC2707

Tick#	By Sam	8:25:12 AM	12/9/2015	
Gross	Tare	Net Lbs	Price	Amount
HMS - HMS #1			(SC=\$50.00)	
10,720.00	9,160.00	1,560.00	50.00	39.00
Amt (Before Tax)				39.00
Sales Tax (0.08%)				0.00
Amt (After Tax)				\$39.00
Ticket Total				39.00
* THIRTY-NINE AND XX / 100				
Date	Mode	Trn #	Amount	
12/9/2015	Cash		39.00	

Print Name: saite misipele

CUSTOMER COPY

Address: 1050 forselles way

City/ST/Zip: hayward/ca/94544

State of issuance:

I hereby state that I'm the lawful owner of the material described heron, that I have a right to sell same, that all REDEMPTION material is in fact valid REDEMPTION material and that for payment received in full, hereby acknowledged,

Circosta Iron and Metal Company Inc.

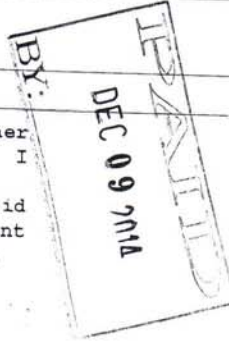

X

You must return this receipt 3 days or later to receive money. THANK YOU!

TE International Disposal Corp of Ca
 Milpitas, CA 95035 408-262-1401
 JSTOMER
 000880
 CSJ WATER POLLUTION CONTROL
 700 LOS ESTEROS RD
 ATTN: ACCOUNTS PAYABLE
 5127Y810688

SITE	TICKET #	CELL
Y1	1218936	
WEIGHMASTER		
Matti D.		
DATE/TIME IN	DATE/TIME OUT	
01-08-2016 1:38 pm	01-8-2016 1:38 pm	
VEHICLE	CONTAINER	
D5		
REFERENCE	INVOICE	
BILL OF LADING	2878639	

SCALE IN GROSS WEIGHT 51,920 NET TONS 14.00
 TARE OUT TARE WEIGHT 23,920 NET WEIGHT 28,000 INBOUND

QTY.	UNIT	DESCRIPTION	RATE	EXTENSION	TAX	TOTAL
10.00	YD	TRACKING QTY				
14.00	TN	SW-BIOSOLIDS ISJ-San Jose				

WEIGHMASTER CERTIFICATE - THIS IS TO CERTIFY that the following described commodity was weighed, measured, or counted by a weighmaster, whose signature is on this certificate, who is a recognized authority of accuracy, as prescribed by Chapter 7 (commencing with Section 12700) of Division 5 of the California Business and Professions Code, administered by the Division of Measurement Standards of the California Department of Food & Agriculture. The undersigned hereby certifies and attests on the basis of the foregoing that the above information is true and correct and that he or she has the authority to sign this document on behalf of the customer.

NET AMOUNT
TENDERED
CHANGE
CHECK#

RS-F042UPR (07/12)

SIGNATURE _____

SITE International Disposal Corp of Ca
 Milpitas, CA 95035 408-262-1401
 CUSTOMER
 900097
 L&W CONSTRUCTION SERVICES
 5200 REDWOOD HIGHWAY SOUTH
 PETALUMA, CA 94952
 51271520388

SITE	TICKET #	CELL
Y1	1210458	
WEIGHMASTER		
Matti D.		
DATE/TIME IN	DATE/TIME OUT	
12-08-2015 1:53 pm	12-8-2015 2:15 pm	
VEHICLE	CONTAINER	
NRC2116	20L	
REFERENCE	INVOICE	
BILL OF LADING	2874042	

SCALE IN	GROSS WEIGHT	43,900	NET TONS	7.61	
SCALE OUT	TARE WEIGHT	28,680	NET WEIGHT	15,220	INBOUND

QTY.	UNIT	DESCRIPTION	RATE	EXTENSION	TAX	TOTAL
20.00	YD	TRACKING QTY				
7.61	TN	SW-CONT SOIL-ALT DAILY COVE Oakland	\$40.00	\$304.40	\$0.00	\$304.40
1.00		ENVIRONMENTAL FEE 1	\$15.00	\$15.00	\$0.00	\$15.00
1.00		FUEL RECOVERY FEE	5.11%	\$15.55	\$0.00	\$15.55

WEIGHMASTER CERTIFICATE - THIS IS TO CERTIFY that the following described commodity was weighed, measured, or counted by a weighmaster, whose signature is on this certificate, who is a recognized authority of accuracy, as prescribed by Chapter 7 (commencing with Section 12700) of Division 5 of the California Business and Professions Code, administered by the Division of Measurement Standards of the California Department of Food & Agriculture.

NET AMOUNT	
	\$334.95
TENDERED	
CHANGE	\$0.00
CHECK#	\$0.00

The undersigned hereby certifies that the above described commodity was weighed, measured, or counted by a weighmaster, whose signature is on this certificate, who is a recognized authority of accuracy, as prescribed by Chapter 7 (commencing with Section 12700) of Division 5 of the California Business and Professions Code, administered by the Division of Measurement Standards of the California Department of Food & Agriculture.

RS-F042UPR (07/12)

SIGNATURE _____

SITE International Disposal Corp of Ca
 Milpitas, CA 95035 408-262-1401

CUSTOMER
 900097
 L&W CONSTRUCTION SERVICES
 5200 REDWOOD HIGHWAY SOUTH
 PETALUMA, CA 94952
 51271520388

SITE	TICKET #	CELL
Y1	1210467	
WEIGHMASTER		
Matti D.		
DATE/TIME IN		DATE/TIME OUT
12-08-2015 1:59 pm		12-8-2015 2:25 pm
VEHICLE		CONTAINER
NRC-2137		20L
REFERENCE	INVOICE	
BILL OF LADING	2874044	

SCALE IN	GROSS WEIGHT	51,220	NET TONS	11.35	
SCALE OUT	TARE WEIGHT	28,520	NET WEIGHT	22,700	INBOUND

QTY.	UNIT	DESCRIPTION	RATE	EXTENSION	TAX	TOTAL
20.00	YD	TRACKING QTY				
11.35	TN	SW-CONT SOIL-ALT DAILY COVE Oakland	\$40.00	\$454.00	\$0.00	\$454.00
1.00		ENVIRONMENTAL FEE 1	\$15.00	\$15.00	\$0.00	\$15.00
1.00		FUEL RECOVERY FEE	5.11%	\$23.20	\$0.00	\$23.20

WEIGHMASTER CERTIFICATE - THIS IS TO CERTIFY that the following described commodity was weighed, measured, or counted by a weighmaster, whose signature is on this certificate, who is a recognized authority of accuracy, as prescribed by Chapter 7 (commencing with Section 12700) of Division 5 of the California Business and Professions Code, administered by the Division of Measurement Standards of the California Department of Food & Agriculture.

The undersigned individual signing this document on behalf of the customer hereby certifies that he or she has read and understands the terms and conditions on the reverse side and that he or she has the authority to sign this document on behalf of the customer.

NET AMOUNT	
	\$492.20
TENDERED	
CHARGE	\$0.00
CHECK#	\$0.00

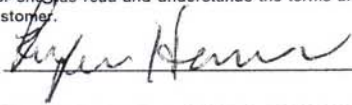
SIGNATURE 

SITE International Disposal Corp of Ca
 CUSTOMER Milpitas, CA 95035 408-262-1401
 900097
 L&W CONSTRUCTION SERVICES
 5200 REDWOOD HIGHWAY SOUTH
 PETALUMA, CA 94952
 51271520388

SITE	TICKET #	CELL
Y1	1212041	
WEIGHMASTER		
Matti D.		
DATE/TIME IN	DATE/TIME OUT	
12-14-2015 10:26 am	12-14-2015 10:52 am	
VEHICLE	CONTAINER	
NRC2116	20L	
REFERENCE	INVOICE	
BILL OF LADING	2878637	

SCALE IN GROSS WEIGHT 39,280 NET TONS 5.39
 SCALE OUT TARE WEIGHT 28,500 NET WEIGHT 10,780 INBOUND

QTY.	UNIT	DESCRIPTION	RATE	EXTENSION	TAX	TOTAL
20.00	YD	TRACKING QTY				
5.39	TN	SW-CONT SOIL-ALT DAILY COVE Oakland	\$40.00	\$215.60	\$0.00	\$215.60
1.00		ENVIRONMENTAL FEE 1	\$15.00	\$15.00	\$0.00	\$15.00
1.00		FUEL RECOVERY FEE	5.11%	\$11.02	\$0.00	\$11.02

WEIGHMASTER CERTIFICATE - THIS IS TO CERTIFY that the following described commodity was weighed, measured, or counted by a weighmaster, whose signature is on this certificate, who is a recognized authority of accuracy, as prescribed by Chapter 7 (commencing with Section 12700) of Division 5 of the California Business and Professions Code, administered by the Division of Measurement Standards of the California Department of Food & Agriculture, on the reverse side and that he or she has the authority to sign this document on behalf of the customer.

NET AMOUNT
\$241.62
TENDERED
\$0.00
CHANGE
\$0.00
CHECK#

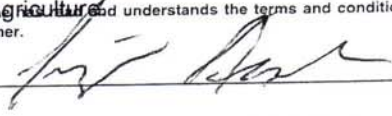
SIGNATURE 

SITE International Disposal Corp of Ca
 Milpitas, CA 95035 408-262-1401

CUSTOMER
 900097
 L&W CONSTRUCTION SERVICES
 5200 REDWOOD HIGHWAY SOUTH
 PETALUMA, CA 94952
 51271520388

SITE	TICKET #	CELL
Y1	1210857	
WEIGHMASTER		
IN - Humberto P. OIT - Matti D.		
DATE/TIME IN	DATE/TIME OUT	
12-09-2015 1:31 pm	12-9-2015 1:56 pm	
VEHICLE	CONTAINER	
NRC-2137	20L	
REFERENCE	INVOICE	
BILL OF LADING	2878636	

SCALE IN GROSS WEIGHT 46,460 NET TONS 9.03
 SCALE OUT TARE WEIGHT 28,400 NET WEIGHT 18,060 INBOUND

QTY.	UNIT	DESCRIPTION	RATE	EXTENSION	TAX	TOTAL
20.00	YD	TRACKING QTY				
9.03	TN	SW-CONT SOIL-ALT DAILY COVE Oakland	\$40.00	\$361.20	\$0.00	\$361.20
1.00		ENVIRONMENTAL FEE 1	\$15.00	\$15.00	\$0.00	\$15.00
1.00		FUEL RECOVERY FEE	5.11%	\$18.46	\$0.00	\$18.46

WEIGHMASTER CERTIFICATE - THIS IS TO CERTIFY that the following described commodity was weighed, measured, or counted by a weighmaster, whose signature is on this certificate, who is a recognized authority of accuracy, as prescribed by Chapter 7 (commencing with Section 12700) of Division 5 of the California Business and Professions Code, administered by the Division of Measurement Standards of the California Department of Food & Agriculture.

The undersigned individual signing this document on behalf of Customer hereby certifies that he or she has read and understands the terms and conditions on the reverse side and that he or she has the authority to sign this document on behalf of the customer.

NET AMOUNT	
	\$394.66
TENDERED	
CHANGE	\$0.00
CHECK#	\$0.00

SIGNATURE 

SITE International Disposal Corp of Ca
 Milpitas, CA 95035 408-262-1401

CUSTOMER
 900097
 L&W CONSTRUCTION SERVICES
 5200 REDWOOD HIGHWAY SOUTH
 PETALUMA, CA 94952
 51271520388

SITE	TICKET #	CELL
Y1	1210888	
WEIGHMASTER		
IN - Humberto P. OUT - Matti D.		
DATE/TIME IN	DATE/TIME OUT	
12-09-2015 2:29 pm	12-9-2015 2:53 pm	
VEHICLE	CONTAINER	
NRC2116	20L	
REFERENCE	INVOICE	
BILL OF LADING	2874043	

SCALE IN GROSS WEIGHT 47,860 NET TONS 9.64
 SCALE OUT TARE WEIGHT 28,580 NET WEIGHT 19,280 INBOUND

QTY.	UNIT	DESCRIPTION	RATE	EXTENSION	TAX	TOTAL
20.00	YD	TRACKING QTY				
9.64	TN	SW-CONT SOIL-ALT DAILY'COVE Oakland	\$40.00	\$385.60	\$0.00	\$385.60
1.00		ENVIRONMENTAL FEE 1	\$15.00	\$15.00	\$0.00	\$15.00
1.00		FUEL RECOVERY FEE	5.11%	\$19.70	\$0.00	\$19.70

WEIGHMASTER CERTIFICATE - THIS IS TO CERTIFY that the following described commodity was weighed, measured, or counted by a weighmaster, whose signature is on this certificate, who is a recognized authority of accuracy, as prescribed by Chapter 7 (commencing with Section 12700) of Division 5 of the California Business and Professions Code, administered by the Division of Measurement Standards of the California Department of Food & Agriculture.

The undersigned individual, signing this document on behalf of Customer, acknowledges that he or she has read and understands the terms and conditions on the reverse side and that he or she has the authority to sign this document on behalf of the customer.

NET AMOUNT
\$420.30
TENDERED
\$0.00
CHANGE
\$0.00
CHECK#

RS-F042UPR (07/12)

SIGNATURE 

APPENDIX C

CHAIN OF CUSTODY

LABORATORY CERTIFICATES OF ANALYSIS

A & R Laboratories

Ms. Jean Lindsay
L & W Construction Services, Inc.
5200 Redwood Hwy S.
Petaluma, CA 94952

12/10/2015

Project: 15-232
Project Site: 1244 2nd Ave., Oakland, CA
Sample Date: 12/8/2015
Lab Job No.: L15L008

Dear Ms. Jean Lindsay:

Enclosed please find the analytical report for the samples received by A & R Laboratories on 12/10/2015 and analyzed by the following EPA methods:

EPA 8260B (BTEX & Napthalene)
EPA 8015M (TPH-Diesel)

All analyses have met the QA/QC criteria of this laboratory.

The sample(s) arrived in good conditions (i.e., chilled, intact) and with a chain of custody record attached.

A & R Laboratories is certified by the CA DHS (Certificate No.2789). Thank you for giving us the opportunity to serve you.

Please feel free to call me at (951)779-0310 if our laboratory can be of further service to you.

Respectfully,
A & R Laboratories

Ken Zheng, M.S.
Laboratory Director

Enclosures
This cover letter is an integral part of this analytical report.

A & R Laboratories

Client:	L & W Construction Services, Inc.	Lab Job No.:	L15L008
Project:	15-232	Date Sampled:	12/8/2015
Project Site:	1244 2nd Ave., Oakland, CA	Date Received:	12/10/2015
Matrix:	Water	Date Analyzed:	12/10/2015
Batch No.:	1210-VOCW4	Date Reported:	12/10/2015

EPA 8260B (BTEX, Oxy. & Naphthalene)

Reporting Unit: ug/L (PPB)

Date Analyzed		12/10/15			
Dilution Factor		100			
Lab Sample I.D.		L15L008-1			
Client Sample I.D.		15-232-GW			
Compound	RL				
Benzene	0.5	ND			
Toluene	0.5	ND			
Ethylbenzene	0.5	ND			
Total Xylene	1	ND			
MTBE	0.5	ND			
Ethyl-t-butyl Ether (ETBE)	1	ND			
Diisopropyl ether (DIPE)	1	ND			
TAME	1	ND			
t-Butanol	10	ND			
Naphthalene	1	500			

RL: Reporting Limit.

ND: Not Detected (Below Reporting Limit X Dilution Factor).

A & R Laboratories

Client: L & W Construction Services, Inc. Lab Job No.: L15L008
Project: 15-232 Date Sampled: 12/8/2015
Project Site: 1244 2nd Ave., Oakland, CA Date Received: 12/10/2015
Matrix: Water Date Analyzed: 12/10/2015
Batch No.: AL10 & BL10-DW Date Reported: 12/10/2015

EPA 8015M (TPH-Diesel)

Reporting Unit: mg/L (PPM)

Client Sample ID	Lab ID	Dilution Factor	Diesel		
			C12-C28		
	RL		0.1		
15-232-GW	L15L008-1	1	50		

RL=Reporting Limit; ND=Not Detected (Below RL).

A & R Laboratories

EPA 8260B (VOCs) Batch QA/QC Report

Client: L & W Construction Services, Inc.
Project: 15-232
Matrix: Water
Batch No.: 1210-VOCW4

Lab Job No.: L15L008
Lab Sample ID: LCS
Date Analyzed: 12/10/2015
Date Reported: 12/10/2015

MB/LCS/LCSD Report

Unit: ug/L(PPB)

Compound	Method Blank	Spike Conc.	LCS	LCSD	LCS %Rec.	LCSD %Rec.	%RPD	%RPD Accept Limit	%Rec. Accept Limit
1,1-Dichloroethene	ND	20	19.5	20.5	97.5	103	5	≤20	80-120
Benzene	ND	20	20.2	19.5	101	98	4	≤20	80-120
Trichloroethene	ND	20	18.0	19.8	90	99	10	≤20	80-120
Toluene	ND	20	19.5	20.9	98	105	7	≤20	80-120
Chlorobenzene	ND	20	20.3	19.5	102	98	4	≤20	80-120

MB: Method Blank.

ND: Not Detected (Below MDL).

A & R Laboratories

EPA 8015B (TPH-Diesel) Batch QA/QC Report

Client: L & W Construction Services, Inc.
Project: 15-232
Matrix: Water
Batch No.: BL10-DW

Lab Job No.: L15L008
Lab Sample ID: LCS
Date Analyzed: 12/10/2015
Date Reported: 12/10/2015

MB/LCS/LCSD Report

Unit:mg/L (PPM)

Analyte	Method	Spike	LCS	LCSD	LCS	LCSD	%RPD	%RPD	%Rec
	Blank	Conc.			%Rec.	%rec.		Accept	Accept
								Limit	Limit
TPH-D	ND	500	450	445	90	89	1	≤20	80-120

ND: Not Detected (at the specified limit).

MB: Method Blank.

LCS: Lab Control Sample.

LCSD: Lab Control Sample Duplicate.

A & R Laboratories

Ms. Jean Lindsay
L & W Construction Services, Inc.
5200 Redwood Hwy S.
Petaluma, CA 94952

12/10/2015

Project: 15-232
Project Site: 1244 2nd Ave., Oakland, CA
Sample Date: 12/9/2015
Lab Job No.: L15L010

Dear Ms. Jean Lindsay:

Enclosed please find the analytical report for the samples received by A & R Laboratories on 12/10/2015 and analyzed by the following EPA methods:

EPA 8260B (VOCs & Oxy.)
EPA 9045C (pH)
EPA 8015M (TPH-Diesel)
EPA 1030 (Flammability)
EPA 6010B (LUFT 5 Metals)

All analyses have met the QA/QC criteria of this laboratory.

The sample(s) arrived in good conditions (i.e., chilled, intact) and with a chain of custody record attached.

A & R Laboratories is certified by the CA DHS (Certificate No.2789). Thank you for giving us the opportunity to serve you.

Please feel free to call me at (951)779-0310 if our laboratory can be of further service to you.

Respectfully,

A & R Laboratories

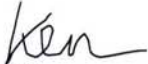
Ken Zheng, M.S.
Laboratory Director

Enclosures

This cover letter is an integral part of this analytical report.

A & R Laboratories

Client: L & W Construction Services, Inc.
 Project: 15-232
 Project Site: 1244 2nd Ave., Oakland, CA
 Matrix: Soil
 Batch No.: 1210-VOCS4

Lab Job No.: L15L010
 Date Sampled: 12/9/2015
 Date Received: 12/10/2015
 Date Analyzed: 12/10/2015
 Date Reported: 12/10/2015

EPA 8260B (VOCs & Oxy.) by GC/MS, Page 1 of 2
 Reporting Unit: mg/kg (PPM)

Date Analyzed	12/10/15		
Dilution Factor	1		
Lab Sample I.D.	L15L010-2		
Client Sample I.D.	15-232-12-9		
Compound	RL		
Dichlorodifluoromethane	0.005	ND	
Chloromethane	0.005	ND	
Vinyl Chloride	0.005	ND	
Bromomethane	0.005	ND	
Chloroethane	0.005	ND	
Trichlorofluoromethane	0.005	ND	
1,1-Dichloroethene	0.005	ND	
Carbon disulfide	0.005	ND	
Methylene chloride	0.005	ND	
Trans-1,2-Dichloroethene	0.005	ND	
1,1-Dichloroethane	0.005	ND	
2,2-Dichloropropane	0.005	ND	
Cis-1,2-Dichloroethene	0.002	ND	
Bromochloromethane	0.005	ND	
Chloroform	0.005	ND	
1,1,1-Trichloroethane	0.005	ND	
Vinyl acetate	0.005	ND	
Carbontetrachloride	0.005	ND	
1,1-Dichloropropene	0.005	ND	
1,2-Dichloroethane	0.005	ND	
Benzene	0.001	ND	
Trichloroethene	0.002	ND	
1,2-Dichloropropane	0.005	ND	
Methyl methacrylate	0.005	ND	
Dibromomethane	0.005	ND	
Bromodichloromethane	0.005	ND	
2-Chloroethyl Vinyl Ether	0.005	ND	
Cis-1,3-Dichloropropene	0.005	ND	
Toluene	0.001	ND	
Trans-1,3-Dichloropropene	0.005	ND	
Ethylmethacrylate	0.005	ND	
1,1,2-Trichloroethane	0.005	ND	
Dibromochloromethane	0.005	ND	
1,2-Dibromoethane (EDB)	0.005	ND	
Tetrachloroethene	0.002	ND	
1,3-Dichloropropane	0.005	ND	
Chlorobenzene	0.005	ND	

RL=Reporting Limit; ND=Not Detected (Below Dilution Factor x RL).

A & R Laboratories

Client:	L & W Construction Services, Inc.	Lab Job No.:	L15L010
Project:	15-232	Date Sampled:	12/9/2015
Project Site:	1244 2nd Ave., Oakland, CA	Date Received:	12/10/2015
Matrix:	Soil	Date Analyzed:	12/10/2015
Batch No.:	1210-VOCS4	Date Reported:	12/10/2015

EPA 8260B (VOCs & Oxy.) by GC/MS, Page 2 of 2
Reporting Unit: mg/kg (PPM)

Date Analyzed		12/10/15	
Dilution Factor		1	
Lab Sample I.D.		L15L010-2	
Client Sample I.D.		15-232-12-9	
Compound	RL		
1,1,1,2-Tetrachloroethane	0.005	ND	
Ethylbenzene	0.001	ND	
Total Xylene	0.002	ND	
Styrene	0.005	ND	
Bromoform	0.005	ND	
Isopropyl benzene	0.005	ND	
Bromobenzene	0.005	ND	
1,2,3-Trichloropropane	0.005	ND	
1,1,2,2-Tetrachloroethane	0.005	ND	
Trans-1,4-dichloro-2-butene	0.005	ND	
2-Chlorotoluene	0.005	ND	
n-Propyl benzene	0.005	ND	
4-Chlorotoluene	0.005	ND	
1,3,5-Trimethyl benzene	0.005	ND	
tert-Butylbenzene	0.005	ND	
p-Isopropyl toluene	0.005	ND	
1,2,4-Trimethyl benzene	0.005	ND	
sec-Butylbenzene	0.005	ND	
1,3-Dichlorobenzene	0.005	ND	
1,4-Dichlorobenzene	0.005	ND	
1,2-Dichlorobenzene	0.005	ND	
n-Butylbenzene	0.005	ND	
1,2-Dibromo-3-chloropropa	0.005	ND	
1,2,4-Trichlorobenzene	0.005	ND	
Hexachlorobutadiene	0.005	ND	
Naphthalene	0.005	ND	
1,2,3-Trichlorobenzene	0.005	ND	
Aceton	0.950	ND	
2-Butanone(MEK)	0.300	ND	
MTBE	0.001	ND	
4-Methyl-2-Pentanone (MIBK)	0.050	ND	
Ethyl-t-butyl Ether(ETBE)	0.002	ND	
Diisopropyl ether (DIPE)	0.002	ND	
TAME	0.002	ND	
t-Butanol	0.020	ND	

RL=Reporting Limit; ND=Not Detected (Below Dilution Factor x RL).

A & R Laboratories

Client: L & W Construction Services, Inc. Lab Job No.: L15L010
Project: 15-232 Date Sampled: 12/9/2015
Project Site: 1244 2nd Ave., Oakland, CA Date Received: 12/10/2015
Matrix: Soil Date Analyzed: 12/10/2015
Batch No.: BL10-DS Date Reported: 12/10/2015

EPA 8015M (TPH-Diesel)

Reporting Unit: mg/kg (PPM)

Client Sample ID	Lab ID	Dilution Factor	Diesel		
			C12-C28		
	RL		10		
15-232-12-9	L15L010-2	1	ND		

RL=Reporting Limit; ND=Not Detected (Below RL).

A & R Laboratories

Client:	L & W Construction Services, Inc.	Lab Job No.:	L15L010
Project:	15-232	Date Sampled:	12/9/2015
Project Site:	1244 2nd Ave., Oakland, CA	Date Received:	12/10/2015
Matrix:	Soil	Date Digested:	12/10/2015
Extraction Method:	EPA 3050	Date Analyzed:	12/10/2015
Batch No.:	1210-MTS	Date Reported:	12/10/2015

EPA 6010B (LUFT 5 Metals)

Report Units: mg/kg (PPM)

Element	EPA Method	L15L010-2			RL
		15-232-12-9			
Cadmium (Cd)	6010B	ND			2
Chromium (Cr)	6010B	8.9			2
Lead (Pb)	6010B	ND			2
Nickel (Ni)	6010B	5.7			2
Zinc (Zn)	6010B	5.3			2

RL=Reporting Limit; ND=Not Detected (Below RL).

A & R Laboratories

Client: L & W Construction Services, Inc.
Project: 15-232
Project Site: 1244 2nd Ave., Oakland, CA
Matrix: Soil
Batch No.: 1210-FLAS

Lab Job No.: L15L010
Date Sampled: 12/9/2015
Date Received: 12/10/2015
Date Analyzed: 12/10/2015
Date Reported: 12/10/2015

EPA 1030 (Flash Point)

Unit: °F

Analyte	EPA	L15L010-2		
	Method	15-232-12-9		
Flash Point	1030	>200		

A & R Laboratories

Client: L & W Construction Services, Inc.
Project: 15-232
Project Site: 1244 2nd Ave., Oakland, CA
Matrix: Soil
Batch No.: 1110-pH

Lab Job No.: L15L010
Date Sampled: 12/9/2015
Date Received: 12/10/2015
Date Analyzed: 12/10/2015
Date Reported: 12/10/2015

EPA 9045C (pH)

Analyte	EPA	L15L010-2		
	Method	15-232-12-9		
pH	9045C	6.85		

A & R Laboratories

Client: L & W Construction Services, Inc.
 Project: 15-232
 Project Site: 1244 2nd Ave., Oakland, CA
 Matrix: Water
 Batch No.: 1210-VOCW4

Lab Job No.: L15L010
 Date Sampled: 12/9/2015
 Date Received: 12/10/2015
 Date Analyzed: 12/10/2015
 Date Reported: 12/10/2015

EPA 8260B (VOCs & Oxy.) by GC/MS, Page 1 of 2

Reporting Unit: ug/L (PPB)

Date Analyzed	12/10/15				
Dilution Factor	100				
Lab Sample I.D.	L15L010-1				
Client Sample I.D.	15-232-GW-2				
Compound	RL				
Dichlorodifluoromethane	0.5	ND			
Chloromethane	0.5	ND			
Vinyl Chloride	0.5	ND			
Bromomethane	0.5	ND			
Chloroethane	0.5	ND			
Trichlorofluoromethane	0.5	ND			
1,1-Dichloroethene	0.5	ND			
Carbon disulfide	0.5	ND			
Methylene chloride	0.5	ND			
Trans-1,2-Dichloroethene	0.5	ND			
1,1-Dichloroethane	0.5	ND			
2,2-Dichloropropane	0.5	ND			
Cis-1,2-Dichloroethene	0.5	ND			
Bromochloromethane	0.5	ND			
Chloroform	0.5	ND			
1,1,1-Trichloroethane	0.5	ND			
Vinyl acetate	0.5	ND			
Carbontetrachloride	0.5	ND			
1,1-Dichloropropene	0.5	ND			
1,2-Dichloroethane	0.5	ND			
Benzene	0.5	ND			
Trichloroethene	0.5	ND			
1,2-Dichloropropane	0.5	ND			
Methyl methacrylate	1	ND			
Dibromomethane	0.5	ND			
Bromodichloromethane	0.5	ND			
2-Chloroethyl Vinyl Ether	0.5	ND			
Cis-1,3-Dichloropropene	0.5	ND			
Toluene	0.5	ND			
Trans-1,3-Dichloropropene	0.5	ND			
Ethylmethacrylate	0.5	ND			
1,1,2-Trichloroethane	0.5	ND			
Dibromochloromethane	0.5	ND			
1,2-Dibromoethane (EDB)	0.5	ND			
Tetrachloroethene	0.5	ND			
1,3-Dichloropropane	0.5	ND			
Chlorobenzene	0.5	ND			

RL=Reporting Limit; ND=Not Detected (Below Dilution Factor x RL).

A & R Laboratories

Client: L & W Construction Services, Inc.
 Project: 15-232
 Project Site: 1244 2nd Ave., Oakland, CA
 Matrix: Water
 Batch No.: 1210-VOCW4

Lab Job No.: L15L010
 Date Sampled: 12/9/2015
 Date Received: 12/10/2015
 Date Analyzed: 12/10/2015
 Date Reported: 12/10/2015

EPA 8260B (VOCs & Oxy.) by GC/MS, Page 2 of 2

Reporting Unit: ug/L (PPB)

Date Analyzed	12/10/15				
Dilution Factor	100				
Lab Sample I.D.	L15L010-1				
Client Sample I.D.	15-232-GW-2				
Compound	RL				
1,1,1,2-Tetrachloroethane	0.5	ND			
Ethylbenzene	0.5	ND			
Total Xylene	0.5	ND			
Styrene	0.5	ND			
Bromoform	0.5	ND			
Isopropyl benzene	0.5	ND			
Bromobenzene	0.5	ND			
1,2,3-Trichloropropane	0.5	ND			
1,1,2,2-Tetrachloroethane	0.5	ND			
Trans-1,4-dichloro-2-butene	0.5	ND			
2-Chlorotoluene	0.5	ND			
n-Propyl benzene	0.5	ND			
4-Chlorotoluene	0.5	ND			
1,3,5-Trimethyl benzene	0.5	ND			
tert-Butylbenzene	0.5	ND			
p-Isopropyl toluene	0.5	ND			
1,2,4-Trimethyl benzene	0.5	ND			
sec-Butylbenzene	0.5	ND			
1,3-Dichlorobenzene	0.5	ND			
1,4-Dichlorobenzene	0.5	ND			
1,2-Dichlorobenzene	0.5	ND			
n-Butylbenzene	0.5	ND			
1,2-Dibromo-3-chloropropan	0.5	ND			
1,2,4-Trichlorobenzene	0.5	ND			
Hexachlorobutadiene	1	ND			
Naphthalene	0.5	300			
1,2,3-Trichlorobenzene	0.5	ND			
Acetone	5	ND			
2-Butanone(MEK)	5	ND			
MTBE	0.5	ND			
4-Methyl-2-Pentanone (MIBK)	5	ND			
Ethyl-t-butyl Ether(ETBE)	1	ND			
Diisopropyl ether (DIPE)	1	ND			
TAME	1	ND			
t-Butanol	10	ND			
Ethanol	250	ND			

RL=Reporting Limit; ND=Not Detected (Below Dilution Factor x RL).

A & R Laboratories

Client:	L & W Construction Services, Inc.	Lab Job No.:	L15L010
Project:	15-232	Date Sampled:	12/9/2015
Project Site:	1244 2nd Ave., Oakland, CA	Date Received:	12/10/2015
Matrix:	Water	Date Analyzed:	12/10/2015
Batch No.:	BL10-DW	Date Reported:	12/10/2015

EPA 8015M (TPH-Diesel)

Reporting Unit: mg/L (PPM)

Client Sample ID	Lab ID	Dilution Factor	Diesel		
			C12-C28		
	RL		0.1		
15-232-GW-2	L15L010-1	1	20		

RL=Reporting Limit; ND=Not Detected (Below RL).

A & R Laboratories

EPA 8260B (VOCs) Batch QA/QC Report

Client: L & W Construction Services, Inc.
Project: 15-232
Matrix: Soil
Batch No.: 1210-VOCS4

Lab Job No.: L15L010
Lab Sample ID: LCS
Date Analyzed: 12/10/2015
Date Reported: 12/10/2015

MB/LCS/LCSD Report

Unit: mg/kg(PPM)

Compound	Method Blank	Spike Conc.	LCS	LCSD	LCS %Rec.	LCSD %Rec.	%RPD	%RPD Accept Limit	%Rec. Accept Limit
1,1-Dichloroethene	ND	0.020	0.018	0.020	90	100	11	≤20	80-120
Benzene	ND	0.020	0.019	0.018	95	90	5	≤20	80-120
Trichloroethene	ND	0.020	0.020	0.020	100	100	0	≤20	80-120
Toluene	ND	0.020	0.019	0.020	95	100	5	≤20	80-120
Chlorobenzene	ND	0.020	0.021	0.019	105	95	10	≤20	80-120

MB: Method Blank.

ND: Not Detected (Below MDL).

A & R Laboratories

EPA 8015B (TPH-Diesel) Batch QA/QC Report

Client: L & W Construction Services, Inc.
Project: 15-232
Matrix: Soil
Batch No.: BL10-DS

Lab Job No.: L15L010
Lab Sample ID: LCS
Date Analyzed: 12/10/2015
Date Reported: 12/10/2015

MB/LCS/LCSD Report

Unit:mg/kg (PPM)

Analyte	Method	Spike	LCS	LCSD	LCS	LCSD	%RPD	%RPD	%Rec
	Blank	Conc.			%Rec.	%rec.		Accept	Accept
								Limit	Limit
TPH-D	ND	500	415	436	83	87	5	≤20	80-120

ND: Not Detected (at the specified limit).

MB: Method Blank.

LCS: Lab Control Sample.

LCSD: Lab Control Sample Duplicate.

A & R Laboratories

EPA 6010B (LUFT 5 Metals) Batch QA/QC Report

Client: L & W Construction Services, Inc.
Project: 15-232
Matrix: Soil
Batch No.: 1210-MTS

Lab Job No.: L15L010
Lab Sample ID: LCS
Date Analyzed: 12/10/2015
Date Reported: 12/10/2015

MB/LCS/LCSD Report

Unit: mg/kg (PPM)

Element	EPA Method	Method Blank	Spike Conc.	LCS	LCSD	LCS %Rec.	LCSD %Rec.	%RPD	%RPD Accept Limit	%Rec. Accept Limit
Cadmium (Cd)	6010B	ND	50	55	49	110	98	12	≤20	80-120
Chromium (Cr)	6010B	ND	50	49	50	98	100	2	≤20	80-120
Lead (Pb)	6010B	ND	50	48	52	96	104	8	≤20	80-120
Nickel (Ni)	6010B	ND	50	50	50	100	100	0	≤20	80-120
Zinc (Zn)	6010B	ND	50	52	49	104	98	6	≤20	80-120

ND: Not Detected (Below Reporting Limit).

A & R Laboratories

Ms. Jean Lindsay
L & W Construction Services, Inc.
5200 Redwood Hwy S.
Petaluma, CA 94952

12/30/2015

Project: 15-232
Project Site: 1244 2nd Ave., Oakland, CA
Sample Date: 12/8/2015
Lab Job No.: L15L008A

Dear Ms. Jean Lindsay:

Enclosed please find the analytical report for the samples received by A & R Laboratories on 12/10/2015 and analyzed by the following EPA methods:

EPA 8260B (VOCs & Oxy.)
EPA 8015M (TPH-Diesel)
EPA 6010B (LUFT 5 Metals)
EPA 8015M (TPH-Gasoline)
EPA 8015M (TPH-Motor Oil)
EPA 8082 (PCBs)
EPA 8270C (Semi-VOCs)

All analyses have met the QA/QC criteria of this laboratory.

The sample(s) arrived in good conditions (i.e., chilled, intact) and with a chain of custody record attached.

A & R Laboratories is certified by the CA DHS (Certificate No.2789). Thank you for giving us the opportunity to serve you.

Please feel free to call me at (951)779-0310 if our laboratory can be of further service to you.

Respectfully,

A & R Laboratories

Ken Zheng, M.S.
Laboratory Director

Enclosures

This cover letter is an integral part of this analytical report.

1650 S. Grove Ave., Suite C
Ontario, CA 91761

Tel: (951)779-0310
Fax: (951)779-0344

A & R Laboratories

Client:	L & W Construction Services, Inc.	Lab Job No.:	L15L008A
Project:	15-232	Date Sampled:	12/8/2015
Project Site:	1244 2nd Ave., Oakland, CA	Date Received:	12/10/2015
Matrix:	Water	Date Analyzed:	12/10/2015
Batch No.:	1210-VOCW4	Date Reported:	12/30/2015

EPA 8260B (BTEX, Oxy. & Naphthalene)

Reporting Unit: ug/L (PPB)

Date Analyzed		12/10/15			
Dilution Factor		100			
Lab Sample I.D.		L15L008-1			
Client Sample I.D.		15-232-GW			
Compound	RL				
Benzene	0.5	ND			
Toluene	0.5	ND			
Ethylbenzene	0.5	ND			
Total Xylene	1	ND			
MTBE	0.5	ND			
Ethyl-t-butyl Ether (ETBE)	1	ND			
Diisopropyl ether (DIPE)	1	ND			
TAME	1	ND			
t-Butanol	10	ND			
Naphthalene	1	500			

RL: Reporting Limit.

ND: Not Detected (Below Reporting Limit X Dilution Factor).

A & R Laboratories

Client:	L & W Construction Services, Inc.	Lab Job No.:	L15L008A
Project:	15-232	Date Sampled:	12/8/2015
Project Site:	1244 2nd Ave., Oakland, CA	Date Received:	12/10/2015
Matrix:	Water	Date Analyzed:	12/10/2015
Batch No.:	AL10-DW	Date Reported:	12/30/2015

EPA 8260B (TPH-Gasoline)

Reporting Unit: ug/L (PPB)

Client Sample ID	Lab ID	Dilution Factor	Gasoline		
			C6-C12		
	RL		100		
15-232-GW	L15L008-1	1	280		

RL=Reporting Limit; ND=Not Detected (Below RL).

A & R Laboratories

Client:	L & W Construction Services, Inc.	Lab Job No.:	L15L008A
Project:	15-232	Date Sampled:	12/8/2015
Project Site:	1244 2nd Ave., Oakland, CA	Date Received:	12/10/2015
Matrix:	Water	Date Analyzed:	12/10/2015
Batch No.:	BL10-DW	Date Reported:	12/30/2015

EPA 8015M (TPH-Diesel)

Reporting Unit: mg/L (PPM)

Client Sample ID	Lab ID	Dilution Factor	Diesel		
			C12-C28		
	RL		0.1		
15-232-GW	L15L008-1	1	50		

RL=Reporting Limit; ND=Not Detected (Below RL).

A & R Laboratories

Client:	L & W Construction Services, Inc.	Lab Job No.:	L15L008A
Project:	15-232	Date Sampled:	12/8/2015
Project Site:	1244 2nd Ave., Oakland, CA	Date Received:	12/10/2015
Matrix:	Water	Date Analyzed:	12/30/2015
Batch No.:	BL10-DW	Date Reported:	12/30/2015

EPA 8015M (TPH-Motor Oil)

Reporting Unit: mg/L (PPM)

Client Sample ID	Lab ID	Dilution Factor	Motor Oil		
			C23-C36		
	RL		2.5		
15-232-GW	L15L008-1	1	ND		

RL=Reporting Limit; ND=Not Detected (Below RL).

A & R Laboratories

Client: L & W Construction Services, Inc. Lab Job No.: L15L008A
Project: 15-232 Date Sampled: 12/8/2015
Project Site: 1244 2nd Ave., Oakland, CA Date Received: 12/10/2015
Matrix: Water Date Analyzed: 12/30/2015
Batch No.: CL30-PCBW Date Reported: 12/30/2015

EPA 8082 (PCBs)

Reporting Unit: ug/L (PPB)

LAB SAMPLE I.D.		L15L008-1			
CLIENT SAMPLE I.D.		15-232-GW			
COMPOUND	RL				
Aroclor-1016	0.25	ND			
Aroclor-1221	0.25	ND			
Aroclor-1232	0.25	ND			
Aroclor-1242	0.25	ND			
Aroclor-1248	0.25	ND			
Aroclor-1254	0.25	ND			
Aroclor-1260	0.25	ND			

RL=Reporting Limit; ND=Not Detected (Below RL).

A & R Laboratories

Client:	L & W Construction Services, Inc.	Lab Job No.:	L15L008A
Project:	15-232	Date Sampled:	12/8/2015
Project Site:	1244 2nd Ave., Oakland, CA	Date Received:	12/10/2015
Matrix:	Water	Date Analyzed:	12/30/2015
Batch No.:	1230-SVOCW	Date Reported:	12/30/2015

EPA 8270C (Semi-VOCs by GC/MS, Page 1 of 2)

Reporting Unit: ug/L (PPB)

Date Analyzed	12/30/15		
Date Extracted	12/10/15		
Dilution Factor	1		
Lab Sample I.D.	L15L008-1		
Client Sample I.D.	15-232-GW		
Compound	MDL	RL	
N-Nitrosodimethylamine	10.000	20.0	ND
Pyridine	10.000	20.0	ND
Aniline	10.000	20.0	ND
Bis(2-chloroethyl) ether	10.000	20.0	ND
Phenol	10.000	20.0	ND
2-Chlorophenol	10.000	20.0	ND
1,3-Dichlorobenzene	10.000	20.0	ND
1,4-Dichlorobenzene	10.000	20.0	ND
Benzyl alcohol	10.000	20.0	ND
1,2-Dichlorobenzene	10.000	20.0	ND
2-Methylphenol	10.000	20.0	ND
Bis(2-chloroisopropyl) ether	10.000	20.0	ND
4-Methylphenol	10.000	20.0	ND
N-Nitroso-di-n-propyl	10.000	20.0	ND
Hexachloroethane	10.000	20.0	ND
Nitrobenzene	10.000	20.0	ND
Isophorone	10.000	20.0	ND
2-Nitrophenol	10.000	20.0	ND
2,4-Dimethylphenol	10.000	20.0	ND
Bis(2-Chloroethoxy) methane	10.000	20.0	ND
Benzoic Acid	10.000	20.0	ND
2,4-Dichlorophenol	10.000	20.0	ND
1,2,4-Trichlorobenzene	10.000	20.0	ND
Naphthalene	10.000	20.0	380
4-Chloroaniline	10.000	20.0	ND
Hexachlorobutadiene	10.000	20.0	ND
4-Chloro-3-methylphenol	10.000	20.0	ND
2-Methylnaphthalene	10.000	20.0	ND
Hexachlorocyclopentadiene	10.000	20.0	ND
2,4,6-Trichlorophenol	10.000	20.0	ND
2,4,5-Trichlorophenol	10.000	20.0	ND
2-Chloronaphthalene	10.000	20.0	ND
2-Nitroaniline	10.000	20.0	ND
Dimethylphthalate	10.000	20.0	ND
Acenaphthylene	10.000	20.0	ND
2,6-Dinitrotoluene	10.000	20.0	ND

RL=Reporting Limit; ND=Not Detected (Below MDL x Dilution Factor); MDL=Method Detection Limit.
J=Trace Value Detected Between RL and MDL.

1650 S. Grove Ave., Suite C
Ontario, CA 91761

Tel: (951)779-0310
Fax: (951)779-0344

A & R Laboratories

Client:	L & W Construction Services, Inc.	Lab Job No.:	L15L008A
Project:	15-232	Date Sampled:	12/8/2015
Project Site:	1244 2nd Ave., Oakland, CA	Date Received:	12/10/2015
Matrix:	Water	Date Analyzed:	12/30/2015
Batch No.:	1230-SVOCW	Date Reported:	12/30/2015

EPA 8270C (Semi-VOCs by GC/MS, Page 2 of 2)

Reporting Unit: ug/L (PPB)

Date Analyzed			12/30/15		
Date Extracted			12/10/15		
Dilution Factor			1		
Lab Sample I.D.			L15L008-1		
Client Sample I.D.			15-232-GW		
Compound	MDL	RL			
3-Nitroaniline	10.000	20.0	ND		
Acenaphthene	10.000	20.0	ND		
2,4-Dinitrophenol	10.000	20.0	ND		
4-Nitrophenol	10.000	20.0	ND		
Dibenzofuran	10.000	20.0	ND		
2,4-Dinitrotoluene	10.000	20.0	ND		
Diethylphthalate	10.000	20.0	ND		
Fluorene	10.000	20.0	ND		
4-Chlorophenyl-phenylether	10.000	20.0	ND		
4-Nitroaniline	10.000	20.0	ND		
1,2-Diphenylhydrazine	10.000	20.0	ND		
4,6-Dinitro-2-methylphenol	10.000	20.0	ND		
N-Nitrosodiphenylamine	10.000	20.0	ND		
4-Bromophenyl-phenylether	10.000	20.0	ND		
Hexachlorobenzene	10.000	20.0	ND		
Pentachlorophenol	10.000	20.0	ND		
Benzidine	10.000	20.0	ND		
Phenanthrene	10.000	20.0	ND		
Anthracene	10.000	20.0	ND		
Carbazole	10.000	20.0	ND		
Di-n-butylphthalate	10.000	20.0	ND		
Fluoranthene	10.000	20.0	ND		
Pyrene	10.000	20.0	ND		
Butylbenzylphthalate	10.000	20.0	ND		
Benzo(a)anthracene	10.000	20.0	ND		
3,3'-Dichlorobenzidine	10.000	20.0	ND		
Chrysene	10.000	20.0	ND		
Bis(2-Ethylhexyl) phthalate	10.000	20.0	ND		
Di-n-octylphthalate	10.000	20.0	ND		
Benzo(b)fluoranthene	10.000	20.0	ND		
Benzo(k)fluoranthene	10.000	20.0	ND		
Benzo(a)pyrene	10.000	20.0	ND		
Indeno(1,2,3-cd)pyrene	10.000	20.0	ND		
Dibenzo(a,h)anthracene	10.000	20.0	ND		
Benzo(g,h,i)perylene	10.000	20.0	ND		
Creosote	50.000	100.0	ND		

RL=Reporting Limit; ND=Not Detected (Below MDL x Dilution Factor); MDL=Method Detection Limit.
 J=Trace Value Detected Between RL and MDL.

1650 S. Grove Ave., Suite C
 Ontario, CA 91761

Tel: (951)779-0310
 Fax: (951)779-0344

A & R Laboratories

Client:	L & W Construction Services, Inc.	Lab Job No.:	L15L008A
Project:	15-232	Date Sampled:	12/8/2015
Project Site:	1244 2nd Ave., Oakland, CA	Date Received:	12/10/2015
Matrix:	Water	Date Digested:	12/30/2015
Extraction Method:	EPA 3010	Date Analyzed:	12/30/2015
Batch No.:	1230-MTW	Date Reported:	12/30/2015

EPA 6010B (LUFT 5 Metals)

Report Units: mg/L (PPM)

Element	EPA Method	L15L008-1			RL
		15-232-GW			
Cadmium (Cd)	6010B	ND			0.02
Chromium (Cr)	6010B	0.19			0.02
Lead (Pb)	6010B	ND			0.02
Nickel (Ni)	6010B	0.38			0.02
Zinc (Zn)	6010B	1.8			0.02

RL=Reporting Limit; ND=Not Detected (Below RL).

1650 S. Grove Ave., Suite C
Ontario, CA 91761

Tel: (951)779-0310
Fax: (951)779-0344

A & R Laboratories

EPA 8260B (VOCs) Batch QA/QC Report

Client: L & W Construction Services, Inc.
Project: 15-232
Matrix: Water
Batch No.: 1210-VOCW4

Lab Job No.: L15L008A
Lab Sample ID: LCS
Date Analyzed: 12/10/2015
Date Reported: 12/30/2015

MB/LCS/LCSD Report

Unit: ug/L(PPB)

Compound	Method Blank	Spike Conc.	LCS	LCSD	LCS %Rec.	LCSD %Rec.	%RPD	%RPD Accept Limit	%Rec. Accept Limit
1,1-Dichloroethene	ND	20	19.5	20.5	97.5	103	5	≤20	80-120
Benzene	ND	20	20.2	19.5	101	98	4	≤20	80-120
Trichloroethene	ND	20	18.0	19.8	90	99	10	≤20	80-120
Toluene	ND	20	19.5	20.9	98	105	7	≤20	80-120
Chlorobenzene	ND	20	20.3	19.5	102	98	4	≤20	80-120

MB: Method Blank.

ND: Not Detected (Below MDL).

A & R Laboratories

EPA 8015B (TPH-Diesel) Batch QA/QC Report

Client: L & W Construction Services, Inc.
Project: 15-232
Matrix: Soil
Batch No.: BL10-DS

Lab Job No.: L15L008A
Lab Sample ID: LCS
Date Analyzed: 12/10/2015
Date Reported: 12/30/2015

MB/LCS/LCSD Report

Unit:mg/kg (PPM)

Analyte	Method	Spike	LCS	LCSD	LCS	LCSD	%RPD	%RPD	%Rec
	Blank	Conc.			%Rec.	%rec.		Accept	Accept
								Limit	Limit
TPH-D	ND	500	415	436	83	87	5	≤20	80-120

ND: Not Detected (at the specified limit).

MB: Method Blank.

LCS: Lab Control Sample.

LCSD: Lab Control Sample Duplicate.

A & R Laboratories

EPA 6010B (LUFT 5 Metals) Batch QA/QC Report

Client: L & W Construction Services, Inc.
Project: 15-232
Matrix: Water
Batch No.: 1230-MTW

Lab Job No.: L15L008A
Lab Sample ID: LCS
Date Analyzed: 12/30/2015
Date Reported: 12/30/2015

MB/LCS/LCSD Report

Unit: mg/kg (PPM)

Element	EPA Method	Method Blank	Spike Conc.	LCS	LCSD	LCS %Rec.	LCSD %Rec.	%RPD	%RPD Accept Limit	%Rec. Accept Limit
Cadmium (Cd)	6010B	ND	1.00	0.95	0.99	95	99	4	≤20	80-120
Chromium (Cr)	6010B	ND	1.00	1.00	1.03	100	103	3	≤20	80-120
Lead (Pb)	6010B	ND	1.00	0.95	0.92	95	92	3	≤20	80-120
Nickel (Ni)	6010B	ND	1.00	1.02	1.02	102	102	0	≤20	80-120
Zinc (Zn)	6010B	ND	1.00	1.05	0.95	105	95	10	≤20	80-120

ND: Not Detected (Below Reporting Limit).

A & R Laboratories

Ms. Jean Lindsay
L & W Construction Services, Inc.
5200 Redwood Hwy S.
Petaluma, CA 94952

12/28/2015

Project: 15-232
Project Site: 1244 2nd Ave., Oakland, CA
Sample Date: 12/9/2015
Lab Job No.: L15L010A

Dear Ms. Jean Lindsay:

Enclosed please find the analytical report for the samples received by A & R Laboratories on 12/10/2015 and analyzed by the following EPA methods:

EPA 8260B (VOCs & Oxy.)
EPA 9045C (pH)
EPA 8015M (TPH-Diesel)
EPA 1030 (Flammability)
EPA 6010B (LUFT 5 Metals)
EPA 8015M (TPH-Gasoline)
EPA 8015M (TPH-Motor Oil)
EPA 8082 (PCBs)
EPA 8270C (Semi-VOCs)

All analyses have met the QA/QC criteria of this laboratory.

The sample(s) arrived in good conditions (i.e., chilled, intact) and with a chain of custody record attached.

A & R Laboratories is certified by the CA DHS (Certificate No.2789). Thank you for giving us the opportunity to serve you.

Please feel free to call me at (951)779-0310 if our laboratory can be of further service to you.

Respectfully,

A & R Laboratories

Ken Zheng, M.S.
Laboratory Director

Enclosures

This cover letter is an integral part of this analytical report.

1650 S. Grove Ave., Suite C
Ontario, CA 91761

Tel: (951)779-0310
Fax: (951)779-0344

A & R Laboratories

Client:	L & W Construction Services, Inc.	Lab Job No.:	L15L010A
Project:	15-232	Date Sampled:	12/9/2015
Project Site:	1244 2nd Ave., Oakland, CA	Date Received:	12/10/2015
Matrix:	Soil	Date Analyzed:	12/10/2015
Batch No.:	1210-VOCS4	Date Reported:	12/28/2015

EPA 8260B (VOCs & Oxy.) by GC/MS, Page 1 of 2
Reporting Unit: mg/kg (PPM)

Date Analyzed		12/10/15			
Dilution Factor		1			
Lab Sample I.D.		L15L010-2			
Client Sample I.D.		15-232-12-9			
Compound	RL				
Dichlorodifluoromethane	0.005	ND			
Chloromethane	0.005	ND			
Vinyl Chloride	0.005	ND			
Bromomethane	0.005	ND			
Chloroethane	0.005	ND			
Trichlorofluoromethane	0.005	ND			
1,1-Dichloroethene	0.005	ND			
Carbon disulfide	0.005	ND			
Methylene chloride	0.005	ND			
Trans-1,2-Dichloroethene	0.005	ND			
1,1-Dichloroethane	0.005	ND			
2,2-Dichloropropane	0.005	ND			
Cis-1,2-Dichloroethene	0.002	ND			
Bromochloromethane	0.005	ND			
Chloroform	0.005	ND			
1,1,1-Trichloroethane	0.005	ND			
Vinyl acetate	0.005	ND			
Carbontetrachloride	0.005	ND			
1,1-Dichloropropene	0.005	ND			
1,2-Dichloroethane	0.005	ND			
Benzene	0.001	ND			
Trichloroethene	0.002	ND			
1,2-Dichloropropane	0.005	ND			
Methyl methacrylate	0.005	ND			
Dibromomethane	0.005	ND			
Bromodichloromethane	0.005	ND			
2-Chloroethyl Vinyl Ether	0.005	ND			
Cis-1,3-Dichloropropene	0.005	ND			
Toluene	0.001	ND			
Trans-1,3-Dichloropropene	0.005	ND			
Ethylmethacrylate	0.005	ND			
1,1,2-Trichloroethane	0.005	ND			
Dibromochloromethane	0.005	ND			
1,2-Dibromoethane (EDB)	0.005	ND			
Tetrachloroethene	0.002	ND			
1,3-Dichloropropane	0.005	ND			
Chlorobenzene	0.005	ND			

RL=Reporting Limit; ND=Not Detected (Below Dilution Factor x RL).

A & R Laboratories

Client:	L & W Construction Services, Inc.	Lab Job No.:	L15L010A
Project:	15-232	Date Sampled:	12/9/2015
Project Site:	1244 2nd Ave., Oakland, CA	Date Received:	12/10/2015
Matrix:	Soil	Date Analyzed:	12/10/2015
Batch No.:	1210-VOCS4	Date Reported:	12/28/2015

EPA 8260B (VOCs & Oxy.) by GC/MS, Page 2 of 2

Reporting Unit: mg/kg (PPM)

Date Analyzed		12/10/15			
Dilution Factor		1			
Lab Sample I.D.		L15L010-2			
Client Sample I.D.		15-232-12-9			
Compound	RL				
1,1,1,2-Tetrachloroethane	0.005	ND			
Ethylbenzene	0.001	ND			
Total Xylene	0.002	ND			
Styrene	0.005	ND			
Bromoform	0.005	ND			
Isopropyl benzene	0.005	ND			
Bromobenzene	0.005	ND			
1,2,3-Trichloropropane	0.005	ND			
1,1,2,2,-Tetrachloroethane	0.005	ND			
Trans-1,4-dichloro-2-butene	0.005	ND			
2-Chlorotoluene	0.005	ND			
n-Propyl benzene	0.005	ND			
4-Chlorotoluene	0.005	ND			
1,3,5-Trimethyl benzene	0.005	ND			
tert-Butylbenzene	0.005	ND			
p-Isopropyl toluene	0.005	ND			
1,2,4-Trimethyl benzene	0.005	ND			
sec-Butylbenzene	0.005	ND			
1,3-Dichlorobenzene	0.005	ND			
1,4-Dichlorobenzene	0.005	ND			
1,2-Dichlorobenzene	0.005	ND			
n-Butylbenzene	0.005	ND			
1,2-Dibromo-3-chloropropa	0.005	ND			
1,2,4-Trichlorobenzene	0.005	ND			
Hexachlorobutadiene	0.005	ND			
Naphthalene	0.005	ND			
1,2,3-Trichlorobenzene	0.005	ND			
Aceton	0.950	ND			
2-Butanone(MEK)	0.300	ND			
MTBE	0.001	ND			
4-Methyl-2-Pentanone (MIB)	0.050	ND			
Ethyl-t-butyl Ether(ETBE)	0.002	ND			
Diisopropyl ether (DIPE)	0.002	ND			
TAME	0.002	ND			
t-Butanol	0.020	ND			

RL=Reporting Limit; ND=Not Detected (Below Dilution Factor x RL).

A & R Laboratories

Client: L & W Construction Services, Inc. Lab Job No.: L15L010A
Project: 15-232 Date Sampled: 12/9/2015
Project Site: 1244 2nd Ave., Oakland, CA Date Received: 12/10/2015
Matrix: Soil Date Analyzed: 12/10/2015
Batch No.: AL10-GS Date Reported: 12/28/2015

EPA 8260B (TPH-Gasoline)

Reporting Unit: mg/kg (PPM)

Client Sample ID	Lab ID	Dilution Factor	Gasoline		
			C6-C12		
	RL		1		
15-232-12-9	L15L010-2	1	ND		

RL=Reporting Limit; ND=Not Detected (Below RL).

A & R Laboratories

Client:	L & W Construction Services, Inc.	Lab Job No.:	L15L010A
Project:	15-232	Date Sampled:	12/9/2015
Project Site:	1244 2nd Ave., Oakland, CA	Date Received:	12/10/2015
Matrix:	Soil	Date Analyzed:	12/10/2015
Batch No.:	BL10-DS	Date Reported:	12/28/2015

EPA 8015M (TPH-Diesel)

Reporting Unit: mg/kg (PPM)

Client Sample ID	Lab ID	Dilution Factor	Diesel		
			C12-C28		
	RL		10		
15-232-12-9	L15L010A-2	1	ND		

RL=Reporting Limit; ND=Not Detected (Below RL).

A & R Laboratories

Client:	L & W Construction Services, Inc.	Lab Job No.:	L15L010A
Project:	15-232	Date Sampled:	12/9/2015
Project Site:	1244 2nd Ave., Oakland, CA	Date Received:	12/10/2015
Matrix:	Soil	Date Analyzed:	12/28/2015
Batch No.:	BL28-DS	Date Reported:	12/28/2015

EPA 8015M (TPH-Motor Oil)

Reporting Unit: mg/kg (PPM)

Client Sample ID	Lab ID	Dilution Factor	Motor Oil		
			C23-C36		
	RL		50		
15-232-12-9	L15L010-2	1	ND		

RL=Reporting Limit; ND=Not Detected (Below RL).

A & R Laboratories

Client: L & W Construction Services, Inc. Lab Job No.: L15L010A
Project: 15-232 Date Sampled: 12/9/2015
Project Site: 1244 2nd Ave., Oakland, CA Date Received: 12/10/2015
Matrix: Soil Date Digested: 12/10/2015
Extraction Method: EPA 3050 Date Analyzed: 12/10/2015
Batch No.: 1210-MTS Date Reported: 12/28/2015

EPA 6010B (LUFT 5 Metals)

Report Units: mg/kg (PPM)

Element	EPA Method	L15L010-2			RL
		15-232-12-9			
Cadmium (Cd)	6010B	ND			2
Chromium (Cr)	6010B	8.9			2
Lead (Pb)	6010B	ND			2
Nickel (Ni)	6010B	5.7			2
Zinc (Zn)	6010B	5.3			2

RL=Reporting Limit; ND=Not Detected (Below RL).

A & R Laboratories

Client: L & W Construction Services, Inc.
Project: 15-232
Project Site: 1244 2nd Ave., Oakland, CA
Matrix: Soil
Batch No.: 1210-FLAS

Lab Job No.: L15L010A
Date Sampled: 12/9/2015
Date Received: 12/10/2015
Date Analyzed: 12/10/2015
Date Reported: 12/28/2015

EPA 1030 (Flash Point)

Unit: °F

Analyte	EPA	L15L010A-2		
	Method	15-232-12-9		
Flash Point	1030	>200		

A & R Laboratories

Client: L & W Construction Services, Inc.
Project: 15-232
Project Site: 1244 2nd Ave., Oakland, CA
Matrix: Soil
Batch No.: 1210-pH

Lab Job No.: L15L010A
Date Sampled: 12/9/2015
Date Received: 12/10/2015
Date Analyzed: 12/10/2015
Date Reported: 12/28/2015

EPA 9045C (pH)

Analyte	EPA Method	L15L010A-2		
		15-232-12-9		
pH	9045C	6.85		

A & R Laboratories

Client:	L & W Construction Services, Inc.	Lab Job No.:	L15L010A
Project:	15-232	Date Sampled:	12/9/2015
Project Site:	1244 2nd Ave., Oakland, CA	Date Received:	12/10/2015
Matrix:	Soil	Date Analyzed:	12/28/2015
Batch No.:	1228-SVOCS	Date Reported:	12/28/2015

EPA 8270C (Semi-VOCs by GC/MS, Page 1 of 2)

Reporting Unit: mg/kg (PPM)

Date Analyzed	12/28/15		
Date Extracted	12/10/15		
Dilution Factor	1		
Lab Sample I.D.	L15L010-2		
Client Sample I.D.	15-232-12-9		
Compound	MDL	RL	
N-Nitrosodimethylamine	0.025	0.3	ND
Pyridine	0.025	0.3	ND
Aniline	0.025	0.3	ND
Bis(2-chloroethyl) ether	0.025	0.3	ND
Phenol	0.025	0.3	ND
2-Chlorophenol	0.025	0.3	ND
1,3-Dichlorobenzene	0.025	0.3	ND
1,4-Dichlorobenzene	0.025	0.3	ND
Benzyl alcohol	0.025	0.3	ND
1,2-Dichlorobenzene	0.025	0.3	ND
2-Methylphenol	0.025	0.3	ND
Bis(2-chloroisopropyl) ether	0.025	0.3	ND
4-Methylphenol	0.025	0.3	ND
N-Nitroso-di-n-propyl	0.025	0.3	ND
Hexachloroethane	0.025	0.3	ND
Nitrobenzene	0.025	0.3	ND
Isophorone	0.025	0.3	ND
2-Nitrophenol	0.025	0.3	ND
2,4-Dimethylphenol	0.025	0.3	ND
Bis(2-Chloroethoxy) methane	0.025	0.3	ND
Benzoic Acid	0.025	0.3	ND
2,4-Dichlorophenol	0.025	0.3	ND
1,2,4-Trichlorobenzene	0.025	0.3	ND
Naphthalene	0.025	0.3	ND
4-Chloroaniline	0.025	0.3	ND
Hexachlorobutadiene	0.025	0.3	ND
4-Chloro-3-methylphenol	0.025	0.3	ND
2-Methylnaphthalene	0.025	0.3	ND
Hexachlorocyclopentadiene	0.025	0.3	ND
2,4,6-Trichlorophenol	0.025	0.3	ND
2,4,5-Trichlorophenol	0.025	0.3	ND
2-Chloronaphthalene	0.025	0.3	ND
2-Nitroaniline	0.025	0.3	ND
Dimethylphthalate	0.025	0.3	ND
Acenaphthylene	0.025	0.3	ND
2,6-Dinitrotoluene	0.025	0.3	ND

RL=Reporting Limit; ND=Not Detected (Below MDL x Dilution Factor); MDL=Method Detection Limit.
 J=Trace Value Detected Between RL and MDL.

1650 S. Grove Ave., Suite C
 Ontario, CA 91761

Tel: (951)779-0310
 Fax: (951)779-0344

A & R Laboratories

Client:	L & W Construction Services, Inc.	Lab Job No.:	L15L010A
Project:	15-232	Date Sampled:	12/9/2015
Project Site:	1244 2nd Ave., Oakland, CA	Date Received:	12/10/2015
Matrix:	Soil	Date Analyzed:	12/28/2015
Batch No.:	1228-SVOCS	Date Reported:	12/28/2015

EPA 8270C (Semi-VOCs by GC/MS, Page 2 of 2)

Reporting Unit: mg/kg (PPM)

Date Analyzed		12/28/15			
Date Extracted		12/10/15			
Dilution Factor		1			
Lab Sample I.D.		L15L010-2			
Client Sample I.D.		15-232-12-9			
Compound	MDL	RL			
3-Nitroaniline	0.025	0.3	ND		
Acenaphthene	0.025	0.3	ND		
2,4-Dinitrophenol	0.025	0.3	ND		
4-Nitrophenol	0.025	0.3	ND		
Dibenzofuran	0.025	0.3	ND		
2,4-Dinitrotoluene	0.025	0.3	ND		
Diethylphthalate	0.025	0.3	ND		
Fluorene	0.025	0.3	ND		
4-Chlorophenyl-phenylether	0.025	0.3	ND		
4-Nitroaniline	0.025	0.3	ND		
1,2-Diphenylhydrazine	0.025	0.3	ND		
4,6-Dinitro-2-methylphenol	0.025	0.3	ND		
N-Nitrosodiphenylamine	0.025	0.3	ND		
4-Bromophenyl-phenylether	0.025	0.3	ND		
Hexachlorobenzene	0.025	0.3	ND		
Pentachlorophenol	0.025	0.3	ND		
Benzidine	0.025	0.3	ND		
Phenanthrene	0.025	0.3	ND		
Anthracene	0.025	0.3	ND		
Carbazole	0.025	0.3	ND		
Di-n-butylphthalate	0.025	0.3	ND		
Fluoranthene	0.025	0.3	ND		
Pyrene	0.025	0.3	ND		
Butylbenzylphthalate	0.025	0.3	ND		
Benzo(a)anthracene	0.025	0.3	ND		
3,3'-Dichlorobenzidine	0.025	0.3	ND		
Chrysene	0.025	0.3	ND		
Bis(2-Ethylhexyl) phthalate	0.025	0.3	ND		
Di-n-octylphthalate	0.025	0.3	ND		
Benzo(b)fluoranthene	0.025	0.3	ND		
Benzo(k)fluoranthene	0.025	0.3	ND		
Benzo(a)pyrene	0.025	0.3	ND		
Indeno(1,2,3-cd)pyrene	0.025	0.3	ND		
Dibenzo(a,h)anthracene	0.025	0.3	ND		
Benzo(g,h,i)perylene	0.025	0.3	ND		
Creosote	0.500	1.0	ND		

RL=Reporting Limit; ND=Not Detected (Below MDL x Dilution Factor); MDL=Method Detection Limit.
 J=Trace Value Detected Between RL and MDL.

1650 S. Grove Ave., Suite C
 Ontario, CA 91761

Tel: (951)779-0310
 Fax: (951)779-0344

A & R Laboratories

Client: L & W Construction Services, Inc. Lab Job No.: L15L010A
Project: 15-232 Date Sampled: 12/9/2015
Project Site: 1244 2nd Ave., Oakland, CA Date Received: 12/10/2015
Matrix: Soil Date Analyzed: 12/28/2015
Batch No.: CL28-PCBS- Date Reported: 12/28/2015

EPA 8082 (PCBs)

Reporting Unit: mg/kg (PPM)

LAB SAMPLE I.D.		L15L010-2			
CLIENT SAMPLE I.D.		15-232-12-9			
COMPOUND	RL				
Aroclor-1016	0.05	ND			
Aroclor-1221	0.05	ND			
Aroclor-1232	0.05	ND			
Aroclor-1242	0.05	ND			
Aroclor-1248	0.05	ND			
Aroclor-1254	0.05	ND			
Aroclor-1260	0.05	ND			

RL=Reporting Limit; ND=Not Detected (Below RL).

1650 S. Grove Ave., Suite C
Ontario, CA 91761

Tel: (951)779-0310
Fax: (951)779-0344

A & R Laboratories

Client: L & W Construction Services, Inc.
 Project: 15-232
 Project Site: 1244 2nd Ave., Oakland, CA
 Matrix: Water
 Batch No.: 1210-VOCW4

Lab Job No.: L15L010A
 Date Sampled: 12/9/2015
 Date Received: 12/10/2015
 Date Analyzed: 12/10/2015
 Date Reported: 12/28/2015

EPA 8260B (VOCs & Oxy.) by GC/MS, Page 1 of 2

Reporting Unit: ug/L (PPB)

Date Analyzed		12/28/15				
Dilution Factor		100				
Lab Sample I.D.		L15L010-1				
Client Sample I.D.		15-232-GW-2				
Compound	RL					
Dichlorodifluoromethane	0.5	ND				
Chloromethane	0.5	ND				
Vinyl Chloride	0.5	ND				
Bromomethane	0.5	ND				
Chloroethane	0.5	ND				
Trichlorofluoromethane	0.5	ND				
1,1-Dichloroethene	0.5	ND				
Carbon disulfide	0.5	ND				
Methylene chloride	0.5	ND				
Trans-1,2-Dichloroethene	0.5	ND				
1,1-Dichloroethane	0.5	ND				
2,2-Dichloropropane	0.5	ND				
Cis-1,2-Dichloroethene	0.5	ND				
Bromochloromethane	0.5	ND				
Chloroform	0.5	ND				
1,1,1-Trichloroethane	0.5	ND				
Vinyl acetate	0.5	ND				
Carbontetrachloride	0.5	ND				
1,1-Dichloropropene	0.5	ND				
1,2-Dichloroethane	0.5	ND				
Benzene	0.5	ND				
Trichloroethene	0.5	ND				
1,2-Dichloropropane	0.5	ND				
Methyl methacrylate	1	ND				
Dibromomethane	0.5	ND				
Bromodichloromethane	0.5	ND				
2-Chloroethyl Vinyl Ether	0.5	ND				
Cis-1,3-Dichloropropene	0.5	ND				
Toluene	0.5	ND				
Trans-1,3-Dichloropropene	0.5	ND				
Ethylmethacrylate	0.5	ND				
1,1,2-Trichloroethane	0.5	ND				
Dibromochloromethane	0.5	ND				
1,2-Dibromoethane (EDB)	0.5	ND				
Tetrachloroethene	0.5	ND				
1,3-Dichloropropane	0.5	ND				
Chlorobenzene	0.5	ND				

RL=Reporting Limit; ND=Not Detected (Below Dilution Factor x RL).

1650 S. Grove Ave., Suite C
 Ontario, CA 91761

Tel: (951)779-0310
 Fax: (951)779-0344

A & R Laboratories

Client: L & W Construction Services, Inc.
 Project: 15-232
 Project Site: 1244 2nd Ave., Oakland, CA
 Matrix: Water
 Batch No.: 1210-VOCW4

Lab Job No.: L15L010A
 Date Sampled: 12/9/2015
 Date Received: 12/10/2015
 Date Analyzed: 12/10/2015
 Date Reported: 12/28/2015

EPA 8260B (VOCs & Oxy.) by GC/MS, Page 2 of 2

Reporting Unit: ug/L (PPB)

Date Analyzed	12/28/15				
Dilution Factor	100				
Lab Sample I.D.	L15L010-1				
Client Sample I.D.	15-232-GW-2				
Compound	RL				
1,1,1,2-Tetrachloroethane	0.5	ND			
Ethylbenzene	0.5	ND			
Total Xylene	0.5	ND			
Styrene	0.5	ND			
Bromoform	0.5	ND			
Isopropyl benzene	0.5	ND			
Bromobenzene	0.5	ND			
1,2,3-Trichloropropane	0.5	ND			
1,1,1,2-Tetrachloroethane	0.5	ND			
Trans-1,4-dichloro-2-butene	0.5	ND			
2-Chlorotoluene	0.5	ND			
n-Propyl benzene	0.5	ND			
4-Chlorotoluene	0.5	ND			
1,3,5-Trimethyl benzene	0.5	ND			
tert-Butylbenzene	0.5	ND			
p-Isopropyl toluene	0.5	ND			
1,2,4-Trimethyl benzene	0.5	ND			
sec-Butylbenzene	0.5	ND			
1,3-Dichlorobenzene	0.5	ND			
1,4-Dichlorobenzene	0.5	ND			
1,2-Dichlorobenzene	0.5	ND			
n-Butylbenzene	0.5	ND			
1,2-Dibromo-3-chloropropan	0.5	ND			
1,2,4-Trichlorobenzene	0.5	ND			
Hexachlorobutadiene	1	ND			
Naphthalene	0.5	300			
1,2,3-Trichlorobenzene	0.5	ND			
Acetone	5	ND			
2-Butanone(MEK)	5	ND			
MTBE	0.5	ND			
4-Methyl-2-Pentanone (MIBK)	5	ND			
Ethyl-t-butyl Ether(ETBE)	1	ND			
Diisopropyl ether (DIPE)	1	ND			
TAME	1	ND			
t-Butanol	10	ND			
Ethanol	250	ND			

RL=Reporting Limit; ND=Not Detected (Below Dilution Factor x RL).

1650 S. Grove Ave., Suite C
 Ontario, CA 91761

Tel: (951)779-0310
 Fax: (951)779-0344

A & R Laboratories

Client: L & W Construction Services, Inc. Lab Job No.: L15L010A
Project: 15-232 Date Sampled: 12/9/2015
Project Site: 1244 2nd Ave., Oakland, CA Date Received: 12/10/2015
Matrix: Water Date Analyzed: 12/10/2015
Batch No.: AL10-DW Date Reported: 12/28/2015

EPA 8260B (TPH-Gasoline)

Reporting Unit: ug/L (PPB)

Client Sample ID	Lab ID	Dilution Factor	Gasoline		
			C6-C12		
	RL		100		
15-232-GW-2	L15L010-1	1	120		

RL=Reporting Limit; ND=Not Detected (Below RL).

A & R Laboratories

Client: L & W Construction Services, Inc. Lab Job No.: L15L010A
Project: 15-232 Date Sampled: 12/9/2015
Project Site: 1244 2nd Ave., Oakland, CA Date Received: 12/10/2015
Matrix: Water Date Analyzed: 12/10/2015
Batch No.: BL10-DW Date Reported: 12/28/2015

EPA 8015M (TPH-Diesel)

Reporting Unit: mg/L (PPM)

Client Sample ID	Lab ID	Dilution Factor	Diesel		
			C12-C28		
	RL		0.1		
15-232-GW-2	L15L010A-1	1	20		

RL=Reporting Limit; ND=Not Detected (Below RL).

A & R Laboratories

Client: L & W Construction Services, Inc. Lab Job No.: L15L010A
Project: 15-232 Date Sampled: 12/9/2015
Project Site: 1244 2nd Ave., Oakland, CA Date Received: 12/10/2015
Matrix: Water Date Analyzed: 12/28/2015
Batch No.: BL10-DW Date Reported: 12/28/2015

EPA 8015M (TPH-Motor Oil)

Reporting Unit: mg/L (PPM)

Client Sample ID	Lab ID	Dilution Factor	Motor Oil		
			C23-C36		
	RL		2.5		
15-232-GW-2	L15L010-1	1	ND		

RL=Reporting Limit; ND=Not Detected (Below RL).

A & R Laboratories

Client: L & W Construction Services, Inc. Lab Job No.: L15L010A
Project: 15-232 Date Sampled: 12/9/2015
Project Site: 1244 2nd Ave., Oakland, CA Date Received: 12/10/2015
Matrix: Water Date Analyzed: 12/28/2015
Batch No.: CL28-PCBW Date Reported: 12/28/2015

EPA 8082 (PCBs)

Reporting Unit: ug/L (PPB)

LAB SAMPLE I.D.		L15L010-1			
CLIENT SAMPLE I.D.		15-232-GW-2			
COMPOUND	RL				
Aroclor-1016	0.25	ND			
Aroclor-1221	0.25	ND			
Aroclor-1232	0.25	ND			
Aroclor-1242	0.25	ND			
Aroclor-1248	0.25	ND			
Aroclor-1254	0.25	ND			
Aroclor-1260	0.25	ND			

RL=Reporting Limit; ND=Not Detected (Below RL).

1650 S. Grove Ave., Suite C
Ontario, CA 91761

Tel: (951)779-0310
Fax: (951)779-0344

A & R Laboratories

Client:	L & W Construction Services, Inc.	Lab Job No.:	L15L010A
Project:	15-232	Date Sampled:	12/9/2015
Project Site:	1244 2nd Ave., Oakland, CA	Date Received:	12/10/2015
Matrix:	Water	Date Analyzed:	12/28/2015
Batch No.:	1228-SVOCW	Date Reported:	12/28/2015

EPA 8270C (Semi-VOCs by GC/MS, Page 1 of 2)

Reporting Unit: ug/L (PPB)

Date Analyzed	12/28/15		
Date Extracted	12/10/15		
Dilution Factor	1		
Lab Sample I.D.	L15L010-1		
Client Sample I.D.	15-232-GW-2		
Compound	MDL	RL	
N-Nitrosodimethylamine	10.000	20.0	ND
Pyridine	10.000	20.0	ND
Aniline	10.000	20.0	ND
Bis(2-chloroethyl) ether	10.000	20.0	ND
Phenol	10.000	20.0	ND
2-Chlorophenol	10.000	20.0	ND
1,3-Dichlorobenzene	10.000	20.0	ND
1,4-Dichlorobenzene	10.000	20.0	ND
Benzyl alcohol	10.000	20.0	ND
1,2-Dichlorobenzene	10.000	20.0	ND
2-Methylphenol	10.000	20.0	ND
Bis(2-chloroisopropyl) ether	10.000	20.0	ND
4-Methylphenol	10.000	20.0	ND
N-Nitroso-di-n-propyl	10.000	20.0	ND
Hexachloroethane	10.000	20.0	ND
Nitrobenzene	10.000	20.0	ND
Isophorone	10.000	20.0	ND
2-Nitrophenol	10.000	20.0	ND
2,4-Dimethylphenol	10.000	20.0	ND
Bis(2-Chloroethoxy) methane	10.000	20.0	ND
Benzoic Acid	10.000	20.0	ND
2,4-Dichlorophenol	10.000	20.0	ND
1,2,4-Trichlorobenzene	10.000	20.0	ND
Naphthalene	10.000	20.0	250
4-Chloroaniline	10.000	20.0	ND
Hexachlorobutadiene	10.000	20.0	ND
4-Chloro-3-methylphenol	10.000	20.0	ND
2-Methylnaphthalene	10.000	20.0	ND
Hexachlorocyclopentadiene	10.000	20.0	ND
2,4,6-Trichlorophenol	10.000	20.0	ND
2,4,5-Trichlorophenol	10.000	20.0	ND
2-Chloronaphthalene	10.000	20.0	ND
2-Nitroaniline	10.000	20.0	ND
Dimethylphthalate	10.000	20.0	ND
Acenaphthylene	10.000	20.0	ND
2,6-Dinitrotoluene	10.000	20.0	ND

RL=Reporting Limit; ND=Not Detected (Below MDL x Dilution Factor); MDL=Method Detection Limit.
 J=Trace Value Detected Between RL and MDL.

1650 S. Grove Ave., Suite C
 Ontario, CA 91761

Tel: (951)779-0310
 Fax: (951)779-0344

A & R Laboratories

Client:	L & W Construction Services, Inc.	Lab Job No.:	L15L010A
Project:	15-232	Date Sampled:	12/9/2015
Project Site:	1244 2nd Ave., Oakland, CA	Date Received:	12/10/2015
Matrix:	Water	Date Analyzed:	12/28/2015
Batch No.:	1228-SVOCW	Date Reported:	12/28/2015

EPA 8270C (Semi-VOCs by GC/MS, Page 2 of 2)

Reporting Unit: ug/L (PPB)

Date Analyzed	12/28/15		
Date Extracted	12/10/15		
Dilution Factor	1		
Lab Sample I.D.	L15L010-1		
Client Sample I.D.	15-232-GW-2		
Compound	MDL	RL	
3-Nitroaniline	10.000	20.0	ND
Acenaphthene	10.000	20.0	ND
2,4-Dinitrophenol	10.000	20.0	ND
4-Nitrophenol	10.000	20.0	ND
Dibenzofuran	10.000	20.0	ND
2,4-Dinitrotoluene	10.000	20.0	ND
Diethylphthalate	10.000	20.0	ND
Fluorene	10.000	20.0	ND
4-Chlorophenyl-phenylether	10.000	20.0	ND
4-Nitroaniline	10.000	20.0	ND
1,2-Diphenylhydrazine	10.000	20.0	ND
4,6-Dinitro-2-methylphenol	10.000	20.0	ND
N-Nitrosodiphenylamine	10.000	20.0	ND
4-Bromophenyl-phenylether	10.000	20.0	ND
Hexachlorobenzene	10.000	20.0	ND
Pentachlorophenol	10.000	20.0	ND
Benzidine	10.000	20.0	ND
Phenanthrene	10.000	20.0	ND
Anthracene	10.000	20.0	ND
Carbazole	10.000	20.0	ND
Di-n-butylphthalate	10.000	20.0	ND
Fluoranthene	10.000	20.0	ND
Pyrene	10.000	20.0	ND
Butylbenzylphthalate	10.000	20.0	ND
Benzo(a)anthracene	10.000	20.0	ND
3,3'-Dichlorobenzidine	10.000	20.0	ND
Chrysene	10.000	20.0	ND
Bis(2-Ethylhexyl) phthalate	10.000	20.0	ND
Di-n-octylphthalate	10.000	20.0	ND
Benzo(b)fluoranthene	10.000	20.0	ND
Benzo(k)fluoranthene	10.000	20.0	ND
Benzo(a)pyrene	10.000	20.0	ND
Indeno(1,2,3-cd)pyrene	10.000	20.0	ND
Dibenzo(a,h)anthracene	10.000	20.0	ND
Benzo(g,h,i)perylene	10.000	20.0	ND
Creosote	50.000	100.0	ND

RL=Reporting Limit; ND=Not Detected (Below MDL x Dilution Factor); MDL=Method Detection Limit.
 J=Trace Value Detected Between RL and MDL.

1650 S. Grove Ave., Suite C
 Ontario, CA 91761

Tel: (951)779-0310
 Fax: (951)779-0344

A & R Laboratories

Client: L & W Construction Services, Inc. Lab Job No.: L15L010A
Project: 15-232 Date Sampled: 12/9/2015
Project Site: 1244 2nd Ave., Oakland, CA Date Received: 12/10/2015
Matrix: Water Date Digested: 12/28/2015
Extraction Method: EPA 3010 Date Analyzed: 12/28/2015
Batch No.: 1228-MTW Date Reported: 12/28/2015

EPA 6010B (LUFT 5 Metals)

Report Units: mg/L (PPM)

Element	EPA Method	L15L010-1			RL
		15-232-GW-2			
Cadmium (Cd)	6010B	ND			0.02
Chromium (Cr)	6010B	0.15			0.02
Lead (Pb)	6010B	ND			0.02
Nickel (Ni)	6010B	0.2			0.02
Zinc (Zn)	6010B	1.5			0.02

RL=Reporting Limit; ND=Not Detected (Below RL).

A & R Laboratories

EPA 8260B (VOCs) Batch QA/QC Report

Client: L & W Construction Services, Inc.
Project: 15-232
Matrix: Soil
Batch No.: 1210-VOCS4

Lab Job No.: L15L010A
Lab Sample ID: LCS
Date Analyzed: 12/10/2015
Date Reported: 12/28/2015

MB/LCS/LCSD Report

Unit: mg/kg(PPM)

Compound	Method Blank	Spike Conc.	LCS	LCSD	LCS %Rec.	LCSD %Rec.	%RPD	%RPD Accept Limit	%Rec. Accept Limit
1,1-Dichloroethene	ND	0.020	0.018	0.020	90	100	11	≤20	80-120
Benzene	ND	0.020	0.019	0.018	95	90	5	≤20	80-120
Trichloroethene	ND	0.020	0.020	0.020	100	100	0	≤20	80-120
Toluene	ND	0.020	0.019	0.020	95	100	5	≤20	80-120
Chlorobenzene	ND	0.020	0.021	0.019	105	95	10	≤20	80-120

MB: Method Blank.

ND: Not Detected (Below MDL).

A & R Laboratories

EPA 8015B (TPH-Diesel) Batch QA/QC Report

Client: L & W Construction Services, Inc.
Project: 15-232
Matrix: Soil
Batch No.: BL10-DS

Lab Job No.: L15L010A
Lab Sample ID: LCS
Date Analyzed: 12/10/2015
Date Reported: 12/28/2015

MB/LCS/LCSD Report

Unit:mg/kg (PPM)

Analyte	Method	Spike	LCS	LCSD	LCS	LCSD	%RPD	%RPD	%Rec
	Blank	Conc.			%Rec.	%rec.		Accept	Accept
								Limit	Limit
TPH-D	ND	500	415	436	83	87	5	≤20	80-120

ND: Not Detected (at the specified limit).

MB: Method Blank.

LCS: Lab Control Sample.

LCSD: Lab Control Sample Duplicate.

1650 S. Grove Ave., Suite C
Ontario, CA 91761

Tel: (951)779-0310
Fax: (951)779-0344

A & R Laboratories

EPA 6010B (LUFT 5 Metals) Batch QA/QC Report

Client: L & W Construction Services, Inc.
Project: 15-232
Matrix: Soil
Batch No.: 1210-MTS

Lab Job No.: L15L010A
Lab Sample ID: LCS
Date Analyzed: 12/10/2015
Date Reported: 12/28/2015

MB/LCS/LCSD Report

Unit: mg/kg (PPM)

Element	EPA Method	Method Blank	Spike Conc.	LCS	LCSD	LCS %Rec.	LCSD %Rec.	%RPD	%RPD Accept Limit	%Rec. Accept Limit
Cadmium (Cd)	6010B	ND	50	55	49	110	98	12	≤20	80-120
Chromium (Cr)	6010B	ND	50	49	50	98	100	2	≤20	80-120
Lead (Pb)	6010B	ND	50	48	52	96	104	8	≤20	80-120
Nickel (Ni)	6010B	ND	50	50	50	100	100	0	≤20	80-120
Zinc (Zn)	6010B	ND	50	52	49	104	98	6	≤20	80-120

ND: Not Detected (Below Reporting Limit).

1650 S. Grove Ave., Suite C
Ontario, CA 91761

Tel: (951)779-0310
Fax: (951)779-0344

APPENDIX D

PHOTO DOCUMENTATION



Construction Services, Inc.

1550 Wallace Avenue, San Francisco, CA 94124, Phone (415) 822-4555 FAX (415) 822-5290
Corporate Offices 5200 Redwood Highway South, Petaluma, CA 94952 Phone (707) 766-9511 FAX (707) 766-9049

UNDERGROUND STORAGE TANK REMOVAL 1244 2ND AVENUE OAKLAND, CALIFORNIA



Trenchshield is installed to support excavation due to groundwater intrusion.



Groundwater in Excavation



Construction Services, Inc.

1550 Wallace Avenue, San Francisco, CA 94124, Phone (415) 822-4555 FAX (415) 822-5290
Corporate Offices 5200 Redwood Highway South, Petaluma, CA 94952 Phone (707) 766-9511 FAX (707) 766-9049

UNDERGROUND STORAGE TANK REMOVAL 1244 2ND AVENUE OAKLAND, CALIFORNIA



UST Removal



Construction Services, Inc.

1550 Wallace Avenue, San Francisco, CA 94124, Phone (415) 822-4555 FAX (415) 822-5290
Corporate Offices 5200 Redwood Highway South, Petaluma, CA 94952 Phone (707) 766-9511 FAX (707) 766-9049

UNDERGROUND STORAGE TANK REMOVAL 1244 2ND AVENUE OAKLAND, CALIFORNIA



Groundwater in excavation.



Loading UST for transport to metal recycling facility.