

RECEIVED

By Alameda County Environmental Health 3:49 pm, Nov 15, 2016

November 15, 2016

Quik Stop Markets, Inc.
4567 Enterprise Street
Fremont, California 94538-7605

Attn: Mr. Roger Batra

RE: Off-Site Well Sampling Report
Quik Stop Market No. 51
3130 35th Avenue, Oakland, California 94619
Fuel Leak Case No. RO0003209; (Global ID No. T10000008568)
(CCI Project No. 12216-1)

"I declare, under penalty of perjury, that the information and/or recommendations contained in the attached proposal or report is true and correct to the best of my knowledge."

Quik Stop Markets, Inc.



Mr. Roger Batra

Date 11/15/16



October 30, 2016

Alameda County Environmental Health Services
Environmental Protection
1131 Harbor Bay Parkway, Suite 250
Alameda, California 94502-6577

Attention: Mr. Keith Nowell

RE: Off-Site Well Sampling Report
Quik Stop Market No. 51
3130 35th Avenue, Oakland, California 94619
Fuel Leak Case No. RO0003209; (Global ID No. T10000008568)
(CCI Project No. 12216-1)

Dear Mr. Nowell:

On behalf of Quik Stop Markets, Inc. (Quik Stop) Compliance & Closure, Inc. (CCI) is pleased to present the results from the sampling of two wells associated with the former BP gas station located at 3201 35th Street (associated with Alameda County Environmental Health (ACEH) case # RO000014) and one well associated with the former Exxon gas station located at 3055 35th Avenue in Oakland, California (ACEH case # RO0000271), Figures 1 & 2.

Background Information

There are currently two, 10,000-gallon gasoline storage tanks at the site. In June 1998, the fuel tanks were removed and replaced by new fuel tanks. During the removal of the fuel tanks, visible staining of the soil was noted. In addition, soil samples collected from the tank excavation were reported to contain 1,100 milligrams per kilogram (mg/kg) total petroleum hydrocarbons as gasoline (TPHg), 5.2 mg/kg benzene, and 13 mg/kg methyl tertiary butyl ether (MTBE). A monitoring well (MW-5), located in the apparent down-gradient direction of the Quik Stop site, and associated with a fuel investigation at 3055 35th Avenue (ACEH case # RO0000271) was reported to have detectable concentrations of petroleum hydrocarbons in samples collected on July 15, 2015 and 9/23/2016. The contamination detected in well MW-5 may or may not be associated with a release from the Quik Stop site. There is a second groundwater monitoring well, also designated MW-5, (associated with ACEH case # RO000014), located on Mangels Avenue, up-gradient of the Quik Stop site also has relatively high concentrations of detectable petroleum hydrocarbons in samples collected on 8/27/2015 and 9/7/2016. Based on the presence of petroleum hydrocarbons in these off-site monitoring wells ACEH requested a work plan from Quik Stop to investigate the site for a potential fuel release. CCI submitted a soil and groundwater investigation work plan on April 20, 2016. The ACEH approved that work plan in its May 9, 2016 letter.

CCI completed the soil and groundwater investigation at Quik Stop Market No. 51 in July 2016. The laboratory data collected from that investigation indicated extensive petroleum hydrocarbon contamination in the soil and groundwater throughout the site. A majority of the soil contamination is generally found between 10 and 25 feet, with the highest concentrations between 15 and 20 feet. Some shallow soil contamination was detected at borings B-1, B-4 and B-5. Lower concentrations of THPg were detected at 5 feet in these three borings, which are located in the central and west to southwest side of the site.

Groundwater was generally encountered at 27 feet and the water table is under hydrostatic pressure. Static water levels were recorded at depths ranging from 16.5 feet to 23 feet. CCI assumes the groundwater flow direction at the Quik Stop Market is generally toward the west-southwest. This assumption is based on the historical groundwater gradient data from the former Exxon gas station located at 3055 35th Avenue, which is just across 35th Avenue from the Quik Stop site.

Off-Site Well Sampling Results

CCI collected duplicate groundwater samples from monitoring wells MW-5 and MW-10R associated with the former BP gas station on September 7, 2016. These samples were collected by Blaine Tech Services, Inc. on behalf of Arcadis. HydraSleeve's were installed in both of these wells and the duplicate samples were collected by a CCI sample technician. It should be noted that there was not enough water in the HydraSleeve in well MW-10R for analysis of total petroleum hydrocarbons as diesel (TPHd) from this well.

CCI collected water samples from the monitoring well MW-5 associated with the former Exxon gas station on September 23, 2016. Prior to sampling the well, CCI measured depth to water using an interface probe to determine the presence of any liquid phase hydrocarbons (LPH). No LPH was found in the well. Prior to sampling well MW-5 (Exxon), approximately 7 gallons of water was purged from the well. A new disposable ball valve bailer was used to collect water samples from the well. The purge water was placed in a 55-gallon drum, which was disposed of by Veolia Environmental Services on October 5, 2016. Copies of the well field logs are attached.

The groundwater samples were submitted to SGS Accutest Laboratory in San Jose, California for analysis. The samples were analyzed for total petroleum hydrocarbons as gasoline and total petroleum hydrocarbons as diesel (TPHd) using EPA Test Method 8015C, benzene, toluene, ethylbenzene, total xylenes and fuel oxygenates using EPA Test Method 8260B. The laboratory reported all three well samples to have detectable petroleum hydrocarbons. The laboratory results are summarized in Table 1. The laboratory reports are attached.

The laboratory data indicates these three off-site wells continue to be impacted by relatively high concentrations of petroleum hydrocarbons. Based on the extensive soil and groundwater contamination discovered by CCI in its July 2016 soil and groundwater investigation conducted at the Quik Stop site, groundwater contamination may be entering the Quik Stop site from direction of the former BP gas station, located north of the Quik Stop site. Free product has been previously documented in some of the up-gradient groundwater monitoring wells associated with the former BP site.

CCI appreciates your comments and if you have any questions, please contact our office at 925-648-2008 or e-mail gary@cci-envr.com.

Sincerely,
Compliance & Closure, Inc.



Gary R. Mulkey, P.G. 5842

Cc: Mr. Roger Batra, Quik Stop Markets

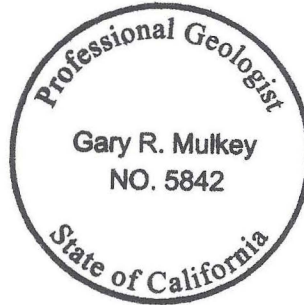

TABLE 1

Summary of On-Site Grab Water Samples
Quik Stop No. 51 - 3130 35th Avenue, Oakland, CA

Sample Number	Date Sampled	TPHg (ug/L)	TPHd (ug/L)	Benzene (ug/L)	Toluene (ug/L)	Ethyl Benzene (ug/L)	Total Xylenes (ug/L)	MTBE (ug/L)	TBA (ug/L)	DIPE (ug/L)	TAME (ug/L)	ETBE (ug/L)	Naphthalene (ug/L)
B-1-W	7/12/2016	71100 ⁽³⁾	N/A	233 ^(1,3)	3.7	254 ^(1,3)	133	25100 ⁽³⁾	39000 ⁽³⁾	<2	16.7	<2	5.9
B-2-W	7/12/2016	21000 ⁽³⁾	N/A	1280 ⁽³⁾	154 ⁽³⁾	575 ⁽³⁾	2430 ⁽³⁾	2.7	51.6	<2	<2	<2	123 ⁽³⁾
B-3-W	7/12/2016	72500 ⁽³⁾	N/A	1140 ⁽³⁾	4.4	1340 ⁽³⁾	784 ^(1,3)	21100 ⁽³⁾	17900 ⁽³⁾	0.28 ⁽¹⁾	16.5	<2	<2500 ⁽³⁾
B-4-W	7/5/2016	40800	N/A	511	<200	141 ⁽¹⁾	316 ⁽¹⁾	14600	20000	<400	<400	<400	<1000
B-5-W	7/12/2016	183000 ⁽³⁾	N/A	404 ^(1,3)	5.5	613 ^(1,3)	551 ^(1,3)	70100 ⁽³⁾	129000 ⁽³⁾	0.93 ⁽¹⁾	42.1	0.39 ⁽¹⁾	12.2
B-W-6	7/5/2016	2790 ⁽³⁾	N/A	365 ⁽³⁾	2.9	110 ⁽³⁾	153	52.8	354	0.28 ⁽¹⁾	<2	<2	4.5 ⁽¹⁾
MW-5 (BP) ⁽⁴⁾	9/7/2016	36200	591	3490	1590	2170	7200	<100	<2000	<100	<200	<200	N/A
MW-10R (BP) ⁽⁴⁾	9/7/2016	1650	N/A ⁽⁷⁾	291 ⁽³⁾	6.4	70.1	26.1	3.4	<20	<1	<2	<2	N/A
MW-5 (Exxon) ⁽⁵⁾	9/23/2016	7250	773 ⁽⁶⁾	1730	38.6	288	26.0 ⁽¹⁾	163	7130	<25	<50	<50	N/A

Foot Notes

- 1 Indicates an estimated value below laboratory reporting limit
- 2 Indicates analyte found in associated method blank
- 3 Result is from Run # 2
- 4 One time sampling of wells MW-5 (BP) and MW-10R (BP) associated with site located at 3201 35th Avenue, Oakland, CA
- 5 One time sampling of well MW-5 (Exxon) associated with site located at 3055 35th Avenue, Oakland, CA
- 6 Petroleum hydrocarbon pattern begins before C10.
- 7 Not enough water in hydrosleeve to sample for diesel

TPHg Total petroleum hydrocarbons as gasoline
 TPHd Total petroleum hydrocarbons as diesel
 MTBE Methyl Tert Butyl Ether
 TBA Tert-Butyl Alcohol
 DIPE Di-Isopropyl ether
 ETBE Ethyl Tert Butyl Ether
 ug/L Micrograms per liter
 < Less than laboratory reporting limit
 N/A Not available



SOURCE: USGS 1:24,000 SCALE SERIES OAKLAND EAST, CA QUAD

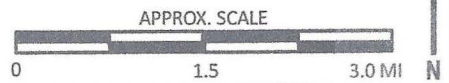

Reviewed By:	GM
Approved By:	GM

VICINITY MAP

Quik Stop Market No. 51
3130 35th Avenue
Oakland, California

Compliance & Closure, Inc.	
Job No.: 12216.1	Drawn By: GM
Date: 4/20/2016	Fig. No.: 1

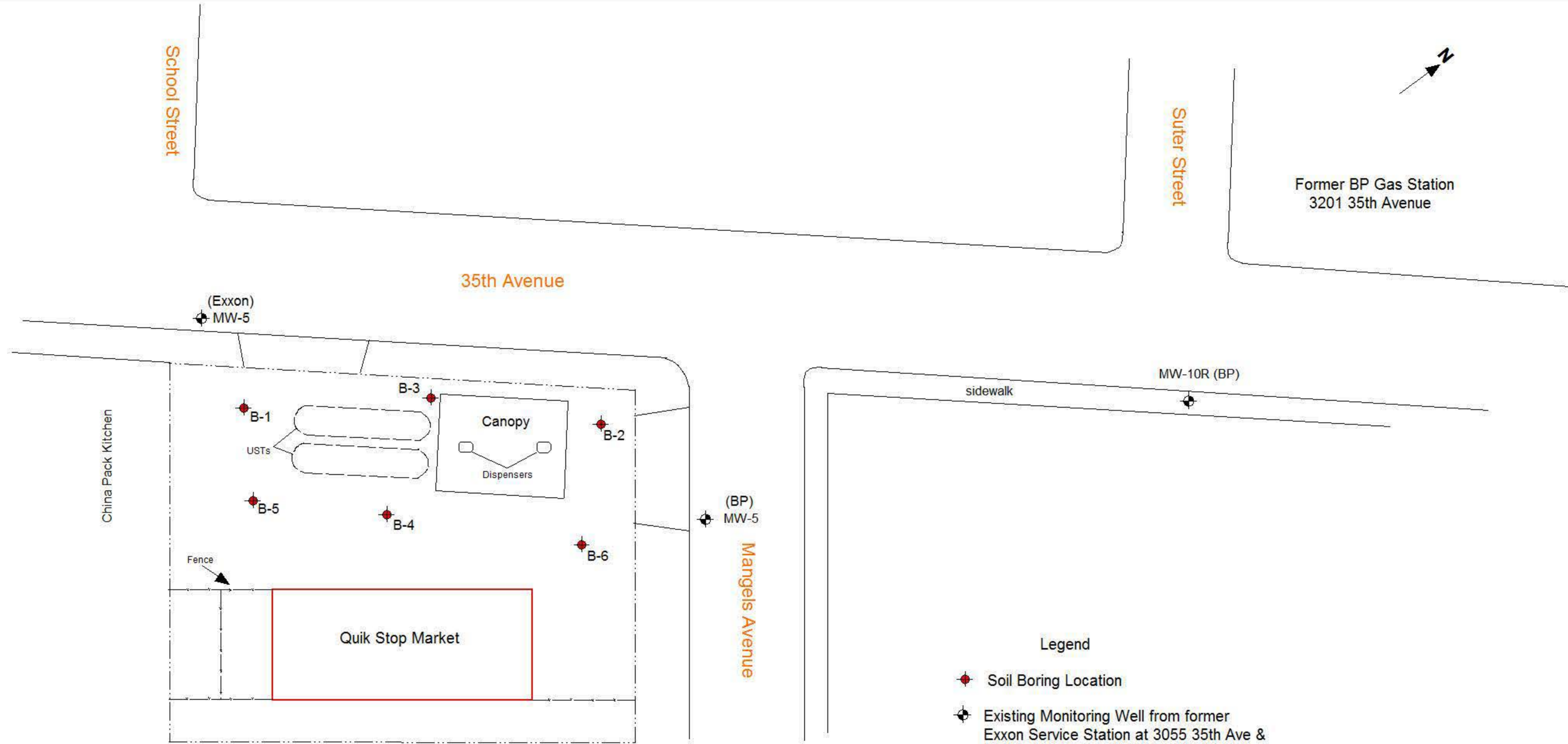

- Legend**
- ◆ Soil Boring Location
 - ⊕ Existing Monitoring Well from former Exxon Service Station at 3055 35th Ave & former BP Station at 3201 35th Ave.

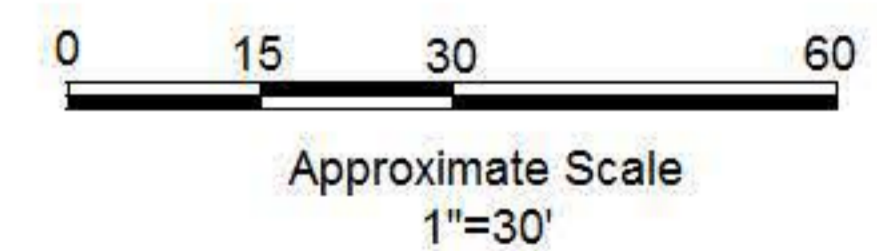

Job No.:	12216-1	Site Plan Quik Stop #51 3130 35th Avenue Oakland, California	Compliance & Closure, Inc.	
Date:	11/7/2016		Drawn by:	Figure No.:
		NLN	2	

Laboratory Reports – September 7, 2016

&

September 23, 2016

Technical Report for

Quick Stop Markets

T10000008568-CCCAD:Quik Stop 51; Oakland, CA

12216-2

SGS Accutest Job Number: FA36765

Sampling Date: 09/07/16

Report to:

Compliance & Closure, Inc.
4115 Blackhawk Plaza Circle Suite 100
Danville, CA 94506
gary@cci-envr.com

ATTN: Gary Mulkey

Total number of pages in report: 29



Test results contained within this data package meet the requirements of the National Environmental Laboratory Accreditation Program and/or state specific certification programs as applicable.

Norm Farmer
Technical Director

Client Service contact: Elvin Kumar 407-425-6700

Certifications: FL (E83510), LA (03051), KS (E-10327), IA (366), IL (200063), NC (573), NJ (FL002), SC (96038001)
DoD ELAP (L-A-B L2229), CA (2937), TX (T104704404), PA (68-03573), VA (460177),
AK, AR, GA, KY, MA, NV, OK, UT, WA

This report shall not be reproduced, except in its entirety, without the written approval of SGS Accutest.
Test results relate only to samples analyzed.

Table of Contents

-1-

Section 1: Sample Summary	3
Section 2: Summary of Hits	4
Section 3: Sample Results	5
3.1: FA36765-1: MW-10R (BP)	6
3.2: FA36765-2: MW-5 (BP)	8
Section 4: Misc. Forms	11
4.1: Certification Exceptions	12
4.2: Chain of Custody	13
Section 5: GC/MS Volatiles - QC Data Summaries	16
5.1: Method Blank Summary	17
5.2: Blank Spike Summary	19
5.3: Matrix Spike/Matrix Spike Duplicate Summary	21
Section 6: GC Volatiles - QC Data Summaries	23
6.1: Method Blank Summary	24
6.2: Blank Spike Summary	25
6.3: Matrix Spike/Matrix Spike Duplicate Summary	26
Section 7: GC Semi-volatiles - QC Data Summaries	27
7.1: Method Blank Summary	28
7.2: Blank Spike Summary	29

1

2

3

4

5

6

7



Sample Summary

Quick Stop Markets

Job No: FA36765

T10000008568-CCCAD: Quik Stop 51; Oakland, CA
Project No: 12216-2

Sample Number	Collected		Received	Matrix		Client Sample ID
	Date	Time By		Code	Type	
FA36765-1	09/07/16	09:44 CP	09/09/16	AQ	Water	MW-10R (BP)
FA36765-2	09/07/16	09:22 CP	09/09/16	AQ	Water	MW-5 (BP)

Summary of Hits

Job Number: FA36765
Account: Quick Stop Markets
Project: T10000008568-CCCAD:Quik Stop 51; Oakland, CA
Collected: 09/07/16

2

Lab Sample ID	Client Sample ID	Result/ Qual	RL	MDL	Units	Method
FA36765-1	MW-10R (BP)					
Benzene ^a		3490	100	20	ug/l	SW846 8260B
Toluene ^a		1590	100	20	ug/l	SW846 8260B
Ethylbenzene ^a		2170	100	25	ug/l	SW846 8260B
Xylene (total) ^a		7200	300	56	ug/l	SW846 8260B
TPH-GRO (C6-C10)		36.2	5.0	2.5	mg/l	SW846 8015C
FA36765-2	MW-5 (BP)					
Benzene		291	5.0	1.0	ug/l	SW846 8260B
Toluene		6.4	1.0	0.20	ug/l	SW846 8260B
Ethylbenzene		70.1	1.0	0.25	ug/l	SW846 8260B
Xylene (total)		26.1	3.0	0.56	ug/l	SW846 8260B
Methyl Tert Butyl Ether		3.4	1.0	0.20	ug/l	SW846 8260B
TPH-GRO (C6-C10)		1.65	1.0	0.50	mg/l	SW846 8015C
TPH (C10-C28)		0.591	0.071	0.029	mg/l	SW846 8015C

(a) Dilution required due to matrix interference.

Sample Results

Report of Analysis

Report of Analysis

3.1
3

Client Sample ID: MW-10R (BP)	Date Sampled: 09/07/16
Lab Sample ID: FA36765-1	Date Received: 09/09/16
Matrix: AQ - Water	Percent Solids: n/a
Method: SW846 8260B	
Project: T10000008568-CCCAD:Quik Stop 51; Oakland, CA	

	File ID	DF	Analyzed	By	Prep Date	Prep Batch	Analytical Batch
Run #1 ^a	J0979540.D	100	09/20/16	DP	n/a	n/a	VJ5433
Run #2							

	Purge Volume
Run #1	5.0 ml
Run #2	

BTEX, Oxygenates

CAS No.	Compound	Result	RL	MDL	Units	Q
71-43-2	Benzene	3490	100	20	ug/l	
108-88-3	Toluene	1590	100	20	ug/l	
100-41-4	Ethylbenzene	2170	100	25	ug/l	
1330-20-7	Xylene (total)	7200	300	56	ug/l	
108-20-3	Di-Isopropyl Ether	ND	100	23	ug/l	
637-92-3	Ethyl Tert Butyl Ether	ND	200	22	ug/l	
1634-04-4	Methyl Tert Butyl Ether	ND	100	20	ug/l	
994-05-8	Tert-Amyl Methyl Ether	ND	200	20	ug/l	
75-65-0	Tert-Butyl Alcohol	ND	2000	910	ug/l	

CAS No.	Surrogate Recoveries	Run# 1	Run# 2	Limits
1868-53-7	Dibromofluoromethane	96%		83-118%
17060-07-0	1,2-Dichloroethane-D4	91%		79-125%
2037-26-5	Toluene-D8	104%		85-112%
460-00-4	4-Bromofluorobenzene	96%		83-118%

(a) Dilution required due to matrix interference.

ND = Not detected MDL = Method Detection Limit J = Indicates an estimated value
 RL = Reporting Limit B = Indicates analyte found in associated method blank
 E = Indicates value exceeds calibration range N = Indicates presumptive evidence of a compound

Report of Analysis

3.1
3

Client Sample ID: MW-10R (BP)	
Lab Sample ID: FA36765-1	Date Sampled: 09/07/16
Matrix: AQ - Water	Date Received: 09/09/16
Method: SW846 8015C	Percent Solids: n/a
Project: T10000008568-CCCAD:Quik Stop 51; Oakland, CA	

Run #	File ID	DF	Analyzed	By	Prep Date	Prep Batch	Analytical Batch
Run #1	CD139936.D	50	09/12/16	EG	n/a	n/a	GCD5827
Run #2							

Run #	Purge Volume
Run #1	5.0 ml
Run #2	

CAS No.	Compound	Result	RL	MDL	Units	Q
	TPH-GRO (C6-C10)	36.2	5.0	2.5	mg/l	
CAS No.	Surrogate Recoveries	Run# 1	Run# 2	Limits		
460-00-4	4-Bromofluorobenzene	95%		70-131%		
98-08-8	aaa-Trifluorotoluene	82%		69-143%		

ND = Not detected	MDL = Method Detection Limit	J = Indicates an estimated value
RL = Reporting Limit		B = Indicates analyte found in associated method blank
E = Indicates value exceeds calibration range		N = Indicates presumptive evidence of a compound

Report of Analysis

Client Sample ID: MW-5 (BP)		Date Sampled: 09/07/16
Lab Sample ID: FA36765-2		Date Received: 09/09/16
Matrix: AQ - Water		Percent Solids: n/a
Method: SW846 8260B		
Project: T10000008568-CCCAD: Quik Stop 51; Oakland, CA		

	File ID	DF	Analyzed	By	Prep Date	Prep Batch	Analytical Batch
Run #1	J0979477.D	1	09/17/16	SP	n/a	n/a	VJ5430
Run #2	J0979541.D	5	09/20/16	DP	n/a	n/a	VJ5433

	Purge Volume
Run #1	5.0 ml
Run #2	5.0 ml

BTEX, Oxygenates

CAS No.	Compound	Result	RL	MDL	Units	Q
71-43-2	Benzene	291 ^a	5.0	1.0	ug/l	
108-88-3	Toluene	6.4	1.0	0.20	ug/l	
100-41-4	Ethylbenzene	70.1	1.0	0.25	ug/l	
1330-20-7	Xylene (total)	26.1	3.0	0.56	ug/l	
108-20-3	Di-Isopropyl Ether	ND	1.0	0.23	ug/l	
637-92-3	Ethyl Tert Butyl Ether	ND	2.0	0.22	ug/l	
1634-04-4	Methyl Tert Butyl Ether	3.4	1.0	0.20	ug/l	
994-05-8	Tert-Amyl Methyl Ether	ND	2.0	0.20	ug/l	
75-65-0	Tert-Butyl Alcohol	ND	20	9.1	ug/l	

CAS No.	Surrogate Recoveries	Run# 1	Run# 2	Limits
1868-53-7	Dibromofluoromethane	98%	95%	83-118%
17060-07-0	1,2-Dichloroethane-D4	92%	89%	79-125%
2037-26-5	Toluene-D8	101%	106%	85-112%
460-00-4	4-Bromofluorobenzene	102%	99%	83-118%

(a) Result is from Run# 2

ND = Not detected MDL = Method Detection Limit

RL = Reporting Limit

E = Indicates value exceeds calibration range

J = Indicates an estimated value

B = Indicates analyte found in associated method blank

N = Indicates presumptive evidence of a compound

Report of Analysis

32
3

Client Sample ID: MW-5 (BP)	Date Sampled: 09/07/16
Lab Sample ID: FA36765-2	Date Received: 09/09/16
Matrix: AQ - Water	Percent Solids: n/a
Method: SW846 8015C	
Project: T10000008568-CCCAD: Quik Stop 51; Oakland, CA	

Run #	File ID	DF	Analyzed	By	Prep Date	Prep Batch	Analytical Batch
Run #1	CD139953.D	10	09/12/16	EG	n/a	n/a	GCD5827
Run #2							

Run #	Purge Volume
Run #1	5.0 ml
Run #2	

CAS No.	Compound	Result	RL	MDL	Units	Q
	TPH-GRO (C6-C10)	1.65	1.0	0.50	mg/l	
CAS No.	Surrogate Recoveries	Run# 1	Run# 2	Limits		
460-00-4	4-Bromofluorobenzene	91%		70-131%		
98-08-8	aaa-Trifluorotoluene	90%		69-143%		

ND = Not detected	MDL = Method Detection Limit	J = Indicates an estimated value
RL = Reporting Limit		B = Indicates analyte found in associated method blank
E = Indicates value exceeds calibration range		N = Indicates presumptive evidence of a compound

Report of Analysis

32
3

Client Sample ID: MW-5 (BP)	Date Sampled: 09/07/16
Lab Sample ID: FA36765-2	Date Received: 09/09/16
Matrix: AQ - Water	Percent Solids: n/a
Method: SW846 8015C SW846 3510C	
Project: T10000008568-CCCAD:Quik Stop 51; Oakland, CA	

	File ID	DF	Analyzed	By	Prep Date	Prep Batch	Analytical Batch
Run #1	WR12664.D	1	09/13/16	SJL	09/12/16	OP61831	GWR489
Run #2							

	Initial Volume	Final Volume
Run #1	700 ml	1.0 ml
Run #2		

CAS No.	Compound	Result	RL	MDL	Units	Q
	TPH (C10-C28)	0.591	0.071	0.029	mg/l	
CAS No.	Surrogate Recoveries	Run# 1	Run# 2	Limits		
84-15-1	o-Terphenyl	89%		50-131%		

ND = Not detected	MDL = Method Detection Limit	J = Indicates an estimated value
RL = Reporting Limit		B = Indicates analyte found in associated method blank
E = Indicates value exceeds calibration range		N = Indicates presumptive evidence of a compound

Misc. Forms

Custody Documents and Other Forms

Includes the following where applicable:

- Certification Exceptions
- Chain of Custody

Parameter Certification Exceptions

Job Number: FA36765

Account: QSMCAF Quick Stop Markets

Project: T10000008568-CCCAD:Quik Stop 51; Oakland, CA

The following parameters included in this report are exceptions to NELAC certification.
The certification status of each is indicated below.

Parameter	CAS#	Method	Mat	Certification Status
Di-Isopropyl Ether	108-20-3	SW846 8260B	AQ	Certified by SOP MS005

4.1
4

CHAIN OF CUSTODY RECORD AND ANALYSIS REQUEST

PROJECT NO. 12216-2		PROJECT NAME/SITE Quik stop # 51 Oakland, CA						ANALYSIS REQUESTED										P.O. #:		
SAMPLERS <i>C.M. Palmer</i> (SIGN)		(PRINT) <i>C.M. Palmer</i>						NO. CONTAINERS	SAMPLE TYPE	/										REMARKS
SAMPLE IDENTIFICATION		DATE	TIME	COMP	GRAB	PRES. USED	ICED			BTEX (602/8220)	TPHg (6015)	TPHg (6015) <i>OMP</i>	TOS 418 15520	6011/8010	824/8240	825/8270	8260 <i>photo</i> (675/1515)			
①	MW-10R (BP)	9/7/16	0944			HCl	Y			4	W	X	X	X			X		Get TPHg from GCMS	
②	MW-5 (BP)	9/7/16	0922			HCl	Y			5	W	X	X	X			X		Well # MW-10R no TPHd test can be undul to limited sample volume.	
RELINQUISHED BY: <i>C.M. Palmer</i> CCI	DATE 9/7/16	TIME 1224	RECEIVED BY: <i>P. HUFANO</i>	LABORATORY: SGS Accutest Labs. San Jose, CA		PLEASE SEND RESULTS TO: Compliance & Closure, Inc. 4115 Blackhawk Plaza Circle Suite 100 Danville, CA 94506 (925) 648-2008 Fax (925) 292-4565 gary @ cci-envr.com														
RELINQUISHED BY: <i>Lee Brown</i>	DATE 9/7/16	TIME 1500	RECEIVED BY: <i>FROX</i>	REQUESTED TURNAROUND TIME: <i>standard</i>		PROJECT MANAGER: Attn: Mr. Gary Mulkey														
RELINQUISHED BY: <i>Fx</i>	DATE	TIME	RECEIVED BY: <i>930</i>	RECEIPT CONDITION: <i>04:0</i>																
RELINQUISHED BY:	DATE	TIME	RECEIVED BY LABORATORY:																	

4.2
4

SGS ACCUTEST - ORLANDO SAMPLE RECEIPT CONFIRMATION

SGS ACCUTEST'S JOB NUMBER: FA36765 CLIENT: Compliance & Closure PROJECT: Quik Stop #51
 DATE/TIME RECEIVED: 9/9/16 930 (MM/DD/YY 24:00) NUMBER OF COOLERS RECEIVED: _____
 METHOD OF DELIVERY: FEDEX UPS ACCUTEST COURIER DELIVERY OTHER: _____
 AIRBILL NUMBERS: 7771 7490 0547

COOLER INFORMATION

- CUSTODY SEAL NOT PRESENT OR NOT INTACT
- CHAIN OF CUSTODY NOT RECEIVED (COC)
- ANALYSIS REQUESTED IS UNCLEAR OR MISSING
- SAMPLE DATES OR TIMES UNCLEAR OR MISSING
- TEMPERATURE CRITERIA NOT MET

TRIP BLANK INFORMATION

- TRIP BLANK PROVIDED
- TRIP BLANK NOT PROVIDED
- TRIP BLANK NOT ON COC
- TRIP BLANK INTACT
- TRIP BLANK NOT INTACT
- RECEIVED WATER TRIP BLANK
- RECEIVED SOIL TRIP BLANK

MISC. INFORMATION

NUMBER OF ENCORES? 25-GRAM _____ 5-GRAM _____
 NUMBER OF 5035 FIELD KITS? _____
 NUMBER OF LAB FILTERED METALS? _____

TEMPERATURE INFORMATION

IR THERM ID 1 CORR. FACTOR -0.4
 OBSERVED TEMPS: 4.4
 CORRECTED TEMPS: 4.0 (USED FOR LIMS)

SAMPLE INFORMATION

- INCORRECT NUMBER OF CONTAINERS USED
- SAMPLE RECEIVED IMPROPERLY PRESERVED
- INSUFFICIENT VOLUME FOR ANALYSIS
- DATES/TIMES ON COC DO NOT MATCH SAMPLE LABEL
- ID'S ON COC DO NOT MATCH LABEL
- VOC VIALS HAVE HEADSPACE (MACRO BUBBLES)
- BOTTLES RECEIVED BUT ANALYSIS NOT REQUESTED
- NO BOTTLES RECEIVED FOR ANALYSIS REQUESTED
- UNCLEAR FILTERING OR COMPOSITING INSTRUCTIONS
- SAMPLE CONTAINER(S) RECEIVED BROKEN
- 5035 FIELD KITS NOT RECEIVED WITHIN 48 HOURS
- BULK VOA SOIL JARS NOT RECEIVED WITHIN 48 HOURS
- % SOLIDS JAR NOT RECEIVED
- RESIDUAL CHLORINE PRESENT LOT# _____

(APPLICABLE TO EPA 600 SERIES OR NORTH CAROLINA ORGANICS)

TEST STRIP LOT#s pH 0-3 230315 pH 10-12 219813A OTHER (specify) _____

SUMMARY OF COMMENTS: (1) 1000mL amber received for sample #2 Received (4) vials between BTEX and 8015. Will be (2) vials for BTEX and (2) vials for 8015 for both samples

TECHNICIAN SIGNATURE/DATE [Signature] 9/9/16 REVIEWER SIGNATURE/DATE JE 9-9-16
 NF 02/16 receipt confirmation 020116.xls

4.2
4

ORIGIN ID:RBKA (408) 588-0200
ELVIN KUPAR
ACCUTEST NORTHERN CA
2105 LUNDY AVE
SAN JOSE, CA 95131
UNITED STATES US

ACTWGT: 21.00 LB
CRD: 104685527/INET3780

BILL RECIPIENT

TO **SAMPLE MANAGEMENT**
ACCUTEST LABORATORIES SOUTHEAST
4405 VINELAND ROAD

ORLANDO FL 32811

(407) 426-8700

REF: C88549

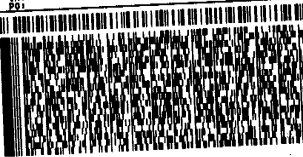

FedEx
Express



TRK# 7771 7490 0547
0201

THU - 08 SEP 10:30A
PRIORITY OVERNIGHT

XH TIXA

32811
FL-US MCO

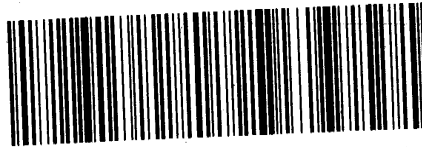

GC/MS Volatiles

QC Data Summaries

Includes the following where applicable:

- Method Blank Summaries
- Blank Spike Summaries
- Matrix Spike and Duplicate Summaries

Method Blank Summary

Job Number: FA36765
Account: QSMCAF Quick Stop Markets
Project: T10000008568-CCCAD:Quik Stop 51; Oakland, CA

Sample	File ID	DF	Analyzed	By	Prep Date	Prep Batch	Analytical Batch
VJ5430-MB	J0979469.D	1	09/17/16	SP	n/a	n/a	VJ5430

The QC reported here applies to the following samples:

Method: SW846 8260B

FA36765-2

CAS No.	Compound	Result	RL	MDL	Units	Q
108-20-3	Di-Isopropyl Ether	ND	1.0	0.23	ug/l	
100-41-4	Ethylbenzene	ND	1.0	0.25	ug/l	
637-92-3	Ethyl Tert Butyl Ether	ND	2.0	0.22	ug/l	
1634-04-4	Methyl Tert Butyl Ether	ND	1.0	0.20	ug/l	
994-05-8	Tert-Amyl Methyl Ether	ND	2.0	0.20	ug/l	
75-65-0	Tert-Butyl Alcohol	ND	20	9.1	ug/l	
108-88-3	Toluene	ND	1.0	0.20	ug/l	
1330-20-7	Xylene (total)	ND	3.0	0.56	ug/l	

CAS No.	Surrogate Recoveries	Limits	
1868-53-7	Dibromofluoromethane	100%	83-118%
17060-07-0	1,2-Dichloroethane-D4	97%	79-125%
2037-26-5	Toluene-D8	107%	85-112%
460-00-4	4-Bromofluorobenzene	105%	83-118%

Method Blank Summary

Job Number: FA36765
Account: QSMCAF Quick Stop Markets
Project: T10000008568-CCCAD:Quik Stop 51; Oakland, CA

Sample	File ID	DF	Analyzed	By	Prep Date	Prep Batch	Analytical Batch
VJ5433-MB	J0979529.D	1	09/20/16	DP	n/a	n/a	VJ5433

The QC reported here applies to the following samples:

Method: SW846 8260B

FA36765-1, FA36765-2

CAS No.	Compound	Result	RL	MDL	Units	Q
71-43-2	Benzene	ND	1.0	0.20	ug/l	
108-20-3	Di-Isopropyl Ether	ND	1.0	0.23	ug/l	
100-41-4	Ethylbenzene	ND	1.0	0.25	ug/l	
637-92-3	Ethyl Tert Butyl Ether	ND	2.0	0.22	ug/l	
1634-04-4	Methyl Tert Butyl Ether	ND	1.0	0.20	ug/l	
994-05-8	Tert-Amyl Methyl Ether	ND	2.0	0.20	ug/l	
75-65-0	Tert-Butyl Alcohol	ND	20	9.1	ug/l	
108-88-3	Toluene	ND	1.0	0.20	ug/l	
1330-20-7	Xylene (total)	ND	3.0	0.56	ug/l	

CAS No.	Surrogate Recoveries	Limits	
1868-53-7	Dibromofluoromethane	97%	83-118%
17060-07-0	1,2-Dichloroethane-D4	92%	79-125%
2037-26-5	Toluene-D8	104%	85-112%
460-00-4	4-Bromofluorobenzene	104%	83-118%

Blank Spike Summary

Job Number: FA36765
Account: QSMCAF Quick Stop Markets
Project: T10000008568-CCCAD:Quik Stop 51; Oakland, CA

Sample	File ID	DF	Analyzed	By	Prep Date	Prep Batch	Analytical Batch
VJ5430-BS	J0979468.D	1	09/17/16	SP	n/a	n/a	VJ5430

The QC reported here applies to the following samples:

Method: SW846 8260B

FA36765-2

CAS No.	Compound	Spike ug/l	BSP ug/l	BSP %	Limits
108-20-3	Di-Isopropyl Ether	25	26.4	106	68-123
100-41-4	Ethylbenzene	25	27.8	111	81-121
637-92-3	Ethyl Tert Butyl Ether	25	23.9	96	71-120
1634-04-4	Methyl Tert Butyl Ether	25	23.7	95	72-117
994-05-8	Tert-Amyl Methyl Ether	25	23.8	95	73-122
75-65-0	Tert-Butyl Alcohol	250	289	116	63-129
108-88-3	Toluene	25	28.3	113	80-120
1330-20-7	Xylene (total)	75	80.7	108	80-126

CAS No.	Surrogate Recoveries	BSP	Limits
1868-53-7	Dibromofluoromethane	99%	83-118%
17060-07-0	1,2-Dichloroethane-D4	93%	79-125%
2037-26-5	Toluene-D8	101%	85-112%
460-00-4	4-Bromofluorobenzene	101%	83-118%

* = Outside of Control Limits.

5.2.1
 5

Blank Spike Summary

Job Number: FA36765
Account: QSMCAF Quick Stop Markets
Project: T10000008568-CCCAD:Quik Stop 51; Oakland, CA

Sample	File ID	DF	Analyzed	By	Prep Date	Prep Batch	Analytical Batch
VJ5433-BS	J0979528.D	1	09/20/16	DP	n/a	n/a	VJ5433

The QC reported here applies to the following samples:

Method: SW846 8260B

FA36765-1, FA36765-2

CAS No.	Compound	Spike ug/l	BSP ug/l	BSP %	Limits
71-43-2	Benzene	25	30.4	122	81-122
108-20-3	Di-Isopropyl Ether	25	29.1	116	68-123
100-41-4	Ethylbenzene	25	29.4	118	81-121
637-92-3	Ethyl Tert Butyl Ether	25	23.6	94	71-120
1634-04-4	Methyl Tert Butyl Ether	25	24.6	98	72-117
994-05-8	Tert-Amyl Methyl Ether	25	23.7	95	73-122
75-65-0	Tert-Butyl Alcohol	250	316	126	63-129
108-88-3	Toluene	25	29.6	118	80-120
1330-20-7	Xylene (total)	75	84.5	113	80-126

CAS No.	Surrogate Recoveries	BSP	Limits
1868-53-7	Dibromofluoromethane	100%	83-118%
17060-07-0	1,2-Dichloroethane-D4	91%	79-125%
2037-26-5	Toluene-D8	100%	85-112%
460-00-4	4-Bromofluorobenzene	97%	83-118%

* = Outside of Control Limits.

5.2.2
 5

Matrix Spike/Matrix Spike Duplicate Summary

Job Number: FA36765

Account: QSMCAF Quick Stop Markets

Project: T10000008568-CCCAD:Quik Stop 51; Oakland, CA

Sample	File ID	DF	Analyzed	By	Prep Date	Prep Batch	Analytical Batch
JC27449-1MS	J0979491.D	1	09/17/16	SP	n/a	n/a	VJ5430
JC27449-1MSD	J0979492.D	1	09/17/16	SP	n/a	n/a	VJ5430
JC27449-1	J0979471.D	1	09/17/16	SP	n/a	n/a	VJ5430

The QC reported here applies to the following samples:

Method: SW846 8260B

FA36765-2

CAS No.	Compound	JC27449-1 ug/l	Spike Q ug/l	MS ug/l	MS %	Spike ug/l	MSD ug/l	MSD %	RPD	Limits Rec/RPD
108-20-3	Di-Isopropyl Ether	ND	25	25.9	104	25	25.6	102	1	68-123/16
100-41-4	Ethylbenzene	ND	25	26.1	104	25	26.6	106	2	81-121/14
637-92-3	Ethyl Tert Butyl Ether	ND	25	22.2	89	25	21.6	86	3	71-120/14
1634-04-4	Methyl Tert Butyl Ether	ND	25	22.4	90	25	22.1	88	1	72-117/14
994-05-8	Tert-Amyl Methyl Ether	ND	25	20.9	84	25	21.5	86	3	73-122/13
75-65-0	Tert-Butyl Alcohol	ND	250	378	151*	250	401	160*	6	63-129/27
108-88-3	Toluene	ND	25	25.8	103	25	26.2	105	2	80-120/14
1330-20-7	Xylene (total)	ND	75	74.8	100	75	74.3	99	1	80-126/15

CAS No.	Surrogate Recoveries	MS	MSD	JC27449-1	Limits
1868-53-7	Dibromofluoromethane	99%	98%	99%	83-118%
17060-07-0	1,2-Dichloroethane-D4	92%	92%	94%	79-125%
2037-26-5	Toluene-D8	97%	100%	106%	85-112%
460-00-4	4-Bromofluorobenzene	95%	95%	102%	83-118%

* = Outside of Control Limits.

Matrix Spike/Matrix Spike Duplicate Summary

Job Number: FA36765

Account: QSMCAF Quick Stop Markets

Project: T10000008568-CCCAD:Quik Stop 51; Oakland, CA

Sample	File ID	DF	Analyzed	By	Prep Date	Prep Batch	Analytical Batch
FA37016-1MS	J0979532.D	1	09/20/16	DP	n/a	n/a	VJ5433
FA37016-1MSD	J0979533.D	1	09/20/16	DP	n/a	n/a	VJ5433
FA37016-1	J0979530.D	1	09/20/16	DP	n/a	n/a	VJ5433

The QC reported here applies to the following samples:

Method: SW846 8260B

FA36765-1, FA36765-2

CAS No.	Compound	FA37016-1 ug/l	Spike Q ug/l	MS ug/l	MS %	Spike ug/l	MSD ug/l	MSD %	RPD	Limits Rec/RPD
71-43-2	Benzene	3.0	25	32.7	119	25	31.4	114	4	81-122/14
108-20-3	Di-Isopropyl Ether	ND	25	27.5	110	25	27.7	111	1	68-123/16
100-41-4	Ethylbenzene	1.2	25	29.2	112	25	27.5	105	6	81-121/14
637-92-3	Ethyl Tert Butyl Ether	ND	25	23.4	94	25	23.4	94	0	71-120/14
1634-04-4	Methyl Tert Butyl Ether	0.63	J 25	23.5	91	25	24.6	96	5	72-117/14
994-05-8	Tert-Amyl Methyl Ether	ND	25	23.6	94	25	23.1	92	2	73-122/13
75-65-0	Tert-Butyl Alcohol	ND	250	352	141*	250	359	144*	2	63-129/27
108-88-3	Toluene	1.1	25	28.6	110	25	27.4	105	4	80-120/14
1330-20-7	Xylene (total)	6.2	75	90.4	112	75	85.0	105	6	80-126/15

CAS No.	Surrogate Recoveries	MS	MSD	FA37016-1	Limits
1868-53-7	Dibromofluoromethane	101%	97%	96%	83-118%
17060-07-0	1,2-Dichloroethane-D4	91%	89%	90%	79-125%
2037-26-5	Toluene-D8	98%	97%	109%	85-112%
460-00-4	4-Bromofluorobenzene	95%	97%	101%	83-118%

* = Outside of Control Limits.

GC Volatiles

QC Data Summaries

Includes the following where applicable:

- Method Blank Summaries
- Blank Spike Summaries
- Matrix Spike and Duplicate Summaries

Method Blank Summary

Job Number: FA36765
Account: QSMCAF Quick Stop Markets
Project: T10000008568-CCCAD:Quik Stop 51; Oakland, CA

Sample	File ID	DF	Analyzed	By	Prep Date	Prep Batch	Analytical Batch
GCD5827-MB	CD139935.D	1	09/12/16	EG	n/a	n/a	GCD5827

The QC reported here applies to the following samples:

Method: SW846 8015C

FA36765-1, FA36765-2

CAS No.	Compound	Result	RL	MDL	Units	Q
	TPH-GRO (C6-C10)	ND	0.10	0.050	mg/l	

CAS No.	Surrogate Recoveries	Limits	
460-00-4	4-Bromofluorobenzene	89%	70-131%
98-08-8	aaa-Trifluorotoluene	78%	69-143%

Blank Spike Summary

Job Number: FA36765
Account: QSMCAF Quick Stop Markets
Project: T10000008568-CCCAD:Quik Stop 51; Oakland, CA

Sample	File ID	DF	Analyzed	By	Prep Date	Prep Batch	Analytical Batch
GCD5827-BS	CD139934.D	1	09/12/16	EG	n/a	n/a	GCD5827

The QC reported here applies to the following samples:

Method: SW846 8015C

FA36765-1, FA36765-2

CAS No.	Compound	Spike mg/l	BSP mg/l	BSP %	Limits
	TPH-GRO (C6-C10)	0.4	0.381	95	75-138

CAS No.	Surrogate Recoveries	BSP	Limits
460-00-4	4-Bromofluorobenzene	92%	70-131%
98-08-8	aaa-Trifluorotoluene	96%	69-143%

* = Outside of Control Limits.

Matrix Spike/Matrix Spike Duplicate Summary

Job Number: FA36765

Account: QSMCAF Quick Stop Markets

Project: T10000008568-CCCAD:Quik Stop 51; Oakland, CA

Sample	File ID	DF	Analyzed	By	Prep Date	Prep Batch	Analytical Batch
FA36752-1MS	CD139942.D	1	09/12/16	EG	n/a	n/a	GCD5827
FA36752-1MSD	CD139943.D	1	09/12/16	EG	n/a	n/a	GCD5827
FA36752-1 ^a	CD139938.D	1	09/12/16	EG	n/a	n/a	GCD5827

The QC reported here applies to the following samples:

Method: SW846 8015C

FA36765-1, FA36765-2

CAS No.	Compound	FA36752-1 mg/l	Spike Q mg/l	MS mg/l	MS %	Spike mg/l	MSD mg/l	MSD %	RPD	Limits Rec/RPD
	TPH-GRO (C6-C10)	ND	0.4	0.414	104	0.4	0.402	101	3	75-138/13

CAS No.	Surrogate Recoveries	MS	MSD	FA36752-1	Limits
460-00-4	4-Bromofluorobenzene	92%	93%	87%	70-131%
98-08-8	aaa-Trifluorotoluene	96%	96%	78%	69-143%

(a) Sample vial(s) contained significant headspace; reported results are considered minimum values.

* = Outside of Control Limits.

GC Semi-volatiles

QC Data Summaries

Includes the following where applicable:

- Method Blank Summaries
- Blank Spike Summaries
- Matrix Spike and Duplicate Summaries

Method Blank Summary

Job Number: FA36765
Account: QSMCAF Quick Stop Markets
Project: T10000008568-CCCAD:Quik Stop 51; Oakland, CA

Sample	File ID	DF	Analyzed	By	Prep Date	Prep Batch	Analytical Batch
OP61831-MB	WR12658.D	1	09/13/16	SJL	09/12/16	OP61831	GWR489

The QC reported here applies to the following samples:

Method: SW846 8015C

FA36765-2

CAS No.	Compound	Result	RL	MDL	Units	Q
	TPH (C10-C28)	ND	0.050	0.020	mg/l	

CAS No.	Surrogate Recoveries	Limits
84-15-1	o-Terphenyl	107% 50-131%

7.1.1
7

Blank Spike Summary

Job Number: FA36765
Account: QSMCAF Quick Stop Markets
Project: T10000008568-CCCAD:Quik Stop 51; Oakland, CA

Sample	File ID	DF	Analyzed	By	Prep Date	Prep Batch	Analytical Batch
OP61831-BS ^a	WR12657.D	1	09/13/16	SJL	09/12/16	OP61831	GWR489

The QC reported here applies to the following samples:

Method: SW846 8015C

FA36765-2

CAS No.	Compound	Spike mg/l	BSP mg/l	BSP %	Limits
	TPH (C10-C28)	1	1.00	100	60-128

CAS No.	Surrogate Recoveries	BSP	Limits
84-15-1	o-Terphenyl	106%	50-131%

(a) Insufficient sample for MS/MSD.

* = Outside of Control Limits.

7.2.1
 7

Technical Report for

Compliance & Closure, Inc.

Quik Stop 51; Oakland, CA

12216-2

SGS Accutest Job Number: FA37200

Sampling Date: 09/23/16

Report to:

Compliance & Closure, Inc
4115 BlackHawk Plaza Circle Suite 100
Danville, CA 94506
gary@cci-envr.com

ATTN: Gary Mulkey

Total number of pages in report: **25**



Test results contained within this data package meet the requirements of the National Environmental Laboratory Accreditation Program and/or state specific certification programs as applicable.

Norm Farmer
Technical Director

Client Service contact: Elvin Kumar 407-425-6700

Certifications: FL (E83510), LA (03051), KS (E-10327), IA (366), IL (200063), NC (573), NJ (FL002), SC (96038001)
DoD ELAP (L-A-B L2229), CA (2937), TX (T104704404), PA (68-03573), VA (460177),
AK, AR, GA, KY, MA, NV, OK, UT, WA

This report shall not be reproduced, except in its entirety, without the written approval of SGS Accutest.
Test results relate only to samples analyzed.

Table of Contents

-1-

Section 1: Sample Summary	3
Section 2: Summary of Hits	4
Section 3: Sample Results	5
3.1: FA37200-1: MW-5 (EXXON)	6
Section 4: Misc. Forms	9
4.1: Certification Exceptions	10
4.2: Chain of Custody	11
Section 5: GC/MS Volatiles - QC Data Summaries	14
5.1: Method Blank Summary	15
5.2: Blank Spike Summary	16
5.3: Matrix Spike/Matrix Spike Duplicate Summary	17
Section 6: GC Volatiles - QC Data Summaries	18
6.1: Method Blank Summary	19
6.2: Blank Spike Summary	20
6.3: Matrix Spike/Matrix Spike Duplicate Summary	21
Section 7: GC Semi-volatiles - QC Data Summaries	22
7.1: Method Blank Summary	23
7.2: Blank Spike Summary	24
7.3: Matrix Spike/Matrix Spike Duplicate Summary	25

1

2

3

4

5

6

7



Sample Summary

Compliance & Closure, Inc.

Job No: FA37200

Quik Stop 51; Oakland, CA
Project No: 12216-2

Sample Number	Collected		Matrix			Client Sample ID
	Date	Time By	Received	Code	Type	
FA37200-1	09/23/16	09:15 GM	09/24/16	AQ	Water	MW-5 (EXXON)

Summary of Hits

Job Number: FA37200
Account: Compliance & Closure, Inc.
Project: Quik Stop 51; Oakland, CA
Collected: 09/23/16

Lab Sample ID	Client Sample ID	Result/ Qual	RL	MDL	Units	Method
---------------	------------------	-----------------	----	-----	-------	--------

FA37200-1 **MW-5 (EXXON)**

Benzene		1730	25	5.1	ug/l	SW846 8260B
Toluene		38.6	25	5.0	ug/l	SW846 8260B
Ethylbenzene		288	25	6.3	ug/l	SW846 8260B
Xylene (total)		26.0 J	75	14	ug/l	SW846 8260B
Methyl Tert Butyl Ether		163	25	5.0	ug/l	SW846 8260B
Tert-Butyl Alcohol ^a		7130	500	230	ug/l	SW846 8260B
TPH-GRO (C6-C10)		7.25	2.0	1.0	mg/l	SW846 8015C
TPH (C10-C28) ^b		0.773	0.24	0.095	mg/l	SW846 8015C

(a) Associated BS recovery outside control limits.

(b) Petroleum hydrocarbon pattern begins before C10.

Sample Results

Report of Analysis

Report of Analysis

Client Sample ID: MW-5 (EXXON)	
Lab Sample ID: FA37200-1	Date Sampled: 09/23/16
Matrix: AQ - Water	Date Received: 09/24/16
Method: SW846 8260B	Percent Solids: n/a
Project: Quik Stop 51; Oakland, CA	

	File ID	DF	Analyzed	By	Prep Date	Prep Batch	Analytical Batch
Run #1	J0979954.D	25	10/04/16	DP	n/a	n/a	VJ5451
Run #2							

	Purge Volume
Run #1	5.0 ml
Run #2	

BTEX, Oxygenates

CAS No.	Compound	Result	RL	MDL	Units	Q
71-43-2	Benzene	1730	25	5.1	ug/l	
108-88-3	Toluene	38.6	25	5.0	ug/l	
100-41-4	Ethylbenzene	288	25	6.3	ug/l	
1330-20-7	Xylene (total)	26.0	75	14	ug/l	J
108-20-3	Di-Isopropyl Ether	ND	25	5.7	ug/l	
637-92-3	Ethyl Tert Butyl Ether	ND	50	5.5	ug/l	
1634-04-4	Methyl Tert Butyl Ether	163	25	5.0	ug/l	
994-05-8	Tert-Amyl Methyl Ether	ND	50	5.0	ug/l	
75-65-0	Tert-Butyl Alcohol ^a	7130	500	230	ug/l	

CAS No.	Surrogate Recoveries	Run# 1	Run# 2	Limits
1868-53-7	Dibromofluoromethane	93%		83-118%
17060-07-0	1,2-Dichloroethane-D4	92%		79-125%
2037-26-5	Toluene-D8	106%		85-112%
460-00-4	4-Bromofluorobenzene	91%		83-118%

(a) Associated BS recovery outside control limits.

ND = Not detected MDL = Method Detection Limit J = Indicates an estimated value
 RL = Reporting Limit B = Indicates analyte found in associated method blank
 E = Indicates value exceeds calibration range N = Indicates presumptive evidence of a compound

Report of Analysis

3.1
3

Client Sample ID: MW-5 (EXXON)	Date Sampled: 09/23/16
Lab Sample ID: FA37200-1	Date Received: 09/24/16
Matrix: AQ - Water	Percent Solids: n/a
Method: SW846 8015C	
Project: Quik Stop 51; Oakland, CA	

Run #	File ID	DF	Analyzed	By	Prep Date	Prep Batch	Analytical Batch
Run #1	CD140133.D	20	09/27/16	EG	n/a	n/a	GCD5836
Run #2							

Run #	Purge Volume
Run #1	5.0 ml
Run #2	

CAS No.	Compound	Result	RL	MDL	Units	Q
	TPH-GRO (C6-C10)	7.25	2.0	1.0	mg/l	
CAS No.	Surrogate Recoveries	Run# 1	Run# 2	Limits		
460-00-4	4-Bromofluorobenzene	103%		70-131%		
98-08-8	aaa-Trifluorotoluene	97%		69-143%		

ND = Not detected	MDL = Method Detection Limit	J = Indicates an estimated value
RL = Reporting Limit		B = Indicates analyte found in associated method blank
E = Indicates value exceeds calibration range		N = Indicates presumptive evidence of a compound

Report of Analysis

3.1
3

Client Sample ID: MW-5 (EXXON)	Date Sampled: 09/23/16
Lab Sample ID: FA37200-1	Date Received: 09/24/16
Matrix: AQ - Water	Percent Solids: n/a
Method: SW846 8015C SW846 3510C	
Project: Quik Stop 51; Oakland, CA	

	File ID	DF	Analyzed	By	Prep Date	Prep Batch	Analytical Batch
Run #1	WR13170.D	5	10/09/16	SJL	09/28/16	OP62027	GWR513
Run #2							

	Initial Volume	Final Volume
Run #1	1050 ml	1.0 ml
Run #2		

CAS No.	Compound	Result	RL	MDL	Units	Q
	TPH (C10-C28) ^a	0.773	0.24	0.095	mg/l	
CAS No.	Surrogate Recoveries	Run# 1	Run# 2	Limits		
84-15-1	o-Terphenyl	86%		50-131%		

(a) Petroleum hydrocarbon pattern begins before C10.

ND = Not detected	MDL = Method Detection Limit	J = Indicates an estimated value
RL = Reporting Limit		B = Indicates analyte found in associated method blank
E = Indicates value exceeds calibration range		N = Indicates presumptive evidence of a compound

Misc. Forms

Custody Documents and Other Forms

Includes the following where applicable:

- Certification Exceptions
- Chain of Custody

Parameter Certification Exceptions

Job Number: FA37200

Account: CCCAD Compliance & Closure, Inc.

Project: Quik Stop 51; Oakland, CA

The following parameters included in this report are exceptions to NELAC certification.
The certification status of each is indicated below.

Parameter	CAS#	Method	Mat	Certification Status
Di-Isopropyl Ether	108-20-3	SW846 8260B	AQ	Certified by SOP MS005

4.1
4



Compliance
&
Closure, Inc.

CADS 40

FA 37200

CHAIN OF CUSTODY RECORD AND ANALYSIS REQUEST

PROJECT NO. 12216-2		PROJECT NAME/SITE Quik stop #51 Oakland, CA						ANALYSIS REQUESTED										P.O. #:
SAMPLERS Gary R. Mulkey (SIGN)		(PRINT) Gary R. Mulkey						NO. CONTAINERS										REMARKS
SAMPLE IDENTIFICATION		DATE	TIME	COMP	GRAB	PRES. USED	ICED	NO. CONTAINERS	SAMPLE TYPE	BTEX (002/0020)	TPH _g (0015)	TPH _h (0015)	TOC 418 (0015)	001/0010	024/0240	025/0270	026/0270	REMARKS
① MW-5 (K2200)		9/23/16	9:15		X	N	X	5	3	X	X	X						Get TPHs from GCMS
																		Prepare EDF Global ID #
RELINQUISHED BY: Gary R. Mulkey		DATE 9/23/16	TIME 10:45	RECEIVED BY: Ali Zeigarni		LABORATORY: SGS Accutest Laboratories SAN JOSE, CA										PLEASE SEND RESULTS TO: Compliance & Closure, Inc. 4115 Blackhawk Plaza Circle Suite 100 Danville, CA 94506 (925) 648-2008 Fax (925) 292-4565 gary@cci-envr.com		
RELINQUISHED BY: Ali Zeigarni		DATE 9/23/16	TIME 15:00	RECEIVED BY: Fedea		REQUESTED TURNAROUND TIME: Standard										PROJECT MANAGER: Attn: Mr. Gary Mulkey		
RELINQUISHED BY: Fedea		DATE 9-24-16	TIME 10:30	RECEIVED BY: J. Cornell (A/SE)		RECEIVED BY LABORATORY:												
RELINQUISHED BY:		DATE:	TIME:	RECEIVED BY LABORATORY:		RECEIPT CONDITION:												

3-2

4.2
4

SGS ACCUTEST - ORLANDO SAMPLE RECEIPT CONFIRMATION

SGS ACCUTEST'S JOB NUMBER: FA37200 CLIENT: COMPLIANCE PROJECT: QUICK STOP
DATE/TIME RECEIVED: 9-24-16 10:30 {MM/DD/YY 24:00} NUMBER OF COOLERS RECEIVED: 1
METHOD OF DELIVERY: FEDEX UPS ACCUTEST COURIER DELIVERY OTHER:
AIRBILL NUMBERS: 7773 0602 4806

COOLER INFORMATION

- CUSTODY SEAL NOT PRESENT OR NOT INTACT
- CHAIN OF CUSTODY NOT RECEIVED (COC)
- ANALYSIS REQUESTED IS UNCLEAR OR MISSING
- SAMPLE DATES OR TIMES UNCLEAR OR MISSING
- TEMPERATURE CRITERIA NOT MET

TRIP BLANK INFORMATION

- TRIP BLANK PROVIDED
- TRIP BLANK NOT PROVIDED
- TRIP BLANK NOT ON COC
- TRIP BLANK INTACT
- TRIP BLANK NOT INTACT
- RECEIVED WATER TRIP BLANK
- RECEIVED SOIL TRIP BLANK

MISC. INFORMATION

NUMBER OF ENCORES? 25-GRAM 5-GRAM
NUMBER OF 5035 FIELD KITS?
NUMBER OF LAB FILTERED METALS?

TEST STRIP LOT#s pH 0-3 230315 pH 10-12 219813A OTHER (specify)
SUMMARY OF COMMENTS:

TEMPERATURE INFORMATION

IR THERM ID 1 CORR. FACTOR -0.4
OBSERVED TEMPS: 3.6
CORRECTED TEMPS: 3.2 (USED FOR LIMS)

SAMPLE INFORMATION

- INCORRECT NUMBER OF CONTAINERS USED
- SAMPLE RECEIVED IMPROPERLY PRESERVED
- INSUFFICIENT VOLUME FOR ANALYSIS
- DATES/TIMES ON COC DO NOT MATCH SAMPLE LABEL
- ID'S ON COC DO NOT MATCH LABEL
- VOC VIALS HAVE HEADSPACE (MACRO BUBBLES)
- BOTTLES RECEIVED BUT ANALYSIS NOT REQUESTED
- NO BOTTLES RECEIVED FOR ANALYSIS REQUESTED
- UNCLEAR FILTERING OR COMPOSITING INSTRUCTIONS
- SAMPLE CONTAINER(S) RECEIVED BROKEN
- 5035 FIELD KITS NOT RECEIVED WITHIN 48 HOURS
- BULK VOA SOIL JARS NOT RECEIVED WITHIN 48 HOURS
- % SOLIDS JAR NOT RECEIVED
- RESIDUAL CHLORINE PRESENT LOT#

(APPLICABLE TO EPA 600 SERIES OR NORTH CAROLINA ORGANICS)

TECHNICIAN SIGNATURE/DATE e 9-24-16 REVIEWER SIGNATURE/DATE KD 9-24-16

NF 02/16

receipt confirmation 020116.xls

FA37200: Chain of Custody

Page 2 of 3

1 of 2
TRK# 7773 0602 4806
0201
MASTER ##
XO TIXA

SA
PRIC
RT 966
ST 23.2
JS MCO
5 12.00
45
09/21
dT
2811

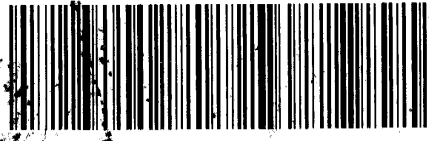

GC/MS Volatiles

QC Data Summaries

Includes the following where applicable:

- Method Blank Summaries
- Blank Spike Summaries
- Matrix Spike and Duplicate Summaries

Method Blank Summary

Job Number: FA37200
Account: CCCAD Compliance & Closure, Inc.
Project: Quik Stop 51; Oakland, CA

Sample	File ID	DF	Analyzed	By	Prep Date	Prep Batch	Analytical Batch
VJ5451-MB	J0979938.D	1	10/04/16	DP	n/a	n/a	VJ5451

The QC reported here applies to the following samples:

Method: SW846 8260B

FA37200-1

CAS No.	Compound	Result	RL	MDL	Units	Q
71-43-2	Benzene	ND	1.0	0.20	ug/l	
108-20-3	Di-Isopropyl Ether	ND	1.0	0.23	ug/l	
100-41-4	Ethylbenzene	ND	1.0	0.25	ug/l	
637-92-3	Ethyl Tert Butyl Ether	ND	2.0	0.22	ug/l	
1634-04-4	Methyl Tert Butyl Ether	ND	1.0	0.20	ug/l	
994-05-8	Tert-Amyl Methyl Ether	ND	2.0	0.20	ug/l	
75-65-0	Tert-Butyl Alcohol	ND	20	9.1	ug/l	
108-88-3	Toluene	ND	1.0	0.20	ug/l	
1330-20-7	Xylene (total)	ND	3.0	0.56	ug/l	

CAS No.	Surrogate Recoveries	Limits	
1868-53-7	Dibromofluoromethane	96%	83-118%
17060-07-0	1,2-Dichloroethane-D4	96%	79-125%
2037-26-5	Toluene-D8	107%	85-112%
460-00-4	4-Bromofluorobenzene	98%	83-118%

CAS No.	Tentatively Identified Compounds	R. T.	Est. Conc.	Units	Q
124-38-9	Carbon dioxide	2.38	2700	ug/l	JN
75-09-2	Methylene Chloride	5.03	140	ug/l	JN
	Total TIC, Volatile		140	ug/l	J

Blank Spike Summary

Job Number: FA37200
Account: CCCAD Compliance & Closure, Inc.
Project: Quik Stop 51; Oakland, CA

Sample	File ID	DF	Analyzed	By	Prep Date	Prep Batch	Analytical Batch
VJ5451-BS	J0979937.D	1	10/04/16	DP	n/a	n/a	VJ5451

The QC reported here applies to the following samples:

Method: SW846 8260B

FA37200-1

CAS No.	Compound	Spike ug/l	BSP ug/l	BSP %	Limits
71-43-2	Benzene	25	28.3	113	81-122
108-20-3	Di-Isopropyl Ether	25	28.2	113	68-123
100-41-4	Ethylbenzene	25	28.8	115	81-121
637-92-3	Ethyl Tert Butyl Ether	25	24.8	99	71-120
1634-04-4	Methyl Tert Butyl Ether	25	27.7	111	72-117
994-05-8	Tert-Amyl Methyl Ether	25	24.5	98	73-122
75-65-0	Tert-Butyl Alcohol	250	333	133*	63-129
108-88-3	Toluene	25	28.6	114	80-120
1330-20-7	Xylene (total)	75	87.2	116	80-126

CAS No.	Surrogate Recoveries	BSP	Limits
1868-53-7	Dibromofluoromethane	97%	83-118%
17060-07-0	1,2-Dichloroethane-D4	97%	79-125%
2037-26-5	Toluene-D8	103%	85-112%
460-00-4	4-Bromofluorobenzene	99%	83-118%

* = Outside of Control Limits.

5.2.1
 5

Matrix Spike/Matrix Spike Duplicate Summary

Job Number: FA37200
Account: CCCAD Compliance & Closure, Inc.
Project: Quik Stop 51; Oakland, CA

Sample	File ID	DF	Analyzed	By	Prep Date	Prep Batch	Analytical Batch
FA37217-1MS	J0979958.D	1	10/04/16	DP	n/a	n/a	VJ5451
FA37217-1MSD	J0979959.D	1	10/04/16	DP	n/a	n/a	VJ5451
FA37217-1	J0979941.D	1	10/04/16	DP	n/a	n/a	VJ5451

The QC reported here applies to the following samples:

Method: SW846 8260B

FA37200-1

CAS No.	Compound	FA37217-1 ug/l	Spike Q ug/l	MS ug/l	MS %	Spike ug/l	MSD ug/l	MSD %	RPD	Limits Rec/RPD
71-43-2	Benzene	ND	25	27.2	109	25	26.9	108	1	81-122/14
108-20-3	Di-Isopropyl Ether	ND	25	25.8	103	25	26.3	105	2	68-123/16
100-41-4	Ethylbenzene	ND	25	26.5	106	25	26.7	107	1	81-121/14
637-92-3	Ethyl Tert Butyl Ether	ND	25	23.4	94	25	23.7	95	1	71-120/14
1634-04-4	Methyl Tert Butyl Ether	ND	25	24.0	96	25	24.3	97	1	72-117/14
994-05-8	Tert-Amyl Methyl Ether	ND	25	23.2	93	25	24.3	97	5	73-122/13
75-65-0	Tert-Butyl Alcohol	ND	250	840	336*	250	441	176*	62*	63-129/27
108-88-3	Toluene	ND	25	25.9	104	25	26.3	105	2	80-120/14
1330-20-7	Xylene (total)	ND	75	78.7	105	75	77.8	104	1	80-126/15

CAS No.	Surrogate Recoveries	MS	MSD	FA37217-1	Limits
1868-53-7	Dibromofluoromethane	94%	97%	97%	83-118%
17060-07-0	1,2-Dichloroethane-D4	91%	93%	92%	79-125%
2037-26-5	Toluene-D8	96%	100%	106%	85-112%
460-00-4	4-Bromofluorobenzene	88%	97%	97%	83-118%

* = Outside of Control Limits.

GC Volatiles

QC Data Summaries

Includes the following where applicable:

- Method Blank Summaries
- Blank Spike Summaries
- Matrix Spike and Duplicate Summaries

Method Blank Summary

Job Number: FA37200
Account: CCCAD Compliance & Closure, Inc.
Project: Quik Stop 51; Oakland, CA

Sample	File ID	DF	Analyzed	By	Prep Date	Prep Batch	Analytical Batch
GCD5836-MB	CD140120.D	1	09/27/16	EG	n/a	n/a	GCD5836

The QC reported here applies to the following samples:

Method: SW846 8015C

FA37200-1

CAS No.	Compound	Result	RL	MDL	Units	Q
	TPH-GRO (C6-C10)	ND	0.10	0.050	mg/l	

CAS No.	Surrogate Recoveries	Limits	
460-00-4	4-Bromofluorobenzene	103%	70-131%
98-08-8	aaa-Trifluorotoluene	86%	69-143%

6.1.1
6

Blank Spike Summary

Job Number: FA37200
Account: CCCAD Compliance & Closure, Inc.
Project: Quik Stop 51; Oakland, CA

Sample	File ID	DF	Analyzed	By	Prep Date	Prep Batch	Analytical Batch
GCD5836-BS	CD140119.D	1	09/27/16	EG	n/a	n/a	GCD5836

The QC reported here applies to the following samples:

Method: SW846 8015C

FA37200-1

CAS No.	Compound	Spike mg/l	BSP mg/l	BSP %	Limits
	TPH-GRO (C6-C10)	0.4	0.342	86	75-138

CAS No.	Surrogate Recoveries	BSP	Limits
460-00-4	4-Bromofluorobenzene	106%	70-131%
98-08-8	aaa-Trifluorotoluene	103%	69-143%

* = Outside of Control Limits.

Matrix Spike/Matrix Spike Duplicate Summary

Job Number: FA37200
Account: CCCAD Compliance & Closure, Inc.
Project: Quik Stop 51; Oakland, CA

Sample	File ID	DF	Analyzed	By	Prep Date	Prep Batch	Analytical Batch
FA37169-1MS	CD140127.D	10	09/27/16	EG	n/a	n/a	GCD5836
FA37169-1MSD	CD140128.D	10	09/27/16	EG	n/a	n/a	GCD5836
FA37169-1	CD140126.D	10	09/27/16	EG	n/a	n/a	GCD5836

The QC reported here applies to the following samples:

Method: SW846 8015C

FA37200-1

CAS No.	Compound	FA37169-1 mg/l	Spike Q mg/l	MS mg/l	MS %	Spike mg/l	MSD mg/l	MSD %	RPD	Limits Rec/RPD
	TPH-GRO (C6-C10)	2.10	4	5.15	76	4	5.16	77	0	75-138/13

CAS No.	Surrogate Recoveries	MS	MSD	FA37169-1	Limits
460-00-4	4-Bromofluorobenzene	106%	105%	104%	70-131%
98-08-8	aaa-Trifluorotoluene	130%	132%	119%	69-143%

* = Outside of Control Limits.

GC Semi-volatiles

QC Data Summaries

Includes the following where applicable:

- Method Blank Summaries
- Blank Spike Summaries
- Matrix Spike and Duplicate Summaries

Method Blank Summary

Job Number: FA37200
Account: CCCAD Compliance & Closure, Inc.
Project: Quik Stop 51; Oakland, CA

Sample	File ID	DF	Analyzed	By	Prep Date	Prep Batch	Analytical Batch
OP62027-MB	WR13167.D	1	10/09/16	SJL	09/28/16	OP62027	GWR513

The QC reported here applies to the following samples:

Method: SW846 8015C

FA37200-1

CAS No.	Compound	Result	RL	MDL	Units	Q
	TPH (C10-C28)	ND	0.050	0.020	mg/l	

CAS No.	Surrogate Recoveries	Limits
84-15-1	o-Terphenyl	127% 50-131%

7.1.1
7

Blank Spike Summary

Job Number: FA37200
Account: CCCAD Compliance & Closure, Inc.
Project: Quik Stop 51; Oakland, CA

Sample	File ID	DF	Analyzed	By	Prep Date	Prep Batch	Analytical Batch
OP62027-BS	WR13166.D	1	10/09/16	SJL	09/28/16	OP62027	GWR513

The QC reported here applies to the following samples:

Method: SW846 8015C

FA37200-1

CAS No.	Compound	Spike mg/l	BSP mg/l	BSP %	Limits
	TPH (C10-C28)	1	0.764	76	60-128

CAS No.	Surrogate Recoveries	BSP	Limits
84-15-1	o-Terphenyl	75%	50-131%

* = Outside of Control Limits.

Matrix Spike/Matrix Spike Duplicate Summary

Job Number: FA37200
Account: CCCAD Compliance & Closure, Inc.
Project: Quik Stop 51; Oakland, CA

Sample	File ID	DF	Analyzed	By	Prep Date	Prep Batch	Analytical Batch
OP62027-MS	WR13171.D	5	10/09/16	SJL	09/28/16	OP62027	GWR513
OP62027-MSD	WR13172.D	5	10/09/16	SJL	09/28/16	OP62027	GWR513
FA37200-1	WR13170.D	5	10/09/16	SJL	09/28/16	OP62027	GWR513

The QC reported here applies to the following samples:

Method: SW846 8015C

FA37200-1

CAS No.	Compound	FA37200-1 mg/l	Spike Q mg/l	MS mg/l	MS %	Spike mg/l	MSD mg/l	MSD %	RPD	Limits Rec/RPD
	TPH (C10-C28)	0.773	1.92	2.32	80	1.92	2.41	85	4	60-128/33

CAS No.	Surrogate Recoveries	MS	MSD	FA37200-1	Limits
84-15-1	o-Terphenyl	89%	93%	86%	50-131%

* = Outside of Control Limits.

Field logs

CCI Proj # 12716-2

COMPLIANCE & CLOSURE, INC.

Split from
Blaine Tech. Services

Well ID.: MW-5

Date: Sept 7 2016

Pump Type: Hydrostatic
Dedicated/Portable (circle one)

Chain of Custody Doc. #: _____

Depth of casing: 28.36'

Casing Diameter: 2"

Depth of water: 17.10'
Time of level: 0810

Volume Factor: N/A

Water in Casing (ft): _____

Gallons / Casing Vol.: Maximum Range N/A

Time Pump on: replace 0910
w/new

Initial Flow Rate
Q = gpm: 10/5

Time Pump Off: replace 0910

Meas. by grad. cylinder-bucket
flow meter-other: N/A

Time	Q	Gal. Removed	pH	Temp (°C)	SC	DO	ORP
0955	N/A		6.32	71.1	0.29	1337	34
		NoPurge					

H₂O Level at time of sampling : _____

	Rep. 1	Rep. 2	Rep. 3
Final pH			
Final T °C			
Final S C			

pH meter Ser. # _____ Calib.: Yes / No
SC meter Ser. # _____ Calib.: Yes / No
H₂O lev. Ser. # _____

Calibrated prior to sample

Sample I.D.: MW-5

Time Collected: 0922

Requested Analyses: See Col

Sample Container (Size/Preserv.): 4 VOA 40 mL
partial 11 40 mL 70% full

Comments: _____

Signature: CMPalme

CCI Prod # 12276-2

COMPLIANCE & CLOSURE, INC.

Blaine Tech Spill
Jeremy Dick

Well ID.: MW-10R

Date: Sept. 7 2016

Pump Type: HydroSlove
Dedicated/Portable (circle one)

Chain of Custody Doc. #: _____

Depth of casing: 22.91'

Casing Diameter: 2"

Depth of water: 18.43'
Time of level: 0824

Volume Factor: N/A

Water in Casing (ft): _____

Gallons / Casing Vol.: N/A

Time Pump on: 0939
Run on HydroSlove
New

Initial Flow Rate
Q = gpm: N/A

Time Pump Off: Replenish Well

Meas. by grad. cylinder-bucket
flow meter-other: N/A

Time	Q	Gal. Removed	pH	DO	Temp ^F	SC ^{mg/L}	Turbidity	ORP DTW
0940	N/A	1	6.93	0.24	72.1	1696	999	-113
		NO PURGE						

H₂O Level at time of sampling :

	Rep. 1	Rep. 2	Rep. 3
Final pH			
Final T °C			
Final S C			

pH meter Ser. # _____ Calib.: Yes / No
SC meter Ser. # _____ Calib.: Yes / No
H₂O lev. Ser. # _____

Sample I.D.: MW-10R

Time Collected: 0944

Requested Analyses: _____

Sample Container (Size/Preserv.): 4 VOA 40ml
no 1 liter 1034A

Comments: See CoC

Signature: [Signature]

COMPLIANCE & CLOSURE, INC.

CCI #
12216-2

Well ID.: MW-5 (EXXON)

Date: 9/23/16

Pump Type: _____
Dedicated/Portable (circle one)

Chain of Custody Doc. #: _____

Depth of casing: 29.30

Casing Diameter: 2"

Depth of water: 15.82
Time of level: 8:30

Volume Factor: 0.163 gal/ft

Water in Casing (ft): 13.48

Gallons / Casing Vol.: 2.19 ~~ft~~ x 3
= 6.57 gal

Time Pump on: _____

Initial Flow Rate
Q = gpm: _____

Time Pump Off: _____

Meas. by grad. cylinder-bucket
flow meter-other: _____

Time	Q	Gal. Removed	pH	Temp °F	SC	D.O.	DPW
8:35	2		7.1	67.39	1436	1.85 mg/l	-135
8:50	2		7.1	67.03	1472	1.82 mg/l	-159
9:10	3		7.1	66.96	1487	1.79 mg/l	-161

TOTAL = 7 → slightly cloudy, moderate product odor

clear to very slightly cloudy, mod product odor

H₂O Level at time of sampling :

	Rep. 1	Rep. 2	Rep. 3
Final pH			
Final T °C			
Final S C			

pH meter Ser. # 752-556 Calib.: Yes / No

SC meter Ser. # 752-556 Calib.: Yes / No

H₂O lev. Ser. # _____

Sample I.D.: MW-5 (EXXON)

Time Collected: 9:15

Requested Analyses: See chain of custody

Sample Container (Size/Preserv.) _____

Comments: _____

Signature: Henry R. Malby