

Green Oak Builders Inc.
888 Brannan St., Suite 101
San Francisco, CA 94103

Date: 7/6/2015
From: Mona Hsieh
To; Haz. Materials Specialist, Alameda Co. Environmental Health
Subject: 3101 35th St., Oakland, CA RO 3164

Perjury Statement

RECEIVED

By Alameda County Environmental Health 9:29 am, Sep 23, 2015

I declare, under penalty of perjury, that the information and/or recommendations contained in the attached document or report is true and correct to the best of my knowledge.

Mona Hsieh

President

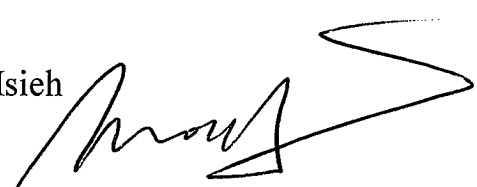

Environmental Restoration Services

Site Investigations * Fuel Tank Closures and Installations * Site Remediation * Regulatory Reporting

Alameda County Health Care Services
Department of Environmental Health
1131 Harbor Bay Parkway, Second Floor
Alameda, CA 94502

July 7, 2015

Attn: Mr. Keith Nowell ; Haz Mat. Specialist for : Green Oaks Builders Inc.
3101 35th St., Oakland Case No. RO-0003164
Re: Revised Report of Interim Remedial Action

1.0 INTRODUCTION

Environmental Restoration Services (ERS) has prepared this Report to describe an Interim Remedial Action (IRA) that removed hydrocarbon impacted soil in the vicinity of underground storage tank (UST) system components (piping to former fuel dispenser locations), discovered during UST removal activities in January of 2015 at the above mentioned site. This report first reviews the known site history and describes the site vicinity. The remedial action scope of this report describes excavation dimensions and excavation extremity soil sampling and analytical analysis. This report further documents impacted soil disposal.

1.1 Site Location

The Property is located on the northern corner of the intersection of 35th Avenue and School Street, in a commercial/residential district of the City of Oakland, Alameda County, California (Figure 1).

1.2. Description of Site Use

The Property consists of a rectangular-shaped parcel of approximately 10,000 square feet in size, which was improved with a one-story gasoline service station building of approximately 2,592 square feet. According to the Property profile, the building was constructed in 1960 and demolished in November of 2014. The subject Property is currently vacant and asphalt and concrete surfaced.

1.3 Background

Based on historical research, a gasoline service station operated at the Property from prior to 1929. In 1960 most recent service station building (recently demolished) was constructed by Texaco Oil, who operated the station to about 1982, when Texaco sold the Property. In later years the building was used for auto parts sales and auto glass. It appears that the main "Texaco" USTs were located on the southern corner of the property (Figure 2) and had previously been removed at an unknown date.

On January 27, 2015, two 350 gallon USTs last containing gasoline and one 350 gallon UST last containing used oil were removed from the property (Figure 2). Analytical results of soil samples recovered from below corroded piping and in the vicinity of former dispenser locations associated with the 350 gallon gasoline USTs, showed levels of Total Petroleum Hydrocarbons as gasoline (TPH/g) at up to 850 milligrams per kilogram (mg/kg).

PO Box 2006 * Menlo Park * California * 94026 * Phone 408/655-9434 * Ben@envirest.com

2.0 SITE DESCRIPTION

2.1 Site Description

The site is located on the corner of 35th Street and School Street (Figure 1). Peralta Creek is located approximately 200 yards to the northwest of the site.

2.2 Vicinity Map

A vicinity map is given in Figure 1, which includes information on adjacent streets.

2.3 Depth to Groundwater

Depth to groundwater at the site, based on a September 2013 depth to water measurement of a monitoring well (MW-6) associated with the neighboring 3055 35th St. LUFT (Former Exxon) site and located approximately 15 feet west of the subject site property line (Figure 2), is 13 to 15 feet below ground surface (bgs.). Groundwater gradient flow direction in the vicinity of the subject site, based on historical groundwater gradient data from the Former Exxon site, has consistently been to the west.

2.4 Soil Profile

The gasoline UST removal excavation sidewalls and bottom show predominately silty, low plasticity clays starting at the surface and extending to approximately two feet bgs.. From approximately two feet bgs. to approximately the excavation bottom sample locations (+/- 10 feet) consisted of clayey sand to sandy clay with some gravels.

2.5 Waste Removal

Two gasoline fuel tanks and one used oil tank have been removed from the site. Approximately 60 cubic yards of TPH impacted soil from the recent UST removal and IRA activities has disposed of off-site.

2.6 Previous Subsurface Investigations

No subsurface investigations have been performed at the site.

3.0 INTERIM REMEDIAL ACTION SCOPE OF WORK

Since shallow hydrocarbon impacted soil exists in the vicinity of UST system former fuel dispenser locations, ERS, on March 23, 2015, removed this impacted soil the same day existing TPH impacted stockpiles (from UST removal activities) were being loaded for disposal.

3.1 Over-Excavation of Former Dispenser Locations

On March 23, 2015 ERS over-excavated the vicinity of the southwestern dispenser island in an attempt to remove the majority of THP/g impacted soil. The this location (Figure 2) was excavated to the approximate dimensions of 6 feet wide by 25 feet long to approximate depth of 6 feet bgs..

From this excavation, approximately 25 cubic yards of non-hazardous petroleum contaminated soil, combined with approximately 25 cubic yards of non-hazardous petroleum contaminated soil from UST removal activities, was transported to Republic Services Newby Island Landfill under Non-Hazardous Waste Manifests and disposed of. Non-Hazardous Waste Manifests are contained in the appendix of this remedial action report.

3.2 Excavation Extremity Soil Sampling

On April 16, 2015, Joel G. Greger, CEG (# EG1633) recovered two soil samples (DispDd6' & DispHd6') from the excavation bottom at approximately 6' bgs., two soil samples (DispBd5' & DispFd5') from the northeast long excavation sidewall (25' long sidewall) at approximately 5' bgs. and 4' bgs., two soil samples (DispEd5' & DispCd5') from the southwest long excavation sidewall (25' long sidewall) at approximately 5', one soil sample (DispAd5') from the northwest short excavation sidewall (6' wide sidewall) at approximately 5' bgs. and one soil sample from southeast the short excavation sidewall (6' wide sidewall) at approximately 5' bgs.. Sample locations are shown in Figure 2.

All excavation soil samples were recovered within two inch diameter by six inch long stainless steel sleeves. Soil from each sample location was recovered using a bullet sampler and a slide hammer. The sample sleeve within the bullet sampler was placed at the sample location and driven into the excavation sidewall until the liner had completely filled. All liners were immediately sealed with Teflon sheet and plastic caps and stored on ice. All samples were transported on ice to McCampbell Analytical Inc. (McCampbell) of Pittsburg, CA, under proper Chain-of-Custody procedures.

3.4 Laboratory Analyses

The following analyses was performed by McCampbell on the samples recovered from the excavation:

EPA 8021B Gasoline Range Organics (GRO), BTEX, MTBE

The results of the soil samples were as follows:

TPH/g results in mg/Kg BTEX & MTBE results in ug/Kg

Sample#	TPH/g	Benzene	Toluene	EthylBenzene	Xylenes	MTBE
Disp.Ad5'	46	ND<50	ND<50	ND<50	69	ND<500
Disp.Bd4'	1.1	ND<5	ND<5	ND<5	ND<50	ND<50
Disp.Cd5'	77	ND<100	ND<100	170	220	ND<1000
Disp.Dd6'	110	ND<50	210	870	160	ND<500
Disp.Ed5'	21	ND<5	31	12	160	ND<50
Disp.Fd5'	68	ND<5	ND<5	ND<5	35	ND<50
Disp.Gd5'	ND< 1.0	ND<5	ND<5	ND<5	ND<5	ND<50
Disp.Hd6'	68	ND<50	340	ND<50	93	ND<500

Respectfully submitted this 7th day of July, 2015.

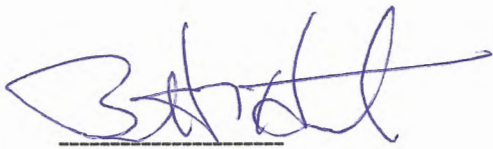

Bennett T Halsted
Project Manager



Samuel H Halsted P.E.
CE 14095

FIGURES

SITE →



VICINITY MAP

3101 35th Street, Oakland, CA

SCALE 1"=2200'

FIGURE 1

Environmental Restoration Services

PO Box 2006, Menlo Park, CA 94026

**VACANT SITE
CONCRETE and
ASPHALT
PAVED**

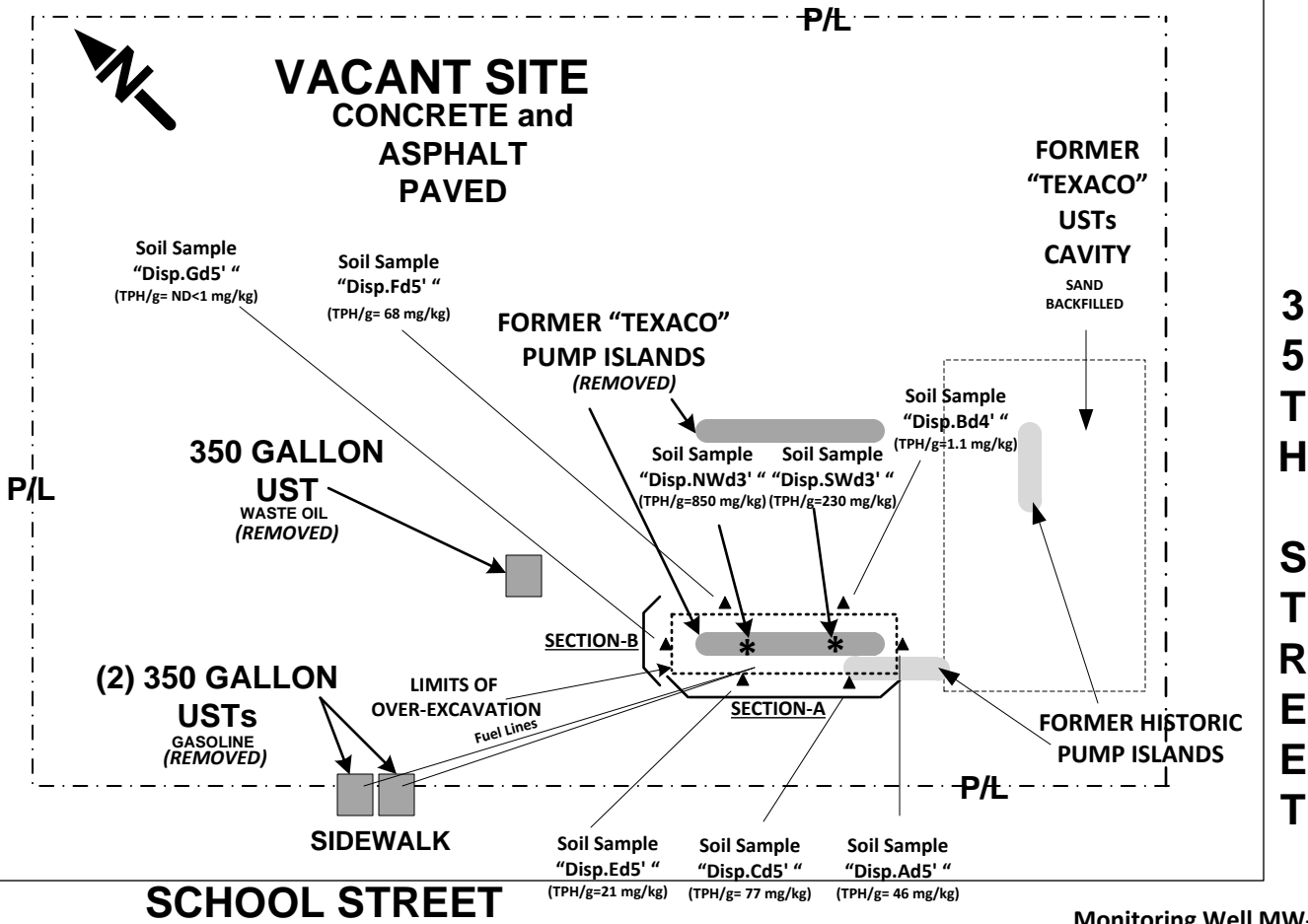

35TH STREET

SCHOOL STREET

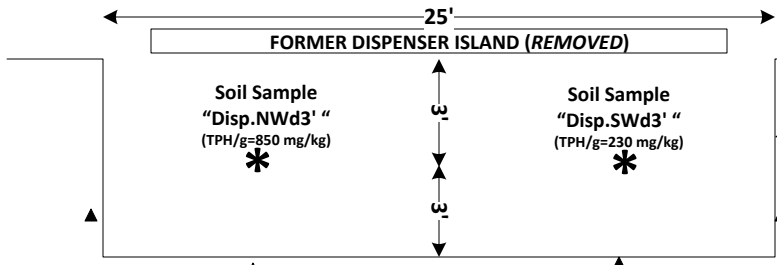

**SECTION-A
SCALE AS SHOWN**

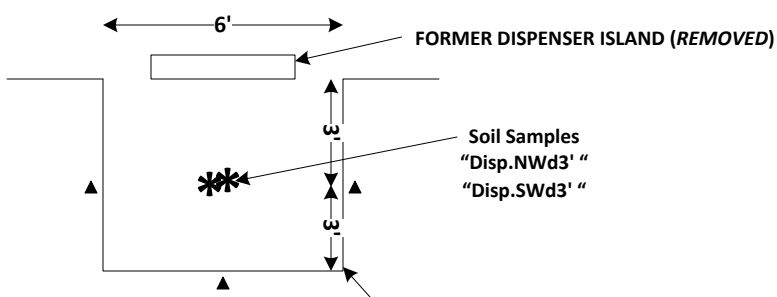

**SECTION-B
SCALE AS SHOWN**

- * 1-27-15 DISPENSER SOIL SAMPLE LOCATION
- ▲ 4-16-15 EXTREMITY SOIL SAMPLE LOCATION

SITE PLAN
3101 35th STREET OAKLAND
4/27/15
SCALE: 1" = 20'
FIGURE 2
ENVIRONMENTAL RESTORATION SERVICES
PO BOX 2006 MENLO PARK CA 94026 (408) 655 9434

SOIL DISPOSAL MANIFESTS



NON-HAZARDOUS SPECIAL WASTE & ASBESTOS MANIFEST

2285120

If waste is asbestos waste, complete Sections I, II, III and IV
 If waste is **NOT** asbestos waste, complete Sections I, II and III

GENERATOR (Generator completes Ia-r)

a. Generator's US EPA ID Number N/A		b. Manifest Document Number		c. Page 1 of	
d. Generator's Name and Location: Green Oak Builders Inc. 3101 35th Ave Oakland, CA 95601 510-928-7888			e. Generator's Mailing Address: Green Oak Builders Inc. 888 Brennan St #101 San Francisco, CA 94103 510-928-7888		
f. If the generating facility differs from the generator, provide:			g. Phone:		
h. Generator's Name:			i. Owner's Phone No.:		
j. Waste Profile #		k. Exp. Date	l. Waste Shipping Name and Description		m. Containers No. Type
5127152448		1/29/2018	Soil		n. Total Quantity o. Unit Wt/Vol CY

GENERATOR'S CERTIFICATION: I hereby certify that the above named material is not a hazardous waste as defined by 40 CFR 261 or any applicable law, has been properly described, classified and packaged, and is in proper condition for transportation according to applicable regulations; AND, if this waste is a treatment residue of a previously restricted hazardous waste subject to the Land Disposal Restrictions, I certify and warrant that the waste has been treated in accordance with the requirements of 40 CFR 268 and is no longer a hazardous waste as defined by 40 CFR 261.

Generator Authorized Agent Name (Print) <i>Infected on behalf of Green Oak Builders</i>		q. Signature <i>[Signature]</i>	r. Date 3-28-15
--	--	------------------------------------	--------------------

TRANSPORTER (Generator completes IIa-b and Transporter completes IIc-e)

s. Transporter's Name and Address: Mosaic Trucking 41558 Boscell Rd Fremont, CA 94538 408-655-9434		
t. Driver Name (Print) <i>Brandon Leigh</i>	u. Signature <i>[Signature]</i>	v. Date 3/28/15

DESTINATION (Generator complete IIIa-c and Destination Site completes IIId-g)

w. Disposal Facility and Site Address: Newby Island Landfill 1601 Dixon Landing Rd Milpitas, CA 95035 408-262-1401		x. US EPA Number	y. Discrepancy Indication Space: 1127617
z. I hereby certify that the above named material has been accepted and to the best of my knowledge the foregoing is true and accurate.			
Name of Authorized Agent (Print)		ff. Signature	gg. Date

International Disposal Corp of Ca
 Milpitas, CA 95035 408-262-1401
 1015
 ENVIRONMENTAL RESTORATION SERVICES
 BOX 2006
 GLENLO PARK, CA 94026
 127152448

SITE Y1	TICKET # 1124817	CELL
WEIGHMASTER Jose L.		
DATE/TIME IN 03-28-2015 11:46 am	DATE/TIME OUT 03-28-2015 11:46 am	
VEHICLE GT101	CONTAINER	
REFERENCE INVOICE		
BILL OF LADING 2285120		

SCALE IN	GROSS WEIGHT	71,840	NET TONS	19.21	
TARE OUT	TARE WEIGHT	33,420	NET WEIGHT	38,420	INBOUND

UNIT	DESCRIPTION	RATE	EXTENSION	TAX	TOTAL
20.00 YD	TRACKING QTY				
10.24 YD	SW-CONT SOIL-ALT DAILY COVE Oakland				



NON-HAZARDOUS SPECIAL WASTE & ASBESTOS MANIFEST

2285121

If waste is asbestos waste, complete Sections I, II, III and IV
 If waste is **NOT** asbestos waste, complete Sections I, II and III

I. GENERATOR (Generator completes la-r)

a. Generator's US EPA ID Number N/A		b. Manifest Document Number		c. Page 1 of	
d. Generator's Name and Location: Green Oak Builders Inc. 3101 35th Ave Oakland, CA 95601			e. Generator's Mailing Address: Green Oak Builders Inc. 888 Brennan St. #101 San Francisco, CA 94103		
f. Phone: 510-928-7888		g. Phone: 510-928-7888			
If owner of the generating facility differs from the generator, provide:					
h. Owner's Name:			i. Owner's Phone No.:		
j. Waste Profile #	k. Exp. Date	l. Waste Shipping Name and Description		m. Containers No.	n. Total Quantity
5127152448	1/29/2018	Soil			CY
GENERATOR'S CERTIFICATION: I hereby certify that the above named material is not a hazardous waste as defined by 40 CFR 261 or any applicable state law, has been properly described, classified and packaged, and is in proper condition for transportation according to applicable regulations; AND, if this waste is a treatment residue of a previously restricted hazardous waste subject to the Land Disposal Restrictions. I certify and warrant that the waste has been treated in accordance with the requirements of 40 CFR 268 and is no longer a hazardous waste as defined by 40 CFR 261.					
p. Generator Authorized Agent Name (Print) B. Hernandez			q. Signature <i>[Signature]</i>		r. Date 3-27-15

II. TRANSPORTER (Generator completes IIa-b and Transporter completes IIc-e)

a. Transporter's Name and Address: Maciel Trucking 41566 Boscell Rd Fremont, CA 94538			b. Phone: 408-655-9434		
c. Driver Name (Print) Dawinder Singh		d. Signature <i>[Signature]</i>		e. Date 3/28/15	

III. DESTINATION (Generator complete IIIa-c and Destination Site completes III d-g)

a. Disposal Facility and Site Address: Newby Island Landfill 1801 Dixon Landing Rd Milpitas, CA 95035		c. US EPA Number 408-262-1401	d. Discrepancy Indication Space: 112.4972
I hereby certify that the above named material has been accepted and to the best of my knowledge the foregoing is true and accurate.			
e. Name of Authorized Agent (Print) Toni		f. Signature <i>[Signature]</i>	
		g. Date 3-28-15	

SITE	International Disposal Corp of Ca		
	Milpitas, CA	95035	408-262-1401
CUSTOMER	001015 ENVIRONMENTAL RESTORATION SERVICES PO BOX 2006 MENLO PARK, CA 94026 5127152448		

SITE	TICKET #	CELL
Y1	1124972	
WEIGHMASTER Porfirio H.		
DATE/TIME IN	DATE/TIME OUT	
03-28-2015 2:42 pm	03-28-2015 2:42 pm	
VEHICLE	CONTAINER	
G1101		
REFERENCE	INVOICE	
BILL OF LADING	2285121	

SCALE IN	GROSS WEIGHT	76,240	NET TONS	21.41
TARE OUT	TARE WEIGHT	33,420	NET WEIGHT	42,820
				INBOUND

QTY.	UNIT	DESCRIPTION	RATE	EXTENSION	TAX	TOTAL
20.00	YD	TRACKING QTY				
21.41	TN	SW-CONT SOIL-ALT DAILY COVE Oakland				



NON-HAZARDOUS SPECIAL WASTE & ASBESTOS MANIFEST

2285122

If waste is asbestos waste, complete Sections I, II, III and IV
 If waste is **NOT** asbestos waste, complete Sections I, II and III

I. GENERATOR (Generator completes la-r)

a. Generator's US EPA ID Number N/A		b. Manifest Document Number		c. Page 1 of	
d. Generator's Name and Location: Green Oak Builders Inc. 3101 36th Ave Oakland, CA 95601			e. Generator's Mailing Address: Green Oak Builders Inc. 888 Brennan St. #101 San Francisco, CA 94103		
f. Phone: 510-928-7888			g. Phone: 510-928-7888		
If owner of the generating facility differs from the generator, provide:					
h. Owner's Name:			i. Owner's Phone No.:		
j. Waste Profile #	k. Exp. Date	l. Waste Shipping Name and Description		m. Containers No.	n. Total Quantity
5127152448	1/29/2018	Soil			
					o. Unit Wt/Vol CY
GENERATOR'S CERTIFICATION: I hereby certify that the above named material is not a hazardous waste as defined by 40 CFR 261 or any applicable state law, has been properly described, classified and packaged, and is in proper condition for transportation according to applicable regulations; AND, if this waste is a treatment residue of a previously restricted hazardous waste subject to the Land Disposal Restrictions. I certify and warrant that the waste has been treated in accordance with the requirements of 40 CFR 268 and is no longer a hazardous waste as defined by 40 CFR 261.					
p. Generator Authorized Agent Name (Print) Billie Anderson for Green Oak Builders Inc			q. Signature [Signature]		r. Date 3-27-15

II. TRANSPORTER (Generator completes IIa-b and Transporter completes IIc-e)

a. Transporter's Name and Address: Maciel Trucking 41568 Boscell Rd Fremont, CA 94538			b. Phone: 408-855-9434		
c. Driver Name (Print) Darindey Lugh		d. Signature [Signature]		e. Date 3/30/15	

III. DESTINATION (Generator complete IIIa-c and Destination Site completes III d-g)

a. Disposal Facility and Site Address: Newby Island Landfill 1601 Dixon Landing Rd Milpitas, CA 95035		c. US EPA Number 408-262-1401	d. Discrepancy Indication Space: 1125103
I hereby certify that the above named material has been accepted and to the best of my knowledge the foregoing is true and accurate.			
e. Name of Authorized Agent (Print) For the		f. Signature [Signature]	g. Date 3-30-15

ITE International Disposal Corp of Ca Milpitas, CA 95035 408-262-1401	CUSTOMER 001015 ENVIRONMENTAL RESTORATION SERVICES PO BOX 2006 MENLO PARK, CA 94026 5127152448
---	---

SITE Y1	TICKET # 1125103	CELL
WEIGHMASTER Porfirio H.		
DATE/TIME IN 03-30-2015 6:42 am	DATE/TIME OUT 03-30-2015 6:42 am	
VEHICLE GT101	CONTAINER	
REFERENCE	INVOICE	
BILL OF LADING 2285122		

SCALE IN	GROSS WEIGHT	76,480	NET TONS	21.53	
TARE OUT	TARE WEIGHT	33,420	NET WEIGHT	43,060	INBOUND

QTY.	UNIT	DESCRIPTION	RATE	EXTENSION	TAX	TOTAL
20.00	YD	TRACKING QTY				
21.53	TN	SW-CONT SOIL-ALT DAILY COVE Oakland				

**LABORATORY
ANALYTICAL RESULTS
CHAIN-OF-CUSTODY**



McC Campbell Analytical, Inc.

"When Quality Counts"

Analytical Report

WorkOrder: 1504689

Report Created for: Environmental Restoration Services

P.O. Box 2006
Menlo Park, CA 94026

Project Contact: Ben Halsted

Project P.O.:

Project Name: 3101 35th Ave., Oakland

Project Received: 04/16/2015

Analytical Report reviewed & approved for release on 04/22/2015 by:

Angela Rydelius,
Laboratory Manager

The report shall not be reproduced except in full, without the written approval of the laboratory. The analytical results relate only to the items tested. Results reported conform to the most current NELAP standards, where applicable, unless otherwise stated in the case narrative.





Glossary of Terms & Qualifier Definitions

Client: Environmental Restoration Services
Project: 3101 35th Ave., Oakland
WorkOrder: 1504689

Glossary Abbreviation

95% Interval	95% Confident Interval
DF	Dilution Factor
DI WET	(DISTLC) Waste Extraction Test using DI water
DISS	Dissolved (direct analysis of 0.45 µm filtered and acidified water sample)
DUP	Duplicate
EDL	Estimated Detection Limit
ITEF	International Toxicity Equivalence Factor
LCS	Laboratory Control Sample
MB	Method Blank
MB % Rec	% Recovery of Surrogate in Method Blank, if applicable
MDL	Method Detection Limit
ML	Minimum Level of Quantitation
MS	Matrix Spike
MSD	Matrix Spike Duplicate
N/A	Not Applicable
ND	Not detected at or above the indicated MDL or RL
NR	Data Not Reported due to matrix interference or insufficient sample amount.
PF	Prep Factor
RD	Relative Difference
RL	Reporting Limit (The RL is the lowest calibration standard in a multipoint calibration.)
RPD	Relative Percent Deviation
RRT	Relative Retention Time
SPK Val	Spike Value
SPKRef Val	Spike Reference Value
SPLP	Synthetic Precipitation Leachate Procedure
TCLP	Toxicity Characteristic Leachate Procedure
TEQ	Toxicity Equivalents
WET (STLC)	Waste Extraction Test (Soluble Threshold Limit Concentration)

Analytical Qualifiers

d7	strongly aged gasoline or diesel range compounds are significant in the TPH(g) chromatogram
d9	no recognizable pattern

Quality Control Qualifiers

F1	MS/MSD recovery and/or RPD was out of acceptance criteria; LCS validated the prep batch.
----	--



Analytical Report

Client: Environmental Restoration Services
Project: 3101 35th Ave., Oakland
Date Received: 4/16/15 16:10
Date Prepared: 4/16/15-4/20/15

WorkOrder: 1504689
Extraction Method: SW5030B
Analytical Method: SW8021B/8015Bm
Unit: mg/Kg

Gasoline Range (C6-C12) Volatile Hydrocarbons as Gasoline with BTEX and MTBE

Client ID	Lab ID	Matrix/ExtType	Date Collected	Instrument	Batch ID
Disp.Ad5'	1504689-001A	Soil	04/16/2015 11:20	GC19	103686

Analytes	Result	RL	DF	Date Analyzed
TPH(g)	46	10	10	04/20/2015 20:37
MTBE	ND	0.50	10	04/20/2015 20:37
Benzene	ND	0.050	10	04/20/2015 20:37
Toluene	ND	0.050	10	04/20/2015 20:37
Ethylbenzene	ND	0.050	10	04/20/2015 20:37
Xylenes	0.069	0.050	10	04/20/2015 20:37

Surrogates	REC (%)	Limits	Date Analyzed
2-Fluorotoluene	78	70-130	04/20/2015 20:37

Analyst(s): IA Analytical Comments: d7,d9

Client ID	Lab ID	Matrix/ExtType	Date Collected	Instrument	Batch ID
Disp.Bd4'	1504689-002A	Soil	04/16/2015 11:25	GC19	103880

Analytes	Result	RL	DF	Date Analyzed
TPH(g)	1.1	1.0	1	04/21/2015 15:28
MTBE	ND	0.050	1	04/21/2015 15:28
Benzene	ND	0.0050	1	04/21/2015 15:28
Toluene	ND	0.0050	1	04/21/2015 15:28
Ethylbenzene	ND	0.0050	1	04/21/2015 15:28
Xylenes	ND	0.0050	1	04/21/2015 15:28

Surrogates	REC (%)	Limits	Date Analyzed
2-Fluorotoluene	102	70-130	04/21/2015 15:28

Analyst(s): IA Analytical Comments: d7



Analytical Report

Client: Environmental Restoration Services
Project: 3101 35th Ave., Oakland
Date Received: 4/16/15 16:10
Date Prepared: 4/16/15-4/20/15

WorkOrder: 1504689
Extraction Method: SW5030B
Analytical Method: SW8021B/8015Bm
Unit: mg/Kg

Gasoline Range (C6-C12) Volatile Hydrocarbons as Gasoline with BTEX and MTBE

Client ID	Lab ID	Matrix/ExtType	Date Collected	Instrument	Batch ID
Disp.Cd5'	1504689-003A	Soil	04/16/2015 11:29	GC19	103686

Analytes	Result	RL	DF	Date Analyzed
TPH(g)	77	20	20	04/20/2015 21:07
MTBE	ND	1.0	20	04/20/2015 21:07
Benzene	ND	0.10	20	04/20/2015 21:07
Toluene	ND	0.10	20	04/20/2015 21:07
Ethylbenzene	0.17	0.10	20	04/20/2015 21:07
Xylenes	0.22	0.10	20	04/20/2015 21:07

Surrogates	REC (%)	Limits	Date Analyzed
2-Fluorotoluene	101	70-130	04/20/2015 21:07

Analyst(s): IA

Analytical Comments: d7,d9

Client ID	Lab ID	Matrix/ExtType	Date Collected	Instrument	Batch ID
Disp.Dd6'	1504689-004A	Soil	04/16/2015 11:37	GC7	103686

Analytes	Result	RL	DF	Date Analyzed
TPH(g)	110	10	10	04/17/2015 14:03
MTBE	ND	0.50	10	04/17/2015 14:03
Benzene	ND	0.050	10	04/17/2015 14:03
Toluene	0.21	0.050	10	04/17/2015 14:03
Ethylbenzene	0.87	0.050	10	04/17/2015 14:03
Xylenes	0.16	0.050	10	04/17/2015 14:03

Surrogates	REC (%)	Limits	Date Analyzed
2-Fluorotoluene	117	70-130	04/17/2015 14:03

Analyst(s): IA

Analytical Comments: d7,d9

(Cont.)



Analytical Report

Client: Environmental Restoration Services
Project: 3101 35th Ave., Oakland
Date Received: 4/16/15 16:10
Date Prepared: 4/16/15-4/20/15

WorkOrder: 1504689
Extraction Method: SW5030B
Analytical Method: SW8021B/8015Bm
Unit: mg/Kg

Gasoline Range (C6-C12) Volatile Hydrocarbons as Gasoline with BTEX and MTBE

Client ID	Lab ID	Matrix/ExtType	Date Collected	Instrument	Batch ID
Disp.Ed5'	1504689-005A	Soil	04/16/2015 11:44	GC7	103686

Analytes	Result	RL	DF	Date Analyzed
TPH(g)	21	1.0	1	04/17/2015 20:51
MTBE	ND	0.050	1	04/17/2015 20:51
Benzene	ND	0.0050	1	04/17/2015 20:51
Toluene	0.031	0.0050	1	04/17/2015 20:51
Ethylbenzene	0.012	0.0050	1	04/17/2015 20:51
Xylenes	0.16	0.0050	1	04/17/2015 20:51

Surrogates	REC (%)	Limits	Date Analyzed
2-Fluorotoluene	116	70-130	04/17/2015 20:51

Analyst(s): IA

Analytical Comments: d7,d9

Client ID	Lab ID	Matrix/ExtType	Date Collected	Instrument	Batch ID
Disp.Fd5'	1504689-006A	Soil	04/16/2015 11:48	GC7	103686

Analytes	Result	RL	DF	Date Analyzed
TPH(g)	68	1.0	1	04/17/2015 21:22
MTBE	ND	0.050	1	04/17/2015 21:22
Benzene	ND	0.0050	1	04/17/2015 21:22
Toluene	ND	0.0050	1	04/17/2015 21:22
Ethylbenzene	ND	0.0050	1	04/17/2015 21:22
Xylenes	0.035	0.0050	1	04/17/2015 21:22

Surrogates	REC (%)	Limits	Date Analyzed
2-Fluorotoluene	116	70-130	04/17/2015 21:22

Analyst(s): IA

Analytical Comments: d7,d9

(Cont.)



Analytical Report

Client: Environmental Restoration Services
Project: 3101 35th Ave., Oakland
Date Received: 4/16/15 16:10
Date Prepared: 4/16/15-4/20/15

WorkOrder: 1504689
Extraction Method: SW5030B
Analytical Method: SW8021B/8015Bm
Unit: mg/Kg

Gasoline Range (C6-C12) Volatile Hydrocarbons as Gasoline with BTEX and MTBE

Client ID	Lab ID	Matrix/ExtType	Date Collected	Instrument	Batch ID
Disp.Gd5'	1504689-007A	Soil	04/16/2015 11:51	GC7	103747

Analytes	Result	RL	DF	Date Analyzed
TPH(g)	ND	1.0	1	04/17/2015 13:00
MTBE	ND	0.050	1	04/17/2015 13:00
Benzene	ND	0.0050	1	04/17/2015 13:00
Toluene	ND	0.0050	1	04/17/2015 13:00
Ethylbenzene	ND	0.0050	1	04/17/2015 13:00
Xylenes	ND	0.0050	1	04/17/2015 13:00

Surrogates	REC (%)	Limits	Date Analyzed
2-Fluorotoluene	101	70-130	04/17/2015 13:00

Analyst(s): IA

Client ID	Lab ID	Matrix/ExtType	Date Collected	Instrument	Batch ID
Disp.Hd6'	1504689-008A	Soil	04/16/2015 11:59	GC19	103747

Analytes	Result	RL	DF	Date Analyzed
TPH(g)	68	10	10	04/20/2015 21:37
MTBE	ND	0.50	10	04/20/2015 21:37
Benzene	ND	0.050	10	04/20/2015 21:37
Toluene	0.34	0.050	10	04/20/2015 21:37
Ethylbenzene	ND	0.050	10	04/20/2015 21:37
Xylenes	0.093	0.050	10	04/20/2015 21:37

Surrogates	REC (%)	Limits	Date Analyzed
2-Fluorotoluene	97	70-130	04/20/2015 21:37

Analyst(s): IA

Analytical Comments: d7,d9



Quality Control Report

Client: Environmental Restoration Services
Date Prepared: 4/15/15
Date Analyzed: 4/15/15
Instrument: GC7
Matrix: Soil
Project: 3101 35th Ave., Oakland

WorkOrder: 1504689
BatchID: 103686
Extraction Method: SW5030B
Analytical Method: SW8021B/8015Bm
Unit: mg/Kg
Sample ID: MB/LCS-103686
 1504624-001AMS/MSD

QC Summary Report for SW8021B/8015Bm

Analyte	MB Result	LCS Result	RL	SPK Val	MB SS %REC	LCS %REC	LCS Limits
TPH(btex)	ND	0.656	0.40	0.60	-	109	70-130
MTBE	ND	0.102	0.050	0.10	-	102	70-130
Benzene	ND	0.120	0.0050	0.10	-	120	70-130
Toluene	ND	0.114	0.0050	0.10	-	115	70-130
Ethylbenzene	ND	0.120	0.0050	0.10	-	120	70-130
Xylenes	ND	0.366	0.0050	0.30	-	122	70-130

Surrogate Recovery

2-Fluorotoluene	0.115	0.117		0.10	115	117	70-130
-----------------	-------	-------	--	------	-----	-----	--------

Analyte	MS Result	MSD Result	SPK Val	SPKRef Val	MS %REC	MSD %REC	MS/MSD Limits	RPD	RPD Limit
TPH(btex)	0.991	0.692	0.60	ND	165,F1	115	70-130	35.6,F1	20
MTBE	0.0918	0.0903	0.10	ND	92	90	70-130	1.64	20
Benzene	0.110	0.116	0.10	ND	110	116	70-130	5.30	20
Toluene	0.107	0.112	0.10	ND	107	112	70-130	4.38	20
Ethylbenzene	0.107	0.113	0.10	ND	107	113	70-130	4.94	20
Xylenes	0.322	0.330	0.30	ND	107	110	70-130	2.39	20

Surrogate Recovery

2-Fluorotoluene	0.108	0.121	0.10		108	121	70-130	11.7	20
-----------------	-------	-------	------	--	-----	-----	--------	------	----

(Cont.)



Quality Control Report

Client: Environmental Restoration Services
Date Prepared: 4/16/15
Date Analyzed: 4/17/15
Instrument: GC7
Matrix: Soil
Project: 3101 35th Ave., Oakland

WorkOrder: 1504689
BatchID: 103747
Extraction Method: SW5030B
Analytical Method: SW8021B/8015Bm
Unit: mg/Kg
Sample ID: MB/LCS-103747
 1504689-007AMS/MSD

QC Summary Report for SW8021B/8015Bm

Analyte	MB Result	LCS Result	RL	SPK Val	MB SS %REC	LCS %REC	LCS Limits
TPH(btex)	ND	0.657	0.40	0.60	-	110	70-130
MTBE	ND	0.103	0.050	0.10	-	95	70-130
Benzene	ND	0.114	0.0050	0.10	-	114	70-130
Toluene	ND	0.109	0.0050	0.10	-	109	70-130
Ethylbenzene	ND	0.113	0.0050	0.10	-	113	70-130
Xylenes	ND	0.348	0.0050	0.30	-	116	70-130

Surrogate Recovery

2-Fluorotoluene	0.123	0.114		0.10	123	114	70-130
-----------------	-------	-------	--	------	-----	-----	--------

Analyte	MS Result	MSD Result	SPK Val	SPKRef Val	MS %REC	MSD %REC	MS/MSD Limits	RPD	RPD Limit
TPH(btex)	0.586	0.596	0.60	ND	98	99	70-130	1.71	20
MTBE	0.0913	0.0947	0.10	ND	91	95	70-130	3.65	20
Benzene	0.0977	0.0949	0.10	ND	94	91	70-130	2.95	20
Toluene	0.0926	0.0912	0.10	ND	93	91	70-130	1.56	20
Ethylbenzene	0.0980	0.0960	0.10	ND	98	96	70-130	2.03	20
Xylenes	0.312	0.310	0.30	ND	104	103	70-130	0.539	20

Surrogate Recovery

2-Fluorotoluene	0.101	0.0991	0.10		101	99	70-130	2.37	20
-----------------	-------	--------	------	--	-----	----	--------	------	----

(Cont.)



Quality Control Report

Client: Environmental Restoration Services
Date Prepared: 4/20/15
Date Analyzed: 4/21/15
Instrument: GC7
Matrix: Soil
Project: 3101 35th Ave., Oakland

WorkOrder: 1504689
BatchID: 103880
Extraction Method: SW5030B
Analytical Method: SW8021B/8015Bm
Unit: mg/Kg
Sample ID: MB/LCS-103880
 1504815-003AMS/MSD

QC Summary Report for SW8021B/8015Bm

Analyte	MB Result	LCS Result	RL	SPK Val	MB SS %REC	LCS %REC	LCS Limits
TPH(btex)	ND	0.664	0.40	0.60	-	111	70-130
MTBE	ND	0.104	0.050	0.10	-	104	70-130
Benzene	ND	0.123	0.0050	0.10	-	123	70-130
Toluene	ND	0.121	0.0050	0.10	-	121	70-130
Ethylbenzene	ND	0.124	0.0050	0.10	-	124	70-130
Xylenes	ND	0.382	0.0050	0.30	-	127	70-130

Surrogate Recovery

2-Fluorotoluene	0.114	0.121		0.10	114	121	70-130
-----------------	-------	-------	--	------	-----	-----	--------

Analyte	MS Result	MSD Result	SPK Val	SPKRef Val	MS %REC	MSD %REC	MS/MSD Limits	RPD	RPD Limit
TPH(btex)	0.676	0.604	0.60	ND	113	101	70-130	11.3	20
MTBE	0.0731	0.0785	0.10	ND	73	79	70-130	7.19	20
Benzene	0.0821	0.0868	0.10	ND	82	87	70-130	5.52	20
Toluene	0.0852	0.0880	0.10	ND	85	88	70-130	3.22	20
Ethylbenzene	0.0846	0.0877	0.10	ND	85	88	70-130	3.63	20
Xylenes	0.251	0.262	0.30	ND	84	87	70-130	4.09	20

Surrogate Recovery

2-Fluorotoluene	0.0755	0.0767	0.10		75	77	70-130	1.54	20
-----------------	--------	--------	------	--	----	----	--------	------	----



1534 Willow Pass Rd
Pittsburg, CA 94565-1701
(925) 252-9262

CHAIN-OF-CUSTODY RECORD

WorkOrder: 1504689

ClientCode: ERSM

WaterTrax
 WriteOn
 EDF
 Excel
 EQuIS
 Email
 HardCopy
 ThirdParty
 J-flag

Report to:
 Ben Halsted
 Environmental Restoration Services
 P.O. Box 2006
 Menlo Park, CA 94026
 650-325-3216 FAX: 650-327-2984

Email: ben@envirest.com
 cc/3rd Party: joelgreger2@gmail.com;
 PO:
 ProjectNo: 3101 35th Ave., Oakland

Bill to:
 Accounts Payable
 Environmental Restoration Services
 P.O. Box 2006
 Menlo Park, CA 94026

Requested TAT: 5 days

Date Received: 04/16/2015
Date Printed: 04/23/2015

Lab ID	Client ID	Matrix	Collection Date	Hold	Requested Tests (See legend below)												
					1	2	3	4	5	6	7	8	9	10	11	12	
1504689-001	Disp.Ad5'	Soil	4/16/2015 11:20	<input type="checkbox"/>	A	A											
1504689-002	Disp.Bd4'	Soil	4/16/2015 11:25	<input type="checkbox"/>	A												
1504689-003	Disp.Cd5'	Soil	4/16/2015 11:29	<input type="checkbox"/>	A												
1504689-004	Disp.Dd6'	Soil	4/16/2015 11:37	<input type="checkbox"/>	A												
1504689-005	Disp.Ed5'	Soil	4/16/2015 11:44	<input type="checkbox"/>	A												
1504689-006	Disp.Fd5'	Soil	4/16/2015 11:48	<input type="checkbox"/>	A												
1504689-007	Disp.Gd5'	Soil	4/16/2015 11:51	<input type="checkbox"/>	A												
1504689-008	Disp.Hd6'	Soil	4/16/2015 11:59	<input type="checkbox"/>	A												

Test Legend:

1	G-MBTX_S	2	PREFD REPORT	3		4		5	
6		7		8		9		10	
11		12							

Prepared by: Jena Alfaro

Comments:

NOTE: Soil samples are discarded 60 days after results are reported unless other arrangements are made (Water samples are 30 days). Hazardous samples will be returned to client or disposed of at client expense.



WORK ORDER SUMMARY

Client Name: ENVIRONMENTAL RESTORATION SERVICES

QC Level: LEVEL 2

Work Order: 1504689

Project: 3101 35th Ave., Oakland

Client Contact: Ben Halsted

Date Received: 4/16/2015

Comments:

Contact's Email: ben@envirest.com

WaterTrax WriteOn EDF Excel Fax Email HardCopy ThirdParty J-flag

Lab ID	Client ID	Matrix	Test Name	Containers /Composites	Bottle & Preservative	De-chlorinated	Collection Date & Time	TAT	Sediment Content	Hold	SubOut
1504689-001A	Disp.Ad5'	Soil	SW8021B/8015Bm (G/MBTEX)	1	Stainless Steel tube 2"x6"	<input type="checkbox"/>	4/16/2015 11:20	5 days		<input type="checkbox"/>	
1504689-002A	Disp.Bd4'	Soil	SW8021B/8015Bm (G/MBTEX)	1	Stainless Steel tube 2"x6"	<input type="checkbox"/>	4/16/2015 11:25	5 days		<input type="checkbox"/>	
1504689-003A	Disp.Cd5'	Soil	SW8021B/8015Bm (G/MBTEX)	1	Stainless Steel tube 2"x6"	<input type="checkbox"/>	4/16/2015 11:29	5 days		<input type="checkbox"/>	
1504689-004A	Disp.Dd6'	Soil	SW8021B/8015Bm (G/MBTEX)	1	Stainless Steel tube 2"x6"	<input type="checkbox"/>	4/16/2015 11:37	5 days		<input type="checkbox"/>	
1504689-005A	Disp.Ed5'	Soil	SW8021B/8015Bm (G/MBTEX)	1	Stainless Steel tube 2"x6"	<input type="checkbox"/>	4/16/2015 11:44	5 days		<input type="checkbox"/>	
1504689-006A	Disp.Fd5'	Soil	SW8021B/8015Bm (G/MBTEX)	1	Stainless Steel tube 2"x6"	<input type="checkbox"/>	4/16/2015 11:48	5 days		<input type="checkbox"/>	
1504689-007A	Disp.Gd5'	Soil	SW8021B/8015Bm (G/MBTEX)	1	Stainless Steel tube 2"x6"	<input type="checkbox"/>	4/16/2015 11:51	5 days		<input type="checkbox"/>	
1504689-008A	Disp.Hd6'	Soil	SW8021B/8015Bm (G/MBTEX)	1	Stainless Steel tube 2"x6"	<input type="checkbox"/>	4/16/2015 11:59	5 days		<input type="checkbox"/>	

NOTES: - STLC and TCLP extractions require 2 days to complete; therefore, all TATs begin after the extraction is completed (i.e., One-day TAT yields results in 3 days from sample submission).
 - MAI assumes that all material present in the provided sampling container is considered part of the sample - MAI does not exclude any material from the sample prior to sample preparation unless requested in writing by the client.

also send results to ben@envirest.com



McC Campbell Analytical, Inc.

1534 Willow Pass Rd. / Pittsburg, Ca. 94565-1701
 www.mccampbell.com / main@mccampbell.com
 Telephone: (877) 252-9262 / Fax: (925) 252-9269

1504689

CHAIN OF CUSTODY RECORD *(regular)*

TURN AROUND TIME: RUSH 1 DAY 2 DAY 3 DAY 5 DAY

GeoTracker EDF PDF EDD Write On (DW) EQUIS 10 DAY

Effluent Sample Requiring "J" flag UST Clean Up Fund Project ; Claim # _____

Report To: Joel Greger Bill To: ERS - Ben Halsted
 Company: Environmental Restoration SVCS (ERS)
POB 2006, Menlo Park, CA 94026
 Tele: (510) 5935382 E-Mail: joelgreger2@gmail.com
 Project #: _____ Project Name: 3101 35th Ave
 Project Location: 3101-35th Ave, Oakland Purchase Order# _____
 Sampler Signature: Joel Greger

Analysis Request

SAMPLE ID	Location/ Field Point Name	SAMPLING		# Containers	MATRIX								METHOD PRESERVED	Analysis Request																								
		Date	Time		Ground Water	Waste Water	Drinking Water	Sea Water	Soil	Air	Sludge	Other	HCL	HNO ₃	Other	BTEX & TPH as Gas (8021/8015) MTBE	TPH as Diesel (8015)	Total Petroleum Oil & Grease (1664/5520 E/B&F)	Total Petroleum Hydrocarbons (418.1)	EPA 505/608/8081 (CI Pesticides)	EPA 608/8082 PCB's; Aroclors / Congeners	EPA 507/8141 (NP Pesticides)	EPA 515/8151 (Acidic CI Herbicides)	EPA 524.2/624/8260 (VOCs)	EPA 525.2/625/8270 (SVOCs)	EPA 8270 SIM/8310 (PAHs/PNAS)	CAM 17 Metals (200.8/6020)***	LUFT 5 Metals (200.8/6020)***	Metals (200.8/6020)***	Lab to Filter sample for Dissolved metals analysis								
Disp. A d5'		4/16/15	1120 AM	1					X					X																								
Disp. B d4'			1125						X					X																								
Disp. C d5'			1129						X					X																								
Disp. D d6'			1137						X					X																								
Disp. E d5'			1144						X					X																								
Disp. F d5'			1148						X					X																								
Disp. G d5'			1151						X					X																								
Disp. H d6'			1159						X					X																								

**MAI clients MUST disclose any dangerous chemicals known to be present in their submitted samples in concentrations that may cause immediate harm or serious future health endangerment as a result of brief, gloved, open air, sample handling by MAI staff. Non-disclosure incurs an immediate \$250 surcharge and the client is subject to full legal liability for harm suffered. Thank you for your understanding and for allowing us to work safely.

*** If metals are requested for water samples and the water type is not specified on the chain of custody, then MAI will default to metals by E200.8.

Relinquished By: <u>Joel Greger</u>	Date: <u>4/16/15</u>	Time: <u>152 PM</u>	Received By: <u>[Signature]</u>	ICE/e GOOD CONDITION _____ HEAD SPACE ABSENT _____ DECHLORINATED IN LAB _____ APPROPRIATE CONTAINERS _____ PRESERVED IN LAB _____ VOAS O&G METALS OTHER HAZARDOUS: PRESERVATION _____ pH < 2 _____	COMMENTS:
Relinquished By: <u>[Signature]</u>	Date: <u>4/16/15</u>	Time: <u>1422</u>	Received By: <u>[Signature]</u>		
Relinquished By: _____	Date: _____	Time: _____	Received By: _____		



Sample Receipt Checklist

Client Name: **Environmental Restoration Services**
 Project Name: **3101 35th Ave., Oakland**
 WorkOrder No: **1504689** Matrix: Soil

Date and Time Received: **4/16/2015 4:10:14 PM**
 LogIn Reviewed by: **Jena Alfaro**
 Carrier: Daniel (MAI Courier)

Chain of Custody (COC) Information

Chain of custody present? Yes No
 Chain of custody signed when relinquished and received? Yes No
 Chain of custody agrees with sample labels? Yes No
 Sample IDs noted by Client on COC? Yes No
 Date and Time of collection noted by Client on COC? Yes No
 Sampler's name noted on COC? Yes No

Sample Receipt Information

Custody seals intact on shipping container/cooler? Yes No NA
 Shipping container/cooler in good condition? Yes No
 Samples in proper containers/bottles? Yes No
 Sample containers intact? Yes No
 Sufficient sample volume for indicated test? Yes No

Sample Preservation and Hold Time (HT) Information

All samples received within holding time? Yes No
 Sample/Temp Blank temperature Temp: 6°C NA
 Water - VOA vials have zero headspace / no bubbles? Yes No NA
 Sample labels checked for correct preservation? Yes No
 pH acceptable upon receipt (Metal: <2; 522: <4; 218.7: >8)? Yes No NA
 Samples Received on Ice? Yes No
 (Ice Type: WET ICE)

UCMR3 Samples:

Total Chlorine tested and acceptable upon receipt for EPA 522? Yes No NA
 Free Chlorine tested and acceptable upon receipt for EPA 218.7, 300.1, 537, 539? Yes No NA

* NOTE: If the "No" box is checked, see comments below.

 Comments: