

Notes:

1. World street basemap is provided through Langan's Esri ArcGIS software licensing and ArcGIS online. Credits: Sources: Esri, DeLorme, NAVTEQ, USGS, Intermap, iPC, NRCAN.
2. Map displayed in California State Plane Coordinate System , Zone III, North American Datum of 1983 (NAD83), US Survey Feet.

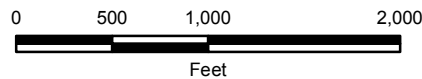

**2302-2332 VALDEZ STREET
2321-2335 WAVERLY STREET**
Oakland, California

SITE LOCATION MAP

LANGAN TREADWELL ROLLO

Date 9/29/2014

Project 731641601

Figure 1

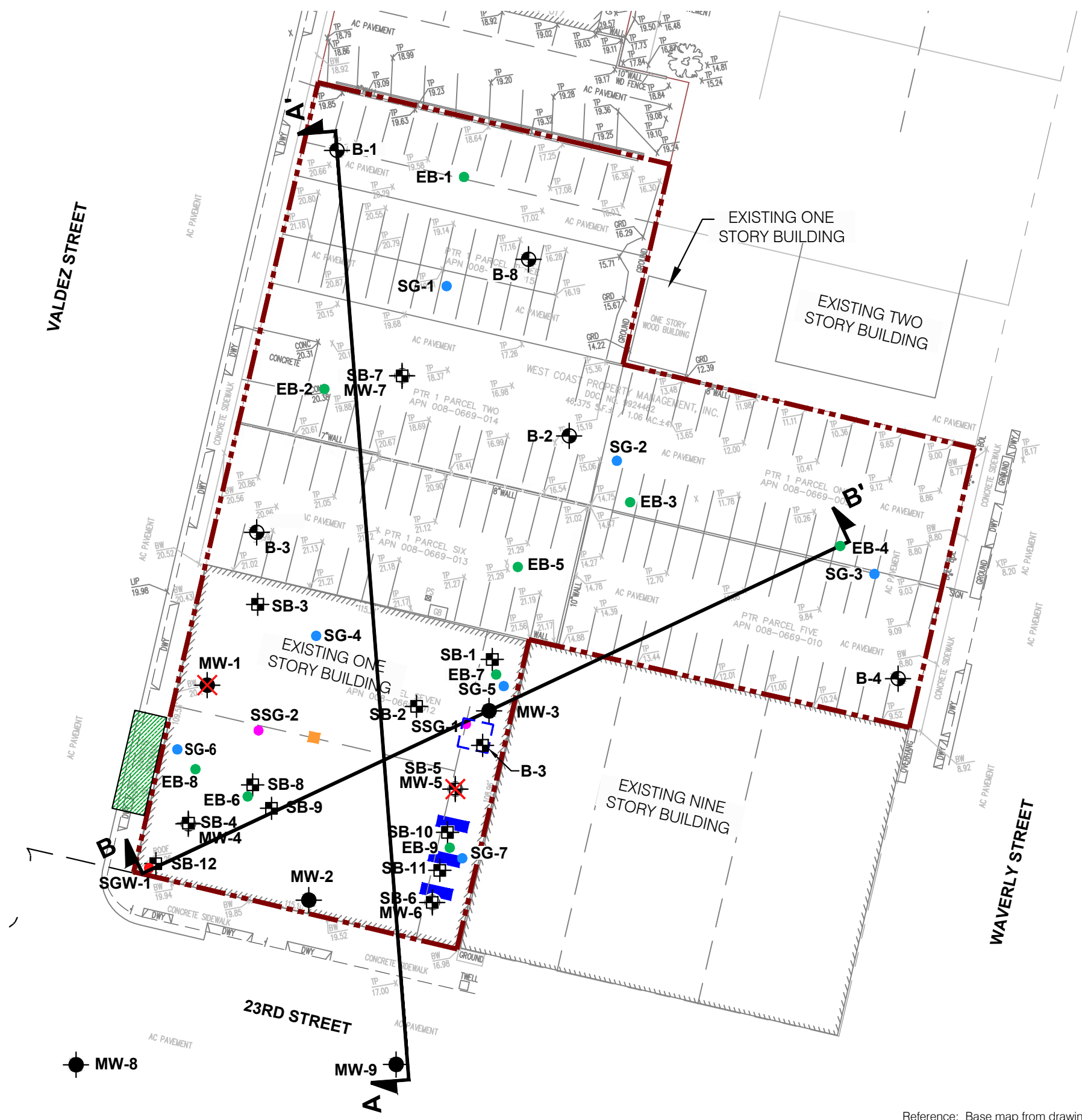

EXPLANATION

- B-1** Approximate location of geotechnical boring by Langan Treadwell Rollo, September and December 2014
- MW-1** Approximate location of previously installed monitoring well
- SB-1** Approximate location of soil boring by Dames and Moore, August 1989 & GRIBI Associates, February 1998
- Approximate location of former USTs. Removed February 1988
- Approximate Site boundary
- SGW-1** Approximate location of permanent soil vapor probe by Langan Treadwell Rollo, February 2015
- EB-1** Approximate location of environmental boring by Langan Treadwell Rollo, September 2014 and February 2015
- SG-1** Approximate location of environmental soil vapor sampling by Langan Treadwell Rollo, September 2014 and February 2015
- SSG-1** Approximate location of environmental sub-slab soil vapor sampling by Langan Treadwell Rollo, September 2014
- Abandoned monitoring well
- Former Drain Area
- Hydraulic Lifts
- Former Fuel Dispenser



Idealized subsurface profile location (See Figures 3 & 4)

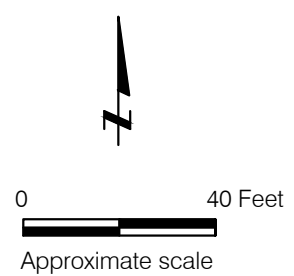

2302-2332 VALDEZ STREET 2321-2335 WAVERLY STREET Oakland, California		
SITE PLAN WITH SAMPLING LOCATIONS		
Date 12/21/15	Project No. 731641601	Figure 2
LANGAN TREADWELL ROLLO		

Reference: Base map from drawing titled "Existing Site Boundary Plan", by BKF, dated 21 November 2014.

\\langan.com\data\SF\data6\731641601\Cadd Data - 731641601\2D-DesignFiles\Environmental\Figure 3 & 4.dwg 12/21/15

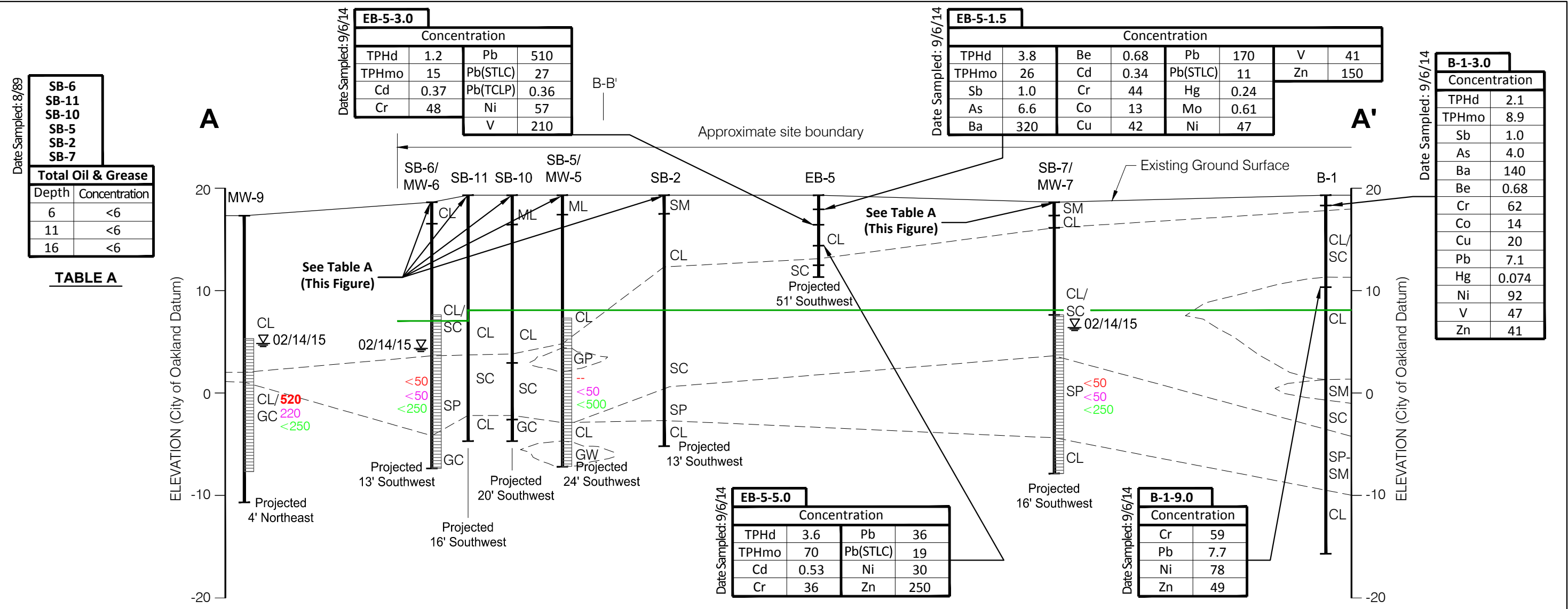

Date Sampled: 8/89

SB-6	
SB-11	
SB-10	
SB-5	
SB-2	
SB-7	
Total Oil & Grease	
Depth	Concentration
6	<6
11	<6
16	<6

TABLE A

Date Sampled: 9/6/14

EB-5-3.0			
Concentration			
TPHd	1.2	Pb	510
TPHmo	15	Pb(STLC)	27
Cd	0.37	Pb(TCLP)	0.36
Cr	48	Ni	57
		V	210

Date Sampled: 9/6/14

EB-5-1.5							
Concentration							
TPHd	3.8	Be	0.68	Pb	170	V	41
TPHmo	26	Cd	0.34	Pb(STLC)	11	Zn	150
Sb	1.0	Cr	44	Hg	0.24		
As	6.6	Co	13	Mo	0.61		
Ba	320	Cu	42	Ni	47		

Date Sampled: 9/6/14

B-1-3.0	
Concentration	
TPHd	2.1
TPHmo	8.9
Sb	1.0
As	4.0
Ba	140
Be	0.68
Cr	62
Co	14
Cu	20
Pb	7.1
Hg	0.074
Ni	92
V	47
Zn	41

Date Sampled: 9/6/14

EB-5-5.0			
Concentration			
TPHd	3.6	Pb	36
TPHmo	70	Pb(STLC)	19
Cd	0.53	Ni	30
Cr	36	Zn	250

Date Sampled: 9/6/14

B-1-9.0	
Concentration	
Cr	59
Pb	7.7
Ni	78
Zn	49

EXPLANATION

- 520 TPH-g (mg/L), total petroleum hydrocarbons, gasoline range in ground water
- 520 TPH-d (mg/L), total petroleum hydrocarbons, diesel range in ground water
- 520 TPH-mo (mg/L), total petroleum hydrocarbons, motor oil range in ground water
- Excavation Depth
- Sb - Antimony
- As - Arsenic
- Ba - Barium
- Be - Beryllium
- Cd - Cadmium
- Cr - Chromium
- Co - Cobalt
- Cu - Copper
- Pb - Lead
- Hg - Mercury
- Mo - Molybdenum
- Ni - Nickel
- V - Vanadium
- Zn - Zinc

USCS CLASSIFICATION

- GW Well-graded gravels or gravel-sand mixtures, little or no fines
- GC Clayey gravels, gravel-sand-clay mixtures
- SP Poorly graded sands or gravelly sands, little or no fines\
- SM Silty sands, sand-silt mixtures
- SC Clayey sands, sand-clay mixtures
- ML Inorganic silts of high plasticity
- CL Inorganic clays of low to medium plasticity, sand silts, gravelly silts

Notes:
 1. The above profile represents a generalized soil cross section interpreted from widely spaced borings. Soil deposits may vary in type, strength, and other important properties between points of exploration.
 2. Excavation depths taken from BKF's Excavation plan, dated 11/16/15.

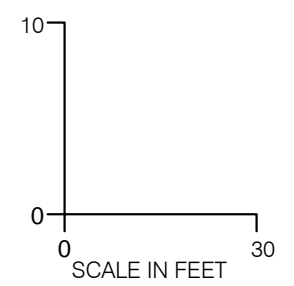
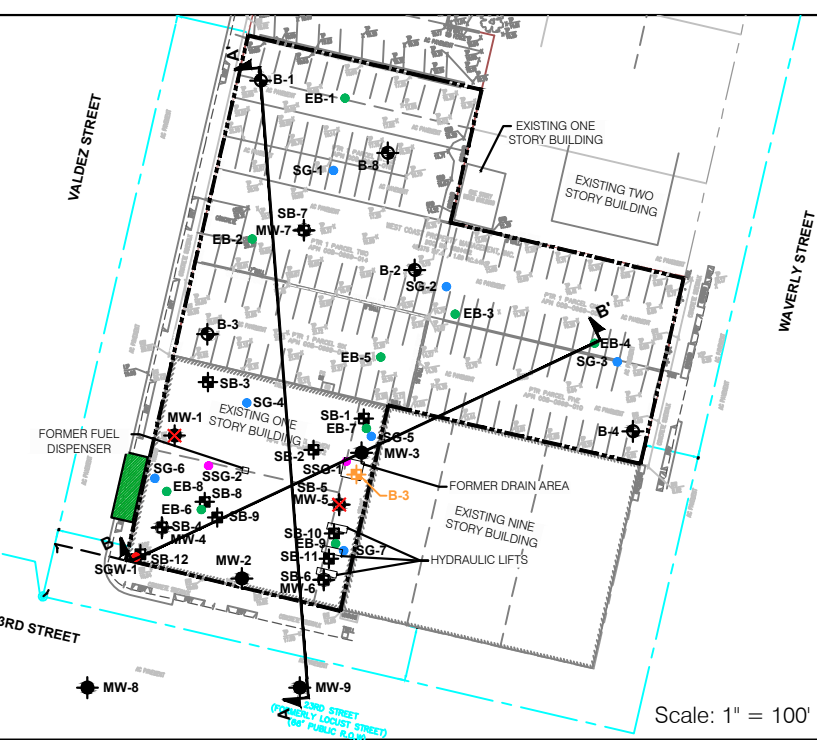

**2302-2332 VALDEZ STREET
 2321-2335 WAVERLY STREET
 Oakland, California**

**IDEALIZED SUBSURFACE PROFILE
 A-A'**

Date 12/21/15	Project No. 731641601	Figure 3
---------------	-----------------------	----------

LANGAN TREADWELL ROLLO

\\langan.com\data\SF\data6\731641601\Cadd Data - 731641601\2D-DesignFiles\Environmental\Figure 3 & 4.dwg 12/21/15

Date Sampled: 8/89

SB-12	
SB-4	
SB-9	
SB-2	
Total Oil & Grease	
Depth	Concentration
6	<6
11	<6
16	<6

TABLE A

B-3 (See note 3)

Concentration	
Total Oil & Grease	5,400
TPHg	40

Date Sampled: 2/1998

EB-7-1.5

Concentration					
As	3.8	Cu	16	Mo	0.56
Ba	150	Pb	170	Ni	24
Cr	35	Pb(STLC)	4.1	V	28
Co	7.8	Hg	0.34	Zn	170

Date Sampled: 2/7/15

EB-4-1.5

Concentration	
Sb	1.8
As	6.7
Ba	350
Be	0.57
Cd	0.51
Cr	45
Co	13
Cu	52
Pb	190
Pb(STLC)	8.5
Hg	0.45
Mo	0.57
Ni	44
V	42
Zn	180

Date Sampled: 9/6/14

EB-4-3.0

Concentration	
Cr	45
Pb	310
Pb(STLC)	26
Ni	38
Zn	65

Date Sampled: 9/6/14

EB-4-8.0

Concentration	
Cr	12
Pb	2.6
Ni	7.8
Zn	43

Date Sampled: 9/6/14

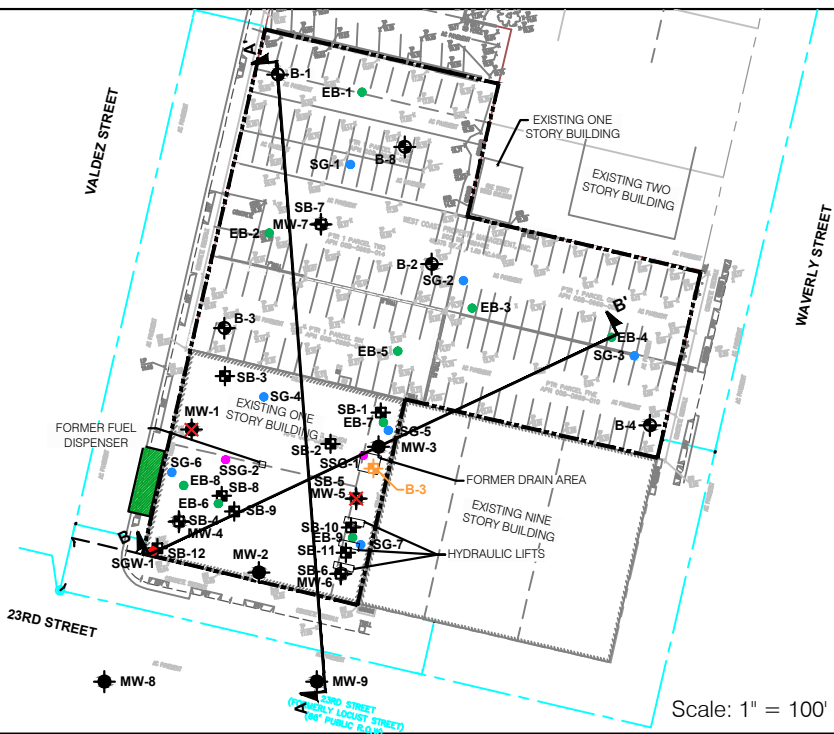
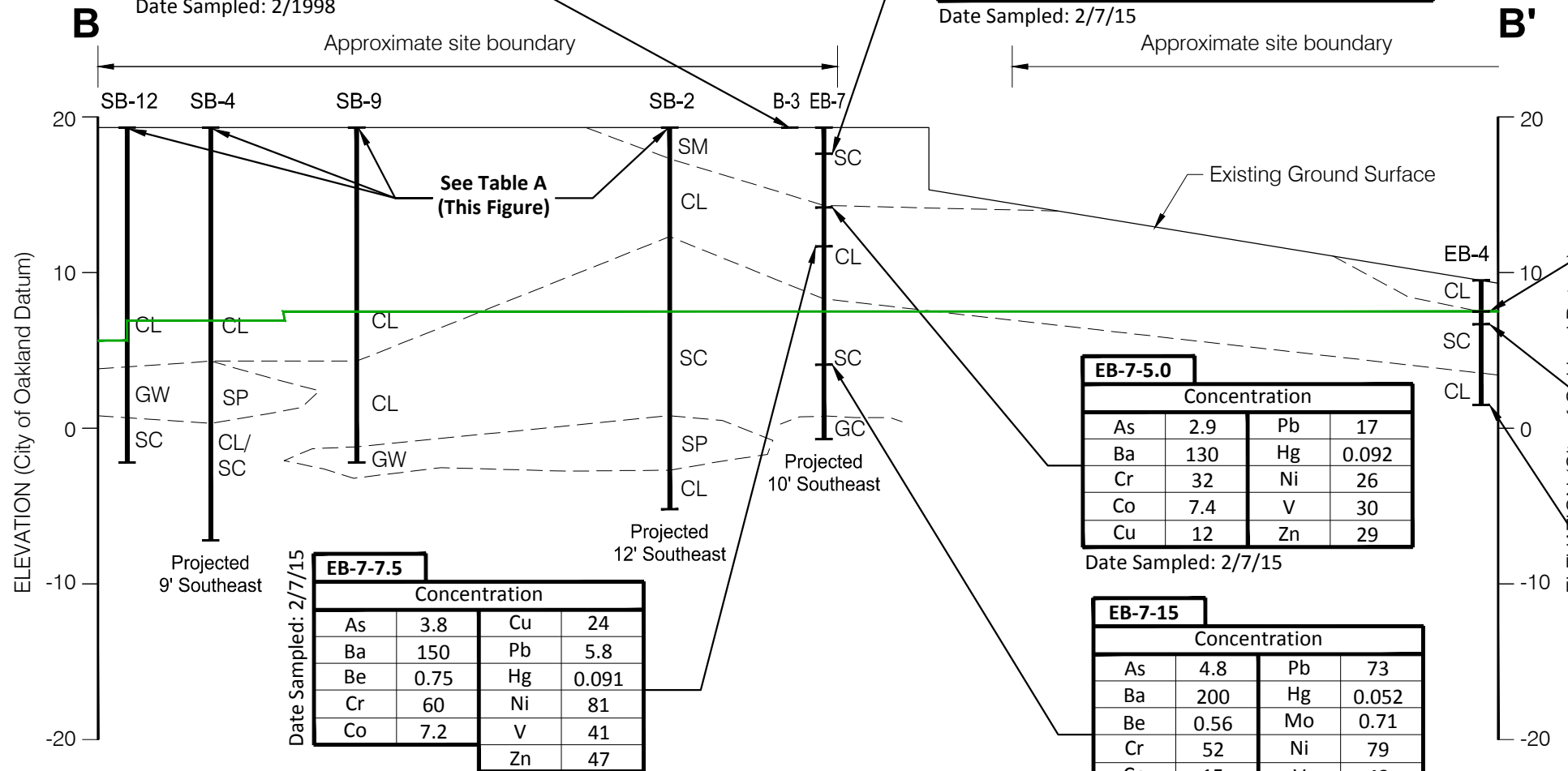

Scale: 1" = 100'

EXPLANATION

- Excavation Depth
- TPH-g (mg/L), total petroleum hydrocarbons, gasoline range

- Sb - Antimony
- As - Arsenic
- Ba - Barium
- Be - Beryllium
- Cd - Cadmium
- Cr - Chromium
- Co - Cobalt
- Cu - Copper
- Pb - Lead
- Hg - Mercury
- Mo - Molybdenum
- Ni - Nickel
- V - Vanadium
- Zn - Zinc

USCS CLASSIFICATION

- GW Well-graded gravels or gravel-sand mixtures, little or no fines
- GC Clayey gravels, gravel-sand-clay mixtures
- SP Poorly graded sands or gravelly sands, little or no fines\
- SM Silty sands, sand-silt mixtures
- SC Clayey sands, sand-clay mixtures
- CL Inorganic clays of low to medium plasticity, sand silts, gravelly silts

Notes:

1. The above profile represents a generalized soil cross section interpreted from widely spaced borings. Soil deposits may vary in type, strength, and other important properties between points of exploration.
2. Excavation depths taken from BKF's Excavation plan dated 11/16/15.
3. Location of soil boring B-3 provided by GRIBI Associates, Figures 3 & 4. Depth of soil boring is unknown.

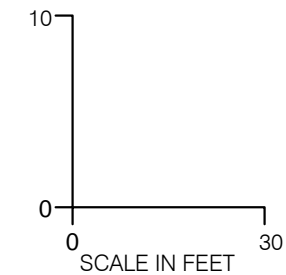

**2302-2332 VALDEZ STREET
2321-2335 WAVERLY STREET
Oakland, California**

**IDEALIZED SUBSURFACE PROFILE
B-B'**

Date 12/21/15	Project No. 731641601	Figure 4
---------------	-----------------------	----------

LANGAN TREADWELL ROLLO