

Cathedral Gardens Oakland, L.P.

2169 East Francisco Boulevard, Suite EAH
San Rafael, CA 94901
(415) 295-8857

November 21, 2014

Mr. Jerry Wickham
Alameda County Department of Environmental Health
1131 Harbor Bay Parkway, Suite 250
Alameda, CA 94502

SUBJECT: SOIL GAS WELL DESTRUCTION REPORT CERTIFICATION
RO 0003138
Cathedral Gardens
638 21st Street
Oakland, California

Dear Mr. Wickham:

You will find enclosed one copy of the following document prepared by P&D Environmental, Inc. for the subject site.

- Soil Gas Well Destruction Report dated November 21, 2014 (document 0553.R6).

I declare, under penalty of perjury, that the information and/or recommendations contained in the above-mentioned work plan for the subject site is true and correct to the best of my knowledge.

Please don't hesitate to call me if you have any questions.

Sincerely,

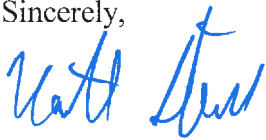

Matt Steinle
EAH, Inc. for
Cathedral Gardens Oakland, L.P.

0553.L9

P&D ENVIRONMENTAL, INC.

55 Santa Clara Ave, Suite 240
Oakland, CA 94610
(510) 658-6916

November 21, 2014
Report 0553.R6

Mr. Matt Steinle
EAH Housing
2169 East Francisco Blvd, Suite EAH
San Rafael, CA 94901

SUBJECT: SOIL GAS WELL DESTRUCTION REPORT
County File # RO 0003138
Cathedral Gardens
638 21st Street
Oakland, CA

Dear Mr. Steinle:

P&D Environmental, Inc. (P&D) has prepared this report documenting the destruction of one soil gas well designated as SG1 at the subject site.

The well was destroyed in accordance with Alameda County Public Works Agency (ACPWA) permit requirements (permit number W2014-1109) on November 19, 2014 by IMX, Inc. (IMX) of Oakland, California by hand augering to a depth of 5.0 feet using a 4-inch outside diameter hand auger. The borehole was then filled with neat cement to approximately one half foot below the ground surface. The well box for the well was removed, and the void space created by removal of the well box was filled with soil and covered with wood chips to match the surrounding landscaping. Mr. Sam Brathwaite was present to observe and document grouting of the well on behalf of ACPWA.

A Site Location Map is attached as Figure 1, a Site Vicinity Aerial Photograph showing the soil gas well location is attached as Figure 2, and a Site Plan Detail showing the soil gas well location is attached as Figure 3. A copy of the well destruction permit (Appendix A) is attached with this report.

All waste generated during well destruction activities was removed from the site by IMX for disposal at a local landfill.

November 21, 2014
Report 0553.R6

Should you have any questions, please do not hesitate to contact us at (510) 658-6916.

Sincerely,

P&D Environmental, Inc.



Paul H. King
California Professional Geologist #5901
Expires: 12/31/15



Attachments:

Figure 1 - Site Location Map

Figure 2 – Site Vicinity Aerial Photograph Showing Soil Gas Well Location

Figure 3 - Site Plan Detail Showing Soil Gas Well Location

Appendix A - ACPWA Permit for Soil Gas Well Destruction

PHK/sjc
0553.R6

FIGURES

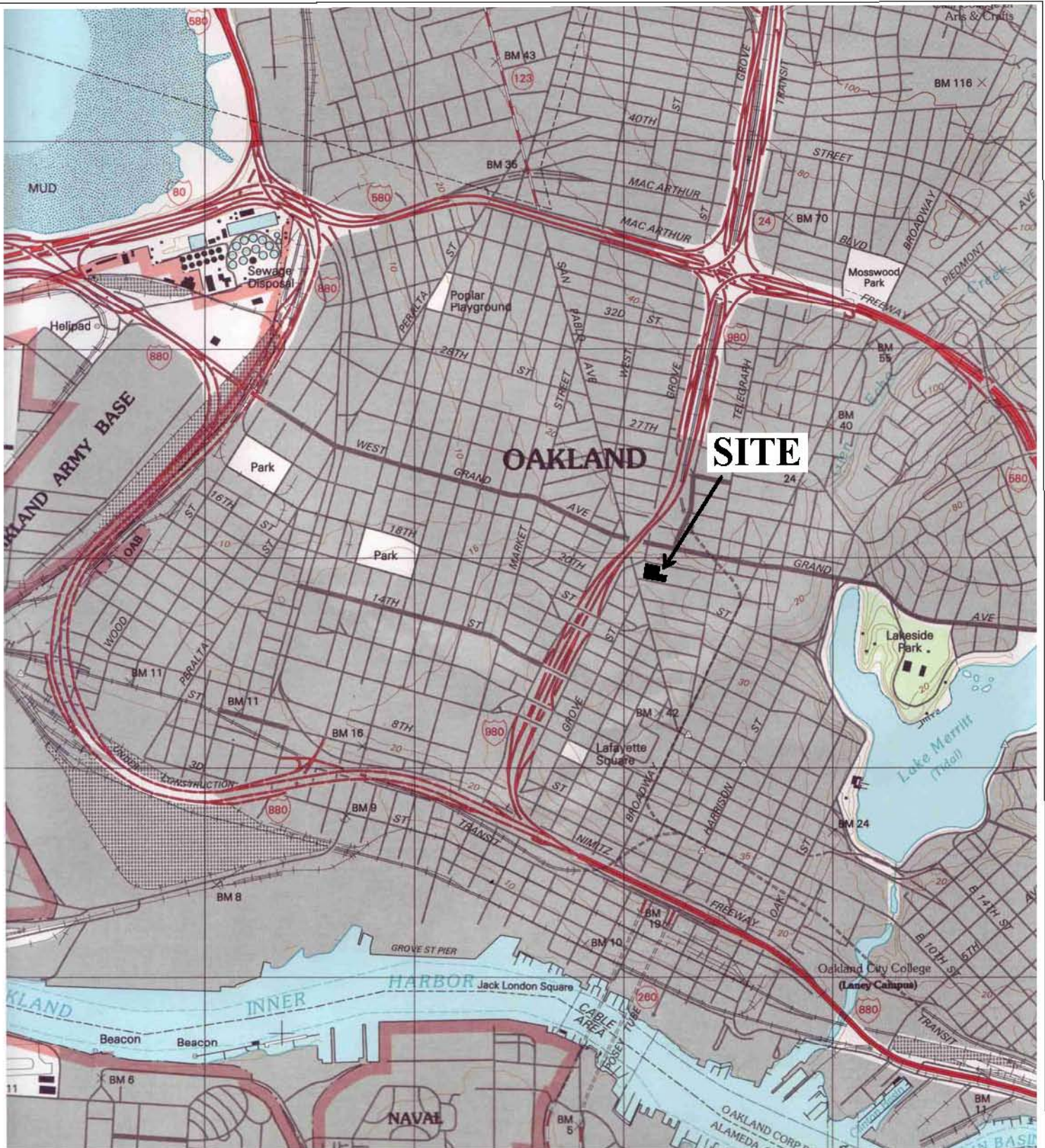
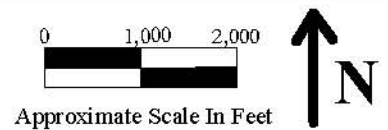

Figure 1
 Site Location Map
 Cathedral Gardens
 638 21st Street
 Oakland, California

Base Map From:
 U. S. Geological Survey
 Oakland West, California
 7.5-Minute Quadrangle
 Photorevised 1993

P&D Environmental, Inc.
 55 Santa Clara Ave., Suite 240
 Oakland, CA 94610





LEGEND

SG1
 • Soil Gas Well Location

Figure 2
 Site Vicinity Aerial Photograph Showing Soil Gas Well Location
 Cathedral Gardens
 638 21st Street
 Oakland, California

Base Map From:
 U.S. Geological Survey
 Oakland West, California
 7.5-Minute Quadrangle
 Photorevised 1993

P&D Environmental, Inc.
 55 Santa Clara Ave., Suite 240
 Oakland, CA 94610

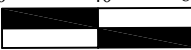
0 40 80

 Approximate Scale In Feet



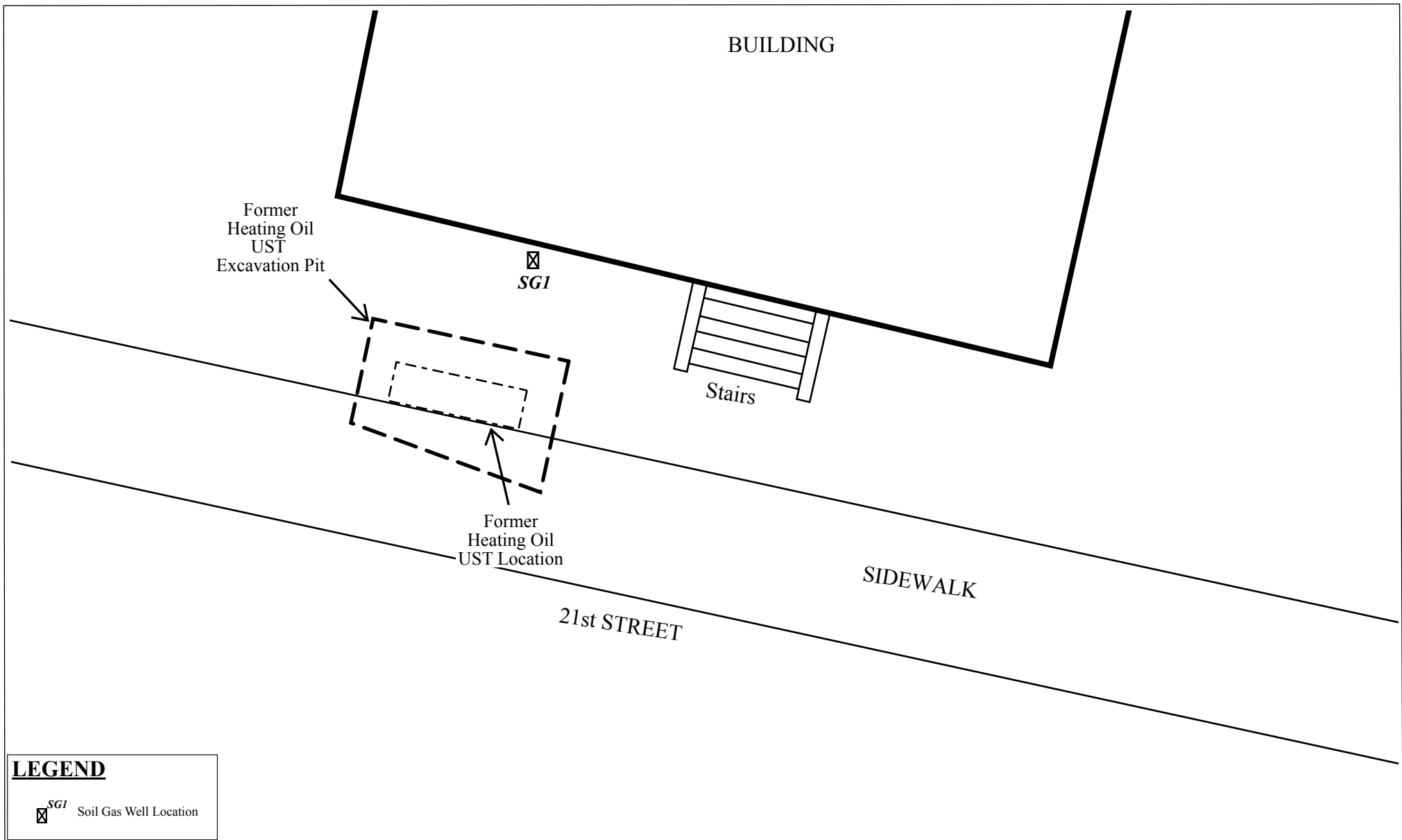
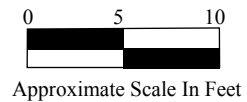

Figure 3
 Site Plan Detail Showing Soil Gas Well Location
 Cathedral Gardens
 638 21st Street
 Oakland, California

Base Map From:
 Basics Environmental, Limited Phase II
 Environmental Site Sampling Report,
 dated June 27, 2011

P&D Environmental, Inc.
 55 Santa Clara Avenue
 Oakland, CA 94610



APPENDIX A
ACPWA PERMIT FOR SOIL GAS WELL
DESTRUCTION

Alameda County Public Works Agency - Water Resources Well Permit

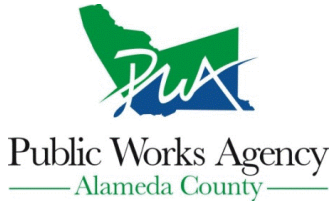

399 Elmhurst Street
Hayward, CA 94544-1395
Telephone: (510)670-6633 Fax:(510)782-1939

Application Approved on: 11/17/2014 By jamesy

Permit Numbers: W2014-1109
Permits Valid from 11/18/2014 to 11/18/2014

Application Id: 1416010321170
Site Location: 638 21st Street
Project Start Date: 11/18/2014

City of Project Site:Oakland

Completion Date:11/18/2014

Assigned Inspector: Contact Sam Brathwaite at (925) 570-7609 or sbrathwaite@groundzonees.com

Applicant: P&D Environmental, Inc. - Steven Carmack
55 Santa Clara Ave., Suite 240, Oakland, CA 94610

Phone: 510-658-6916

Property Owner: Cathedral Gardens Oakland, L.P. (contact -

Phone: 415-295-8857

Benny Kwong EAH, Inc.)
2169 East Francisco Boulevard, Suite EAH, San Rafael, CA 94901

Client: ** same as Property Owner **

Contact: Michael Bass-Deschenes

Phone: 510-658-6916

Cell: 510-387-6206

	Total Due:	\$265.00
Receipt Number: WR2014-0473	Total Amount Paid:	\$265.00
Payer Name : Paul H King	Paid By: VISA	PAID IN FULL

Works Requesting Permits:

Remediation Well Destruction-Vapor Remediation Well - 1 Wells
Driller: IMX INC - Lic #: 537261 - Method: Hand

Work Total: \$265.00

Specifications

Permit #	Issued Date	Expire Date	Owner Well Id	Hole Diam.	Casing Diam.	Seal Depth	Max. Depth	State Well #	Orig. Permit #	DWR #
W2014-1109	11/17/2014	02/16/2015	SG1	1.50 in.	1.50 in.	1.00 ft	5.00 ft		W2014-0665	

Specific Work Permit Conditions

1. Permittee shall assume entire responsibility for all activities and uses under this permit and shall indemnify, defend and save the Alameda County Public Works Agency, its officers, agents, and employees free and harmless from any and all expense, cost, liability in connection with or resulting from the exercise of this Permit including, but not limited to, properly damage, personal injury and wrongful death.
2. Permittee, permittee's contractors, consultants or agents shall be responsible to assure that all material or waters generated during drilling, boring destruction, and/or other activities associated with this Permit will be safely handled, properly managed, and disposed of according to all applicable federal, state, and local statutes regulating such. In no case shall these materials and/or waters be allowed to enter, or potentially enter, on or off-site storm sewers, dry wells, or waterways or be allowed to move off the property where work is being completed.
3. Compliance with the well-sealing specifications shall not exempt the well-sealing contractor from complying with appropriate State reporting-requirements related to well destruction (Sections 13750 through 13755 (Division 7, Chapter 10, Article 3) of the California Water Code). Contractor must complete State DWR Form 188 and mail original to the Alameda County Public Works Agency, Water Resources Section, within 60 days. Include permit number and site map.
4. Applicant shall submit the copies of the approved encroachment permit to this office within 60 days.
5. Applicant shall contact assigned inspector listed on the top of the permit at least five (5) working days prior to starting,

Alameda County Public Works Agency - Water Resources Well Permit

once the permit has been approved. Confirm the scheduled date(s) at least 24 hours prior to drilling.

6. Remove the Christy box or similar structure. Destroy well(s) by overdrilling to total depth & Tremie Grouting with Cement. After the seal has set, backfill the remaining hole with concrete or compacted material to match existing.

7. Copy of approved drilling permit must be on site at all times. Failure to present or show proof of the approved permit application on site shall result in a fine of \$500.00.

8. Prior to any drilling activities onto any public right-of-ways, it shall be the applicants responsibilities to contact and coordinate a Underground Service Alert (USA), obtain encroachment permit(s), excavation permit(s) or any other permits required for that City or to the County and follow all City or County Ordinances. It shall also be the applicants responsibilities to provide to the Cities or to Alameda County a Traffic Safety Plan for any lane closures or detours planned. No work shall begin until all the permits and requirements have been approved or obtained.
