

LAW OFFICE OF
DILLINGHAM & MURPHY, LLP

601 CALIFORNIA STREET

SUITE 1900

SAN FRANCISCO, CALIFORNIA 94108

TELEPHONE (415) 397-2700

FAX (415) 397-3300

www.dillinghammurphy.com

RECEIVED

By Alameda County Environmental Health at 4:13 pm, May 20, 2014

May 19, 2014

Alameda County Environmental Health Department
Attention: Jerry Wickham
1131 Harbor Bay Parkway, Suite 250
Alameda, CA 94502-6577

Re: Byron Power Company, 4901 Bruns Rd., Byron CA

Dear Mr. Wickham:

Attached please find a report, entitled Monitoring Well Abandonment Report, dated May 19, 2014, prepared for Byron Power Company by Quest GeoSystems. As a legal authorized representative of Byron Power, I declare under penalty of perjury that, on information and belief, the information and/or recommendations contained in the attached documents and/or reports are true and correct to the best of my knowledge.

Very truly yours,

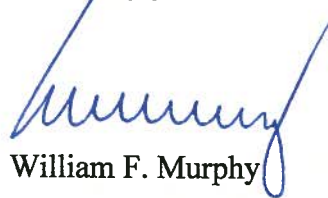

William F. Murphy

Encl.



May 19, 2014

Quest GSM# G04152014-01

Mr. Jerry Wickham
Alameda County Environmental Health Services
Environmental Protection
1131 Harbor Bay Parkway, Suite 250
Alameda, CA 94502-6577

**SITE: SLIC CASE RO0003079; GEOTRACKER GLOBAL ID T1000003401
BYRON POWER COMPANY
4901 BRUNS ROAD
BYRON, CALIFORNIA 94514**

RE: MONITORING WELL ABANDONMENT REPORT

Dear Mr. Wickham,

Quest GeoSystems Management, Inc. (Quest) has prepared this report to document the results of the monitoring well destructions completed at the above referenced facility in Byron, California (Figure 1). The site activities were completed in response to requirements from the Alameda County Environmental Health Services (ACEHS) in a letter dated April 8, 2014.

1 SITE ACTIVITIES

1.1 PREFIELD ACTIVITIES

Prior to initiating field activities, Quest obtained well destruction permit (2014056) from the Zone 7 Water Agency (Zone 7). The permit allowed for the monitoring wells to be abandoned in place. All monitoring well destruction locations were pre-marked with white paint and Underground Service Alert (USA) was notified a minimum of 48 hours prior to the well destructions, so as to allow the local utilities to identify potential subsurface utilities in the area. Copies of the well destruction permits are included as Attachment A.

1.2 WELL DESTRUCTION

On May 6, 2014, Quest personnel supervised Woodward Drilling Company, Inc. (Woodward) of Rio Vista, California in the destruction of the four (4) onsite monitoring wells (MW-1 through MW-4). Woodward filled each casing with cement grout sealing material to two feet below the finished grade and pressurized the well head to 25 psi for 5 minutes, forcing the sealing material through the existing perforations and into the surrounding formation. Woodward subsequently, removed the pressure apparatus, refilled the empty portion of the casing with grout allowing it to spill over the top of the casing to form a cap, and then cut and removed each well casing to two feet below the finished grade. The remaining hole was backfilled and compacted with locally derived gravel.

1.3 WASTE DISPOSAL

The monitoring wells were abandoned in place and therefore no soil and waste water were generated during well destruction activities.

1.4 WELL LOGS COMPLETION FORMS

Department of Water Resources (DWR) Well Completion Reports were completed and submitted to the Zone 7. Copies of the DWR Well Completion Reports are included in Attachment A.

2 CERTIFICATION

Quest certifies that the destruction of the above stated monitoring wells were completed consistent with Zone 7 requirements, DWR Bulletin No. 74-81, and DWR Supplement No. 74-90. The well destructions were completed under the direct supervision of a California Professional Geologist.

3 CLOSING

It is Quests' understanding that, with the completion of the destruction of the onsite monitoring wells, ACEHS will continue with the case closure process. Should you have any questions or comments, please feel free to contact me directly in our Rancho Cordova, California office at (925) 756-1210.

Sincerely,

Quest GeoSystems Management, Inc.



Eric W. Garcia, CHG, CEG
Principal Geologist
PG #7007, CHG# 765 / CEG# 2230

May 19, 2014
Date

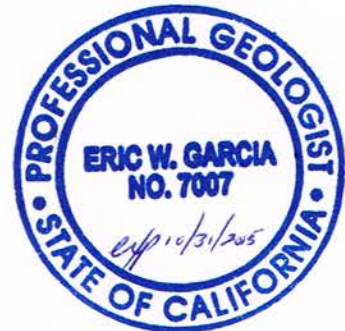

Attachments:

cc: Mr. William F. Murphy, Dillingham & Murphy, LLP
File

ATTACHMENT A
WELL DESTRUCTION DOCUMENTATION

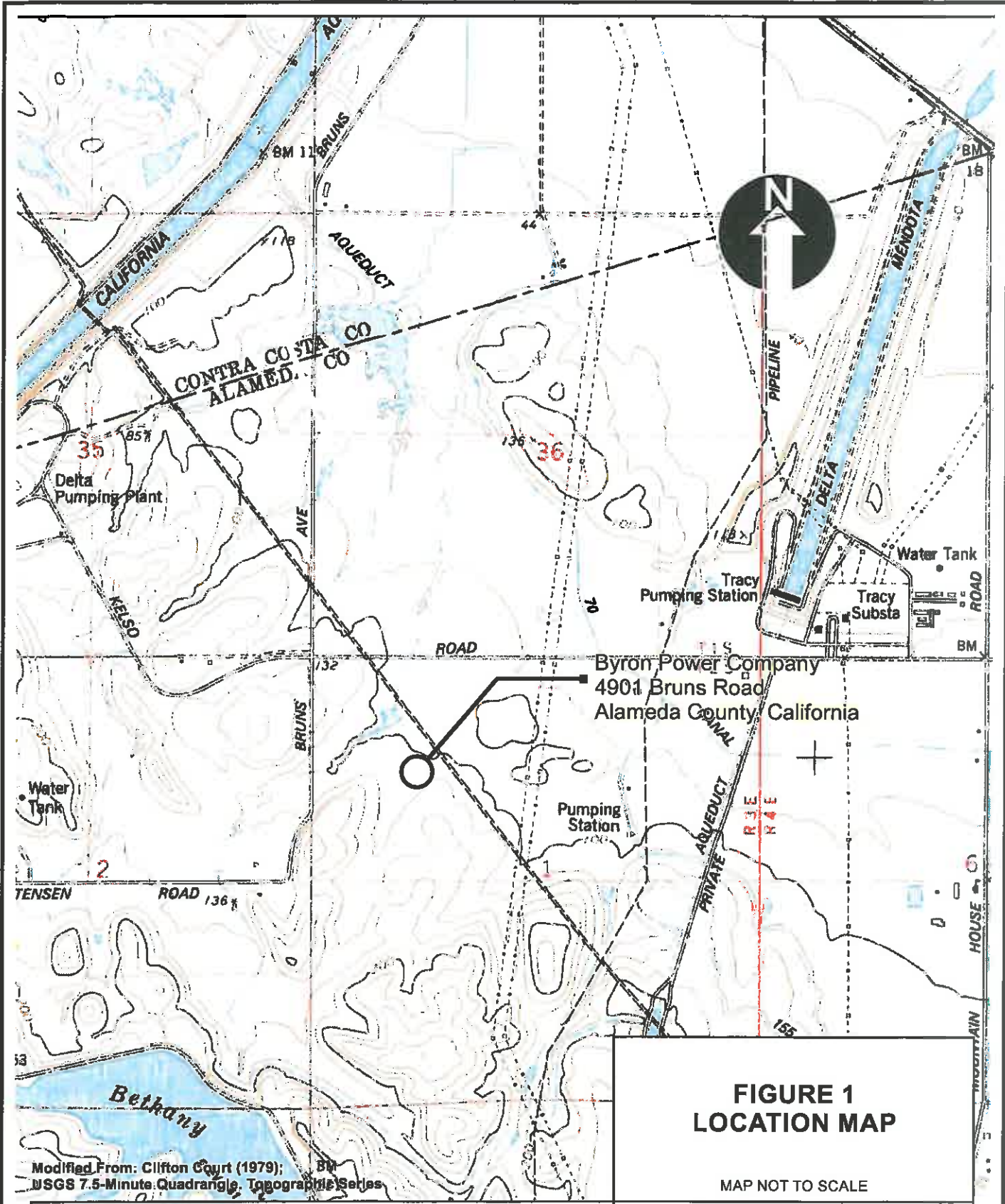

**FIGURE 1
LOCATION MAP**

MAP NOT TO SCALE

Modified From: Clifton Court (1979);
USGS 7.5-Minute Quadrangle, Topographic Series

Project Name: Byron Power Company
4901 Bruns Road, Alameda County, California

Project No.:
G09212012-02

Drafter: EWG
Review: EWG

Revision Date:
10/20/2012



QUEST GEOSYSTEMS MANAGEMENT
11275 Sunrise Gold Circle, Suite R
Rancho Cordova, CA 95742
(925) 756-1210 · (925) 756-1227 Fax



ZONE 7 WATER AGENCY

100 NORTH CANYONS PARKWAY, LIVERMORE, CALIFORNIA 94551 VOICE (925) 454-5000 FAX (925) 245-9306
E-MAIL whong@zone7water.com

DRILLING PERMIT APPLICATION

FOR APPLICANT TO COMPLETE

FOR OFFICE USE

LOCATION OF PROJECT Byron Power Company
4901 Bruns Road, Byron, CA 94514

PERMIT NUMBER 2014056
WELL NUMBER 2S/3E-1C2 to 1C5 (MW-1 to MW-4)
APN 99B-7050-001-10

Coordinates Source _____ ft. Accuracy ✓ _____ ft.
LAT: 37.791719 ft. LONG: -121.60051 ft.
APN 99B-7050-1-10

PERMIT CONDITIONS
(Circled Permit Requirements Apply)

CLIENT
Name Dan Gulino - Byron Power Partners, L.P.
Address 14 Philips Parkway Phone (201) 447-9000
City Montvale, NJ Zip 07645

- A. GENERAL**
1. A permit application should be submitted so as to arrive at the Zone 7 office five days prior to your proposed starting date.
 2. Submit to Zone 7 within 60 days after completion of permitted work the original **Department of Water Resources Water Well Drillers Report (DWR Form 188), signed by the driller.**
 3. Permit is void if project not begun within 90 days of approval date.
 4. **Notify Zone 7 at least 24 hours before the start of work.**

APPLICANT
Name Eric Garcia - Quest GeoSystems Management, Inc.
Email EWG@QUESTGSM.COM Fax (925) 756-1227
Address 11275 Sunrise Gold Cir, Ste R Phone (925) 756-1210
City Rancho Cordova, CA Zip 95742

- B. WATER SUPPLY WELLS**
1. Minimum surface seal diameter is four inches greater than the well casing diameter.
 2. Minimum seal depth is 50 feet for municipal and industrial wells or 20 feet for domestic and irrigation wells unless a lesser depth is specially approved.
 3. Grout placed by tremie.
 4. An access port at least 0.5 inches in diameter is required on the wellhead for water level measurements.
 5. A sample port is required on the discharge pipe near the wellhead.

TYPE OF PROJECT:
Well Construction _____ Geotechnical Investigation _____
Well Destruction Contamination Investigation _____
Cathodic Protection _____ Other _____

- C. GROUNDWATER MONITORING WELLS INCLUDING PIEZOMETERS**
1. Minimum surface seal diameter is four inches greater than the well or piezometer casing diameter.
 2. Minimum seal depth for monitoring wells is the maximum depth practicable or 20 feet.
 3. Grout placed by tremie.

PROPOSED WELL USE:
Domestic _____ Irrigation _____
Municipal _____ Remediation _____
Industrial _____ Groundwater Monitoring _____
Dewatering _____ Other _____

- D. GEOTECHNICAL.** Backfill bore hole with compacted cuttings or heavy bentonite and upper two feet with compacted material. In areas of known or suspected contamination, tremied cement grout shall be used in place of compacted cuttings.

DRILLING METHOD:
Mud Rotary _____ Air Rotary _____ Hollow Stem Auger
Cable Tool _____ Direct Push _____ Other _____

- E. CATHODIC.** Fill hole above anode zone with concrete placed by tremie.

DRILLING COMPANY Woodward Drilling Company, Inc.
PO BOX 336, Rio Vista, CA 94571
DRILLER'S LICENSE NO. 710079

- F. WELL DESTRUCTION.** See attached.
- G. SPECIAL CONDITIONS.** Submit to Zone 7 within 60 days after completion of permitted work the well installation report **including all soil and water laboratory analysis results.**

WELL SPECIFICATIONS:
Drill Hole Diameter 8 in. Maximum _____
Casing Diameter 2 in. Depth 35 ft.
Surface Seal Depth 11 ft. Number 4

SOIL BORINGS:
Number of Borings _____ Maximum _____
Hole Diameter _____ in. Depth _____ ft.

ESTIMATED STARTING DATE 05/06/2014
ESTIMATED COMPLETION DATE 05/07/2014

I hereby agree to comply with all requirements of this permit and Alameda County Ordinance No. 73-68.

Approved Wyman Hong Date 4/22/14
Wyman Hong

APPLICANT'S SIGNATURE [Signature] Date 04/16/2014

ATTACH SITE PLAN OR SKETCH

April 24, 2014

**Zone 7
Water Resources Engineering
Groundwater Protection Ordinance**

Byron Power Partners
4901 Bruns Road
Byron
Wells 2S/3E-1C2 to 2S/3E-1C5(MW-1 to MW-4)
Permit 2014056

Destruction Requirements:

1. Remove from the well any pump, appurtenances, debris, or other materials.
2. Sound the well as deeply as practicable and record for your report.
3. Fill casing with neat cement or cement grout sealing material to two feet below the finished grade and pressurize to 25 psi and maintain for 5 minutes, forcing the sealing material through the existing perforations and into the surrounding formation.
4. Release the pressure and refill the empty portion of the casing with grouting material allowing it to spill over the top of the casing to form a cap.
5. Cut and remove any casing(s) to two feet below the finished grade or original ground, whichever is the lower elevation (optional).
6. After seal has set, backfill the remaining hole with compacted material.

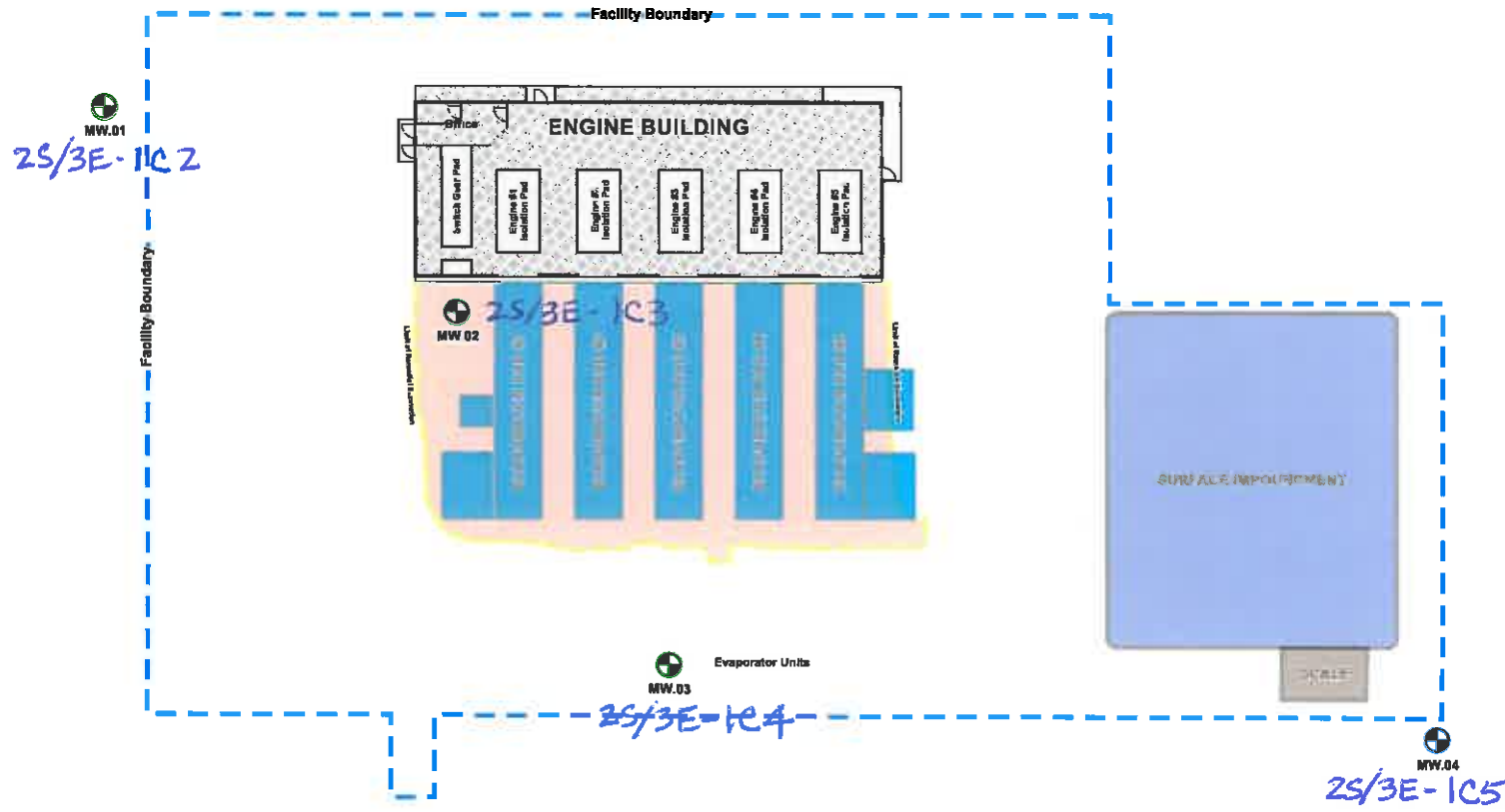

EXPLANATION

Monitoring Well Locations
MW.04

Concrete Pad w/Gravel Base



APPROXIMATE SCALE:
1 Inch = 30 Feet

**FIGURE 2
SITE MAP DEPICTING
WELL ABANDONMENT
LOCATIONS**

Project Name: Byron Power Company
4901 Bruns Road, Alameda County, California

Project No.: G04152014-01	Drafter: EWG Reviewer: EWG	Revision Date: 04/16/2014
------------------------------	-------------------------------	------------------------------



QUEST GeOSYSTEMS MANAGEMENT, INC.
11275 Sunrise Gold Circle, Suite R
Rancho Cordova, CA 95742
(925) 758-1210 • (925) 758-1227 Fax

Modified From: Google Earth (03/29/2013)



Quick Links

Search ACGOV

Skip County Header

<< [Assessor Homepage](#)

Parcel Viewer
Alameda County Office of Assessor

Overview Details

998 7050 1 10

Site Address: 4901 BRUNS RD 95391

[Assessor Parcel Information](#)

[Tax Information](#)

If you close this window click on the highlighted parcel to have the window redisplay.

more Streets Aerial

Parcel Search

BRUNS AVE

KELS0 RD

CONFIDENTIAL

STATE OF CALIFORNIA DWR
WELL COMPLETION REPORT
(WELL LOGS)

REMOVED

CONFIDENTIAL

STATE OF CALIFORNIA DWR
WELL COMPLETION REPORT
(WELL LOGS)

REMOVED

CONFIDENTIAL

STATE OF CALIFORNIA DWR
WELL COMPLETION REPORT
(WELL LOGS)

REMOVED

CONFIDENTIAL

STATE OF CALIFORNIA DWR
WELL COMPLETION REPORT
(WELL LOGS)

REMOVED