

CES Controlled Environmental Services

General Engineering & Construction

License #807330 A-Haz

PO Box 401, Oakley, CA 94561

Telephone (925) 625-1736

October 23, 2009

510-222-1421

Mr. Athan Magganas
2550 Appian Way Suite 20
Pinole, CA 94564

RE: Tank Removal Report/Closure for 6501 Shattuck Avenue in Oakland, CA

Permits:

CES obtained permits from the Oakland Fire Department as required.

UST – Content Removal and Cleaning:

CES pumped out and triple washed the (6) tanks on September 29, 2009. The product and rinse water was removed, transported with a vacuum truck and disposed of by Clearwater Environmental management Inc.

Tank Inerting:

On September 30, 2009, CES used dry ice to inert the tanks and test prior to cutting the tanks open to inspect the tanks to insure they were clean prior to removal and disposal. After cutting open the tanks, two tanks had a small amount of solids that needed to be removed prior to removing the tanks so CES rewashed those two tanks and once again Clearwater Environmental used a vacuum truck to remove transport and dispose of the waste generated by the cleaning activities.

Tank Removal:

On October 1, 2009, the tanks were inspected by the Oakland Fire Department and after the LEL was checked, CES used a backhoe to remove the (6) tanks and the tanks were loaded onto a trailer and transported to Sims Metals in Richmond California, to be recycled as non hazardous. Upon removing the tanks, several holes were noted in (4) of the (6) tanks. Tanks # 1,2,5,6 had holes. After the tanks were removed, soil samples were collected at the direction of the Oakland Fire Department. Samples were taken under the tanks and from the sidewalls of the tank excavations as well as the stockpiled soil on site. After the sampling activities were completed, the stockpiled soil was covered with visqueen and the site was secured until the results were available.

Continued on Page Two

Page Two
October 23, 2009

Mr. Athan Magganas
2550 Appian Way Suite 20
Pinole, CA 94564

RE: Tank Removal Report/Closure for 6501 Shattuck Avenue in Oakland CA

Samples:

The samples were taken using a backhoe and collected from the backhoe bucket, CES used brass tubes with Teflon liners and caps with Teflon tape. The samples then were placed on ice in an ice chest and transported under a chain of custody to a certified laboratory for analysis.

All of the paperwork ie; manifest, chain of custody, lab results, scrap metal receipts are attached. A UST unauthorized release/leak report was completed and given to the owner to turn in to the Fire Department.

At this point CES has completed its work as authorized by the owner. At this time CES does not have any future work at the site authorized by the owner. CES is still talking to and trying to help direct the owner as to the best solutions for the site. The owner wants to do what is required to get the site cleaned up.

CES Controlled Environmental Services enjoyed working with you on this project. We trust that you will find everything in order. If you have any questions or concerns, please feel free to call me at (925) 625-1736.

Respectfully yours,

CES Controlled Environmental Services
A California Corporation

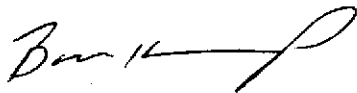

Bob J. Kemp
Vice President

BUILDING

Over
Head
Lines

9-21-09

65th ST

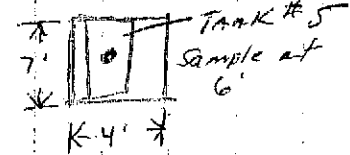

TANK #6
Sampled at
14' below grade

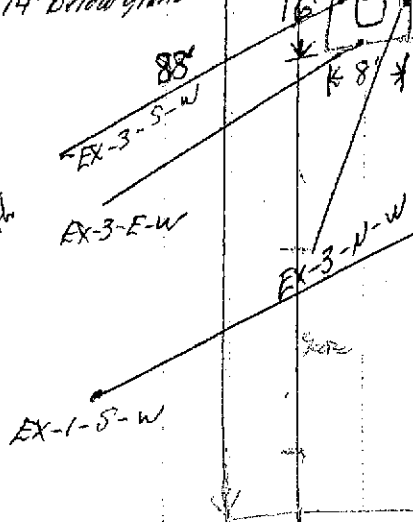

BLD 8
FORMER
GAS STATION

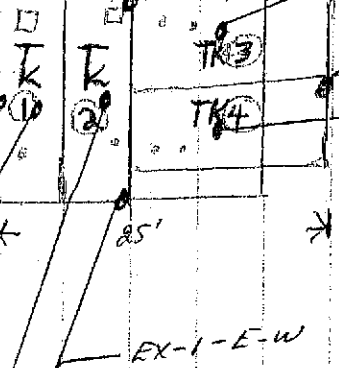

TANK #3
sampled at
13' DEPT

TANK #4
sampled at
13' DEPT

TANK #1
Sample at
DEPT - 15'

TANK #2
sampled at
13' DEPT

6501 SHATTUCK AVE OAKLAND CA

GATE

Shattuck Ave

North

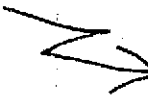

EAST

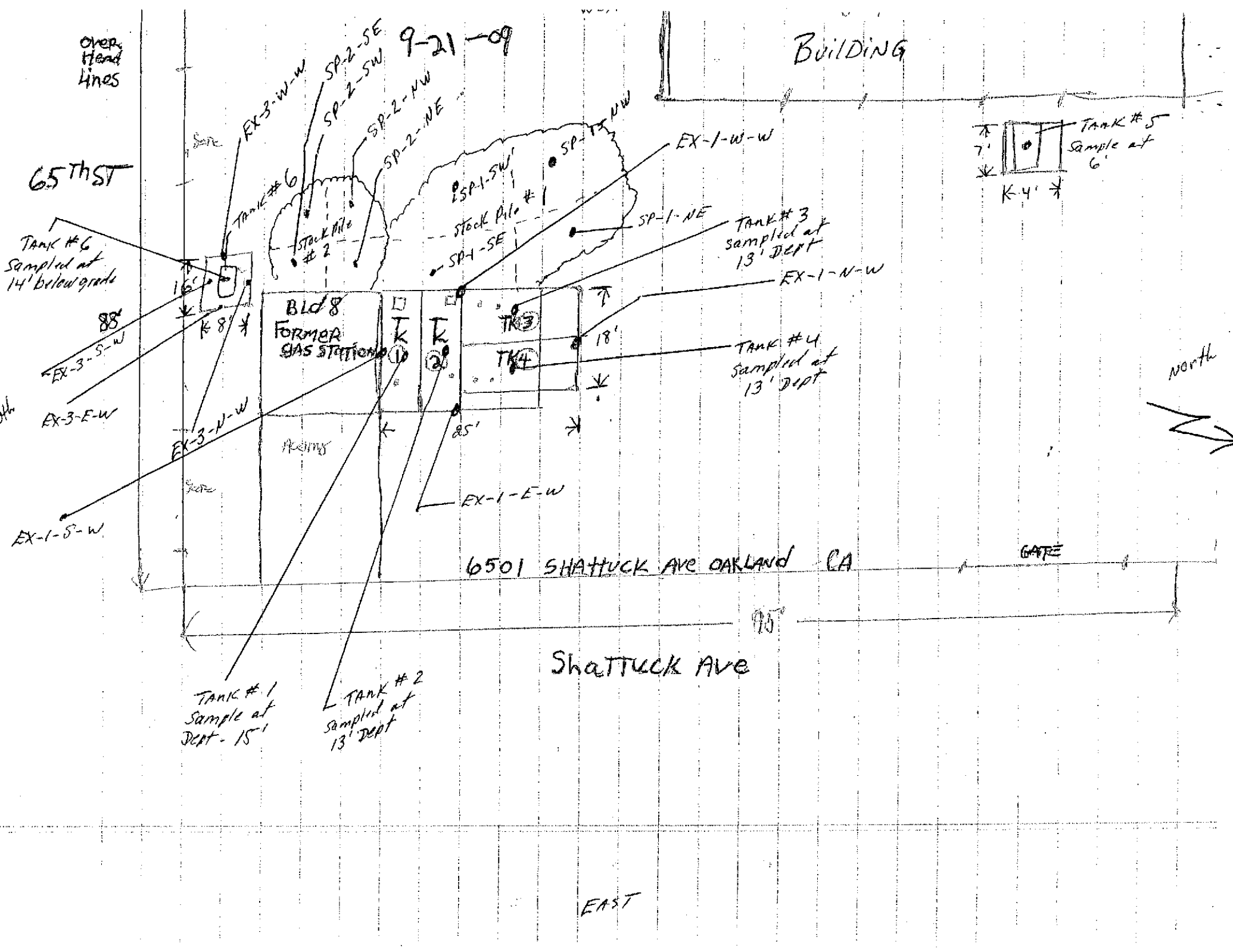

Excavation dimension and dept of tanks. For Athan Magganas
located at 6501 Shattuck ave, Oakland, ca

Excavation # 1

Tank #1,2,3,4 is located in excavation # 1. Tank bottoms are 10 feet below grade, and excavation dimensions in 18 feet by 25 feet.

Excavation #2

Tank# 5(55 oil drum) . Tank bottom is 4 feet below grade, excavation dimension is 4 feet by 7 feet .

Excavation# 3

Tank # 6 is located on south end of lot. Tank bottom is 7 feet 6 inches below grade. Excavation dimensions is 8 feet by 16 feet.

Abbreviations

T- means Tanks

EX-1- means excavation area #1

EX-2- means excavation area #2

EX-3- means excavation area # 3

SP-1- means stockpile # 1

SP-2- means stockpile # 2

Comments:

Tank #1 and 2 had hole's in bottom and at end of tanks.

Tank # 5 which is a 55 gal drum had hole in botton of drum.

Tank # 6 had hole's in bottom of tank.

Tank#1 and tank#2 are 1,000 gal steel tanks.

Tank#3,4,6 turned out to be 2,000 gal steel tanks.

Tank#5 is a 55 gal drum layed down and used for recycled oil.

Comments(continued)

Ground water was observed in Excavation # 1 at a dept of 11 feet below grade.

Ground water was also observed in Excavation# 3 at a dept of 7 feet below grade and has fuel residue on top of water.

Sample log for Athan Magganas located at 6501 shattuck
ave, Oakland, ca

T-4 Sample taken at 13 feet below grade using backhoe bucket.
T-3 Sample taken at 13 feet below grade using back hoe bucket.
T-2 Sample taken at 13 feet below grade using back hoe bucket.
T-1 Sample taken at 15 feet below grade using back hoe bucket.
T-5 Sample taken at 6 feet below grade using back hoe bucket.

Method for side wall sampling was the use of hand auger and a slide hammer with extentions with sample tubes to get side wall samples in excavation. This method was only used in excavation #1 and #3. No side wall samples were taken from excavation #2 due to a shallow dept.

EX-1-E-W Side wall sample at 13 feet below grade on east wall.
EX-1-N-W Side wall sample at 10 feet below grade on west wall.

Grab samples- 4 point composite from stockpile #1

SP-1-NE Sample taken from center of stockpile in north east corner.

SP-1-NW Sample taken from center of stockpile in north west corner.

SP-1-SE Sample taken from center of stockpile in south east corner.

SP-1-SW Sample taken from center of stockpile in south west corner.

Grab samples- 4 point composite from stockpile #2

SP-2-SW Sample taken from center of stockpile in south west corner.

SP-2-NW Sample taken from center of stockpile in north west corner.

SP-2-SE Sample taken from center of stockpile in south east corner.

SP-2-NE Sample taken from center of stockpile in north east corner.

T-6 Sample taken at 14 feet below grade.

EX-1-S-W Side wall sample taken at 12 feet below grade on south wall.

EX-1-W-W Side wall sample taken at 13 feet below grade on west wall.

EX-3-E-W Side wall sample taken at 13 feet below grade on east wall.

EX-3-N-W Side wall sample taken at 13 feet below grade on north wall.

EX-3-S-W Side wall sample taken at 12 feet below grade on south wall.

EX-3-W-W Side wall sample taken at 12 feet below grade on west wall.

**McC Campbell Analytical, Inc.**

"When Quality Counts"

1534 Willow Pass Road, Pittsburg, CA 94565-1701
Web: www.mcccampbell.com E-mail: main@mcccampbell.com
Telephone: 877-252-9262 Fax: 925-252-9269

Controlled Env. Svcs. (CES) P.O. Box 401 Oakley, CA 94561	Client Project ID: #3041; Athan Magganas	Date Sampled: 10/01/09
		Date Received: 10/01/09
	Client Contact: Mike Pedersen	Date Reported: 10/08/09
	Client P.O.:	Date Completed: 10/08/09

WorkOrder: 0910023

October 08, 2009

Dear Mike:

Enclosed within are:

- 1) The results of the **16** analyzed samples from your project: **#3041; Athan Magganas**,
- 2) A QC report for the above samples,
- 3) A copy of the chain of custody, and
- 4) An invoice for analytical services.

All analyses were completed satisfactorily and all QC samples were found to be within our control limits.

If you have any questions or concerns, please feel free to give me a call. Thank you for choosing

McC Campbell Analytical Laboratories for your analytical needs.

Best regards,

Angela Rydelius
Laboratory Manager
McC Campbell Analytical, Inc.

7/20/81 10:00 AM 910-520-1487
 032990000 - 48000 510-223-4483

McCAMPBELL ANALYTICAL, INC.
 111 1st AVENUE SOUTH, 3RD
 FLOOR, OAKLEY, CA 94661

CHAIN OF CUSTODY RECORD

TURN AROUND TIME: RUSH 24 HOUR 48 HOUR 5 DAY

Telephone: (925) 798-1620 Fax: (925) 798-1627

Report To: MRB Pearson / Bob Kemp Bill To: *Alison Rayburn*

Company: Controlled Business and Services *2550 Airport Blvd*
San Jose, CA 95128
 P.O. Box 401
 Oakley, CA 94661

Phone: (925) 625-1734 Fax: (925) 673-2618

Project #: *3041* Project Name: *Alison Rayburn*

Project Location: *6301 Skyway Blvd, Oakland, CA*

Sample Number: *1-11*

Analysis Requested: _____ Other: _____ Comments: _____

SAMPLE ID	LOCATION	SAMPLING		ANALYSIS	METHOD	REMARKS
		Date	Time			
T-4	<i>San Jose</i>	<i>7/20</i>	<i>1:20</i>	<i>1</i>	<i>1</i>	<i>X</i>
T-3	<i>San Jose</i>	<i>7/20</i>	<i>1:30</i>	<i>1</i>	<i>1</i>	<i>X</i>
T-1	<i>San Jose</i>	<i>7/20</i>	<i>1:40</i>	<i>1</i>	<i>1</i>	<i>X</i>
T-2	<i>San Jose</i>	<i>7/20</i>	<i>1:50</i>	<i>1</i>	<i>1</i>	<i>X</i>
T-5	<i>San Jose</i>	<i>7/20</i>	<i>2:00</i>	<i>1</i>	<i>1</i>	<i>X</i>
T-6	<i>San Jose</i>	<i>7/20</i>	<i>2:10</i>	<i>1</i>	<i>1</i>	<i>X</i>
T-7	<i>San Jose</i>	<i>7/20</i>	<i>2:20</i>	<i>1</i>	<i>1</i>	<i>X</i>
T-8	<i>San Jose</i>	<i>7/20</i>	<i>2:30</i>	<i>1</i>	<i>1</i>	<i>X</i>
T-9	<i>San Jose</i>	<i>7/20</i>	<i>2:40</i>	<i>1</i>	<i>1</i>	<i>X</i>
T-10	<i>San Jose</i>	<i>7/20</i>	<i>2:50</i>	<i>1</i>	<i>1</i>	<i>X</i>
T-11	<i>San Jose</i>	<i>7/20</i>	<i>3:00</i>	<i>1</i>	<i>1</i>	<i>X</i>
T-12	<i>San Jose</i>	<i>7/20</i>	<i>3:10</i>	<i>1</i>	<i>1</i>	<i>X</i>
T-13	<i>San Jose</i>	<i>7/20</i>	<i>3:20</i>	<i>1</i>	<i>1</i>	<i>X</i>
T-14	<i>San Jose</i>	<i>7/20</i>	<i>3:30</i>	<i>1</i>	<i>1</i>	<i>X</i>
T-15	<i>San Jose</i>	<i>7/20</i>	<i>3:40</i>	<i>1</i>	<i>1</i>	<i>X</i>
T-16	<i>San Jose</i>	<i>7/20</i>	<i>3:50</i>	<i>1</i>	<i>1</i>	<i>X</i>
T-17	<i>San Jose</i>	<i>7/20</i>	<i>4:00</i>	<i>1</i>	<i>1</i>	<i>X</i>
T-18	<i>San Jose</i>	<i>7/20</i>	<i>4:10</i>	<i>1</i>	<i>1</i>	<i>X</i>
T-19	<i>San Jose</i>	<i>7/20</i>	<i>4:20</i>	<i>1</i>	<i>1</i>	<i>X</i>
T-20	<i>San Jose</i>	<i>7/20</i>	<i>4:30</i>	<i>1</i>	<i>1</i>	<i>X</i>
T-21	<i>San Jose</i>	<i>7/20</i>	<i>4:40</i>	<i>1</i>	<i>1</i>	<i>X</i>
T-22	<i>San Jose</i>	<i>7/20</i>	<i>4:50</i>	<i>1</i>	<i>1</i>	<i>X</i>
T-23	<i>San Jose</i>	<i>7/20</i>	<i>5:00</i>	<i>1</i>	<i>1</i>	<i>X</i>
T-24	<i>San Jose</i>	<i>7/20</i>	<i>5:10</i>	<i>1</i>	<i>1</i>	<i>X</i>
T-25	<i>San Jose</i>	<i>7/20</i>	<i>5:20</i>	<i>1</i>	<i>1</i>	<i>X</i>
T-26	<i>San Jose</i>	<i>7/20</i>	<i>5:30</i>	<i>1</i>	<i>1</i>	<i>X</i>
T-27	<i>San Jose</i>	<i>7/20</i>	<i>5:40</i>	<i>1</i>	<i>1</i>	<i>X</i>
T-28	<i>San Jose</i>	<i>7/20</i>	<i>5:50</i>	<i>1</i>	<i>1</i>	<i>X</i>
T-29	<i>San Jose</i>	<i>7/20</i>	<i>6:00</i>	<i>1</i>	<i>1</i>	<i>X</i>
T-30	<i>San Jose</i>	<i>7/20</i>	<i>6:10</i>	<i>1</i>	<i>1</i>	<i>X</i>
T-31	<i>San Jose</i>	<i>7/20</i>	<i>6:20</i>	<i>1</i>	<i>1</i>	<i>X</i>
T-32	<i>San Jose</i>	<i>7/20</i>	<i>6:30</i>	<i>1</i>	<i>1</i>	<i>X</i>
T-33	<i>San Jose</i>	<i>7/20</i>	<i>6:40</i>	<i>1</i>	<i>1</i>	<i>X</i>
T-34	<i>San Jose</i>	<i>7/20</i>	<i>6:50</i>	<i>1</i>	<i>1</i>	<i>X</i>
T-35	<i>San Jose</i>	<i>7/20</i>	<i>7:00</i>	<i>1</i>	<i>1</i>	<i>X</i>
T-36	<i>San Jose</i>	<i>7/20</i>	<i>7:10</i>	<i>1</i>	<i>1</i>	<i>X</i>
T-37	<i>San Jose</i>	<i>7/20</i>	<i>7:20</i>	<i>1</i>	<i>1</i>	<i>X</i>
T-38	<i>San Jose</i>	<i>7/20</i>	<i>7:30</i>	<i>1</i>	<i>1</i>	<i>X</i>
T-39	<i>San Jose</i>	<i>7/20</i>	<i>7:40</i>	<i>1</i>	<i>1</i>	<i>X</i>
T-40	<i>San Jose</i>	<i>7/20</i>	<i>7:50</i>	<i>1</i>	<i>1</i>	<i>X</i>
T-41	<i>San Jose</i>	<i>7/20</i>	<i>8:00</i>	<i>1</i>	<i>1</i>	<i>X</i>
T-42	<i>San Jose</i>	<i>7/20</i>	<i>8:10</i>	<i>1</i>	<i>1</i>	<i>X</i>
T-43	<i>San Jose</i>	<i>7/20</i>	<i>8:20</i>	<i>1</i>	<i>1</i>	<i>X</i>
T-44	<i>San Jose</i>	<i>7/20</i>	<i>8:30</i>	<i>1</i>	<i>1</i>	<i>X</i>
T-45	<i>San Jose</i>	<i>7/20</i>	<i>8:40</i>	<i>1</i>	<i>1</i>	<i>X</i>
T-46	<i>San Jose</i>	<i>7/20</i>	<i>8:50</i>	<i>1</i>	<i>1</i>	<i>X</i>
T-47	<i>San Jose</i>	<i>7/20</i>	<i>9:00</i>	<i>1</i>	<i>1</i>	<i>X</i>
T-48	<i>San Jose</i>	<i>7/20</i>	<i>9:10</i>	<i>1</i>	<i>1</i>	<i>X</i>
T-49	<i>San Jose</i>	<i>7/20</i>	<i>9:20</i>	<i>1</i>	<i>1</i>	<i>X</i>
T-50	<i>San Jose</i>	<i>7/20</i>	<i>9:30</i>	<i>1</i>	<i>1</i>	<i>X</i>
T-51	<i>San Jose</i>	<i>7/20</i>	<i>9:40</i>	<i>1</i>	<i>1</i>	<i>X</i>
T-52	<i>San Jose</i>	<i>7/20</i>	<i>9:50</i>	<i>1</i>	<i>1</i>	<i>X</i>
T-53	<i>San Jose</i>	<i>7/20</i>	<i>10:00</i>	<i>1</i>	<i>1</i>	<i>X</i>
T-54	<i>San Jose</i>	<i>7/20</i>	<i>10:10</i>	<i>1</i>	<i>1</i>	<i>X</i>
T-55	<i>San Jose</i>	<i>7/20</i>	<i>10:20</i>	<i>1</i>	<i>1</i>	<i>X</i>
T-56	<i>San Jose</i>	<i>7/20</i>	<i>10:30</i>	<i>1</i>	<i>1</i>	<i>X</i>
T-57	<i>San Jose</i>	<i>7/20</i>	<i>10:40</i>	<i>1</i>	<i>1</i>	<i>X</i>
T-58	<i>San Jose</i>	<i>7/20</i>	<i>10:50</i>	<i>1</i>	<i>1</i>	<i>X</i>
T-59	<i>San Jose</i>	<i>7/20</i>	<i>11:00</i>	<i>1</i>	<i>1</i>	<i>X</i>
T-60	<i>San Jose</i>	<i>7/20</i>	<i>11:10</i>	<i>1</i>	<i>1</i>	<i>X</i>
T-61	<i>San Jose</i>	<i>7/20</i>	<i>11:20</i>	<i>1</i>	<i>1</i>	<i>X</i>
T-62	<i>San Jose</i>	<i>7/20</i>	<i>11:30</i>	<i>1</i>	<i>1</i>	<i>X</i>
T-63	<i>San Jose</i>	<i>7/20</i>	<i>11:40</i>	<i>1</i>	<i>1</i>	<i>X</i>
T-64	<i>San Jose</i>	<i>7/20</i>	<i>11:50</i>	<i>1</i>	<i>1</i>	<i>X</i>
T-65	<i>San Jose</i>	<i>7/20</i>	<i>12:00</i>	<i>1</i>	<i>1</i>	<i>X</i>
T-66	<i>San Jose</i>	<i>7/20</i>	<i>12:10</i>	<i>1</i>	<i>1</i>	<i>X</i>
T-67	<i>San Jose</i>	<i>7/20</i>	<i>12:20</i>	<i>1</i>	<i>1</i>	<i>X</i>
T-68	<i>San Jose</i>	<i>7/20</i>	<i>12:30</i>	<i>1</i>	<i>1</i>	<i>X</i>
T-69	<i>San Jose</i>	<i>7/20</i>	<i>12:40</i>	<i>1</i>	<i>1</i>	<i>X</i>
T-70	<i>San Jose</i>	<i>7/20</i>	<i>12:50</i>	<i>1</i>	<i>1</i>	<i>X</i>
T-71	<i>San Jose</i>	<i>7/20</i>	<i>1:00</i>	<i>1</i>	<i>1</i>	<i>X</i>
T-72	<i>San Jose</i>	<i>7/20</i>	<i>1:10</i>	<i>1</i>	<i>1</i>	<i>X</i>
T-73	<i>San Jose</i>	<i>7/20</i>	<i>1:20</i>	<i>1</i>	<i>1</i>	<i>X</i>
T-74	<i>San Jose</i>	<i>7/20</i>	<i>1:30</i>	<i>1</i>	<i>1</i>	<i>X</i>
T-75	<i>San Jose</i>	<i>7/20</i>	<i>1:40</i>	<i>1</i>	<i>1</i>	<i>X</i>
T-76	<i>San Jose</i>	<i>7/20</i>	<i>1:50</i>	<i>1</i>	<i>1</i>	<i>X</i>
T-77	<i>San Jose</i>	<i>7/20</i>	<i>2:00</i>	<i>1</i>	<i>1</i>	<i>X</i>
T-78	<i>San Jose</i>	<i>7/20</i>	<i>2:10</i>	<i>1</i>	<i>1</i>	<i>X</i>
T-79	<i>San Jose</i>	<i>7/20</i>	<i>2:20</i>	<i>1</i>	<i>1</i>	<i>X</i>
T-80	<i>San Jose</i>	<i>7/20</i>	<i>2:30</i>	<i>1</i>	<i>1</i>	<i>X</i>
T-81	<i>San Jose</i>	<i>7/20</i>	<i>2:40</i>	<i>1</i>	<i>1</i>	<i>X</i>
T-82	<i>San Jose</i>	<i>7/20</i>	<i>2:50</i>	<i>1</i>	<i>1</i>	<i>X</i>
T-83	<i>San Jose</i>	<i>7/20</i>	<i>3:00</i>	<i>1</i>	<i>1</i>	<i>X</i>
T-84	<i>San Jose</i>	<i>7/20</i>	<i>3:10</i>	<i>1</i>	<i>1</i>	<i>X</i>
T-85	<i>San Jose</i>	<i>7/20</i>	<i>3:20</i>	<i>1</i>	<i>1</i>	<i>X</i>
T-86	<i>San Jose</i>	<i>7/20</i>	<i>3:30</i>	<i>1</i>	<i>1</i>	<i>X</i>
T-87	<i>San Jose</i>	<i>7/20</i>	<i>3:40</i>	<i>1</i>	<i>1</i>	<i>X</i>
T-88	<i>San Jose</i>	<i>7/20</i>	<i>3:50</i>	<i>1</i>	<i>1</i>	<i>X</i>
T-89	<i>San Jose</i>	<i>7/20</i>	<i>4:00</i>	<i>1</i>	<i>1</i>	<i>X</i>
T-90	<i>San Jose</i>	<i>7/20</i>	<i>4:10</i>	<i>1</i>	<i>1</i>	<i>X</i>
T-91	<i>San Jose</i>	<i>7/20</i>	<i>4:20</i>	<i>1</i>	<i>1</i>	<i>X</i>
T-92	<i>San Jose</i>	<i>7/20</i>	<i>4:30</i>	<i>1</i>	<i>1</i>	<i>X</i>
T-93	<i>San Jose</i>	<i>7/20</i>	<i>4:40</i>	<i>1</i>	<i>1</i>	<i>X</i>
T-94	<i>San Jose</i>	<i>7/20</i>	<i>4:50</i>	<i>1</i>	<i>1</i>	<i>X</i>
T-95	<i>San Jose</i>	<i>7/20</i>	<i>5:00</i>	<i>1</i>	<i>1</i>	<i>X</i>
T-96	<i>San Jose</i>	<i>7/20</i>	<i>5:10</i>	<i>1</i>	<i>1</i>	<i>X</i>
T-97	<i>San Jose</i>	<i>7/20</i>	<i>5:20</i>	<i>1</i>	<i>1</i>	<i>X</i>
T-98	<i>San Jose</i>	<i>7/20</i>	<i>5:30</i>	<i>1</i>	<i>1</i>	<i>X</i>
T-99	<i>San Jose</i>	<i>7/20</i>	<i>5:40</i>	<i>1</i>	<i>1</i>	<i>X</i>
T-100	<i>San Jose</i>	<i>7/20</i>	<i>5:50</i>	<i>1</i>	<i>1</i>	<i>X</i>

Handwritten notes and signatures on the right side of the page.

Remarks: *SHO 80*
 Analyzed by: *[Signature]*
 Reviewed by: *[Signature]*
 Date: *[Date]*

McCAMPBELL ANALYTICAL INC.

110 2ND AVENUE SOUTH, #D7
FACILITY, CA 94612-9969

Telephone: (925) 798-1620

Fax: (925) 798-1622

Report To: Mike Pedersen / Bob Kemp

Bill To: *Arthur Maggadus*

Company: Controlled Environmental Services

P.O. Box 601

Oakley, CA 94661

Tele: (925) 625-1776

Fax: (925) 625-2618

Project #: 3041

Project Name: *Athena Maggadus*

Project Location: *6501 Skyline Ave., Oakland Ca*

Sampler Signature: *[Signature]*

CHAIN OF CUSTODY RECORD

TURN AROUND TIME

RUSH 24 HOUR 48 HOUR 5 DAY

Analysis Request

Other

Comments

SAMPLE ID	LOCATION	SAMPLING		# Containers	Type Container	MATRIX					METHOD PRESERVED		EPA 816 (S&S) FOR ALL SOLIDS & BOSS WATER	EPA 816 (S&S) FOR ALL SOLIDS & BOSS WATER	TPH as Dissol (0015)	Total Petroleum Hydrocarbons (418.1)	Total Petroleum Hydrocarbons (418.1)	EPA 801 (916)	BTEX ONLY (EPA 801 (916))	EPA 905 (908)	EPA 815 (909) PCB'S ONLY	EPA 824 (910) (916)	EPA 825 (916)	PARTICULATE (EPA 825 (916) (910))	CATIONIC	ANIONIC	METALS	USE OF PRESERVED	TC										
		Date	Time			Water	Soil	Air	Sludge	Other	Ice	BCL																						HNO ₃	Other				
SP-2-SE	6501 Skyline Ave.	11/1/99	5:18	1	T	X					X																												
T-G	"	"	5:23	1	T	X					X																												
EX-1-S-W	"	"	3:57	1	T	X					X																												
EX-1-S-W	"	"	4:06	1	T	X					X																												
EX-3-S-W	"	"	4:20	1	T	X					X																												
EX-5-S-W	"	"	4:26	1	T	X					X																												
EX-7-S-W	"	"	4:35	1	T	X					X																												
EX-9-S-W	"	"	4:45	1	T	X					X																												

original

Retrieved By: <i>[Signature]</i>	Date: 11/1/99	Time: 3:45	Received By: <i>Mike Vall</i>
Retrieved By:	Date:	Time:	Received By:
Retrieved By:	Date:	Time:	Received By:

Remarks:

McCampbell Analytical, Inc.



1534 Willow Pass Rd
Pittsburg, CA 94565-1701
(925) 252-9262

CHAIN-OF-CUSTODY RECORD

WorkOrder: 0910023

ClientCode: CESO

WaterTrax WriteOn EDF Excel Fax Email HardCopy ThirdParty J-flag

Report to:

Mike Pedersen
Controlled Env. Svcs. (CES)
P.O. Box 401
Oakley, CA 94561
(925) 625-1736 FAX (925) 625-2618

Email: cestanks@aol.com; cesmike@sbcglobe.com
cc:
PO:
ProjectNo: #3041; Athan Magganas

Bill to:

Athan Magganas
2550 Appian Way, Ste. 20
Pinole, CA 94564

Requested TAT: 5 days

Date Received: 10/01/2009
Date Printed: 10/01/2009

Lab ID	Client ID	Matrix	Collection Date	Hold	Requested Tests (See legend below)												
					1	2	3	4	5	6	7	8	9	10	11	12	
0910023-001	T-4	Soil	10/1/2009 13:25	<input type="checkbox"/>		A	A	A									
0910023-002	T-2	Soil	10/1/2009 13:30	<input type="checkbox"/>		A	A	A									
0910023-003	T-1	Soil	10/1/2009 13:43	<input type="checkbox"/>		A	A	A									
0910023-004	T-3	Soil	10/1/2009 14:00	<input type="checkbox"/>		A	A	A									
0910023-005	EX-1-E-W	Soil	10/1/2009 13:52	<input type="checkbox"/>		A	A	A									
0910023-006	EX-1-N-W	Soil	10/1/2009 14:10	<input type="checkbox"/>		A	A	A									
0910023-007	T-5	Soil	10/1/2009 14:23	<input type="checkbox"/>	A	A	A		A								
0910023-008	SP-1-NE,NW,SE,SW	Soil	10/1/2009 14:49	<input type="checkbox"/>		A	A	A									
0910023-009	SP-2-NW,NE,SW,SE	Soil	10/1/2009 15:10	<input type="checkbox"/>		A	A	A									
0910023-010	T-6	Soil	10/1/2009 15:23	<input type="checkbox"/>		A	A	A									
0910023-011	EX-1-S-W	Soil	10/1/2009 15:57	<input type="checkbox"/>		A	A	A									
0910023-012	EX-1-W-W	Soil	10/1/2009 16:06	<input type="checkbox"/>		A	A	A									
0910023-013	EX-3-E-W	Soil	10/1/2009 16:20	<input type="checkbox"/>		A	A	A									
0910023-014	EX-3-N-W	Soil	10/1/2009 16:26	<input type="checkbox"/>		A	A	A									

Test Legend:

1	8082A_PCB_S	2	G-MBTEX_S	3	LUFTMS_S	4	TPH(D) S	5	TPH(DMO) S
6		7		8		9		10	
11		12							

Prepared by: Melissa Valles

Comments:

NOTE: Soil samples are discarded 60 days after results are reported unless other arrangements are made (Water samples are 30 days).
Hazardous samples will be returned to client or disposed of at client expense.

McC Campbell Analytical, Inc.



1534 Willow Pass Rd
Pittsburg, CA 94565-1701
(925) 252-9262

CHAIN-OF-CUSTODY RECORD

WorkOrder: 0910023

ClientCode: CESO

WaterTrax WriteOn EDF Excel Fax Email HardCopy ThirdParty J-flag

Report to:

Mike Pedersen
Controlled Env. Svcs. (CES)
P.O. Box 401
Oakley, CA 94561
(925) 625-1736 FAX (925) 625-2618

Email: cestanks@aol.com; cesmike@sbcglobe.com
cc:
PO:
ProjectNo: #3041; Athan Magganas

Bill to:

Athan Magganas
2550 Appian Way, Ste. 20
Pinole, CA 94564

Requested TAT: 5 days

Date Received: 10/01/2009

Date Printed: 10/01/2009

Lab ID	Client ID	Matrix	Collection Date	Hold	Requested Tests (See legend below)											
					1	2	3	4	5	6	7	8	9	10	11	12
0910023-015	EX-3-S-W	Soil	10/1/2009 16:30	<input type="checkbox"/>		A	A	A								
0910023-016	EX-3-W-W	Soil	10/1/2009 16:45	<input type="checkbox"/>		A	A	A								

Test Legend:

1	8082A_PCB_S
6	
11	

2	G-MBTEX_S
7	
12	

3	LUFTMS_S
8	

4	TPH(D)_S
9	

5	TPH(DMO)_S
10	

Prepared by: Melissa Valles

Comments:

NOTE: Soil samples are discarded 60 days after results are reported unless other arrangements are made (Water samples are 30 days).
Hazardous samples will be returned to client or disposed of at client expense.



Sample Receipt Checklist

Client Name: **Controlled Env. Svcs. (CES)**

Date and Time Received: **10/1/2009 5:50:19 PM**

Project Name: **#3041; Athan Magganas**

Checklist completed and reviewed by: **Melissa Valles**

WorkOrder N°: **0910023** Matrix Soil

Carrier: Client Drop-In

Chain of Custody (COC) Information

- Chain of custody present? Yes No
- Chain of custody signed when relinquished and received? Yes No
- Chain of custody agrees with sample labels? Yes No
- Sample IDs noted by Client on COC? Yes No
- Date and Time of collection noted by Client on COC? Yes No
- Sampler's name noted on COC? Yes No

Sample Receipt Information

- Custody seals intact on shipping container/cooler? Yes No NA
- Shipping container/cooler in good condition? Yes No
- Samples in proper containers/bottles? Yes No
- Sample containers intact? Yes No
- Sufficient sample volume for indicated test? Yes No

Sample Preservation and Hold Time (HT) Information

- All samples received within holding time? Yes No
- Container/Temp Blank temperature Cooler Temp: 5.6°C NA
- Water - VOA vials have zero headspace / no bubbles? Yes No No VOA vials submitted
- Sample labels checked for correct preservation? Yes No
- Metal - pH acceptable upon receipt (pH<2)? Yes No NA
- Samples Received on Ice? Yes No

(Ice Type: WET ICE)

* NOTE: If the "No" box is checked, see comments below.

Client contacted:

Date contacted:

Contacted by:

Comments:



McC Campbell Analytical, Inc.

"When Quality Counts"

1534 Willow Pass Road, Pittsburg, CA 94565-1701
Web: www.mcccampbell.com E-mail: main@mcccampbell.com
Telephone: 877-252-9262 Fax: 925-252-9269

Controlled Env. Svcs. (CES) P.O. Box 401 Oakley, CA 94561	Client Project ID: #3041; Athan Magganas	Date Sampled: 10/01/09
	Client Contact: Mike Pedersen	Date Received: 10/01/09
	Client P.O.:	Date Extracted: 10/01/09
		Date Analyzed: 10/02/09

Polychlorinated Biphenyls (PCBs) Aroclors by GC-ECD*

Extraction Method: SW3550C

Analytical Method: SW8082

Work Order: 0910023

Lab ID	0910023-007A				Reporting Limit for DF =1	
Client ID	T-5					
Matrix	S					
DF	1					

Compound	Concentration				mg/kg	ug/L
	Aroclor1016	ND				0.025
Aroclor1221	ND				0.025	NA
Aroclor1232	ND				0.025	NA
Aroclor1242	ND				0.025	NA
Aroclor1248	ND				0.025	NA
Aroclor1254	ND				0.025	NA
Aroclor1260	ND				0.025	NA
PCBs, total	ND				0.025	NA

Surrogate Recoveries (%)

%SS:	115				
Comments					

* water samples in µg/L, soil/sludge/solid samples in mg/kg, wipe samples in µg/wipe, filter samples in µg/filter, product/oil/non-aqueous liquid samples and all TCLP & SPLP extracts are reported in mg/L.

ND means not detected above the reporting limit; N/A means analyte not applicable to this analysis.

surrogate diluted out of range or surrogate coelutes with another peak.



McC Campbell Analytical, Inc.

"When Quality Counts"

1534 Willow Pass Road, Pittsburg, CA 94565-1701
Web: www.mcccampbell.com E-mail: main@mcccampbell.com
Telephone: 877-252-9262 Fax: 925-252-9269

Controlled Env. Svcs. (CES) P.O. Box 401 Oakley, CA 94561	Client Project ID: #3041; Athan Magganas	Date Sampled: 10/01/09
	Client Contact: Mike Pedersen	Date Received: 10/01/09
	Client P.O.:	Date Extracted: 10/01/09
		Date Analyzed: 10/02/09-10/07/09

Gasoline Range (C6-C12) Volatile Hydrocarbons as Gasoline with BTEX and MTBE*

Extraction method: SW5030B

Analytical methods: SW8021B/8015Bm

Work Order: 0910023

Lab ID	Client ID	Matrix	TPH(g)	MTBE	Benzene	Toluene	Ethylbenzene	Xylenes	DF	% SS	Comments
001A	T-4	S	1.8	ND	ND	ND	0.020	0.090	1	84	d2
002A	T-2	S	420	ND<1.0	0.16	ND<0.10	ND<0.10	0.72	20	---#	d7,d9
003A	T-1	S	8.2	ND	ND	ND	ND	0.013	1	81	d7,d9
004A	T-3	S	100	ND<1.0	ND<0.10	ND<0.10	0.24	1.4	20	110	d7,d9
005A	EX-1-E-W	S	93	ND<1.0	ND<0.10	0.18	ND<0.10	0.15	20	106	d7,d9
006A	EX-1-N-W	S	8.2	ND	ND	0.0099	ND	0.035	1	84	d7,d9
007A	T-5	S	8.0	ND	ND	ND	ND	0.020	1	89	d7,d9
008A	SP-1-NE,NW,SE,SW	S	340	ND<1.0	ND<0.10	ND<0.10	0.23	1.0	20	110	d7,d9
009A	SP-2-NW,NE,SW,SE	S	770	ND<1.0	ND<0.10	0.99	3.2	18	20	96	d7,d9
010A	T-6	S	280	ND<2.5	0.45	1.9	2.7	15	50	---#	d2,d9
011A	EX-1-S-W	S	490	ND<1.0	0.54	0.12	3.6	1.6	20	90	d7,d9
012A	EX-1-W-W	S	1700	ND<2.5	ND<0.25	ND<0.25	1.9	5.9	50	---#	d7,d9
013A	EX-3-E-W	S	2100	ND<5.0	2.7	3.0	15	60	100	95	d7,d9
014A	EX-3-N-W	S	180	ND<1.0	0.71	5.9	2.7	17	20	102	d1
015A	EX-3-S-W	S	2900	ND<5.0	5.0	27	36	200	100	99	d2,d9
016A	EX-3-W-W	S	95	ND<1.0	0.42	ND<0.10	0.11	0.28	20	116	d7,d9

Reporting Limit for DF = 1; ND means not detected at or above the reporting limit	W	50	5.0	0.5	0.5	0.5	0.5	0.5	ug/L
	S	1.0	0.05	0.005	0.005	0.005	0.005	0.005	mg/Kg

* water and vapor samples are reported in µg/L, soil/sludge/solid samples in mg/kg, wipe samples in µg/wipe, product/oil/non-aqueous liquid samples and all TCLP & SPLP extracts in mg/L.

cluttered chromatogram, sample peak coelutes w/surrogate peak; low surrogate recovery due to matrix interference.

+The following descriptions of the TPH chromatogram are cursory in nature and McC Campbell Analytical is not responsible for their interpretation:

- d1) weakly modified or unmodified gasoline is significant
- d2) heavier gasoline range compounds are significant (aged gasoline?)
- d7) strongly aged gasoline or diesel range compounds are significant in the TPH(g) chromatogram
- d9) no recognizable pattern



McC Campbell Analytical, Inc.

"When Quality Counts"

1534 Willow Pass Road, Pittsburg, CA 94565-1701

Web: www.mcccampbell.com E-mail: main@mcccampbell.com

Telephone: 877-252-9262 Fax: 925-252-9269

Controlled Env. Svcs. (CES) P.O. Box 401 Oakley, CA 94561	Client Project ID: #3041; Athan Magganas	Date Sampled: 10/01/09
	Client Contact: Mike Pedersen	Date Received: 10/01/09
	Client P.O.:	Date Extracted: 10/01/09
		Date Analyzed: 10/02/09-10/06/09

LUFT 5 Metals*

Extraction method: SW3050B

Analytical methods: 6020A

Work Order: 0910023

Lab ID	Client ID	Matrix	Extraction Type	Cadmium	Chromium	Lead	Nickel	Zinc	DF	% SS	Comments
001A	T-4	S	TOTAL	ND	40	7.0	42	63	1	106	
002A	T-2	S	TOTAL	0.41	42	14	41	220	1	107	
003A	T-1	S	TOTAL	ND	49	6.5	47	66	1	100	
004A	T-3	S	TOTAL	ND	51	14	53	99	1	128	
005A	EX-1-E-W	S	TOTAL	ND	31	8.7	18	21	1	93	
006A	EX-1-N-W	S	TOTAL	ND	40	9.9	22	31	1	119	
007A	T-5	S	TOTAL	ND	39	12	23	45	1	115	
008A	SP-1-NE,NW,SE,SW	S	TOTAL	0.28	30	41	77	200	1	121	
009A	SP-2-NW,NE,SW,SE	S	TOTAL	2.5	37	170	42	240	1	114	
010A	T-6	S	TOTAL	2.1	46	95	68	290	1	104	
011A	EX-1-S-W	S	TOTAL	ND	44	8.9	54	58	1	116	
012A	EX-1-W-W	S	TOTAL	2.2	14	92	79	580	1	99	
013A	EX-3-E-W	S	TOTAL	46	23	4200	85	3900	1	109	
014A	EX-3-N-W	S	TOTAL	7.0	18	320	71	480	1	89	
015A	EX-3-S-W	S	TOTAL	4.3	20	240	70	560	1	97	

Reporting Limit for DF =1; ND means not detected at or above the reporting limit	W	TOTAL	NA	NA	NA	NA	NA	NA	NA
	S	TOTAL	0.25	0.5	0.5	0.5	0.5	5.0	mg/Kg

*water samples are reported in µg/L, product/oil/non-aqueous liquid samples and all TCLP / STLC / DISTLC / SPLP extracts are reported in mg/L, soil/sludge/solid samples in mg/kg, wipe samples in µg/wipe, filter samples in µg/filter.

means surrogate diluted out of range; ND means not detected above the reporting limit; N/A means not applicable to this sample or instrument.

TOTAL = acid digestion.

WET = Waste Extraction Test (STLC).

DI WET = Waste Extraction Test using de-ionized water.

i) aqueous sample containing greater than ~1 vol. % sediment; for DISSOLVED metals, this sample has been preserved prior to filtration; for TOTAL^ metals, a representative sediment-water mixture was digested; j) reporting limit raised due to insufficient sample amount; k) reporting limit raised due to matrix interference; m) estimated value due to low/high surrogate recovery, caused by matrix interference; n) results are reported on a dry weight basis; p) see attached narrative.



McC Campbell Analytical, Inc.

"When Quality Counts"

1534 Willow Pass Road, Pittsburg, CA 94565-1701

Web: www.mcccampbell.com E-mail: main@mcccampbell.com

Telephone: 877-252-9262 Fax: 925-252-9269

Controlled Env. Svcs. (CES) P.O. Box 401 Oakley, CA 94561	Client Project ID: #3041; Athan Magganas	Date Sampled: 10/01/09
	Client Contact: Mike Pedersen	Date Received: 10/01/09
	Client P.O.:	Date Extracted: 10/01/09
		Date Analyzed: 10/02/09-10/06/09

LUFT 5 Metals*

Extraction method: SW3050B

Analytical methods: 6020A

Work Order: 0910023

Lab ID	Client ID	Matrix	Extraction Type	Cadmium	Chromium	Lead	Nickel	Zinc	DF	% SS	Comments
016A	EX-3-W-W	S	TOTAL	ND	34	10	14	25	1	90	

Reporting Limit for DF =1; ND means not detected at or above the reporting limit	W	TOTAL	NA	NA	NA	NA	NA	NA	NA
	S	TOTAL	0.25	0.5	0.5	0.5	5.0	mg/Kg	

*water samples are reported in µg/L, product/oil/non-aqueous liquid samples and all TCLP / STLC / DISTLC / SPLP extracts are reported in mg/L, soil/sludge/solid samples in mg/kg, wipe samples in µg/wipe, filter samples in µg/filter.

means surrogate diluted out of range; ND means not detected above the reporting limit; N/A means not applicable to this sample or instrument.

TOTAL = acid digestion.
WET = Waste Extraction Test (STLC).
DI WET = Waste Extraction Test using de-ionized water.

i) aqueous sample containing greater than ~1 vol. % sediment; for DISSOLVED metals, this sample has been preserved prior to filtration; for TOTAL^ metals, a representative sediment-water mixture was digested; j) reporting limit raised due to insufficient sample amount; k) reporting limit raised due to matrix interference; m) estimated value due to low/high surrogate recovery, caused by matrix interference; n) results are reported on a dry weight basis; p) see attached narrative.



McC Campbell Analytical, Inc.

"When Quality Counts"

1534 Willow Pass Road, Pittsburg, CA 94565-1701
Web: www.mcccampbell.com E-mail: main@mcccampbell.com
Telephone: 877-252-9262 Fax: 925-252-9269

Controlled Env. Svcs. (CES) P.O. Box 401 Oakley, CA 94561	Client Project ID: #3041; Athan Magganas	Date Sampled: 10/01/09
	Client Contact: Mike Pedersen	Date Received: 10/01/09
	Client P.O.:	Date Extracted: 10/01/09
		Date Analyzed: 10/02/09-10/06/09

Total Extractable Petroleum Hydrocarbons*

Extraction method SW3550C

Analytical methods: SW8015B

Work Order: 0910023

Lab ID	Client ID	Matrix	TPH-Diesel (C10-C23)	DF	% SS	Comments
0910023-001A	T-4	S	2.5	1	97	e4
0910023-002A	T-2	S	270	1	112	e11,e2,e7
0910023-003A	T-1	S	2.6	1	89	e11
0910023-004A	T-3	S	58	1	91	e11,e7
0910023-005A	EX-1-E-W	S	76	1	103	e11
0910023-006A	EX-1-N-W	S	3.5	1	96	e11
0910023-008A	SP-1-NE,NW,SE,SW	S	200	2	96	e11,e7,e2
0910023-009A	SP-2-NW,NE,SW,SE	S	320	20	101	e11
0910023-010A	T-6	S	230	1	---#	e11,e7,e2
0910023-011A	EX-1-S-W	S	170	5	104	e11
0910023-012A	EX-1-W-W	S	1800	20	---#	e11,e7,e2
0910023-013A	EX-3-E-W	S	680	20	---#	e11
0910023-014A	EX-3-N-W	S	48	1	100	e11,e7
0910023-015A	EX-3-S-W	S	780	20	---#	e11
0910023-016A	EX-3-W-W	S	41	1	94	e11,e7,e2

Reporting Limit for DF =1;
ND means not detected at or
above the reporting limit

W

NA

NA

S

1.0

mg/Kg

* water samples are reported in µg/L, wipe samples in µg/wipe, soil/solid/sludge samples in mg/kg, product/oil/non-aqueous liquid samples in mg/L, and all DISTLC / STLC / SPLP / TCLP extracts are reported in µg/L.

cluttered chromatogram resulting in coeluted surrogate and sample peaks, or; surrogate peak is on elevated baseline, or; surrogate has been diminished by dilution of original extract.

+The following descriptions of the TPH chromatogram are cursory in nature and McC Campbell Analytical is not responsible for their interpretation:

e2) diesel range compounds are significant; no recognizable pattern

e4) gasoline range compounds are significant.

e7) oil range compounds are significant

e11) stoddard solvent/mineral spirit (?)



McC Campbell Analytical, Inc.

"When Quality Counts"

1534 Willow Pass Road, Pittsburg, CA 94565-1701

Web: www.mcccampbell.com E-mail: main@mcccampbell.com

Telephone: 877-252-9262 Fax: 925-252-9269

Controlled Env. Svcs. (CES)

P.O. Box 401

Oakley, CA 94561

Client Project ID: #3041; Athan
Magganas

Client Contact: Mike Pedersen

Client P.O.:

Date Sampled: 10/01/09

Date Received: 10/01/09

Date Extracted: 10/01/09

Date Analyzed: 10/02/09

Total Extractable Petroleum Hydrocarbons*

Extraction method: SW3550C

Analytical methods: SW8015B

Work Order: 0910023

Lab ID	Client ID	Matrix	TPH-Diesel (C10-C23)	TPH-Motor Oil (C18-C36)	DF	% SS	Comments
0910023-007A	T-5	S	11	44	1	94	e7,e11,e2

Reporting Limit for DF =1; ND means not detected at or above the reporting limit	W	NA	NA	ug/L
	S	1.0	5.0	mg/Kg

* water samples are reported in µg/L, wipe samples in µg/wipe, soil/solid/sludge samples in mg/kg, product/oil/non-aqueous liquid samples in mg/L, and all DISTLC / STLC / SPLP / TCLP extracts are reported in µg/L.

cluttered chromatogram resulting in coeluted surrogate and sample peaks, or, surrogate peak is on elevated baseline, or, surrogate has been diminished by dilution of original extract.

+The following descriptions of the TPH chromatogram are cursory in nature and McC Campbell Analytical is not responsible for their interpretation:

e2) diesel range compounds are significant; no recognizable pattern
e7) oil range compounds are significant
e11) stoddard solvent/mineral spirit (?)



McC Campbell Analytical, Inc.

"When Quality Counts"

1534 Willow Pass Road, Pittsburg, CA 94565-1701
Web: www.mcccampbell.com E-mail: main@mcccampbell.com
Telephone: 877-252-9262 Fax: 925-252-9269

QC SUMMARY REPORT FOR SW8082

W.O. Sample Matrix: Soil

QC Matrix: Soil

BatchID: 46130

WorkOrder: 0910023

EPA Method SW8082		Extraction SW3550C							Spiked Sample ID: 0910023-007A			
Analyte	Sample	Spiked	MS	MSD	MS-MSD	LCS	LCSD	LCS-LCSD	Acceptance Criteria (%)			
	mg/kg	mg/kg	% Rec.	% Rec.	% RPD	% Rec.	% Rec.	% RPD	MS / MSD	RPD	LCS/LCSD	RPD
Aroclor1260	ND	0.075	113	117	3.45	93.1	95.9	2.94	70 - 130	20	70 - 130	20
%SS:	115	0.050	86.8	91.7	5.52	86	89	3.90	70 - 130	20	70 - 130	20

All target compounds in the Method Blank of this extraction batch were ND less than the method RL with the following exceptions:
NONE

BATCH 46130 SUMMARY

Lab ID	Date Sampled	Date Extracted	Date Analyzed	Lab ID	Date Sampled	Date Extracted	Date Analyzed
0910023-007A	10/01/09 2:23 PM	10/01/09	10/02/09 11:08 PM				

MS = Matrix Spike; MSD = Matrix Spike Duplicate; LCS = Laboratory Control Sample; LCSD = Laboratory Control Sample Duplicate; RPD = Relative Percent Deviation.

% Recovery = $100 * (MS - Sample) / (Amount Spiked)$; RPD = $100 * (MS - MSD) / ((MS + MSD) / 2)$.

MS / MSD spike recoveries and / or %RPD may fall outside of laboratory acceptance criteria due to one or more of the following reasons: a) the sample is inhomogenous AND contains significant concentrations of analyte relative to the amount spiked, or b) the spiked sample's matrix interferes with the spike recovery.

N/A = not enough sample to perform matrix spike and matrix spike duplicate.

NR = analyte concentration in sample exceeds spike amount for soil matrix or exceeds 2x spike amount for water matrix or sample diluted due to high matrix or analyte content.



QC SUMMARY REPORT FOR SW8021B/8015Bm

W.O. Sample Matrix: Soil

QC Matrix: Soil

BatchID: 46191

WorkOrder: 0910023

EPA Method SW8021B/8015Bm		Extraction SW5030B							Spiked Sample ID: 0910088-001A			
Analyte	Sample	Spiked	MS	MSD	MS-MSD	LCS	LCSD	LCS-LCSD	Acceptance Criteria (%)			
	mg/Kg	mg/Kg	% Rec.	% Rec.	% RPD	% Rec.	% Rec.	% RPD	MS / MSD	RPD	LCS/LCSD	RPD
TPH(btex) ^f	ND	0.60	110	106	3.97	118	117	0.601	70 - 130	20	70 - 130	20
MTBE	ND	0.10	108	99.3	8.35	86	92.6	7.39	70 - 130	20	70 - 130	20
Benzene	ND	0.10	91.5	86.9	5.21	90.5	90.8	0.338	70 - 130	20	70 - 130	20
Toluene	ND	0.10	89.7	84.8	5.68	89.3	89.2	0.0280	70 - 130	20	70 - 130	20
Ethylbenzene	ND	0.10	89.1	84.4	5.40	89	89.5	0.526	70 - 130	20	70 - 130	20
Xylenes	ND	0.30	90.3	85	6.09	89.9	89.7	0.190	70 - 130	20	70 - 130	20
%SS:	84	0.10	79	77	2.60	89	99	10.9	70 - 130	20	70 - 130	20

All target compounds in the Method Blank of this extraction batch were ND less than the method RL with the following exceptions:
NONE

BATCH 46191 SUMMARY

Lab ID	Date Sampled	Date Extracted	Date Analyzed	Lab ID	Date Sampled	Date Extracted	Date Analyzed
0910023-001A	10/01/09 1:25 PM	10/01/09	10/05/09 6:33 PM	0910023-002A	10/01/09 1:30 PM	10/01/09	10/02/09 8:45 PM
0910023-003A	10/01/09 1:43 PM	10/01/09	10/07/09 7:37 PM	0910023-004A	10/01/09 2:00 PM	10/01/09	10/02/09 9:47 PM
0910023-005A	10/01/09 1:52 PM	10/01/09	10/02/09 11:49 PM	0910023-006A	10/01/09 2:10 PM	10/01/09	10/05/09 8:33 PM
0910023-007A	10/01/09 2:23 PM	10/01/09	10/05/09 7:03 PM	0910023-008A	10/01/09 2:49 PM	10/01/09	10/03/09 1:51 AM
0910023-009A	10/01/09 3:10 PM	10/01/09	10/03/09 3:21 AM	0910023-010A	10/01/09 3:23 PM	10/01/09	10/03/09 3:52 AM
0910023-011A	10/01/09 3:57 PM	10/01/09	10/03/09 4:21 AM	0910023-012A	10/01/09 4:06 PM	10/01/09	10/03/09 5:21 AM
0910023-013A	10/01/09 4:20 PM	10/01/09	10/03/09 5:51 AM	0910023-014A	10/01/09 4:26 PM	10/01/09	10/03/09 6:21 AM
0910023-015A	10/01/09 4:30 PM	10/01/09	10/03/09 7:21 AM	0910023-016A	10/01/09 4:45 PM	10/01/09	10/05/09 2:28 PM

MS = Matrix Spike; MSD = Matrix Spike Duplicate; LCS = Laboratory Control Sample; LCSD = Laboratory Control Sample Duplicate; RPD = Relative Percent Deviation.

% Recovery = 100 * (MS-Sample) / (Amount Spiked); RPD = 100 * (MS - MSD) / ((MS + MSD) / 2).

MS / MSD spike recoveries and / or %RPD may fall outside of laboratory acceptance criteria due to one or more of the following reasons: a) the sample is inhomogenous AND contains significant concentrations of analyte relative to the amount spiked, or b) the spiked sample's matrix interferes with the spike recovery.

Σ TPH(btex) = sum of BTEX areas from the FID.

cluttered chromatogram; sample peak coelutes with surrogate peak.

N/A = not enough sample to perform matrix spike and matrix spike duplicate.

NR = matrix interference and/or analyte concentration in sample exceeds spike amount for soil matrix or exceeds 2x spike amount for water matrix or sample diluted due to high matrix or analyte content.



QC SUMMARY REPORT FOR 6020A

W.O. Sample Matrix: Soil

QC Matrix: Soil

WorkOrder: 0910023

EPA Method 6020A		Extraction SW3050B				BatchID: 46163			Spiked Sample ID: 0909846-007A				
Analyte	Sample	Spiked	MS	MSD	MS-MSD	Spiked	LCS	LCSD	LCS-LCSD	Acceptance Criteria (%)			
	mg/Kg	mg/Kg	% Rec.	% Rec.	% RPD	mg/Kg	% Rec.	% Rec.	% RPD	MS / MSD	RPD	LCS/LCSD	RPD
Cadmium	ND	50	95.2	94.7	0.527	10	93	95.6	2.77	75 - 125	20	75 - 125	20
Chromium	63	50	NR	NR	NR	10	90.8	91	0.132	75 - 125	20	75 - 125	20
Lead	18	50	91.5	91	0.411	10	95.3	97.8	2.55	75 - 125	20	75 - 125	20
Nickel	52	50	NR	NR	NR	10	95.7	96.2	0.563	75 - 125	20	75 - 125	20
Zinc	43	500	95.3	94.8	0.521	100	96	96.1	0.0937	75 - 125	20	75 - 125	20
%SS:	116	250	100	99	0.928	250	97	97	0	70 - 130	20	70 - 130	20

All target compounds in the Method Blank of this extraction batch were ND less than the method RL with the following exceptions:
NONE

BATCH 46163 SUMMARY

Lab ID	Date Sampled	Date Extracted	Date Analyzed	Lab ID	Date Sampled	Date Extracted	Date Analyzed
0910023-001A	10/01/09 1:25 PM	10/01/09	10/02/09 4:34 PM	0910023-002A	10/01/09 1:30 PM	10/01/09	10/05/09 8:06 PM
0910023-003A	10/01/09 1:43 PM	10/01/09	10/05/09 8:14 PM	0910023-004A	10/01/09 2:00 PM	10/01/09	10/02/09 4:57 PM
0910023-005A	10/01/09 1:52 PM	10/01/09	10/05/09 8:23 PM	0910023-006A	10/01/09 2:10 PM	10/01/09	10/02/09 5:38 PM
0910023-007A	10/01/09 2:23 PM	10/01/09	10/02/09 5:45 PM				

MS = Matrix Spike; MSD = Matrix Spike Duplicate; LCS = Laboratory Control Sample; LCSD = Laboratory Control Sample Duplicate; RPD = Relative Percent Deviation.

% Recovery = 100 * (MS-Sample) / (Amount Spiked); RPD = 100 * (MS - MSD) / ((MS + MSD) / 2).

MS / MSD spike recoveries and / or %RPD may fall outside of laboratory acceptance criteria due to one or more of the following reasons: a) the sample is inhomogenous AND contains significant concentrations of analyte relative to the amount spiked, or b) the spiked sample's matrix interferes with the spike recovery.

N/A = not applicable to this method.

NR = analyte concentration in sample exceeds spike amount for soil matrix or exceeds 2x spike amount for water matrix or sample diluted due to high matrix or analyte content.



QC SUMMARY REPORT FOR 6020A

W.O. Sample Matrix: Soil

QC Matrix: Soil

WorkOrder: 0910023

Analyte	EPA Method 6020A					Extraction SW3050B			BatchID: 46193			Spiked Sample ID: 0910023-016A		
	Sample	Spiked	MS	MSD	MS-MSD	Spiked	LCS	LCSD	LCS-LCSD	Acceptance Criteria (%)				
	mg/Kg	mg/Kg	% Rec.	% Rec.	% RPD	mg/Kg	% Rec.	% Rec.	% RPD	MS / MSD	RPD	LCS/LCSD	RPD	
Cadmium	ND	50	91.1	92.9	1.91	10	95.6	92.2	3.56	75 - 125	20	75 - 125	20	
Chromium	34	50	77.4	85	5.06	10	93.7	92.9	0.868	75 - 125	20	75 - 125	20	
Lead	10	50	89.5	92.2	2.49	10	94.4	94.7	0.328	75 - 125	20	75 - 125	20	
Nickel	14	50	90.3	94.7	3.69	10	97.9	99.5	1.59	75 - 125	20	75 - 125	20	
Zinc	25	500	88.6	93.9	5.55	100	94.5	93.8	0.680	75 - 125	20	75 - 125	20	
%SS:	90	250	84	87	3.14	250	96	95	1.01	70 - 130	20	70 - 130	20	

All target compounds in the Method Blank of this extraction batch were ND less than the method RL with the following exceptions:
NONE

BATCH 46193 SUMMARY

Lab ID	Date Sampled	Date Extracted	Date Analyzed	Lab ID	Date Sampled	Date Extracted	Date Analyzed
0910023-008A	10/01/09 2:49 PM	10/01/09	10/02/09 5:53 PM	0910023-009A	10/01/09 3:10 PM	10/01/09	10/02/09 6:01 PM
0910023-009A	10/01/09 3:10 PM	10/01/09	10/05/09 8:40 PM	0910023-010A	10/01/09 3:23 PM	10/01/09	10/02/09 6:08 PM
0910023-010A	10/01/09 3:23 PM	10/01/09	10/05/09 8:49 PM	0910023-011A	10/01/09 3:57 PM	10/01/09	10/02/09 6:16 PM
0910023-012A	10/01/09 4:06 PM	10/01/09	10/02/09 6:24 PM	0910023-013A	10/01/09 4:20 PM	10/01/09	10/02/09 6:31 PM
0910023-014A	10/01/09 4:26 PM	10/01/09	10/02/09 6:39 PM	0910023-014A	10/01/09 4:26 PM	10/01/09	10/05/09 9:32 PM
0910023-015A	10/01/09 4:30 PM	10/01/09	10/02/09 6:46 PM	0910023-015A	10/01/09 4:30 PM	10/01/09	10/05/09 9:41 PM
0910023-016A	10/01/09 4:45 PM	10/01/09	10/02/09 7:28 PM				

MS = Matrix Spike; MSD = Matrix Spike Duplicate; LCS = Laboratory Control Sample; LCSD = Laboratory Control Sample Duplicate; RPD = Relative Percent Deviation.

% Recovery = 100 * (MS-Sample) / (Amount Spiked); RPD = 100 * (MS - MSD) / ((MS + MSD) / 2).

MS / MSD spike recoveries and / or %RPD may fall outside of laboratory acceptance criteria due to one or more of the following reasons: a) the sample is inhomogenous AND contains significant concentrations of analyte relative to the amount spiked, or b) the spiked sample's matrix interferes with the spike recovery.

N/A = not applicable to this method.

NR = analyte concentration in sample exceeds spike amount for soil matrix or exceeds 2x spike amount for water matrix or sample diluted due to high matrix or analyte content.



QC SUMMARY REPORT FOR SW8015B

W.O. Sample Matrix: Soil

QC Matrix: Soil

BatchID: 46182

WorkOrder: 0910023

EPA Method SW8015B		Extraction SW3550C							Spiked Sample ID: 0910015-006A			
Analyte	Sample	Spiked	MS	MSD	MS-MSD	LCS	LCSD	LCS-LCSD	Acceptance Criteria (%)			
	mg/Kg	mg/Kg	% Rec.	% Rec.	% RPD	% Rec.	% Rec.	% RPD	MS / MSD	RPD	LCS/LCSD	RPD
TPH-Diesel (C10-C23)	46	20	NR	NR	NR	97.3	101	3.67	70 - 130	30	70 - 130	30
%SS:	84	50	98	87	12.1	89	92	3.75	70 - 130	30	70 - 130	30

All target compounds in the Method Blank of this extraction batch were ND less than the method RL with the following exceptions:
NONE

BATCH 46182 SUMMARY

Lab ID	Date Sampled	Date Extracted	Date Analyzed	Lab ID	Date Sampled	Date Extracted	Date Analyzed
0910023-001A	10/01/09 1:25 PM	10/01/09	10/02/09 11:34 PM	0910023-002A	10/01/09 1:30 PM	10/01/09	10/03/09 11:06 AM
0910023-003A	10/01/09 1:43 PM	10/01/09	10/02/09 2:03 PM	0910023-004A	10/01/09 2:00 PM	10/01/09	10/02/09 3:15 PM
0910023-005A	10/01/09 1:52 PM	10/01/09	10/06/09 8:41 PM	0910023-006A	10/01/09 2:10 PM	10/01/09	10/02/09 9:04 AM
0910023-007A	10/01/09 2:23 PM	10/01/09	10/02/09 6:49 PM	0910023-008A	10/01/09 2:49 PM	10/01/09	10/02/09 4:26 PM

MS = Matrix Spike; MSD = Matrix Spike Duplicate; LCS = Laboratory Control Sample; LCSD = Laboratory Control Sample Duplicate; RPD = Relative Percent Deviation.
 % Recovery = $100 * (MS - Sample) / (Amount Spiked)$; $RPD = 100 * (MS - MSD) / ((MS + MSD) / 2)$.
 MS / MSD spike recoveries and / or %RPD may fall outside of laboratory acceptance criteria due to one or more of the following reasons: a) the sample is inhomogenous AND contains significant concentrations of analyte relative to the amount spiked, or b) the spiked sample's matrix interferes with the spike recovery.
 N/A = not enough sample to perform matrix spike and matrix spike duplicate.
 NR = analyte concentration in sample exceeds spike amount for soil matrix or exceeds 2x spike amount for water matrix or sample diluted due to high matrix or analyte content.



QC SUMMARY REPORT FOR SW8015B

W.O. Sample Matrix: Soil

QC Matrix: Soil

BatchID: 46192

WorkOrder: 0910023

Analyte	Extraction SW3550C								Spiked Sample ID: 0910023-016A			
	Sample	Spiked	MS	MSD	MS-MSD	LCS	LCSD	LCS-LCSD	Acceptance Criteria (%)			
	mg/Kg	mg/Kg	% Rec.	% Rec.	% RPD	% Rec.	% Rec.	% RPD	MS / MSD	RPD	LCS/LCSD	RPD
TPH-Diesel (C10-C23)	41	20	NR	NR	NR	102	111	8.18	70 - 130	30	70 - 130	30
%SS:	94	50	95	94	0.848	94	103	9.55	70 - 130	30	70 - 130	30

All target compounds in the Method Blank of this extraction batch were ND less than the method RL with the following exceptions:
NONE

BATCH 46192 SUMMARY

Lab ID	Date Sampled	Date Extracted	Date Analyzed	Lab ID	Date Sampled	Date Extracted	Date Analyzed
0910023-009A	10/01/09 3:10 PM	10/01/09	10/02/09 3:15 PM	0910023-010A	10/01/09 3:23 PM	10/01/09	10/03/09 2:13 AM
0910023-011A	10/01/09 3:57 PM	10/01/09	10/06/09 1:18 AM	0910023-012A	10/01/09 4:06 PM	10/01/09	10/03/09 1:28 PM
0910023-013A	10/01/09 4:20 PM	10/01/09	10/03/09 3:21 AM	0910023-014A	10/01/09 4:26 PM	10/01/09	10/03/09 8:46 AM
0910023-015A	10/01/09 4:30 PM	10/01/09	10/03/09 5:39 AM	0910023-016A	10/01/09 4:45 PM	10/01/09	10/06/09 10:52 AM

MS = Matrix Spike; MSD = Matrix Spike Duplicate; LCS = Laboratory Control Sample; LCSD = Laboratory Control Sample Duplicate; RPD = Relative Percent Deviation.

% Recovery = 100 * (MS-Sample) / (Amount Spiked); RPD = 100 * (MS - MSD) / ((MS + MSD) / 2).

MS / MSD spike recoveries and / or %RPD may fall outside of laboratory acceptance criteria due to one or more of the following reasons: a) the sample is inhomogenous AND contains significant concentrations of analyte relative to the amount spiked, or b) the spiked sample's matrix interferes with the spike recovery.

N/A = not enough sample to perform matrix spike and matrix spike duplicate.

NR = analyte concentration in sample exceeds spike amount for soil matrix or exceeds 2x spike amount for water matrix or sample diluted due to high matrix or analyte content.

UNIFIED PROGRAM CONSOLIDATED FORM
HAZARDOUS WASTE
HAZARDOUS WASTE TANK CLOSURE CERTIFICATION

I. FACILITY IDENTIFICATION

BUSINESS NAME (Same as FACILITY NAME or DBA - Doing Business As)	5.	FACILITY ID#
Former GAS STATION		
TANK OWNER NAME		
ATHAN MAGGANAS Bruder LLC		
TANK OWNER ADDRESS		
6501 SHATTUCK AVE		
TANK OWNER CITY	742.	STATE
OAKLAND		CA
	743.	ZIP CODE

II. TANK CLOSURE INFORMATION

TANK INTERIOR ATMOSPHERE READINGS	Tank ID # (Attach additional copies of this page for more than three tanks)	Concentration of Flammable Vapor			Concentration of Oxygen		
		Top	Center	Bottom	Top	Center	Bottom
1	GAS 745.	0 745a.	0 745b.	0 745c.	20.9 747a.	20.9 747b.	20.9 747c.
2	GAS 746.	0 746a.	0 746b.	0 746c.	20.9 750a.	20.9 750b.	20.9 750c.
3	GAS 751.	0 752a.	0 752b.	0 752c.	20.9 753a.	20.9 753b.	20.9 753c.

III. CERTIFICATION

On examination of the tank, I certify the tank is visually free from product, sludge, scale (thin, flaky residual of tank contents), residue and debris. I further certify that the information provided herein is true and accurate to the best of my knowledge.

SIGNATURE OF CERTIFIER	754.	STATUS OR AFFILIATION OF CERTIFYING PERSON
Lee DAVIS		Certifier is a representative of the CUPA, authorized agency, or LIA: <input type="checkbox"/> Yes <input checked="" type="checkbox"/> No
TITLE OF CERTIFIER	755.	Name of CUPA, authorized agency, or LIA:
Supv		N/A
ADDRESS	756.	If certifier is other than CUPA / LIA check appropriate box below:
3900 MAIN ST SUITE B		<input type="checkbox"/> a. Certified Industrial Hygienist (CIH)
CITY	757.	<input type="checkbox"/> b. Certified Safety Professional (CSP)
OAKLEY		<input type="checkbox"/> c. Certified Marine Chemist (CMC)
PHONE	758.	<input type="checkbox"/> d. Registered Environmental Health Specialist (REHS)
925-625-1736		<input type="checkbox"/> e. Professional Engineer (PE)
DATE	759.	<input type="checkbox"/> f. Class II Registered Environmental Assessor
9-29-09		<input checked="" type="checkbox"/> g. Contractors' State License Board licensed contractor (with hazardous substance removal certification)
CERTIFICATION TIME		
1600		

TANK PREVIOUSLY HELD FLAMMABLE OR COMBUSTIBLE MATERIALS 763.

(If yes, the tank interior atmosphere shall be re-checked with a combustible gas indicator prior to work being conducted on the tank.) Yes No

CERTIFIER'S TANK MANAGEMENT INSTRUCTIONS FOR SCRAP DEALER, DISPOSAL FACILITY, ETC: 764.

NO OPEN FLAMES.

A copy of this certificate shall accompany the tank to the recycling/disposal facility and be provided to the agency overseeing tank closure (i.e. CUPA or other authorized local agency); the owner and/or operator of the tank system; and the tank removal contractor.

UNIFIED PROGRAM CONSOLIDATED FORM
HAZARDOUS WASTE
HAZARDOUS WASTE TANK CLOSURE CERTIFICATION

Page 2 of 2

I. FACILITY IDENTIFICATION

BUSINESS NAME (Same as FACILITY NAME or DBA - Doing Business As)	3.	FACILITY ID#	1.
former GAS STATION			
TANK OWNER NAME	740.	ATHAN MAGANAS BRUDER LLC	
TANK OWNER ADDRESS	741.	6501 SHATTUCK AVE	
TANK OWNER CITY	742.	STATE	743.
OAKLAND		CA	744.
ZIP CODE			

II. TANK CLOSURE INFORMATION

TANK INTERIOR ATMOSPHERE READINGS	Tank ID # (Attach additional copies of this page for more than three tanks)	Concentration of Flammable Vapor			Concentration of Oxygen		
		Top	Center	Bottom	Top	Center	Bottom
4	GAS 745.	0 745a.	0 745b.	0 745c.	20.9 747a.	20.9 747b.	20.9 747c.
5	Oil 748.	0 748a.	0 748b.	0 748c.	20.9 750a.	20.9 750b.	20.9 750c.
6	GAS 751.	0 751a.	0 751b.	0 751c.	20.9 753a.	20.9 753b.	20.9 753c.

III. CERTIFICATION

On examination of the tank, I certify the tank is visually free from product, sludge, scale (thin, flaky residual of tank contents), rust and debris. I further certify that the information provided herein is true and accurate to the best of my knowledge.

SIGNATURE OF CERTIFIER	STATUS OR AFFILIATION OF CERTIFYING PERSON
	Certifier is a representative of the CUPA, authorized agency, or LIA: 760.
NAME OF CERTIFIER (Print) 754.	<input type="checkbox"/> Yes <input checked="" type="checkbox"/> No
Lee DAVIS	Name of CUPA, authorized agency, or LIA: 761.
TITLE OF CERTIFIER 755.	N/A
SUPV	If certifier is other than CUPA / LIA check appropriate box below: 762.
ADDRESS 756.	<input type="checkbox"/> a. Certified Industrial Hygienist (CIH)
3900 MAIN ST SUITE B	<input type="checkbox"/> b. Certified Safety Professional (CSP)
CITY 757.	<input type="checkbox"/> c. Certified Marine Chemist (CMC)
OAKLEY	<input type="checkbox"/> d. Registered Environmental Health Specialist (REHS)
PHONE 758.	<input type="checkbox"/> e. Professional Engineer (PE)
925-625-1736	<input type="checkbox"/> f. Class II Registered Environmental Assessor
DATE 759.	<input checked="" type="checkbox"/> g. Contractors' State License Board licensed contractor (with hazardous substance removal certification)
9-29-09	
CERTIFICATION TIME	
1600	

TANK PREVIOUSLY HELD FLAMMABLE OR COMBUSTIBLE MATERIALS 763.

(If yes, the tank interior atmosphere shall be re-checked with a combustible gas indicator prior to work being conducted on the tank.) Yes No

CERTIFIER'S TANK MANAGEMENT INSTRUCTIONS FOR SCRAP DEALER, DISPOSAL FACILITY, ETC: 764.

NO OPEN FLAMES

A copy of this certificate shall accompany the tank to the recycling/disposal facility and be provided to the agency overseeing tank closure (i.e. CUPA or other authorized local agency); the owner and/or operator of the tank system; and the tank removal contractor.

CES Controlled Environmental Services

General Engineering & Construction

License #720852 A-Haz

P.O. Box 401, Oakley, CA 94551

Telephone (925) 625-1736 ~ Fax (925) 679-1126

CERTIFICATION OF TANK CLEANING

This letter certifies the cleaning of under ground storage tanks. Product, sludge and rinse water have been removed from each tank. Each tank is empty, has been inerted and will be recycled as non hazardous scrap metal.

Location of Tank Cleaning: 6501-SHATTUCK AVE OAKLAND

Tank Composition & Size: 1. Steel - 1000
2. Steel - 1000
3. Steel 2000
4. STEEL 2000

Method of Cleaning: HIGH Pressure WASHING

Type of Cleaning: WATER WASHING

Date of Cleaning: 9-29-09

Tank Destination: SCRAP METAL

Tank Cleaning Company: CES

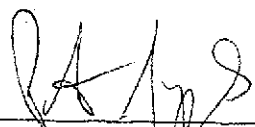

Certification of Tank Owner

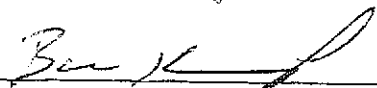

CES Controlled Environmental Services
Project Manager

CES Controlled Environmental Services

General Engineering & Construction

License #720552 A-Haz

P.O. Box 401, Oakley, CA 94551

Telephone (925) 626-1738 ~ Fax (925) 679-1128

CERTIFICATION OF TANK CLEANING

This letter certifies the cleaning of under ground storage tanks. Product, sludge and rinse water have been removed from each tank. Each tank is empty, has been inerted and will be recycled as non hazardous scrap metal.

Location of Tank Cleaning: 6501-SHATTUCK AVE OAKLAND

Tank Composition & Size: 5# STEEL 2000 GALLON

6# STEEL 50 GALLON

3. _____

4. _____

Method of Cleaning: HIGH PRESSURE WASHING.

Type of Cleaning: WATER WASHING

Date of Cleaning: 9-29-09

Tank Destination: SCRAP METAL

Tank Cleaning Company: CES

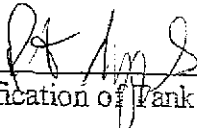
Certification of Tank Owner

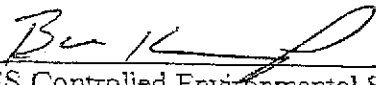
CES Controlled Environmental Services
Project Manager



CLEARWATER

ENVIRONMENTAL MANAGEMENT, INC.

WE ACCEPT VISA & MASTERCARD



REMIT TO:

P.O. Box 2407 UNION CITY, CA 94587-2407
(800) 499-3676 FAX (510) 476-1786
CAR 000 007 013

P.O. Box 349 SILVER SPRINGS, NV 89429-0349
(775) 577-9001 FAX (775) 577-9199
NVD 982 358 483 (800) 471-2105

Bill of Lading

Invoice # 182778

Date 9/29/09

BILLING INFORMATION

JOB SITE

NAME <i>Controlled Envir Svcs</i>			NAME <i>6501 Shattuck</i>			PO#	CASH	CHECK
ADDRESS <i>PO Box 401</i>			ADDRESS <i>OT Klums</i>			CUSTOMER EPA ID # <i>Cal 00264677</i>		
CITY <i>Oakley</i>	STATE <i>Ca</i>	ZIP <i>94561</i>	CITY	STATE	ZIP	PROFILE #		
PHONE NO. <i>(925) 625-1736</i>			PHONE NO. <i>()</i>			CUSTOMER ID #		

PRODUCT	PROPER SHIPPING DESCRIPTION	WASTE CODE	MANIFEST NUMBER	QUANTITY	UNITS	PRICE	AMOUNT
Used Oil, Non-RCRA Hazardous Waste, Liquid		221					
Used Automotive Antifreeze, Non-RCRA Hazardous Waste, Liquid		134					
Oily Water Non-RCRA Hazardous Waste, Liquid			<i>223 004524-KJH 2/00</i>		<i>6</i>		
Non RCRA Hazardous Waste Solid							
Oil Contaminated Debris / Soil							
Waste Combustible Liquid nos 3 UN1993, PG III							
Non Hazardous Waste Liquid							
Non Hazardous Waste Solid							
Transportation Charges		<i>α</i>		<i>7</i>	<i>hr</i>		
Washout Charges							
Drained Used Oil Filters							
Empty Drums							
Additional Labor							
Pressure Washer							
Other:							

DISPOSAL/RECYCLING FACILITY:	Collection Station	Industrial	Agriculture	Government	Marine	TOTAL
-------------------------------------	--------------------	------------	-------------	------------	--------	--------------

<input type="checkbox"/> Alviso Independent Oil 5002 Archer Street, Alviso, CA CAL 000 161 743; 95002 (510) 476-1740	<input checked="" type="checkbox"/> Clearwater Environmental Mgmt. Inc 2430 Almond Dr. Silver Springs, NV 89429 NVD 982 358 483 (775) 577-9001	<input type="checkbox"/> D/K Environmental 3650 E. 26th Street, Vernon, CA CAT 080 033 661; 93023 (323) 268-5056
<input type="checkbox"/> Onyx Environmental Services 1125 Hensley Street, Richmond, CA CAT 080 014 079; 94801 (510) 233-8001	<input type="checkbox"/> Seaport Environmental 676 Seaport Blvd, Redwood City, CA CAR 000 140 624; 94053 (650) 364-8154	<input type="checkbox"/> Commercial Filter Recycling 33210 Western Ave, Union City, CA (510) 487-9227; 94587
<input type="checkbox"/> DeMenno Kerdoon 2000 N. Alameda Blvd, Compton, CA CAT 080 013 352; 90222 (310) 537-7100	<input type="checkbox"/> Evergreen Oil 6860 Smith Ave, Newark, CA CAD 980 687 418; 94560 (510) 795-4400	

NET 10 DAYS

I hereby certify that all information submitted in this and all attached documents contain true and accurate descriptions of the waste. All relevant information regarding known or suspected hazards associated with the wastes has been disclosed. I certify that we have an established program to reduce the volume of waste to the degree to be economically practicable.

DRIVER SIGNATURE *[Signature]*

GENERATOR SIGNATURE *[Signature]*

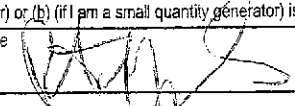
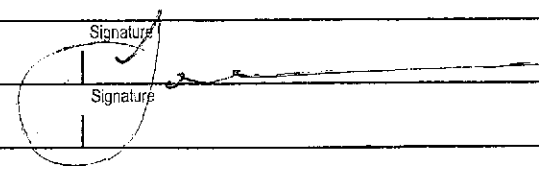
UNIFORM HAZARDOUS WASTE MANIFEST		1. Generator ID Number CAC002646777	2. Page 1 of 1	3. Emergency Response Phone (510)476-1740	4. Manifest Tracking Number 004452845 JJK				
5. Generator's Name and Mailing Address BRUDER LLC 2550 APPIAN WAY SUITE 201 PINOLE CA 945642262				Generator's Site Address (if different than mailing address) 6501 SHATTUCK AVE OAKLAND CA 946091017					
6. Transporter 1 Company Name UNI WASTE					U.S. EPA ID Number CAT000317320				
7. Transporter 2 Company Name					U.S. EPA ID Number				
8. Designated Facility Name and Site Address CLEARWATER ENVIRONMENTAL 2430 ALMOND DRIVE SILVER SPRINGS NV 89429					U.S. EPA ID Number NVD982358483				
9a. HM					9b. U.S. DOT Description (including Proper Shipping Name, Hazard Class, ID Number, and Packing Group (if any)) (775)577-9001 NON RCRA HAZARDOUS WASTE LIQUID (OIL & WATER)		10. Containers No. Type 001 TT		
					11. Total Quantity 2,200		12. Unit Wt./Vol. G		
					13. Waste Codes 223				
14. Special Handling Instructions and Additional Information WEAR PPE, ERG # 171									
15. GENERATOR'S/OFFEROR'S CERTIFICATION: I hereby declare that the contents of this consignment are fully and accurately described above by the proper shipping name, and are classified, packaged, marked and labeled/placarded, and are in all respects in proper condition for transport according to applicable international and national governmental regulations. If export shipment and I am the Primary Exporter, I certify that the contents of this consignment conform to the terms of the attached EPA Acknowledgment of Consent. I certify that the waste minimization statement identified in 40 CFR 262.27(a) (if I am a large quantity generator) or (b) (if I am a small quantity generator) is true.									
Generator's/Offoror's Printed/Typed Name Peter Maganias					Signature 		Month 09	Day 29	Year 10
16. International Shipments <input type="checkbox"/> Import to U.S. <input type="checkbox"/> Export from U.S. Port of entry/exit: _____ Date leaving U.S.: _____									
17. Transporter Acknowledgment of Receipt of Materials									
Transporter 1 Printed/Typed Name Von Fischer					Signature 		Month 09	Day 29	Year 10
Transporter 2 Printed/Typed Name					Signature		Month	Day	Year
18. Discrepancy									
18a. Discrepancy Indication Space <input type="checkbox"/> Quantity <input type="checkbox"/> Type <input type="checkbox"/> Residue <input type="checkbox"/> Partial Rejection <input type="checkbox"/> Full Rejection									
18b. Alternate Facility (or Generator) Manifest Reference Number: _____ U.S. EPA ID Number _____									
18c. Signature of Alternate Facility (or Generator) _____ Month _____ Day _____ Year _____									
19. Hazardous Waste Report Management Method Codes (i.e., codes for hazardous waste treatment, disposal, and recycling systems)									
1. _____		2. _____		3. _____		4. _____			
20. Designated Facility Owner or Operator. Certification of receipt of hazardous materials covered by the manifest except as noted in Item 18a									
Printed/Typed Name _____					Signature _____		Month _____	Day _____	Year _____



CLEARWATER

ENVIRONMENTAL MANAGEMENT, INC.

WE ACCEPT VISA & MASTERCARD



REMIT TO:

P.O. Box 2407 UNION CITY, CA 94587-2407
(800) 499-3676 FAX (510) 476-1786
CAR 000 007 013

P.O. Box 349 SILVER SPRINGS, NV 89429-0349
(775) 577-9001 FAX (775) 577-9199
NVD 982 358 483 (800) 471-2105

Bill of Lading

Invoice # **184411**

Date **SEP 30, 2009**

BILLING INFORMATION

JOB SITE BRUDER LLC

NAME CONTROLLED ENVIRONMENTAL SER			NAME EAST BAY SMOG CENTER			PO #	CASH	CHECK
ADDRESS P.O. Box 401			ADDRESS 6501 S. INATUCK			CUSTOMER EPA ID # CAR 002646777		
CITY OAKLEY	STATE CA	ZIP 94561	CITY OAKLAND	STATE CA	ZIP	PROFILE #		
PHONE NO. (925) 625-1736			PHONE NO.			CUSTOMER ID #		

PRODUCT	PROPER SHIPPING DESCRIPTION	WASTE CODE	MANIFEST NUMBER	QUANTITY	UNITS	PRICE	AMOUNT
Used Oil, Non-RCRA Hazardous Waste, Liquid		221					
Used Automotive Antifreeze, Non-RCRA Hazardous Waste, Liquid		134					
Oily Water Non-RCRA Hazardous Waste, Liquid		W3	004449151 JK	375	4		
Non RCRA Hazardous Waste Solid							
Oil Contaminated Debris / Soil							
Waste Combustible Liquid nos 3 UN1993, PG III							
Non Hazardous Waste Liquid							
Non Hazardous Waste Solid							
Transportation Charges					4.5 hrs		
Washout Charges							
Drained Used Oil Filters							
Empty Drums							
Additional Labor							
Pressure Washer							
Other:							

DISPOSAL/RECYCLING FACILITY:	Collection Station	Industrial	Agriculture	Government	Marine	TOTAL	\$708.75	
<input type="checkbox"/> Aviso Independent Oil 5002 Archer Street, Alviso, CA CAL 000 161 745; 95002 (510) 476-1740	<input checked="" type="checkbox"/> Clearwater Environmental Mgmt. Inc. 2430 Almond Dr. Silver Springs, NV 89429 NVD 982 358 483 (775) 577-9001	<input type="checkbox"/> Siemens Water Tech 5375 S. Boyle Ave; Vernon, CA CAD 097 030 995; 90358 (800) 265-7747						NET 10 DAYS
<input type="checkbox"/> Pacific Recovery Resource 3150 Pico Blvd; Los Angeles, CA CAD 008 252 405; 90023	<input type="checkbox"/> Seaport Environmental 675 Seaport Blvd, Redwood City, CA CAR 000 140 624; 94063 (650) 364-8154	<input type="checkbox"/> Commercial Filter Recycling 33210 Western Ave; Union City, CA (510) 487-9227; 94587						
<input type="checkbox"/> DeMerno Kerdon 2000 N. Alameda Blvd; Compton, CA CAT 080 013 352; 90222 (310) 537-7100	<input type="checkbox"/> Crosby & Overton 1630 W. 17th Street; Long Beach, CA CAD 028 409 019; 90183	<input type="checkbox"/>						

I hereby certify that all information submitted in this and all attached documents contain true and accurate descriptions of the waste. All relevant information regarding known or suspected hazards associated with the wastes has been disclosed. I certify that we have an established program to reduce the volume of waste to the degree to be economically practicable.

DRIVER SIGNATURE: *[Signature]* KIRK HAYWARD

GENERATOR SIGNATURE: *[Signature]*

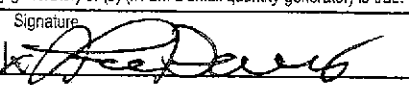
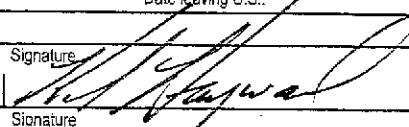
UNIFORM HAZARDOUS WASTE MANIFEST		1. Generator ID Number CAC602 646 777	2. Page 1 of 1	3. Emergency Response Phone (510)476-1740	4. Manifest Tracking Number 004449151 JJK		
5. Generator's Name and Mailing Address BRUDER LLC 2550 ARRIAN WAY SUITE 201 PINOLE CA 94864-2262				Generator's Site Address (if different than mailing address) EAST BAY BOWL CENTER 6501 SNATUCK O OAKLAND CA			
Generator's Phone: 510-223-4433				U.S. EPA ID Number CA L 0 0 0 3 1 7 3 2 0			
6. Transporter 1 Company Name UNI WASTE				U.S. EPA ID Number			
7. Transporter 2 Company Name				U.S. EPA ID Number			
8. Designated Facility Name and Site Address CLEARWATER ENVIRONMENTAL 2430 ALMOND DRIVE SILVER SPRINGS NV 89429				U.S. EPA ID Number NVD 9 8 2 3 5 8 4 8 3			
Facility's Phone: (775)577-9001				U.S. EPA ID Number			
9a. HM	9b. U.S. DOT Description (including Proper Shipping Name, Hazard Class, ID Number, and Packing Group (if any))	10. Containers		11. Total Quantity	12. Unit Wt./Vol.	13. Waste Codes	
		No.	Type				
1.	WASTE COMBUSTIBLE LIQUID, NOS, 3, UN 1995 PG III OILY W/		TT			223	
2.	OILY WATER NON PCRS HAZARDOUS WASTE LIQUID	001	TT	375	G	223	
3.							
4.							
14. Special Handling Instructions and Additional Information WEAR PPE, ERG #128							
15. GENERATOR'S/OFFEROR'S CERTIFICATION: I hereby declare that the contents of this consignment are fully and accurately described above by the proper shipping name, and are classified, packaged, marked and labeled/placarded, and are in all respects in proper condition for transport according to applicable international and national governmental regulations. If export shipment and I am the Primary Exporter, I certify that the contents of this consignment conform to the terms of the attached EPA Acknowledgment of Consent. I certify that the waste minimization statement identified in 40 CFR 262.27(a) (if I am a large quantity generator) or (b) (if I am a small quantity generator) is true.							
Generator's/Offoror's Printed/Typed Name Lee Davis Agent for Brucker LLC				Signature 		Month Day Year 09 30 09	
16. International Shipments <input type="checkbox"/> Import to U.S. <input type="checkbox"/> Export from U.S. Port of entry/exit: _____ Date leaving U.S.: _____							
17. Transporter Acknowledgment of Receipt of Materials							
Transporter 1 Printed/Typed Name Rick Johnson				Signature 		Month Day Year 09 30 09	
Transporter 2 Printed/Typed Name				Signature		Month Day Year	
18. Discrepancy							
18a. Discrepancy Indication Space <input type="checkbox"/> Quantity <input type="checkbox"/> Type <input type="checkbox"/> Residue <input type="checkbox"/> Partial Rejection <input type="checkbox"/> Full Rejection							
18b. Alternate Facility (or Generator)				Manifest Reference Number: _____ U.S. EPA ID Number _____			
Facility's Phone: _____				U.S. EPA ID Number			
18c. Signature of Alternate Facility (or Generator)						Month Day Year	
19. Hazardous Waste Report Management Method Codes (i.e., codes for hazardous waste treatment, disposal, and recycling systems)							
1.		2.		3.		4.	
20. Designated Facility Owner or Operator: Certification of receipt of hazardous materials covered by the manifest except as noted in Item 18a							
Printed/Typed Name				Signature		Month Day Year	

GENERATOR
INTL
TRANSPORTER
DESIGNATED FACILITY

WEIGHMASTER CERTIFICATE
TRUCK SCALE



WEIGHMASTER CERTIFICATE
THIS IS TO CERTIFY that the following described commodity was weighed, measured, or counted by a weighmaster, whose signature is on this certificate, who is a recognized authority of accuracy, as prescribed by Chapter 7 (commencing with Section 12700) of Division 5 of the California Business and Professions Code, administered by the Division of Measurement Standards of the California Department of Food and Agriculture.
Control No.: 12 166726

Ticket #: TBNCNG
SHIP DATE: 10/01/09

Purchased From: CP012P
CONTROLLED ENVIRONMENTAL
PO BX 401
OAKLEY, CA 94561

WEIGHED AT:

12 RICHMOND, CA. RC3265
600 S. 4TH STREET
RICHMOND, CA 94804-3504
510-412-5300

DL/ID # B9290196 JASON PAYNECHAPP

Veh # TK 6282487 ID # 6282487

SHPMNT#	COMMODITY	GROSS	TARE	NET	ADJ	REASON	PD	WT	RED.	C/W	RD	EXT
TBNCNG #1	Unprepared	20960a	18880b	2080	0		2080	0.0	0.00			
ALL WEIGHTS ARE REPORTED IN POUNDS UNLESS OTHERWISE INDICATED. ALL NON-POUND WEIGHTS ARE ASSUMED TO BE MANUAL WEIGHTS												

TOTALS	# CARS	0	20960	18880	2080	0	2080	0.0	0.00			
--------	--------	---	-------	-------	------	---	------	-----	------	--	--	--

WEIGHMASTER SIGNATURE _____
CUSTOMER SIGNATURE _____
a=SCALE 1 b=SCALE 2 c=SCALE 3 d=SCALE 4 m=MANUAL WEIGHT

GRS Date 10/01/09	METRIC TON
GRS Time 15:12	0.9435
TRE Date 10/01/09	
TRE Time 15:28	

NOT REFUNDABLE MORE THAN 90 DAYS FROM ABOVE DATE

Driver Copy

In accordance with the Clean Air Act and other applicable laws, seller must sign the Scrap Acceptance Agreement form provided at the scale at least one time every 3 years, which applies to any recyclables in the transaction which may contain or have contained refrigerants or other potential Hazardous Materials.

FOR SALVAGE VEHICLE SALES: I hereby certify, under penalty of perjury that any vehicle sold has been cleared for dismantling with the Department of Motor Vehicles.

HOLD HARMLESS AGREEMENT: Seller will indemnify and hold buyer harmless for damages, demands and liabilities, including reasonable attorney's fees, resulting from the breach of any warranty hereunder and driver agrees to be responsible for damage to vehicle during unloading.

BILL OF SALE: I warrant that I am the owner (or owner's representative) of the material described herein and have the right to sell same, that it contains no Hazardous Material as defined in the Scrap Acceptance Agreement or otherwise by any federal or state law and that for payment hereby received, I sell and convey title to Sims Hugo Neu.

Seller certifies that all refrigerant including but not limited to Chlorofluorocarbons and Hydrochlorofluorocarbons (collectively "CFC's") Refrigerants and their substitutes as defined in section 608 of the Clean Air Act that has not leaked previously have been recovered from appliance and motor vehicles prior to delivery. I understand it is unlawful to release Freon and CFC's into the atmosphere and that any CFC's must be properly removed before appliances or motor vehicle air conditioners can be recycled. I verify that either (check one):

- (1) all CFC's previously leaked from this container, or
- (2) all CFC's were properly recovered in accordance with 40 C.F.R. Section 82.156(g) and (h) by:

El vendedor certifica que todos los refrigerantes incluyendo pero no limitado a CFC's y HCFC's Refrigerantes y sus sustitutos como se define en la sección 608 del Acta de Aire Limpio que no ha goteado previamente han sido recuperados de los electrodomésticos y automóviles antes de ser entregados.
Yo entiendo que es contra la ley liberar Freón y otros clorofluorocarbonos y hidroclorofluorocarbonos (legalmente llamados CFC's) en el aire y que todos los CFC's tienen que estar removidos apropiadamente antes de que los aparatos o aire acondicionados de los carros puedan ser reciclados. Yo verifico que (cheque uno):

- (1) todos los CFC's han sido previamente evacuados de este contenedor, o
- (2) todos los CFC's fueron recuperados en forma apropiada de acuerdo con 40 C.F.R. Sección 82.156(g) y (h) por:

Name/Nombre: _____
Address/Dirección: _____
Date/Fecha: _____
Seller Signed/Seller Firma: _____
Printed Name/Nombre: _____
Date/Fecha: _____

Seller's Warrant/Seller's Warrant: Seller warrants and represents to the Purchaser the material transferred, by the Seller to the Purchaser pursuant to this Agreement is not and does not contain a "hazardous substance" as said term is defined in the current applicable federal or state environmental laws, rules, or regulations. In the event Purchaser incurs any liability or obligation due to a breach of said warranty and representation, Seller agrees to indemnify and hold Purchaser harmless from all such liabilities and obligations. Notwithstanding the foregoing, nothing set forth herein shall constitute a waiver by Seller of any rights under the law pursuant to any written or oral agreements that it may have against any entity.

EL VENDEDOR GARANTIZA. El vendedor garantiza y representa al Comprador que el material transferido, por el Vendedor al Comprador de acuerdo a este acuerdo no es y no contiene "sustancias peligrosas" como se dijo en e termino como se define en las leyes, reglas, o regulaciones ambientales federales y estatales. En el evento que el Comprador incurra alguna responsabilidad u obligación por el rompimiento de dicha garantía y representación. El Vendedor acuerda en indemnizar y no hacer responsable al Comprador de toda dicha responsabilidad y obligación. No obstante lo precedente, nada dicho aquí constituirá una renuncia por el Vendedor de cualquier derecho bajo la ley según cualquier acuerdo escrito u oral que pueda tener en contra de cualquier entidad."

WEIGHMASTER CERTIFICATE
TRUCK SCALE



Ticket #: **TBNCNG**
SHIP DATE: 10/01/09

Purchased From: CP012P
CONTROLLED ENVIRONMENTAL
PO BX 401
OAKLEY, CA 94561

WEIGHED AT:

WEIGHMASTER CERTIFICATE
THIS IS TO CERTIFY that the following described commodity was weighed, measured, or counted by a weighmaster, whose signature is on this certificate, who is a recognized authority of accuracy, as prescribed by Chapter 7 (commencing with Section 12700) of Division 5 of the California Business and Professions Code, administered by the Division of Measurement Standards of the California Department of Food and Agriculture.
Control No.: 12 166726

12 RICHMOND, CA. RC3265
600 S. 4TH STREET
RICHMOND, CA 94804-3504
510-412-5300

DL/ID # B9290196 JASON PAYNECHAPP

Veh # TK 6282487 ID # 6282487

SHPMNT#	COMMODITY	GROSS	TARE	NET	ADJ	REASON	PD	WT	RED	C/W	RD	EXT	CBK	FRT	PRICE	TOTAL AMT
TBNCNG #1	Unprepared	20960a	18880b	2080	0		2080	0.0	0.00	0.00	130.0000NT					135.20

ALL WEIGHTS ARE REPORTED IN POUNDS UNLESS OTHERWISE INDICATED. ALL NON-POUND WEIGHTS ARE ASSUMED TO BE MANUAL WEIGHTS

TOTALS	# CARS	0	20960	18880	2080	0	2080	0.0	0.00	0.00						135.20
--------	--------	---	-------	-------	------	---	------	-----	------	------	--	--	--	--	--	--------

WEIGHMASTER SIGNATURE

(Traci Crespo)

(Traci Crespo)

GRS Date 10/01/09 METRIC TON
GRS Time 15:12 0.9435
TRE Date 10/01/09
TRE Time 15:28

CUSTOMER SIGNATURE

a=SCALE 1 b=SCALE 2 c=SCALE 3 d=SCALE 4 m=MANUAL WEIGHT

NOT REFUNDABLE MORE THAN 90 DAYS FROM ABOVE DATE

Customer Copy

In accordance with the Clean Air Act and other applicable laws, seller must sign the Scrap Acceptance Agreement provided at the scale at least one time every 3 years, which applies to any vehicle in the transaction which may contain or have contained refrigerants or other potential Hazardous Materials.
Total Paid at 10/01/09 3:30PM by Check No. 414512 \$135.20

FOR SALVAGE VEHICLE SALES: I hereby certify, under penalty of perjury that any vehicle sold has been cleared for dismantling with the Department of Motor Vehicles.

HOLD HARMLESS AGREEMENT: Seller will indemnify and hold buyer harmless for damages, demands and liabilities, including reasonable attorney's fees, resulting from the breach of any warranty hereunder and driver agrees to be responsible for damage to vehicle during unloading.

BILL OF SALE: I warrant that I am the owner (or owner's representative) of the material described hereon and have the right to sell same, that it contains no Hazardous Material as defined in the Scrap Acceptance Agreement or otherwise by any federal or state law and that for payment hereby received, I sell and convey title to Sims Hugo Neu.

Seller certifies that all refrigerant including but not limited to Chlorofluorocarbons and Hydrochlorofluorocarbons (collectively "CFC's") Refrigerants and their substitutes as defined in section 608 of the Clean Air Act that has not leaked previously have been recovered from appliance and motor vehicles prior to delivery. I understand it is unlawful to release Freon and CFC's into the atmosphere and that any CFC's must be properly removed before appliances or motor vehicle air conditioners can be recycled. I verify that either (check one):

- (1) all CFC's previously leaked from this container, or
- (2) all CFC's were properly recovered in accordance with 40 C.F.R. Section 82.156(g) and (h) by:

El vendedor certifica que todos los refrigerantes incluyendo pero no limitado a CFC's y HCFC's Refrigerantes y sus substitutos como se define en la sección 608 del Acta de Aire Limpio que no ha goteado previamente han sido recuperados de los electrodomésticos y automóviles antes de ser entregados.

Yo entiendo que es contra la ley liberar Freón y otros clorofluorocarbonos y hidroclofluorocarbonos (legalmente llamados CFC's) en el aire y que todos los CFC's tienen que estar removidos apropiadamente antes de que los aparatos o aire acondicionados de los carros puedan ser reciclados. Yo verifique que (cheque uno):

- (1) todos los CFC's han sido previamente evacuados de este contenedor, o
- (2) todos los CFC's fueron recuperados en forma apropiada de acuerdo con 40 C.F.R. Sección 82.156(g) y (h) por:

Name/Nombre: _____

Address/Dirección: _____

Date/Fecha: _____

Seller Signed/Seller Firma: _____

Printed Name/Nombre: _____

Date/Fecha: _____

Seller's Warrant/Seller's Warrant: Seller warrants and represents to the Purchaser the material transferred, by the Seller to the Purchaser pursuant to this Agreement is not and does not contain a "hazardous substance" as said term is defined in the current applicable federal or state environmental laws, rules, or regulations. In the event Purchaser incurs any liability or obligation due to a breach of said warranty and representation, Seller agrees to indemnify and hold Purchaser harmless from all such liabilities and obligations. Notwithstanding the foregoing, nothing set forth herein shall constitute a waiver by Seller of any rights under the law pursuant to any written or oral agreements that it may have against any entity.

EL VENDEDOR GARANTIZA. El vendedor garantiza y representa al Comprador que el material transferido, por el Vendedor al Comprador de acuerdo a este acuerdo no es y no contiene "sustancias peligrosas" como se dijo en e termino como se define en las leyes, reglas, o regulaciones ambientales federales y estatales. En el evento que el Comprador incurra alguna responsabilidad u obligación por el rompimiento de dicha garantía y representación. El Vendedor acuerda en indemnizar y no hacer responsable al Comprador de toda dicha responsabilidad y obligación. No obstante lo precedente, nada dicho aquí constituirá una renuncia por el Vendedor de cualquier derecho bajo la ley según cualquier acuerdo escrito u oral que pueda tener en contra de cualquier entidad.

WEIGHMASTER CERTIFICATE
TRUCK SCALE



WEIGHMASTER CERTIFICATE

THIS IS TO CERTIFY that the following described commodity was weighed, measured, or counted by a weighmaster, whose signature is on this certificate, who is a recognized authority of accuracy, as prescribed by Chapter 7 (commencing with Section 12700) of Division 5 of the California Business and Professions Code, administered by the Division of Measurement Standards of the California Department of Food and Agriculture.

Ticket #: **TBNCLE**

Purchased From: CP012P
CONTROLLED ENVIRONMENTAL SERVI
PO BX 401
OAKLEY, CA 94561

SHIP DATE: 10/01/09

WEIGHED AT:

12 RICHMOND, CA. RC3265
600 S. 4TH STREET
RICHMOND, CA 94804-3504
510-412-5300

Control No.: 12 166674

DL/ID # B9290796 JASON PAYNECHAPP

Veh # TK 6282487 ID # 6282487

SHPMNT#	COMMODITY	GROSS	TARE	NET	ADJ	REASON	PD	WT	RED	C/W	RD	EXT
TBNCLE #1	Unprepared	22920a	18940b	3980	0			3980	0.0			0.00

ALL WEIGHTS ARE REPORTED IN POUNDS UNLESS OTHERWISE INDICATED. ALL NON-POUND WEIGHTS ARE ASSUMED TO BE MANUAL WEIGHTS

TOTALS	# CARS	0	22920	18940	3980	0		3980	0.0			0.00
--------	--------	---	-------	-------	------	---	--	------	-----	--	--	------

WEIGHMASTER SIGNATURE

[Signature]
(Traci Crespo)

CUSTOMER SIGNATURE

[Signature]

GRS Date 10/01/09	METRIC TON
GRS Time 13:16	1.8053
TRE Date 10/01/09	
TRE Time 13:33	

a=SCALE 1 b=SCALE 2 c=SCALE 3 d=SCALE 4 m=MANUAL WEIGHT

NOT REFUNDABLE MORE THAN 90 DAYS FROM ABOVE DATE

Driver Copy

In accordance with the Clean Air Act and other applicable laws, seller must sign the Scrap Acceptance Agreement form provided at the scale at least one time every 3 years, which applies to any recyclables in the transaction which may contain or have contained refrigerants or other potential Hazardous Materials

FOR SALVAGE VEHICLE SALES: I hereby certify, under penalty of perjury that any vehicle acid has been cleaned for dismantling with the Department of Motor Vehicles.

HOLD HARMLESS AGREEMENT: Seller will indemnify and hold buyer harmless for damages, demands and liabilities, including reasonable attorney's fees, resulting from the breach of any warranty hereunder and driver agrees to be responsible for damage to vehicle during unloading.

BILL OF SALE: I warrant that I am the owner (or owner's representative) of the material described hereon and have the right to sell same, that it contains no Hazardous Material as defined in the Scrap Acceptance Agreement or otherwise by any federal or state law and that for payment hereby received, I sell and convey title to Sims Hugo Neu.

Seller certifies that all refrigerant including but not limited to Chlorofluorocarbons and Hydrochlorofluorocarbons (collectively "CFC's") Refrigerants and their substitutes as defined in section 608 of the Clean Air Act that has not leaked previously have been recovered from appliance and motor vehicles prior to delivery. I understand it is unlawful to release Freon and CFC's into the atmosphere and that any CFC's must be properly removed before appliances or motor vehicle air conditioners can be recycled. I verify that either (check one):

- (1) all CFC's previously leaked from this container, or
- (2) all CFC's were properly recovered in accordance with 40 C.F.R. Section 82.156(g) and (h) by:

El vendedor certifica que todos los refrigerantes incluyendo pero no limitado a CFC's y HCFC's Refrigerantes y sus substitutos como se define en la sección 608 del Acta de Aire Limpio que no ha goteado previamente han sido recuperados de los electrodomésticos y automóviles antes de ser entregados.

Yo entiendo que es contra la ley liberar Freón y otros clorofluorocarbonos y hidroclorofluorocarbonos (legalmente llamados CFC's) en el aire y que todos los CFC's tienen que estar removidos apropiadamente antes de que los aparatos o aire acondicionados de los carros puedan ser reciclados. Yo verifico que (cheque uno):

- (1) todos los CFC's han sido previamente evacuados de este contenedor, o
- (2) todos los CFC's fueron recuperados en forma apropiada de acuerdo con 40 C.F.R. Sección 82.156(g) y (h) por:

Name/Nombre: _____

Address/Dirección: _____

Date/Fecha: _____

Seller Signed/Seller Firma: _____

Printed Name/Nombre: _____

Date/Fecha: _____

Seller's Warrant/Seller's Warrant: Seller warrants and represents to the Purchaser the material transferred, by the Seller to the Purchaser pursuant to this Agreement is not and does not contain a "hazardous substance" as said term is defined in the current applicable federal or state environmental laws, rules, or regulations. In the event Purchaser incurs any liability or obligation due to a breach of said warranty and representation, Seller agrees to indemnify and hold Purchaser harmless from all such liabilities and obligations. Notwithstanding the foregoing, nothing set forth herein shall constitute a waiver by Seller of any rights under the law pursuant to any written or oral agreements that it may have against any entity.

EL VENDEDOR GARANTIZA. El vendedor garantiza y representa al Comprador que el material transferido, por el Vendedor al Comprador de acuerdo a este acuerdo no es y no contiene "sustancias peligrosas" como se dijo en a termino como se define en las leyes, reglas, o regulaciones ambientales federales y estatales. En el evento que el Comprador incurra alguna responsabilidad u obligación por el rompimiento de dicha garantía y representación. El Vendedor acuerda en indemnizar y no hacer responsable al Comprador de toda dicha responsabilidad y obligación. No obstante lo precedente, nada dicho aquí constituirá una renuncia por el Vendedor de cualquier derecho bajo la ley según cualquier acuerdo escrito u oral que pueda tener en contra de cualquier entidad."

WEIGHMASTER CERTIFICATE
TRUCK SCALE



Ticket #: **TBNCLE**

Purchased From: CP012P
CONTROLLED ENVIRONMENTAL SERVI
PO BX 401
OAKLEY, CA 94561

SHIP DATE: 10/01/09

WEIGHED AT:

WEIGHMASTER CERTIFICATE

THIS IS TO CERTIFY that the following described commodity was weighed, measured, or counted by a weighmaster, whose signature is on this certificate, who is a recognized authority of accuracy, as prescribed by Chapter 7 (commencing with Section 12700) of Division 6 of the California Business and Professions Code, administered by the Division of Measurement Standards of the California Department of Food and Agriculture.

Control No.: 12 166674

12 RICHMOND, CA. RC3265
600 S. 4TH STREET
RICHMOND, CA 94804-3504
510-412-5300

DL/ID # B9290796 JASON PAYNECHAPP

Veh # TK 6282487 ID # 6282487

SHPMNT#	COMMODITY	GROSS	TARE	NET	ADJ	REASON	PD	WT	RED	C/W	RD	EXT	CBK	FRT	PRICE	TOTAL AMT
TBNCLE #1	Unprepared	22920a	18940b	3980	0			3980	0.0		0.00	0.00		130.0000NT		258.70
<p>ALL WEIGHTS ARE REPORTED IN POUNDS UNLESS OTHERWISE INDICATED. ALL NON-POUND WEIGHTS ARE ASSUMED TO BE MANUAL WEIGHTS</p>																
TOTALS	# CARS	0	22920	18940	3980	0		3980	0.0		0.00	0.00				258.70

WEIGHMASTER SIGNATURE

CUSTOMER SIGNATURE

[Handwritten Signature]

(Traci Crespo)

GRS Date 10/01/09 | METRIC TON
GRS Time 13:16 | 1.8053
TRE Date 10/01/09 |
TRE Time 13:33

a=SCALE 1 b=SCALE 2 c=SCALE 3 d=SCALE 4 m=MANUAL WEIGHT

NOT REFUNDABLE MORE THAN 90 DAYS FROM ABOVE DATE

Customer Copy

In accordance with the Clean Air Act and other applicable laws, seller must sign the Scrap Acceptance Agreement provided at the scale or, at least one time every 3 years, which applies to any refrigerator in the transaction which may contain or have contained refrigerants or other potential hazardous materials. Total Paid at 10/01/09 1:57pm on Truck # 414480 \$258.70

FOR SALVAGE VEHICLE SALES: I hereby certify, under penalty of perjury that any vehicle sold has been cleared for dismantling with the Department of Motor Vehicles.

HOLD HARMLESS AGREEMENT: Seller will indemnify and hold buyer harmless for damages, demands and liabilities, including reasonable attorney's fees, resulting from the breach of any warranty hereunder and driver agrees to be responsible for damage to vehicle during unloading.

BILL OF SALE: I warrant that I am the owner (or owner's representative) of the material described herein and have the right to sell same, that it contains no Hazardous Material as defined in the Scrap Acceptance Agreement or otherwise by any federal or state law and that for payment hereby received, I sell and convey title to Sims Hugo Nau.

Seller certifies that all refrigerant including but not limited to Chlorofluorocarbons and Hydrochlorofluorocarbons (collectively "CFC's") Refrigerants and their substitutes as defined in section 608 of the Clean Air Act that has not leaked previously have been recovered from appliance and motor vehicles prior to delivery. I understand it is unlawful to release Freon and CFC's into the atmosphere and that any CFC's must be properly removed before appliances or motor vehicle air conditioners can be recycled. I verify that either (check one):

- (1) all CFC's previously leaked from this container, or
- (2) all CFC's were properly recovered in accordance with 40 C.F.R. Section 82.156(g) and (h) by:

El vendedor certifica que todos los refrigerantes incluyendo pero no limitado a CFC's y HCFC's Refrigerantes y sus substitutos como se define en la sección 608 del Acta de Aire Limpio que no ha goteado previamente han sido recuperados de los electrodomésticos y automóviles antes de ser entregados.

Yo entiendo que es contra la ley liberar Freón y otros clorofluorocarbonos y hidroclofluorocarbonos (legalmente llamados CFC's) en el aire y que todos los CFC's tienen que estar removidos apropiadamente antes de que los aparatos o aire acondicionados de los carros puedan ser reciclados. Yo verifico que (cheque uno):

- (1) todos los CFC's han sido previamente evacuados de este contenedor, o
- (2) todos los CFC's fueron recuperados en forma apropiada de acuerdo con 40 C.F.R. Sección 82.156(g) y (h) por:

Name/Nombre: _____

Address/Dirección: _____

Date/Fecha: _____

Seller Signed/Seller Firma: _____

Printed Name/Nombre: _____

Date/Fecha: _____

Seller's Warranty/Seller's Warrant: Seller warrants and represents to the Purchaser the material transferred, by the Seller to the Purchaser pursuant to this Agreement is not and does not contain a "hazardous substance" as said term is defined in the current applicable federal or state environmental laws, rules, or regulations. In the event Purchaser incurs any liability or obligation due to a breach of said warranty and representation, Seller agrees to indemnify and hold Purchaser harmless from all such liabilities and obligations. Notwithstanding the foregoing, nothing set forth herein shall constitute a waiver by Seller of any rights under the law pursuant to any written or oral agreements that it may have against any entity.

EL VENDEDOR GARANTIZA. El vendedor garantiza y representa al Comprador que el material transferido, por el Vendedor al Comprador de acuerdo a este acuerdo no es y no contiene "sustancias peligrosas" como se dijo en e termino como se define en las leyes, reglas, o regulaciones ambientales federales y estatales. En el evento que el Comprador incurra alguna responsabilidad u obligación por el rompimiento de dicha garantía y representación. El Vendedor acuerda indemnizar y no hacer responsable al Comprador de toda dicha responsabilidad y obligación. No obstante lo precedente, nada dicho aquí constituirá una renuncia por el Vendedor de cualquier derecho bajo la ley según cualquier acuerdo escrito u oral que pueda tener en contra de cualquier entidad.

WEIGHMASTER CERTIFICATE
TRUCK SCALE



Ticket #: TBNCLF

Purchased From: CP012P
CONTROLLED ENVIRONMENTAL SERVI
PO BX 401
OAKLEY, CA 94561

SHIP DATE: 10/01/09

WEIGHED AT:

WEIGHMASTER CERTIFICATE

THIS IS TO CERTIFY that the following described commodity was weighed, measured, or counted by a weighmaster, whose signature is on this certificate, who is a recognized authority of accuracy, as prescribed by Chapter 7 (commencing with Section 12700) of Division 5 of the California Business and Professions Code, administered by the Division of Measurement Standards of the California Department of Food and Agriculture.

Control No.: 12 166675

12 RICHMOND, CA. RC3265
600 S. 4TH STREET
RICHMOND, CA 94804-3504
510-412-5300

DL/ID # B9290796 JASON PAYNECHAPP

Veh # TK 6N34468 ID # 6N34468

SHPMNT#	COMMODITY	GROSS	TARE	NET	ADJ	REASON	PD	WT	RED	C/W	RD	EXT
TBNCLF #1	Unprepared	12840a	11320b	1520	0		1520	0.0	0.00			
ALL WEIGHTS ARE REPORTED IN POUNDS UNLESS OTHERWISE INDICATED. ALL NON-POUND WEIGHTS ARE ASSUMED TO BE MANUAL WEIGHTS												

TOTALS	# CARS	0	12840	11320	1520	0	1520	0.0	0.00			
--------	--------	---	-------	-------	------	---	------	-----	------	--	--	--

WEIGHMASTER SIGNATURE

(Traci Crespo)

CUSTOMER SIGNATURE

a=SCALE 1 b=SCALE 2 c=SCALE 3 d=SCALE 4 m=MANUAL WEIGHT

GRS Date	10/01/09	METRIC TON
GRS Time	13:19	0.6895
TRE Date	10/01/09	
TRE Time	13:37	

NOT REFUNDABLE MORE THAN 90 DAYS FROM ABOVE DATE

Driver Copy

In accordance with the Clean Air Act and other applicable laws, seller must sign the Scrap Acceptance Agreement form provided at the scale at least one time every 3 years, which applies to any recyclables in the transaction which may contain or have contained refrigerants or other potential Hazardous Materials.

FOR SALVAGE VEHICLE SALES: I hereby certify, under penalty of perjury that any vehicle sold has been cleared for dismantling with the Department of Motor Vehicles

HOLD HARMLESS AGREEMENT: Seller will indemnify and hold buyer harmless from damages, demands and liabilities, including reasonable attorney's fees, resulting from the breach of any warranty hereunder and driver agrees to be responsible for damage to vehicle during unloading.

BILL OF SALE: I warrant that I am the owner (or owner's representative) of the material described herein and have the right to sell same, that it contains no Hazardous Material as defined in the Scrap Acceptance Agreement or otherwise by any federal or state law and that for payment hereby received, I sell and convey title to Sims Hugg Nau.

Seller certifies that all refrigerant including but not limited to Chlorofluorocarbons and Hydrochlorofluorocarbons (collectively "CFC's") Refrigerants and their substitutes as defined in section 608 of the Clean Air Act that has not leaked previously have been recovered from appliance and motor vehicles prior to delivery. I understand it is unlawful to release Freon and CFC's into the atmosphere and that any CFC's must be properly removed before appliances or motor vehicle air conditioners can be recycled. I verify that either (check one):

- (1) all CFC's previously leaked from this container, or
- (2) all CFC's were properly recovered in accordance with 40 C.F.R. Section 82.156(g) and (h) by:

El vendedor certifica que todos los refrigerantes incluyendo pero no limitado a CFC's y HCFC's Refrigerantes y sus substitutos como se define en la sección 608 del Acta de Aire Limpio que no ha goteado previamente han sido recuperados de los electrodomésticos y automóviles antes de ser entregados.

Yo entiendo que es contra la ley liberar Freón y otros clorofluorocarbonos y hidroclorofluorocarbonos (legalmente llamados CFC's) en el aire y que todos los CFC's tienen que estar removidos apropiadamente antes de que los aparatos o aire acondicionados de los carros puedan ser reciclados. Yo verifico que (cheque uno):

- (1) todos los CFC's han sido previamente evacuados de este contenedor, o
- (2) todos los CFC's fueron recuperados en forma apropiada de acuerdo con 40 C.F.R. Sección 82.156(g) y (h) por:

Name/Nombre: _____

Address/Dirección: _____

Date/Fecha: _____

Seller Signed/Seller Firma: _____

Printed Name/Nombre: _____

Date/Fecha: _____

Seller's Warrant/Seller's Warrant: Seller warrants and represents to the Purchaser the material transferred, by the Seller to the Purchaser pursuant to this Agreement is not and does not contain a "hazardous substance" as said term is defined in the current applicable federal or state environmental laws, rules, or regulations. In the event Purchaser incurs any liability or obligation due to a breach of said warranty and representation, Seller agrees to indemnify and hold Purchaser harmless from all such liabilities and obligations. Notwithstanding the foregoing, nothing set forth herein shall constitute a waiver by Seller of any rights under the law pursuant to any written or oral agreements that it may have against any entity.

EL VENDEDOR GARANTIZA. El vendedor garantiza y representa al Comprador que el material transferido, por el Vendedor al Comprador de acuerdo a este acuerdo no es y no contiene "sustancias peligrosas" como se dijo en el termino como se define en las leyes, reglas, o regulaciones ambientales federales y estatales. En el evento que el Comprador incurra alguna responsabilidad u obligación por el rompimiento de dicha garantía y representación. El Vendedor acuerda en indemnizar y no hacer responsable al Comprador de toda dicha responsabilidad y obligación. No obstante lo precedente, nada dicho aquí constituirá una renuncia por el Vendedor de cualquier derecho bajo la ley según cualquier acuerdo escrito u oral que pueda tener en contra de cualquier entidad."

WEIGHMASTER CERTIFICATE
TRUCK SCALE



Ticket #: TBNCLF

Purchased From: CP012P
CONTROLLED ENVIRONMENTAL SERV
PO BX 401
OAKLEY, CA 94561

SHIP DATE: 10/01/09

WEIGHED AT:

WEIGHMASTER CERTIFICATE

THIS IS TO CERTIFY that the following described commodity was weighed, measured, or counted by a weighmaster, whose signature is on this certificate, who is a recognized authority of accuracy, as prescribed by Chapter 7 (commencing with Section 12799) of Division 5 of the California Business and Professions Code, administered by the Division of Measurement Standards of the California Department of Food and Agriculture.

Control No.: 12 166675

12 RICHMOND, CA. RC3265
600 S. 4TH STREET
RICHMOND, CA 94804-3504
510-412-5300

DL/ID # B9290796 JASON PAYNECHAPP

Veh # TK 6N34468 ID # 6N34468

SHPMNT#	COMMODITY	GROSS	TARE	NET	ADJ	REASON	PD	WT	RED	C/W	RD	EXT	CBK	FRT	PRICE	TOTAL AMT
TBNCLF #1	Unprepared	12840a	11320b	1520	0			1520	0.0		0.00	0.00			130.0000NT	98.80

ALL WEIGHTS ARE REPORTED IN POUNDS UNLESS OTHERWISE INDICATED. ALL NON-POUND WEIGHTS ARE ASSUMED TO BE MANUAL WEIGHTS

TOTALS	# CARS	0	12840	11320	1520	0		1520	0.0		0.00	0.00				98.80
--------	--------	---	-------	-------	------	---	--	------	-----	--	------	------	--	--	--	-------

WEIGHMASTER SIGNATURE

CUSTOMER SIGNATURE

a=SCALE 1 b=SCALE 2 c=SCALE 3 d=SCALE 4 m=MANUAL WEIGHT

GRS Date 10/01/09	METRIC TON
GRS Time 13:19	0.6895
TRE Date 10/01/09	
TRE Time 13:37	

NOT REFUNDABLE MORE THAN 90 DAYS FROM ABOVE DATE

Customer Copy

In accordance with the Clean Air Act and other applicable laws, seller must sign the Scrap Acceptance Agreement provided at the scale at least one time every 3 years, which applies to any refrigerant in the regulation which may contain or have contained refrigerants or other potential hazardous materials.

FOR SALVAGE VEHICLE SALES: I hereby certify, under penalty of perjury that any vehicle sold has been cleared for dismantling with the Department of Motor Vehicles.

HOLD HARMLESS AGREEMENT: Seller will indemnify and hold buyer harmless for damages, demands and liabilities, including reasonable attorney's fees, resulting from the breach of any warranty hereunder and driver agrees to be responsible for damage to vehicle during unloading.

BILL OF SALE: I warrant that I am the owner (or owner's representative) of the material described hereon and have the right to sell same, that it contains no Hazardous Material as defined in the Scrap Acceptance Agreement or otherwise by any federal or state law and that for payment hereby received, I sell and convey title to Sims Hugo Neu.

Seller certifies that all refrigerant including but not limited to Chlorofluorocarbons and Hydrochlorofluorocarbons (collectively "CFC's") Refrigerants and their substitutes as defined in section 608 of the Clean Air Act that has not leaked previously have been recovered from appliance and motor vehicles prior to delivery. I understand it is unlawful to release Freon and CFC's into the atmosphere and that any CFC's must be properly removed before appliances or motor vehicle air conditioners can be recycled. I verify that either (check one):

- (1) all CFC's previously leaked from this container, or
- (2) all CFC's were properly recovered in accordance with 40 C.F.R. Section 82.156(g) and (h) by:

El vendedor certifica que todos los refrigerantes incluyendo pero no limitado a CFC's y HCFC's Refrigerantes y sus substitutos como se define en la seccion 608 del Acta de Aire Limpio que no ha goteado previamente han sido recuperados de los electrodomesticos y automoviles antes de ser entregados.

Yo entiendo que es contra la ley liberar Freon y otros clorofluorocarbonos y hidroclorofluorocarbonos (legalmente llamados CFC's) en el aire y que todos los CFC's tienen que estar removidos apropiadamente antes de que los aparatos o aire acondicionados de los carros puedan ser reciclados. Yo verifico que (cheque uno):

- (1) todos los CFC's han sido previamente evacuados de este contenedor, o
- (2) todos los CFC's fueron recuperados en forma apropiada de acuerdo con 40 C.F.R. Seccion 82.156(g) y (h) por:

Name/Nombre: _____

Address/Direccion: _____

Date/Fecha: _____

Seller Signed/Seller Firma: _____

Printed Name/Nombre: _____

Date/Fecha: _____

Seller's Warrant/Seller's Warrant: Seller warrants and represents to the Purchaser the material transferred, by the Seller to the Purchaser pursuant to this Agreement is not and does not contain a "hazardous substance" as said term is defined in the current applicable federal or state environmental laws, rules, or regulations. In the event Purchaser incurs any liability or obligation due to a breach of said warranty and representation, Seller agrees to indemnify and hold Purchaser harmless from all such liabilities and obligations. Notwithstanding the foregoing, nothing set forth herein shall constitute a waiver by Seller of any rights under the law pursuant to any written or oral agreements that it may have against any entity.

EL VENDEDOR GARANTIZA. El vendedor garantiza y representa al Comprador que el material transferido, por el Vendedor al Comprador de acuerdo a este acuerdo no es y no contiene "sustancias peligrosas" como se dijo en e termino como se define en las leyes, reglas, o regulaciones ambientales federales y estatales. En el evento que el Comprador incurra alguna responsabilidad u obligacion por el rompimiento de dicha garantia y representacion. El Vendedor acuerda en indemnizar y no hacer responsable al Comprador de toda dicha responsabilidad y obligacion. No obstante lo precedente, nada dicho aqui constituirá una renuncia por el Vendedor de cualquier derecho bajo la ley según cualquier acuerdo escrito u oral que pueda tener en contra de cualquier entidad.



FREIGHT CHARGES	NO. OF PIECES	PULLED BY

WARNING: Transporting flammable gases and/or hazardous materials in an enclosed van, automobile or automobile trunk is very dangerous because it can cause a fire or explosion resulting in serious injury or death. Read cylinder label warnings, Material Safety Data Sheets (MSDS) and/or safety booklet P-3499.

PICKING TICKET

Sold by: To Place Orders call Sales Dept. at: 1-800-660-2066



Ship to: CES CONTROLLED ENVIRONMENTAL SERVICE
2900 B MAIN ST
OAKLEY CA 94561
925-625-1736

Cust # : BX772
Order # : 11313657-00
Order Date : 09/30/09
Ship Date: 09/30/09
Page : 001 OF 001

NAME : CES CONTROLLED ENVIRONMENTAL SERVICE TER: 192 SHIP VIA: CUREY PICKUP -NOCM- INITIALS: PRC
PO # : DRY ICE SLS: 191 OTW ZONE: 64 UPS: 0 DRP TYPE: CHRG
REF: BKN: 191 DEL/APP: PPOBAGD TIME : 30-SEP-09 01:55PM
PHONE#: 925-625-1736 SEL ROUTE # : CRT : THRE530

QTY	UNIT	HAZ	DESCRIPTION	ID	LINE	ITEM	LOC	QTY	CYLINDERS	VOL/	UNIT	EXTENDED
SHIP			& HAZARD CLASS	NUMBER	NO	NUMBER		ORDER	SHIP	WT	AMOUNT	AMOUNT
150	LB	X	CARBON DIOXIDE, SOLID, 9, PG III (CUSTOMER OWNED) (CO2 DRY ICE NUGGETS)	UN1845	1	CO NUGGET	191	150		150		

QTY	UNIT	HAZ	DESCRIPTION	LINE	ITEM	LOC	QTY	QTY	RIN	WT	UNIT	EXTENDED
SHIP			& HAZARD CLASS	NO	NUMBER		ORDER	BUDG	LOC		AMOUNT	AMOUNT
1	EA		HAZARDOUS MATERIAL CHARGE	2	ZZZ NN	191	1	0	ZZZZZ	.0		

DRY ICE

COC

This is to certify that the above named materials are properly classified, described, packaged, marked and labeled, and are in proper condition for transportation according to the applicable regulations of the Department of Transportation.

EMERGENCY RESPONSE TELEPHONE NUMBER:
CALL 1-800-424-9300

Authorized Signature Pham

Received by [Signature]

DATE SHIPPED: 09/30/09

PLACARDS OFFERED: ACCEPTED REJECTED

CONTINUOUS SHIPPER 2PT

CUSTOMER'S COPY