

28 November 2006  
Project 4017.02

Deborah S. Bardwick  
Attorney at Law  
Meyers Nave  
555 12th Street, Suite 1500  
Oakland, CA 94607

Subject: Updated Phase I Environmental Site Assessment  
11759 Dublin Boulevard  
Dublin, California

Dear Ms. Bardwick:

This letter report presents the results of Treadwell & Rollo, Inc.'s Update of the Phase I Environmental Site Assessment (ESA) for the property at 11759 Dublin Boulevard (Site) in Dublin, California (Figures 1 and 2). The purpose of this investigation was to determine if any substantial changes in Site environmental conditions have occurred since we issued our *Phase I Environmental Site Assessment, 11759 Dublin Boulevard, Dublin, California*, dated 4 January 2005.

To complete the evaluation, we performed the following tasks:

- reviewed the January 2005 Phase I ESA report
- ordered and reviewed historical data contained in an EDR regulatory database search report
- performed a reconnaissance survey of the Site and interviewed the current Site owner representative, and observed the adjacent properties, as accessible, to make visual observations of existing conditions, activities, types of land use, and businesses within the search area
- reviewed local, state, tribal, and federal records provided by a commercial database search firm for government databases pertinent to a Phase I ESA
- performed a file review at the Alameda County Department of Environmental Health and Dublin Fire Department regarding environmental conditions at or near the Site
- prepared this report.

## **SITE DESCRIPTION AND HISTORY**

The 11759 Dublin Boulevard property is about 4.36 acres in area and is occupied by two buildings and a parking area and called Dublin Square Center (Figure 2). The Site is located in a mixed commercial and residential area of Dublin, California. It is bounded by Dublin Boulevard to the north, Donlon Way to the east, commercial properties to the west, and residential properties and a cemetery to the south. The Site is at an elevation ranging from about 400 feet above mean sea level (msl) and slopes downward in a northeasterly direction.

Based on our review of historical records, the 11759 Dublin Boulevard property appears to have been vacant land prior to the construction of the two current buildings. The 1906 historical topographic map shows the Site and surrounding areas sparsely developed. The 1939 aerial photograph shows the Site and surrounding areas used as agricultural land with several farming houses located on the property and groves of trees to the west of the Site. Agricultural land is located to the north, south, and east of the Site. The 1945 historical topographic map shows the Site and surrounding properties as relatively unchanged from the previous map.

The 1946 and 1958 aerial photograph show the Site and surrounding areas as unchanged from the 1939 aerial photograph. The freeway off-ramps are present to the southeast of the Site in the 1958 aerial photograph. The 1961 historical topographic map shows the Site and surrounding areas as developed. The 1965 aerial photograph shows the Site as unoccupied with an industrial building to the west of the Site. Residential properties are present to the northwest and agricultural land is present to the north, south, and east of the Site.

The 1982 aerial photograph shows the Site occupied by two buildings and a parking area, as it appears today. Residential buildings are present to the north, east, west, and south of the Site. The surrounding properties are shown densely populated in comparison to the 1965 aerial photograph. No significant changes to the Site and surrounding properties are shown on the 1993 aerial photograph.

## **PREVIOUS SITE INVESTIGATIONS AND REPORTS**

### **Treadwell & Rollo Phase I ESA**

The significant findings identified in Treadwell & Rollo's January 2005 Phase I ESA included:

- Two nearby facilities (7007 San Ramon Road and 7575 Dublin Boulevard) were listed on regulatory agency databases. There is no readily available evidence that these facilities have affected or are likely to affect the environmental conditions of the site.



- We concluded that other sites identified within the one-mile environmental search radius did not present a significant environmental risk to the subject property due to: (1) the location of the sites with respect to groundwater flow direction; (2) the distance of the sites from the subject property; and/or (3) the case closed/cleanup complete status of the sites.
- We revealed one possible recognized adverse environmental condition in connection with the Site. It is our opinion, with the Site previously used for agricultural purposes, possible pesticide/herbicide contamination maybe present in the near surface.

## **REVIEW OF PUBLIC RECORDS**

Treadwell & Rollo obtained a government records report prepared by Environmental Data Resources, Inc., (EDR), which is included in Appendix A. This report contains the results of a search of several government database sources pertinent to Phase I ESAs. The search included businesses or properties on these government lists within a one-eighth to one mile radius of the site. Our assessment also included a review of the Alameda County Department of Environmental Health (ACDEH) and Dublin Fire Department (DFD) files to identify UST locations and evaluate fuel and hazardous materials leaks reported at the site and neighboring sites. The list of the government agency databases reviewed by EDR is summarized in their report included in Appendix A of this report.

### **Site – 11759 Dublin Boulevard**

The Site was not listed on regulatory agency databases searched by EDR and no files were found at the ACEH or DFD.

### **Nearby Facilities**

A review of the recent EDR report for the subject Site identified one additional site that would have the potential to impact the environmental conditions at the Site. Near-surface groundwater flow would be expected to serve as the chief transport mechanism for the migration of offsite chemical impacts to the onsite environment. The potential for these properties to affect the Site is largely based on their relative location and the regional groundwater flow direction which has been identified to be in the north-northeasterly direction.

### 11711 Dublin Boulevard - Hexcel Corporation

This facility, approximately 225 feet east – southeast of the subject site and down- to cross-gradient from the Site, was listed as a RCRIS- LQG<sup>1</sup>, FINDS<sup>2</sup>, HAZNET<sup>3</sup>, CORTESE<sup>4</sup>, SLIC<sup>5</sup>, HIS UST<sup>6</sup>, and LUST<sup>7</sup> site. A file was located at DFD but no files were located within ACDEH files.

Reportedly, an underground storage tank (UST) containing chromium was removed from the site in July 1985. In May 1988, three shallow soil borings were advanced at the locations near the former UST and analytical results detected total chromium at concentrations ranging from not detected (ND) at or above the method reporting limits to 350 milligrams per kilograms (mg/kg).

---

<sup>1</sup> **RCRIS:** Resource Conservation and Recovery Information System. RCRIS includes selective information on sites which generate, transport, store, treat and/or dispose of hazardous waste as defined by the Resource Conservation and Recovery Act (RCRA). Conditionally exempt small quantity generators (CESQGs): generate less than 100 kg of hazardous waste, or less than 1 kg of acutely hazardous waste per month. Small quantity generators (SQGs): generate between 100 kg and 1,000 kg of hazardous waste per month. Large quantity generators (LQGs): generate over 1,000 kilograms (kg) of hazardous waste, or over 1 kg of acutely hazardous waste from the generator off-site to a facility that can recycle, treat, store, or dispose of the waste. TSDs treat, store, or dispose of the waste.

<sup>2</sup> **FINDS:** The Facility Index System contains both facility information and “pointers” to other sources of information that contain more detail. These include: RCRIS; Permit Compliance System (PCS); Aerometric Information Retrieval System (AIRS); FATES (FIFRA [Federal Insecticide Fungicide Rodenticide Act] and TSCA Enforcement System, FTTS [FIFRA/TSCA Tracking System]; CERCLIS; DOCKET (Enforcement Docket used to manage and track information on civil judicial enforcement cases for all environmental statutes); Federal Underground Injection Control (FURS); Federal Reporting Data System (FRDS); Surface Impoundments (SIA); TSCA Chemicals in Commerce Information System (CICS); PADS; RCRA-J (medical waste transporters/disposers); TRIS; and TSCA. The source of this database is the U.S. EPA/NTIS.

<sup>3</sup> **HAZNET:** The data is extracted from the copies of hazardous waste manifests received each year by the DTSC. The annual volume of manifests is typically 700,000-1,000,000 annually, representing approximately 350,000-500,000 shipments. Data from non-California manifests & continuation sheets are not included at the present time. Data are from the manifests submitted without correction, and therefore many contain some invalid values for data elements such as generator ID, TSD ID, waste category, & disposal method. The source is the Department of Toxic Substance Control is the agency.

<sup>4</sup> **CORTESE:** This database identifies public drinking water wells with detectable levels of contamination, hazardous substance sites selected for remedial action, sites with known toxic material identified through the abandoned site assessment program, sites with USTs having a reportable release and all solid waste disposal facilities from which there is known migration. The source is the California Environmental Protection Agency/Office of Emergency Information.

<sup>5</sup> **SLIC:** This Spills, Leaks, Investigations, and Cleanups (SLIC) listings includes unauthorized discharges from spills and leaks, other than from underground storage tanks or other regulated sites.

<sup>6</sup> **HIS UST:** Historical UST Registered Database.

<sup>7</sup> **LUST:** The Leaking Underground Storage Tank Incident Reports contain an inventory of reported leaking underground storage tank incidents. The data come from the State Water Resources Control Board Leaking Underground Storage Tank Information System.

Additionally, all soil samples that had detections of chromium were then analyzed for hexavalent chromium. No hexavalent chromium was detected at or above method reporting limits.

There was no additional information regarding the former UST and no readily available evidence that this facility has affected or likely to affect the environmental conditions of the Site.

## **SITE AND VICINITY RECONNAISSANCE**

On 22 November 2006, Treadwell & Rollo representatives conducted a reconnaissance of the Site and nearby areas. The purpose of the reconnaissance was to look for visual evidence of past or present use or storage of petroleum products and hazardous materials that could potentially affect soil and/or groundwater quality at the Site.

The Site is bounded by Dublin Boulevard to the north, Donlon Way to the east, commercial properties to the west, and residential properties and a cemetery to the south. The Site is approximately 4.36 acres and is occupied by two buildings, which are operated by US Bank and various retail stores (Figure 2).

One building is occupied by US Bank, which appears to be a one-story building with a surrounding parking area. The other building is occupied by All Video TV and Audio Repair, Finishmaster (automotive and industrial paint sales – sales only no manufacturing), Aunt Betty's Thrift Store, Carpet Wizardry (carpet and upholstery cleaning), Len's Barbershop, Chefs Touch (a food catering company), and two empty retail stores. The stores are surrounded by an asphalt-paved parking lot and an alley way which surrounds the property.

Small quantities of materials such as paints and cleaning supplies are kept at the Site for use by the janitorial and maintenance staff. We did not observe any recognized environmental conditions associated with the storage of hazardous materials at the Site.

### **Nearby Area**

The neighboring properties as observed from public sidewalks are commercial properties and streets. No apparent signs of chemical releases or leaks were noted at any nearby facilities.

## **SUMMARY AND CONCLUSIONS**

This Update Phase I ESA has been performed by Treadwell & Rollo, Inc. for Meyers Nave, for the property located at 11759 Dublin Boulevard, in Dublin, California. The Site is located in a mixed commercial and residential area of Dublin. It is bounded by Dublin Boulevard to the north, Donlon Way to the east, commercial properties to the west, and residential properties and a cemetery to the south. The Site is approximately 4.36 acres and is occupied by two buildings, one by US Bank and the other with several businesses.

Deborah S. Bardwick  
Attorney at Law  
Meyers Nave  
28 November 2006  
Page 6

**Treadwell & Rollo**

The Site and surrounding area is underlain by stiff to very stiff clay to a depth of approximately 20 feet below ground surface (bgs). At depths greater than 20 feet bgs soil varies from medium dense to dense clayey and silty sands. Groundwater is generally encountered at depths ranging from 20 to 29 feet bgs.

There are several facilities within the study area that appear on the regulatory agency lists (Appendix A). No facilities appear to be affecting the environmental conditions at the Site.

Based on our review of regulatory files, the Site history, and Site reconnaissance, this assessment revealed one possible recognized adverse environmental condition in connection with the Site. It is our opinion, with the Site previously used for agricultural purposes, possible pesticide/herbicide contamination maybe present in the near surface.

#### **LIMITATIONS**

Activities undertaken as part of this assessment were conducted on behalf of Meyers Nave. Activities undertaken as part of this investigation were conducted to assess the presence of recognized releases of hazardous materials and petroleum hydrocarbons at the Site. The conclusions presented in this report are professional opinions based on the specific activities conducted. No other party can rely on the information contained in this report without the written consent of Treadwell & Rollo, Inc.

Descriptions of specific field activities are based on our observations and on information provided by others. The opinions and information presented in this report apply to site conditions and the information that was available at the time the work was performed and do not apply to changes of which we are not aware or have not had the opportunity to evaluate. Treadwell & Rollo, Inc. makes no guarantees or warranties with respect to the accuracy or completeness of this information.

If you have any questions, please call.

Sincerely yours,  
TREADWELL & ROLLO, INC.

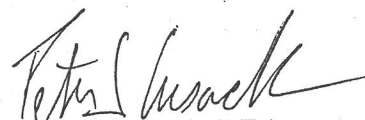

Peter J. Cusack, REA  
Senior Scientist  
40170201.PJC

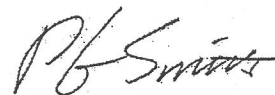

Philip G. Smith, REA II  
Principal

Attachments: Figure 1 – Site Location Map  
Figure 2 – Site Plan  
Appendix A - Environmental and Regulatory Records Documentation

# Treadwell&Rollo

4 January 2005  
Project 4017.01

Ms. Elizabeth Silver  
Meyers Nave  
555 12<sup>th</sup> Street, Suite 1500  
Oakland, California 94607

Subject: Phase I Environmental Site Assessment  
11759 Dublin Boulevard  
Dublin, California

Dear Ms. Silver:

We are pleased to submit our report titled "Phase I Environmental Site Assessment" for 11759 Dublin Boulevard in Dublin, California. We appreciate the opportunity to be of service to you on this project. If you have any questions or require additional information, please call.

Sincerely yours,  
TREADWELL & ROLLO, INC.

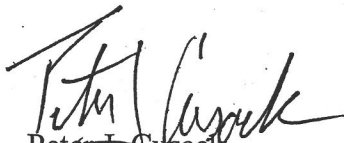

Peter J. Cusack  
Senior Scientist

40170101.PJC

Enclosure



Brian K. Moore, P.E.  
Senior Engineer

---

**PHASE I  
ENVIRONMENTAL SITE ASSESSMENT  
11759 DUBLIN BOULEVARD  
Dublin, California**

**Meyers Nave  
Oakland, California**

**4 January 2005  
Project No. 4017.01**



## TABLE OF CONTENTS

1.0	INTRODUCTION AND SCOPE .....	1
2.0	SITE DESCRIPTION .....	2
3.0	GEOLOGIC AND HYDROGEOLOGIC SETTING .....	2
4.0	SITE HISTORY .....	3
5.0	REVIEW OF PUBLIC RECORDS .....	4
5.1	Site – 11759 Dublin Boulevard.....	5
5.2	Nearby Facilities .....	5
5.2.1	7007 San Ramon Road – ChevronTexaco .....	5
5.2.2	7575 Dublin Boulevard – Montgomery Ward Auto Center .....	6
6.0	SITE RECONNAISSANCE .....	7
6.1	11759 Dublin Boulevard.....	7
6.2	Nearby Area.....	8
7.0	SUMMARY AND conclusions .....	8
8.0	LIMITATIONS .....	9

REFERENCES

FIGURES

APPENDICES

## **LIST OF FIGURES**

- Figure 1 Site Location Map
- Figure 2 Site Plan
- Figure 3 USGS Topographic Map

## **APPENDIX A**

City Directory

## **APPENDIX B**

Aerial Photographs

## **APPENDIX C**

EDR Environmental Data Resources, Inc. Report

**PHASE I  
ENVIRONMENTAL SITE ASSESSMENT  
11759 DUBLIN BOULEVARD  
Dublin, California**

## **1.0 INTRODUCTION AND SCOPE**

This report presents the results of Treadwell & Rollo's (Treadwell & Rollo) Phase I Environmental Site Assessment (ESA) for the property located 11759 Dublin Boulevard (Site) in Dublin, California (Figure 1). Treadwell & Rollo performed this work for The City of Dublin. The 11759 Dublin Boulevard property is about 4.36 acres in area and is occupied by two buildings and a parking area and called Dublin Square Center (Figure 2).

The scope of our work consisted of the following:

- Reviewing readily available documents and maps regarding local geologic and hydrogeologic conditions.
- Reviewing readily available historical aerial photographs and United States Geological Survey (USGS) historical topographic maps for the Site.
- Performing a reconnaissance survey of the Site and a survey of the area within a 1/4-mile radius of the Site, as accessible, to make visual observations of existing Site conditions, activities, types of land use, and businesses within the search area.
- Reviewing local, state, and federal records provided by Environmental Data Resources, Inc. (EDR) of Southport, Connecticut, for government databases pertinent to Phase I ESAs.

- Conducting inquiries by telephone, visit, and/or written correspondence with Alameda County Environmental Health (ACEH), City of Dublin Fire Department (DFD), and California Regional Water Quality Control Board (RWQCB) as appropriate, regarding environmental permits, environmental violations, incidents, and/or status of enforcement actions at the Site.
- Preparing this report.

## 2.0 SITE DESCRIPTION

The Site is located in a mixed commercial and residential area of Dublin, California. It is bounded by Dublin Boulevard to the north, Donlon Way to the east, commercial properties to the west, and residential properties and a cemetery to the south. The Site is approximately 4.36 acres and is occupied by two retail buildings and a parking lot, US Bank occupies one building and various retail businesses occupy the other (Figure 2).

The Site is at an elevation ranging from about 400 feet above mean sea level (msl) and slopes downward in a northeasterly direction. A topographic map of the Site vicinity is presented on Figure 3.

## 3.0 GEOLOGIC AND HYDROGEOLOGIC SETTING

According to subsurface investigations of nearby areas, the Site area is likely underlain by stiff to very stiff clay to a depth of approximately 20 feet below ground surface (bgs). At depths greater than 20 feet bgs, the soil varies from medium dense to dense clayey and silty sands (Treadwell & Rollo, 1998). Based on ground surface gradients and physical setting source maps provided by EDR, shallow groundwater likely flows in a southeasterly direction. No groundwater gradient information based on monitoring well data was identified for the Site or neighboring properties during this Phase I ESA. Depth to groundwater in the vicinity is typically 15 to 29 feet

(Treadwell & Rollo, 1998). The groundwater direction flow is assumed to be in the southeasterly direction.

## 4.0 SITE HISTORY

The history of the Site and vicinity was reviewed to identify activities at the Site and adjacent properties that may have released hazardous materials into the subsurface. To accomplish this objective, we reviewed readily available environmental and geotechnical reports; the historical business directories were searched by EDR for the years 1920 to 2000 and no coverage was available (Appendix A); Historical Topographic maps for the years 1906, 1945, and 1961; and aerial photographs for the years 1939, 1946, 1958, 1965, 1982, and 1993. A request was made for Sanborn Maps but no maps were produced for this area. Copies of aerial photographs are included in Appendix B.

The 1906 historical topographic map shows the Site and surrounding areas sparsely developed. The 1939 aerial photograph shows the Site and surrounding areas used as agricultural land with several farming houses located on the property and groves of trees to the west of the Site. Agricultural land is located to the north, south, and east of the Site. A copy of the 1939 aerial photograph is presented on Figure B-1.

The 1945 historical topographic map shows the Site and surrounding properties as relatively unchanged from the previous map. The 1946 and 1958 aerial photograph show the Site and surrounding areas as unchanged from the 1936 aerial photograph. The freeway off-ramps are present to the southeast of the Site in the 1958 aerial photograph. The 1946 and 1958 aerial photographs are presented on Figures B-2 and B-3, respectively.

The 1961 historical topographic map shows the Site and surrounding areas as developed. The 1965 aerial photograph shows the Site as unoccupied with an industrial building to the west of the Site. Residential properties are present to the northwest and agricultural land is present to the north, south, and east of the Site. The 1965 aerial photograph is presented on Figure B-4.

The 1982 aerial photograph shows the Site occupied by two buildings and a parking area, as it appears today. Residential buildings are present to the north, east, west, and south of the Site. The surrounding properties are shown densely populated in comparison to the 1965 aerial photograph. No significant changes to the Site and surrounding properties are shown on the 1993 aerial photograph. The 1982 and 1993 aerial photographs are presented on Figures B-5 and B-6, respectively.

## 5.0 REVIEW OF PUBLIC RECORDS

EDR prepared a government records report for the Site; the report is attached as Appendix C. This report contains the results of a search of several government database sources pertinent to Phase I ESAs which identify potential sources of hazardous substances that may affect the soil and/or groundwater quality at the Site. These regulatory lists include locations where an unauthorized release is a potential hazard, where an unauthorized release is suspected to have occurred, and where an unauthorized release has been confirmed. The regulatory lists also include locations where hazardous materials are generated and/or stored, whether or not there has been an unauthorized release.

The search focused on businesses or properties on these government lists within a one-mile radius of the Site. The EDR report provides a comprehensive listing of agency records. There may be multiple entries for one site location on a single agency list, or a site may be identified on more than one list. Many properties are identified on the various agency lists because of previous problems or the potential for future problems. Also, properties identified may have been categorized by the listing regulatory agency as needing no further action, as closed, or of low priority. These properties would not likely have affected the soil or groundwater at the Site. Therefore, the regulatory files (if any) on such properties were not reviewed as part of this scope of work.



On the basis of the information provided in the EDR report, we reviewed regulatory agency case files for those properties with the potential to detrimentally affect the environmental conditions at the Site. Our findings are summarized below by location.

## 5.1 Site – 11759 Dublin Boulevard

The Site was not listed on regulatory agency databases searched by EDR and no files were found at the ACEH or DFD.

## 5.2 Nearby Facilities

Public files were reviewed for properties in proximity to and in the assumed upgradient or cross gradient direction of groundwater flow to the Site to evaluate the potential for these properties to affect the conditions at the Site. Near-surface groundwater flow would be expected to serve as the chief transport mechanism for the migration of offsite chemical impacts to the onsite environment. The potential for these properties to affect the Site is largely based on their relative location and the regional groundwater flow direction which has been identified to be in the southeasterly direction. Our summary of the reviews is presented below.

### 5.2.1 7007 San Ramon Road – ChevronTexaco

This facility, approximately 1175 feet east and cross gradient from the Site, is listed as a CORTESE<sup>1</sup>, LUST<sup>2</sup>, and HIST UST<sup>3</sup> site. In February 1990, four underground storage tanks (USTs) and associated piping were removed and approximately 500 cubic yards of soil were excavated. Soil sampling was performed following the removal to evaluate the extent of

---

<sup>1</sup> **CORTESE:** This database identifies public drinking water wells with detectable levels of contamination, hazardous substance sites selected for remedial action, sites with known toxic material identified through the abandoned site assessment program, sites with USTs having a reportable release and all solid waste disposal facilities from which there is known migration. The source is the California Environmental Protection Agency/Office of Emergency Information.

<sup>2</sup> **LUST:** The Leaking Underground Storage Tank Incident Reports contain an inventory of reported leaking underground storage tank incidents. The data come from the State Water Resources Control Board Leaking Underground Storage Tank Information System.

<sup>3</sup> **HIST UST:** Historical UST Registered Database.

impacted soil. Following excavation, soil and groundwater samples were collected and analytical results indicated high levels of total petroleum hydrocarbons (TPH) as gasoline (TPHg), methyl-tert-butyl-ether (MTBE), and benzene, resulting in an additional excavation to 22 feet bgs. Additionally, from March 1990 through June 1996, fifteen borings were advanced in the vicinity of the property and several groundwater monitoring wells were installed to determine the extent of petroleum impacted soils and groundwater contamination. Based on the Risk Management Plan (RMP) by Gettler-Ryan Inc., it appears that remedial excavation activities at the property have removed impacted soils and the groundwater contamination concentrations are stabilized.

The potential for this property to affect the environmental conditions at the Site is considered minimal due to the distance from the Site and groundwater gradient.

## **5.2.2 7575 Dublin Boulevard – Montgomery Ward Auto Center**

This facility, approximately 2,425 feet east north-east and cross gradient from the Site, and is listed as a LUST and CORTESE site. In November 1988, it was determined that one of three 10,000-gallon USTs was leaking petroleum hydrocarbons to the soil and groundwater. Between December 1988 and February 1989, eight soil borings were drilled and converted into groundwater monitoring wells prior to removal of the USTs to determine possible contamination. TPH and benzene, toluene, ethylbenzene, and xylenes (BTEX) were detected in soil samples at levels ranging in levels below laboratory detection limits to 2,180 milligrams per kilogram (mg/kg) for TPH, and 255 mg/kg for benzene. Groundwater samples also indicated elevated levels of TPH and BTEX.

On 18 May 1989, three 10,000-gallon gasoline USTs were removed from the property. Following removal of the USTs, an additional site investigation was performed by installing two additional monitoring wells. In 1990, a groundwater extraction system was installed and groundwater pumping tests were performed. Quarterly groundwater monitoring activities were

performed commencing in April 1992 through 1995. On 19 February 1997, ACEH granted case closure for the property based on soil and groundwater analytical results.

The potential for this property to affect the environmental conditions at the Site is considered minimal due to the distance from the Site, groundwater gradient, and administrative case closure.

## **6.0 SITE RECONNAISSANCE**

On 18 November 2004, Mr. Peter Cusack and Ms. Marianne Gibbons of Treadwell & Rollo conducted a reconnaissance of the Site and nearby area. The purpose of the reconnaissance was to look for visual evidence of past or present use or storage of petroleum products and/or hazardous materials that could potentially affect the soil and/or groundwater quality at the Site. A summary of conditions observed during the Site reconnaissance is provided below.

### **6.1 11759 Dublin Boulevard**

As described in Section 2.0, the Site is located in a mixed commercial and residential area of Dublin, California. It is bounded by Dublin Boulevard to the north, Donlon Way to the east, commercial properties to the west, and residential properties and a cemetery to the south. The Site is approximately 4.36 acres and is occupied by two buildings, which are operated by US Bank and various retail stores (Figure 2).

The 11759 Dublin Boulevard lot is occupied by two buildings. One building is occupied by US Bank, which appears to be a one-story building with a surrounding parking area. The other building is occupied by the Journey Church Community, All Video TV and Audio Repair, Woodplay Playsets, Catered with a Chefs Touch, Ultimate Home Solutions Deliveries, Dublin Corral, and The Plumbers. The stores are surrounded by an asphalt-paved parking lot and an alley way which surrounds the property.

At the time of our inspection, the buildings and asphalt-paved parking lot appeared well maintained. There was no apparent evidence of significant staining, spillage, and/or ponded liquids or uncontained solids.

## 6.2 Nearby Area

The neighboring properties, as observed from public sidewalks, were occupied by commercial buildings and businesses to the east, residential properties to the north and south, and a cemetery to the south. No apparent signs of chemical releases or leaks were noted at nearby facilities.

## 7.0 SUMMARY AND CONCLUSIONS

This Phase I ESA has been performed by Treadwell & Rollo for The City of Dublin, for the property located at 11759 Dublin Boulevard, Dublin, California. The Site is located in a mixed commercial and residential area of Dublin. It is bounded by Dublin Boulevard to the north, Donlon Way to the east, commercial properties to the west, and residential properties and a cemetery to the south. The Site is approximately 4.36 acres and is occupied by two buildings, one by US Bank and the other with several businesses (Figure 2).

The Site and surrounding area is underlain by stiff to very stiff clay to a depth of approximately 20 feet below ground surface (bgs). At depths greater than 20 feet bgs soil varies from medium dense to dense clayey and silty sands. Groundwater is generally encountered at depths ranging from 15 to 29 feet bgs. Based on ground surface gradients and physical setting source maps provided by Environmental Data Resources, Inc (EDR), shallow groundwater likely flows in a southeasterly direction.

There are several facilities within the study area that appear on the regulatory agency lists (Appendix B). No facilities appear to be affecting the environmental conditions at the Site.

Based on our review of regulatory files, the Site history, and Site reconnaissance, this assessment revealed one possible recognized adverse environmental condition in connection with the Site.

It is our opinion, with the Site previously used for agricultural purposes, possible pesticide/herbicide contamination maybe present in the near surface.

## 8.0 LIMITATIONS

The only intended beneficiary of our assessment is Meyers Nave. Reasonable effort has been made to check that the information obtained is factual and from reliable sources. Treadwell & Rollo assumes no responsibility or liability for errors in the information used or statements from sources other than those of Treadwell & Rollo, Inc. All conclusions and recommendations in this report concerning the Site and other areas discussed are the professional opinions of Treadwell & Rollo, Inc. and this report should not be considered a legal interpretation of existing environmental regulations. Opinions presented herein apply to conditions existing at the time of our assessment, and cannot necessarily be taken to apply to changes or conditions of which we are not aware and have not had the opportunity to evaluate.

The assessment did not include testing for the presence of lead paint, asbestos, poly chlorinated biphenyls in transformers or other electrical equipment, or naturally occurring environmental hazards (e.g., radon). The assessment did not address non-chemical hazards, such as the potential for seismic hazards at the Site, nor did the scope of services include and soil, air, or groundwater testing.

## REFERENCES

Aerial photographs for the years 1939, 1958, 1965, 1982, and 1993.

Historical Topographic maps for the years 1906, 1945, and 1961.

Treadwell & Rollo, *Phase I Environmental Site Assessment, Proposed Dublin Lifestyle Center, Interstate 580 and Hacienda Drive, Dublin, California*. 29 December 2003a.



**FIGURES**

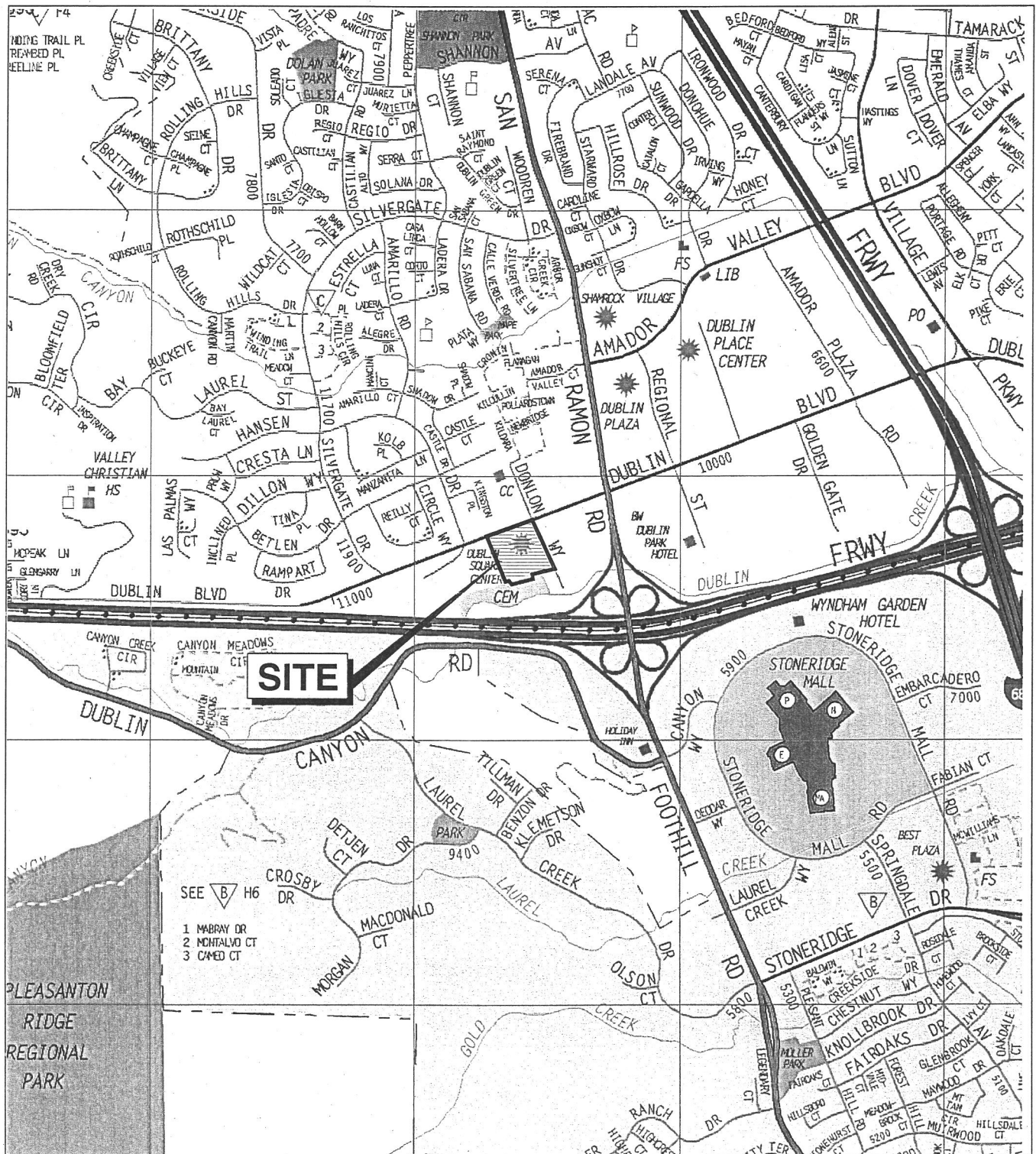

11759 DUBLIN BOULEVARD  
Dublin, California

## SITE LOCATION MAP

**Treadwell&Rollo**

Date 11/22/04

Project No. 4017.01

Figure 1



Base map: City of Dublin, 11759 Dublin Blvd.,  
November 2003

■ Site

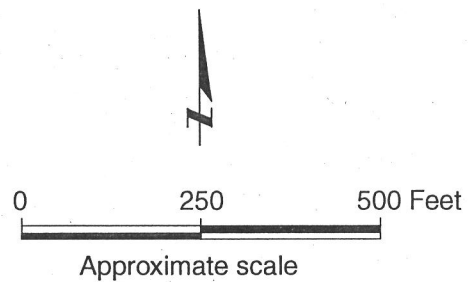

**11759 DUBLIN BOULEVARD**  
Dublin, California

**SITE**

Date 12/10/04	Project No. 4017.01	Figure 2
---------------	---------------------	----------

**Treadwell&Rollo**

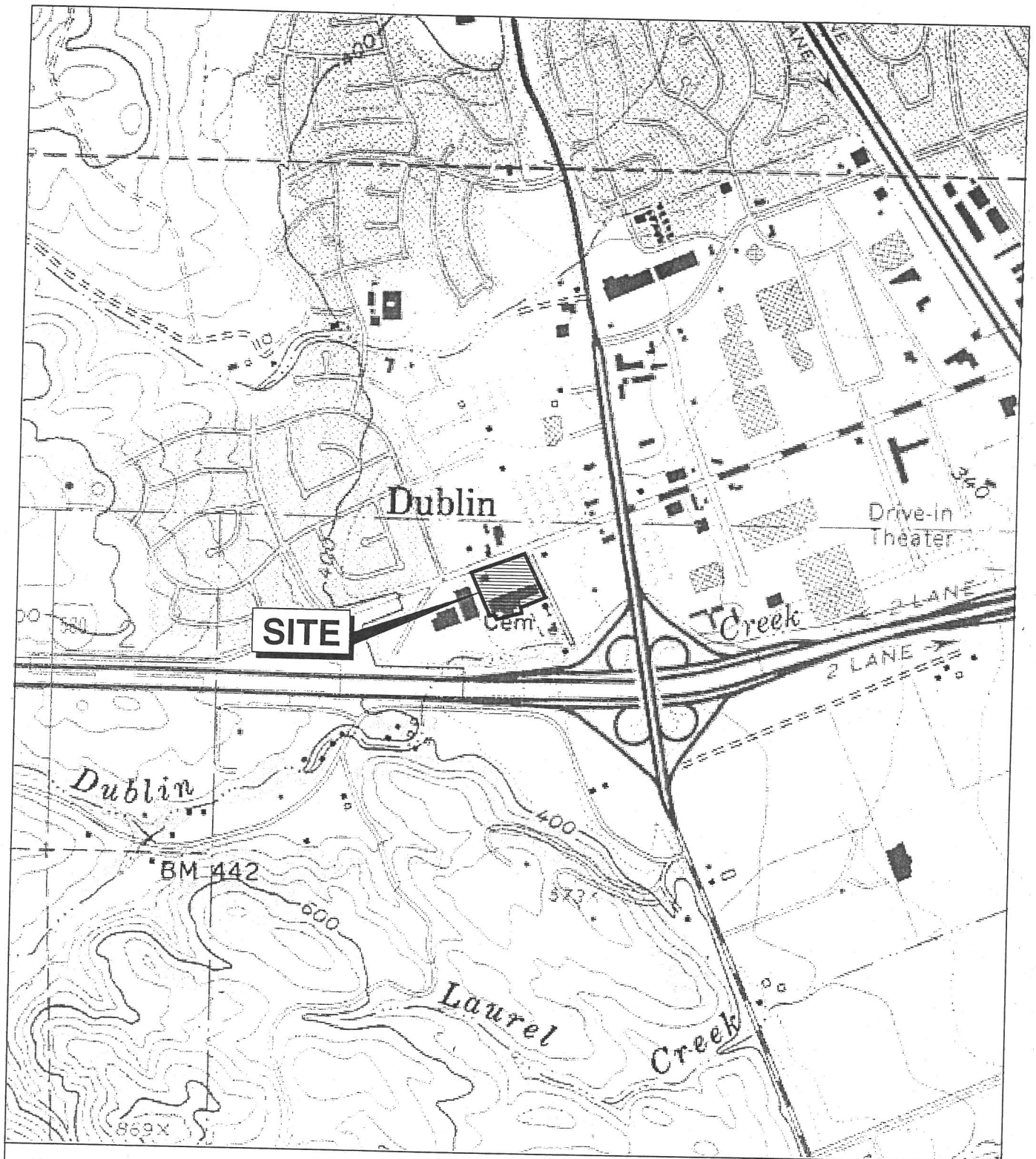

Base map: Maptech Inc., 2001

0 1/4 1/2 Mile  
Approximate scale



11759 DUBLIN BOULEVARD  
Dublin, California

USGS TOPOGRAPHIC MAP

**Treadwell&Rollo**

Date 12/30/04

Project No. 4017.01

Figure 3

**APPENDIX A**  
**City Directory**





**EDR™** Environmental  
Data Resources Inc

**The EDR-City Directory**  
*Abstract*

**11759 Dublin Boulevard  
11759 Dublin Boulevard  
Dublin, CA 94568**

**October 08, 2004**

**Inquiry Number: 1282084-7**

**The Standard  
In Environmental  
Risk Management  
Information**

**440 Wheelers Farms Road  
Milford, Connecticut 06460**

**Nationwide Customer Service**

**Telephone: 1-800-352-0050  
Fax: 1-800-231-6802**



## SUMMARY

- **City Directories:**

This document reports that Environmental Data Resources, Inc. (EDR ) searched select national repositories of business directories, and, based on client-supplied Target Property information, business directories including the Target Property information were not deemed *reasonably ascertainable* (refer to ASTM E1527-00, Section 3.3.30) by EDR. This **No Coverage** determination reflects a search only of business directory repository collections which EDR accessed. It can not be concluded from this search that no coverage for the Target Property exists anywhere, in any collection.

## NO COVERAGE

Please call EDR Nationwide Customer Service at  
1-800-352-0050 (8am-8pm EST)  
with questions or comments about your report.  
*Thank you for your business!*

### Disclaimer - Copyright and Trademark Notice

*This report contains information obtained from a variety of public and other sources. NO WARRANTY EXPRESSED OR IMPLIED, IS MADE WHATSOEVER IN CONNECTION WITH THIS REPORT. ENVIRONMENTAL DATA RESOURCES, INC. SPECIFICALLY DISCLAIMS THE MAKING OF ANY SUCH WARRANTIES, INCLUDING WITHOUT LIMITATION, MERCHANTABILITY OR FITNESS FOR A PARTICULAR USE OR PURPOSE. ALL RISK IS ASSUMED BY THE USER. IN NO EVENT SHALL EDR BE LIABLE TO ANYONE, WHETHER ARISING OUT OF ERRORS OR OMISSIONS, NEGLIGENCE, ACCIDENT OR ANY OTHER CAUSE, FOR ANY LOSS OR DAMAGE, INCLUDING, WITHOUT LIMITATION, SPECIAL, INCIDENTAL, CONSEQUENTIAL, OR EXEMPLARY DAMAGES. It can not be concluded from this report that coverage information for the target and surrounding properties does not exist from other sources. Any analyses, estimates, ratings or risk codes provided for illustrative purposes only, and are not intended to provide, nor should they be interpreted as providing any facts regarding, or prediction or forecast of, any environmental risk for any property. Any liability on the part of EDR is strictly limited to a refund of the amount paid for this report.*

*Copyright 2004 by Environmental Data Resources, Inc. All rights reserved. Reproduction in any media or format, in whole or in part, of any report or map of Environmental Data Resources, Inc. or its affiliates, is prohibited without prior written permission.*

*EDR and its logos (including Sanborn and Sanborn Map) are trademarks of Environmental Data Resources, Inc. or its affiliates. All other trademarks used herein are the property of their respective owners.*

**APPENDIX B**  
**Aerial Photographs**



11759 DUBLIN BOULEVARD  
Dublin, California

1939 AERIAL PHOTOGRAPH

**Treadwell&Rollo**

Date 12/29/04

Project No. 4017.01

Figure B-1





11759 DUBLIN BOULEVARD  
Dublin, California

1946 AERIAL PHOTOGRAPH

**Treadwell&Rollo**

Date 12/29/04

Project No. 4017.01

Figure B-2



11759 DUBLIN BOULEVARD  
Dublin, California

1958 AERIAL PHOTOGRAPH

**Treadwell&Rollo**

Date 12/29/04

Project No. 4017.01

Figure B-3





11759 DUBLIN BOULEVARD  
Dublin, California

1965 AERIAL PHOTOGRAPH

**Treadwell&Rollo**

Date 12/29/04

Project No. 4017.01

Figure B-4



No scale

11759 DUBLIN BOULEVARD  
Dublin, California

1982 AERIAL PHOTOGRAPH

**Treadwell&Rollo**

Date 12/29/04

Project No. 4017.01

Figure B-5





11759 DUBLIN BOULEVARD  
Dublin, California

1993 AERIAL PHOTOGRAPH

**Treadwell&Rollo**

Date 12/29/04

Project No. 4017.01

Figure B-6



**APPENDIX C**  
**EDR Environmental Data Resources, Inc. Report**



**EDR™** Environmental  
Data Resources Inc

## **The EDR Radius Map with GeoCheck®**

**11759 Dublin Boulevard  
11759 Dublin Boulevard  
Dublin, CA 94568**

**Inquiry Number: 1282084.2s**

**October 05, 2004**

## **The Standard in Environmental Risk Management Information**

**440 Wheelers Farms Road  
Milford, Connecticut 06460**

### **Nationwide Customer Service**

**Telephone: 1-800-352-0050  
Fax: 1-800-231-6802  
Internet: [www.edrnet.com](http://www.edrnet.com)**

## EXECUTIVE SUMMARY

A search of available environmental records was conducted by Environmental Data Resources, Inc. (EDR). The report meets the government records search requirements of ASTM Standard Practice for Environmental Site Assessments, E 1527-00. Search distances are per ASTM standard or custom distances requested by the user.

### TARGET PROPERTY INFORMATION

#### ADDRESS

11759 DUBLIN BOULEVARD  
DUBLIN, CA 94568

#### COORDINATES

Latitude (North): 37.700600 - 37° 42' 2.2"  
Longitude (West): 121.939600 - 121° 56' 22.6"  
Universal Transverse Mercator: Zone 10  
UTM X (Meters): 593481.2  
UTM Y (Meters): 4172921.0  
Elevation: 381 ft. above sea level

### USGS TOPOGRAPHIC MAP ASSOCIATED WITH TARGET PROPERTY

Target Property: 37121-F8 DUBLIN, CA  
Source: USGS 7.5 min quad index

### TARGET PROPERTY SEARCH RESULTS

The target property was not listed in any of the databases searched by EDR.

### DATABASES WITH NO MAPPED SITES

No mapped sites were found in EDR's search of available ( "reasonably ascertainable ") government records either on the target property or within the ASTM E 1527-00 search radius around the target property for the following databases:

### FEDERAL ASTM STANDARD

NPL..... National Priority List  
Proposed NPL..... Proposed National Priority List Sites  
CERCLIS..... Comprehensive Environmental Response, Compensation, and Liability Information System  
CERC-NFRAP..... CERCLIS No Further Remedial Action Planned  
CORRACTS..... Corrective Action Report  
RCRIS-TSD..... Resource Conservation and Recovery Information System  
RCRIS-LQG..... Resource Conservation and Recovery Information System  
ERNS..... Emergency Response Notification System

### STATE ASTM STANDARD

AWP..... Annual Workplan Sites

## EXECUTIVE SUMMARY

### SURROUNDING SITES: SEARCH RESULTS

Surrounding sites were identified.

Elevations have been determined from the USGS Digital Elevation Model and should be evaluated on a relative (not an absolute) basis. Relative elevation information between sites of close proximity should be field verified. Sites with an elevation equal to or higher than the target property have been differentiated below from sites with an elevation lower than the target property.

Page numbers and map identification numbers refer to the EDR Radius Map report where detailed data on individual sites can be reviewed.

Sites listed in ***bold italics*** are in multiple databases.

Unmappable (orphan) sites are not considered in the foregoing analysis.

### FEDERAL ASTM STANDARD

**RCRIS:** Resource Conservation and Recovery Information System. RCRIS includes selective information on sites which generate, transport, store, treat and/or dispose of hazardous waste as defined by the Resource Conservation and Recovery Act (RCRA). Conditionally exempt small quantity generators (CESQGs): generate less than 100 kg of hazardous waste, or less than 1 kg of acutely hazardous waste per month. Small quantity generators (SQGs): generate between 100 kg and 1,000 kg of hazardous waste per month. Large quantity generators (LQGs): generate over 1,000 kilograms (kg) of hazardous waste, or over 1 kg of acutely hazardous waste from the generator off-site to a facility that can recycle, treat, store, or dispose of the waste. TSDFs treat, store, or dispose of the waste.

A review of the RCRIS-SQG list, as provided by EDR, and dated 06/15/2004 has revealed that there is 1 RCRIS-SQG site within approximately 0.25 miles of the target property.

<u>Equal/Higher Elevation</u>	<u>Address</u>	<u>Dist / Dir</u>	<u>Map ID</u>	<u>Page</u>
<b><i>SHELL OIL CO</i></b>	<b><i>11989 DUBLIN BL/SAN RAM</i></b>	<b><i>1/8 - 1/4 W</i></b>	<b><i>1</i></b>	<b><i>6</i></b>

### STATE ASTM STANDARD

**CORTESE:** This database identifies public drinking water wells with detectable levels of contamination, hazardous substance sites selected for remedial action, sites with known toxic material identified through the abandoned site assessment program, sites with USTs having a reportable release and all solid waste disposal facilities from which there is known migration. The source is the California Environmental Protection Agency/Office of Emergency Information.

A review of the Cortese list, as provided by EDR, has revealed that there are 6 Cortese sites within approximately 0.5 miles of the target property.

<u>Lower Elevation</u>	<u>Address</u>	<u>Dist / Dir</u>	<u>Map ID</u>	<u>Page</u>
<b><i>CHEVRON</i></b>	<b><i>7007 SAN RAMON RD</i></b>	<b><i>1/8 - 1/4 E</i></b>	<b><i>A2</i></b>	<b><i>6</i></b>
<b><i>TRANSAMERICA TITLE COMPAN</i></b>	<b><i>6850 REGIONAL</i></b>	<b><i>1/4 - 1/2 ENE</i></b>	<b><i>6</i></b>	<b><i>9</i></b>
<b><i>MONTGOMERY WARD</i></b>	<b><i>7575 DUBLIN BLVD</i></b>	<b><i>1/4 - 1/2 ENE</i></b>	<b><i>B7</i></b>	<b><i>9</i></b>
<b><i>UNOCAL</i></b>	<b><i>7850 AMADOR VALLEY BLVD</i></b>	<b><i>1/4 - 1/2 NE</i></b>	<b><i>C10</i></b>	<b><i>11</i></b>
<b><i>EXXON</i></b>	<b><i>7840 AMADOR VALLEY BLVD</i></b>	<b><i>1/4 - 1/2 NE</i></b>	<b><i>C11</i></b>	<b><i>14</i></b>

## EXECUTIVE SUMMARY

### EDR PROPRIETARY HISTORICAL DATABASES

See the EDR Proprietary Historical Database Section for details

# OVERVIEW MAP - 1282084.2s - Treadwell & Rollo, Inc.



★ Target Property

◆ Sites at elevations higher than or equal to the target property

● Sites at elevations lower than the target property

▲ Coal Gasification Sites

▨ National Priority List Sites

▩ Landfill Sites

▧ Dept. Defense Sites

▨ Indian Reservations BIA

— Oil & Gas pipelines

▨ 100-year flood zone

▨ 500-year flood zone

▩ Federal Wetlands

▩ Areas of Concern

TARGET PROPERTY: 11759 Dublin Boulevard  
ADDRESS: 11759 Dublin Boulevard  
CITY/STATE/ZIP: Dublin CA 94568  
LAT/LONG: 37.7006 / 121.9396

CUSTOMER: Treadwell & Rollo, Inc.  
CONTACT: Peter J. Cusack  
INQUIRY #: 1282084.2s  
DATE: October 05, 2004 2:18 pm

## MAP FINDINGS SUMMARY

Database	Target Property	Search Distance (Miles)	< 1/8	1/8 - 1/4	1/4 - 1/2	1/2 - 1	> 1	Total Plotted
<b><u>FEDERAL ASTM STANDARD</u></b>								
NPL		1.000	0	0	0	0	NR	0
Proposed NPL		1.000	0	0	0	0	NR	0
CERCLIS		0.500	0	0	0	NR	NR	0
CERC-NFRAP		0.250	0	0	NR	NR	NR	0
CORRACTS		1.000	0	0	0	0	NR	0
RCRIS-TSD		0.500	0	0	0	NR	NR	0
RCRIS Lg. Quan. Gen.		0.250	0	0	NR	NR	NR	0
RCRIS Sm. Quan. Gen.		0.250	0	1	NR	NR	NR	1
ERNS		TP	NR	NR	NR	NR	NR	0
<b><u>STATE ASTM STANDARD</u></b>								
AWP		1.000	0	0	0	0	NR	0
Cal-Sites		1.000	0	0	0	0	NR	0
CHMIRS		TP	NR	NR	NR	NR	NR	0
Cortese		0.500	0	1	5	NR	NR	6
Notify 65		1.000	0	0	0	3	NR	3
Toxic Pits		1.000	0	0	0	0	NR	0
State Landfill		0.500	0	0	0	NR	NR	0
WMUDS/SWAT		0.500	0	0	0	NR	NR	0
LUST		0.500	0	1	7	NR	NR	8
CA Bond Exp. Plan		1.000	0	0	0	0	NR	0
UST		0.250	0	1	NR	NR	NR	1
VCP		0.500	0	0	0	NR	NR	0
INDIAN LUST		0.500	0	0	0	NR	NR	0
INDIAN UST		0.250	0	0	NR	NR	NR	0
CA FID UST		0.250	0	0	NR	NR	NR	0
HIST UST		0.250	0	1	NR	NR	NR	1
<b><u>FEDERAL ASTM SUPPLEMENTAL</u></b>								
CONSENT		1.000	0	0	0	0	NR	0
ROD		1.000	0	0	0	0	NR	0
Delisted NPL		1.000	0	0	0	0	NR	0
FINDS		TP	NR	NR	NR	NR	NR	0
HMIRS		TP	NR	NR	NR	NR	NR	0
MLTS		TP	NR	NR	NR	NR	NR	0
MINES		0.250	0	0	NR	NR	NR	0
NPL Liens		TP	NR	NR	NR	NR	NR	0
PADS		TP	NR	NR	NR	NR	NR	0
ODI		0.500	0	0	0	NR	NR	0
DOD		1.000	0	0	0	0	NR	0
INDIAN RESERV		1.000	0	0	0	0	NR	0
UMTRA		0.500	0	0	0	NR	NR	0
FUDS		1.000	0	0	0	0	NR	0
RAATS		TP	NR	NR	NR	NR	NR	0
TRIS		TP	NR	NR	NR	NR	NR	0



Map ID  
Direction  
Distance  
Distance (ft.)  
Elevation

MAP FINDINGS

Site

Database(s)

EDR ID Number  
EPA ID Number

**1**  
**West**  
**1/8-1/4**  
**777 ft.**

**SHELL OIL CO**  
**11989 DUBLIN BL/SAN RAMON RD**  
**DUBLIN, CA 94568**

**RCRIS-SQG**  
**FINDS**

**1000288661**  
**CAD981402456**

**Relative:**  
**Higher**

**RCRIS:**  
**Owner:** NOT REQUIRED  
(415) 555-1212  
**EPA ID:** CAD981402456  
**Contact:** Not reported  
**Classification:** Small Quantity Generator  
**TSD Activities:** Not reported  
**Violation Status:** No violations found

**Actual:**  
**391 ft.**

**FINDS:**

Other Pertinent Environmental Activity Identified at Site:  
Resource Conservation and Recovery Act Information system

**A2**  
**East**  
**1/8-1/4**  
**1171 ft.**

**CHEVRON**  
**7007 SAN RAMON RD**  
**DUBLIN, CA 94568**

**Cortese**  
**LUST**

**S105030601**  
**N/A**

**Site 1 of 2 in cluster A**

**Relative:**  
**Lower**

**State LUST:**  
**Cross Street:** Not reported  
**Qty Leaked:** Not reported  
**Case Number:** 01-0385  
**Reg Board:** 2  
**Chemical:** Gasoline  
**Lead Agency:** Local Agency  
**Local Agency :** 01000L  
**Case Type:** Other ground water affected  
**Status:** Remediation Plan  
**Abate Method:** Excavate and Dispose - remove contaminated soil and dispose in approved site  
**Review Date:** 1992-03-20 00:00:00  
**Workplan:** 1983-12-31 00:00:00  
**Pollution Char:** 1993-07-15 00:00:00  
**Remed Action:** Not reported  
**Monitoring:** Not reported  
**Close Date:** Not reported  
**Release Date:** Not reported  
**Cleanup Fund Id :** Not reported  
**Discover Date :** Not reported  
**Enforcement Dt :** 1992-03-20 00:00:00  
**Enf Type:** EF  
**Enter Date :** 1991-06-21 00:00:00  
**Funding:** Federal Funds  
**Staff Initials:** UNK  
**How Discovered:** Tank Closure  
**How Stopped:** Not reported  
**Interim :** Yes  
**Leak Cause:** Structure Failure  
**Leak Source:** Tank  
**MTBE Date :** 1965-01-02 00:00:00  
**Max MTBE GW :** 30 Parts per Billion  
**MTBE Tested:** MTBE Detected. Site tested for MTBE & MTBE detected  
**Priority:** Not reported

**Confirm Leak:** 1992-03-20 00:00:00  
**Prelim Assess:** 1983-12-31 00:00:00  
**Remed Plan:** 1993-07-15 00:00:00

Map ID  
Direction  
Distance  
Distance (ft.)  
Elevation Site

MAP FINDINGS

Database(s) EDR ID Number  
EPA ID Number

**A3**  
**East**  
**1/8-1/4**  
**1171 ft.**

**CHEVRON STATION**  
**7007 SAN RAMON ROAD**  
**DUBLIN, CA 94568**

**UST** **U003911913**  
**N/A**

**Site 2 of 2 in cluster A**

**Relative:**  
**Lower**

UST Alameda County:  
Region :

ALAMEDA

**Actual:**  
**369 ft.**

Inspection Dt: Sept. 3, 2003/June 3, 2004  
Owner Name : Tim & Kathy Johnson  
Owner Tele : 9258283935  
Permit Expire Date: Oct 12, 2008  
Comments : MVF 3

**4**  
**ENE**  
**1/8-1/4**  
**1298 ft.**

**95542**  
**7007 SAN RAMON VALLEY BLV**  
**DUBLIN, CA 94568**

**HIST UST** **U001598169**  
**N/A**

**Relative:**  
**Lower**

**UST HIST:**

**Actual:**  
**366 ft.**

Facility ID: 62768  
Total Tanks: 4  
Owner Address: 575 MARKET  
SAN FRANCISCO, CA 94105  
Tank Used for: PRODUCT  
Tank Num: 1  
Tank Capacity: 00009000  
Type of Fuel: Not reported  
Leak Detection: Stock Inventor  
Contact Name: THOMPSON, R C  
Facility Type: Gas Station

Owner Name: CHEVRON U.S.A. INC.  
Region: STATE

Container Num: 1  
Year Installed: 1965  
Tank Construction: 0000250 unknown

Telephone: (415) 828-2700  
Other Type: Not reported

Facility ID: 62768  
Total Tanks: 4  
Owner Address: 575 MARKET  
SAN FRANCISCO, CA 94105  
Tank Used for: PRODUCT  
Tank Num: 2  
Tank Capacity: 00009000  
Type of Fuel: Not reported  
Leak Detection: Stock Inventor  
Contact Name: THOMPSON, R C  
Facility Type: Gas Station

Owner Name: CHEVRON U.S.A. INC.  
Region: STATE

Container Num: 2  
Year Installed: 1965  
Tank Construction: 0000250 unknown

Telephone: (415) 828-2700  
Other Type: Not reported

Facility ID: 62768  
Total Tanks: 4  
Owner Address: 575 MARKET  
SAN FRANCISCO, CA 94105  
Tank Used for: PRODUCT  
Tank Num: 3  
Tank Capacity: 00004000  
Type of Fuel: Not reported  
Leak Detection: Stock Inventor  
Contact Name: THOMPSON, R C  
Facility Type: Gas Station

Owner Name: CHEVRON U.S.A. INC.  
Region: STATE

Container Num: 3  
Year Installed: 1965  
Tank Construction: 0000170 unknown

Telephone: (415) 828-2700  
Other Type: Not reported

Facility ID: 62768  
Total Tanks: 4  
Owner Address: 575 MARKET  
SAN FRANCISCO, CA 94105  
Tank Used for: WASTE

Owner Name: CHEVRON U.S.A. INC.  
Region: STATE

Map ID  
Direction  
Distance  
Distance (ft.)  
Elevation    Site

MAP FINDINGS

Database(s)    EDR ID Number  
EPA ID Number

MONTGOMERY WARD (Continued)

S103472193

Monitoring: Not reported  
Close Date: 1998-05-06 00:00:00  
Release Date: Not reported  
Cleanup Fund Id : Not reported  
Discover Date : Not reported  
Enforcement Dt : Not reported  
Enf Type: Not reported  
Enter Date : 1989-10-31 00:00:00  
Funding: Federal Funds  
Staff Initials: UNK  
How Discovered: Tank Closure  
How Stopped: Not reported  
Interim : Yes  
Leak Cause: Structure Failure  
Leak Source: Tank  
MTBE Date : 1965-01-02 00:00  
Max MTBE GW : 290 Parts per Billion  
MTBE Tested: MTBE Detected. Site tested for MTBE & MTBE detected  
Priority: Not reported  
Local Case # : 1054  
Beneficial: Not reported  
Staff : BG  
GW Qualifier : Not reported  
Max MTBE Soil : Not reported  
Soil Qualifier : Not reported  
Hydr Basin #: Livermore Valley (2-  
Operator : Not reported  
Oversight Prgm: LUST  
Review Date : 1998-05-11 00:00:00  
Stop Date : Not reported  
Work Suspended : No  
Responsible Party: BLANK RP  
RP Address: Not reported  
Global Id: T0600100936  
Org Name: Not reported  
Contact Person: Not reported  
MTBE Conc: 1  
Mtb Fuel: 1  
Water System Name: Not reported  
Well Name: Not reported  
Distance To Lust: 1  
Waste Discharge Global ID: Not reported  
Waste Disch Assigned Name: Not reported

LUST Region 2:

Region: 2  
Case Number: 1054  
Facility Id: 01-1014  
Facility Status: Case Closed  
How Discovered: TC  
Leak Cause: Structure Failure  
Leak Source: Tank  
Date Leak Confirmed: Not reported  
Prelim. Site Assessment Workplan Submitted: Not reported  
Preliminary Site Assessment Began: 12/2/1988  
Pollution Characterization Began: 8/25/1989  
Pollution Remediation Plan Submitted: 8/30/1989  
Date Remediation Action Underway: Not reported

Map ID  
Direction  
Distance  
Distance (ft.)  
Elevation    Site

MAP FINDINGS

Database(s)    EDR ID Number  
EPA ID Number

UNOCAL (Continued)

1000167392

Funding: Federal Funds  
Staff Initials: SOS  
How Discovered: OM  
How Stopped: Not reported  
Interim : Yes  
Leak Cause: UNK  
Leak Source: UNK  
MTBE Date : 1965-01-02 00:0  
Max MTBE GW : 120 Parts per Billion  
MTBE Tested: MTBE Detected. Site tested for MTBE & MTBE detected  
Priority: Not reported  
Local Case # : 0  
Beneficial: Not reported  
Staff : BG  
GW Qualifier : Not reported  
Max MTBE Soil : 0.1 Parts per Million  
Soil Qualifier : Not reported  
Hydr Basin #: Livermore Valley (2-  
Operator : Not reported  
Oversight Prgm: LUST  
Review Date : 2001-08-02 00:00:00  
Stop Date : Not reported  
Work Suspended : No  
Responsible Party: DAVID B. DEWITT  
RP Address: 76 BROADWAY  
Global Id: T0600101883  
Org Name: Not reported  
Contact Person: Not reported  
MTBE Conc: 2  
Mtbe Fuel: 1  
Water System Name: Not reported  
Well Name: Not reported  
Distance To Lust: 1  
Waste Discharge Global ID: Not reported  
Waste Disch Assigned Name: Not reported

LUST Region 2:

Region: 2  
Case Number: RO0000482  
Facility Id: 01-2038  
Facility Status: Post remedial action monitoring  
How Discovered: OM  
Leak Cause: UNK  
Leak Source: UNK  
Date Leak Confirmed: 1/24/1996  
Prelim. Site Assessment Workplan Submitted: Not reported  
Preliminary Site Assessment Began: Not reported  
Pollution Characterization Began: Not reported  
Pollution Remediation Plan Submitted: Not reported  
Date Remediation Action Underway: Not reported  
Date Remediation Action Underway: 9/5/2000

Map ID  
Direction  
Distance  
Distance (ft.)  
Elevation     Site

MAP FINDINGS

Database(s)  
EDR ID Number  
EPA ID Number

UNOCAL (Continued)

1000167392

Gepaid: CAD982058810  
TSD EPA ID: CAD009452657  
Gen County: 7  
Tsd County: San Mateo  
Tons: .0667  
Waste Category: Aqueous solution with 10% or more total organic residues  
Disposal Method: Recycler  
Contact: UNION OIL COMPANY OF CALIFORNI  
Telephone: (714) 428-6560  
Mailing Address: PO BOX 25376  
SANTA ANA, CA 92799 - 5376  
County: 7

Click this hyperlink while viewing on your computer to access  
1 additional CA HAZNET record(s) in the EDR Site Report.

CORTESE:

Region: CORTESE  
Fac Address 2: 7850 AMADOR VALLEY BLVD

C11  
NE  
1/4-1/2  
2569 ft.

EXXON  
7840 AMADOR VALLEY BLVD  
DUBLIN, CA 94566

Cortese S102429374  
HAZNET N/A  
LUST

Site 3 of 3 in cluster C

Relative:  
Lower

Actual:  
360 ft.

State LUST:

Cross Street: Not reported  
Qty Leaked: Not reported  
Case Number: 01-0600  
Reg Board: 2  
Chemical: Gasoline  
Lead Agency: Local Agency  
Local Agency: 01000L  
Case Type: A, S  
Status: Suspension of Work Letter from Cleanup Fund  
Abate Method: Excavate and Dispose - remove contaminated soil and dispose in approved site

Review Date: 1993-08-11 00:00:00

Confirm Leak: 1993-08-11 00:00:00

Workplan: Not reported

Prelim Assess: Not reported

Pollution Char: Not reported

Remed Plan: Not reported

Remed Action: Not reported

Monitoring: Not reported

Close Date: 1997-06-09 00:00:00

Release Date: Not reported

Cleanup Fund Id: Not reported

Discover Date: Not reported

Enforcement Dt: 1992-10-27 00:00:00

Enf Type: EF

Enter Date: 1992-06-11 00:00:00

Funding: Federal Funds

Staff Initials: SOS

How Discovered: Tank Closure

How Stopped: Not reported

Interim: Yes

Leak Cause: Structure Failure

Leak Source: Tank

MTBE Date: Not reported

Max MTBE GW: Not reported

Map ID  
Direction  
Distance  
Distance (ft.)  
Elevation

MAP FINDINGS

EXXON (Continued)

EDR ID Number  
EPA ID Number

Database(s)

S102429374

County DUBLIN, CA 94566  
Not reported

CORTESE:

Region: CORTESE  
Fac Address 2: 7840 AMADOR VALLEY BLVD

12  
ENE  
1/4-1/2  
2600 ft.

SHAMROCK FORD  
7499 DUBLIN BLVD  
DUBLIN, CA 94568

Cortese 1000303001  
HIST UST N/A  
HAZNET  
LUST  
EMI

Relative:  
Lower

Actual:  
352 ft.

State LUST:

Cross Street: Not reported  
Qty Leaked: Not reported  
Case Number: 01-1158  
Reg Board: 2  
Chemical: Gasoline  
Lead Agency: Local Agency  
Local Agency : 01000L  
Case Type: Undefined  
Status: Case Closed  
Abate Method: No Action Taken - no action has as yet been taken at the site  
Review Date: Not reported  
Workplan: Not reported  
Pollution Char: Not reported  
Remed Action: Not reported  
Monitoring: Not reported  
Close Date: 1995-09-15 00:00:00  
Release Date: Not reported  
Cleanup Fund Id : Not reported  
Discover Date : Not reported  
Enforcement Dt : Not reported  
Enf Type: Not reported  
Enter Date : 1993-07-21 00:00:00  
Funding: Federal Funds  
Staff Initials: UNK  
How Discovered: Tank Closure  
How Stopped: Not reported  
Interim : No  
Leak Cause: UNK  
Leak Source: UNK  
MTBE Date : Not reported  
Max MTBE GW : Not reported  
MTBE Tested: Site NOT Tested for MTBE.Includes Unknown and Not Analyzed.  
Priority: Not reported  
Local Case # : 2127  
Beneficial: Not reported  
Staff : BG  
GW Qualifier : Not reported  
Max MTBE Soil : Not reported  
Soil Qualifier : Not reported  
Hydr Basin #: Livermore Valley (2-  
Operator : Not reported  
Oversight Prgm: LUST  
Review Date : 1997-04-16 00:00:00  
Stop Date : Not reported  
Work Suspended No

Confirm Leak: Not reported  
Prelim Assess: Not reported  
Remed Plan: Not reported

Map ID  
Direction  
Distance  
Distance (ft.)  
Elevation    Site

MAP FINDINGS

Database(s)    EDR ID Number  
EPA ID Number

SHAMROCK FORD (Continued)

1000303001

Gepaid: CAD981171192  
TSD EPA ID: CAD980887418  
Gen County: 1  
Tsd County: 1  
Tons: 4.7955  
Waste Category: Aqueous solution with less than 10% total organic residues  
Disposal Method: Transfer Station  
Contact: JAMES WOULFE & CRAIG CALDWELL  
Telephone: (925) 829-5211  
Mailing Address: PO BOX 2040  
DUBLIN, CA 94568 - 2489  
County 1

Gepaid: CAD981171192  
TSD EPA ID: CAT000613950  
Gen County: 1  
Tsd County: Sacramento  
Tons: .4440  
Waste Category: Oxygenated solvents (acetone, butanol, ethyl acetate, etc.)  
Disposal Method: Transfer Station  
Contact: JAMES WOULFE & CRAIG CALDWELL  
Telephone: (925) 829-5211  
Mailing Address: PO BOX 2040  
DUBLIN, CA 94568 - 2489  
County 1

Gepaid: CAD981171192  
TSD EPA ID: CAT000613893  
Gen County: 1  
Tsd County: Los Angeles  
Tons: .3940  
Waste Category: Oxygenated solvents (acetone, butanol, ethyl acetate, etc.)  
Disposal Method: Transfer Station  
Contact: JAMES WOULFE & CRAIG CALDWELL  
Telephone: (925) 829-5211  
Mailing Address: PO BOX 2040  
DUBLIN, CA 94568 - 2489  
County 1

Gepaid: CAD981171192  
TSD EPA ID: CAT000613893  
Gen County: 1  
Tsd County: Los Angeles  
Tons: .1230  
Waste Category: Oxygenated solvents (acetone, butanol, ethyl acetate, etc.)  
Disposal Method: Not reported  
Contact: JAMES WOULFE & CRAIG CALDWELL  
Telephone: (925) 829-5211  
Mailing Address: PO BOX 2040  
DUBLIN, CA 94568 - 2489  
County 1

Click this hyperlink while viewing on your computer to access  
45 additional CA HAZNET record(s) in the EDR Site Report.

CORTESE:

Region: CORTESE  
Fac Address 2: 7499 Dublin Blvd



Map ID  
Direction  
Distance  
Distance (ft.)  
Elevation

MAP FINDINGS

14  
NE  
1/2-1  
5088 ft.

MOBIL SERVICE #1100-KNK  
7197 VILLAGE PARKWAY  
DUBLIN, CA 92562

Database(s)

EDR ID Number  
EPA ID Number

Notify 65  
Cortese  
LUST

S100178910  
N/A

Relative:  
Lower

Actual:  
339 ft.

State LUST:

Cross Street: Not reported  
Qty Leaked: Not reported  
Case Number: 01-1006  
Reg Board: 2  
Chemical: Waste Oil  
Lead Agency: Local Agency  
Local Agency : 01000L  
Case Type: Other ground water affected  
Status: Pollution Characterization  
Abate Method: Excavate and Dispose - remove contaminated soil and dispose in approved site

Review Date: Not reported  
Workplan: 1989-08-29 00:00:00  
Pollution Char: Not reported  
Remed Action: Not reported  
Monitoring: Not reported  
Close Date: Not reported  
Release Date: Not reported  
Cleanup Fund Id : Not reported  
Discover Date : Not reported  
Enforcement Dt : 1992-11-04 00:00:00  
Enf Type: EF  
Enter Date : 1989-06-13 00:00:00  
Funding: Federal Funds  
Staff Initials: UNK  
How Discovered: Tank Closure  
How Stopped: Not reported  
Interim : Yes  
Leak Cause: Structure Failure  
Leak Source: Tank  
MTBE Date : 1998-02-23 00:0  
Max MTBE GW : 5600 Parts per Billion  
MTBE Tested: MTBE Detected. Site tested for MTBE & MTBE detected  
Priority: Not reported  
Local Case # : 2043  
Beneficial: Not reported  
Staff : BG  
GW Qualifier : Not reported  
Max MTBE Soil : 10 Parts per Million  
Soil Qualifier : <  
Hydr Basin #: Livermore Valley (2-  
Operator : Not reported  
Oversight Prgm: LUST  
Review Date : 2001-07-03 00:00:00  
Stop Date : Not reported  
Work Suspended No  
Responsible Party: BLANK RP  
RP Address: Not reported  
Global Id: T0600100929  
Org Name: Not reported  
Contact Person: Not reported  
MTBE Conc: 2  
Mtbe Fuel: 0

Confirm Leak: Not reported  
Prelim Assess: 1989-08-29 00:00:00  
Remed Plan: Not reported

Map ID  
Direction  
Distance  
Distance (ft.)  
Elevation

MAP FINDINGS

EDR ID Number  
EPA ID Number  
Database(s)

ARCO SERVICE STATION NO. 6041 (Continued)

S100179467

Release Date: Not reported  
Cleanup Fund Id : Not reported  
Discover Date : Not reported  
Enforcement Dt : 1992-04-09 00:00:00  
Enf Type: EF  
Enter Date : 1991-09-21 00:00:00  
Funding: Federal Funds  
Staff Initials: SOS  
How Discovered: Tank Closure  
How Stopped: Not reported  
Interim : No  
Leak Cause: Structure Failure  
Leak Source: Tank  
MTBE Date : 1965-01-02 00:00:00  
Max MTBE GW : 20000 Parts per Billion  
MTBE Tested: MTBE Detected. Site tested for MTBE & MTBE detected  
Priority: Not reported  
Local Case # : 0  
Beneficial: Not reported  
Staff : BG  
GW Qualifier : Not reported  
Max MTBE Soil : Not reported  
Soil Qualifier : Not reported  
Hydr Basin #: Livermore Valley (2-  
Operator : Not reported  
Oversight Prgm: LUST  
Review Date : 2000-09-06 00:00:00  
Stop Date : Not reported  
Work Suspended No  
Responsible Party PAUL SUPPLE  
RP Address: PO BOX 6549  
Global Id: T0600100109  
Org Name: Not reported  
Contact Person: Not reported  
MTBE Conc: 1  
Mtbe Fuel: 1  
Water System Name: Not reported  
Well Name: Not reported  
Distance To Lust: 1  
Waste Discharge Global ID: Not reported  
Waste Disch Assigned Name: Not reported

LUST Region 2:

Region: 2  
Case Number: RO0000452  
Facility Id: 01-0117  
Facility Status: Pollution Characterization  
How Discovered: TC  
Leak Cause: Structure Failure  
Leak Source: Tank  
Date Leak Confirmed: Not reported  
Prelim. Site Assesment Wokplan Submitted: 8/27/1991  
Preliminary Site Assesment Began: 9/20/1991  
Pollution Characterization Began: 2/24/1994  
Pollution Remediation Plan Submitted: Not reported  
Date Remediation Action Underway: Not reported  
Date Remediation Action Underway: Not reported

Map ID  
Direction  
Distance  
Distance (ft.)  
Elevation    Site

MAP FINDINGS

Database(s)

EDR ID Number  
EPA ID Number

ARCO SERVICE STATION NO. 6041 (Continued)

S100179467

Vehicle License Number :	Not reported
Vehicle State :	Not reported
Vehicle Id Number :	Not reported
CA/DOT/PUC/ICC Number :	Not reported
Company Name :	Not reported
Reporting Officer Name/ID :	Not reported
Report Date :	Not reported
Comments :	Not reported
Facility Telephone Number :	Not reported
Waterway Involved :	No
Waterway :	Not reported
Spill Site :	Service Station
Cleanup By :	Contractor
Containment :	Yes
What Happened :	Not reported
Type :	Not reported
Other :	Not reported
Chemical 1 :	Not Reported
Chemical 2 :	Not Reported
Chemical 3 :	Not Reported
Date/Time :	7/24/200103:18:07 PM
Evacuations :	0
True date :	12/31/03
Year :	2001
Agency :	Atlantic Richfield
BBLS :	0
Cups :	0
CUFT :	0
Gallons :	10
Grams :	0
Pounds :	0
Liters :	0
Ounces :	0
Pints :	0
Quarts :	0
Sheen :	0
Tons :	0
Unknown :	0.000000
Description :	Facility was being demolished and workers removed two hydraulic hoists, and the hoists leaked fluid.
Incident date :	7/23/200112:00:00 AM
Admin Agency :	Alameda County Environmental Health
OES date :	Not reported
OES time :	Not reported
Amount :	Not reported

## ORPHAN SUMMARY

City	EDR ID	Site Name	Site Address	Zip	Database(s)
ALAMEDA COUNTY	S105636607		I 580 AT NORTH LIVERMORE EXIT		CHMIRS, LUST
DUBLIN	S104735471	PARKS RESERVE FORCES TRAINING AREA	BLDG. 790, 5TH STREET	94568	Cal-Sites, AWP, CA WDS
DUBLIN	1000285234	DUBLIN RECORDS CENTER	6400 DIERA CT	94568	RCRIS-SQG, FINDS
DUBLIN	8714340	11989 DUBLIN RD @ HANSON	11989 DUBLIN RD @ HANSON		ERNS
DUBLIN	8722442	11976 DUBLIN BLVD. + I-580.	11976 DUBLIN BLVD. + I-580.		ERNS
DUBLIN	S103678607	DUBLIN UNIFIED SCHOOL DISTRICT	DUBLIN ELEMENTARY SCHOOL	94568	HAZNET
DUBLIN	S102792776	DUBLIN UNIFIED SCHOOL DISTRICT	DUBLIN HIGH SCHOOL	94568	HAZNET
DUBLIN	S106235163	WARMINGTON HOMES - HANSEN HILLS	DUBLIN BLVD @ SILVERGATE DR	94568	CA SLIC
DUBLIN	S106447563	SANTA RITA CENTRAL PARCEL	DUBLIN BLVD EXT	94568	LUST
DUBLIN	S106499738	SANTA RITA - CENTRAL PAR	DUBLIN BLVD EXTEN	94568	LUST
DUBLIN	93321066	WB LANE OF INT 580 AT THE DUBLIN EXIT	WB LANE OF INT 580 AT THE DUBLIN EXIT	94568	ERNS
DUBLIN	S105628367	M-1 MIDDLE SCHOOL	PARCEL 0-TRACT 6725/S DUBLIN RANCH DRIVE	94568	SCH
DUBLIN	1006804973	CHEVRON STATION NO 95542	7007 SAN RAMON VLY BLVD	94568	RCRIS-SQG, FINDS
DUBLIN	S106499731	SANTA RITA - OLD GRAYSTONE	580 E SANTA RITA RD	94568	LUST
DUBLIN	S106447756	PARKS RFTA (FORMERLY DUBLIN ECS 30)	5TH STREET	94568	LUST
DUBLIN	8714239	VASCO RD/5MILES N OF DUBLIN	VASCO RD/5MILES N OF DUBLIN		ERNS

## GOVERNMENT RECORDS SEARCHED / DATA CURRENCY TRACKING

Date of Government Version: 05/17/04  
Date Made Active at EDR: 08/10/04  
Database Release Frequency: Quarterly

Date of Data Arrival at EDR: 06/23/04  
Elapsed ASTM days: 48  
Date of Last EDR Contact: 09/21/04

### **CORRACTS:** Corrective Action Report

Source: EPA

Telephone: 800-424-9346

CORRACTS identifies hazardous waste handlers with RCRA corrective action activity.

Date of Government Version: 06/15/04  
Date Made Active at EDR: 08/10/04  
Database Release Frequency: Semi-Annually

Date of Data Arrival at EDR: 06/25/04  
Elapsed ASTM days: 46  
Date of Last EDR Contact: 09/07/04

### **RCRIS:** Resource Conservation and Recovery Information System

Source: EPA

Telephone: 800-424-9346

Resource Conservation and Recovery Information System. RCRIS includes selective information on sites which generate, transport, store, treat and/or dispose of hazardous waste as defined by the Resource Conservation and Recovery Act (RCRA). Conditionally exempt small quantity generators (CESQGs): generate less than 100 kg of hazardous waste, or less than 1 kg of acutely hazardous waste per month. Small quantity generators (SQGs): generate between 100 kg and 1,000 kg of hazardous waste per month. Large quantity generators (LQGs): generate over 1,000 kilograms (kg) of hazardous waste, or over 1 kg of acutely hazardous waste per month. Transporters are individuals or entities that move hazardous waste from the generator off-site to a facility that can recycle, treat, store, or dispose of the waste. TSDFs treat, store, or dispose of the waste.

Date of Government Version: 06/15/04  
Date Made Active at EDR: 07/20/04  
Database Release Frequency: Varies

Date of Data Arrival at EDR: 06/23/04  
Elapsed ASTM days: 27  
Date of Last EDR Contact: 08/24/04

### **ERNS:** Emergency Response Notification System

Source: National Response Center, United States Coast Guard

Telephone: 202-260-2342

Emergency Response Notification System. ERNS records and stores information on reported releases of oil and hazardous substances.

Date of Government Version: 12/31/03  
Date Made Active at EDR: 03/12/04  
Database Release Frequency: Annually

Date of Data Arrival at EDR: 01/26/04  
Elapsed ASTM days: 46  
Date of Last EDR Contact: 07/26/04

## **FEDERAL ASTM SUPPLEMENTAL RECORDS**

### **BRS:** Biennial Reporting System

Source: EPA/NTIS

Telephone: 800-424-9346

The Biennial Reporting System is a national system administered by the EPA that collects data on the generation and management of hazardous waste. BRS captures detailed data from two groups: Large Quantity Generators (LQG) and Treatment, Storage, and Disposal Facilities.

Date of Government Version: 12/01/01  
Database Release Frequency: Biennially

Date of Last EDR Contact: 09/20/04  
Date of Next Scheduled EDR Contact: 12/13/04

### **CONSENT:** Superfund (CERCLA) Consent Decrees

Source: Department of Justice, Consent Decree Library

Telephone: Varies

Major legal settlements that establish responsibility and standards for cleanup at NPL (Superfund) sites. Released periodically by United States District Courts after settlement by parties to litigation matters.

Date of Government Version: 03/05/04  
Database Release Frequency: Varies

Date of Last EDR Contact: 07/30/04  
Date of Next Scheduled EDR Contact: 10/25/04

## GOVERNMENT RECORDS SEARCHED / DATA CURRENCY TRACKING

Date of Government Version: 10/15/91  
Database Release Frequency: No Update Planned

Date of Last EDR Contact: 08/23/04  
Date of Next Scheduled EDR Contact: 11/22/04

### **PADS:** PCB Activity Database System

Source: EPA  
Telephone: 202-564-3887

PCB Activity Database. PADS Identifies generators, transporters, commercial storers and/or brokers and disposers of PCB's who are required to notify the EPA of such activities.

Date of Government Version: 06/29/04  
Database Release Frequency: Annually

Date of Last EDR Contact: 08/10/04  
Date of Next Scheduled EDR Contact: 11/08/04

### **DOD:** Department of Defense Sites

Source: USGS  
Telephone: 703-692-8801

This data set consists of federally owned or administered lands, administered by the Department of Defense, that have any area equal to or greater than 640 acres of the United States, Puerto Rico, and the U.S. Virgin Islands.

Date of Government Version: 10/01/03  
Database Release Frequency: Semi-Annually

Date of Last EDR Contact: 08/12/04  
Date of Next Scheduled EDR Contact: 11/08/04

### **INDIAN RESERV:** Indian Reservations

Source: USGS  
Telephone: 202-208-3710

This map layer portrays Indian administered lands of the United States that have any area equal to or greater than 640 acres.

Date of Government Version: 10/01/03  
Database Release Frequency: Semi-Annually

Date of Last EDR Contact: 08/12/04  
Date of Next Scheduled EDR Contact: 11/08/04

### **FUDS:** Formerly Used Defense Sites

Source: U.S. Army Corps of Engineers  
Telephone: 202-528-4285

The listing includes locations of Formerly Used Defense Sites properties where the US Army Corps of Engineers is actively working or will take necessary cleanup actions.

Date of Government Version: 12/31/03  
Database Release Frequency: Varies

Date of Last EDR Contact: 07/06/04  
Date of Next Scheduled EDR Contact: 10/04/04

### **STORMWATER:** Storm Water General Permits

Source: Environmental Protection Agency  
Telephone: 202-564-0746

A listing of all facilities with Storm Water General Permits.

Date of Government Version: 02/04/04  
Database Release Frequency: Quarterly

Date of Last EDR Contact: 07/06/04  
Date of Next Scheduled EDR Contact: 10/04/04

### **RMP:** Risk Management Plans

Source: Environmental Protection Agency  
Telephone: 202-564-8600

When Congress passed the Clean Air Act Amendments of 1990, it required EPA to publish regulations and guidance for chemical accident prevention at facilities using extremely hazardous substances. The Risk Management Program Rule (RMP Rule) was written to implement Section 112(r) of these amendments. The rule, which built upon existing industry codes and standards, requires companies of all sizes that use certain flammable and toxic substances to develop a Risk Management Program, which includes a(n): Hazard assessment that details the potential effects of an accidental release, an accident history of the last five years, and an evaluation of worst-case and alternative accidental releases; Prevention program that includes safety precautions and maintenance, monitoring, and employee training measures; and Emergency response program that spells out emergency health care, employee training measures and procedures for informing the public and response agencies (e.g the fire department) should an accident occur.

## GOVERNMENT RECORDS SEARCHED / DATA CURRENCY TRACKING

Date of Government Version: 04/13/04  
Database Release Frequency: Quarterly

Date of Last EDR Contact: 09/07/04  
Date of Next Scheduled EDR Contact: 12/20/04

### **SSTS: Section 7 Tracking Systems**

Source: EPA  
Telephone: 202-564-5008

Section 7 of the Federal Insecticide, Fungicide and Rodenticide Act, as amended (92 Stat. 829) requires all registered pesticide-producing establishments to submit a report to the Environmental Protection Agency by March 1st each year. Each establishment must report the types and amounts of pesticides, active ingredients and devices being produced, and those having been produced and sold or distributed in the past year.

Date of Government Version: 12/31/01  
Database Release Frequency: Annually

Date of Last EDR Contact: 07/20/04  
Date of Next Scheduled EDR Contact: 10/18/04

### **FTTS: FIFRA/ TSCA Tracking System - FIFRA (Federal Insecticide, Fungicide, & Rodenticide Act)/TSCA (Toxic Substances Control Act)**

Source: EPA/Office of Prevention, Pesticides and Toxic Substances  
Telephone: 202-564-2501

FTTS tracks administrative cases and pesticide enforcement actions and compliance activities related to FIFRA, TSCA and EPCRA (Emergency Planning and Community Right-to-Know Act). To maintain currency, EDR contacts the Agency on a quarterly basis.

Date of Government Version: 04/13/04  
Database Release Frequency: Quarterly

Date of Last EDR Contact: 09/07/04  
Date of Next Scheduled EDR Contact: 12/20/04

### **STATE OF CALIFORNIA ASTM STANDARD RECORDS**

#### **AWP: Annual Workplan Sites**

Source: California Environmental Protection Agency  
Telephone: 916-323-3400

Known Hazardous Waste Sites. California DTSC's Annual Workplan (AWP), formerly BEP, identifies known hazardous substance sites targeted for cleanup.

Date of Government Version: 06/01/04  
Date Made Active at EDR: 06/25/04  
Database Release Frequency: Annually

Date of Data Arrival at EDR: 06/04/04  
Elapsed ASTM days: 21  
Date of Last EDR Contact: 09/16/04

#### **CAL-SITES: Calsites Database**

Source: Department of Toxic Substance Control  
Telephone: 916-323-3400

The Calsites database contains potential or confirmed hazardous substance release properties. In 1996, California EPA reevaluated and significantly reduced the number of sites in the Calsites database.

Date of Government Version: 06/01/04  
Date Made Active at EDR: 06/25/04  
Database Release Frequency: Quarterly

Date of Data Arrival at EDR: 06/04/04  
Elapsed ASTM days: 21  
Date of Last EDR Contact: 09/16/04

#### **CHMIRS: California Hazardous Material Incident Report System**

Source: Office of Emergency Services  
Telephone: 916-845-8400

California Hazardous Material Incident Reporting System. CHMIRS contains information on reported hazardous material incidents (accidental releases or spills).

Date of Government Version: 12/31/03  
Date Made Active at EDR: 06/25/04  
Database Release Frequency: Varies

Date of Data Arrival at EDR: 05/18/04  
Elapsed ASTM days: 38  
Date of Last EDR Contact: 08/23/04

#### **CORTESE: "Cortese" Hazardous Waste & Substances Sites List**

Source: CAL EPA/Office of Emergency Information  
Telephone: 916-323-9100

The sites for the list are designated by the State Water Resource Control Board (LUST), the Integrated Waste Board (SWF/LS), and the Department of Toxic Substances Control (Cal-Sites). This listing is no longer updated by the state agency.



## GOVERNMENT RECORDS SEARCHED / DATA CURRENCY TRACKING

### CA BOND EXP. PLAN: Bond Expenditure Plan

Source: Department of Health Services

Telephone: 916-255-2118

Department of Health Services developed a site-specific expenditure plan as the basis for an appropriation of Hazardous Substance Cleanup Bond Act funds. It is not updated.

Date of Government Version: 01/01/89

Date Made Active at EDR: 08/02/94

Database Release Frequency: No Update Planned

Date of Data Arrival at EDR: 07/27/94

Elapsed ASTM days: 6

Date of Last EDR Contact: 05/31/94

### CA UST:

#### UST: Active UST Facilities

Source: SWRCB

Telephone: 916-341-5752

Active UST facilities gathered from the local regulatory agencies

Date of Government Version: 07/12/04

Date Made Active at EDR: 08/06/04

Database Release Frequency: Semi-Annually

Date of Data Arrival at EDR: 07/12/04

Elapsed ASTM days: 25

Date of Last EDR Contact: 07/12/04

### VCP: Voluntary Cleanup Program Properties

Source: Department of Toxic Substances Control

Telephone: 916-323-3400

Contains low threat level properties with either confirmed or unconfirmed releases and the project proponents have request that DTSC oversee investigation and/or cleanup activities and have agreed to provide coverage for DTSC's costs.

Date of Government Version: 06/01/04

Date Made Active at EDR: 06/25/04

Database Release Frequency: Quarterly

Date of Data Arrival at EDR: 06/04/04

Elapsed ASTM days: 21

Date of Last EDR Contact: 09/16/04

### INDIAN LUST: Leaking Underground Storage Tanks on Indian Land

Source: Environmental Protection Agency

Telephone: 415-972-3372

LUSTs on Indian land in Arizona, California, New Mexico and Nevada

Date of Government Version: 06/18/04

Date Made Active at EDR: 07/26/04

Database Release Frequency: Varies

Date of Data Arrival at EDR: 06/21/04

Elapsed ASTM days: 35

Date of Last EDR Contact: 08/23/04

### INDIAN LUST: Leaking Underground Storage Tanks on Indian Land

Source: EPA Region 10

Telephone: 206-553-2857

LUSTs on Indian land in Alaska, Idaho, Oregon and Washington.

Date of Government Version: 06/23/04

Date Made Active at EDR: 07/26/04

Database Release Frequency: Varies

Date of Data Arrival at EDR: 06/23/04

Elapsed ASTM days: 33

Date of Last EDR Contact: 08/23/04

### INDIAN UST: Underground Storage Tanks on Indian Land

Source: EPA Region 9

Telephone: 415-972-3368

Date of Government Version: 06/18/04

Date Made Active at EDR: 07/26/04

Database Release Frequency: Varies

Date of Data Arrival at EDR: 06/21/04

Elapsed ASTM days: 35

Date of Last EDR Contact: 08/23/04

### CA FID UST: Facility Inventory Database

Source: California Environmental Protection Agency

Telephone: 916-445-6532

The Facility Inventory Database (FID) contains a historical listing of active and inactive underground storage tank locations from the State Water Resource Control Board. Refer to local/county source for current data.

## GOVERNMENT RECORDS SEARCHED / DATA CURRENCY TRACKING

### **EMI:** Emissions Inventory Data

Source: California Air Resources Board

Telephone: 916-322-2990

Toxics and criteria pollutant emissions data collected by the ARB and local air pollution agencies.

Date of Government Version: 12/31/02

Database Release Frequency: Varies

Date of Last EDR Contact: 07/22/04

Date of Next Scheduled EDR Contact: 10/18/04

### **REF:** Unconfirmed Properties Referred to Another Agency

Source: Department of Toxic Substances Control

Telephone: 916-323-3400

This category contains properties where contamination has not been confirmed and which were determined as not requiring direct DTSC Site Mitigation Program action or oversight. Accordingly, these sites have been referred to another state or local regulatory agency.

Date of Government Version: 06/01/04

Database Release Frequency: Quarterly

Date of Last EDR Contact: 09/16/04

Date of Next Scheduled EDR Contact: 11/29/04

### **SCH:** School Property Evaluation Program

Source: Department of Toxic Substances Control

Telephone: 916-323-3400

This category contains proposed and existing school sites that are being evaluated by DTSC for possible hazardous materials contamination. In some cases, these properties may be listed in the CalSites category depending on the level of threat to public health and safety or the environment they pose.

Date of Government Version: 06/01/04

Database Release Frequency: Quarterly

Date of Last EDR Contact: 09/16/04

Date of Next Scheduled EDR Contact: 11/29/04

### **NFE:** Properties Needing Further Evaluation

Source: Department of Toxic Substances Control

Telephone: 916-323-3400

This category contains properties that are suspected of being contaminated. These are unconfirmed contaminated properties that need to be assessed using the PEA process. PEA in Progress indicates properties where DTSC is currently conducting a PEA. PEA Required indicates properties where DTSC has determined a PEA is required, but not currently underway.

Date of Government Version: 06/01/04

Database Release Frequency: Quarterly

Date of Last EDR Contact: 09/16/04

Date of Next Scheduled EDR Contact: 11/29/04

### **SLIC:** Statewide SLIC Cases

Source: State Water Resources Control Board

Telephone: 916-341-5752

The Spills, Leaks, Investigations, and Cleanups (SLIC) listings includes unauthorized discharges from spills and leaks, other than from underground storage tanks or other regulated sites.

Date of Government Version: 08/03/04

Database Release Frequency: Varies

Date of Last EDR Contact: 08/03/04

Date of Next Scheduled EDR Contact: 10/11/04

### **HAZNET:** Facility and Manifest Data

Source: California Environmental Protection Agency

Telephone: 916-255-1136

Facility and Manifest Data. The data is extracted from the copies of hazardous waste manifests received each year by the DTSC. The annual volume of manifests is typically 700,000 - 1,000,000 annually, representing approximately 350,000 - 500,000 shipments. Data are from the manifests submitted without correction, and therefore many contain some invalid values for data elements such as generator ID, TSD ID, waste category, and disposal method.

Date of Government Version: 12/31/02

Database Release Frequency: Annually

Date of Last EDR Contact: 08/09/04

Date of Next Scheduled EDR Contact: 11/08/04

## GOVERNMENT RECORDS SEARCHED / DATA CURRENCY TRACKING

Date of Government Version: 06/03/03  
Database Release Frequency: Varies

Date of Last EDR Contact: 08/19/04  
Date of Next Scheduled EDR Contact: 11/15/04

### **City of El Segundo Underground Storage Tank**

Source: City of El Segundo Fire Department  
Telephone: 310-524-2236

Date of Government Version: 06/02/04  
Database Release Frequency: Semi-Annually

Date of Last EDR Contact: 08/30/04  
Date of Next Scheduled EDR Contact: 11/15/04

### **City of Long Beach Underground Storage Tank**

Source: City of Long Beach Fire Department  
Telephone: 562-570-2543

Date of Government Version: 03/28/03  
Database Release Frequency: Annually

Date of Last EDR Contact: 08/27/04  
Date of Next Scheduled EDR Contact: 11/22/04

### **City of Torrance Underground Storage Tank**

Source: City of Torrance Fire Department  
Telephone: 310-618-2973

Date of Government Version: 08/16/04  
Database Release Frequency: Semi-Annually

Date of Last EDR Contact: 06/16/04  
Date of Next Scheduled EDR Contact: 11/15/04

### **City of Los Angeles Landfills**

Source: Engineering & Construction Division  
Telephone: 213-473-7869

Date of Government Version: 03/01/04  
Database Release Frequency: Varies

Date of Last EDR Contact: 09/14/04  
Date of Next Scheduled EDR Contact: 12/13/04

### **HMS: Street Number List**

Source: Department of Public Works  
Telephone: 626-458-3517  
Industrial Waste and Underground Storage Tank Sites.

Date of Government Version: 04/29/04  
Database Release Frequency: Semi-Annually

Date of Last EDR Contact: 08/16/04  
Date of Next Scheduled EDR Contact: 11/15/04

### **Site Mitigation List**

Source: Community Health Services  
Telephone: 323-890-7806  
Industrial sites that have had some sort of spill or complaint.

Date of Government Version: 02/26/04  
Database Release Frequency: Annually

Date of Last EDR Contact: 08/16/04  
Date of Next Scheduled EDR Contact: 11/15/04

### **San Gabriel Valley Areas of Concern**

Source: EPA Region 9  
Telephone: 415-972-3178  
San Gabriel Valley areas where VOC contamination is at or above the MCL as designated by region 9 EPA office.

Date of Government Version: 12/31/98  
Database Release Frequency: No Update Planned

Date of Last EDR Contact: 07/06/99  
Date of Next Scheduled EDR Contact: N/A

### **MARIN COUNTY:**

#### **Underground Storage Tank Sites**

Source: Public Works Department Waste Management  
Telephone: 415-499-6647  
Currently permitted USTs in Marin County.

## GOVERNMENT RECORDS SEARCHED / DATA CURRENCY TRACKING

### RIVERSIDE COUNTY:

#### Listing of Underground Tank Cleanup Sites

Source: Department of Public Health  
Telephone: 909-358-5055  
Riverside County Underground Storage Tank Cleanup Sites (LUST).

Date of Government Version: 06/21/04  
Database Release Frequency: Quarterly

Date of Last EDR Contact: 07/19/04  
Date of Next Scheduled EDR Contact: 10/18/04

#### Underground Storage Tank Tank List

Source: Health Services Agency  
Telephone: 909-358-5055

Date of Government Version: 06/21/04  
Database Release Frequency: Quarterly

Date of Last EDR Contact: 07/19/04  
Date of Next Scheduled EDR Contact: 10/18/04

### SACRAMENTO COUNTY:

#### CS - Contaminated Sites

Source: Sacramento County Environmental Management  
Telephone: 916-875-8406

Date of Government Version: 04/16/04  
Database Release Frequency: Quarterly

Date of Last EDR Contact: 08/02/04  
Date of Next Scheduled EDR Contact: 11/02/04

#### ML - Regulatory Compliance Master List

Source: Sacramento County Environmental Management  
Telephone: 916-875-8406

Any business that has hazardous materials on site - hazardous material storage sites, underground storage tanks, waste generators.

Date of Government Version: 04/16/04  
Database Release Frequency: Quarterly

Date of Last EDR Contact: 08/02/04  
Date of Next Scheduled EDR Contact: 11/01/04

### SAN BERNARDINO COUNTY:

#### Hazardous Material Permits

Source: San Bernardino County Fire Department Hazardous Materials Division  
Telephone: 909-387-3041

This listing includes underground storage tanks, medical waste handlers/generators, hazardous materials handlers, hazardous waste generators, and waste oil generators/handlers.

Date of Government Version: 06/28/04  
Database Release Frequency: Quarterly

Date of Last EDR Contact: 09/07/04  
Date of Next Scheduled EDR Contact: 12/06/04

### SAN DIEGO COUNTY:

#### Solid Waste Facilities

Source: Department of Health Services  
Telephone: 619-338-2209  
San Diego County Solid Waste Facilities.

Date of Government Version: 08/01/00  
Database Release Frequency: Varies

Date of Last EDR Contact: 08/23/04  
Date of Next Scheduled EDR Contact: 11/22/04

## GOVERNMENT RECORDS SEARCHED / DATA CURRENCY TRACKING

### Hazardous Material Facilities

Source: City of San Jose Fire Department  
Telephone: 408-277-4659

Date of Government Version: 10/01/03  
Database Release Frequency: Annually

Date of Last EDR Contact: 09/07/04  
Date of Next Scheduled EDR Contact: 12/06/04

### SOLANO COUNTY:

#### Leaking Underground Storage Tanks

Source: Solano County Department of Environmental Management  
Telephone: 707-421-6770

Date of Government Version: 07/08/04  
Database Release Frequency: Quarterly

Date of Last EDR Contact: 09/13/04  
Date of Next Scheduled EDR Contact: 12/13/04

#### Underground Storage Tanks

Source: Solano County Department of Environmental Management  
Telephone: 707-421-6770

Date of Government Version: 07/08/04  
Database Release Frequency: Quarterly

Date of Last EDR Contact: 09/13/04  
Date of Next Scheduled EDR Contact: 12/13/04

### SONOMA COUNTY:

#### Leaking Underground Storage Tank Sites

Source: Department of Health Services  
Telephone: 707-565-6565

Date of Government Version: 07/26/04  
Database Release Frequency: Quarterly

Date of Last EDR Contact: 07/26/04  
Date of Next Scheduled EDR Contact: 10/25/04

### SUTTER COUNTY:

#### Underground Storage Tanks

Source: Sutter County Department of Agriculture  
Telephone: 530-822-7500

Date of Government Version: 01/29/04  
Database Release Frequency: Semi-Annually

Date of Last EDR Contact: 07/06/04  
Date of Next Scheduled EDR Contact: 10/04/04

### VENTURA COUNTY:

#### Inventory of Illegal Abandoned and Inactive Sites

Source: Environmental Health Division  
Telephone: 805-654-2813

Ventura County Inventory of Closed, Illegal Abandoned, and Inactive Sites.

Date of Government Version: 09/01/02  
Database Release Frequency: Annually

Date of Last EDR Contact: 08/25/04  
Date of Next Scheduled EDR Contact: 11/22/04

#### Listing of Underground Tank Cleanup Sites

Source: Environmental Health Division  
Telephone: 805-654-2813

Ventura County Underground Storage Tank Cleanup Sites (LUST).

## GOVERNMENT RECORDS SEARCHED / DATA CURRENCY TRACKING

Date of Government Version: 02/10/04  
Database Release Frequency: No Update Planned

Date of Last EDR Contact: 08/16/04  
Date of Next Scheduled EDR Contact: 12/27/04

**LUST REG 5:** Leaking Underground Storage Tank Database

Source: California Regional Water Quality Control Board Central Valley Region (5)  
Telephone: 916-464-3291

Date of Government Version: 07/01/04  
Database Release Frequency: Quarterly

Date of Last EDR Contact: 07/19/04  
Date of Next Scheduled EDR Contact: 10/04/04

**LUST REG 6L:** Leaking Underground Storage Tank Case Listing

Source: California Regional Water Quality Control Board Lahontan Region (6)  
Telephone: 916-542-5424

For more current information, please refer to the State Water Resources Control Board's LUST database.

Date of Government Version: 09/09/03  
Database Release Frequency: No Update Planned

Date of Last EDR Contact: 09/08/04  
Date of Next Scheduled EDR Contact: 12/06/04

**LUST REG 6V:** Leaking Underground Storage Tank Case Listing

Source: California Regional Water Quality Control Board Victorville Branch Office (6)  
Telephone: 760-346-7491

Date of Government Version: 08/09/04  
Database Release Frequency: Quarterly

Date of Last EDR Contact: 10/04/04  
Date of Next Scheduled EDR Contact: 01/03/05

**LUST REG 7:** Leaking Underground Storage Tank Case Listing

Source: California Regional Water Quality Control Board Colorado River Basin Region (7)  
Telephone: 760-346-7491

Date of Government Version: 02/26/04  
Database Release Frequency: Semi-Annually

Date of Last EDR Contact: 09/27/04  
Date of Next Scheduled EDR Contact: 12/27/04

**LUST REG 8:** Leaking Underground Storage Tanks

Source: California Regional Water Quality Control Board Santa Ana Region (8)  
Telephone: 909-782-4498

California Regional Water Quality Control Board Santa Ana Region (8). For more current information, please refer to the State Water Resources Control Board's LUST database.

Date of Government Version: 07/01/04  
Database Release Frequency: No Update Planned

Date of Last EDR Contact: 08/09/04  
Date of Next Scheduled EDR Contact: 11/08/04

**LUST REG 9:** Leaking Underground Storage Tank Report

Source: California Regional Water Quality Control Board San Diego Region (9)  
Telephone: 858-467-2980

Orange, Riverside, San Diego counties. For more current information, please refer to the State Water Resources Control Board's LUST database.

Date of Government Version: 03/01/01  
Database Release Frequency: No Update Planned

Date of Last EDR Contact: 06/29/04  
Date of Next Scheduled EDR Contact: 10/18/04

### California Regional Water Quality Control Board (RWQCB) SLIC Records

**SLIC REG 1:** Active Toxic Site Investigations

Source: California Regional Water Quality Control Board, North Coast Region (1)  
Telephone: 707-576-2220

Date of Government Version: 04/03/03  
Database Release Frequency: Semi-Annually

Date of Last EDR Contact: 08/23/04  
Date of Next Scheduled EDR Contact: 11/22/04



## GOVERNMENT RECORDS SEARCHED / DATA CURRENCY TRACKING

### SLIÇ REG 9: Spills, Leaks, Investigation & Cleanup Cost Recovery Listing

Source: California Regional Water Quality Control Board San Diego Region (9)

Telephone: 858-467-2980

Date of Government Version: 04/29/04

Database Release Frequency: Annually

Date of Last EDR Contact: 08/30/04

Date of Next Scheduled EDR Contact: 11/29/04

### EDR PROPRIETARY HISTORICAL DATABASES

**EDR Historical Gas Station and Dry Cleaners:** EDR has searched select national collections of business directories and has collected listings of potential dry cleaner and gas station/filling station/service station sites that were available to EDR researchers. EDR's review was limited to those categories of sources that might, in EDR's opinion, include dry cleaning and gas station/filling station/service station establishments. The categories reviewed included, but were not limited to: *gas, gas station, gasoline station, filling station, auto, automobile repair, auto service station, service station, dry cleaner, cleaners, laundry, laundromat, cleaning/laundry, wash & dry, etc.*

This information is meant to assist and complement environmental professionals in their conduct of environmental site assessments, and is not meant to be a substitute for a full historical investigation as defined in ASTM E1527. The information provided in this proprietary database may or may not be complete; i.e., the absence of a dry cleaner or gas station/filling station/service station site does not necessarily mean that such a site did not exist in the area covered by this report.

*(A note on "dry cleaning" sites: it is not possible for EDR to differentiate between establishments that use PERC on-site as a cleaning solvent and sites that function simply as drop-off and pick-up locations or that are traditional wet cleaning/laundry facilities. Therefore, it is essential for environmental professionals to incorporate professional judgment in the evaluation of each site.)*

**Former Manufactured Gas (Coal Gas) Sites:** The existence and location of Coal Gas sites is provided exclusively to EDR by Real Property Scan, Inc. ©Copyright 1993 Real Property Scan, Inc. For a technical description of the types of hazards which may be found at such sites, contact your EDR customer service representative.

#### **Disclaimer Provided by Real Property Scan, Inc.**

The information contained in this report has predominantly been obtained from publicly available sources produced by entities other than Real Property Scan. While reasonable steps have been taken to insure the accuracy of this report, Real Property Scan does not guarantee the accuracy of this report. Any liability on the part of Real Property Scan is strictly limited to a refund of the amount paid. No claim is made for the actual existence of toxins at any site. This report does not constitute a legal opinion.

### BROWNFIELDS DATABASES

#### **VCP: Voluntary Cleanup Program Properties**

Source: Department of Toxic Substances Control

Telephone: 916-323-3400

Contains low threat level properties with either confirmed or unconfirmed releases and the project proponents have request that DTSC oversee investigation and/or cleanup activities and have agreed to provide coverage for DTSC's costs.

Date of Government Version: 06/01/04

Database Release Frequency: Quarterly

Date of Last EDR Contact: 09/16/04

Date of Next Scheduled EDR Contact: 11/29/04

#### **US BROWNFIELDS: A Listing of Brownfields Sites**

Source: Environmental Protection Agency

Telephone: 202-566-2777

Included in the listing are brownfields properties addresses by Cooperative Agreement Recipients and brownfields properties addressed by Targeted Brownfields Assessments. Targeted Brownfields Assessments-EPA's Targeted Brownfields Assessments (TBA) program is designed to help states, tribes, and municipalities--especially those without EPA Brownfields Assessment Demonstration Pilots--minimize the uncertainties of contamination often associated with brownfields. Under the TBA program, EPA provides funding and/or technical assistance for environmental assessments at brownfields sites throughout the country. Targeted Brownfields Assessments supplement and work with other efforts under EPA's Brownfields Initiative to promote cleanup and redevelopment of brownfields. Cooperative Agreement Recipients--States, political subdivisions, territories, and Indian tribes become BCRLF cooperative agreement recipients when they enter into BCRLF cooperative agreements with the U.S. EPA. EPA selects BCRLF cooperative agreement recipients based on a proposal and application process. BCRLF cooperative agreement recipients must use EPA funds provided through BCRLF cooperative agreement for specified brownfields-related cleanup activities.



## GOVERNMENT RECORDS SEARCHED / DATA CURRENCY TRACKING

### STREET AND ADDRESS INFORMATION

© 2003 Geographic Data Technology, Inc., Rel. 07/2003. This product contains proprietary and confidential property of Geographic Data Technology, Inc. Unauthorized use, including copying for other than testing and standard backup procedures, of this product is expressly prohibited.

## GEOCHECK® - PHYSICAL SETTING SOURCE SUMMARY

### GROUNDWATER FLOW DIRECTION INFORMATION

Groundwater flow direction for a particular site is best determined by a qualified environmental professional using site-specific well data. If such data is not reasonably ascertainable, it may be necessary to rely on other sources of information, such as surface topographic information, hydrologic information, hydrogeologic data collected on nearby properties, and regional groundwater flow information (from deep aquifers).

### TOPOGRAPHIC INFORMATION

Surface topography may be indicative of the direction of surficial groundwater flow. This information can be used to assist the environmental professional in forming an opinion about the impact of nearby contaminated properties or, should contamination exist on the target property, what downgradient sites might be impacted.

### TARGET PROPERTY TOPOGRAPHY

USGS Topographic Map: 37121-F8 DUBLIN, CA  
General Topographic Gradient: General East  
Source: USGS 7.5 min quad index

### SURROUNDING TOPOGRAPHY: ELEVATION PROFILES

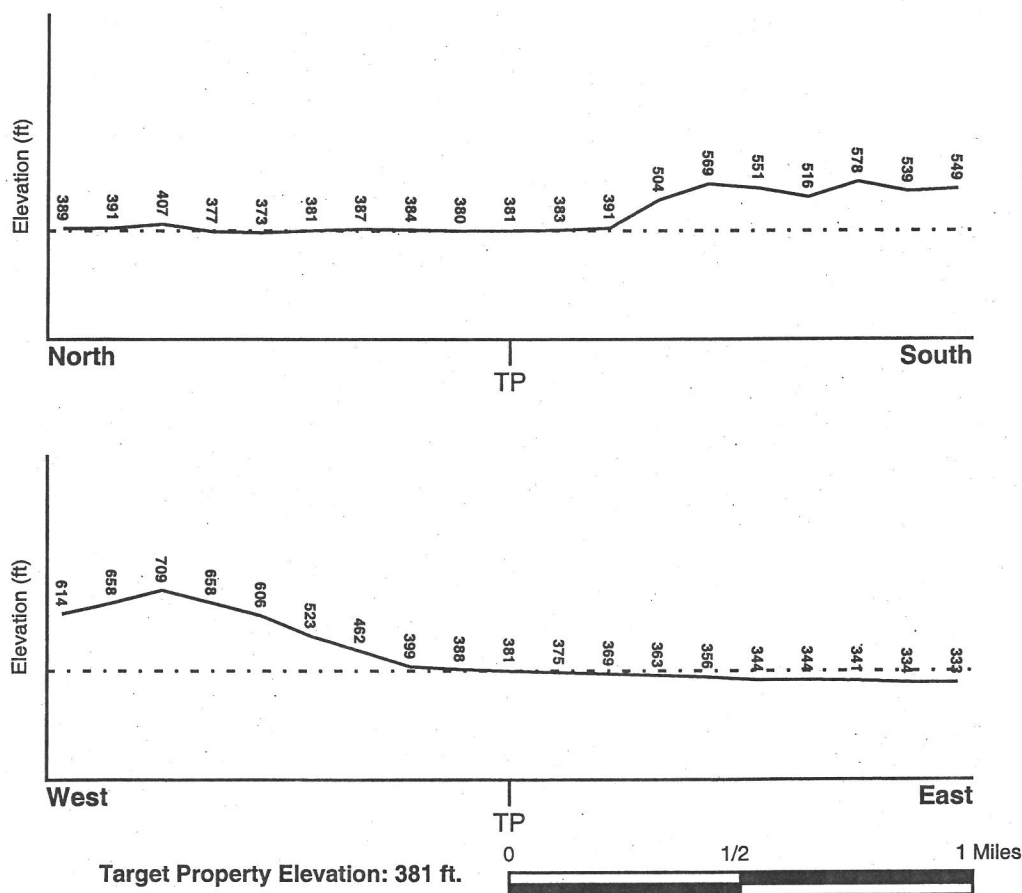

Source: Topography has been determined from the USGS 7.5' Digital Elevation Model and should be evaluated on a relative (not an absolute) basis. Relative elevation information between sites of close proximity should be field verified.

## GEOCHECK® - PHYSICAL SETTING SOURCE SUMMARY

<u>MAP ID</u>	<u>LOCATION FROM TP</u>	<u>GENERAL DIRECTION GROUNDWATER FLOW</u>
D11	1/2 - 1 Mile ENE	S
E12	1/2 - 1 Mile ENE	NE
E13	1/2 - 1 Mile ENE	SE
I4	1/2 - 1 Mile NE	Varies
F15	1/2 - 1 Mile NNE	E
E16	1/2 - 1 Mile ENE	NW
F17	1/2 - 1 Mile NNE	E
G19	1/2 - 1 Mile NNE	Varies
G20	1/2 - 1 Mile NNE	Varies
G21	1/2 - 1 Mile NNE	E,SE,Varies
G22	1/2 - 1 Mile NNE	Varies
H23	1/2 - 1 Mile NE	Varies
H24	1/2 - 1 Mile NE	Varies
H25	1/2 - 1 Mile NE	Varies
H26	1/2 - 1 Mile NE	E
H27	1/2 - 1 Mile NE	E
I28	1/2 - 1 Mile NE	SSE
I29	1/2 - 1 Mile NE	NE
I30	1/2 - 1 Mile NE	Flat
I31	1/2 - 1 Mile NE	Flat
J32	1/2 - 1 Mile NE	NW
J33	1/2 - 1 Mile NE	W
J34	1/2 - 1 Mile NE	Varies

For additional site information, refer to Physical Setting Source Map Findings.

## GEOCHECK® - PHYSICAL SETTING SOURCE SUMMARY

Soil Layer Information							
	Boundary			Classification			
Layer	Upper	Lower	Soil Texture Class	AASHTO Group	Unified Soil	Permeability Rate (in/hr)	Soil Reaction (pH)
2	13 inches	60 inches	clay	Silt-Clay Materials (more than 35 pct. passing No. 200), Clayey Soils.	FINE-GRAINED SOILS, Silts and Clays (liquid limit 50% or more), Fat Clay.	Max: 0.20 Min: 0.06	Max: 8.40 Min: 7.40

### OTHER SOIL TYPES IN AREA

Based on Soil Conservation Service STATSGO data, the following additional subordinant soil types may appear within the general area of target property.

Soil Surface Textures: silty clay loam  
clay loam  
loam  
silt loam

Surficial Soil Types: silty clay loam  
clay loam  
loam  
silt loam

Shallow Soil Types: clay  
gravelly - sandy clay loam  
clay loam  
stratified

Deeper Soil Types: clay loam  
stratified  
silty clay loam  
sandy clay loam  
loam  
silty clay  
weathered bedrock

### ADDITIONAL ENVIRONMENTAL RECORD SOURCES

According to ASTM E 1527-00, Section 7.2.2, "one or more additional state or local sources of environmental records may be checked, in the discretion of the environmental professional, to enhance and supplement federal and state sources... Factors to consider in determining which local or additional state records, if any, should be checked include (1) whether they are reasonably ascertainable, (2) whether they are sufficiently useful, accurate, and complete in light of the objective of the records review (see 7.1.1), and (3) whether they are obtained, pursuant to local, good commercial or customary practice." One of the record sources listed in Section 7.2.2 is water well information. Water well information can be used to assist the environmental professional in assessing sources that may impact groundwater flow direction, and in forming an opinion about the impact of contaminant migration on nearby drinking water wells.

# PHYSICAL SETTING SOURCE MAP - 1282084.2s

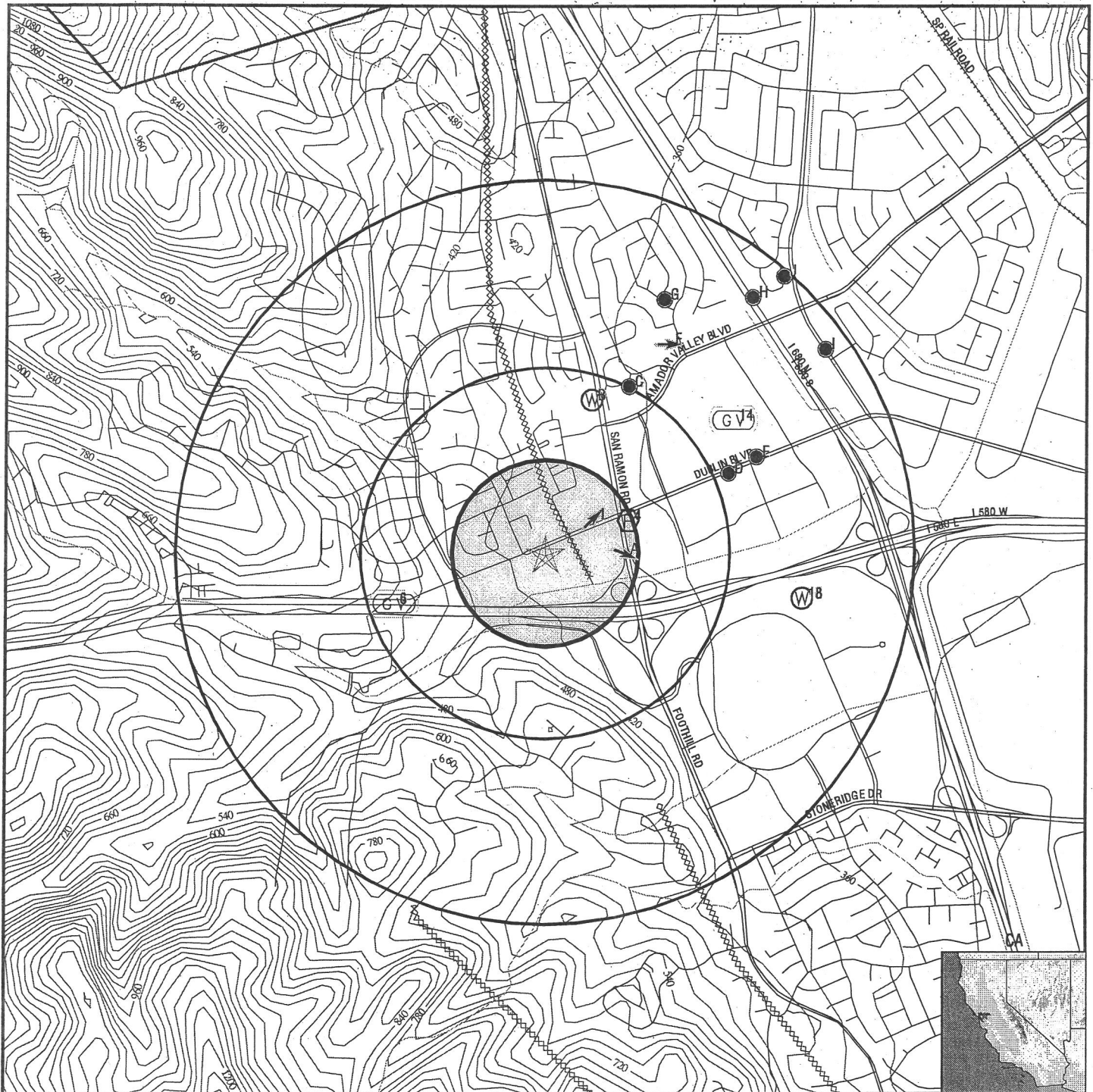

- County Boundary
- Major Roads
- Contour Lines
- Earthquake Fault Lines
- Earthquake epicenter, Richter 5 or greater
- Water Wells
- Public Water Supply Wells
- Cluster of Multiple Icons

- Groundwater Flow Direction
- Indeterminate Groundwater Flow at Location
- Groundwater Flow Varies at Location
- Closest Hydrogeological Data
- Oil, gas or related wells

**TARGET PROPERTY:** 11759 Dublin Boulevard  
**ADDRESS:** 11759 Dublin Boulevard  
**CITY/STATE/ZIP:** Dublin CA 94568  
**LAT/LONG:** 37.7006 / 121.9396

**CUSTOMER:** Treadwell & Rollo, Inc.  
**CONTACT:** Peter J. Cusack  
**INQUIRY #:** 1282084.2s  
**DATE:** October 05, 2004 2:19 pm

# GEOCHECK® - PHYSICAL SETTING SOURCE MAP FINDINGS

Agency:	USGS	Site ID:	374223121561001
Site Name:	003S001W02A002M		
Dec. Latitude:	37.70632		
Dec. Longitude:	-121.93718		
Coord Sys:	NAD83		
State:	CA		
County:	Alameda County		
Altitude:	368.10		
Hydrologic code:	18050004		
Topographic:	Valley flat		
Site Type:	Ground-water other than Spring		
Const Date:	19760618	Inven Date:	Not Reported
Well Type:	Single well, other than collector or Ranney type		
Primary Aquifer:	110ALVM		
Aquifer type:	Not Reported		
Well depth:	47.0		
Hole depth:	47.0		
Project no:	Not Reported	Source:	Not Reported

Ground-water levels, Number of Measurements: 33

Date	Feet below Surface	Feet to Sealevel	Date	Feet below Surface	Feet to Sealevel
1981-07-20	27.30		1981-04-27	26.20	
1981-01-13	27.90		1980-10-09	25.90	
1980-10-01	25.70		1980-07-29	23.70	
1980-05-14	20.90		1980-04-30	20.40	
1980-01-08	27.10		1979-10-15	26.70	
1979-06-29	23.40		1979-05-29	22.50	
1979-03-26	22.10		1979-01-22	25.70	
1979-01-18	25.90		1978-10-11	25.60	
1978-07-18	22.70		1978-05-04	20.50	
1978-02-27	24.00		1977-10-26	33.70	
1977-09-14	33.50		1977-08-26	33.40	
1977-04-21	32.60		1977-03-28	32.50	
1977-02-15	32.30		1977-01-14	32.00	
1977-01-04	31.70		1976-12-27	32.10	
1976-11-18	31.70		1976-10-25	31.60	
1976-10-07	31.40		1976-08-06	30.80	
1976-07-12	30.50				

<b>6</b> <b>WSW</b> <b>1/4 - 1/2 Mile</b> <b>Higher</b>	Site ID: 01-1571 Groundwater Flow: Varies Shallow Water Depth: Not Reported Deep Water Depth: Not Reported Average Water Depth: 8' bg Date: 07/30/1990	<b>AQUIFLOW 51548</b>
--	---	-----------------------

<b>B7</b> <b>NNE</b> <b>1/4 - 1/2 Mile</b> <b>Lower</b>		<b>FED USGS USGS0119497</b>
--	--	-----------------------------

# GEOCHECK® - PHYSICAL SETTING SOURCE MAP FINDINGS

Map ID  
Direction  
Distance  
Elevation

Database      EDR ID Number

<b>D10</b> <b>ENE</b> <b>1/2 - 1 Mile</b> <b>Lower</b>	Site ID: Groundwater Flow: Shallow Water Depth: Deep Water Depth: Average Water Depth: Date:	01-0892 SE Not Reported Not Reported 16 09/01/1992	<b>AQUIFLOW</b>	<b>51653</b>
<b>D11</b> <b>ENE</b> <b>1/2 - 1 Mile</b> <b>Lower</b>	Site ID: Groundwater Flow: Shallow Water Depth: Deep Water Depth: Average Water Depth: Date:	01-1054 S 9.36 11.02 Not Reported 11/01/1991	<b>AQUIFLOW</b>	<b>51655</b>
<b>E12</b> <b>ENE</b> <b>1/2 - 1 Mile</b> <b>Lower</b>	Site ID: Groundwater Flow: Shallow Water Depth: Deep Water Depth: Average Water Depth: Date:	01-1158 NE 5.92 7.88 Not Reported 07/17/1995	<b>AQUIFLOW</b>	<b>52513</b>
<b>E13</b> <b>ENE</b> <b>1/2 - 1 Mile</b> <b>Lower</b>	Site ID: Groundwater Flow: Shallow Water Depth: Deep Water Depth: Average Water Depth: Date:	01-1158 SE Not Reported Not Reported 7 10/27/1993	<b>AQUIFLOW</b>	<b>52512</b>
<b>14</b> <b>NE</b> <b>1/2 - 1 Mile</b> <b>Lower</b>	Site ID: Groundwater Flow: Shallow Water Depth: Deep Water Depth: Average Water Depth: Date:	01-0514 Varies 8.5 9.5 Not Reported 11/27/1995	<b>AQUIFLOW</b>	<b>50328</b>
<b>F15</b> <b>NNE</b> <b>1/2 - 1 Mile</b> <b>Lower</b>	Site ID: Groundwater Flow: Shallow Water Depth: Deep Water Depth: Average Water Depth: Date:	01-0084 E 2.89 7.78 Not Reported 11/20/1995	<b>AQUIFLOW</b>	<b>50269</b>
<b>E16</b> <b>ENE</b> <b>1/2 - 1 Mile</b> <b>Lower</b>	Site ID: Groundwater Flow: Shallow Water Depth: Deep Water Depth: Average Water Depth: Date:	Not Reported NW 14.08 16.41 Not Reported 08/02/1999	<b>AQUIFLOW</b>	<b>52987</b>



# GEOCHECK® - PHYSICAL SETTING SOURCE MAP FINDINGS

Ground-water levels, continued.

Date	Feet below Surface	Feet to Sealevel	Date	Feet below Surface	Feet to Sealevel
1979-08-06	18.20		1979-07-16	17.80	
1979-07-06	17.40		1979-07-02	17.10	
1979-06-11	16.50		1979-05-29	16.00	
1979-04-30	15.70		1979-04-26	15.60	
1979-04-09	15.50		1979-04-02	15.50	
1979-03-26	15.60		1979-03-19	15.80	
1979-03-08	15.80		1979-01-26	17.50	
1978-10-26	19.70		1978-09-12	19.00	
1978-08-24	18.60		1978-05-17	15.50	
1978-03-30	15.90		1978-03-16	16.60	
1977-10-17	24.10		1977-09-14	23.80	
1977-07-22	23.80		1977-05-26	23.30	
1977-03-28	22.90		1977-03-18	23.00	
1977-01-27	22.80		1977-01-19	22.80	
1976-12-20	23.30		1976-11-16	23.30	
1976-10-22	23.10		1976-09-23	23.10	
1976-08-18	23.00		1976-07-29	22.60	
1976-06-17	22.30		1976-05-18	21.90	
1976-04-29	21.70		1976-03-09	21.30	
1976-02-18	21.70		1975-09-23	20.30	
1974-09-23	18.70		1974-03-04	16.90	
1973-10-01	18.80		1973-03-12	16.30	
1972-09-19	23.80		1972-03-14	20.80	
1971-09-14	20.50		1971-04-13	18.00	
1970-10-09	20.90		1970-04-10	15.90	
1969-10-06	19.30		1969-04-29	13.40	
1968-09-19	13.70		1968-04-05	14.30	
1967-10-24	17.60		1967-04-25	15.50	
1966-09-26	21.50		1966-03-21	17.50	
1965-10-01	19.30		1965-03-23	16.60	
1964-10-02	21.00		1964-03-24	17.60	
1963-04-17	17.70		1963-03-25	16.50	
1962-09-06	22.00		1962-03-26	17.60	
1961-09-28	25.00		1961-03-16	22.80	

**G19**  
**NNE**  
**1/2 - 1 Mile**  
**Lower**

Site ID: 01-0513  
Groundwater Flow: Varies  
Shallow Water Depth: Not Reported  
Deep Water Depth: Not Reported  
Average Water Depth: 5-10  
Date: 12/11/1989

**AQUIFLOW 52500**

**G20**  
**NNE**  
**1/2 - 1 Mile**  
**Lower**

Site ID: 01-0513  
Groundwater Flow: Varies  
Shallow Water Depth: 8.29  
Deep Water Depth: 9.02  
Average Water Depth: Not Reported  
Date: 06/16/1995

**AQUIFLOW 52501**

**G21**  
**NNE**  
**1/2 - 1 Mile**  
**Lower**

Site ID: 01-0513  
Groundwater Flow: E,SE,Varies  
Shallow Water Depth: 8.29  
Deep Water Depth: 9.02  
Average Water Depth: Not Reported  
Date: 06/16/1995

**AQUIFLOW 49988**



## GEOCHECK® - PHYSICAL SETTING SOURCE MAP FINDINGS

Map ID  
Direction  
Distance  
Elevation

Database      EDR ID Number

<b>I29</b> <b>NE</b> <b>1/2 - 1 Mile</b> <b>Lower</b>	Site ID: Groundwater Flow: Shallow Water Depth: Deep Water Depth: Average Water Depth: Date:	01-0458 NE 15' 20' Not Reported 05/02/1991	<b>AQUIFLOW</b>	<b>51651</b>
--	---	---	-----------------	--------------

<b>I30</b> <b>NE</b> <b>1/2 - 1 Mile</b> <b>Lower</b>	Site ID: Groundwater Flow: Shallow Water Depth: Deep Water Depth: Average Water Depth: Date:	01-1769 Flat 5.56 12.03 Not Reported 07/18/1996	<b>AQUIFLOW</b>	<b>51657</b>
--	---	--	-----------------	--------------

<b>I31</b> <b>NE</b> <b>1/2 - 1 Mile</b> <b>Lower</b>	Site ID: Groundwater Flow: Shallow Water Depth: Deep Water Depth: Average Water Depth: Date:	01-1769 Flat 6.5 f 7.5 f Not Reported 11/19/1993	<b>AQUIFLOW</b>	<b>51656</b>
--	---	---	-----------------	--------------

<b>J32</b> <b>NE</b> <b>1/2 - 1 Mile</b> <b>Lower</b>	Site ID: Groundwater Flow: Shallow Water Depth: Deep Water Depth: Average Water Depth: Date:	01-1006 NW Not Reported Not Reported Not Reported 09/01/1989	<b>AQUIFLOW</b>	<b>52355</b>
--	---	---	-----------------	--------------

<b>J33</b> <b>NE</b> <b>1/2 - 1 Mile</b> <b>Lower</b>	Site ID: Groundwater Flow: Shallow Water Depth: Deep Water Depth: Average Water Depth: Date:	01-0117 W 6.26 10.26 Not Reported 09/19/1990	<b>AQUIFLOW</b>	<b>52353</b>
--	---	---	-----------------	--------------

<b>J34</b> <b>NE</b> <b>1/2 - 1 Mile</b> <b>Lower</b>	Site ID: Groundwater Flow: Shallow Water Depth: Deep Water Depth: Average Water Depth: Date:	01-0117 Varies 5.90 11.25 Not Reported 06/22/1999	<b>AQUIFLOW</b>	<b>52352</b>
--	---	--	-----------------	--------------

# PHYSICAL SETTING SOURCE RECORDS SEARCHED

## TOPOGRAPHIC INFORMATION

### **USGS 7.5' Digital Elevation Model (DEM)**

Source: United States Geologic Survey

EDR acquired the USGS 7.5' Digital Elevation Model in 2002. 7.5-Minute DEMs correspond to the USGS 1:24,000- and 1:25,000-scale topographic quadrangle maps.

## HYDROLOGIC INFORMATION

**Flood Zone Data:** This data, available in select counties across the country, was obtained by EDR in 1999 from the Federal Emergency Management Agency (FEMA). Data depicts 100-year and 500-year flood zones as defined by FEMA.

**NWI:** National Wetlands Inventory. This data, available in select counties across the country, was obtained by EDR in 2002 from the U.S. Fish and Wildlife Service.

## HYDROGEOLOGIC INFORMATION

### **AQUIFLOW<sup>R</sup> Information System**

Source: EDR proprietary database of groundwater flow information

EDR has developed the AQUIFLOW Information System (AIS) to provide data on the general direction of groundwater flow at specific points. EDR has reviewed reports submitted to regulatory authorities at select sites and has extracted the date of the report, hydrogeologically determined groundwater flow direction and depth to water table information.

## GEOLOGIC INFORMATION

### **Geologic Age and Rock Stratigraphic Unit**

Source: P.G. Schruben, R.E. Arndt and W.J. Bawiec, Geology of the Conterminous U.S. at 1:2,500,000 Scale - A digital representation of the 1974 P.B. King and H.M. Beikman Map, USGS Digital Data Series DDS - 11 (1994).

### **STATSGO: State Soil Geographic Database**

Source: Department of Agriculture, Natural Resources Conservation Services

The U.S. Department of Agriculture's (USDA) Natural Resources Conservation Service (NRCS) leads the national Conservation Soil Survey (NCSS) and is responsible for collecting, storing, maintaining and distributing soil survey information for privately owned lands in the United States. A soil map in a soil survey is a representation of soil patterns in a landscape. Soil maps for STATSGO are compiled by generalizing more detailed (SSURGO) soil survey maps.

## ADDITIONAL ENVIRONMENTAL RECORD SOURCES

### **FEDERAL WATER WELLS**

#### **PWS: Public Water Systems**

Source: EPA/Office of Drinking Water

Telephone: 202-564-3750

Public Water System data from the Federal Reporting Data System. A PWS is any water system which provides water to at least 25 people for at least 60 days annually. PWSs provide water from wells, rivers and other sources.

#### **PWS ENF: Public Water Systems Violation and Enforcement Data**

Source: EPA/Office of Drinking Water

Telephone: 202-564-3750

Violation and Enforcement data for Public Water Systems from the Safe Drinking Water Information System (SDWIS) after August 1995. Prior to August 1995, the data came from the Federal Reporting Data System (FRDS).

#### **USGS Water Wells: USGS National Water Inventory System (NWIS)**

This database contains descriptive information on sites where the USGS collects or has collected data on surface water and/or groundwater. The groundwater data includes information on wells, springs, and other sources of groundwater.