

Atlantic Richfield Company

Chuck Carmel
Remediation Management Project Manager

RECEIVED

By Alameda County Environmental Health at 10:06 am, Oct 21, 2014

PO Box 1257
San Ramon, CA 94583
Phone: (925) 275-3804
Fax: (925) 275-3815
E-Mail: chuck.carmel@bp.com

October 17, 2014

Re: Third Quarter 2014 Status Report
Former Richfield Oil Company Station No. 472
6415 International Boulevard, Oakland, California
ACEH Case #RO0002982

I declare that to the best of my knowledge at the present time, that the information and/or recommendations contained in the attached document are true and correct.

Submitted by,



Chuck Carmel
Remediation Management Project Manager

Attachment



4820 Business Center Drive, Suite 110
Fairfield, CA 94534
[T] 707-455-7290 [F] 707 863 9046
broadbentinc.com

Creating Solutions. Building Trust.

October 17, 2014

Project No. 09-88-601

Atlantic Richfield Company
P.O. Box 1257
San Ramon, CA 94583
Submitted via ENFOS

Attn.: Mr. Chuck Carmel

Re: Third Quarter 2014 Status Report, Former Richfield Oil Company Station No. 472,
6415 International Boulevard, Oakland, California; ACEH Case #RO0002982

Dear Mr. Carmel

Attached is the Third Quarter 2014 Status Report for Former Richfield Oil Company Station No. 472 located at 6415 International Boulevard, Oakland, California. This report presents a summary of current developments at the Site through the Third Quarter of 2014.

Should you have questions regarding this submittal, please do not hesitate to contact me at (707) 455-7290.

Sincerely,

BROADBENT & ASSOCIATES, INC.

Kristene Tidwell, P.G., C.HG.
Associate Hydrogeologist

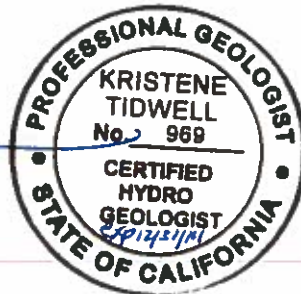

Enclosures

cc: Mr. Keith Nowell, Alameda County Environmental Health (submitted via ACEH ftp site)
Mr. Mahmud Ghanem, 6207 International Boulevard, Oakland, California 94621
Electronic copy uploaded to GeoTracker

**THIRD QUARTER 2014
STATUS REPORT
FORMER STATION No. 472, OAKLAND, CALIFORNIA**

Broadbent & Associates, Inc. (Broadbent) is pleased to present this *Third Quarter 2014 Status Report* on behalf of Atlantic Richfield Company (a BP affiliated company) for Former Richfield Oil Company Station No. 472 located in Oakland, Alameda County, California (Site). Quarterly reporting is being submitted to the Alameda County Environmental Health Services Agency (ACEH) consistent with their requirements under the legal authority of the California Regional Water Quality Control Board, as codified by California Code of Regulations Title 23, Section 2652(d). A summary description of current developments regarding the site is provided below.

Facility Name / Address:	Former Station No. 472 / 6415 International Boulevard, Oakland
Client Project Manager / Title:	Mr. Chuck Carmel / RM Operations Project Manager
Broadbent Contact:	Kristene Tidwell, P.G., C.Hg., (707) 455-7290
Broadbent Project No.:	09-88-601
Primary Regulatory Agency / ID No.:	ACEH, Case #RO0002982
Current phase of project:	Case Closure Evaluation
List of Acronyms / Abbreviations:	See end of report text for list of acronyms/abbreviations used in report.

WORK PERFORMED THIS QUARTER (Third Quarter 2014)

1. Submitted *Second Quarter 2014 Status Report* on July 30, 2014.
2. No environmental field work was conducted at Former Station No. 472 during the Third Quarter 2014 due to the pending case closure request.

WORK SCHEDULED FOR NEXT QUARTER (Fourth Quarter 2014):

1. Submit *Third Quarter 2014 Status Report* (contained herein).
2. After the public comment period ends on October 21, 2014, carryout well decommissioning activities upon approval of the *Additional Well Survey Information and Case Closure Request Addendum* by the ACEH.

DISCUSSION:

On May 1, 2014 Broadbent submitted an *Additional Well Survey Information and Case Closure Request Addendum*. This Well Survey Closure Addendum was prepared in response to a letter issued by the ACEH dated April 25, 2014 (ACEH Letter). This letter provided comments on the most recent Previous CCR Addendum, and which indicated that the Site would meet the criteria for case closure based on the Low Threat Underground Storage Tank Case Closure Policy, provided additional well survey information was submitted. It is anticipated that comments and/or closure approval will be received during the fourth quarter 2014, upon approval of case closure request well decommissioning activities would be carried out. The public comment period ends October 21, 2014.

ATTACHMENT:

- Drawing 1: Site Location Map
Drawing 2: Groundwater Elevation and Analytical Summary Map, September 4, 2013

LIST OF COMMONLY USED ACCRONYMS/ABBREVIATIONS:

ACEH:	Alameda County Environmental Health	ft/ft:	feet per foot
ACPWA:	Alameda County Public Works Agency	gal:	Gallons
BTEX:	Benzene, Toluene, Ethylbenzene, Total Xylenes	GRO:	Gasoline-Range Organics
1,2-DCA:	1,2-Dichloroethane	LNAPL:	Light Non-Aqueous Phase Liquid
DIPE:	Di-Isopropyl Ether	MTBE:	Methyl Tertiary Butyl Ether
DO:	Dissolved Oxygen	NO ₃ :	Nitrate as Nitrogen
DRO:	Diesel-Range Organics	ppb:	parts per billion
EDB:	1,2-Dibromomethane	SO ₄ :	Sulfate
Eh:	Oxidation Reduction Potential	TAME:	Tert-Amyl Methyl Ether
EPA:	Environmental Protection Agency	TBA:	Tertiary Butyl Ether
ETBE:	Ethyl Tertiary Butyl Ether	TOC:	Top of Casing
Fe ²⁺ :	Ferrous Iron	µg/L:	micrograms per liter

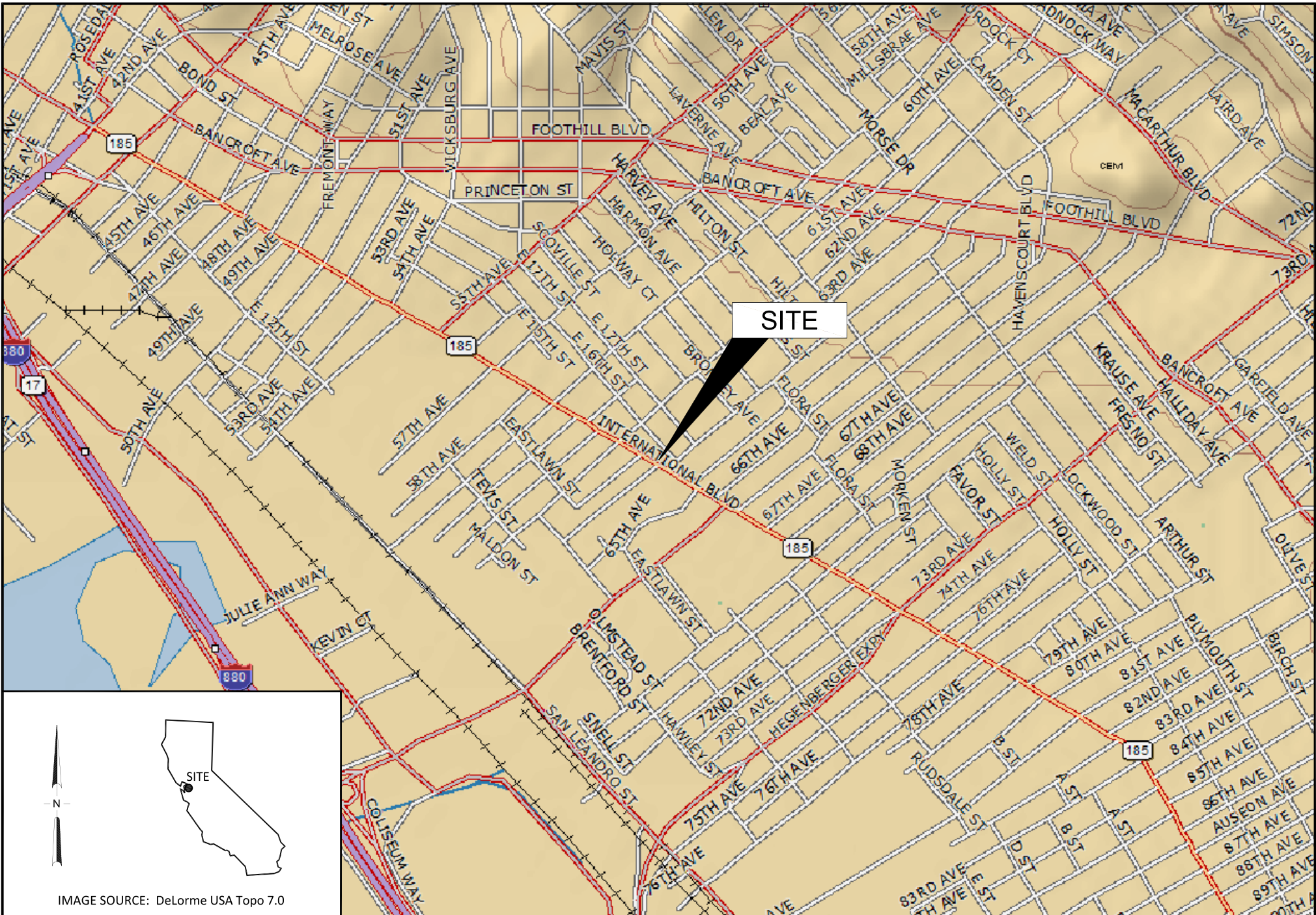

SITE

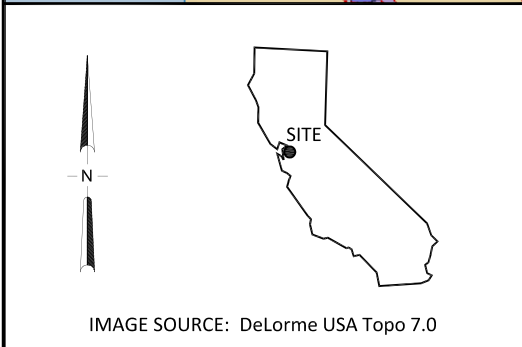
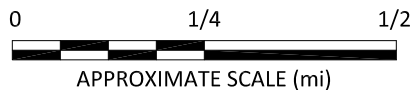

IMAGE SOURCE: DeLorme USA Topo 7.0



BROADBENT
 1370 Ridgewood Dr., Suite 5
 Chico, California 95973
 Project No.: 09-88-601 Date: 4/2/2013

Former Station #472
 6415 International Boulevard
 Oakland, California

Site Location Map

Drawing
1

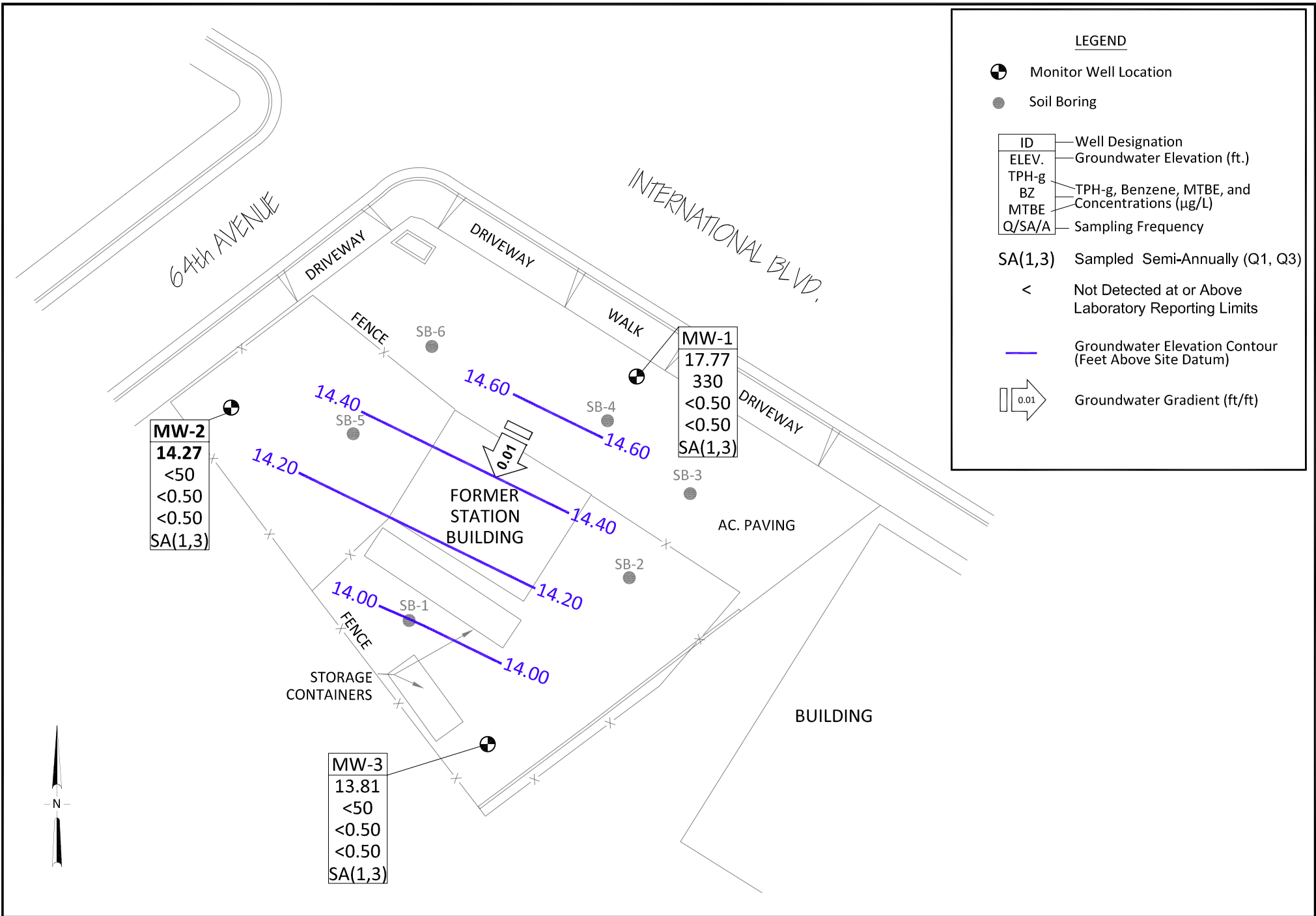

MW-2
 14.27
 <50
 <0.50
 <0.50
 SA(1,3)

MW-1
 17.77
 330
 <0.50
 <0.50
 SA(1,3)

MW-3
 13.81
 <50
 <0.50
 <0.50
 SA(1,3)

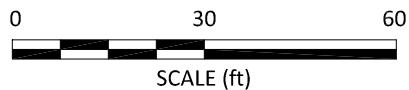

875 Cotting Lane, Suite G
 Vacaville, California 95688
 Project No.: 09-88-601 Date: 10/01/2013

ARCO Former Station No 472
 6415 International Boulevard
 Oakland, California

Groundwater Elevation and
 Analytical Summary Map
 September 4, 2013