

RECEIVED

By Alameda County Environmental Health at 4:17 pm, Jan 24, 2014

Atlantic Richfield Company

Chuck Carmel
Remediation Management Project Manager

PO Box 1257
San Ramon, CA 94583
Phone: (925) 275-3804
Fax: (925) 275-3815
E-Mail: chuck.carmel@bp.com

January 24, 2014

Re: Fourth Quarter 2013 Status Report
Former Richfield Oil Company Station No. 472
6415 International Boulevard, Oakland, California
ACEH Case #RO0002982

I declare that to the best of my knowledge at the present time, that the information and/or recommendations contained in the attached document are true and correct.

Submitted by,



Chuck Carmel
Remediation Management Project Manager

Attachment



BROADBENT

875 Cotting Ln., Suite G, Vacaville, CA 95688

[T] 707-455-7290 [F] 707-455-7295

broadbentinc.com

CREATING SOLUTIONS. BUILDING TRUST.

January 24, 2014

Project No. 09-88-601

Atlantic Richfield Company
P.O. Box 1257
San Ramon, CA 94583
Submitted via ENFOS

Attn.: Mr. Chuck Carmel

Re: Fourth Quarter 2013 Status Report, Former Richfield Oil Company Station No. 472,
6415 International Boulevard, Oakland, California; ACEH Case #RO0002982

Dear Mr. Carmel

Attached is the Fourth Quarter 2013 Status Report for Former Richfield Oil Company Station No. 472 located at 6415 International Boulevard, Oakland, California. This report presents a summary of current developments at the Site through the Fourth Quarter of 2013.

Should you have questions regarding this submittal, please do not hesitate to contact me at (707) 455-7290.

Sincerely,

BROADBENT & ASSOCIATES, INC.

Kristene Tidwell, P.G., C.Hg.
Senior Geologist

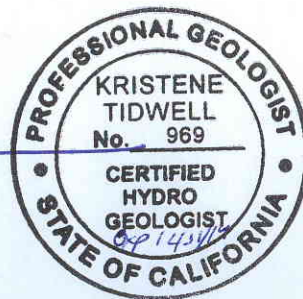

Enclosures

cc: Mr. Keith Nowell, Alameda County Environmental Health (submitted via ACEH ftp site)
Mr. Mahmud Ghanem, 6207 International Boulevard, Oakland, California 94621
Electronic copy uploaded to GeoTracker

**FOURTH QUARTER 2013
STATUS REPORT
FORMER STATION No. 472, OAKLAND, CALIFORNIA**

Broadbent & Associates, Inc. (Broadbent) is pleased to present this *Fourth Quarter 2013 Status Report* on behalf of Atlantic Richfield Company (a BP affiliated company) for Former Richfield Oil Company Station No. 472 located in Oakland, Alameda County, Californian(Site). Quarterly reporting is being submitted to the Alameda County Environmental Health Services Agency (ACEH) consistent with their requirements under the legal authority of the California Regional Water Quality Control Board, as codified by California Code of Regulations Title 23, Section 2652(d). A summary description of current developments regarding the site is provided below.

Facility Name / Address:	Former Station No. 472 / 6415 International Boulevard, Oakland
Client Project Manager / Title:	Mr. Chuck Carmel / RM Operations Project Manager
Broadbent Contact:	Kristene Tidwell, P.G., C.Hg., (707) 455-7290
Broadbent Project No.:	09-88-601
Primary Regulatory Agency / ID No.:	ACEH, Case #RO0002982
Current phase of project:	Case Closure Evaluation
List of Acronyms / Abbreviations:	See end of report text for list of acronyms/abbreviations used in report.

WORK PERFORMED THIS QUARTER (Fourth Quarter 2013)

1. Submitted *Third Quarter 2013 Monitoring Report* on October 31, 2013.
2. Submitted a *Conceptual Site Model and Case Closure Request Addendum* on October 8, 2013.
3. No environmental field work was conducted at Former Station No. 472 during the Fourth Quarter 2013.

WORK SCHEDULED FOR NEXT QUARTER (First Quarter 2014):

1. Submit *Fourth Quarter 2013 Status Report* (contained herein).
2. Perform and report upon additional well survey activities per ACEH request and evaluate if Closure is warranted based on the well survey data.

DISCUSSION:

In 2013 Broadbent submitted a Case Closure Request and Addendum to the Case Closure Request (submitted June 19, 2013 and October 8, 2013; respectively). The ACEH initially suggested that this site would be closed, but has recently requested that a well search with the ACPWA be conducted due to a small potential that the low concentrations of GRO in groundwater may be undefined in a periodic downgradient direction. The well search is intended to evaluate if further groundwater definition in this direction is needed based on proximity to any private wells, distance of the potential wells from the impacted monitoring well, and calculations of how far the plume may have travelled in that direction. It is anticipated that these activities will be completed during the first quarter 2014.

ATTACHMENT:

Drawing 1: Site Location Map

LIST OF COMMONLY USED ACCRONYMS/ABBREVIATIONS:

ACEH:	Alameda County Environmental Health	ft/ft:	feet per foot
ACPWA:	Alameda County Public Works Agency	gal:	Gallons
BTEX:	Benzene, Toluene, Ethylbenzene, Total Xylenes	GRO:	Gasoline-Range Organics
1,2-DCA:	1,2-Dichloroethane	LNAPL:	Light Non-Aqueous Phase Liquid
DIPE:	Di-Isopropyl Ether	MTBE:	Methyl Tertiary Butyl Ether
DO:	Dissolved Oxygen	NO ₃ :	Nitrate as Nitrogen
DRO:	Diesel-Range Organics	ppb:	parts per billion
EDB:	1,2-Dibromomethane	SO ₄ :	Sulfate
Eh:	Oxidation Reduction Potential	TAME:	Tert-Amyl Methyl Ether
EPA:	Environmental Protection Agency	TBA:	Tertiary Butyl Ether
ETBE:	Ethyl Tertiary Butyl Ether	TOC:	Top of Casing
Fe ²⁺ :	Ferrous Iron	µg/L:	micrograms per liter

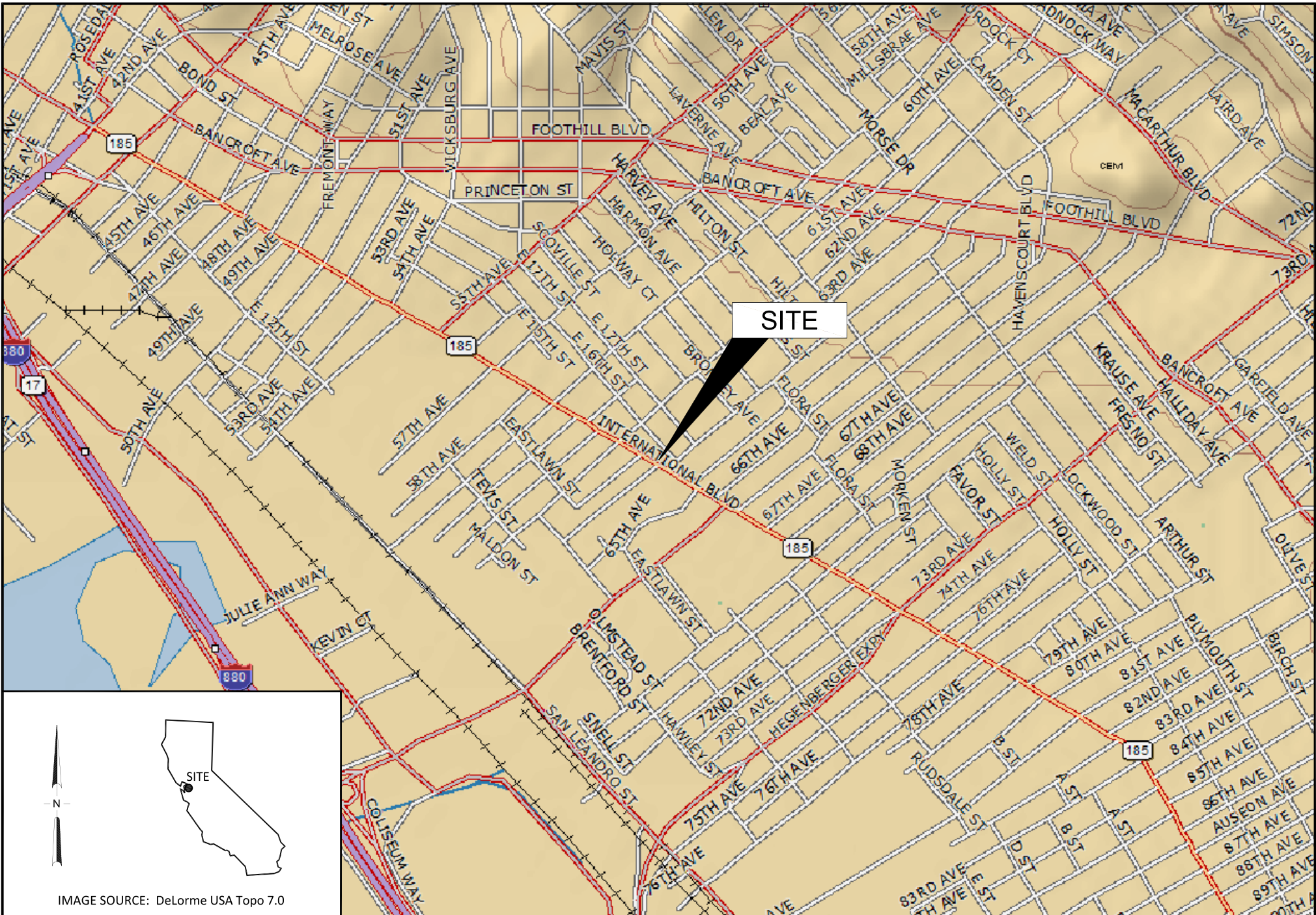

SITE

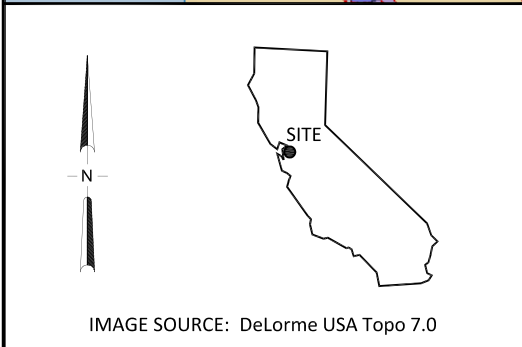
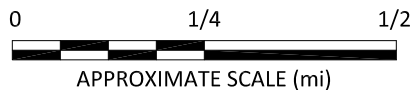

IMAGE SOURCE: DeLorme USA Topo 7.0



BROADBENT
 1370 Ridgewood Dr., Suite 5
 Chico, California 95973
 Project No.: 09-88-601 Date: 4/2/2013

Former Station #472
 6415 International Boulevard
 Oakland, California

Site Location Map

Drawing
1

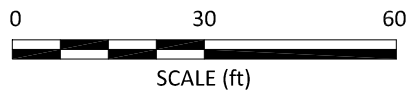
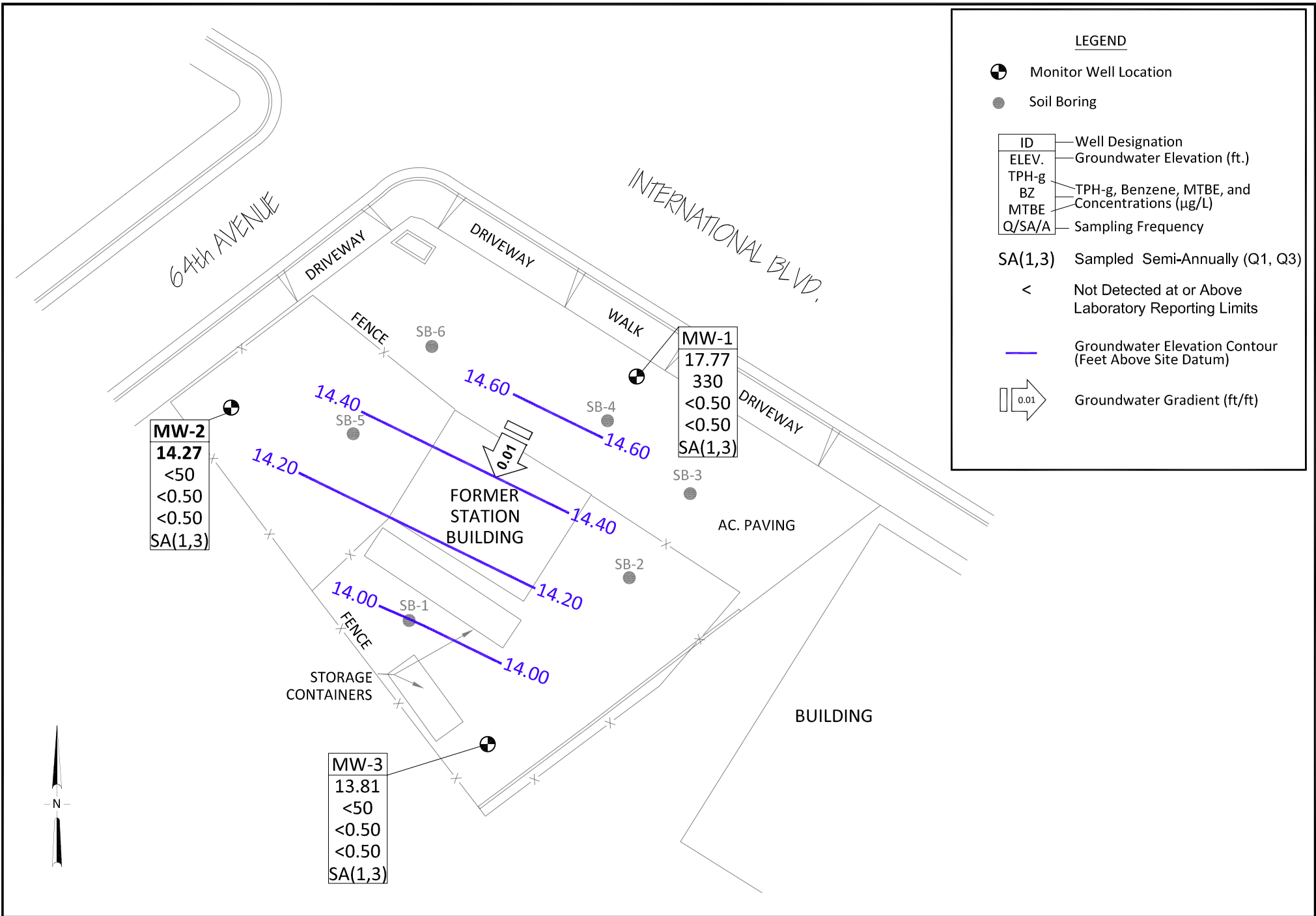

Project No.: 09-88-601 Date: 10/01/2013

ARCO Former Station No 472
 6415 International Boulevard
 Oakland, California

Groundwater Elevation and Analytical Summary Map
 September 4, 2013

Drawing

2