

ALAMEDA COUNTY  
**HEALTH CARE SERVICES**  
AGENCY

REBECCA GEBHART, Interim Director



DEPARTMENT OF ENVIRONMENTAL HEALTH  
LOCAL OVERSIGHT PROGRAM (LOP) FOR  
HAZARDOUS MATERIALS RELEASES  
1131 HARBOR BAY PARKWAY  
ALAMEDA, CA 94502  
(510) 567-6700  
FAX (510) 337-9335

April 20, 2017

George Kong

(Sent via electronic mail to: [gkongwashworld@comcast.net](mailto:gkongwashworld@comcast.net))

Subject: Site Cleanup Program Case RO0002981 and GeoTracker Global ID T10000000416, Red Hanger Kleaners, 6235-6239 College Avenue, Oakland, California

Dear Responsible Party:

Alameda County Department of Environmental Health (ACDEH) is providing regulatory oversight of the investigation and cleanup of the subject site due to releases of volatile organic chemicals to the subsurface from the former Red Hanger Kleaners (RHK) located at 6235-6239 College Avenue in Oakland operated by you and the Gordon Family. Investigations completed to date have not fully delineated the extent of impact to soil, soil vapor and groundwater. The locations of soil, groundwater and soil vapor contamination ("hot spots") relative to the location of the former RHK at 6235-6239 College Avenue is shown on **Attachment 1 – Site Map**.

Since at least 1991, the City of Oakland Fire Department and ACDEH recognized S.R. Gordon, CEO of Red Hanger Kleaners, Inc, Ila Gordon, and Ila Gordon Trust as responsible parties (RPs) for the investigation and remediation of contamination resulting from dry cleaning releases and operating practices of the RHK business. Ron Elvidge and College Claremont Venture, LLC were added as RPs after acquiring ownership of the parcel located at 6235-6239 College Avenue.

A summary of historic property ownership and dry cleaner operations at 6235-6239 College Avenue is provided below.

- **Property Ownership.** Review of Alameda County Assessor Office records indicates that the Gordon Family owned the parcel addressed as 6235-6239 College Avenue (Assessor Parcel No. 48A-7069-9-1) since at least 1986. Property ownership was transferred to College Claremont Venture LLC in 2005. **Attachment 2** includes a copies of the Assessor's Office ownership records and parcel map.
- **Historic Dry Cleaner Operations.** In 1986 the Gordon Family moved their dry cleaning business from 6251-6255 College Avenue into the building at 6235-6239 College Avenue and continued operating RHK at this address until 2005. Site inspection records for RHK during operation by the Gordon Family shows a history of poor housekeeping, incomplete record keeping, and insufficient care with respect to management of hazardous wastes and chemicals. In particular, waste materials were stored in exterior areas and inspector notes suggest concern of storm water discharge due to oil drippings and spilled waste dry cleaning chemicals. **Attachment 3** includes selected agency inspection records dated in 1987, 1991 and 1994. The Gordon Family operated RHK at 6235-6239 College Avenue until 2005 when the business was sold to you.

Records indicate that you operated RHK at 6235-6239 College Avenue until at least 2014 when the dry cleaning machines using tetrachloroethylene (PCE) were removed. Agency site inspections in 2014 during operation of RHK by you also indicate poor housekeeping and insufficient care with respect to management of hazardous wastes and chemicals. In particular, drums of waste materials were stored in exterior areas with an accumulation start date of December 2009, and a possible PCE still in addition to two dry cleaning machines containing PCE were observed within the dry cleaning suite in although reportedly idle for two years. Additionally, during a site agency site visit you indicated that there had been a history of "flooding" at the dry cleaning machines even though secondary containment was in place. The dry cleaning machines utilizing PCE were removed from the site by the end of September 2014. **Attachment 4** includes selected agency correspondence dated in 2014.

### **Meeting Request**

ACDEH is requiring further investigation of the dry cleaner release to facilitate the delineation of impacts and evaluation of additional source areas. Your full cooperation and participation in these continued investigations and future remedial efforts is required.

We would like to meet with you within the next two weeks to discuss the next phase of investigation and coordination with the other RPs. Please provide us with several dates and times that you are available for this meeting. Additionally, please provide your contact information including mailing address and phone number in your response correspondence.

Should you have any questions, please contact me at (510) 567--6764 or send me an electronic mail message at [keith.nowell@acgov.org](mailto:keith.nowell@acgov.org).

Sincerely,

Keith Nowell, PG, CHG  
Hazardous Materials Specialist

#### Attachments:

Attachment 1 – Site Map

Attachment 2 – Assessor's Records for 6235-6239 College Avenue

Attachment 3 – Agency Inspection Records for Red Hanger Kleaners, 6235-6239 College Avenue

Attachment 4 – ACDEH Correspondence for 6235-6239 College Avenue

cc: Ronald Elvidge, College Claremont Venture LLC, 1345 Grand Ave., Piedmont, CA 94610 (*Sent via electronic mail to: [ronpatelvidge@gmail.com](mailto:ronpatelvidge@gmail.com)*)

Todd Borst, Trustee, Ila Lynn Gordon Investment Trust, 2305 Little Ben, Lincoln, CA 95648

Ila Lynn Gordon, Trustee of SIRILA Living Trust, Ila Lynn Gordon Investment, Trust of Gordon Family Trust, 554 Red Arrow Trail, Palm Desert, CA 92211

Ila Lynn Gordon, Trustee of SIRILA Living Trust, Ila Lynn Gordon Investment, Trust of Gordon Family Trust, 827 Mesa Grande Drive, Palm Desert, CA 92211

Ila Lynn Gordon, Trustee of SIRILA Living Trust, Ila Lynn Gordon Investment, Trust of Gordon Family Trust, PO Box 13214, Palm Desert, CA 92255

Brian J. Gordon, PO Box 13214, Palm desert, CA 92255

David B. Gordon, 9 Calle, San Clemente, CA 92673

Jonathan W. Redding, Wendel, Rosen, Black & Dean LLP, 1111 Broadway, 24th Floor, Oakland, CA 94607 (*Sent via electronic mail to [jredding@wendel.com](mailto:jredding@wendel.com)*)

Dilan Roe, ACDEH, (*Sent via electronic mail to [dilan.roe@acgov.org](mailto:dilan.roe@acgov.org)*)

Paresh Khatri, ACDEH, (*Sent via electronic mail to [paresh.khatri@acgov.org](mailto:paresh.khatri@acgov.org)*)

Keith Nowell, ACDEH, (*Sent via electronic mail to [keith.nowell@acgov.org](mailto:keith.nowell@acgov.org)*)

Geotracker, Electronic File

**ATTACHMENT 1**  
**SITE MAP**

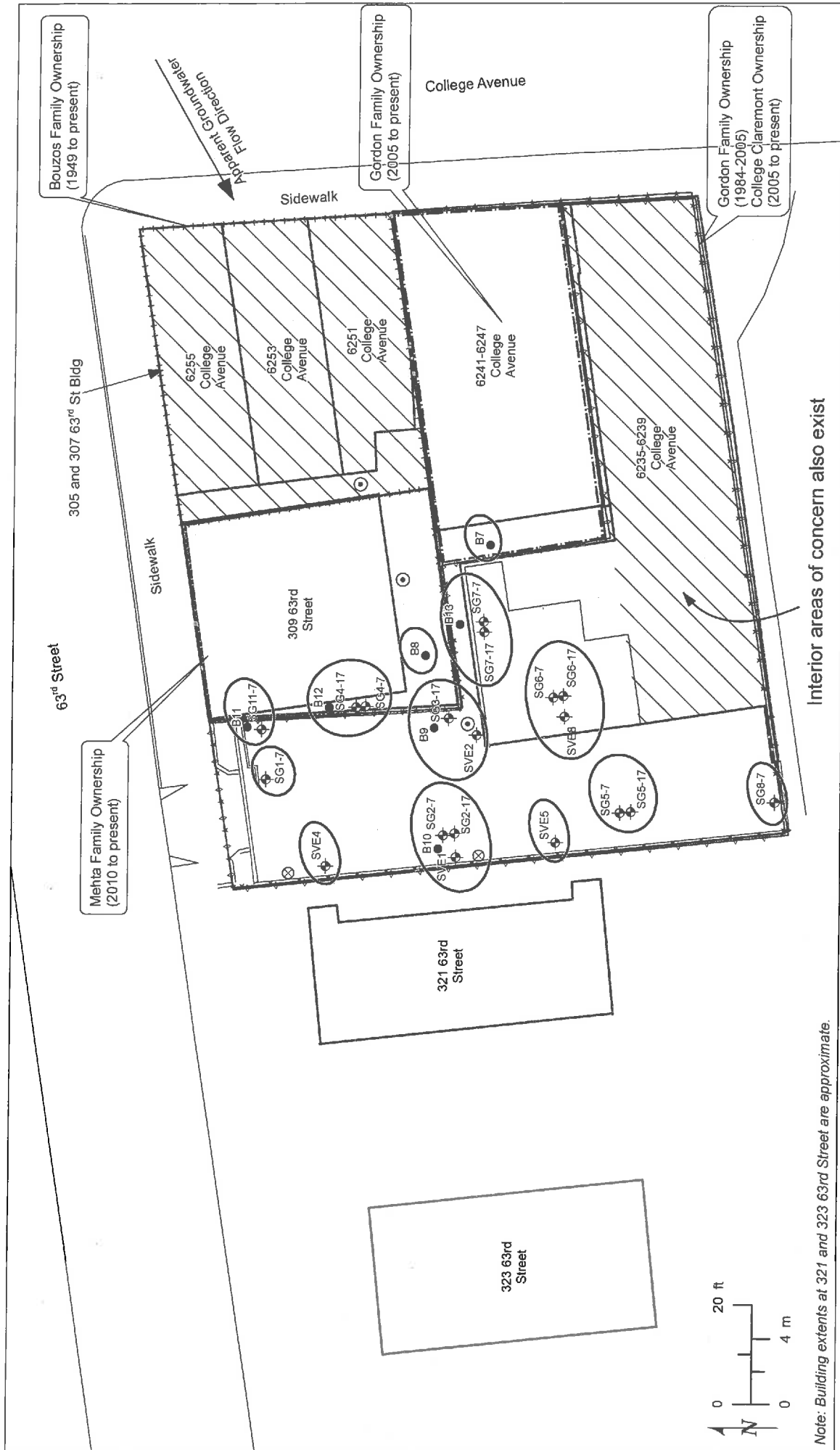

**Data Location Map for  
Bouzos and Gordon Parcels**

Interior areas of concern also exist

**ATTACHMENT 2**  
**ASSESSOR'S RECORDS**  
**6235 – 6239 COLLEGE AVENUE**



COUNTY OF ALAMEDA  
**Assessor's Office**

[Help](#)

[New Query](#)

**Property Value System**

[History](#) | [Value](#) | [Transfer](#) | [Map](#) | [Glossary](#)

Parcel Number: **48A-7069-9-1** Inactive: **N** Lien Date: **01/01/2016** Owner: **COLLEGE CLAREMONT VENTURE LLC**  
 Property Address: **6235 COLLEGE AVE, OAKLAND, CA 94618**  
[Parcel History](#)

| Mailing Name                  |                             | Historical Mailing Address                     | Document Date | Document Number | Value From Trans Tax | Parcel Count | Use         |
|-------------------------------|-----------------------------|--|---------------|-----------------|----------------------|--------------|-------------|
| COLLEGE CLAREMONT VENTURE LLC | <a href="#">List Owners</a> | 1345 GRAND AVE ,<br>PIEDMONT, CA 94610-1000    | 08/05/2005    | 2005-335814     | \$3,160,000          | 1            | <u>3200</u> |
| BORST TODD TR                 | <a href="#">List Owners</a> | 300 HARDING BLVD # 114,<br>ROSEVILLE, CA 95678 | 08/05/2005    | 2005-335813     |                      | 1            | <u>3200</u> |
| GORDON ILA L TR               | <a href="#">List Owners</a> | PO BOX 1131 ,<br>LAFAYETTE, CA 94549-1131      | 02/21/1986    | 1986-45844      |                      | 2            | <u>3200</u> |

All information on this site is to be assumed accurate for property assessment purposes only, and is based upon the Assessor's knowledge of each property. Caution is advised for use other than its intended purpose.

The Alameda County Intranet site is best viewed in Internet Explorer Version 5.5 or later.  
 Click [here](#) for more information regarding supported browsers.

Copyright © 2001 Alameda County

ASSESSOR'S MAP 48A

Santa Fe Tract No. 6. (Bk. 20 P. 10)

Code Area Nos. 17-003  
13-000

Claremont Avenue Tract. Revised. (Bk. 13 P. 13)

Scale 1 in = 40 ft.

Rev. 12, 20, 24, 26, 28, 30, 32, 34, 36, 38, 40, 42, 44, 46, 48, 50, 52, 54, 56, 58, 60, 62, 64, 66, 68, 70, 72, 74, 76, 78, 80, 82, 84, 86, 88, 90, 92, 94, 96, 98, 100

7069

BOOK 15

1409

BERKELEY 1409

13-000  
SOUTH LINE OF BERKELEY ANNEX OF AUGUST 1906  
17-003

Avenue.



7070

63<sup>RD</sup>

Street.

N. 4° 33' W

BOOK 15

1408

College

Claremont Avenue.

7071

62<sup>RD</sup>

Street

Florio St.

1407

1267



**Parcel History:**

Formerly :     48A-7069-5  
                  48A-7069-8-1  
                  48A-7069-9

[Close Window](#)



COUNTY OF ALAMEDA  
**Assessor's Office**  
**Property Value System**

[Help](#)

[New Query](#)

[History](#)

[Value](#)

[Transfer](#)

[Map](#)

[Glossary](#)

Parcel Number: **48A-7069-5**    Inactive: **Y**    Lien Date: **01/01/2016**    Owner: **GORDON SIEBERT R & ILA L**

Property Address: **63RD ST, OAKLAND, CA 94603**

[Parcel History](#)

| Mailing Name             |                             | Historical Mailing Address             | Document Date | Document Number | Value From Trans Tax | Parcel Count | Use         |
|--------------------------|-----------------------------|--|---------------|-----------------|----------------------|--------------|-------------|
| GORDON SIEBERT R & ILA L | <a href="#">List Owners</a> | PO BOX 1131 , LAFAYETTE, CA 94549-1131 | 04/06/1984    | 1984-67277      |                      | <u>4</u>     | <u>8100</u> |
| KRUSE EDW H ETAL         | <a href="#">List Owners</a> | 63RD ST , OAKLAND, CA 94603            | 03/01/1969    | TRAN-53575      |                      | 1            | <u>8100</u> |
| KRUSE EDWARD H ETAL      | <a href="#">List Owners</a> | PO BOX 2567 , BERKELEY, CA 94702-0567  | 12/29/1950    | AE-116986       |                      | <u>2</u>     | <u>8100</u> |

All information on this site is to be assumed accurate for property assessment purposes only, and is based upon the

Assessor's knowledge of each property. Caution is advised for use other than its intended purpose.

The Alameda County Intranet site is best viewed in Internet Explorer Version 5.5 or later.  
 Click [here](#) for more information regarding supported browsers.

Copyright © 2001 Alameda County



COUNTY OF ALAMEDA  
**Assessor's Office**  
Property Value System

[Help](#)

[New Query](#)

[History](#)

[Value](#)

[Transfer](#)

[Map](#)

[Glossary](#)

Parcel Number: **48A-7069-8-1** Inactive: **Y** Lien Date: **01/01/2016** Owner: **GORDON ILA L TR**

Property Address: **6235 COLLEGE AVE, OAKLAND, CA 94618-1329**

[Parcel History](#)

| Mailing Name | Historical Mailing Address | Document Date | Document Number | Value From Trans Tax | Parcel Use Count |
|--------------|----------------------------|---------------|-----------------|----------------------|------------------|
|--------------|----------------------------|---------------|-----------------|----------------------|------------------|

All information on this site is to be assumed accurate for property assessment purposes only, and is based upon the Assessor's knowledge of each property. Caution is advised for use other than its intended purpose.

The Alameda County Intranet site is best viewed in Internet Explorer Version 5.5 or later. Click [here](#) for more information regarding supported browsers.

Copyright © 2001 Alameda County

**Parcel History:**

Formerly : 48A-7069-8

Now : 48A-7069-9-1

[Close Window](#)



COUNTY OF ALAMEDA  
**Assessor's Office**  
**Property Value System**

[Help](#)

[New Query](#)

[History](#) | [Value](#) | [Transfer](#) | [Map](#) | [Glossary](#)

Parcel Number: **48A-7069-8** Inactive: **Y** Lien Date: **01/01/2016** Owner: **GORDON SIEBERT R & ILA L**  
 Property Address: **6247 COLLEGE AVE, OAKLAND, CA 94618-1329**

[Parcel History](#)

| Mailing Name             |                             | Historical Mailing Address                | Document Date | Document Number | Value From Trans Tax | Parcel Count | Use  |
|--------------------------|-----------------------------|---|---------------|-----------------|----------------------|--------------|------|
| GORDON SIEBERT R & ILA L | <a href="#">List Owners</a> | PO BOX 1131 , LAFAYETTE, CA 94549-1131    | 04/06/1984    | 1984-67277      |                      | 4            | 3200 |
| KRUSE EDW H ETAL         | <a href="#">List Owners</a> | 6247 COLLEGE AVE , OAKLAND, CA 94618-1329 | 03/01/1969    | TRAN-53577      |                      | 1            | 3200 |
| KRUSE EDWARD H ETAL      | <a href="#">List Owners</a> | PO BOX 2567 , BERKELEY, CA 94702-0567     | 12/29/1950    | AE-116986       |                      | 2            | 3200 |

All information on this site is to be assumed accurate for property assessment purposes only, and is based upon the

Assessor's knowledge of each property. Caution is advised for use other than its intended purpose.

The Alameda County Intranet site is best viewed in Internet Explorer Version 5.5 or later.  
 Click [here](#) for more information regarding supported browsers.

Copyright © 2001 Alameda County



COUNTY OF ALAMEDA  
**Assessor's Office**  
**Property Value System**

[Help](#)

[New Query](#)

[History](#)   [Value](#)   [Transfer](#)   [Map](#)   [Glossary](#)

Parcel Number: **48A-7069-9**   Inactive: **Y**   Lien Date: **01/01/2016**   Owner: **GORDON SIEBERT R & ILA L**  
 Property Address: **6235 COLLEGE AVE, OAKLAND, CA 94618-1329**

Parcel History

| Mailing Name             |                             | Historical Mailing Address                | Document Date | Document Number | Value From Trans Tax | Parcel Count | Use  |
|--------------------------|-----------------------------|---|---------------|-----------------|----------------------|--------------|------|
| GORDON SIEBERT R & ILA L | <a href="#">List Owners</a> | PO BOX 1131 , LAFAYETTE, CA 94549-1131    | 04/06/1984    | 1984-67277      |                      | 4            | 3000 |
| KRUSE EDWARD H & DAVID J | <a href="#">List Owners</a> | PO BOX 2567 , BERKELEY, CA 94702-0567     | 04/06/1984    | 1984-67276      |                      | 1            | 3000 |
| KRUSE L J CO             | <a href="#">List Owners</a> | 6235 COLLEGE AVE , OAKLAND, CA 94618-1329 | 03/01/1969    | TRAN-53578      |                      | 1            | 3000 |
| KRUSE L J CO             | <a href="#">List Owners</a> | PO BOX 2567 , BERKELEY, CA 94702-0567     | 04/01/1955    | AK-35824        |                      | 1            | 3000 |

All information on this site is to be assumed accurate for property assessment purposes only, and is based upon the

Assessor's knowledge of each property. Caution is advised for use other than its intended purpose.

The Alameda County Intranet site is best viewed in Internet Explorer Version 5.5 or later.  
 Click [here](#) for more information regarding supported browsers.

Copyright © 2001 Alameda County

**ATTACHMENT 3**  
**AGENCY INSPECTION RECORDS**  
**RED HANGER KLEANERS**  
**6235 – 6239 COLLEGE**

COMPLAINT REPORT FORM  
(Use ball-point pen.)

*Story File*

Is this an emergency? Yes  No  If yes, call the Office of Emergency Services (OES): 800-852-7550

Log Number: 020910051 Date Complaint Received: 9/26/91 Time: 1020 Received By: Matt McLaggon

Notifications made (Yes/No) Prop. 65 \_\_\_\_\_ Local agency \_\_\_\_\_ Who? \_\_\_\_\_

| INFORMANT   | ALLEGED RESPONSIBLE PARTY                           |
|---|---|
| Name: <u>Elaine Kelly</u>   | Name: <u>Burt Gordon</u>                            |
| Address: _____  | Firm: <u>Red Hanger Cleaners</u>                    |
| City: _____ Zip: _____  | Address: <u>6239 College</u>                        |
| Phone: ( ) <u>530-9311 (T-TR) only</u>  | City: <u>OAKLAND</u> Zip: <u>94619</u>              |
| <input checked="" type="checkbox"/> Confidential OR <input checked="" type="checkbox"/> Anonymous: (Check one.) | County Code*: <u>1</u> Phone: <u>(510) 654-1740</u> |

COMPLAINT DATA

Date of Incident: on going Allegation Code\*: B Quantity: 4 Drums

Type/Condition of Containers Visible: (2) 55 gallon (2) smaller drums

Source of Complaint/Code\*: D If Code A, Specify: \_\_\_\_\_

Response Code \*: R Region/Agency Referred To: Alameda Co Env. Health

Other Comments: Drums stored for at least 2 years, possibly P.C.P. in parking lot in backside of building. There are hazardous waste labels on the drums. ~~After~~ The informant wishes to remain anonymous but is willing to answer any other ~~good~~ questions. She works up stairs from the dry cleaners for the past 2 years, and has noticed the drums since she was there.

Response Date: \_\_\_\_\_ Investigator: \_\_\_\_\_ Date Assigned: \_\_\_\_\_

Note: Information to be transferred to complaint log is highlighted in bold italic print. Attach an addendum if necessary.

\* See code on reverse side

Original—Regional Office

*JMK 9/30*

Duplicate—Log

Triplicate—Investigations



COMPLAINT REPORT FORM  
(Use ball-point pen.)

File

Matt McCann

Is this an emergency? Yes  No  If yes, call the Office of Emergency Services (OES): 800-852-7550

Log Number: 020910051 Date Complaint Received: 9/25/91 Time: 1020 Received By: Matt McCann

Notifications made (Yes/No) Prop. 65 \_\_\_\_\_ Local agency \_\_\_\_\_ Who? 540-3739

| INFORMANT   | ALLEGED RESPONSIBLE PARTY                           |
|---|---|
| Name: <u>Elaine Kelly</u>   | Name: <u>Quint Gordon</u>                           |
| Address: _____  | Firm: <u>Red Hanger Cleaners</u>                    |
| City: _____   | Address: <u>6239 College</u>                        |
| Phone: <u>(510) 237-0314 (7-TR)</u>   | City: <u>OAKLAND</u> zip: <u>94618</u>              |
| <input checked="" type="checkbox"/> Confidential OR <input checked="" type="checkbox"/> Anonymous: (Check one.) | County Code*: <u>1</u> Phone: <u>(510) 654-1740</u> |

COMPLAINT DATA

Date of Incident: in 70's Allegation Code\*: A Quantity: 4 drums

Type/Condition of Containers Visible: (1) 55 gallon (2) smaller drums

Source of Complaint/Code\*: D If Code A, Specify: \_\_\_\_\_

Response Code\*: R Region/Agency Referred to: Alameda Co Env Health

Other Comments: Drums stored for at least 2 years, possibly PCB in parking lot in backside of building. There are Raybestos waste cables on the drums. The informant wishes to remain anonymous but is willing to answer any other general questions. She works up stairs from the dry cleaners for the past 2 years, and has visited the drums since she was there.

10-25-91 Inspection of site was performed. Their records on the site reveals they dispose of their waste approx. every 6 weeks. They use Technichem

Response Date: 10-25-91 Investigator: Carry Solo Date Assigned: \_\_\_\_\_

Note: Information to be transferred to complaint log is highlighted in bold italic print. Attach an addendum if necessary.

\* See code on reverse side

Original—Regional Office

Duplicate—Log

Triplicate—Investigations



Alameda County Urban Runoff Clean Water Program

A Consortium of Local Agencies

Municipality: Oakland

Agency Conducting Inspection: Alameda County (HM)

Inspector: Ruel M. Magallanes / Brad Lea

*4894  
Bm*

Date of inspection: 3-17-94

Date of last inspection: \_\_\_\_\_

Facility ID #: 1539

Standard Industrial and Commercial Business Inspection Checklist A

**I. Background Information** (as reported by Facility Contact)

|   |  |   |  |
|---|--|---|--|
| 1. Name of Facility: <u>Red Hanger Cleaners</u>   |  | 2. ACURID#:   |  |
| 3. Starting Date of Business:   |  | 4. Business Owner: <u>Robert Fiorden</u>                  |  |
| 5. Facility Contact (include title): <u>David Fiorden</u>   |  | 6. Phone No. of Contact: <u>654-1740</u>                  |  |
| 7. Site Address: <u>2239 College Ave, Oakland 94618</u>   |  |   |  |
| 8. Mailing Address: <u>P.O. Box 1131, Lafayette, CA 94549-113</u>   |  |   |  |
| 9. Property Owner (if different from Business Owner): <u>SRILA Living Trust</u>   |  | 10. Phone No. of Property Owner: <u>436-3633</u>          |  |
| 11. Mailing Address for Property Owner: <u>P.O. Box 1131, Lafayette 94545</u>   |  |   |  |
| 12. Business Type: <u>Dry Cleaner</u>   |  | 13. Standard Industrial Classification Codes: <u>7216</u> |  |
| 14. Does facility have Spill Prevention Plans?      yes <input checked="" type="checkbox"/> no <input type="checkbox"/>   |  |   |  |
| 15. Is facility covered under a NPDES permit to discharge storm water?    general <input type="checkbox"/> individual <input type="checkbox"/> none <input checked="" type="checkbox"/>   |  |   |  |
| 16. Is facility covered under any other permits?<br>none <input type="checkbox"/> air quality <input checked="" type="checkbox"/> sanitary sewer <input type="checkbox"/> underground storage tanks <input type="checkbox"/>                                      |  |   |  |
| 17. Operating Schedule: Continues throughout year <input checked="" type="checkbox"/> Seasonal <input type="checkbox"/> (circle the months that the facility is in operation)    Jan    Feb    Mar    Apr    May    Jun    Jul    Aug    Sep    Oct    Nov    Dec |  |   |  |

**II. Monitoring** (as reported by Facility Contact)

Is storm water sampled?    yes     no     If yes, indicate sampling locations on facility layout.

|                                    |                       |                                       |
|------------------------------------|-----------------------|---------------------------------------|
| Sampling method:                   | Sample monitoring:    | Parameters tested for:                |
| grab <input type="checkbox"/>      | last sampling date    | pH <input type="checkbox"/>           |
| composite <input type="checkbox"/> | frequency of sampling | oil & grease <input type="checkbox"/> |
| other                              |                       | conductivity <input type="checkbox"/> |
|                                    |                       | TOC <input type="checkbox"/>          |
|                                    |                       | TSS <input type="checkbox"/>          |
|                                    |                       | bioassay <input type="checkbox"/>     |
|                                    |                       | other                                 |

**III. Facility Layout**

Attach map(s) that identify and describe locations of storm drains/inlets, outdoor/indoor (storm and sewer) drains, storm water conveyance structures, storage areas, unit process areas, vehicle and heavy equipment wash and maintenance areas, and storm water sampling locations. If facility operator cannot provide an existing map, include a sketch on page 6.

See Attachment A for sample facility map.

Facility Name: Red Hanger Cleaners Fac ID#: 1539  
 Date: 3/7/94

Standard Inspection Checklist A

| IV. Outdoor Material Storage Areas   | <u>Waste Rec</u>                        | Not Applicable <input type="checkbox"/> |
|--|---|---|
| 1. How are outdoor storage areas cleaned swept <input type="checkbox"/> wiped <input type="checkbox"/> absorbent material <input type="checkbox"/> other: _____  |   |   |
| 2. How often are outdoor storage areas cleaned? <u>once per week</u>   |   |   |
| 3. Are materials stored in specified areas?  | yes <input checked="" type="checkbox"/> | no <input type="checkbox"/>             |
| 4. Are storage containers (including drums) inspected regularly for cracks and leaks?  | yes <input checked="" type="checkbox"/> | no <input type="checkbox"/>             |
| 5. Are storage containers (including drums) free of cracks/leaks?  | yes <input checked="" type="checkbox"/> | no <input type="checkbox"/>             |
| 6. Are the covers/lids of containers kept closed or are containers not exposed to rainwater?   | yes <input checked="" type="checkbox"/> | no <input type="checkbox"/>             |
| 7. If storage containers are cleaned, describe how wash water and/or the residual material is disposed.<br>_____   |   |   |
| 8. Is the surface of the storage area paved and impermeable? yes <input checked="" type="checkbox"/> no <input type="checkbox"/>   |   |   |
| 9. Where do surface drains in this area discharge? no drains <input type="checkbox"/> storm drains <input checked="" type="checkbox"/> sanitary <input type="checkbox"/> unknown <input type="checkbox"/>                    |   |   |
| 10. Is the outdoor storage area covered and unexposed to rainwater? yes <input checked="" type="checkbox"/> no <input type="checkbox"/>  |   |   |
| 11. Has the potential for storm water runoff or runoff from the storage areas been eliminated? yes <input type="checkbox"/> no <input checked="" type="checkbox"/>   |   |   |
| 12. Is the ground surface free of any stains or other signs of pollutants? yes <input type="checkbox"/> no <input checked="" type="checkbox"/>   |   |   |
| 13. Describe best management practices (BMPs) used to prevent materials from outdoor storage areas from contacting storm water and discharging to storm drains.<br>_____   |   |   |
| V. Waste Disposal Areas and Practices  | <u>Dumpster</u>                         | Not Applicable <input type="checkbox"/> |
| 1. Are the lids on any waste dumpsters and/or trash compactors onsite kept closed? yes <input checked="" type="checkbox"/> no <input type="checkbox"/>   |   |   |
| 2. Are dumpsters and/or trash compactors inspected regularly for cracks/leaks? yes <input type="checkbox"/> no <input checked="" type="checkbox"/>   |   |   |
| 3. Are dumpsters and/or trash compactors free of cracks/leaks? yes <input type="checkbox"/> no <input checked="" type="checkbox"/>   |   |   |
| 4. Is the area free of litter? yes <input type="checkbox"/> no <input checked="" type="checkbox"/>   |   |   |
| 5. Where do drains discharge? no drains <input type="checkbox"/> storm drains <input checked="" type="checkbox"/> sanitary <input type="checkbox"/> unknown <input type="checkbox"/>   |   |   |
| 6. Is waste storage area enclosed or covered from rainfall? yes <input type="checkbox"/> no <input checked="" type="checkbox"/>  |   |   |
| 7. Has the potential for storm water runoff or runoff from the waste disposal areas been eliminated? yes <input type="checkbox"/> no <input checked="" type="checkbox"/>   |   |   |
| 8. Is the floor/ground surface free of any stains or other signs of pollutants on the floor? yes <input type="checkbox"/> no <input checked="" type="checkbox"/>   |   |   |
| 9. Describe BMPs used to prevent pollutants from waste disposal areas from contacting storm water and discharging to storm drains.<br><u>Garbage other than cardboard are in plastic bins prior to dumping into dumpster</u> |   |   |

Facility Name: Red Hanger Cleaners Fac ID# 1539  
 Date: 3-17-94

Standard Inspection Checklist A

|   |  |  |
|---|--|--|
| <b>VI. Vehicle and Heavy Equipment Storage and Maintenance Areas</b>  |  | Not Applicable <input type="checkbox"/>  |
| <b>A. Parking Areas and Access Roads</b> <span style="float: right;"><u>Parking Area</u></span>   |  |  |
| 1. Are vehicles and/or heavy equipment parked onsite?   |  | yes <input checked="" type="checkbox"/> no <input type="checkbox"/>            |
| 2. How often are parking areas cleaned?   | <u>Once per week</u>   |  |
| 3. Describe method for cleaning parking areas.  | <u>area swept</u>  |  |
| 4. Where do drains in parking areas discharge?  | no drains <input type="checkbox"/> storm drains <input checked="" type="checkbox"/> sanitary <input type="checkbox"/> unknown <input type="checkbox"/>                       |  |
| 5. Are parking areas covered or enclosed?   |  | yes <input checked="" type="checkbox"/> no <input checked="" type="checkbox"/> |
| 6. Are parking areas or access roads free of any sign of past spills?   |  | yes <input type="checkbox"/> no <input checked="" type="checkbox"/>            |
| 7. Are parking areas or access roads free of signs of excessive leaking from oil and/or motor fluids?   |  | yes <input type="checkbox"/> no <input checked="" type="checkbox"/>            |
| <b>B. Vehicle and Heavy Equipment Repair and Maintenance Areas</b> <span style="float: right;"><u>N/A</u></span>  |  | Not Applicable <input checked="" type="checkbox"/>                             |
| 1. Where do drains in repair and maintenance areas discharge?   | no drains <input type="checkbox"/> storm drains <input type="checkbox"/> sanitary <input type="checkbox"/> unknown <input type="checkbox"/>                                  |  |
| 2. Are repair and maintenance activity areas onsite enclosed or covered and unexposed to rainwater?   |  | yes <input type="checkbox"/> no <input type="checkbox"/>                       |
| 3. Has the potential for storm water runoff from repair/maintenance areas been eliminated?  |  | yes <input type="checkbox"/> no <input type="checkbox"/>                       |
| 4. Is the floor/ground surface of repair/maintenance area free of any stains or other signs of pollutants?  |  | yes <input type="checkbox"/> no <input type="checkbox"/>                       |
| <b>C. Vehicle and Heavy Equipment Wash Areas</b> <span style="float: right;"><u>N/A</u></span>  |  | Not Applicable <input type="checkbox"/>  |
| 1. Where do drains in wash areas discharge?   | no drain <input type="checkbox"/> recycled <input type="checkbox"/> storm drains <input type="checkbox"/> sanitary <input type="checkbox"/> unknown <input type="checkbox"/> |  |
| 2. Is wash area covered or enclosed and unexposed to rainwater?   |  | yes <input type="checkbox"/> no <input type="checkbox"/>                       |
| 3. Has the potential for storm water runoff from the wash area been eliminated?   |  | yes <input type="checkbox"/> no <input type="checkbox"/>                       |
| 4. Is the floor of the wash area free of any stains or other signs of pollutants?   |  | yes <input type="checkbox"/> no <input type="checkbox"/>                       |
| 5. Describe BMP's used to minimize the discharge of pollutants from access roads and vehicle and heavy equipment parking, repair, maintenance, and wash areas to storm water.     | <br><br>   |  |
| <b>VII. Rooftop Equipment</b> <span style="float: right;"><u>Cooling tower (not exposed)</u></span>   |  | Not Applicable <input type="checkbox"/>  |
| Describe the potential for pollutants from rooftop equipment to be exposed to storm water runoff (e.g. condensation, exhaust gas, emissions, exposed motors/pumps, etc.).<br><br> |  |  |

Facility Name: Red Hanger Cleaner Fac ID# 1539  
 Date: 3-17-91

Standard Inspection Checklist A

VIII. Storm Water Conveyance System and Spill Response/Prevention Practices Not Applicable

1. How often are storm drain inlets (including catch basins) inspected, maintained, and/or cleaned?  
When required / Puffed 3x month
2. Describe method of cleaning. vacuum  flush with water  other: Shovel
3. Describe any testing for illicit connections to the storm drain system conducted by the facility (e.g. visual inspection, dye tests, etc.).  
None
4. If there are any other areas onsite that may be exposed to storm water (e.g. process and/or work areas, indoor storage areas, materials handling areas, etc.), fill out appropriate section of Attachment B.  
 all areas of the facility have been described  see Attachment B for further information
5. Briefly describe BMPs taken to prevent spills from entering the storm drain system and methods for clean-up should a spill occur.  
None / Absorbent used

IX. Significant Materials (Materials that may have potential to be released with storm water discharges)

Estimate degree of material exposure to storm water using Code: 0 - None

- 1 - Little Potential for exposure to storm water
- 2 - Some potential for exposure to storm water
- 3 - Great potential for exposure to storm water

|   | (Code)    | Describe Materials if appropriate:         |
|---|-----------|--|
| Raw Materials used in processing or production                                  | <u>0</u>  | <u>None</u>                                |
| Finished Materials  | <u>0</u>  |  |
| Hazardous Substances  | <u>2L</u> | <u>oil drippings / spilled waste prod.</u> |
| Metals (especially copper, lead, zinc) solids (e.g. metal scraps) and solutions | <u>0</u>  |  |
| Waste Products  | <u>1L</u> | <u>sitter from dumpster / Coal / Scar.</u> |
| Other   | <u>0</u>  |  |

Standard Inspection Checklist A

X. Conclusions (to be completed by the Inspector)

1. For each area of activity, indicate a numerical code to describe the level of potential discharge to the storm drains AND a letter code to describe the type of potential discharge found.

Level of Potential Discharge:

- 0 - not applicable for facility
- 1 - little potential for pollutant discharge to storm drains
- 2 - some potential for pollutant discharge to storm drains
- 3 - great potential for pollutant discharge to storm drains

Type of Potential Discharge:

- A - illicit connection
- B - where drain discharges unknown
- C - activity area and/or material exposed to storm water
- D - other (please specify)

Areas of Activity:

Outdoor Material Storage Areas 2C

Waste Disposal Areas 1C

Rooftop Equipment 0

Vehicle and Heavy Equipment Storage and Maintenance Areas

parking areas and access roads 0

repair and maintenance areas 2C

wash areas 0

Other Areas: 0

- 2. Is a General Permit required?      yes       no       questionable\*   
\*need clarification from Regional Water Quality Control Board whether permit is required.
- 3. Does the facility have a Storm Water Pollution Prevention Plan (SWPPP)?      yes       no
- 4. Did the inspector use facility's SWPPP during the inspection?      yes       no
- 5. Describe outreach performed by inspector to promote the Alameda County Urban Runoff Clean Water Program.

- general ACURCWP brochure       industrial brochure
- verbal       BMP handouts (describe below)  *Industrial*
- Informed facility that General Permit may be necessary       Other (describe below)

6. Follow-up Activities:      None       Warning Notice   
    Informal Violation       Formal Violation

If a violation was identified, indicate date of follow-up inspection if scheduled: \_\_\_\_\_

no follow-up inspection necessary       follow-up inspection to be scheduled at a later date

7. Time to perform inspection: 2 hours

Recommended actions:

- (1) clean up dumpster area.
- (2) provide cap/plug for dumpster, stop leaks
- (3) clean debris (plant material) around Hazardous waste area.

Comments: (4) provide berm around Hazardous waste container or other method as to contain leakage.  
 (5) oil dripping to be clean up quickly as to prevent seepage to concrete. Do not water wash -

Facility Representative Signature: [Signature]

Date: 3-17-94

Print Facility Rep. Name: \_\_\_\_\_

Inspector's Signature: Paul Neregil

736-3633

**ATTACHMENT 4**  
**ACDEH CORRESPONDENCE**  
**6235 – 6239 COLLEGE AVENUE**

Jan 2, 2014

## Nowell, Keith, Env. Health

---

**To:** elvidge@sbcglobal.net  
**Cc:** patrick@ellwoodcommercial.com; dcs@youngdahl.net; gkongwashworld@comcast.net; Gary\_Bates@efiglobal.com; Roe, Dilan, Env. Health; lgriffin@oaklandnet.com  
**Subject:** Red Hanger Cleaners - RO2981  
**Attachments:** PercMachandTrap.jpg; HazWasteStorage.jpg; BoilerRmStill.jpg

Dear Mr. Elvidge,

Thank you for the opportunity for Alameda County Environmental Health (ACEH) staff to visit the site today and meet with Patrick Ellwood of Ellwood Commercial Real Estate, David Sederquist consultant with YoungDahl Consulting Group, Inc. (consultant), and Gordon Kong, the business owner. The on-site meeting proved beneficial to view the current configuration of the dry cleaning establishment, look for evidence of prior locations of equipment, and discuss potential sampling locations for the upcoming soil gas and sub-slab vapor intrusion study.

During the site visit two dry cleaning machines were observed within secondary containment traps near the rear of the building. We understand the traps were installed in 2005 in conjunction with the acquisition of the business by Mr. Kong from Mr. Gordon. According to Gordon Kong, the two machines, formerly used for cleaning using tetrachloroethylene ("perc"), have sat idle for two years as the use of perc in the industry has been phased out. Mr. Kong indicated these machines will be removed and replaced with newer, non-perc, dry cleaning machines sometime in the future. A spotting station for fabric pretreatment and press machines were observed near the middle of the dry cleaning suite and a possible perc still was noted in the far corner of the boiler room. Additionally, locations were observed in areas where the concrete floor was exposed that could be indicative of previous equipment locations. These interior areas will be considered for targeted sampling.

Lidded containers, including two 55-gallon drums labeled *waste tetrachloroethylene* and identified as consisting of *dry cleaning filters, residue, and/or other perc contaminated wastes*, were observed stored on a pallet in an outdoor area behind the suite. The accumulation start date on one of the drums was identified as 12/15/09. Accompanying the drums on the pallet were several 5-gallon pails. Dried liquid was observed on the sides of some of these containers. Though the pallet was situated over secondary containment, this exterior area will be considered for targeted sampling.

The integrity of the secondary containment at the site is unknown and the capacity questionable due to reported historic "flooding" at the perc machines.

Based on the outcome of the underground utility survey, the consultant will provide a figure presenting the proposed locations for the collection of soil gas and sub-slab vapor samples for review and approval by ACEH prior to mobilization. The consultant is proposing one mobilization with the collection of samples from ten locations. ACEH notes that based on the conditions described above, additional mobilizations may be required to characterize the site.

Attached are a few photographs taken during today's site visit. Should you have any questions regarding this correspondence or your case, please call me at (510) 567-6764 or send an electronic mail message at [keith.nowell@acgov.org](mailto:keith.nowell@acgov.org).

Regards,

Keith Nowell

Keith Nowell PG, CHG  
Hazardous Materials Specialist  
Alameda County Environmental Health  
1131 Harbor Bay Parkway  
Alameda, CA 94502-6540  
phone: 510 / 567 - 6764  
fax: 510 / 337 - 9335  
email: [keith.nowell@acgov.org](mailto:keith.nowell@acgov.org)

PDF copies of case files can be reviewed/downloaded at:



Jan. 17, 2014

## Nowell, Keith, Env. Health

---

**To:** elvidge@sbcglobal.net  
**Cc:** dcs@youngdahl.net; patrick@ellwoodcommercial.com; Gary\_Bates@efiglobal.com; gkongwashworld@comcast.net; lgriffin@oaklandnet.com; SSkillern@oaklandnet.com; Roe, Dilan, Env. Health  
**Subject:** Red Hanger Cleaners, RO2981, 6335-6339 College Ave, Oakland

Dear Mr. Elvidge,

Alameda County Environmental Health (ACEH) is working with you, as the property owner, and Mr. Kong, the business owner, to schedule an on-site meeting with the Oakland Fire Department (CUPA unit) to discuss removal of the PCE dry cleaning machines at Red Hanger Cleaners, ACEH case file RO0002981. ACEH believes it is prudent to have the meeting with the Oakland CUPA prior to finalizing the proposed sub-slab and soil gas sampling locations.

Based on a recent discussion with Dr. Blayne Hartman regarding vapor cloud contamination at dry cleaner sites, ACEH is concerned about the potential for contamination to have occurred through this mechanism due to the poor condition of the machines, potential for PCE to still be in the machines, and the reported "flooding" that has occurred in the past. Therefore ACEH would like to revisit the proposed sampling locations with your consultant after the site visit with the Oakland CUPA and a determination of when the machines will be removed.

If Oakland CUPA does not respond within the next two business days the investigation should be postponed.

Regards,  
Keith Nowell

Keith Nowell PG, CHG  
Hazardous Materials Specialist  
Alameda County Environmental Health  
1131 Harbor Bay Parkway  
Alameda, CA 94502-6540  
phone: 510 / 567 - 6764  
fax: 510 / 337 - 9335  
email: [keith.nowell@acgov.org](mailto:keith.nowell@acgov.org)

PDF copies of case files can be reviewed/downloaded at:

<http://www.acgov.org/aceh/top/ust.htm>

---

**From:** David Sederquist [mailto:[dcs@youngdahl.net](mailto:dcs@youngdahl.net)]  
**Sent:** Wednesday, January 15, 2014 8:01 AM  
**To:** Nowell, Keith, Env. Health  
**Subject:** Sampling Plan for Red Hanger Kleaners

Good morning Keith:

On Monday we sent you a sampling plan showing proposed soil gas and subslab locations for Red Hanger Kleaners. Once you approve it, I can get the drilling permit. I have TEG scheduled for January 27<sup>th</sup>, but if there is going to be much more delay, we may have to push the date back. Do you have an estimate on when we will know?

Thank you,

**David C. Sederquist, C.E.G., C.H.G.**  
*Senior Engineering Geologist / Hydrogeologist*

**Youngdahl Consulting Group, Inc.**  
1234 Glenhaven Court, El Dorado Hills, CA 95762  
Office: (916) 933.0633 Fax: (916) 933.6482

**Electronic Documents (if attached):**

*\*\*By accepting and using the attached documents the user (Client or any person or entity) agrees that all documents and information provided by Youngdahl Consulting Group, Inc. in an electronic format are for information purposes only and not as final documentation. Only the signed paper prints constitute our professional work product, and because the electronic documents are subject to undetectable alteration, the signed paper prints must be referred to for the original and correct information\*\**



This email is free from viruses and malware because avast! Antivirus protection is active.

Aug 18, 2014

---

**From:** Nowell, Keith, Env. Health  
**Sent:** Monday, August 18, 2014 10:08 AM  
**To:** 'gkongwashworld@comcast.net'  
**Cc:** 'mosleyservice@gmail.com'; 'Patrick Ellwood (patrick@ellwoodcommercial.com)'; Roe, Dilan, Env. Health  
**Subject:** RE: RO2981 - Red Hanger Cleaners, 6335-6339 College Ave., Oakland

George,

Alameda County Environmental Health (ACEH) has requested to be informed of when the perc machines are to be drained and removed. Other than being informed the work may have commenced, ACEH has not received information the work is proceeding or information regarding the schedule of events. During a visit to the site on Thursday, August 12, I learned that one of the machines and it's secondary containment appears to have been removed without notification to ACEH.

This facility is an open and active case in the Site Cleanup Program (SCP) overseen by ACEH. Please keep ACEH informed of the schedule for the equipment removal so a representative of ACEH is present when the machines/product lines are drained of residual fluid and when the secondary containment is removed.

Thank you for your cooperation.  
Keith Nowell

Keith Nowell PG, CHG  
Hazardous Materials Specialist  
Alameda County Environmental Health  
1131 Harbor Bay Parkway  
Alameda, CA 94502-6540  
phone: 510 / 567 - 6764  
fax: 510 / 337 - 9335  
email: [keith.nowell@acgov.org](mailto:keith.nowell@acgov.org)

PDF copies of case files can be reviewed/downloaded at:

<http://www.acgov.org/aceh/top/ust.htm>

**From:** Nowell, Keith, Env. Health  
**Sent:** Wednesday, August 06, 2014 10:15 AM  
**To:** gkongwashworld@comcast.net  
**Cc:** mosleyservice@gmail.com; Patrick Ellwood (patrick@ellwoodcommercial.com); Roe, Dilan, Env. Health  
**Subject:** FW: RO2981 - Red Hanger Cleaners, 6335-6339 College Ave., Oakland  
**Importance:** High

George,

Please keep me informed of the schedule for the equipment removal as I would like to be there when the machines/product lines are drained of residual fluid. I also wish to be present when the secondary containment is removed.

Regards,  
Keith Nowell

Keith Nowell PG, CHG  
Hazardous Materials Specialist  
Alameda County Environmental Health  
1131 Harbor Bay Parkway  
Alameda , CA 94502-6540  
phone: 510 / 567 - 6764  
fax: 510 / 337 - 9335  
email: [keith.nowell@acgov.org](mailto:keith.nowell@acgov.org)

PDF copies of case files can be reviewed/downloaded at:

<http://www.acgov.org/aceh/lop/ust.htm>

**From:** Nowell, Keith, Env. Health  
**Sent:** Wednesday, April 09, 2014 3:00 PM  
**To:** 'James Mosley'  
**Cc:** Roe, Dilan, Env. Health  
**Subject:** RE: RO2981 - Red Hanger Cleaners, 6335-6339 College Ave., Oakland

James,

Thanks for the update. I would like to be there when the machines/product lines are drained of residual fluid. I also wish to be present when the secondary containment is removed. Please make sure I am informed as to when these events will occur.

Regards,  
Keith Nowell

Keith Nowell PG, CHG  
Hazardous Materials Specialist  
Alameda County Environmental Health  
1131 Harbor Bay Parkway  
Alameda , CA 94502-6540  
phone: 510 / 567 - 6764  
fax: 510 / 337 - 9335  
email: [keith.nowell@acgov.org](mailto:keith.nowell@acgov.org)

PDF copies of case files can be reviewed/downloaded at:

<http://www.acgov.org/aceh/lop/ust.htm>

---

**From:** James Mosley [<mailto:mosleyservice@gmail.com>]  
**Sent:** Wednesday, April 09, 2014 11:34 AM  
**To:** Nowell, Keith, Env. Health  
**Cc:** Skillern, Sheryl; Roe, Dilan, Env. Health  
**Subject:** Re: RO2981 - Red Hanger Cleaners, 6335-6339 College Ave., Oakland

Hello:

We are overwhelmed with emergency calls at this time. We will need to postpone the machine removal in a later time. We will keep you posted of when we can schedule the date again.

Thanks.

James

---

James Mosley Equipment Sales  
4032 E 15th Street  
Oakland CA 94601  
CA Lic. # 988188

Cell: 510-691-4707  
Tel: 510-533-8899  
Fax: 510-394-1931

On Fri, Jan 24, 2014 at 3:30 PM, Nowell, Keith, Env. Health <[Keith.Nowell@acgov.org](mailto:Keith.Nowell@acgov.org)> wrote:

Dear Ms. Skillern and Mr. Mosley,

Thank you for participating in the on-site meeting held at Red Hanger Cleaners today. You were a great help with Alameda County Environmental Health's understanding of the activities at the site. We look forward to continuing to work with you as the case moves forward.

Respectfully,

Keith Nowell

Keith Nowell PG, CHG

Hazardous Materials Specialist

Alameda County Environmental Health

1131 Harbor Bay Parkway

Alameda , CA 94502-6540

phone: 510 / 567 - 6764

fax: 510 / 337 - 9335

email: [keith.nowell@acgov.org](mailto:keith.nowell@acgov.org)

PDF copies of case files can be reviewed/downloaded at:

<http://www.acgov.org/aceh/lop/ust.htm>



---

**From:** Nowell, Keith, Env. Health  
**Sent:** Thursday, September 11, 2014 3:43 PM  
**To:** gkongwashworld@comcast.net  
**Cc:** Roe, Dilan, Env. Health  
**Subject:** SCP case ro2981- Red Hanger Cleaners, 6335-6339 College Ave. Oakland

George,

I was unable to rearrange my schedule on such short notice. Alameda County Environmental Health (ACEH) is disappointed with the notifications to our office regarding this case. Please be reminded that this facility is an open and active case in the Site Cleanup Program (SCP) overseen by ACEH. The lack of ACEH oversight during the equipment decommissioning and removal may affect future investigations conducted at your facility.

Please contact ACEH with the status of the of the removal and a description of what has been done. Please do not proceed with additional work until ACEH can be present on site. I am available to meet you at the site on Monday September 15, 2014 between the hours of 9:30 AM and 3:00 PM. Please inform me if you wish me to visit the site when you provide your case status of the of the removal and description of what has been done.

Regards,  
Keith Nowell

Keith Nowell PG, CHG  
Hazardous Materials Specialist  
Alameda County Environmental Health  
1131 Harbor Bay Parkway  
Alameda , CA 94502-6540  
phone: 510 / 567 - 6764  
fax: 510 / 337 - 9335  
email: keith.nowell@acgov.org

PDF copies of case files can be reviewed/downloaded at:

<http://www.acgov.org/aceh/top/ust.htm>

---

**From:** Nowell, Keith, Env. Health  
**Sent:** Monday, September 29, 2014 8:43 AM  
**To:** 'Patrick Ellwood'; George Kong  
**Cc:** mosleyservice@gmail.com; Roe, Dilan, Env. Health; Bates, Gary; Ron Elvidge; Roe, Dilan, Env. Health  
**Subject:** RE: SCP case ro2981- Red Hanger Cleaners, 6335-6339 College Ave. Oakland

Patrick,

I observed the removal and transport off-site of the one remaining dry cleaning machine. It had previously been disconnected from piping, emptied of residual fluid, and the secondary containment removed.

Keith Nowell

Keith Nowell PG, CHG

Hazardous Materials Specialist  
Alameda County Environmental Health  
1131 Harbor Bay Parkway  
Alameda, CA 94502-6540  
phone: 510 / 567 - 6764  
fax: 510 / 337 - 9335  
email: keith.nowell@acgov.org

PDF copies of case files can be reviewed/downloaded at:

<http://www.acgov.org/aceh/top/ust.htm>

**From:** Patrick Ellwood [mailto:patrick@ellwoodcommercial.com]  
**Sent:** Friday, September 26, 2014 11:50 AM  
**To:** Nowell, Keith, Env. Health; George Kong  
**Cc:** mosleyservice@gmail.com; Roe, Dilan, Env. Health; Bates, Gary; Ron Elvidge  
**Subject:** RE: SCP case ro2981- Red Hanger Cleaners, 6335-6339 College Ave. Oakland

Keith: How did your on-site inspection go yesterday?

Thanks!

Patrick Ellwood  
Ellwood Commercial Real Estate  
510-238-9111 tel  
510-238-9131 fax  
[patrick@ellwoodcommercial.com](mailto:patrick@ellwoodcommercial.com)



DRE License #00471233

**From:** Nowell, Keith, Env. Health [mailto:[Keith.Nowell@acgov.org](mailto:Keith.Nowell@acgov.org)]  
**Sent:** Monday, September 22, 2014 8:44 AM  
**To:** 'George Kong'  
**Cc:** [mosleyservice@gmail.com](mailto:mosleyservice@gmail.com); <[patrick@ellwoodcommercial.com](mailto:patrick@ellwoodcommercial.com)>; Roe, Dilan, Env. Health  
**Subject:** RE: SCP case ro2981- Red Hanger Cleaners, 6335-6339 College Ave. Oakland

George,

My schedule is open that day. I'll be there.

Regards,  
Keith Nowell

**From:** George Kong [mailto:[gkongwashworld@comcast.net](mailto:gkongwashworld@comcast.net)]  
**Sent:** Saturday, September 20, 2014 8:47 AM  
**To:** Nowell, Keith, Env. Health  
**Cc:** [mosleyservice@gmail.com](mailto:mosleyservice@gmail.com); <[patrick@ellwoodcommercial.com](mailto:patrick@ellwoodcommercial.com)>  
**Subject:** Re: SCP case ro2981- Red Hanger Cleaners, 6335-6339 College Ave. Oakland

Hi Keith...James wants to know if Thursday 9/25 at 10am works for you?

Please confirm on Monday. Thanks

Sent from my iPhone

On Sep 11, 2014, at 3:42 PM, "Nowell, Keith, Env. Health" <[Keith.Nowell@acgov.org](mailto:Keith.Nowell@acgov.org)> wrote:

George,

I was unable to rearrange my schedule on such short notice. Alameda County Environmental Health (ACEH) is disappointed with the notifications to our office regarding this case. Please be reminded that this facility is an open and active case in the Site Cleanup Program (SCP) overseen by ACEH. The lack of ACEH oversight during the equipment decommissioning and removal may affect future investigations conducted at your facility.

Please contact ACEH with the status of the of the removal and a description of what has been done. Please do not proceed with additional work until ACEH can be present on site. I am available to meet you at the site on Monday September 15, 2014 between the hours of 9:30 AM and 3:00 PM. Please inform me if you wish me to visit the site when you provide your case status of the of the removal and description of what has been done.

Regards,  
Keith Nowell

Keith Nowell PG, CHG  
Hazardous Materials Specialist  
Alameda County Environmental Health

1131 Harbor Bay Parkway  
Alameda , CA 94502-6540  
phone: 510 / 567 - 6764  
fax: 510 / 337 - 9335  
email: [keith.nowell@acgov.org](mailto:keith.nowell@acgov.org)

PDF copies of case files can be reviewed/downloaded at:

<http://www.acgov.org/aceh/lop/ust.htm>