



**CONESTOGA-ROVERS  
& ASSOCIATES**

5900 Hollis Street, Suite A  
Emeryville, California 94608  
Telephone: (510) 420-0700 Fax: (510) 420-9170  
www.CRAworld.com

## TRANSMITTAL

DATE: December 5, 2011 REFERENCE NO.: 060204  
PROJECT NAME: 2301-2307 Lincoln Avenue, Alameda  
TO: Jerry Wickham  
Alameda County Environmental Health  
1131 Harbor Bay Parkway, Suite 250  
Alameda, California 94502-6577

**RECEIVED**  
  
*8:42 am, Dec 06, 2011*  
  
Alameda County  
Environmental Health

Please find enclosed:  Draft  Final  
 Originals  Other  
 Prints

Sent via:  Mail  Same Day Courier  
 Overnight Courier  Other GeoTracker and Alameda County FTP

QUANTITY	DESCRIPTION
1	Monitoring Well and Soil Vapor Probe Destruction Report

As Requested  For Review and Comment  
 For Your Use  \_\_\_\_\_  
 \_\_\_\_\_

**COMMENTS:**

If you have any questions regarding the contents of this document, please call Peter Schaefer at (510) 420-3319.

Copy to: Denis Brown, Shell Oil Products US (electronic copy)  
Alan A. and Beverly M. Sebanc, Trustees, 2805 Ralston Avenue, Hillsborough, CA 94010  
Jake Torrens, AMEC Geomatrix, Inc., 2101 Webster Street, 12<sup>th</sup> Floor, Oakland, CA 94612

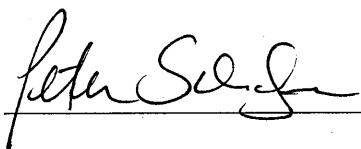
Completed by: Peter Schaefer Signed: 

Filing: **Correspondence File**



Mr. Jerry Wickham  
Alameda County Environmental Health  
1131 Harbor Bay Parkway, Suite 250  
Alameda, CA 94502-6577

**Denis L. Brown**  
**Shell Oil Products US**  
HSE – Environmental Services  
20945 S. Wilmington Ave.  
Carson, CA 90810-1039  
Tel (707) 865 0251  
Fax (707) 865 2542  
Email [denis.l.brown@shell.com](mailto:denis.l.brown@shell.com)

Subject: 2301-2307 Lincoln Avenue  
Alameda, California  
SAP Code 165255  
Incident No. 97767044  
Agency No. RO0002971

Dear Mr. Wickham,

The attached document is provided for your review and comment. Upon information and belief, I declare, under penalty of perjury, that the information contained in the attached document is true and correct.

As always, please feel free to contact me directly at (707) 865-0251 with any questions or concerns.

Sincerely,

A handwritten signature in cursive script, appearing to read "Denis L. Brown", is written over a horizontal line.

Denis L. Brown  
Senior Program Manager



## **MONITORING WELL AND SOIL VAPOR PROBE DESTRUCTION REPORT**

**FORMER SHELL SERVICE STATION  
2301-2307 LINCOLN AVENUE  
ALAMEDA, CALIFORNIA**

**SAP CODE           165255  
INCIDENT NO.    97767044  
AGENCY NO.      RO0002971**

**DECEMBER 5, 2011  
REF. NO. 060204 (22)**

This report is printed on recycled paper.

**Prepared by:  
Conestoga-Rovers  
& Associates**

5900 Hollis Street, Suite A  
Emeryville, California  
U.S.A. 94608

Office: (510) 420-0700  
Fax: (510) 420-9170

web: <http://www.CRAworld.com>

TABLE OF CONTENTS

	<u>Page</u>
1.0 INTRODUCTION.....	1
2.0 WELL DESTRUCTION.....	1
2.1 FIELD DATE.....	1
2.2 PERSONNEL PRESENT .....	1
2.3 DESTRUCTION METHOD .....	1
2.4 WASTE DISPOSAL.....	1

LIST OF FIGURES  
(Following Text)

FIGURE 1 VICINITY MAP

FIGURE 2 SITE PLAN

LIST OF APPENDICES

APPENDIX A PERMIT

## 1.0 INTRODUCTION

Conestoga-Rovers & Associates (CRA) prepared this report on behalf of Equilon Enterprises LLC dba Shell Oil Products US (Shell) to document the recent well destructions at the referenced site.

The wells were properly destroyed as requested in Alameda County Environmental Health's (ACEH's) October 27, 2011 letter as a condition for case closure.

## 2.0 WELL DESTRUCTION

### 2.1 FIELD DATES

November 30 through December 2, 2011.

### 2.2 PERSONNEL PRESENT

CRA field staff Alan Anderson directed the well destructions under the supervision of California Professional Geologist Peter Schaefer.

### 2.3 DESTRUCTION METHOD

After removing the well boxes, wells MW-1 through MW-3 were destroyed by over-drilling with a hand auger and backfilling with neat cement, wells MW-5 through MW-9 were destroyed by pressure grouting, and soil vapor probes SVP-1 through SVP-4 and SVP-6 through SVP-9 were destroyed by over-drilling using an air-/water-knife drill rig and backfilling with neat cement. A copy of the Alameda County Public Works Agency's well destruction permit is included in Appendix A.

### 2.4 WASTE DISPOSAL

Soil and water-knife sludge generated during field activities was stored on site in 55-gallon drums, sampled, and profiled for disposal. Waste disposal confirmation documentation is pending and will be provided by CRA upon request.

Construction debris generated by the well destruction activities was transported by Vapor Tech Services of Berkeley, California to Commercial Waste and Recycling of Oakland, California for recycling.

All of Which is Respectfully Submitted,  
CONESTOGA-ROVERS & ASSOCIATES

  
Peter Schaefer, CEG, CHG

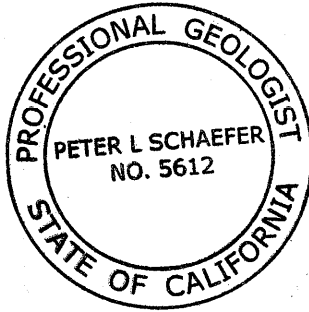



Kay Pannell, REP, REA-II



## FIGURES

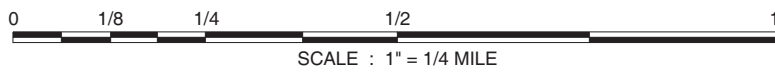
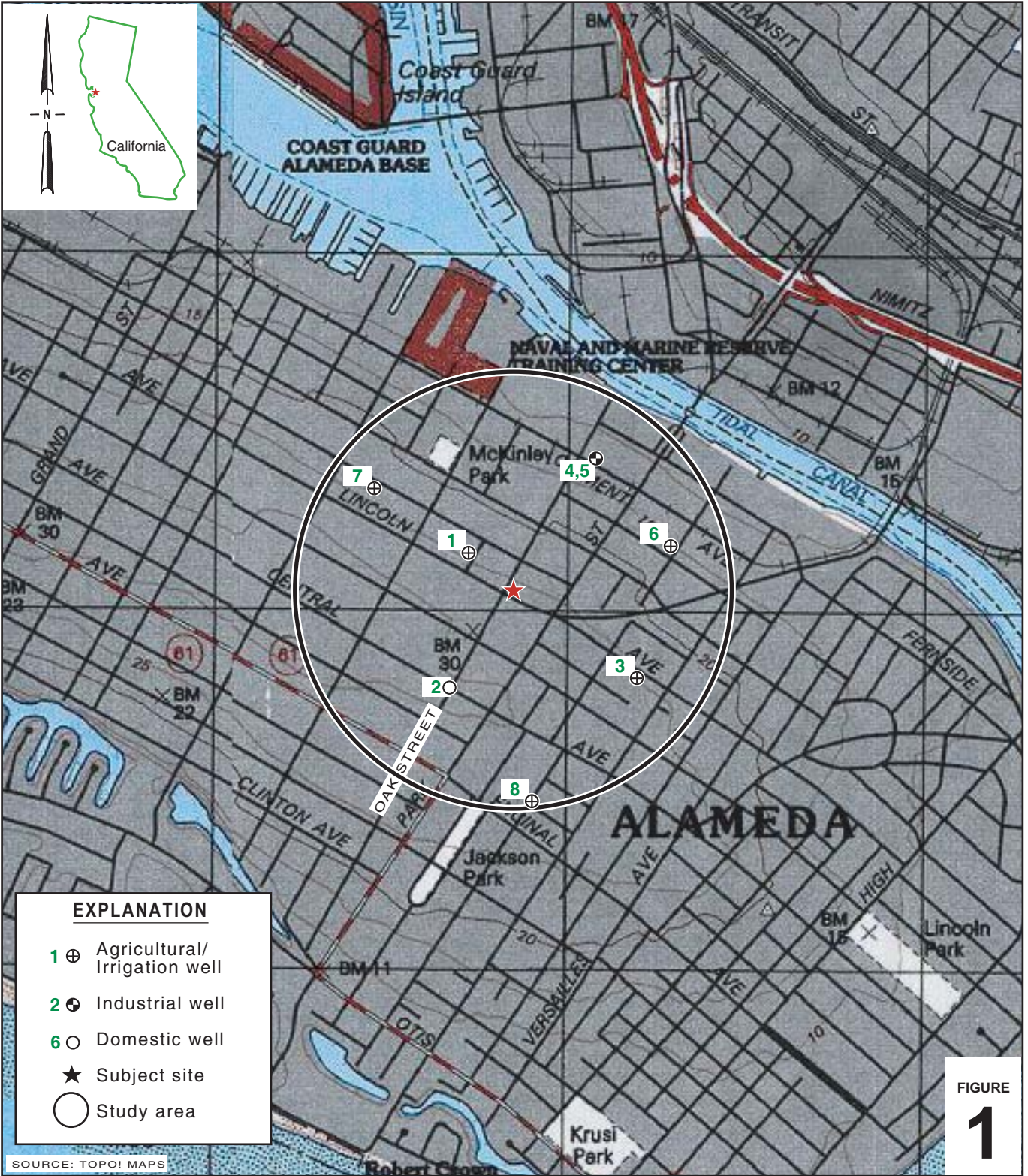

### Former Shell Service Station

2301-2307 Lincoln Avenue  
Alameda, California



**CONESTOGA-ROVERS  
& ASSOCIATES**

### Vicinity Map



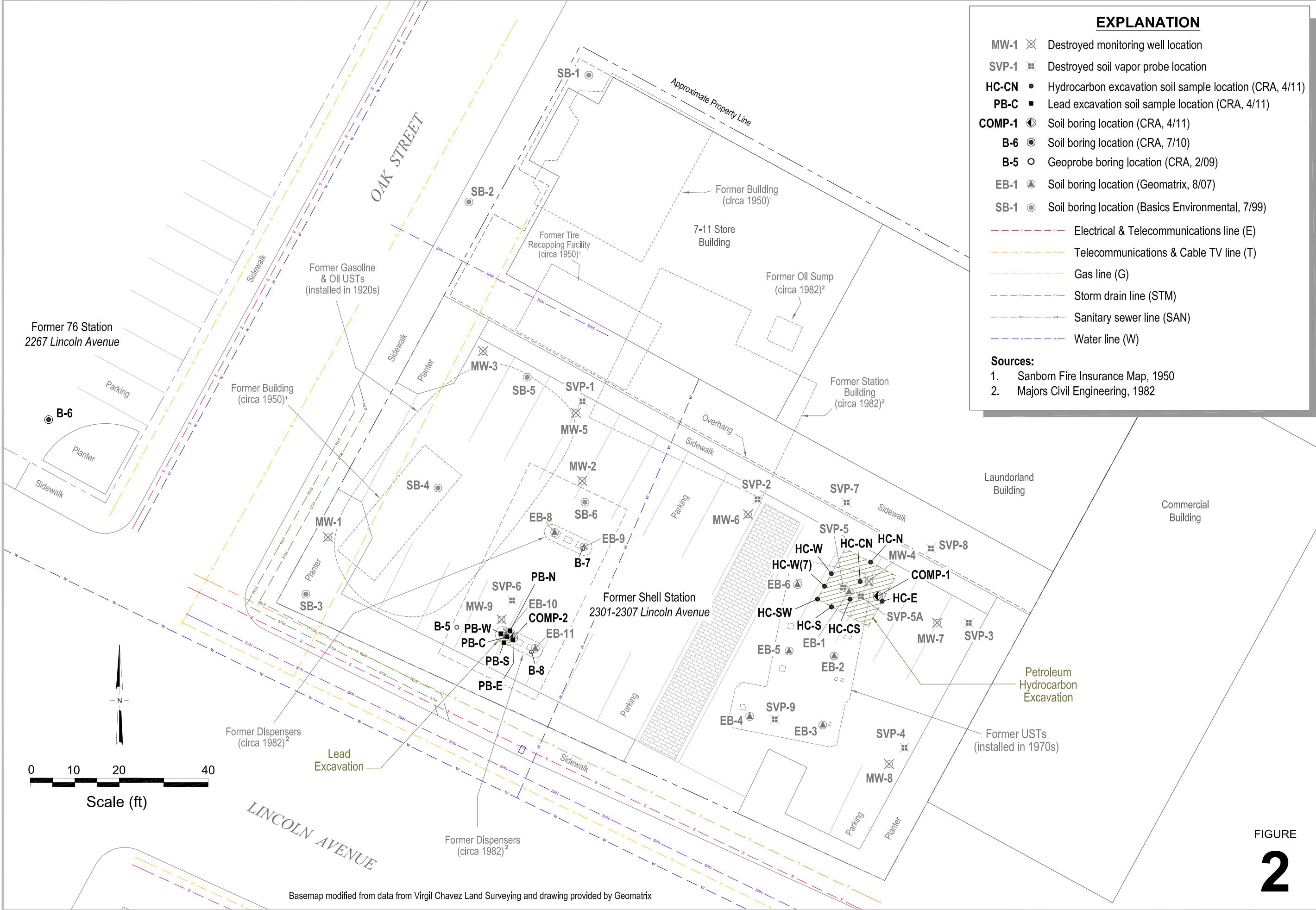

### EXPLANATION

- MW-1 ☒ Destroyed monitoring well location
- SVP-1 ☒ Destroyed soil vapor probe location
- HC-CN ● Hydrocarbon excavation soil sample location (CRA, 4/11)
- PB-C ■ Lead excavation soil sample location (CRA, 4/11)
- COMP-1 ⊕ Soil boring location (CRA, 4/11)
- B-6 ⊙ Soil boring location (CRA, 7/10)
- B-5 ⊖ Geoprobe boring location (CRA, 2/09)
- EB-1 ▲ Soil boring location (Geomatrix, 8/07)
- SB-1 ⊙ Soil boring location (Basics Environmental, 7/99)

- - - Electrical & Telecommunications line (E)
- - - Telecommunications & Cable TV line (T)
- - - Gas line (G)
- - - Storm drain line (STM)
- - - Sanitary sewer line (SAN)
- - - Water line (W)

**Sources:**

- Sanborn Fire Insurance Map, 1950
- Majors Civil Engineering, 1982

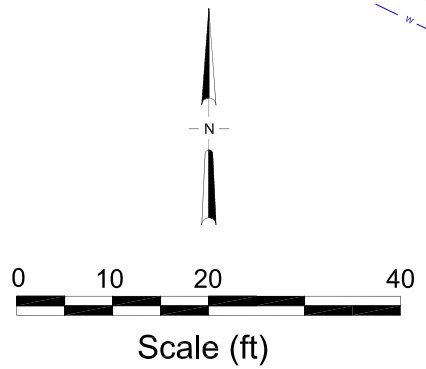

Basemap modified from data from Virgil Chavez Land Surveying and drawing provided by Geomatrix

FIGURE 2

I:\Shell\6-chars\0602--060204-Alameda 2301-2307 Lincoln Ave\060204 FIGURES\060204 SITE PLAN.DWG



CONESTOGA-ROVERS & ASSOCIATES

Former Shell Service Station  
2301-2307 Lincoln Avenue  
Alameda, California

APPENDIX A

PERMIT

# Alameda County Public Works Agency - Water Resources Well Permit

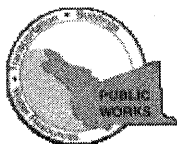

399 Elmhurst Street  
Hayward, CA 94544-1395  
Telephone: (510)670-6633 Fax:(510)782-1939

**Application Approved on: 11/22/2011 By jamesy**

**Permit Numbers: W2011-0707 to W2011-0715**  
**Permits Valid from 11/30/2011 to 12/02/2011**

**Application Id:** 1320417387324  
**Site Location:** 2301-2307 Lincoln Ave

**City of Project Site:** Alameda

**Project Start Date:** 11/30/2011  
**Assigned Inspector:** Contact Vicky Hamlin at (510) 670-5443 or vickyh@acpwa.org

**Completion Date:** 12/02/2011

**Applicant:** Conestoga Rovers & Associates - Peter Schaefer  
5900 Hollis Street, Suite A, Emeryville, CA 94608

**Phone:** 510-420-3319

**Property Owner:** Alan and Beverly Sebanc  
2805 Ralston Ave, Hillsboro, CA 94010

**Phone:** --

**Client:** Peter Schaefer Shell Oil Products US  
20945 S Wilmington, Carson, CA 90815

**Phone:** 510-420-3319

**Contact:** Sherry Phillips

**Phone:** --  
**Cell:** 707-732-3039

	<b>Total Due:</b>	\$3441.00
<b>Receipt Number: WR2011-0344</b>	<b>Total Amount Paid:</b>	\$3441.00
<b>Payer Name : Conestoga Rovers &amp; Associates</b>	<b>Paid By: CHECK</b>	<b>PAID IN FULL</b>

## Works Requesting Permits:

Well Destruction-Monitoring - 8 Wells

Driller: Vapor Tech Services - Lic #: 916085 - Method: press

**Work Total: \$3176.00**

### Specifications

Permit #	Issued Date	Expire Date	Owner Well Id	Hole Diam.	Casing Diam.	Seal Depth	Max. Depth	State Well #	Orig. Permit #	DWR #
W2011-0707	11/22/2011	02/28/2012	MW-1	6.00 in.	1.00 in.	4.00 ft	12.50 ft	2S/3W7N	W2007-0884	e063745
W2011-0708	11/22/2011	02/28/2012	MW-2	6.00 in.	1.00 in.	5.00 ft	13.00 ft	2S/3W7N	W2007-0885	e063747
W2011-0709	11/22/2011	02/28/2012	MW-3	6.00 in.	1.00 in.	4.00 ft	12.50 ft	2S/3W7N	W2007-0886	e063748
W2011-0710	11/22/2011	02/28/2012	MW-5	10.00 in.	4.00 in.	4.00 ft	18.00 ft	2S/3W7N	W2009-0110	e008939
W2011-0711	11/22/2011	02/28/2012	MW-6	10.00 in.	4.00 in.	4.00 ft	18.00 ft	2S/3W7N	W2009-0111	e0089040
W2011-0712	11/22/2011	02/28/2012	MW-7	10.00 in.	4.00 in.	4.00 ft	18.00 ft	2S/3W7N	W2009-0112	e0089041
W2011-0713	11/22/2011	02/28/2012	MW-8	10.00 in.	4.00 in.	4.00 ft	18.00 ft	2S/3W7N	W2009-0113	e0089042
W2011-0714	11/22/2011	02/28/2012	MW-9	10.00 in.	4.00 in.	4.00 ft	18.00 ft	2S/3W7N	W2010-0153	e0107838

### Specific Work Permit Conditions

1. Drilling Permit(s) can be voided/ cancelled only in writing. It is the applicant's responsibility to notify Alameda County Public Works Agency, Water Resources Section in writing for an extension or to cancel the drilling permit application. No drilling permit application(s) shall be extended beyond ninety (90) days from the original start date. Applicants may not cancel a drilling permit application after the completion date of the permit issued has passed.

## Alameda County Public Works Agency - Water Resources Well Permit

2. Prior to any drilling activities, it shall be the applicant's responsibility to contact and coordinate an Underground Service Alert (USA), obtain encroachment permit(s), excavation permit(s) or any other permits or agreements required for that Federal, State, County or City, and follow all City or County Ordinances. No work shall begin until all the permits and requirements have been approved or obtained. It shall also be the applicants responsibilities to provide to the Cities or to Alameda County an Traffic Safety Plan for any lane closures or detours planned. No work shall begin until all the permits and requirements have been approved or obtained.
  
3. Compliance with the well-sealing specifications shall not exempt the well-sealing contractor from complying with appropriate State reporting-requirements related to well construction or destruction (Sections 13750 through 13755 (Division 7, Chapter 10, Article 3) of the California Water Code). Contractor must complete State DWR Form 188 and mail original to the Alameda County Public Works Agency, Water Resources Section, within 60 days. Including permit number and site map.
  
4. Applicant shall submit the copies of the approved encroachment permit to this office within 60 days.
  
5. Permittee shall assume entire responsibility for all activities and uses under this permit and shall indemnify, defend and save the Alameda County Public Works Agency, its officers, agents, and employees free and harmless from any and all expense, cost and liability in connection with or resulting from the exercise of this Permit including, but not limited to, property damage, personal injury and wrongful death.
  
6. Applicant shall contact Vicky Hamlin for an inspection time at 510-670-5443 or email to vickyh@acpwa.org at least five (5) working days prior to starting, once the permit has been approved. Confirm the scheduled date(s) at least 24 hours prior to drilling.
  
7. Permittee, permittee's contractors, consultants or agents shall be responsible to assure that all material or waters generated during drilling, boring destruction, and/or other activities associated with this Permit will be safely handled, properly managed, and disposed of according to all applicable federal, state, and local statutes regulating such. In no case shall these materials and/or waters be allowed to enter, or potentially enter, on or off-site storm sewers, dry wells, or waterways or be allowed to move off the property where work is being completed.
  
8. Remove the Christy box or similar structure.

Destroy well by grouting neat cement with a tremie pipe or pressure grouting (25 psi for 5min.) to the bottom of the well and by filling with neat cement to three (3-5) feet below surface grade. Allow the sealing material to spill over the top of the casing to fill any annular space between casing and soil.

After the seal has set, backfill the remaining hole with concrete or compacted material to match existing conditions.

9. Copy of approved drilling permit must be on site at all times. Failure to present or show proof of the approved permit application on site shall result in a fine of \$500.00.

Well Destruction-Vapor monitoring well - 7 Wells

Driller: Vapor Tech Services - Lic #: 916085 - Method: press

**Work Total: \$265.00**

**Specifications**

Permit #	Issued Date	Expire Date	Owner Well Id	Hole Diam.	Casing Diam.	Seal Depth	Max. Depth	State Well #	Orig. Permit #	DWR #
W2011-0715	11/22/2011	02/28/2012	SVP-1	2.00 in.	0.25 in.	3.00 ft	5.00 ft	2S3W7N	W2009-0115	e0089043

## Alameda County Public Works Agency - Water Resources Well Permit

W2011-0715	11/22/2011	02/28/2012	SVP-2	2.00 in.	0.25 in.	3.00 ft	5.00 ft	2S3W7N	W2009-0116	e0089044
W2011-0715	11/22/2011	02/28/2012	SVP-3	2.00 in.	0.25 in.	3.00 ft	5.00 ft	2S3W7N	W2009-0117	e0089045
W2011-0715	11/22/2011	02/28/2012	SVP-4	2.00 in.	0.25 in.	1.00 ft	5.00 ft	2S3W7N	W2009-0118	e008906
W2011-0715	11/22/2011	02/28/2012	SVP-6	2.00 in.	0.25 in.	1.00 ft	5.00 ft	2S3W7N	W2010-0154	e0107842
W2011-0715	11/22/2011	02/28/2012	SVP-7	2.00 in.	0.25 in.	1.00 ft	5.00 ft	2S3W7N	W2010-0154	e0107843
W2011-0715	11/22/2011	02/28/2012	SVP-8	2.00 in.	0.25 in.	1.00 ft	5.00 ft	2S3W7N	W2010-0154	e0107844

### Specific Work Permit Conditions

1. Drilling Permit(s) can be voided/ cancelled only in writing. It is the applicant's responsibility to notify Alameda County Public Works Agency, Water Resources Section in writing for an extension or to cancel the drilling permit application. No drilling permit application(s) shall be extended beyond ninety (90) days from the original start date. Applicants may not cancel a drilling permit application after the completion date of the permit issued has passed.
2. Compliance with the above well-sealing specifications shall not exempt the well-sealing contractor from complying with appropriate state reporting-requirements related to well destruction (Sections 13750 through 13755 (Division 7, Chapter 10, Article 3) of the California Water Code). Contractor must complete State DWR Form 188 and mail original to the Alameda County Public Works Agency, Water Resources Section, within 60 days, including permit number and site map.
3. Permittee shall assume entire responsibility for all activities and uses under this permit and shall indemnify, defend and save the Alameda County Public Works Agency, its officers, agents, and employees free and harmless from any and all expense, cost, liability in connection with or resulting from the exercise of this Permit including, but not limited to, properly damage, personal injury and wrongful death.
4. Permittee, permittee's contractors, consultants or agents shall be responsible to assure that all material or waters generated during drilling, boring destruction, and/or other activities associated with this Permit will be safely handled, properly managed, and disposed of according to all applicable federal, state, and local statutes regulating such. In no case shall these materials and/or waters be allowed to enter, or potentially enter, on or off-site storm sewers, dry wells, or waterways or be allowed to move off the property where work is being completed.
5. Prior to any drilling activities, it shall be the applicant's responsibility to contact and coordinate an Underground Service Alert (USA), obtain encroachment permit(s), excavation permit(s) or any other permits or agreements required for that Federal, State, County or City, and follow all City or County Ordinances. No work shall begin until all the permits and requirements have been approved or obtained. It shall also be the applicants responsibilities to provide to the Cities or to Alameda County an Traffic Safety Plan for any lane closures or detours planned. No work shall begin until all the permits and requirements have been approved or obtained.
6. No changes in construction procedures or well type shall change, as described on this permit application. This permit may be voided if it contains incorrect information.
7. Applicant shall submit the copies of the approved encroachment permit to this office within 60 days.
8. Applicant shall contact Vicky Hamlin for an inspection time at 510-670-5443 or email to vickyh@acpwa.org at least five (5) working days prior to starting, once the permit has been approved. Confirm the scheduled date(s) at least 24 hours prior to drilling.

## Alameda County Public Works Agency - Water Resources Well Permit

9. Remove the Christy box or similar structure.

Destroy well by grouting neat cement with a tremie pipe or pressure grouting (25 psi for 5min.) to the bottom of the well and by filling with neat cement to three (3-5) feet below surface grade. Allow the sealing material to spill over the top of the casing to fill any annular space between casing and soil.

After the seal has set, backfill the remaining hole with concrete or compacted material to match existing conditions.

10. Copy of approved drilling permit must be on site at all times. Failure to present or show proof of the approved permit application on site shall result in a fine of \$500.00.

11. Vapor monitoring wells constructed with tubing shall be decommissioned by complete removal of tubing, grout seal, and fill material of sand or bentonite. Fill material may be removed by hand auger if material can be removed completely.

Vapor monitoring wells constructed with pvc pipe less than 2" shall be overdrilled to total depth.

Vapor monitoring wells constructed with 2" pvc pipe or larger may be grouted by tremie pipe (any depth) or pressure grouted (less than 30', 25 psi for 5 min).

---