

RECEIVED

2:43 pm, May 04, 2009

Alameda County  
Environmental Health

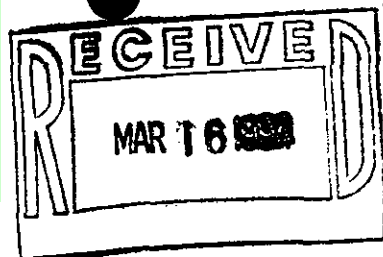

*F. 61128*  
**Chevron**

**Chevron U.S.A. Products Company**  
2410 Camino Ramon  
San Ramon, CA 94583  
P.O. Box 5004  
San Ramon, CA 94583-0804

**Marketing Department**  
Phone 510 842 9500

March 9, 1994

Mr. Scott Seery  
Alameda County Environmental Health  
80 Swan Way, Room 200  
Oakland, CA 94621

Re: Chevron Station # 9-1924, 4904 South Front Street, Livermore, CA  
Attached groundwater monitoring report (GTI, 9/14/93)  
Attached groundwater monitoring report (GTI, 12/2/93)

Dear Mr. Seery:

Attached you will find reports dated September 14, 1993 and December 2, 1993, which were prepared by Chevron's consultant, Groundwater Technology, Inc. (GTI), to describe the results of groundwater monitoring performed on July 20, 1993 and October 20, 1993.

The measured direction of groundwater flow in July was generally toward the west. Seventeen of the nineteen site monitoring wells were sampled and analyzed for the presence of TPHGas and BTEX constituents. Monitoring wells MW-14 and MW-16 were not sampled. The measured levels of dissolved hydrocarbons were consistent with data collected during previous site monitoring events.

During the October site monitoring event the measured direction of groundwater flow was again, generally towards the west. However, there appeared to be measurable variations within the westerly trend; a southwesterly flow direction and a northwesterly direction. Seventeen of the nineteen site-related monitoring wells were sampled and analyzed for TPHGas and BTEX constituents. Monitoring well MW-14 was dry and MW-18 appeared to be paved over. The detected concentrations of dissolved hydrocarbons remained consistent to those detected during previous measurements. The status of well MW-18 will be verified during the next monitoring event.

If you have any questions or comments, I can be reached at (510) 842-8695.

Sincerely,

Brett L. Hunter  
Environmental Engineer  
Site Assessment and Remediation



Attachments

cc: Eddie So, San Francisco Bay RWQCB, Oakland, CA  
Jeanne Price, 213 Del Mesa Carmel, Carmel, CA 93921  
Dave Baker, Mobil Oil, 3225 Gallows Rd., Rm. 1W109, Fairfax, Virginia, 22037  
Scott Hooton, BP Oil, Northwest Division, Southcenter Place Bldg., 16400 Southcenter  
Parkway, Suite 301, Tukwila, Washington, 98188

SEP 20 '93 J.M.M.

# GROUNDWATER TECHNOLOGY, INC.

1401 Halyard Drive, Suite 140, West Sacramento, CA 95691, (916) 372-4700

September 14, 1993

FAX (916) 372-8781  
Project No. 02070 4233

Mr. Brett L. Hunter  
Chevron U.S.A. Products Company  
2410 Camino Ramon  
San Ramon, CA 94583-0804

**RE: QUARTERLY MONITORING AND SAMPLING ACTIVITIES  
CHEVRON SERVICE STATION 9-1924  
4904 SOUTHFRONT ROAD  
LIVERMORE, CALIFORNIA**

Dear Mr. Hunter:

Groundwater Technology, Inc. submits this letter as a summary of quarterly groundwater monitoring and sampling data collected at the above-referenced site on July 20 and 21, 1993. The eighteen site-related groundwater monitoring wells were gauged to determine depth to groundwater (DTW) and to check for the presence of separate-phase petroleum hydrocarbons (SP). A potentiometric surface map (Figure 1) and a summary of groundwater monitoring data (Table 1) are included. The July 20, 1993 potentiometric surface map includes data collected on the same date by Kaprelian Engineering, Inc. for the Unocal station northwest of the Chevron site. After measuring DTW, sixteen monitoring wells were purged and sampled. Wells MW-14 and MW-16, which are located in Southfront Road, were not sampled due to heavy traffic. The groundwater samples were analyzed for dissolved benzene, toluene, ethylbenzene and xylenes (BTEX), and total petroleum hydrocarbons-as-gasoline (TPH-G). Results of the chemical analyses are summarized in Table 1. Laboratory reports and chain-of-custody manifests are included in Attachment I. All purge water generated during sampling was collected in a Department of Transportation (DOT)-approved purge trailer and transported for recycling to the Chevron refinery in Richmond, California.

Groundwater Technology, Inc. is pleased to assist Chevron on this project. If you have any questions or comments please call our West Sacramento office.

Sincerely,  
Groundwater Technology, Inc.  
Written/Submitted by

Groundwater Technology, Inc.  
Reviewed/Approved by

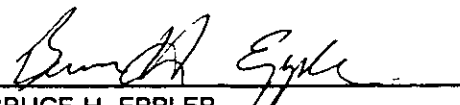
  
BRUCE H. EPPLER  
Environmental Geologist  
Project Manager

  
E. K. SIMONIS, R.G.  
Senior Environmental Geologist

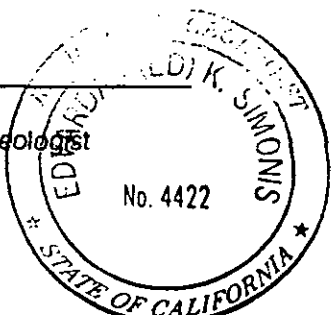

PR   
DSB/BHE/EKS:rz  
Attachments  
4233QTR3.LTR

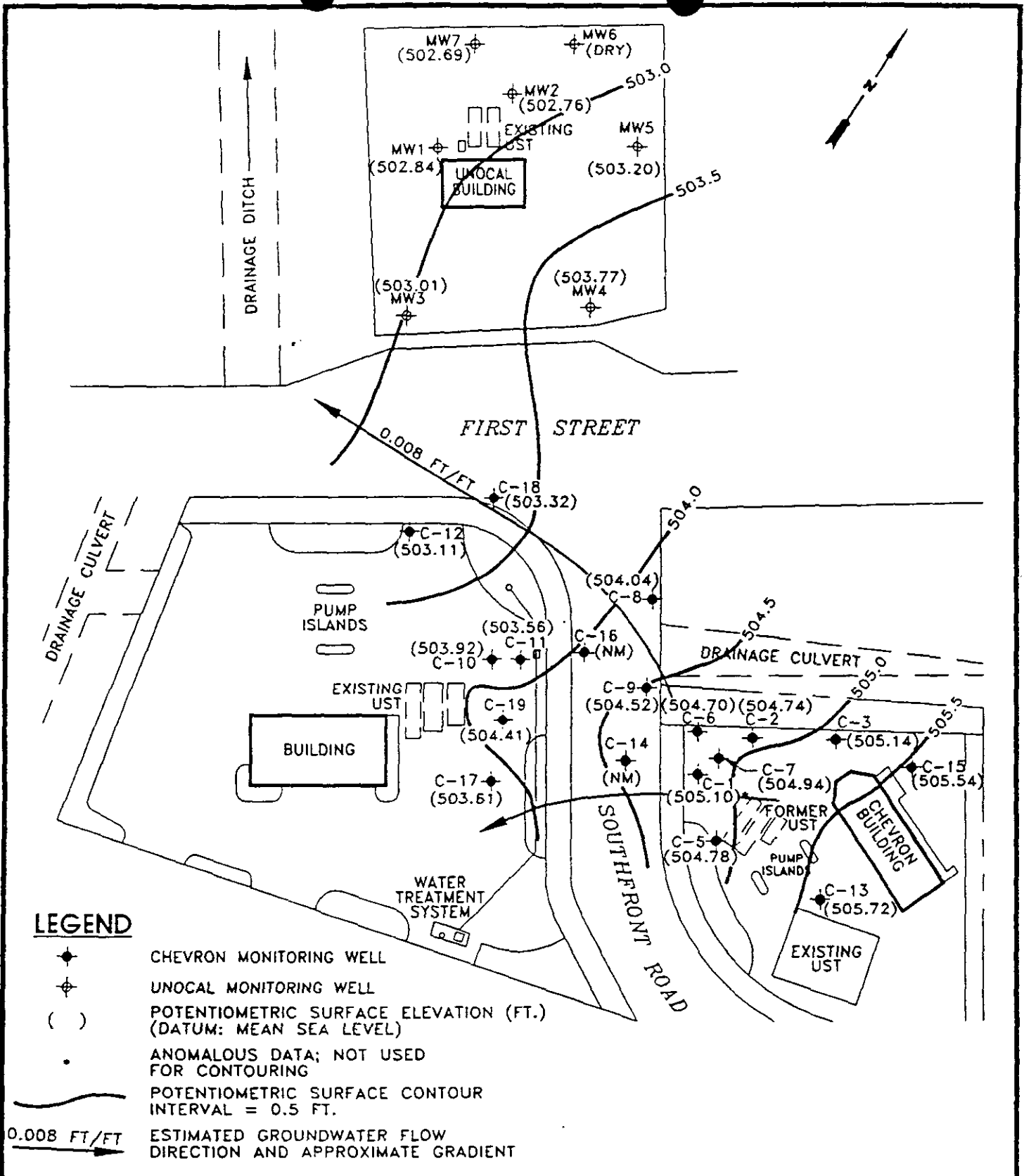

		<b>POTENTIOMETRIC SURFACE MAP</b> <b>JULY 20, 1993</b>			
<b>CLIENT:</b> CHEVRON U.S.A. PRODUCTS CO. SERVICE STATION NO. 9-1924		<b>FILE:</b> 4233SMA/4233PSM		<b>PROJECT NO.:</b> 02070-4233	
<b>LOCATION:</b> 4904 SOUTHFRONT ROAD LIVERMORE, CALIFORNIA		<b>REV.</b> 1		<b>PM</b> <i>[Signature]</i>	
		<b>DES.</b> DSB		<b>PE/RC</b> <i>[Signature]</i>	
		<b>DET.</b> AJK		<b>FIGURE:</b> 1	
		<b>DATE:</b> 9/7/93			

**Table 1**  
**HISTORICAL GROUNDWATER ANALYTICAL RESULTS AND MONITORING DATA**

CHEVRON SERVICE STATION #9-1924  
4904 SOUTHFRONT ROAD, LIVERMORE, CALIFORNIA

WELL ID/ ELEVATION (TOC)	DATE	BENZENE (ppb)	TOLUENE (ppb)	ETHYL- BENZENE (ppb)	XYLENES (ppb)	TPH-G (ppb)	TOG (ppb)	1,2- DCA (ppb)	OTHER (ppb)	MC (ppb)	1,1,1- TCA (ppb)	1,1- DCA (ppb)	PCE (ppb)	DTW (feet)	SPT (feet)	WTE (feet)
C-1 520.39	03/28/86	--	--	--	--	--	--	--	--	--	--	--	--	11.75	0.00	508.64
	03/15/88	770	87	610	2,100	27,000	--	--	--	--	--	--	--	13.50	0.00	506.89
	05/10/88	--	--	--	--	--	--	--	--	--	--	--	--	13.65	0.00	506.74
	06/10/88	--	--	--	--	--	--	--	--	--	--	--	--	14.72	0.00	505.67
	07/25/88	--	--	--	--	--	--	--	--	--	--	--	--	13.50	0.00	506.89
	10/13/88	220	11	62	130	3,200	--	--	--	--	--	--	--	12.89	0.00	507.50
	01/01/89	--	--	--	--	--	--	--	--	--	--	--	--	12.89	0.00	507.50
	01/12/89	820	43	490	260	4,000	--	--	--	--	--	--	--	--	--	--
	04/10/89	100	ND	70	50	4,000	ND	ND	--	--	--	--	--	13.65	0.00	506.74
	04/10/89	100	ND	60	50	4,000	--	ND	--	--	--	--	--	13.65	0.00	506.74
	06/26/89	97	20	60	50	600	ND	3	--	--	--	--	--	13.94	0.00	506.45
	06/26/89	86	15	44	35	570	--	1.7	--	--	--	--	--	13.94	0.00	506.45
	10/13/89	64	ND	51	48	1,600	ND	ND	5	--	--	--	--	13.92	0.00	506.47
	01/03/90	38	0.68	30	30	1,100	--	1	--	--	--	--	--	13.80	0.00	506.59
	05/08/90	37	9.2	40	32	1,300	--	1.2	--	ND	--	ND	--	13.91	0.00	506.48
	09/29/90	19	1.2	32	31	350	--	ND	ND	0.7	1.4	ND	--	13.93	0.00	506.46
	01/03/91	12	ND	17	14	400	--	ND	ND	ND	ND	ND	ND	13.85	0.00	506.54
	04/12/91	--	--	--	--	--	--	--	--	--	--	--	--	13.51	0.00	506.88
	09/04/91	--	--	--	--	--	--	--	--	--	--	--	--	14.10	0.00	506.29
	04/06/92	12	0.8	31	31	1,000	--	ND	ND	ND	ND	ND	ND	13.06	0.00	507.33
	07/28/92	47	110	96	260	4,200	--	--	--	--	--	--	--	13.93	0.00	506.46
10/16/92	11	ND	32.0	55.0	1,800	--	--	--	--	--	--	--	14.45	0.00	505.94	
01/14/93*	24	ND	98	62	2,000	--	--	--	--	--	--	--	11.23	0.00	509.16	
03/26/93	21	12	120	100	4,400	--	--	--	--	--	--	--	10.94	0.00	509.45	
04/22/93	26	44	580	330	18,000	--	--	--	--	--	--	--	16.25	SHEEN	504.14	
07/20,21/93	73	11	470	470	7,100**	--	--	--	--	--	--	--	15.29	0.00	505.10	
C-2 520.76	03/28/86	--	--	--	--	--	--	--	--	--	--	--	--	11.98	0.00	508.78
	03/15/88	3,900	1,900	1,200	1,200	22,000	--	--	--	--	--	--	--	13.77	0.00	506.99
	05/10/88	--	--	--	--	--	--	--	--	--	--	--	--	14.03	0.00	506.73
	06/10/88	--	--	--	--	--	--	--	--	--	--	--	--	15.12	0.00	505.64
	07/25/88	--	--	--	--	--	--	--	--	--	--	--	--	13.86	0.00	506.90
	10/13/88	ND	ND	ND	ND	ND	--	--	--	--	--	--	--	14.11	0.00	506.65
	01/01/89	--	--	--	--	--	--	--	--	--	--	--	--	12.83	0.00	507.93
	01/12/89	25	3	83	59	1,000	--	--	--	--	--	--	--	--	--	--
	04/10/89	2.5	ND	15	12	600	ND	ND	--	--	--	--	--	14.04	0.00	506.72
	04/10/89	ND	ND	11	11	ND	--	ND	--	--	--	--	--	14.04	0.00	506.72
	06/26/89	5.3	8	18	14	640	ND	ND	--	--	--	--	--	14.34	0.00	506.42
	06/26/89	3.7	0.6	13	8.2	750	--	2	--	--	--	--	--	14.34	0.00	506.42
	10/13/89	ND	ND	17	10	630	--	ND	--	--	--	--	--	13.92	0.00	506.84
	01/03/90	3	ND	19	17	880	--	1	--	--	--	--	--	14.11	0.00	506.65
	05/08/90	1.3	2.7	8.4	11	340	--	1.1	--	ND	--	ND	--	14.28	0.00	506.48
	09/29/90	ND	ND	4.6	1.8	74	--	ND	ND	1.7	0.5	ND	ND	14.25	0.00	506.51
	01/03/91	270	ND	79	93	2,000	--	ND	ND	ND	ND	ND	ND	14.15	0.00	506.61
	04/12/91	--	--	--	--	--	--	--	--	--	--	--	--	13.86	0.00	506.90
	09/04/91	--	--	--	--	--	--	--	--	--	--	--	--	14.50	0.00	506.26
	04/06/92	ND	ND	54.0	6.1	1,200	--	ND	ND	ND	ND	ND	ND	13.47	0.00	507.29
	07/28/92	5.2	2.9	26	16	1,000	--	--	--	--	--	--	--	14.35	0.00	506.41
10/16/92	ND	2.2	20	10	2,000	--	--	--	--	--	--	--	14.84	0.00	505.92	
01/14/93*	49	50	31	29	1,800	--	--	--	--	--	--	--	11.22	0.00	509.54	
03/26/93	15	12	14	6	820**	--	--	--	--	--	--	--	10.77	0.00	509.99	
04/22/93	12	12	28	29	2,000	--	--	--	--	--	--	--	12.93	0.00	507.83	
07/20,21/93	28	8	4	4	1,100**	--	--	--	--	--	--	--	16.02	0.00	504.74	

**Table 1**  
**HISTORICAL GROUNDWATER ANALYTICAL RESULTS AND MONITORING DATA**

CHEVRON SERVICE STATION #8-1924  
4904 SOUTHFRONT ROAD, LIVERMORE, CALIFORNIA

WELL ID/ ELEVATION (TOC)	DATE	BENZENE (ppb)	TOLUENE (ppb)	ETHYL- BENZENE (ppb)	XYLENES (ppb)	TPH-G (ppb)	TOG (ppb)	1,2- DCA (ppb)	OTHER (ppb)	MC (ppb)	1,1,1- TCA (ppb)	1,1- DCA (ppb)	PCE (ppb)	DTW (feet)	SPT (feet)	WTE (feet)
C-3 521.31	03/28/86	---	---	---	---	---	---	---	---	---	---	---	---	12.24	0.00	509.07
	03/15/88	88	8	30	36.0	2,100	---	---	---	---	---	---	---	14.21	0.00	507.10
	05/10/88	---	---	---	---	---	---	---	---	---	---	---	---	14.43	0.00	506.88
	06/10/88	---	---	---	---	---	---	---	---	---	---	---	---	15.53	0.00	505.78
	07/25/88	---	---	---	---	---	---	---	---	---	---	---	---	14.22	0.00	507.09
	10/13/88	ND	ND	ND	ND	ND	---	---	---	---	---	---	---	14.10	0.00	507.21
	01/01/89	---	---	---	---	---	---	---	---	---	---	---	---	12.70	0.00	508.61
	04/10/89	2.1	ND	4.4	2.6	200	ND	1.4	---	---	---	---	---	14.36	0.00	506.95
	06/26/89	1.1	0.7	4.9	1.6	260	ND	1.5	---	---	---	---	---	14.74	0.00	506.57
	10/13/89	ND	ND	ND	ND	ND	---	---	---	---	---	---	---	14.70	0.00	506.61
	01/03/90	ND	ND	0.9	1.4	ND	---	0.7	---	---	---	---	---	14.42	0.00	506.89
	05/08/90	ND	ND	ND	ND	ND	---	0.7	---	---	---	---	---	14.65	0.00	506.66
	09/27/90	ND	1.0	ND	ND	71	---	ND	ND	1.1	1.6	ND	---	14.67	0.00	506.64
	01/03/91	ND	ND	ND	ND	57	---	ND	ND	ND	ND	ND	---	14.58	0.00	506.73
	04/12/91	ND	ND	1.6	ND	98	---	ND	ND	ND	ND	ND	---	14.23	0.00	507.08
	09/04/91	ND	ND	ND	ND	64	---	ND	ND	ND	ND	ND	---	14.88	0.00	506.43
	04/06/92	ND	ND	0.8	ND	88	---	ND	ND	ND	ND	ND	---	13.83	0.00	507.48
	07/28/92	ND	ND	0.5	1.1	80	---	---	---	---	---	---	---	14.80	0.00	506.51
	10/16/92	ND	ND	6.6	11	1,400	---	---	---	---	---	---	---	15.23	0.00	506.08
	01/14/93*	ND	ND	ND	1.3	100	---	---	---	---	---	---	---	11.45	0.00	509.86
03/26/93	0.7	1	ND	ND	74	---	---	---	---	---	---	---	11.27	0.00	510.04	
04/22/93	ND	ND	ND	ND	ND***	---	---	---	---	---	---	---	12.61	0.00	508.70	
07/20,21/93	ND	ND	ND	ND	ND	---	---	---	---	---	---	---	16.17	0.00	505.14	
C-5 520.82	03/28/86	---	---	---	---	---	---	---	---	---	---	---	---	12.00	0.00	508.82
	03/15/88	82	7	77	95	1,600	---	---	---	---	---	---	---	13.75	0.00	507.07
	05/10/88	---	---	---	---	---	---	---	---	---	---	---	---	13.92	0.00	506.90
	07/10/88	---	---	---	---	---	---	---	---	---	---	---	---	13.72	0.00	507.10
	07/25/88	---	---	---	---	---	---	---	---	---	---	---	---	13.72	0.00	507.10
	10/13/88	ND	ND	ND	ND	2,500	---	---	---	---	---	---	---	13.84	0.00	506.98
	01/01/89	---	---	---	---	---	---	---	---	---	---	---	---	13.41	0.00	507.41
	01/12/89	42	3	44	52	ND	---	---	---	---	---	---	---	---	0.00	520.82
	04/10/89	2.6	ND	6.2	5.5	180	ND	1.4	---	---	---	---	---	13.88	---	---
	06/26/89	7.6	0.8	40	56	420	ND	1.5	---	---	---	---	---	14.14	0.00	506.68
	10/13/89	ND	ND	10	ND	620	ND	ND	---	---	---	---	---	14.15	0.00	506.67
	01/03/90	0.7	ND	8	6	ND	---	ND	---	---	---	---	---	14.10	0.00	506.72
	05/08/90	0.6	0.8	11	7.2	140	---	0.8	---	---	---	---	---	14.00	0.00	506.82
	09/27/90	ND	3.2	5.2	6.4	360	---	ND	ND	0.7	ND	ND	---	14.00	0.00	506.82
	01/03/91	ND	ND	ND	3	90	---	ND	ND	ND	ND	ND	---	14.00	0.00	506.82
	04/12/91	12	ND	19	7	270	---	0.5	ND	ND	ND	ND	---	13.71	0.00	507.11
	09/04/91	ND	ND	ND	ND	ND	---	ND	ND	ND	ND	ND	---	14.30	0.00	506.52
	04/06/92	12	ND	40	ND	670	---	ND	ND	ND	ND	ND	---	13.29	0.00	507.53
	07/28/92	15	ND	1.8	0.5	130	---	---	---	---	---	---	---	14.13	0.00	506.69
	10/16/92	ND	ND	1.2	ND	ND	---	---	---	---	---	---	---	14.68	0.00	506.14
01/14/93*	13	ND	110	10	2,300	---	---	---	---	---	---	---	11.87	0.00	508.95	
03/26/93	---	---	---	---	---	---	---	---	---	---	---	---	---	---	---	---
04/22/93	220	18	120	65	2,300**	---	---	---	---	---	---	---	12.12	0.00	508.70	
07/20,21/93	18	5	8	14	970**	---	---	---	---	---	---	---	16.04	0.00	504.78	

**Table 1**  
**HISTORICAL GROUNDWATER ANALYTICAL RESULTS AND MONITORING DATA**

CHEVRON SERVICE STATION #9-1924  
4904 SOUTHFRONT ROAD, LIVERMORE, CALIFORNIA

WELL ID/ ELEVATION (TOC)	DATE	BENZENE (ppb)	TOLUENE (ppb)	ETHYL- BENZENE (ppb)	XYLENES (ppb)	TPH-G (ppb)	TOG (ppb)	1,2- DCA (ppb)	OTHER (ppb)	MC (ppb)	1,1,1- TCA (ppb)	1,1- DCA (ppb)	PCE (ppb)	DTW (feet)	SPT (feet)	WTE (feet)
C-6 519.62	03/26/86	---	---	---	---	---	---	---	---	---	---	---	---	11.12	0.00	508.50
	03/15/88	870	4,600	1,500	8,200	46,000	---	---	---	---	---	---	---	12.93	0.00	506.69
	05/10/88	1,400	10,000	3,000	19,000	86,000	---	---	---	---	---	---	---	13.03	0.00	506.59
	06/10/88	---	---	---	---	---	---	---	---	---	---	---	---	14.11	0.00	505.51
	07/25/88	---	---	---	---	---	---	---	---	---	---	---	---	12.95	0.00	506.67
	10/13/88	300	600	260	1,600	5,300	---	---	---	---	---	---	---	13.14	0.00	506.48
	01/01/89	---	---	---	---	---	---	---	---	---	---	---	---	12.14	0.00	507.48
	01/12/89	260	110	270	720	5,000	---	---	---	---	---	---	---	---	---	---
	04/12/89	90	190	190	680	5,000	4.0	ND	---	---	---	---	---	12.98	0.00	506.64
	06/26/89	77	250	140	610	3,600	ND	ND	---	---	---	---	---	13.39	0.00	506.23
	10/13/89	32	81	100	530	3,500	ND	ND	---	---	---	---	---	13.40	0.00	506.22
	01/03/90	20	97	65	410	3,200	---	1	---	---	---	---	---	13.18	0.00	506.44
	05/08/90	17	140	ND	400	1,800	---	1.6	---	ND	---	ND	---	13.39	0.00	506.23
	09/29/90	58	210	260	2,100	8,000	---	1.0	ND	ND	2.4	1.6	---	13.32	0.00	506.30
	01/03/91	4	79	59	380	2,300	---	0.5	ND	ND	ND	ND	ND	13.19	0.00	506.43
	04/12/91	---	---	---	---	---	---	---	---	---	---	---	---	12.91	0.00	506.71
	09/04/91	---	---	---	---	---	---	---	---	---	---	---	---	13.56	0.00	506.06
	04/06/92	ND	120	740	3,400	44,000	---	ND	ND	ND	ND	ND	ND	12.48	0.00	507.14
	07/28/92	220	1,100	3,000	13,000	120,000	---	---	---	---	---	---	---	13.47	0.00	506.15
	10/16/92	ND	830	3,300	9,600	570,000	---	---	---	---	---	---	---	13.95	0.00	505.67
01/14/93*	ND	25	460	980	19,000	---	---	---	---	---	---	---	10.39	0.00	509.23	
03/26/93	30	90	290	1,100	11,000**	---	---	---	---	---	---	---	9.83	0.00	509.79	
04/22/93	29	170	640	2,400	20,000	---	---	---	---	---	---	---	11.32	0.00	508.30	
07/20,21/93	130	490	1,000	4,900	32,000**	---	---	---	---	---	---	---	14.92	TRACE	504.70	
C-7 520.30	03/28/86	---	---	---	---	---	---	---	---	---	---	---	---	11.67	0.00	508.63
	03/15/88	98	690	120	120	8,000	---	---	---	---	---	---	---	13.48	0.00	506.82
	05/10/88	---	---	---	---	---	---	---	---	---	---	---	---	13.60	0.00	506.70
	06/10/88	---	---	---	---	---	---	---	---	---	---	---	---	14.68	0.00	505.62
	07/25/88	---	---	---	---	---	---	---	---	---	---	---	---	13.43	0.00	506.87
	10/13/88	4,400	220	1,000	3,000	16,000	---	---	---	---	---	---	---	13.61	0.00	506.69
	01/01/89	---	---	---	---	---	---	---	---	---	---	---	---	12.66	0.00	507.64
	01/12/89	950	47	670	640	8,000	---	---	---	---	---	---	---	---	---	---
	04/12/89	1,100	30	760	370	6,000	ND	ND	---	---	---	---	---	13.60	0.00	506.70
	06/26/89	1,300	50	600	340	6,000	ND	ND	---	---	---	---	---	13.88	0.00	506.42
	10/13/89	1,300	ND	160	150	3,900	---	ND	---	---	---	---	---	13.81	0.00	506.49
	01/03/90	1,200	13	180	200	5,600	---	1	---	---	---	---	---	13.71	0.00	506.59
	05/08/90	1,100	15	110	140	3,500	---	1.7	---	ND	---	ND	---	13.85	0.00	506.45
	09/29/90	580	ND	46	68	2,400	---	0.7	ND	ND	ND	ND	ND	13.80	0.00	506.50
	01/03/91	300	2	110	120	2,500	---	0.7	ND	ND	ND	ND	ND	13.71	0.00	506.59
	04/12/91	190	1	81	87	2,300	---	0.6	ND	ND	ND	ND	ND	13.46	0.00	506.84
	09/04/91	---	---	---	---	---	---	---	---	---	---	---	---	14.09	0.00	506.21
	10/07/91	170	1.9	97	59	4,700	---	ND	ND	24	ND	ND	ND	---	---	---
	04/06/92	95	0.8	110	100	2,400	---	ND	ND	ND	ND	ND	ND	13.02	0.00	507.28
	07/28/92	120	3.4	110	110	2,000	---	---	---	---	---	---	---	13.76	0.00	506.54
10/16/92	130	4.2	68	74	2,700	---	---	---	---	---	---	---	14.42	0.00	505.88	
01/14/93*	160	33	380	210	7,800	---	---	---	---	---	---	---	10.98	0.00	509.32	
03/26/93	39	9	28	15	1,400	---	---	---	---	---	---	---	10.61	0.00	509.69	
04/22/93	130	18	43	36	3,800	---	---	---	---	---	---	---	11.84	0.00	508.46	
07/20,21/93	35	18	61	87	1,900	---	---	---	---	---	---	---	15.36	SHEEN	504.94	

**Table 1  
HISTORICAL GROUNDWATER ANALYTICAL RESULTS AND MONITORING DATA**

CHEVRON SERVICE STATION #9-1924  
4904 SOUTHFRONT ROAD, LIVERMORE, CALIFORNIA

WELL ID/ ELEVATION (TOC)	DATE	BENZENE (ppb)	TOLUENE (ppb)	ETHYL- BENZENE (ppb)	XYLENES (ppb)	TPH-G (ppb)	TOG (ppb)	1,2- DCA (ppb)	OTHER (ppb)	MC (ppb)	1,1,1- TCA (ppb)	1,1- DCA (ppb)	PCE (ppb)	DTW (feet)	SPT (feet)	WTE (feet)
C-8 519.74	03/28/86	---	---	---	---	---	---	---	---	---	---	---	---	11.78	0.00	507.96
	03/15/88	360	25	10	ND	7,500	---	---	---	---	---	---	---	13.63	0.00	506.11
	05/10/88	---	---	---	---	---	---	---	---	---	---	---	---	13.74	0.00	506.00
	06/10/88	---	---	---	---	---	---	---	---	---	---	---	---	14.89	0.00	504.85
	07/25/88	---	---	---	---	---	---	---	---	---	---	---	---	13.65	0.00	506.09
	10/13/88	6	5.3	ND	ND	ND	---	---	---	---	---	---	---	13.78	0.00	505.96
	01/01/89	---	---	---	---	---	---	---	---	---	---	---	---	12.68	0.00	507.06
	01/12/89	37	4	1	5	ND	---	---	---	---	---	---	---	---	---	---
	04/12/89	13	ND	ND	ND	3,000	12.0	5	---	---	---	---	---	13.77	0.00	505.97
	06/26/89	14	6	ND	6	780	ND	4	---	---	---	---	---	14.03	0.00	505.71
	10/13/89	ND	ND	ND	ND	ND	ND	ND	---	---	---	---	---	14.06	0.00	505.68
	01/03/90	ND	ND	1	1	910	---	1.5	---	---	---	---	---	13.74	0.00	506.00
	05/07/90	3.9	6	0.5	3.4	620	---	1.9	---	ND	---	ND	---	14.10	0.00	505.64
	09/29/90	ND	1.4	ND	ND	77	---	ND	ND	0.6	ND	ND	---	13.97	0.00	505.77
	01/03/91	2	2	ND	2	67	---	ND	ND	0.7	ND	ND	ND	13.81	0.00	505.93
	04/12/91	4	ND	ND	ND	180	---	0.6	ND	ND	ND	ND	ND	13.60	0.00	506.14
	09/04/91	1.8	4.7	0.8	4.8	140	---	ND	ND	ND	ND	ND	ND	14.14	0.00	505.60
	04/06/92	ND	ND	ND	ND	150	---	ND	ND	ND	ND	ND	ND	13.12	0.00	506.62
	07/28/92	ND	ND	ND	0.8	90	---	---	---	---	---	---	---	14.10	0.00	505.64
	10/16/92	ND	ND	ND	ND	51	---	---	---	---	---	---	---	14.57	0.00	505.17
01/14/93*	ND	1.6	1.0	3.5	120	---	---	---	---	---	---	---	10.95	0.00	508.79	
03/26/93	---	---	---	---	---	---	---	---	---	---	---	---	---	---	---	
04/22/93	ND	0.6	0.6	0.8	68**	---	---	---	---	---	---	---	12.07	0.00	507.67	
07/20,21/93	ND	ND	ND	ND	ND	ND	---	---	---	---	---	---	15.70	0.00	504.04	
C-9 519.52	03/28/86	---	---	---	---	---	---	---	---	---	---	---	---	11.24	0.00	508.28
	03/15/88	540	560	580	3,900	29,000	---	---	---	---	---	---	---	12.92	0.00	506.60
	05/10/88	---	---	---	---	---	---	---	---	---	---	---	---	13.12	0.00	506.40
	06/10/88	---	---	---	---	---	---	---	---	---	---	---	---	14.16	0.00	505.36
	07/25/88	---	---	---	---	---	---	---	---	---	---	---	---	13.00	0.00	506.52
	10/13/88	57	8	20	150	2,200	---	---	---	---	---	---	---	13.13	0.00	506.39
	01/01/89	---	---	---	---	---	---	---	---	---	---	---	---	12.19	0.00	507.33
	01/12/89	39	12	51	46	2,000	---	---	---	---	---	---	---	---	---	
	04/12/89	16	20	55	240	6,000	ND	2.1	---	---	---	---	---	13.11	0.00	506.41
	04/11/89	14	25	45	290	6,000	---	ND	---	---	---	---	---	13.11	0.00	506.41
	06/26/89	37	63	140	690	3,900	ND	ND	---	---	---	---	---	13.40	0.00	506.12
	10/13/89	7	ND	26	50	1,300	ND	ND	---	---	---	---	---	13.46	0.00	506.06
	01/03/90	ND	0.7	202	37	1,500	---	1.5	---	---	---	---	---	13.30	0.00	506.22
	05/07/90	21	33	89	500	7,100	---	1.9	---	ND	---	ND	---	13.48	0.00	506.04
	09/29/90	21	3.9	31	110	1,000	---	1.0	ND	0.7	1.8	1.0	---	13.39	0.00	506.13
	01/03/91	ND	ND	32	140	3,200	---	0.8	ND	ND	ND	ND	ND	13.28	0.00	506.44
	04/12/91	---	---	---	---	---	---	---	---	---	---	---	---	13.00	0.00	506.72
	09/04/91	---	---	---	---	---	---	---	---	---	---	---	---	13.61	0.00	506.11
	04/06/92	ND	ND	33	130	2,800	---	ND	ND	ND	ND	ND	ND	12.54	0.00	507.18
	07/28/92	6.5	2.4	17	37	1,000	---	---	---	---	---	---	---	13.45	0.00	506.27
10/16/92	ND	730	960	2,000	190,000	---	---	---	---	---	---	---	13.98	0.00	505.74	
01/14/93*	ND	ND	27	77	2,200	---	---	---	---	---	---	---	10.44	0.00	509.28	
03/26/93	---	---	---	---	---	---	---	---	---	---	---	---	---	---		
04/22/93	60	40	68	98	7,300	---	---	---	---	---	---	---	11.43	0.00	508.29	
07/20,21/93	160	130	450	1100	30,000**	---	---	---	---	---	---	---	15.20	0.00	504.52	



**Table 1**  
**HISTORICAL GROUNDWATER ANALYTICAL RESULTS AND MONITORING DATA**

CHEVRON SERVICE STATION #9-1924  
4904 SOUTHFRONT ROAD, LIVERMORE, CALIFORNIA

WELL ID/ ELEVATION (TOC)	DATE	BENZENE (ppb)	TOLUENE (ppb)	ETHYL- BENZENE (ppb)	XYLENES (ppb)	TPH-G (ppb)	TOG (ppb)	1,2- DCA (ppb)	OTHER (ppb)	MC (ppb)	1,1,1- TCA (ppb)	1,1- DCA (ppb)	PCE (ppb)	DTW (feet)	SPT (feet)	WTE (feet)
C-10 520.41	03/28/86	---	---	---	---	---	---	---	---	---	---	---	---	---	---	---
	03/15/88	7	ND	ND	ND	90	---	---	---	---	---	---	---	14.86	0.00	505.55
	05/10/88	---	---	---	---	---	---	---	---	---	---	---	---	14.90	0.00	505.51
	06/10/88	---	---	---	---	---	---	---	---	---	---	---	---	15.94	0.00	504.47
	07/25/88	---	---	---	---	---	---	---	---	---	---	---	---	14.85	0.00	505.56
	10/13/88	ND	ND	ND	ND	ND	---	---	---	---	---	---	---	14.80	0.00	505.51
	01/01/89	---	---	---	---	---	---	---	---	---	---	---	---	14.83	0.00	505.58
	01/12/89	ND	ND	ND	ND	ND	---	---	---	---	---	---	---	---	---	---
	04/11/89	4.8	ND	ND	ND	ND	ND	ND	6.1	---	---	---	---	14.90	0.00	505.51
	06/26/89	0.7	ND	ND	ND	1.5	ND	4.0	ND	---	---	---	---	15.12	0.00	505.29
	10/13/89	ND	ND	ND	ND	ND	ND	ND	ND	---	---	---	---	15.11	0.00	505.30
	01/03/90	ND	ND	ND	ND	ND	ND	ND	3	---	---	---	---	15.01	0.00	505.40
	05/07/90	ND	ND	ND	ND	ND	ND	ND	ND	---	---	---	---	15.53	0.00	504.88
	09/27/90	ND	ND	ND	ND	ND	ND	ND	ND	1.2	ND	ND	---	15.20	0.00	505.21
	01/03/91	ND	ND	ND	ND	ND	ND	ND	ND	ND	ND	ND	ND	15.06	0.00	505.35
	04/12/91	16	ND	2.9	2.7	110	---	---	1	ND	ND	ND	ND	14.86	0.00	505.55
	09/04/91	ND	ND	ND	ND	ND	ND	ND	ND	ND	ND	ND	ND	15.22	0.00	505.19
	04/06/92	ND	ND	ND	ND	ND	57	---	1.1	ND	ND	ND	ND	14.21	0.00	506.20
	07/28/92	ND	ND	ND	ND	ND	ND	---	---	---	---	---	---	14.78	0.00	505.63
	10/16/92	ND	ND	ND	ND	ND	ND	---	---	---	---	---	---	15.51	0.00	504.90
01/14/93*	4.7	ND	2.3	1.6	88	---	---	---	---	---	---	---	13.44	0.00	506.97	
03/26/93	ND	ND	ND	ND	ND	ND	---	---	---	---	---	---	12.55	0.00	507.86	
04/22/93	ND	ND	ND	ND	ND	ND	---	---	---	---	---	---	13.74	0.00	506.67	
07/20,21/93	ND	ND	ND	ND	ND	180	---	---	---	---	---	---	16.49	0.00	503.92	
C-11 520.04	03/28/86	---	---	---	---	---	---	---	---	---	---	---	---	13.82	0.00	506.22
	03/15/88	---	---	---	---	---	---	---	---	---	---	---	---	14.49	0.00	505.55
	05/10/88	---	---	---	---	---	---	---	---	---	---	---	---	14.31	0.00	505.73
	06/10/88	---	---	---	---	---	---	---	---	---	---	---	---	15.47	0.00	504.57
	07/25/88	---	---	---	---	---	---	---	---	---	---	---	---	13.60	0.00	506.44
	10/14/88	240	33	4.7	67	2	---	---	---	---	---	---	---	14.53	0.00	505.51
	01/01/89	---	---	---	---	---	---	---	---	---	---	---	---	14.10	0.00	505.94
	01/12/89	ND	0.8	ND	ND	ND	---	---	---	---	---	---	---	---	---	---
	04/12/89	4.3	ND	ND	ND	ND	ND	4.0	ND	---	---	---	---	14.36	0.00	505.68
	06/26/89	2	ND	ND	ND	ND	ND	ND	ND	---	---	---	---	14.58	0.00	505.46
	10/13/89	ND	ND	ND	ND	ND	ND	ND	ND	---	---	---	---	14.71	0.00	505.33
	01/03/90	ND	ND	ND	0.7	ND	---	---	---	---	---	---	---	14.61	0.00	505.43
	05/08/90	12	11	0.9	22	110	---	---	---	ND	---	---	---	15.53	0.00	504.51
	09/28/90	2.0	1.4	ND	3.3	ND	---	---	---	ND	ND	ND	---	15.51	0.00	504.53
	01/03/91	2	ND	ND	2	ND	---	---	---	ND	ND	ND	---	14.63	0.00	505.41
	04/12/91	---	---	---	---	---	---	---	---	---	---	---	---	14.30	0.00	505.74
	09/04/91	---	---	---	---	---	---	---	---	---	---	---	---	14.84	0.00	505.20
	04/06/92	ND	ND	ND	ND	ND	---	---	---	ND	ND	ND	ND	13.56	0.00	506.48
	07/28/92	ND	ND	ND	ND	ND	---	---	---	---	---	---	---	14.39	0.00	505.65
	10/16/92	ND	ND	ND	ND	ND	---	---	---	---	---	---	---	15.79	0.00	504.25
01/14/93*	ND	1.3	0.7	6	94	---	---	---	---	---	---	---	12.14	0.00	507.90	
03/26/93	2	ND	0.6	1	130	---	---	---	---	---	---	---	11.81	0.00	508.23	
04/22/93	0.8	ND	ND	ND	ND	---	---	---	---	---	---	---	12.94	0.00	507.10	
07/20,21/93	3	1	ND	1	1,200	---	---	---	---	---	---	---	16.48	0.00	503.56	

**Table 1**  
**HISTORICAL GROUNDWATER ANALYTICAL RESULTS AND MONITORING DATA**

CHEVRON SERVICE STATION #9-1924  
4904 SOUTHFRONT ROAD, LIVERMORE, CALIFORNIA

WELL ID/ ELEVATION (TOC)	DATE	BENZENE (ppb)	TOLUENE (ppb)	ETHYL- BENZENE (ppb)	XYLENES (ppb)	TPH-G (ppb)	TOG (ppb)	1,2- DCA (ppb)	OTHER (ppb)	MC (ppb)	1,1,1- TCA (ppb)	1,1- DCA (ppb)	PCE (ppb)	DTW (feet)	SPT (feet)	WTE (feet)
C-12 519.82	03/28/86	--	--	--	--	--	--	--	--	--	--	--	--	13.61	0.00	506.21
	03/15/88	ND	ND	ND	ND	ND	ND	ND	ND	ND	ND	ND	ND	14.55	0.00	505.27
	05/10/88	---	---	---	---	---	---	---	---	---	---	---	---	14.57	0.00	505.25
	06/10/88	---	---	---	---	---	---	---	---	---	---	---	---	15.63	0.00	504.19
	07/25/88	---	---	---	---	---	---	---	---	---	---	---	---	14.51	0.00	505.31
	10/13/88	ND	ND	ND	ND	ND	ND	ND	ND	ND	ND	ND	ND	14.60	0.00	505.22
	01/12/89	ND	ND	ND	ND	ND	ND	ND	ND	ND	ND	ND	ND	14.62	0.00	505.20
	04/11/89	ND	ND	ND	ND	ND	ND	ND	ND	ND	ND	ND	ND	14.81	0.00	505.21
	06/26/89	ND	ND	ND	ND	ND	ND	ND	ND	ND	ND	ND	ND	14.75	0.00	505.07
	10/13/89	ND	ND	ND	ND	ND	ND	ND	ND	ND	ND	ND	ND	14.77	0.00	505.05
	01/03/90	ND	ND	ND	0.6	ND	ND	ND	ND	ND	ND	ND	ND	14.85	0.00	504.97
	05/07/90	ND	ND	ND	ND	ND	ND	ND	ND	ND	ND	ND	ND	14.75	0.00	505.07
	09/27/90	ND	ND	ND	ND	ND	ND	ND	ND	ND	1.2	ND	ND	14.61	0.00	505.21
	01/03/91	ND	ND	ND	ND	ND	ND	ND	ND	ND	ND	ND	ND	14.70	0.00	505.12
	04/12/91	---	---	---	---	---	---	---	---	---	---	---	---	14.52	0.00	505.30
	09/04/91	---	---	---	---	---	---	---	---	---	---	---	---	14.83	0.00	504.99
	04/06/92	ND	ND	ND	ND	ND	ND	ND	ND	ND	ND	ND	ND	13.81	0.00	506.01
	07/28/92	ND	ND	ND	ND	ND	ND	ND	ND	ND	ND	ND	ND	14.32	0.00	505.50
	10/16/92	ND	ND	ND	ND	ND	ND	ND	ND	ND	ND	ND	ND	15.12	0.00	504.70
	01/14/93*	ND	ND	ND	ND	1.7	65	---	---	---	---	---	---	13.23	0.00	506.59
03/26/93	0.9	ND	ND	ND	ND	ND	---	---	---	---	---	---	12.20	0.00	507.62	
04/22/93	ND	ND	ND	ND	ND	ND	---	---	---	---	---	---	13.21	0.00	506.61	
07/20,21/93	ND	ND	ND	ND	ND	ND	---	---	---	---	---	---	16.71	0.00	503.11	
C-13 522.24	03/28/86	--	--	--	--	--	--	--	--	--	--	--	--	12.95	0.00	509.29
	03/15/88	2	ND	9	3	250	---	---	---	---	---	---	---	14.82	0.00	507.42
	05/10/88	---	---	---	---	---	---	---	---	---	---	---	---	15.03	0.00	507.21
	06/10/88	---	---	---	---	---	---	---	---	---	---	---	---	16.10	0.00	506.14
	07/25/88	---	---	---	---	---	---	---	---	---	---	---	---	14.73	0.00	507.51
	10/13/88	1.9	ND	ND	ND	ND	---	---	---	---	---	---	---	14.91	0.00	507.33
	01/01/89	---	---	---	---	---	---	---	---	---	---	---	---	14.10	0.00	508.14
	01/12/89	ND	0.6	4	ND	ND	---	---	---	---	---	---	---	---	---	---
	04/10/89	ND	ND	8	ND	ND	ND	ND	ND	ND	ND	ND	ND	14.99	0.00	507.25
	06/26/89	0.3	ND	ND	ND	ND	ND	ND	ND	ND	ND	ND	ND	15.16	0.00	507.08
	10/13/89	ND	ND	ND	ND	ND	ND	ND	ND	ND	ND	ND	ND	15.23	0.00	507.01
	01/03/90	ND	ND	0.5	0.6	ND	ND	ND	ND	ND	ND	ND	ND	15.15	0.00	507.09
	05/08/90	ND	ND	ND	ND	ND	ND	ND	ND	ND	ND	ND	ND	15.02	0.00	507.22
	09/27/90	ND	0.6	ND	ND	ND	ND	ND	ND	ND	ND	ND	ND	15.11	0.00	507.13
	01/03/91	ND	ND	ND	0.6	ND	ND	---	---	---	---	---	---	15.08	0.00	507.16
	04/12/91	---	---	---	---	---	---	---	---	---	---	---	---	14.77	0.00	507.47
	09/04/91	---	---	---	---	---	---	---	---	---	---	---	---	15.43	0.00	506.81
	04/06/92	ND	ND	ND	ND	66	---	---	---	---	---	---	---	14.43	0.00	507.81
	07/28/92	8.2	ND	ND	1.1	60	---	---	---	---	---	---	---	15.37	0.00	506.87
	10/16/92	ND	ND	ND	ND	ND	---	---	---	---	---	---	---	15.87	0.00	506.37
01/14/93*	ND	ND	ND	1.3	100	---	---	---	---	---	---	---	12.83	0.00	509.41	
03/26/93	ND	ND	ND	ND	ND	---	---	---	---	---	---	---	12.59	0.00	509.65	
04/22/93	ND	ND	ND	ND	ND	---	---	---	---	---	---	---	13.16	0.00	509.08	
07/20,21/93	4	13	2	7	99	---	---	---	---	---	---	---	16.52	0.00	505.72	

**Table 1  
HISTORICAL GROUNDWATER ANALYTICAL RESULTS AND MONITORING DATA**

CHEVRON SERVICE STATION #9-1924  
4904 SOUTHFRONT ROAD, LIVERMORE, CALIFORNIA

WELL ID/ ELEVATION (TOC)	DATE	BENZENE (ppb)	TOLUENE (ppb)	ETHYL- BENZENE (ppb)	XYLENES (ppb)	TPH-G (ppb)	TOG (ppb)	1,2- DCA (ppb)	OTHER (ppb)	MC (ppb)	1,1,1- TCA (ppb)	1,1- DCA (ppb)	PCE (ppb)	DTW (feet)	SPT (feet)	WTE (feet)
C-14 520.08	03/28/86	---	---	---	---	---	---	---	---	---	---	---	---	---	---	---
	03/15/88	---	---	---	---	---	---	---	---	---	---	---	---	---	---	---
	05/10/88	19,000	29,000	2,700	18	120,000	---	---	---	---	---	---	---	13.39	0.00	506.69
	06/10/88	---	---	---	---	---	---	---	---	---	---	---	---	14.65	0.00	505.43
	07/25/88	---	---	---	---	---	---	---	---	---	---	---	---	13.47	0.00	506.61
	10/13/88	ND	ND	ND	ND	ND	---	---	---	---	---	---	---	13.58	0.00	506.50
	01/01/89	---	---	---	---	---	---	---	---	---	---	---	---	13.00	0.00	507.08
	01/12/89	ND	ND	ND	ND	NS	---	---	---	---	---	---	---	---	---	---
	04/12/89	ND	ND	ND	ND	NS	ND	ND	---	---	---	---	---	13.47	0.00	506.61
	06/26/89	14,000	25,000	3,400	26,000	140,000	---	30	---	---	---	---	---	13.80	0.00	506.28
	10/13/89	12,000	16,000	1,600	13,000	86,000	---	---	---	---	---	---	---	13.62	0.00	506.46
	01/03/90	9,500	16,000	1,800	13,000	120,000	---	---	25	3	---	---	---	13.91	0.00	506.17
	01/04/90	3,900	8,100	1,200	7,700	76,000	---	---	18	1	---	---	---	13.91	0.00	506.17
	05/08/90	7,500	17,000	1,400	14,000	62,000	---	---	13	---	ND	---	ND	13.89	0.00	506.19
	09/27/90	---	---	---	---	---	---	---	---	---	---	---	---	13.78	0.00	506.30
	01/03/91	---	---	---	---	---	---	---	---	---	---	---	---	13.72	0.00	506.36
	04/12/91	750	3,800	720	9,200	60,000	---	---	ND	ND	ND	ND	ND	12.97	0.00	507.11
	09/04/91	2,800	11,000	1,300	13,000	110,000	---	---	---	---	---	---	---	13.84	0.00	506.24
	04/06/92	190	1,800	440	5,100	41,000	---	---	ND	ND	ND	ND	ND	12.44	0.00	507.64
	07/28/92	2,300	9,700	1,800	15,000	130,000	---	---	---	---	---	---	---	13.70	0.00	506.38
10/16/92	---	---	---	---	---	---	---	---	---	---	---	---	14.38	0.00	505.70	
01/14/93*	220	790	220	2,700	27,000	---	---	---	---	---	---	---	8.80	0.00	511.28	
03/26/93	330	1,600	460	4,000	23,000**	---	---	---	---	---	---	---	9.12	0.00	510.96	
04/22/93	840	2,300	130	3,500	17,000	---	---	---	---	---	---	---	12.10	SHEEN	507.98	
07/20,21/93	---	---	---	---	---	---	---	---	---	---	---	---	---	---	---	---
C-15 522.41	03/28/86	---	---	---	---	---	---	---	---	---	---	---	---	13.14	0.00	509.27
	03/15/88	ND	ND	ND	ND	ND	---	---	---	---	---	---	---	15.13	0.00	507.28
	05/10/88	---	---	---	---	---	---	---	---	---	---	---	---	15.40	0.00	507.01
	06/10/88	---	---	---	---	---	---	---	---	---	---	---	---	16.49	0.00	505.92
	07/25/88	---	---	---	---	---	---	---	---	---	---	---	---	15.17	0.00	507.24
	10/13/88	ND	ND	ND	ND	ND	---	---	---	---	---	---	---	15.33	0.00	507.08
	01/01/89	---	---	---	---	---	---	---	---	---	---	---	---	13.70	0.00	508.71
	01/12/89	ND	ND	ND	ND	ND	---	---	---	---	---	---	---	---	---	---
	04/12/89	ND	ND	ND	ND	ND	ND	ND	---	---	---	---	---	15.34	0.00	507.07
	06/26/89	ND	ND	ND	ND	ND	ND	ND	---	---	---	---	---	15.72	0.00	506.69
	10/13/89	ND	ND	ND	ND	ND	ND	ND	---	---	---	---	---	15.96	0.00	506.45
	01/03/90	ND	ND	ND	ND	ND	ND	ND	---	---	---	---	---	15.42	0.00	506.99
	05/08/90	ND	ND	ND	ND	ND	ND	ND	---	---	---	---	---	15.62	0.00	506.79
	09/27/90	ND	ND	ND	ND	ND	ND	ND	---	---	---	---	---	15.59	0.00	506.82
	01/03/91	ND	ND	ND	ND	0.6	ND	ND	ND	ND	ND	ND	ND	15.50	0.00	506.91
	04/12/91	---	---	---	---	---	---	---	---	---	---	---	---	15.21	0.00	507.20
	09/04/91	---	---	---	---	---	---	---	---	---	---	---	---	15.90	0.00	506.51
	04/06/92	ND	ND	ND	ND	ND	ND	ND	ND	ND	ND	ND	ND	14.88	0.00	507.53
	07/28/92	ND	ND	ND	ND	ND	ND	ND	ND	ND	ND	ND	ND	15.82	0.00	506.59
	10/16/92	ND	ND	ND	ND	ND	ND	ND	ND	ND	ND	ND	ND	16.25	0.00	506.16
01/14/93*	ND	1.9	0.8	5.1	61	ND	ND	ND	ND	ND	ND	ND	12.48	0.00	509.93	
03/26/93	ND	ND	ND	1	ND	ND	ND	ND	ND	ND	ND	ND	12.67	0.00	509.74	
04/22/93	ND	ND	ND	ND	ND	ND	ND	ND	ND	ND	ND	ND	13.60	0.00	508.81	
07/20,21/93	ND	ND	ND	ND	ND	ND	ND	ND	ND	ND	ND	ND	16.87	0.00	505.54	

**Table 1  
HISTORICAL GROUNDWATER ANALYTICAL RESULTS AND MONITORING DATA**

CHEVRON SERVICE STATION #9-1924  
4904 SOUTHFRONT ROAD, LIVERMORE, CALIFORNIA

WELL ID/ ELEVATION (TOC)	DATE	BENZENE (ppb)	TOLUENE (ppb)	ETHYL- BENZENE (ppb)	XYLENES (ppb)	TPH-G (ppb)	TOG (ppb)	1,2- DCA (ppb)	OTHER (ppb)	MC (ppb)	1,1,1- TCA (ppb)	1,1- DCA (ppb)	PCE (ppb)	DTW (feet)	SPT (feet)	WTE (feet)
C-16 519.68	03/28/86	---	---	---	---	---	---	---	---	---	---	---	---	---	---	---
	03/15/88	---	---	---	---	---	---	---	---	---	---	---	---	---	---	---
	05/10/88	1,000	73	140	180	4,500	---	---	---	---	---	---	---	13.78	0.00	505.90
	06/10/88	---	---	---	---	---	---	---	---	---	---	---	---	14.88	0.00	504.80
	07/25/88	---	---	---	---	---	---	---	---	---	---	---	---	13.69	0.00	505.99
	10/13/88	16	5.5	ND	16	1,600	---	---	---	---	---	---	---	13.80	0.00	505.88
	01/01/89	---	---	---	---	---	---	---	---	---	---	---	---	13.45	0.00	506.23
	01/12/89	360	11	78	51	1,000	---	---	---	---	---	---	---	---	---	---
	04/11/89	130	4	21	19	15,800	ND	8	---	---	---	---	---	13.78	0.00	505.90
	06/26/89	170	8	37	43	1,300	ND	ND	---	---	---	---	---	14.02	0.00	505.66
	10/13/89	20	ND	7	ND	1,000	ND	ND	---	---	---	---	---	14.01	0.00	505.67
	01/03/90	150	3	41	24	1,300	---	5	---	---	---	---	---	13.97	0.00	505.71
	05/07/90	49	4.4	29	13	480	---	4.5	---	---	---	---	---	14.45	0.00	505.23
	09/29/90	18	2.1	11	8.0	360	---	1.8	ND	ND	ND	ND	---	14.32	0.00	505.36
	01/03/91	12	ND	6	6	230	---	2	ND	0.8	ND	ND	ND	13.96	0.00	505.72
	04/12/91	---	---	---	---	---	---	---	---	---	---	---	---	13.74	0.00	505.94
	09/04/91	---	---	---	---	---	---	---	---	---	---	---	---	14.22	0.00	505.46
	04/06/92	30	ND	14	12.0	360	---	1.0	ND	ND	ND	ND	ND	13.18	0.00	506.50
	07/28/92	31	ND	6.8	16	210	---	---	---	---	---	---	---	13.93	0.00	505.75
	10/16/92	11	ND	5.1	3.4	140	---	---	---	---	---	---	---	14.92	0.00	504.76
01/14/93*	24	ND	36	21	740	---	---	---	---	---	---	---	11.81	0.00	507.87	
03/26/93	22	2	16	10	730	---	---	---	---	---	---	---	11.36	0.00	508.32	
04/22/93	46	ND	24	6	850	---	---	---	---	---	---	---	12.30	0.00	507.38	
07/20,21/93	---	---	---	---	---	---	---	---	---	---	---	---	---	---	---	---
C-17 520.82	03/28/86	---	---	---	---	---	---	---	---	---	---	---	---	13.48	0.00	507.34
	03/15/88	---	---	---	---	---	---	---	---	---	---	---	---	14.76	0.00	506.06
	05/10/88	---	---	---	---	---	---	---	---	---	---	---	---	14.77	0.00	506.05
	06/10/88	---	---	---	---	---	---	---	---	---	---	---	---	15.84	0.00	504.98
	07/25/88	---	---	---	---	---	---	---	---	---	---	---	---	14.63	0.00	506.19
	10/13/88	18	900	760	5,500	270,000	---	---	---	---	---	---	---	14.83	0.00	505.99
	01/01/89	---	---	---	---	---	---	---	---	---	---	---	---	14.78	0.00	506.04
	01/12/89	ND	490	2,100	6,700	190,000	---	---	---	---	---	---	---	---	---	---
	04/11/89	30	150	320	1,000	27,000	6.0	ND	---	---	---	---	---	14.83	0.00	505.99
	06/26/89	50	390	660	2,000	20,000	ND	ND	---	---	---	---	---	15.03	0.00	505.79
	06/26/89	40	420	740	2,200	27,000	---	ND	---	---	---	---	---	15.03	0.00	505.79
	10/13/89	ND	48	230	480	17,000	ND	ND	---	---	---	---	---	15.02	0.00	505.80
	01/03/90	ND	29	120	210	14,000	---	---	---	---	---	---	---	15.10	0.00	505.72
	05/08/90	25	130	210	470	9,500	---	ND	---	---	---	---	---	15.12	0.00	505.70
	09/29/90	ND	ND	ND	ND	ND	---	ND	ND	ND	1.9	ND	---	14.99	0.00	505.83
	09/29/90	ND	3.4	ND	ND	ND	---	ND	ND	1.8	1.9	ND	---	14.99	0.00	505.83
	01/03/91	ND	28	56	140	3,700	---	ND	ND	1.8	1.9	ND	ND	14.92	0.00	505.90
	01/03/91	ND	10	59	150	8,600	---	ND	ND	ND	ND	ND	ND	14.92	0.00	505.90
	04/12/91	ND	5	47	120	8,600	---	ND	ND	ND	ND	ND	ND	14.71	0.00	506.11
	04/12/91	ND	11	48	120	4,400	---	ND	ND	ND	ND	ND	ND	14.71	0.00	506.11
09/04/91	ND	27	49	79	5,800	---	ND	ND	ND	ND	ND	ND	15.17	0.00	505.65	
09/04/91	ND	21	36	61	4,100	---	ND	ND	ND	ND	ND	ND	15.17	0.00	505.65	
04/06/92	ND	5.8	27	29	2,300	---	ND	ND	ND	ND	ND	ND	14.14	0.00	506.68	
07/28/92	99	180	170	430	11,000	---	---	---	---	---	---	---	15.18	0.00	505.64	
10/16/92	ND	4,800	3,900	6,600	1,200,000	---	---	---	---	---	---	---	15.76	0.00	505.06	
01/14/93*	9.3	9.1	23	34	3,500	---	---	---	---	---	---	---	13.44	0.00	507.38	
03/26/93	ND	19	20	35	3,700**	---	---	---	---	---	---	---	12.46	0.00	508.36	
04/22/93	16	68	44	97	8,900	---	---	---	---	---	---	---	13.30	0.00	507.52	
07/20,21/93	5	35	33	62	4,200	---	---	---	---	---	---	---	17.21	0.00	503.61	

**Table 1  
HISTORICAL GROUNDWATER ANALYTICAL RESULTS AND MONITORING DATA**

CHEVRON SERVICE STATION #9-1924  
4904 SOUTHFRONT ROAD, LIVERMORE, CALIFORNIA

WELL ID/ ELEVATION (TOC)	DATE	BENZENE (ppb)	TOLUENE (ppb)	ETHYL- BENZENE (ppb)	XYLENES (ppb)	TPH-G (ppb)	TOG (ppb)	1,2- DCA (ppb)	OTHER (ppb)	MC (ppb)	1,1,1- TCA (ppb)	1,1- DCA (ppb)	PCE (ppb)	DTW (feet)	SPT (feet)	WTE (feet)
C-18 518.96	03/28/86	---	---	---	---	---	---	---	---	---	---	---	---	---	---	---
	03/15/88	---	---	---	---	---	---	---	---	---	---	---	---	---	---	---
	05/10/88	---	---	---	---	---	---	---	---	---	---	---	---	---	---	---
	06/10/88	---	---	---	---	---	---	---	---	---	---	---	---	---	---	---
	07/25/88	---	---	---	---	---	---	---	---	---	---	---	---	14.89	0.00	504.07
	10/13/88	---	---	---	---	---	---	---	---	---	---	---	---	13.79	0.00	505.17
	01/01/89	ND	ND	ND	ND	ND	---	---	---	---	---	---	---	13.86	0.00	505.10
	01/12/89	ND	ND	ND	ND	ND	ND	---	---	---	---	---	---	13.94	0.00	505.02
	04/11/89	ND	ND	ND	ND	ND	ND	---	---	---	---	---	---	---	0.00	518.96
	06/26/89	ND	ND	ND	ND	ND	ND	ND	3.6	---	---	---	---	14.86	0.00	504.10
	10/13/89	ND	ND	ND	ND	ND	ND	ND	3.1	---	---	---	---	14.02	0.00	504.94
	01/03/90	ND	ND	ND	ND	ND	ND	ND	ND	---	---	---	---	15.06	0.00	503.90
	05/07/90	ND	ND	ND	ND	ND	ND	ND	1	---	---	---	---	14.07	0.00	504.89
	09/27/90	ND	ND	ND	ND	ND	ND	ND	ND	ND	---	---	---	14.01	0.00	504.95
	01/03/91	ND	ND	ND	ND	ND	ND	ND	ND	ND	ND	ND	ND	13.91	0.00	505.05
	04/12/91	ND	ND	ND	ND	ND	ND	ND	ND	ND	ND	ND	ND	13.98	0.00	504.98
	09/04/91	ND	ND	ND	ND	ND	ND	ND	ND	ND	ND	ND	ND	13.83	0.00	505.13
	04/06/92	ND	ND	ND	ND	ND	ND	ND	ND	ND	ND	ND	ND	14.20	0.00	504.76
	07/28/92	ND	ND	ND	ND	ND	ND	ND	ND	ND	ND	ND	ND	13.07	0.00	505.89
	10/16/92	ND	ND	ND	ND	ND	ND	ND	---	---	---	---	---	13.55	0.00	505.41
01/14/93*	ND	ND	ND	ND	1.8	56	---	---	---	---	---	---	14.38	0.00	504.58	
03/26/93	ND	ND	ND	ND	ND	ND	---	---	---	---	---	---	12.46	0.00	506.50	
04/22/93	ND	ND	ND	ND	ND	ND	---	---	---	---	---	---	11.46	0.00	507.50	
07/20,21/93	ND	0.5	ND	ND	ND	92	---	---	---	---	---	---	12.58	0.00	506.38	
														15.64	0.00	503.32

**Table 1  
HISTORICAL GROUNDWATER ANALYTICAL RESULTS AND MONITORING DATA**

CHEVRON SERVICE STATION #9-1924  
4904 SOUTHFRONT ROAD, LIVERMORE, CALIFORNIA

WELL ID/ ELEVATION (TOC)	DATE	BENZENE (ppb)	TOLUENE (ppb)	ETHYL- BENZENE (ppb)	XYLENES (ppb)	TPH-G (ppb)	TOG (ppb)	1,2- DCA (ppb)	OTHER (ppb)	MC (ppb)	1,1,1- TCA (ppb)	1,1- DCA (ppb)	PCE (ppb)	DTW (feet)	SPT (feet)	WTE (feet)
C-19 520.99	03/28/86	---	---	---	---	---	---	---	---	---	---	---	---	---	---	---
	03/15/88	---	---	---	---	---	---	---	---	---	---	---	---	---	---	---
	05/10/88	1,400	360	350	1,300	18	---	---	---	---	---	---	---	15.23	0.00	505.76
	06/10/88	---	---	---	---	---	---	---	---	---	---	---	---	16.58	0.00	504.41
	07/25/88	---	---	---	---	---	---	---	---	---	---	---	---	15.19	0.00	505.80
	10/13/88	8.3	4.7	4.4	ND	ND	---	---	---	---	---	---	---	15.27	0.00	505.72
	01/01/89	---	---	---	---	---	---	---	---	---	---	---	---	15.20	0.00	505.79
	01/12/89	5	4	ND	ND	ND	---	---	---	---	---	---	---	---	---	---
	04/11/89	1.8	ND	ND	ND	ND	ND	13	---	---	---	---	---	15.24	0.00	505.75
	04/11/89	1.2	ND	0.6	0.6	500	---	14	---	---	---	---	---	15.24	0.00	505.75
	06/26/89	2.5	ND	ND	ND	500	ND	26	---	---	---	---	---	15.44	0.00	505.55
	10/13/89	ND	ND	ND	ND	540	ND	13	13	---	---	---	---	15.47	0.00	505.52
	01/03/90	1.2	0.7	1.3	0.9	ND	---	11	---	---	---	---	---	15.45	0.00	505.54
	05/07/90	ND	ND	ND	ND	ND	---	4.6	---	ND	---	ND	---	15.68	0.00	505.31
	09/28/90	ND	ND	ND	ND	ND	---	ND	ND	1.2	ND	ND	---	15.52	0.00	505.47
	01/03/91	ND	ND	ND	ND	66	---	1	ND	ND	ND	ND	0.9	15.56	0.00	505.43
	04/12/91	---	---	---	---	---	---	---	---	---	---	---	---	15.20	0.00	505.79
	09/04/91	---	---	---	---	---	---	---	---	---	---	---	---	15.60	0.00	505.39
	04/06/92	0.7	ND	1.0	ND	110	---	1.9	ND	ND	ND	ND	ND	14.58	0.00	506.41
	07/28/92	1.4	ND	1.0	4.2	ND	---	---	---	---	---	---	---	15.26	0.00	505.73
10/16/92	ND	ND	ND	ND	ND	---	---	---	---	---	---	---	16.00	0.00	504.99	
01/14/93*	1.1	ND	0.9	0.9	100	---	---	---	---	---	---	---	13.69	0.00	507.30	
03/26/93	ND	ND	ND	ND	ND	---	---	---	---	---	---	---	12.96	0.00	508.03	
04/22/93	0.6	1	1	1	250**	---	---	---	---	---	---	---	14.18	0.00	506.81	
07/20,21/93	ND	ND	0.8	2	390**	---	---	---	---	---	---	---	16.58	0.00	504.41	

**Explanation**

Elevations are expressed as feet above mean sea level.

TOC = Top of casing

WTE = Water table elevation (well elevation - (DTW - (SPT x 0.8))

DTW = Depth to water

SPT = Separate-phase hydrocarbon thickness

TPH-G = Total Petroleum Hydrocarbons as Gasoline (ppb)

TOG = Total Oil & Grease (EPA Method 503D & 503E)

\* = Rinsate sample contaminated; resampled 03/26/93

\*\* = Uncategorized compound not included in gasoline hydrocarbon total

\*\*\* = Hydrocarbon pattern uncharacteristic of fresh gasoline

PCE = Tetrachloroethene

1,2-DCA = 1,2-Dichloroethane

MC = Methylene Chloride

TCA = 1,1,1-Trichloroethane

1,1-DCA = 1,1-Dichloroethane

ND = Not detected at or above the minimum quantitation limit (MQL)

--- = Not sampled, not monitored, inaccessible

OTHER = 5 ppb Carbon Disulfide detected in C-1 on 10/13/89

3 ppb Vinyl Chloride detected in C-14 on 1/3/90

1 ppb Vinyl Chloride detected in C-14 on 1/4/90

13 ppb Carbon Disulfide detected in C-19 on 10/13/89

**ATTACHMENT I**

**ANALYTICAL LABORATORY REPORTS**

**AND**

**CHAIN-OF-CUSTODY MANIFESTS**



# GTEL

ENVIRONMENTAL  
LABORATORIES, INC.

4080 Pike Lane  
Concord, CA 94520  
(510) 685-7852  
(800) 544-3422 Inside CA  
(800) 423-7143 Outside CA  
(510) 825-0720 FAX

Client Number: 020704233  
Consultant Project Number: 020704233  
Facility Number: 9-1924  
Project ID: 4904 South Front Rd.  
Livermore, CA  
Work Order Number: C3-07-0346

August 3, 1993

Bruce Eppler  
Groundwater Technology, Inc.  
1401 Halyard Drive, Suite 140  
West Sacramento, CA 95691

Enclosed please find the analytical results for samples received by GTEL Environmental Laboratories, Inc. on 07/22/93.

A formal Quality Assurance/Quality Control (QA/QC) program is maintained by GTEL, which is designed to meet or exceed the EPA requirements. Analytical work for this project met QA/QC criteria, unless otherwise stated in the footnotes.

GTEL is certified by the California State Department of Health Services, Laboratory certification number E1075, to perform analyses for drinking water, wastewater, and hazardous waste materials according to EPA protocols.

If you have any questions concerning this analysis or if we can be of further assistance, please call our Customer Service Representative.

Sincerely,  
GTEL Environmental Laboratories, Inc.

Eileen F. Bullen  
Laboratory Director



Client Number: 020704233  
 Consultant Project Number: 020704233  
 Facility Number: 9-1924  
 Project ID: 4904 South Front Rd.  
 Livermore, CA  
 Work Order Number: C3-07-0346

Table 1

ANALYTICAL RESULTS

Aromatic Volatile Organics and  
 Total Petroleum Hydrocarbons as Gasoline in Water

EPA Methods 5030, 8020, and Modified 8015<sup>a</sup>

GTEL Sample Number		01	02	03	04
Client Identification		FIELD BLANK	RINSATE C-11	C-11	C-12
Date Sampled		07/21/93	07/21/93	07/21/93	07/21/93
Date Analyzed		07/30/93	07/30/93	07/30/93	07/30/93
Analyte	Detection Limit, ug/L	Concentration, ug/L			
Benzene	0.5	<0.5	<0.5	3	<0.5
Toluene	0.5	<0.5	<0.5	1	<0.5
Ethylbenzene	0.5	<0.5	<0.5	<0.5	<0.5
Xylene, total	0.5	<0.5	<0.5	1	<0.5
BTEX, total	--	--	--	5	--
TPH as Gasoline	50	<50	<50	1200	<50
Detection Limit Multiplier		1	1	1	1
BFB surrogate, % recovery		103	98.8	92.4	89.9

a. Test Methods for Evaluating Solid Waste, SW-846, Third Edition, Revision 0, US EPA November 1986. Modification for TPH as gasoline as per California State Water Resources Control Board LUFT Manual protocols, May 1988 revision. Bromofluorobenzene surrogate recovery acceptability limits are 70 - 130%.

Client Number: 020704233  
 Consultant Project Number: 020704233  
 Facility Number: 9-1924  
 Project ID: 4904 South Front Rd.  
 Livermore, CA  
 Work Order Number: C3-07-0346

**Table 1 (Continued)**

**ANALYTICAL RESULTS**

**Aromatic Volatile Organics and  
 Total Petroleum Hydrocarbons as Gasoline in Water**

**EPA Methods 5030, 8020, and Modified 8015<sup>a</sup>**

GTEL Sample Number		05	06	07	08
Client Identification		C-15	C-18	C-10	C-13
Date Sampled		07/21/93	07/21/93	07/21/93	07/21/93
Date Analyzed		07/30/93	07/30/93	07/31/93	07/31/93
Analyte	Detection Limit, ug/L	Concentration, ug/L			
Benzene	0.5	<0.5	<0.5	<0.5	4
Toluene	0.5	<0.5	0.5	<0.5	13
Ethylbenzene	0.5	<0.5	<0.5	<0.5	2
Xylene, total	0.5	<0.5	<0.5	<0.5	7
BTEX, total	--	--	1	--	25
TPH as Gasoline	50	<50	92	100	99
Detection Limit Multiplier		1	1	1	1
BFB surrogate, % recovery		89.2	92.6	92.9	90.5

a. Test Methods for Evaluating Solid Waste, SW-846, Third Edition, Revision 0, US EPA November 1986. Modification for TPH as gasoline as per California State Water Resources Control Board LUFT Manual protocols, May 1988 revision. Bromofluorobenzene surrogate recovery acceptability limits are 70 - 130%.

Client Number: 020704233  
 Consultant Project Number: 020704233  
 Facility Number: 9-1924  
 Project ID: 4904 South Front Rd.  
 Livermore, CA  
 Work Order Number: C3-07-0346  
 Date Reissued: 08-05-93

**Table 1 (Continued)**

**ANALYTICAL RESULTS**

**Aromatic Volatile Organics and  
 Total Petroleum Hydrocarbons as Gasoline in Water**

EPA Methods 5030, 8020, and Modified 8015<sup>a</sup>

GTEL Sample Number		09	10	11	12
Client Identification		C-3	C-19	C-8	C-5
Date Sampled		07/21/93	07/21/93	07/21/93	07/21/93
Date Analyzed		07/31/93	07/31/93	07/31/93	07/31/93
Analyte	Detection Limit, ug/L	Concentration, ug/L			
Benzene	0.5	<0.5	<0.5	<0.5	18
Toluene	0.5	<0.5	<0.5	<0.5	5
Ethylbenzene	0.5	<0.5	0.8	<0.5	8
Xylene, total	0.5	<0.5	2	<0.5	14
BTEX, total	--	--	3	--	45
TPH as Gasoline	50	<50	390*	<50	970*
Detection Limit Multiplier		1	1	1	1
BFB surrogate, % recovery		93.7	92.4	91.8	103

a. Test Methods for Evaluating Solid Waste, SW-846, Third Edition, Revision 0, US EPA November 1986. Modification for TPH as gasoline as per California State Water Resources Control Board LUFT Manual protocols, May 1988 revision. Bromofluorobenzene surrogate recovery acceptability limits are 70 - 130%.

\* Uncategorized compound is not included in gasoline hydrocarbon total.

Client Number: 020704233  
 Consultant Project Number: 020704233  
 Facility Number: 9-1924  
 Project ID: 4904 South Front Rd.  
 Livermore, CA  
 Work Order Number: C3-07-0346

**Table 1 (Continued)**

**ANALYTICAL RESULTS**

**Aromatic Volatile Organics and  
 Total Petroleum Hydrocarbons as Gasoline in Water**

**EPA Methods 5030, 8020, and Modified 8015<sup>a</sup>**

GTEL Sample Number		13	14	15	16
Client Identification		RINSATE C-1	C-1	C-2	C-17
Date Sampled		07/21/93	07/21/93	07/21/93	07/21/93
Date Analyzed		07/31/93	08/01/93	07/31/93	07/31/93
Analyte	Detection Limit, ug/L	Concentration, ug/L			
Benzene	0.5	<0.5	73	28	5
Toluene	0.5	<0.5	11	8	35
Ethylbenzene	0.5	<0.5	470	4	33
Xylene, total	0.5	<0.5	470	4	62
BTEX, total	--	--	1000	44	140
TPH as Gasoline	50	<50	7100*	1100*	4200
Detection Limit Multiplier		1	5	1	1
BFB surrogate, % recovery		90.4	105	102	122

a. Test Methods for Evaluating Solid Waste, SW-846, Third Edition, Revision 0, US EPA November 1986. Modification for TPH as gasoline as per California State Water Resources Control Board LUFT Manual protocols, May 1988 revision. Bromofluorobenzene surrogate recovery acceptability limits are 70 - 130%.

\* Uncategorized compound is not included in gasoline hydrocarbon total.

Client Number: 020704233  
 Consultant Project Number: 020704233  
 Facility Number: 9-1924  
 Project ID: 4904 South Front Rd.  
 Livermore, CA  
 Work Order Number: C3-07-0346

Table 1 (Continued)

ANALYTICAL RESULTS

Aromatic Volatile Organics and  
 Total Petroleum Hydrocarbons as Gasoline in Water

EPA Methods 5030, 8020, and Modified 8015<sup>a</sup>

GTEL Sample Number		17	18	19	Q073093
Client Identification		C-7	C-9	C-6	METHOD BLANK
Date Sampled		07/21/93	07/21/93	07/21/93	-
Date Analyzed		07/31/93	08/02/93	08/02/93	07/30/93
Analyte	Detection Limit, ug/L	Concentration, ug/L			
Benzene	0.5	35	160	130	<0.5
Toluene	0.5	18	130	490	<0.5
Ethylbenzene	0.5	61	450	1000	<0.5
Xylene, total	0.5	87	1100	4900	<0.5
BTEX, total	-	200	1800	6500	-
TPH as Gasoline	50	1900	30000*	32000*	<50
Detection Limit Multiplier		1	10	10	1
BFB surrogate, % recovery		110	115	108	90.3

a. Test Methods for Evaluating Solid Waste, SW-846, Third Edition, Revision 0, US EPA November 1986. Modification for TPH as gasoline as per California State Water Resources Control Board LUFT Manual protocols, May 1988 revision. Bromofluorobenzene surrogate recovery acceptability limits are 70 - 130%.

\* Uncategorized compound not included in the gasoline hydrocarbon concentrations.

Client Number: 020704233  
Consultant Project Number: 020704233  
Facility Number: 9-1924  
Project ID: 4904 South Front Rd.  
Livermore, CA  
Work Order Number: C3-07-0346

### QC Matrix Spike and Duplicate Spike Results

Matrix: Water

Analyte	Sample ID	Spike Amount	Units	Recovery, %	Duplicate Recovery, %	RPD, %	Control Limits
<b>Modified EPA 8020:</b>							
Benzene	C3070397-03	20.0	ug/L	93.0	95.0	2.1	55 - 129
Toluene	C3070397-03	20.0	ug/L	101	103	1.9	72 - 149
Ethylbenzene	C3070397-03	20.0	ug/L	92.0	94.0	2.2	75 - 138
Xylene, total	C3070397-03	60.0	ug/L	94.8	96.3	1.6	74 - 147

fax copy of Lab Report and COC to Chevron Contact:  No

Chain-of-Custody-Rec

Chevron U.S.A. Inc.  
P.O. BOX 5004  
San Ramon, CA 94583  
FAX (415)842-9591

Chevron Facility Number 9-1924  
Facility Address 4904 South Front Rd Livermore, Ca  
Consultant Project Number 0207042330610  
Consultant Name Groundwater Technology  
Address 1401 Halyard Dr. St. 140 W/Santa 95078  
Project Contact (Name) Bruce Feffer  
(Phone) 916-372-4200 (Fax Number) 372-8781

Chevron Contact (Name) Brett Hunter  
(Phone) 510-842-8625  
Laboratory Name GTEL  
Laboratory Release Number 9033280  
Samples Collected by (Name) Steven Thompson  
Collection Date 7/21/93  
Signature [Signature]

Sample Number	Lab Sample Number	Number of Containers	Matrix S = Soil W = Water A = Air C = Charcoal	Type G = Grab C = Composite D = Discrete	Time	Sample Preservation	Iced (Yes or No)	Analyses To Be Performed										NOTE: Do NOT BILL TB-LB SAMPLING ON THIS 7/22/93 Remarks			
								BTEX + TPH GAS (8020 + 8015)	TPH Diesel (8015)	Oil and Grease (5520)	Purgeable Halocarbons (8010)	Purgeable Aromatics (8020)	Purgeable Organics (8240)	Extractable Organics (8270)	Metals Cd, Cr, Pb, Zn, Ni (ICAP or AA)						
Field Blank	01	2	W	G	8:40	HCL	Yes	2													
Rinsate C-1	02				8:50																
C-11	03				8:55																
C-12	04				9:00																
C-15	05				9:20																
C-18	06				9:30																
C-10	07				9:40																
C-13	08				9:50																
C-3	09				10:00																
C-19	10				10:10																
C-8	11				10:20																
<del>C-1</del>	<del>12</del>				<del>10:30</del>																
C-5	12				10:40																
Rinsate C-1	13				10:50																

C3070346

Relinquished By (Signature) <u>[Signature]</u>	Organization <u>GTEL</u>	Date/Time <u>7/21/93 6:37am</u>	Received By (Signature) <u>John Weber</u>	Organization <u>GTEL</u>	Date/Time <u>7/22 12:00</u>	Turn Around Time (Circle Choice) 24 hrs. 48 hrs. 5 Days 10 Days <u>As Controlled</u>
Relinquished By (Signature) <u>John Weber</u>	Organization <u>GTEL</u>	Date/Time <u>7/21/93 1:30</u>	Received By (Signature)	Organization	Date/Time	
Relinquished By (Signature)	Organization	Date/Time	Received For Laboratory By (Signature) <u>[Signature]</u>		Date/Time <u>7/22/93 1:30</u>	

COC TO CONTACT-200

Chevron U.S.A. Inc.  
P.O. BOX 5004  
San Ramon, CA 94583  
FAX (415)842-9591

Chevron Facility Number 9-1924  
Facility Address 4904 South Fruit Rd Livermore  
Consultant Project Number 0207042330610  
Consultant Name Ground Water Technology  
Address 1401 Halgard Dr St.140 W/Santa  
Project Contact (Name) Bruce Epler 95691  
(Phone) 916-372-4200 (Fax Number) 372-3781

Chevron Contact (Name) Brett Hunter  
(Phone) 510-842-8695  
Laboratory Name GTEL  
Laboratory Release Number 9033280  
Samples Collected by (Name) Esteban Thompson  
Collection Date 7/21/93  
Signature [Signature]

Sample Number	Lab Sample Number	Number of Containers	Matrix S = Soil W = Water C = Charcoal	Type C = Grab C = Composite D = Discrete	Time	Sample Preservation	Iced (Yes or No)	Analyses To Be Performed													
								BTEX + TPH GAS (8020 + 8015)	TPH Diesel (8015)	Oil and Grease (5520)	Purgeable Halocarbons (8010)	Purgeable Aromatics (8020)	Purgeable Organics (8240)	Extractable Organics (8270)	Metals Cd, Cr, Pb, Zn, Ni (ICAP or AA)						
C-1	14	2	W	G	11:00	HCL	Yes	2													
C-2	15				11:10																
C-17	16				11:20																
C-7	17				11:30																
C-9	18				11:40																
<del>C-18</del>																					
C-6	19	✓	✓	✓	12:00	✓	✓	✓													

NOTE:  
Do NOT BIL  
TB-LB SAMP  
SEAL IN THE  
ON IC  
7/22/93  
Remarks

**C3070346**

Relinquished By (Signature) <u>[Signature]</u>	Organization <u>GTE</u>	Date/Time <u>7/21/93 6:37 AM</u>	Received By (Signature) <u>John Weber</u>	Organization <u>GTEL</u>	Date/Time <u>7/22 1200</u>	Turn Around Time (Circle Choice) 24 hrs. 48 hrs. 5 Days <u>10 Days</u> As Contracted
Relinquished By (Signature) <u>John Weber</u>	Organization <u>GTEL</u>	Date/Time <u>7/22/93</u>	Received By (Signature) <u>[Signature]</u>	Organization	Date/Time	
Relinquished By (Signature)	Organization	Date/Time	Received For Laboratory By (Signature) <u>[Signature]</u>		Date/Time <u>7/22/93</u>	

Form: 2 (Rev. 11-82)



**GROUNDWATER  
TECHNOLOGY, INC.**

1401 Halyard Drive, Suite 140, West Sacramento, CA 95691, (916) 372-4700

FAX (916) 372-8781

December 2, 1993

Project No. 02070 4233

Mr. Brett L. Hunter  
Chevron U.S.A. Products Company  
2410 Camino Ramon  
San Ramon, CA 94583-0804

**RE: QUARTERLY MONITORING AND SAMPLING ACTIVITIES  
CHEVRON SERVICE STATION 9-1924  
4904 SOUTHFRONT ROAD  
LIVERMORE, CALIFORNIA**

Dear Mr. Hunter:

Groundwater Technology, Inc. submits this letter as a summary of quarterly groundwater monitoring and sampling data collected at the above-referenced site on October 20, 1993. The eighteen site-related groundwater monitoring wells were gauged to determine depth to groundwater (DTW) and to check for the presence of separate-phase petroleum hydrocarbons (SP). A potentiometric surface map (Figure 1) and a summary of groundwater monitoring data (Table 1) are included. The October 20, 1993 potentiometric surface map includes data collected on the same date by Kaprelian Engineering, Inc. for the Unocal station northwest of the Chevron site. After measuring DTW, sixteen monitoring wells were purged and sampled. Well MW-14 was not sampled due to insufficient water in the well, and MW-18 is suspected to be paved over with asphalt. The groundwater samples were analyzed for dissolved benzene, toluene, ethylbenzene and xylenes (BTEX), and total petroleum hydrocarbons-as-gasoline (TPH-G). Results of the chemical analyses are summarized in Table 1. Laboratory reports and chain-of-custody manifests are included in Attachment I. All purge water generated during sampling was collected in a Department of Transportation (DOT)-approved purge water trailer and transported for recycling to the Chevron refinery in Richmond, California.

Groundwater Technology, Inc. is pleased to assist Chevron on this project. If you have any questions or comments please call our West Sacramento office.

Sincerely,  
**Groundwater Technology, Inc.**  
Written/Submitted by

**Groundwater Technology, Inc.**  
Reviewed/Approved by

  
\_\_\_\_\_  
BRUCE H. EPPLER  
Environmental Geologist  
Project Manager

  
\_\_\_\_\_  
E. K. SIMONIS, R.G.  
Senior Environmental Geologist

PR   
DSB/BHE/EKS:rz  
Attachments  
4233QTR4.LTR

Offices throughout the U.S., Canada and Overseas

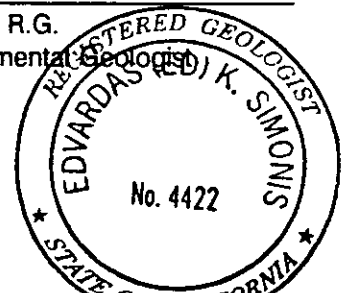

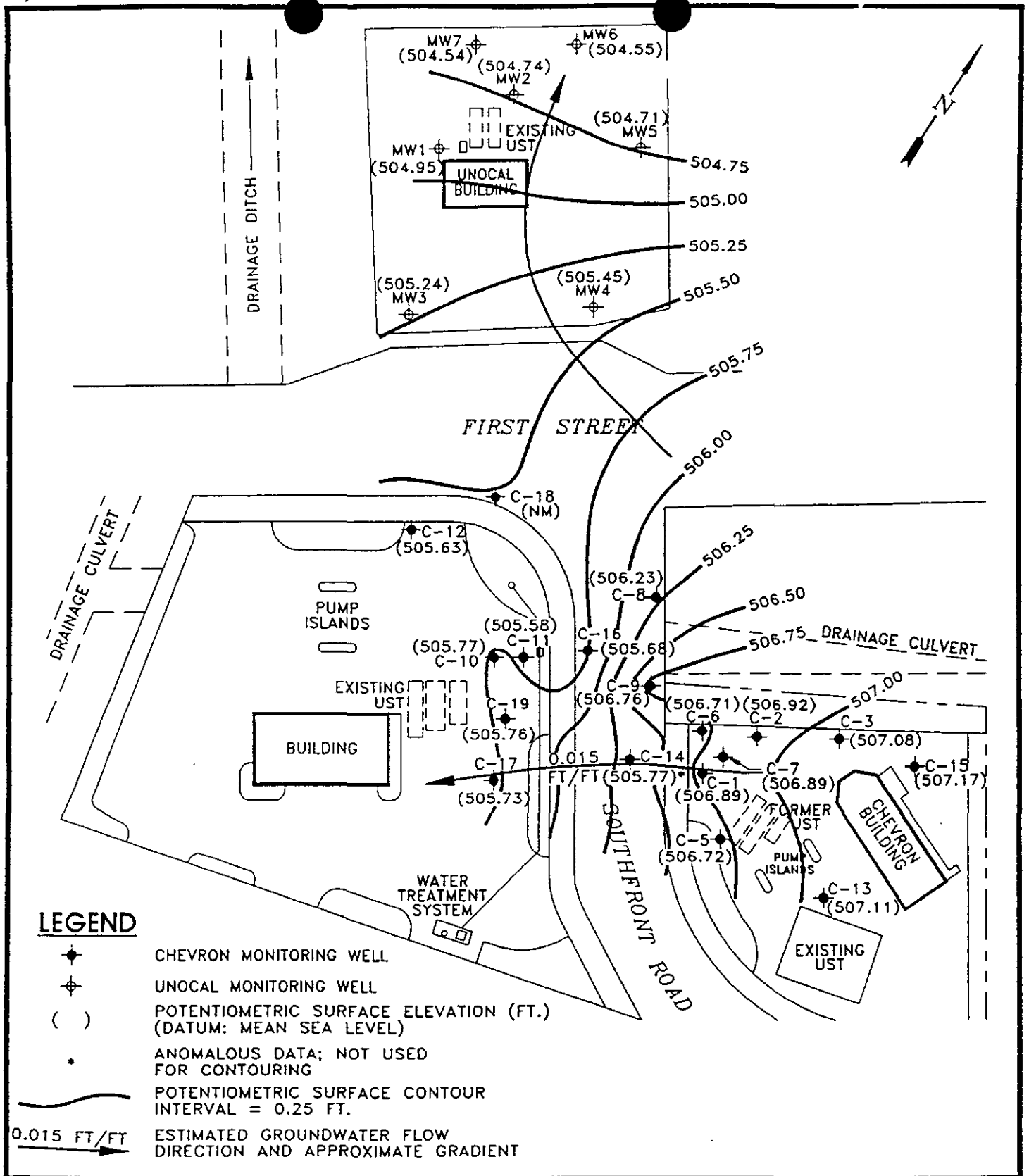

				<b>POTENTIOMETRIC SURFACE MAP OCTOBER 20, 1993</b>	
<b>CLIENT:</b> CHEVRON U.S.A. PRODUCTS CO. SERVICE STATION NO. 9-1924		<b>FILE:</b> 4233SMA/4233PSM		<b>PROJECT NO.:</b> 02070-4233	
<b>LOCATION:</b> 4904 SOUTHFRONT ROAD LIVERMORE, CALIFORNIA		<b>REV.</b> 1		<b>FIGURE:</b> 1	
		<b>DES.</b> DSB	<b>DET.</b> AJK	<b>DATE:</b> 11/23/93	

**Table 1  
HISTORICAL GROUNDWATER ANALYTICAL RESULTS AND MONITORING DATA**

CHEVRON SERVICE STATION #9-1924  
4904 SOUTHFRONT ROAD, LIVERMORE, CALIFORNIA

WELL ID/ ELEVATION (TOC)	DATE	BENZENE (ppb)	TOLUENE (ppb)	ETHYL- BENZENE (ppb)	XYLENES (ppb)	TPH-G (ppb)	TOG (ppb)	1,2- DCA (ppb)	OTHER (ppb)	MC (ppb)	1,1,1- TCA (ppb)	1,1- DCA (ppb)	PCE (ppb)	DTW (feet)	SPT (feet)	WTE (feet)
C-1 520.39	03/28/86	---	---	---	---	---	---	---	---	---	---	---	---	11.75	0.00	508.64
	03/15/88	770	87	610	2,100	27,000	---	---	---	---	---	---	---	13.50	0.00	506.89
	05/10/88	---	---	---	---	---	---	---	---	---	---	---	---	13.65	0.00	506.74
	06/10/88	---	---	---	---	---	---	---	---	---	---	---	---	14.72	0.00	505.67
	07/25/88	---	---	---	---	---	---	---	---	---	---	---	---	13.50	0.00	506.89
	10/13/88	220	11	62	130	3,200	---	---	---	---	---	---	---	12.89	0.00	507.50
	01/01/89	---	---	---	---	---	---	---	---	---	---	---	---	12.89	0.00	507.50
	01/12/89	820	43	490	260	4,000	---	---	---	---	---	---	---	---	---	---
	04/10/89	100	ND	70	50	4,000	ND	ND	---	---	---	---	---	13.65	0.00	506.74
	04/10/89	100	ND	60	50	4,000	---	ND	---	---	---	---	---	13.65	0.00	506.74
	06/26/89	97	20	60	50	600	ND	3	---	---	---	---	---	13.94	0.00	506.45
	06/26/89	86	15	44	35	570	---	1.7	---	---	---	---	---	13.94	0.00	506.45
	10/13/89	64	ND	51	48	1,600	ND	ND	5	---	---	---	---	13.92	0.00	506.47
	01/03/90	36	0.68	30	30	1,100	---	1	---	---	---	---	---	13.80	0.00	506.59
	05/08/90	37	9.2	40	32	1,300	---	1.2	---	ND	---	ND	---	13.91	0.00	506.48
	09/29/90	19	1.2	32	31	350	---	ND	ND	0.7	1.4	ND	---	13.93	0.00	506.46
	01/03/91	12	ND	17	14	400	---	ND	ND	ND	ND	ND	---	13.85	0.00	506.54
	04/12/91	---	---	---	---	---	---	---	---	---	---	---	---	13.51	0.00	506.88
	09/04/91	---	---	---	---	---	---	---	---	---	---	---	---	14.10	0.00	506.29
	04/06/92	12	0.8	31	31	1,000	---	ND	ND	ND	ND	ND	---	13.06	0.00	507.33
07/28/92	47	110	96	260	4,200	---	---	---	---	---	---	---	13.93	0.00	506.46	
10/16/92	11	ND	32.0	55.0	1,800	---	---	---	---	---	---	---	14.45	0.00	505.94	
01/14/93*	24	ND	98	62	2,000	---	---	---	---	---	---	---	11.23	0.00	509.16	
03/26/93	21	12	120	100	4,400	---	---	---	---	---	---	---	10.94	0.00	509.45	
04/22/93	26	44	580	330	18,000	---	---	---	---	---	---	---	16.25	SHEEN	504.14	
07/20,21/93	73	11	470	470	7,100**	---	---	---	---	---	---	---	15.29	0.00	505.10	
10/20/93	19	26	260	190	880**	---	---	---	---	---	---	---	13.50	0.00	506.89	
C-2 520.76	03/28/86	---	---	---	---	---	---	---	---	---	---	---	---	11.98	0.00	508.78
	03/15/88	3,900	1,900	1,200	1,200	22,000	---	---	---	---	---	---	---	13.77	0.00	506.99
	05/10/88	---	---	---	---	---	---	---	---	---	---	---	---	14.03	0.00	506.73
	06/10/88	---	---	---	---	---	---	---	---	---	---	---	---	15.12	0.00	505.64
	07/25/88	---	---	---	---	---	---	---	---	---	---	---	---	13.86	0.00	506.90
	10/13/88	ND	ND	ND	ND	ND	---	---	---	---	---	---	---	14.11	0.00	506.65
	01/01/89	---	---	---	---	---	---	---	---	---	---	---	---	12.83	0.00	507.93
	01/12/89	25	3	83	59	1,000	---	---	---	---	---	---	---	---	---	---
	04/10/89	2.5	ND	15	12	600	ND	ND	---	---	---	---	---	14.04	0.00	506.72
	04/10/89	ND	ND	11	11	ND	---	ND	---	---	---	---	---	14.04	0.00	506.72
	06/26/89	5.3	8	18	14	640	ND	ND	---	---	---	---	---	14.34	0.00	506.42
	06/26/89	3.7	0.6	13	8.2	750	---	2	---	---	---	---	---	14.34	0.00	506.42
	10/13/89	ND	ND	17	10	630	---	ND	---	---	---	---	---	13.92	0.00	506.84
	01/03/90	3	ND	19	17	880	---	1	---	---	---	---	---	14.11	0.00	506.65
	05/08/90	1.3	2.7	8.4	11	340	---	1.1	---	ND	---	ND	---	14.28	0.00	506.48
	09/29/90	ND	ND	4.6	1.8	74	---	ND	ND	1.7	0.5	ND	---	14.25	0.00	506.51
	01/03/91	270	ND	79	93	2,000	---	ND	ND	ND	ND	ND	---	14.15	0.00	506.61
	04/12/91	---	---	---	---	---	---	---	---	---	---	---	---	13.86	0.00	506.90
	09/04/91	---	---	---	---	---	---	---	---	---	---	---	---	14.50	0.00	506.26
	04/06/92	ND	ND	54.0	6.1	1,200	---	ND	ND	ND	ND	ND	---	13.47	0.00	507.29
07/28/92	5.2	2.9	26	16	1,000	---	---	---	---	---	---	---	14.35	0.00	506.41	
10/16/92	ND	2.2	20	10	2,000	---	---	---	---	---	---	---	14.84	0.00	505.92	
01/14/93*	49	50	31	29	1,800	---	---	---	---	---	---	---	11.22	0.00	509.54	
03/26/93	15	12	14	6	820**	---	---	---	---	---	---	---	10.77	0.00	509.99	
04/22/93	12	12	28	29	2,000	---	---	---	---	---	---	---	12.93	0.00	507.83	
07/20,21/93	28	8	4	4	1,100**	---	---	---	---	---	---	---	16.02	0.00	504.74	
10/20/93	140	18	22	27	1,600**	---	---	---	---	---	---	---	16.84	0.00	506.92	

**Table 1  
HISTORICAL GROUNDWATER ANALYTICAL RESULTS AND MONITORING DATA**

CHEVRON SERVICE STATION #9-1924  
4904 SOUTHFRONT ROAD, LIVERMORE, CALIFORNIA

WELL ID/ ELEVATION (TOC)	DATE	BENZENE (ppb)	TOLUENE (ppb)	ETHYL- BENZENE (ppb)	XYLENES (ppb)	TPH-G (ppb)	TOG (ppb)	1,2- DCA (ppb)	OTHER (ppb)	MC (ppb)	1,1,1- TCA (ppb)	1,1- DCA (ppb)	PCE (ppb)	DTW (feet)	SPT (feet)	WTE (feet)
C-3 521.31	03/28/86	---	---	---	---	---	---	---	---	---	---	---	---	12.24	0.00	509.07
	03/15/88	86	8	30	36.0	2,100	---	---	---	---	---	---	---	14.21	0.00	507.10
	05/10/88	---	---	---	---	---	---	---	---	---	---	---	---	14.43	0.00	506.88
	06/10/88	---	---	---	---	---	---	---	---	---	---	---	---	15.53	0.00	505.78
	07/25/88	---	---	---	---	---	---	---	---	---	---	---	---	14.22	0.00	507.09
	10/13/88	ND	ND	ND	ND	ND	---	---	---	---	---	---	---	14.10	0.00	507.21
	01/01/89	---	---	---	---	---	---	---	---	---	---	---	---	12.70	0.00	508.61
	04/10/89	2.1	ND	4.4	2.6	200	ND	1.4	---	---	---	---	---	14.36	0.00	506.95
	06/26/89	1.1	0.7	4.9	1.6	260	ND	1.5	---	---	---	---	---	14.74	0.00	506.57
	10/13/89	ND	ND	ND	ND	ND	---	ND	---	---	---	---	---	14.70	0.00	506.61
	01/03/90	ND	ND	0.9	1.4	ND	---	0.7	---	---	---	---	---	14.42	0.00	506.89
	05/08/90	ND	ND	ND	ND	ND	---	0.7	---	ND	---	ND	---	14.65	0.00	506.66
	09/27/90	ND	1.0	ND	ND	ND	---	ND	ND	1.1	1.6	ND	---	14.67	0.00	506.64
	01/03/91	ND	ND	ND	ND	ND	---	ND	ND	ND	ND	ND	---	14.58	0.00	506.73
	04/12/91	ND	ND	1.6	ND	98	---	ND	ND	ND	ND	ND	---	14.23	0.00	507.08
	09/04/91	ND	ND	ND	ND	84	---	ND	ND	ND	ND	ND	---	14.88	0.00	506.43
	04/06/92	ND	ND	0.8	ND	88	---	ND	ND	ND	ND	ND	---	13.83	0.00	507.48
	07/28/92	ND	ND	0.5	1.1	80	---	---	---	---	---	---	---	14.80	0.00	506.51
	10/16/92	ND	ND	6.6	11	1,400	---	---	---	---	---	---	---	15.23	0.00	506.08
	01/14/93*	ND	ND	ND	1.3	100	---	---	---	---	---	---	---	11.45	0.00	509.86
03/26/93	0.7	1	ND	ND	74	---	---	---	---	---	---	---	11.27	0.00	510.04	
04/22/93	ND	ND	ND	ND	ND***	---	---	---	---	---	---	---	12.61	0.00	508.70	
07/20,21/93	ND	ND	ND	ND	ND	---	---	---	---	---	---	---	16.17	0.00	505.14	
10/20/93	ND	1	ND	0.8	ND	---	---	---	---	---	---	---	14.23	0.00	507.08	
C-5 520.82	03/28/86	---	---	---	---	---	---	---	---	---	---	---	---	12.00	0.00	508.82
	03/15/88	82	7	77	95	1,600	---	---	---	---	---	---	---	13.75	0.00	507.07
	05/10/88	---	---	---	---	---	---	---	---	---	---	---	---	13.92	0.00	506.90
	07/10/88	---	---	---	---	---	---	---	---	---	---	---	---	13.72	0.00	507.10
	07/25/88	---	---	---	---	---	---	---	---	---	---	---	---	13.72	0.00	507.10
	10/13/88	ND	ND	ND	ND	2,500	---	---	---	---	---	---	---	13.84	0.00	506.98
	01/01/89	---	---	---	---	---	---	---	---	---	---	---	---	13.41	0.00	507.41
	01/12/89	42	3	44	52	ND	---	---	---	---	---	---	---	---	0.00	520.82
	04/10/89	2.6	ND	6.2	5.5	180	ND	1.4	---	---	---	---	---	13.88	---	---
	06/26/89	7.6	0.8	40	58	420	ND	1.5	---	---	---	---	---	14.14	0.00	506.68
	10/13/89	ND	ND	10	ND	620	ND	ND	---	---	---	---	---	14.15	0.00	506.67
	01/03/90	0.7	ND	8	6	ND	---	ND	---	---	---	---	---	14.10	0.00	506.72
	05/08/90	0.6	0.8	11	7.2	140	---	0.8	---	ND	---	ND	---	14.00	0.00	506.82
	09/27/90	ND	3.2	5.2	6.4	360	---	ND	ND	0.7	ND	ND	---	14.00	0.00	506.82
	01/03/91	ND	ND	ND	3	90	---	ND	ND	ND	ND	ND	---	14.00	0.00	506.82
	04/12/91	12	ND	19	7	270	---	0.5	ND	ND	ND	ND	---	13.71	0.00	507.11
	09/04/91	ND	ND	ND	ND	ND	---	ND	ND	ND	ND	ND	---	14.30	0.00	506.52
	04/06/92	12	ND	40	ND	670	---	ND	ND	ND	ND	ND	---	13.29	0.00	507.53
	07/28/92	15	ND	1.8	0.5	130	---	---	---	---	---	---	---	14.13	0.00	506.69
	10/16/92	ND	ND	ND	1.2	ND	---	---	---	---	---	---	---	14.68	0.00	506.14
01/14/93*	13	ND	110	10	2,300	---	---	---	---	---	---	---	11.87	0.00	508.95	
03/26/93	---	---	---	---	---	---	---	---	---	---	---	---	---	---	---	---
04/22/93	220	18	120	65	2,300**	---	---	---	---	---	---	---	12.12	0.00	508.70	
07/20,21/93	18	5	8	14	970**	---	---	---	---	---	---	---	16.04	0.00	504.78	
10/20/93	7	5	3	15	2,200	---	---	---	---	---	---	---	14.10	0.00	506.72	

**Table 1  
HISTORICAL GROUNDWATER ANALYTICAL RESULTS AND MONITORING DATA**

CHEVRON SERVICE STATION #9-1924  
4904 SOUTHFRONT ROAD, LIVERMORE, CALIFORNIA

WELL ID/ ELEVATION (TOC)	DATE	BENZENE (ppb)	TOLUENE (ppb)	ETHYL- BENZENE (ppb)	XYLENES (ppb)	TPH-G (ppb)	TOG (ppb)	1,2- DCA (ppb)	OTHER (ppb)	MC (ppb)	1,1,1- TCA (ppb)	1,1- DCA (ppb)	PCE (ppb)	DTW (feet)	SPT (feet)	WTE (feet)
C-6 519.62	03/26/86	---	---	---	---	---	---	---	---	---	---	---	---	11.12	0.00	508.50
	03/15/88	870	4,600	1,500	8,200	46,000	---	---	---	---	---	---	---	12.93	0.00	506.69
	05/10/88	1,400	10,000	3,000	19,000	86,000	---	---	---	---	---	---	---	13.03	0.00	506.59
	06/10/88	---	---	---	---	---	---	---	---	---	---	---	---	14.11	0.00	505.51
	07/25/88	---	---	---	---	---	---	---	---	---	---	---	---	12.95	0.00	506.67
	10/13/88	300	600	260	1,600	5,300	---	---	---	---	---	---	---	13.14	0.00	506.48
	01/01/89	---	---	---	---	---	---	---	---	---	---	---	---	12.14	0.00	507.48
	01/12/89	260	110	270	720	5,000	---	---	---	---	---	---	---	---	---	---
	04/12/89	90	190	190	680	5,000	4.0	ND	---	---	---	---	---	12.98	0.00	506.64
	06/26/89	77	250	140	610	3,600	ND	ND	---	---	---	---	---	13.39	0.00	506.23
	10/13/89	32	81	100	530	3,500	ND	ND	---	---	---	---	---	13.40	0.00	506.22
	01/03/90	20	97	65	410	3,200	---	1	---	---	---	---	---	13.18	0.00	506.44
	05/08/90	17	140	ND	400	1,800	---	1.6	ND	ND	---	ND	---	13.39	0.00	506.23
	09/29/90	58	210	260	2,100	8,000	---	1.0	ND	ND	2.4	1.8	---	13.32	0.00	506.30
	01/03/91	4	79	59	380	2,300	---	0.5	ND	ND	ND	ND	ND	13.19	0.00	506.43
	04/12/91	---	---	---	---	---	---	---	---	---	---	---	---	12.91	0.00	506.71
	09/04/91	---	---	---	---	---	---	---	---	---	---	---	---	13.56	0.00	506.06
	04/06/92	ND	120	740	3,400	44,000	---	ND	ND	ND	ND	ND	ND	12.48	0.00	507.14
	07/28/92	220	1,100	3,000	13,000	120,000	---	---	---	---	---	---	---	13.47	0.00	506.15
	10/16/92	ND	830	3,300	9,600	570,000	---	---	---	---	---	---	---	13.95	0.00	505.67
01/14/93*	ND	25	460	980	19,000	---	---	---	---	---	---	---	10.39	0.00	509.23	
03/26/93	30	90	290	1,100	11,000**	---	---	---	---	---	---	---	9.83	0.00	509.79	
04/22/93	29	170	640	2,400	20,000	---	---	---	---	---	---	---	11.32	0.00	508.30	
07/20,21/93	130	490	1,000	4,900	32,000**	---	---	---	---	---	---	---	14.92	TRACE	504.70	
10/20/93	290	790	2,500	7,600	77,000**	---	---	---	---	---	---	---	12.91	0.00	506.71	
C-7 520.30	03/28/86	---	---	---	---	---	---	---	---	---	---	---	---	11.67	0.00	508.63
	03/15/88	98	690	120	120	8,000	---	---	---	---	---	---	---	13.48	0.00	506.82
	05/10/88	---	---	---	---	---	---	---	---	---	---	---	---	13.60	0.00	506.70
	06/10/88	---	---	---	---	---	---	---	---	---	---	---	---	14.68	0.00	505.62
	07/25/88	---	---	---	---	---	---	---	---	---	---	---	---	13.43	0.00	506.87
	10/13/88	4,400	220	1,000	3,000	16,000	---	---	---	---	---	---	---	13.61	0.00	506.69
	01/01/89	---	---	---	---	---	---	---	---	---	---	---	---	12.66	0.00	507.64
	01/12/89	950	47	670	640	8,000	---	---	---	---	---	---	---	---	---	---
	04/12/89	1,100	30	760	370	6,000	ND	ND	---	---	---	---	---	13.60	0.00	506.70
	06/26/89	1,300	50	600	340	6,000	ND	ND	---	---	---	---	---	13.88	0.00	506.42
	10/13/89	1,300	ND	160	150	3,900	---	ND	---	---	---	---	---	13.81	0.00	506.49
	01/03/90	1,200	13	180	200	5,600	---	1	---	---	---	---	---	13.71	0.00	506.59
	05/08/90	1,100	15	110	140	3,500	---	1.7	---	ND	---	ND	---	13.85	0.00	506.45
	09/29/90	580	ND	46	68	2,400	---	0.7	ND	ND	ND	ND	ND	13.80	0.00	506.50
	01/03/91	300	2	110	120	2,500	---	0.7	ND	ND	ND	ND	ND	13.71	0.00	506.59
	04/12/91	190	1	81	87	2,300	---	0.6	ND	ND	ND	ND	ND	13.46	0.00	506.84
	09/04/91	---	---	---	---	---	---	---	---	---	---	---	---	14.09	0.00	506.21
	10/07/91	170	1.9	97	59	4,700	---	ND	ND	24	ND	ND	ND	---	---	---
	04/06/92	95	0.8	110	100	2,400	---	ND	ND	ND	ND	ND	ND	13.02	0.00	507.28
	07/28/92	120	3.4	110	110	2,000	---	---	---	---	---	---	---	13.76	0.00	506.54
10/16/92	130	4.2	68	74	2,700	---	---	---	---	---	---	---	14.42	0.00	505.88	
01/14/93*	160	33	380	210	7,800	---	---	---	---	---	---	---	10.98	0.00	509.32	
03/26/93	39	9	28	15	1,400	---	---	---	---	---	---	---	10.61	0.00	509.69	
04/22/93	130	18	43	38	3,800	---	---	---	---	---	---	---	11.84	0.00	508.46	
07/20,21/93	35	18	61	87	1,900	---	---	---	---	---	---	---	15.36	SHEEN	504.94	
10/20/93	72	26	250	180	5,500	---	---	---	---	---	---	---	13.41	0.00	506.89	

**Table 1  
HISTORICAL GROUNDWATER ANALYTICAL RESULTS AND MONITORING DATA**

CHEVRON SERVICE STATION #9-1924  
4904 SOUTHFRONT ROAD, LIVERMORE, CALIFORNIA

WELL ID/ ELEVATION (TOC)	DATE	BENZENE (ppb)	TOLUENE (ppb)	ETHYL- BENZENE (ppb)	XYLENES (ppb)	TPH-G (ppb)	TOG (ppb)	1,2- DCA (ppb)	OTHER (ppb)	MC (ppb)	1,1,1- TCA (ppb)	1,1- DCA (ppb)	PCE (ppb)	DTW (feet)	SPT (feet)	WTE (feet)
C-8 519.74	03/28/86	---	---	---	---	---	---	---	---	---	---	---	---	11.78	0.00	507.96
	03/15/88	360	25	10	ND	7,500	---	---	---	---	---	---	---	13.63	0.00	506.11
	05/10/88	---	---	---	---	---	---	---	---	---	---	---	---	13.74	0.00	506.00
	06/10/88	---	---	---	---	---	---	---	---	---	---	---	---	14.89	0.00	504.85
	07/25/88	---	---	---	---	---	---	---	---	---	---	---	---	13.65	0.00	506.09
	10/13/88	6	5.3	ND	ND	ND	---	---	---	---	---	---	---	13.78	0.00	505.96
	01/01/89	---	---	---	---	---	---	---	---	---	---	---	---	12.68	0.00	507.06
	01/12/89	37	4	1	5	ND	---	---	---	---	---	---	---	---	---	---
	04/12/89	13	ND	ND	ND	3,000	12.0	5	---	---	---	---	---	13.77	0.00	505.97
	06/26/89	14	6	ND	6	780	ND	4	---	---	---	---	---	14.03	0.00	505.71
	10/13/89	ND	ND	ND	ND	ND	ND	ND	---	---	---	---	---	14.06	0.00	505.68
	01/03/90	ND	ND	1	1	910	---	---	1.5	---	---	---	---	13.74	0.00	506.00
	05/07/90	3.9	6	0.5	3.4	620	---	---	1.9	---	ND	ND	---	14.10	0.00	505.64
	09/29/90	ND	1.4	ND	ND	77	---	---	ND	ND	ND	ND	---	13.97	0.00	505.77
	01/03/91	2	2	ND	2	67	---	---	ND	ND	0.7	ND	ND	13.81	0.00	505.93
	04/12/91	4	ND	ND	ND	180	---	---	0.6	ND	ND	ND	ND	13.60	0.00	506.14
	09/04/91	1.8	4.7	0.8	4.8	140	---	---	ND	ND	ND	ND	ND	14.14	0.00	505.60
	04/06/92	ND	ND	ND	ND	150	---	---	ND	ND	ND	ND	ND	13.12	0.00	506.62
	07/28/92	ND	ND	ND	0.8	90	---	---	---	---	---	---	---	14.10	0.00	505.64
	10/16/92	ND	ND	ND	ND	51	---	---	---	---	---	---	---	14.57	0.00	505.17
01/14/93*	ND	1.6	1.0	3.5	120	---	---	---	---	---	---	---	10.95	0.00	508.79	
03/26/93	---	---	---	---	---	---	---	---	---	---	---	---	---	---	---	---
04/22/93	ND	0.8	0.6	0.8	68**	---	---	---	---	---	---	---	12.07	0.00	507.67	
07/20,21/93	ND	ND	ND	ND	ND	---	---	---	---	---	---	---	15.70	0.00	504.04	
10/20/93	ND	ND	ND	ND	ND	---	---	---	---	---	---	---	13.51	0.00	506.23	
C-9 519.52	03/28/86	---	---	---	---	---	---	---	---	---	---	---	---	11.24	0.00	508.28
	03/15/88	540	560	580	3,900	29,000	---	---	---	---	---	---	---	12.92	0.00	506.60
	05/10/88	---	---	---	---	---	---	---	---	---	---	---	---	13.12	0.00	506.40
	06/10/88	---	---	---	---	---	---	---	---	---	---	---	---	14.16	0.00	505.36
	07/25/88	---	---	---	---	---	---	---	---	---	---	---	---	13.00	0.00	506.52
	10/13/88	57	8	20	150	2,200	---	---	---	---	---	---	---	13.13	0.00	506.39
	01/01/89	---	---	---	---	---	---	---	---	---	---	---	---	12.19	0.00	507.33
	01/12/89	39	12	51	46	2,000	---	---	---	---	---	---	---	---	---	---
	04/12/89	16	20	55	240	6,000	ND	2.1	---	---	---	---	---	13.11	0.00	506.41
	04/11/89	14	25	45	290	6,000	---	---	ND	---	---	---	---	13.11	0.00	506.41
	06/26/89	37	63	140	690	3,900	ND	ND	---	---	---	---	---	13.40	0.00	506.12
	10/13/89	7	ND	26	50	1,300	ND	ND	---	---	---	---	---	13.46	0.00	506.06
	01/03/90	ND	0.7	202	37	1,500	---	---	1.5	---	---	---	---	13.30	0.00	506.22
	05/07/90	21	33	89	500	7,100	---	---	1.9	---	ND	ND	---	13.48	0.00	506.04
	09/29/90	21	3.9	31	110	1,000	---	---	1.0	ND	0.7	1.8	1.0	13.39	0.00	506.13
	01/03/91	ND	ND	32	140	3,200	---	---	0.8	ND	ND	ND	ND	13.28	0.00	506.44
	04/12/91	---	---	---	---	---	---	---	---	---	---	---	---	13.00	0.00	506.72
	09/04/91	---	---	---	---	---	---	---	---	---	---	---	---	13.61	0.00	506.11
	04/06/92	ND	ND	33	130	2,800	---	---	ND	ND	ND	ND	ND	12.54	0.00	507.18
	07/28/92	6.5	2.4	17	37	1,000	---	---	---	---	---	---	---	13.45	0.00	506.27
10/16/92	ND	730	960	2,000	190,000	---	---	---	---	---	---	---	13.98	0.00	505.74	
01/14/93*	ND	ND	27	77	2,200	---	---	---	---	---	---	---	10.44	0.00	509.28	
03/26/93	---	---	---	---	---	---	---	---	---	---	---	---	---	---	---	---
04/22/93	60	40	68	98	7,300	---	---	---	---	---	---	---	11.43	0.00	508.29	
07/20,21/93	160	130	450	1,100	30,000**	---	---	---	---	---	---	---	15.20	0.00	504.52	
10/20/93	22	200	440	930	36,000	---	---	---	---	---	---	---	12.96	0.00	506.76	

**Table 1  
HISTORICAL GROUNDWATER ANALYTICAL RESULTS AND MONITORING DATA**

CHEVRON SERVICE STATION #9-1924  
4904 SOUTHFRONT ROAD, LIVERMORE, CALIFORNIA

WELL ID/ ELEVATION (TOC)	DATE	BENZENE (ppb)	TOLUENE (ppb)	ETHYL- BENZENE (ppb)	XYLENES (ppb)	TPH-G (ppb)	TOG (ppb)	1,2- DCA (ppb)	OTHER (ppb)	MC (ppb)	1,1,1- TCA (ppb)	1,1- DCA (ppb)	PCE (ppb)	DTW (feet)	SPT (feet)	WTE (feet)
C-10 520.41	03/28/86	---	---	---	---	---	---	---	---	---	---	---	---	---	---	---
	03/15/88	7	ND	ND	ND	90	---	---	---	---	---	---	---	14.86	0.00	505.55
	05/10/88	---	---	---	---	---	---	---	---	---	---	---	---	14.90	0.00	505.51
	06/10/88	---	---	---	---	---	---	---	---	---	---	---	---	15.94	0.00	504.47
	07/25/88	---	---	---	---	---	---	---	---	---	---	---	---	14.85	0.00	505.56
	10/13/88	ND	ND	ND	ND	ND	---	---	---	---	---	---	---	14.90	0.00	505.51
	01/01/89	---	---	---	---	---	---	---	---	---	---	---	---	14.83	0.00	505.58
	01/12/89	ND	ND	ND	ND	ND	---	---	---	---	---	---	---	---	---	---
	04/11/89	4.8	ND	ND	ND	ND	ND	ND	6.1	---	---	---	---	14.90	0.00	505.51
	06/26/89	0.7	ND	ND	ND	1.5	ND	4.0	ND	---	---	---	---	15.12	0.00	505.29
	10/13/89	ND	ND	ND	ND	ND	ND	ND	ND	---	---	---	---	15.11	0.00	505.30
	01/03/90	ND	ND	ND	ND	ND	ND	ND	3	---	---	---	---	15.01	0.00	505.40
	05/07/90	ND	ND	ND	ND	ND	ND	ND	ND	ND	---	---	---	15.53	0.00	504.88
	09/27/90	ND	ND	ND	ND	ND	ND	ND	ND	ND	ND	ND	---	15.20	0.00	505.21
	01/03/91	ND	ND	ND	ND	ND	ND	ND	ND	ND	ND	ND	ND	15.06	0.00	505.35
	04/12/91	16	ND	2.9	2.7	110	---	---	1	ND	ND	ND	ND	14.86	0.00	505.55
	09/04/91	ND	ND	ND	ND	ND	---	---	ND	ND	ND	ND	ND	15.22	0.00	505.19
	04/06/92	ND	ND	ND	ND	ND	57	---	1.1	ND	ND	ND	ND	14.21	0.00	506.20
	07/28/92	ND	ND	ND	ND	ND	ND	---	---	---	---	---	---	14.78	0.00	505.63
	10/16/92	ND	ND	ND	ND	ND	ND	---	---	---	---	---	---	15.51	0.00	504.90
01/14/93*	4.7	ND	2.3	1.6	88	---	---	---	---	---	---	---	13.44	0.00	506.97	
03/26/93	ND	ND	ND	ND	ND	ND	---	---	---	---	---	---	12.55	0.00	507.86	
04/22/93	ND	ND	ND	ND	ND	ND	---	---	---	---	---	---	13.74	0.00	506.67	
07/20,21/93	ND	ND	ND	ND	ND	100	---	---	---	---	---	---	16.49	0.00	503.92	
10/20/93	ND	ND	ND	ND	ND	ND	---	---	---	---	---	---	14.64	0.00	505.77	
C-11 520.04	03/28/86	---	---	---	---	---	---	---	---	---	---	---	---	13.82	0.00	506.22
	03/15/88	---	---	---	---	---	---	---	---	---	---	---	---	14.49	0.00	505.55
	05/10/88	---	---	---	---	---	---	---	---	---	---	---	---	14.31	0.00	505.73
	06/10/88	---	---	---	---	---	---	---	---	---	---	---	---	15.47	0.00	504.57
	07/25/88	---	---	---	---	---	---	---	---	---	---	---	---	13.60	0.00	506.44
	10/14/88	240	33	4.7	67	2	---	---	---	---	---	---	---	14.53	0.00	505.51
	01/01/89	---	---	---	---	---	---	---	---	---	---	---	---	14.10	0.00	505.94
	01/12/89	ND	0.8	ND	ND	ND	---	---	---	---	---	---	---	---	---	---
	04/12/89	4.3	ND	ND	ND	ND	ND	ND	---	---	---	---	---	14.36	0.00	505.68
	06/26/89	2	ND	ND	ND	ND	ND	4.0	ND	---	---	---	---	14.58	0.00	505.46
	10/13/89	ND	ND	ND	ND	ND	ND	ND	ND	---	---	---	---	14.71	0.00	505.33
	01/03/90	ND	ND	ND	ND	0.7	ND	---	---	---	---	---	---	14.61	0.00	505.43
	05/08/90	12	11	0.9	22	110	---	---	---	---	---	---	---	15.53	0.00	504.51
	09/28/90	2.0	1.4	ND	3.3	ND	---	---	---	---	---	---	---	15.51	0.00	504.53
	01/03/91	2	ND	ND	2	ND	---	---	---	---	---	---	---	14.63	0.00	505.41
	04/12/91	---	---	---	---	---	---	---	---	---	---	---	---	14.30	0.00	505.74
	09/04/91	---	---	---	---	---	---	---	---	---	---	---	---	14.84	0.00	505.20
	04/06/92	ND	ND	ND	ND	ND	---	---	ND	ND	ND	ND	ND	13.56	0.00	506.48
	07/28/92	ND	ND	ND	ND	ND	---	---	---	---	---	---	---	14.39	0.00	505.65
	10/16/92	ND	ND	ND	ND	ND	---	---	---	---	---	---	---	15.79	0.00	504.25
01/14/93*	ND	1.3	0.7	6	94	---	---	---	---	---	---	---	12.14	0.00	507.90	
03/26/93	2	ND	0.6	1	130	---	---	---	---	---	---	---	11.81	0.00	508.23	
04/22/93	0.8	ND	ND	ND	ND	---	---	---	---	---	---	---	12.94	0.00	507.10	
07/20,21/93	3	1	ND	1	ND	1,200	---	---	---	---	---	---	16.48	0.00	503.56	
10/20/93	2	ND	ND	ND	ND	ND**	---	---	---	---	---	---	14.46	0.00	505.58	

**Table 1  
HISTORICAL GROUNDWATER ANALYTICAL RESULTS AND MONITORING DATA**

CHEVRON SERVICE STATION #9-1924  
4904 SOUTHFRONT ROAD, LIVERMORE, CALIFORNIA

WELL ID/ ELEVATION (TOC)	DATE	BENZENE (ppb)	TOLUENE (ppb)	ETHYL- BENZENE (ppb)	XYLENES (ppb)	TPH-G (ppb)	TOG (ppb)	1,2- DCA (ppb)	OTHER (ppb)	MC (ppb)	1,1,1- TCA (ppb)	1,1- DCA (ppb)	PCE (ppb)	DTW (feet)	SPT (feet)	WTE (feet)
C-12 519.82	03/28/86	--	--	--	--	--	--	--	--	--	--	--	--	13.61	0.00	506.21
	03/15/88	ND	ND	ND	ND	ND	ND	ND	ND	ND	ND	ND	ND	14.55	0.00	505.27
	05/10/88	--	--	--	--	--	--	--	--	--	--	--	--	14.57	0.00	505.25
	06/10/88	--	--	--	--	--	--	--	--	--	--	--	--	15.63	0.00	504.19
	07/25/88	--	--	--	--	--	--	--	--	--	--	--	--	14.51	0.00	505.31
	10/13/88	ND	ND	ND	ND	ND	ND	ND	ND	ND	ND	ND	ND	14.60	0.00	505.22
	01/12/89	ND	ND	ND	ND	ND	ND	ND	ND	ND	ND	ND	ND	14.62	0.00	505.20
	04/11/89	ND	ND	ND	ND	ND	ND	ND	ND	ND	ND	ND	ND	14.81	0.00	505.21
	06/26/89	ND	ND	ND	ND	ND	ND	ND	ND	ND	ND	ND	ND	14.75	0.00	505.07
	10/13/89	ND	ND	ND	ND	ND	ND	ND	ND	ND	ND	ND	ND	14.77	0.00	505.05
	01/03/90	ND	ND	ND	ND	0.6	ND	ND	ND	ND	ND	ND	ND	14.85	0.00	504.97
	05/07/90	ND	ND	ND	ND	ND	ND	ND	ND	ND	ND	ND	ND	14.75	0.00	505.07
	09/27/90	ND	ND	ND	ND	ND	ND	ND	ND	ND	1.2	ND	ND	14.61	0.00	505.21
	01/03/91	ND	ND	ND	ND	ND	ND	ND	ND	ND	ND	ND	ND	14.70	0.00	505.12
	04/12/91	--	--	--	--	--	--	--	--	--	--	--	--	14.52	0.00	505.30
	09/04/91	--	--	--	--	--	--	--	--	--	--	--	--	14.83	0.00	504.99
	04/06/92	ND	ND	ND	ND	ND	ND	ND	ND	ND	ND	ND	ND	13.81	0.00	506.01
	07/28/92	ND	ND	ND	ND	ND	ND	ND	ND	ND	ND	ND	ND	14.32	0.00	505.50
	10/16/92	ND	ND	ND	ND	ND	ND	ND	ND	ND	ND	ND	ND	15.12	0.00	504.70
	01/14/93*	ND	ND	ND	ND	1.7	65	ND	ND	ND	ND	ND	ND	13.23	0.00	506.59
03/26/93	0.9	ND	ND	ND	ND	ND	ND	ND	ND	ND	ND	ND	12.20	0.00	507.62	
04/22/93	ND	ND	ND	ND	ND	ND	ND	ND	ND	ND	ND	ND	13.21	0.00	506.61	
07/20,21/93	ND	ND	ND	ND	ND	ND	ND	ND	ND	ND	ND	ND	16.71	0.00	503.11	
10/20/93	ND	ND	ND	ND	ND	ND	ND	ND	ND	ND	ND	ND	14.19	0.00	505.63	
C-13 522.24	03/28/86	--	--	--	--	--	--	--	--	--	--	--	--	12.95	0.00	509.29
	03/15/88	--	ND	9	3	250	ND	ND	ND	ND	ND	ND	ND	14.82	0.00	507.42
	05/10/88	--	--	--	--	--	--	--	--	--	--	--	--	15.03	0.00	507.21
	06/10/88	--	--	--	--	--	--	--	--	--	--	--	--	16.10	0.00	506.14
	07/25/88	--	--	--	--	--	--	--	--	--	--	--	--	14.73	0.00	507.51
	10/13/88	1.9	ND	ND	ND	ND	ND	ND	ND	ND	ND	ND	ND	14.91	0.00	507.33
	01/01/89	--	--	--	--	--	--	--	--	--	--	--	--	14.10	0.00	508.14
	01/12/89	ND	0.6	4	ND	ND	ND	ND	ND	ND	ND	ND	ND	--	--	--
	04/10/89	ND	ND	8	ND	ND	ND	ND	ND	ND	ND	ND	ND	14.99	0.00	507.25
	06/26/89	0.3	ND	ND	ND	ND	ND	ND	ND	ND	ND	ND	ND	15.16	0.00	507.08
	10/13/89	ND	ND	ND	ND	ND	ND	ND	ND	ND	ND	ND	ND	15.23	0.00	507.01
	01/03/90	ND	ND	0.5	0.6	ND	ND	ND	ND	ND	ND	ND	ND	15.15	0.00	507.09
	05/08/90	ND	ND	ND	ND	ND	ND	ND	ND	ND	ND	ND	ND	15.02	0.00	507.22
	09/27/90	ND	0.6	ND	ND	ND	ND	ND	ND	1.7	ND	ND	ND	15.11	0.00	507.13
	01/03/91	ND	ND	ND	0.6	ND	ND	ND	ND	ND	ND	ND	ND	15.08	0.00	507.16
	04/12/91	--	--	--	--	--	--	--	--	--	--	--	--	14.77	0.00	507.47
	09/04/91	--	--	--	--	--	--	--	--	--	--	--	--	15.43	0.00	506.81
	04/06/92	ND	ND	ND	ND	66	ND	ND	ND	ND	ND	ND	ND	14.43	0.00	507.81
	07/28/92	8.2	ND	ND	1.1	60	ND	ND	ND	ND	ND	ND	ND	15.37	0.00	506.87
	10/16/92	ND	ND	ND	ND	ND	ND	ND	ND	ND	ND	ND	ND	15.87	0.00	506.37
01/14/93*	ND	ND	ND	1.3	100	ND	ND	ND	ND	ND	ND	ND	12.83	0.00	509.41	
03/26/93	ND	ND	ND	ND	ND	ND	ND	ND	ND	ND	ND	ND	12.59	0.00	509.65	
04/22/93	ND	ND	ND	ND	ND	ND	ND	ND	ND	ND	ND	ND	13.16	0.00	509.08	
07/20,21/93	4	13	2	7	99	ND	ND	ND	ND	ND	ND	ND	16.52	0.00	505.72	
10/20/93	ND	ND	ND	ND	ND	ND	ND	ND	ND	ND	ND	ND	15.13	0.00	507.11	



**Table 1**  
**HISTORICAL GROUNDWATER ANALYTICAL RESULTS AND MONITORING DATA**

CHEVRON SERVICE STATION #9-1924  
4904 SOUTHFRONT ROAD, LIVERMORE, CALIFORNIA

WELL ID/ ELEVATION (TOC)	DATE	BENZENE (ppb)	TOLUENE (ppb)	ETHYL- BENZENE (ppb)	XYLENES (ppb)	TPH-G (ppb)	TOG (ppb)	1,2- DCA (ppb)	OTHER (ppb)	MC (ppb)	1,1,1- TCA (ppb)	1,1- DCA (ppb)	PCE (ppb)	DTW (feet)	SPT (feet)	WTE (feet)
C-14 520.08	03/28/86	--	--	--	--	--	--	--	--	--	--	--	--	--	--	--
	03/15/88	--	--	--	--	--	--	--	--	--	--	--	--	--	--	--
	05/10/88	13,000	29,000	2,700	18	120,000	--	--	--	--	--	--	--	13.39	0.00	506.69
	06/10/88	--	--	--	--	--	--	--	--	--	--	--	--	14.65	0.00	505.43
	07/25/88	--	--	--	--	--	--	--	--	--	--	--	--	13.47	0.00	506.61
	10/13/88	ND	ND	ND	ND	ND	--	--	--	--	--	--	--	13.58	0.00	506.50
	01/01/89	--	--	--	--	--	--	--	--	--	--	--	--	13.00	0.00	507.08
	01/12/89	ND	ND	ND	ND	NS	--	--	--	--	--	--	--	--	--	--
	04/12/89	ND	ND	ND	ND	NS	ND	--	--	--	--	--	--	--	--	--
	06/26/89	14,000	25,000	3,400	26,000	140,000	--	ND	ND	--	--	--	--	13.47	0.00	506.61
	10/13/89	12,000	16,000	1,600	13,000	86,000	--	--	--	--	--	--	--	13.80	0.00	506.28
	01/03/90	8,500	16,000	1,800	13,000	120,000	--	--	25	3	--	--	--	13.62	0.00	506.46
	01/04/90	3,900	8,100	1,200	7,700	76,000	--	--	18	1	--	--	--	13.91	0.00	506.17
	05/08/90	7,500	17,000	1,400	14,000	62,000	--	--	13	--	ND	--	ND	13.91	0.00	506.17
	09/27/90	--	--	--	--	--	--	--	--	--	--	--	--	13.89	0.00	506.19
	01/03/91	--	--	--	--	--	--	--	--	--	--	--	--	13.78	0.00	506.30
	04/12/91	750	3,800	720	9,200	60,000	--	--	ND	ND	ND	ND	ND	13.72	0.00	506.36
	09/04/91	2,800	11,000	1,300	13,000	110,000	--	--	--	--	--	--	--	12.97	0.00	507.11
	04/06/92	190	1,800	440	5,100	41,000	--	--	ND	ND	ND	ND	ND	13.84	0.00	506.24
	07/28/92	2,300	9,700	1,800	15,000	130,000	--	--	ND	ND	ND	ND	ND	12.44	0.00	507.64
10/16/92	--	--	--	--	--	--	--	--	--	--	--	--	13.70	0.00	506.38	
01/14/93*	220	790	220	2,700	27,000	--	--	--	--	--	--	--	14.38	0.00	505.70	
03/26/93	330	1,600	460	4,000	23,000**	--	--	--	--	--	--	--	8.80	0.00	511.28	
04/22/93	840	2,300	130	3,500	17,000	--	--	--	--	--	--	--	9.12	0.00	510.96	
TRAFFIC #	07/20,21/93	--	--	--	--	--	--	--	--	--	--	--	--	12.10	SHEEN	507.98
	10/20/93	--	--	--	--	--	--	--	--	--	--	--	--	14.31	0.00	505.77
C-15 522.41	03/28/86	--	--	--	--	--	--	--	--	--	--	--	--	13.14	0.00	509.27
	03/15/88	ND	ND	ND	ND	ND	--	--	--	--	--	--	--	15.13	0.00	507.28
	05/10/88	--	--	--	--	--	--	--	--	--	--	--	--	15.40	0.00	507.01
	06/10/88	--	--	--	--	--	--	--	--	--	--	--	--	16.49	0.00	505.92
	07/25/88	--	--	--	--	--	--	--	--	--	--	--	--	15.17	0.00	507.24
	10/13/88	ND	ND	ND	ND	ND	--	--	--	--	--	--	--	15.33	0.00	507.08
	01/01/89	--	--	--	--	--	--	--	--	--	--	--	--	13.70	0.00	508.71
	01/12/89	ND	ND	ND	ND	ND	--	--	--	--	--	--	--	--	--	--
	04/12/89	ND	ND	ND	ND	ND	ND	ND	ND	ND	ND	ND	ND	15.34	0.00	507.07
	06/26/89	ND	ND	ND	ND	ND	ND	ND	ND	ND	ND	ND	ND	15.72	0.00	506.69
	10/13/89	ND	ND	ND	ND	ND	ND	ND	ND	ND	ND	ND	ND	15.96	0.00	506.45
	01/03/90	ND	ND	ND	ND	ND	ND	ND	ND	ND	ND	ND	ND	15.42	0.00	506.99
	05/08/90	ND	ND	ND	ND	ND	ND	ND	ND	ND	ND	ND	ND	15.62	0.00	506.79
	09/27/90	ND	ND	ND	ND	ND	ND	ND	ND	ND	ND	ND	ND	15.58	0.00	506.82
	01/03/91	ND	ND	ND	ND	0.6	ND	ND	ND	2.9	ND	ND	ND	15.50	0.00	506.91
	04/12/91	--	--	--	--	--	--	--	--	--	--	--	--	15.21	0.00	507.20
	09/04/91	--	--	--	--	--	--	--	--	--	--	--	--	15.90	0.00	506.51
	04/06/92	ND	ND	ND	ND	ND	ND	ND	ND	ND	ND	ND	ND	14.88	0.00	507.53
	07/28/92	ND	ND	ND	ND	ND	ND	ND	ND	ND	ND	ND	ND	15.82	0.00	506.59
	10/16/92	ND	ND	ND	ND	ND	ND	ND	ND	ND	ND	ND	ND	16.25	0.00	506.16
01/14/93*	ND	1.9	0.8	5.1	61	ND	ND	ND	ND	ND	ND	ND	12.48	0.00	509.93	
03/26/93	ND	ND	ND	ND	1	ND	ND	ND	ND	ND	ND	ND	12.67	0.00	509.74	
04/22/93	ND	ND	ND	ND	ND	ND	ND	ND	ND	ND	ND	ND	13.60	0.00	508.81	
07/20,21/93	ND	ND	ND	ND	ND	ND	ND	ND	ND	ND	ND	ND	16.87	0.00	505.54	
10/20/93	ND	ND	ND	ND	ND	ND	ND	ND	ND	ND	ND	ND	15.24	0.00	507.17	

**Table 1  
HISTORICAL GROUNDWATER ANALYTICAL RESULTS AND MONITORING DATA**

CHEVRON SERVICE STATION #9-1924  
4904 SOUTHFRONT ROAD, LIVERMORE, CALIFORNIA

WELL ID/ ELEVATION (TOC)	DATE	BENZENE (ppb)	TOLUENE (ppb)	ETHYL- BENZENE (ppb)	XYLENES (ppb)	TPH-G (ppb)	TOG (ppb)	1,2- DCA (ppb)	OTHER (ppb)	MC (ppb)	1,1,1- TCA (ppb)	1,1- DCA (ppb)	PCE (ppb)	DTW (feet)	SPT (feet)	WTE (feet)
C-16 519.68	03/28/86	---	---	---	---	---	---	---	---	---	---	---	---	---	---	---
	03/15/88	---	---	---	---	---	---	---	---	---	---	---	---	---	---	---
	05/10/88	1,000	73	140	180	4,500	---	---	---	---	---	---	---	13.78	0.00	505.90
	06/10/88	---	---	---	---	---	---	---	---	---	---	---	---	14.88	0.00	504.80
	07/25/88	---	---	---	---	---	---	---	---	---	---	---	---	13.69	0.00	505.99
	10/13/88	16	5.5	ND	16	1,600	---	---	---	---	---	---	---	13.80	0.00	505.88
	01/01/89	---	---	---	---	---	---	---	---	---	---	---	---	13.45	0.00	506.23
	01/12/89	360	11	78	51	1,000	---	---	---	---	---	---	---	---	---	---
	04/11/89	130	4	21	19	15,800	ND	8	---	---	---	---	---	13.78	0.00	505.90
	06/26/89	170	8	37	43	1,300	ND	ND	---	---	---	---	---	14.02	0.00	505.66
	10/13/89	20	ND	7	ND	1,000	ND	ND	---	---	---	---	---	14.01	0.00	505.67
	01/03/90	150	3	41	24	1,300	---	5	---	---	---	---	---	13.97	0.00	505.71
	05/07/90	49	4.4	29	13	480	---	4.5	---	ND	ND	---	---	14.45	0.00	505.23
	09/29/90	18	2.1	11	8.0	360	---	1.8	ND	ND	ND	---	---	14.32	0.00	505.36
	01/03/91	12	ND	6	6	230	---	2	ND	0.8	ND	ND	ND	13.96	0.00	505.72
	04/12/91	---	---	---	---	---	---	---	---	---	---	---	---	13.74	0.00	505.94
	09/04/91	---	---	---	---	---	---	---	---	---	---	---	---	14.22	0.00	505.46
	04/06/92	30	ND	14	12.0	360	---	1.0	ND	ND	ND	ND	ND	13.18	0.00	506.50
	07/28/92	31	ND	6.8	16	210	---	---	---	---	---	---	---	13.93	0.00	505.75
	10/16/92	11	ND	5.1	3.4	140	---	---	---	---	---	---	---	14.92	0.00	504.76
	01/14/93*	24	ND	36	21	740	---	---	---	---	---	---	---	11.81	0.00	507.87
	03/26/93	22	2	16	10	730	---	---	---	---	---	---	---	11.36	0.00	508.32
	04/22/93	46	ND	24	6	850	---	---	---	---	---	---	---	12.30	0.00	507.38
TRAFFIC	07/20,21/93	---	---	---	---	---	---	---	---	---	---	---	---	---	---	---
	10/20/93	18	2	16	17	290**	---	---	---	---	---	---	---	14.00	0.00	505.68

**Table 1  
HISTORICAL GROUNDWATER ANALYTICAL RESULTS AND MONITORING DATA**

CHEVRON SERVICE STATION #9-1924  
4904 SOUTHFRONT ROAD, LIVERMORE, CALIFORNIA

WELL ID/ ELEVATION (TOC)	DATE	BENZENE (ppb)	TOLUENE (ppb)	ETHYL- BENZENE (ppb)	XYLENES (ppb)	TPH-G (ppb)	TOG (ppb)	1,2- DCA (ppb)	OTHER (ppb)	MC (ppb)	1,1,1- TCA (ppb)	1,1- DCA (ppb)	PCE (ppb)	DTW (feet)	SPT (feet)	WTE (feet)
C-17 520.82	03/28/86	---	---	---	---	---	---	---	---	---	---	---	---	13.48	0.00	507.34
	03/15/88	---	---	---	---	---	---	---	---	---	---	---	---	14.76	0.00	506.06
	05/10/88	---	---	---	---	---	---	---	---	---	---	---	---	14.77	0.00	506.05
	06/10/88	---	---	---	---	---	---	---	---	---	---	---	---	15.84	0.00	504.98
	07/25/88	---	---	---	---	---	---	---	---	---	---	---	---	14.63	0.00	506.19
	10/13/88	18	900	760	5,500	270,000	---	---	---	---	---	---	---	14.83	0.00	505.99
	01/01/89	---	---	---	---	---	---	---	---	---	---	---	---	14.78	0.00	506.04
	01/12/89	ND	490	2,100	6,700	190,000	---	---	---	---	---	---	---	---	---	---
	04/11/89	30	150	320	1,000	27,000	6.0	ND	---	---	---	---	---	14.83	0.00	505.99
	06/26/89	50	390	660	2,000	20,000	ND	ND	---	---	---	---	---	15.03	0.00	505.79
	06/26/89	40	420	740	2,200	27,000	---	ND	---	---	---	---	---	15.03	0.00	505.79
	10/13/89	ND	48	230	480	17,000	---	ND	---	---	---	---	---	15.02	0.00	505.80
	01/03/90	ND	29	120	210	14,000	---	ND	---	---	---	---	---	15.10	0.00	505.72
	05/08/90	25	130	210	470	9,500	---	ND	---	---	---	---	---	15.12	0.00	505.70
	09/29/90	ND	ND	ND	ND	ND	---	ND	ND	ND	1.9	ND	---	14.99	0.00	505.83
	09/29/90	ND	3.4	ND	ND	ND	---	ND	ND	1.8	1.9	ND	---	14.99	0.00	505.83
	01/03/91	ND	28	56	140	3,700	---	ND	ND	1.8	1.9	ND	ND	14.92	0.00	505.90
	01/03/91	ND	10	59	150	8,600	---	ND	ND	ND	ND	ND	ND	14.92	0.00	505.90
	04/12/91	ND	5	47	120	8,600	---	ND	ND	ND	ND	ND	ND	14.71	0.00	506.11
	04/12/91	ND	11	48	120	4,400	---	ND	ND	ND	ND	ND	ND	14.71	0.00	506.11
	09/04/91	ND	27	49	79	5,800	---	ND	ND	ND	ND	ND	ND	15.17	0.00	505.65
	09/04/91	ND	21	36	61	4,100	---	ND	ND	ND	ND	ND	ND	15.17	0.00	505.65
	04/06/92	ND	5.8	27	29	2,300	---	ND	ND	ND	ND	ND	ND	14.14	0.00	506.68
	07/28/92	99	180	170	430	11,000	---	---	---	---	---	---	---	15.18	0.00	505.64
	10/16/92	ND	4,800	3,900	6,600	1,200,000	---	---	---	---	---	---	---	15.76	0.00	505.06
	01/14/93*	9.3	9.1	23	34	3,500	---	---	---	---	---	---	---	13.44	0.00	507.38
	03/26/93	ND	19	20	35	3,700**	---	---	---	---	---	---	---	12.46	0.00	508.36
	04/22/93	16	68	44	97	8,900	---	---	---	---	---	---	---	13.30	0.00	507.52
	07/20,21/93	5	35	33	62	4,200	---	---	---	---	---	---	---	17.21	0.00	503.61
	10/20/93	5	12	43	64	4,500	---	---	---	---	---	---	---	15.09	0.00	505.73

**Table 1**  
**HISTORICAL GROUNDWATER ANALYTICAL RESULTS AND MONITORING DATA**

CHEVRON SERVICE STATION #9-1924  
4904 SOUTHFRONT ROAD, LIVERMORE, CALIFORNIA

WELL ID/ ELEVATION (TOC)	DATE	BENZENE (ppb)	TOLUENE (ppb)	ETHYL- BENZENE (ppb)	XYLENES (ppb)	TPH-G (ppb)	TOG (ppb)	1,2- DCA (ppb)	OTHER (ppb)	MC (ppb)	1,1,1- TCA (ppb)	1,1- DCA (ppb)	PCE (ppb)	DTW (feet)	SPT (feet)	WTE (feet)
C-18 518.96	03/28/86	---	---	---	---	---	---	---	---	---	---	---	---	---	---	---
	03/15/88	---	---	---	---	---	---	---	---	---	---	---	---	---	---	---
	05/10/88	---	---	---	---	---	---	---	---	---	---	---	---	---	---	---
	06/10/88	---	---	---	---	---	---	---	---	---	---	---	---	---	---	---
	07/25/88	---	---	---	---	---	---	---	---	---	---	---	---	14.89	0.00	504.07
	10/13/88	ND	ND	ND	ND	ND	ND	ND	ND	ND	ND	ND	ND	13.79	0.00	505.17
	01/01/89	---	---	---	---	---	---	---	---	---	---	---	---	13.86	0.00	505.10
	01/12/89	ND	ND	ND	ND	ND	ND	ND	ND	ND	ND	ND	ND	13.94	0.00	505.02
	04/11/89	ND	ND	ND	ND	ND	ND	ND	ND	ND	ND	ND	ND	---	0.00	518.96
	06/26/89	ND	ND	ND	ND	ND	ND	ND	3.6	---	---	---	---	14.86	0.00	504.10
	10/13/89	ND	ND	ND	ND	ND	ND	ND	3.1	---	---	---	---	14.02	0.00	504.94
	01/03/90	ND	ND	ND	ND	ND	ND	ND	ND	---	---	---	---	15.06	0.00	503.90
	05/07/90	ND	ND	ND	ND	ND	ND	ND	1	---	---	---	---	14.07	0.00	504.89
	09/27/90	ND	ND	ND	ND	ND	ND	ND	ND	ND	ND	ND	ND	14.01	0.00	504.95
	01/03/91	ND	ND	ND	ND	ND	ND	ND	ND	ND	ND	ND	ND	13.91	0.00	505.05
	04/12/91	ND	ND	ND	ND	ND	ND	ND	ND	ND	ND	ND	ND	13.98	0.00	504.98
	09/04/91	ND	ND	ND	ND	ND	ND	ND	ND	ND	ND	ND	ND	13.83	0.00	505.13
	04/06/92	ND	ND	ND	ND	ND	ND	ND	ND	ND	ND	ND	ND	14.20	0.00	504.76
	07/28/92	ND	ND	ND	ND	ND	ND	ND	ND	ND	ND	ND	ND	13.07	0.00	505.89
	10/16/92	ND	ND	ND	ND	ND	ND	ND	ND	ND	ND	ND	ND	13.55	0.00	505.41
01/14/93*	ND	ND	ND	ND	1.8	56	---	---	---	---	---	---	14.38	0.00	504.58	
03/26/93	ND	ND	ND	ND	ND	ND	---	---	---	---	---	---	12.46	0.00	506.50	
04/22/93	ND	ND	ND	ND	ND	ND	---	---	---	---	---	---	11.46	0.00	507.50	
07/20,21/93	ND	0.5	ND	ND	ND	92	---	---	---	---	---	---	12.58	0.00	506.38	
PAVED OVER?	10/20/93	---	---	---	---	---	---	---	---	---	---	---	15.84	0.00	503.32	

**Table 1  
HISTORICAL GROUNDWATER ANALYTICAL RESULTS AND MONITORING DATA**

CHEVRON SERVICE STATION #9-1924  
4904 SOUTHFRONT ROAD, LIVERMORE, CALIFORNIA

WELL ID/ ELEVATION (TOC)	DATE	BENZENE (ppb)	TOLUENE (ppb)	ETHYL- BENZENE (ppb)	XYLENES (ppb)	TPH-G (ppb)	TOG (ppb)	1,2- DCA (ppb)	OTHER (ppb)	MC (ppb)	1,1,1- TCA (ppb)	1,1- DCA (ppb)	PCE (ppb)	DTW (feet)	SPT (feet)	WTE (feet)
C-19 520.99	03/28/86	---	---	---	---	---	---	---	---	---	---	---	---	---	---	---
	03/15/88	---	---	---	---	---	---	---	---	---	---	---	---	---	---	---
	05/10/88	1,400	360	350	1,300	18	---	---	---	---	---	---	---	15.23	0.00	505.76
	06/10/88	---	---	---	---	---	---	---	---	---	---	---	---	16.58	0.00	504.41
	07/25/88	---	---	---	---	---	---	---	---	---	---	---	---	15.19	0.00	505.80
	10/13/88	8.3	4.7	4.4	ND	ND	---	---	---	---	---	---	---	15.27	0.00	505.72
	01/01/89	---	---	---	---	---	---	---	---	---	---	---	---	15.20	0.00	505.79
	01/12/89	5	4	ND	ND	ND	---	---	---	---	---	---	---	---	---	---
	04/11/89	1.8	ND	ND	ND	ND	---	13	---	---	---	---	---	15.24	0.00	505.75
	04/11/89	1.2	ND	0.6	0.6	500	---	14	---	---	---	---	---	15.24	0.00	505.75
	06/26/89	2.5	ND	ND	ND	500	---	26	---	---	---	---	---	15.44	0.00	505.55
	10/13/89	ND	ND	ND	ND	540	---	13	13	---	---	---	---	15.47	0.00	505.52
	01/03/90	1.2	0.7	1.3	0.9	ND	---	11	---	---	---	---	---	15.45	0.00	505.54
	05/07/90	ND	ND	ND	ND	ND	---	4.6	---	ND	---	ND	---	15.68	0.00	505.31
	09/28/90	ND	ND	ND	ND	ND	---	---	---	1.2	---	ND	---	15.52	0.00	505.47
	01/03/91	ND	ND	ND	ND	66	---	1	---	ND	---	ND	0.9	15.56	0.00	505.43
	04/12/91	---	---	---	---	---	---	---	---	---	---	---	---	15.20	0.00	505.79
	09/04/91	---	---	---	---	---	---	---	---	---	---	---	---	15.60	0.00	505.39
	04/06/92	0.7	ND	1.0	ND	110	---	1.9	---	ND	---	ND	---	14.58	0.00	506.41
	07/28/92	1.4	ND	1.0	4.2	ND	---	---	---	---	---	---	---	15.26	0.00	505.73
10/16/92	ND	ND	ND	ND	ND	---	---	---	---	---	---	---	16.00	0.00	504.99	
01/14/93*	1.1	ND	0.9	0.9	100	---	---	---	---	---	---	---	13.69	0.00	507.30	
03/26/93	ND	ND	ND	ND	ND	---	---	---	---	---	---	---	12.96	0.00	508.03	
04/22/93	0.6	1	1	1	250**	---	---	---	---	---	---	---	14.18	0.00	506.81	
07/20,21/93	ND	ND	0.8	2	390**	---	---	---	---	---	---	---	16.58	0.00	504.41	
10/20/93	ND	ND	ND	ND	ND**	---	---	---	---	---	---	---	15.23	0.00	505.76	

**Explanation**

Elevations are expressed as feet above mean sea level.  
 TOC = Top of casing  
 WTE = Water table elevation (well elevation - (DTW - (SPT x 0.8))  
 DTW = Depth to water  
 SPT = Separate-phase hydrocarbon thickness  
 TPH-G = Total Petroleum Hydrocarbons as Gasoline (ppb)  
 TOG = Total Oil & Grease (EPA Method 503D & 503E)  
 \* = Rinsate sample contaminated; resampled 03/26/93  
 \*\* = Uncategorized compound not included in gasoline hydrocarbon total  
 \*\*\* = Hydrocarbon pattern uncharacteristic of fresh gasoline  
 # = Not enough water to purge and sample

PCE = Tetrachloroethene  
 1,2-DCA = 1,2-Dichloroethane  
 MC = Methylene Chloride  
 TCA = 1,1,1-Trichloroethane  
 1,1-DCA = 1,1-Dichloroethane  
 ND = Not detected at or above the minimum quantitation limit (MQL)  
 -- = Not sampled, not monitored, inaccessible  
 OTHER = 5 ppb Carbon Disulfide detected in C-1 on 10/13/89  
 3 ppb Vinyl Chloride detected in C-14 on 1/3/90  
 1 ppb Vinyl Chloride detected in C-14 on 1/4/90  
 13 ppb Carbon Disulfide detected in C-19 on 10/13/89



4080 Pike Lane  
Concord, CA 94520  
(510) 685-7852  
(800) 544-3422 Inside CA  
(800) 423-7143 Outside CA  
(510) 825-0720 FAX

Client Number: 0270704233  
Consultant Project Number: 0270704233  
Facility Number: 9-1924  
Project ID: 4904 Southfront Road  
Work Order Number: C3100403

November 23, 1993

Bruce Eppler  
Groundwater Technology, Inc.  
4057 Port Chicago Hwy.  
Concord, CA 94520

Enclosed please find the analytical results for samples received by GTEL Environmental Laboratories, Inc. on 10/21/93.

A formal Quality Assurance/Quality Control (QA/QC) program is maintained by GTEL, which is designed to meet or exceed the EPA requirements. Analytical work for this project met QA/QC criteria, unless otherwise stated in the footnotes.

GTEL is certified by the California State Department of Health Services, Laboratory certification number E1075, to perform analyses for drinking water, wastewater, and hazardous waste materials according to EPA protocols.

If you have any questions concerning this analysis or if we can be of further assistance, please call our Customer Service Representative.

Sincerely,  
GTEL Environmental Laboratories, Inc.

Eileen F. Bullen  
Laboratory Director

Client Number: 0270704233  
 Consultant Project Number: 0270704233  
 Facility Number: 9-1924  
 Project ID: 4904 Southfront Road  
 Work Order Number: C3100403

Table 1

ANALYTICAL RESULTS

Aromatic Volatile Organics and  
 Total Petroleum Hydrocarbons as Gasoline in Water

EPA Methods 5030, 8020, and Modified 8015<sup>a</sup>

GTEL Sample Number		01	02	03	04
Client Identification		TB-LB	C-11	C-12	C-15
Date Sampled		10/20/93	10/20/93	10/20/93	10/20/93
Date Analyzed		10/26/93	10/27/93	10/27/93	10/27/93
Analyte	Detection Limit, ug/L	Concentration, ug/L			
Benzene	0.5	<0.5	2	<0.5	<0.5
Toluene	0.5	<0.5	<0.5	<0.5	<0.5
Ethylbenzene	0.5	<0.5	<0.5	<0.5	<0.5
Xylene, total	0.5	<0.5	<0.5	<0.5	<0.5
BTEX, total	--	--	2	--	--
TPH as Gasoline	50	<50	<50 <sup>b</sup>	<50	<50
Detection Limit Multiplier		1	1	1	1
BFB surrogate, % recovery		87.4	92.6	99.9	85.2

- a. Test Methods for Evaluating Solid Waste, SW-846, Third Edition, Revision 0, US EPA November 1986. Modification for TPH as gasoline as per California State Water Resources Control Board LUFT Manual protocols, May 1988 revision. Bromofluorobenzene surrogate recovery acceptability limits are 70 - 130%.
- b. Uncategorized compound is not included in total hydrocarbon concentration.

Client Number: 0270704233  
 Consultant Project Number: 0270704233  
 Facility Number: 9-1924  
 Project ID: 4904 Southfront Road  
 Work Order Number: C3100403

**Table 1 (Continued)**

**ANALYTICAL RESULTS**

**Aromatic Volatile Organics and  
 Total Petroleum Hydrocarbons as Gasoline in Water**

EPA Methods 5030, 8020, and Modified 8015<sup>a</sup>

GTEL Sample Number		05	06	07	08
Client Identification		C-5	C-10	C-13	C-3
Date Sampled		10/20/93	10/20/93	10/20/93	10/20/93
Date Analyzed		10/28/93	11/03/93	10/27/93	10/26/93
Analyte	Detection Limit, ug/L	Concentration, ug/L			
Benzene	0.5	7	<0.5	<0.5	<0.5
Toluene	0.5	5	<0.5	<0.5	1
Ethylbenzene	0.5	3	<0.5	<0.5	<0.5
Xylene, total	0.5	15	<0.5	<0.5	0.8
BTEX, total	--	30	--	--	2
TPH as Gasoline	50	2200	<50	<50	<50
Detection Limit Multiplier		1	1	1	1
BFB surrogate, % recovery		106	79.5	93.3	92.1

a. Test Methods for Evaluating Solid Waste, SW-846, Third Edition, Revision 0, US EPA November 1986. Modification for TPH as gasoline as per California State Water Resources Control Board LUFT Manual protocols, May 1988 revision. Bromofluorobenzene surrogate recovery acceptability limits are 70 - 130%.



Client Number: 0270704233  
 Consultant Project Number: 0270704233  
 Facility Number: 9-1924  
 Project ID: 4904 Southfront Road  
 Work Order Number: C3100403

**Table 1 (Continued)**

**ANALYTICAL RESULTS**

**Aromatic Volatile Organics and  
 Total Petroleum Hydrocarbons as Gasoline in Water**

**EPA Methods 5030, 8020, and Modified 8015<sup>a</sup>**

GTEL Sample Number		09	10	11	12
Client Identification		C-19	C-8	C-16	C-1
Date Sampled		10/20/93	10/20/93	10/20/93	10/20/93
Date Analyzed		10/29/93	10/27/93	10/28/93	10/28/93
Analyte	Detection Limit, ug/L	Concentration, ug/L			
Benzene	0.5	<0.5	<0.5	18	19
Toluene	0.5	<0.5	<0.5	2	26
Ethylbenzene	0.5	<0.5	<0.5	16	260
Xylene, total	0.5	<0.5	<0.5	17	190
BTEX, total	--	--	--	53	500
TPH as Gasoline	50	<50 <sup>b</sup>	<50	290 <sup>b</sup>	880 <sup>b</sup>
Detection Limit Multiplier		1	1	1	1
BFB surrogate, % recovery		105	87.2	98.3	118

- a. Test Methods for Evaluating Solid Waste, SW-846, Third Edition, Revision 0, US EPA November 1986. Modification for TPH as gasoline as per California State Water Resources Control Board LUFT Manual protocols, May 1988 revision. Bromofluorobenzene surrogate recovery acceptability limits are 70 - 130%.
- b. Uncategorized compound is not included in total hydrocarbon concentration.

Client Number: 0270704233  
 Consultant Project Number: 0270704233  
 Facility Number: 9-1924  
 Project ID: 4904 Southfront Road  
 Work Order Number: C3100403

**Table 1 (Continued)**

**ANALYTICAL RESULTS**

**Aromatic Volatile Organics and  
 Total Petroleum Hydrocarbons as Gasoline in Water**

EPA Methods 5030, 8020, and Modified 8015<sup>a</sup>

GTEL Sample Number		13	14	15	16
Client Identification		C-2	C-17	C-7	C-9
Date Sampled		10/20/93	10/20/93	10/20/93	10/20/93
Date Analyzed		10/28/93	10/28/93	10/29/93	10/29/93
Analyte	Detection Limit, ug/L	Concentration, ug/L			
Benzene	0.5	140	5	72	22
Toluene	0.5	18	12	26	200
Ethylbenzene	0.5	22	43	250	440
Xylene, total	0.5	27	64	160	930
BTEX, total	--	210	120	510	1600
TPH as Gasoline	50	1600 <sup>b</sup>	4500	5500	36000
Detection Limit Multiplier		1	10	10	10
BFB surrogate, % recovery		104	102	94.9	115

- a. Test Methods for Evaluating Solid Waste, SW-846, Third Edition, Revision 0, US EPA November 1986. Modification for TPH as gasoline as per California State Water Resources Control Board LUFT Manual protocols, May 1988 revision. Bromofluorobenzene surrogate recovery acceptability limits are 70 - 130%.
- b. Uncategorized compound is not included in total hydrocarbon concentration.

Client Number: 0270704233  
 Consultant Project Number: 0270704233  
 Facility Number: 9-1924  
 Project ID: 4904 Southfront Road  
 Work Order Number: C3100403

**Table 1 (Continued)**

**ANALYTICAL RESULTS**

**Aromatic Volatile Organics and  
 Total Petroleum Hydrocarbons as Gasoline in Water**

EPA Methods 5030, 8020, and Modified 8015<sup>a</sup>

GTEL Sample Number		18	102793M		
Client Identification		C-6	METHOD BLANK		
Date Sampled		10/20/93	--		
Date Analyzed		10/21/93	10/27/93		
Analyte	Detection Limit, ug/L	Concentration, ug/L			
Benzene	0.5	290	<0.5		
Toluene	0.5	790	<0.5		
Ethylbenzene	0.5	2500	<0.5		
Xylene, total	0.5	7600	<0.5		
BTEX, total	--	11000	--		
TPH as Gasoline	50	77000 <sup>b</sup>	<50		
Detection Limit Multiplier		100	1		
BFB surrogate, % recovery		107	93.8		

- a. Test Methods for Evaluating Solid Waste, SW-846, Third Edition, Revision 0, US EPA November 1986. Modification for TPH as gasoline as per California State Water Resources Control Board LUFT Manual protocols, May 1988 revision. Bromofluorobenzene surrogate recovery acceptability limits are 70 - 130%.
- b. Uncategorized compound is not included in total hydrocarbon concentration.

Client Number: 0270704233  
Consultant Project Number: 0270704233  
Facility Number: 9-1924  
Project ID: 4904 Southfront Road  
Work Order Number: C3100403

### QC Matrix Spike and Duplicate Spike Results

Matrix: Water

Analyte	Sample ID	Spike Amount	Units	Recovery, %	Duplicate Recovery, %	RPD, %	Control Limits
<b>Modified EPA 8020:</b>							
Benzene	C3100450-04	20	ug/L	84.5	80.5	4.8	55 - 129
Toluene	C3100450-04	20	ug/L	90.5	87.5	3.4	72 - 149
Ethylbenzene	C3100450-04	20	ug/L	94.0	91.0	3.2	75 - 138
Xylene, total	C3100450-04	60	ug/L	95.7	93.2	2.6	74 - 147

Fax copy of Lab Report and COC to Chevron Contact:  Yes  No

Chain-of-Custody-Record

Chevron U.S.A. Inc.  
P.O. BOX 5004  
San Ramon, CA 94583  
FAX (415)842-9591

Chevron Facility Number 9-1924<sup>v</sup>  
 Facility Address 4904 Southfront Road  
 Consultant Project Number 02070 4233.0610  
 Consultant Name GTI  
 Address 4057 Part Chgo. Hwy. Concord  
 Project Contact (Name) Bruce Eppeler  
 (Phone) 916 372-4700 (Fax Number)

Chevron Contact (Name) Brett Hunter  
 (Phone) (510) 842-8695  
 Laboratory Name GTE L  
 Laboratory Release Number 9033280  
 Samples Collected by (Name) S. JETT, M. CARCIA, R. MCKINNEY, 4 S.  
 Collection Date 10/20/93  
 Signature [Signature]

Sample Number	Lab Sample Number	Number of Containers	Matrix S = Soil W = Water A = Air C = Charcoal	Type C = Grab C = Composite D = Diacrite	Time	Sample Preservation	Lead (Yes or No)	Analyses To Be Performed										NOTE: Do NOT BILL TB-LB SAMPLES SEALS IN GWICS AS 39 Remarks			
								BTEX + TPH GAS (8020 + 8015)	TPH Diesel (8015)	Oil and Grease (5520)	Purgeable Halocarbons (8010)	Purgeable Aromatics (8020)	Purgeable Organics (8240)	Extractable Organics (8270)	Metals Cd, Cr, Pb, Zn, Ni (ICAP or AA)						
1B LB	01	2	W		4:30	HCl	Yes	✓													
-11	02	2			4:35			✓													
-12	03	2			4:40			✓													
-15	04	2			4:45			✓													
-5	05	2			4:50			✓													
-10	06	2			4:55			✓													
-13	07	2			5:00			✓													
-3	08	2			5:05			✓													
-19	09	2			5:10			✓													
-8	10	2			5:15			✓													
-16	11	2			5:20			✓													
<del>---</del>	<del>---</del>	<del>---</del>						<del>---</del>													
-1	12	2			5:25			✓													
-2	13	2	W		5:30	HCl	Yes	✓													

Relinquished By (Signature) <u>[Signature]</u>	Organization <u>GTI</u>	Date/Time <u>10/21/93 7:00</u>	Received By (Signature) <u>[Signature]</u>	Organization <u>GTI</u>	Date/Time <u>10/21/93 7:00</u>	Turn Around Time (Circle Choice) 24 Hrs. 48 Hrs. 5 Days 10 Days As Contracted
Relinquished By (Signature) <u>[Signature]</u>	Organization <u>GTI</u>	Date/Time <u>10/21/93 12:45</u>	Received By (Signature) <u>[Signature]</u>	Organization	Date/Time	
Relinquished By (Signature)	Organization	Date/Time	Received For Laboratory By (Signature) <u>[Signature]</u>		Date/Time <u>10/21/93</u>	