

RECEIVED

By Alameda County Environmental Health at 3:46 pm, May 31, 2013

May 31, 2013

Mr. Keith Nowell
Alameda County Health Care Services Agency
1131 Harbor Bay Parkway, Suite 250
Alameda, CA 94502-6577

Subject: Well Destruction Report
Site: 76 Service Station No. 6277
15803 East 14th Street
San Leandro, California
Fuel Leak Case No. RO0002969

Dear Mr. Nowell;

I declare under penalty of perjury that to the best of my knowledge the information and/or recommendations contained in the attached report is/are true and correct.

If you have any questions or need additional information, please call:

Brian Whalen
Platinum Energy
30343 Canwood Street, Suite 200
Agoura Hills, Ca 91301
Tel: (818) 206-5704
Fax: (818) 206-5721
bwhalen@platinum-energy.net

Sincerely,

PLATINUM ENERGY

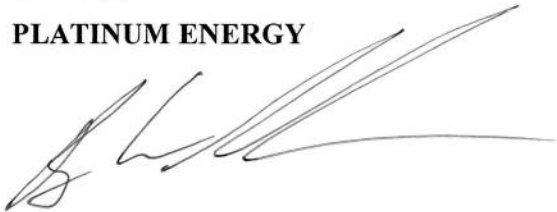

BRIAN WHALEN

Attachment

Well Destruction Report

*76 Service Station No. 6277
15803 East 14th Street
San Leandro, California*

*Alameda County Health Care Services Agency,
Fuel Leak Case No. RO0002969*

GeoTracker Global ID No. T0619718179

Antea Group Project No. I40256277

May 31, 2013

Prepared for:

Mr. Keith Nowell
Hazardous Materials Specialist
Alameda County Health Care
Services Agency
1131 Harbor Bay Parkway,
Suite 250
Alameda, CA 94502-6577

Prepared by:

Antea®Group
11050 White Rock Road, Suite 110
Rancho Cordova, CA 95670
+1 800 477 7411

Table of Contents

1.0	INTRODUCTION	1
2.0	SCOPE OF WORK	1
2.1	Pre-Field Activities	1
2.2	Well Destruction Activities.....	1
2.3	Disposal of Derived Waste	2
3.0	CONCLUSIONS.....	2
4.0	REMARKS.....	3

Figures

Figure 1	Site Location Map
Figure 2	Site Plan

Table

Table 1	Well Destruction Details
---------	--------------------------

Attachments

Attachment A	ACHCSA E-mail
Attachment B	Well Destruction Permit
Attachment C	DWR Well Completion Reports

1.0 INTRODUCTION

Antea Group is pleased to submit this Well Destruction Report for the site located at 15803 East 14th Street, San Leandro, California (**Figure 1, Figure 2**). This report summarizes the destruction of the four monitoring wells associated with the site, in May 2013. The well destruction was conducted as required for site closure. This report has received a technical review by Mr. Dennis Dettloff a California Professional Geologist No. 7480.

2.0 SCOPE OF WORK

The scope of work completed for the monitoring well destruction included the following activities:

- Obtained permits from the Alameda County Public Works Agency (ACPWA);
- Updated the site-specific health and safety plan;
- Conducted a utility clearance;
- Pressure grouted the four monitoring wells associated with the site; and
- Removed the well box of each monitoring well.

2.1 Pre-Field Activities

The Alameda County Health Care Services Agency (ACHCSA) email approving the well destruction work as part of site closure is presented as **Attachment A**. Prior to beginning field operations Antea Group obtained a permit for well destruction from the ACPWA (**Attachment B**).

Antea Group prepared a site-specific Health and Safety Plan (HASP) in accordance with Title 8, Section 5192 of the California Code of Regulations. The HASP contained a list of emergency contacts, as well as a hospital route map to the nearest emergency facility.

A utility survey was conducted prior to the field operations. Underground Service Alert (USA) was notified prior to well destruction and a private utility locator was retained to minimize the risk of damage to underground utilities.

2.2 Well Destruction Activities

On May 22, 2013, Gregg Drilling (Gregg), under supervision of an Antea Group field geologist, destroyed four on-site wells [MW-7 through MW-10 (**Figure 2**)].

Before commencing well destruction activities the total depths of each well were measured. The total depth of each monitoring well was within 0.1 feet of its original depth. **Table 1** shows the construction details and destruction details of each well.

The four monitoring wells were destroyed by pressure grouting using neat cement. Each monitoring well was filled with neat cement until the neat cement remained stable near the top of the casing. Then an air compressor was attached to the well and 25 pounds per square inch (psi) was applied for 5 minutes. If the grout level dropped or the pressure did not hold for 5 minutes, more grout was added and pressure was reapplied until each monitoring well held 25 psi for 5 minutes without a significant drop in the grout level in the monitoring well. In addition to pressure grouting, each monitoring well had the well box removed using a jackhammer. After each well box was removed the open hole was backfilled with concrete. Concrete patches were dyed black to match the color of the surrounding asphalt.

As required by the permit, a copy of the completed Department of Water Resources (DWR) forms was submitted to the ACPWA instead of to the DWR. DWR Well Completion Reports for the four monitoring wells are presented as **Attachment C**.

2.3 Disposal of Derived Waste

No waste soil or waste water was generated during well destruction activities. Construction debris was removed from the site and disposed by Gregg.

3.0 CONCLUSIONS

The previously discussed groundwater monitoring well destruction activities conclude Antea Group's environmental work at the subject site.

4.0 REMARKS

The recommendations contained in this report represent Antea USA, Inc.'s professional opinions based upon the currently available information and are arrived at in accordance with currently accepted professional standards. This report is based upon a specific scope of work requested by the client. For any reports cited that were not generated by Delta or Antea Group, the data from those reports is used "as is" and is assumed to be accurate. Antea Group does not guarantee the accuracy of this data for the referenced work performed nor the inferences or conclusions stated in these reports. The contract between Antea USA, Inc. and its client outlines the scope of work, and only those tasks specifically authorized by that contract or outlined in this report were performed. This report is intended only for the use of Antea USA, Inc.'s client and anyone else specifically identified in writing by Antea USA, Inc. as a user of this report. Antea USA, Inc. will not and cannot be liable for unauthorized reliance by any other third party. Other than as contained in this paragraph, Antea USA, Inc. makes no express or implied warranty as to the contents of this report.

Prepared by:



Jonathan Fillingame
Staff Geologist

Information, conclusions, and recommendations provided by Antea Group in this document regarding the site have been prepared under the supervision of and reviewed by the licensed professional whose signature appears below.

Licensed Approver:

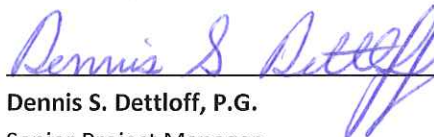

Dennis S. Dettloff, P.G.
Senior Project Manager
California Registered Professional Geologist No. 7480

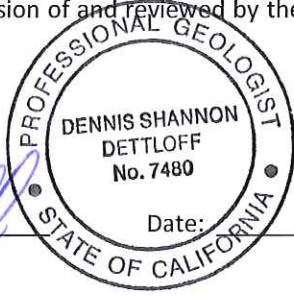
Date: 5/31/13

Figures

- Figure 1 Site Location Map
- Figure 2 Site Plan

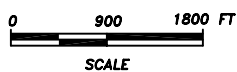
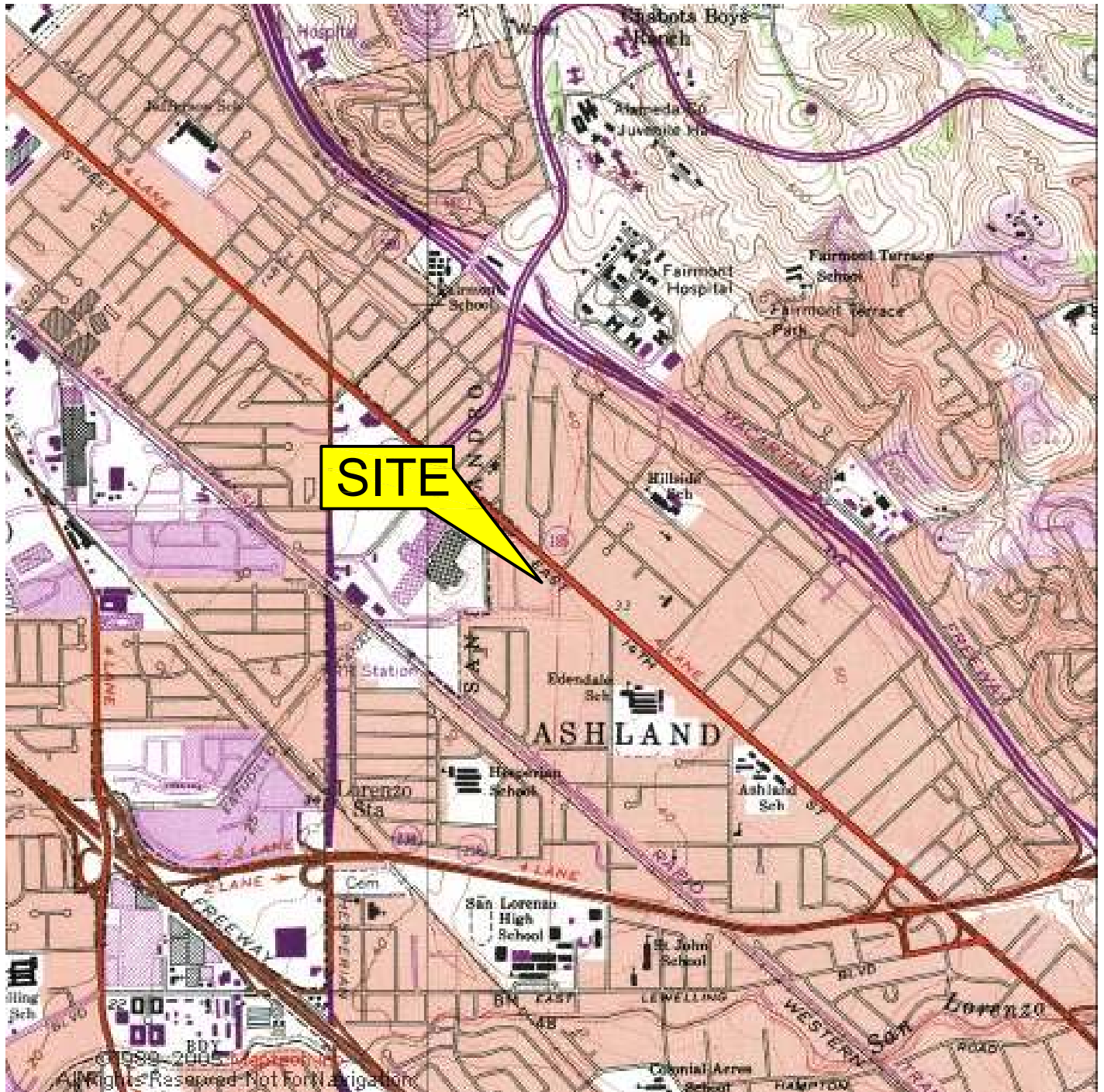

SOURCE: USGS 7.5 MINUTE TOPOGRAPHIC MAP, SAN LEANDRO QUADRANGLE (1973)

FIGURE 1
SITE LOCATION MAP

76 SERVICE STATION NO. 6277
15803 EAST 14TH STREET
SAN LEANDRO, CALIFORNIA

PROJECT NO. I4256277	DRAWN BY JH 05/13/11
FILE NO. 6277-SiteLocator	PREPARED BY EW
REVISION NO.	REVIEWED BY



LEGEND:

- — — — — APPROXIMATE PROPERTY BOUNDARY
- x - x - FENCE
- - - - - FORMER EXCAVATION AREA
- ⊕ MONITORING WELL LOCATION (ANTEA GROUP 2011)

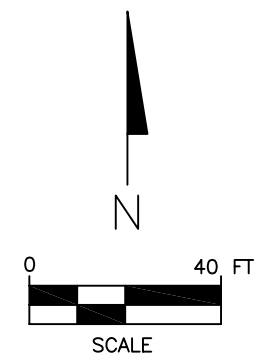
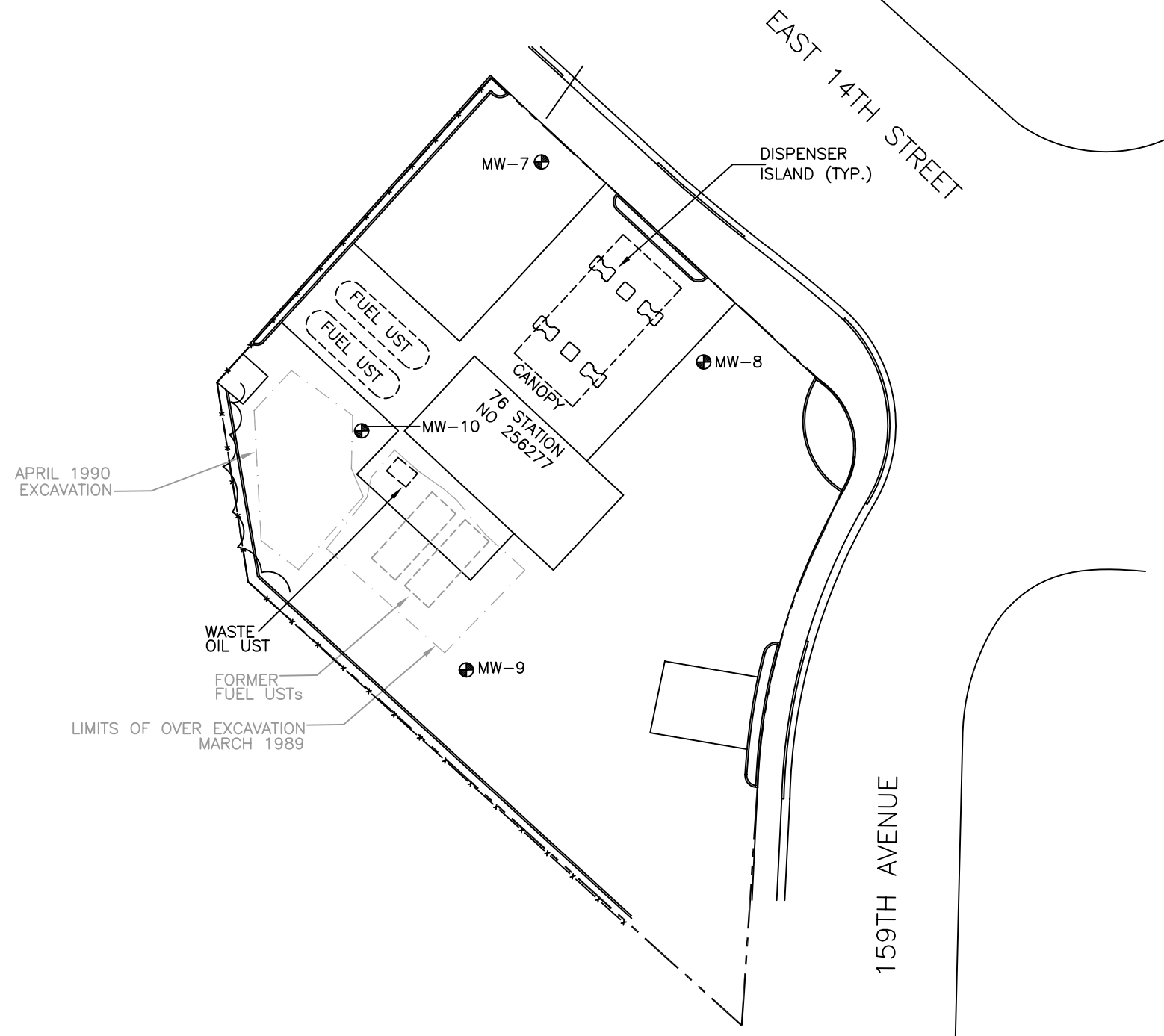

SITE PLAN ADAPTED FROM A SURVEY BY MORROW SURVEYING 2011 AND BASE MAPS DATED 1989 AND 2003 BY KEI AND 2007 BY ATC AND ASSOCIATES.

**FIGURE 2
SITE PLAN**

76 SERVICE STATION NO. 6277
15803 EAST 14TH STREET
SAN LEANDRO, CALIFORNIA

PROJECT NO. 14256277	PREPARED BY EW	DRAWN BY JH
DATE 04/21/11	REVIEWED BY DD	FILE NAME 6277-SMS



Table

Table 1 Well Destruction Details

TABLE 1
Well Construction Details
76 Service Station No. 6277
15803 East 14th Street
San Leandro, Ca

Well I.D.	Construction Date	Elevation (TOC feet above MSL)	Original Boring Depth (feet bgs)	Casing Diameter (inches)	Casing Material	Screen Size (inches)	Screened Interval (feet bgs)	Filter Pack Interval (feet bgs)	Bentonite Seal Interval (feet bgs)	Cement Seal Interval (feet bgs)	Destruction Date	Destruction Method
Groundwater Monitoring Wells												
MW-7	04/05/11	34.60	20	2	PVC	0.02	9-19	8-20	7-8	1-7	05/22/13	Pressure Grout
MW-8	04/05/11	34.85	20	2	PVC	0.02	9-20	8-20	7-8	1-7	05/22/13	Pressure Grout
MW-9	04/05/11	35.09	20	2	PVC	0.02	9-24	8-24	7-8	1-7	05/22/13	Pressure Grout
MW-10	04/05/11	36.00	24	2	PVC	0.02	9-20	8-20	7-8	1-7	05/22/13	Pressure Grout

Notes:

TOC = top of casing

MSL = mean sea level

bgs = below ground surface

Elevations are in US survey feet, Vertical Datum is NGVD29

Attachment A

ACHCSA E-mail

Jonathan Fillingame

From: Nowell, Keith, Env. Health <Keith.Nowell@acgov.org>
Sent: Friday, May 10, 2013 4:56 PM
To: Shane Nolan (snolan@platinum-energy.net)
Cc: 'Ralston, Ed C.'; Dennis Dettloff
Subject: RO2969-Unocal #6277, 15803 E. 14th St, San Leandro, CA

Dear Mr. Nolan,

This email serves as notification of the conclusion of the Public Notification period for the Unocal #6277 facility located at 15803 E. 14th St in San Leandro, California. Alameda County Environmental Health (ACEH) has not received any public comments regarding the closure of the leaking underground storage tank case for this facility. Please proceed with the well destruction at the facility as requested in our Directive Letter dated March 7, 2013. Please provide ACEH with a Well Destruction Report by June 14th, 2013.

Thank you,
Keith Nowell

Keith Nowell PG, CHG
Hazardous Materials Specialist
Alameda County Environmental Health
1131 Harbor Bay Parkway
Alameda, CA 94502-6540
phone: 510 / 567 - 6764
fax: 510 / 337 - 9335
email: keith.nowell@acgov.org

PDF copies of case files can be reviewed/downloaded at:

<http://www.acgov.org/aceh/lop/ust.htm>

Attachment B

Well Destruction Permits

Alameda County Public Works Agency - Water Resources Well Permit



399 Elmhurst Street
Hayward, CA 94544-1395
Telephone: (510)670-6633 Fax:(510)782-1939

Application Approved on: 03/28/2013 By jamesy

Permit Numbers: W2013-0252 to W2013-0255
Permits Valid from 05/22/2013 to 05/23/2013

Application Id: 1364316866132
Site Location: 15803 E 14th St, San Leandro, CA
Project Start Date: 05/22/2013
Assigned Inspector: Contact Steve Miller at (510) 670-5517 or stevem@acpwa.org

City of Project Site: San Leandro

Completion Date: 05/23/2013

Applicant: Antea Group - Ed Weyrens
11050 White Rock Rs, Ste 110, Rancho Cordova, CA 95670
Property Owner: Ali Aliasgari
15803 E 14th St, San Leandro, CA 94577
Client: Platinum Energy
30343 Canwood St, Ste 200, Augora Hills, CA 91301

Phone: 916-503-1277

Phone: 510-276-6336

Phone: 818-206-5705

Receipt Number: WR2013-0115	Total Due:	\$1588.00
Payer Name : Antea Group	Total Amount Paid:	\$1588.00
	Paid By: CHECK	PAID IN FULL

Works Requesting Permits:

Well Destruction-Monitoring - 4 Wells

Driller: Gregg Drilling, Inc - Lic #: 485165 - Method: press

Work Total: \$1588.00

Specifications

Permit #	Issued Date	Expire Date	Owner Well Id	Hole Diam.	Casing Diam.	Seal Depth	Max. Depth	State Well #	Orig. Permit #	DWR #
W2013-0252	03/28/2013	08/20/2013	MW-10	8.00 in.	2.00 in.	8.00 ft	20.00 ft	3S/2W6H	W2011-0157	e0128261
W2013-0253	03/28/2013	08/20/2013	MW-7	8.00 in.	2.00 in.	7.00 ft	20.00 ft	3S/2W6H	W2011-0154	e0128262
W2013-0254	03/28/2013	08/20/2013	MW-8	8.00 in.	2.00 in.	7.00 ft	20.00 ft	3S/2W6H	W2011-0155	e0128263
W2013-0255	03/28/2013	08/20/2013	MW-9	8.00 in.	2.00 in.	7.00 ft	24.00 ft	3S/2W6H	W2011-0156	e0128265

Specific Work Permit Conditions

1. Drilling Permit(s) can be voided/ cancelled only in writing. It is the applicant's responsibility to notify Alameda County Public Works Agency, Water Resources Section in writing for an extension or to cancel the drilling permit application. No drilling permit application(s) shall be extended beyond ninety (90) days from the original start date. Applicants may not cancel a drilling permit application after the completion date of the permit issued has passed.

2. Prior to any drilling activities, it shall be the applicant's responsibility to contact and coordinate an Underground Service Alert (USA), obtain encroachment permit(s), excavation permit(s) or any other permits or agreements required for that Federal, State, County or City, and follow all City or County Ordinances. No work shall begin until all the permits and requirements have been approved or obtained. It shall also be the applicants responsibilities to provide to the Cities or to Alameda County an Traffic Safety Plan for any lane closures or detours planned. No work shall begin until all the permits and requirements have been approved or obtained.

3. Compliance with the well-sealing specifications shall not exempt the well-sealing contractor from complying with appropriate State reporting-requirements related to well construction or destruction (Sections 13750 through 13755 (Division 7, Chapter 10, Article 3) of the California Water Code). Contractor must complete State DWR Form 188 and mail original to the Alameda County Public Works Agency, Water Resources Section, within 60 days. Include permit

Alameda County Public Works Agency - Water Resources Well Permit

number and site map.

4. Applicant shall submit the copies of the approved encroachment permit to this office within 60 days.
5. Permittee shall assume entire responsibility for all activities and uses under this permit and shall indemnify, defend and save the Alameda County Public Works Agency, its officers, agents, and employees free and harmless from any and all expense, cost and liability in connection with or resulting from the exercise of this Permit including, but not limited to, property damage, personal injury and wrongful death.
6. Applicant shall contact Steve Miller for an inspection time at (510) 670-5517 or email to stevem@acpwa.org at least five (5) working days prior to starting, once the permit has been approved. Confirm the scheduled date(s) at least 24 hours prior to drilling.
7. Permittee, permittee's contractors, consultants or agents shall be responsible to assure that all material or waters generated during drilling, boring destruction, and/or other activities associated with this Permit will be safely handled, properly managed, and disposed of according to all applicable federal, state, and local statutes regulating such. In no case shall these materials and/or waters be allowed to enter, or potentially enter, on or off-site storm sewers, dry wells, or waterways or be allowed to move off the property where work is being completed.
8. Remove the Christy box or similar structure.

Destroy well by grouting neat cement with a tremie pipe or pressure grouting (25 psi for 5min.) to the bottom of the well and by filling with neat cement to three (3-5) feet below surface grade. Allow the sealing material to spill over the top of the casing to fill any annular space between casing and soil.

After the seal has set, backfill the remaining hole with concrete or compacted material to match existing conditions.

9. Copy of approved drilling permit must be on site at all times. Failure to present or show proof of the approved permit application on site shall result in a fine of \$500.00.
-

Attachment C

DWR Well Completion Reports

CONFIDENTIAL

STATE OF CALIFORNIA DWR
WELL COMPLETION REPORT
(WELL LOGS)

REMOVED

CONFIDENTIAL

STATE OF CALIFORNIA DWR
WELL COMPLETION REPORT
(WELL LOGS)

REMOVED

CONFIDENTIAL

**STATE OF CALIFORNIA DWR
WELL COMPLETION REPORT
(WELL LOGS)**

REMOVED

CONFIDENTIAL

STATE OF CALIFORNIA DWR
WELL COMPLETION REPORT
(WELL LOGS)

REMOVED