



Edward C. Ralston
Program Manager
Remediation Management
Phillips 66 Company
76 Broadway
Sacramento, CA 95818
Phone 916.558.7633
ed.c.ralston@P66.com

November 2, 2012

Ms. Barbara Jakub
Alameda County Environmental Health
1131 Harbor Bay Parkway
Alameda, California 94502-6577

RECEIVED

8:15 am, Nov 05, 2012

Alameda County
Environmental Health

Re: Report Submittal

**Well Abandonment Report
76 Service Station No. 251028
5300 Broadway
Oakland, California
Alameda County LOP Case #: RO0002967**

Dear Ms. Jakub:

I declare under penalty of perjury that to the best of my knowledge the information and/or recommendations contained in the attached report is/are true and correct.

If you have any questions or need additional information, please contact Ms. Lia Holden at (408) 826-1863.

Sincerely,

A handwritten signature in black ink that reads "Ed Ralston". The signature is written in a cursive style.

Edward Ralston
Program Manager
Remediation Management

Well Abandonment Report

*76 Service Station No. 251028
5300 Broadway
Oakland, California*

*Alameda County Environmental Health,
LOP Case # RO0002967*

*Antea Group Project No. I40251028
November 2, 2012*

Prepared for:
Barbara Jakub
Alameda County Health
Care Services Agency
1131 Harbor Bay Parkway, Suite 250
Alameda, California, 94502-6577

Prepared by:
Antea™Group
312 Piercy Road
San Jose, CA 95138
+1 800 477 7411



Table of Contents

1.0	INTRODUCTION	1
2.0	WELL ABANDONMENT ACTIVITIES	1
2.1	Well Abandonments	1
3.0	WASTE DISPOSAL	1
4.0	REMARKS.....	2

Figures

- Figure 1 Site Location Map
- Figure 2 Site Plan

Appendices

- Appendix A Agency Correspondence
- Appendix B Well Abandonment Permits
- Appendix C Non-Hazardous Waste Manifest

Well Abandonment Report

76 Service Station No. 251028
5300 Broadway, Oakland, California USA
Alameda County Environmental Health
LOP Case # R00002967

1.0 INTRODUCTION

Antea™Group (Antea Group) has prepared this Well Abandonment Report to document the abandonment of three groundwater monitoring wells (MW-1 through MW-3) associated with the subject site. These wells were abandoned as requested in correspondence from the Alameda County Health Care Services (ACHCS). A Site Location Map and Site Plan are provided as **Figure 1** and **Figure 2**, respectively. Agency correspondence granting closure concurrence and the directive to destroy site monitoring wells is provided as **Appendix A**. Following agency review of this report, Antea Group requests to receive correspondence documenting final case closure for the site.

2.0 WELL ABANDONMENT ACTIVITIES

All wells were destroyed by Gregg Drilling and Testing, Inc. (Gregg), C-57 License #485165, under the supervision of Antea Group. Antea Group obtained well abandonment permits from the Alameda County Public Works Agency (**Appendix B**).

2.1 Well Abandonments

On September 27, 2012, each well was over-drilled and grouted by filling the well with neat cement grout until the level of grout within the well stabilized (until the level did not decrease). Following grouting, the upper five feet of each well was drilled out with 8-inch diameter hollow-stem augers. Monitoring wells MW-1, MW-2, and MW-3 were then grouted to the surface, capped with concrete and dyed black to match the surrounding asphalt surface. Following well abandonment, Antea Group and Gregg completed Notice of Completion forms for the Department of Water Resources (DWR). These forms have been sent to Alameda County Public Works Agency (ACPWA) for their records and review and subsequent submittal to the DWR.

3.0 WASTE DISPOSAL

Soil cuttings and construction debris (concrete and well casing material) generated during well abandonment activities were placed in Department of Transportation (DOT) approved 55-gallon drums, sealed and labeled in accordance with the corresponding DOT protocols for non-hazardous waste and temporarily stored on site. The waste was profiled and drums were subsequently removed from the site on October 10, 2012 and transported to an approved disposal facility. A copy of the non-hazardous waste manifest is provided as **Appendix C**.

4.0 REMARKS

The findings contained in this report represent Antea Group's professional opinions based upon the currently available information and are arrived at in accordance with currently acceptable professional standards. For any reports cited that were not generated by Antea USA, Inc., the data from those reports are used "as is" and is assumed to be accurate. Antea USA, Inc does not guarantee the accuracy of this data for the referenced work performed nor the inferences or conclusions stated in these reports. This report is based upon a specific scope of work requested by the client. The Contract between Antea Group and its client outlines the scope of work, and only those tasks specifically authorized by that contract or outlined in this report were performed. This report is intended only for the use of Antea Group's Client and anyone else specifically listed on this report. Antea Group will not and cannot be liable for unauthorized reliance by any other third party. Other than as contained in this paragraph, Antea Group makes no express or implied warranty as to the contents of this report.

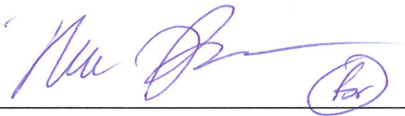

Renee Ransom
Staff Professional
Antea Group

Reviewed by:

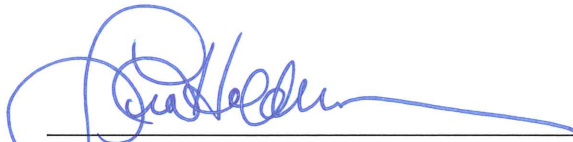

Lia Holden, P.G.
Senior Project Manager
Antea Group

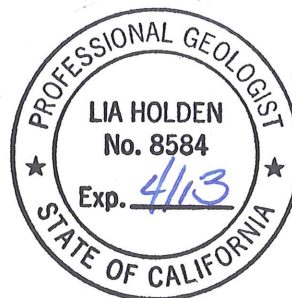

Figures

- Figure 1 Site Location Map
- Figure 2 Site Plan

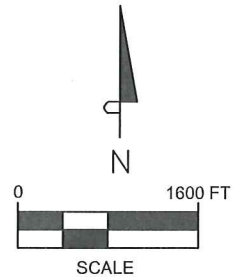
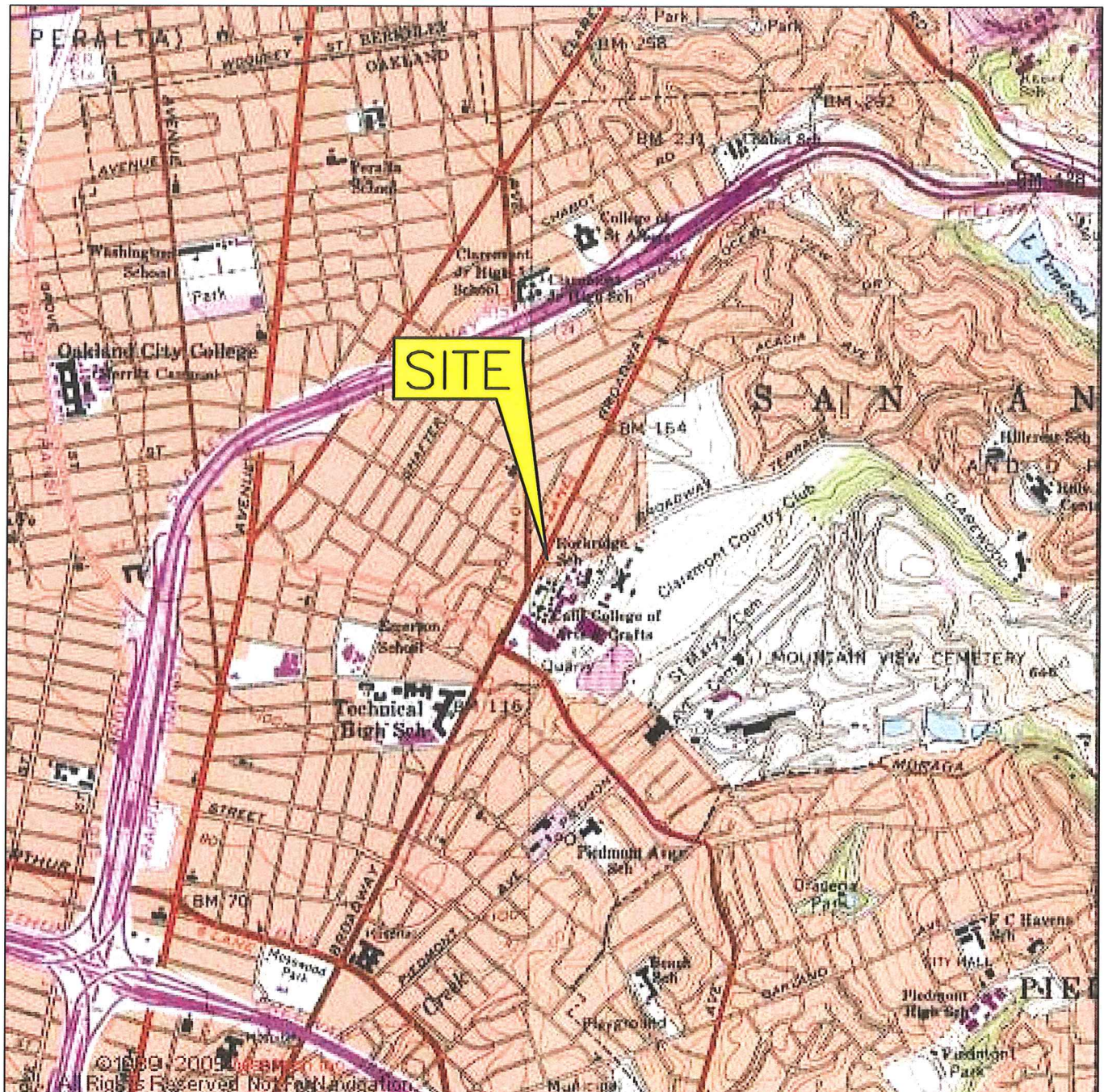

FIGURE 1
SITE LOCATION MAP

76 STATION NO. 1028
5300 BROADWAY AVENUE
OAKLAND, CALIFORNIA

PROJECT NO. 140251028	PREPARED BY NP	DRAWN BY JH
DATE 04/19/10	REVIEWED BY LH	FILE NAME 1028-Topo



SOURCE: USGS 7.5 MINUTE TOPOGRAPHIC MAP, OAKLAND EAST QUADRANGLE (1973)

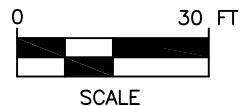
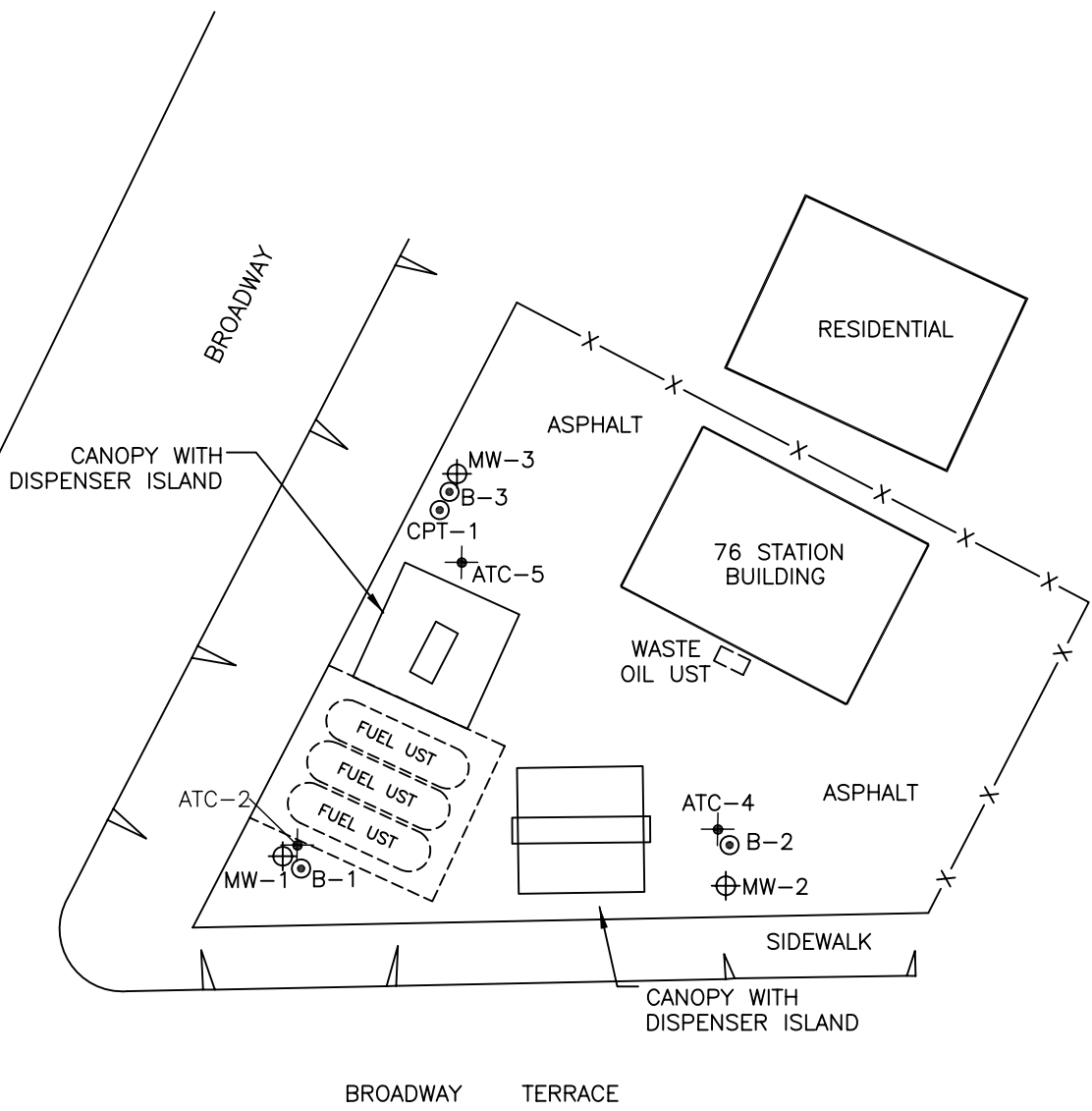

SITE MAP ADAPTED FROM A SURVEY BY MIDCOAST ENGINEERS, DECEMBER 2010 AND A SITE MAP BY ATC ASSOCIATES, 2007.

LEGEND:

- — — — — APPROXIMATE PROPERTY BOUNDARY
- ATC-5 SOIL BORING LOCATION (ATC 2007)
- MW-3 MONITORING WELL LOCATION (DELTA 2010)
- B-3 SOIL BORING LOCATION (DELTA 2010)

FIGURE 2
SITE MAP

76 STATION NO. 1028
5300 BROADWAY
OAKLAND, CALIFORNIA

PROJECT NO. 140251028	PREPARED BY NP	DRAWN BY KYM	
DATE 07/07/10	REVIEWED BY LH	FILE NAME 1028-Site	

*Well Abandonment Report
76 Service Station No. 251028
5300 Broadway, Oakland, California
Antea Group Project No. I40251028*



Appendix A

Agency Correspondence

ALAMEDA COUNTY
HEALTH CARE SERVICES
AGENCY
ALEX BRISCOE, Agency Director



ENVIRONMENTAL HEALTH SERVICES
ENVIRONMENTAL PROTECTION
1131 Harbor Bay Parkway, Suite 250
Alameda, CA 94502-6577
(510) 567-6700
FAX (510) 337-9335

August 16, 2012

Ms. Shari London
ConocoPhillips
3900 Kilroy Airport Way
Long Beach, CA 90806 (*Sent via*
E-mail to: Shari.A.London@conocophillips.com)

Mr. Mohammad Ahmadi
Lafayette Investment Group, LLC
587 Ygnacio Valley Road
Walnut Creek, CA 94596

Ms. Elizabeth Bochnak
64 Glenwild Rd.
Madison, NJ 07940

Subject: Monitoring Well Decommissioning for Case Closure of Fuel Leak Case No. RO0002967 Global ID # T0619732490, Unocal #1028 / ConocoPhillips #251028, 5300 Broadway, Oakland, CA 94618

Dear Ms. London, et. al.:

Alameda County Environmental Health (ACEH) staff have reviewed the fuel leak case file and case closure summary for the above-referenced site and concur that no further action related to the underground storage tank fuel release is required at this time. No comments were received on the proposed case closure during a public comment period conducted between July 16, 2012 and August 16, 2012. Prior to issuance of remedial action completion certification and case closure, we request that the monitoring wells at the site be properly decommissioned. Please decommission the monitoring wells and provide documentation of the well decommissioning to this office by the due date requested below. Remedial action completion certification will be issued following receipt of the documentation.

Well destruction permits may be obtained from the Alameda County Public Works Agency (<http://www.acgov.org/pwa/wells/index.shtml>).

NOTIFICATION OF FIELDWORK ACTIVITIES

Please schedule the fieldwork activities and provide ACEH with at least three (3) business days notification prior to conducting the fieldwork.

TECHNICAL REPORT REQUEST

Please submit technical reports to ACEH (Attention: Barbara Jakub), according to the following schedule:

- **September 26, 2012** – Well Decommissioning Report

Ms. London et. al.
RO0002967
August 16, 2012, Page 2

Thank you for your cooperation. Should you have any questions or concerns regarding this correspondence or your case, please call me at (510) 639-1287 or send me an electronic mail message at barbara.jakub@acgov.org.

Sincerely,

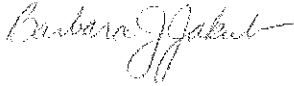

Digitally signed by Barbara J. Jakub
DN: cn=Barbara J. Jakub, o, ou,
email=barbara.jakub@acgov.org,
c=US
Date: 2012.08.16 14:41:03 -07'00'

Barbara J. Jakub, P.G.
Hazardous Materials Specialist

Enclosures: Responsible Party(ies) Legal Requirements/Obligations
ACEH Electronic Report Upload (ftp) Instructions

cc: Lia Holden, 312 Percy Road, San Jose, CA 95138 (Sent via E-mail to: Lia.Holden@anteagroup.com)
Leroy Griffin, Oakland Fire Department, 250 Frank H. Ogawa Plaza, Ste. 3341, Oakland, CA 94612-2032
(Sent via E-mail to: lgriffin@oaklandnet.com)
Donna Drogos, ACEH (Sent via E-mail to: donna.drogos@acgov.org)
Barbara Jakub, ACEH (Sent via E-mail to: barbara.jakub@acgov.org)
GeoTracker, file

Responsible Party(ies) Legal Requirements/Obligations

REPORT REQUESTS

These reports are being requested pursuant to California Health and Safety Code Section 25296.10. 23 CCR Sections 2652 through 2654, and 2721 through 2728 outline the responsibilities of a responsible party in response to an unauthorized release from a petroleum UST system, and require your compliance with this request.

ELECTRONIC SUBMITTAL OF REPORTS

ACEH's Environmental Cleanup Oversight Programs (LOP and SLIC) require submission of reports in electronic form. The electronic copy replaces paper copies and is expected to be used for all public information requests, regulatory review, and compliance/enforcement activities. Instructions for submission of electronic documents to the Alameda County Environmental Cleanup Oversight Program FTP site are provided on the attached "Electronic Report Upload Instructions." Submission of reports to the Alameda County FTP site is an addition to existing requirements for electronic submittal of information to the State Water Resources Control Board (SWRCB) GeoTracker website. In September 2004, the SWRCB adopted regulations that require electronic submittal of information for all groundwater cleanup programs. For several years, responsible parties for cleanup of leaks from underground storage tanks (USTs) have been required to submit groundwater analytical data, surveyed locations of monitoring wells, and other data to the GeoTracker database over the Internet. Beginning July 1, 2005, these same reporting requirements were added to Spills, Leaks, Investigations, and Cleanup (SLIC) sites. Beginning July 1, 2005, electronic submittal of a complete copy of all reports for all sites is required in GeoTracker (in PDF format). Please visit the SWRCB website for more information on these requirements (http://www.swrcb.ca.gov/ust/electronic_submittal/report_rqmts.shtml).

PERJURY STATEMENT

All work plans, technical reports, or technical documents submitted to ACEH must be accompanied by a cover letter from the responsible party that states, at a minimum, the following: "I declare, under penalty of perjury, that the information and/or recommendations contained in the attached document or report is true and correct to the best of my knowledge." This letter must be signed by an officer or legally authorized representative of your company. Please include a cover letter satisfying these requirements with all future reports and technical documents submitted for this fuel leak case.

PROFESSIONAL CERTIFICATION & CONCLUSIONS/RECOMMENDATIONS

The California Business and Professions Code (Sections 6735, 6835, and 7835.1) requires that work plans and technical or implementation reports containing geologic or engineering evaluations and/or judgments be performed under the direction of an appropriately registered or certified professional. For your submittal to be considered a valid technical report, you are to present site specific data, data interpretations, and recommendations prepared by an appropriately licensed professional and include the professional registration stamp, signature, and statement of professional certification. Please ensure all that all technical reports submitted for this fuel leak case meet this requirement.

UNDERGROUND STORAGE TANK CLEANUP FUND

Please note that delays in investigation, later reports, or enforcement actions may result in your becoming ineligible to receive grant money from the state's Underground Storage Tank Cleanup Fund (Senate Bill 2004) to reimburse you for the cost of cleanup.

AGENCY OVERSIGHT

If it appears as though significant delays are occurring or reports are not submitted as requested, we will consider referring your case to the Regional Board or other appropriate agency, including the County District Attorney, for possible enforcement actions. California Health and Safety Code, Section 25299.76 authorizes enforcement including administrative action or monetary penalties of up to \$10,000 per day for each day of violation.

Alameda County Environmental Cleanup Oversight Programs (LOP and SLIC)	REVISION DATE: July 20, 2010
	ISSUE DATE: July 5, 2005
	PREVIOUS REVISIONS: October 31, 2005; December 16, 2005; March 27, 2009; July 8, 2010
SECTION: Miscellaneous Administrative Topics & Procedures	SUBJECT: Electronic Report Upload (ftp) Instructions

The Alameda County Environmental Cleanup Oversight Programs (LOP and SLIC) require submission of all reports in electronic form to the county's ftp site. Paper copies of reports will no longer be accepted. The electronic copy replaces the paper copy and will be used for all public information requests, regulatory review, and compliance/enforcement activities.

REQUIREMENTS

- **Please do not submit reports as attachments to electronic mail.**
- Entire report including cover letter must be submitted to the ftp site as a **single portable document format (PDF) with no password protection.**
- It is **preferable** that reports be converted to PDF format from their original format, (e.g., Microsoft Word) rather than scanned.
- **Signature pages and perjury statements must be included and have either original or electronic signature.**
- **Do not password protect the document.** Once indexed and inserted into the correct electronic case file, the document will be secured in compliance with the County's current security standards and a password. **Documents with password protection will not be accepted.**
- Each page in the PDF document should be rotated in the direction that will make it easiest to read on a computer monitor.
- Reports must be named and saved using the following naming convention:

RO#_Report Name_Year-Month-Date (e.g., RO#5555_WorkPlan_2005-06-14)

Submission Instructions

- 1) Obtain User Name and Password
 - a) Contact the Alameda County Environmental Health Department to obtain a User Name and Password to upload files to the ftp site.
 - i) Send an e-mail to deh.loptoxic@acgov.org
 - b) In the subject line of your request, be sure to include "**ftp PASSWORD REQUEST**" and in the body of your request, include the **Contact Information, Site Addresses, and the Case Numbers (RO# available in Geotracker) you will be posting for.**
- 2) Upload Files to the ftp Site
 - a) Using Internet Explorer (IE4+), go to <ftp://alcoftp1.acgov.org>
 - (i) Note: Netscape, Safari, and Firefox browsers will not open the FTP site as they are NOT being supported at this time.
 - b) Click on Page located on the Command bar on upper right side of window, and then scroll down to Open FTP Site in Windows Explorer.
 - c) Enter your User Name and Password. (Note: Both are Case Sensitive.)
 - d) Open "My Computer" on your computer and navigate to the file(s) you wish to upload to the ftp site.
 - e) With both "My Computer" and the ftp site open in separate windows, drag and drop the file(s) from "My Computer" to the ftp window.
- 3) Send E-mail Notifications to the Environmental Cleanup Oversight Programs
 - a) Send email to deh.loptoxic@acgov.org notify us that you have placed a report on our ftp site.
 - b) Copy your Caseworker on the e-mail. Your Caseworker's e-mail address is the entire first name then a period and entire last name @acgov.org. (e.g., firstname.lastname@acgov.org)
 - c) The subject line of the e-mail must start with the RO# followed by **Report Upload**. (e.g., Subject: RO1234 Report Upload) If site is a new case without an RO#, use the street address instead.
 - d) If your document meets the above requirements and you follow the submission instructions, you will receive a notification by email indicating that your document was successfully uploaded to the ftp site.

*Well Abandonment Report
76 Service Station No. 251028
5300 Broadway, Oakland, California
Antea Group Project No. I40251028*



Appendix B

Well Abandonment Permits

Alameda County Public Works Agency - Water Resources Well Permit



399 Elmhurst Street
Hayward, CA 94544-1395
Telephone: (510)670-6633 Fax:(510)782-1939

Application Approved on: 08/31/2012 By jamesy

Permit Numbers: W2012-0633 to W2012-0635
Permits Valid from 09/27/2012 to 09/27/2012

Application Id: 1345498268164
Site Location: 5300 Broadway
Project Start Date: 09/27/2012
Assigned Inspector: Contact Vicky Hamlin at (510) 670-5443 or vickyh@acpwa.org

City of Project Site:Oakland

Completion Date:09/27/2012

Applicant: Antea Group - Nadine Periat
312 Piercy Road, San Jose, CA 95120
Property Owner: Lafayette Investment Group, LLC
587 Emacio Valley Rd, Walnut Creek, CA 94596
Client: Antea Group
312 Piercy Road, San Jose, CA 95138

Phone: 408-826-1879

Phone: --

Phone: 408-826-1879

Receipt Number: WR2012-0286	Total Due:	\$1191.00
Payer Name : AnteaUSA Inc.	Total Amount Paid:	\$1191.00
	Paid By: CHECK	PAID IN FULL

Works Requesting Permits:

Well Destruction-Monitoring - 3 Wells

Driller: Gregg Drilling and Testing - Lic #: 485165 - Method: hstem

Work Total: \$1191.00

Specifications

Permit #	Issued Date	Expire Date	Owner Well Id	Hole Diam.	Casing Diam.	Seal Depth	Max. Depth	State Well #	Orig. Permit #	DWR #
W2012-0633	08/31/2012	12/26/2012	MW-1	8.00 in.	2.00 in.	1.50 ft	12.00 ft	1S/4W13Q	W2010-0825	e0123022
W2012-0634	08/31/2012	12/26/2012	MW-2	8.00 in.	2.00 in.	1.50 ft	12.00 ft	1S/4W13Q	W2010-0826	e0123023
W2012-0635	08/31/2012	12/26/2012	MW-3	8.00 in.	2.00 in.	1.50 ft	12.00 ft	1S/4W13Q	W2010-0827	e0123025

Specific Work Permit Conditions

1. Drilling Permit(s) can be voided/ cancelled only in writing. It is the applicant's responsibility to notify Alameda County Public Works Agency, Water Resources Section in writing for an extension or to cancel the drilling permit application. No drilling permit application(s) shall be extended beyond ninety (90) days from the original start date. Applicants may not cancel a drilling permit application after the completion date of the permit issued has passed.

2. Prior to any drilling activities, it shall be the applicant's responsibility to contact and coordinate an Underground Service Alert (USA), obtain encroachment permit(s), excavation permit(s) or any other permits or agreements required for that Federal, State, County or City, and follow all City or County Ordinances. No work shall begin until all the permits and requirements have been approved or obtained. It shall also be the applicants responsibilities to provide to the Cities or to Alameda County an Traffic Safety Plan for any lane closures or detours planned. No work shall begin until all the permits and requirements have been approved or obtained.

3. Compliance with the well-sealing specifications shall not exempt the well-sealing contractor from complying with appropriate State reporting-requirements related to well construction or destruction (Sections 13750 through 13755 (Division 7, Chapter 10, Article 3) of the California Water Code). Contractor must complete State DWR Form 188 and mail original to the Alameda County Public Works Agency, Water Resources Section, within 60 days. Include permit number and site map.

Alameda County Public Works Agency - Water Resources Well Permit

4. Applicant shall submit the copies of the approved encroachment permit to this office within 60 days.
 5. Permittee shall assume entire responsibility for all activities and uses under this permit and shall indemnify, defend and save the Alameda County Public Works Agency, its officers, agents, and employees free and harmless from any and all expense, cost and liability in connection with or resulting from the exercise of this Permit including, but not limited to, property damage, personal injury and wrongful death.
 6. Applicant shall contact Vicky Hamlin for an inspection time at 510-670-5443 or email to vickyh@acpwa.org at least five (5) working days prior to starting, once the permit has been approved. Confirm the scheduled date(s) at least 24 hours prior to drilling.
 7. Permittee, permittee's contractors, consultants or agents shall be responsible to assure that all material or waters generated during drilling, boring destruction, and/or other activities associated with this Permit will be safely handled, properly managed, and disposed of according to all applicable federal, state, and local statutes regulating such. In no case shall these materials and/or waters be allowed to enter, or potentially enter, on or off-site storm sewers, dry wells, or waterways or be allowed to move off the property where work is being completed.
 8. Remove the Christy box or similar structure. Destroy well by overdrilling & Tremie Grouting with Cement. After the seal has set, backfill the remaining hole with concrete or compacted material to match existing.
 9. Copy of approved drilling permit must be on site at all times. Failure to present or show proof of the approved permit application on site shall result in a fine of \$500.00.
-

*Well Abandonment Report
76 Service Station No. 251028
5300 Broadway, Oakland, California
Antea Group Project No. I40251028*



Appendix C

Non-Hazardous Waste Manifest

Manifest

SOIL SAFE OF CA - TPST Non-Hazardous Soils

↓ Manifest # ↓

Date of Shipment: 10/24/12 Responsible for Payment: Transport Truck #: 383/476 Facility #: A07 Approval Number: 39942 Load #: 10011

Generator's Name and Billing Address: CONOCOPHILLIPS RM & R
ATTN: ED RALSTON
78 BROADWAY
SACRAMENTO, CA 95818

Generator's Phone #: 916-558-7833
Person to Contact:
FAX#: Customer Account Number

Consultant's Name and Billing Address:

Consultant's Phone #:
Person to Contact:
FAX#: Customer Account Number

Generation Site (Transport from): (name & address)
76 STATION NO. 261028
5300 BROADWAY
OAKLAND, CA 94618

Site Phone #:
Person to Contact:
FAX#:

Designated Facility (Transport to): (name & address)
SOIL SAFE
12328 HIBISCUS AVENUE
ADELANTO, CA 92301

Facility Phone #: (800) 802-8001
Person to Contact: DELLENA JEFFREY
FAX#: (760) 240-8004

Transporter Name and Mailing Address: BELSHIRE
25971 TOWNE CENTRE DRIVE
FOOTHILL RANCH, CA 92810 BESE: 211322

Transporter's Phone #: 949-460-5200 CAR000183813
Person to Contact: LARRY MOOTHART 450647
FAX#: 949-460-5210 Customer Account Number

Description of Soil	Moisture Content	Contaminated by:	Approx. Qty:	Description of Delivery	Gross Weight	Tare Weight	Net Weight
Sand <input type="checkbox"/> Organic <input type="checkbox"/> Clay <input type="checkbox"/> Other <input type="checkbox"/>	0 - 10% <input type="checkbox"/> 10 - 20% <input type="checkbox"/> 20% - over <input type="checkbox"/>	Gas <input type="checkbox"/> Diesel <input type="checkbox"/> Other <input type="checkbox"/>	1 dm		38100	37600	500
Sand <input type="checkbox"/> Organic <input type="checkbox"/> Clay <input type="checkbox"/> Other <input type="checkbox"/>	0 - 10% <input type="checkbox"/> 10 - 20% <input type="checkbox"/> 20% - over <input type="checkbox"/>	Gas <input type="checkbox"/> Diesel <input type="checkbox"/> Other <input type="checkbox"/>					.25

List any exception to items listed above: Scale Ticket # 104511

Generator's and/or consultant's certification: I/We certify that the soil referenced herein is taken entirely from those soils described in the Soil Data Sheet completed and certified by me/us for the Generation Site shown above and nothing has been added or done to such soil that would alter it in any way.

Print or Type Name: Generator Consultant Signature and date: [Signature] Month Day Year: 10/10/12

Transporter's certification: I/We acknowledge receipt of the soil referenced above and certify that such soil is being delivered in exactly the same condition as when received. I/We further certify that the soil is being directly transported from the Generation Site to the Designated Facility without off-loading, adding to, subtracting from or in any way delaying delivery to such site.

Print or Type Name: [Signature] Signature and date: [Signature] Month Day Year: 10/10/12

Discrepancies:
251028
805548

Recycling Facility certifies the receipt of the soil covered by this manifest except as noted above:
Print or Type Name: D. JEFFREY/J. PROVANSAL Signature and date: [Signature] 10/24/12

Generator and/or Consultant

Transporter

Recycling Facility

Please print or type.