



COUNTY OF ALAMEDA
Assessor's Office
Property Value System

[Help](#)

[New Query](#)

[History](#)

[Value](#)

[Transfer](#)

[Map](#)

[Glossary](#)

Parcel Number: **41-4142-38** Inactive: **N** Lien Date: **01/01/2010** Owner: **MAYORGA DANILO**
 Property Address: **1001 77TH AVE, OAKLAND, CA 94621-2527**

Mailing Name		Historical Mailing Address	Document Date	Document Number	Value From Trans Tax	Parcel Count	Use
MAYORGA DANILO	List Owners	5305 E 12TH ST , OAKLAND, CA 94601-5622	04/11/2008	2008-118812	\$240,000	1	<u>8100</u>
ACTS FULL GOSPEL CHURCH	List Owners	1034 66TH AVE , OAKLAND, CA 94621-3536	09/18/1998	1998-325163	\$63,000	1	<u>8100</u>
USTIN DANIEL	List Owners	PO BOX 591 , GARDEN VALL, ID 83622	12/02/1997	1997-316343		1	<u>8100</u>
CHU MAN F & SIUMEI L	List Owners	2985 CALIFORNIA ST , OAKLAND, CA 94602-3330	03/20/1992	1992-84737	\$105,000	1	<u>8100</u>
USTIN DANIEL	List Owners	220 REDWOOD HWY , MILL VALLEY, CA 94941-3607	05/30/1986	1986-125436		1	<u>8100</u>
OLHAUSEN A G & VERA A	List Owners	1001 77TH AVE , OAKLAND, CA 94621-2527	03/01/1969	TRAN-44663		1	<u>8100</u>

All information on this site is to be assumed accurate for property assessment purposes only, and is based upon the Assessor's knowledge of each property. Caution is advised for use other than its intended purpose.

The Alameda County Intranet site is best viewed in Internet Explorer Version 5.5 or later.
 Click [here](#) for more information regarding supported browsers.

Copyright © 2001 Alameda County

ASSESSOR'S MAP 41

Code Area Nos. 17-032

4142

Scale: 1" = 50'

RESUB.- TOWNSITE OF FITCHBURG (Bk. 17 Pg. 9)
FITCHBURG HOMESTEAD LOTS (Bk. 5 Pg. 8)
P.M. 7829 268/1-2

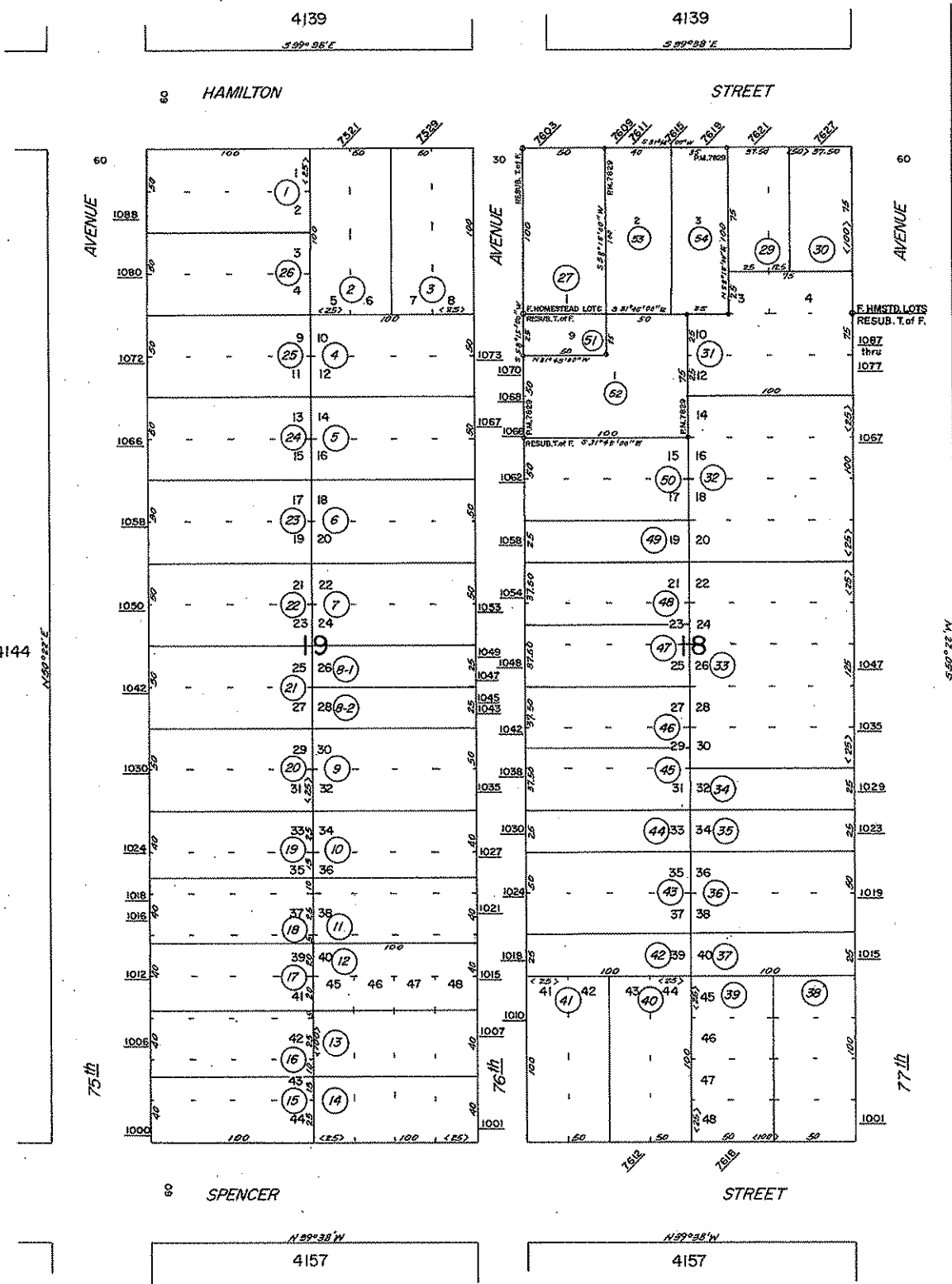

Drawn: 3-67 E.L. Revised: 4-23-86 JT
12-9-02 EG

Formerly: Blks. 4141, 8 4142, 3-67

4144

4211

4157

4157