



**CONESTOGA-ROVERS  
& ASSOCIATES**

5900 Hollis Street, Suite A  
Emeryville, California 94608  
Telephone: (510) 420-0700 Fax: (510) 420-9170  
www.CRAworld.com

## TRANSMITTAL

DATE: January 23, 2014 REFERENCE NO.: 201232

PROJECT NAME: 1801 Santa Rita Road, Pleasanton

TO: Jerry Wickham  
Alameda County Environmental Health  
1131 Harbor Bay Parkway, Suite 250  
Alameda, California 94502-6577

**RECEIVED**  
*By Alameda County Environmental Health at 3:58 pm, Feb 11, 2014*

Please find enclosed:  Draft  Final  
 Originals  Other  
 Prints

Sent via:  Mail  Same Day Courier  
 Overnight Courier  Other GeoTracker and Alameda County FTP

QUANTITY	DESCRIPTION
1	Well Destruction Report

As Requested  For Review and Comment  
 For Your Use

**COMMENTS:**  
If you have any questions regarding the contents of this document, please call the CRA project manager Peter Schaefer at (510) 420-3319 or the Shell program manager Marvin Katz at (310) 550-5846.

Copy to: Marvin Katz, Shell Oil Products US (electronic copy)  
Danielle Stefani, Livermore-Pleasanton Fire Department, 3560 Nevada Street, Pleasanton, CA 94566-6267  
Colleen Winey, Zone 7 Water Agency (electronic copy)

Completed by: Peter Schaefer Signed: *Peter Schaefer*

Filing: Correspondence File



Mr. Jerry Wickham  
Alameda County Environmental Health  
1131 Harbor Bay Parkway, Suite 250  
Alameda, California 94502-6577

**Shell Oil Products US**  
Soil and Groundwater Focus Delivery Group  
20945 S. Wilmington Avenue  
Carson, CA 90810  
Tel (310) 550 5846  
Fax (281) 582 4172  
Email [marvin.katz@shell.com](mailto:marvin.katz@shell.com)  
Internet <http://www.shell.com>

Re: 1801 Santa Rita Road  
Pleasanton, California  
SAP Code 135783  
Incident No. 97615964  
ACEH Case No. RO0002882

Dear Mr. Wickham:

The attached document is provided for your review and comment. Upon information and belief, I declare, under penalty of perjury, that the information contained in the attached document is true and correct.

As always, please feel free to contact me directly at (310) 550-5846 with any questions or concerns.

Sincerely,  
Shell Oil Products US

A handwritten signature in cursive script that reads "Marvin Katz".

Marvin Katz  
Senior Program Manager



## WELL DESTRUCTION REPORT

FORMER SHELL SERVICE STATION  
1801 SANTA RITA ROAD  
PLEASANTON, CALIFORNIA

SAP CODE           135783  
INCIDENT NO.     97615964  
AGENCY NO.       RO0002882

JANUARY 23, 2014  
REF. NO. 201232 (9)  
This report is printed on recycled paper.

**Prepared by:**  
**Conestoga-Rovers**  
**& Associates**

5900 Hollis Street, Suite A  
Emeryville, California  
U.S.A. 94608

Office: (510) 420-0700  
Fax: (510) 420-9170

web: [www.CRAworld.com](http://www.CRAworld.com)

TABLE OF CONTENTS

	<u>Page</u>
1.0 INTRODUCTION.....	1
2.0 WELL DESTRUCTIONS.....	1
2.1 FIELD DATE.....	1
2.2 PERSONNEL PRESENT .....	1
2.3 DESTRUCTION METHOD .....	1
2.4 WASTE DISPOSAL.....	1

LIST OF FIGURES  
(Following Text)

- FIGURE 1 VICINITY MAP  
FIGURE 2 SITE PLAN

LIST OF APPENDICES

- APPENDIX A PERMIT  
APPENDIX B DISPOSAL DOCUMENTATION

## 1.0 INTRODUCTION

Conestoga-Rovers & Associates (CRA) prepared this report on behalf of Equilon Enterprises LLC dba Shell Oil Products US (Shell) to document the recent well destructions at the referenced site.

The wells were properly destroyed to facilitate case closure as requested by Alameda County Environmental Health in their November 13, 2013 letter.

## 2.0 WELL DESTRUCTIONS

### 2.1 FIELD DATE

January 2 and 3, 2014.

### 2.2 PERSONNEL PRESENT

Geologist Scott Lewis directed the well destructions under the supervision of California Professional Geologist Peter Schaefer.

### 2.3 DESTRUCTION METHOD

After removing the well boxes, wells MW-1 through MW-6, MW-1A, and MW-4A were destroyed by pressure grouting. A copy of the Zone 7 Water Agency well destruction permit is included in Appendix A.

### 2.4 WASTE DISPOSAL

Construction debris was generated during the well destructions and was temporarily stored on site in 55-gallon drums. On January 17, 2014, the construction debris was transported to Allied Waste Industries' Keller Canyon Landfill in Pittsburg, California.

All of Which is Respectfully Submitted,  
CONESTOGA-ROVERS & ASSOCIATES



Peter Schaefer, CEG, CHG

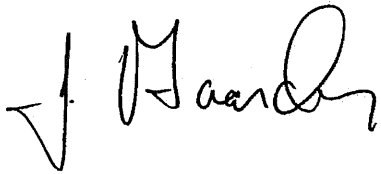
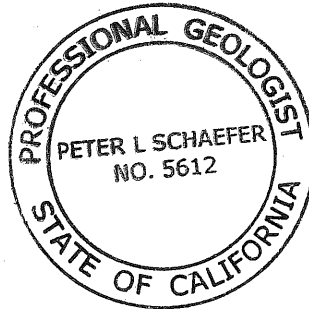

Aubrey K. Cool, PG

## FIGURES



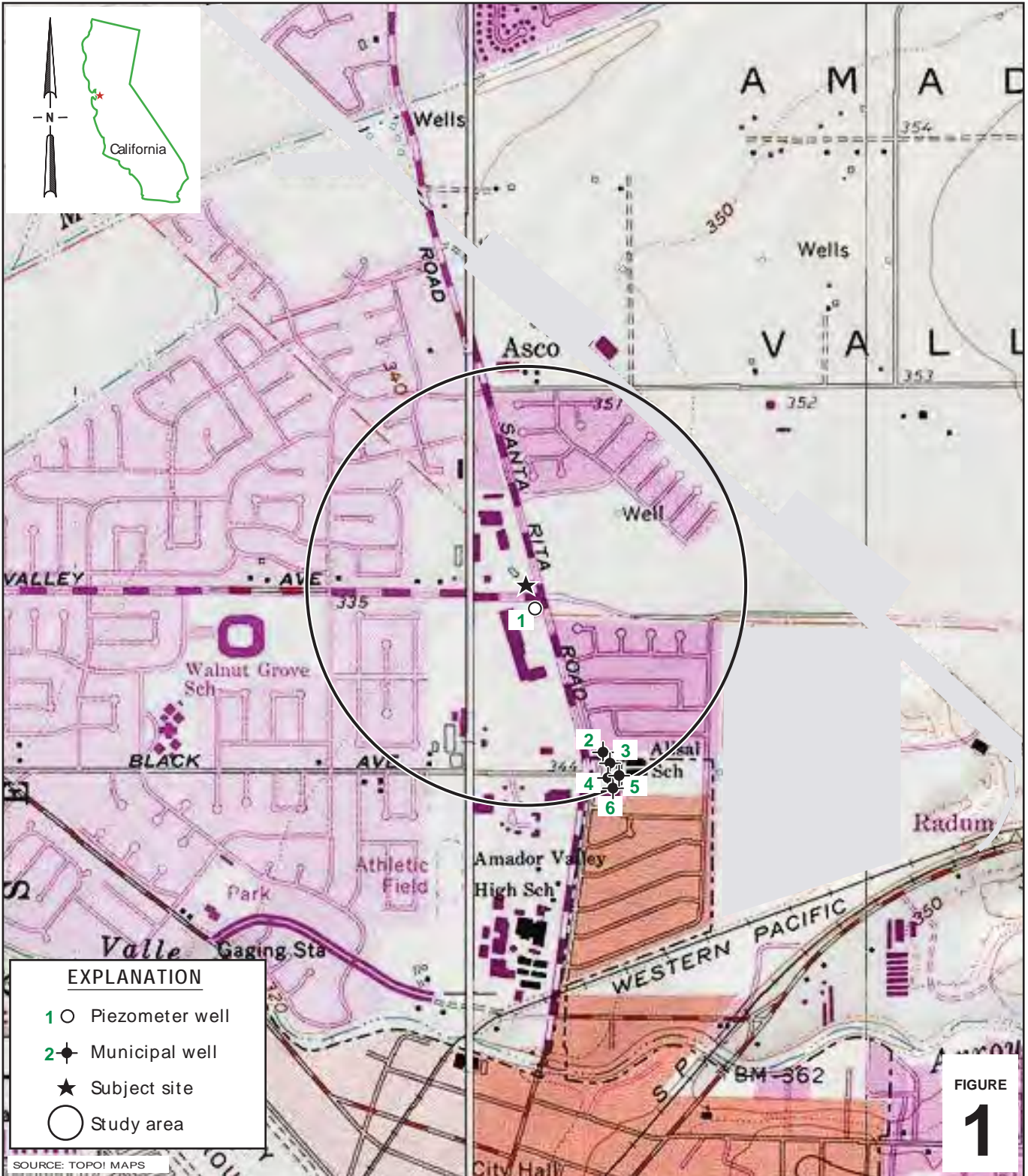
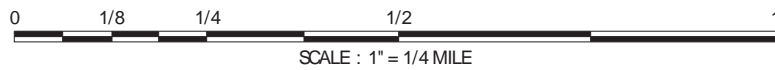

FIGURE 1



**Former Shell Service Station**  
 1801 Santa Rita Road  
 Pleasanton, California



**CONESTOGA-ROVERS & ASSOCIATES**

**Vicinity Map**

I:\Shell\6-chara\2012-1\201232-Pleasanton\_1801\_Santa\_Rita\201232-FIGURES\201232 VICINITY (F1).AI

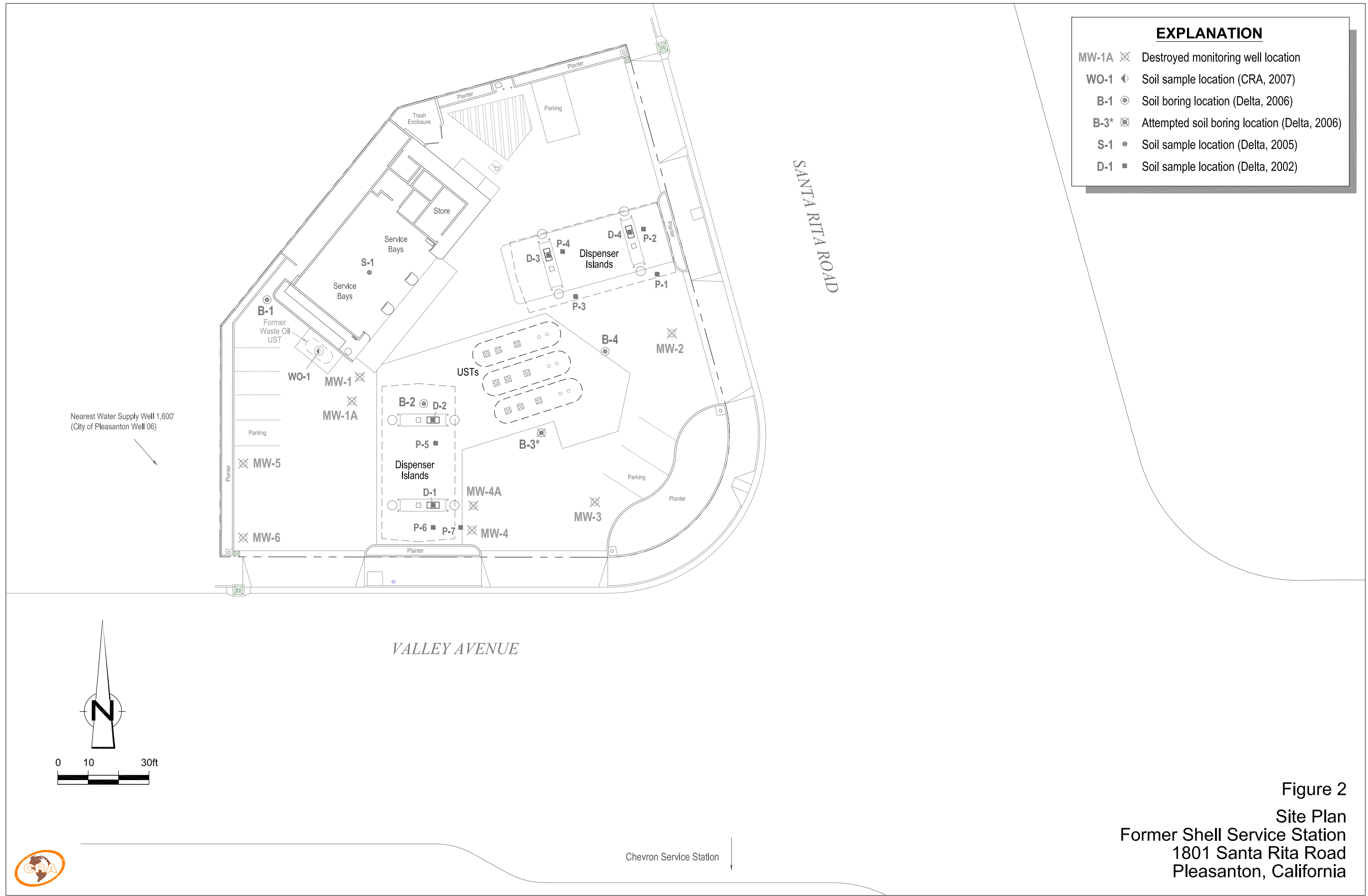

**EXPLANATION**

MW-1A	⊗	Destroyed monitoring well location
WO-1	◊	Soil sample location (CRA, 2007)
B-1	⊙	Soil boring location (Delta, 2006)
B-3*	⊗	Attempted soil boring location (Delta, 2006)
S-1	•	Soil sample location (Delta, 2005)
D-1	■	Soil sample location (Delta, 2002)

Figure 2  
 Site Plan  
 Former Shell Service Station  
 1801 Santa Rita Road  
 Pleasanton, California



APPENDIX A

PERMIT



# ZONE 7 WATER AGENCY

100 NORTH CANYONS PARKWAY, LIVERMORE, CALIFORNIA 94551 VOICE (925) 454-5000 FAX (925) 245-9306  
E-MAIL [whong@zone7water.com](mailto:whong@zone7water.com)

## DRILLING PERMIT APPLICATION

FOR APPLICANT TO COMPLETE

FOR OFFICE USE

LOCATION OF PROJECT 1801 Santa Rita Road  
Pleasanton, CA

PERMIT NUMBER 2013159  
WELL NUMBER MW-1 to MW-6  
APN 946-3295-003-06

Coordinates Source \_\_\_\_\_ ft. Accuracy \_\_\_\_\_ ft.  
LAT: \_\_\_\_\_ ft. LONG: \_\_\_\_\_ ft.  
APN 946-3295-003-06

PERMIT CONDITIONS  
(Circled Permit Requirements Apply)

CLIENT Name Shell Oil Products US  
Address 20945 Santa L. Wilington Ave Phone 310-550-5846  
City Carson, CA Zip 90810

- A. GENERAL
  1. A permit application should be submitted so as to arrive at the Zone 7 office five days prior to your proposed starting date.
  2. Submit to Zone 7 within 60 days after completion of permitted work the original Department of Water Resources Water Well Drillers Report (DWR Form 188), signed by the driller.
  3. Permit is void if project not begun within 90 days of approval date.
  4. Notify Zone 7 at least 24 hours before the start of work.

APPLICANT Name Scott Lewis - Constance - Rovers & Associates  
Email slewis@cravocdl.com Fax 707-935-6649  
Address 19449 Riverside Drive, Suite 230 Phone 707-933-2369  
City Sonoma, CA Zip 95476

- B. WATER SUPPLY WELLS
  1. Minimum surface seal diameter is four inches greater than the well casing diameter.
  2. Minimum seal depth is 50 feet for municipal and industrial wells or 20 feet for domestic and irrigation wells unless a lesser depth is specially approved.
  3. Grout placed by tremie.
  4. An access port at least 0.5 inches in diameter is required on the wellhead for water level measurements.
  5. A sample port is required on the discharge pipe near the wellhead.

TYPE OF PROJECT:  
Well Construction \_\_\_\_\_ Geotechnical Investigation \_\_\_\_\_  
Well Destruction  Contamination Investigation \_\_\_\_\_  
Cathodic Protection \_\_\_\_\_ Other \_\_\_\_\_

- C. GROUNDWATER MONITORING WELLS INCLUDING PIEZOMETERS
  1. Minimum surface seal diameter is four inches greater than the well or piezometer casing diameter.
  2. Minimum seal depth for monitoring wells is the maximum depth practicable or 20 feet.
  3. Grout placed by tremie.

PROPOSED WELL USE:  
Domestic \_\_\_\_\_ Irrigation \_\_\_\_\_  
Municipal \_\_\_\_\_ Remediation \_\_\_\_\_  
Industrial \_\_\_\_\_ Groundwater Monitoring   
Dewatering \_\_\_\_\_ Other \_\_\_\_\_

- D. GEOTECHNICAL. Backfill bore hole with compacted cuttings or heavy bentonite and upper two feet with compacted material. In areas of known or suspected contamination, tremied cement grout shall be used in place of compacted cuttings.

DRILLING METHOD:  
Mud Rotary \_\_\_\_\_ Air Rotary \_\_\_\_\_ Hollow Stem Auger \_\_\_\_\_  
Cable Tool \_\_\_\_\_ Direct Push \_\_\_\_\_ Other Pressure grout  
pressure grout with cement 25 PSI in 5 minutes - Tremie grout  
DRILLING COMPANY Cascade Drilling L.P.

- E. CATHODIC. Fill hole above anode zone with concrete placed by tremie.

DRILLER'S LICENSE NO. 938110 - C57

- F. WELL DESTRUCTION. See attached.

WELL SPECIFICATIONS:  
Drill Hole Diameter 8 or 10" in. Maximum \_\_\_\_\_  
Casing Diameter 2 or 4" in. Depth 55-87 ft.  
Surface Seal Depth 6 or 8" ft. Number 7

- G. SPECIAL CONDITIONS. Submit to Zone 7 within 60 days after completion of permitted work the well installation report including all soil and water laboratory analysis results.

SOIL BORINGS:  
Number of Borings \_\_\_\_\_ Maximum \_\_\_\_\_  
Hole Diameter \_\_\_\_\_ in. Depth \_\_\_\_\_ ft.

ESTIMATED STARTING DATE 1/2/13  
ESTIMATED COMPLETION DATE 1/31/13

I hereby agree to comply with all requirements of this permit and Alameda County Ordinance No. 73-68.

Approved Wyman Hong Date 12/30/13  
Wyman Hong

APPLICANT'S SIGNATURE Scott Lewis Date 12-6-13

ATTACH SITE PLAN OR SKETCH

December 30, 2013

**Zone 7  
Water Resources Engineering  
Groundwater Protection Ordinance**

Shell Oil Products  
1801 Santa Rita Road  
Pleasanton

Wells 3S/1E-16D25 (MW-1), 3S/1E-16D26 (MW-2), 3S/1E-16D27 (MW-3), 3S/1E-16D28 (MW-4), 3S/1E-16D29 (MW-1A), 3S/1E-16D30 (MW-4A), 3S/1E-16D31 (MW-5) & 3S/1E-16D32 (MW-6)  
Permit 2013159

**Destruction Requirements:**

1. Remove from the well any pump, appurtenances, debris, or other materials.
2. Sound the well as deeply as practicable and record for your report.
3. Fill casing with neat cement or cement grout sealing material to two feet below the finished grade and pressurize to 25 psi and maintain for 5 minutes, forcing the sealing material through the existing perforations and into the surrounding formation.
4. Release the pressure and refill the empty portion of the casing with grouting material allowing it to spill over the top of the casing to form a cap.
5. Cut and remove any casing(s) to two feet below the finished grade or original ground, whichever is the lower elevation (optional).
6. After seal has set, backfill the remaining hole with compacted material.

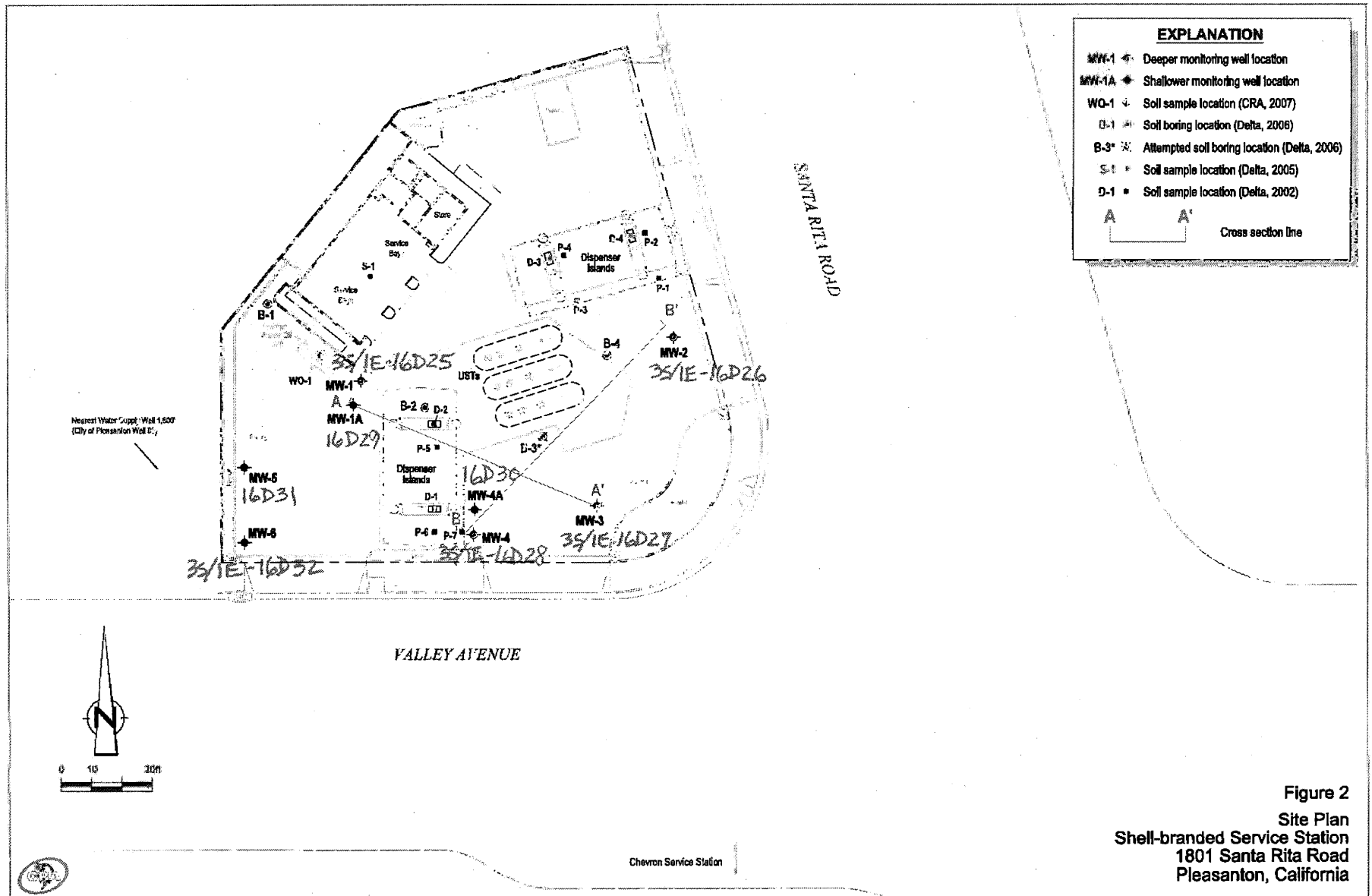

**EXPLANATION**

- MW-1 ◊ Deeper monitoring well location
- MW-1A ◊ Shallower monitoring well location
- WO-1 ↓ Soil sample location (CRA, 2007)
- D-1 ◻ Soil boring location (Delta, 2006)
- B-3\* ✕ Attempted soil boring location (Delta, 2006)
- S-1 ✕ Soil sample location (Delta, 2005)
- D-1 ◻ Soil sample location (Delta, 2002)

A — A' Cross section line

**Figure 2**  
**Site Plan**  
**Shell-branded Service Station**  
**1801 Santa Rita Road**  
**Pleasanton, California**



**NON-HAZARDOUS WASTE MANIFEST**

1. Generator ID Number  
**NOT REQUIRED**

2. Page 1 of  
**1**

3. Emergency Response Phone  
**800-424-8300**

4. Waste Tracking Number  
**0700724**

5. Generator's Name and Mailing Address  
**Shell Oil Products US care of CRA Attn: Derek Eisman  
5520 Corporate Drive, Indianapolis, IN 46278**

Generator's Site Address (if different than mailing address)  
**1801 Santa Rita Road  
Pleasanton, CA**

Generator's Phone:

6. Transporter 1 Company Name  
**American Integrated Services, Inc.**

U.S. EPA ID Number  
**CAR000148338**

7. Transporter 2 Company Name

U.S. EPA ID Number

8. Designated Facility Name and Site Address  
**Kearney Canyon Landfill**

U.S. EPA ID Number  
**Not Required**

**901 Bailey Road  
Pittsburg, CA 94565 925-458-9800**

Facility's Phone:

9. Waste Shipping Name and Description	10. Containers		11. Total Quantity	12. Unit Wt./Vol.
	No.	Type		
1. <b>Non-Hazardous Waste Solid. (Construction Debris)</b>	<b>004</b>	<b>DM</b>	<b>2000</b>	<b>P</b>
2.				
3.				
4.				

13. Special Handling Instructions and Additional Information

**Wear protective equipment while handling. Weights or volumes are approximate.**

**4x55**

**Project #: 74006-2-6**

14. GENERATOR'S/OFFEROR'S CERTIFICATION: I hereby declare that the contents of this consignment are fully and accurately described above by the proper shipping name, and are classified, packaged, marked and labeled/placarded, and are in all respects in proper condition for transport according to applicable international and national governmental regulations.

Generator's/Offereor's Printed/Typed Name  
**K Dupler**

Signature  
*K Dupler*

Month Day Year  
**1 17 14**

15. International Shipments  Import to U.S.  Export from U.S.

Port of entry/exit:

Transporter Signature (for exports only):

Date leaving U.S.:

16. Transporter Acknowledgment of Receipt of Materials

Transporter 1 Printed/Typed Name  
**MARCO MARTINEZ**

Signature  
*Marco Mart*

Month Day Year  
**1 17 14**

Transporter 2 Printed/Typed Name

Signature

Month Day Year

17. Discrepancy

17a. Discrepancy Indication Space  Quantity  Type  Residue  Partial Rejection  Full Rejection

Manifest Reference Number:

17b. Alternate Facility (or Generator)

U.S. EPA ID Number

Facility's Phone:

17c. Signature of Alternate Facility (or Generator)

Month Day Year

18. Designated Facility Owner or Operator: Certification of receipt of materials covered by the manifest except as noted in Item 17a

Printed/Typed Name

Signature

Month Day Year

GENERATOR  
TRANSPORTER  
DESIGNATED FACILITY