

**RECEIVED**

*By dehloptoxic at 8:29 am, Sep 15, 2006*



**Shell Oil Products US**

September 15, 2006

Re: **Third Quarter 2006 Groundwater Monitoring Report**  
**Shell-branded Service Station**  
**1801 Santa Rita Road**  
**Pleasanton, California**

Dear Mr. Jerry Wickham:

I declare, under penalty of perjury, that the information and/or recommendations contained in the attached document or report is true and correct to the best of my knowledge.

Sincerely,  
Shell Oil Products US

A handwritten signature in black ink, appearing to read "Denis L. Brown".

Denis L. Brown  
Project Manager



Solving environment-related business problems worldwide

www.deltaenv.com

175 Bernal Road • Suite 200  
San Jose, California 95119 USA

800.477.7411  
Fax 408.225.8506

September 15, 2006  
DELTA Project SJ18-01S-1  
SAP: 135783

Mr. Jerry Wickham  
Alameda County Health Care Services Agency  
1131 Harbor Bay Parkway, Suite 250  
Alameda, California 94502-6577

**Re: THIRD QUARTER 2006 GROUNDWATER MONITORING REPORT**  
**Shell-Branded Service Station**  
**1801 Santa Rita Road**  
**Pleasanton, California**

Dear Mr. Wickham:

On behalf of Shell Oil Products (Shell), Delta Environmental Consultants, Inc. (Delta), has prepared this *Third Quarter 2006 Groundwater Monitoring Report* for the above referenced site.

This quarterly report represents Delta's professional opinions based upon the currently available information and is arrived at in accordance with currently acceptable professional standards. This report is based upon a specific scope of work requested by the client. The Contract between Delta and its client outlines the scope of work, and only those tasks specifically authorized by that contract or outlined in this report were performed. This report is intended only for the use of Delta's Client and anyone else specifically listed on this report. Delta will not and cannot be liable for unauthorized reliance by any other third party. Other than as contained in this paragraph, Delta makes no express or implied warranty as to the contents of this report.

If you have any questions regarding this site, please contact Ms. Debbie Arnold (Delta) at (408) 826-1873 or Mr. Denis Brown (Shell) at (707) 865-0251.

Sincerely,  
Delta Environmental Consultants, Inc.

Heather Buckingham  
Senior Staff Geologist

Debbie Arnold, PG 7745  
Project Manager

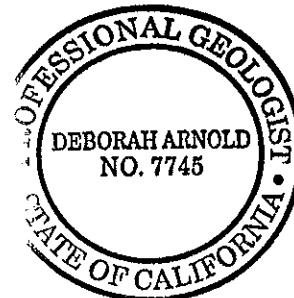

Attachment: Third Quarter 2006 Groundwater Monitoring Report

cc: Denis Brown, Shell Oil Products US, Carson

A member of:



**SHELL QUARTERLY STATUS REPORT**

Station Address:	1801 Santa Rita Road, Pleasanton, CA
DELTA Project No.:	SJ18-01S-1
SHELL Project Manager / Phone No.:	Denis Brown / (707) 865-0251
DELTA Site Manager / Phone No.:	Debbie Arnold / (408) 826-1873
Primary Agency / Regulatory ID No.:	Alameda County Environmental Health / Mr. Jerry Wickham, P.G., CHG
Other Agencies to Receive Copies:	None

**WORK PERFORMED THIS QUARTER (THIRD - 2006):**

- Quarterly groundwater monitoring and sampling. Submitted quarterly report.

**WORK PROPOSED FOR NEXT QUARTER (FOURTH - 2006):**

- Quarterly groundwater monitoring and sampling. Submit quarterly report.

Current Phase of Project:	Groundwater monitoring.
Frequency of Sampling:	Quarterly – Wells MW-1, MW-1A, MW-4, MW-4A, and MW-5 Annual – Wells MW-2 and MW-3
Frequency of Monitoring:	Quarterly – Wells MW-1, MW-1A, MW-4, MW-4A, and MW-5 Annual – Wells MW-2 and MW-3
Is Separate Phase Hydrocarbon Present On-site (Well #'s):	<input type="checkbox"/> Yes <input checked="" type="checkbox"/> No
Cumulative SPH Recovered to Date:	NA
SPH Recovered This Quarter :	None
Sensitive Receptor(s) and Respective Direction(s):	City of Pleasanton Well 06 located approximately 1,531 feet southeast of the site is the nearest municipal water supply well identified by Delta.
Current Remediation Techniques:	None
Permits for Discharge:	None
Approximate Depth to Groundwater:	44 feet below top of well casing (stable since 1Q06). Groundwater has risen a total of approximately 40 feet since 2002.
Groundwater Gradient:	Variable. Groundwater flow direction typically ranges from west to southwest at a gradient of less than 0.01 feet/feet (essential flat).
Current Agency Correspondence:	ACEH letter dated June 23, 2006 approving a decrease in sampling frequency for Wells MW-2 and MW-3 from quarterly to annual.
Summary of Activity:	TPH-G continues to increase in Well MW-4A from 15,000 ug/l last quarter to 25,900 ug/l. TBA was detected in Well MW-4A for the first time at a concentration of 32.2 ug/l. Total Oil and Grease (initial testing) was not detected in Well MW-1A during this event.
Recommendations:	Shell proposes to evaluate further site assessment activities to define the source of impacts observed in Well MW-4A. A work plan will be submitted to the ACEH during fourth quarter 2006.

---

Debbie Arnold  
Site Manager (DELTA)

**ATTACHED:**

- Figure 1 – Site Location Map
- Figure 2 – Groundwater Elevation Contour Map, July 12, 2006
- Figure 3 – TPH-G, Benzene, and MTBE in Groundwater Concentration Map, July 12, 2006
- Attachment A – Groundwater Monitoring and Sampling Report, August 2, 2006

## FIGURES

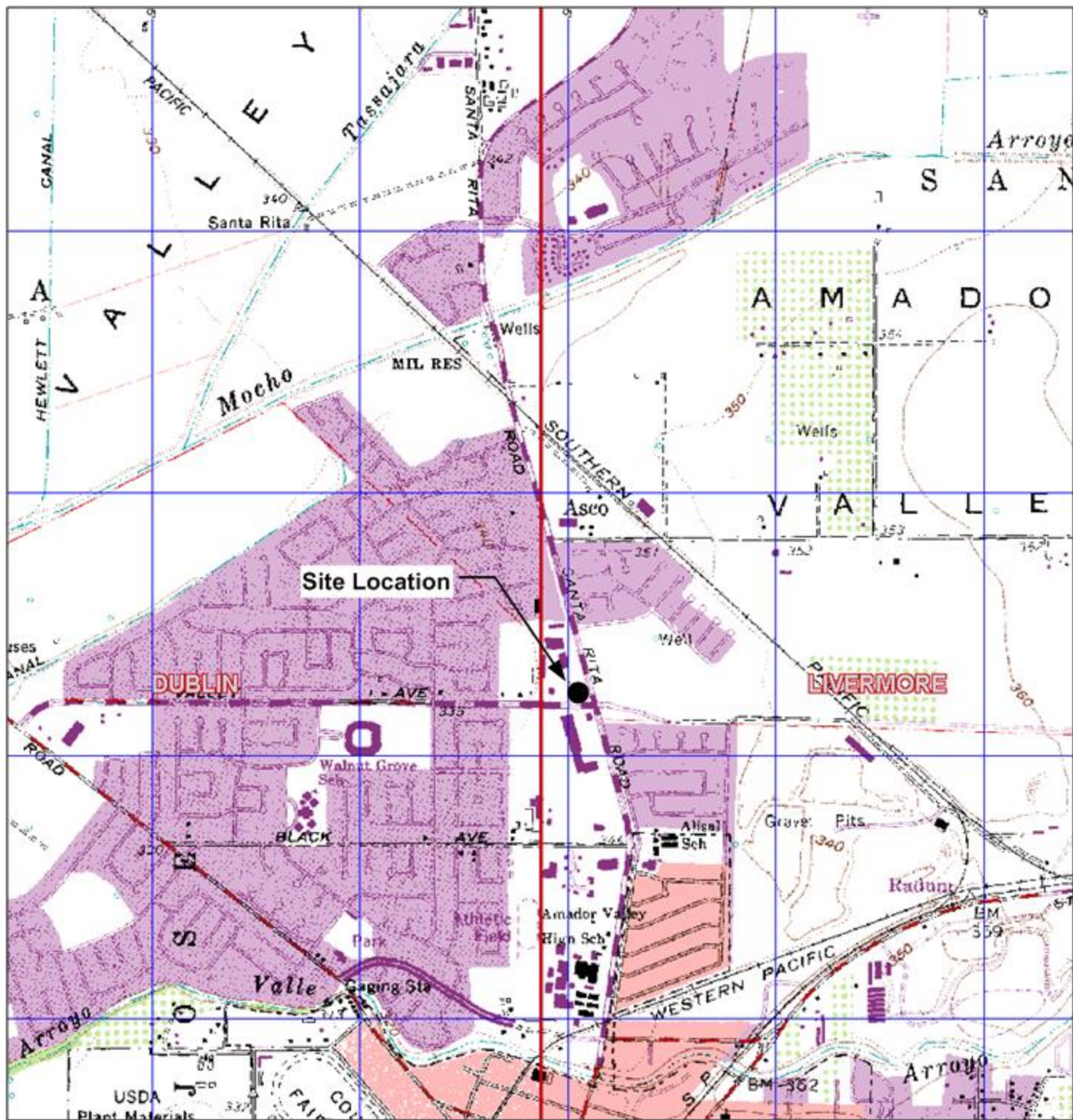

**GENERAL NOTES:**

Base Map from: DeLorme Yarmouth, ME 04096  
 Source Data: USGS



QUADRANGLE LOCATION



Scale, Feet

**FIGURE 1**  
**SITE LOCATION MAP**

**SHELL-BRANDED SERVICE STATION**  
 1801 Santa Rita Road  
 Pleasanton, California

PROJECT NO. SJ18-01S-G.2004	DRAWN BY VF 10/23/03
FILE NO. SJ18-01S-G.2004	PREPARED BY VF
REVISION NO.	REVIEWED BY



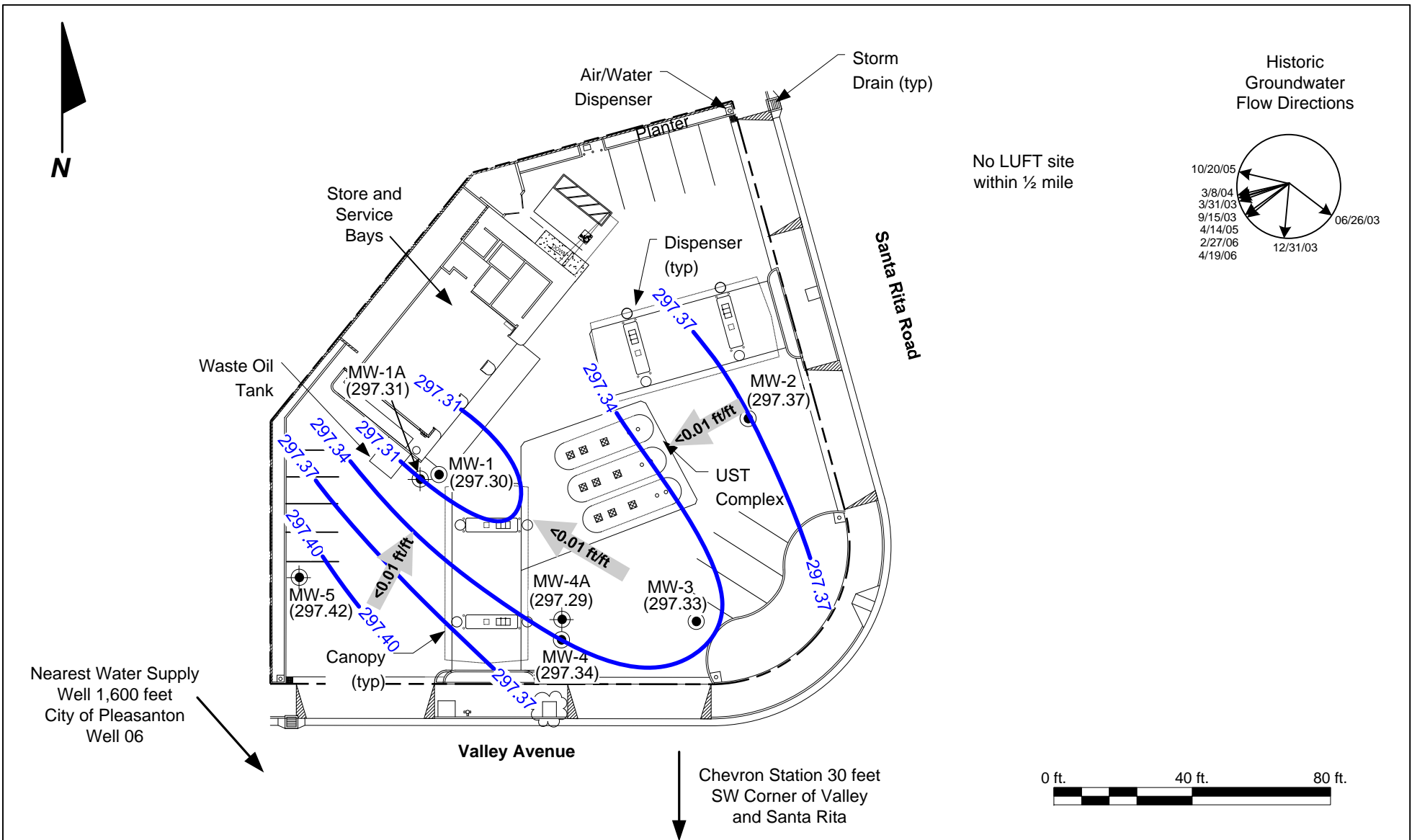

**LEGEND**

- MW-1 ● **GROUNDWATER MONITORING WELL (OCTOBER 2002), MONITORS GROUNDWATER IN THE 80-95 FOOT INTERVAL**
- MW-1A ⊕ **GROUNDWATER MONITORING WELL (FEBRUARY 2006), MONITORS GROUNDWATER IN THE 45-55 FOOT INTERVAL**
- (298.95) **GROUNDWATER ELEVATION (FEET-MSL), 07/12/06**
- 299.00 **GROUNDWATER ELEVATION CONTOUR**
- ← <math><0.01\text{ ft/ft}</math> **APPROXIMATE GROUNDWATER FLOW DIRECTION AND GRADIENT**

**FIGURE 2**  
**GROUNDWATER ELEVATION CONTOUR MAP,**  
**JULY 12, 2006**  
**SHELL-BRANDED SERVICE STATION**  
**1801 Santa Rita Road**  
**Pleasanton, California**

PROJECT NO. SJ18-01S-G.2006	DRAWN BY BH 08/25/06
FILE NO. SJ18-01S-G.2006	PREPARED BY HB
REVISION NO. 2	REVIEWED BY



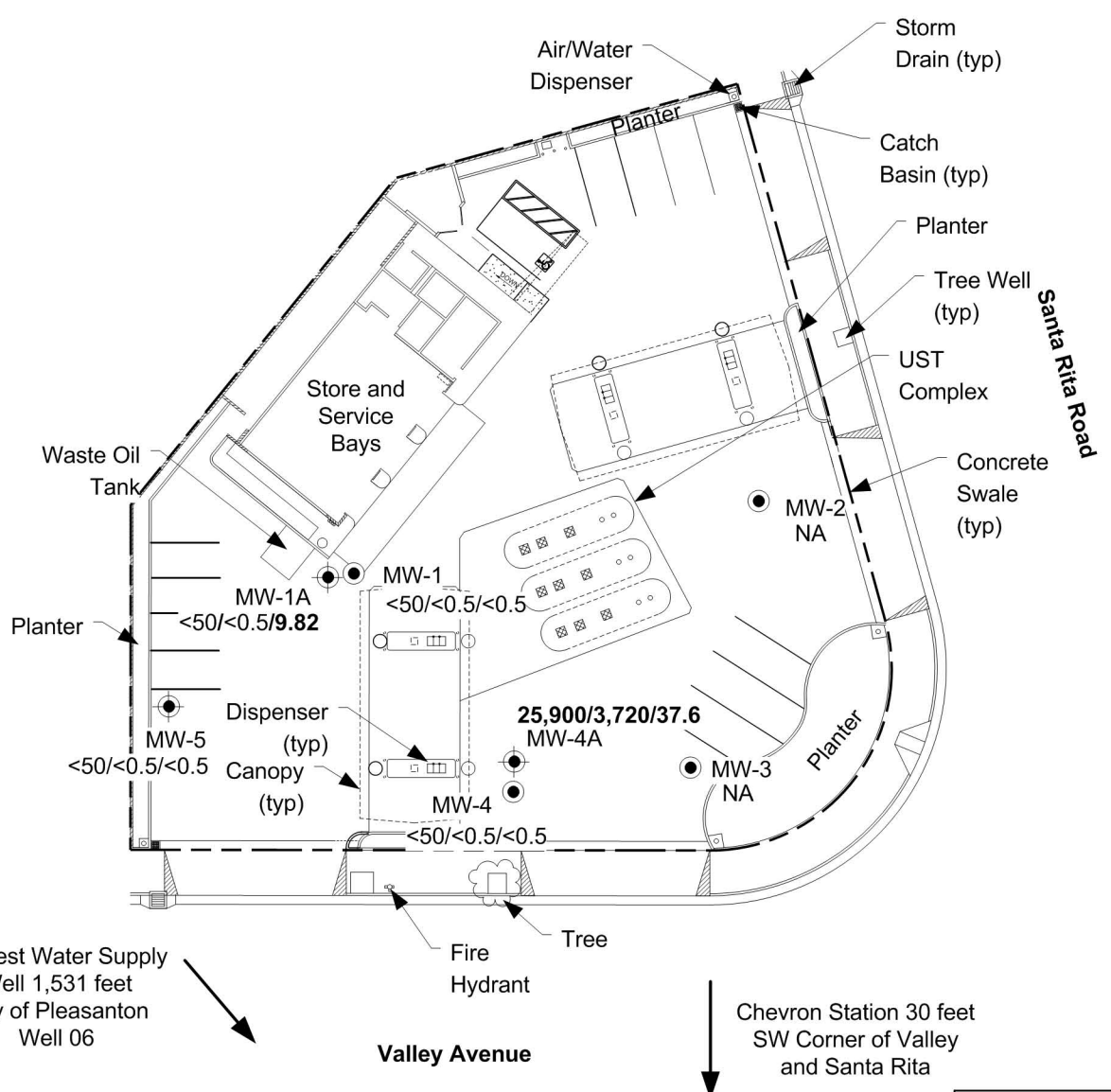

No LUFT sites within 1/2 mile

**LEGEND**

- MW-1 ● **GROUNDWATER MONITORING WELL (OCTOBER 2002), MONITORS GROUNDWATER IN THE 80-95 FOOT INTERVAL**
- MW-1A ⊕ **GROUNDWATER MONITORING WELL (FEBRUARY 2006), MONITORS GROUNDWATER IN THE 45-55 FOOT INTERVAL**
- <50/<0.5/<0.5 **TPH-G/BENZENE/MTBE CONCENTRATIONS (UG/L), 07/12/06**
- NA **NOT ANALYZED (SAMPLED ANNUALLY DURING THE SECOND QUARTER)**

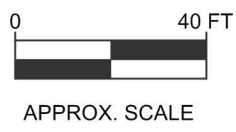

**FIGURE 3**  
 TPH-G, BENZENE, AND MTBE CONCENTRATIONS MAP,  
 JULY 12, 2006

**SHELL-BRANDED SERVICE STATION**  
 1801 Santa Rita Road  
 Pleasanton, California

PROJECT NO. SJ18-01S-G.2006	DRAWN BY BH 08/25/06
FILE NO. SJ18-01S-G.2006	PREPARED BY HB
REVISION NO. 2	REVIEWED BY





**ATTACHMENT A**

**GROUNDWATER MONITORING AND SAMPLING REPORT, AUGUST 2, 2006**

---

**BLAINE**  
TECH SERVICES INC.

---

GROUNDWATER SAMPLING SPECIALISTS  
SINCE 1985

August 2, 2006

Denis Brown  
Shell Oil Products US  
20945 S. Wilmington Avenue  
Carson, CA 90810

Third Quarter 2006 Groundwater Monitoring at  
Shell-branded Service Station  
1801 Santa Rita Road  
Pleasanton, CA

Monitoring performed on July 12, 2006

---

Groundwater Monitoring Report **060712-DW-2**

This report covers the routine monitoring of groundwater wells at this Shell-branded facility. In accordance with standard procedures that conform to Regional Water Quality Control Board requirements, routine field data collection includes depth to water, total well depth, thickness of any separate immiscible layer, water column volume, calculated purge volume (if applicable), elapsed evacuation time (if applicable), total volume of water removed (if applicable), and standard water parameter instrument readings. Sample material is collected, contained, stored, and transported to the laboratory in conformance with EPA standards. Purgewater (if applicable) is, likewise, collected and transported to the Martinez Refining Company.

Basic field information is presented alongside analytical values excerpted from the laboratory report in the cumulative table of **WELL CONCENTRATIONS**. The full analytical report for the most recent samples and the field data sheets are attached to this report.

At a minimum, Blaine Tech Services, Inc. field personnel are certified on completion of a forty-hour Hazardous Materials and Emergency Response training course per 29 CFR 1910.120. Field personnel are also enrolled in annual eight-hour refresher courses.

Blaine Tech Services, Inc. conducts sampling and documentation assignments of this type as an independent third party. Our activities at this site consisted of objective data and sample collection only. No interpretation of analytical results, defining of hydrological conditions or formulation of recommendations was performed.

Please call if you have any questions.

Yours truly,

Mike Ninokata  
Project Coordinator

MN/ks

attachments: Cumulative Table of WELL CONCENTRATIONS  
Certified Analytical Report  
Field Data Sheets

cc: Debbie Arnold  
Delta Environmental  
175 Bernal Road, Suite 200  
San Jose, CA 95119

**WELL CONCENTRATIONS**  
**Shell-branded Service Station**  
**1801 Santa Rita Road**  
**Pleasanton, CA**

Well ID	Date	TPPH (ug/L)	TEPH (ug/L)	B (ug/L)	T (ug/L)	E (ug/L)	X (ug/L)	MTBE 8260 (ug/L)	DIPE (ug/L)	ETBE (ug/L)	TAME (ug/L)	TBA (ug/L)	TOC (MSL)	Depth to Water (ft.)	GW Elevation (MSL)
---------	------	----------------	----------------	-------------	-------------	-------------	-------------	------------------------	----------------	----------------	----------------	---------------	--------------	----------------------------	--------------------------

MW-1	12/12/2002	NA	NA	NA	NA	NA	NA	NA	NA	NA	NA	NA	NA	85.83	NA
MW-1	12/20/2002	<50	<50	<0.50	<0.50	<0.50	0.71	<0.50	<2.0	<2.0	<2.0	<50	NA	85.60	NA
MW-1	03/31/2003	<50	75	<0.50	<0.50	<0.50	<1.0	<5.0	NA	NA	NA	NA	342.10	77.36	264.74
MW-1	06/26/2003	<50	<50	<0.50	<0.50	<0.50	<1.0	<0.50	<2.0	<2.0	<2.0	<5.0	342.10	72.48	269.62
MW-1	09/15/2003	<50	<50	<0.50	<0.50	<0.50	<1.0	<0.50	<2.0	<2.0	<2.0	<5.0	342.10	79.03	263.07
MW-1	12/31/2003	<50	<50	<0.50	0.99	<0.50	<1.0	<0.50	<2.0	<2.0	<2.0	<5.0	342.10	70.57	271.53
MW-1	03/08/2004	<50	<50	<0.50	<0.50	<0.50	<1.0	<0.50	<2.0	<2.0	<2.0	<5.0	342.10	65.95	276.15
MW-1	06/16/2004	<50	<50	<0.50	<0.50	<0.50	<1.0	<0.50	<2.0	<2.0	<2.0	<5.0	342.10	66.50	275.60
MW-1	04/14/2005	<50	<50	<0.50	<0.50	<0.50	<1.0	<0.50	<2.0	<2.0	<2.0	<5.0	342.10	55.97	286.13
MW-1	10/20/2005	<50	330 b/190 b	0.86	<0.50	<0.50	1.2	0.87	<2.0	<2.0	<2.0	<5.0	342.10	56.51	285.59
MW-1	02/27/2006	NA	NA	NA	NA	NA	NA	NA	NA	NA	NA	NA	342.10	45.93	296.17
MW-1	04/19/2006	<50.0	<47.2 c	<0.500	<0.500	<0.500	<0.500	<0.500	<0.500	<0.500	<0.500	<10.0	342.10	43.15	298.95
<b>MW-1</b>	<b>07/12/2006</b>	<b>&lt;50.0</b>	<b>53.1 c</b>	<b>&lt;0.500</b>	<b>&lt;0.500</b>	<b>&lt;0.500</b>	<b>&lt;1.5</b>	<b>&lt;0.500</b>	<b>&lt;0.500</b>	<b>&lt;0.500</b>	<b>&lt;0.500</b>	<b>&lt;10.0</b>	<b>342.10</b>	<b>44.80</b>	<b>297.30</b>

MW-1A	02/23/2006	NA	NA	NA	NA	NA	NA	NA	NA	NA	NA	NA	341.72	46.95	294.77
MW-1A	02/27/2006	<50.0	55.9 c	4.04	<0.500	<0.500	2.02	3.32	<0.500	<0.500	<0.500	12.5	341.72	45.56	296.16
MW-1A	04/19/2006	<50.0	119 c	1.05	0.990	<0.500	<0.500	1.41	<0.500	<0.500	<0.500	<10.0	341.72	42.78	298.94
<b>MW-1A</b>	<b>07/12/2006</b>	<b>&lt;50.0</b>	<b>79.6 c</b>	<b>&lt;0.500</b>	<b>&lt;0.500</b>	<b>&lt;0.500</b>	<b>&lt;1.5</b>	<b>9.82</b>	<b>&lt;0.500</b>	<b>&lt;0.500</b>	<b>&lt;0.500</b>	<b>19.1</b>	<b>341.72</b>	<b>44.41</b>	<b>297.31</b>

MW-2	12/12/2002	NA	NA	NA	NA	NA	NA	NA	NA	NA	NA	NA	NA	85.15	NA
MW-2	12/20/2002	<50	<50	<0.50	<0.50	<0.50	<0.50	<0.50	<2.0	<2.0	<2.0	<50	NA	85.00	NA
MW-2	03/31/2003	<50	63	<0.50	0.71	<0.50	<1.0	<5.0	NA	NA	NA	NA	341.57	76.63	264.94
MW-2	06/26/2003	<50	<50	<0.50	<0.50	<0.50	<1.0	<0.50	<2.0	<2.0	<2.0	<5.0	341.57	71.94	269.63
MW-2	09/15/2003	<50	<50	<0.50	<0.50	<0.50	<1.0	<0.50	<2.0	<2.0	<2.0	<5.0	341.57	78.41	263.16
MW-2	12/31/2003	<50	120 a	<0.50	1.3	<0.50	<1.0	<0.50	<2.0	<2.0	<2.0	<5.0	341.57	69.96	271.61
MW-2	03/08/2004	<50	110 a	<0.50	<0.50	<0.50	<1.0	<0.50	<2.0	<2.0	<2.0	<5.0	341.57	65.34	276.23

**WELL CONCENTRATIONS**  
**Shell-branded Service Station**  
**1801 Santa Rita Road**  
**Pleasanton, CA**

Well ID	Date	TPPH (ug/L)	TEPH (ug/L)	B (ug/L)	T (ug/L)	E (ug/L)	X (ug/L)	MTBE 8260 (ug/L)	DIPE (ug/L)	ETBE (ug/L)	TAME (ug/L)	TBA (ug/L)	TOC (MSL)	Depth to Water (ft.)	GW Elevation (MSL)
---------	------	----------------	----------------	-------------	-------------	-------------	-------------	------------------------	----------------	----------------	----------------	---------------	--------------	----------------------------	--------------------------

MW-2	06/16/2004	<50	90 a	<0.50	<0.50	<0.50	<1.0	<0.50	<2.0	<2.0	<2.0	<5.0	341.57	65.86	275.71
MW-2	04/14/2005	<50	77 a	<0.50	<0.50	<0.50	<1.0	<0.50	<2.0	<2.0	<2.0	<5.0	341.57	55.35	286.22
MW-2	10/20/2005	<50	75 a/<50	<0.50	<0.50	<0.50	<1.0	0.54	<2.0	<2.0	<2.0	<5.0	341.57	55.89	285.68
MW-2	02/27/2006	NA	NA	NA	NA	NA	NA	NA	NA	NA	NA	NA	341.57	45.30	296.27
MW-2	04/19/2006	<50.0	80.1 c	<0.500	<0.500	<0.500	<0.500	0.630	<0.500	<0.500	<0.500	<10.0	341.57	42.56	299.01
<b>MW-2</b>	<b>07/12/2006</b>	<b>NA</b>	<b>NA</b>	<b>NA</b>	<b>NA</b>	<b>NA</b>	<b>NA</b>	<b>NA</b>	<b>NA</b>	<b>NA</b>	<b>NA</b>	<b>NA</b>	<b>341.57</b>	<b>44.20</b>	<b>297.37</b>

MW-3	12/12/2002	NA	NA	NA	NA	NA	NA	NA	NA	NA	NA	NA	NA	85.49	NA
MW-3	12/20/2002	<50	<50	<0.50	<0.50	<0.50	<0.50	<0.50	<2.0	<2.0	<2.0	<50	NA	85.25	NA
MW-3	03/31/2003	<50	<50	<0.50	<0.50	<0.50	<1.0	<5.0	NA	NA	NA	NA	341.65	76.81	264.84
MW-3	06/26/2003	<50	80 a	<0.50	<0.50	<0.50	<1.0	<0.50	<2.0	<2.0	<2.0	<5.0	341.65	72.05	269.60
MW-3	09/15/2003	<50	<50	<0.50	<0.50	<0.50	<1.0	<0.50	<2.0	<2.0	<2.0	<5.0	341.65	78.52	263.13
MW-3	12/31/2003	<50	<50	<0.50	1.2	<0.50	<1.0	<0.50	<2.0	<2.0	<2.0	<5.0	341.65	70.15	271.50
MW-3	03/08/2004	<50	<50	<0.50	<0.50	<0.50	<1.0	<0.50	<2.0	<2.0	<2.0	<5.0	341.65	65.46	276.19
MW-3	06/16/2004	<50	<50	<0.50	<0.50	<0.50	<1.0	<0.50	<2.0	<2.0	<2.0	<5.0	341.65	65.87	275.78
MW-3	04/14/2005	<50	<50	<0.50	<0.50	<0.50	<1.0	<0.50	<2.0	<2.0	<2.0	<5.0	341.65	55.50	286.15
MW-3	10/20/2005	<50	55 a/<50	<0.50	<0.50	<0.50	<1.0	<0.50	<2.0	<2.0	<2.0	<5.0	341.65	55.97	285.68
MW-3	02/27/2006	NA	NA	NA	NA	NA	NA	NA	NA	NA	NA	NA	341.65	45.45	296.20
MW-3	04/19/2006	<50.0	200 c	<0.500	<0.500	<0.500	<0.500	<0.500	<0.500	<0.500	<0.500	20.2	341.65	42.67	298.98
<b>MW-3</b>	<b>07/12/2006</b>	<b>NA</b>	<b>NA</b>	<b>NA</b>	<b>NA</b>	<b>NA</b>	<b>NA</b>	<b>NA</b>	<b>NA</b>	<b>NA</b>	<b>NA</b>	<b>NA</b>	<b>341.65</b>	<b>44.32</b>	<b>297.33</b>

MW-4	12/12/2002	NA	NA	NA	NA	NA	NA	NA	NA	NA	NA	NA	NA	84.36	NA
MW-4	12/20/2002	<50	69	<0.50	<0.50	<0.50	<0.50	<0.50	<2.0	<2.0	<2.0	<50	NA	84.15	NA
MW-4	03/31/2003	<50	70	<0.50	<0.50	<0.50	<1.0	<0.50	NA	NA	NA	NA	340.68	75.90	264.78
MW-4	06/26/2003	<50	86 a	<0.50	<0.50	<0.50	<1.0	<0.50	<2.0	<2.0	<2.0	<5.0	340.68	71.01	269.67
MW-4	09/15/2003	<50	120 a	1.0	<0.50	<0.50	<1.0	<0.50	<2.0	<2.0	<2.0	<5.0	340.68	77.57	263.11
MW-4	12/31/2003	<50	<50	<0.50	0.64	<0.50	<1.0	<0.50	<2.0	<2.0	<2.0	<5.0	340.68	69.15	271.53

**WELL CONCENTRATIONS**  
**Shell-branded Service Station**  
**1801 Santa Rita Road**  
**Pleasanton, CA**

Well ID	Date	TPPH (ug/L)	TEPH (ug/L)	B (ug/L)	T (ug/L)	E (ug/L)	X (ug/L)	MTBE 8260 (ug/L)	DIPE (ug/L)	ETBE (ug/L)	TAME (ug/L)	TBA (ug/L)	TOC (MSL)	Depth to Water (ft.)	GW Elevation (MSL)
---------	------	----------------	----------------	-------------	-------------	-------------	-------------	------------------------	----------------	----------------	----------------	---------------	--------------	----------------------------	--------------------------

MW-4	03/08/2004	<50	<50	<0.50	<0.50	<0.50	<1.0	<0.50	<2.0	<2.0	<2.0	<5.0	340.68	64.51	276.17
MW-4	06/16/2004	<50	<50	<0.50	<0.50	<0.50	<1.0	<0.50	<2.0	<2.0	<2.0	<5.0	340.68	65.04	275.64
MW-4	04/14/2005	<50	<50	<0.50	<0.50	<0.50	<1.0	<0.50	<2.0	<2.0	<2.0	<5.0	340.68	54.53	286.15
MW-4	10/20/2005	<50	<50	<0.50	<0.50	<0.50	<1.0	<0.50	<2.0	<2.0	<2.0	<5.0	340.68	55.05	285.63
MW-4	02/27/2006	NA	NA	NA	NA	NA	NA	NA	NA	NA	NA	NA	340.68	44.49	296.19
MW-4	04/19/2006	<50.0	265 c	<0.500	<0.500	<0.500	<0.500	<0.500	<0.500	<0.500	<0.500	<10.0	340.68	41.72	298.96
<b>MW-4</b>	<b>07/12/2006</b>	<b>&lt;50.0</b>	<b>652 c</b>	<b>&lt;0.500</b>	<b>&lt;0.500</b>	<b>&lt;0.500</b>	<b>&lt;1.5</b>	<b>&lt;0.500</b>	<b>&lt;0.500</b>	<b>&lt;0.500</b>	<b>&lt;0.500</b>	<b>&lt;10.0</b>	<b>340.68</b>	<b>43.34</b>	<b>297.34</b>

MW-4A	02/23/2006	NA	NA	NA	NA	NA	NA	NA	NA	NA	NA	NA	340.77	46.55	294.22
MW-4A	02/27/2006	3,280	246 c	232	135	27.2	306	10.2	<0.500	<0.500	<0.500	<10.0	340.77	44.61	296.16
MW-4A	04/19/2006	15,000	967 c	2,620	1,280	518	1,460	34.9	<0.500	<0.500	<0.500	<10.0	340.77	41.82	298.95
<b>MW-4A</b>	<b>07/12/2006</b>	<b>25,900</b>	<b>&lt;47.2 c</b>	<b>3,720</b>	<b>749</b>	<b>728</b>	<b>1,770</b>	<b>37.6</b>	<b>&lt;0.500</b>	<b>&lt;0.500</b>	<b>&lt;0.500</b>	<b>32.2</b>	<b>340.77</b>	<b>43.48</b>	<b>297.29</b>

MW-5	02/23/2006	NA	NA	NA	NA	NA	NA	NA	NA	NA	NA	NA	340.86	45.10	295.76
MW-5	02/27/2006	<50.0	<50.0 c	<0.500	<0.500	<0.500	<0.500	<0.500	<0.500	<0.500	<0.500	<10.0	340.86	44.69	296.17
MW-5	04/19/2006	<50.0	<47.2 c	0.810	0.810	<0.500	<0.500	<0.500	<0.500	<0.500	<0.500	<10.0	340.86	41.95	298.91
<b>MW-5</b>	<b>07/12/2006</b>	<b>&lt;50.0</b>	<b>71.6 c</b>	<b>&lt;0.500</b>	<b>&lt;0.500</b>	<b>&lt;0.500</b>	<b>&lt;1.5</b>	<b>&lt;0.500</b>	<b>&lt;0.500</b>	<b>&lt;0.500</b>	<b>&lt;0.500</b>	<b>&lt;10.0</b>	<b>340.86</b>	<b>43.44</b>	<b>297.42</b>

**WELL CONCENTRATIONS**  
**Shell-branded Service Station**  
**1801 Santa Rita Road**  
**Pleasanton, CA**

Well ID	Date	TPPH (ug/L)	TEPH (ug/L)	B (ug/L)	T (ug/L)	E (ug/L)	X (ug/L)	MTBE 8260 (ug/L)	DIPE (ug/L)	ETBE (ug/L)	TAME (ug/L)	TBA (ug/L)	TOC (MSL)	Depth to Water (ft.)	GW Elevation (MSL)
---------	------	----------------	----------------	-------------	-------------	-------------	-------------	------------------------	----------------	----------------	----------------	---------------	--------------	----------------------------	--------------------------

Abbreviations:

TPPH = Total petroleum hydrocarbons as gasoline by EPA Method 8260B.

TEPH = Total petroleum hydrocarbons as diesel by modified EPA Method 8015.

BTEX = Benzene, toluene, ethylbenzene, xylenes by EPA Method 8260B.

MTBE = Methyl tertiary butyl ether

DIPE = Di-isopropyl ether

ETBE = Ethyl tertiary butyl ether

TAME = Tertiary amyl methyl ether

TBA = Tertiary Butanol or Tertiary butyl alcohol

n/n = TEPH/TEPH w/Silica Gel Clean-up

TOC = Top of Casing Elevation

GW = Groundwater

ug/L = Parts per billion

MSL = Mean sea level

ft. = Feet

<n = Below detection limit

NA = Not applicable

Notes:

a = Hydrocarbon does not match pattern of laboratory's standard.

b = The concentration reported reflect(s) individual or discrete unidentified peaks not matching a typical fuel pattern.

c = Diesel with Silica Gel clean-up

Site surveyed January 14, 2003 by Mid Coast Engineers.

1Q06 survey data for wells MW-1A, MW-4A, and MW-5 provided by Delta Environmental.

July 28, 2006

Client: Delta Env. Consultants (San Jose) / SHELL (13653)  
175 Bernal Rd., Suite 200  
San Jose, CA 95119  
Attn: Heather Buckingham

Work Order: NPG1831  
Project Name: 1801 Santa Rita Rd., Pleasanton, CA  
Project Nbr: SAP 135783  
P/O Nbr: 97615964  
Date Received: 07/14/06

SAMPLE IDENTIFICATION	LAB NUMBER	COLLECTION DATE AND TIME
MW-1	NPG1831-01	07/12/06 14:29
MW-1A	NPG1831-02	07/12/06 14:46
MW-4	NPG1831-03	07/12/06 13:41
MW-4A	NPG1831-04	07/12/06 15:08
MW-5	NPG1831-05	07/12/06 13:58

An executed copy of the chain of custody, the project quality control data, and the sample receipt form are also included as an addendum to this report. If you have any questions relating to this analytical report, please contact your Laboratory Project Manager at 1-800-765-0980. Any opinions, if expressed, are outside the scope of the Laboratory's accreditation.

This material is intended only for the use of the individual(s) or entity to whom it is addressed, and may contain information that is privileged and confidential. If you are not the intended recipient, or the employee or agent responsible for delivering this material to the intended recipient, you are hereby notified that any dissemination, distribution, or copying of this material is strictly prohibited. If you have received this material in error, please notify us immediately at 615-726-0177.

California Certification Number: 01168CA

The Chain(s) of Custody, 2 pages, are included and are an integral part of this report.

These results relate only to the items tested. This report shall not be reproduced except in full and with permission of the laboratory.

Report Approved By:

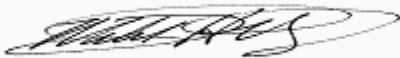

Mark Hollingsworth  
Director of Project Management



Client Delta Env. Consultants (San Jose) / SHELL (13653)  
 175 Bernal Rd., Suite 200  
 San Jose, CA 95119  
 Attn Heather Buckingham

Work Order: NPG1831  
 Project Name: 1801 Santa Rita Rd., Pleasanton, CA  
 Project Number: SAP 135783  
 Received: 07/14/06 08:00

## ANALYTICAL REPORT

Analyte	Result	Flag	Units	MRL	Dilution Factor	Analysis Date/Time	Method	Batch
<b>Sample ID: NPG1831-01 (MW-1 - Water) Sampled: 07/12/06 14:29</b>								
Volatile Organic Compounds by EPA Method 8260B								
Tert-Amyl Methyl Ether	ND		ug/L	0.500	1	07/25/06 19:19	SW846 8260B	6074210
Benzene	ND		ug/L	0.500	1	07/25/06 19:19	SW846 8260B	6074210
Ethyl tert-Butyl Ether	ND		ug/L	0.500	1	07/25/06 19:19	SW846 8260B	6074210
Diisopropyl Ether	ND		ug/L	0.500	1	07/25/06 19:19	SW846 8260B	6074210
Ethylbenzene	ND		ug/L	0.500	1	07/25/06 19:19	SW846 8260B	6074210
Methyl tert-Butyl Ether	ND		ug/L	0.500	1	07/25/06 19:19	SW846 8260B	6074210
Toluene	ND		ug/L	0.500	1	07/25/06 19:19	SW846 8260B	6074210
Tertiary Butyl Alcohol	ND		ug/L	10.0	1	07/25/06 19:19	SW846 8260B	6074210
Xylenes, total	ND		ug/L	1.50	1	07/25/06 19:19	SW846 8260B	6074210
<i>Surr: 1,2-Dichloroethane-d4 (70-130%)</i>	<i>101 %</i>					<i>07/25/06 19:19</i>	<i>SW846 8260B</i>	<i>6074210</i>
<i>Surr: Dibromofluoromethane (79-122%)</i>	<i>110 %</i>					<i>07/25/06 19:19</i>	<i>SW846 8260B</i>	<i>6074210</i>
<i>Surr: Toluene-d8 (78-121%)</i>	<i>85 %</i>					<i>07/25/06 19:19</i>	<i>SW846 8260B</i>	<i>6074210</i>
<i>Surr: 4-Bromofluorobenzene (78-126%)</i>	<i>93 %</i>					<i>07/25/06 19:19</i>	<i>SW846 8260B</i>	<i>6074210</i>
Purgeable Petroleum Hydrocarbons								
Gasoline Range Organics	ND		ug/L	50.0	1	07/25/06 19:19	CA LUFT GC/MS	6074210
<i>Surr: 1,2-Dichloroethane-d4 (0-200%)</i>	<i>101 %</i>					<i>07/25/06 19:19</i>	<i>CA LUFT GC/MS</i>	<i>6074210</i>
<i>Surr: Dibromofluoromethane (0-200%)</i>	<i>110 %</i>					<i>07/25/06 19:19</i>	<i>CA LUFT GC/MS</i>	<i>6074210</i>
<i>Surr: Toluene-d8 (0-200%)</i>	<i>85 %</i>					<i>07/25/06 19:19</i>	<i>CA LUFT GC/MS</i>	<i>6074210</i>
<i>Surr: 4-Bromofluorobenzene (0-200%)</i>	<i>93 %</i>					<i>07/25/06 19:19</i>	<i>CA LUFT GC/MS</i>	<i>6074210</i>
Extractable Petroleum Hydrocarbons with Silica Gel Treatment								
Diesel	<b>53.1</b>		ug/L	47.2	1	07/26/06 03:19	SW846 8015B	6072612
<i>Surr: o-Terphenyl (55-150%)</i>	<i>101 %</i>					<i>07/26/06 03:19</i>	<i>SW846 8015B</i>	<i>6072612</i>
<b>Sample ID: NPG1831-02 (MW-1A - Water) Sampled: 07/12/06 14:46</b>								
General Chemistry Parameters								
Oil & Grease HEM	ND		mg/L	5.21	1	07/19/06 07:36	EPA 1664A	6072741
Volatile Organic Compounds by EPA Method 8260B								
Tert-Amyl Methyl Ether	ND		ug/L	0.500	1	07/25/06 19:44	SW846 8260B	6074210
1,2-Dibromoethane (EDB)	ND		ug/L	0.500	1	07/25/06 19:44	SW846 8260B	6074210
Benzene	ND		ug/L	0.500	1	07/25/06 19:44	SW846 8260B	6074210
1,2-Dichloroethane	ND		ug/L	0.500	1	07/25/06 19:44	SW846 8260B	6074210
Ethylbenzene	ND		ug/L	0.500	1	07/25/06 19:44	SW846 8260B	6074210
Toluene	ND		ug/L	0.500	1	07/25/06 19:44	SW846 8260B	6074210
Ethyl tert-Butyl Ether	ND		ug/L	0.500	1	07/25/06 19:44	SW846 8260B	6074210
Diisopropyl Ether	ND		ug/L	0.500	1	07/25/06 19:44	SW846 8260B	6074210
Methyl tert-Butyl Ether	<b>9.82</b>		ug/L	0.500	1	07/25/06 19:44	SW846 8260B	6074210
Xylenes, total	ND		ug/L	1.50	1	07/25/06 19:44	SW846 8260B	6074210
Tertiary Butyl Alcohol	<b>19.1</b>		ug/L	10.0	1	07/25/06 19:44	SW846 8260B	6074210
<i>Surr: 1,2-Dichloroethane-d4 (70-130%)</i>	<i>99 %</i>					<i>07/25/06 19:44</i>	<i>SW846 8260B</i>	<i>6074210</i>
<i>Surr: Dibromofluoromethane (79-122%)</i>	<i>110 %</i>					<i>07/25/06 19:44</i>	<i>SW846 8260B</i>	<i>6074210</i>
<i>Surr: Toluene-d8 (78-121%)</i>	<i>83 %</i>					<i>07/25/06 19:44</i>	<i>SW846 8260B</i>	<i>6074210</i>
<i>Surr: 4-Bromofluorobenzene (78-126%)</i>	<i>94 %</i>					<i>07/25/06 19:44</i>	<i>SW846 8260B</i>	<i>6074210</i>
Purgeable Petroleum Hydrocarbons								

Client Delta Env. Consultants (San Jose) / SHELL (13653)  
 175 Bernal Rd., Suite 200  
 San Jose, CA 95119  
 Attn Heather Buckingham

Work Order: NPG1831  
 Project Name: 1801 Santa Rita Rd., Pleasanton, CA  
 Project Number: SAP 135783  
 Received: 07/14/06 08:00

## ANALYTICAL REPORT

Analyte	Result	Flag	Units	MRL	Dilution Factor	Analysis Date/Time	Method	Batch
<b>Sample ID: NPG1831-02 (MW-1A - Water) - cont. Sampled: 07/12/06 14:46</b>								
Purgeable Petroleum Hydrocarbons - cont.								
Gasoline Range Organics	ND		ug/L	50.0	1	07/25/06 19:44	CA LUFT GC/MS	6074210
<i>Surr: 1,2-Dichloroethane-d4 (0-200%)</i>	99 %					07/25/06 19:44	CA LUFT GC/MS	6074210
<i>Surr: Dibromofluoromethane (0-200%)</i>	110 %					07/25/06 19:44	CA LUFT GC/MS	6074210
<i>Surr: Toluene-d8 (0-200%)</i>	83 %					07/25/06 19:44	CA LUFT GC/MS	6074210
<i>Surr: 4-Bromofluorobenzene (0-200%)</i>	94 %					07/25/06 19:44	CA LUFT GC/MS	6074210
Extractable Petroleum Hydrocarbons with Silica Gel Treatment								
Diesel	79.6		ug/L	47.2	1	07/26/06 03:36	SW846 8015B	6072612
<i>Surr: o-Terphenyl (55-150%)</i>	96 %					07/26/06 03:36	SW846 8015B	6072612
<b>Sample ID: NPG1831-03 (MW-4 - Water) Sampled: 07/12/06 13:41</b>								
Volatile Organic Compounds by EPA Method 8260B								
Tert-Amyl Methyl Ether	ND		ug/L	0.500	1	07/25/06 20:09	SW846 8260B	6074210
Benzene	ND		ug/L	0.500	1	07/25/06 20:09	SW846 8260B	6074210
Ethyl tert-Butyl Ether	ND		ug/L	0.500	1	07/25/06 20:09	SW846 8260B	6074210
Diisopropyl Ether	ND		ug/L	0.500	1	07/25/06 20:09	SW846 8260B	6074210
Ethylbenzene	ND		ug/L	0.500	1	07/25/06 20:09	SW846 8260B	6074210
Methyl tert-Butyl Ether	ND		ug/L	0.500	1	07/25/06 20:09	SW846 8260B	6074210
Toluene	ND		ug/L	0.500	1	07/25/06 20:09	SW846 8260B	6074210
Tertiary Butyl Alcohol	ND		ug/L	10.0	1	07/25/06 20:09	SW846 8260B	6074210
Xylenes, total	ND		ug/L	1.50	1	07/25/06 20:09	SW846 8260B	6074210
<i>Surr: 1,2-Dichloroethane-d4 (70-130%)</i>	103 %					07/25/06 20:09	SW846 8260B	6074210
<i>Surr: Dibromofluoromethane (79-122%)</i>	117 %					07/25/06 20:09	SW846 8260B	6074210
<i>Surr: Toluene-d8 (78-121%)</i>	84 %					07/25/06 20:09	SW846 8260B	6074210
<i>Surr: 4-Bromofluorobenzene (78-126%)</i>	88 %					07/25/06 20:09	SW846 8260B	6074210
Purgeable Petroleum Hydrocarbons								
Gasoline Range Organics	ND		ug/L	50.0	1	07/25/06 20:09	CA LUFT GC/MS	6074210
<i>Surr: 1,2-Dichloroethane-d4 (0-200%)</i>	103 %					07/25/06 20:09	CA LUFT GC/MS	6074210
<i>Surr: Dibromofluoromethane (0-200%)</i>	117 %					07/25/06 20:09	CA LUFT GC/MS	6074210
<i>Surr: Toluene-d8 (0-200%)</i>	84 %					07/25/06 20:09	CA LUFT GC/MS	6074210
<i>Surr: 4-Bromofluorobenzene (0-200%)</i>	88 %					07/25/06 20:09	CA LUFT GC/MS	6074210
Extractable Petroleum Hydrocarbons with Silica Gel Treatment								
Diesel	652		ug/L	47.2	1	07/24/06 20:27	SW846 8015B	6072612
<i>Surr: o-Terphenyl (55-150%)</i>	31 %	ZX				07/24/06 20:27	SW846 8015B	6072612

Client Delta Env. Consultants (San Jose) / SHELL (13653)  
 175 Bernal Rd., Suite 200  
 San Jose, CA 95119  
 Attn Heather Buckingham

Work Order: NPG1831  
 Project Name: 1801 Santa Rita Rd., Pleasanton, CA  
 Project Number: SAP 135783  
 Received: 07/14/06 08:00

## ANALYTICAL REPORT

Analyte	Result	Flag	Units	MRL	Dilution Factor	Analysis Date/Time	Method	Batch
<b>Sample ID: NPG1831-04 (MW-4A - Water) Sampled: 07/12/06 15:08</b>								
Volatile Organic Compounds by EPA Method 8260B								
Tert-Amyl Methyl Ether	ND		ug/L	0.500	1	07/26/06 00:42	SW846 8260B	6074065
1,2-Dibromoethane (EDB)	ND		ug/L	0.500	1	07/26/06 00:42	SW846 8260B	6074065
Benzene	3720		ug/L	10.0	20	07/26/06 12:01	SW846 8260B	6074720
1,2-Dichloroethane	ND		ug/L	0.500	1	07/26/06 00:42	SW846 8260B	6074065
Ethylbenzene	728		ug/L	10.0	20	07/26/06 12:01	SW846 8260B	6074720
Toluene	749		ug/L	10.0	20	07/26/06 12:01	SW846 8260B	6074720
Ethyl tert-Butyl Ether	ND		ug/L	0.500	1	07/26/06 00:42	SW846 8260B	6074065
Diisopropyl Ether	ND		ug/L	0.500	1	07/26/06 00:42	SW846 8260B	6074065
Methyl tert-Butyl Ether	37.6		ug/L	0.500	1	07/26/06 00:42	SW846 8260B	6074065
Xylenes, total	1770		ug/L	30.0	20	07/26/06 12:01	SW846 8260B	6074720
Tertiary Butyl Alcohol	32.2		ug/L	10.0	1	07/26/06 00:42	SW846 8260B	6074065
<i>Surr: 1,2-Dichloroethane-d4 (70-130%)</i>	97 %					07/26/06 00:42	SW846 8260B	6074065
<i>Surr: 1,2-Dichloroethane-d4 (70-130%)</i>	100 %					07/26/06 12:01	SW846 8260B	6074720
<i>Surr: Dibromofluoromethane (79-122%)</i>	103 %					07/26/06 00:42	SW846 8260B	6074065
<i>Surr: Dibromofluoromethane (79-122%)</i>	102 %					07/26/06 12:01	SW846 8260B	6074720
<i>Surr: Toluene-d8 (78-121%)</i>	84 %					07/26/06 00:42	SW846 8260B	6074065
<i>Surr: Toluene-d8 (78-121%)</i>	92 %					07/26/06 12:01	SW846 8260B	6074720
<i>Surr: 4-Bromofluorobenzene (78-126%)</i>	99 %					07/26/06 00:42	SW846 8260B	6074065
<i>Surr: 4-Bromofluorobenzene (78-126%)</i>	98 %					07/26/06 12:01	SW846 8260B	6074720
Purgeable Petroleum Hydrocarbons								
Gasoline Range Organics	25900		ug/L	1000	20	07/26/06 12:01	CA LUFT GC/MS	6074720
<i>Surr: 1,2-Dichloroethane-d4 (0-200%)</i>	100 %					07/26/06 12:01	CA LUFT GC/MS	6074720
<i>Surr: Dibromofluoromethane (0-200%)</i>	102 %					07/26/06 12:01	CA LUFT GC/MS	6074720
<i>Surr: Toluene-d8 (0-200%)</i>	92 %					07/26/06 12:01	CA LUFT GC/MS	6074720
<i>Surr: 4-Bromofluorobenzene (0-200%)</i>	98 %					07/26/06 12:01	CA LUFT GC/MS	6074720
Extractable Petroleum Hydrocarbons with Silica Gel Treatment								
Diesel	ND		ug/L	47.2	1	07/24/06 20:45	SW846 8015B	6072612
<i>Surr: o-Terphenyl (55-150%)</i>	70 %					07/24/06 20:45	SW846 8015B	6072612
<b>Sample ID: NPG1831-05 (MW-5 - Water) Sampled: 07/12/06 13:58</b>								
Volatile Organic Compounds by EPA Method 8260B								
Tert-Amyl Methyl Ether	ND		ug/L	0.500	1	07/26/06 01:07	SW846 8260B	6074065
1,2-Dibromoethane (EDB)	ND		ug/L	0.500	1	07/26/06 01:07	SW846 8260B	6074065
Benzene	ND		ug/L	0.500	1	07/26/06 11:33	SW846 8260B	6074720
1,2-Dichloroethane	ND		ug/L	0.500	1	07/26/06 01:07	SW846 8260B	6074065
Ethylbenzene	ND		ug/L	0.500	1	07/26/06 11:33	SW846 8260B	6074720
Toluene	ND		ug/L	0.500	1	07/26/06 01:07	SW846 8260B	6074065
Ethyl tert-Butyl Ether	ND		ug/L	0.500	1	07/26/06 01:07	SW846 8260B	6074065
Diisopropyl Ether	ND		ug/L	0.500	1	07/26/06 01:07	SW846 8260B	6074065
Methyl tert-Butyl Ether	ND		ug/L	0.500	1	07/26/06 01:07	SW846 8260B	6074065
Xylenes, total	ND		ug/L	1.50	1	07/26/06 01:07	SW846 8260B	6074065
Tertiary Butyl Alcohol	ND		ug/L	10.0	1	07/26/06 01:07	SW846 8260B	6074065
<i>Surr: 1,2-Dichloroethane-d4 (70-130%)</i>	95 %					07/26/06 01:07	SW846 8260B	6074065
<i>Surr: 1,2-Dichloroethane-d4 (70-130%)</i>	104 %					07/26/06 11:33	SW846 8260B	6074720

Client Delta Env. Consultants (San Jose) / SHELL (13653)  
 175 Bernal Rd., Suite 200  
 San Jose, CA 95119  
 Attn Heather Buckingham

Work Order: NPG1831  
 Project Name: 1801 Santa Rita Rd., Pleasanton, CA  
 Project Number: SAP 135783  
 Received: 07/14/06 08:00

## ANALYTICAL REPORT

Analyte	Result	Flag	Units	MRL	Dilution Factor	Analysis Date/Time	Method	Batch
<b>Sample ID: NPG1831-05 (MW-5 - Water) - cont. Sampled: 07/12/06 13:58</b>								
Volatile Organic Compounds by EPA Method 8260B - cont.								
Surr: Dibromofluoromethane (79-122%)	110 %					07/26/06 01:07	SW846 8260B	6074065
Surr: Dibromofluoromethane (79-122%)	106 %					07/26/06 11:33	SW846 8260B	6074720
Surr: Toluene-d8 (78-121%)	85 %					07/26/06 01:07	SW846 8260B	6074065
Surr: Toluene-d8 (78-121%)	92 %					07/26/06 11:33	SW846 8260B	6074720
Surr: 4-Bromofluorobenzene (78-126%)	92 %					07/26/06 01:07	SW846 8260B	6074065
Surr: 4-Bromofluorobenzene (78-126%)	101 %					07/26/06 11:33	SW846 8260B	6074720
Purgeable Petroleum Hydrocarbons								
Gasoline Range Organics	ND		ug/L	50.0	1	07/26/06 01:07	CA LUFT GC/MS	6074065
Surr: 1,2-Dichloroethane-d4 (0-200%)	95 %					07/26/06 01:07	CA LUFT GC/MS	6074065
Surr: Dibromofluoromethane (0-200%)	110 %					07/26/06 01:07	CA LUFT GC/MS	6074065
Surr: Toluene-d8 (0-200%)	85 %					07/26/06 01:07	CA LUFT GC/MS	6074065
Surr: 4-Bromofluorobenzene (0-200%)	92 %					07/26/06 01:07	CA LUFT GC/MS	6074065
Extractable Petroleum Hydrocarbons with Silica Gel Treatment								
Diesel	71.6		ug/L	47.2	1	07/26/06 03:54	SW846 8015B	6072612
Surr: o-Terphenyl (55-150%)	88 %					07/26/06 03:54	SW846 8015B	6072612

Client Delta Env. Consultants (San Jose) / SHELL (13653)  
 175 Bernal Rd., Suite 200  
 San Jose, CA 95119  
 Attn Heather Buckingham

Work Order: NPG1831  
 Project Name: 1801 Santa Rita Rd., Pleasanton, CA  
 Project Number: SAP 135783  
 Received: 07/14/06 08:00

### SAMPLE EXTRACTION DATA

Parameter	Batch	Lab Number	Wt/Vol Extracted	Extracted Vol	Date	Analyst	Extraction Method
Extractable Petroleum Hydrocarbons with Silica Gel Treatment							
SW846 8015B	6072612	NPG1831-01	1060.00	1.00	07/17/06 10:15	KWL	EPA 3510C
SW846 8015B	6072612	NPG1831-02	1060.00	1.00	07/17/06 10:15	KWL	EPA 3510C
SW846 8015B	6072612	NPG1831-03	1060.00	1.00	07/17/06 10:15	KWL	EPA 3510C
SW846 8015B	6072612	NPG1831-03RE1	1060.00	1.00	07/17/06 10:15	KWL	EPA 3510C
SW846 8015B	6074583	NPG1831-03RE2	1060.00	1.00	07/26/06 06:33	CEC	EPA 3510C
SW846 8015B	6072612	NPG1831-04	1060.00	1.00	07/17/06 10:15	KWL	EPA 3510C
SW846 8015B	6072612	NPG1831-05	1060.00	1.00	07/17/06 10:15	KWL	EPA 3510C

Client Delta Env. Consultants (San Jose) / SHELL (13653)  
 175 Bernal Rd., Suite 200  
 San Jose, CA 95119  
 Attn Heather Buckingham

Work Order: NPG1831  
 Project Name: 1801 Santa Rita Rd., Pleasanton, CA  
 Project Number: SAP 135783  
 Received: 07/14/06 08:00

**PROJECT QUALITY CONTROL DATA**  
**Blank**

Analyte	Blank Value	Q	Units	Q.C. Batch	Lab Number	Analyzed Date/Time
---------	-------------	---	-------	------------	------------	--------------------

**General Chemistry Parameters**

**6072741-BLK1**

Oil & Grease HEM	<0.833		mg/L	6072741	6072741-BLK1	07/19/06 07:36
------------------	--------	--	------	---------	--------------	----------------

**Volatile Organic Compounds by EPA Method 8260B**

**6074065-BLK1**

Tert-Amyl Methyl Ether	<0.200		ug/L	6074065	6074065-BLK1	07/25/06 23:28
1,2-Dibromoethane (EDB)	<0.250		ug/L	6074065	6074065-BLK1	07/25/06 23:28
Benzene	<0.200		ug/L	6074065	6074065-BLK1	07/25/06 23:28
1,2-Dichloroethane	<0.390		ug/L	6074065	6074065-BLK1	07/25/06 23:28
Ethylbenzene	<0.200		ug/L	6074065	6074065-BLK1	07/25/06 23:28
Toluene	<0.200		ug/L	6074065	6074065-BLK1	07/25/06 23:28
Ethyl tert-Butyl Ether	<0.200		ug/L	6074065	6074065-BLK1	07/25/06 23:28
Diisopropyl Ether	<0.200		ug/L	6074065	6074065-BLK1	07/25/06 23:28
Methyl tert-Butyl Ether	<0.200		ug/L	6074065	6074065-BLK1	07/25/06 23:28
Xylenes, total	<0.350		ug/L	6074065	6074065-BLK1	07/25/06 23:28
Tertiary Butyl Alcohol	<5.06		ug/L	6074065	6074065-BLK1	07/25/06 23:28
Surrogate: 1,2-Dichloroethane-d4	101%			6074065	6074065-BLK1	07/25/06 23:28
Surrogate: 1,2-Dichloroethane-d4	101%			6074065	6074065-BLK1	07/25/06 23:28
Surrogate: Dibromofluoromethane	117%			6074065	6074065-BLK1	07/25/06 23:28
Surrogate: Dibromofluoromethane	117%			6074065	6074065-BLK1	07/25/06 23:28
Surrogate: Toluene-d8	85%			6074065	6074065-BLK1	07/25/06 23:28
Surrogate: Toluene-d8	85%			6074065	6074065-BLK1	07/25/06 23:28
Surrogate: 4-Bromofluorobenzene	94%			6074065	6074065-BLK1	07/25/06 23:28
Surrogate: 4-Bromofluorobenzene	94%			6074065	6074065-BLK1	07/25/06 23:28

**6074210-BLK1**

Tert-Amyl Methyl Ether	<0.200		ug/L	6074210	6074210-BLK1	07/25/06 11:51
1,2-Dibromoethane (EDB)	<0.250		ug/L	6074210	6074210-BLK1	07/25/06 11:51
Benzene	<0.200		ug/L	6074210	6074210-BLK1	07/25/06 11:51
1,2-Dichloroethane	<0.390		ug/L	6074210	6074210-BLK1	07/25/06 11:51
Ethylbenzene	<0.200		ug/L	6074210	6074210-BLK1	07/25/06 11:51
Toluene	<0.200		ug/L	6074210	6074210-BLK1	07/25/06 11:51
Ethyl tert-Butyl Ether	<0.200		ug/L	6074210	6074210-BLK1	07/25/06 11:51
Diisopropyl Ether	<0.200		ug/L	6074210	6074210-BLK1	07/25/06 11:51
Methyl tert-Butyl Ether	<0.200		ug/L	6074210	6074210-BLK1	07/25/06 11:51
Xylenes, total	<0.350		ug/L	6074210	6074210-BLK1	07/25/06 11:51
Tertiary Butyl Alcohol	<5.06		ug/L	6074210	6074210-BLK1	07/25/06 11:51
Surrogate: 1,2-Dichloroethane-d4	95%			6074210	6074210-BLK1	07/25/06 11:51
Surrogate: 1,2-Dichloroethane-d4	95%			6074210	6074210-BLK1	07/25/06 11:51
Surrogate: Dibromofluoromethane	108%			6074210	6074210-BLK1	07/25/06 11:51
Surrogate: Dibromofluoromethane	108%			6074210	6074210-BLK1	07/25/06 11:51
Surrogate: Toluene-d8	85%			6074210	6074210-BLK1	07/25/06 11:51
Surrogate: Toluene-d8	85%			6074210	6074210-BLK1	07/25/06 11:51

Client Delta Env. Consultants (San Jose) / SHELL (13653)  
 175 Bernal Rd., Suite 200  
 San Jose, CA 95119  
 Attn Heather Buckingham

Work Order: NPG1831  
 Project Name: 1801 Santa Rita Rd., Pleasanton, CA  
 Project Number: SAP 135783  
 Received: 07/14/06 08:00

**PROJECT QUALITY CONTROL DATA**  
**Blank - Cont.**

Analyte	Blank Value	Q	Units	Q.C. Batch	Lab Number	Analyzed Date/Time
---------	-------------	---	-------	------------	------------	--------------------

**Volatile Organic Compounds by EPA Method 8260B**

**6074210-BLK1**

Surrogate: 4-Bromofluorobenzene	93%			6074210	6074210-BLK1	07/25/06 11:51
Surrogate: 4-Bromofluorobenzene	93%			6074210	6074210-BLK1	07/25/06 11:51

**6074720-BLK1**

Benzene	<0.200		ug/L	6074720	6074720-BLK1	07/26/06 10:38
Ethylbenzene	<0.200		ug/L	6074720	6074720-BLK1	07/26/06 10:38
Toluene	<0.200		ug/L	6074720	6074720-BLK1	07/26/06 10:38
Xylenes, total	<0.350		ug/L	6074720	6074720-BLK1	07/26/06 10:38
Surrogate: 1,2-Dichloroethane-d4	95%			6074720	6074720-BLK1	07/26/06 10:38
Surrogate: Dibromofluoromethane	97%			6074720	6074720-BLK1	07/26/06 10:38
Surrogate: Toluene-d8	92%			6074720	6074720-BLK1	07/26/06 10:38
Surrogate: 4-Bromofluorobenzene	101%			6074720	6074720-BLK1	07/26/06 10:38

**Purgeable Petroleum Hydrocarbons**

**6074065-BLK1**

Gasoline Range Organics	<50.0		ug/L	6074065	6074065-BLK1	07/25/06 23:28
Surrogate: 1,2-Dichloroethane-d4	101%			6074065	6074065-BLK1	07/25/06 23:28
Surrogate: Dibromofluoromethane	117%			6074065	6074065-BLK1	07/25/06 23:28
Surrogate: Toluene-d8	85%			6074065	6074065-BLK1	07/25/06 23:28
Surrogate: 4-Bromofluorobenzene	94%			6074065	6074065-BLK1	07/25/06 23:28

**6074210-BLK1**

Gasoline Range Organics	<50.0		ug/L	6074210	6074210-BLK1	07/25/06 11:51
Surrogate: 1,2-Dichloroethane-d4	95%			6074210	6074210-BLK1	07/25/06 11:51
Surrogate: Dibromofluoromethane	108%			6074210	6074210-BLK1	07/25/06 11:51
Surrogate: Toluene-d8	85%			6074210	6074210-BLK1	07/25/06 11:51
Surrogate: 4-Bromofluorobenzene	93%			6074210	6074210-BLK1	07/25/06 11:51

**6074720-BLK1**

Gasoline Range Organics	<50.0		ug/L	6074720	6074720-BLK1	07/26/06 10:38
Surrogate: 1,2-Dichloroethane-d4	95%			6074720	6074720-BLK1	07/26/06 10:38
Surrogate: Dibromofluoromethane	97%			6074720	6074720-BLK1	07/26/06 10:38
Surrogate: Toluene-d8	92%			6074720	6074720-BLK1	07/26/06 10:38
Surrogate: 4-Bromofluorobenzene	101%			6074720	6074720-BLK1	07/26/06 10:38

**Extractable Petroleum Hydrocarbons with Silica Gel Treatment**

**6072612-BLK1**

Diesel	<33.0		ug/L	6072612	6072612-BLK1	07/24/06 18:04
Surrogate: o-Terphenyl	90%			6072612	6072612-BLK1	07/24/06 18:04

Client Delta Env. Consultants (San Jose) / SHELL (13653)  
 175 Bernal Rd., Suite 200  
 San Jose, CA 95119  
 Attn Heather Buckingham

Work Order: NPG1831  
 Project Name: 1801 Santa Rita Rd., Pleasanton, CA  
 Project Number: SAP 135783  
 Received: 07/14/06 08:00

**PROJECT QUALITY CONTROL DATA**  
**LCS**

Analyte	Known Val.	Analyzed Val	Q	Units	% Rec.	Target Range	Batch	Analyzed Date/Time
<b>General Chemistry Parameters</b>								
<b>6072741-BS1</b>								
Oil & Grease HEM	40.0	41.2		mg/L	103%	78 - 114	6072741	07/19/06 07:36
<b>Volatile Organic Compounds by EPA Method 8260B</b>								
<b>6074065-BS1</b>								
Tert-Amyl Methyl Ether	50.0	47.4		ug/L	95%	56 - 145	6074065	07/25/06 22:13
1,2-Dibromoethane (EDB)	50.0	48.8		ug/L	98%	75 - 128	6074065	07/25/06 22:13
Benzene	50.0	55.8		ug/L	112%	79 - 123	6074065	07/25/06 22:13
1,2-Dichloroethane	50.0	61.4		ug/L	123%	74 - 131	6074065	07/25/06 22:13
Ethylbenzene	50.0	46.7		ug/L	93%	79 - 125	6074065	07/25/06 22:13
Toluene	50.0	48.3		ug/L	97%	78 - 122	6074065	07/25/06 22:13
Ethyl tert-Butyl Ether	50.0	43.9		ug/L	88%	64 - 141	6074065	07/25/06 22:13
Diisopropyl Ether	50.0	47.1		ug/L	94%	73 - 135	6074065	07/25/06 22:13
Methyl tert-Butyl Ether	50.0	51.8		ug/L	104%	66 - 142	6074065	07/25/06 22:13
Xylenes, total	150	143		ug/L	95%	79 - 130	6074065	07/25/06 22:13
Tertiary Butyl Alcohol	500	547		ug/L	109%	42 - 154	6074065	07/25/06 22:13
<i>Surrogate: 1,2-Dichloroethane-d4</i>	50.0	50.1			100%	70 - 130	6074065	07/25/06 22:13
<i>Surrogate: 1,2-Dichloroethane-d4</i>	50.0	50.1			100%	70 - 130	6074065	07/25/06 22:13
<i>Surrogate: Dibromofluoromethane</i>	50.0	55.4			111%	79 - 122	6074065	07/25/06 22:13
<i>Surrogate: Dibromofluoromethane</i>	50.0	55.4			111%	79 - 122	6074065	07/25/06 22:13
<i>Surrogate: Toluene-d8</i>	50.0	42.3			85%	78 - 121	6074065	07/25/06 22:13
<i>Surrogate: Toluene-d8</i>	50.0	42.3			85%	78 - 121	6074065	07/25/06 22:13
<i>Surrogate: 4-Bromofluorobenzene</i>	50.0	43.8			88%	78 - 126	6074065	07/25/06 22:13
<i>Surrogate: 4-Bromofluorobenzene</i>	50.0	43.8			88%	78 - 126	6074065	07/25/06 22:13
<b>6074210-BS1</b>								
Tert-Amyl Methyl Ether	50.0	49.0		ug/L	98%	56 - 145	6074210	07/25/06 11:01
1,2-Dibromoethane (EDB)	50.0	51.2		ug/L	102%	75 - 128	6074210	07/25/06 11:01
Benzene	50.0	54.7		ug/L	109%	79 - 123	6074210	07/25/06 11:01
1,2-Dichloroethane	50.0	60.7		ug/L	121%	74 - 131	6074210	07/25/06 11:01
Ethylbenzene	50.0	48.5		ug/L	97%	79 - 125	6074210	07/25/06 11:01
Toluene	50.0	48.7		ug/L	97%	78 - 122	6074210	07/25/06 11:01
Ethyl tert-Butyl Ether	50.0	44.3		ug/L	89%	64 - 141	6074210	07/25/06 11:01
Diisopropyl Ether	50.0	46.9		ug/L	94%	73 - 135	6074210	07/25/06 11:01
Methyl tert-Butyl Ether	50.0	52.9		ug/L	106%	66 - 142	6074210	07/25/06 11:01
Xylenes, total	150	147		ug/L	98%	79 - 130	6074210	07/25/06 11:01
Tertiary Butyl Alcohol	500	579		ug/L	116%	42 - 154	6074210	07/25/06 11:01
<i>Surrogate: 1,2-Dichloroethane-d4</i>	50.0	48.5			97%	70 - 130	6074210	07/25/06 11:01
<i>Surrogate: 1,2-Dichloroethane-d4</i>	50.0	48.5			97%	70 - 130	6074210	07/25/06 11:01
<i>Surrogate: Dibromofluoromethane</i>	50.0	54.3			109%	79 - 122	6074210	07/25/06 11:01
<i>Surrogate: Dibromofluoromethane</i>	50.0	54.3			109%	79 - 122	6074210	07/25/06 11:01
<i>Surrogate: Toluene-d8</i>	50.0	43.1			86%	78 - 121	6074210	07/25/06 11:01
<i>Surrogate: Toluene-d8</i>	50.0	43.1			86%	78 - 121	6074210	07/25/06 11:01



Client Delta Env. Consultants (San Jose) / SHELL (13653)  
 175 Bernal Rd., Suite 200  
 San Jose, CA 95119  
 Attn Heather Buckingham

Work Order: NPG1831  
 Project Name: 1801 Santa Rita Rd., Pleasanton, CA  
 Project Number: SAP 135783  
 Received: 07/14/06 08:00

**PROJECT QUALITY CONTROL DATA**  
**LCS - Cont.**

Analyte	Known Val.	Analyzed Val	Q	Units	% Rec.	Target Range	Batch	Analyzed Date/Time
<b>Volatile Organic Compounds by EPA Method 8260B</b>								
<b>6074210-BS1</b>								
Surrogate: 4-Bromofluorobenzene	50.0	45.9			92%	78 - 126	6074210	07/25/06 11:01
Surrogate: 4-Bromofluorobenzene	50.0	45.9			92%	78 - 126	6074210	07/25/06 11:01
<b>6074720-BS1</b>								
Benzene	50.0	49.8		ug/L	100%	79 - 123	6074720	07/26/06 09:42
Ethylbenzene	50.0	52.9		ug/L	106%	79 - 125	6074720	07/26/06 09:42
Toluene	50.0	48.6		ug/L	97%	78 - 122	6074720	07/26/06 09:42
Xylenes, total	150	167		ug/L	111%	79 - 130	6074720	07/26/06 09:42
Surrogate: 1,2-Dichloroethane-d4	50.0	45.7			91%	70 - 130	6074720	07/26/06 09:42
Surrogate: Dibromofluoromethane	50.0	46.4			93%	79 - 122	6074720	07/26/06 09:42
Surrogate: Toluene-d8	50.0	48.8			98%	78 - 121	6074720	07/26/06 09:42
Surrogate: 4-Bromofluorobenzene	50.0	48.0			96%	78 - 126	6074720	07/26/06 09:42
<b>Purgeable Petroleum Hydrocarbons</b>								
<b>6074065-BS1</b>								
Gasoline Range Organics	3050	2290		ug/L	75%	67 - 130	6074065	07/25/06 22:13
Surrogate: 1,2-Dichloroethane-d4	50.0	50.1			100%	70 - 130	6074065	07/25/06 22:13
Surrogate: Dibromofluoromethane	50.0	55.4			111%	70 - 130	6074065	07/25/06 22:13
Surrogate: Toluene-d8	50.0	42.3			85%	70 - 130	6074065	07/25/06 22:13
Surrogate: 4-Bromofluorobenzene	50.0	43.8			88%	70 - 130	6074065	07/25/06 22:13
<b>6074210-BS1</b>								
Gasoline Range Organics	3050	2630		ug/L	86%	67 - 130	6074210	07/25/06 11:01
Surrogate: 1,2-Dichloroethane-d4	50.0	48.5			97%	70 - 130	6074210	07/25/06 11:01
Surrogate: Dibromofluoromethane	50.0	54.3			109%	70 - 130	6074210	07/25/06 11:01
Surrogate: Toluene-d8	50.0	43.1			86%	70 - 130	6074210	07/25/06 11:01
Surrogate: 4-Bromofluorobenzene	50.0	45.9			92%	70 - 130	6074210	07/25/06 11:01
<b>6074720-BS1</b>								
Gasoline Range Organics	3050	2930		ug/L	96%	67 - 130	6074720	07/26/06 09:42
Surrogate: 1,2-Dichloroethane-d4	50.0	45.7			91%	70 - 130	6074720	07/26/06 09:42
Surrogate: Dibromofluoromethane	50.0	46.4			93%	70 - 130	6074720	07/26/06 09:42
Surrogate: Toluene-d8	50.0	48.8			98%	70 - 130	6074720	07/26/06 09:42
Surrogate: 4-Bromofluorobenzene	50.0	48.0			96%	70 - 130	6074720	07/26/06 09:42
<b>Extractable Petroleum Hydrocarbons with Silica Gel Treatment</b>								
<b>6072612-BS1</b>								
Diesel	1000	953		ug/L	95%	49 - 118	6072612	07/24/06 18:22
Surrogate: o-Terphenyl	20.0	21.0			105%	55 - 150	6072612	07/24/06 18:22

Client Delta Env. Consultants (San Jose) / SHELL (13653)  
 175 Bernal Rd., Suite 200  
 San Jose, CA 95119  
 Attn Heather Buckingham

Work Order: NPG1831  
 Project Name: 1801 Santa Rita Rd., Pleasanton, CA  
 Project Number: SAP 135783  
 Received: 07/14/06 08:00

**PROJECT QUALITY CONTROL DATA**  
**LCS Dup**

Analyte	Orig. Val.	Duplicate	Q	Units	Spike Conc	% Rec.	Target Range	RPD	Limit	Batch	Sample Duplicated	Analyzed Date/Time
<b>General Chemistry Parameters</b>												
<b>6072741-BSD1</b>												
Oil & Grease HEM		41.6		mg/L	40.0	104%	78 - 114	1	18	6072741		07/19/06 07:36

Client Delta Env. Consultants (San Jose) / SHELL (13653)  
 175 Bernal Rd., Suite 200  
 San Jose, CA 95119  
 Attn Heather Buckingham

Work Order: NPG1831  
 Project Name: 1801 Santa Rita Rd., Pleasanton, CA  
 Project Number: SAP 135783  
 Received: 07/14/06 08:00

**PROJECT QUALITY CONTROL DATA**  
**Matrix Spike**

Analyte	Orig. Val.	MS Val	Q	Units	Spike Conc	% Rec.	Target Range	Batch	Sample Spiked	Analyzed Date/Time
<b>General Chemistry Parameters</b>										
<b>6072741-MS1</b>										
Oil & Grease HEM	ND	42.1		mg/L	40.0	105%	78 - 114	6072741	NPG1677-01	07/19/06 07:36
<b>Volatile Organic Compounds by EPA Method 8260B</b>										
<b>6074065-MS1</b>										
Tert-Amyl Methyl Ether	ND	40.9		ug/L	50.0	82%	45 - 155	6074065	NPG2044-01	07/26/06 08:09
1,2-Dibromoethane (EDB)	ND	41.7		ug/L	50.0	83%	71 - 138	6074065	NPG2044-01	07/26/06 08:09
Benzene	ND	47.3		ug/L	50.0	95%	71 - 137	6074065	NPG2044-01	07/26/06 08:09
1,2-Dichloroethane	ND	54.9		ug/L	50.0	110%	70 - 140	6074065	NPG2044-01	07/26/06 08:09
Ethylbenzene	ND	42.0		ug/L	50.0	84%	72 - 139	6074065	NPG2044-01	07/26/06 08:09
Toluene	ND	41.2		ug/L	50.0	82%	73 - 133	6074065	NPG2044-01	07/26/06 08:09
Ethyl tert-Butyl Ether	ND	38.2		ug/L	50.0	76%	57 - 148	6074065	NPG2044-01	07/26/06 08:09
Diisopropyl Ether	ND	40.3		ug/L	50.0	81%	67 - 143	6074065	NPG2044-01	07/26/06 08:09
Methyl tert-Butyl Ether	ND	45.9		ug/L	50.0	92%	55 - 152	6074065	NPG2044-01	07/26/06 08:09
Xylenes, total	ND	125		ug/L	150	83%	70 - 143	6074065	NPG2044-01	07/26/06 08:09
Tertiary Butyl Alcohol	ND	453		ug/L	500	91%	19 - 183	6074065	NPG2044-01	07/26/06 08:09
Surrogate: 1,2-Dichloroethane-d4		50.2		ug/L	50.0	100%	70 - 130	6074065	NPG2044-01	07/26/06 08:09
Surrogate: 1,2-Dichloroethane-d4		50.2		ug/L	50.0	100%	70 - 130	6074065	NPG2044-01	07/26/06 08:09
Surrogate: Dibromofluoromethane		55.8		ug/L	50.0	112%	79 - 122	6074065	NPG2044-01	07/26/06 08:09
Surrogate: Dibromofluoromethane		55.8		ug/L	50.0	112%	79 - 122	6074065	NPG2044-01	07/26/06 08:09
Surrogate: Toluene-d8		42.5		ug/L	50.0	85%	78 - 121	6074065	NPG2044-01	07/26/06 08:09
Surrogate: Toluene-d8		42.5		ug/L	50.0	85%	78 - 121	6074065	NPG2044-01	07/26/06 08:09
Surrogate: 4-Bromofluorobenzene		44.4		ug/L	50.0	89%	78 - 126	6074065	NPG2044-01	07/26/06 08:09
Surrogate: 4-Bromofluorobenzene		44.4		ug/L	50.0	89%	78 - 126	6074065	NPG2044-01	07/26/06 08:09
<b>6074210-MS1</b>										
Tert-Amyl Methyl Ether	ND	41.6		ug/L	50.0	83%	45 - 155	6074210	NPG1674-04	07/25/06 20:34
1,2-Dibromoethane (EDB)	ND	43.0		ug/L	50.0	86%	71 - 138	6074210	NPG1674-04	07/25/06 20:34
Benzene	ND	50.9		ug/L	50.0	102%	71 - 137	6074210	NPG1674-04	07/25/06 20:34
1,2-Dichloroethane	ND	54.7		ug/L	50.0	109%	70 - 140	6074210	NPG1674-04	07/25/06 20:34
Ethylbenzene	ND	42.7		ug/L	50.0	85%	72 - 139	6074210	NPG1674-04	07/25/06 20:34
Toluene	ND	44.3		ug/L	50.0	89%	73 - 133	6074210	NPG1674-04	07/25/06 20:34
Ethyl tert-Butyl Ether	ND	38.8		ug/L	50.0	78%	57 - 148	6074210	NPG1674-04	07/25/06 20:34
Diisopropyl Ether	ND	41.9		ug/L	50.0	84%	67 - 143	6074210	NPG1674-04	07/25/06 20:34
Methyl tert-Butyl Ether	1.00E9	1.00E9	MHA	ug/L	50.0	0%	55 - 152	6074210	NPG1674-04	07/25/06 20:34
Xylenes, total	ND	131		ug/L	150	87%	70 - 143	6074210	NPG1674-04	07/25/06 20:34
Tertiary Butyl Alcohol	ND	452		ug/L	500	90%	19 - 183	6074210	NPG1674-04	07/25/06 20:34
Surrogate: 1,2-Dichloroethane-d4		49.9		ug/L	50.0	100%	70 - 130	6074210	NPG1674-04	07/25/06 20:34
Surrogate: 1,2-Dichloroethane-d4		49.9		ug/L	50.0	100%	70 - 130	6074210	NPG1674-04	07/25/06 20:34

Client Delta Env. Consultants (San Jose) / SHELL (13653)  
 175 Bernal Rd., Suite 200  
 San Jose, CA 95119  
 Attn Heather Buckingham

Work Order: NPG1831  
 Project Name: 1801 Santa Rita Rd., Pleasanton, CA  
 Project Number: SAP 135783  
 Received: 07/14/06 08:00

**PROJECT QUALITY CONTROL DATA**  
**Matrix Spike - Cont.**

Analyte	Orig. Val.	MS Val	Q	Units	Spike Conc	% Rec.	Target Range	Batch	Sample Spiked	Analyzed Date/Time
<b>Volatile Organic Compounds by EPA Method 8260B</b>										
<b>6074210-MS1</b>										
Surrogate: Dibromofluoromethane		57.2		ug/L	50.0	114%	79 - 122	6074210	NPG1674-04	07/25/06 20:34
Surrogate: Dibromofluoromethane		57.2		ug/L	50.0	114%	79 - 122	6074210	NPG1674-04	07/25/06 20:34
Surrogate: Toluene-d8		43.5		ug/L	50.0	87%	78 - 121	6074210	NPG1674-04	07/25/06 20:34
Surrogate: Toluene-d8		43.5		ug/L	50.0	87%	78 - 121	6074210	NPG1674-04	07/25/06 20:34
Surrogate: 4-Bromofluorobenzene		46.2		ug/L	50.0	92%	78 - 126	6074210	NPG1674-04	07/25/06 20:34
Surrogate: 4-Bromofluorobenzene		46.2		ug/L	50.0	92%	78 - 126	6074210	NPG1674-04	07/25/06 20:34
<b>Purgeable Petroleum Hydrocarbons</b>										
<b>6074065-MS1</b>										
Gasoline Range Organics	ND	1900		ug/L	3050	62%	60 - 140	6074065	NPG2044-01	07/26/06 08:09
Surrogate: 1,2-Dichloroethane-d4		50.2		ug/L	50.0	100%	0 - 200	6074065	NPG2044-01	07/26/06 08:09
Surrogate: Dibromofluoromethane		55.8		ug/L	50.0	112%	0 - 200	6074065	NPG2044-01	07/26/06 08:09
Surrogate: Toluene-d8		42.5		ug/L	50.0	85%	0 - 200	6074065	NPG2044-01	07/26/06 08:09
Surrogate: 4-Bromofluorobenzene		44.4		ug/L	50.0	89%	0 - 200	6074065	NPG2044-01	07/26/06 08:09
<b>6074210-MS1</b>										
Gasoline Range Organics	313	2400		ug/L	3050	68%	60 - 140	6074210	NPG1674-04	07/25/06 20:34
Surrogate: 1,2-Dichloroethane-d4		49.9		ug/L	50.0	100%	0 - 200	6074210	NPG1674-04	07/25/06 20:34
Surrogate: Dibromofluoromethane		57.2		ug/L	50.0	114%	0 - 200	6074210	NPG1674-04	07/25/06 20:34
Surrogate: Toluene-d8		43.5		ug/L	50.0	87%	0 - 200	6074210	NPG1674-04	07/25/06 20:34
Surrogate: 4-Bromofluorobenzene		46.2		ug/L	50.0	92%	0 - 200	6074210	NPG1674-04	07/25/06 20:34

Client Delta Env. Consultants (San Jose) / SHELL (13653)  
 175 Bernal Rd., Suite 200  
 San Jose, CA 95119  
 Attn Heather Buckingham

Work Order: NPG1831  
 Project Name: 1801 Santa Rita Rd., Pleasanton, CA  
 Project Number: SAP 135783  
 Received: 07/14/06 08:00

**PROJECT QUALITY CONTROL DATA**  
**Matrix Spike Dup**

Analyte	Orig. Val.	Duplicate	Q	Units	Spike Conc	% Rec.	Target Range	RPD	Limit	Batch	Sample Duplicated	Analyzed Date/Time
<b>Volatile Organic Compounds by EPA Method 8260B</b>												
<b>6074065-MSD1</b>												
Tert-Amyl Methyl Ether	ND	45.4		ug/L	50.0	91%	45 - 155	10	24	6074065	NPG2044-01	07/26/06 08:34
1,2-Dibromoethane (EDB)	ND	46.1		ug/L	50.0	92%	71 - 138	10	27	6074065	NPG2044-01	07/26/06 08:34
Benzene	ND	52.7		ug/L	50.0	105%	71 - 137	11	23	6074065	NPG2044-01	07/26/06 08:34
1,2-Dichloroethane	ND	60.2		ug/L	50.0	120%	70 - 140	9	21	6074065	NPG2044-01	07/26/06 08:34
Ethylbenzene	ND	45.6		ug/L	50.0	91%	72 - 139	8	23	6074065	NPG2044-01	07/26/06 08:34
Toluene	ND	46.1		ug/L	50.0	92%	73 - 133	11	25	6074065	NPG2044-01	07/26/06 08:34
Ethyl tert-Butyl Ether	ND	42.6		ug/L	50.0	85%	57 - 148	11	22	6074065	NPG2044-01	07/26/06 08:34
Diisopropyl Ether	ND	44.7		ug/L	50.0	89%	67 - 143	10	22	6074065	NPG2044-01	07/26/06 08:34
Methyl tert-Butyl Ether	ND	50.1		ug/L	50.0	100%	55 - 152	9	27	6074065	NPG2044-01	07/26/06 08:34
Xylenes, total	ND	139		ug/L	150	93%	70 - 143	11	27	6074065	NPG2044-01	07/26/06 08:34
Tertiary Butyl Alcohol	ND	509		ug/L	500	102%	19 - 183	12	39	6074065	NPG2044-01	07/26/06 08:34
Surrogate: 1,2-Dichloroethane-d4		49.2		ug/L	50.0	98%	70 - 130			6074065	NPG2044-01	07/26/06 08:34
Surrogate: 1,2-Dichloroethane-d4		49.2		ug/L	50.0	98%	70 - 130			6074065	NPG2044-01	07/26/06 08:34
Surrogate: Dibromofluoromethane		54.3		ug/L	50.0	109%	79 - 122			6074065	NPG2044-01	07/26/06 08:34
Surrogate: Dibromofluoromethane		54.3		ug/L	50.0	109%	79 - 122			6074065	NPG2044-01	07/26/06 08:34
Surrogate: Toluene-d8		42.0		ug/L	50.0	84%	78 - 121			6074065	NPG2044-01	07/26/06 08:34
Surrogate: Toluene-d8		42.0		ug/L	50.0	84%	78 - 121			6074065	NPG2044-01	07/26/06 08:34
Surrogate: 4-Bromofluorobenzene		44.0		ug/L	50.0	88%	78 - 126			6074065	NPG2044-01	07/26/06 08:34
Surrogate: 4-Bromofluorobenzene		44.0		ug/L	50.0	88%	78 - 126			6074065	NPG2044-01	07/26/06 08:34
<b>6074210-MSD1</b>												
Tert-Amyl Methyl Ether	ND	43.1		ug/L	50.0	86%	45 - 155	4	24	6074210	NPG1674-04	07/25/06 20:59
1,2-Dibromoethane (EDB)	ND	45.4		ug/L	50.0	91%	71 - 138	5	27	6074210	NPG1674-04	07/25/06 20:59
Benzene	ND	52.5		ug/L	50.0	105%	71 - 137	3	23	6074210	NPG1674-04	07/25/06 20:59
1,2-Dichloroethane	ND	54.7		ug/L	50.0	109%	70 - 140	0	21	6074210	NPG1674-04	07/25/06 20:59
Ethylbenzene	ND	44.3		ug/L	50.0	89%	72 - 139	4	23	6074210	NPG1674-04	07/25/06 20:59
Toluene	ND	45.2		ug/L	50.0	90%	73 - 133	2	25	6074210	NPG1674-04	07/25/06 20:59
Ethyl tert-Butyl Ether	ND	39.7		ug/L	50.0	79%	57 - 148	2	22	6074210	NPG1674-04	07/25/06 20:59
Diisopropyl Ether	ND	43.2		ug/L	50.0	86%	67 - 143	3	22	6074210	NPG1674-04	07/25/06 20:59
Methyl tert-Butyl Ether	1.00E9	1.00E9	MHA	ug/L	50.0	0%	55 - 152	0	27	6074210	NPG1674-04	07/25/06 20:59
Xylenes, total	ND	134		ug/L	150	89%	70 - 143	2	27	6074210	NPG1674-04	07/25/06 20:59
Tertiary Butyl Alcohol	ND	505		ug/L	500	101%	19 - 183	11	39	6074210	NPG1674-04	07/25/06 20:59
Surrogate: 1,2-Dichloroethane-d4		48.7		ug/L	50.0	97%	70 - 130			6074210	NPG1674-04	07/25/06 20:59
Surrogate: 1,2-Dichloroethane-d4		48.7		ug/L	50.0	97%	70 - 130			6074210	NPG1674-04	07/25/06 20:59
Surrogate: Dibromofluoromethane		55.6		ug/L	50.0	111%	79 - 122			6074210	NPG1674-04	07/25/06 20:59
Surrogate: Dibromofluoromethane		55.6		ug/L	50.0	111%	79 - 122			6074210	NPG1674-04	07/25/06 20:59
Surrogate: Toluene-d8		42.9		ug/L	50.0	86%	78 - 121			6074210	NPG1674-04	07/25/06 20:59
Surrogate: Toluene-d8		42.9		ug/L	50.0	86%	78 - 121			6074210	NPG1674-04	07/25/06 20:59
Surrogate: 4-Bromofluorobenzene		45.7		ug/L	50.0	91%	78 - 126			6074210	NPG1674-04	07/25/06 20:59
Surrogate: 4-Bromofluorobenzene		45.7		ug/L	50.0	91%	78 - 126			6074210	NPG1674-04	07/25/06 20:59

Client Delta Env. Consultants (San Jose) / SHELL (13653)  
 175 Bernal Rd., Suite 200  
 San Jose, CA 95119  
 Attn Heather Buckingham

Work Order: NPG1831  
 Project Name: 1801 Santa Rita Rd., Pleasanton, CA  
 Project Number: SAP 135783  
 Received: 07/14/06 08:00

**PROJECT QUALITY CONTROL DATA**  
**Matrix Spike Dup - Cont.**

Analyte	Orig. Val.	Duplicate	Q	Units	Spike Conc	% Rec.	Target Range	RPD	Limit	Batch	Sample Duplicated	Analyzed Date/Time
<b>Purgeable Petroleum Hydrocarbons</b>												
<b>6074065-MSD1</b>												
Gasoline Range Organics	ND	2220		ug/L	3050	73%	60 - 140	16	40	6074065	NPG2044-01	07/26/06 08:34
Surrogate: 1,2-Dichloroethane-d4		49.2		ug/L	50.0	98%	0 - 200			6074065	NPG2044-01	07/26/06 08:34
Surrogate: Dibromofluoromethane		54.3		ug/L	50.0	109%	0 - 200			6074065	NPG2044-01	07/26/06 08:34
Surrogate: Toluene-d8		42.0		ug/L	50.0	84%	0 - 200			6074065	NPG2044-01	07/26/06 08:34
Surrogate: 4-Bromofluorobenzene		44.0		ug/L	50.0	88%	0 - 200			6074065	NPG2044-01	07/26/06 08:34
<b>6074210-MSD1</b>												
Gasoline Range Organics	313	2500		ug/L	3050	72%	60 - 140	4	40	6074210	NPG1674-04	07/25/06 20:59
Surrogate: 1,2-Dichloroethane-d4		48.7		ug/L	50.0	97%	0 - 200			6074210	NPG1674-04	07/25/06 20:59
Surrogate: Dibromofluoromethane		55.6		ug/L	50.0	111%	0 - 200			6074210	NPG1674-04	07/25/06 20:59
Surrogate: Toluene-d8		42.9		ug/L	50.0	86%	0 - 200			6074210	NPG1674-04	07/25/06 20:59
Surrogate: 4-Bromofluorobenzene		45.7		ug/L	50.0	91%	0 - 200			6074210	NPG1674-04	07/25/06 20:59

Client Delta Env. Consultants (San Jose) / SHELL (13653)  
 175 Bernal Rd., Suite 200  
 San Jose, CA 95119  
 Attn Heather Buckingham

Work Order: NPG1831  
 Project Name: 1801 Santa Rita Rd., Pleasanton, CA  
 Project Number: SAP 135783  
 Received: 07/14/06 08:00

### CERTIFICATION SUMMARY

**TestAmerica - Nashville, TN**

Method	Matrix	AIHA	Nelac	California
CA LUFT GC/MS	Water			X
EPA 1664A	Water	N/A	X	X
NA	Water			
SW846 8015B	Water			
SW846 8260B	Water	N/A	X	X

Client Delta Env. Consultants (San Jose) / SHELL (13653)  
175 Bernal Rd., Suite 200  
San Jose, CA 95119  
Attn Heather Buckingham

Work Order: NPG1831  
Project Name: 1801 Santa Rita Rd., Pleasanton, CA  
Project Number: SAP 135783  
Received: 07/14/06 08:00

## NELAC CERTIFICATION SUMMARY

TestAmerica Analytical - Nashville does not hold NELAC certifications for the following analytes included in this report

<u>Method</u>	<u>Matrix</u>	<u>Analyte</u>
CA LUFT GC/MS	Water	Gasoline Range Organics
SW846 8015B	Water	Diesel



Client Delta Env. Consultants (San Jose) / SHELL (13653)  
175 Bernal Rd., Suite 200  
San Jose, CA 95119  
Attn Heather Buckingham

Work Order: NPG1831  
Project Name: 1801 Santa Rita Rd., Pleasanton, CA  
Project Number: SAP 135783  
Received: 07/14/06 08:00

## DATA QUALIFIERS AND DEFINITIONS

**MHA** Due to high levels of analyte in the sample, the MS/MSD calculation does not provide useful spike recovery information. See Blank Spike (LCS).  
**ZX** Due to sample matrix effects, the surrogate recovery was outside the acceptance limits.

## METHOD MODIFICATION NOTES

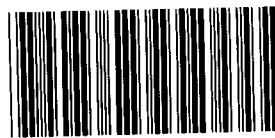

**Nashville Division**  
**COOLER RECEIPT FORM**

BC#

NPG1831

Cooler Received/Opened On: 7/14/2006 8:00  
1. Indicate the Airbill Tracking Number (last 4 digits for Fedex only) and Name of Courier below: 0172

FED-EX  
Temperature of representative sample or temperature blank when opened: 2.0 Degrees Celsius  
(indicate IR Gun ID#)

101507

3. Were custody seals on outside of cooler?..... YES...NO...NA  
a. If yes, how many and where: 2 F/OUT

4. Were the seals intact, signed, and dated correctly?..... YES...NO...NA

5. Were custody papers inside cooler?..... YES...NO...NA

I certify that I opened the cooler and answered questions 1-5 (initial)..... WJ

6. Were custody seals on containers: YES NO and Intact YES NO NA  
were these signed, and dated correctly?..... YES...NO...NA

7. What kind of packing material used? Bubblewrap Peanuts Vermiculite Foam Insert  
Plastic bag Paper Other \_\_\_\_\_ None

8. Cooling process: Ice Ice-pack Ice (direct contact) Dry ice Other None

9. Did all containers arrive in good condition (unbroken)?..... YES...NO...NA

10. Were all container labels complete (#, date, signed, pres., etc)?..... YES...NO...NA

11. Did all container labels and tags agree with custody papers?..... YES...NO...NA

12. a. Were VOA vials received?..... YES...NO...NA

b. Was there any observable head space present in any VOA vial?..... YES...NO...NA

I certify that I unloaded the cooler and answered questions 6-12 (initial)..... WJ

13. a. On preserved bottles did the pH test strips suggest that preservation reached the correct pH level? YES...NO...NA

b. Did the bottle labels indicate that the correct preservatives were used..... YES...NO...NA

If preservation in-house was needed, record standard ID of preservative used here \_\_\_\_\_

14. Was residual chlorine present?..... YES...NO...NA

I certify that I checked for chlorine and pH as per SOP and answered questions 13-14 (initial)..... WJ

15. Were custody papers properly filled out (ink, signed, etc)?..... YES...NO...NA

16. Did you sign the custody papers in the appropriate place?..... YES...NO...NA

17. Were correct containers used for the analysis requested?..... YES...NO...NA

18. Was sufficient amount of sample sent in each container?..... YES...NO...NA

I certify that I entered this project into LIMS and answered questions 15-18 (initial)..... WJ

I certify that I attached a label with the unique LIMS number to each container (initial)..... WJ

19. Were there Non-Conformance issues at login YES NO Was a PIPE generated YES NO # \_\_\_\_\_

*Oil & Grease received non preserved*

- LAB:   
 TA - Irvine, California   
 TA - Morgan Hill, California   
 TA - Sacramento, California   
 TA - Nashville, Tennessee   
 Calscience   
 Other \_\_\_\_\_

NPG1831

07/28/06 23:59



# SHELL Chain Of Custody Record

NAME OF PERSON TO BILL: Denis Brown

ENVIRONMENTAL SERVICES

NETWORK DEV / FE

COMPLIANCE

BILL CONSULTANT

RMT/CRMT

CHECK BOX TO VERIFY IF NO INCIDENT # APPLIES

INCIDENT # (ES ONLY)

9 7 6 1 5 9 6 4

DATE: 7-12-06

PAGE: 1 of 1

SAMPLING COMPANY: **Blaine Tech Services** LOG CODE: **BTSS**

ADDRESS: **1680 Rogers Avenue, San Jose, CA 95112**

PROJECT CONTACT (Hardcopy or PDF Report to): **Michael Ninokata**

TELEPHONE: **408-573-0555** FAX: **408-573-7771** E-MAIL: **mninokata@blainetech.com**

TAT (STD IS 10 BUSINESS DAYS / RUSH IS CALENDAR DAYS):   
 STD  5 DAY  3 DAY  2 DAY  24 HOURS  RESULTS NEEDED ON WEEKEND

STATE: **CA** GLOBAL ID NO.: **T0600144714**

SITE ADDRESS: Street and City: **1801 Santa Rita Rd., Pleasanton**

EDF DELIVERABLE TO (Name, Company, Office Location): **Heather Buckingham, Delta, San Jose Office** PHONE NO.: **(408)224-4724** E-MAIL: **hbuckingham@deltaenv.com** CONSULTANT PROJECT NO.: **060712-Pw-J**

SAMPLER NAME(S) (Print): **Dave Walter** LAB USE ONLY

LA - RWQCB REPORT FORMAT  UST AGENCY:

SPECIAL INSTRUCTIONS OR NOTES:   
 EDD NOT NEEDED   
 SHELL CONTRACT RATE APPLIES   
 STATE REIMB RATE APPLIES   
 RECEIPT VERIFICATION REQUESTED

Run TPHd and Total Oil and Grease with Silica Gel Clean Up

REQUESTED ANALYSIS

TPH - Gas, Purgeable (8260B)	TPH - Diesel, Extractable (8015M)	BTEX (8260B)	5 Oxygenates (8260B) (MTBE, TBA, DIPE, TAME, ETBE)	MTBE (8260B)	TBA (8260B)	DIPE (8260B)	TAME (8260B)	ETBE (8260B)	1,2 DCA (8260B)	EDB (8260B)	Ethanol (8260B)	Methanol (8015M)	TPH-motor oil (8015M)	TDS (160.1)	Total Iron (6010B)	Total Lead (6010B)	Total Oil and Grease (1664A)	FIELD NOTES:
																		Container/Preservative or PID Readings or Laboratory Notes

LAB USE ONLY	Field Sample Identification	SAMPLING		MATRIX	NO. OF CONT.	TPH - Gas, Purgeable (8260B)	TPH - Diesel, Extractable (8015M)	BTEX (8260B)	5 Oxygenates (8260B) (MTBE, TBA, DIPE, TAME, ETBE)	MTBE (8260B)	TBA (8260B)	DIPE (8260B)	TAME (8260B)	ETBE (8260B)	1,2 DCA (8260B)	EDB (8260B)	Ethanol (8260B)	Methanol (8015M)	TPH-motor oil (8015M)	TDS (160.1)	Total Iron (6010B)	Total Lead (6010B)	Total Oil and Grease (1664A)	TEMPERATURE ON RECEIPT C°	
		DATE	TIME																						
	MW-1	7-12	1429	W	5	X	X	X	X																
	MW-1A		1446		7	X	X	X	X						X	X							X		Np-1831-01
	MW-4		1341		5	X	X	X	X																2
	MW-4A		1508		5	X	X	X	X					X	X										3
	MW-5		1358		5	X	X	X	X					X	X										4
																									5

Relinquished by: (Signature) **David C. Slatt** Received by: (Signature) **[Signature]** Date: **7/12/06** Time: **8:00**

Relinquished by: (Signature) **[Signature]** Received by: (Signature) **[Signature]** Date: **7/13/06** Time: **1615**

Relinquished by: (Signature) **[Signature]** Received by: (Signature) **[Signature]** Date: **7/13/06** Time: **1309**

Relinquished by: (Signature) **[Signature]** Received by: (Signature) **[Signature]** Date: **7/13/06** Time: **1435**

7-13-06 15:15

# WELLHEAD INSPECTION CHECKLIST

Client Shell Date 7-12-06

Site Address 1801 Santa Rita Rd Pleasanton

Job Number 060712-0w-3 Technician DW

Well ID	Well Inspected - No Corrective Action Required	WELL IS SECURABLE BY DESIGN (12" or less)	WELL IS MARKED WITH THE WORDS "MONITORING WELL" (12" or less)	Water Bailed From Wellbox	Wellbox Components Cleaned	Cap Replaced	Lock Replaced	Other Action Taken (explain below)	Well Not Inspected (explain below)	Repair Order Submitted
MW-1	X									
MW-1A		casing broken at top, cap just barely seals								
MW-2	X									
MW-3	Y									
MW-4	Y									
MW-4A	Y									
MW-5	Y									

NOTES: \_\_\_\_\_

\_\_\_\_\_  
 \_\_\_\_\_  
 \_\_\_\_\_

# WELL GAUGING DATA

Project # 060712-DW-2      Date 7-12-06      Client Shell

Site 1801 Santa Rita Rd Pleasanton

Well ID	Time	Well Size (in.)	Sheen / Odor	Depth to Immiscible Liquid (ft.)	Thickness of Immiscible Liquid (ft.)	Volume of Immiscibles Removed (ml)	Depth to water (ft.)	Depth to well bottom (ft.)	Survey Point: TOB or TOC	Notes
mw-1	1248	4					44.80	91.80	↓	
mw-1A	1300	4				44.41	97.30			
mw-2	1253	4				44.20	93.07	GO		
mw-3	1232	4				44.32	96.85	GO		
mw-4	1236	2				43.34	94.46			
mw-4A	1306	4				43.48	54.36			
mw-5	1240	4				43.44	54.40	↓		

### SHELL WELL MONITORING DATA SHEET

BTS #: <u>060712-DW-2</u>	Site: <u>1801 Santa Rita Rd</u>
Sampler: <u>DW</u>	Date: <u>7-12-06</u>
Well I.D.: <u>MW-1</u>	Well Diameter: 2 3 <u>4</u> 6 8
Total Well Depth (TD): <u>91.80</u>	Depth to Water (DTW): <u>44.80</u>
Depth to Free Product:	Thickness of Free Product (feet):
Referenced to: <u>PVC</u> Grade	D.O. Meter (if req'd): YSI HACH
DTW with 80% Recharge [(Height of Water Column x 0.20) + DTW]: <u>54.20</u>	

Purge Method: Bailer  Waterwa  Sampling Method:  Bailer  
Disposable Bailer  Peristaltic  Disposable Bailer  
Positive Air Displacement  Extraction Pump  Extraction Port  
 Electric Submersible  Other \_\_\_\_\_  Dedicated Tubing  
Other: \_\_\_\_\_

30.6 (Gals.) X 3 = 91.5 Gals.  
1 Case Volume Specified Volumes Calculated Volume

Well Diameter	Multiplier	Well Diameter	Multiplier
1"	0.04	4"	0.65
2"	0.16	6"	1.47
3"	0.37	Other	radius <sup>2</sup> * 0.163

Time	Temp (°F)	pH	Cond. (mS or $\mu$ S)	Turbidity (NTUs)	Gals. Removed	Observations
<u>1412</u>	<u>70.5</u>	<u>6.8</u>	<u>1604</u>	<u>1</u>	<u>30.6</u>	
<u>1418</u>	<u>68.9</u>	<u>6.8</u>	<u>1567</u>	<u>1</u>	<u>61.2</u>	
<u>1424</u>	<u>68.4</u>	<u>6.8</u>	<u>1564</u>	<u>1</u>	<u>91.5</u>	

Did well dewater? Yes   No      Gallons actually evacuated: 91.5

Sampling Date: 7-12-06      Sampling Time: 1429      Depth to Water: 45.05

Sample I.D.: MW-1      Laboratory: STL      Other: TA

Analyzed for: TPH-C BTEX MTBE TPH-D      Other: See Sow

EB I.D. (if applicable): @ \_\_\_\_\_      Duplicate I.D. (if applicable): \_\_\_\_\_

Analyzed for: TPH-G BTEX MTBE TPH-D      Other: \_\_\_\_\_

D.O. (if req'd):	Pre-purge:	mg/L	Post-purge:	mg/L
O.R.P. (if req'd):	Pre-purge:	mV	Post-purge:	mV

## SHELL WELL MONITORING DATA SHEET

BTS #: <u>060712-DW-2</u>	Site: <u>1801 Santa Rita Rd</u>
Sampler: <u>DW</u>	Date: <u>7-12-06</u>
Well I.D.: <u>MW-1A</u>	Well Diameter: 2 3 <u>4</u> 6 8 _____
Total Well Depth (TD): <u>57.30</u>	Depth to Water (DTW): <u>44.41</u>
Depth to Free Product:	Thickness of Free Product (feet):
Referenced to: <u>PVC</u> Grade	D.O. Meter (if req'd): YSI HACH
DTW with 80% Recharge [(Height of Water Column x 0.20) + DTW]: <u>46.98</u>	

Purge Method: Bailer	Watera	Sampling Method: <input checked="" type="checkbox"/> Bailer
Disposable Bailer	Peristaltic	Disposable Bailer
Positive Air Displacement	Extraction Pump	Extraction Port
<input checked="" type="checkbox"/> Electric Submersible	Other _____	Dedicated Tubing
Other: _____		

<u>8.4</u> (Gals.) X <u>3</u> = <u>25.2</u> Gals. 1 Case Volume      Specified Volumes      Calculated Volume	<table border="1" style="width: 100%; border-collapse: collapse; font-size: small;"> <tr> <th>Well Diameter</th> <th>Multiplier</th> <th>Well Diameter</th> <th>Multiplier</th> </tr> <tr> <td>1"</td> <td>0.04</td> <td>4"</td> <td>0.65</td> </tr> <tr> <td>2"</td> <td>0.16</td> <td>6"</td> <td>1.47</td> </tr> <tr> <td>3"</td> <td>0.37</td> <td>Other</td> <td>radius<sup>2</sup> * 0.163</td> </tr> </table>	Well Diameter	Multiplier	Well Diameter	Multiplier	1"	0.04	4"	0.65	2"	0.16	6"	1.47	3"	0.37	Other	radius <sup>2</sup> * 0.163
Well Diameter	Multiplier	Well Diameter	Multiplier														
1"	0.04	4"	0.65														
2"	0.16	6"	1.47														
3"	0.37	Other	radius <sup>2</sup> * 0.163														

Time	Temp (°F)	pH	Cond. (mS or $\mu$ S)	Turbidity (NTUs)	Gals. Removed	Observations
<u>1437</u>	<u>71.0</u>	<u>6.9</u>	<u>1781</u>	<u>917</u>	<u>8.4</u>	
<u>1439</u>	<u>70.1</u>	<u>6.8</u>	<u>1783</u>	<u>318</u>	<u>16.8</u>	
<u>1441</u>	<u>69.7</u>	<u>6.8</u>	<u>1745</u>	<u>74</u>	<u>25.2</u>	

Did well dewater? Yes <input checked="" type="checkbox"/> No	Gallons actually evacuated: <u>25.2</u>
Sampling Date: <u>7-12-06</u> Sampling Time: <u>1446</u> Depth to Water: <u>44.55</u>	
Sample I.D.: <u>MW-1A</u> Laboratory: STL Other: <u>TA</u>	
Analyzed for: <u>TPH-G</u> <u>BTEX</u> MTBE <u>TPH-D</u> Other: <u>See Sow</u>	
EB I.D. (if applicable): _____ @ _____ Time Duplicate I.D. (if applicable): _____	
Analyzed for: TPH-G BTEX MTBE TPH-D Other: _____	
D.O. (if req'd): Pre-purge: _____ mg/L Post-purge: _____ mg/L	
O.R.P. (if req'd): Pre-purge: _____ mV Post-purge: _____ mV	

## SHELL WELL MONITORING DATA SHEET

BTS #: <u>060712-DW-2</u>	Site: <u>1801 Santa Rita Rd</u>
Sampler: <u>DW</u>	Date: <u>7-12-06</u>
Well I.D.: <u>MW-4</u>	Well Diameter: <u>(2)</u> 3 4 6 8
Total Well Depth (TD): <u>94.40</u>	Depth to Water (DTW): <u>43.34</u>
Depth to Free Product:	Thickness of Free Product (feet):
Referenced to: <u>(PVC)</u> Grade	D.O. Meter (if req'd): YSI HACH
DTW with 80% Recharge [(Height of Water Column x 0.20) + DTW]: <u>53.55</u>	

Purge Method: Bailer	Waterra	Sampling Method: <input checked="" type="checkbox"/> Bailer
Disposable Bailer	Peristaltic	Disposable Bailer
<input checked="" type="checkbox"/> Positive Air Displacement	Extraction Pump	Extraction Port
Electric Submersible	Other _____	Dedicated Tubing
		Other: _____

<u>8.2</u> (Gals.) X <u>3</u> = <u>24.6</u> Gals. 1 Case Volume      Specified Volumes      Calculated Volume	<table border="1" style="width: 100%; border-collapse: collapse; text-align: center;"> <thead> <tr> <th>Well Diameter</th> <th>Multiplier</th> <th>Well Diameter</th> <th>Multiplier</th> </tr> </thead> <tbody> <tr> <td>1"</td> <td>0.04</td> <td>4"</td> <td>0.65</td> </tr> <tr> <td>2"</td> <td>0.16</td> <td>6"</td> <td>1.47</td> </tr> <tr> <td>3"</td> <td>0.37</td> <td>Other</td> <td>radius<sup>2</sup> * 0.163</td> </tr> </tbody> </table>	Well Diameter	Multiplier	Well Diameter	Multiplier	1"	0.04	4"	0.65	2"	0.16	6"	1.47	3"	0.37	Other	radius <sup>2</sup> * 0.163
Well Diameter	Multiplier	Well Diameter	Multiplier														
1"	0.04	4"	0.65														
2"	0.16	6"	1.47														
3"	0.37	Other	radius <sup>2</sup> * 0.163														

Time	Temp (°F)	pH	Cond. (mS or $\mu$ S)	Turbidity (NTUs)	Gals. Removed	Observations
<u>1318</u>	<u>71.1</u>	<u>6.8</u>	<u>1618</u>	<u>977</u>	<u>8.2</u>	
<u>1327</u>	<u>70.0</u>	<u>6.9</u>	<u>1548</u>	<u>876</u>	<u>16.4</u>	
<u>1336</u>	<u>69.4</u>	<u>6.9</u>	<u>1521</u>	<u>752</u>	<u>24.6</u>	

Did well dewater? Yes <input type="checkbox"/> <input checked="" type="checkbox"/> No	Gallons actually evacuated: <u>24.6</u>
Sampling Date: <u>7-12-06</u> Sampling Time: <u>1341</u>	Depth to Water: <u>43.87</u>
Sample I.D.: <u>MW-4</u>	Laboratory: STL    Other: <u>(TA)</u>
Analyzed for: <u>(TPH-G)</u> <u>(BTEX)</u> MTBE <u>(TPH-D)</u> Other: <u>See Sow</u>	
EB I.D. (if applicable): @ _____	Duplicate I.D. (if applicable):
Analyzed for: TPH-G BTEX MTBE TPH-D Other:	
D.O. (if req'd): Pre-purge: _____ mg/L	Post-purge: _____ mg/L
O.R.P. (if req'd): Pre-purge: _____ mV	Post-purge: _____ mV





