



RECEIVED

By dehloptoxic at 1:29 pm, Jul 17, 2006

July 14, 2006

Mr. Steven Plunkett
Alameda County Health Care Services Agency
Environmental Health Services
Environmental Protection (LOP)
1131 Harbor Bay Parkway, Suite 250
Alameda, CA 94502-6577

RE: Sensitive Receptor Survey for Site Closure Review- Monterey Apartments,
748 Lincoln Avenue, Alameda, California
(ACHCSA Fuel Leak Case No: RO0002880; GGTR Project No. 8657)

Dear Mr. Plunkett:

On behalf of Mr. Robert Bond of Monterey Apartments, Golden Gate Tank Removal, Inc. (GGTR) is pleased to provide a brief summary of findings of the Sensitive Receptor Survey performed in the vicinity of the subject property at 748 Lincoln Avenue in Alameda, California. The activities at the site were performed in general accordance with the April 12, 2006 directive letter issued by the Alameda County Health Care Services Agency (ACHCSA), which requested a Sensitive Receptor Survey be performed within a 2,000-foot radius of the site. The purpose of the survey is to provide a review of all municipal, irrigation, and domestic water supply wells, as well as all surface waters in the vicinity of the site. Information acquired from the receptor survey will be incorporated into the site closure review. Figure 1 is a *Site Location Map* showing the survey radius area. A copy of the ACHCSA's April 12, 2006 letter is attached.

Site Location, Description, and Environmental Background

The subject commercial property is located along the south side of Lincoln Avenue, between Webster Street and 8th Street in the City and County of Alameda. The site lies approximately 900 feet (0.17 mile) east of Webster Street and 0.5 mile north of San Francisco Bay (Figure 1). The general location of the site is shown on Figure 1.

The elevation of the property is approximately 17 feet above Mean Sea Level. The property consists of a rectangular site occupying 9,750 square feet (0.22 acre) in lot area and has been owned by Mr. Robert Bond since September 1972 (Alameda County Assessor Parcel 73-419-47). The property is relatively flat lying with the topographic relief generally directed towards the north-northeast (Figure 1), in the general direction of the Oakland Inner Harbor. The subject and vicinity properties are zoned as General Residential District (R-5; City of Alameda Planning & Zoning).

Golden Gate Tank Removal, Inc.
255 Shipley Street, San Francisco, California
Phone (415) 512-1555 ♦ Fax (415) 512-0964

A multi-story, apartment building, approximately 7,625 square feet in area, is situated on the majority of the property, with two open basement garage entrances on the north side of the building providing access to tenant vehicular parking. At least two active sump pumps are located on the north and east sides of the basement floor to evacuate water having accumulated during periods of high rainfall and/or runoff. The surface area in the parking garage is completely paved with concrete. The north entryway of the property is paved throughout with concrete, with small areas on each side of the garage driveway ramps landscaped with lawn. The City right of way sidewalk borders the north property line. Figure 2 presents a *Site Plan* of the subject property.

The site is in the East Bay Plain groundwater basin according to the San Francisco Bay Basin Water Quality Control Plan prepared by the California Regional Water Quality Control Board – Region 2 (CRWQCB, 1995). Groundwater in this basin is designated beneficial for municipal and domestic water supply and industrial process, service water, and agricultural water supply. The regional groundwater flow direction in the vicinity of the site is estimated to be toward the north-northeast, in the general direction of the Oakland Inner Harbor and decreasing topographic relief. The static groundwater level measured during temporary wellhead elevation survey activities (B2-B4) on November 22, 2005, was between 8.12 and 8.94 fbg, and the associated groundwater flow direction was directed toward the east-northeast (N82E @ 0.009 foot/foot). The nearest surface water body is the Robert Crown Memorial State Beach Inlet of the San Francisco Bay, located approximately 0.5 mile southwest and lateral gradient of the subject property (Figure 1).

One 1,500-gallon heating oil UST was located beneath the sidewalk in front of the northeast corner of the subject site, and was removed by GGTR on June 15, 2005. A soil sample collected from the east end of the excavation at 11.5 feet below grade (fbg) contained non-detectable concentrations of total petroleum hydrocarbons (TPH) as diesel (TPH-D; <2.5 mg/kg), benzene, toluene, ethylbenzene, and total xylenes (BTEX <0.25 mg/kg), methyl tertiary butyl ether (MTBE; <0.25), and tert-butyl ethyl ether (<0.25). The grab groundwater sample collected from the center of the excavation at approximately 10 fbg (following stabilization) contained 9,100 micrograms per liter (ug/l) TPH-D and non-detectable concentrations of BTEX, MTBE, and tert-butyl ethyl ether. The approximate location of each sample is shown in Figure 2. Additional details and tabulated soil/groundwater sample analytical results are in *GGTR's June 27, 2005 Tank Closure Report*.

Based on review of the findings of the aforementioned Tank Closure Report, the ACHCSA, in a letter dated August 17, 2005, requested that a work plan be prepared to assess the extent of soil and groundwater contamination in the direct vicinity of the former UST. On September 23, 2005, GGTR submitted their Work Plan for Preliminary Site Characterization, which was subsequently approved by the ACHCSA in a letter dated November 2, 2005.

On November 18, 2005, GGTR percussion-drilled four (4) subsurface investigative soil borings, B1 through B4, up to approximately 24 fbg along the north, northeast, west, and southeast sides of the former tank excavation site to evaluate the extent of hydrocarbon-affected soil and groundwater in the vicinity of the former UST. Soil samples were collected continuously in each boring between 5 and 24 fbg. GGTR collected grab groundwater samples from B1 through B4. Each borehole was subsequently backfilled with neat Portland cement and either asphalt patch or surface concrete. All soil and grab groundwater samples collected in B1 through B4 contained non-detectable concentrations of TPH-D, BTEX, and MTBE, not exceeding applicable environmental screening levels and/or maximum contaminant levels. The grab groundwater sample collected in B2 contained 240 mg/l Total Dissolved Solids. Additional details and

tabulated analytical results are presented in *GGTR's January 25, 2006 Report of Preliminary Site Characterization*.

Sensitive Receptor Survey

Based upon results of the preliminary site investigation activities, the ACHCSA, in its most recent April 12, 2006 letter, requested that a sensitive receptor survey be performed within the vicinity of the subject property. The purpose of the survey was to determine whether any municipal, irrigation, and/or domestic water-producing wells exist within a 2,000-foot radius of the site and whether they may potentially act as receptors for offsite migration of the hydrocarbon-affected groundwater. The survey was also utilized to locate any surface water bodies and any areas of sensitive land usage in the vicinity of the site.

The letter and previous correspondence references a similar receptor survey conducted at the Shell Service Station located at the northwest corner of Webster Street & Lincoln Avenue (Shell Station #13-5032; 1601 Webster Street), approximately 900 feet west of the site. The survey was conducted within a 0.5-mile (@ 2,600 feet) radius of the Shell Station, which does cover the subject site as well as approximately 1,700 feet to its east. According to the ACHCSA's April 12, 2006 letter, the Shell receptor survey is not valid because it is not within 2,000 feet of the subject site.

On April 24, 2006, GGTR submitted a Well Completion Report Release Agreement to the Department of Water Resources (DWR), Central District and the Alameda County Public Works Agency (ACPWA), Water Resources Section for all municipal, irrigation and domestic water supply wells installed within a 2,000-foot radius of the subject property. A copy of the DWR and ACPWA Well Report Release Agreement is attached.

On May 11, 2006, the ACPWA submitted all Well Completion Reports within an approximate 0.5- to 1-mile radius of the subject property. Thirteen (13) irrigation wells, one (1) industrial well, four (4) groundwater extraction/vapor wells, and approximately seventy-five (75) groundwater monitoring wells were located as result of the ACPWA radius search. However, only two irrigation wells and one industrial well exist within the 2,000-foot radius survey area. Groundwater monitor wells were located within the 2,000-foot radius survey area, but were not requested as part of this search.

On June 20, 2006 GGTR visited the **DWR Central District Office** in Sacramento, California to acquire Well Completion Reports on the DWR database within an approximate 1-mile radius of the subject property. DWR staff was previously unavailable to conduct a database record search. One (1) domestic water supply well, Three (3) irrigation wells, One (1) cathodic protection well, five (5) vapor extraction wells, and approximately eighteen (18) groundwater monitoring wells were located as result of the DWR 1-mile radius search. No wells, including groundwater monitor wells, exist within the 2000-foot radius survey area. Again, groundwater monitor wells were not requested as part of this search.

GGTR also accessed the State Water Resources Control Board's GeoTracker Database to determine the status of Leaking Underground Fuel Tank sites with historical groundwater/vapor extraction wells. Only one site outside the 2,000-foot search radius area and located at 1127 Lincoln Avenue (@ Bay Street), historically maintained four (4) vapor extraction wells. The site, showing on both the ACPWA & DWR file search, was closed in November 2001. A copy of the GeoTracker LUFT Report and Regulatory History for this site is attached.

Sensitive Receptor Survey Results

The results of the receptor well survey are presented in the table below. Wells shown in bold type are located within the 2,000-foot radius survey area. Figure 1 shows the approximate location of each subject well, as described by its respective Well Record / Report number. Additional details and locational information for each subject well (shown in bold type) are presented in the attached spreadsheet provided by the ACPWA. A copy of each associated DWR Well Driller Report for Well Record Nos. 613, 4071, 106486, 106524, 140358 is attached. Well Driller Reports for the remaining Well Records tabulated below were not available from either the ACPWA or DWR..

Well Record/ Report No.	Distance from Site (Feet)	Well Diameter (Inches)	Total Well Depth (Feet)	Well Construction Material	Screened Interval (Feet)	Well Usage (D,I,M,In,Ex)	Well Installation Date
613	2400 (SE)	10	60	PVC Plastic	40-60	I	02/90
4062	1600 (W)	6	25	?	?	I	06/77
4065	3500 (SE)	4	70	?	?	I	07/77
4066	2800 (SE)	?	68	?	?	I	05/77
4067	3100 (SE)	4	80	?	?	I	08/77
4069	3200 (SE)	?	28	?	?	I	07/77
4070	3800 (SE)	5	60	?	?	I	10/88
4071	3200 (SE)	5	60	PVC Plastic	40-60	I	10/88
4072	2100 (SSE)	36	?	?	?	I	01/58
4073	1900 (SSE)	6	70	?	?	I	10/87
4074	1650 (SSW)	8	88	?	?	In	10/77
4075	3500 (SE)	4	70	?	?	I	07/77
4076	3500 (SE)	4	70	?	?	I	07/77
106486	3500 (WSW)	2	30	PVC Plastic	23-30	D	05/77
106524	4750 (W)	4	35	PVC Plastic	?	I	08/77
140358	3000 (WSW)	NA	120	NA	NA	C	06/76

Notes: D = Domestic Supply
I = Irrigation/Landscaping
M = Municipal
In = Industrial
Ex = Extraction/Vapor
C = Cathodic Protection
NA = Not Applicable

Based on results of the receptor well survey, only two irrigation wells and one industrial well reportedly exist within the 2000-foot survey radius of the subject property. Both irrigation wells (Well Record Nos. 4062 & 4073), reportedly exist approximately 1,600- and 1,900- feet west and south, respectively, from the site and are located regionally cross- and up-gradient of the property. One industrial well (Well Record No. 4074), exists approximately 1,650 feet south-southwest and cross-gradient of the site. Because of their distance and cross/up-gradient locations from the subject property, it appears unlikely that such wells will act as potential receptors or vertical conduits for potential contaminant migration from the subject property. The approximate location of each associated well is shown in Figure 1, and referenced by its specific Well Report Number.

One Cathodic Protection Well is located approximately 3,000 feet west-southwest and regionally lateral-gradient of the subject site. Although the deepest of the vicinity wells, the well is sealed with concrete to 95 fbg and does not appear to be a potential receptor based on its usage and

distant location cross-gradient of the site. Cathodic protection wells are typically installed to protect metallic objects (i.e., buried petroleum, natural gas, and water pipelines) in contact with the ground or subsurface environment from electrolytic corrosion.

Sensitive Surface Water and Land Usage

As mentioned above, the nearest surface water body is the Robert Crown Memorial State Beach Inlet of the San Francisco Bay, located approximately 0.5 mile southwest and lateral gradient of the subject property. The Alameda-Oakland Estuary is also located approximately 0.6 mile north-northeast of the site. Both surface water bodies, are ultimately contiguous and well outside the 2,000-foot radius survey area, and do not appear to act as a sensitive receptor from offsite migration of any impacted groundwater. According to Figure 1, and our July 13, 2006 Site Vicinity Reconnaissance, no apparent drainage creeks or springs are located within the 2,000-foot radius survey vicinity of the site.

Based on information from Google Maps, one children’s day care center and three elementary schools exist within the 2,000-foot radius survey area of the site. GGTR confirmed existing locations during the July 13, 2006 Site Reconnaissance. The table below provides information for each facility.

Facility Name	Description	Address (Alameda, CA)	Distance from Site (Feet)
Children’s Cottage Rising Star	Day Care Center	770 Santa Clara Ave.	550-600 (South)
Washington Elementary	Elementary School	825 Taylor Ave.	1100 (SE)
St. Barnabas School	Elementary School	1400 6 th St.	2000-2100 (SW)
Longfellow Elementary	Elementary School	500 Pacific Ave.	2000-2100 (WNW)

Each educational facility is located either up-and/or cross-gradient of the subject property and its underlying groundwater does not appear to be a potential receptor of any offsite contaminant migration. A copy of each applicable Google Map is attached.

Conclusions/Recommendation

Based on results of the Sensitive Receptor Survey and information provided on potential sensitive land usage in the vicinity of the site, it appears at this time, that no receptors exist within the designated survey radius area that would be affected by any offsite migration of impacted groundwater.

Based on the above, and on the findings and conclusions of the November 2005 soil boring and sampling activities, GGTR recommends that no further action be conducted at the site and that the ACHCSA complete the site closure review process.

Limitations and Certification

It should be understood that all environmental assessments are inherently limited in that conclusions are drawn and recommendations developed from information obtained from limited research and visual observations. Subsurface conditions change significantly with distance and time and therefore may differ from the conditions implied by subsurface investigation. It must be noted that no investigation can absolutely rule out the existence of any hazardous or petroleum substances at a given site. Existing hazardous materials and contaminants can escape detection using these methods. The work performed in conjunction with this assessment and the data developed are intended as a description of available information at the dates and location given. GGTR's professional services have been performed, with findings obtained and recommendations prepared in accordance with customary principles and practices in the field of environmental science, at the time of the assessment. This warranty is in lieu of all other warranties either expressed or implied. GGTR is not responsible for the accuracy of information reported by others or the independent conclusions, opinions or recommendations made by others based on the field exploration presented in this report. The findings contained in this report are based upon information contained in previous reports of corrective action activities performed at the subject property and based upon site conditions as they existed at the time of the investigation, and are subject to change. The scope of services conducted in execution of this phase of investigation may not be appropriate to satisfy the needs of other users and any use or reuse of this document and any of its information presented herein is at the sole risk of said user. The figures, drawings and plates presented in this report are only for the purposes of environmental assessment and no other use is recommended. No other third party may rely on this report, figures or plates for any other purpose.

Golden Gate Tank Removal, Inc.

Prepared By:

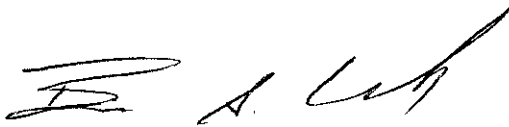

Brent A. Wheeler
Project Engineer

Reviewed By:

Sami Malaeb, P.E.
Environmental Director

Report Distribution

All reports that are prepared during the continuing work on this project will be sent to:

Alameda County Health Care Services
Environmental Health Services
Environmental Protection (LOP)
1131 Harbor Bay Parkway, Suite 250
Alameda, CA 94502-6577
Attention: Mr. Steven Plunkett

(1 PDF Copy Via GeoTracker)
(1 PDF Copy Via ACHCSA FTP)

Mr. Robert G Bond
865 Hallmark Drive
Redding, California, 96001

(2 Copies Bound)

87°47'32", 122°17'24"

37°47'32", 122°15'23"

LEGEND

- Concrete Supply
- Well
- Injection Well
- Industrial Well
- Cultural Protection
- Well
- Well Report No.
- Site Location
- Site Groundwater
- Gravel (110285)

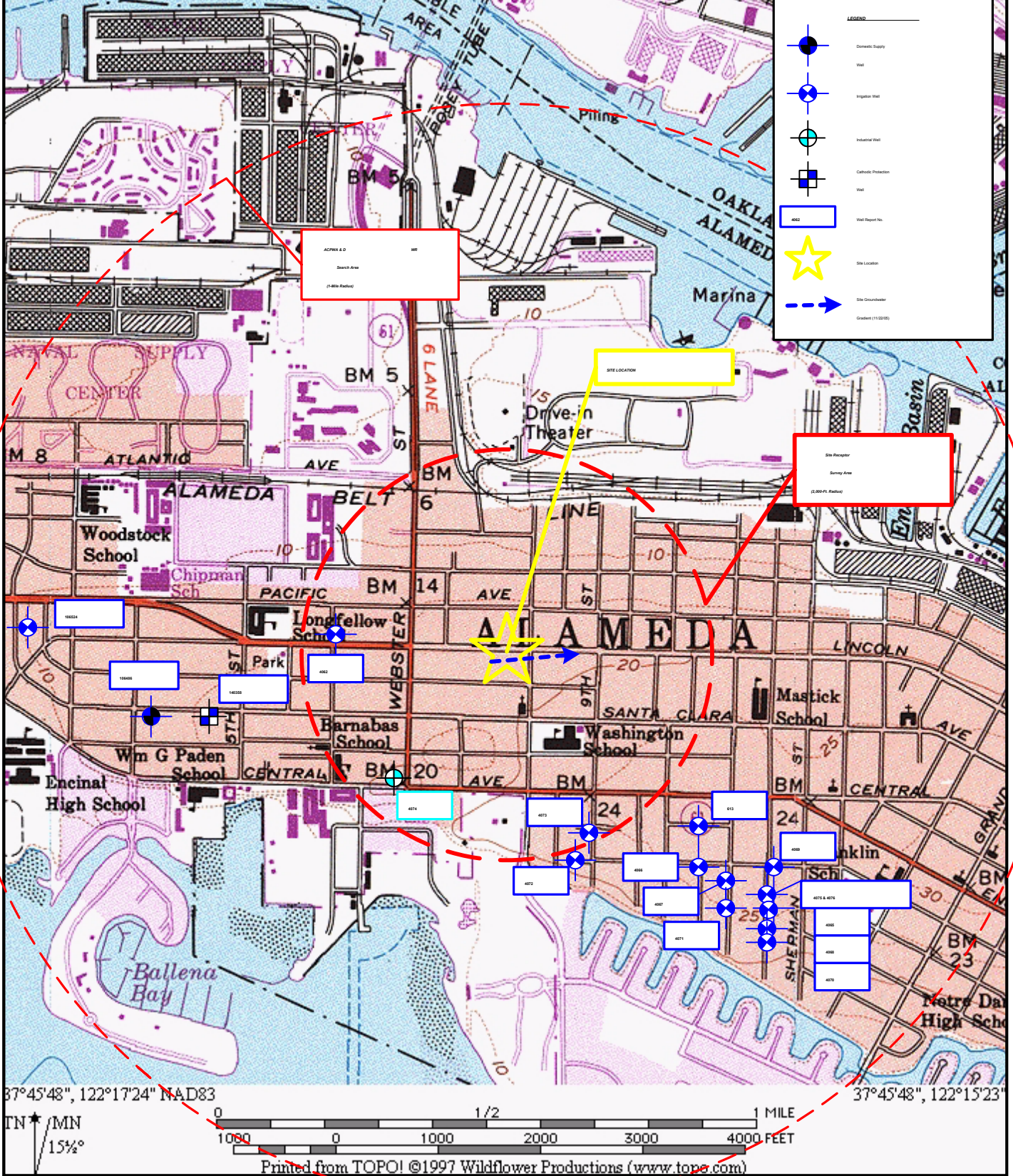

87°45'48", 122°17'24" NAD83

37°45'48", 122°15'23"

TN MN 15 1/2°

0 1000 2000 3000 4000 FEET

1/2 1 MILE

Printed from TOPO! ©1997 Wildflower Productions (www.topo.com)

GOLDEN GATE TANK REMOVAL, INC.
 255 Shipley Street
 San Francisco, CA 94107
 Ph (415) 512-1555 Fx (415) 512-0864





GGTR Project No. 8657

SENSITIVE RECEPTOR SURVEY AREA
 748 Lincoln Avenue
 Alameda, California

Revision By: baw/07-06

Figure 1

LEGEND

- B1**  Soil Boring Location (November 18, 2005)
-  UST Removal Soil/ Groundwater Sample (June 15, 2005)
-  Approximate Limit of UST Excavation
- PL**  Property Line

Notes: Figure 2 based upon GGTR's September 19 and November 22, 2005 Site Reconnaissance; Soil samples and borings shown are not to scale.

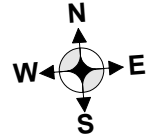

LINCOLN AVENUE

Centerline

Former Location of 1500-Gallon Heating Oil UST (Removed June 15, 2005)

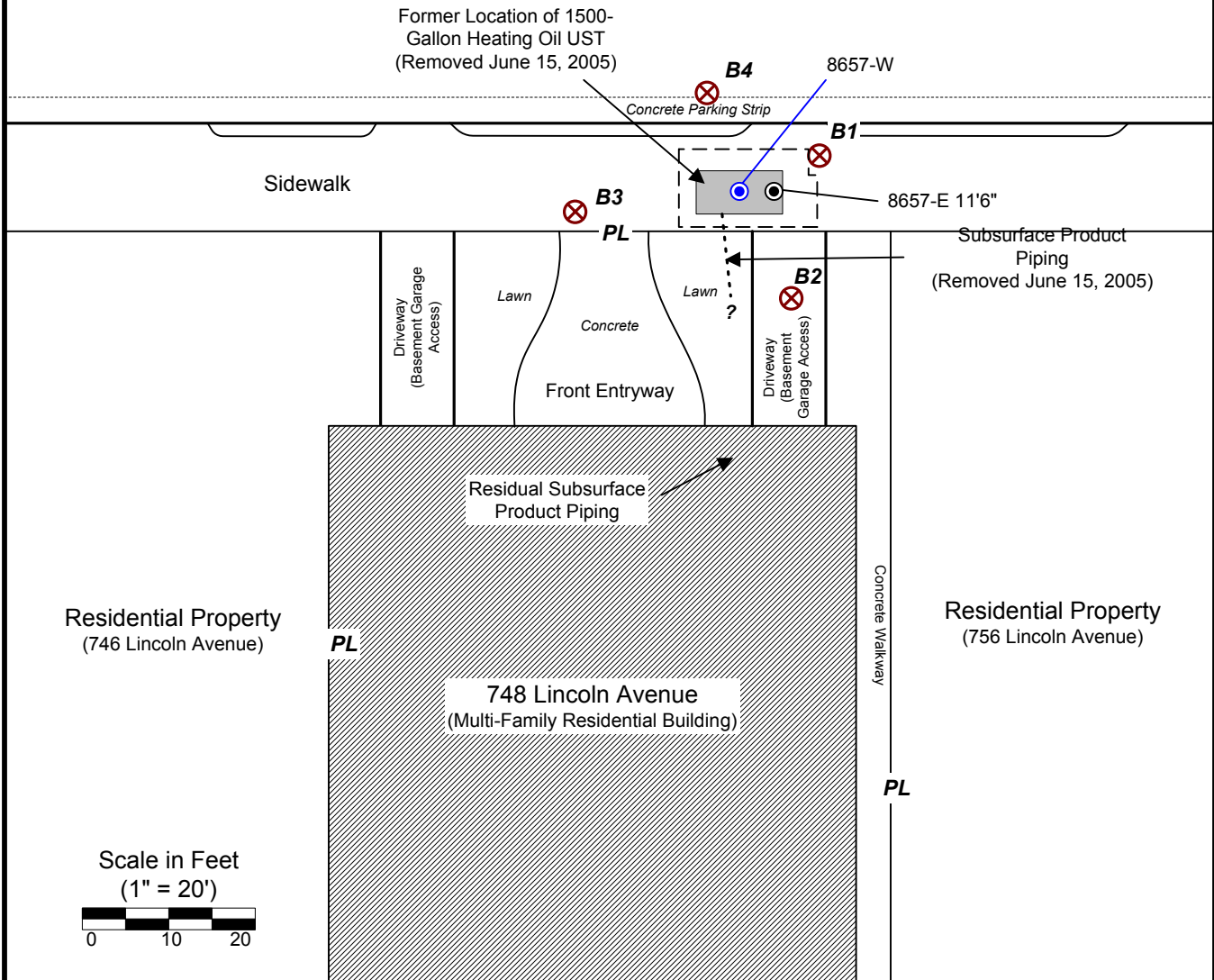

Residential Property (746 Lincoln Avenue)

Residential Property (756 Lincoln Avenue)

748 Lincoln Avenue
(Multi-Family Residential Building)

Scale in Feet
(1" = 20')



GOLDEN GATE TANK REMOVAL, INC.

255 Shipley Street
San Francisco, CA 94107
Ph (415) 512-1555 Fx (415) 512-1555

SITE PLAN

748 Lincoln Avenue
Alameda, California

ATTACHMENTS

ACHCSA April 12, 2006 Correspondence
DWR and ACPWA Well Report Release Agreement
GeoTracker LUST Report & Regulatory History (1127 Lincoln Avenue)
ACPWA Spreadsheet & Well Legend
Well Driller Reports
Google Maps

ALAMEDA COUNTY
HEALTH CARE SERVICES

AGENCY
DAVID J. KEARS, Agency Director



ENVIRONMENTAL HEALTH SERVICES
ENVIRONMENTAL PROTECTION
1131 Harbor Bay Parkway, Suite 250
Alameda, CA 94502-6577
(510) 567-6700
FAX (510) 337-9335

April 12, 2006

Mr. Robert Bond
865 Hallmark Drive
Redding, CA 96001

Dear Mr. Bond:

Subject: Fuel Leak Case No. RO0002880, Monterey Apartments, 748 Lincoln Avenue, Alameda, CA

Alameda County Environmental Health (ACEH) staff has recently reviewed the case file for the site and the report titled, "Report of Preliminary Site Characterization", dated January 25, 2006, and prepared by Golden Gate Tank Removal Inc. We are currently reviewing this site for closure, however, we need additional data to complete our review. Therefore, we request that you address the following technical comments, perform the proposed work, and send us the reports requested below.

TECHNICAL COMMENTS

1. Preferential Pathway Sensitive Receptor Survey –

- a. The purpose of the well survey is to present a detailed review of municipal, irrigation and domestic water supply wells in the vicinity of 748 Lincoln Avenue, Alameda, CA. This survey is an essential component of the site closure process. In an email communication to ACEH, Golden Gate Tank Removal mentioned a well survey conducted for a nearby service station (Shell Station #13-5032), which indicates the presence of two irrigation wells and one well of unknown use. Unfortunately, the survey performed for this Shell Station cannot be used for the subject site, as it was not within 2,000 feet of the subject site. We request that your survey be performed within a 2,000 foot radius of the subject site and should include both California State Department of Water Resources and Alameda County Public Works Agency (Water Resources) well data.
- b. In addition, the sensitive receptor survey will identify all surface waters in the vicinity of 748 Lincoln Avenue, Alameda, CA.

TECHNICAL REPORT REQUEST

Please submit technical reports to Alameda County Environmental Health (Attention: Mr. Steven Plunkett), according to the following schedule:

- **May 10, 2006 - Completed Sensitive Receptor Survey**

Mr. Robert G. Bond

4/13/06

Page 2

These reports are being requested pursuant to California Health and Safety Code Section 25296.10. 23 CCR Sections 2652 through 2654, and 2721 through 2728 outline the responsibilities of a responsible party in response to an unauthorized release from a petroleum UST system, and require your compliance with this request.

ELECTRONIC SUBMITTAL OF REPORTS

The Alameda County Environmental Cleanup Oversight Programs (LOP and SLIC) require submission of all reports in electronic form to the county's ftp site. Paper copies of reports will no longer be accepted. The electronic copy replaces the paper copy and will be used for all public information requests, regulatory review, and compliance/enforcement activities. Instructions for submission of electronic documents to the Alameda County Environmental Cleanup Oversight Program ftp site are provided on the attached "Electronic Report Upload (ftp) Instructions." Please do not submit reports as attachments to electronic mail.

Submission of reports to the Alameda County ftp site is an addition to existing requirements for electronic submittal of information to the State Water Resources Control Board (SWRCB) Geotracker website. Submission of reports to the Geotracker website does not fulfill the requirement to submit documents to the Alameda County ftp site. In September 2004, the SWRCB adopted regulations that require electronic submittal of information for groundwater cleanup programs. For several years, responsible parties for cleanup of leaks from underground storage tanks (USTs) have been required to submit groundwater analytical data, surveyed locations of monitor wells, and other data to the Geotracker database over the Internet. Beginning July 1, 2005, electronic submittal of a complete copy of all necessary reports was required in Geotracker (in PDF format). Please visit the SWRCB website for more information on these requirements (http://www.swrcb.ca.gov/ust/cleanup/electronic_reporting).

In order to facilitate electronic correspondence, we request that you provide up to date electronic mail addresses for all responsible and interested parties. Please provide current electronic mail addresses and notify us of future changes to electronic mail addresses by sending an electronic mail message to me at steven.plunkett@acgov.org

PERJURY STATEMENT

All work plans, technical reports, or technical documents submitted to ACEH must be accompanied by a cover letter from the responsible party that states, at a minimum, the following: "I declare, under penalty of perjury, that the information and/or recommendations contained in the attached document or report is true and correct to the best of my knowledge." This letter must be signed by an officer or legally authorized representative of your company. Please include a cover letter satisfying these requirements with all future reports and technical documents submitted for this fuel leak case.

PROFESSIONAL CERTIFICATION & CONCLUSIONS/RECOMMENDATIONS

The California Business and Professions Code (Sections 6735, 6835, and 7835.1) requires that work plans and technical or implementation reports containing geologic or engineering evaluations and/or judgments be performed under the direction of an appropriately registered or certified professional. For your submittal to be considered a valid technical report, you are to present site specific data, data interpretations, and recommendations prepared by an

Mr. Robert G. Bond

4/13/06

Page 3

appropriately licensed professional and include the professional registration stamp, signature, and statement of professional certification. Please ensure all that all technical reports submitted for this fuel leak case meet this requirement.

UNDERGROUND STORAGE TANK CLEANUP FUND

Please note that delays in investigation, later reports, or enforcement actions may result in your becoming ineligible to receive grant money from the state's Underground Storage Tank Cleanup Fund (Senate Bill 2004) to reimburse you for the cost of cleanup.

AGENCY OVERSIGHT

If it appears as though significant delays are occurring or reports are not submitted as requested, we will consider referring your case to the Regional Board or other appropriate agency, including the County District Attorney, for possible enforcement actions. California Health and Safety Code, Section 25299.76 authorizes enforcement including administrative action or monetary penalties of up to \$10,000 per day for each day of violation.

If you have any questions, please call me at (510) 383-1767

Sincerely,

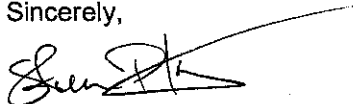

Steven Plunkett
Hazardous Materials Specialist

cc: Mr. Mark Youngkin, Golden Gate Tank Removal, Inc.
Donna Drogos, ACEH
Steven Plunkett, ACEH
File

DEPARTMENT OF WATER RESOURCES

CENTRAL DISTRICT
3251 S Street
Sacramento, CA 95816
(916) 227-7632
(916) 227-7600(Fax)

NORTHERN DISTRICT
2440 Main Street
Red Bluff, CA 96080
(530) 529-7300
(530) 529-7322 (Fax)

SAN JOAQUIN DISTRICT
3374 East Shields Avenue
Fresno, CA 93726
(559) 230-3300
(559) 230-3301 (Fax)

SOUTHERN DISTRICT
770 Fairmont Avenue
Glendale, CA 91203
(818) 543-4600
(818) 543-4604 (Fax)

WELL COMPLETION REPORT RELEASE AGREEMENT-AGENCY
(Government and Regulatory Agencies and their Authorized Agents)

Project/Contract No. 3657 County - ALAMEDA
743 LINCOLN AVENUE, ALAMEDA

Township, Range, and Section _____ Radius - 2,000'

(Must include entire study area and a map that shows the area of interest.)

Under California Water Code Section 13752, the agency named below requests permission from Department of Water Resources to inspect or copy, or for our authorized agent named below to inspect or copy, Well Completion Reports filed pursuant to Section 13751 to (check one):

Make a study, or,

Perform an environmental cleanup study associated with an unauthorized release of a contaminant within a distance of 2 miles.

In accordance with Section 13752, information obtained from these reports shall be kept confidential and shall not be disseminated, published, or made available for inspection by the public without written authorization from the owner(s) of the well(s). The information shall be used only for the purpose of conducting the study. Copies obtained shall be stamped **CONFIDENTIAL** and shall be kept in a restricted file accessible only to agency staff or the authorized agent.

GOLDEN GATE TANK REMOVAL
Authorized Agent

255 SHERLEY ST.
Address

SAN FRANCISCO, CA 94107
City, State, and Zip Code

Signature [Signature]

Title PROJECT MANAGER

Telephone (415) 512-1535

Fax (415) 312-0964

Date 4/24/04

E-mail BRENT@GGTR.COM

ALAMEDA COUNTY HEALTH CARE
Government or Regulatory Agency

1131 HARBOR BAY PARKWAY, STE 250
Address

ALAMEDA, CA 94502-6577
City, State, and Zip Code

Signature [Signature]

Title HARBOROUS MATERIALS SPEC.

Telephone (510) 383-1767

Fax (510) 337-9335

Date 4/25/06

E-mail STEVEN.FLUNKETT@ACSOV.ORG

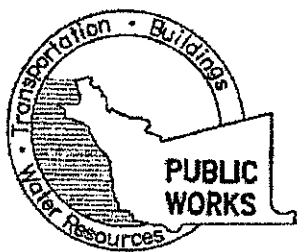

**COUNTY OF ALAMEDA
PUBLIC WORKS AGENCY
WATER RESOURCES SECTION**
399 Elmhurst Street, Hayward, CA 94544-1395
James Yoo PH: (510) 670-6633 FAX: (510) 782-1939
FOR GENERAL DRILLING PERMIT INFO:
www.acgov.org/pwa/wells

WELL COMPLETION REPORT RELEASE AGREEMENT—AGENCY
(Government and Regulatory Agencies and their Authorized Agents)

Project No/ Site Address. 8657 743 LINCOLN AVENUE City ALAMEDA

Township, Range, and Section _____ Radius 2,000'
(Must include entire study area and a map that shows the area of interest.)

Under California Water Code Section 13752, the agency named below requests permission from Department of Water Resources to inspect or copy, or for our authorized agent named below to inspect or copy, Well Completion Reports filed pursuant to Section 13751 to (check one):

- Make a study, or,
- Perform an environmental cleanup study associated with an unauthorized release of a contaminant within a distance of 2 miles.

In accordance with Section 13752, information obtained from these reports shall be kept confidential and shall not be disseminated, published, or made available for inspection by the public without written authorization from the owner(s) of the well(s). The information shall be used only for the purpose of conducting the study. Copies obtained shall be stamped **CONFIDENTIAL** and shall be kept in a restricted file accessible only to agency staff or the authorized agent.

GOLDEN GATE TANK REMOVAL
Authorized Agent

255 SHIPLEY ST.
Address

SAN FRANCISCO, CA 94107
City, State, and Zip Code

[Signature]
Signature

PROJECT MANAGER
Title

Telephone () 415 512-1555

Fax () 415-512-0964

4/24/06
Date

BRENT@GBTR.COM
E-mail

ALAMEDA COUNTY HEALTH CARE
Government or Regulatory Agency

1131 HARBOUR BAY PARKWAY, STE 250
Address

ALAMEDA, CA 94502-6577
City, State, and Zip Code

[Signature]
Signature

HAZARDOUS MATERIALS SPECIALIST.
Title

Telephone () 510-383-1747

Fax () 510-337-9335

4/25/06
Date

STEVEN.PUNKETT@ACGOV.ORG
E-mail

LEAKING UNDERGROUND FUEL TANK REPORT**BAY ST SVC STATION (ALAMEDA)**

1127 LINCOLN AVE
ALAMEDA, CA 94501

CASE STATUS: CLOSED

[SHOW THIS SITE ON MAP](#)

[RETURN TO REPORT MAIN MENU](#)

REGIONAL BOARD - CASE #: 01-0902

SAN FRANCISCO BAY RWQCB (REGION 2)

CONTACT: - (510) 622-2300

LOCAL AGENCY (LEAD AGENCY) - CASE #: 3566

ALAMEDA COUNTY LOP - (AG)

RB RECORD FILE #:

CHOOSE A REPORT TO VIEW**SITE INFO:**

- [REGULATORY HISTORY](#)
- [LOCATIONAL INFORMATION](#)
- [ANALYTICAL DATA](#)
- [ELECTRONIC ANALYTICAL DATA](#)
- [DEPTH TO WATER INFORMATION](#)
- [RISK MANAGEMENT](#)
- [LAND USE CONTROLS](#)

LEAK INFO:

- [DETAILED RELEASE INFORMATION](#)
- [REMEDIATION ON SITE](#)

ADDITIONAL INFO:

- 0 FIELD POINTS FOR THIS SITE
- 0 PUBLIC WATER WELL(S) ESTIMATED TO BE NEARBY THIS SITE

ELECTRONIC SUBMITTALS:

- ANALYTICAL DATA (NONE AVAILABLE)
- LOCATION DATA (NONE AVAILABLE)
- ELEVATION DATA (NONE AVAILABLE)
- DEPTH TO WATER DATA (NONE AVAILABLE)
- GEO MAP DATA (NONE AVAILABLE)
- GEO REPORT / SITE DOCUMENTS (NONE AVAILABLE)
- GEO BORE DATA (NONE AVAILABLE)

CUF REIMBURSEMENT AMOUNT:

\$24,132

[Geotracker Home](#) | [Site/Facility Finder](#) | [Case Finder](#) | [MTBE/Case Reports](#)

REGULATORY HISTORY**BAY ST SVC STATION (ALAMEDA)**

1127 LINCOLN AVE
ALAMEDA , CA 94501

CASE STATUS: CLOSED

[SHOW THIS SITE ON MAP](#)

[RETURN TO REPORT MAIN MENU](#)

REGIONAL BOARD - CASE #: 01-0902

SAN FRANCISCO BAY RWQCB (REGION 2)

CONTACT: - (510) 622-2300

LOCAL AGENCY (LEAD AGENCY) - CASE #: 3566

ALAMEDA COUNTY LOP - (AG)

RB RECORD FILE #:

REGULATORY HISTORY

BEGIN DATE	STATUS
9/22/1989	* Leak Discovery
9/22/1989	* Leak Reported
9/22/1989	* Leak Stopped
2/22/1990	* System Entry
3/14/1991	* Site Assessment
5/12/1992	* Site Assessment
1/25/2001	Verification Monitoring
7/25/2001	* Regulatory Review
11/26/2001	Case Closed

[Geotracker Home](#) | [Site/Facility Finder](#) | [Case Finder](#) | [MTBE/Case Reports](#)

Permit	Tr	Section	Address	Locncty	Owner	Update	Xcoord	Ycoord	Matchleve	Tsrqg	Rec_code	Phone	City	Drilldate	Elevation	Totaldepth	Waterdept	Diameter	Use
	2S/4W	11C	1601 Webster St.	Alameda	Shell Oil Company	7/22/1993	1.22E+08	37775665	1	2S/4W 11C	0	0	ALA	Oct-92	0	13	10	0	BOR
	2S/4W	11C	1900 Webster St	Alameda	Taco Bell U-14	9/23/1992	1.22E+08	37778429	1	2S/4W 11C	7970	0	ALA	5/92	0	20	16	0	BOR*
	2S/4W	11C	1916 WEBSTER ST	Alameda	ALAMEDA HOUSING AUTH	10/6/1986	1.22E+08	37778733	0	2S/4W 11C	4058	0	ALA	Aug-86	0	12	5	0	BOR
	2S/4W	11C 1	1916 WEBSTER ST	Alameda	ALAMEDA HOUSING AUTH	10/6/1986	1.22E+08	37778733	0	2S/4W 11C	4059	0	ALA	Aug-86	0	14	4	2	MON
	2S/4W	11C 2	1916 WEBSTER ST	Alameda	ALAMEDA HOUSING AUTH	10/6/1986	1.22E+08	37778733	0	2S/4W 11C	4060	0	ALA	Aug-86	0	10	5	2	MON
	2S/4W	11C 3	1701 Webster Street	Alameda	Bernita Leskowski	7/9/1990	1.22E+08	37778735	0	2S/4W 11C	489	0	ALA	Nov-89	0	19	8	2	MON
	2S/4W	11C 4	1701 Webster Street	Alameda	Bernita Leskowski	7/9/1990	1.22E+08	37778735	0	2S/4W 11C	490	0	ALA	Nov-89	0	19	8	2	MON
	2S/4W	11C 5	1701 Webster Street	Alameda	Bernita Leskowski	7/9/1990	1.22E+08	37778735	0	2S/4W 11C	491	0	ALA	Nov-89	0	19	8	2	MON
	2S/4W	11C 6	701 Atlantic Ave	Alameda	Alameda Housing Authority	3/9/1992	1.22E+08	37779526	1	2S/4W 11C	7336	0	ALA	7/91	0	15	4	2	MON
	2S/4W	11C 7	1916 Webster St.	Alameda	Alameda Housing Auth.MW-3	9/30/1992	1.22E+08	37778733	1	2S/4W 11C	8173	0	ALA	7/91	6	16	4	2	MON
	2S/4W	11C 8	1900 Webster St.	Alameda	Dolan Foster Enterprises	6/16/1993	1.22E+08	37778656	1	2S/4W 11C	0	0	ALA	8/92	0	18	0	4	MON
	2S/4W	11C 9	1900 Webster St.	Alameda	Dolan Foster Enterprises	6/16/1993	1.22E+08	37778656	1	2S/4W 11C	0	0	ALA	8/92	0	18	0	4	MON
	2S/4W	11C 10	1900 Webster St.	Alameda	Dolan Foster Enterprises	6/16/1993	1.22E+08	37778656	1	2S/4W 11C	0	0	ALA	8/92	0	18	0	4	MON
	2S/4W	11C 11	1900 Webster St.	Alameda	Dolan Foster Enterprises	6/16/1993	1.22E+08	37778656	1	2S/4W 11C	0	0	ALA	8/92	0	19	0	4	MON
	2S/4W	11C 12	1601 Webster St.	Alameda	Shell Oil Company	6/17/1993	1.22E+08	37775662	1	2S/4W 11C	0	0	ALA	2/93	0	20	6	4	MON
	2S/4W	11C 13	1716 Webster St.	Alameda	BP Oil Co. #11104	6/18/1993	1.22E+08	37776819	1	2S/4W 11C	0	0	ALA	7/92	0	17	9	2	MON
	2S/4W	11C 14	1716 Webster St.	Alameda	BP Oil Co. #11104	6/18/1993	1.22E+08	37776819	1	2S/4W 11C	0	0	ALA	7/92	0	17	9	2	MON
	2S/4W	11C 15	1716 Webster St.	Alameda	BP Oil Co. #11104	6/18/1993	1.22E+08	37776819	1	2S/4W 11C	0	0	ALA	7/92	0	17	9	2	MON
	2S/4W	11C 16	1802 Webster St.	Alameda	Chevron B-7	7/13/1993	1.22E+08	37777674	1	2S/4W 11C	0	0	ALA	3/93	0	16	5	2	MON
	2S/4W	11C 17	1802 Webster St.	Alameda	Chevron B-8	7/13/1993	1.22E+08	37777674	1	2S/4W 11C	0	0	ALA	3/93	0	16	5	2	MON
	2S/4W	11C 18	1802 Webster St.	Alameda	Chevron B-9	7/13/1993	1.22E+08	37777674	1	2S/4W 11C	0	0	ALA	3/93	0	16	5	2	MON
	2S/4W	11C 19	1716 Webster St.	Alameda	BP Oil Co. #11104 MW-4	7/15/1993	1.22E+08	37776819	1	2S/4W 11C	0	0	ALA	3/93	0	15	5	2	MON
	2S/4W	11C 20	1716 Webster St.	Alameda	BP Oil Co. #11104 MW-5	7/15/1993	1.22E+08	37776819	1	2S/4W 11C	0	0	ALA	3/93	0	15	5	2	MON
	2S/4W	11C 21	1716 Webster St.	Alameda	BP Oil Company	8/19/1997	1.22E+08	37776834	1	2S/4W 11C	0	0	ALA	8/93	0	23	5	6	MON
	2S/4W	11C 22	1916 Webster St	Alameda	Alameda Housing	9/30/1997	1.22E+08	37778733	1	2S/4W 11C	0	0	ALA	9/94	0	14	5	4	MON
	2S/4W	11C 23	1916 Webster St	Alameda	Alameda Housing	9/30/1997	1.22E+08	37778733	1	2S/4W 11C	0	0	ALA	9/94	0	14	0	4	MON
	2S/4W	11C 24	1916 Webster St	Alameda	Alameda Housing	9/30/1997	1.22E+08	37778733	1	2S/4W 11C	0	0	ALA	9/94	0	14	0	4	MON
	2S/4W	11C 25	1628 Webster St	Alameda	Mrs Jean Ratto Larkin	9/17/1997	1.22E+08	37775885	1	2S/4W 11C	0	0	ALA	6/95	0	15	6	2	MON
	2S/4W	11C 26	1628 Webster St	Alameda	Mrs Jean Ratto Larkin	9/17/1997	1.22E+08	37775885	1	2S/4W 11C	0	0	ALA	6/95	0	15	6	2	MON
	2S/4W	11C 27	1628 Webster St	Alameda	Mrs Jean Ratto Larkin	9/17/1997	1.22E+08	37775885	1	2S/4W 11C	0	0	ALA	6/95	0	15	6	2	MON
95716	2S/4W	11C 28	1802 Webster St	Alameda	Chevron USA	2/4/1998	1.22E+08	37777660	1	2S/4W 11C	0	0	ALA	Oct-95	0	17	7	2	MON
95716	2S/4W	11C 29	1802 Webster St	Alameda	Chevron USA	2/4/1998	1.22E+08	37777660	1	2S/4W 11C	0	0	ALA	Oct-95	0	15	6	2	MON
95716	2S/4W	11C 30	1802 Webster St	Alameda	Chevron USA	2/4/1998	1.22E+08	37777660	1	2S/4W 11C	0	0	ALA	Oct-95	0	16	6	2	MON
95718	2S/4W	11C 31	1802 Webster St	Alameda	Chevron USA	2/4/1998	1.22E+08	37777660	1	2S/4W 11C	0	0	ALA	Oct-95	0	15	0	2	MON
	2S/4W	11D 1	635 PACIFIC ST	Alameda	CITY OF ALAMEDA (F/H #2)	7/22/1986	1.22E+08	37776700	2	2S/4W 11C	4061	5224100	ALA	6/86	0	23	5	2	MON
	2S/4W	11D 2	635 Pacific Ave.	Alameda	Fire Station #2 MW-2	7/28/1993	1.22E+08	37776700	1	2S/4W 11C	0	0	ALA	8/92	0	18	0	2	MON
	2S/4W	11D 3	635 Pacific Ave.	Alameda	Fire Station #2 MW-3	7/28/1993	1.22E+08	37776700	1	2S/4W 11C	0	0	ALA	8/92	0	18	0	2	MON
	2S/4W	11D 4	635 Pacific Ave.	Alameda	Fire Station #2 MW-4	7/28/1993	1.22E+08	37776700	1	2S/4W 11C	0	0	ALA	8/92	0	20	0	2	MON
	2S/4W	11E 1	1614 6TH ST	Alameda	DANIEL ROBINSON	8/2/1984	1.22E+08	37775859	0	2S/4W 11E	4062	0	ALA	6/77	0	25	8	6	IRR
	2S/4W	11F 1	1601 WEBSTER & LINCOLN	Alameda	SHELL SERVICE STATION	2/23/1998	1.22E+08	37775500	1	2S/4W 11F	4063	0	ALA	9/87	0	20	7	3	MON
	2S/4W	11F 2	1601 Webster Street	Alameda	Shell Oil Company	5/30/1990	1.22E+08	37775665	0	2S/4W 11F	49	0	ALA	4/90	14	21	8	4	MON
	2S/4W	11F 3	1601 Webster Street	Alameda	Shell Oil Company	5/30/1990	1.22E+08	37775665	0	2S/4W 11F	50	0	ALA	4/90	14	20	8	4	MON
	2S/4W	11F 4	1435 Webster St.	Alameda	John Ferrar MW-1	7/15/1993	1.22E+08	37772858	1	2S/4W 11F	0	0	ALA	1/93	0	24	0	2	MON
	2S/4W	11F 5	1435 Webster St.	Alameda	John Ferrar MW-2	7/15/1993	1.22E+08	37772858	1	2S/4W 11F	0	0	ALA	1/93	0	24	0	2	MON
	2S/4W	11F 6	1435 Webster St.	Alameda	John Ferrar MW-3	7/15/1993	1.22E+08	37772858	1	2S/4W 11F	0	0	ALA	1/93	0	24	0	2	MON
	2S/4W	11F 7	1528 Webster St	Alameda	Bank of America	7/23/1997	1.22E+08	37774641	1	2S/4W 11F	0	0	ALA	3/94	0	20	7	2	MON
	2S/4W	11F 8	1528 Webster St	Alameda	Bank of America	7/23/1997	1.22E+08	37774641	1	2S/4W 11F	0	0	ALA	3/94	0	20	7	2	MON
	2S/4W	11F 9	1528 Webster St	Alameda	Bank of America	7/23/1997	1.22E+08	37774641	1	2S/4W 11F	0	0	ALA	3/94	0	20	6	2	MON
	2S/4W	11F 10	1528 Webster St	Alameda	Bank of America	7/24/1997	1.22E+08	37774641	1	2S/4W 11F	0	0	ALA	Oct-94	0	20	8	2	MON
	2S/4W	11F 11	1528 Webster St	Alameda	Bank of America	7/24/1997	1.22E+08	37774641	1	2S/4W 11F	0	0	ALA	Oct-94	0	20	8	2	MON
	2S/4W	11G	901 Lincoln Avenue	Alameda	Steve Chrissanthos	7/22/1993	1.22E+08	37775416	1	2S/4W 11C	0	0	ALA	Dec-92	0	18	14	0	BOR
	2S/4W	11G 1	901 Lincoln Avenue	Alameda	Steve Chrissanthos MW-1	4/30/1993	1.22E+08	37775414	1	2S/4W 11C	0	0	ALA	Dec-92	0	15	9	2	MON
	2S/4W	11G 2	901 Lincoln Avenue	Alameda	Steve Chrissanthos MW-2	4/30/1993	1.22E+08	37775414	1	2S/4W 11C	0	0	ALA	Dec-92	0	18	14	2	MON
	2S/4W	11G 3	901 Lincoln Avenue	Alameda	Steve Chrissanthos MW-3	4/30/1993	1.22E+08	37775414	1	2S/4W 11C	0	0	ALA	Dec-92	0	18	14	2	MON
93544	2S/4W	11G 4	901 Lincoln Ave	Alameda	Steve Chrissanthos	7/30/1998	1.22E+08	37775390	1	2S/4W 11C	0	0	ALA	Oct-93	0	20	11	2	MON
	2S/4W	11H	1127 Lincoln Ave	Alameda	Former Texaco Station	8/2/1991	1.22E+08	37775200	0	2S/4W 11F	1921	0	ALA	3/91	0	9	10	2	EXT
	2S/4W	11H 1	SANTA CLARA ST	Alameda	PG&E	8/2/1984	1.22E+08	37775800	2	2S/4W 11F	4064	0	ALA	4/76	0	120	0	0	CAT
	2S/4W	11H 2	1127 Lincoln Ave	Alameda	Former Texaco Station	8/2/1991	1.22E+08	37775200	0	2S/4W 11F	1913	0	ALA	2/91	0	14	7	2	MON
	2S/4W	11H 3	1127 Lincoln Ave	Alameda	Former Texaco Station	8/2/1991	1.22E+08	37775200	0	2S/4W 11F	1914	0	ALA	2/91	0	14	7	2	MON
	2S/4W	11H 4	1127 Lincoln Ave	Alameda	Former Texaco Station	8/2/1991	1.22E+08	37775200	0	2S/4W 11F	1915	0	ALA	3/91	0	20	10	4	MON
	2S/4W	11H 5	1127 Lincoln Ave	Alameda	Former Texaco Station	8/2/1991	1.22E+08	37775200	0	2S/4W 11F	1916	0	ALA	3/91	0	20	8	4	MON
	2S/4W	11H 6	1127 Lincoln Ave	Alameda	Former Texaco Station	8/2/1991	1.22E+08	37775200	0	2S/4W 11F	1917	0	ALA	3/91	0	20	7	4	MON
	2S/4W	11H 7	1127 Lincoln Ave	Alameda	Former Texaco Station	8/2/1991	1.22E+08	37775200	0	2S/4W 11F	1918	0	ALA	3/91	0	8	9	2	EXT
	2S/4W	11H 8	1127 Lincoln Ave	Alameda	Former Texaco Station	8/2/1991	1.22E+08	37775200	0	2S/4W 11F	1919	0	ALA	3/91	0	9	9	2	EXT
	2S/4W	11H 9	1127 Lincoln Ave	Alameda	Former Texaco Station	8/2/1991	1.22E+08	37775200	0	2S/4W 11F	1920	0	ALA	3/91	0	9	10	2	EXT
	2S/4W	11H 10	1127 Lincoln Ave	Alameda	Former Texaco Stat. MW8	6/17/1993	1.22E+08	37775198	1	2S/4W 11F	0	0	ALA	6/92	0	20	13	4	MON

2S/4W	11H11	1127 Lincoln Ave	Alameda	Former Texaco Stat. MW7	6/17/1993	1.22E+08	37775198	1	2S/4W 11H	0	0	ALA	6/92	0	20	10	4	MON
2S/4W	11H12	1127 Lincoln Ave	Alameda	Former Texaco Stat. MW6	6/17/1993	1.22E+08	37775198	1	2S/4W 11H	0	0	ALA	6/92	0	21	11	4	MON
2S/4W	11H13	1127 Lincoln Ave	Alameda	Former Texaco Stat. MW5	6/17/1993	1.22E+08	37775198	1	2S/4W 11H	0	0	ALA	6/92	0	20	12	4	MON
2S/4W	11H14	1127 Lincoln Ave	Alameda	Former Texaco Stat. MW4	6/17/1993	1.22E+08	37775198	1	2S/4W 11H	0	0	ALA	6/92	0	20	10	4	MON
2S/4W	11H15	1127 Lincoln Av	Alameda	Texaco USA	7/16/1997	1.22E+08	37775227	1	2S/4W 11H	0	0	ALA	5/95	0	16	6	4	MON
2S/4W	11H16	1127 Lincoln Av	Alameda	Texaco USA	7/16/1997	1.22E+08	37775227	1	2S/4W 11H	0	0	ALA	5/95	0	17	5	4	MON
2S/4W	11H17	1127 Lincoln Av	Alameda	Texaco USA	7/16/1997	1.22E+08	37775227	1	2S/4W 11H	0	0	ALA	5/95	0	17	3	4	MON
2S/4W	11J 1	1205 BAY ST	Alameda	W.C. LYONS	8/2/1984	1.22E+08	37767935	0	2S/4W 11J	4065	0	ALA	7/77	0	70	14	4	IRR
2S/4W	11J 2	1036 SAN ANTONIO AVE	Alameda	GROVER CHESSMORE	8/2/1984	1.22E+08	37769400	0	2S/4W 11J	4066	0	ALA	5/77	0	68	15	0	IRR
2S/4W	11J 3	1236 ST CHARLES	Alameda	FRANK WEEDER	8/2/1984	1.22E+08	37768612	2	2S/4W 11J	4067	0	ALA	8/77	0	80	10	4	IRR
2S/4W	11J 4	1224 BAY ST	Alameda	RICHARD BARTALIM	8/2/1984	1.22E+08	37768153	0	2S/4W 11J	4068	0	ALA	8/77	0	75	14	4	IRR
2S/4W	11J 5	1200 SAN ANTONIO AVE	Alameda	GLORIA JACKSON	8/2/1984	1.22E+08	37769400	0	2S/4W 11J	4069	0	ALA	7/77	0	28	14	0	IRR
2S/4W	11J 6	1251 BAY ST.	Alameda	JAMES MR.	6/15/1989	1.22E+08	37768479	0	2S/4W 11J	4070	0	ALA	Oct-88	0	60	10	5	IRR
2S/4W	11J 7	1261 ST. CHAS. AV.	Alameda	RISLING MR.	6/15/1989	1.22E+08	37770237	9	2S/4W 11J	4071	0	ALA	Oct-88	0	60	10	5	IRR
2S/4W	11J 8	1040 Fair Oaks Drive	Alameda	Ashley Jones	7/16/1990	1.22E+08	37770237	9	2S/4W 11J	613	0	ALA	2/90	0	60	10	5	IRR
2S/4W	11K 1	801 SAN ANTONIO AVE	Alameda	MRS. VAILE	8/2/1984	1.22E+08	37769783	0	2S/4W 11K	4072	0	ALA	1/58	0	0	8	36	IRR
2S/4W	11K 2	920 CENTENNIAL AVE	Alameda	LAWRENCE PICETTI	2/24/1988	1.22E+08	37770400	0	2S/4W 11K	4073	0	ALA	Oct-87	0	70	18	6	IRR
2S/4W	11K 3	905 Central Ave	Alameda	Watson Butcher	8/14/1992	1.22E+08	37771830	1	2S/4W 11K	7721	0	ALA	8/91	0	75	15	0	MON
2S/4W	11M 1	645 CENTRAL	Alameda	PAUL MARRETT	8/2/1984	1.22E+08	37771800	2	2S/4W 11M	4074	0	ALA	Oct-77	0	88	17	8	IND
2S/4W	11M 2	620 Central Av	Alameda	General Services Administr	7/23/1997	1.22E+08	37771636	1	2S/4W 11M	0	0	ALA	1/94	0	14	5	2	MON
2S/4W	11M 3	620 Central Av	Alameda	General Services Administr	7/23/1997	1.22E+08	37771636	1	2S/4W 11M	0	0	ALA	1/94	0	14	5	2	MON
2S/4W	11M 4	620 Central Av	Alameda	General Services Administr	7/23/1997	1.22E+08	37771636	1	2S/4W 11M	0	0	ALA	1/94	0	14	5	2	MON
2S/4W	11Q 1	900 Otis Dr	Alameda	Chevron Service Station	8/1/1991	1.22E+08	37766872	0	2S/4W 11Q	1871	0	ALA	2/91	0	40	27	4	MON
96001 2S/4W	11Q 2	900 Otis Dr	Alameda	Chevron	3/29/1998	1.22E+08	37766881	1	2S/4W 11Q	0	0	ALA	1/96	0	17	3	2	MON
96001 2S/4W	11Q 3	900 Otis Dr	Alameda	Chevron	3/29/1998	1.22E+08	37766881	1	2S/4W 11Q	0	0	ALA	1/96	0	16	3	2	MON
96001 2S/4W	11Q 4	900 Otis Dr	Alameda	Chevron	3/29/1998	1.22E+08	37766881	1	2S/4W 11Q	0	0	ALA	1/96	0	17	4	2	MON
96001 2S/4W	11Q 5	900 Otis Dr	Alameda	Chevron	3/29/1998	1.22E+08	37766881	1	2S/4W 11Q	0	0	ALA	1/96	0	17	4	2	MON
96001 2S/4W	11Q 6	900 Otis Dr	Alameda	Chevron	3/29/1998	1.22E+08	37766881	1	2S/4W 11Q	0	0	ALA	1/96	0	17	4	2	MON
96001 2S/4W	11Q 7	900 Otis Dr	Alameda	Chevron	3/29/1998	1.22E+08	37766881	1	2S/4W 11Q	0	0	ALA	1/96	0	17	6	2	MON
2S/4W	11R 1	1204 BAY ST	Alameda	BOB BONINI	8/2/1984	1.22E+08	37767929	0	2S/4W 11R	4075	0	ALA	7/77	0	70	0	4	IRR
2S/4W	11R 2	1204 BAY ST	Alameda	HARVEY GLASSER	8/2/1984	1.22E+08	37767929	0	2S/4W 11R	4076	0	ALA	7/77	0	70	0	4	IRR

Well Legend

DOM=Domestic well

IRR=Irrigation well

MUN= Municipal well

IND=Industrial well

CAT=Cathodic well

DES=well destroyed (through permit)

ABN=Abandoned and not being used (but has not been destroyed through permit process)

TES=Test well

BOR= Geotechnical investigation

MON= Monitoring well

EXT=Extraction/ Vapor wells

PIE=Piezometers

REC=Recovery well (extraction/ vapor)

? = Unknown or no information found or given

From: Yoo, James [jamesy@acpwa.org]
Sent: Wednesday, July 12, 2006 5:53 PM
To: Brent@ggtr.com
Subject: RE: Request for Well Driller Logs / DWR Reports

Brent:

I check for all your DWR reports you have requested and found NO actual DWR copies. Before 1995 Zone 7 Water Agency had the Jurisdiction in our area. During the transfer period, it appears only the data base was given to us and no actual reports.

You can try Zone 7 Water Agency (925-454-5000), but I know in the past they have said they also don't have the reports anymore.

It looks like all the records you want was from 1984,1988,1989 and 1992 and all I have are the data base records, which I have already sent you.

James

-----Original Message-----

From: Brent@ggtr.com [mailto:Brent@ggtr.com]
Sent: Tuesday, July 11, 2006 2:04 PM
To: Yoo, James
Subject: Request for Well Driller Logs / DWR Reports

James,

As just discussed, please provide logs/reports for the following sites listed below. All are located in Alameda, CA in Township/Range 2S/4W.

Site Address	Section	Well Record #
1614 6th St.	11E 1	4062
1205 Bay	11J 1	4065
1036 San Antonio Ave.	11J 2	4066
1236 St. Charles Ave.	11J 3	4067
1224 Bay St.	11J 4	4068
1200 San Antonio Ave.	11J 5	4069
1251 Bay St.	11J 6	4070
1261 St. Charles	11J 7	4071
801 San Antonio Ave.	11K 1	4072
920 Centennial Ave.	11K 2	4073
645 Central	11M 1	4074
1204 Bay St.	11R 1	4075
1204 Bay St.	11R 1	4076

Thanks,

Regards,

Brent A. Wheeler
Project Engineer
Environmental Consulting Division
Golden Gate Tank Removal, Inc.
255 Shipley Street, San Francisco, CA 94107 Ph (415) 512-1555 Fax
(415)512-0964 Cell (415) 686-8846

ACFWA
WELL RECORD # 613

2S/4W 11J8

01-454X

WATER WELL DRILLING REPORT

PERMIT NUMBER 90133

Feb 21 1990

LOCATION:

The well is located at 1040 Fair Oaks Drive Alameda, California. Zone 7 of the Alameda county flood control and water conservation district.

PROPOSAL:

Our intention was to dig a 60 foot hole approximately 10 inches in diameter. Once the hole was dug we would attempt to set 20 feet of P.V.C. well casing with .039" slots and 40 feet of solid P.V.C. casing. After the casing was set we would attempt to fill the annular space with a #3 sand. We intend to use sand as the annular filter material because we understand that any larger material used in alameda can allow passage into the well of the fine sand that is so predominant in the undersoil. The top of the well annulus would then be sealed with a concrete mix and neatly squared off around the well head. We intend to use a submersible pump suspended on stainless steel cable and P.V.C. pipe and a rubber gasketed, steel sanitary well casing seal.

Casing Diam: 5 1/4"

DRILLING DETAILS:

The Well was dug by the rotary hydro drilling method. During the digging process we had some opportunity to note the material thru which we were cutting. The first 5 feet seemed to be just top soil dirt. Once we had bored past 5 feet, we noticed that we were cutting thru what appeared to be all sand. We hit the first ground water table at about 10 feet. The combination of very fine sand and a high ground water table made bentonite a must and it was used throughout the drilling process according to the manufacturers instructions. Starting at about 40 feet we hit a layer of a slightly coarse sand. We drilled for about 10 more feet where we seemed to hit a layer of clay. At 60 feet the drilling was halted, and the drill rod and bit were removed. Working quickly, we began lowering the casing. Once the casing was set we started filling the annular space with the sand pack and then sealed the top 50 feet with cement.

The well is yielding approximately 10 gallons per minute and the water appears clean and clear.

Report By,



Mark Ratto
East Bay Pump Co.

Lic # C57 362016

Owner: Ashley Jones
Irrigation well

CAROLINE

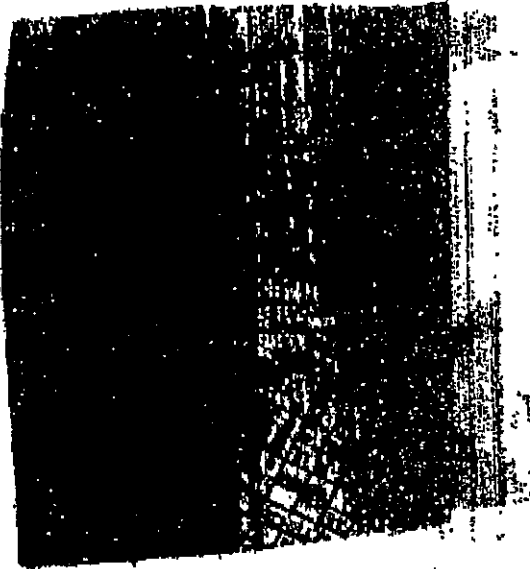
01-434X
2S/4W 1158



FAIR OAKS

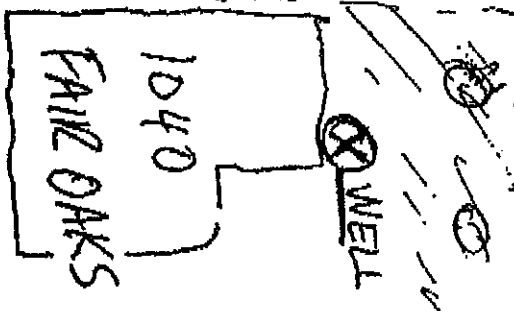

ST CHARLES

100L
ADD ✓

WATER WELL DRILLING REPORT

PERMIT NUMBER 88471

LOCATION:

Mr & Mrs. Risling

The well is located at 1261 St. Avenue Charles Alameda, California. Zone 7 of the Alameda county flood control and water conservation district. (see attached location sketch.)

PROPOSAL:

Our intention was to dig a 60 foot hole approximately 10 inches in diameter. Once the hole was dug we would attempt to set 20 feet of P.V.C. well casing with .039" slots, and 40 feet of solid P.V.C. casing. After the casing was set we would attempt to fill the annular space with a #3 sand. We intend to use sand as the annular filter material because we understand that any larger material used in alameda can allow passage into the well of the fine sand that is so predominant in the underoil. The top of the well annulus would then be sealed with a concrete mix and neatly squared off around the well head. We intend to use a deepwell jet pump with a two pipe injector suspended on P.V.C. pipe and a rubber gasketed, steel sanitary well casing seal.

DRILLING DETAILS:

The Well was dug by the rotary hydro drilling method. During the digging process we had some opportunity to note the material thru which we were cutting. The first 5 feet seemed to be just top soil dirt. Once we had bored past 5 feet, we noticed that we were cutting thru what appeared to be all sand. We hit the first ground water table at about 10 feet. The combination of very fine sand and a high ground water table made bentonite a must and it was used throughout the drilling process according to the manufacturers instructions. Starting at about 50 feet we hit a layer of clay. At 60 feet the drilling was halted, and the drill rod and bit were removed. Working quickly, we began lowering the casing. Once the casing was set we started filling the annular space with the sand pack and then sealed the top 20 feet with cement.

The well is yielding approximately 10 gallons per minute and the water seems to be clean and clear.

Report By,



Mark Ratto
East Bay Pump Co.

10-88
IRRIGATION well
5" CASING

Lic: 362016

CONFIDENTIAL

STATE OF CALIFORNIA DWR
WELL COMPLETION REPORT
(WELL LOGS)

REMOVED

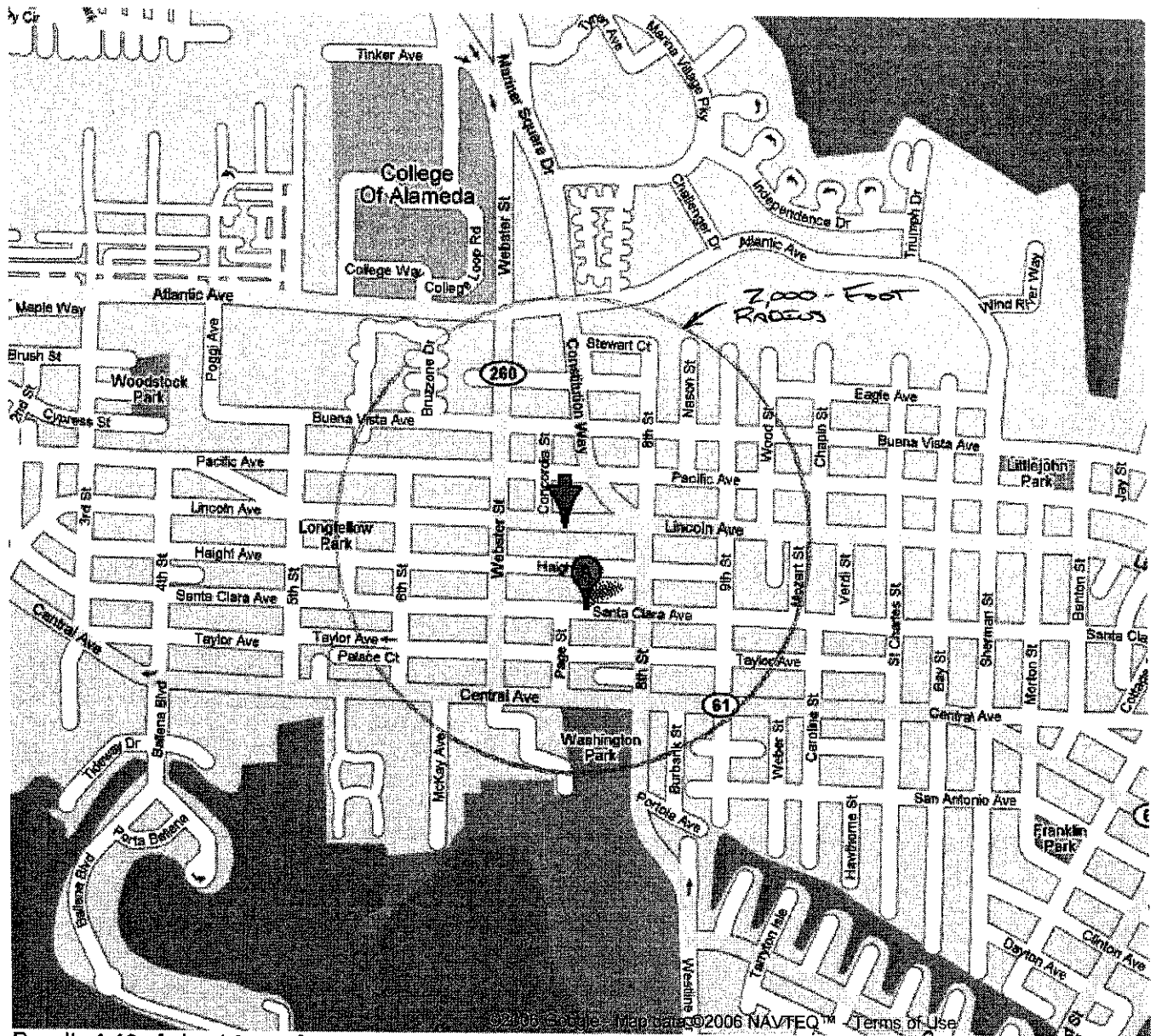

Results 1-10 of about 3,470 for Children's Day Care near 748 Lincoln Ave, Alameda, CA 94501 - Modify search

- A. **Children's Cottage Rising Star**
770 Santa Clara Ave, Alameda, CA
0.1 mi S - (510) 521-8940
- B. **Little Seeds Children's Center**
2055 Santa Clara Ave, Alameda, CA
1.4 mi E - (510) 865-5900
- C. **First Step Children's Center**
111 Fairmount Ave, Oakland, CA
2.9 mi N - (510) 238-0880
- D. **Lakeshore Children's Center**
3540 Lakeshore Ave, Oakland, CA
3.1 mi NE - (510) 893-4048
- E. **Grace Children's Center**
993 53rd St, Oakland, CA
4.3 mi N - (510) 653-1115
- F. **Via Nova Children's Preschool**
3032 Martin Luther King Jr Way, Berkeley, CA
5.4 mi N - (510) 848-6682
- G. **Centro Vida Children's Center**
- H. **Catholic Charities of the Archdiocese of SN Frncsco:**

1000 Camelia St, Berkeley, CA
7.2 mi N - (510) 525-1463

Children's Village Child Development Center
250 10th St, San Francisco, CA
7.6 mi W - (415) 865-2610

I. **Civic Center Child Care Corporation: Infant-Toddler**
455 Golden Gate Ave # 2400, San Francisco, CA
7.8 mi W - (415) 703-1277

J. **Betty's Children's Academy**
11200 Golf Links Rd # D, Oakland, CA
8.5 mi E - (510) 430-8789

Google ►
1 2 3 4 Next

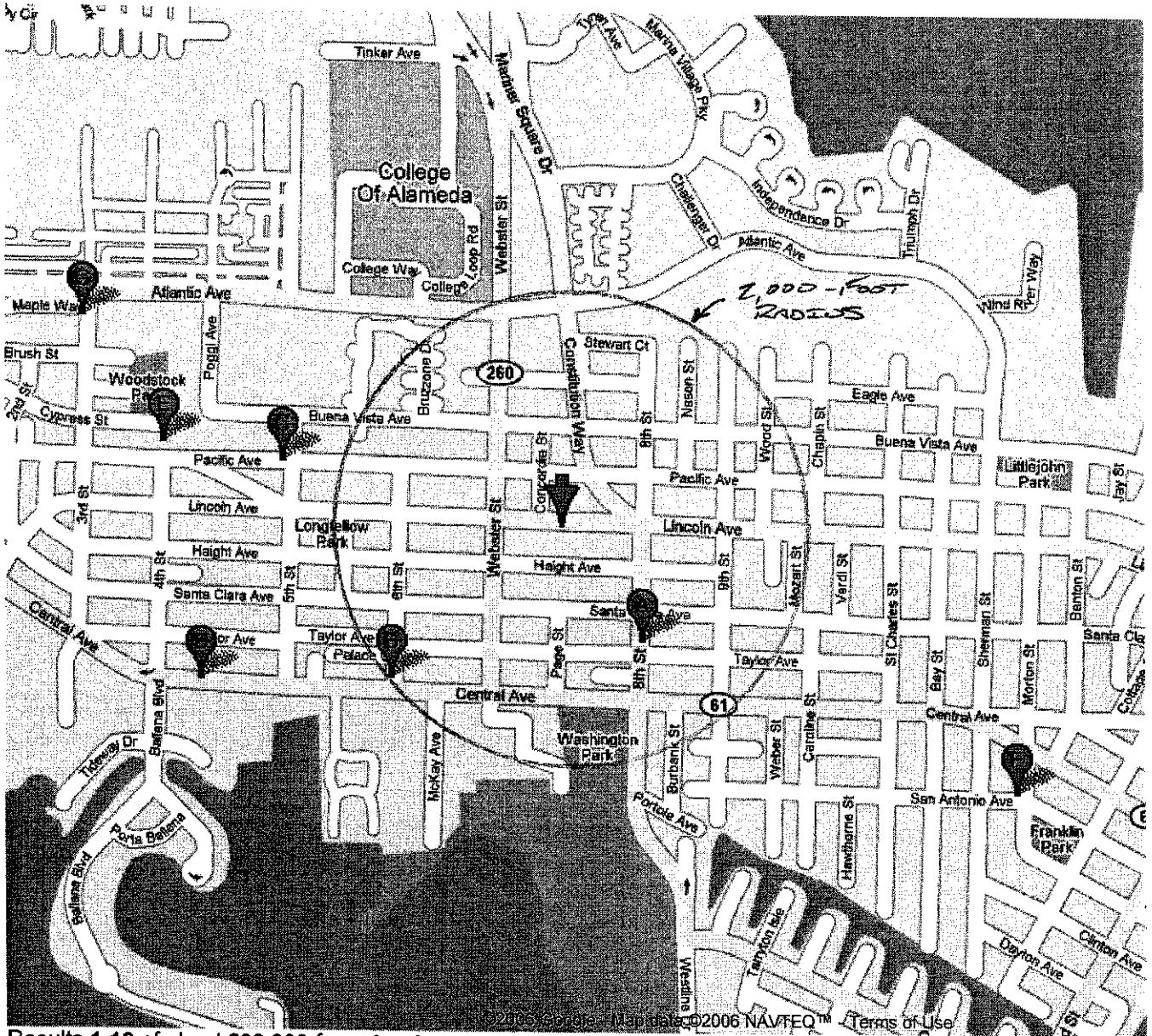

Results 1-10 of about 202,000 for schools near 748 Lincoln Ave, Alameda, CA 94501 - Modify search

- A. Washington Elementary School
825 Taylor Ave, Alameda, CA
0.2 mi SE - (510) 748-4007
- B. St Barnabas School
1400 6th St, Alameda, CA
0.4 mi SW - (510) 521-0595
- C. Alameda Unified School District: Longfellow Elementary School
500 Pacific Ave, Alameda, CA
0.4 mi W - (510) 748-4008
- D. Paden Elementary School
444 Central Ave, Alameda, CA
0.6 mi SW - (510) 748-4014
- E. Chipman Middle School
401 Pacific Ave, Alameda, CA
0.6 mi W - (510) 748-4017
- F. Franklin Elementary School
1433 San Antonio Ave, Alameda, CA
0.8 mi SE - (510) 748-4004
- G.
- H.

Woodstock Elementary School
1900 3rd St, Alameda, CA
0.8 mi W - (510) 748-4012

George P Miller Elementary
250 Singleton Ave, Alameda, CA
1.0 mi NW - (510) 748-4011

I. **Woodstock Child Development**
190 Singleton Ave, Alameda, CA
1.1 mi NW - (510) 748-4001

J. **Will C Wood Middle School**
420 Grand St, Alameda, CA
1.1 mi SE - (510) 748-4015

Google 
1 2 3 4 Next