



**RECEIVED**  
By dehloptoxic at 2:28 pm, Dec 21, 2006

December 18, 2006

Jerry Wickham  
Hazardous Materials Specialist  
Alameda County Environmental Health  
1131 Harbor Bay Parkway, Suite 250  
Alameda, California 94502-6577

Clayton Project No. 33104-004583.04

Subject: Remedial Excavation Report for SLIC Case No. RO0002874  
GE/Imatron/Caral Manufacturing  
578 Cleveland Avenue, Albany, California

Dear Mr. Wickham:

Clayton Group Services, Inc., (Clayton) a *Bureau Veritas* company, has prepared this Remedial Excavation Report on behalf of GE Healthcare (GE) for the subject facility in response to your August 18, 2006 letter. Clayton excavated soil along the west side of the warehouse building to a depth of 3 feet below ground surface (bgs). The soil was disposed of at an appropriate non-hazardous waste landfill facility. The excavated area was backfilled with clean soil.

Based on our review of the current data and the remedial actions that have occurred at the site, Clayton recommends the SLIC Case be closed with no further investigation or remediation action. Please review the enclosed Report and call me at (925) 426-2681 or Mr. Richard Rinck of GE at (650) 827-7729 if you have any questions. We declare, under penalty of perjury, that the information and/or recommendations contained in the enclosed report is/are true and correct to the best of our knowledge.

Sincerely,

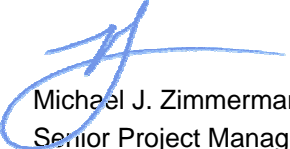
  
Michael J. Zimmerman, P.E., R.E.A.  
Senior Project Manager  
Environmental Services

MJZ/jdm

Enclosure

cc: Richard Rinck, GE Healthcare  
389 Oyster Point Blvd. Suite 8, South San Francisco, California 94080

**Clayton Group Services, Inc.**

*A Bureau Veritas Company*  
6920 Koll Center Parkway, Suite 216  
Pleasanton, California 94566

Main: (925) 426-2600  
Fax: (925) 426-0106  
[www.us.bureauveritas.com](http://www.us.bureauveritas.com)

# **Remedial Excavation Report**

---

Former GE Caral Manufacturing Facility  
578 Cleveland Avenue  
Albany, California 94710

December 18, 2006  
33104-004583.04

Prepared for  
**GE HEALTHCARE**  
389 Oyster Point Blvd. Suite 8  
South San Francisco, California 94080



For the benefit of business and people

**Clayton Group Services, Inc.**  
*A Bureau Veritas Company*  
6920 Koll Center Parkway  
Pleasanton, California 94566  
925.426.2600  
[www.us.bureauveritas.com](http://www.us.bureauveritas.com)



## CONTENTS

<u>Section</u>	<u>Page</u>
<b>Executive Summary</b> .....	<b>i</b>
<b>1.0 INTRODUCTION</b> .....	<b>1</b>
1.1 BACKGROUND .....	1
1.2 WEST OF WAREHOUSE .....	1
<b>2.0 SCOPE OF WORK</b> .....	<b>2</b>
2.1 PRE-FIELD ACTIVITIES .....	2
2.2 FIELD ACTIVITIES .....	2
<b>3.0 REMEDIAL EXCAVATION LIMITATIONS</b> .....	<b>3</b>
<b>4.0 SITE INVESTIGATION CONCLUSIONS AND RECOMMENDATIONS</b> .....	<b>3</b>

### Tables

- 1 Soil Analytical Results - Area West of Warehouse
- 2 Soil Analytical Results - Backfill and Excavated Soil Samples

### Figures

- 1 Site Location Map
- 2 Facility Site Plan
- 3 Excavation West of Warehouse

### Photos

### Appendices

- A Remedial Action Workplan Dated August 14, 2006
- B Alameda County Letter dated August 18, 2006
- C Non-Hazardous Waste Manifests
- D Laboratory Analytical Data Sheets



## **EXECUTIVE SUMMARY**

Clayton Group Services, Inc., (Clayton) a *Bureau Veritas* company, completed remedial action on behalf of GE Healthcare (GE) at the former GE facility located at 578 Cleveland Avenue in Albany, California (the "Site") (Figures 1, 2, and 3). The purpose of this Remedial Excavation Report is to document completion of remedial action activities at the Site pursuant to the workplan dated August 14, 2006 (Appendix A) and approved by the Alameda County Health Care Services Agency (the County) in its letter dated August 18, 2006 in association with SLIC Case NO. RO0002874 (Appendix B).

Clayton prepared this Remedial Excavation Report which consists of a description of how the work complied with the workplan and associated relevant figures and data depicting the remedial action location, permits, data tables, certified laboratory analytical data sheets, findings, conclusions, and recommendations.

Clayton will both submit the analytical data electronically to the Geotracker website and electronically submit a complete copy of the report to the GeoTracker website in PDF format.

### **Background**

In May 2006, soil samples collected west of the warehouse indicated the presence of three metals, antimony, cobalt and lead at shallow depths. Samples taken from deeper depths (3 to 6 feet bgs) did not contain concentrations of these metals that exceeded Regional Water Quality Control Board Environmental Screening Levels (ESLs).

On August 18, 2006, the County requested that GE complete an excavation west of the warehouse to remove soil in which these metals had been detected. In the meeting with the County on August 3, 2006, the County agreed that horizontal and vertical confirmation sampling was unnecessary because detected concentrations of these metals at depths greater than 3 feet in the area were below the ESLs and because there were adequate samples surrounding the excavation in which these metals had not been detected above the ESLs (Appendix B). Table 1 provides a summary of the soil sample results for the area west of the warehouse.

### **Scope of Work Completed**

In October 2006, Clayton excavated soil along the west side of the warehouse building to a depth of 3 feet bgs in the area shown in Figure 3. The overall dimensions of the excavation were approximately 100 feet long x 10 feet wide x 3 feet deep; 3,000 cubic feet or 111 cubic yards soil were removed.

The excavated soil was stockpiled in the parking lot on visqueen pending offsite disposal. A four (4) – point composite soil sample was taken from the stockpile and analyzed for total metals by Curtis and Tompkins Laboratory in Berkeley, California. Results from the stockpile sampling indicated that the excavated soil was non-hazardous. The soil was disposed offsite at an appropriate non-hazardous waste landfill facility. The excavation was backfilled and compacted with clean soil from a quarry. Prior to backfilling, a four-point composite soil sample was taken at the quarry that determined that the soil did not contain chemicals of concern above ESLs. Following the backfill and compaction activities, GE installed a 3-inch asphalt cover over the excavated area to return it to its original state.





## **Executive Summary**

(Continued)

### **Conclusions and Recommendations**

All work was accomplished in accordance with the workplan. As a result, the remedial activities were effective. Consequently, Clayton recommends that the SLIC case be closed and no further investigation or remediation action is necessary.



## **1.0 INTRODUCTION**

Clayton Group Services, Inc., (Clayton) a *Bureau Veritas* company, completed remedial action on behalf of GE Healthcare (GE) at the former GE facility located at 578 Cleveland Avenue in Albany, California (the "Site") (Figures 1, 2, and 3). The purpose of this Remedial Excavation Report is to document completion of remedial action activities at the Site pursuant to the workplan dated August 14, 2006 (Appendix A) and approved by the Alameda County Health Care Services Agency (the County) in its letter dated August 18, 2006 in association with SLIC Case NO. RO0002874 (Appendix B).

The remedial action consisted of the removal of soil, located to the west of the warehouse, to a depth of 3 feet belowgrade surface (bgs). The overall dimensions of the excavation were approximately 100 feet long x 10 feet wide x 3 feet deep; 3,000 cubic feet or 111 cubic yards soil were removed. The excavated area was then backfilled and compacted with clean soil.

Clayton prepared this Remedial Excavation Report which consists of a description of how the work complied with the workplan and associated relevant figures and data depicting the remedial action location, permits, data tables, certified laboratory analytical data sheets, findings, conclusions, and recommendations.

Clayton will both submit the analytical data electronically to the GeoTracker website and electronically submit a complete copy of the report to the GeoTracker website in PDF format.

## **1.1 BACKGROUND**

In February and May 2006, Clayton collected soil samples onsite at depths of 1, 3 and 6 feet bgs for borings SB-1 through SB-17 identified on Figure 2. Soil samples collected west of the warehouse indicated the presence of three metals, antimony, cobalt and lead in the 1-foot level. Samples taken from deeper depths (3 to 6 feet bgs) did not contain concentrations of these metals that exceeded Regional Water Quality Control Board Environmental Screening Levels (ESLs). Clayton submitted a Remedial Action Workplan on August 14, 2006, to address the County's request for additional remedial work. The County approved the workplan in its letter dated August 18, 2006 and stated that confirmation sampling was unnecessary because the previously obtained samples from depths greater than 3 feet in which these metals were not detected above ESLs provided adequate confirmation. Further, adequate horizontal samples had previously been taken from areas outside the excavation, making additional horizontal confirmation sampling also unnecessary.

## **1.2 WEST OF WAREHOUSE**

Soil samples collected west of the warehouse (SB-13 through SB-17) in February and May 2006 were analyzed for the Title 22 CAM17 metals by EPA Methods 6000/7000 and PCBs by EPA Method 8082. Several metals were detected above ESLs in the samples from the 1-foot level.

- Antimony was detected in one sample that exceeded the residential ESL.



- Cobalt was detected in three samples that exceeded the residential and commercial/industrial ESLs.
- Lead was detected in two samples that exceeded the residential ESL

The previous soil samples collected on February 16, 2006 from 3 to 6 feet bgs in this same area showed significantly lower concentrations for metals than soil at 1 to 2 feet bgs. The County concluded that remedial excavation to a depth of three feet would be sufficient (Appendix B).

## **2.0 SCOPE OF WORK**

The scope of work completed in October 2006 for the Remedial Excavation is presented below.

### **2.1 PRE-FIELD ACTIVITIES**

The purpose of the pre-field activities was to appropriately plan the work and to ensure that onsite personnel were prepared for potential safety hazards at the property. Clayton obtained the required grading permit from the City of Albany, obtained access from the property owner, located utilities, and completed a health and safety plan.

Clayton contacted Underground Service Alert to mark underground utilities in the vicinity of the proposed excavation a minimum of 48 hours prior to the commencement of field activities. Clayton also contracted with a private utility locator to clear safe drilling locations and mark subsurface utilities in the project area.

Clayton developed a site-specific health and safety plan (HSP) for the Remedial Excavation detailing the work to be performed, safety precautions, emergency response procedures, nearest hospital information and onsite personnel responsible for managing emergency situations. A copy of the HSP was kept onsite during the field activities and tailgate health and safety meetings were conducted daily before the start of work.

### **2.2 FIELD ACTIVITIES**

Clayton excavated soil along the west side of the warehouse building to a depth of 3 feet bgs in the area shown in Figure 3 from October 3 through October 5, 2006. The overall dimensions of the excavation were approximately 100 feet long x 10 feet wide x 3 feet deep; for a total of approximately 3,000 cubic feet or 111 cubic yards.

The excavated soil was stockpiled in the parking lot on visqueen pending offsite disposal. A four (4) – point composite soil sample was taken from the stockpile and analyzed for total metals by Curtis and Tompkins Laboratory in Berkeley, California. Results from the waste profile sample indicated that the soil was non-hazardous and that no chemicals of concern were present. Table 2 contains a summary of the analytical results from the waste profile sampling. Analytical data from the laboratory is included in Appendix C. The excavated soil was disposed of at the Altamont Landfill in Livermore California using the appropriate non-hazardous waste manifest forms. Copies of the non-hazardous waste manifest forms are included in Appendix D.



Following the soil removal, the excavated area was backfilled using clean, uncontaminated fill obtained from a quarry. Clayton took a four-point composite sample for metals of the fill material prior to the backfilling. The soil sample was submitted to Curtis and Tompkins Laboratory in Berkeley, California using the proper chain of custody procedures. The soil sample confirmed that the soil did not contain any chemicals of concern. Table 2 contains a summary of the results from the backfill soil sampling. Analytical data for the soil samples is included in Appendix C. The backfilling activities occurred from October 18<sup>th</sup> through October 27, 2006. Following the completion of the backfilling activities, asphalt was poured over the excavated area to a depth of three inches to return the site to its original state.

### **3.0 REMEDIAL EXCAVATION LIMITATIONS**

Two items were identified during the excavation that had a minor impact on the performance of the workplan.

1. A buried electrical line runs to a pole next to the west side of the warehouse between soil borings SB-14 and SB-15 (Figure 3). A second unidentified line ran from east to west adjacent to the building between borings SB-15 and SB-16 (Figure 3). Clayton hand excavated around the buried lines but had to leave a small area of soil in place around the pole to prevent impacting the structural footing of the pole and to avoid electrical shock hazards. The County approved this method in its August 18, 2006 letter.
2. During the excavation, a 4-inch drainage pipe was discovered about 2 feet below the surface, running the entire length of the area being excavated. The pipe crossed over the excavation area in two places. The pipe did not remain intact during the excavation, and therefore was removed. Clayton replaced the pipe with acrylonitrile-butadiene-styrene (ABS) pipe prior to backfilling the excavated area. The City of Albany visited the Site during the excavation activities and was satisfied with Clayton's plan to replace the pipe with an ABS section.

### **4.0 SITE INVESTIGATION CONCLUSIONS AND RECOMMENDATIONS**

All work was accomplished in accordance with the workplan. As a result, the remedial activities were effective. Consequently, Clayton recommends that the SLIC case be closed and no further investigation or remediation action is necessary.



Based on the results of the deeper soil samples from the area west of the warehouse, the remedial activities were effective, and there is no significant residual contamination at this Site. Clayton recommends the SLIC case be closed with no further investigation or remediation action.

This report prepared by:

Joseph D. Moulton  
Project Consultant  
Environmental Services

This report reviewed by:

Decie Y. Boone  
Environmental Consultant  
Environmental Services

This report reviewed by:

Michael J. Zimmerman, P.E., R.E.A.  
Senior Project Manager  
Environmental Services

This report reviewed by:

Jon A. Rosso, P.E.  
Director  
Environmental Services



December 18, 2006

Clayton Project No. 33104-004583.04



## TABLES

**TABLE 1**  
**Soil Analytical Results-Area West of Warehouse**  
**Former GE Carol Manufacturing Facility**  
**578 Cleveland Avenue**  
**Albany, California**

Sample ID	Sample Date	Sample Depth (ft bgs)	Antimony (mg/Kg)	Arsenic (mg/Kg)	Barium (mg/Kg)	Beryllium (mg/Kg)	Cadmium (mg/Kg)	Total Chromium (mg/Kg)	Cobalt (mg/Kg)	Copper (mg/Kg)	Lead (mg/Kg)	Mercury (mg/Kg)	Molybdenum (mg/Kg)	Nickel (mg/Kg)	Selenium (mg/Kg)	Silver (mg/Kg)	Thallium (mg/Kg)	Vanadium (mg/Kg)	Zinc (mg/Kg)
SS-1	5/1/2004	na	na	<5	na	na	12	410	14	280	630	na	na	250	na	na	24	na	4900
B-5	5/1/2004	1.5	na	2200	na	na	3.5	8.6	<0.5	<0.5	3.2	na	na	<1	na	na	<25	na	<1
B-5	5/1/2004	5	na	<5	na	na	<0.5	290	26	34	3.8	na	na	200	na	na	<25	na	30
SB-13-1'	5/25/2006	1	< 3.0	4.6	370	0.43	< 0.25	18	9.8	37	100	1.3	< 1.0	17	1.2	< 0.25	< 0.25	24	170
SB-13-3'	2/17/2006	3	< 2.8	2.2	56	0.38	< 0.23	12	2.9	4.1	4.0	0.018	< 0.92	5.7	< 0.23	< 0.23	< 0.23	20	7.4
SB-13-6'	2/17/2006	6	< 2.4	2.1	63	0.5	< 0.20	14	6.4	3.5	4.9	< 0.019	< 0.81	12	< 0.20	< 0.20	< 0.20	21	12
SB-14-1	5/25/2006	1	8.3	3.9	160	0.39	1.2	59	14	120	720	0.19	5.9	29	0.27	5.2	< 0.25	23	210
SB-14-3'	2/17/2006	3	< 2.1	3.4	100	0.56	< 0.18	14	11	3.1	5.4	0.067	< 0.70	8.9	< 0.18	< 0.18	< 0.18	24	9.2
SB-14-6'	2/17/2006	6	< 2.6	1.9	68	0.52	< 0.21	19	3.4	4.2	4.8	0.03	< 0.85	13	< 0.21	< 0.21	< 0.21	20	17
SB-15-1'	5/25/2006	1	< 3.0	3.2	140	0.46	0.3	22	7.6	78	210	0.16	< 1.0	20	< 0.25	0.66	< 0.25	26	97
SB-15-3'	2/17/2006	3	< 1.7	1.8	77	0.34	< 0.14	13	2.4	3.3	3.8	0.13	< 0.58	5.7	< 0.14	< 0.14	< 0.14	20	6.9
SB-15-6'	2/17/2006	6	< 2.7	5.5	230	0.89	< 0.23	10	6.1	7.6	62	< 0.019	< 0.91	16	< 0.23	< 0.23	< 0.23	32	44
SB-16-1	5/25/2006	1	< 3.0	2.9	210	0.53	< 0.25	15	22	13	18	0.05	< 1.0	14	1.1	< 0.25	< 0.25	24	81
SB-16-3'	2/17/2006	3	< 2.9	1.4	92	0.3	< 0.24	14	3.1	3.2	3.5	< 0.015	< 0.96	6.7	< 0.24	< 0.24	< 0.24	17	7.7
SB-16-6'	2/17/2006	6	< 2.3	2	54	0.5	< 0.19	17	4.8	3.5	4.0	< 0.016	< 0.77	17	< 0.19	< 0.19	< 0.19	22	14
SB-17-1.5	5/25/2006	1.5	< 3.0	4.2	180	0.48	0.65	13	12	44	43	0.076	< 1.0	12	< 0.25	< 0.25	< 0.25	22	290
SB-17-3'	2/17/2006	3	< 2.3	2	120	0.42	< 0.19	12	4.2	7.4	5.0	< 0.014	< 0.76	8.8	< 0.19	< 0.19	< 0.19	18	17
SB-17-6'	2/17/2006	6	< 2.6	2.4	51	0.32	< 0.22	23	2.1	5.7	4.3	0.021	< 0.88	17	< 0.22	< 0.22	< 0.22	27	14
Regional BKG Conc. (LBNL, 2002)			<10	5.5	130	0.42	5.6	58	14	32	7	0.5	<5	68	5.1	3	10	46	64
Regional BKG Conc. (Bradford et al 1996)			---	3.5	509	1.3	0.4	122	15	29	24	0.26	---	57	---	---	---	112	149
EPA Preliminary Remediation Goal (Industrial)			410	0.25	67,000	1,900	450	450	1,900	41,000	150	310	5,100	20,000	5,100	5,100	67	1,000	100,000
Residential ESL			6.0	5.5	750	4	1.7	58	10.5	225	150	3.7	40	150	10	20	1.0	106.5	600
Commercial/Industrial ESL			40	5.5	1,500	8	7.4	58	10.5	225	750	10	40	150	10	40	12	200	600

**Notes:**

- 1) All samples were analyzed by EPA methods 6010B/7471A.
- 2) mg/kg = milligrams per kilogram or parts per million (by weight).
- 3) ft bgs = feet below ground surface.
- 4) Bold concentrations were detected above the reporting limit.
- 5) < 2.1 indicates the analyte was not detected at or above the reporting limit of 2.1 mg/Kg.
- 6) ESL = SF Bay RWQCB Environmental Screening Level, February 2005.
- 7) na - Data not available.

**TABLE 2**  
**Soil Analytical Results - Excavated Soil and Backfill Samples**  
**Former GE Caral Manufacturing Facility**  
**578 Cleveland Avenue**  
**Albany, California**

	<b>Excavated Soil Waste Profile Sample</b>	<b>Backfill Sample from Quarry</b>
<b>Sample ID</b>	1-4 Point Comp.	RGW Backfill 1
<b>Sample Date</b>	10/4/2006	10/9/2006
<b>Antimony (mg/Kg)</b>	< 3.0	< 2.0
<b>Arsenic (mg/Kg)</b>	<b>2.9</b>	<b>5.9</b>
<b>Barium (mg/Kg)</b>	<b>120</b>	<b>270</b>
<b>Beryllium (mg/Kg)</b>	<b>0.39</b>	< 0.50
<b>Cadmium (mg/Kg)</b>	<b>0.41</b>	< 0.50
<b>Total Chromium (mg/Kg)</b>	<b>13</b>	<b>9.8</b>
<b>Cobalt (mg/Kg)</b>	<b>4.2</b>	<b>5.8</b>
<b>Copper (mg/Kg)</b>	<b>34</b>	<b>11</b>
<b>Lead (mg/Kg)</b>	<b>56</b>	<b>8.2</b>
<b>Mercury (mg/Kg)</b>	<b>0.26</b>	NS
<b>Molybdenum (mg/Kg)</b>	<b>1.2</b>	< 0.99
<b>Nickel (mg/Kg)</b>	<b>14</b>	<b>8.7</b>
<b>Selenium (mg/Kg)</b>	< 0.25	< 2.0
<b>Silver (mg/Kg)</b>	< 0.25	< 0.99
<b>Thallium (mg/Kg)</b>	< 0.25	< 0.99
<b>Vanadium (mg/Kg)</b>	<b>20</b>	<b>27</b>
<b>Zinc (mg/Kg)</b>	<b>100</b>	<b>37</b>

**Notes:**

- 1) All samples were analyzed by EPA methods 6010B/7471A.
- 2) mg/kg = milligrams per kilogram or parts per million (by weight).
- 3) Bold concentrations were detected above the reporting limit.





## FIGURES



Map Source: TOPO!© 2000 National Geographic Holdings

Note: Boundaries and Location Information is Approximate

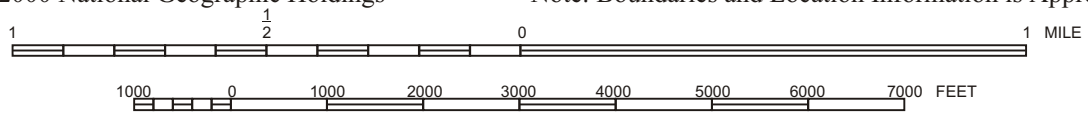

Portion of the 7.5-Minute Series Richmond, California  
 Quadrangle Topographic Map (Datum: NAD 27)  
 United States Department of the Interior  
 Geological Survey  
 1995 Photorevised from 1993



QUADRANGLE LOCATION

SITE LOCATION MAP  
 GE Healthcare  
 Caral Division  
 578 Cleveland Avenue  
 Albany, California  
 Clayton Project No. 70-04583.02

Figure

1





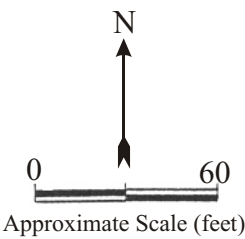
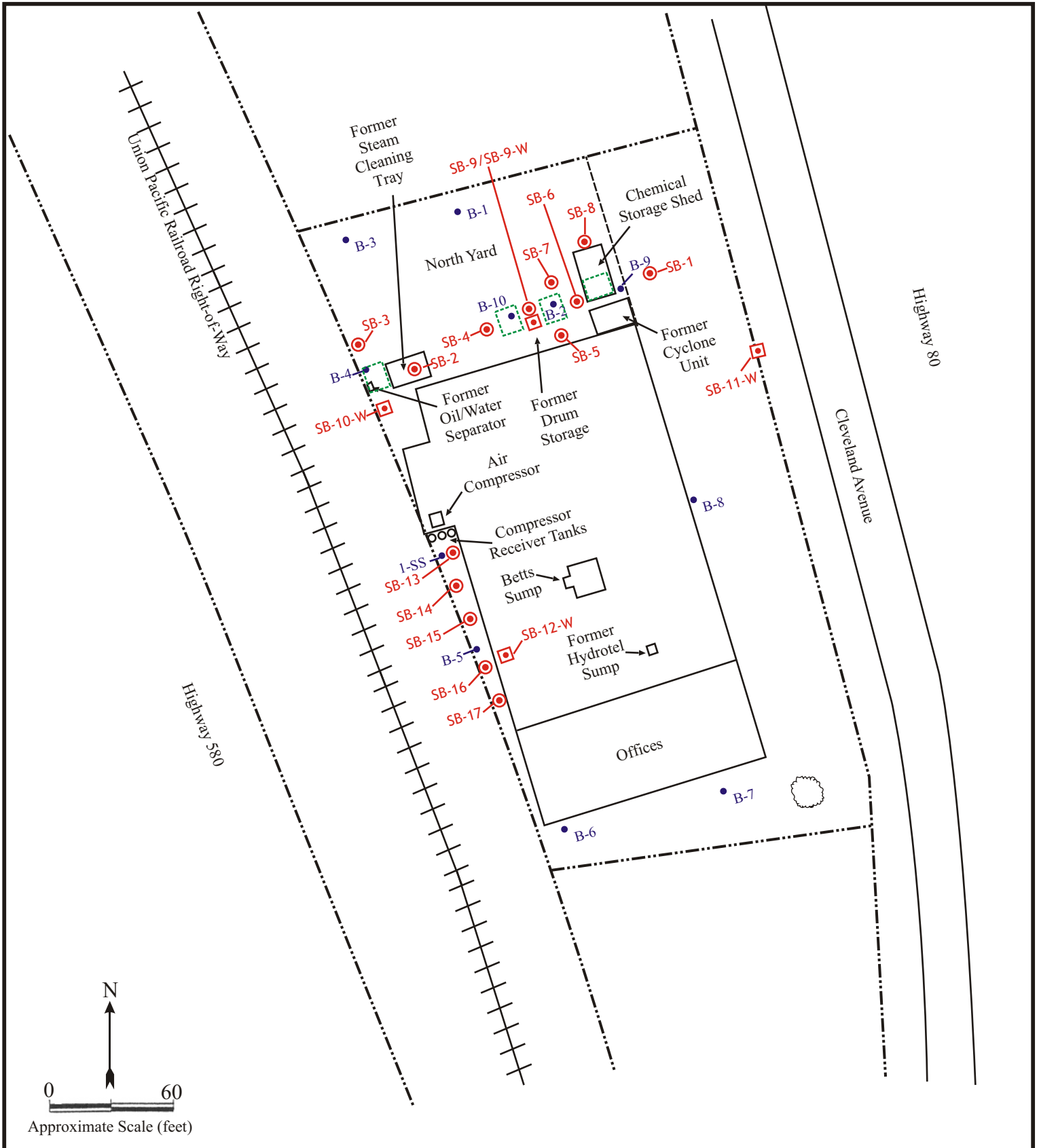

BUREAU  
 VERITAS



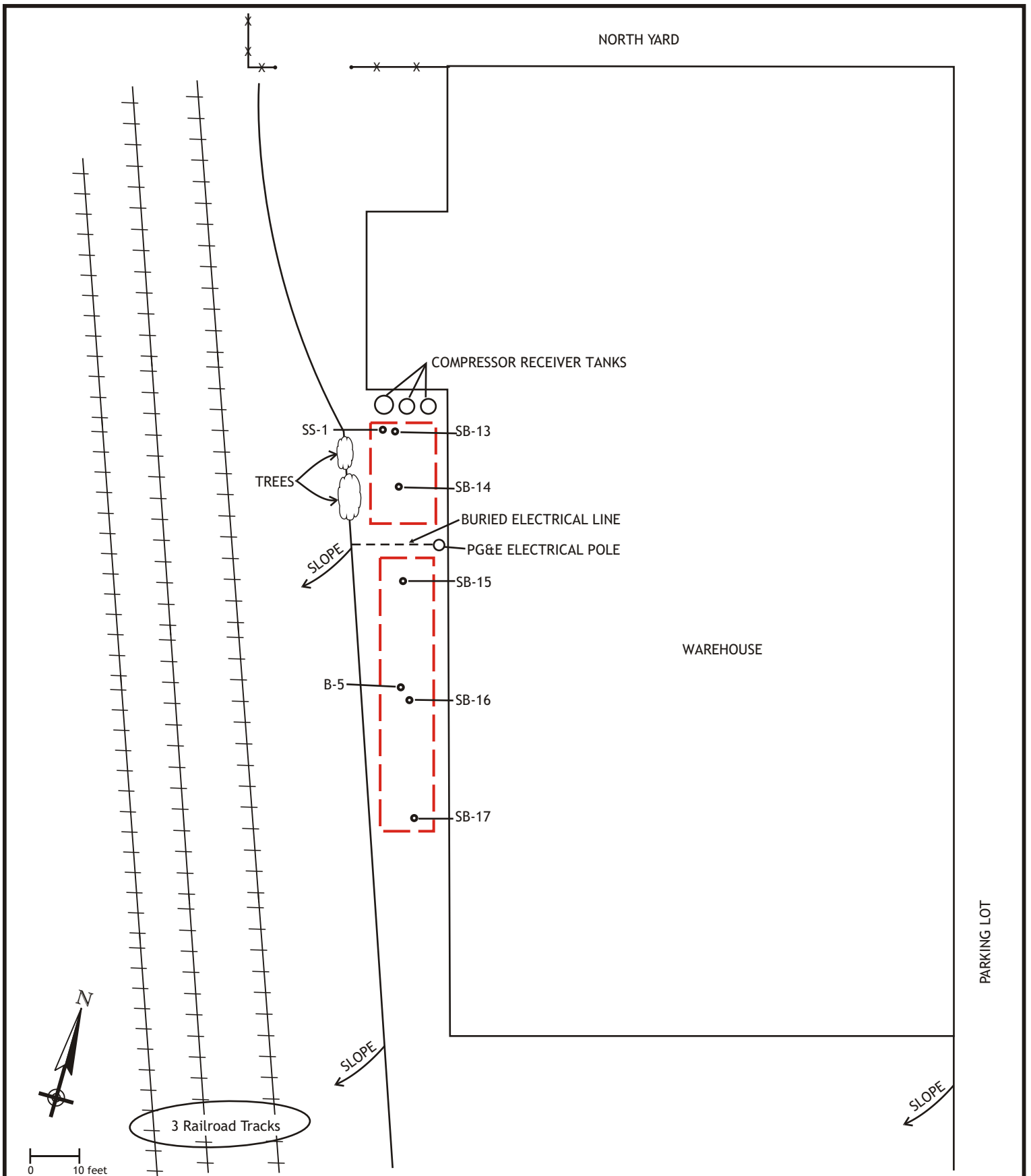

<b>LEGEND</b>	<b>FACILITY SITE PLAN</b>	<b>FIGURE</b>	
<ul style="list-style-type: none"> <li>----- Approximate Property Line</li> <li>• Boring Completed by ERM prior to May 2004</li> <li>○ Soil Boring Location</li> <li>□ Grab Groundwater Sample Location</li> <li>□ North Yard Excavation Completed in 2004</li> </ul>	<p>GE Healthcare            Caral Division            578 Cleveland Avenue            Albany, California            Clayton Project No. 33104-004583.04</p>	<h1>2</h1>	

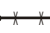

<p><b>LEGEND</b></p>	<p><b>Excavation West of Warehouse</b></p>	<p><b>FIGURE</b></p>	
<p> Areas Excavated to 3 Feet Deep</p> <p> Fence</p>	<p>GE Healthcare          Caral Division          578 Cleveland Avenue          Albany, California          Clayton Project No. 33104-004583.04</p>	<p><b>3</b></p>	



## PHOTOS



Clayton Project No. 33104-004583.04	Description	Northern view of excavation area prior to remedial activities	1
	Site Name	GE Caral, 578 Cleveland Avenue, Albany, California	Photo Date October 2 2006



Clayton Project No. 33104-004583.04	Description	Southern view of excavation area prior to remedial activities	2
	Site Name	GE Caral, 578 Cleveland Avenue, Albany, California	Photo Date October 2 2006





Clayton Project No. 33104-004583.04	Description	Northern view of excavation area following asphalt removal	3
	Site Name	GE Caral, 578 Cleveland Avenue, Albany, California	Photo Date October 2 2006



Clayton Project No. 33104-004583.04	Description	View of steel pipe located in excavation area	4
	Site Name	GE Caral, 578 Cleveland Avenue, Albany, California	Photo Date October 2 2006





Clayton Project No. 33104-004583.04	Description	View of clay pipe located in excavation area	5
	Site Name	GE Caral, 578 Cleveland Avenue, Albany, California	Photo Date October 2 2006



Clayton Project No. 33104-004583.04	Description	View of the soil removal to a depth of three feet	6
	Site Name	GE Caral, 578 Cleveland Avenue, Albany, California	Photo Date October 2 2006





Clayton Project No. 33104-004583.04	Description	Northern view of the clay pipe located in the excavation area	7
	Site Name	GE Caral, 578 Cleveland Avenue, Albany, California	Photo Date October 2 2006



Clayton Project No. 33104-004583.04	Description	View of the excavated soil located on the eastern portion of the property	8
	Site Name	GE Caral, 578 Cleveland Avenue, Albany, California	Photo Date October 3 2006



Clayton Project No. 33104-004583.04	Description	View of a drainage pipe located in the excavation area	9
	Site Name	GE Caral, 578 Cleveland Avenue, Albany, California	Photo Date October 3 2006



Clayton Project No. 33104-004583.04	Description	View of excavation area following soil removal	10
	Site Name	GE Caral, 578 Cleveland Avenue, Albany, California	Photo Date October 4 2006





Clayton Project No. 33104-004583.04	Description	View of the backfilling of the excavation area	11
	Site Name	GE Caral, 578 Cleveland Avenue, Albany, California	Photo Date October 26 2006



Clayton Project No. 33104-004583.04	Description	Backfilling of the excavation area prior to completion	12
	Site Name	GE Caral, 578 Cleveland Avenue, Albany, California	Photo Date October 26 2006





Clayton Project No. 33104-004583.04	Description	Replacing the removed clay pipe	13
	Site Name	GE Caral, 578 Cleveland Avenue, Albany, California	Photo Date October 26 2006



Clayton Project No. 33104-004583.04	Description	The excavation area following the backfilling activities	14
	Site Name	GE Caral, 578 Cleveland Avenue, Albany, California	Photo Date October 26 2006



## **APPENDIX A**

**REMEDIAL ACTION WORKPLAN DATED AUGUST 14, 2006**



August 14, 2006

Jerry Wickham  
Hazardous Materials Specialist  
Alameda County Environmental Health  
1131 Harbor Bay Parkway, Suite 250  
Alameda, California 94502-6577

Clayton Project No. 331040-004583.03

Subject: Remedial Action Workplan  
SLIC Case No. RO0002874, GE/Imatron/Caral Manufacturing  
578 Cleveland Avenue, Albany, California

Dear Mr. Wickham:

Clayton Group Services, Inc., (Clayton) a *Bureau Veritas* company, has prepared this Remedial Workplan on behalf of GE Healthcare (GE) for the subject facility in response to your July 7, 2006 letter.

### **Background**

The Facility location is identified in Figure 1. In February and May 2006, Clayton collected soil samples onsite at depths of 1, 3 and 6 feet below grade surface (bgs) for borings SB-1 through SB-17 identified on Figure 2. Based on the sample results, Alameda County requested that GE conduct remedial action and confirmation sampling west of the warehouse. Clayton, GE, and Alameda County met at your offices on August 3, 2006 to discuss the scope of the remedial action, which is presented in this Workplan.

### **Scope of Work**

Clayton proposes to excavate soil along the west side of the warehouse building to a depth of 3 feet bgs in the area shown in Figure 3. The overall dimensions of the excavation are estimated to be approximately 100 feet long x 10 feet wide x 3 feet deep for an estimated removal of 3,000 cubic feet or 111 cubic yards. We intend to use a limited access rig that is on tracks to address some of the physical site restrictions listed below.

The excavated soil will be stockpiled in the parking lot on visqueen pending offsite disposal. Based on the existing data, the soil is non-hazardous and will be disposed at an appropriate non-hazardous waste landfill facility. The excavation will be backfilled with clean soil from a quarry.

As previously reported, metals concentrations for the deeper samples from 3 and 6 feet bgs were lower than concentrations for the shallow 1 foot bgs samples. Therefore, confirmation samples should not be

## **Clayton Group Services, Inc.**

*A Bureau Veritas Company*  
6920 Koll Center Parkway, Suite 216  
Pleasanton, California 94566

Main: (925) 426-2600  
Fax: (925) 426-0106  
[www.us.bureauveritas.com](http://www.us.bureauveritas.com)



Mr. Jerry Wickham  
Alameda County Environmental Health  
August 14, 2006

Page 2  
Project No. 33104-004583.03

necessary after excavating the upper three feet of soil west of the warehouse. We propose to use the existing data for the 3 and 6 feet bgs samples as confirmation sample data.

### **Physical Site Restrictions**

Below is a summary of physical site restrictions that Clayton will address during the Remedial Action.

1. The excavation area is not easily accessible from the possible access points: the street and parking lot on the east side of the warehouse are five to six feet higher in elevation; a gate and trees close to the northwest end of the building prevent equipment access from the North Yard; and railroad tracks to the west are in active use and within a railroad easement. Equipment will access the site from the parking lot on the east side of the warehouse.
2. Truck and loader size is limited by the 10-foot width of the area available for turning equipment at the southwest corner of the building.
3. Based on the underground utility survey we performed in February 2006, a buried electrical line runs to a pole next to the west side of the warehouse between soil borings SB-14 and SB-15 (Figure 3). We will hand excavate around the buried line but may have to leave a small area of soil in place around the pole to prevent impacting the structural footing of the pole and to avoid electrical shock hazards.

### **Remedial Action Report**

After the field activities are completed, Clayton will document the Remedial Action and offsite disposal of soil, and submit the report to Alameda County for final approval and closure of the SLIC case.

### **Closing**

Please review the Workplan and call me at (925) 426-2681 or Mr. Richard Rinck of GE at (650) 827-7729 if you have any questions.

Sincerely,

  
Michael Zimmerman, P.E., R.E.A.  
Senior Project Manager  
Environmental Services

Enclosure

cc: Richard Rinck, GE Healthcare, 389 Oyster Point Blvd. Suite 8, South San Francisco, California 94080





Map Source: TOPO!© 2000 National Geographic Holdings

Note: Boundaries and Location Information is Approximate

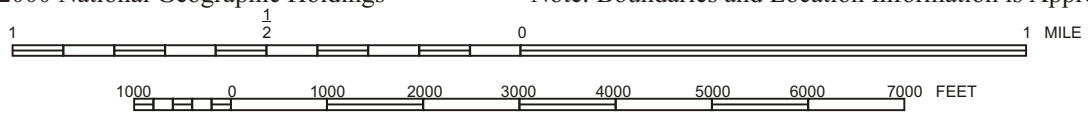

Portion of the 7.5-Minute Series Richmond, California  
 Quadrangle Topographic Map (Datum: NAD 27)  
 United States Department of the Interior  
 Geological Survey  
 1995 Photorevised from 1993



QUADRANGLE LOCATION

SITE LOCATION MAP  
 GE Healthcare  
 Caral Division  
 578 Cleveland Avenue  
 Albany, California  
 Clayton Project No. 70-04583.02

Figure

1



BUREAU  
 VERITAS



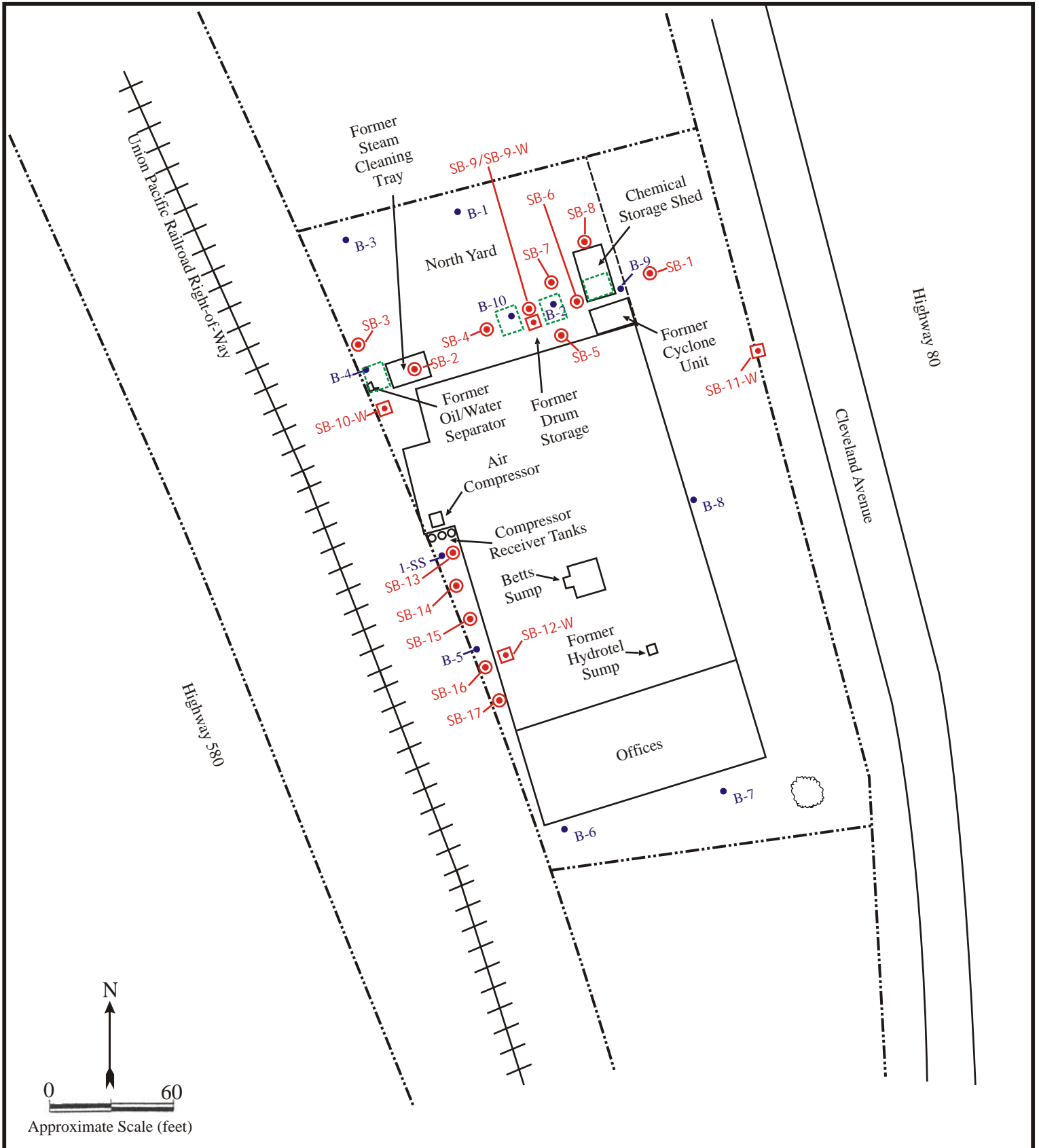

**LEGEND**

- Approximate Property Line
- Boring Completed by ERM prior to May 2004
- Proposed Soil Boring Location
- Proposed Grab Groundwater Sample Location
- North Yard Excavation Completed in 2004

**FACILITY SITE PLAN**



GE Healthcare  
 Caral Division  
 578 Cleveland Avenue  
 Albany, California  
 Clayton Project No. 70-04583.02.000

**FIGURE**

2

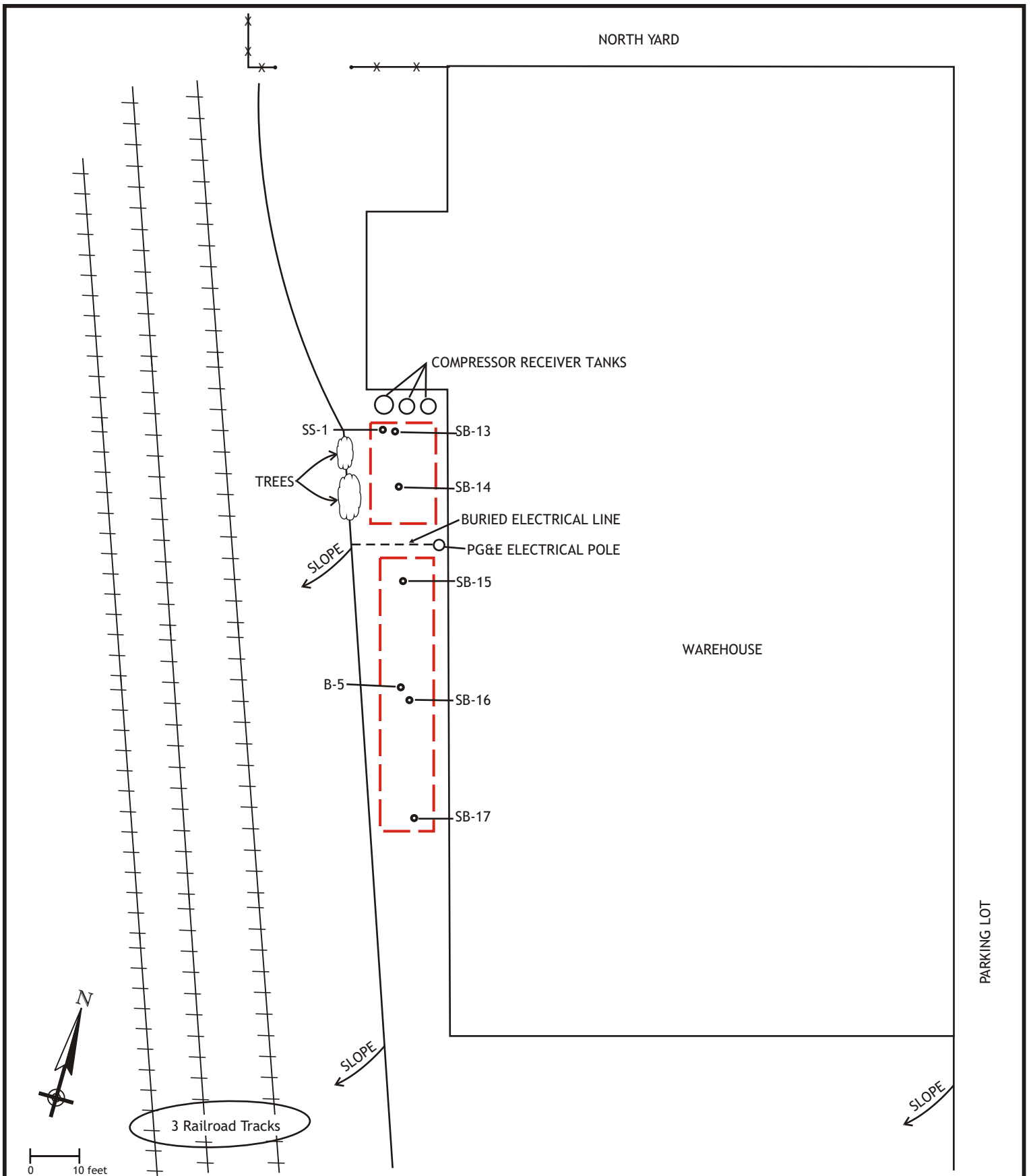

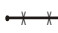

LEGEND	Proposed Excavation West of Warehouse	FIGURE	
 Areas to be Excavated to 3 Feet Deep  Fence	GE Healthcare Caral Division 578 Cleveland Avenue Albany, California Clayton Project No. 33104-004583.03	<h1>3</h1>	 <b>BUREAU</b> <b>VERITAS</b>



## **APPENDIX B**

**ALAMEDA COUNTY LETTER DATED AUGUST 18, 2006**

ALAMEDA COUNTY  
HEALTH CARE SERVICES

AGENCY  
DAVID J. KEARS, Agency Director



ENVIRONMENTAL HEALTH SERVICES  
ENVIRONMENTAL PROTECTION  
1131 Harbor Bay Parkway, Suite 250  
Alameda, CA 94502-6577  
(510) 567-6700  
FAX (510) 337-9335

August 18, 2006

Richard Rinck  
GE Healthcare  
389 Oyster Point Blvd.  
South San Francisco, CA 94080

August Blasquez and Paul Dresnick TRS  
P.O. Box 66571  
Scotts Valley, CA 95067

August Blasquez and Celia Villar  
7026 Santa Teresa Blvd.  
San Jose, CA 95139

Subject: SLIC Case No. RO0002874, GE Imatron/Caral Manufacturing, 578 Cleveland Avenue, Albany, CA

Dear Richard Rinck, August Blasquez and Paul Dresnick TRS, and Celia Villar:

Alameda County Environmental Health (ACEH) staff has reviewed the Spills, Leaks, Investigations, and Cleanups (SLIC) case file for the above-referenced site and the report entitled, "Remedial Action Work Plan," dated August 14, 2006, prepared on your behalf by Clayton Group Services, Inc. The Work Plan proposes to excavate soil along the west side of the warehouse building to a depth of 3 feet bgs to remove and dispose of soils containing elevated concentrations of metals. An estimated 111 cubic yards of soil would be transported off-site for disposal. The excavated soil would be replaced by clean fill. We generally concur with the proposed scope of work provided that the technical comments below are addressed during the remedial action.

We request that you address the following technical comments, perform the proposed work, and send us the technical reports requested below. Please provide 72-hour advance written notification to this office (e-mail preferred to [jerry.wickham@acgov.org](mailto:jerry.wickham@acgov.org)) prior to the start of field activities.

**TECHNICAL COMMENTS**

1. **Excavation Around Structures.** The area west of the warehouse contains several structures including the compressor receiver tanks, electrical pole, and buried electrical line. Although removal of soil to a depth of 3 feet may not be feasible, we request that surface soil around the structures and the edges of the building be removed to the maximum extent that is safe and practicable by hand excavation. Please present the results of the remedial excavation in the Remedial Excavation Report requested below.

### TECHNICAL REPORT REQUEST

Please submit technical reports to Alameda County Environmental Health (Attention: Jerry Wickham), according to the following schedule:

- **December 19, 2006** – Remedial Excavation Report

These reports are being requested pursuant to California Health and Safety Code Section 25296.10. 23 CCR Sections 2652 through 2654, and 2721 through 2728 outline the responsibilities of a responsible party in response to an unauthorized release from a petroleum UST system, and require your compliance with this request.

### ELECTRONIC SUBMITTAL OF REPORTS

Effective **January 31, 2006**, the Alameda County Environmental Cleanup Oversight Programs (LOP and SLIC) require submission of all reports in electronic form to the county's ftp site. Paper copies of reports will no longer be accepted. The electronic copy replaces the paper copy and will be used for all public information requests, regulatory review, and compliance/enforcement activities. Instructions for submission of electronic documents to the Alameda County Environmental Cleanup Oversight Program ftp site are provided on the attached "Electronic Report Upload (ftp) Instructions." Please do not submit reports as attachments to electronic mail.

Submission of reports to the Alameda County ftp site is an addition to existing requirements for electronic submittal of information to the State Water Resources Control Board (SWRCB) Geotracker website. Submission of reports to the Geotracker website does not fulfill the requirement to submit documents to the Alameda County ftp site. In September 2004, the SWRCB adopted regulations that require electronic submittal of information for groundwater cleanup programs. For several years, responsible parties for cleanup of leaks from underground storage tanks (USTs) have been required to submit groundwater analytical data, surveyed locations of monitor wells, and other data to the Geotracker database over the Internet. Beginning July 1, 2005, electronic submittal of a complete copy of all necessary reports was required in Geotracker (in PDF format). Please visit the SWRCB website for more information on these requirements ([http://www.swrcb.ca.gov/ust/cleanup/electronic\\_reporting](http://www.swrcb.ca.gov/ust/cleanup/electronic_reporting)).

### PERJURY STATEMENT

All work plans, technical reports, or technical documents submitted to ACEH must be accompanied by a cover letter from the responsible party that states, at a minimum, the following: "I declare, under penalty of perjury, that the information and/or recommendations contained in the attached document or report is true and correct to the best of my knowledge." This letter must be signed by an officer or legally authorized representative of your company. Please include a cover letter satisfying these requirements with all future reports and technical documents submitted for this fuel leak case.

Richard Rinck  
August Blasquez and Paul Dresnick TRS  
August Blasquez and Celia Villar  
August 18, 2006  
Page 3

PROFESSIONAL CERTIFICATION & CONCLUSIONS/RECOMMENDATIONS

The California Business and Professions Code (Sections 6735, 6835, and 7835.1) requires that work plans and technical or implementation reports containing geologic or engineering evaluations and/or judgments be performed under the direction of an appropriately registered or certified professional. For your submittal to be considered a valid technical report, you are to present site specific data, data interpretations, and recommendations prepared by an appropriately licensed professional and include the professional registration stamp, signature, and statement of professional certification. Please ensure all that all technical reports submitted for this fuel leak case meet this requirement.

UNDERGROUND STORAGE TANK CLEANUP FUND

Please note that delays in investigation, later reports, or enforcement actions may result in your becoming ineligible to receive grant money from the state's Underground Storage Tank Cleanup Fund (Senate Bill 2004) to reimburse you for the cost of cleanup.

AGENCY OVERSIGHT

If it appears as though significant delays are occurring or reports are not submitted as requested, we will consider referring your case to the Regional Board or other appropriate agency, including the County District Attorney, for possible enforcement actions. California Health and Safety Code, Section 25299.76 authorizes enforcement including administrative action or monetary penalties of up to \$10,000 per day for each day of violation.

If you have any questions, please call me at (510) 567-6791.

Sincerely,

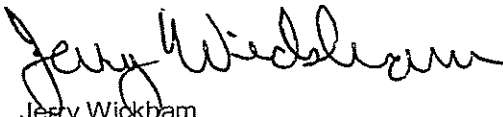

Jerry Wickham  
Hazardous Materials Specialist

Enclosure: ACEH Electronic Report Upload (ftp) Instructions

cc: Michael Zimmerman  
Clayton Group Services, Inc.  
6920 Koll Center Parkway  
Pleasanton, CA 94566

Donna Drogos, ACEH  
Jerry Wickham, ACEH  
File



**APPENDIX C**  
**NON-HAZARDOUS WASTE MANIFESTS**

Please print or type  
(Form designed for use on elite (12-pitch) typewriter.)

<b>NON-HAZARDOUS WASTE MANIFEST</b>		1. Generator's US EPA ID No. N/A	Manifest Document No. NH-009	2. Page 1 of 1
3. Generator's Name and Mailing Address 6E Healthcare, 389 Oyster Pt. Blvd, suite 8, South San Francisco, CA 94080				
4. Generator's Phone (415) 277-7729				
5. Transporter 1 Company Name Dio's Trucking/Doerbs		6. US EPA ID Number N/A		A. Transporter's Phone 510-236-7723
7. Transporter 2 Company Name		8. US EPA ID Number		B. Transporter's Phone
9. Designated Facility Name and Site Address Waste Mgt. Altamont Landfill 10840 Altamont Pass Rd Livermore, CA 94551			10. US EPA ID Number N/A	
11. Waste Shipping Name and Description			12. Containers No.   Type	13. Total Quantity
a. Non Hazardous waste solid (soil) - #cover class			001 DT 18	0Y
b.				
c.				
d.				
D. Additional Descriptions for Materials Listed Above			E. Handling Codes for Wastes Listed Above	
Profile # 55394200				
15. Special Handling Instructions and Additional Information Site GE Carol 578 Cleveland Ave Albany, CA 94710				
16. GENERATOR'S CERTIFICATION: I certify the materials described above on this manifest are not subject to federal regulations for reporting proper disposal of Hazardous Waste.				
Printed/Typed Name Dorie Boone Clayton Grayson		Signature Dorie Boone		Month Day Year 10 27 06
17. Transporter 1 Acknowledgement of Receipt of Materials				
Printed/Typed Name Antoine Walter		Signature AW		Month Day Year 10 26 06
18. Transporter 2 Acknowledgement of Receipt of Materials				
Printed/Typed Name		Signature		Month Day Year
19. Discrepancy Indication Space				
20. Facility Owner or Operator: Certification of receipt of waste materials covered by this manifest except as noted in Item 19.				
Printed/Typed Name		Signature		Month Day Year 10 26 06



ASTER Altamont Landfill Resource Recovery Original  
 Altamont Pass Road Ticket# 719048  
 ore, CA, 94561  
 25)455-7300

Environment Carrier GEN Altamont Generic  
 Vehicle# 9C42295W7 Volume  
 Container  
 BIBBS B4 W/  
 License#  
 Billing # 005825/  
 Gen EPA ID

Il Cover (NRC Env' GE Canal)  
 Canal

Scale	Deputy Weighmaster	Inbound	Gross	57260	lb
Scale Inbound	PRATTO		Tare	30700	lb
	PRATTO		Net	26560	lb
			Tons		13.28

%	Qty	UOM	Rate	Tax	Amount	Origin
	13.28	Tons				Albany

Total Tax  
 Total Ticket

The above described commodity was weighed, measured or counted by a weighmaster, a duly qualified person, or a scale operator, who is a recognized authority of accuracy, as prescribed by Chapter 7, Division 5 of the California Business and Professions Code, administered by the the California Dept. of Food and Agriculture.

<b>NON-HAZARDOUS WASTE MANIFEST</b>		1. Generator's US EPA ID No. <i>N/A</i>	Manifest Document No. <i>W4-0-10</i>	2. Page 1 of 1
3. Generator's Name and Mailing Address <i>GE Healthcare, 1789 Oyster Point, Suite 8 South San Francisco, CA 94080</i>				
4. Generator's Phone (650) <i>827-7729</i> <i>ATTN: Rich Pink</i>				
5. Transporter 1 Company Name <i>Pio's Trucking / Doc Bilbs</i>		6. US EPA ID Number <i>N/A</i>		A. Transporter's Phone <i>510 236-7723</i>
7. Transporter 2 Company Name		8. US EPA ID Number		B. Transporter's Phone
9. Designated Facility Name and Site Address <i>Waste Management Altamont Landfill 10840 Altamont Pass Road Livermore CA 94551</i>			10. US EPA ID Number <i>N/A</i>	
			C. Facility's Phone <i>925-455-7300</i>	
11. Waste Shipping Name and Description			12. Containers No.   Type	13. Total Quantity
a. <i>Non-Hazardous Waste Solid (soil) - Class II cover</i>			<i>001 DT</i>	<i>1.8 cY</i>
b.				
c.				
d.				
D. Additional Descriptions for Materials Listed Above  <i>Profile # 55394200</i>			E. Handling Codes for Wastes Listed Above	
15. Special Handling Instructions and Additional Information <i>Site: GE Carol 578 Cleveland Ave Albany CA 94176</i>				
16. GENERATOR'S CERTIFICATION: I certify the materials described above on this manifest are not subject to federal regulations for reporting proper disposal of Hazardous Waste.				
Printed/Typed Name <i>Deke Boase</i>		Signature <i>[Signature]</i>		Month Day Year <i>10   27   06</i>
17. Transporter 1 Acknowledgement of Receipt of Materials				
Printed/Typed Name <i>JD Giusi Transport</i>		Signature <i>[Signature]</i>		Month Day Year <i>10   27   06</i>
18. Transporter 2 Acknowledgement of Receipt of Materials				
Printed/Typed Name		Signature		Month Day Year
19. Discrepancy Indication Space				
20. Facility Owner or Operator: Certification of receipt of waste materials covered by this manifest except as noted in Item 19.				
Printed/Typed Name <i>[Signature]</i>		Signature <i>[Signature]</i>		Month Day Year <i>10   26   06</i>

GENERATOR

TRANSPORTER

FACILITY

MASTER-Altamont Landfill & Resource Recovery Original  
 Altamont Pab's Road Ticket# 718984  
 More, CA, 94551  
 (25)455-7300

Environment Carrier GEN Altamont Generic  
 Vehicle# 2GIUSTI Volume  
 Container  
 JD GIUSTI GZ  
 License#  
 Billing # 0038257  
 Gen EPA ID

II Cover "NRC Env" GE Caral  
 Caral

scale	Deputy Weighmaster	Inbound	Gross	60560	lb
scale	Inbound	RROJAS1841	Tare	32400	lb
		RROJAS1841	Net	28260	lb
			Tons		14.13

Qty	UOM	Rate	Tax	Amount	Origin
14.13	Tons				Albany

Total Tax  
 Total Ticket

The described commodity was weighed, measured or counted by a weighmaster, state, who is a recognized authority of accuracy, as prescribed by Chapter 7 Division 5 of the California Business and Professions Code, administered by the the California Dept. of Food and Agriculture.

7 0  
 421



<b>NON-HAZARDOUS WASTE MANIFEST</b>		1. Generator's US EPA ID No. <i>N/A</i>	Manifest Document No. <i>N.H 008</i>	2. Page 1 of 1
3. Generator's Name and Mailing Address <i>GE Healthcare, 1389 Oyster Point suite 8 South San Francisco CA 94080</i>				
4. Generator's Phone (650) <i>027 7729</i> <i>attn Rich Rinck</i>				
5. Transporter 1 Company Name <i>Pic's Trucking / Doc Bilbs</i>		6. US EPA ID Number <i>N/A</i>		A. Transporter's Phone <i>510 236-7723</i>
7. Transporter 2 Company Name		8. US EPA ID Number		B. Transporter's Phone
9. Designated Facility Name and Site Address <i>Waste Mgmt. Altamont Landfill 10840 Altamont Pass Road Livermore CA 94551</i>			10. US EPA ID Number <i>N/A</i>	
			C. Facility's Phone <i>925-4557300</i>	
11. Waste Shipping Name and Description			12. Containers No. Type	13. Total Quantity
a. <i>Non Hazardous waste Solid (solid) class II cover</i>			<i>001 DT</i>	<i>18</i>
b.				
c.				
d.				
D. Additional Descriptions for Materials Listed Above  <i>Profile # 55394200</i>			E. Handling Codes for Wastes Listed Above	
15. Special Handling Instructions and Additional Information <i>Site: GE Carol 578 Cleveland Ave Albany CA 94710</i>				
16. GENERATOR'S CERTIFICATION: I certify the materials described above on this manifest are not subject to federal regulations for reporting proper disposal of Hazardous Waste.				
Printed/Typed Name <i>G. Scott</i>		Signature <i>Guy Scott</i>		Month Day Year <i>11 02 06</i>
17. Transporter 1 Acknowledgement of Receipt of Materials				
Printed/Typed Name <i>Dante Boate signing for Clifton Group Services</i>		Signature <i>Dante Boate</i>		Month Day Year <i>11 02 06</i>
18. Transporter 2 Acknowledgement of Receipt of Materials				
Printed/Typed Name		Signature		Month Day Year
19. Discrepancy Indication Space				
20. Facility Owner or Operator: Certification of receipt of waste materials covered by this manifest except as noted in Item 19.				
Printed/Typed Name		Signature		Month Day Year

GENERATOR  
TRANSPORTER  
FACILITY

(-Altamont Landfill) & Resource Recovery Original  
 Mont Pass Road Ticket# 718981  
 CA, 94551  
 95-7300

Environment Carrier GEN Altamont Generic  
 Vehicle# 9D50919-WT Volume  
 Container  
 DOC BIBB TR-B9  
 License#  
 Billing # 0036257  
 Gen EPA ID

Over~NRC Env~ GE Carel)

Deputy Weighmaster Inbound	Gross	62520	lb
2 Outbound ken sr	Tare	33160	lb
ken sr	Net	29360	lb
	Tone		14.68

Qty	UDM	Rate	Tax	Amount	Origin
14.68	Tons				Albany

*VB*

Total Tax

ng described commodity was weighed, measured or counted by a weighmaster, date, who is a recognized authority of accuracy, as prescribed by Chapter 7 Division 5 of the California Business and Professions Code, administered by the the California Dept. of Food and Agriculture.

*[Signature]*



Please print or type  
(Form designed for use on elite (12-pitch) typewriter.)

**NON-HAZARDOUS  
WASTE MANIFEST**

1. Generator's US EPA ID No.

N.I.A. . . . .

Manifest Document No.  
N.H.W.D.#

2. Page 1  
of 1

3. Generator's Name and Mailing Address

GE Healthcare 289 Oyster Pt. Blvd. Ste 9  
South St. Field, CA 94050

4. Generator's Phone (650) 977-7721

5. Transporter 1 Company Name

Pacific Energy & Gas

6. US EPA ID Number

N.I.A. . . . .

A. Transporter's Phone

(510) 336-7723

7. Transporter 2 Company Name

8. US EPA ID Number

. . . . .

B. Transporter's Phone

9. Designated Facility Name and Site Address

Waste Management Authority L.P. #1  
10840 Altamont Road  
Lawrence, GA 30551

10. US EPA ID Number

N.I.A. . . . .

C. Facility's Phone

(478) 455-7300

11. Waste Shipping Name and Description

a. Non-hazardous waste, solid (sol.) Class II (cont)

12. Containers  
No. Type

0-0-1 . . . . .

13. Total  
Quantity

. . . . .

14. Unit  
Wt/Val

cy

D. Additional Descriptions for Materials Listed Above

Profile # 55394200

E. Handling Codes for Wastes Listed Above

15. Special Handling Instructions and Additional Information

SITE CELL  
573 Circuit Ave.  
Ft. Belknap, CA 94716

16. GENERATOR'S CERTIFICATION: I certify the materials described above on this manifest are not subject to federal regulations for reporting proper disposal of Hazardous Waste.

Printed/Typed Name

M. J. Zimmian (signature) GE

Signature

(signature)

Month Day Year

1 2 2 5 0 6

17. Transporter 1 Acknowledgement of Receipt of Materials

Printed/Typed Name

x Antoinette Mathew

Signature

(signature)

Month Day Year

1 0 2 6 0 6

18. Transporter 2 Acknowledgement of Receipt of Materials

Printed/Typed Name

Signature

Month Day Year

. . . . .

19. Discrepancy Indication Space

20. Facility Owner or Operator: Certification of receipt of waste materials covered by this manifest except as noted in Item 19.

Printed/Typed Name

Kim Brown

Signature

Month Day Year

1 0 2 6 0 6

GENERATOR

TRANSPORTER

FACILITY

Altamont Landfill & Resource Recovery Original  
 Front Pass Road Ticket# 718905  
 CA, 94551  
 95-7300

Environment Carrier GEN Altamont Generic  
 Vehicle# 9C42295WT Volume  
 Container  
 BIBBS B4 WT  
 License#  
 Billing # 0038257  
 Gen EPA ID

Cover\*(NRC Env\* GE Canal)

Deputy Weighmaster Inbound	Gross	55000	lb
Inbound KEN SR	Tare	30700	lb
Outbound rrojasi1841	Net	34300	lb
	Tons		17.19

Qty	UDM	Rate	Tax	Amount	Origin
17.19	Tons				Albany

Total Tax

The above described commodity was weighed, measured or counted by a weighmaster, state, who is a recognized authority of accuracy, as prescribed by Chapter 7 Division 5 of the California Business and Professions Code, administered by the the California Dept. of Food and Agriculture.



<b>NON-HAZARDOUS WASTE MANIFEST</b>		1. Generator's US EPA ID No. <i>NIA</i>	Manifest Document No. <i>NH-0-0-5</i>	2. Page 1 of 1
3. Generator's Name and Mailing Address <i>GE Healthcare, 339 Oyster Point Blvd, Suite B South San Francisco, CA 94080</i>				
4. Generator's Phone ( <i>650</i> ) <i>827-7729</i> Attn: <i>Rich Rinck</i>				
5. Transporter 1 Company Name <i>Pio's Trucking / Doc Bibbs</i>		6. US EPA ID Number <i>NIA</i>		A. Transporter's Phone <i>(510) 236-7723</i>
7. Transporter 2 Company Name		8. US EPA ID Number		B. Transporter's Phone
9. Designated Facility Name and Site Address <i>Waste Management Altamont Landfill 10840 Altamont Pass Road Livermore, CA 94551</i>			10. US EPA ID Number <i>NIA</i>	
			C. Facility's Phone <i>(925) 455-7300</i>	
11. Waste Shipping Name and Description  <i>a. Non Hazardous waste, solid (soil) - Class II cover</i>			12. Containers No.	13. Total Quantity
			Type	14. Unit Wt/Vol
			<i>0.01</i>	<i>P.T.</i>
			<i>1.8</i>	<i>cy</i>
D. Additional Descriptions for Materials Listed Above <i>Profile # 55394200</i>			E. Handling Codes for Wastes Listed Above	
15. Special Handling Instructions and Additional Information  <i>SITE: GE Barad 578 Cleveland Ave. Albany, CA 94710</i>				
16. GENERATOR'S CERTIFICATION: I certify the materials described above on this manifest are not subject to federal regulations for reporting proper disposal of Hazardous Waste.				
Printed/Typed Name <i>Mike Zimmerman</i>		Signature <i>[Signature]</i>		Month Day Year <i>10   25   06</i>
17. Transporter 1 Acknowledgement of Receipt of Materials		Printed/Typed Name <i>JD GUSTI TRANSPORT</i>		Signature <i>[Signature]</i>
18. Transporter 2 Acknowledgement of Receipt of Materials		Printed/Typed Name		Signature
19. Discrepancy Indication Space				
20. Facility Owner or Operator: Certification of receipt of waste materials covered by this manifest except as noted in Item 19.				
Printed/Typed Name		Signature <i>Kim B...</i>		Month Day Year <i>10   26   06</i>

GENERATOR

TRANSPORTER

FACILITY



Altamont Landfill & Resource Recovery Original  
 Mont Pass Road Ticket# 718816  
 CA, 94551  
 IS-7300

Environment Carrier GEN Altamont Generic  
 Vehicle# 26IU8TI Volume  
 Container  
 JD 6IU8TI B2  
 License#  
 Billing # 0038257  
 Gen EPA ID

(over~NRC Env~ GE Daral)

Deputy Weighmaster Inbound	Gross	67320	1b
Inbound KEN SR	Tare	32400	1b
Outbound RROJAS1841	Net	34920	1b
	Tons		17.46

Qty	UOM	Rate	Tax	Amount	Origin
7.46	Tons				Albany

Total Tax

ng described commodity was weighed, measured or counted by a weighmaster, date, who is a recognized authority of accuracy, as prescribed by Chapter 7 Division 5 of the California Business and Professions Code, administered by the the California Dept. of Food and Agriculture.

*Handwritten signature and initials*



<b>NON-HAZARDOUS WASTE MANIFEST</b>		1. Generator's US EPA ID No. <i>.N/A.</i>	Manifest Document No. <i>NH008</i>	2. Page 1 of 1
3. Generator's Name and Mailing Address <i>GE Healthcare 389 Oyster Point, Suite 8 South San Francisco CA 94080</i>				
4. Generator's Phone <i>(650) 827-7229</i> Attn: <i>Rich Rinck</i>				
5. Transporter 1 Company Name <i>Pio's Trucking / Doc Bibbs</i>		6. US EPA ID Number <i>. . . N/A . . . . .</i>		A. Transporter's Phone <i>510-236-7723</i>
7. Transporter 2 Company Name		8. US EPA ID Number		B. Transporter's Phone
9. Designated Facility Name and Site Address <i>Waste Management Altamont Landfill 10840 Altamont Pass Road Livermore CA 94551</i>			10. US EPA ID Number <i>. . . N/A . . . . .</i>	
11. Waste Shipping Name and Description			12. Containers	13. Total Quantity
a. <i>Non Hazardous Waste Solid (soil) - class II cover</i>			No. <i>001</i>	Type <i>DT</i>
b.				<i>.18</i>
c.				
d.				<i>cy</i>
D. Additional Descriptions for Materials Listed Above <i>Profile # 55394200</i>			E. Handling Codes for Wastes Listed Above	
15. Special Handling Instructions and Additional Information  <i>Site: GE Carol 578 Cleveland Ave Albany CA 94710</i>				
16. GENERATOR'S CERTIFICATION: I certify the materials described above on this manifest are not subject to federal regulations for reporting proper disposal of Hazardous Waste.				
Printed/Typed Name <i>Clayton Group Services Joe Moulton agent for GE Healthcare</i>		Signature <i>[Signature]</i>		Month Day Year <i>. . . . .</i>
17. Transporter 1 Acknowledgement of Receipt of Materials		Printed/Typed Name <i>[Signature] G. SCOTT</i>		Signature <i>[Signature]</i>
18. Transporter 2 Acknowledgement of Receipt of Materials		Printed/Typed Name		Signature <i>[Signature]</i>
19. Discrepancy Indication Space				
20. Facility Owner or Operator: Certification of receipt of waste materials covered by this manifest except as noted in Item 19.				
Printed/Typed Name		Signature <i>[Signature]</i>		Month Day Year <i>10/26/06</i>

GENERATOR

TRANSPORTER

FACILITY

ASTER-Altamont Landfill Resource Recovery Original  
 Altamont Pass Road Ticket# 718814  
 ore, CA, 94551  
 25)455-7300

rc Environment Carrier GEN Altamont Generic  
 Vehicle# 9U50919-WR Volume  
 Container  
 DDC B166 TR-B9  
 License#  
 Billing # 0038257  
 Gen EPA ID

U Cover NKC Env GE Caral)  
 Caral

scale	Deputy Weighmaster Inbound	Gross	67860	lb
scale Inbound	KEN SR	Tare	33160	lb
	KEN SR	Net	34700	lb
		Tons		17.35

* Qty	UOM	Rate	Tax	Amount	Origin
17.35	Tons				Albany

*ICB*

Total Tax  
 Total Freight

ng described commodity was weighed, measured or counted by a weighmaster,  
 :ate, who is a recognized authority of accuracy, as prescribed by Chapter 7  
 Division 5 of the California Business and Professions Code, administered by the  
 the California Dept. of Food and Agriculture.

*[Signature]*



ASTER-Altamont Landfill Resource Recovery Original  
 Altamont Pass Road Ticket# 718896  
 Ore, CA, 94551  
 25)486-7400

Environment Carrier GEN ALTAMONT Generic  
 Vehicle# 9050919-WT Volume  
 Container  
 DOT 2166 TR-be  
 License#  
 Billing # 8038257  
 Gen EPA 10

II Cover (MRC Env/ BE Caral)  
 Caral

Scale	Deputy Weighmaster Inbound	Gross	67480	lb
Scale Inbound	Ken sr	Tare	33160	lb
	Ken sr	Net	34320	lb
		Tons		17.16

Qty	Unit	Rate	Tax	Amount	Origin
17.16	Tons				Albany

Total Tax  
 Total Ticket

The following described commodity was weighed, measured or counted by a weighmaster, state, who is a recognized authority of accuracy, as prescribed by Chapter 7 Division 5 of the California Business and Professions Code, administered by the California Dept. of Food and Agriculture.

Please print or type  
(Form designed for use on a 12-pitch typewriter.)

**NON-HAZARDOUS  
WASTE MANIFEST**

1. Generator's US EPA ID No.

N/A.

Manifest Document No.  
M# 004

2. Page 1  
of 1

10/25/06

3. Generator's Name and Mailing Address  
GE Healthcare, 389 Oyster Point Suite 8  
South San Francisco CA 94080

4. Generator's Phone (650) 827 7729 attn: Rich Rinck

5. Transporter 1 Company Name  
Pio's Trucking / Doc Bibbs

6. US EPA ID Number  
N/A.

A. Transporter's Phone  
510 236 7723

7. Transporter 2 Company Name

8. US EPA ID Number

B. Transporter's Phone

9. Designated Facility Name and Site Address  
Waste Management Altamont Landfill  
10840 Altamont Pass Road  
Livermore CA 94551

10. US EPA ID Number  
N/A.

C. Facility's Phone  
925-455-7300

11. Waste Shipping Name and Description

a. Non hazardous waste Solid (sn) Class II C.U.D.

12. Containers  
No. Type

13. Total Quantity  
18

14. Unit  
CY

b.

c.

d.

D. Additional Descriptions for Materials Listed Above

Profile # 55394200

E. Handling Codes for Wastes Listed Above

15. Special Handling Instructions and Additional Information

Site Ge Carol  
578 Cleveland Ave  
Albany CA 94710

16. GENERATOR'S CERTIFICATION: I certify the materials described above on this manifest are not subject to federal regulations for reporting proper disposal of Hazardous Waste.

Printed/Typed Name Clayton Group Services  
Joe Moulton agent for GE Healthcare

Signature [Signature]

Month Day Year  
10 25 06

17. Transporter 1 Acknowledgement of Receipt of Materials

Printed/Typed Name CRAIG LAMUN

Signature [Signature]

Month Day Year  
10 25 06

18. Transporter 2 Acknowledgement of Receipt of Materials

Printed/Typed Name

Signature

Month Day Year

19. Discrepancy Indication Space

20. Facility Owner or Operator: Certification of receipt of waste materials covered by this manifest except as noted in Item 19.

Printed/Typed Name

Signature [Signature]

Month Day Year  
10 25 06

GENERATOR

TRANSPORTER

FACILITY

~~ASTER~~ ~~Altamont~~ ~~Landfill~~ & Resource Recovery Original  
 Altamont Pass Road Ticket# 718689  
 Ore, CA, 94551  
 (25)455-7300

Environment Carrier GEN Altamont Generic  
 Vehicle# 9A99180 Volume  
 Container  
 PIUS TRUCKING 57  
 License#  
 Billing # 0036257  
 Gen EPA ID

(11 Cover (NRC Env/ SE Canal)  
 Canal

Scale	Deputy Weighmaster Inbound	Gross	70940	lb
Scale Inbound	Ken sr	Tare	33680	lb
	Ken sr	Net	36760	lb
		Tons		18.38

Qty	UOM	Rate	Tax	Amount	Origin
18.38	Tons				Albany

*Handwritten initials*

Total Tons  
Total Ticks

If described commodity was weighed, measured or counted by a weighmaster,  
 scale, or other recognized authority of accuracy, as prescribed by Chapter 7  
 Division 5 of the California Business and Professions Code, administered by the  
 the California Dept. of Food and Agriculture.

*Handwritten signature*



Please print or type  
(Form designed for use on a 12-pitch typewriter.)

**NON-HAZARDOUS  
WASTE MANIFEST**

1. Generator's US EPA ID No.  
N/A

Manifest Document No.  
M#004

2. Page 1  
of 1

10/25/06

3. Generator's Name and Mailing Address  
GE Healthcare, 389 Oyster Point Suite 8  
South San Francisco CA 94080

4. Generator's Phone (650) 827 7729 attn: Rich Rinck

5. Transporter 1 Company Name  
Pio's Trucking / Doc Bibbs

6. US EPA ID Number  
N/A

A. Transporter's Phone  
510 236 7723

7. Transporter 2 Company Name

8. US EPA ID Number

B. Transporter's Phone

9. Designated Facility Name and Site Address  
Waste Management Altamont landfill  
10840 Altamont Pass Road  
Livermore CA 94551

10. US EPA ID Number  
N/A

C. Facility's Phone  
925-455-7300

11. Waste Shipping Name and Description

12. Containers  
No. Type

a. Non hazardous waste Solid (50') Class II C.L.D.

13. Total Quantity  
18  
14. Unit  
CY

b.

c.

d.

D. Additional Descriptions for Materials Listed Above  
Profile # 55394200

E. Handling Codes for Wastes Listed Above

15. Special Handling Instructions and Additional Information  
Site Ge Carol  
578 Cleveland Ave  
Albany CA 94710

16. GENERATOR'S CERTIFICATION: I certify the materials described above on this manifest are not subject to federal regulations for reporting proper disposal of Hazardous Waste.

Printed/Typed Name Clayton Group Services  
Joe Moulton agent for GE Healthcare

Signature [Signature]

Month Day Year  
10 25 06

17. Transporter 1 Acknowledgement of Receipt of Materials  
Printed/Typed Name CRAIG LAMUN  
Signature Craig Lamun  
Month Day Year 10 25 06

18. Transporter 2 Acknowledgement of Receipt of Materials  
Printed/Typed Name  
Signature  
Month Day Year

19. Discrepancy Indication Space

20. Facility Owner or Operator: Certification of receipt of waste materials covered by this manifest except as noted in Item 19.

Printed/Typed Name

Signature Ken Brown

Month Day Year  
10 25 06

GENERATOR  
TRANSPORTER  
FACILITY

Altaont 411 Resource Recovery Original  
 ont Pass Road Ticket# 718582  
 CA, 94551  
 5-7300

Environment Carrier GEN Altaont Generic  
 Vehicle# 9D50919-WT Volume  
 Container  
 DOC B12B 1R-B9  
 License#  
 Billing # 0038257  
 Gen EPA ID

over (MHC Env GE Canal)

Deputy Weighmaster Inbound	Gross	68140	lb
Inbound RRDJAS1841	Tare	33160	lb
Outba pratto	Net	34980	lb
	Tons		17.49

Qty	UOM	Rate	Tax	Amount	Origin
7.49	Tons				Albany

Total Tax

ng described commodity was weighed, measured or counted by a weighmaster,  
 ate, who is a recognized authority of accuracy, as prescribed by Chapter 7  
 Division 5 of the California Business and Professions Code, administered by the  
 the California Dept. of Food and Agriculture.

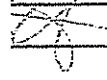



57 9A99180  
67600

Please print or type  
(Form designed for use on 41/4 (12-pitch) typewriter.)

NON-HAZARDOUS WASTE MANIFEST		1. Generator's US EPA ID No.	Manifest Document No.	2. Page 1 of 1	
3. Generator's Name and Mailing Address 66 Heathcote, 309 1/2 Ave. Road, Suite 3, S. Highway 100, CA 94710		6. US EPA ID Number W.I.A.		A. Transporter's Phone 510-236-7723	
4. Generator's Phone ( ) 927-7777		7. Transporter 1 Company Name P.O. Box 2085		B. Transporter's Phone	
5. Transporter 2 Company Name		8. US EPA ID Number		C. Facility's Phone 425-455-7000	
9. Designated Facility Name and Site Address 1050 1st St, Alameda, CA 94501		10. US EPA ID Number			
11. Waste Shipping Name and Description			12. Containers No.	13. Total Quantity	14. Unit Wt/Vol
a. Misc. Hazardous Waste, Class II			1	1	100
b.					
c.					
d.					
D. Additional Descriptions for Materials Listed Above Part # 55394200			E. Handling Codes for Wastes Listed Above		
15. Special Handling Instructions and Additional Information SITE: 66 HWY 1 575 CIVILIAN AVE. ALB., CA 94710					
16. GENERATOR'S CERTIFICATION: I certify the materials described above on this manifest are not subject to federal regulations for reporting proper disposal of Hazardous Waste.					
Printed/Typed Name M. J. [Signature]		Signature		Month Day Year 10 25 90	
17. Transporter 1 Acknowledgement of Receipt of Materials					
Printed/Typed Name C. [Signature]		Signature		Month Day Year 10 25 90	
18. Transporter 2 Acknowledgement of Receipt of Materials					
Printed/Typed Name		Signature		Month Day Year	
19. Discrepancy Indication Space					
20. Facility Owner or Operator: Certification of receipt of waste materials covered by this manifest except as noted in Item 19.					
Printed/Typed Name [Signature]		Signature		Month Day Year 10 25 90	

GENERATOR

TRANSPORTER

FACILITY

Altamont Sanfill & Resource Recovery Original  
 mt Pass Road Ticket# 718581  
 CR, 94551  
 1-7300

Environment Carrier GEN Altamont Generic  
 Vehicle# 9499180 Volume  
 Container  
 PIDS TRUCKING 57  
 License#  
 Billing # 0038227  
 Gen EPA ID

over\*(NRC Env\* GE Daral)

Deputy Weighmaster Inbound	Gross	67540	lb
Inbound RRCJAS1841	Tare	33680	lb
Outbound pratto	Net	33860	lb
	Tons		16.98

Qty	Unit	Rate	Tax	Amount	Origin
16.98	Tons				Albany

Total Tax

ig described commodity was weighed, measured or counted by a weighmaster, ate, who is a recognized authority of accuracy, as prescribed by Chapter 7 Division 5 of the California Business and Professions Code, administered by the he California Dept. of Food and Agriculture.



<b>NON-HAZARDOUS WASTE MANIFEST</b>		1. Generator's US EPA ID No. N/A	Manifest Document No. N.H.002	2. Page 1 of 1	10/25/2006
3. Generator's Name and Mailing Address GE Healthcare, 389 Oyster Point BLVD, Suite 8 South San Francisco CA 94080					
4. Generator's Phone (650) 827 7729 ATTN: Rich Rinck					
5. Transporter 1 Company Name Pio's Trucking / DE Bilbs			6. US EPA ID Number N/A		A. Transporter's Phone 510 236-7723
7. Transporter 2 Company Name			8. US EPA ID Number		B. Transporter's Phone
9. Designated Facility Name and Site Address Waste Management Altamont Landfill 10800 Altamont Pass Road Livermore CA 94551				10. US EPA ID Number N/A	
				C. Facility's Phone 925 455 7300	
11. Waste Shipping Name and Description a. Non Hazardous waste, Solid (soil) - Class II cover b. c. d.				12. Containers	
				No. Type	
				00.1 . . . 15 CY	
				. . . . .	
				. . . . .	
D. Additional Descriptions for Materials Listed Above Profile #55394200 Site: GE Carol ; 578 Cleveland Ave Albany, CA 94710				E. Handling Codes for Wastes Listed Above	
15. Special Handling Instructions and Additional Information					
16. GENERATOR'S CERTIFICATION: I certify the materials described above on this manifest are not subject to federal regulations for reporting proper disposal of Hazardous Waste.					
Printed/Typed Name Clayton Group Services Joe Moulton agent for GE Health		Signature 		Month Day Year 10 25 06	
17. Transporter 1 Acknowledgement of Receipt of Materials		Printed/Typed Name G. Scott		Signature 	
18. Transporter 2 Acknowledgement of Receipt of Materials		Printed/Typed Name		Signature	
19. Discrepancy Indication Space					
20. Facility Owner or Operator: Certification of receipt of waste materials covered by this manifest except as noted in Item 19.					
Printed/Typed Name		Signature		Month Day Year	

<b>NON-HAZARDOUS WASTE MANIFEST</b>		1. Generator's US EPA ID No. N/A	Manifest Document No. NH-0-0-1	2. Page 1 of 1	10/25/06		
3. Generator's Name and Mailing Address GE Healthcare, 389 Oyster Point Blvd, Suite 8, South San Francisco, CA 94080							
4. Generator's Phone (650) 827-7729 ATTN: RICH RINCK							
5. Transporter 1 Company Name Pro's Trucking / OBC Bibbs		6. US EPA ID Number N/A		A. Transporter's Phone (510) 236-7723			
7. Transporter 2 Company Name		8. US EPA ID Number		B. Transporter's Phone			
9. Designated Facility Name and Site Address Waste Management Altamont Landfill 10840 Altamont Pass Road Livermore, CA 94551				10. US EPA ID Number N/A			
				C. Facility's Phone 925 455-7300			
11. Waste Shipping Name and Description				12. Containers No.	13. Total Quantity		
				a. Non Hazardous Waste, Solid (soil) - class II cover		001	1.8 CY
				b.			
				c.			
				d.			
D. Additional Descriptions for Materials Listed Above Profile # 55394200				E. Handling Codes for Wastes Listed Above			
15. Special Handling Instructions and Additional Information SITE: GE Canal 578 Cleveland Ave. Albany, CA 94710							
16. GENERATOR'S CERTIFICATION: I certify the materials described above on this manifest are not subject to federal regulations for reporting proper disposal of Hazardous Waste.							
Printed/Typed Name Mike Zimmerman		Signature <i>[Signature]</i>		Month Day Year 10 25 06			
17. Transporter 1 Acknowledgement of Receipt of Materials							
Printed/Typed Name CHRIS LAMUN		Signature <i>[Signature]</i>		Month Day Year .			
18. Transporter 2 Acknowledgement of Receipt of Materials							
Printed/Typed Name		Signature		Month Day Year			
19. Discrepancy Indication Space							
20. Facility Owner or Operator: Certification of receipt of waste materials covered by this manifest except as noted in Item 19.							
Printed/Typed Name		Signature		Month Day Year			

GENERATOR

TRANSPORTER

FACILITY

57  
9A99180  
67600

Please print or type  
(Form designed for use on elite (12-pitch) typewriter.)

<b>NON-HAZARDOUS WASTE MANIFEST</b>	1. Generator's US EPA ID No. N/A	Manifest Document No. N/A	2. Page 1 of 1	10/5/06
-------------------------------------	-------------------------------------	------------------------------	----------------	---------

3. Generator's Name and Mailing Address GE Healthcare; 389 West Point Blvd, Suite 8, Somerville, MA 01906		4. Generator's Phone (508) 927-7779 ATTN: RICH RIVICK	
5. Transporter 1 Company Name Pio's Transport	6. US EPA ID Number N/A	A. Transporter's Phone (508) 236-7723	
7. Transporter 2 Company Name	8. US EPA ID Number	B. Transporter's Phone	
9. Designated Facility Name and Site Address Waste Management Assoc. 1000 10012 Ave. in 15 Days Road Lafayette, CA 94503		10. US EPA ID Number N/A	C. Facility's Phone 925 455-7300

11. Waste Shipping Name and Description	12. Containers		13. Total Quantity	14. Unit Wt/Vol
	No.	Type		
a. Non-Hazardous Waste, 2nd Class - Class II SWC	1	DRUM	1	DRUM
b.				
c.				
d.				

D. Additional Descriptions for Materials Listed Above Product # 55374200	E. Handling Codes for Wastes Listed Above
---	---

15. Special Handling Instructions and Additional Information  
SITE:  
GE Camt  
575 Cleveland Ave.  
Albany, CA 94710

16. GENERATOR'S CERTIFICATION: I certify the materials described above on this manifest are not subject to federal regulations for reporting proper disposal of Hazardous Waste.

Printed/Typed Name GUYTON GIUFFRÈ MGR. Environmental and Mfg. of Hardware	Signature <i>Guyton Giuffrè</i>	Month Day Year 10 5 06
17. Transporter 1 Acknowledgement of Receipt of Materials Printed/Typed Name CHRIS LAMUCA	Signature <i>Chris Lamuca</i>	Month Day Year 10 5 06
18. Transporter 2 Acknowledgement of Receipt of Materials Printed/Typed Name	Signature	Month Day Year

19. Discrepancy Indication Space

20. Facility Owner or Operator: Certification of receipt of waste materials covered by this manifest except as noted in Item 19.		
Printed/Typed Name <i>RJ</i>	Signature <i>RJ</i>	Month Day Year 10 5 06

GENERATOR

TRANSPORTER

FACILITY





**APPENDIX D**  
**LABORATORY ANALYTICAL DATA SHEETS**



Lead			
Lab #:	189855	Location:	GE Healthcare Caral
Client:	Clayton Group Services	Prep:	WET
Project#:	STANDARD	Analysis:	EPA 6010B
Analyte:	Lead	Batch#:	118578
Field ID:	1-4 POINT COMP.	Sampled:	10/04/06
Matrix:	WET Leachate	Received:	10/04/06
Units:	ug/L	Prepared:	10/19/06
Diln Fac:	10.00	Analyzed:	10/19/06

Type	Lab ID	Result	RL
SAMPLE	189855-001	4,800	150
BLANK	QC360941	ND	150

ND= Not Detected  
 RL= Reporting Limit

Batch QC Report

Lead			
Lab #:	189855	Location:	GE Healthcare Caral
Client:	Clayton Group Services	Prep:	WET
Project#:	STANDARD	Analysis:	EPA 6010B
Analyte:	Lead	Batch#:	118578
Field ID:	1-4 POINT COMP.	Sampled:	10/04/06
MSS Lab ID:	189855-001	Received:	10/04/06
Matrix:	WET Leachate	Prepared:	10/19/06
Units:	ug/L	Analyzed:	10/19/06

Type	Lab ID	Spiked	Result	%REC	Limits	RPD	Lim	Diln	Fac
BS	QC360942	2,000	1,998	100	80-120			1.000	
BSD	QC360943	2,000	1,990	100	80-120	0	20	1.000	
MS	QC360944		NA						
MSD	QC360945	10,000	15,110	103	70-120	4	20	10.00	

NA= Not Analyzed

RPD= Relative Percent Difference

**CASE NARRATIVE**

Laboratory number: 189855  
Client: Clayton Group Services  
Location: GE Healthcare Caral  
Request Date: 10/04/06  
Samples Received: 10/04/06

This hardcopy data package contains sample and QC results for one three-point soil composite, requested for the above referenced project on 10/04/06. The samples were received on ice and intact.

**Metals (EPA 6010B and EPA 7471A):**

No analytical problems were encountered.

### California Title 26 Metals

Lab #:	189855	Project#:	STANDARD
Client:	Clayton Group Services	Location:	GE Healthcare Caral
Field ID:	1-4 POINT COMP.	Diln Fac:	1.000
Lab ID:	189855-001	Sampled:	10/04/06
Matrix:	Soil	Received:	10/04/06
Units:	mg/Kg	Analyzed:	10/05/06
Basis:	as received		

Analyte	Result	RL	Batch#	Prepared	Prep	Analysis
Antimony	ND	3.0	118137	10/04/06	EPA 3050B	EPA 6010B
Arsenic	2.9	0.25	118137	10/04/06	EPA 3050B	EPA 6010B
Barium	120	0.50	118137	10/04/06	EPA 3050B	EPA 6010B
Beryllium	0.39	0.10	118137	10/04/06	EPA 3050B	EPA 6010B
Cadmium	0.41	0.25	118137	10/04/06	EPA 3050B	EPA 6010B
Chromium	13	0.50	118137	10/04/06	EPA 3050B	EPA 6010B
Cobalt	4.2	1.0	118137	10/04/06	EPA 3050B	EPA 6010B
Copper	34	0.50	118137	10/04/06	EPA 3050B	EPA 6010B
Lead	56	0.15	118137	10/04/06	EPA 3050B	EPA 6010B
Mercury	0.26	0.020	118172	10/05/06	METHOD	EPA 7471A
Molybdenum	1.2	1.0	118137	10/04/06	EPA 3050B	EPA 6010B
Nickel	14	1.0	118137	10/04/06	EPA 3050B	EPA 6010B
Selenium	ND	0.25	118137	10/04/06	EPA 3050B	EPA 6010B
Silver	ND	0.25	118137	10/04/06	EPA 3050B	EPA 6010B
Thallium	ND	0.25	118137	10/04/06	EPA 3050B	EPA 6010B
Vanadium	20	0.50	118137	10/04/06	EPA 3050B	EPA 6010B
Zinc	100	1.0	118137	10/04/06	EPA 3050B	EPA 6010B

ND= Not Detected  
 RL= Reporting Limit



## Batch QC Report

California Title 26 Metals			
Lab #:	189855	Location:	GE Healthcare Caral
Client:	Clayton Group Services	Prep:	EPA 3050B
Project#:	STANDARD	Analysis:	EPA 6010B
Type:	BLANK	Diln Fac:	1.000
Lab ID:	QC359038	Batch#:	118137
Matrix:	Soil	Prepared:	10/04/06
Units:	mg/Kg	Analyzed:	10/05/06
Basis:	as received		

Analyte	Result	RL
Antimony	ND	3.0
Arsenic	ND	0.25
Barium	ND	0.50
Beryllium	ND	0.10
Cadmium	ND	0.25
Chromium	ND	0.50
Cobalt	ND	1.0
Copper	ND	0.50
Lead	ND	0.15
Molybdenum	ND	1.0
Nickel	ND	1.0
Selenium	ND	0.25
Silver	ND	0.25
Thallium	ND	0.25
Vanadium	ND	0.50
Zinc	ND	1.0

ND= Not Detected

RL= Reporting Limit

## Batch QC Report

California Title 26 Metals			
Lab #:	189855	Location:	GE Healthcare Caral
Client:	Clayton Group Services	Prep:	EPA 3050B
Project#:	STANDARD	Analysis:	EPA 6010B
Matrix:	Soil	Batch#:	118137
Units:	mg/Kg	Prepared:	10/04/06
Basis:	as received	Analyzed:	10/05/06
Diln Fac:	1.000		

Type: BS Lab ID: QC359039

Analyte	Spiked	Result	%REC	Limits
Antimony	100.0	94.30	94	80-120
Arsenic	50.00	46.54	93	80-120
Barium	100.0	98.91	99	80-120
Beryllium	2.500	2.561	102	80-120
Cadmium	10.00	9.977	100	80-120
Chromium	100.0	96.86	97	80-120
Cobalt	25.00	23.30	93	80-120
Copper	12.50	11.81	94	80-120
Lead	100.0	90.81	91	80-120
Molybdenum	20.00	20.03	100	80-120
Nickel	25.00	23.18	93	80-120
Selenium	50.00	46.77	94	80-120
Silver	10.00	9.009	90	80-120
Thallium	50.00	45.60	91	80-120
Vanadium	25.00	24.11	96	80-120
Zinc	25.00	24.72	99	80-120

Type: BSD Lab ID: QC359040

Analyte	Spiked	Result	%REC	Limits	RPD	Lim
Antimony	100.0	92.63	93	80-120	2	20
Arsenic	50.00	46.15	92	80-120	1	20
Barium	100.0	96.92	97	80-120	2	20
Beryllium	2.500	2.511	100	80-120	2	20
Cadmium	10.00	9.850	98	80-120	1	20
Chromium	100.0	94.98	95	80-120	2	20
Cobalt	25.00	23.00	92	80-120	1	20
Copper	12.50	11.62	93	80-120	2	20
Lead	100.0	89.68	90	80-120	1	20
Molybdenum	20.00	19.90	100	80-120	1	20
Nickel	25.00	22.89	92	80-120	1	20
Selenium	50.00	45.64	91	80-120	2	20
Silver	10.00	8.903	89	80-120	1	20
Thallium	50.00	45.07	90	80-120	1	20
Vanadium	25.00	23.80	95	80-120	1	20
Zinc	25.00	24.37	97	80-120	1	20

RPD= Relative Percent Difference

## Batch QC Report

California Title 26 Metals			
Lab #:	189855	Location:	GE Healthcare Caral
Client:	Clayton Group Services	Prep:	EPA 3050B
Project#:	STANDARD	Analysis:	EPA 6010B
Field ID:	ZZZZZZZZZZ	Batch#:	118137
MSS Lab ID:	189656-004	Sampled:	09/25/06
Matrix:	Soil	Received:	09/26/06
Units:	mg/Kg	Prepared:	10/04/06
Basis:	as received	Analyzed:	10/05/06
Diln Fac:	1.000		

Type: MS Lab ID: QC359041

Analyte	MSS Result	Spiked	Result	%REC	Limits
Antimony	0.1970	86.96	23.26	27	1-126
Arsenic	2.890	43.48	39.35	84	74-120
Barium	62.31	86.96	133.7	82	53-134
Beryllium	0.2825	2.174	2.275	92	78-120
Cadmium	0.09382	8.696	7.913	90	71-120
Chromium	19.85	86.96	94.06	85	64-120
Cobalt	5.567	21.74	23.56	83	64-120
Copper	6.361	10.87	15.39	83	56-139
Lead	3.457	86.96	73.78	81	57-120
Molybdenum	0.2822	17.39	14.37	81	68-120
Nickel	21.19	21.74	37.75	76	48-132
Selenium	<0.05627	43.48	36.02	83	72-120
Silver	<0.03135	8.696	7.337	84	67-120
Thallium	<0.02211	43.48	35.10	81	69-120
Vanadium	29.22	21.74	45.58	75	55-134
Zinc	23.27	21.74	40.59	80	46-133

Type: MSD Lab ID: QC359042

Analyte	Spiked	Result	%REC	Limits	RPD	Lim
Antimony	78.13	18.54	23	1-126	12	21
Arsenic	39.06	37.20	88	74-120	4	20
Barium	78.13	136.7	95	53-134	8	20
Beryllium	1.953	2.128	95	78-120	3	20
Cadmium	7.813	7.189	91	71-120	1	20
Chromium	78.13	89.06	89	64-120	3	20
Cobalt	19.53	22.51	87	64-120	4	20
Copper	9.766	15.20	90	56-139	5	20
Lead	78.13	66.50	81	57-120	0	20
Molybdenum	15.63	12.73	80	68-120	2	20
Nickel	19.53	37.57	84	48-132	5	20
Selenium	39.06	33.42	86	72-120	3	20
Silver	7.813	6.845	88	67-120	4	20
Thallium	39.06	31.35	80	69-120	1	20
Vanadium	19.53	43.97	76	55-134	1	20
Zinc	19.53	39.63	84	46-133	3	20

RPD= Relative Percent Difference

## Batch QC Report

California Title 26 Metals			
Lab #:	189855	Location:	GE Healthcare Caral
Client:	Clayton Group Services	Prep:	METHOD
Project#:	STANDARD	Analysis:	EPA 7471A
Analyte:	Mercury	Basis:	as received
Type:	BLANK	Diln Fac:	1.000
Lab ID:	QC359187	Batch#:	118172
Matrix:	Soil	Prepared:	10/05/06
Units:	mg/Kg	Analyzed:	10/05/06

Result	RL
ND	0.020

ND= Not Detected  
 RL= Reporting Limit

## Batch QC Report

California Title 26 Metals			
Lab #:	189855	Location:	GE Healthcare Caral
Client:	Clayton Group Services	Prep:	METHOD
Project#:	STANDARD	Analysis:	EPA 7471A
Analyte:	Mercury	Diln Fac:	1.000
Matrix:	Soil	Batch#:	118172
Units:	mg/Kg	Prepared:	10/05/06
Basis:	as received	Analyzed:	10/05/06

Type	Lab ID	Spiked	Result	%REC	Limits	RPD	Lim
BS	QC359188	0.5000	0.4940	99	80-120		
BSD	QC359189	0.5000	0.5230	105	80-120	6	20

RPD= Relative Percent Difference

Batch QC Report

California Title 26 Metals			
Lab #:	189855	Location:	GE Healthcare Caral
Client:	Clayton Group Services	Prep:	METHOD
Project#:	STANDARD	Analysis:	EPA 7471A
Analyte:	Mercury	Diln Fac:	1.000
Field ID:	ZZZZZZZZZZ	Batch#:	118172
MSS Lab ID:	189851-002	Sampled:	10/03/06
Matrix:	Soil	Received:	10/04/06
Units:	mg/Kg	Prepared:	10/05/06
Basis:	as received	Analyzed:	10/05/06

Type	Lab ID	MSS Result	Spiked	Result	%REC	Limits	RPD	Lim
MS	QC359191	0.03053	0.4386	0.4763	102	54-154		
MSD	QC359192		0.4310	0.4672	101	54-154	0	28

RPD= Relative Percent Difference





## ANALYTICAL REPORT

Job Number: 720-5866-1

Job Description: RGW-Backfill

For:  
Bureau Veritas  
Clayton Group Services, Inc.  
6920 Koll Center Parkway  
Suite 216  
Pleasanton, CA 94566

Attention: Mike Zimmerman

A handwritten signature in black ink that reads "Melissa Brewer".

---

Melissa Brewer  
Project Manager I  
mbrewer@stl-inc.com  
10/10/2006

Project Manager: Dimple Sharma

## EXECUTIVE SUMMARY - Detections

Client: Bureau Veritas

Job Number: 720-5866-1

Lab Sample ID	Client Sample ID	Result / Qualifier	Reporting Limit	Units	Method
<b>720-5866-1</b>	<b>RGW-BACKFILL-1</b>				
Arsenic		5.9	0.99	mg/Kg	6010B
Barium		270	0.99	mg/Kg	6010B
Chromium		9.8	0.99	mg/Kg	6010B
Cobalt		5.8	0.99	mg/Kg	6010B
Copper		11	0.99	mg/Kg	6010B
Lead		8.2	0.99	mg/Kg	6010B
Nickel		8.7	0.99	mg/Kg	6010B
Vanadium		27	0.99	mg/Kg	6010B
Zinc		37	0.99	mg/Kg	6010B

## METHOD SUMMARY

Client: Bureau Veritas

Job Number: 720-5866-1

Description	Lab Location	Method	Preparation Method
<b>Matrix: Solid</b>			
Nonhalogenated Organics using GC/FID -Modified (Diesel Range Organics)	STL SF	SW846 8015B	
Ultrasonic Extraction	STL SF		SW846 3550B
Silica Gel Cleanup	STL SF		SW846 3630C
Inductively Coupled Plasma - Atomic Emission Spectrometry	STL SF	SW846 6010B	
Acid Digestion of Sediments, Sludges, and Soils	STL SF		SW846 3050B
Mercury in Solid or Semisolid Waste (Manual Cold Vapor Technique)	STL SF	SW846 7471A	
Mercury in Solid or Semi-Solid Waste (Manual	STL SF		SW846 7471A

### LAB REFERENCES:

STL SF = STL San Francisco

### METHOD REFERENCES:

SW846 - "Test Methods For Evaluating Solid Waste, Physical/Chemical Methods", Third Edition, November 1986 And Its Updates.

## SAMPLE SUMMARY

Client: Bureau Veritas

Job Number: 720-5866-1

<b>Lab Sample ID</b>	<b>Client Sample ID</b>	<b>Client Matrix</b>	<b>Date/Time Sampled</b>	<b>Date/Time Received</b>
720-5866-1	RGW-BACKFILL-1	Solid	10/09/2006 1306	10/09/2006 1408

# Analytical Data

Client: Bureau Veritas

Job Number: 720-5866-1

**Client Sample ID: RGW-BACKFILL-1**

Lab Sample ID: 720-5866-1  
Client Matrix: Solid

Date Sampled: 10/09/2006 1306  
Date Received: 10/09/2006 1408

---

## 8015B Nonhalogenated Organics using GC/FID -Modified (Diesel Range Organics)

Method:	8015B	Analysis Batch: 720-14063	Instrument ID:	HP DRO5
Preparation:	3550B	Prep Batch: 720-14003	Lab File ID:	N/A
Dilution:	1.0		Initial Weight/Volume:	30.12 g
Date Analyzed:	10/10/2006 0630		Final Weight/Volume:	5 mL
Date Prepared:	10/09/2006 0824		Injection Volume:	
			Column ID:	PRIMARY

Analyte	DryWt Corrected: N	Result (mg/Kg)	Qualifier	RL
Diesel Range Organics [C10-C28]		ND		1.0
Motor Oil Range Organics [C24-C36]		ND		50
Surrogate		%Rec		Acceptance Limits
o-Terphenyl		67		50 - 130
Capric Acid (Surr)		0		0 - 5

## Analytical Data

Client: Bureau Veritas

Job Number: 720-5866-1

### Client Sample ID: RGW-BACKFILL-1

Lab Sample ID: 720-5866-1  
Client Matrix: Solid

Date Sampled: 10/09/2006 1306  
Date Received: 10/09/2006 1408

#### 6010B Inductively Coupled Plasma - Atomic Emission Spectrometry

Method: 6010B                      Analysis Batch: 720-14065                      Instrument ID:                      Varian ICP  
Preparation: 3050B                      Prep Batch: 720-14034                      Lab File ID:                      N/A  
Dilution: 1.0                      Initial Weight/Volume: 1.01 g  
Date Analyzed: 10/10/2006 1149                      Final Weight/Volume: 50 mL  
Date Prepared: 10/09/2006 1509

Analyte	DryWt Corrected: N	Result (mg/Kg)	Qualifier	RL
Antimony		ND		2.0
Arsenic		5.9		0.99
Barium		270		0.99
Beryllium		ND		0.50
Cadmium		ND		0.50
Chromium		9.8		0.99
Cobalt		5.8		0.99
Copper		11		0.99
Lead		8.2		0.99
Molybdenum		ND		0.99
Nickel		8.7		0.99
Selenium		ND		2.0
Silver		ND		0.99
Thallium		ND		0.99
Vanadium		27		0.99
Zinc		37		0.99

#### 7471A Mercury in Solid or Semisolid Waste (Manual Cold Vapor Technique)

Method: 7471A                      Analysis Batch: 720-14064                      Instrument ID:                      FIMS 100  
Preparation: 7471A                      Prep Batch: 720-13970                      Lab File ID:                      N/A  
Dilution: 1.0                      Initial Weight/Volume: 1.02 g  
Date Analyzed: 10/10/2006 0920                      Final Weight/Volume: 50 mL  
Date Prepared: 10/06/2006 1402

Analyte	DryWt Corrected: N	Result (mg/Kg)	Qualifier	RL
Mercury		ND		0.049



## DATA REPORTING QUALIFIERS

<b>Lab Section</b>	<b>Qualifier</b>	<b>Description</b>
--------------------	------------------	--------------------

---

## Quality Control Results

Client: Bureau Veritas

Job Number: 720-5866-1

### QC Association Summary

Lab Sample ID	Client Sample ID	Report Basis	Client Matrix	Method	Prep Batch
<b>GC Semi VOA</b>					
<b>Prep Batch: 720-14003</b>					
LCS 720-14003/2-B	Lab Control Spike	T	Solid	3550B	
LCSD 720-14003/3-B	Lab Control Spike Duplicate	T	Solid	3550B	
MB 720-14003/1-B	Method Blank	T	Solid	3550B	
720-5866-1	RGW-BACKFILL-1	T	Solid	3550B	
<b>Analysis Batch:720-14063</b>					
LCS 720-14003/2-B	Lab Control Spike	T	Solid	8015B	720-14003
LCSD 720-14003/3-B	Lab Control Spike Duplicate	T	Solid	8015B	720-14003
MB 720-14003/1-B	Method Blank	T	Solid	8015B	720-14003
720-5866-1	RGW-BACKFILL-1	T	Solid	8015B	720-14003
<b>Report Basis</b>					
T = Total					
<b>Metals</b>					
<b>Prep Batch: 720-13970</b>					
LCS 720-13970/2-A	Lab Control Spike	T	Solid	7471A	
LCSD 720-13970/3-A	Lab Control Spike Duplicate	T	Solid	7471A	
MB 720-13970/1-A	Method Blank	T	Solid	7471A	
720-5866-1	RGW-BACKFILL-1	T	Solid	7471A	
<b>Prep Batch: 720-14034</b>					
LCS 720-14034/2-A	Lab Control Spike	T	Solid	3050B	
LCSD 720-14034/3-A	Lab Control Spike Duplicate	T	Solid	3050B	
MB 720-14034/1-A	Method Blank	T	Solid	3050B	
720-5866-1	RGW-BACKFILL-1	T	Solid	3050B	
<b>Analysis Batch:720-14064</b>					
LCS 720-13970/2-A	Lab Control Spike	T	Solid	7471A	720-13970
LCSD 720-13970/3-A	Lab Control Spike Duplicate	T	Solid	7471A	720-13970
MB 720-13970/1-A	Method Blank	T	Solid	7471A	720-13970
720-5866-1	RGW-BACKFILL-1	T	Solid	7471A	720-13970
<b>Analysis Batch:720-14065</b>					
LCS 720-14034/2-A	Lab Control Spike	T	Solid	6010B	720-14034
LCSD 720-14034/3-A	Lab Control Spike Duplicate	T	Solid	6010B	720-14034
MB 720-14034/1-A	Method Blank	T	Solid	6010B	720-14034
720-5866-1	RGW-BACKFILL-1	T	Solid	6010B	720-14034

### Report Basis

T = Total

**STL San Francisco**

## Quality Control Results

Client: Bureau Veritas

Job Number: 720-5866-1

**Method Blank - Batch: 720-14003**

**Method: 8015B  
Preparation: 3550B**

Lab Sample ID: MB 720-14003/1-B  
Client Matrix: Solid  
Dilution: 1.0  
Date Analyzed: 10/09/2006 2025  
Date Prepared: 10/09/2006 0824

Analysis Batch: 720-14063  
Prep Batch: 720-14003  
Units: mg/Kg

Instrument ID: HP DRO5  
Lab File ID: N/A  
Initial Weight/Volume: 30.03 g  
Final Weight/Volume: 5 mL  
Injection Volume:  
Column ID: PRIMARY

Analyte	Result	Qual	RL
Diesel Range Organics [C10-C28]	ND		1.0
Motor Oil Range Organics [C24-C36]	ND		50
<b>Surrogate</b>	<b>% Rec</b>		<b>Acceptance Limits</b>
o-Terphenyl	76		50 - 130
Capric Acid (Surr)	0		0 - 5

**Lab Control Spike/  
Lab Control Spike Duplicate Recovery Report - Batch: 720-14003**

**Method: 8015B  
Preparation: 3550B**

LCS Lab Sample ID: LCS 720-14003/2-B  
Client Matrix: Solid  
Dilution: 1.0  
Date Analyzed: 10/09/2006 2052  
Date Prepared: 10/09/2006 0824

Analysis Batch: 720-14063  
Prep Batch: 720-14003  
Units: mg/Kg

Instrument ID: HP DRO5  
Lab File ID: N/A  
Initial Weight/Volume: 30.05 g  
Final Weight/Volume: 5 mL  
Injection Volume:  
Column ID: PRIMARY

LCSD Lab Sample ID: LCSD 720-14003/3-B  
Client Matrix: Solid  
Dilution: 1.0  
Date Analyzed: 10/09/2006 2120  
Date Prepared: 10/09/2006 0824

Analysis Batch: 720-14063  
Prep Batch: 720-14003  
Units: mg/Kg

Instrument ID: HP DRO5  
Lab File ID: N/A  
Initial Weight/Volume: 30.10 g  
Final Weight/Volume: 5 mL  
Injection Volume:  
Column ID: PRIMARY

Analyte	<u>% Rec.</u>		Limit	RPD	RPD Limit	LCS Qual	LCSD Qual
	LCS	LCSD					
Diesel Range Organics [C10-C28]	65	66	50 - 130	2	30		
<b>Surrogate</b>		<b>LCS % Rec</b>	<b>LCSD % Rec</b>			<b>Acceptance Limits</b>	
o-Terphenyl		73	74			50 - 130	

Calculations are performed before rounding to avoid round-off errors in calculated results.

## Quality Control Results

Client: Bureau Veritas

Job Number: 720-5866-1

### Method Blank - Batch: 720-14034

Lab Sample ID: MB 720-14034/1-A  
Client Matrix: Solid  
Dilution: 1.0  
Date Analyzed: 10/10/2006 1117  
Date Prepared: 10/09/2006 1509

Analysis Batch: 720-14065  
Prep Batch: 720-14034  
Units: mg/Kg

### Method: 6010B Preparation: 3050B

Instrument ID: Varian ICP  
Lab File ID: N/A  
Initial Weight/Volume: 1 g  
Final Weight/Volume: 50 mL

Analyte	Result	Qual	RL
Antimony	ND		2.0
Arsenic	ND		1.0
Barium	ND		1.0
Beryllium	ND		0.50
Cadmium	ND		0.50
Chromium	ND		1.0
Cobalt	ND		1.0
Copper	ND		1.0
Lead	ND		1.0
Molybdenum	ND		1.0
Nickel	ND		1.0
Selenium	ND		2.0
Silver	ND		1.0
Thallium	ND		1.0
Vanadium	ND		1.0
Zinc	ND		1.0

Calculations are performed before rounding to avoid round-off errors in calculated results.

## Quality Control Results

Client: Bureau Veritas

Job Number: 720-5866-1

**Lab Control Spike/  
Lab Control Spike Duplicate Recovery Report - Batch: 720-14034**

**Method: 6010B  
Preparation: 3050B**

LCS Lab Sample ID: LCS 720-14034/2-A  
Client Matrix: Solid  
Dilution: 1.0  
Date Analyzed: 10/10/2006 1120  
Date Prepared: 10/09/2006 1509

Analysis Batch: 720-14065  
Prep Batch: 720-14034  
Units: mg/Kg

Instrument ID: Varian ICP  
Lab File ID: N/A  
Initial Weight/Volume: 1 g  
Final Weight/Volume: 50 mL

LCSD Lab Sample ID: LCSD 720-14034/3-A  
Client Matrix: Solid  
Dilution: 1.0  
Date Analyzed: 10/10/2006 1124  
Date Prepared: 10/09/2006 1509

Analysis Batch: 720-14065  
Prep Batch: 720-14034  
Units: mg/Kg

Instrument ID: Varian ICP  
Lab File ID: N/A  
Initial Weight/Volume: 1 g  
Final Weight/Volume: 50 mL

Analyte	% Rec.		Limit	RPD	RPD Limit	LCS Qual	LCSD Qual
	LCS	LCSD					
Antimony	88	87	80 - 120	0	20		
Arsenic	94	90	80 - 120	4	20		
Barium	99	96	80 - 120	4	20		
Beryllium	95	92	80 - 120	4	20		
Cadmium	92	89	80 - 120	3	20		
Chromium	94	91	80 - 120	4	20		
Cobalt	94	91	80 - 120	4	20		
Copper	98	94	80 - 120	4	20		
Lead	91	88	80 - 120	4	20		
Molybdenum	96	94	80 - 120	3	20		
Nickel	92	89	80 - 120	4	20		
Selenium	92	89	80 - 120	4	20		
Silver	96	93	80 - 120	4	20		
Thallium	94	91	80 - 120	3	20		
Vanadium	96	93	80 - 120	3	20		
Zinc	91	87	80 - 120	4	20		

Calculations are performed before rounding to avoid round-off errors in calculated results.

## Quality Control Results

Client: Bureau Veritas

Job Number: 720-5866-1

**Method Blank - Batch: 720-13970**

**Method: 7471A**  
**Preparation: 7471A**

Lab Sample ID: MB 720-13970/1-A  
Client Matrix: Solid  
Dilution: 1.0  
Date Analyzed: 10/10/2006 0902  
Date Prepared: 10/06/2006 1402

Analysis Batch: 720-14064  
Prep Batch: 720-13970  
Units: mg/Kg

Instrument ID: FIMS 100  
Lab File ID: N/A  
Initial Weight/Volume: 1 g  
Final Weight/Volume: 50 mL

Analyte	Result	Qual	RL
Mercury	ND		0.050

**Lab Control Spike/  
Lab Control Spike Duplicate Recovery Report - Batch: 720-13970**

**Method: 7471A**  
**Preparation: 7471A**

LCS Lab Sample ID: LCS 720-13970/2-A  
Client Matrix: Solid  
Dilution: 1.0  
Date Analyzed: 10/10/2006 0903  
Date Prepared: 10/06/2006 1402

Analysis Batch: 720-14064  
Prep Batch: 720-13970  
Units: mg/Kg

Instrument ID: FIMS 100  
Lab File ID: N/A  
Initial Weight/Volume: 1 g  
Final Weight/Volume: 50 mL

LCSD Lab Sample ID: LCSD 720-13970/3-A  
Client Matrix: Solid  
Dilution: 1.0  
Date Analyzed: 10/10/2006 0904  
Date Prepared: 10/06/2006 1402

Analysis Batch: 720-14064  
Prep Batch: 720-13970  
Units: mg/Kg

Instrument ID: FIMS 100  
Lab File ID: N/A  
Initial Weight/Volume: 1 g  
Final Weight/Volume: 50 mL

Analyte	<u>% Rec.</u>		Limit	RPD	RPD Limit	LCS Qual	LCSD Qual
	LCS	LCSD					
Mercury	96	95	85 - 115	1	20		

Calculations are performed before rounding to avoid round-off errors in calculated results.



BUREAU VERITAS

720-5866 Clayton Group Services, Inc. A Bureau Veritas Company

REQUEST FOR LABORATORY ANALYTICAL SERVICES

IMPORTANT

Date Results Requested: 10/10/06 Rush Charges Authorized? [X] Yes [ ] No [ ] Fax or [ ] E-mail Results E-mail address:

102171

For Clayton Use Only Clayton Lab Project No.

Form containing client information (Name: Mike Zimmerman, Job No: 04583-003), analysis requested details (Soils, Waters), and a table for sample identification and analysis results. Includes a 'RUSH' stamp and a 'CHAIN OF CUSTODY' section.

Please return completed form and samples to one of the Clayton Group Services, Inc. labs listed below: Detroit Regional Lab, Atlanta Regional Lab, Seattle Regional Lab.

DISTRIBUTION: White = Clayton Laboratory, Yellow = Clayton Accounting, Pink = Client Copy



## LOGIN SAMPLE RECEIPT CHECK LIST

Client: Bureau Veritas

Job Number: 720-5866-1

**Login Number: 5866**

Question	T/F/NA	Comment
Radioactivity either was not measured or, if measured, is at or below background	NA	
The cooler's custody seal, if present, is intact.	NA	
The cooler or samples do not appear to have been compromised or tampered with.	True	
Samples were received on ice.	True	
Cooler Temperature is acceptable.	True	
Cooler Temperature is recorded.	True	
COC is present.	True	
COC is filled out in ink and legible.	True	
COC is filled out with all pertinent information.	True	
There are no discrepancies between the sample IDs on the containers and the COC.	True	
Samples are received within Holding Time.	True	
Sample containers have legible labels.	True	
Containers are not broken or leaking.	True	
Sample collection date/times are provided.	True	
Appropriate sample containers are used.	True	
Sample bottles are completely filled.	True	
There is sufficient vol. for all requested analyses, incl. any requested MS/MSDs	True	
VOA sample vials do not have headspace or bubble is <6mm (1/4") in diameter.	True	
If necessary, staff have been informed of any short hold time or quick TAT needs	True	
Multiphasic samples are not present.	True	
Samples do not require splitting or compositing.	True	