

ASSESSOR'S MAP 941

Code Area Nos. 26-001

40

SUBDIVISION OF PLOT A OF THE DOUGHERTY RANCH (S.K. 15 Pg. 17)
P.M. 2806 (107/62) AMENDED 109/90 P.M. 928 78/4

Scale 1" = 200'

REV. 2-1-81 BE DE 5-30-88RS
2-10-85 CT 1-27-88VA
3-23-86 BV 3-30-88CSL
4-27-82 RB 7-06-01 EG
5-18-88 BV 8-19-88 BV
6-28-91 JT 10-19-83CSL
11-25-91 JT

Fmly Bk 25 BK 25

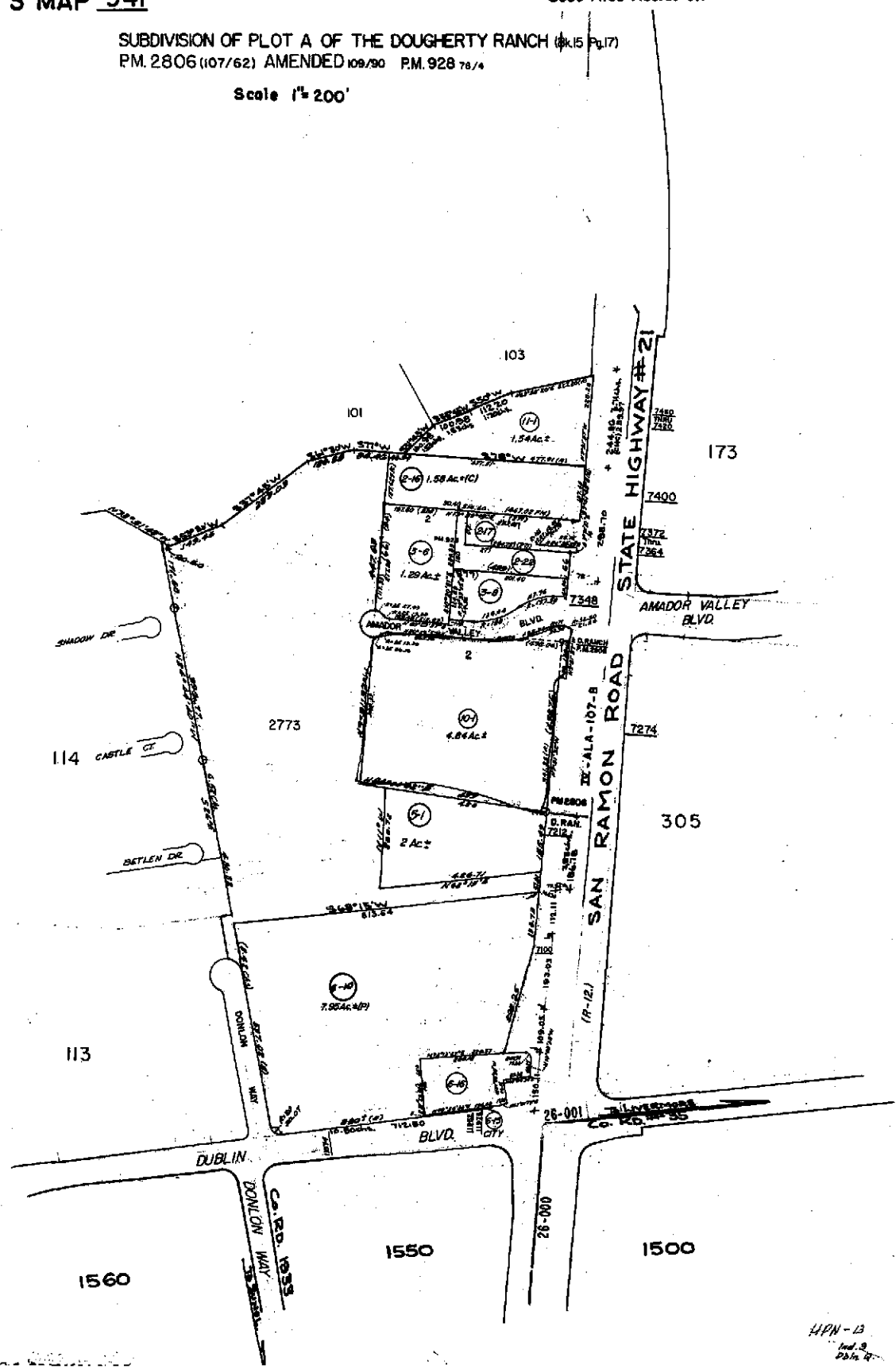

HPN-B
Ind. 9
Date 8/



COUNTY OF ALAMEDA
Assessor's Office

Property Value System

History

Value

Transfer

New Query

Parcel Number: **941-40-10-1** Inactive: **N** Lien Date: **01/01/2006** Owner: **CHIU GABRIEL H & LAI H TRS**
 Property Address: **SAN RAMON RD , DUBLIN, CA 94566**
[Parcel History](#)

Mailing Name	Historical Mailing Address	Document Date	Document Number	Value From Trans Tax	Parcel Count	Use
CHIU GABRIEL H & LAI H TRS	10698 INSPIRATION CIR , DUBLIN, CA 94568	03/29/2005	2005-120716	\$15,800,000	1	<u>3100</u>
DUBLIN TOWN & COUNTRY ASSOCIATES	318 DIABLO RD STE 250, DANVILLE, CA 94526-3421	11/02/1984	1984-221456		3	<u>3100</u>

All information on this site is to be assumed accurate for property assessment purposes only, and is based upon the Assessor's knowledge of each property. Caution is advised for use other than its intended purpose.

The Alameda County Intranet site is best viewed in Internet Explorer Version 5.5 or later.
 Click [here](#) for more information regarding supported browsers.

Copyright © 2001 Alameda County