



February 24, 2006

RECEIVED

By loprojectop at 2:14 pm, Mar 01, 2006

Mr. Barney Chan
Alameda County Health Care Services Agency
1131 Harbor Bay Parkway, Suite 250
Alameda, CA 94502

Subject: Workplan Addendum
6310 Houston Place
Dublin, California
AEI Project No. 116304
Fuel Leak Case RO00002862

Dear Mr. Chan:

This letter has been prepared to address the comments in the January 20, 2006 letter from your office relating to the above referenced matter. The letter was prepared to comment on the *Soil and Groundwater Investigation Workplan*, July 11, 2005, prepared by AEI to investigate the possible additional fuel release at the property.

Attached is a revised site plan, with revised soil boring locations, per your comments. Several changes have been made to address those comments:

- Proposed boring SB-1 has been moved to just outside of the tank former tank hold, as requested, to between the tank hold and former monitoring well MW-2
- SB-2 was relocated to just southeast (down-gradient) of former well MW-5
- A fifth boring SB-5 was added to the scope of work, located south / southeast of former well MW-1, at the property boundary, to evaluate the extent of a release, if one occurred.

Based on site observations, the former monitoring wells on the subject property have been closed. According to the current property owner, the wells were closed prior to his purchase of the property. In addition, the current owner does not have formal well closure reports. AEI received Department of Water Resources (DWR) reports for the surrounding area. These records did not include either well installation or closure records for the subject property. Because the wells are closed, they cannot be sampled.

As part of the upcoming investigation and report, AEI will request well permit records for the subject property from Alameda County Zone 7 Water District. Findings of the records request will be presented in the soil and groundwater investigation report.

AEI has been retained to proceed with the drilling and sampling activities. As site construction activities are scheduled to begin shortly, we expect to complete the field work in approximately 2 to 3 weeks, pending permit approval and rig availability.

If you have any additional questions or comments regarding the scope of work or site conditions, please don't hesitate to contact me. I can be reached at 925/283-6000, extension 104 or at pmcintyre@aeiconsultants.com.

Sincerely,
AEI Consultants

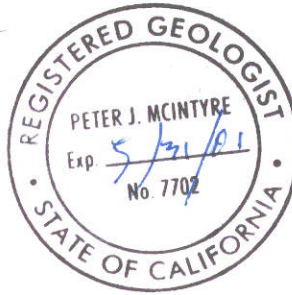

Peter McIntyre, PG
Senior Project Manager



Attachment: Revised Site Plan

cc: Mr. Cary Greyson, G&G International Holding Company
2413 Stirrup Court, Walnut Creek, CA 94596

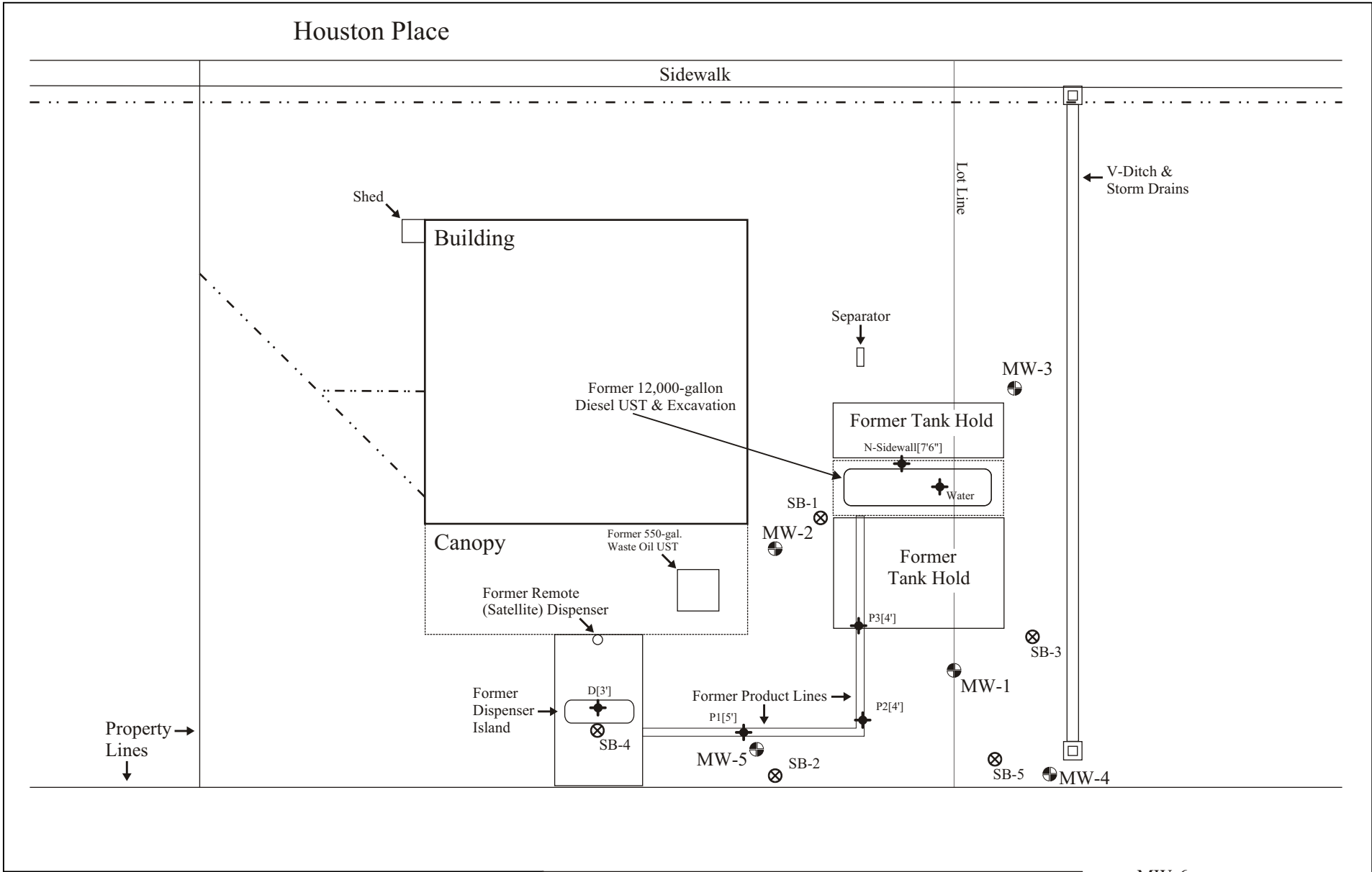
Houston Place



AEI CONSULTANTS
 2500 CAMINO DIABLO, STE 200 WALNUT CREEK, CA 94597

REVISED SITE PLAN

6310 HOUSTON PLACE
 DUBLIN, CA 94568

FIGURE 2
 Project # 116304

LEGEND

- ⊕ Former Monitoring Well Locations (Approx)
- ⊕ Tank Removal Sample Locations (GGTR, 2004)
- ⊗ Proposed Boring Locations
- · - · - Approximate Location of Subsurface Utilities

MW-6

0' 10' 20' 30'

Scale: 1 in = 30 ft
 Revised Feb. 2006

