

C A M B R I A

October 15, 2004

Mr. Keith L. Matthews  
 Hazardous Materials Inspector  
 Office of Emergency Services  
 City of Oakland, Fire Services Agency  
 1605 Martin Luther King, Jr. Way  
 Oakland, California 94612

Re: **Dispenser Upgrade Sampling Report**  
 Shell-branded Service Station  
 3600 Park Boulevard  
 Oakland, California  
 Incident # 98995747  
 Cambria Project #206-0937-002

Alameda County  
 OCT 19 2004  
 Environmental Health



Dear Mr. Matthews:

On behalf of Equilon Enterprises LLC dba Shell Oil Products US (Shell), Cambria Environmental Technology, Inc. (Cambria) is submitting this *Dispenser Upgrade Sampling Report* which presents the results of sampling conducted during station upgrade activities at the referenced site. Presented below are a summary of site conditions, sampling activities and analytical results.

## SITE CONDITIONS AND BACKGROUND

**Location:** The site is located at the Park Boulevard and Chatham Road intersection in Oakland, California. The area surrounding the site is both commercial and residential. Highway 580 runs near the southwestern boundary of the site (Figure 1). The service station layout includes a station building, four dispenser islands, and a gasoline underground storage tank (UST) complex. (Figure 2).

**1998 Upgrade Soil Sampling Activities:** In February 1998, secondary containment was added to the existing dispensers and the turbine sumps. Cambria inspected the dispenser and tank pit areas. No field indications of hydrocarbons, such as staining or odor, were observed beneath dispensers D-3 or D-4 during the site visit. Since the City of Oakland did not require sampling at dispensers during 1998 upgrade projects unless there was evidence of hydrocarbons, no sampling was required for these dispensers. Cambria personnel observed staining and odor beneath dispensers D-1 and D-2, and collected soil samples beneath these dispensers at depths of approximately

Cambria  
 Environmental  
 Technology, Inc.

5900 Hollis Street  
 Suite A  
 Emeryville, CA 94608  
 Tel (510) 420-0700  
 Fax (510) 420-9170

2 feet into native soil. A second sample was collected from beneath dispenser D-2 at a depth of approximately 5 feet into native soil. Table 1 summarizes the analytical results. On March 5, 1998, Shell filed an Underground Storage Tank Unauthorized Release Site Report. These results were reported in Cambria's April 7, 1998 *Dispenser Soil Sampling Report*.

**2004 Well Survey:** At Shell's request, Cambria performed a well survey for all water producing wells within a 1/2-mile radius of the site. As shown on Figure 1, Cambria's search of the California Department of Water Resources and Geotracker database records did not return any records of water-producing wells within the search radius.



**Upgrade Activities:** Paradiso Mechanical, Inc. (Paradiso) of San Leandro, California recently upgraded this Shell-branded service station. Paradiso upgraded under-dispenser containment at the dispenser locations and installed enhanced vapor recovery equipment on the UST fuel fill port sumps.

## SAMPLING ACTIVITIES AND SAMPLE ANALYSIS

**Personnel Present:** Stewart Dalie, Staff Scientist, Cambria.  
Keith L. Matthews, Hazardous Materials Inspector, City of Oakland, Fire Services Agency.

**Sample Date:** August 20, 2004.

**Sampling Requirements:** As directed by Keith Matthews during field activities on August 20, 2004, one soil sample was required from beneath each dispenser within 1 to 2 feet of native soil. Only the soil beneath each dispenser was exposed and available for sampling.

**Dispenser Sampling:** Under Mr. Matthews' direction, four soil samples were collected at depths ranging from 4 to 5 feet below grade (fbg) (Figure 2). Attachment A presents Cambria's standard procedures for dispenser and piping sampling.

**Sample Analyses:** State-certified laboratory Severn Trent Laboratories Inc. (STL), of Pleasanton, California analyzed all four samples for total petroleum hydrocarbons as gasoline (TPHg), benzene, toluene, ethylbenzene, and xylenes (BTEX), and methyl tert-butyl ether (MTBE) by EPA Method 8260B. Table 1 summarizes laboratory analytical results. Attachment B presents laboratory analytical reports and chain of custody records.

**Soil Stockpile Disposal:** To characterize stockpiled soil for disposal, four brass tubes of soil were collected from the approximately 5 cubic yards of stockpiled soil and composited by STL. The

soil was analyzed for TPHg and BTEX by EPA Method 8260B and for total lead. On September 7, 2004, the stockpile was transported to Forward Landfill in Manteca, California for disposal as a non-hazardous waste. A soil disposal confirmation report is included as Attachment C.

**Groundwater:** Approximately 12,000 gallons of water were removed from the UST pit during the upgrade activities. The extracted water was disposed of at Shell's Martinez refinery. It is estimated that water in the tank pit was originally present at approximately 5 fbg, and was likely locally perched water or water trapped in the UST pit, as no evidence of groundwater was observed during soil sampling activities. Attachment D presents water transportation documents.



## ANALYTICAL RESULTS

TPHg and xylenes were detected in two of the four soil samples submitted for analysis. TPHg concentrations detected were 180 and 30 parts per million (ppm) in samples D-1-5' and D-4-5', respectively, and xylene was detected at a concentration of 2.3 ppm in sample D-1-5'. Soil analytical results are summarized in Table 1, and the laboratory analytical report is included as Attachment B.

## CONCLUSIONS

The current soil sampling identifies petroleum hydrocarbon impacts to soil in the vicinity of the dispensers. Based on the analytical results, Shell submitted an Unauthorized Release Report (URR) to the City of Oakland Fire Department on August 24, 2004. A copy of the URR is included as Attachment E.

Based upon the site's location and the lack of water supply wells known in the site vicinity, Cambria believes it is unlikely that groundwater in the area is used for drinking water. The site is currently used as commercial property.

To compare the results to applicable screening criteria, Cambria compared the August 2004 soil sampling results to the San Francisco Regional Water Quality Control Board's (RWQCB) environmental screening levels (ESLs) and the City of Oakland Urban Land Redevelopment Program's Tier 1 risk-based screening levels (RBSLs) for soil for commercial land uses and where groundwater is not used as drinking water. Only the total xylenes concentration of 2.3 ppm in sample D-1-5' exceeded the applicable RWQCB ESL of 1.5 ppm. The xylenes ESL is

based upon a groundwater protection/soil leaching criteria. Since groundwater is not a source of drinking water, this criteria does not apply. The xylenes concentration is below all other criteria used in the development of the xylene ESL.

None of the soil sample results exceeded the applicable Oakland RBSLs. As a result, Cambria believes the results indicate that the impacted soils pose little or no risk to human health, and recommends no further action.

**CLOSING**



Please call Jason Gerke 420-3320 if you have any questions or comments.

Sincerely,  
**Cambria Environmental Technology, Inc.**

*Matthew W. Derby*  
for  
Jason Gerke  
Senior Staff Scientist

*Matthew W. Derby*  
Matthew M. Derby, P.E.  
Senior Principal Engineer



Figures: 1 - Site Vicinity/Well Survey Map  
2 - Soil Sample Location Map

Table: 1 - Soil Analytical Results

Attachments: A - Standard Piping and Dispenser Removal Sampling Procedures  
B - Certified Analytical Laboratory Report  
C - Soil Disposal Confirmation Report  
D - Water Disposal Documentation  
E - Unauthorized Release Report

cc: Karen Petryna, Shell Oil Products US, 20945 S. Wilmington, Carson CA 90810  
Mr. Bill Merchant, Shell Oil Products US, 9141 E. Stockton Boulevard, Suite  
250-321, Elk Grove, CA 95624  
Ms. Rosana Garcia-LaGrille, Alameda County Health Care Services Agency,  
1131 Harbor Bay Parkway, Suite 250, Alameda, CA 94502-6577

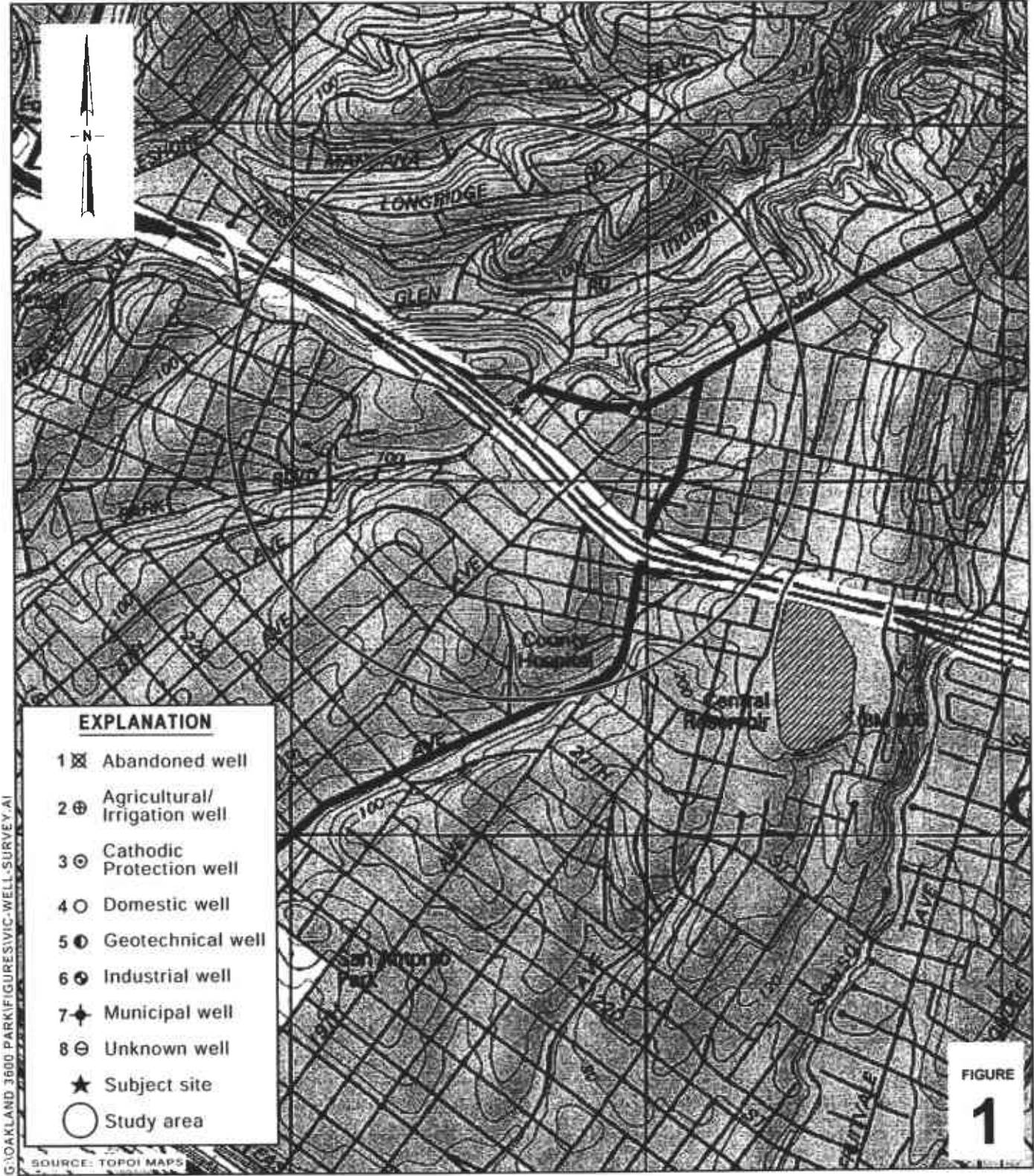

G:\OAKLAND 3600 PARK\FIGURE5\VIC-WELL-SURVEY.AI

**EXPLANATION**

- 1 ☒ Abandoned well
- 2 ⊕ Agricultural/Irrigation well
- 3 ⊙ Cathodic Protection well
- 4 ○ Domestic well
- 5 ⊖ Geotechnical well
- 6 ⊕ Industrial well
- 7 ◆ Municipal well
- 8 ⊕ Unknown well
- ★ Subject site
- Study area

SOURCE: TOPOI MAPS

0 1/8 1/4 1/2 1

SCALE : 1" = 1/4 MILE

FIGURE 1

**Shell-branded Service Station**

3600 Park Boulevard  
Oakland, California  
Incident #98995747



C A M B R I A

**Site Vicinity/Well Survey Map**

(1/2-Mile Radius)



PARK BOULEVARD

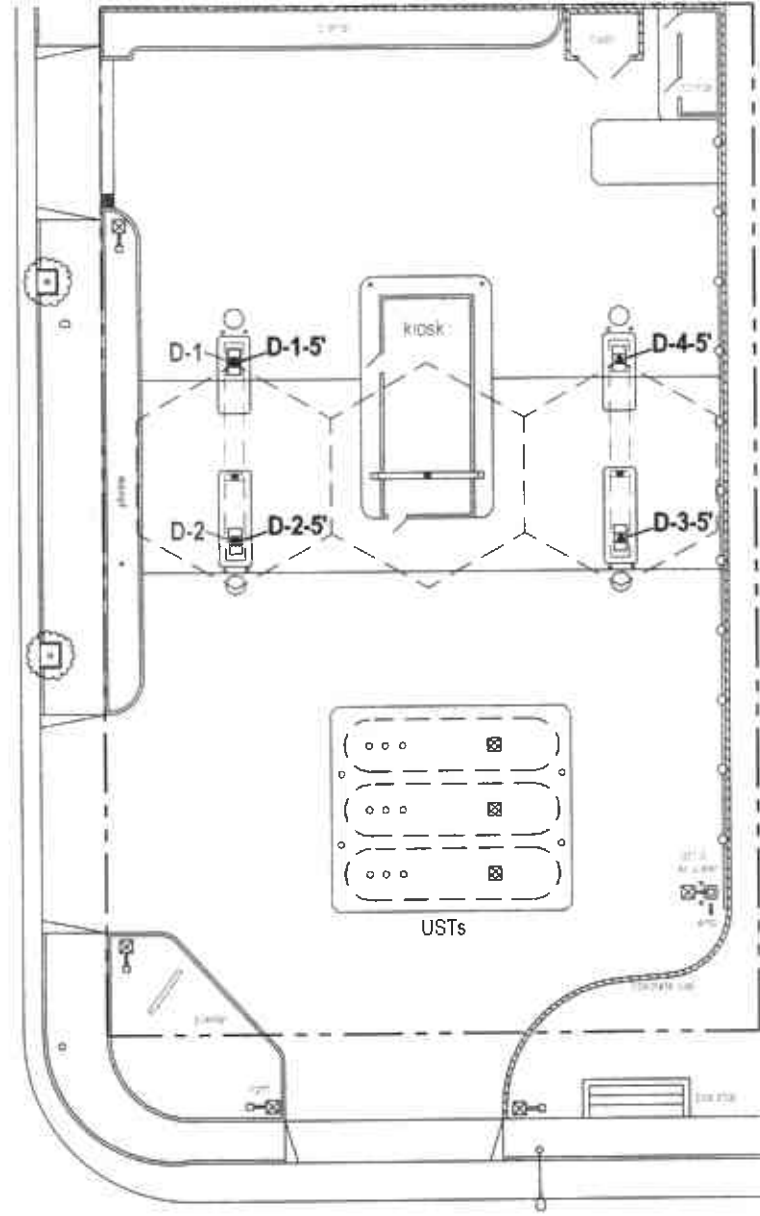

153rd AVE

OAKLAND 3600 PARK BOULEVARD SITE PLAN 04.DWG

**EXPLANATION**

- D-1-5' ▲ Dispenser soil sample location (8/20/04)
- D-1 ● Dispenser soil sample location (02/20/98)



FIGURE 2

**Shell-branded Service Station**  
 3600 Park Boulevard  
 Oakland, California  
 Incident #98995747



C A M B R I A

**Soil Sample Location Map**

August 20, 2004

# CAMBRIA

**Table 1. Soil Analytical Results - Shell-branded Service Station, 3600 Park Blvd., Oakland, California SAP # 135689**

Sample	Depth (fbg)	Date Sampled	TPHg (mg/kg)	Benzene (mg/kg)	Toluene (mg/kg)	Ethyl benzene (mg/kg)	Xylenes (mg/kg)	MTBE (mg/kg)
D-1	2.0	2/20/1998	930	1.0	20	11	78	49
D-2	2.0	2/20/1998	2,703	1.2	1.1	1.9	14	4.5
D-2	5.0	2/20/1998	180	1.3	0.46	1.7	4.0	1.6
D-1-5'	5.0	8/20/2004	180	<0.50	<0.50	<0.50	2.3	<0.50
D-2-5'	5.0	8/20/2004	<1.0	<0.0050	<0.0050	<0.0050	<0.0050	<0.0050
D-3-5'	5.0	8/20/2004	<1.0	<0.0050	<0.0050	<0.0050	<0.0050	<0.0050
D-4-5'	5.0	8/20/2004	30	<0.0050	<0.0050	<0.0050	<0.0050	<0.0050

**Abbreviations and Notes:**

fbg = Feet below grade

mg/kg = Milligrams per kilogram (parts per million)

TPHg = Total petroleum hydrocarbons as gasoline analyzed by EPA Method 88260b; prior to 2004, analyzed by EPA Method 8015

Benzene, toluene, ethylbenzene, and xylenes analyzed by EPA Method 8260B; prior to 2004, analyzed by EPA Method 8020

MTBE = methyl tertiary butyl ether analyzed by EPA Method 8260B; prior to 2004, analyzed by EPA Method 8020

<x = Not detected at detection limit x

## **ATTACHMENT A**

Standard Piping and Dispenser Removal Sampling Procedures



# CAMBRIA

## STANDARD PIPING AND DISPENSER REMOVAL SAMPLING PROCEDURES

Cambria Environmental Technology, Inc. (Cambria) has developed standard operating procedures for collecting soil samples during petroleum dispenser and piping removal. These procedures ensure that the samples are collected, handled, and documented in compliance with California Administration Code Title 23: Waters; Chapter 3: Water Resources Control Board; Subchapter 16: Underground Storage Tank Regulations (Title 23). Cambria's sampling procedures are based on guidelines contained in the California State Regional Water Quality Control Board Tri-Regional Staff Recommendations for Preliminary Evaluation and Investigation of Underground Tank Sites dated August 10, 1990.

### **Piping and Dispenser Removal Sampling**

The objective of sample collection during routine dispenser and piping removals is to determine whether hydrocarbons or other stored chemicals have leaked to the subsurface. We collect one soil sample from the native soil beneath each dispenser unit, at each piping elbow, and at every 20 ft of product piping, as applicable.

The soil samples are collected in steam cleaned brass or steel tubes from either a driven split-spoon type sampler or the bucket of a backhoe. When a backhoe is used, approximately three inches of soil are scraped from the surface and the tube is driven into the exposed soil.

Upon removal from the split-spoon sampler or the backhoe, the samples are trimmed flush, capped with Teflon sheets and plastic end caps, labeled, logged and refrigerated for delivery under chain of custody to a State certified analytic laboratory.

F:\TEMPLATE\SOPs\PIPING.doc

**ATTACHMENT B**

Certified Analytical Laboratory Report

**Cambria Environmental Emeryville**

August 23, 2004

5900 Hollis Street, Ste. A  
Emeryville, CA 94608

Attn.: Jason Gerke

Site: 3600 Park Blvd., Oakland

Attached is our report for your samples received on 08/20/2004 16:30  
This report has been reviewed and approved for release. Reproduction of this report  
is permitted only in its entirety.

Please note that any unused portion of the samples will be discarded after  
10/04/2004 unless you have requested otherwise.

We appreciate the opportunity to be of service to you. If you have any questions,

You can also contact me via email. My email address is: [mbrewer@stl-inc.com](mailto:mbrewer@stl-inc.com)

Sincerely,

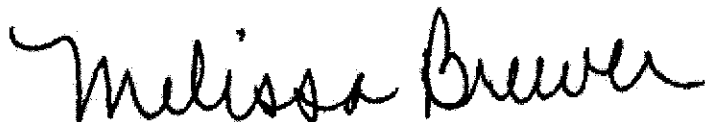

Melissa Brewer  
Project Manager

**Gas/BTEXFuel Oxygenates by 8260B (High Level)**

Cambria Environmental Emeryville

Attn.: Jason Gerke

5900 Hollis Street, Ste. A

Emeryville, CA 94608

Phone: (510) 420-3320 Fax: (510) 420-9170

Project:

Received: 08/20/2004 16:30

Site: 3600 Park Blvd., Oakland

**Samples Reported**

Sample Name	Date Sampled	Matrix	Lab #
D-1-5'	08/20/2004 11:30	Soil	1

Severn Trent Laboratories, Inc.

STL San Francisco \* 1220 Quarry Lane, Pleasanton, CA 94566

Tel 925 484 1919 Fax 925 484 1096 \* www.stl-inc.com \* CA DHS ELAP# 2496

08/23/2004 14:34

**Gas/BTEXFuel Oxygenates by 8260B (High Level)**

Cambria Environmental Emeryville

Attn.: Jason Gerke

5900 Hollis Street, Ste. A  
Emeryville, CA 94608  
Phone: (510) 420-3320 Fax: (510) 420-9170

Project:

Received: 08/20/2004 16:30

Site: 3600 Park Blvd., Oakland

Prep(s): 5030B	Test(s): 8260B
Sample ID: D-1-5	Lab ID: 2004-08-0540-1
Sampled: 08/20/2004 11:30	Extracted: 8/23/2004 10:53
Matrix: Soil	QC Batch#: 2004/08/23-2A.66
Analysis Flag: o ( See Legend and Note Section )	

Compound	Conc.	RL	Unit	Dilution	Analyzed	Flag
Gasoline	180	50	mg/Kg	1.00	08/23/2004 10:53	g
Benzene	ND	0.50	mg/Kg	1.00	08/23/2004 10:53	
Toluene	ND	0.50	mg/Kg	1.00	08/23/2004 10:53	
Ethyl benzene	ND	0.50	mg/Kg	1.00	08/23/2004 10:53	
Total xylenes	2.3	0.50	mg/Kg	1.00	08/23/2004 10:53	
Methyl tert-butyl ether (MTBE)	ND	0.50	mg/Kg	1.00	08/23/2004 10:53	
<b>Surrogate(s)</b>						
1,2-Dichloroethane-d4	84.7	53-129	%	1.00	08/23/2004 10:53	
Toluene-d8	90.7	47-136	%	1.00	08/23/2004 10:53	

Severn Trent Laboratories, Inc.

STL San Francisco \* 1220 Quarry Lane, Pleasanton, CA 94566

Tel 925 484 1919 Fax 925 484 1096 \* www.stl-inc.com \* CA DHS ELAP# 2496

08/23/2004 14:34

**Gas/BTEXFuel Oxygenates by 8260B (High Level)**

Cambria Environmental Emeryville

Attn.: Jason Gerke

5900 Hollis Street, Ste. A  
Emeryville, CA 94608  
Phone: (510) 420-3320 Fax: (510) 420-9170

Project:

Received: 08/20/2004 16:30

Site: 3600 Park Blvd., Oakland

Batch QC Report			
Prep(s): 5030B			Test(s): 8260B
Method Blank	Soil		QC Batch # 2004/08/23-2A.66
MB: 2004/08/23-2A.66-020			Date Extracted: 08/23/2004 10:20

Compound	Conc.	RL	Unit	Analyzed	Flag
Gasoline	ND	50	mg/Kg	08/23/2004 10:20	
Benzene	ND	0.50	mg/Kg	08/23/2004 10:20	
Toluene	ND	0.50	mg/Kg	08/23/2004 10:20	
Ethyl benzene	ND	0.50	mg/Kg	08/23/2004 10:20	
Total xylenes	ND	0.50	mg/Kg	08/23/2004 10:20	
Methyl tert-butyl ether (MTBE)	ND	0.50	mg/Kg	08/23/2004 10:20	
<b>Surrogates(s)</b>					
1,2-Dichloroethane-d4	86.4	53-129	%	08/23/2004 10:20	
Toluene-d8	89.6	47-136	%	08/23/2004 10:20	

**Gas/BTEXFuel Oxygenates by 8260B (High Level)**

Cambria Environmental Emeryville

Attn.: Jason Gerke

5900 Hollis Street, Ste. A  
Emeryville, CA 94608  
Phone: (510) 420-3320 Fax: (510) 420-9170

Project:

Received: 08/20/2004 16:30

Site: 3600 Park Blvd., Oakland

Batch QC Report										
Prep(s): 5030B						Test(s): 8260B				
Laboratory Control Spike			Soil			QC Batch # 2004/08/23-2A.66				
LCS	2004/08/23-2A.66-035		Extracted: 08/23/2004			Analyzed: 08/23/2004 09:35				
LCSD	2004/08/23-2A.66-057		Extracted: 08/23/2004			Analyzed: 08/23/2004 09:57				
Compound	Conc. mg/Kg		Exp.Conc.	Recovery %		RPD	Ctrl.Limits %		Flags	
	LCS	LCSD		LCS	LCSD		%	Rec.	RPD	LCS
Benzene	9.54	10.4	10	95.4	104.0	8.6	69-129	20		
Toluene	9.53	10.6	10	95.3	106.0	10.6	70-130	20		
Methyl tert-butyl ether (MTBE)	7.65	9.31	10	76.5	93.1	19.6	65-165	20		
<b>Surrogates(s)</b>										
1,2-Dichloroethane-d4	205	223	250	82.0	89.2		53-129			
Toluene-d8	227	253	250	90.8	101.2		47-136			

Severn Trent Laboratories, Inc.

STL San Francisco \* 1220 Quarry Lane, Pleasanton, CA 94566

Tel 925 484 1919 Fax 925 484 1096 \* www.stl-inc.com \* CA DHS ELAP# 2496

08/23/2004 14:34

**Gas/BTEXFuel Oxygenates by 8260B (High Level)**

Cambria Environmental Emeryville

Attn.: Jason Gerke

5900 Hollis Street, Ste. A

Emeryville, CA 94608

Phone: (510) 420-3320 Fax: (510) 420-9170

Project:

Received: 08/20/2004 16:30

Site: 3600 Park Blvd., Oakland

**Legend and Notes**

**Analysis Flag**

o

Reporting limits were raised due to high level of analyte present in the sample.

**Result Flag**

g

Hydrocarbon reported in the gasoline range does not match our gasoline standard.



**Gas/BTEX Fuel Oxygenates by 8260B (C6-C12)**

Cambria Environmental Emeryville

Attn.: Jason Gerke

5900 Hollis Street, Ste. A  
Emeryville, CA 94608  
Phone: (510) 420-3320 Fax: (510) 420-9170

Project:

Received: 08/20/2004 16:30

Site: 3600 Park Blvd., Oakland

**Samples Reported**

Sample Name	Date Sampled	Matrix	Lab #
SP-1	08/20/2004 12:30	Soil	2
D-2-5'	08/20/2004 11:45	Soil	3
D-3-5'	08/20/2004 12:00	Soil	4
D-4-5'	08/20/2004 12:15	Soil	5

Severn Trent Laboratories, Inc.

STL San Francisco \* 1220 Quarry Lane, Pleasanton, CA 94566

Tel 925 484 1919 Fax 925 484 1096 \* www.stl-inc.com \* CA DHS ELAP# 2496

08/23/2004 14:33

**Gas/BTEX Fuel Oxygenates by 8260B (C6-C12)**

Cambria Environmental Emeryville

Attn.: Jason Gerke

5900 Hollis Street, Ste. A  
Emeryville, CA 94608  
Phone: (510) 420-3320 Fax: (510) 420-9170

Project:

Received: 08/20/2004 16:30

Site: 3600 Park Blvd., Oakland

Prep(s):	5030B	Test(s):	8260B
Sample ID:	SP-1	Lab ID:	2004-08-0540 - 2
Sampled:	08/20/2004 12:30	Extracted:	8/21/2004 16:36
Matrix:	Soil	QC Batch#:	2004/08/21-1A.66

Compound	Conc.	RL	Unit	Dilution	Analyzed	Flag
Gasoline	ND	1.0	mg/Kg	1.00	08/21/2004 16:36	
Benzene	ND	0.0050	mg/Kg	1.00	08/21/2004 16:36	
Toluene	ND	0.0050	mg/Kg	1.00	08/21/2004 16:36	
Ethyl benzene	ND	0.0050	mg/Kg	1.00	08/21/2004 16:36	
Total xylenes	ND	0.0050	mg/Kg	1.00	08/21/2004 16:36	
<b>Surrogate(s)</b>						
1,2-Dichloroethane-d4	111.6	76-124	%	1.00	08/21/2004 16:36	
Toluene-d8	94.4	75-116	%	1.00	08/21/2004 16:36	

**Gas/BTEX Fuel Oxygenates by 8260B (C6-C12)**

Cambria Environmental Emeryville

Attn.: Jason Gerke

5900 Hollis Street, Ste. A  
Emeryville, CA 94608  
Phone: (510) 420-3320 Fax: (510) 420-9170

Project:

Received: 08/20/2004 16:30

Site: 3600 Park Blvd., Oakland

Prep(s): 5030B	Test(s): 8260B
Sample ID: D-2-5	Lab ID: 2004-08-0540 - 3
Sampled: 08/20/2004 11:45	Extracted: 8/21/2004 16:58
Matrix: Soil	QC Batch#: 2004/08/21-1A.66

Compound	Conc.	RL	Unit	Dilution	Analyzed	Flag
Gasoline	ND	1.0	mg/Kg	1.00	08/21/2004 16:58	
Benzene	ND	0.0050	mg/Kg	1.00	08/21/2004 16:58	
Toluene	ND	0.0050	mg/Kg	1.00	08/21/2004 16:58	
Ethyl benzene	ND	0.0050	mg/Kg	1.00	08/21/2004 16:58	
Total xylenes	ND	0.0050	mg/Kg	1.00	08/21/2004 16:58	
Methyl tert-butyl ether (MTBE)	ND	0.0050	mg/Kg	1.00	08/21/2004 16:58	
<b>Surrogate(s)</b>						
1,2-Dichloroethane-d4	105.1	76-124	%	1.00	08/21/2004 16:58	
Toluene-d8	99.3	75-116	%	1.00	08/21/2004 16:58	

Severn Trent Laboratories, Inc.

STL San Francisco \* 1220 Quarry Lane, Pleasanton, CA 94566

Tel 925 484 1919 Fax 925 484 1096 \* www.stl-inc.com \* CA DHS ELAP# 2496

08/23/2004 14:33

**Gas/BTEX Fuel Oxygenates by 8260B (C6-C12)**

Cambria Environmental Emeryville

Attn.: Jason Gerke

5900 Hollis Street, Ste. A

Emeryville, CA 94608

Phone: (510) 420-3320 Fax: (510) 420-9170

Project:

Received: 08/20/2004 16:30

Site: 3600 Park Blvd., Oakland

Prep(s):	5030B	Test(s):	8260B
Sample ID:	D-3-5	Lab ID:	2004-08-0540 - 4
Sampled:	08/20/2004 12:00	Extracted:	8/21/2004 17:21
Matrix:	Soil	QC Batch#:	2004/08/21-1A.66

Compound	Conc.	RL	Unit	Dilution	Analyzed	Flag
Gasoline	ND	1.0	mg/Kg	1.00	08/21/2004 17:21	
Benzene	ND	0.0050	mg/Kg	1.00	08/21/2004 17:21	
Toluene	ND	0.0050	mg/Kg	1.00	08/21/2004 17:21	
Ethyl benzene	ND	0.0050	mg/Kg	1.00	08/21/2004 17:21	
Total xylenes	ND	0.0050	mg/Kg	1.00	08/21/2004 17:21	
Methyl tert-butyl ether (MTBE)	ND	0.0050	mg/Kg	1.00	08/21/2004 17:21	
<b>Surrogate(s)</b>						
1,2-Dichloroethane-d4	106.0	76-124	%	1.00	08/21/2004 17:21	
Toluene-d8	99.7	75-116	%	1.00	08/21/2004 17:21	

Severn Trent Laboratories, Inc.

STL San Francisco \* 1220 Quarry Lane, Pleasanton, CA 94566

Tel 925 484 1919 Fax 925 484 1096 \* www.stl-inc.com \* CA DHS ELAP# 2496

08/23/2004 14:33

**Gas/BTEX Fuel Oxygenates by 8260B (C6-C12)**

Cambria Environmental Emeryville

Attn.: Jason Gerke

5900 Hollis Street, Ste. A

Emeryville, CA 94608

Phone: (510) 420-3320 Fax: (510) 420-9170

Project:

Received: 08/20/2004 16:30

Site: 3600 Park Blvd., Oakland

Prep(s):	5030B	Test(s):	8260B
Sample ID:	D-4-5	Lab ID:	2004-08-0540 - 5
Sampled:	08/20/2004 12:15	Extracted:	8/21/2004 17:43
Matrix:	Soil	QC Batch#:	2004/08/21-1A.66
Analysis Flag: o ( See Legend and Note Section )			

Compound	Conc.	RL	Unit	Dilution	Analyzed	Flag
Gasoline	30	5.0	mg/Kg	4.95	08/21/2004 17:43	g
Benzene	ND	0.025	mg/Kg	4.95	08/21/2004 17:43	
Toluene	ND	0.025	mg/Kg	4.95	08/21/2004 17:43	
Ethyl benzene	ND	0.025	mg/Kg	4.95	08/21/2004 17:43	
Total xylenes	ND	0.025	mg/Kg	4.95	08/21/2004 17:43	
Methyl tert-butyl ether (MTBE)	ND	0.025	mg/Kg	4.95	08/21/2004 17:43	
<b>Surrogate(s)</b>						
1,2-Dichloroethane-d4	102.7	76-124	%	4.95	08/21/2004 17:43	
Toluene-d8	96.8	75-116	%	4.95	08/21/2004 17:43	

Severn Trent Laboratories, Inc.

STL San Francisco \* 1220 Quarry Lane, Pleasanton, CA 94566

Tel 925 484 1919 Fax 925 484 1096 \* www.stl-inc.com \* CA DHS ELAP# 2496

08/23/2004 14:33

**Gas/BTEX Fuel Oxygenates by 8260B (C6-C12)**

Cambria Environmental Emeryville

Attn.: Jason Gerke

5900 Hollis Street, Ste. A  
Emeryville, CA 94608  
Phone: (510) 420-3320 Fax: (510) 420-9170

Project:

Received: 08/20/2004 16:30

Site: 3600 Park Blvd., Oakland

Batch QC Report					
Prep(s): 5030B				Test(s): 8260B	
Method Blank		Soil		QC Batch # 2004/08/21-1A.66	
MB: 2004/08/21-1A.66-020				Date Extracted: 08/21/2004 09:20	

Compound	Conc.	RL	Unit	Analyzed	Flag
Gasoline	ND	1.0	mg/Kg	08/21/2004 09:20	
Methyl tert-butyl ether (MTBE)	ND	0.0050	mg/Kg	08/21/2004 09:20	
Benzene	ND	0.0050	mg/Kg	08/21/2004 09:20	
Toluene	ND	0.0050	mg/Kg	08/21/2004 09:20	
Ethyl benzene	ND	0.0050	mg/Kg	08/21/2004 09:20	
Total xylenes	ND	0.0050	mg/Kg	08/21/2004 09:20	
<b>Surrogates(s)</b>					
1,2-Dichloroethane-d4	95.8	76-124	%	08/21/2004 09:20	
Toluene-d8	97.0	75-116	%	08/21/2004 09:20	

**Gas/BTEX Fuel Oxygenates by 8260B (C6-C12)**

Cambria Environmental Emeryville

Attn.: Jason Gerke

5900 Hollis Street, Ste. A

Emeryville, CA 94608

Phone: (510) 420-3320 Fax: (510) 420-9170

Project:

Received: 08/20/2004 16:30

Site: 3600 Park Blvd., Oakland

Batch QC Report									
Prep(s): 5030B					Test(s): 8260B				
Laboratory Control Spike			Soil			QC Batch # 2004/08/21-1A.66			
LCS	2004/08/21-1A.66-035		Extracted: 08/21/2004			Analyzed: 08/21/2004 08:35			
LCSD	2004/08/21-1A.66-057		Extracted: 08/21/2004			Analyzed: 08/21/2004 08:57			

Compound	Conc. mg/Kg		Exp. Conc.	Recovery %		RPD	Ctrl. Limits %		Flags	
	LCS	LCSD		LCS	LCSD		%	Rec.	RPD	LCS
Methyl tert-butyl ether (MTBE)	0.0544	0.0534	0.05	108.8	106.8	1.9	65-165	20		
Benzene	0.0528	0.0539	0.05	105.6	107.8	2.1	69-129	20		
Toluene	0.0487	0.0512	0.05	97.4	102.4	5.0	70-130	20		
<b>Surrogates(s)</b>										
1,2-Dichloroethane-d4	486	459	500	97.2	91.8		76-124			
Toluene-d8	504	505	500	100.8	101.0		75-116			

Severn Trent Laboratories, Inc.

STL San Francisco \* 1220 Quarry Lane, Pleasanton, CA 94566

Tel 925 484 1919 Fax 925 484 1096 \* www.stl-inc.com \* CA DHS ELAP# 2496

08/23/2004 14:33

**Gas/BTEX Fuel Oxygenates by 8260B (C6-C12)**

Cambria Environmental Emeryville

Attn.: Jason Gerke

5900 Hollis Street, Ste. A

Emeryville, CA 94608

Phone: (510) 420-3320 Fax: (510) 420-9170

Project:

Received: 08/20/2004 16:30

Site: 3600 Park Blvd., Oakland

**Legend and Notes**

**Analysis Flag**

o

Reporting limits were raised due to high level of analyte present in the sample.

**Result Flag**

g

Hydrocarbon reported in the gasoline range does not match our gasoline standard.

Severn Trent Laboratories, Inc.

STL San Francisco \* 1220 Quarry Lane, Pleasanton, CA 94566

Tel 925 484 1919 Fax 925 484 1096 \* www.stl-inc.com \* CA DHS ELAP# 2496

08/23/2004 14:33



**Total Lead**

Cambria Environmental Emeryville

Attn.: Jason Gerke

5900 Hollis Street, Ste. A

Emeryville, CA 94608

Phone: (510) 420-3320 Fax: (510) 420-9170

Project:

Received: 08/20/2004 16:30

Site: 3600 Park Blvd., Oakland

**Samples Reported**

Sample Name	Date Sampled	Matrix	Lab #
SP-1	08/20/2004 12:30	Soil	2

Severn Trent Laboratories, Inc.

STL San Francisco \* 1220 Quarry Lane, Pleasanton, CA 94566

Tel 925 484 1919 Fax 925 484 1096 \* www.stl-inc.com \* CA DHS ELAP# 2496

08/23/2004 14:46

**Total Lead**

Cambria Environmental Emeryville

Attn.: Jason Gerke

5900 Hollis Street, Ste. A

Emeryville, CA 94608

Phone: (510) 420-3320 Fax: (510) 420-9170

Project:

Received: 08/20/2004 16:30

Site: 3600 Park Blvd., Oakland

Prep(s):	3050B	Test(s):	6010B
Sample ID:	SP-1	Lab ID:	2004-08-0540 - 2
Sampled:	08/20/2004 12:30	Extracted:	8/20/2004 11:07
Matrix:	Soil	QC Batch#:	2004/08/20-03.15

Compound	Conc.	RL	Unit	Dilution	Analyzed	Flag
Lead	6.7	1.0	mg/Kg	1.00	08/23/2004 11:43	

Severn Trent Laboratories, Inc.

STL San Francisco \* 1220 Quarry Lane, Pleasanton, CA 94566

Tel 925 484 1919 Fax 925 484 1096 \* www.stl-inc.com \* CA DHS ELAP# 2496

08/23/2004 14:46

**Total Lead**

Cambria Environmental Emeryville  
Attn.: Jason Gerke

5900 Hollis Street, Ste. A  
Emeryville, CA 94608  
Phone: (510) 420-3320 Fax: (510) 420-9170

Project:

Received: 08/20/2004 16:30

Site: 3600 Park Blvd., Oakland

**Batch QC Report**

Prep(s): 3050B

Test(s): 6010B

Method Blank

Soil

QC Batch # 2004/08/20-03.15

MB: 2004/08/20-03.15-041

Date Extracted: 08/20/2004 11:07

Compound	Conc.	RL	Unit	Analyzed	Flag
Lead	ND	1.0	mg/Kg	08/23/2004 11:01	

Severn Trent Laboratories, Inc.

STL San Francisco \* 1220 Quarry Lane, Pleasanton, CA 94566

Tel 925 484 1919 Fax 925 484 1096 \* www.stl-inc.com \* CA DHS ELAP# 2496

08/23/2004 14:46

**Total Lead**

Cambria Environmental Emeryville  
Attn.: Jason Gerke

5900 Hollis Street, Ste. A  
Emeryville, CA 94608  
Phone: (510) 420-3320 Fax: (510) 420-9170

Project:

Received: 08/20/2004 16:30

Site: 3600 Park Blvd., Oakland

Batch QC Report										
Prep(s): 3050B						Test(s): 6010B				
Laboratory Control Spike				Soil			QC Batch # 2004/08/20-03.15			
LCS	2004/08/20-03.15-042			Extracted: 08/20/2004			Analyzed: 08/23/2004 11:05			
LCSD	2004/08/20-03.15-043			Extracted: 08/20/2004			Analyzed: 08/23/2004 11:11			
Compound	Conc. mg/Kg		Exp.Conc.	Recovery %		RPD	Ctrl.Limits %		Flags	
	LCS	LCSD		LCS	LCSD		%	Rec.	RPD	LCS
Lead	94.5	92.5	100.0	94.5	92.5	2.1	80-120	20		

**2004-08-0540**

90261

1220 Quarry Lane  
Pleasanton, CA 94566

Shell Project Manager to be Invoiced:

- SCIENCE & ENGINEERING
- TECHNICAL SERVICES
- CRIME-HOUSTON

Bill Marchant

INCIDENT NUMBER (SAE ONLY)

SAP or CRMT NUMBER (ITS/DRMT)

1 3 5 6 8 9

DATE: 8/10/04  
PAGE: 1 of 2

(925) 484-1919 (925) 484-1096 fax

COMPLER COMPANY: <b>CAMBRIA ENVIRONMENTAL TECHNOLOGY INC</b>		SITE ADDRESS (Please print any city): <b>3600 Park Blvd, Oakland</b>	ADDRESS: <b>5900 HOLLIS ST, Suite A, Emeryville, CA 94608</b>	
PROJECT CONTACT (Name and title of Rep): <b>Jason Gerke</b>		PROJECT NAME: <b>Shell Oakland EOP</b>		PROJECT CONTACT EMAIL: <b>JGerke@Cambria-env.com</b>
TELEPHONE: <b>(510) 420-3320</b>	FAX: <b>(510) 420-9170</b>	CAMBRIA NAME (Print): <b>Jason Gerke</b>		
UPWARD TIME (BUSINESS DAYS): <input type="checkbox"/> 10 DAYS <input type="checkbox"/> 5 DAYS <input type="checkbox"/> 72 HOURS <input type="checkbox"/> 48 HOURS <input checked="" type="checkbox"/> 24 HOURS <input type="checkbox"/> LESS THAN 24 HOURS				
REQUESTED ANALYSIS				

LAB USE ONLY

FIELD NOTES:  
Container/Preservative or PID Readings or Laboratory Notes

# RUSH

TEMPERATURE ON RECEIPT OF: 6

<input type="checkbox"/> LA - RWCC REPORT FORMAT <input checked="" type="checkbox"/> LIST AGENCY				
SPECIAL INSTRUCTIONS OR NOTES: <span style="float: right;">CHECK BOX IF EDD IS NOT NEEDED: <input type="checkbox"/></span> <p style="font-size: 24px; font-weight: bold;">24 hr TAT</p> <p>cc: cww@cambria-env.com</p>				

DATE	TIME	MTRIX	NO. OF CONT.	ANALYSIS												TEMPERATURE ON RECEIPT OF							
				TPH - Purgeable	TPH - Extractable (per 15m)	BTEX	MNBE	IBA	P. Oxygenates	1,2 DCA and EDB	Ethanol	Methanol	VOCs by 8240G	Semi-Volatiles by 8270C	Lead <input type="checkbox"/> Total <input type="checkbox"/> STLC <input type="checkbox"/> TOLP		Cadmium <input type="checkbox"/> Total <input type="checkbox"/> STLC <input type="checkbox"/> TOLP	CAM17 <input type="checkbox"/> Total <input type="checkbox"/> STLC <input type="checkbox"/> TOLP	Test for Disposal (see attached)				
		D-1-5'	8/10/04 11:30	Soil	1	X		X	X														
		D-2-5'	11:45	↓	1	X		X	X														
		D-3-5'	12:00	↓	1	X		X	X														
		D-4-5'	12:15	↓	1	X		X	X														
		SP-1A	8/20/04 12:00	Soil	1	X		X															
		SP-1B	↓	↓	1	X		X															
		SP-1C	↓	↓	1	X		X															
		SP-1D	↓	↓	1	X		X															

Prepared By (Signature): 	Received By (Signature): 	Date: 8/10/04 Time: 1:00
Prepared By (Signature): 	Received By (Signature): 	Date: 8-20-04 Time: 4:30
Prepared By (Signature): 	Received By (Signature): 	Date: 8-20-04 Time: 18:30

DISTRIBUTE WITH TEST REPORT. DESIGN BY EHS. XEROX COPY FOR CLIENT.  
G:\Oakland 3600 Park\2004 Upgrades\3600Oakland COC.xls\STL

This information is business proprietary and confidential and must not be divulged or shared outside the company. The use of this information is strictly for the purpose of doing business with the Centralized Residual Management Team (CRMT). Upon termination of the relationship with the CRMT, this information is not to be forwarded, duplicated, shared or used for any purpose other than for the documentation of past actions.

RESIDUAL MANAGEMENT PROCEDURE

ISSUED DATE: 08/01/01  
CANCELS ISSUE:  
ISSUED BY: LRR

RESIDUAL STREAM: SOIL WITH UNLEADED GASOLINE ~~+ DIESEL~~  
VENDOR: ALLIED-BFI  
LOCATION: ALLIED WASTE - MANTECA  
9999 SOUTH AUSTIN ROAD  
MANTECA, CA 95336

CALIFORNIA - TRANSPORTATION AND RETAIL

BTEX - EPA 8021B/8260B (IF BENZENE IS > OR = TO 10 MG/KG THEN TCLP BENZENE IS REQUIRED)

CAM METALS = TTLC METALS - *lead only*  
STLC ON ALL TTLC METALS 10 TIMES STLC MAXIMUM  
TTLC LEAD => 13 MG/KG REQUIRES ORGANIC LEAD ANALYSIS  
IF ANY TTLC TOTAL METAL IS > OR = TO 20 TIMES TCLP REGULATORY LEVELS, TCLP IS REQUIRED

TOTAL PETROLEUM HYDROCARBONS, METHOD 418.1 OR 8015 - ~~GASOLINE AND DIESEL~~

~~ATDE METHOD 8260B (GC/MS)~~

AQUATIC BIOASSAY (FISH TOX) IS ONLY TO BE RUN ON SAMPLES > OR = TO 5000 PPM TPH. AQUATIC BIOASSAY (FISH TOX) = PART 800 OF STANDARD METHODS FOR THE EXAMINATION OF WATER AND WASTEWATER (15TH EDITION)

LABORATORY INSTRUCTIONS (MINIMUM GUIDELINES ONLY)  
-ALTERNATE APPROVED TEST METHODS PER SW846 ARE ALSO ACCEPTABLE  
-ALL REQUIRED TESTS ON COMPOSITE (*max 4:1*)  
-LABORATORY IS TO SUPPLY QA/QC INFORMATION WITH ALL ANALYTICAL REPORTS  
~~MAIL OR FAX ALL ANALYSIS TO THE CENTRALIZED RESIDUAL MANAGEMENT TEAM~~

PROCEDURE ORIGINAL DATE: 08/01/01  
PROCEDURE REVISED DATE: 08/01/01

2004-08-0540

**ATTACHMENT C**

Soil Disposal Confirmation Report



**FAXED**

Hazardous Waste Hauler (Registration #2843)

8896 Elder Creek Rd. • Sacramento, CA 95828 • FAX (916) 381-1573

### Disposal Confirmation

Request for Transportation Received: 08/31/04

### Consultant Information

Company: Cambria Environmental  
Contact: Stu Dalie  
Phone: 510 420-3339  
Fax: 510 420-9170

### Site Information

Station #: N/A  
Street Address: 3600 Park Blvd  
City, State, ZIP: Oakland, CA

Customer: Shell Oil Company RESA-0023-LDC  
RIPR #: 37655  
SAP # / Location: 135689  
Incident #: \_\_\_\_\_  
Location / WIC #: \_\_\_\_\_  
Environmental Engineer: Jim Martin

Material Description: Contaminated Soil  
Estimated Quantity: 5 yards  
Service Requested Date: \_\_\_\_\_

Disposal Facility: Forward Landfill  
Contact: Joe Griffith  
Phone: 800 204-4242  
Approval #: 4775  
Date of Disposal: 09/07/04  
Actual Tonnage: 20.47

Transporter: Manley & Sons Trucking, Inc.  
Contact: Janice Cox  
Phone: 916 381-6864  
Fax: 916 381-1573  
Invoice: 52511  
Date of Invoice: 9/10/04



**ATTACHMENT D**  
Water Disposal Documentation

ATTENTION SHIPPERS!

FREIGHT CHARGES ARE PREPAID ON THIS BILL OF LADING UNLESS MARKED COLLECT.

# STRAIGHT BILL OF LADING

ORIGINAL — NOT NEGOTIABLE

Shipper No. GRW 0935

Carrier No. \_\_\_\_\_

Page 1 of 1

ONYX INDUSTRIAL SERVICES  
(Name of carrier) (SCAC)

Date 8-19-04

On Collect on Delivery shipments, the letters "COD" must appear before consignee's name or as otherwise provided in Item 430, Sec. 1.

TO: **Shell Oil Products US**  
 Consignee **MARTINEZ REFINERY**

Street **1801 MARINA VISTA**

City **MARTINEZ** State **CA** Zip Code **94553**

FROM: Shipper **SERVICE STATION**

Street **3600 PARK BLVD.**

City **OAKLAND** State **CA** Zip Code \_\_\_\_\_

24 hr. Emergency Contact Tel. No. **CHEMTREC 800-424-9300**

Route		Vehicle Number <u>2674/2583</u>				
No. of Units & Container Type	HM	BASIC DESCRIPTION Proper Shipping Name, Hazard Class, Identification Number (UN or NA), Packing Group, per 172.101, 172.202, 172.203	TOTAL QUANTITY (Weight, Volume, Gallons, etc.)	WEIGHT (Subject to Correction)	RATE	CHARGES (For Carrier Use Only)
<u>1 T.T.</u>		<b>NON-HAZARDOUS GROUNDWATER</b>	<u>4000 GALS</u> <u>5094 "</u>			
		<b>Contains water with &lt; 10% oil bearing materials and may include extracted groundwater from service station facilities that would be non-hazardous under federal and state waste classification criteria.</b>				
		<b>SOP US Martinez Refinery Receiving Gate to direct driver to the Effluent Treatment Plant Operator (x3202) for off loading directions.</b>				
		<b>SAP/INCIDENT #: <u>135689/98995747</u></b>				
		<b>RIPR #: <u>37311</u></b>				

PLACARDS TENDERED: YES  NO

Note—(1) Where the rate is dependent on value, shippers are required to state specifically in writing the agreed or declared value of the property, as follows: "The agreed or declared value of the property is hereby specifically stated by the shipper to be not exceeding \_\_\_\_\_ per \_\_\_\_\_."

(2) Where the applicable tariff provisions specify a limitation of the carrier's liability absent a release or a value declaration by the shipper and the shipper does not release the carrier's liability or declare a value, the carrier's liability shall be limited to the extent provided by such provisions. See NMFC Item 172.

(3) Commodities requiring special or additional care or attention in handling or loading must be so marked and packaged as to ensure safe transportation. See Section 2(e) of item 360, Bills of Lading, Freight Bills and Statements of Charges and Section 1(a) of the Contract Terms and Conditions for a list of such articles.

I hereby declare that the contents of this consignment are fully and accurately described above by the proper shipping name and are classified, packaged, marked and labelled/placarded, and are in all respects in proper condition for transport according to applicable international and national governmental regulations.

*[Signature]* Signature

REMIT C.O.D. TO: ADDRESS

**COD** Amt: \$ \_\_\_\_\_

Subject to Section 7 of the conditions, if this shipment is to be delivered to the consignee without recourse on the consignor, the consignor shall sign the following statement:  
The carrier shall not make delivery of this shipment without payment of freight and all other lawful charges.

C.O.D. FEE: PREPAID  COLLECT  \$ \_\_\_\_\_

TOTAL CHARGES \$ \_\_\_\_\_

FREIGHT CHARGES  
FREIGHT PREPAID except when box at right is checked  Check box if charges are to be collect

RECEIVED, subject to the classifications and tariffs in effect on the date of issue of this Bill of Lading, the property described above in apparent good order, except as noted (contents and condition of contents of packages unknown), marked, consigned, and destined as indicated above which said carrier (the word carrier being understood throughout this contract as meaning any person or corporation in possession of the property under the contract) agrees to carry to its usual place of delivery at said destination, if on its route, otherwise to deliver to another carrier on the route to said destination. It is mutually agreed as to each carrier of all or any of, said property over all or any portion of said route to

destination and as to each party at any time interested in all or any said property, that every service to be performed hereunder shall be subject to all the bill of lading terms and conditions in the governing classification on the date of shipment.

Shipper hereby certifies that he is familiar with all the lading terms and conditions in the governing classification and the said terms and conditions are hereby agreed to by the shipper and accepted for himself and his assigns.

SHIPPER **Shell Oil Products US**

CARRIER ONYX IND. SERV.

BY *[Signature]* ON BEHALF OF SHELL / EQUILON

PER *[Signature]*

RECEIVING SITE SIGNATURE / DATE:

DATE 8-19-04

Permanent post-office address of shipper.

1

**STRAIGHT BILL OF LADING - SHORT FORM - Original - Not Negotiable**

Shipper's No. \_\_\_\_\_

(Carrier) PSC

SCAC \_\_\_\_\_

Carrier's No. \_\_\_\_\_

Received, subject to the classifications and tariffs in effect on the date of this Bill of Lading:

at 395 West Channel Road, date \_\_\_\_\_ from Bericia CA

the property described below, in apparent good order, except as noted (contents and condition of contents of packages unknown), marked, consigned, and destined as indicated below, which said company (the word company being understood throughout this contract as meaning any person or corporation in possession of the property under the contract) agrees to carry to its usual place of delivery at said destination, if on its own road or its own water line, otherwise to deliver to another carrier on the route to said destination. It is mutually agreed, as to each carrier of all or any of said property over all or any portion of said route to destination, and as to each party at any time interested in all or any of said property, that every service to be performed hereunder shall be subject to all the conditions not prohibited by law, whether printed or written, herein contained (as specified in Appendix B to Part 1035) which are hereby agreed to by the shipper and accepted for himself and his assigns.

**TO:** (Mail or street address of consignee for purposes of notification only.)  
 Consignee Shell Oil Products US  
Martinez Refinery  
 Street 1801 Marina Vista  
 Destination Martinez CA Zip \_\_\_\_\_  
 Route: \_\_\_\_\_

**FROM:**  
 Shipper Service Station  
 Street 3600 Park Road  
 Origin Oakland CA Zip \_\_\_\_\_

Delivering Carrier Psc Trailer Initial/Number \_\_\_\_\_ U.S. DOT Hazmat Reg. Number \_\_\_\_\_

No. of packages	HM	Description of articles, special marks, and exceptions	Hazard Class	I.D. Number	Packing Group	*Weight (subject to correction)	Class or rate	Labels required (or exemption)	Check column
		<u>Gasoline mixture</u> <u>ERG#128</u>	<u>3</u>	<u>UN1203</u>	<u>II</u>				
<p><b>Contains water with &lt;10% oil bearing materials and may include extracted groundwater from service station facilities that would be non-hazardous under federal and state waste classification criteria.</b></p> <p><b>SOP US Martinez Refinery</b>  <b>Receiving Gate to direct driver to the Effluent Treatment Plant Operator (x3202) for off loading directions.</b></p> <p><b>SAP/INCIDENT #:</b>  <b>RIPR# 37311</b></p>									

Remit C.O.D. to:  
 Address: \_\_\_\_\_  
 City: \_\_\_\_\_ State: \_\_\_\_\_ Zip: \_\_\_\_\_

**COD AMT:** \_\_\_\_\_  
 Charges Advanced

Subject to Section 7 of conditions, if this shipment is to be delivered to the consignee without recourse on the consignor, the consignor shall sign the following statement:  
 The carrier shall not make delivery of this shipment without payment of freight and all other lawful charges.

**C. O. D. FEE:**  
 Prepaid   
 Collect  \$ \_\_\_\_\_  
**FREIGHT CHARGES**  
 Prepaid  Collect

If the shipment moves between two ports by a carrier by water, the law requires that the bill of lading shall state whether it is "carrier's or shipper's weight".  
 Note: - where the rate is dependent on value, shippers are required to state specifically in writing the agreed or declared value of the property.  
 The agreed or declared value of the property is hereby specifically stated by the shipper to be not exceeding \_\_\_\_\_ per \_\_\_\_\_

This is to certify that the above-named materials are properly classified, described, packaged, marked and labeled, and are in proper condition for transportation according to the applicable regulations of the Department of Transportation.

**PLACARDS REQUIRED**

**PLACARDS SUPPLIED**

YES  NO - FURNISHED BY CARRIER  
 DRIVER'S SIGNATURE: \_\_\_\_\_

**SPECIAL INSTRUCTIONS:**  
 SHIPPER: Shell Oil Products US  
 PER: Wendell Williams DATE: 2/18/04

CARRIER: PSC  
 PER: Wendell Williams DATE: 2/19/04  
**EMERGENCY RESPONSE TELEPHONE NUMBER:** ( )

Permanent post office address of shipper

Monitored at all times the Hazardous Material is in transportation including storage incidental to transportation (§172.604).

**STRAIGHT BILL OF LADING - SHORT FORM - Original - Not Negotiable**

Shipper's No. \_\_\_\_\_

(Carrier) PSC

SCAC. \_\_\_\_\_

Carrier's No. \_\_\_\_\_

Received, subject to the classifications and tariffs in effect on the date of this Bill of Lading:

at 395 W. Channel Road, date \_\_\_\_\_ from Benicia CA

the property described below, in apparent good order, except as noted (contents and condition of contents of packages unknown), marked, consigned, and destined as indicated below, which said company (the word company being understood throughout this contract as meaning any person or corporation in possession of the property under the contract) agrees to carry to its usual place of delivery at said destination, if on its own road or its own water line, otherwise to deliver to another carrier on the route to said destination. It is mutually agreed, as to each carrier of all or any of said property over all or any portion of said route to destination, and as to each party at any time interested in all or any of said property, that every service to be performed hereunder shall be subject to all the conditions not prohibited by law, whether printed or written, herein contained (as specified in Appendix B to Part 1035) which are hereby agreed to by the shipper and accepted for himself and his assigns.

TO: (Mail or street address of consignee for purposes of notification only.)

Shell Oil Products US

FROM:

Consignee Martinez Refinery

Shipper Service Station

Street 1801 Marina Vista

Street 3600 Park Blvd

Destination Martinez CA Zip \_\_\_\_\_

Origin Oakland CA Zip \_\_\_\_\_

Route: \_\_\_\_\_

Delivering Carrier

PSC

Trailer Initial/Number

U.S. DOT Hazmat Reg. Number

No. of packages	HM	Description of articles, special marks, and exceptions	Hazard Class	I.D. Number	Packing Group	Weight (subject to correction)	Class or rate	Labels required (or exemption)	Check column
<u>4000 Gallons</u>		<u>Gasoline Mixture</u> <u>ERG # 128</u>	<u>3</u>	<u>UN1203</u>	<u>II</u>	<u>4000</u>			
		<b>Contains water with &lt;10% oil bearing materials and may include extracted groundwater from service station facilities that would be non-hazardous under federal and state waste classification criteria.</b>							
		<b>SOP US Martinez Refinery</b>							
		<b>Receiving Gate to direct driver to the Effluent Treatment Plant Operator (x3202) for off loading directions.</b>							
		<b>SAP/INCIDENT #:</b>							
		<b>RIPR# 37311</b>							

Remit C.O.D. to:

Address:

City:

State:

Zip:

**COD**

AMT:

\$

Charges Advanced

\$

Subject to Section 7 of conditions, if this shipment is to be delivered to the consignee without recourse on the consignor, the consignor shall sign the following statement: The carrier shall not make delivery of this shipment without payment of freight and all other lawful charges.

(Signature of consignor)

**C. O. D. FEE:**

Prepaid

Collect  \$

**FREIGHT CHARGES**

Prepaid  Collect

If the shipment moves between two ports by a carrier by water, the law requires that the bill of lading shall state whether it is "carrier's or shipper's weight". Note - where the rate is dependent on value, shippers are required to state specifically in writing the agreed or declared value of the property. The agreed or declared value of the property is hereby specifically stated by the shipper to be not exceeding \_\_\_\_\_ per \_\_\_\_\_.

This is to certify that the above-named materials are properly classified, described, packaged, marked and labeled, and are in proper condition for transportation according to the applicable regulations of the Department of Transportation.

Per \_\_\_\_\_

**PLACARDS REQUIRED**

**PLACARDS SUPPLIED**

YES  NO - FURNISHED BY CARRIER  
DRIVER'S SIGNATURE: \_\_\_\_\_

SPECIAL INSTRUCTIONS:

SHIPPER: Shell Oil Products US

PER: Walter on behalf of PSC DATE: 8/18/04

CARRIER: P.S.C

PER: Denell Williams DATE: 8-19-04

EMERGENCY RESPONSE

TELEPHONE NUMBER: ( ) \_\_\_\_\_

Permanent post office address of shipper

Monitored at all times the Hazardous Material is in transportation including storage incidental to transportation (§172.604).

**ATTACHMENT E**

Unauthorized Release Report

UNDERGROUND STORAGE TANK UNAUTHORIZED RELEASE (LEAK) / CONTAMINATION SITE REPORT			
EMERGENCY <input type="checkbox"/> YES <input checked="" type="checkbox"/> NO		HAS STATE OFFICE OF EMERGENCY SERVICES REPORT BEEN FILED? <input type="checkbox"/> YES <input checked="" type="checkbox"/> NO	
REPORT DATE 08/24/04		CASE #	
FOR LOCAL AGENCY USE ONLY I HEREBY CERTIFY THAT I HAVE DISTRIBUTED THIS INFORMATION ACCORDING TO THE DISTRIBUTION SHOWN ON THE INSTRUCTION SHEET OR THE BACK PAGE OF THIS FORM.			
REPORTED BY	NAME OF INDIVIDUAL FILING REPORT Karen Petryna		PHONE (559) 695-9306
	SIGNATURE <i>Karen Petryna</i>		COMPANY OR AGENCY NAME Shell Oil Products US
	REPRESENTING <input checked="" type="checkbox"/> OWNER/OPERATOR <input type="checkbox"/> REGIONAL BOARD <input type="checkbox"/> LOCAL AGENCY <input type="checkbox"/> OTHER		ADDRESS 20945 S. Wilmington Carson CA 90810
RESPONSIBLE PARTY	NAME Equilon Enterprises dba Shell Oil Products		CONTACT PERSON Karen Petryna
	ADDRESS 20945 S. Wilmington Carson CA 90810		PHONE (559) 695-9306
SITE LOCATION	FACILITY NAME (IF APPLICABLE) Shell-branded Service Station		OPERATOR ( )
	ADDRESS 3600 Park Boulevard Oakland Alameda 94610		PHONE ( )
	CROSS STREET Chatham Road		
IMPLEMENTING AGENCIES	LOCAL AGENCY CITY OF OAKLAND FIRE SERVICES AGENCY		CONTACT PERSON KEITH L. MATTHEWS
	REGIONAL BOARD Regional Water Quality Control Board		PHONE (570) 238-2396
SUBSTANCES INVOLVED	NAME (1) Gasoline Constituents		QUANTITY LOST (GALLONS) <input checked="" type="checkbox"/> UNKNOWN
			<input type="checkbox"/> UNKNOWN
DISCOVERY/ABATEMENT	DATE DISCOVERED 08/23/04	HOW DISCOVERED <input type="checkbox"/> TANK TEST <input type="checkbox"/> TANK REMOVAL <input checked="" type="checkbox"/> OTHER Soil Sampling/Equip Upgrade	INVENTORY CONTROL <input type="checkbox"/> SUBSURFACE MONITORING <input type="checkbox"/> NUISANCE CONDITIONS <input type="checkbox"/>
	DATE DISCHARGE BEGAN Unknown	METHOD USED TO STOP DISCHARGE (CHECK ALL THAT APPLY) <input type="checkbox"/> REMOVE CONTENTS <input type="checkbox"/> CLOSE TANK & REMOVE <input type="checkbox"/> REPAIR PIPING <input type="checkbox"/> REPAIR TANK <input type="checkbox"/> CLOSE TANK & FILL IN PLACE <input type="checkbox"/> CHANGE PROCEDURE <input type="checkbox"/> REPLACE TANK <input type="checkbox"/> OTHER	
	HAS DISCHARGE BEEN STOPPED? Unknown	IF YES, DATE	
SOURCE/CAUSE	SOURCE OF DISCHARGE <input type="checkbox"/> TANK LEAK <input checked="" type="checkbox"/> UNKNOWN <input type="checkbox"/> PIPING LEAK <input type="checkbox"/> OTHER		CAUSE(S) <input type="checkbox"/> OVERFILL <input type="checkbox"/> RUPTURE/FAILURE <input type="checkbox"/> SPILL <input type="checkbox"/> CORROSION <input type="checkbox"/> UNKNOWN <input type="checkbox"/> OTHER
	CASE TYPE <input checked="" type="checkbox"/> UNDETERMINED <input type="checkbox"/> SOIL ONLY <input type="checkbox"/> GROUNDWATER <input type="checkbox"/> DRINKING WATER - (CHECK ONLY IF WATER WELLS HAVE ACTUALLY BEEN AFFECTED)		
CURRENT STATUS	CHECK ONE ONLY <input checked="" type="checkbox"/> NO ACTION TAKEN <input type="checkbox"/> PRELIMINARY SITE ASSESSMENT WORKPLAN SUBMITTED <input type="checkbox"/> POLLUTION CHARACTERIZATION <input type="checkbox"/> LEAK BEING CONFIRMED <input type="checkbox"/> PRELIMINARY SITE ASSESSMENT UNDERWAY <input type="checkbox"/> POST CLEANUP MONITORING IN PROGRESS <input type="checkbox"/> REMEDIATION PLAN <input type="checkbox"/> CASE CLOSED (CLEANUP COMPLETED OR UNNECESSARY) <input type="checkbox"/> CLEANUP UNDERWAY		
	CHECK APPROPRIATE ACTION(S) <input type="checkbox"/> EXCAVATE & DISPOSE (ED) <input type="checkbox"/> REMOVE FREE PRODUCT (FP) <input type="checkbox"/> ENHANCED BIO DEGRADATION (BT) <input type="checkbox"/> CAP SITE (CS) <input type="checkbox"/> EXCAVATE & TREAT (ET) <input type="checkbox"/> PUMP & TREAT GROUNDWATER (GT) <input type="checkbox"/> REPLACE SUPPLY (RS) <input type="checkbox"/> CONTAINMENT BARRIER (CB) <input type="checkbox"/> NO ACTION REQUIRED (NA) <input type="checkbox"/> TREATMENT AT HOICKUP (HA) <input type="checkbox"/> VENT SOIL (VS) <input type="checkbox"/> VACUUM EXTRACT (VE) <input type="checkbox"/> OTHER (OT)		
COMMENTS	Soil Samples collected 8-20-04, final results reported 8-23-04. Maximum known soil concentrations: TPHs: 180 ppm, Benzene: ND Toluene: ND, Ethyl Benzene: ND, Xlenes 2.3 ppm, MTBE: ND *hydrocarbon reported in the gasoline range does not match Lab's standard		