



**CONESTOGA-ROVERS
& ASSOCIATES**

5900 Hollis Street, Suite A
Emeryville, California 94608
Telephone: (510) 420-0700 Fax: (510) 420-9170
www.CRAworld.com

TRANSMITTAL

DATE: August 27, 2010 REFERENCE NO.: 240898
 PROJECT NAME: 510 East 14th Street
(506-510 International Boulevard),
Oakland

TO: Jerry Wickham
Alameda County Environmental Health
1131 Harbor Bay Parkway, Suite 250
Alameda, California 94502-6577

RECEIVED

9:44 am, Sep 01, 2010

Alameda County
Environmental Health

Please find enclosed: Draft Final
 Originals Other
 Prints

Sent via: Mail Same Day Courier
 Overnight Courier Other GeoTracker and Alameda County FTP

QUANTITY	DESCRIPTION
1	Well Destruction Report

As Requested For Review and Comment
 For Your Use

COMMENTS:

If you have any questions regarding the contents of this document, please call Peter Schaefer at (510) 420-3319.

Copy to: Denis Brown, Shell Oil Products US (electronic copy)
 SF Data Room (electronic copy)

Completed by: Peter Schaefer Signed: *Peter Schaefer*

Filing: Correspondence File



Jerry Wickham
Alameda County Environmental Health
1131 Harbor Bay Parkway, Suite 250
Alameda, California 94502-6577

Denis L. Brown
Shell Oil Products US
HSE – Environmental Services
20945 S. Wilmington Ave.
Carson, CA 90810-1039
Tel (707) 865 0251
Fax (707) 865 2542
Email denis.l.brown@shell.com

Re: Shell-branded Service Station
510 East 14th Street (506-510 International Boulevard)
Oakland, California
SAP Code 135695
Incident No. 97601734
ACEH Case No. RO0002853

Dear Mr. Wickham:

The attached document is provided for your review and comment. Upon information and belief, I declare, under penalty of perjury, that the information contained in the attached document is true and correct.

If you have any questions or concerns, please call me at (707) 865-0251.

Sincerely,

A handwritten signature in black ink, appearing to read "Denis L. Brown", is written over a horizontal line.

Denis L. Brown
Project Manager



WELL DESTRUCTION REPORT

**SHELL-BRANDED SERVICE STATION
510 EAST 14TH STREET (506-510 INTERNATIONAL BOULEVARD)
OAKLAND, CALIFORNIA**

**SAP CODE 135695
INCIDENT NO. 97601734
AGENCY NO. RO0002853**

**AUGUST 27, 2010
REF. NO. 240898 (8)**
This report is printed on recycled paper.

**Prepared by:
Conestoga-Rovers
& Associates**

5900 Hollis Street, Suite A
Emeryville, California
U.S.A. 94608

Office: (510) 420-0700
Fax: (510) 420-9170

web: <http://www.CRAworld.com>

TABLE OF CONTENTS

	<u>Page</u>
1.0 INTRODUCTION.....	1
2.0 WELL DESTRUCTION.....	1
2.1 FIELD DATE.....	1
2.2 PERSONNEL PRESENT	1
2.3 DESTRUCTION METHOD	1
2.4 WASTE DISPOSAL.....	1

LIST OF FIGURES
(Following Text)

FIGURE 1 VICINITY MAP

FIGURE 2 SITE PLAN

LIST OF APPENDICES

APPENDIX A PERMIT

1.0 INTRODUCTION

Conestoga-Rovers & Associates (CRA) prepared this report on behalf of Equilon Enterprises LLC dba Shell Oil Products US (Shell) to document the recent well destructions at the referenced site.

The well destructions are required for case closure per Alameda County Environmental Health's (ACEH's) June 11, 2010 letter. CRA followed the scope of work and procedures presented in our July 19, 2010 *Well Destruction Work Plan*, which was approved per ACEH's July 21, 2010 letter.

2.0 WELL DESTRUCTION

2.1 FIELD DATE

August 26 to August 27, 2010.

2.2 PERSONNEL PRESENT

CRA field staff member Oliver Yan directed the well destruction under the supervision of California Professional Geologist Peter Schaefer.

2.3 DESTRUCTION METHOD

Five monitoring wells (MW-1 through MW-5) were destroyed by pressure grouting. A copy of the Alameda County Public Works Agency well destruction permit is included in Appendix A.

2.4 WASTE DISPOSAL

Rinse water generated during the well destructions was stored on site in a 55-gallon drum, tested, and profiled for disposal. Construction debris generated by the well destruction activities was transported by Vapor Tech Services of Berkeley, California to Commercial Waste and Recycling of Oakland, California for recycling. The disposal documentation is pending and will be provided upon request.

All of Which is Respectfully Submitted,
CONESTOGA-ROVERS & ASSOCIATES

Peter Schaefer
Peter Schaefer, CEG, CHG

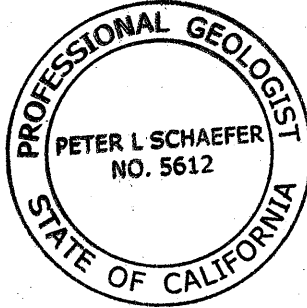

Eric A. Syrstad
Eric A. Syrstad, PG

FIGURES

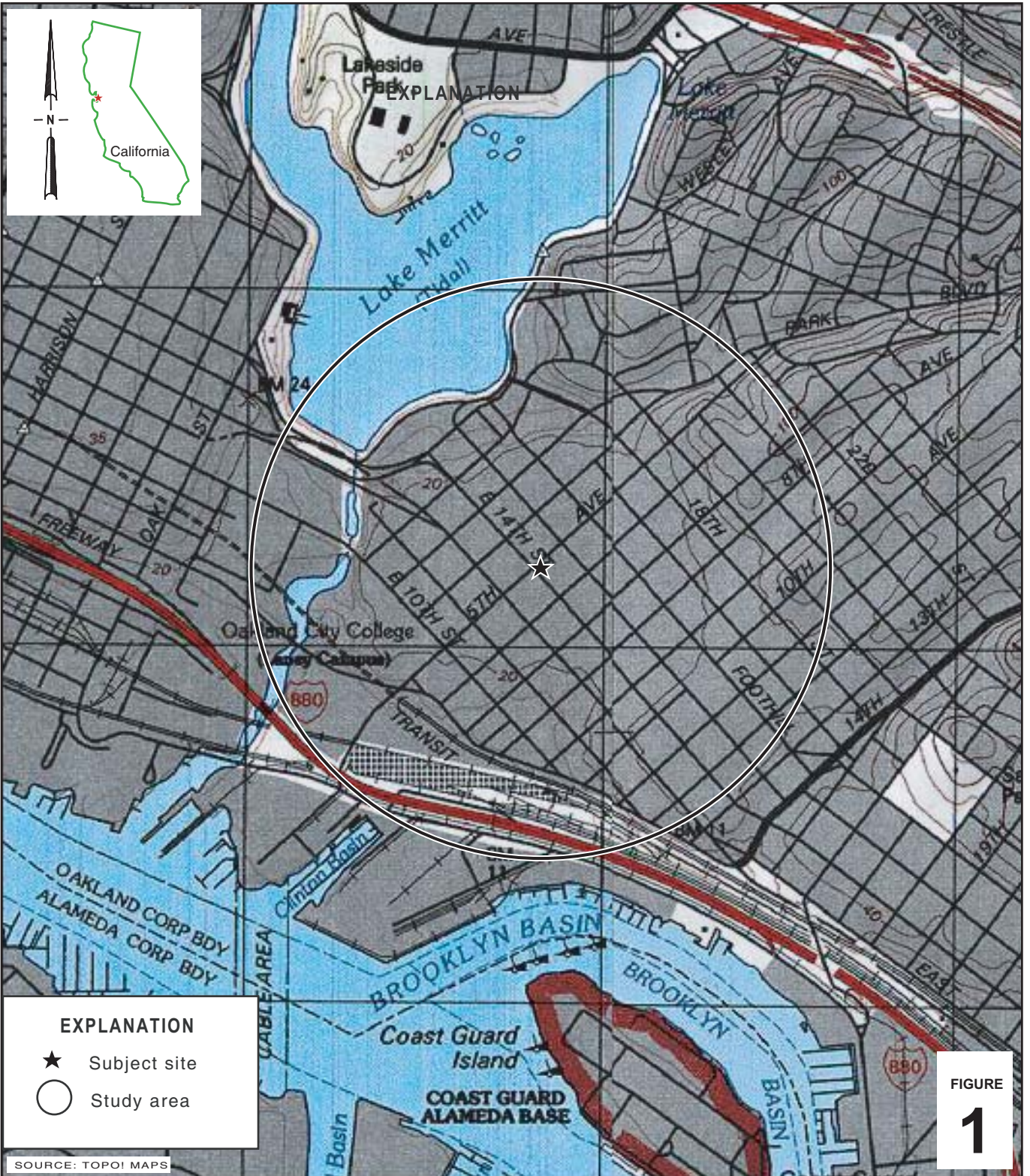

I:\Shell\6-chars\2408--\240898-Oakland 510 E. 14th (506-510 International Blvd)\240898-FIGURES\240898 VICINITY.AI

FIGURE 1

Shell-branded Service Station
510 E. 14th Street (506-510 International Blvd.)
Oakland, California



CONESTOGA-ROVERS & ASSOCIATES

Vicinity Map

I:\Shell\TEMP\6-chars\2408-1240898-Oakland 510 E. 14th (506-510 International Blvd)\240898-FIGURES\241898 3Q\08.DWG

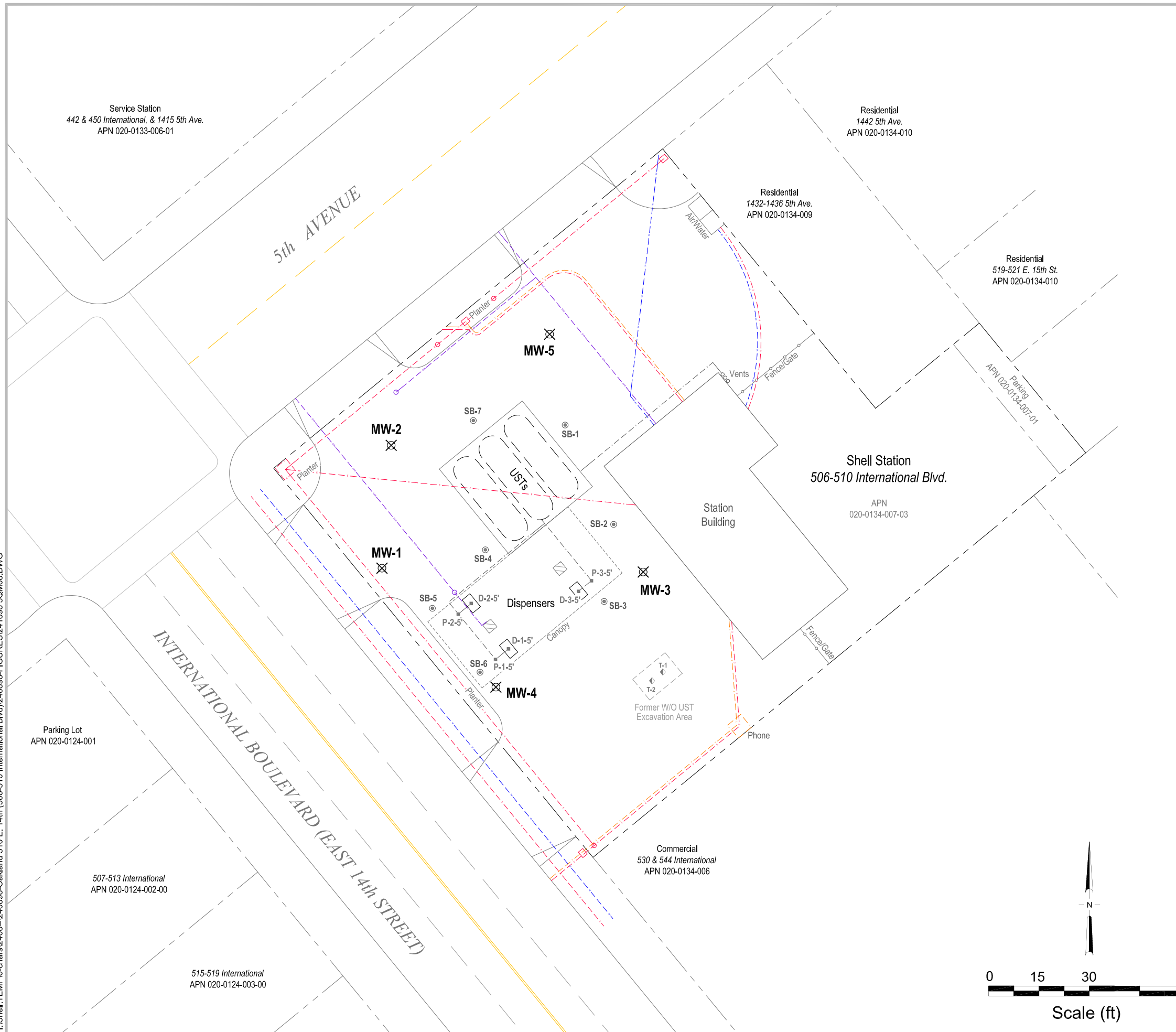

EXPLANATION	
MW-1	✕ Destroyed monitoring well location
SB-1	○ Soil boring location (10/18-19/2005)
D-1-5'	■ Soil and groundwater sample location (7/22/2004)
T-1	◊ Soil sample location (1993)
- - - - -	Electrical line (E)
- - - - -	Telecommunication line (T)
- - - - -	Sanitary sewer line (SAN)
- - - - -	Water line (W)
- - - - -	Product piping line (P)
- - - - -	Vent line (V)

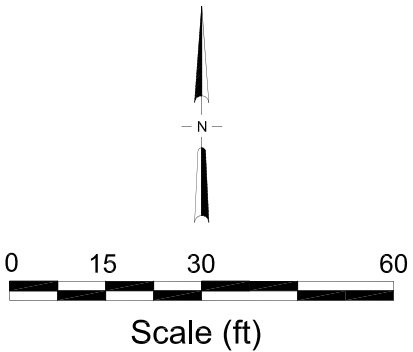

FIGURE 2

Site Plan



Shell-branded Service Station
 510 East 14th Street (506-510 International Boulevard)
 Oakland, California

APPENDIX A

PERMITS

Alameda County Public Works Agency - Water Resources Well Permit

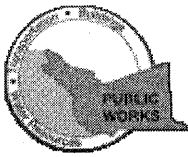

399 Elmhurst Street
Hayward, CA 94544-1395
Telephone: (510)670-6633 Fax:(510)782-1939

Application Approved on: 08/10/2010 By jamesy

Permit Numbers: W2010-0612 to W2010-0616
Permits Valid from 08/26/2010 to 08/27/2010

Application Id: 1280265365887
Site Location: 510 East 14th Street

City of Project Site:Oakland

Project Start Date: 08/26/2010
Assigned Inspector: Contact Vicky Hamlin at (510) 670-5443 or vickyh@acpwa.org

Completion Date:08/27/2010

Applicant: Conestoga Rover & Associates - Cortlandt
Toczykowski
5900 Hollis Stree, Suite A, Emeryville, CA 94608

Property Owner: Denis Brown- Shell Oil Products US
20945 S. Wilmington Ave, Carson, CA 90810

Client: ** same as Property Owner **

Phone: 510-420-3321

Phone: 707-865-0251

	Total Due:	\$1985.00
Receipt Number: WR2010-0276	Total Amount Paid:	\$1985.00
Payer Name : Conestoga-Rovers & Associates		PAID IN FULL
		& Paid By: CHECK

Works Requesting Permits:

Well Destruction-Monitoring - 5 Wells
Driller: Vapor Tech Services - Lic #: 916085 - Method: press

Work Total: \$1985.00

Specifications

Permit #	Issued Date	Expire Date	Owner Well Id	Hole Diam.	Casing Diam.	Seal Depth	Max. Depth	State Well #	Orig. Permit #	DWR #
W2010-0612	08/10/2010	11/24/2010	MW-1	10.00 in.	4.00 in.	0.00 ft	25.00 ft	No records	No records	No records
W2010-0613	08/10/2010	11/24/2010	MW-2	10.00 in.	4.00 in.	0.00 ft	25.00 ft	No records	No records	No records
W2010-0614	08/10/2010	11/24/2010	MW-3	10.00 in.	4.00 in.	0.00 ft	30.00 ft	No records	No records	No records
W2010-0615	08/10/2010	11/24/2010	MW-4	10.00 in.	4.00 in.	0.00 ft	25.00 ft	No records	No records	No records
W2010-0616	08/10/2010	11/24/2010	MW-5	10.00 in.	4.00 in.	0.00 ft	25.00 ft	No records	No records	No records

Specific Work Permit Conditions

1. Drilling Permit(s) can be voided/ cancelled only in writing. It is the applicant's responsibility to notify Alameda County Public Works Agency, Water Resources Section in writing for an extension or to cancel the drilling permit application. No drilling permit application(s) shall be extended beyond ninety (90) days from the original start date. Applicants may not cancel a drilling permit application after the completion date of the permit issued has passed.

2. Prior to any drilling activities, it shall be the applicant's responsibility to contact and coordinate an Underground Service Alert (USA), obtain encroachment permit(s), excavation permit(s) or any other permits or agreements required for that Federal, State, County or City, and follow all City or County Ordinances. No work shall begin until all the permits and requirements have been approved or obtained. It shall also be the applicants responsibilities to provide to the Cities or to Alameda County an Traffic Safety Plan for any lane closures or detours planned. No work shall begin until all the permits and requirements have been approved or obtained.

Alameda County Public Works Agency - Water Resources Well Permit

3. Compliance with the well-sealing specifications shall not exempt the well-sealing contractor from complying with appropriate State reporting-requirements related to well construction or destruction (Sections 13750 through 13755 (Division 7, Chapter 10, Article 3) of the California Water Code). Contractor must complete State DWR Form 188 and mail original to the Alameda County Public Works Agency, Water Resources Section, within 60 days. Including permit number and site map.
4. Permittee shall assume entire responsibility for all activities and uses under this permit and shall indemnify, defend and save the Alameda County Public Works Agency, its officers, agents, and employees free and harmless from any and all expense, cost and liability in connection with or resulting from the exercise of this Permit including, but not limited to, property damage, personal injury and wrongful death.
5. Applicant shall contact Vicky Hamlin for an inspection time at 510-670-5443 or email to vickyh@acpwa.org at least five (5) working days prior to starting, once the permit has been approved. Confirm the scheduled date(s) at least 24 hours prior to drilling.
6. Permittee, permittee's contractors, consultants or agents shall be responsible to assure that all material or waters generated during drilling, boring destruction, and/or other activities associated with this Permit will be safely handled, properly managed, and disposed of according to all applicable federal, state, and local statutes regulating such. In no case shall these materials and/or waters be allowed to enter, or potentially enter, on or off-site storm sewers, dry wells, or waterways or be allowed to move off the property where work is being completed.
7. Remove the Christy box or similar structure.

Destroy well by grouting neat cement with a tremie pipe or pressure grouting (25 psi for 5min.) to the bottom of the well and by filling with neat cement to three (3-5) feet below surface grade. Allow the sealing material to spill over the top of the casing to fill any annular space between casing and soil.

After the seal has set, backfill the remaining hole with concrete or compacted material to match existing conditions.

8. Copy of approved drilling permit must be on site at all times. Failure to present or show proof of the approved permit application on site shall result in a fine of \$500.00.
-