

Facsimile

Environmental Resources Management

To: Susan Hugo
Company: Alameda County
Fax number: (510) 337-9335
From: Debbie Lind
File number: 8057.31
Date: 29 January 2001
Number of pages: 2 including cover sheet

1777 Botelho Drive
Suite 260
Walnut Creek, CA 94596
(925) 946-0455
(925) 946-9968 (fax)

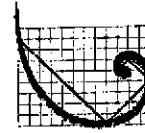

ERM.

Susan,

Attached is a site map for the UPRR Emeryville site as you requested. The existing fence line represents the *approximate* property line.

Please let me know if you have any questions.

Debbie Lind

PRIVILEGE AND CONFIDENTIALITY NOTICE

This message is intended only for the use of the individual(s) to whom it is addressed and may contain information that is privileged and/or confidential. If the reader of this message is not the intended recipient or the employee or agent responsible for delivering the message to the intended recipient, you are hereby notified that any dissemination, distribution, or copying of this communication is strictly prohibited. If you have received this communication in error, please notify us immediately at (925) 946-0455 and return the original message to us at the address above via the U. S. Postal Service. Thank you.

Project No.: 8057.03

Date: 11/06/97

Drawn By: H. Lutsky

CVS File: g:\cad\8057\03\80570305.cvs

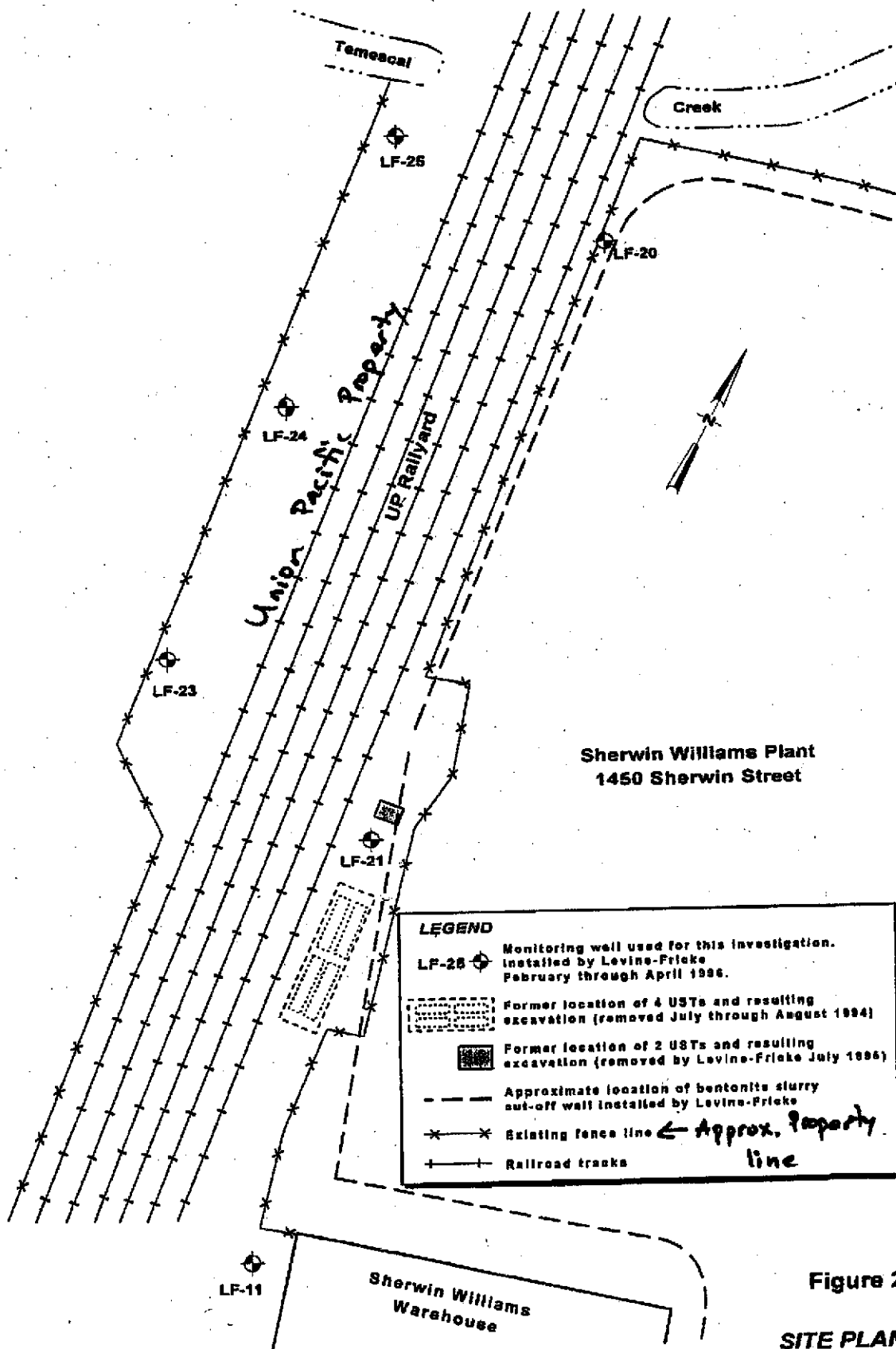

Sherwin Williams Plant
1450 Sherwin Street

LEGEND

- LF-25 ◆ Monitoring well used for this investigation. Installed by Levine-Fricke February through April 1996.
- ▭ Former location of 4 USTs and resulting excavation (removed July through August 1994)
- ▭ Former location of 2 USTs and resulting excavation (removed by Levine-Fricke July 1996)
- - - Approximate location of bentonite slurry cut-off wall installed by Levine-Fricke
- x x Existing fence line ← *Approx. property line*
- + + Railroad tracks

Figure 2

SITE PLAN
UNION PACIFIC RAILROAD
1450 SHERWIN STREET
EMERYVILLE, CA