

**Status Update Meeting  
Del Monte Plant 35, Emeryville, CA  
January 5, 1995**

1. Introduction

2. Background

3. West Parcel Groundwater Extraction and Treatment System

Treatment and Monitoring Results

Future GET System Operation

4. East Parcel Soil and Groundwater Remediation

Review of Work Completed and Recommended Future Work

Agency Questions and Comments on East Parcel Soil Removal Report

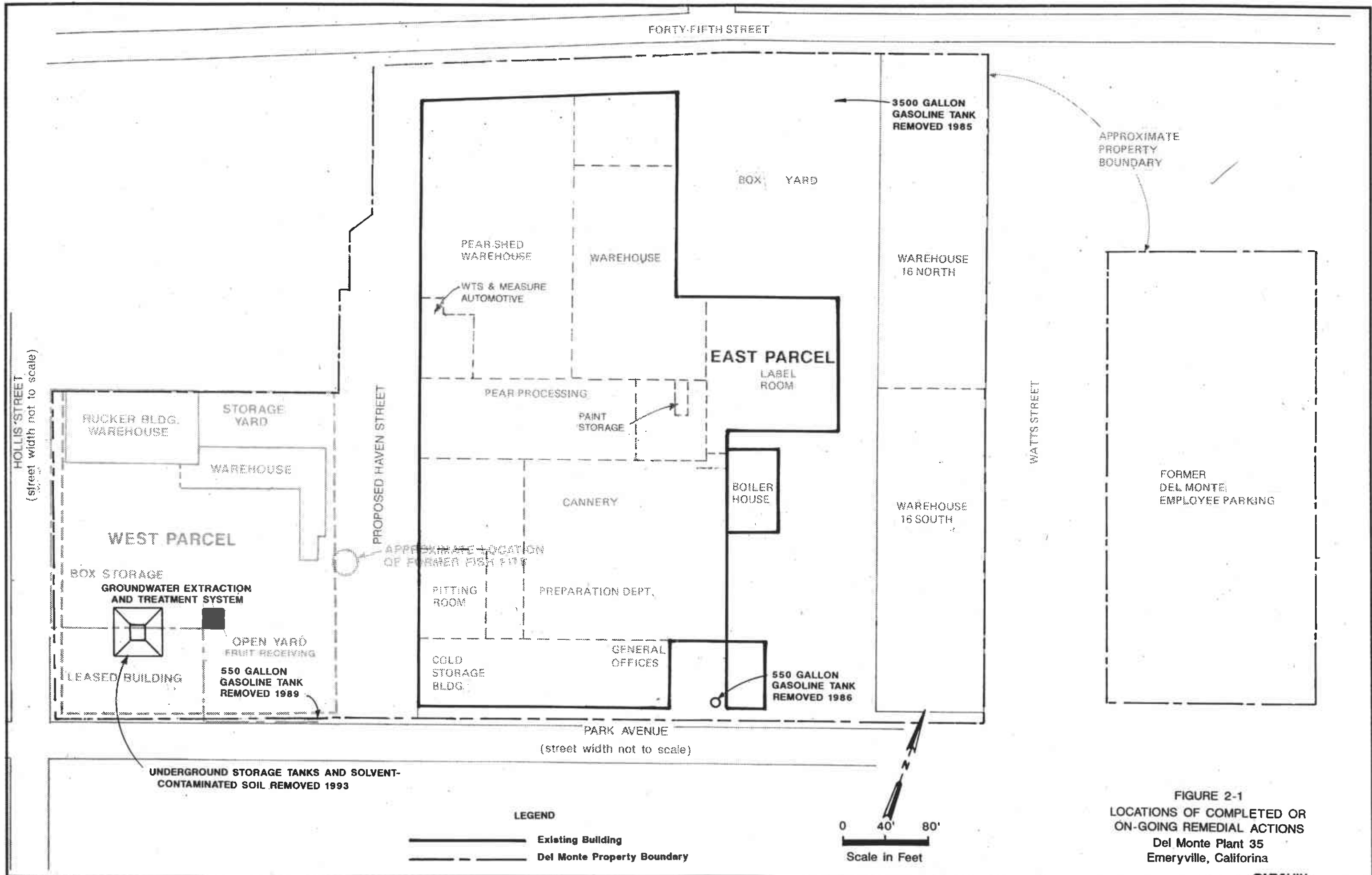

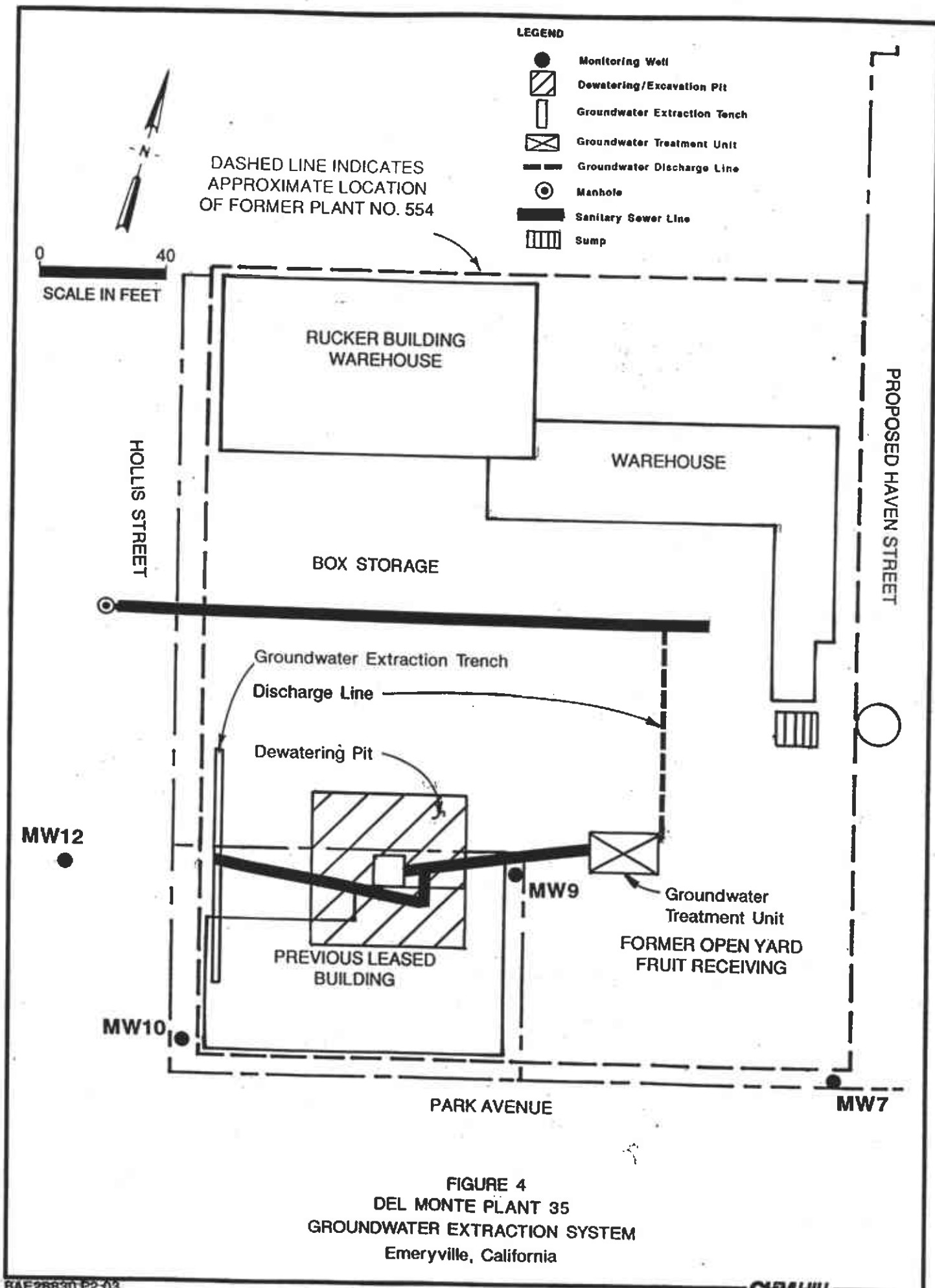

FIGURE 4  
 DEL MONTE PLANT 35  
 GROUNDWATER EXTRACTION SYSTEM  
 Emeryville, California

**Summary of Groundwater Monitoring Data  
West Parcel, Del Monte Plant 35, Emeryville**

Monitoring Well	Constituent	Average Concentration (ug/l)			Calculated Asymtote (ug/l)
		1989 to 1993 (Before GET)	1993	1994	
<b>MW-8</b>	TCE	570	164	84*	77
(source)	PCE	22	15	9*	12
	1,2-DCE	111	26	<1	--
<b>MW-11</b>	TCE	226	175	45	--
(down-gradient)	PCE	18	12	5	--
	1,2-DCE	111	25	5	--
<b>MW-10</b>	TCE	44	19	9	33
(down-gradient)	PCE	48	27	5	6.4
	1,2-DCE	142	44	7	--
<b>MW-12</b>	TCE	--	--	76	--
(down-gradient)	PCE	--	--	12	--
	1,2-DCE	--	--	19	--
<b>MW-7</b>	TCE	35	23	11	13
(up-gradient)	PCE	22	18	9	13
	1,2-DCE	96	37	14	--
<b>MW-9</b>	TCE	29	11	11	12.5
(up-gradient)	PCE	32	24	20	27
	1,2-DCE	45	25	26	--
* Includes results through July 1994.					

**TABLE 1**  
**DEL MONTE PLANT NO. 35, WEST PARCEL**  
**4204 HOLLIS STREET, EMERYVILLE, CA**  
**QUARTERLY GROUNDWATER MONITORING RESULTS**

Monitoring Well	Sampling Date	Concentration (ug/L)						
		1,2-DCE(a)	1,1-DCE(b)	1,2-DCA(c)	TCE(d)	PCE(e)	VC(f)	1,2-DP(g)
MW9	24-Oct-89	6.4	<0.5	<0.5	29.0	48.0	23.0	<0.5
MW9	07-Feb-90	55.0	<0.5	<0.5	15.0	30.0	7.1	<0.5
MW9	10-Jul-90	3.0	<0.2	<0.5	9.0	43.0	10.0	<0.5
MW9	17-Oct-90	70.0	<0.5	<0.5	14.0	32.0	4.6	<0.5
MW9	24-Jan-91	70.0	<2.0	<2.0	220.0	23.0	<2.0	<2.0
MW9	17-Apr-91	44.0	<0.5	<0.5	12.0	26.0	<0.5	<0.5
MW9	31-Jul-91	55.0	<0.5	<0.5	14.0	32.0	2.3	<0.5
MW9	22-Oct-91	71.0	<0.5	<0.5	15.0	33.0	2.8	<0.5
MW9	23-Jan-92	64.0	<0.5	<0.5	10.0	27.0	2.1	<0.5
MW9	23-Apr-92	22.0	<0.5	<0.5	11.0	29.0	<0.5	<0.5
MW9	17-Jul-92	26.0	<0.5	<0.5	13.0	32.0	<0.5	<0.5
MW9	12-Oct-92	41.0	<0.5	<0.5	17.0	36.0	3.0	<0.5
MW9	21-Dec-93	34.5	<0.5	<0.5	16.0	34.0	5.9	<0.5
MW9	13-Jan-93	22.0	<0.5	<0.5	7.9	17.0	1.4	<0.5
MW9	30-Mar-93	26.0	<0.5	<0.5	9.6	22.0	2.1	<0.5
MW9	16-Jun-93	41.5	<2.0	<2.0	12.0	27.0	6.8	<2.0
MW9	17-Sep-93	1.6 (t)	<1.0	<1.0	11.0	21.0	3.5	<1.0
MW9	21-Dec-93	34.5	<0.5	<0.5	16.0	34.0	5.9	<0.5
MW9	14-Feb-94	30.8	<0.5	<0.5	11.0	25.0	4.2	<0.5
MW9	11-Apr-94	18.0	<0.5	<0.5	9.0	18.0	1.6	<0.5
MW9	15-Jul-94	42.4	<0.5	<0.5	15.0	24.0	7.1	<0.5
MW9	17-Oct-94	35.6	<0.5	<0.5	14.0	24.0	2.2	<0.5
MW9	29 Dec 94	<1.0 (t)	<1.0	<1.0	3.5	8.5	<1.0	<1.0
MW10	10-Jul-89	85.0	0.8	<0.5	27.0	42.0	28.0	<0.5
MW10	24-Oct-89	104.8	<0.5	<0.5	37.0	28.0	6.9	<0.5
MW10	07-Feb-90	50.0	<0.5	<0.5	11.0	8.0	5.3	<0.5
MW10	10-Jul-90	9.0	<0.2	<0.5	30.0	76.0	54.0	<0.5
MW10-dup	10-Jul-90	10.0	5.0	<0.5	28.0	69.0	17.0	<0.5
MW10	17-Oct-90	140.0	<0.5	<0.5	35.0	37.0	13.0	<0.5
MW10	24-Jan-91	65.0	<0.5	<0.5	14.0	31.0	3.3	<0.5
MW10	17-Apr-91	210.0	<2.0	<2.0	48.0	52.0	10.0	<2.0
MW10	31-Jul-91	280.0	<2.0	<2.0	66.0	14.0	2.0	<2.0
MW10	22-Oct-91	160.0	<1.0	<1.0	40.0	40.0	5.0	<1.0
MW10	23-Jan-92	240.0	<2.0	<2.0	46.0	54.0	10.0	<2.0
MW10	23-Apr-92	210.0	<2.0	<2.0	89.0	110.0	<2.0	<2.0
MW10	17-Jul-92	180.0	<1.0	<1.0	78.0	82.0	15.0	<1.0
MW10	12-Oct-92	110.0	<1.0	<1.0	45.0	46.0	11.0	<1.0
MW10	13-Jan-93	190.0	<1.0	<1.0	78.0	110.0	19.0	<1.0
MW10	30-Mar-93	26.0	<0.5	<0.5	15.0	18.0	0.7	<0.5
MW10	16-Jun-93	3.2	<2.0	<2.0	2.7	4.7	<2.0	<2.0
MW10	17-Sep-93	<1.0 (t)	<1.0	<1.0	<1.0	<1.0	<1.0	<1.0
MW10	21-Dec-93	<0.5	<0.5	<0.5	<0.5	1.6	<0.5	<0.5
MW10	14-Feb-94	9.9	<0.5	<0.5	5.4	4.4	<0.5	<0.5
MW10	11-Apr-94	3.7	<0.5	<0.5	2.2	1.5	<1.0	<0.5
MW10	15-Jul-94	<0.5	<0.5	<0.5	1.0	1.0	<0.5	<0.5
MW10	17-Oct-94	20.6	<0.5	<0.5	37.0	19.0	<0.5	<0.5
MW10	29 Dec 94	<1.0 (t)	<1.0	<1.0	<1.0	<1.0	<1.0	<1.0
MW11	10-Jul-89	73.0	<1.0	4.0	160.0	12.0	16.0	5.7
MW11	24-Oct-89	188.0	<2.0	10.0	410.0	15.0	22.0	20.0

**TABLE 1**  
**DEL MONTE PLANT NO. 35, WEST PARCEL**  
**4204 HOLLIS STREET, EMERYVILLE, CA**  
**QUARTERLY GROUNDWATER MONITORING RESULTS**

Monitoring Well	Sampling Date	Concentration (ug/L)						
		1,2-DCE(a)	1,1-DCE(b)	1,2-DCA(c)	TCE(d)	PCE(e)	VC(f)	1,2-DP(g)
MW11	07-Feb-90	105.0	<2.0	2.0	270.0	8.0	11.0	13.0
MW11	10-Jul-90	4.0	<2.0	23.0	46.0	18.0	15.0	<0.5
MW11	17-Oct-90	150.0	<2.0	11.0	300.0	8.0	<2.0	31.0
MW11	24-Jan-91	120.0	<1.0	<1.0	29.0	29.0	3.0	<1.0
MW11	17-Apr-91	100.0	<1.0	14.0	160.0	12.0	5.0	29.0
MW11	31-Jul-91	250.0	<2.0	<2.0	61.0	65.0	12.0	2.0
MW11	22-Oct-91	180.0	<2.0	5.0	560.0	20.0	5.0	30.0
MW11	23-Jan-92	160.0	<2.0	13.0	290.0	19.0	<2.0	21.0
MW11	23-Apr-92	30.0	<1.0	9.0	120.0	13.0	<1.0	14.0
MW11	17-Jul-92	26.0	<0.5	1.4	81.0	<0.5	<0.5	3.5
MW11	12-Oct-92	63.0	<3.0	4.4	450.0	16.0	5.2	17.0
MW11	13-Jan-93	29.0	<1.0	2.2	140.0	13.0	3.2	6.4
MW11	30-Mar-93	17.0	<0.5	<0.5	55.0	10.0	1.6	5.1
MW11	16-Jun-93	41.5	<2.0	6.3	230.0	20.0	7.0	7.2
MW11	17-Sep-93	<5.0 (t)	<5.0	<5.0	230.0	<5.0	<5.0	<5.0
MW11	21-Dec-93	32.2	<0.5	2.8	220.0	14.0	6.1	<0.5
MW11	14-Feb-94	11.8	<0.5	2.0	52.0	5.6	1.5	2.6
MW11	11-Apr-94	10.0	<0.5	<0.5	57.0	4.9	<1.0	2.7
MW11	27-Jun-94	<0.5	<0.5	<0.5	110.0	12.0	<0.5	<0.5
MW-11 (SP-E)	30-Sep-94	<1.0 (t)	<1.0	<1.0	2.6	2.8	<1.0	<1.0
MW-11 (SPE)	6 Dec 94	<1.0 (t)	<1.0	<1.0	4.2	1.8	<1.0	<1.0
MW12	02-Mar-94	35.3	<0.5	<0.5	170.0	16.0	6.8	<0.5
MW12	11-Apr-94	25.0	<0.5	<0.5	100.0	13.0	<1.0	<0.5
MW12	15-Jul-94	31.9	<0.5	<0.5	82.0	19.0	4.2	<0.5
MW12	17-Oct-94	<0.5	<0.5	<0.5	1.1	0.9	<0.5	<0.5
MW12	29 Dec 94	<1.0 (t)	<1.0	<1.0	28	11	<1.0	<1.0
Primary MCL		—	6	0.5	5	5	0.5	5
(a) 1,2-Dichloroethene	(c) 1,2-Dichloroethane	(e) Tetrachloroethene	(g) 1,2-Dichloropropane					
(b) 1,1-Dichloroethene	(d) Trichloroethene	(f) Vinyl chloride	(t) trans-1,2-Dichloroethene					

### MW8 TCE Concentration and Regression Curves

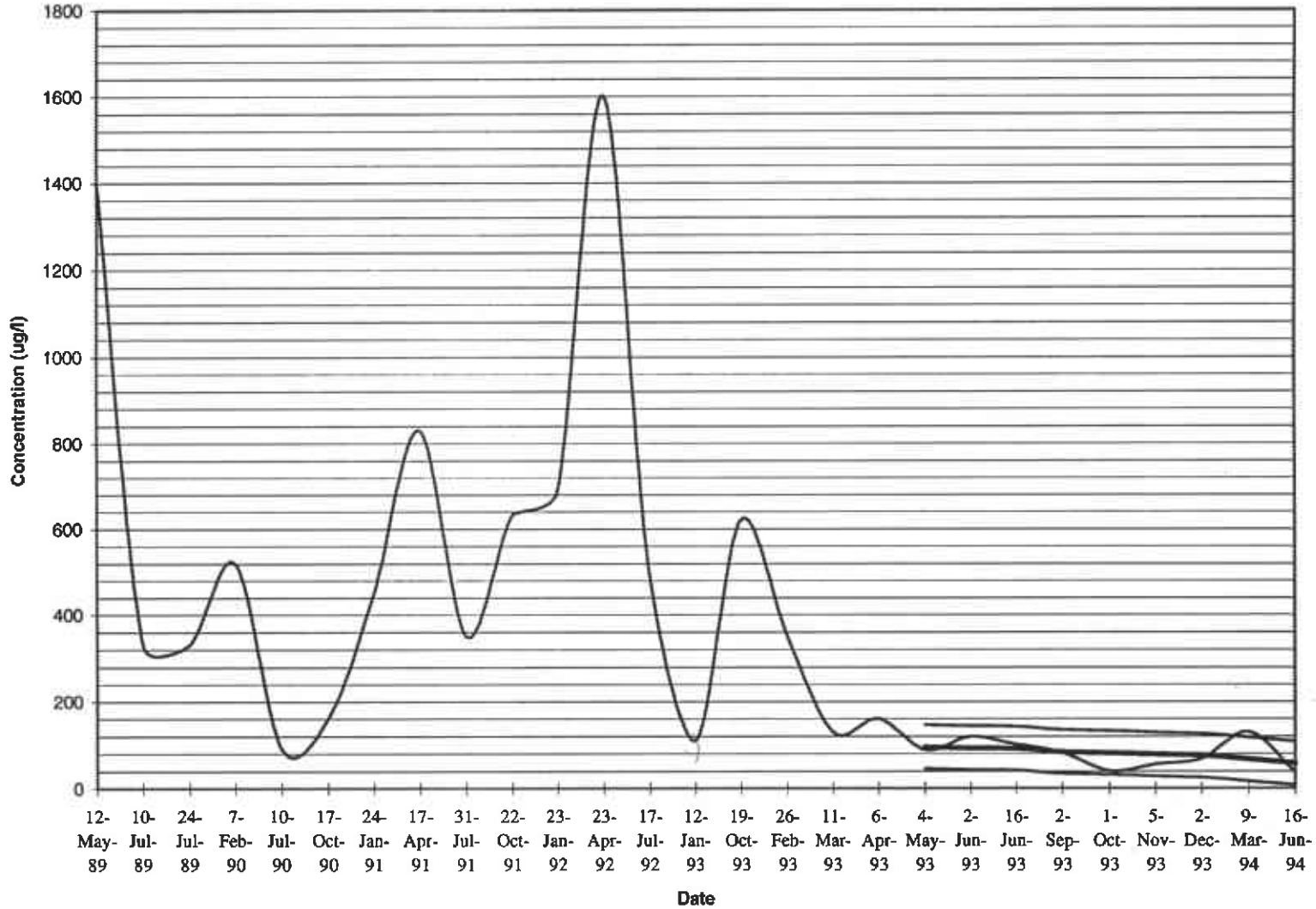

Asymptote: 76.77 ug/l

— Raw Conc. — 95% Conf. lower — Fit Conc. — 95% Conf. upper

### MW8 PCE Concentration and Regression Curves

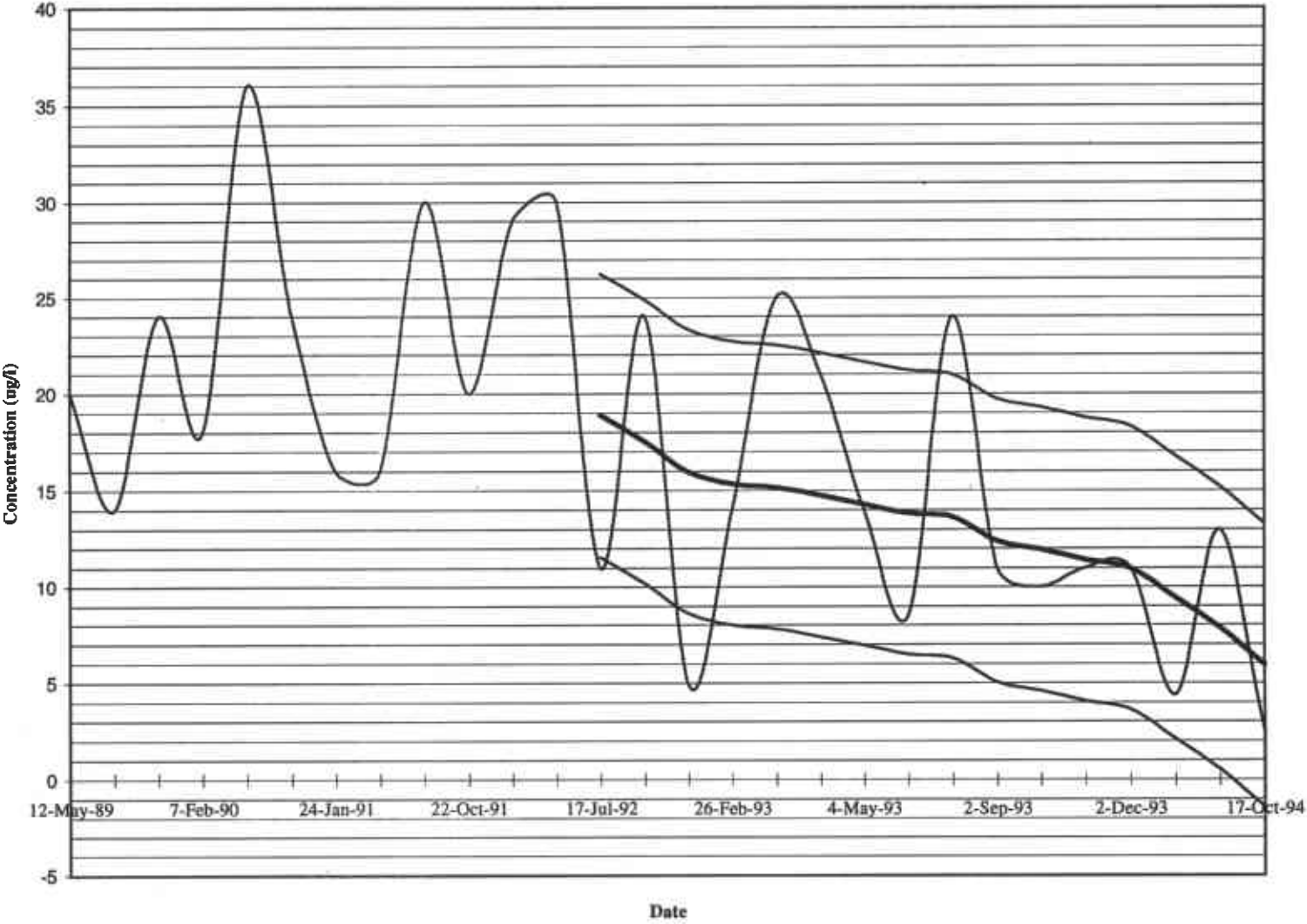

Asymptote: 12.41 ug/l

Raw Conc. 95% Conf. upper Fit Conc. 95% Conf. lower



### MW10 TCE Concentration and Regression Curves

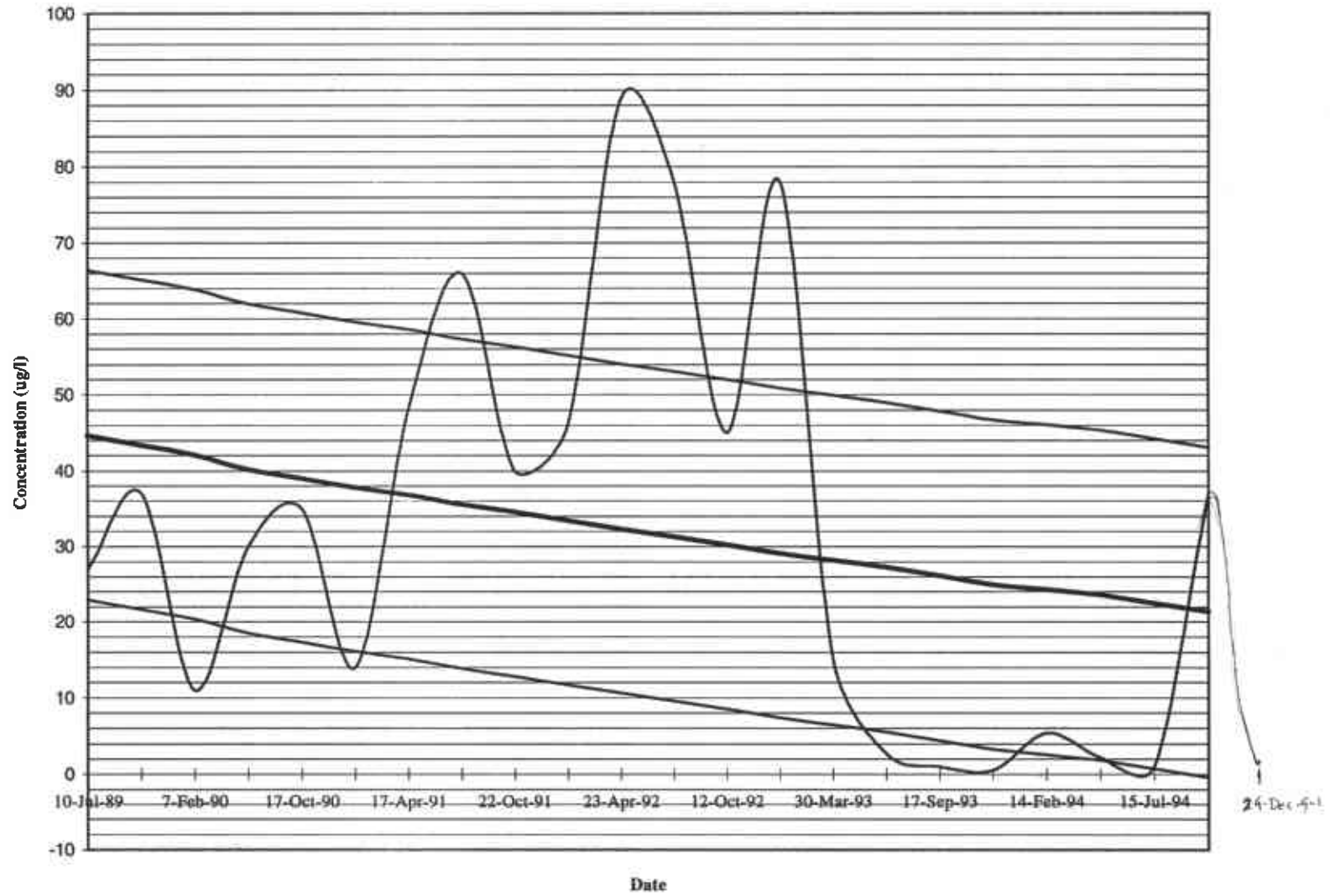

Accumulate: 33.00 ug/l

Raw Conc. 95% Conf. lower Fit Conc. 95% Conf. upper

### MW10 PCE Concentration and Regression Curves

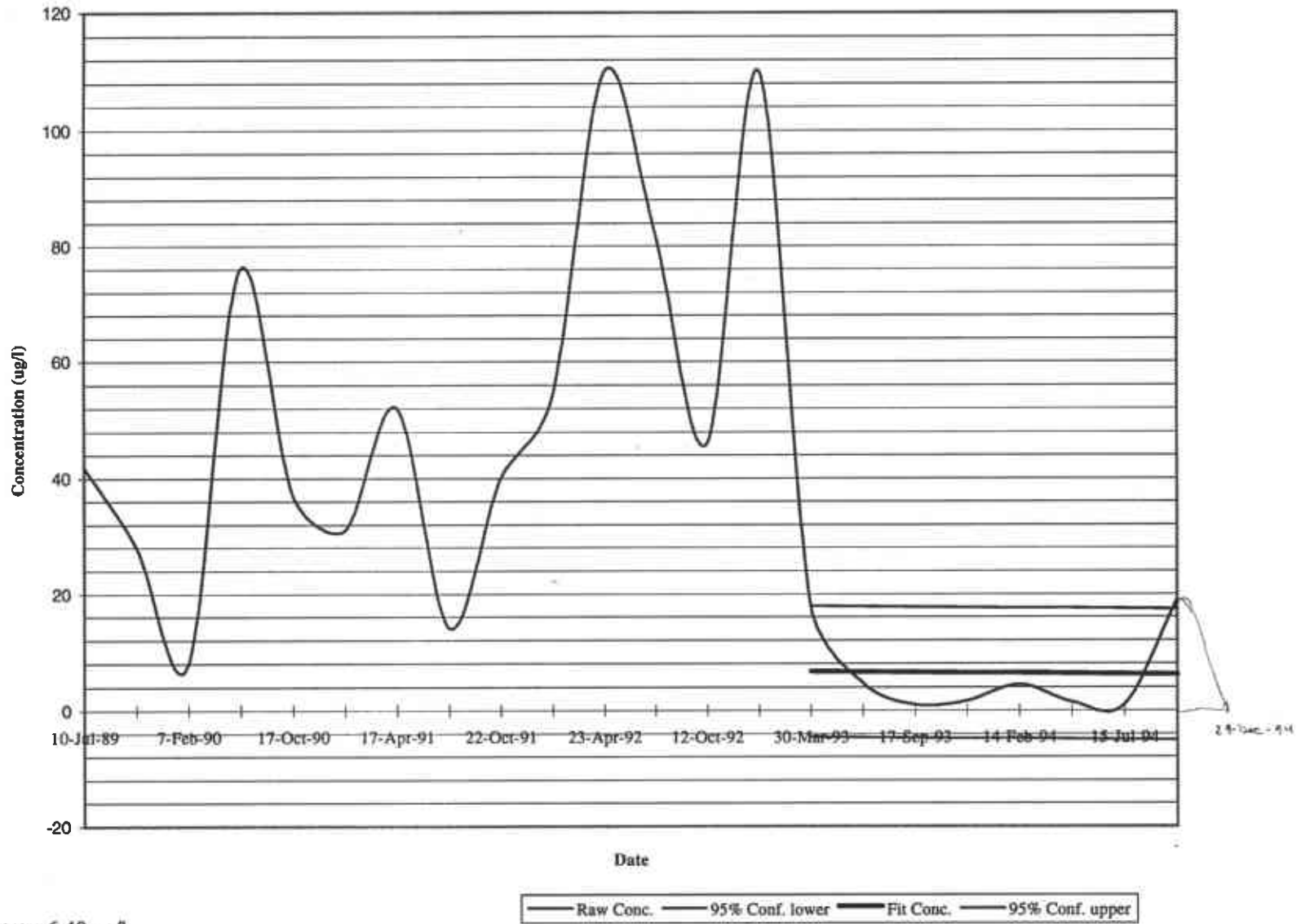

Asvmtote: 6.40  $\mu\text{g/l}$

### MW7 TCE Concentration and Regression Curves

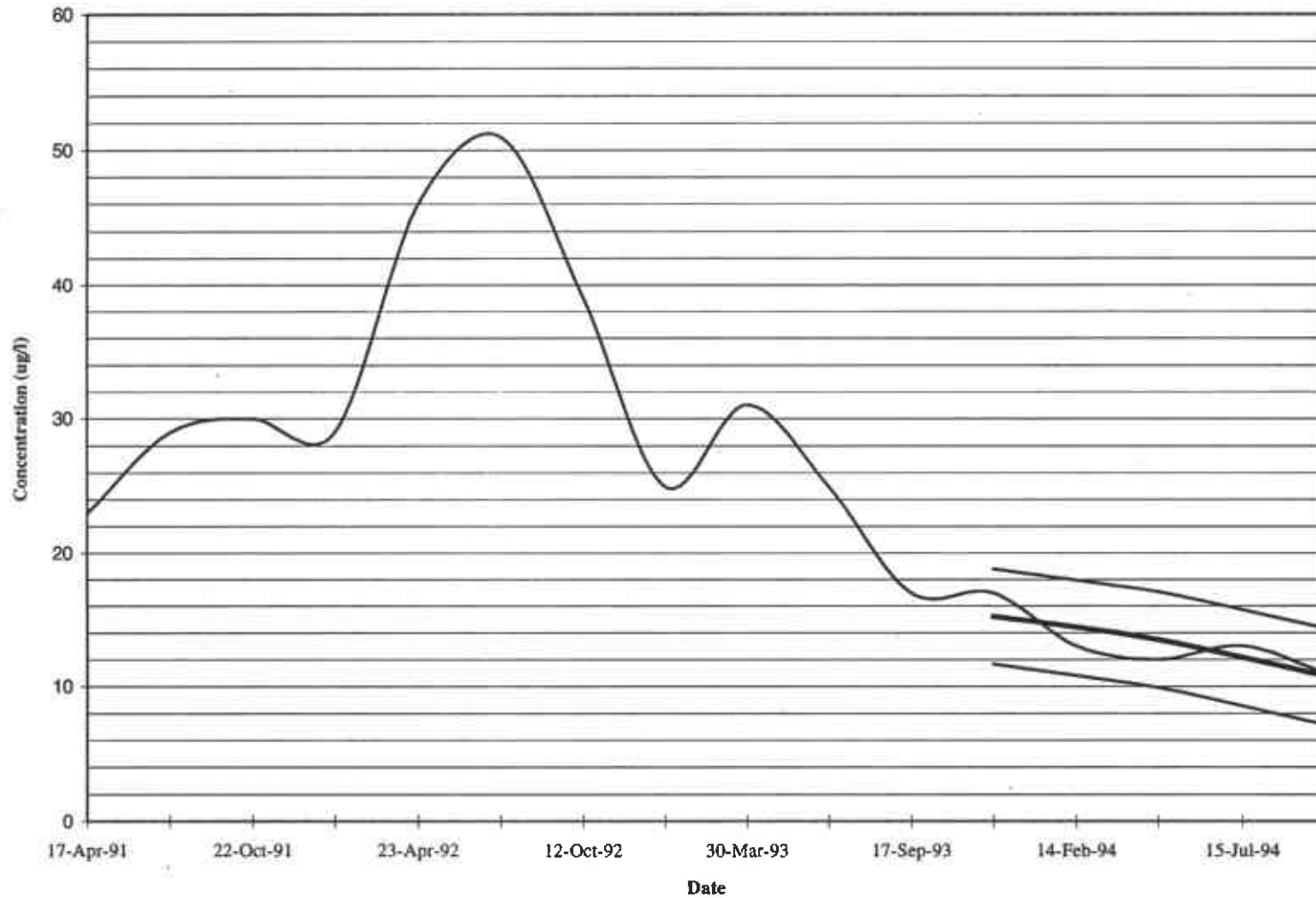

Asymptote: 12.99 ug/l

Raw Conc. 95% Conf. lower Fit Conc. 95% Conf. upper

### MW7 PCE Concentration and Regression Curves

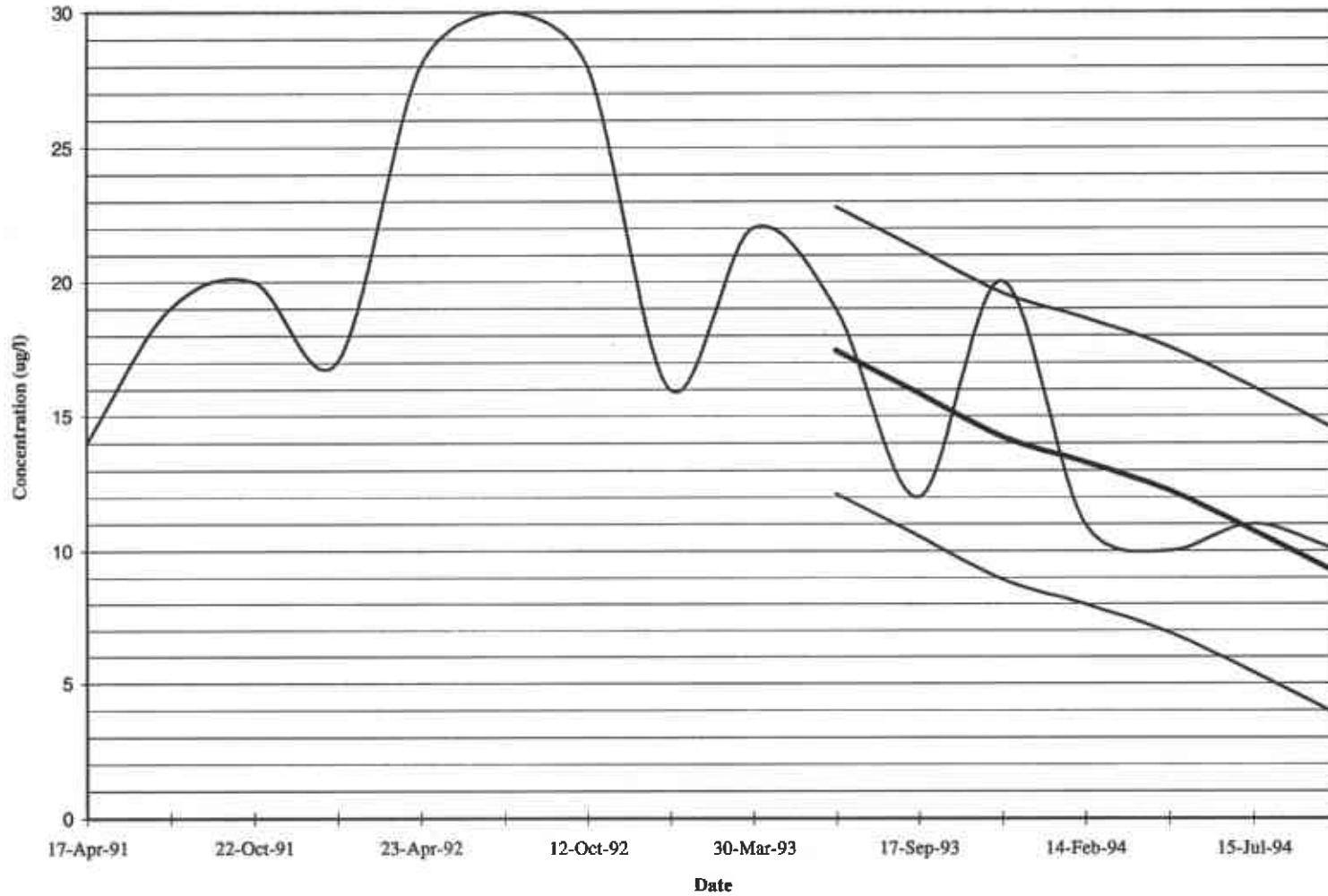

Raw Conc. 95% Conf. lower Fit Conc. 95% Conf. upper

Asymptote: 13.29 ug/l

### MW9 TCE Concentration and Regression Curves

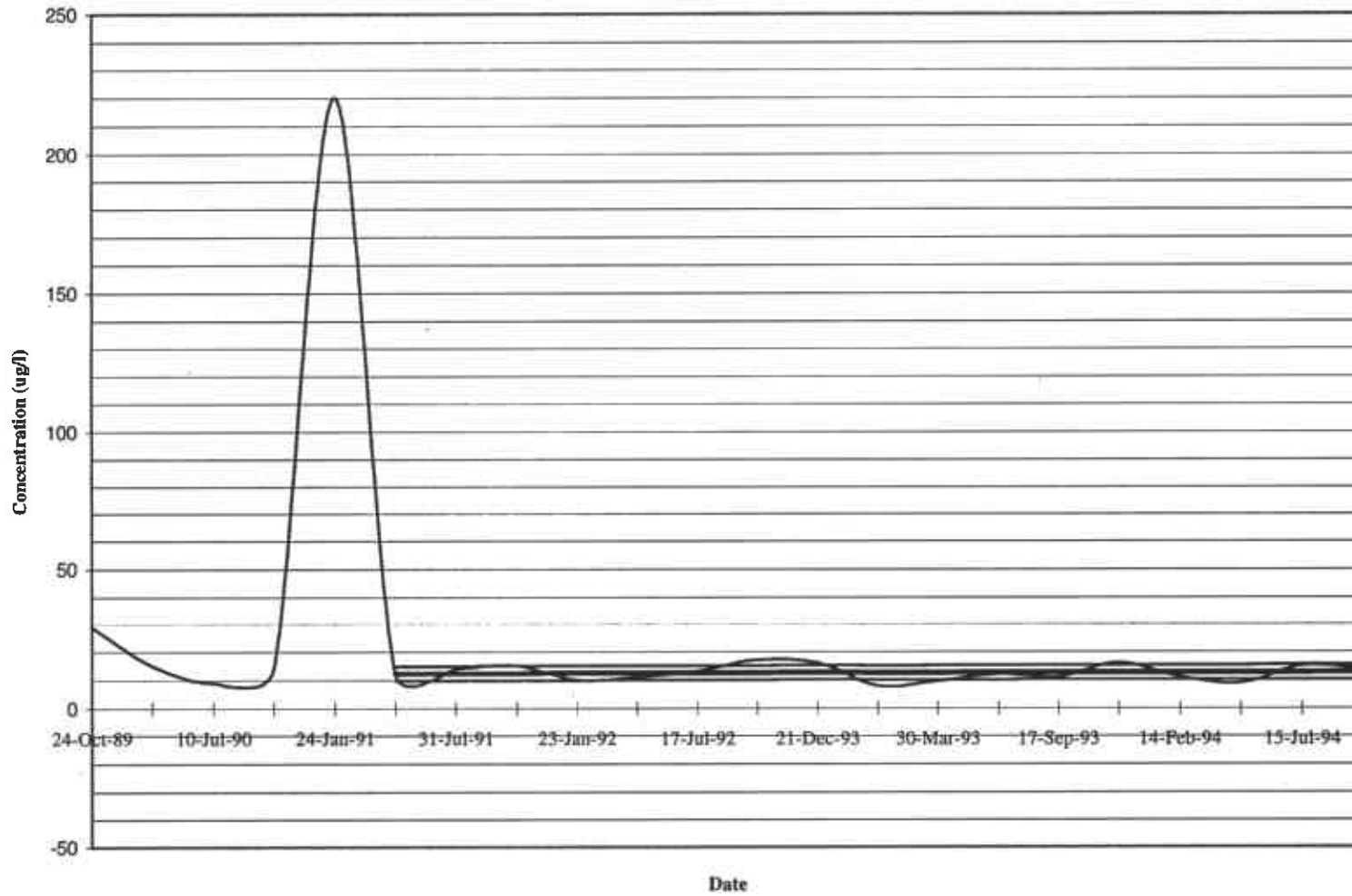

Asymptote: 12.54 ug/l

Legend: Raw Conc. (thin line), 95% Conf. lower (dashed line), Fit Conc. (thick line), 95% Conf. upper (dashed line)

### MW9 PCE Concentration and Regression Curves

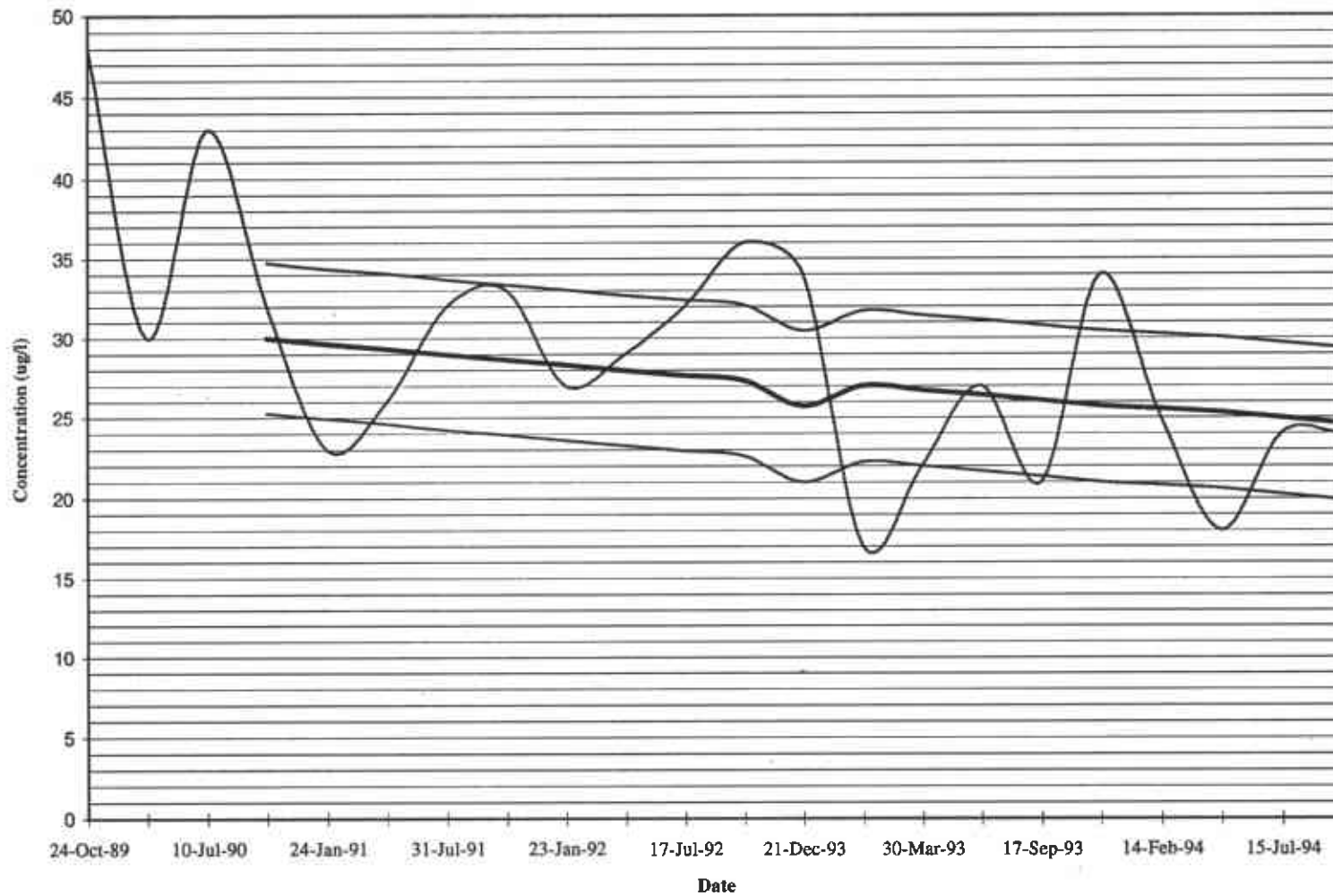

Asymptote: 27.32 ug/l

