

City of Fremont

Public Works Department
Hazardous Materials Division
39572 Stevenson Place, Suite 125
Fremont, California 94539 - 3075

(415) 791 - 4279

May 7, 1990

Mr. Dale Sobek
6000 S Corporation
6000 Stevenson Boulevard
Fremont, CA 94538

RE: 6000 S CORPORATION, 6000 STEVENSON BLVD.

Dear Mr. Sobek:

The document entitled "Work Plan, Sampling of Foundry Sands, 6000 Stevenson Boulevard, Fremont, California" prepared by Levine Fricke for 6000 S Corporation has been reviewed. The purpose of this phase of the investigation is to screen foundry sands for Soluble Threshold Limit Concentrations (STLCs) in order to determine appropriate off-site disposal options. Previous analytical data indicate elevated soluble lead concentrations in the sands above the STLC value.

The City of Fremont accepts Sampling and Analysis Approach described in the work plan for purposes of initial screening of the foundry sands which includes collection and analysis of twelve samples (duplicate samples will also be obtained). The samples will be composited and chemically analyzed for soluble lead concentrations. A report documenting this Phase of the investigation will be submitted to this office for our review.

In the event that the average lead concentrations are below the STLC and 6000 S Corporation requests to assess the potential for use of the foundry sand as fill, an in depth sampling and analysis Plan shall be developed in order to characterize the foundry sand. The Plan should be submitted to the City of Fremont and Regional Water Quality Control Board for review and approval prior to implementation.



May 7, 1990
6000 S Corporation
Page 2

Advance notification of 72 hours is required in order to schedule the mandated regulatory oversight required for this phase of the investigation.

This phase of the project shall be completed within five weeks of May 7, 1990.

Sincerely,

A handwritten signature in cursive script that reads "Linda S. Vrabel". The signature is written in dark ink and is positioned above the typed name.

LINDA S. VRABEL
Hazardous Materials Specialist

Draft to Ms. Stowe
re: Aerial photograph interpretation.

4/23/68

AERIAL PHOTOGRAPH# AV-1193-6-56
5-19-79

This image contains five buildings which are labled for purposes of this discussion as: building "A", the main production facility, building "B", the paint facility, building "C", the machine shop and, building "D", which is an unidentified structure. Refer to location map coordinates for site locaton.

1. Storage of materials at coordinate S-17 show no barrels, but, there is a visible stain on the concrete.
2. There is staining of the concrete at coordinate R-23, but no ✓ discernable storage of barrels.
3. A storage area extends from coordinates G-39,G40 down to ✓ coordinates R-39,R-40. Bulk goods are present and barrels at P-40.
4. Visible staining at coordinates P,Q,R,S,T-28. ✓
5. Heavy activity with staining at coordinate H-30. ✓
6. Building "B" shows barrels and staining at coordinate C-19&20. ✓
7. Staining occurs at building "D" C-22. ✓
8. Barrel storage at T-37. ✓

AERIAL PHOTOGRAPH# AV-1750-6-64
9-14-79

Structure "D" is missing leaving only a partial foundation. Extensive grading has taken place from coordinates A-22, G-22 to A-34, G-34.

1. What appears to be industrial scraps and compacted trash now occupy coordinates E-45 to H-45. ✓
2. Tanks have been installed at coordinate Q-32 with staining at R-32. ✓
3. Barrels are visible at coordinates S-28&29 to T-28&29 and, ✓ coordinates P-26&28 to Q-26&28 with a fair amount of staining on the concrete. ✓
4. Stain remains on concrete at S-17 but storage area has been removed.

5. Tanks are visible at C-14 & 15 with visible diking surrounding them.
6. A circular stain is visible at B-16. An irregular stain is at B-17.
7. Barrels are stored at B-13.

AERIAL PHOTOGRAPH #AV-2040-6-63
6-22-81

1. Tanks no longer at Q-32, but stain remains at R-32.
2. Barrels no longer at coordinates P-26,28 to R-26,28 but staining remains at that location and extending down to T-28.
3. Stain on concrete at coordinate Q-18.
4. Barrels have been moved to coordinate E-35.
5. Fill has been dumped at coordinates A-35, C&D-28.
6. Staining is visible at D-23 where building "D" once stood.
7. Two large tanks appear at C-14 ?
8. Five tanks appear at B-17,18. ✓
9. Staining on parking lot at A-15
10. A fill "material" has been dumped at B-12.
11. Barrels occupy a section of B-13.

AERIAL PHOTOGRAPH #AV-2640-6-61
5-15-85

1. A stain with a circular pattern is visible at Q-32.
2. Stain evident at P, Q, R, S, T-28.
3. Fill "material" has been dumped at coordinates A, B, C, D-42 and at coordinates D, E-32.
4. Tanks have been removed from coordinates C-14,15 and, B-17,18.
5. Barrels are visible at coordinates B-17, C-18 and, D-18.
6. What appears to be a skeleton of a tank is visible on C-16.
7. Barrels are placed on soil at coordinate H-34 and, D-19.

AERIAL PHOTOGRAPH #AV3268-6-63
3-30-88

1. A parking lot now covers coordinates A,K-12 to A,K-21.
2. A building now covers coordinates B,G-23 to B,G-32.

3. Extensive dumping of fill "material" covers coordinates A-42 thru 53 down to K-42 thru 53. No barrels are visible at these coordinates.
4. It appears that the stains at coordinates P, Q, R, S-27 have tried to have been removed as a fill material is visible at the leading edge of the loading dock. material has been removed and placed somewhere, but stains remain.

L. K. N. I.

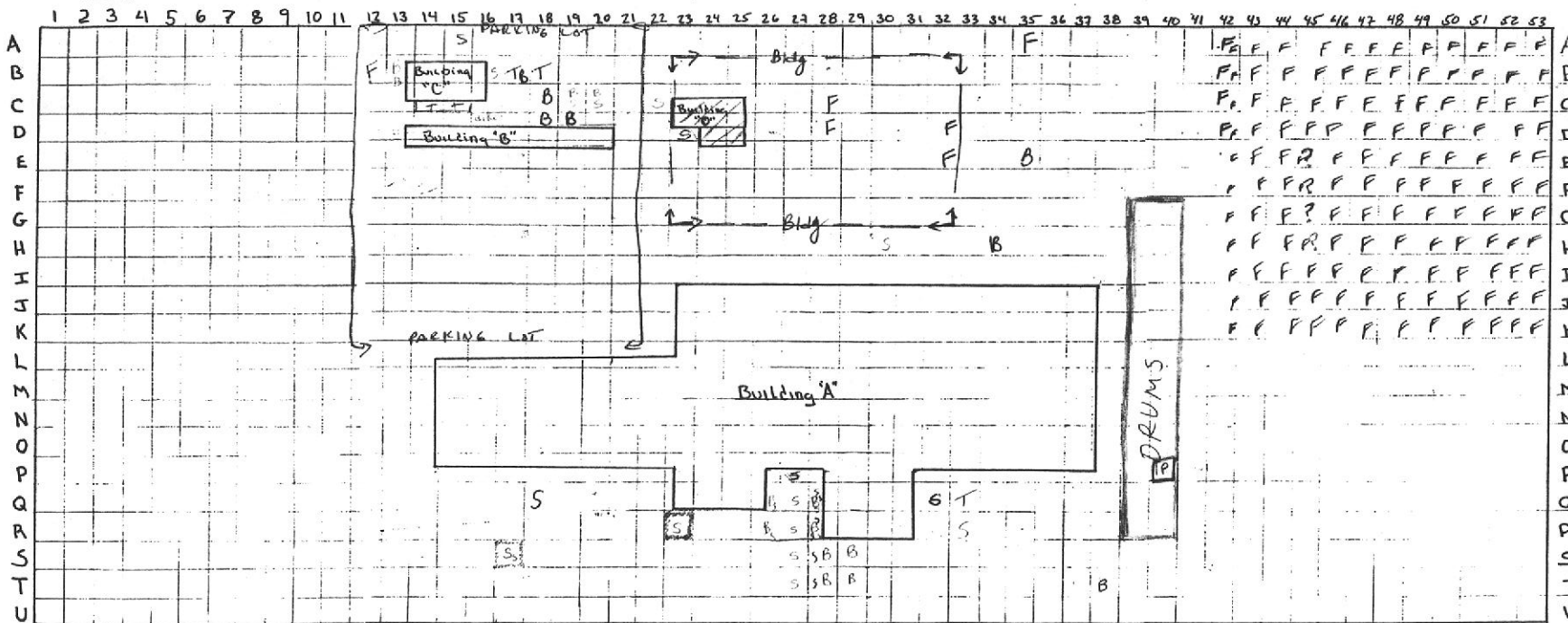

Grids NOT SET TO MAP SCALE

TRUE MAPS at 1" = 100'

