

ENGEO

INCORPORATED

2401 Crow Canyon Road

Suite 200

San Ramon, CA 94583

(925) 838-1600

Fax (925) 838-7425

FAX TRANSMITTAL

TO: Ms. Medullah Logan

DATE: 10-15-98

FROM: Keith Nowell

PROJECT NO. 4216-E3

FAX NO.: 510/337-9335

SUBJECT: Niles Court Tract 6938, Fremont, CA

CC: Mr. Bill Reykalin, 510/494-4822

TOTAL PAGES INCLUDING THIS PAGE: 18

REMARKS:

- Urgent
 For your review
 Reply ASAP
 Please comment
 This is the only copy you will receive
 A copy will also be sent via:
 U. S. Mail
 Overnight Mail
 Courier

Medullah,

Following are the sample results for the street sections, lots, and stockpile. Street section samples are prefixed with an "S-" and were collected at 21 to 27-inch intervals. In the cases where two samples were collected, the upper sample (A) was collected at 21 to 27-inch intervals and the lower samples (B) at 36 to 42-inch intervals. All street sample depths were measured from existing grade. Lot samples have no letter prefix and the sample number correlates with the lot number. Three samples were retrieved from each of the lots sampled, with samples A and B collected from the backyard (side yards in the case of lot 20) and C collected from the front of the lot. Lot 1 contains the development sales office and is paved. This lot has not been sampled. If you have any questions please contact our office.

Keith Nowell

THE INFORMATION CONTAINED IN THIS FACSIMILE IS CONFIDENTIAL AND MAY ALSO BE SUBJECT TO THE ATTORNEY CLIENT PRIVILEGE OR MAY CONSTITUTE PRIVILEGED WORK PRODUCT. The information is intended only for the use of the individual or entity to whom it is addressed. If you are not the intended recipient, or the agent or employee responsible to deliver it to the intended recipient, you are hereby notified that any use, dissemination, distribution or copying of this communication is strictly prohibited. If you have received this facsimile in error, please notify us by telephone immediately and return the original message to us at the address above via the U.S. Postal Service. Thank you.

Copyright © 1996
ENGEO Incorporated

Lot 17: AGT - P-1
KING AVENUE

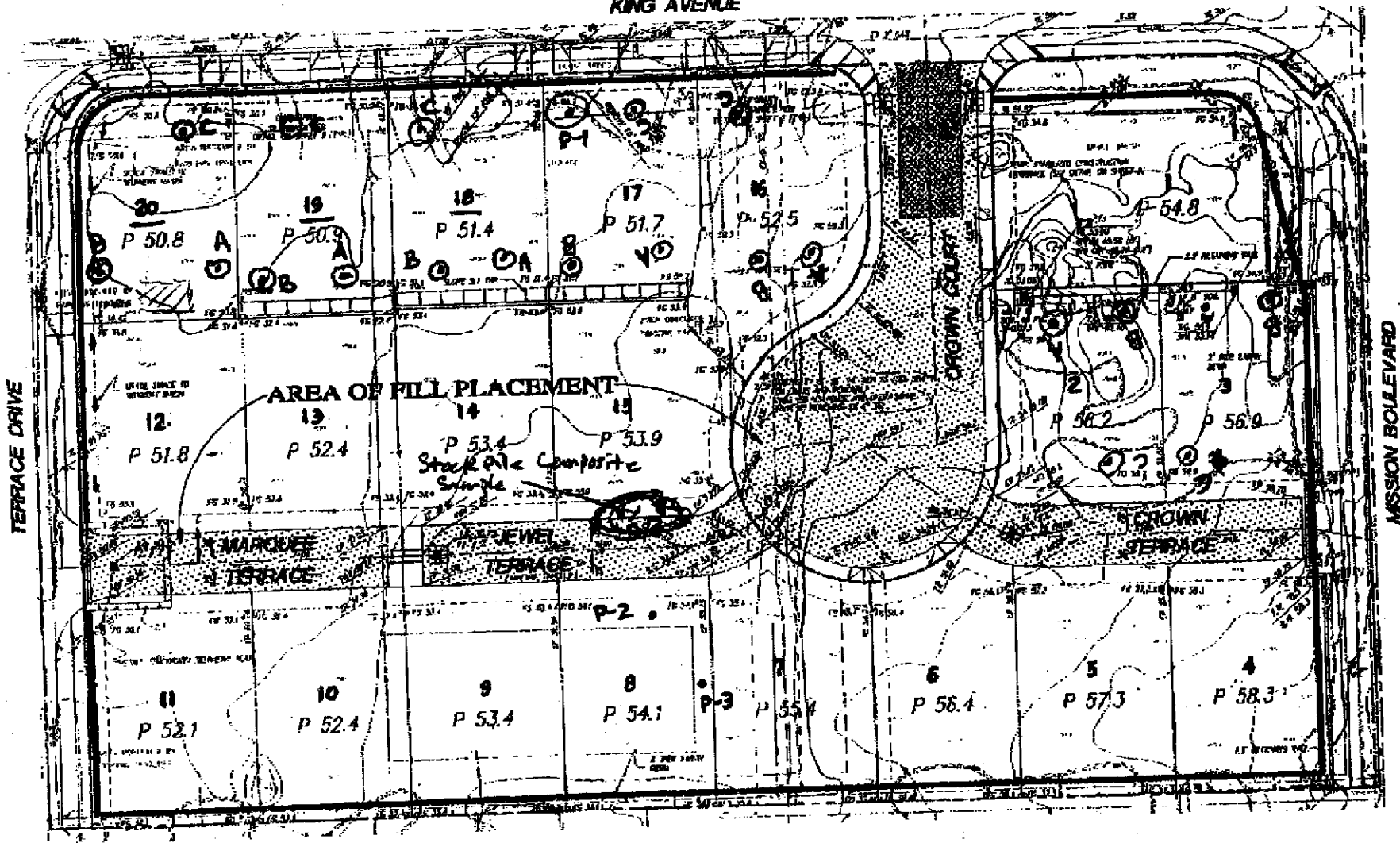

Lot 8 - stained soil @ Bldg perimeter

BASE: RUGGERI-JENSEN-AZAR & ASSOCIATES



ENGEO
INCORPORATED

SITE PLAN
NILES COURT-TRACT 6938
FREMONT, CALIFORNIA

PROJECT NO.: 4216-E3
DATE: SEPTEMBER 1998
DRAWN BY: [Signature] CHECKED BY: [Signature]

FIGURE NO.
1

OCT.-09' 98(FRI) 15:36 CHROMALAB, INC.

TEL:510 484 1096

P.001

CHROMALAB, INC.

Environmental Services (SOB)

October 9, 1998

Submission #: 9810055

ENGEO, INC.

Atten: Keith Nowell

Project: NILES COURT TRACT 6938
Received: October 2, 1998

Project#: 4216-B3

re: 12 samples for Lead analysis.
Method: EPA 3050A/7420A

Matrix: SOIL Extracted: October 5, 1998
Run#: 15237 Analyzed: October 5, 1998
Sampled: October 2, 1998

SPL#	CLIENT SPL ID	LEAD (mg/Kg)	REPORTING LIMIT (mg/Kg)	BLANK RESULT (mg/Kg)	BLANK SPIKE DILUTION FACTOR (%)
208744	2-A	17	5.0	N.D.	94.4
208745	2-B	38	5.0	N.D.	94.4
208746	2-C ✓	26	5.0	N.D.	94.4
208747	3-A ✓	15	5.0	N.D.	94.4
208748	3-B ✓	5.4	5.0	N.D.	94.4
208749	3-C ✓	30	5.0	N.D.	94.4
208750	16-A ✓	65	5.0	N.D.	94.4
208751	16-B ✓	28	5.0	N.D.	94.4
208752	16-C ✓	18	5.0	N.D.	94.4
208753	17-A ✓	55	5.0	N.D.	94.4
208754	17-B ✓	11	5.0	N.D.	94.4
208755	17-C ✓	14	5.0	N.D.	94.4

Shafi Barekzai
Analyst

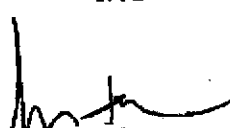
Michael Verona
Operations Manager

10-12-1998 12:53PM FROM

CHROMALAB, INC.

Environmental Services (SDB)

October 12, 1998

Submission #: 9810129

ENGEO, INC.

Atten: Keith Nowell

Project: NILES COURT TRACT 6938
Received: October 8, 1998

Project#: 4216-E3

re: 9 samples for Lead analysis.
Method: EPA 3050A/7420A

Matrix: SOIL Extracted: October 9, 1998
Run#: 15326 Analyzed: October 9, 1998
Sampled: October 8, 1998

Spl#	CLIENT SPL ID	LEAD (mg/Kg)	REPORTING LIMIT (mg/Kg)	BLANK RESULT (mg/Kg)	BLANK SPIKE (%)	DILUTION FACTOR
209529	18-A	14	5.0	N.D.	90.4	1
209530	18-B	9.9	5.0	N.D.	90.4	1
209531	18-C	12	5.0	N.D.	90.4	1
209532	19-A	61	5.0	N.D.	90.4	1
209533	19-B	12	5.0	N.D.	90.4	1
209534	19-C	15	5.0	N.D.	90.4	1
209535	20-A	N.D.	5.0	N.D.	90.4	1
209536	20-B	N.D.	5.0	N.D.	90.4	1
209537	20-C	N.D.	5.0	N.D.	90.4	1

Shafi Barekzai
Analyst

Michael Verona
Operations Manager

Run SPLP for Lead
on RUSH - 48 hr. TAT.

thanks,

Keith Nowell

10/12/98

CHROMALAB, INC.

Environmental Services (SES)

October 14, 1998

Submission #: 9810167

ENGEO, INC.

Atten: SHAWN MUNGER

Project: NILES COURT TRACT 6938
Received: October 2, 1998

Project#: 4216-E3

re: 4 samples for TCLP Lead analysis.
Method: EPA 3010A/7420A

Sampled: October 2, 1998 Matrix: SOIL Run#: 15396
Extracted: October 14, 1998
Analyzed: October 14, 1998

Spl#	CLIENT SPL ID	LEAD (mg/L)	REPORTING LIMIT (mg/L)	BLANK RESULT (mg/L)	BLANK SPIKE (%)	DILUTION FACTOR
209988	16A	N.D.	1.0	N.D.	104	1
209989	17A	N.D.	1.0	N.D.	104	1
210114	2-C	N.D.	1.0	N.D.	104	1
210115	3-C	N.D.	1.0	N.D.	104	1

Note: SPLP

Shashi Barezkai
Analyst

Michael Verona
Operations Manager

CHROMALAB, INC.

Environmental Services (SES)

October 14, 1998

Submission #: 9810168

ENGEO, INC.

Atten: Keith Nowell

Project: NILES COURT TRACT 6938
Received: October 8, 1998

Project#: 4216-E3

re: 1 sample for TCLP Lead analysis.
Method: EPA 3010A/7420A

Matrix: SOIL Extracted: October 14, 1998
Run#: 15396 Analyzed: October 14, 1998
Sampled: October 8, 1998

Split	CLIENT	SPL ID	LEAD (mg/L)	REPORTING LIMIT (mg/L)	BLANK RESULT (mg/L)	BLANK SPIKE (%)	DILUTION FACTOR
209990	19A		N.D.	1.0	N.D.	104	1

Note: SPLP

Shafi Barekzai
Analyst

Michael Verona
Operations Manager

CHROMALAB, INC.

Environmental Services (SES)

October 12, 1998

Submission #: 9810128

ENGEO, INC.

Atten: Keith Nowell

Project: NILES COURT TRACT 6938
Received: October 8, 1998

Project#: 4216-E3

re: 1 sample for Oil and Grease analysis.
Method: 5520 E&F

Sampled: October 8, 1998 Matrix: SOIL Run#: 15332 Extracted: October 9, 1998
Analyzed: October 9, 1998

Spl#	CLIENT SPL ID	OIL & GREASE (mg/Kg)	REPORTING LIMIT (mg/Kg)	BLANK RESULT (mg/Kg)	BLANK SPIKE (%)	DILUTION FACTOR
209528	S-1A,B,C,D	67	50	N.D.	96.5	1

for references
Lulu Frazier
Analyst

Michael Verona
Michael Verona
Operations Manager

CHROMALAB, INC.

Environmental Services (SDB)

October 12, 1998

Submission #: 9810128

ENGEO, INC.

Atten: Keith Nowell

Project: NILES COURT TRACT 6938
Received: October 8, 1998

Project#: 4216-E3

re: 1 sample for Lead analysis.
Method: EPA 3050A/7420A

Sampled: October 8, 1998 Matrix: SOIL Run#: 15326 Extracted: October 9, 1998
Analyzed: October 9, 1998

Spl#	CLIENT SPL ID	LEAD (mg/Kg)	REPORTING LIMIT (mg/Kg)	BLANK RESULT (mg/Kg)	BLANK SPIKE (%)	DILUTION FACTOR
209528	S-1A,B,C,D	24.5	5.0	N.D.	90.4	1

Shafi Barakzai
Analyst

Michael Verona
Operations Manager

ENGEO

INCORPORATED

2401 Crow Canyon Road

Suite 200

San Ramon, CA 94583

(925) 838-1600

Fax (925) 838-7425

FAX TRANSMITTAL**TO:** M. Logan**DATE:** October 4, 1998**FROM:** Shawn Munger**PROJECT NO.** 4216-E3**FAX NO.:** 337.9335**SUBJECT:** Niles Ct. Subdivision - Fremont**CC:****TOTAL PAGES INCLUDING THIS PAGE:** 10**REMARKS:**

- Urgent For your review Reply ASAP Please comment This is the only copy you will receive
 A copy will also be sent via: U. S. Mail Overnight Mail Courier

Medullah: Sukla asked that we forward these results to your office. These 15 samples were recovered from the street sections. The "B" samples were the five 36" to 42" depths. The remainder were recovered at 21 - 27 inches. The SPLP analyses for these 15 samples have also been completed and will be faxed to you later today. The SPLP was reported "ND" for all 15 samples.

Please note that an asphalt emulsion was applied to the road sections several weeks ago. This is the source of the reported hydrocarbons. I have had Chromalab prepare the sample chromatograms and standards and will forward to you. I also have the MSDS for the product if you are interested.

We recovered additional samples from several of the residential lots on Friday. More sampling is scheduled for later this week. Based on the results of the SPLP analyses for the road section, I would like to run total lead only on the remaining samples. Provided the totals do not exceed the street section totals... I would request that SPLPs are omitted.

Please leave a voice mail message for me @ 925-838-1600 with your comments.

Thanks for your help.

THE INFORMATION CONTAINED IN THIS FACSIMILE IS CONFIDENTIAL AND MAY ALSO BE SUBJECT TO THE ATTORNEY CLIENT PRIVILEGE OR MAY CONSTITUTE PRIVILEGED WORK PRODUCT. The information is intended only for the use of the individual or entity to whom it is addressed. If you are not the intended recipient, or the agent or employee responsible to deliver it to the intended recipient, you are hereby notified that any use, dissemination, distribution or copying of this communication is strictly prohibited. If you have received this facsimile in error, please notify us by telephone immediately and return the original message to us at the address above via the U.S. Postal Service. Thank you.

SEP.-30'98(WED) 18:00 CHROMALAB, INC.

TEL:510 484 1096

P.001

CHROMALAB, INC.

Environmental Services (SDB)

September 30, 1998

Submission #: 9809397

ENGEO, INC.

Atten: Keith Nowell

Project: NILES COURT-TRACT 6938
Received: September 28, 1998

Project#: 4216-B3

re: 15 samples for Lead analysis.
Method: EPA 3050A/7420A

Matrix: SOIL
Sampled: September 28, 1998 Run#: 15143
Extracted: September 29, 1998
Analyzed: September 29, 1998

Spl#	CLIENT SPL ID	LEAD (mg/Kg)	REPORTING LIMIT (mg/Kg)	BLANK RESULT (mg/Kg)	BLANK SPIKE FACTOR (%)	DILUTION FACTOR
207974	S-1	N.D.	5.0	N.D.	106	1
207975	S-2A	N.D.	5.0	N.D.	106	1
207976	S-2B	N.D.	5.0	N.D.	106	1
207977	S-3	N.D.	5.0	N.D.	106	1
207978	S-4	5.0	5.0	N.D.	106	1
207980	S-5A	8.2	5.0	N.D.	106	1
207981	S-5B	10	5.0	N.D.	106	1
207982	S-6	25	5.0	N.D.	106	1
207983	S-7A	N.D.	5.0	N.D.	106	1
207984	S-7B	N.D.	5.0	N.D.	106	1
207985	S-8A	N.D.	5.0	N.D.	106	1
207986	S-8B	5.5	5.0	N.D.	106	1
207987	S-9	20	5.0	N.D.	106	1
207988	S-10A	30	5.0	N.D.	106	1
207989	S-10B	N.D.	5.0	N.D.	106	1

Shafi-Barekzai
Analyst

Michael Venema
Operations Manager

SEP-30 98 (WED) 18:01 CHROMALAB, INC.

TEL:510 484 1096

CHROMALAB, INC.

Environmental Services (SDB)

September 30, 1998

Submission #: 9809397

ENGE0, INC.

Atten: Keith Nowell

Project: NILES COURT-TRACT 6930
Received: September 28, 1998

Project#: 4216-B3

re: 4 samples for TEPH analysis.
Method: EPA 8015M

Matrix: SOIL
Sampled: September 28, 1998 Run#: 15135

Extracted: September 29, 1998
Analyzed: September 30, 1998

Spl#	CLIENT SPL ID	Diesel (mg/Kg)	Motor Oil (mg/Kg)
207974	S-1 Note: Hydrocarbon reported is in the late Diesel Range and does not match our Diesel Standard.	13	110
207975	S-2A Note: Hydrocarbon reported is in the late Diesel Range and does not match our Diesel Standard.	24	150
207976	S-2B Note: Hydrocarbon reported is in the late Diesel Range and does not match our Diesel Standard.	2.3	N.D.
207977	S-3	N.D.	N.D.
Reporting Limits		1.0	50
Blank Result		N.D.	
Blank Spike Result (%)		114	--

Carolyn House
Carolyn House
Analyst

Bruce Havlik
Bruce Havlik
Analyst

SEP. -30' 98 (WED) 18:01 CHROMALAB, INC.

TEL: 510 484 1096

P. 003

CHROMALAB, INC.

Environmental Services (SDS)

September 30, 1998

Submission #: 9809397

ENGEO, INC.

Atten: Keith Nowell

Project: NILES COURT-TRACT 6938
Received: September 28, 1998

Project#: 4216-E3

re: 1 sample for TEPH analysis.
Method: EPA 8015M

Matrix: SOIL
Sampled: September 28, 1998 Run#: 15135

Extracted: September 29, 1998
Analyzed: September 30, 1998

SPL#	CLIENT SPL ID	Diesel (mg/Kg)	Motor Oil (mg/Kg)
207981	S-5B	2.5	N.D.

Note: Hydrocarbon reported is in the late Diesel Range and does not match our Diesel Standard.

Reporting Limits	1.0	50
Blank Result	N.D.	
Blank Spike Result (%)	114	--

Carol House
Carolyn House
Analyst

Bruce Havlik
Analyst

SEP.-30' 98 (WED) 18:01 CHROMALAB, INC.

TEL: 510 484 1096

P. 004

CHROMALAB, INC.

Environmental Services (SDS)

September 30, 1998

Submission #: 9809397

ENGEO, INC.

Atten: Keith Nowell

Project: NILES COURT-TRACT 6938
Received: September 28, 1998

Project#: 4216-E3

re: 1 sample for TEPH analysis.
Method: EPA 8015M

Matrix: SOIL
Sampled: September 28, 1998 Run#: 15135

Extracted: September 29, 1998
Analyzed: September 30, 1998

Spl#	CLIENT SPL ID	Diesel (mg/Kg)	Motor Oil (mg/Kg)
207982	S-5	120	670

Note: Hydrocarbon reported is in the late Diesel Range and does not match our Diesel Standard. Surrogate Recoveries biased high due to Hydrocarbon co-elution.

Reporting Limits	10	200
Blank Result	N.D.	
Blank Spike Result (%)	114	--

Carolyn House
Carolyn House
Analyst

Bruce Havlik
Analyst

SEP.-30' 98(WED) 18:01 CHROMALAB, INC.

TEL:510 484 1096

P.005

CHROMALAB, INC.

Environmental Services (SDB)

September 30, 1998

Submission #: 9809397

ENGEO, INC.

Atten: Keith Nowell

Project: NILES COURT-TRACT 6938
Received: September 28, 1998

Project#: 4216-E3

re: 1 sample for TEPH analysis.
Method: EPA 8015M

Sampled: September 28, 1998 Matrix: SOIL Run#: 15135

Extracted: September 29, 1998
Analyzed: September 30, 1998

Spl#	CLIENT SPL ID	Diesel (mg/Kg)	Motor Oil (mg/Kg)
207983	S-7A	13	51

Note: Hydrocarbon reported does not match the pattern of our Diesel Standard.

Reporting Limits	Diesel	Motor Oil
Blank Result	1.0	50
Blank Spike Result (%)	N.D.	--
	114	--

Carolyn House
Carolyn House
Analyst

Bruce Havlik
Analyst

SEP. -30' 98 (WED) 18:01 CHROMALAB, INC.

TEL:510 484 1096

P. 006

CHROMALAB, INC.

Environmental Services (SES)

September 30, 1998

Submission #: 9809397

ENGEO, INC.

Atten: Keith Nowell

Project: NILES COURT-TRACT 6938
Received: September 28, 1998

Project#: 4216-E3

re: 2 samples for TEPH analysis.
Method: EPA 8015M

Sampled: September 28, 1998 Matrix: SOIL Run#: 15135

Extracted: September 29, 1998
Analyzed: September 29, 1998

Spl#	CLIENT SPL ID	Diesel (mg/Kg)	Motor Oil (mg/Kg)
207978	S-4	37	440
Note: Hydrocarbon reported is in the late Diesel Range and does not match our Diesel Standard. Surrogate Recoveries biased high due to Hydrocarbon co-elution.			
207980	S-5A	44	530
Note: Hydrocarbon reported is in the late Diesel Range and does not match our Diesel Standard. Surrogate Recoveries biased high due to Hydrocarbon co-elution.			
Reporting Limits		10	200
Blank Result		N.D.	
Blank Spike Result (%)		114	--

Carolyn House
Carolyn House
Analyst

Bruce Havlik
Analyst

SEP. 30 '98 (WED) 18:01 CHROMALAB, INC.

TEL: 510 484 1096

P. 007

CHROMALAB, INC.

Environmental Services (SDB)

September 30, 1998

Submission #: 9809397

ENGE0, INC.

Atten: Keith Nowell

Project: NILES COURT-TRACT 6938

Project#: 4216-B3

Received: September 28, 1998

re: 4 samples for TEPH analysis.
Method: EPA 8015MMatrix: SOIL
Sampled: September 28, 1998 Run#: 15135Extracted: September 29, 1998
Analyzed: September 29, 1998

Spl#	CLIENT SPL ID	Diesel (mg/Kg)	Motor Oil (mg/Kg)
207986	S-8B	63	390
Note: Hydrocarbon reported does not match the pattern of our Diesel Standard. Surrogate Recoveries biased high due to Hydrocarbon co-elution.			
207987	S-9	310	1400
Note: Hydrocarbon reported is in the late Diesel Range and does not match our Diesel Standard. Surrogate Recoveries biased high due to Hydrocarbon co-elution.			

Matrix: SOIL
Sampled: September 28, 1998 Run#: 15135Extracted: September 29, 1998
Analyzed: September 30, 1998

Spl#	CLIENT SPL ID	Diesel (mg/Kg)	Motor Oil (mg/Kg)
207984	S-7B	41	360
Note: Hydrocarbon reported does not match the pattern of our Diesel Standard.			
207985	S-8A	35	380
Note: Hydrocarbon reported does not match the pattern of our Diesel Standard.			

Reporting Limits

Blank Result

10

200

Blank Spike Result (†)

N.D.

114

--

Carolyn House
Carolyn House
Analyst

Bruce Havlik
Analyst

SEP. -30' 98 (WED) 18:02 CHROMALAB, INC.

TEL: 510 484 1096

P. 008

CHROMALAB, INC.

Environmental Services (SES)

September 30, 1998

Submission #: 9809397

ENGEO, INC.

Atten: Keith Nowell

Project: NILES COURT-TRACT 6938
Received: September 28, 1998

Project#: 4216-E3

re: 1 sample for TEPH analysis.
Method: EPA 8015M

Sampled: September 28, 1998 Matrix: SOIL Run#: 15135

Extracted: September 29, 1998
Analyzed: September 29, 1998

Spl#	CLIENT EPL ID	Diesel (mg/Kg)	Motor Oil (mg/Kg)
207988	S-10A	140	1200

Note: Hydrocarbon reported is in the late Diesel Range and does not match our Diesel Standard. Surrogate Recoveries biased high due to Hydrocarbon co-elution.

Reporting Limits	Diesel	Motor Oil
Blank Result	20	400
Blank Spike Result (%)	N.D.	
	114	--

Carol House
Carolyn House
Analyst

Bruce Havlik
Analyst

SEP.-30'98(WED) 18:02 CHROMALAB, INC.

TEL:510 484 1096

P.009

CHROMALAB, INC.

Environmental Services (SOB)

September 30, 1998

Submission #: 9809397

ENGEO, INC.

Atten: Keith Nowell

Project: NILES COURT-TRACT 6938
Received: September 28, 1998

Project#: 4216-E3

re: 1 sample for TEPH analysis.
Method: EPA 8015M

Sampled: September 28, 1998 Matrix: SOIL Run#: 15135

Extracted: September 29, 1998
Analyzed: September 29, 1998

Spl# CLIENT SPL ID
207989 S-10B

Diesel Motor Oil
(mg/Kg) (mg/Kg)
N.D. N.D.

Reporting Limits
Blank Result
Blank Spike Result (†)

1.0 50
N.D.
114 --

Carolyn House
Analyst

Bruce Havlik
Analyst

10-02-1998 2:01PM FROM

P.1

CHROMALAB, INC.

Environmental Services (SDB)

October 2, 1998

Submission #: 9809428

ENGEO, INC.

Atten: Shawn Munger

Project: NILES COURT-TRACT 6938
Received: September 28, 1998

Project#: 4216-E3

re: 15 samples for SPLP Lead analysis.
Method: EPA 3010A/7420AMatrix: SOIL
Sampled: September 28, 1998 Run#: 15177Extracted: October 1, 1998
Analyzed: October 1, 1998

Spl#	CLIENT SPL ID	LEAD (mg/L)	REPORTING LIMIT (mg/L)	BLANK RESULT (mg/L)	BLANK SPIKE (%)	DILUTION FACTOR
208287	S-1	N.D.	1.0	N.D.	103	1
208288	S-2A	N.D.	1.0	N.D.	103	1
208289	S-2B	N.D.	1.0	N.D.	103	1
208290	S-3	N.D.	1.0	N.D.	103	1
208291	S-4	N.D.	1.0	N.D.	103	1
208292	S-5A	N.D.	1.0	N.D.	103	1
208293	S-5B	N.D.	1.0	N.D.	103	1
208294	S-6	N.D.	1.0	N.D.	103	1
208295	S-7A	N.D.	1.0	N.D.	103	1
208296	S-8A	N.D.	1.0	N.D.	103	1
208297	S-8B	N.D.	1.0	N.D.	103	1
208298	S-9	N.D.	1.0	N.D.	103	1
208299	S-10A	N.D.	1.0	N.D.	103	1
208300	S-10B	N.D.	1.0	N.D.	103	1
208301	S-7B	N.D.	1.0	N.D.	103	1

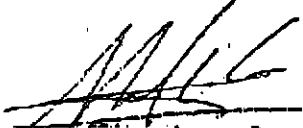
 Christopher Arndt
 Analyst

 Michael Verona
 Operations Manager

SPLP
Lead
Results