

RGA ENVIRONMENTAL, INC



4701 Doyle Street, Suite 14, Emeryville, California 94608  
658-9094 Fax: 510 658-9074 Tel: 510 658-4263  
E-Mail: RGAEnv@AOL.com

FAX TRANSMITTAL SHEET

TO: Susan Hugo  
COMPANY: ACDEH  
FAX NO: 510/337-9335  
PHONE NO: 510/567-6780  
RE: Heritage Construction  
5800 SHELMAN ST.

FROM: ~~Paul King~~ Greg Beaud  
DATE: 9/29/00  
TOTAL NO. OF PAGES FAXED: 1  
SENDER'S JOB REFERENCE NO: 45815835

EMERYVILLE, CA

URGENT

FOR REVIEW

PLEASE COMMENT

PLEASE REPLY

Susan -

Our printer has sneaked us in in his busy schedule to replace ATD1A at Harbore - Monday, October 2, 2000

at 8 AM. I apologize for the short notice - the choice was that or waiting, possibly into November.

Give us a call if you have questions.

(You approved of this verbally on 9/19, in response to our letter OCH.L29 of 9/13.)

THANKS!

- GREG

Delling

CC: MARCON ~~MAG~~, ACDDPW - 510/782-1939 (e) RE: PERMIT W00-544  
MAGALLANS

RGA ENVIRONMENTAL, INC



4701 Doyle Street, Suite 14, Emeryville, California 94608  
658-4574 Fax: 510 ~~510-658-4574~~ Tel: 510 ~~510-658-4563~~ 658-4563  
E-Mail: RGAEnv@AOL.com

SLIC 6593A

FAX TRANSMITTAL SHEET

TO: Susan Hugo	FROM: <del>Greg Brown</del> GREG BROWN
COMPANY: ACDEH	DATE: 9/5/00
FAX NO: 510/60 837-9335	TOTAL NO. OF PAGES FAXED: 2
PHONE NO: 510/567-6780	SENDER'S JOB REFERENCE NO: HSN14689
RE: HERDAGE CONSTRUCTION 5900 SHELLEMAN EMERYVILLE CA	

URGENT     FOR REVIEW     PLEASE COMMENT     PLEASE REPLY

Susan -

PLEASE FIND ATTACHED A MAP SHOWING THE WELL (ATDEA) WHICH WAS RECENTLY BROKEN BY CONSTRUCTION ACTIVITY, AND WHICH WE INTEND TO REPLACE. OUR SCOPE OF WORK IS EQUIVALENT TO THE LAST TIME WE HAD TO DO THIS, DISCUSSED IN OUR WORK PLAN OIB4.W4, DATED NOV. 22, 1999, AND APPROVED BY YOU. GIVE US A CALL IF YOU HAVE ANY QUESTIONS.

THANKS!  
- GREG

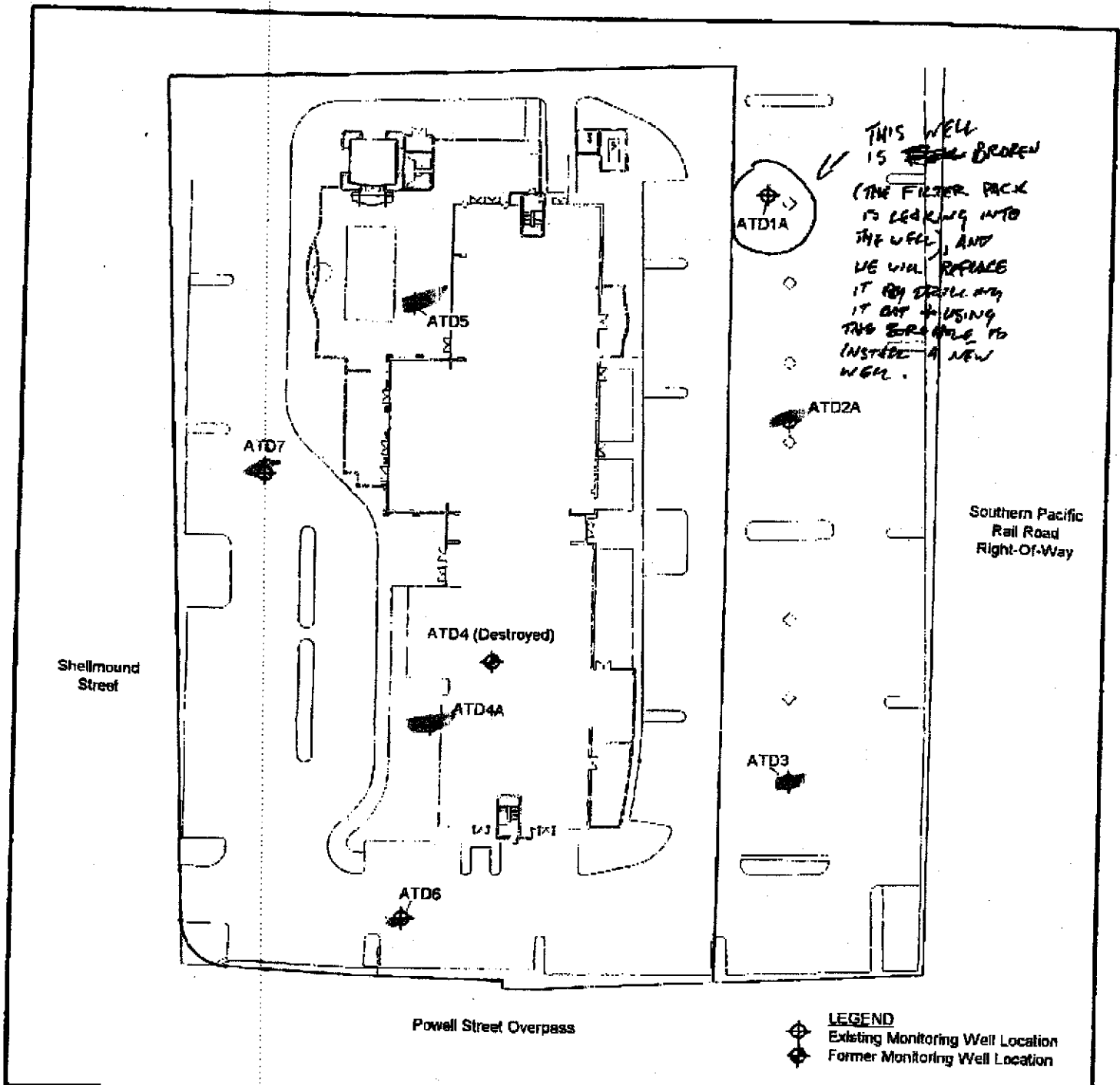
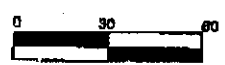

**FIGURE 2**  
**SITE PLAN**  
 Hardage Construction Corporation Site  
 5800 Shellmound Street  
 Emeryville, California



Source:  
 Serina & Thompson, Inc.  
 Woodrow Gate Meter  
 Monitoring Well Location and Elevation Map  
 March, 1999

RGA Environmental, Inc.  
 4701 Doyle Street, Suite 14  
 Emeryville, California 94608



SCALE IN FEET

## RGA ENVIRONMENTAL, INC



4701 Doyle Street, Suite 14, Emeryville, California 94608  
 658-9074 Fax: 510 ~~944-1234~~ Tel: 510 ~~944-1234~~ 658-4363  
 E-Mail: RGAEnv@AOL.com

## FAX TRANSMITTAL SHEET

TO: Susan Hugo  
 COMPANY: ACDEH  
 FAX NO: 510/337-9335  
 PHONE NO: 510/567-6780

RE: ~~HAZARDOUS~~ CONSTRUCTION ~~MITIGATION~~  
 5800 SMALLMOUND RD.

FROM: ~~XXXXXXXXXX~~ Gary Brown

DATE: 9/29/99

TOTAL NO. OF PAGES FAXED: 2

SENDER'S JOB REFERENCE NO: 15014089

URGENT

FOR REVIEW

PLEASE COMMENT

PLEASE REPLY

Susan -

PLEASE FIND THE FOLLOWING ATTACHED:

- HAZARDOUS CONSTRUCTION SITE PLAN (FIGURE 2) (1 P.)

THE MARKED WELL (ATDZ) IS ON THE SITE'S EAST SIDE IS THE ONE WE'D LIKE TO EITHER DESTROY OR REPLACE. WHAT SEEMS APPROPRIATE TO YOU? (ALSO, I APOLOGIZE - I COULDN'T FIND THE SITE'S STIP B; I KNOW YOU APPROVED THE ~~HAZARDOUS~~ CONTAMINATION MITIGATION WORK PLAN, THOUGH, SO I HOPE THIS SEEMS FAMILIAR).

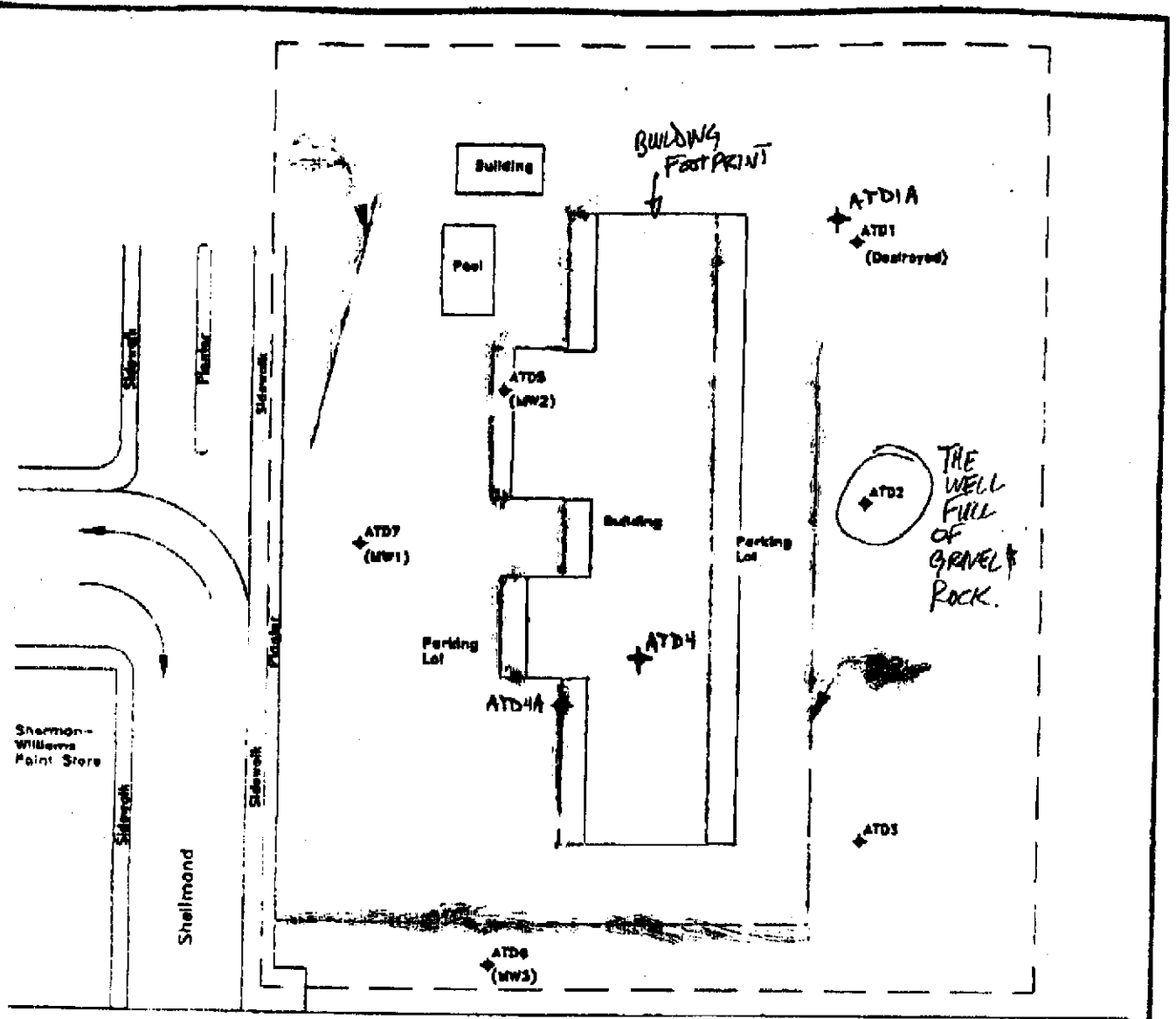

Powell Street (Overpass)

**LEGEND**

◆ Monitoring Well Location

— Property Boundary

FIGURE 2  
 SITE PLAN  
 Hardoge Suite Hotels, Inc.  
 Intersection of Shellmound and Powell Street (Northeast corner)  
 Emeryville, California



Site Map From:  
 CA Environmental Inc.  
 November, 1997  
 Mason Engineers, Inc.  
 August 8, 1991  
 Applied GeoScience  
 February, 1992  
 (B10840065)

RGA Environmental, Inc.  
 1260 45th Street  
 Emeryville, California 94608

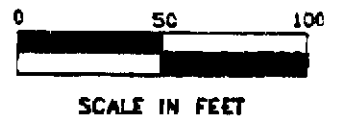

.....  
**facsimile transmission**

**To:** Paul King @ RGA

**From:** Chuck Hart

**Re:** Emergency Services

**CC:** Susan Hugo @ County Health  
Services (510) 371-1111

**Urgent** for Review

The check for \$4,000.00, dated 10/1/98, per the request of Susan L. Hugo @ the County Health Care Services in her letter dated August 5, 1998 was sent along with the missing application and was processed through the bank on 10/28/98. Has this application package been located? Please let me know.

Thanks

.....

ALAMEDA COUNTY  
HEALTH CARE SERVICES

AGENCY  
DAVID J. KEARS, Agency Director



ENVIRONMENTAL  
PROTECTION

~~98 OCT - 8 PM 3:06~~

August 5, 1998

Mr. Charles Hibert  
Hardage Construction Corporation  
12730 High Bluff Drive, Suite 250  
San Diego, California 91230

ENVIRONMENTAL HEALTH SERVICES  
1131 Harbor Bay Parkway, Suite 250  
Alameda, CA 94502-6577  
(510) 567-6700  
(510) 337-9335 (FAX)

**RE: Project # 6532 A - Type M (STID # 6593)  
Woodfin Suite Hotel – 5800 Shellmound and Powell Street, Emeryville, CA 94608**

Dear Mr. Hibert:

Our records indicate the deposit / refund account for the above project has fallen below the minimum deposit amount. To replenish the account, please submit an additional deposit of \$4,000.00 payable to Alameda County, Environmental Health Services.

We must receive this deposit so that future regulatory oversight on the subject site can proceed in a timely fashion. At the completion of this project, any unused monies will be refunded to you or your designee.

The deposit refund mechanism is authorized in Section 6.92.040L of the Alameda County Ordinance Code. Work on this project will be debited at the Ordinance specified rate, currently at \$ 100 per hour.

Please be sure to write the following on the check to identify your account:

- project #,
- type of project and
- site address (see RE: line above).

If you have any questions, please contact me at (510) 567-6780.

Sincerely,

Susan L. Hugo  
Hazardous Materials Specialist

c: Thomas Peacock, Program Manager  
Paul King, RGA, 4701 Doyle Street, Suite 14, Emeryville, California 94608  
SH / files



# WOODFIN SUITE HOTELS



July 30, 1998

East Bay Municipal Utility District  
Wastewater Department  
MS 702  
P.O. Box 24055  
Oakland, CA 94623-1055



To Whom It May Concern:

This letter authorizes Chuck Hibert to sign any documents regarding the Woodfin Suite Hotel at 5800 Shellmound in Emeryville, California. If you have any questions, do not hesitate to contact me at 619-799-0710.

Sincerely,

*Charles Pendry, Jr.*  
Chuck Pendry  
Chief Operating Officer

CP/cd







WOODFIN SUITE HOTELS



FAX MEMO

TO: Chuck Hibert  
FROM: Carole  
DATE: July 30, 1998  
RE: Letter of Authorization

TOTAL NUMBER OF PAGES INCLUDING COVER SHEET - 2

---



Chuck:

Please see attached a copy of the letter of authorization I am sending to East Bay Municipal Utility District for your signature of documents.

Call me if you have any questions.

Regards,

Carole



ALAMEDA COUNTY  
HEALTH CARE SERVICES



AGENCY  
DAVID J. KEARS, Agency Director

ENVIRONMENTAL HEALTH SERVICES

1131 Harbor Bay Parkway, Suite 250  
Alameda, CA 94502-6577  
(510) 567-6700  
(510) 337-9335 (FAX)

July 10, 1998

Mr. Charles Hibert  
Hardage Construction Corporation  
12730 High Bluff Drive, Suite 250  
San Diego, California 91230

**Subject: Woodfin Suite Hotels, Inc. - Shellmound and Powell Street, Emeryville, California 94608  
SLIC # 6593**

Dear Mr. Hibert:

This agency has reviewed the following reports prepared and submitted by RGA Environmental for the proposed development of a hotel at the subject site:

- Contamination Mitigation Work Plan dated April 9, 1998
- Storm Water Pollution Prevention Plan dated May 20, 1998
- Pile Driving Work Plan prepared by Hardage Construction Corporation dated June 19, 1998 and verbally approved by Mr. Derek Lee of the Cal-EPA/San Francisco Bay Regional Water Quality Control Board on June 22, 1998
- Contamination Mitigation Work Plan Addendum dated June 23, 1998
- Site Safety Plan dated July 3, 1998 and approved by Ms. Barbara Cook of the Cal-EPA/ Department of Toxic Substances Control in a letter dated July 6, 1998
- Contamination Mitigation Work Plan Addendum dated July 10, 1998

Based on this review, the proposed work plan adequately addresses issues of concern this office has regarding the development of the site. The work plan is approved and you may proceed with construction activities at the subject site. A report should be submitted to this agency following completion of the project.

Please keep this agency apprised of the schedule of activities at the site.

If you have any questions regarding this letter or the subject site, please contact me at (510) 567-6780.

Sincerely,

Susan L. Hugo  
Hazardous Materials Specialist

c: Derek Lee, San Francisco Bay RWQCB  
Ravi Arulanantham, San Francisco Bay RWQCB  
Remedios Sunga, Cal-EPA/DTSC, 700 Heinz Ave., Suite 300, Berkeley, CA 94710  
Claudia Cappio, Emeryville Planning & Building Dept., 2200 Powell, 12<sup>th</sup> Fl., Emeryville, CA 94608  
Paul King, RGA, 4701 Doyle St., Suite 14, Emeryville, CA 94608  
SH / files



ENVIRONMENTAL  
PROTECTION  
**CITY OF EMERYVILLE**  
INCORPORATED 1896  
98 JUL -7 PM 3:21  
PLANNING DEPARTMENT  
2200 POWELL, 12TH FLOOR  
EMERYVILLE, CALIFORNIA 94608

TEL: (510) 596-4360 FAX: (510) 658-8095

**MEMORANDUM**

**DATE:** July 2, 1998

**TO:** Chuck Heibert, Hardage Construction

**FROM:** Claudia Cappio, Planning and Building Director *CC*  
City of Emeryville

**RE:** Authorization to Proceed with Indicator Piles for Woodfin Suites Hotel

This memorandum serves as authorization for the Woodfin Suites Hotel Project to proceed with driving indicator piles, subject to the following conditions and requirements:

- ▶ The indicator piles shall be driven for a maximum time period of two weeks from the commencement date.
- ▶ Hours of pile driving shall be restricted from 8:00 AM to 5:00 PM , Monday through Fridays only.
- ▶ Prior written notification to adjacent properties, including the Public Market is required.
- ▶ The pile driving shall occur in compliance with all Federal, State, Regional and County requirements concerning management of contaminated soil and water, worker health and safety plans, remedial action plans, etc.

Please notify the Building Department (Margaret Elliott, Building Official) at 596-4330 upon commencement of the indicator pile driving, or if you have further questions concerning this authorization.

cc: Margret Elliott, Building Official  
Paul King, RGA Environmental  
Susan Hugo, County of Alameda ✓

6/3/98

TO: Susan Hugo  
FROM: Chuck Albert - Hardware Construction  
RE: Woodfin Suite Hotel - Emeryville

I apologize for this form but do not have site forms printed and do not have power at the site trailer yet.

Per RGA Environmental I am sending you the Storm Water Plan, Geotech Report, Civil (Grading) Plans and the Structural Plans.

It is also understood that we will control the dust during all construction activities through the use of water trucks and other means as required.

ENVIRONMENTAL PROTECTION  
98 JUN -4 PM 2:58