

ALCO  
HAZMAT

94 JUN -3 PM 2:55



# 4980

June 2, 1994

BAE36921.A3.ZZ

Alameda County Department of Environmental Health  
Division of Hazardous Materials  
80 Swan Way, Room 200  
Oakland, California 94621

Attention: Mr. Barney Chan

Subject: Report of Soil Containing Diesel/Motor Oil  
Del Monte Plant 26, Oakland, California

As we discussed by phone last week, on May 23rd a Del Monte contractor encountered soil containing an oily substance when excavating a pit as part of a utility modification project at the former Del Monte Plant 26 property located at 400 Lancaster Street in Oakland, California 94601. As shown on the attached figure, the pit was located at the northeast property line between the former Del Monte property and what is believed to be Southern Pacific Railroad property. Del Monte is currently researching the question of property ownership with Southern Pacific representatives.

The pit dimensions were approximately 12 feet by 5 feet, with the depth ranging from 3 to 5 feet below ground surface. An oily liquid was observed seeping from the corners of the excavation at about 3 feet below ground surface. Soil at that depth appeared oily and had a petroleum hydrocarbon odor. A soil sample was collected on May 23rd and was analyzed for Total Extractable Petroleum Hydrocarbons (kerosene, diesel, and motor oil). The laboratory report is attached. Diesel was detected in the soil sample at 1,100 mg/kg and motor oil at 1,200 mg/kg. No kerosene was detected. *STOP?*

As part of the same utility project, a trench with a depth of approximately 4 to 5 feet was excavated adjacent to the ramp into the warehouse as shown on the attached figure. No apparent soil or groundwater contamination was encountered during its construction.

For reasons of public safety, on May 27th, the pit was backfilled with the soil that had been excavated.

Alameda County Department of Environmental Health

Page 2

June 2, 1994

BAE36921.A3.ZZ

Del Monte has contacted Southern Pacific to discuss soil remediation and will keep you apprised of the situation. Please contact me if you have any questions about this letter.

Sincerely,

CH2M HILL



Madeline Wall  
Project Manager

cc: Mr. Thomas Bender/Del Monte  
Mr. Steve Ronzone/Del Monte  
Mr. Soon Kim/Del Monte  
Mr. Joseph Cheng/Transmeridian Warehouses, Inc.

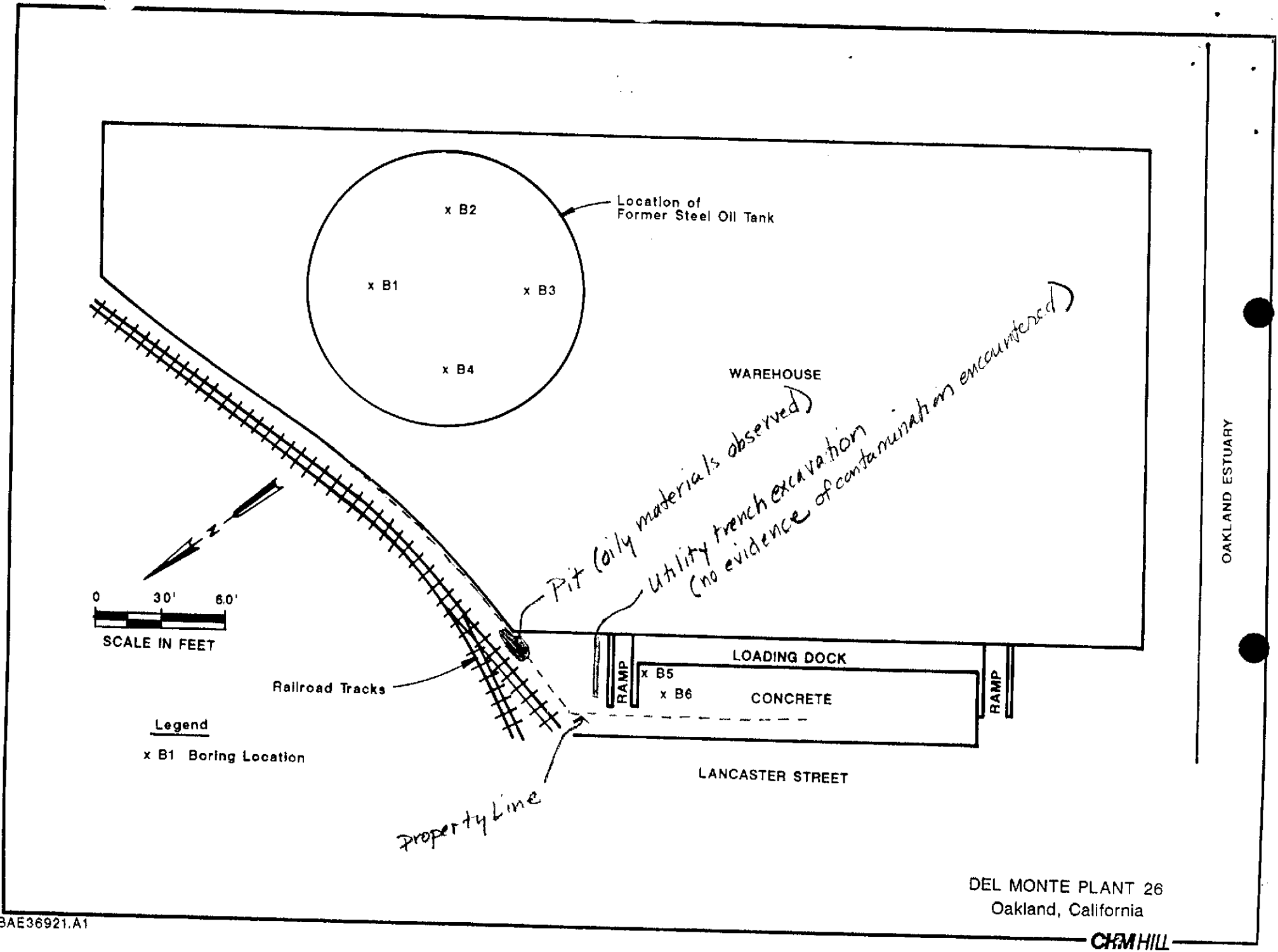

OAKLAND ESTUARY

Location of Former Steel Oil Tank

WAREHOUSE

LOADING DOCK

CONCRETE

LANCASTER STREET

*Pit (oily materials observed)*  
*Utility trench excavation (no evidence of contamination encountered)*

*Property Line*

0 30' 60'  
 SCALE IN FEET

Legend

x B1 Boring Location

DEL MONTE PLANT 26  
 Oakland, California

CHM HILL

BAE36921.A1

**CHROMALAB, INC.**

Environmental Services (SUB)

May 27, 1994

ChromaLab File No.: 9405350

CH2M HILL OAKLAND

Attn: Keith Gally

RE: One soil sample for TEPH analysis

Project Name: DEL MONTE PLANT 26

Project Number: BAE36921.A3.ZZ

Date Sampled: May 23, 1994

Date Submitted: May 26, 1994

Date Extracted: May 27, 1994

Date Analyzed: May 27, 1994

**RESULTS:**

Sample I.D.	Kerosene (mg/Kg)	Diesel (mg/Kg)	Motor Oil (mg/Kg)
DM 26-SS	N.D.	1100	1200
BLANK	N.D.	N.D.	N.D.
SPIKE RECOVERY	--	91%	--
DETECTION LIMIT	10	10	100
METHOD OF ANALYSIS	3550/8015	3550/8015	3550/8015

ChromaLab, Inc.

  
 Alex Tam  
 Analytical Chemist

  
 Eric Tam  
 Laboratory Director

99