

R02745
G

CAMBRIA

July 15, 2005

Alameda County
JUL 19 2005
Environmental Health

Mr. Jerry Wickham
Hazardous Materials Specialist
Alameda County Health Care Services Agency
1131 Harbor Bay Parkway, Suite 250
Alameda, California 94502-6577

Re: **Second Quarter 2005 Status Report**
Shell-branded Service Station
1601 Webster Street
Alameda, California
Incident # 97564701
SAP Code 135032
ACHCSA # 13-503



Dear Mr. Wickham:

Cambria Environmental Technology, Inc. (Cambria) prepared this report on behalf of Equilon Enterprises LLC dba Shell Oil Products US (Shell) in accordance with the quarterly reporting requirements of 23 CCR 2652d.

SITE LOCATION AND DESCRIPTION

The subject property is an operating Shell-branded service station located on the northwest corner of Webster Street and Lincoln Avenue in Alameda, California (Figure 1). The station layout includes three underground storage tanks (USTs), a former waste oil UST, two current dispensers and two former dispensers islands, a station building, and a kiosk (Figure 2). The local topography is flat with a site elevation at approximately 13 feet above mean sea level. The site is surrounded by a mix of commercial and residential development.

SECOND QUARTER 2005 ACTIVITIES

Periodic groundwater extraction (GWE) and sampling from TBW-N continued on a monthly basis. Onyx Industrial performed monthly batch GWE events on April 6 and May 2, 2005. Blaine performed monthly gauging and sampling on April 12 and May 13, 2005. No SPH was observed in TBW-N during any of these events. The groundwater samples from TBW-N were analyzed for TPHg, BTEX, MTBE, di-isopropyl ether (DIPE), tertiary amyl methyl ether (TAME), tertiary butyl alcohol (TBA), and ethyl tert butyl ether (ETBE), ethylene dibromide (EDB), 1,2-dichloroethane (1,2-DCA), and ethanol. A copy of Blaine's monitoring report, including laboratory reports, is included in Appendix A.

Cambria
Environmental
Technology, Inc.

270 Perkins Street
Sonoma, CA 95476
Tel (707) 935-4850
Fax (707) 935-6649

C A M B R I A

To date, an estimated volume of 1,982.1 gallons of separate-phase hydrocarbons (SPH) were recovered as separate-phase liquid. As of the end of May 2005, an estimated mass of 116.0 pounds (an equivalent volume of 18.6 gallons) of dissolved TPHg was recovered in water. The analytical results for TBW-N are presented in the Blaine's data table in Appendix A. Cambria's water removal data and estimates of SPH and dissolved-phase product recovery are summarized in Table 1. Figure 3 graphically illustrates the SPH thickness, volume of recovered groundwater and TPHg concentrations versus time. Figure 4 graphically illustrates the volume of recovered groundwater and benzene concentrations versus time. Figure 5 graphically illustrates the volume of recovered groundwater and MTBE concentrations versus time.



ANTICIPATED THIRD QUARTER 2005 ACTIVITIES

The periodic GWE will continue and Blaine will continue the monthly gauging and sampling of TBW-N. Cambria will prepare a status report documenting the activities.

As requested by the Alameda County Health Care Services Agency in correspondence dated May 13, 2005, a work plan for subsurface investigation will be submitted by July 15, 2005, under separate cover.

C A M B R I A

CLOSING

If you have any questions regarding this submittal, please call Ana Friel at (707) 268-3812.

Sincerely,
Cambria Environmental Technology, Inc.

K. Newton
for Karen Newton
Staff Engineer

A. Friel
for Ana Friel
Senior Project Geologist
PG 6452

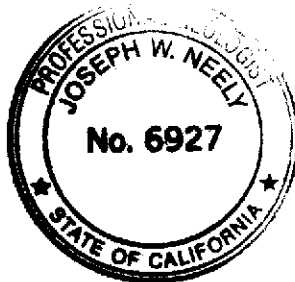

Attachments

Table 1. Groundwater and Product Removal Data

- Figure 1. Vicinity/Sensitive Receptor Survey Map
- Figure 2. Site Plan/Historical Sample Location Map
- Figure 3. GWE Pumping Volume, SPH Thickness, and TPHg Concentration
- Figure 4. GWE Pumping Volume, and Benzene Concentration
- Figure 5. GWE Pumping Volume, and MTBE Concentration

Appendix A. Blaine Services Inc. First Quarter 2005 Groundwater Monitoring Report

cc: Mr. Denis Brown, Shell Oil Products US
Mr. Thomas H. Kosel, ConocoPhillips Risk Management & Remediation, 76
Broadway, Sacramento, CA 95818
Mr. James C. Kirschner, ATC Associates, Inc., 6602 Owens Drive, Suite 100,
Pleasanton, CA 94588 (consultant for ConocoPhillips)

Table 1. Groundwater and Product Removal Data - Shell Service Station, Incident # 97564701, 1601 Webster Street, Alameda, California.

Date	Total Volume Hauled (gal)	Cumulative Volume (gal)	Measured Product Thickness in Vacuum Truck (feet)	Dissolved TPHg Conc. (ppm or mg/L)	Estimated pounds removed in Dissolved Phase (lbs)	Estimated Volume of Product Removed as SPH (gal)	Estimated Volume of Product Removed as dissolved phase (gal)	Comments
								FUEL RELEASE ESTIMATE: UST gaging by SJ Weaver on 8/18 read 71.5 inches = 8,340 gallons, per tank chart. On 8/19 gaging by SJ Weaver read 55 inches = 6,256 gallons, per tank chart. Net est. Loss = 8,340-6,256 = 2,084 gallons.
8/19/2004	2,168	2,168	NM	120	2.17	NM	0.36	Pumped from well into open Baker tank. Then tank emptied by PSC vacuum truck. Water not sampled - TPHg concentration estimated from 9/20/04 concentration as a "maximum" reasonable estimate.
8/19/2004	2,535	4,703	NM	120	2.54	915	0.42	Pumped from well into open Baker tank. Also pumped directly into Vacuum Truck. Then open Baker tank emptied by PSC. Water not sampled - TPHg concentration estimated from 9/20/04 concentration as a "maximum" reasonable estimate.
8/20/2004	0	4,703	NM	120	0.00	--	0.00	Pumped into closed Baker tank - none hauled.
8/21/2004	4,369	9,072	NM	120	4.37	50	0.72	Pumped into closed Baker tank, then began emptying closed tank by vacuum truck. Estimated SPH volume from similar data. Water not sampled - TPHg concentration estimated from 9/20/04 concentration as a "maximum" reasonable estimate.
8/21/2004	3,654	12,726	0.67	120	3.66	773	0.60	From closed Baker tank and well. Volumes based on verbal report - missing bills of lading. Water not sampled - TPHg concentration estimated from 9/20/04 concentration as a "maximum" reasonable estimate.
8/21/2004	2,091	14,817	0.04	120	2.09	57	0.34	From well and baker tank. Volumes based on verbal report - missing bills of lading
8/22/2004	319	15,136	NM	120	0.32	NM	0.05	Baker Tank cleaning water. Water not sampled - TPHg concentration estimated from 9/20/04 concentration as a "maximum" reasonable estimate.
8/22/2004	2,285	17,421	0.11	120	2.29	150	0.38	Water not sampled - TPHg concentration estimated from 9/20/04 concentration as a "maximum" reasonable estimate.
8/23/2004	1,947	19,368	0.01	120	1.95	13	0.32	Water not sampled - TPHg concentration estimated from 9/20/04 concentration as a "maximum" reasonable estimate.
8/24/2004	1,013	20,381	0.01	120	1.01	12	0.17	Water not sampled - TPHg concentration estimated from 9/20/04 concentration as a "maximum" reasonable estimate.
8/25/2004	4,026	24,407	NM	120	4.03	NM	0.66	Water not sampled - TPHg concentration estimated from 9/20/04 concentration as a "maximum" reasonable estimate.
8/26/2004	3,839	28,246	NM	82	2.63	NM	0.43	
8/27/2004	3,882	32,128	NM	82	2.66	NM	0.44	
8/28/2004	2,770	34,898	NM	100	2.31	NM	0.38	
8/29/2004	3,834	38,732	NM	100	3.20	NM	0.53	
8/30/2004	3,376	42,108	NM	91	2.56	12	0.42	Half UST cleaning water and half groundwater from well. SPH amount estimated from 0.02' SPH in UST gaged on 8/21/04.
8/31/2004	3,249	45,357	NM	91	2.47	NM	0.41	
9/1/2004	3,832	49,189	NM	110	3.52	NM	0.58	
9/2/2004	2,151	51,340	NM	110	1.97	NM	0.32	
9/3/2004	3,136	54,476	NM	99	2.59	NM	0.43	
9/4/2004	3,671	58,147	NM	99	3.03	NM	0.50	
9/5/2004	3,395	61,542	NM	66	1.87	NM	0.31	
9/6/2004	2,948	64,490	NM	66	1.62	NM	0.27	
9/7/2004	3,285	67,775	NM	66	1.81	NM	0.30	
9/8/2004	3,128	70,903	NM	66	1.72	NM	0.28	
9/9/2004	3,902	74,805	NM	67	2.18	NM	0.36	water from TBW-N, TBW-S, & TBW-E
9/10/2004	2,989	77,794	NM	67	1.67	NM	0.27	water from TBW-N, TBW-S, & TBW-E
9/13/2004	2,807	80,601	NM	61	1.43	NM	0.23	70-barrel truck
9/20/2004	4,266	84,867	NM	120	4.27	NM	0.70	
9/28/2004	4,691	89,558	NM	99	3.88	NM	0.64	
10/4/2004	4,050	93,608	NM	80	2.70	NM	0.44	
10/11/2004	3,121	96,729	NM	57	1.48	NM	0.24	
10/18/2004	3,597	100,326	NM	68	2.04	NM	0.34	
10/25/2004	4,127	104,453	NM	81	2.79	NM		2,641 additional gallons from tank cleaning were disposed of on 10/25/04
11/1/2004	5,047	109,500	NM	86	3.62	NM	0.59	
11/8/2004	2,178	111,678	NM	100	1.82	NM	0.30	
11/16/2004	4,891	116,569	NM	83	3.39	NM	0.56	concentration based on 11/23/04 sample
11/29/2004	4,531	121,100	NM	160	6.05	NM	0.99	concentration based on 11/30/04 sample
12/13/2004	5,208	126,308	NM	120	5.21	NM	0.86	concentration based on 12/15/04 sample
12/27/2004	4,800	131,108	NM	100	4.01	NM	0.66	concentration based on 12/27/04 sample
1/17/2005	3,580	134,688	NM	86	2.57	NM	0.42	concentration based on 1/17/05 sample
2/7/2005	2,389	137,077	NM	97	1.93	NM	0.32	concentration based on 2/4/05 sample
3/8/2005	4,843	141,920	NM	94	3.80	NM	0.62	concentration based on 3/3/05 sample
4/6/2005	4,711	146,631	NM	27	1.06	NM	0.17	concentration based on 4/12/05 sample
5/2/2005	4,706	151,337	NM	42	1.65	NM	0.27	concentration based on 5/13/05 sample

TOTALS

151,337 (gallons) Total Estimated Volume of Liquid Removed

116.0 (pounds) Total estimated mass based on dissolved TPHg concentrations	1,982.1 (gallons) Total Estimated Volume accounted for as liquid SPH	18.6 (gallons) Total estimated equivalent volume based on dissolved TPHg concentrations
--	---	--

NOTES:

Mass removal values are approximate only.

Pounds of TPHg removal based on the calculation: (TPHg concentration (ppm)) x gallons pumped x (8.3x10⁻⁶ (liters/galxppm/mg))

lbs = pounds

gal = gallons

ppm = parts per million

estimate value based on visual assessment

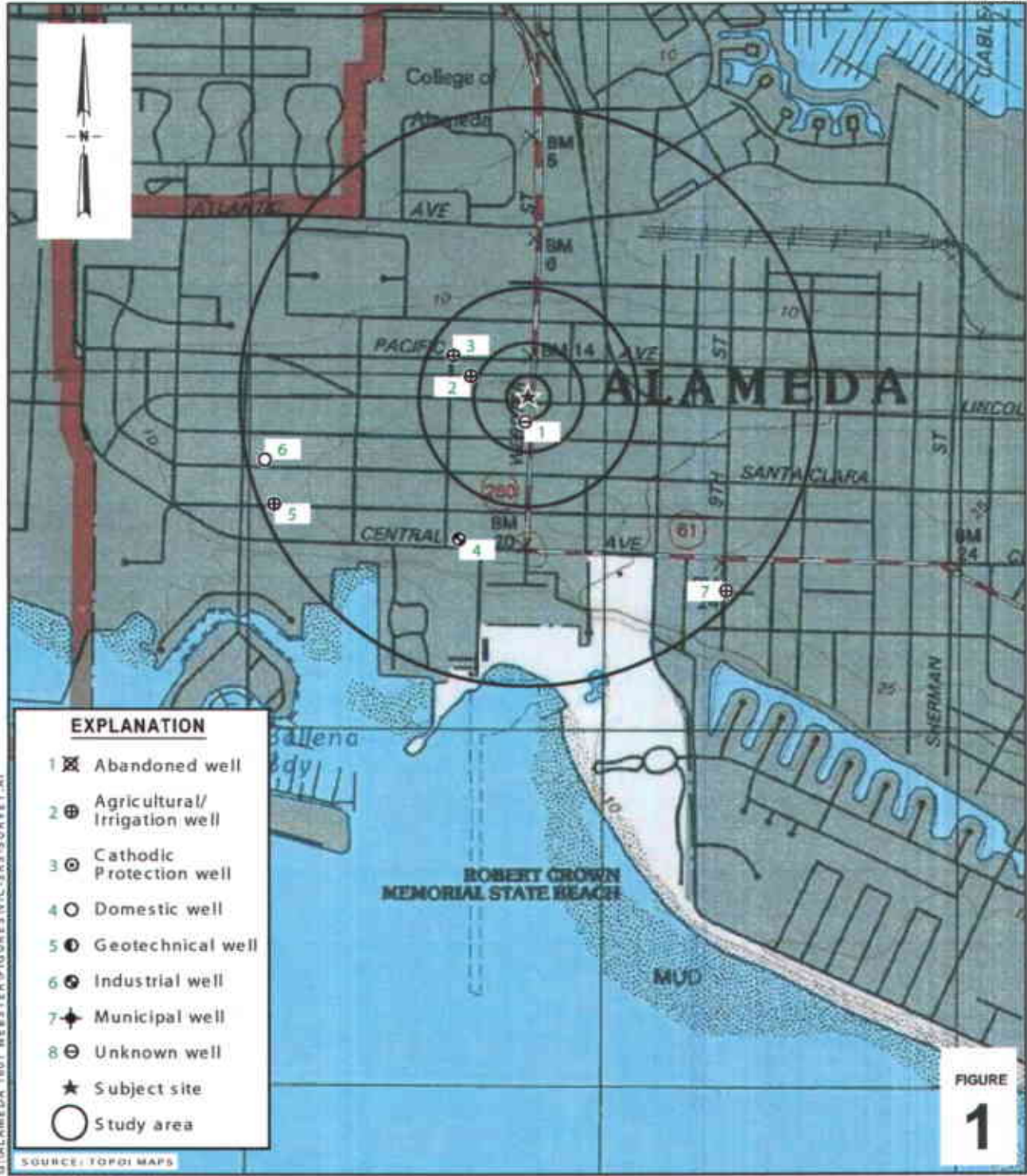

ALAMEDA 1601 WEBSTER FIGURES VIC-SRS-SURVEY-A1

- EXPLANATION**
- 1 ☒ Abandoned well
 - 2 ⊕ Agricultural/Irrigation well
 - 3 ⊕ Cathodic Protection well
 - 4 ○ Domestic well
 - 5 ⊕ Geotechnical well
 - 6 ⊕ Industrial well
 - 7 ⊕ Municipal well
 - 8 ⊕ Unknown well
 - ★ Subject site
 - Study area

FIGURE 1

0 1/8 1/4 1/2 1
SCALE : 1" = 1/4 MILE

Shell-branded Service Station

1601 Webster Street
Alameda, California
Incident #97437680



C A M B R I A

Vicinity/Sensitive Receptor Survey Map

(200, 500, and 1,000 Ft., and 1/2 Mile Radii)

G:\ALAMEDA\1601 WEBSTER\FIGURES\SITE PLAN 5-05.DWG

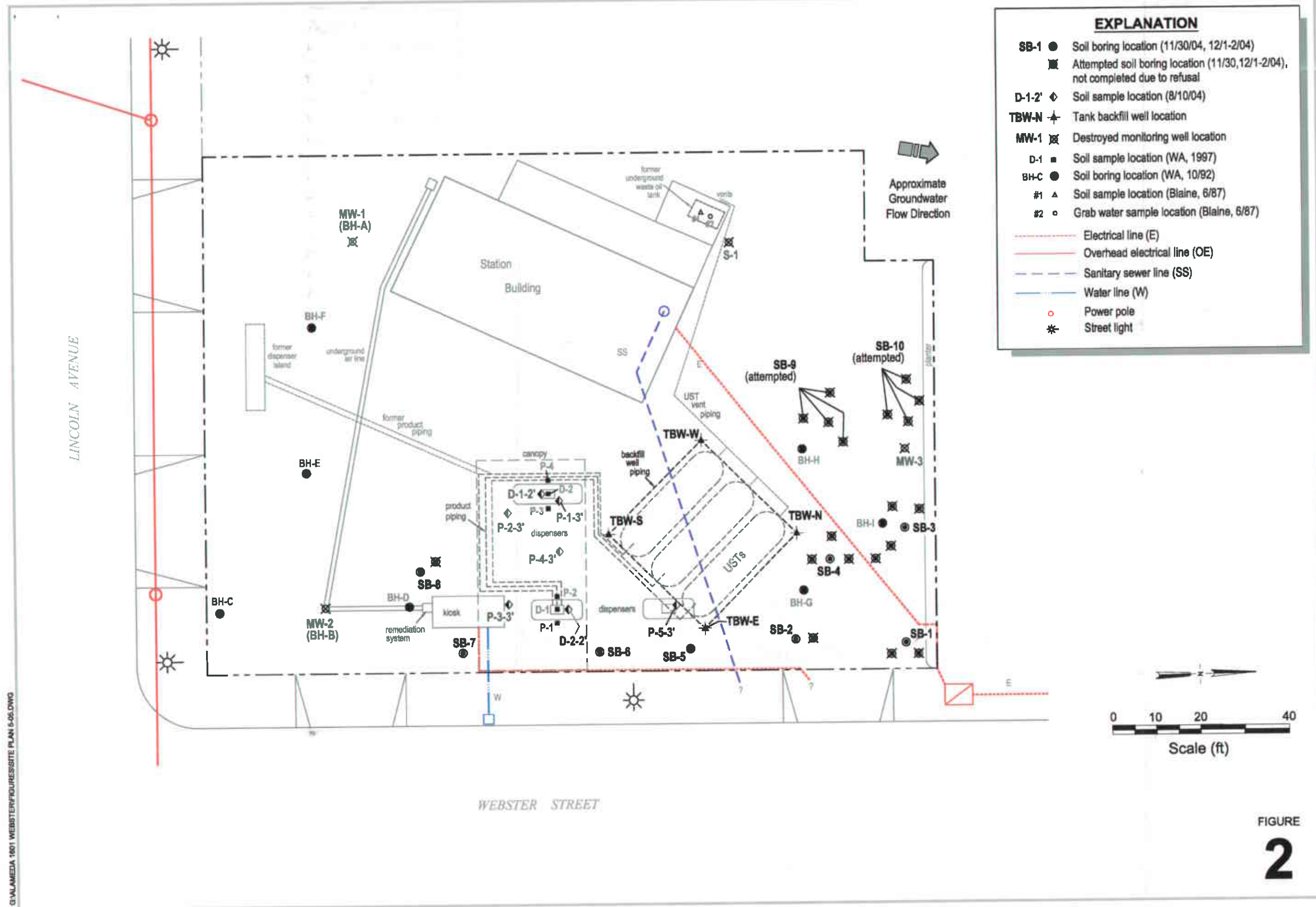

EXPLANATION

- SB-1 Soil boring location (11/30/04, 12/1-2/04)
- ⊠ Attempted soil boring location (11/30,12/1-2/04), not completed due to refusal
- ◆ D-1-2' Soil sample location (8/10/04)
- ⊕ TBW-N Tank backfill well location
- ⊠ MW-1 Destroyed monitoring well location
- D-1 Soil sample location (WA, 1997)
- BH-C Soil boring location (WA, 10/92)
- ▲ #1 Soil sample location (Blaine, 6/87)
- #2 Grab water sample location (Blaine, 6/87)
- Electrical line (E)
- Overhead electrical line (OE)
- Sanitary sewer line (SS)
- Water line (W)
- Power pole
- * Street light

Site Plan/Historical Sample Location Map



C A M B R I A

Shell-branded Service Station
1601 Webster Street
Alameda, California
Incident No.97564701

FIGURE
2

Figure 3 - Shell 1601 Webster St, Alameda
Groundwater Pumping Volume, SPH Thickness,
and TPH Concentration

CAMBRIA

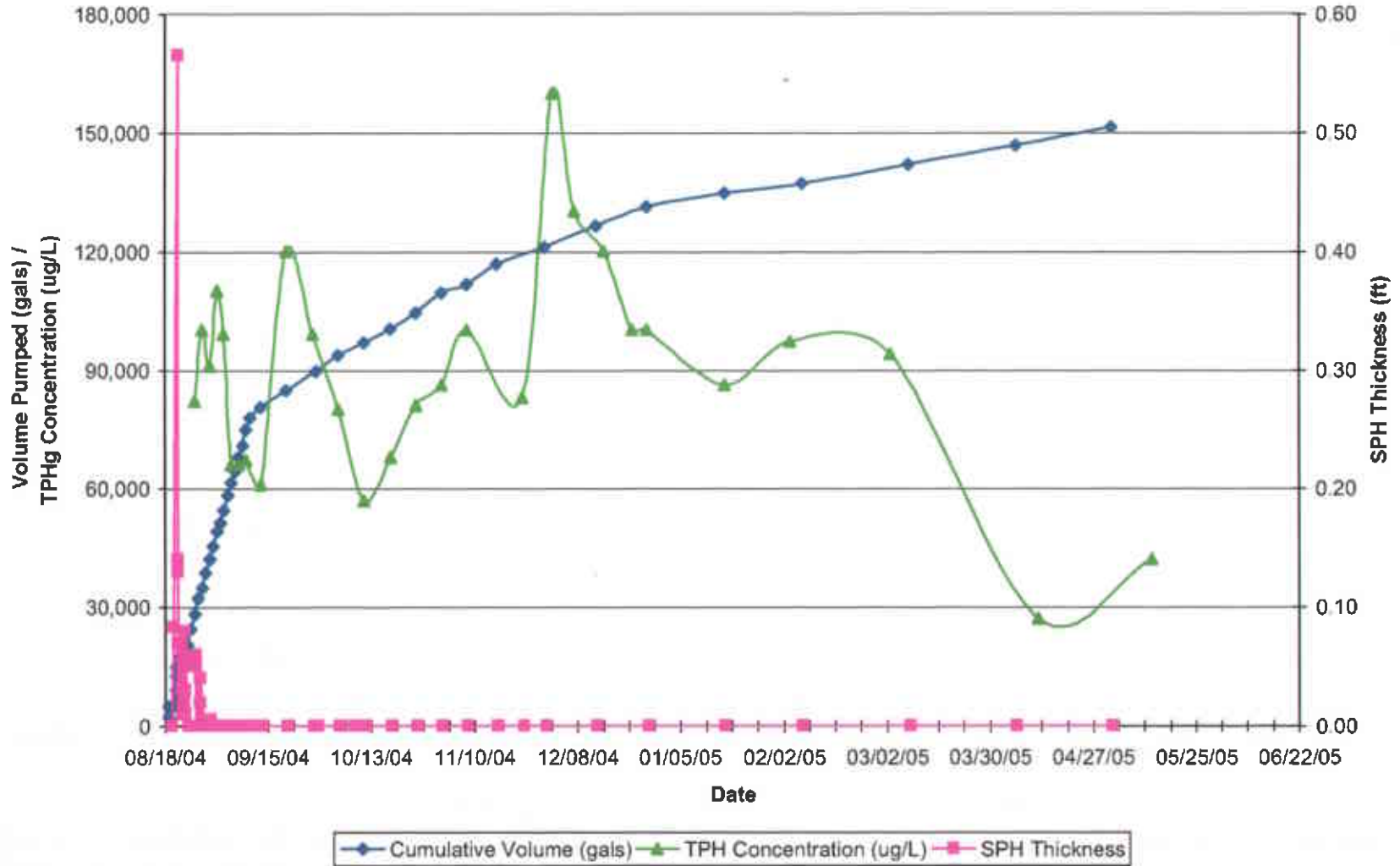

Figure 4 - Shell 1601 Webster St, Alameda
Groundwater Pumping Volume,
and Benzene Concentration

CAMBRIA

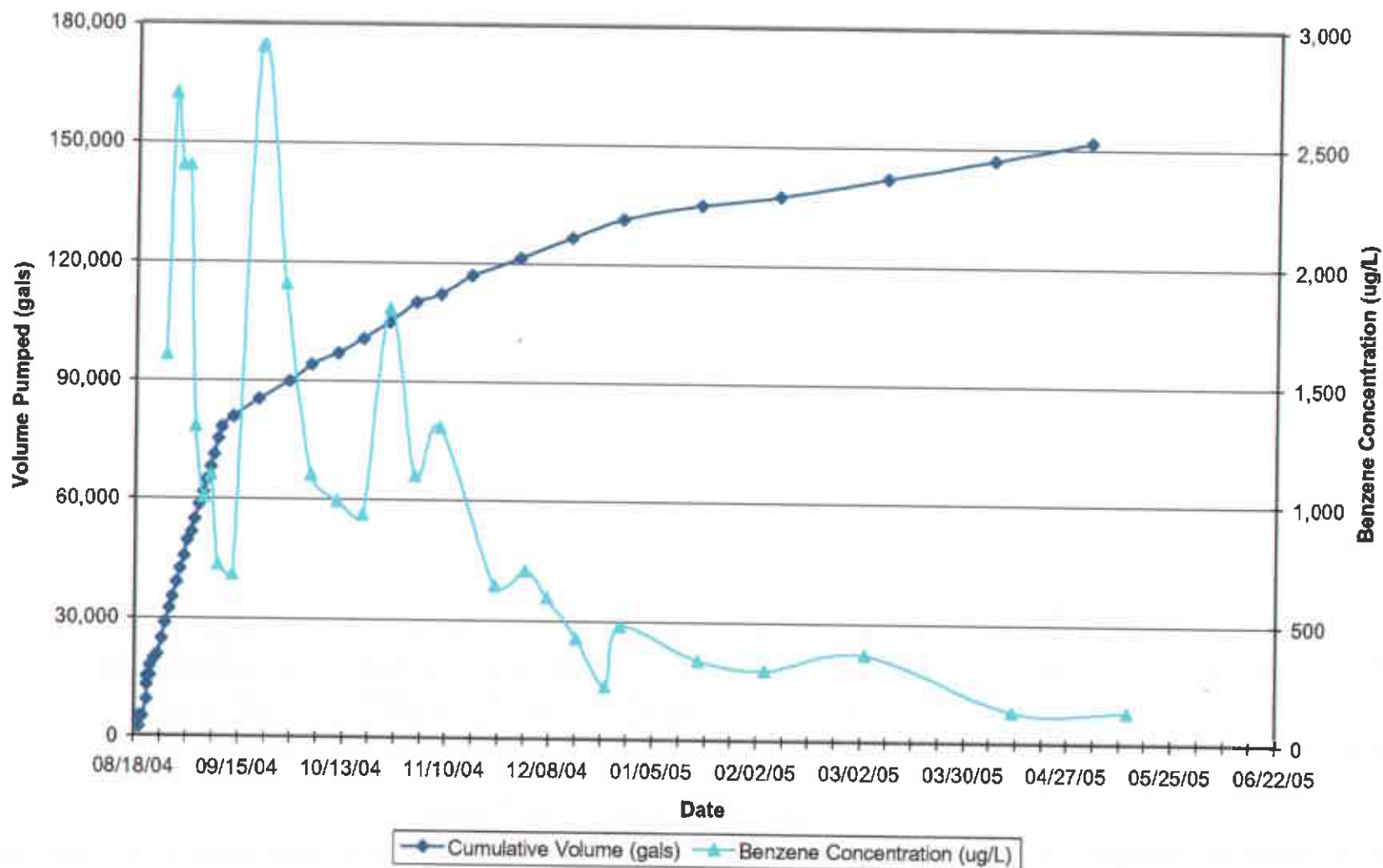
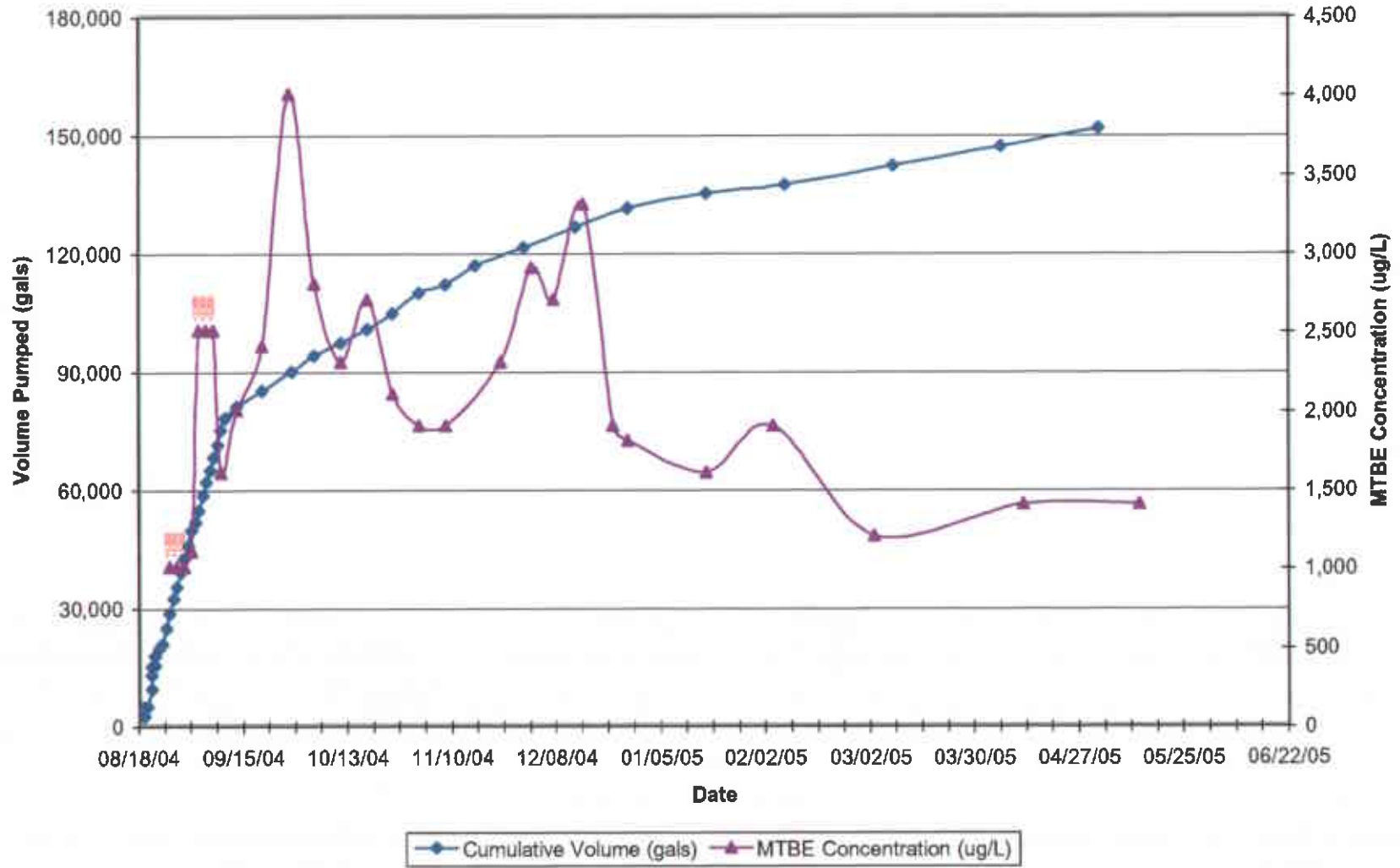

Figure 5 - Shell 1601 Webster St, Alameda
Groundwater Pumping Volume,
and MTBE Concentration

CAMBRIA



Appendix A

**Blaine Tech Services, Inc.
Groundwater Monitoring Report**

BLAINE
TECH SERVICES INC.

GROUNDWATER SAMPLING SPECIALISTS
SINCE 1985

June 8, 2005

Denis Brown
Shell Oil Products US
20945 South Wilmington Avenue
Carson, CA 90810

Second Quarter 2005 Groundwater Monitoring at
Shell-branded Service Station
1601 Webster Street
Alameda, CA

Monitoring performed on April 12 and May 13, 2005

Groundwater Monitoring Report 050513-MT-2

This report covers the routine monitoring of groundwater wells at this Shell-branded facility. In accordance with standard procedures that conform to Regional Water Quality Control Board requirements, routine field data collection includes depth to water, total well depth, thickness of any separate immiscible layer, water column volume, calculated purge volume (if applicable), elapsed evacuation time (if applicable), total volume of water removed (if applicable), and standard water parameter instrument readings. Sample material is collected, contained, stored, and transported to the laboratory in conformance with EPA standards. Purgewater (if applicable) is, likewise, collected and transported to the Martinez Refining Company.

Basic field information is presented alongside analytical values excerpted from the laboratory report in the cumulative table of **WELL CONCENTRATIONS**. The full analytical report for the most recent samples and the field data sheets are attached to this report.

At a minimum, Blaine Tech Services, Inc. field personnel are certified on completion of a forty-hour Hazardous Materials and Emergency Response training course per 29 CFR 1910.120. Field personnel are also enrolled in annual eight-hour refresher courses.

SAN JOSE

1680 ROGERS AVENUE

SAN JOSE, CA 95112-1106

SACRAMENTO

(408) 573-0885

LOS ANGELES

FAX (408) 573-7771

LIC. 746684

SAN DIEGO

www.blainetech.com

Blaine Tech Services, Inc. conducts sampling and documentation assignments of this type as an independent third party. Our activities at this site consisted of objective data and sample collection only. No interpretation of analytical results, defining of hydrological conditions or formulation of recommendations was performed.

Please call if you have any questions.

Yours truly,

Leon Gearhart
Project Coordinator

LG/ks

attachments: Cumulative Table of WELL CONCENTRATIONS
Certified Analytical Report
Field Data Sheets

cc: Ana Friel
Cambria Environmental Technology, Inc.
P.O. Box 259
Sonoma, CA 95476-0259

WELL CONCENTRATIONS
Shell Service Station
1601 Webster Street
Alameda, CA

Well ID	Date	TPPH (ug/L)	B (ug/L)	T (ug/L)	E (ug/L)	X (ug/L)	MTBE 8260 (ug/L)	DIPE (ug/L)	ETBE (ug/L)	TAME (ug/L)	TBA (ug/L)	Ethanol (ug/L)	1,2-DCA (ug/L)	EDB (ug/L)	TOC (MSL)	Depth to Water (ft.)	GW Elevation (MSL)
---------	------	----------------	-------------	-------------	-------------	-------------	------------------------	----------------	----------------	----------------	---------------	-------------------	-------------------	---------------	--------------	----------------------------	--------------------------

TBW-E	11/23/2004	NA	NA	NA	NA	NA	NA	NA	NA	NA	NA	NA	NA	NA	NA	6.31	NA
TBW-E	12/01/2004	NA	NA	NA	NA	NA	NA	NA	NA	NA	NA	NA	NA	NA	NA	7.01	NA
TBW-E	12/07/2004	NA	NA	NA	NA	NA	NA	NA	NA	NA	NA	NA	NA	NA	NA	6.32	NA
TBW-E	12/15/2004	NA	NA	NA	NA	NA	NA	NA	NA	NA	NA	NA	NA	NA	NA	6.55	NA
TBW-E	12/23/2004	NA	NA	NA	NA	NA	NA	NA	NA	NA	NA	NA	NA	NA	NA	5.95	NA
TBW-E	12/27/2004	NA	NA	NA	NA	NA	NA	NA	NA	NA	NA	NA	NA	NA	NA	8.47	NA

TBW-N	11/23/2004	83,000	640	27,000	1,700	20,000	2,300	<400	<400	<400	1,300	<10,000	<100	<100	NA	5.64	NA
TBW-N	12/01/2004	160,000	700	31,000	2,300	24,000	2,900	<400	<400	<400	1,200	<10,000	<100	<100	NA	6.35	NA
TBW-N	12/07/2004	130,000	590	29,000	2,300	24,000	2,700	<400	<400	<400	1,300	<10,000	<100	<100	NA	5.65	NA
TBW-N	12/15/2004	120,000	420	26,000	2,000	22,000	3,300	<400	<400	<400	<1,000	<10,000	<100	<100	NA	5.85	NA
TBW-N	12/23/2004	100,000	220	23,000	1,900	20,000	1,900	<400	<400	<400	<1,000	<10,000	<100	<100	NA	5.30	NA
TBW-N	12/27/2004	110,000	470	26,000	2,300	22,000	1,800	<400	<400	<400	<1,000	<10,000	<100	<100	NA	7.80	NA
TBW-N	01/17/2005	86,000	330	22,000	2,200	21,000	1,600	<400	<400	<400	1,600	<10,000	<100	<100	NA	6.59	NA
TBW-N	02/04/2005	97,000	290	23,000	1,800	20,000	1,900	<400	<400	<400	<1,000	<10,000	<100	<100	NA	4.50	NA
TBW-N	03/02/2005	94,000	360	24,000	2,000	19,000	1,200	<400	<400	<400	<1,000	<10,000	<100	<100	NA	4.11	NA
TBW-N	04/12/2005	27,000	130	9,300	1,100	8,700	1,400	<100	<100	<20	390	<2,500	<25	<25	NA	4.08	NA
TBW-N	05/13/2005	42,000	130	8,700	1,500	12,000	1,400	<100	<100	<100	440	<2,500	<25	<25	NA	4.45	NA

TBW-S	11/23/2004	NA	NA	NA	NA	NA	NA	NA	NA	NA	NA	NA	NA	NA	NA	6.18	NA
TBW-S	12/01/2004	NA	NA	NA	NA	NA	NA	NA	NA	NA	NA	NA	NA	NA	NA	6.87	NA
TBW-S	12/07/2004	NA	NA	NA	NA	NA	NA	NA	NA	NA	NA	NA	NA	NA	NA	6.15	NA
TBW-S	12/15/2004	NA	NA	NA	NA	NA	NA	NA	NA	NA	NA	NA	NA	NA	NA	6.38	NA
TBW-S	12/23/2004	NA	NA	NA	NA	NA	NA	NA	NA	NA	NA	NA	NA	NA	NA	5.81	NA
TBW-S	12/27/2004	NA	NA	NA	NA	NA	NA	NA	NA	NA	NA	NA	NA	NA	NA	8.35	NA

TBW-W	11/23/2004	NA	NA	NA	NA	NA	NA	NA	NA	NA	NA	NA	NA	NA	NA	6.14	NA
TBW-W	12/01/2004	NA	NA	NA	NA	NA	NA	NA	NA	NA	NA	NA	NA	NA	NA	6.86	NA

WELL CONCENTRATIONS
Shell Service Station
1601 Webster Street
Alameda, CA

Well ID	Date	TPPH (ug/L)	B (ug/L)	T (ug/L)	E (ug/L)	X (ug/L)	MTBE 8260 (ug/L)	DIPE (ug/L)	ETBE (ug/L)	TAME (ug/L)	TBA (ug/L)	Ethanol (ug/L)	1,2-DCA (ug/L)	EDB (ug/L)	TOC (MSL)	Depth to Water (ft.)	GW Elevation (MSL)
TBW-W	12/07/2004	NA	NA	NA	NA	NA	NA	NA	NA	NA	NA	NA	NA	NA	NA	6.13	NA
TBW-W	12/15/2004	NA	NA	NA	NA	NA	NA	NA	NA	NA	NA	NA	NA	NA	NA	6.37	NA
TBW-W	12/23/2004	NA	NA	NA	NA	NA	NA	NA	NA	NA	NA	NA	NA	NA	NA	5.79	NA
TBW-W	12/27/2004	NA	NA	NA	NA	NA	NA	NA	NA	NA	NA	NA	NA	NA	NA	8.32	NA

Abbreviations:

TPPH = Total petroleum hydrocarbons as gasoline by modified EPA Method 8260B.

BTEX = Benzene, toluene, ethylbenzene, xylenes by EPA Method 8260B.

MTBE = Methyl tertiary butyl ether

DIPE = Di-isopropyl ether, analyzed by EPA Method 8260B

ETBE = Ethyl tertiary butyl ether, analyzed by EPA Method 8260B

TAME = Tertiary amyl methyl ether, analyzed by EPA Method 8260B

TBA = Tertiary butyl alcohol or tertiary butanol, analyzed by EPA Method 8260B

1,2-DCA = 1,2-Dichloroethane, analyzed by EPA Method 8260B

EDB = Ethylene Dibromide, analyzed by EPA Method 8260B

TOC = Top of Casing Elevation

GW = Groundwater

ug/L = Parts per billion

MSL = Mean sea level

ft. = Feet

<n = Below detection limit

NA = Not applicable

Notes:

Ethanol analyzed by EPA Method 8260B.

Blaine Tech Services, Inc.

April 29, 2005

1680 Rogers Avenue
San Jose, CA 95112-1105
Attn.: Leon Gearhart
Project#: 050412-SS3
Project: 97564701
Site: 1601 Webster St., Alameda

Dear Mr. Gearhart,

Attached is our report for your samples received on 04/13/2005 14:23

This report has been reviewed and approved for release. Reproduction of this report is permitted only in its entirety.

Please note that any unused portion of the samples will be discarded after 05/28/2005 unless you have requested otherwise.

We appreciate the opportunity to be of service to you. If you have any questions,

You can also contact me via email. My email address is: mbrewer@stl-inc.com

Sincerely,

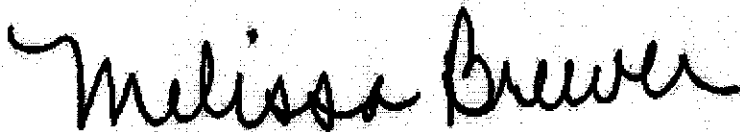

Melissa Brewer
Project Manager

Gas/BTEX Fuel Oxygenates by 8260B (C6-C12)

Blaine Tech Services, Inc.

Attn.: Leon Gearhart

1680 Rogers Avenue

San Jose, CA 95112-1105

Phone: (408) 573-0555 Fax: (408) 573-7771

Project: 050412-SS3

97564701

Received: 04/13/2005 14:23

Site: 1601 Webster St., Alameda

Samples Reported

Sample Name	Date Sampled	Matrix	Lab #
TBW-N	04/12/2005 14:05	Water	1

Gas/BTEX Fuel Oxygenates by 8260B (C6-C12)

Blaine Tech Services, Inc.

Attn.: Leon Gearhart

1680 Rogers Avenue
San Jose, CA 95112-1105
Phone: (408) 573-0555 Fax: (408) 573-7771

Project: 050412-SS3
97564701

Received: 04/13/2005 14:23

Site: 1601 Webster St., Alameda

Prep(s):	5030B	Inst(s):	8260B
Sample ID:	TBW-N	Lab ID:	2005-04-0406
Sampled:	04/12/2005 14:05	Extracted:	04/26/2005 20:54 04/26/2005 17:47
Matrix:	Water	QC Batch#:	2005/04/26-2A-59 2005/04/26-2B-58
Analysis Flag: L2, pH: <2 (See Legend and Note Section)			

Compound	Conc.	RL	Unit	Dilution	Analyzed	Flag
Gasoline [Shell]	27000	500	ug/L	10.00	04/26/2005 17:47	
Benzene	130	25	ug/L	50.00	04/26/2005 20:54	
Toluene	9300	25	ug/L	50.00	04/26/2005 20:54	
Ethylbenzene	1100	25	ug/L	50.00	04/26/2005 20:54	
Total xylenes	8700	50	ug/L	50.00	04/26/2005 20:54	
tert-Butyl alcohol (TBA)	390	250	ug/L	50.00	04/26/2005 20:54	
Methyl tert-butyl ether (MTBE)	1400	25	ug/L	50.00	04/26/2005 20:54	
Di-isopropyl Ether (DIPE)	ND	100	ug/L	50.00	04/26/2005 20:54	
Ethyl tert-butyl ether (ETBE)	ND	100	ug/L	50.00	04/26/2005 20:54	
tert-Amyl methyl ether (TAME)	ND	20	ug/L	10.00	04/26/2005 17:47	
1,2-DCA	ND	25	ug/L	50.00	04/26/2005 20:54	
EDB	ND	25	ug/L	50.00	04/26/2005 20:54	
Ethanol	ND	2500	ug/L	50.00	04/26/2005 20:54	
Surrogate(s)						
1,2-Dichloroethane-d4	99.3	73-130	%	10.00	04/26/2005 17:47	
1,2-Dichloroethane-d4	102.9	73-130	%	50.00	04/26/2005 20:54	
Toluene-d8	114.2	81-114	%	50.00	04/26/2005 20:54	S7
Toluene-d8	102.2	81-114	%	10.00	04/26/2005 17:47	

Gas/BTEX Fuel Oxygenates by 8260B (C6-C12)

Blaine Tech Services, Inc.

Attn.: Leon Gearhart

1680 Rogers Avenue

San Jose, CA 95112-1105

Phone: (408) 573-0555 Fax: (408) 573-7771

Project: 050412-SS3
97564701

Received: 04/13/2005 14:23

Site: 1601 Webster St., Alameda

Batch QC Report			
Prep(S): 8030B	Water	Test(S): 8260B	
Method: Blank		QC Batch #: 2005/04/26-2A169	
MB: 2005/04/26-2A169-045		Date Extracted: 04/26/2005 17:45	

Compound	Conc.	RL	Unit	Analyzed	Flag
Gasoline [Shell]	ND	50	ug/L	04/26/2005 17:45	
tert-Butyl alcohol (TBA)	ND	5.0	ug/L	04/26/2005 17:45	
Methyl tert-butyl ether (MTBE)	ND	0.5	ug/L	04/26/2005 17:45	
Di-isopropyl Ether (DIPE)	ND	2.0	ug/L	04/26/2005 17:45	
Ethyl tert-butyl ether (ETBE)	ND	2.0	ug/L	04/26/2005 17:45	
tert-Amyl methyl ether (TAME)	ND	2.0	ug/L	04/26/2005 17:45	
1,2-DCA	ND	0.5	ug/L	04/26/2005 17:45	
EDB	ND	0.5	ug/L	04/26/2005 17:45	
Benzene	ND	0.5	ug/L	04/26/2005 17:45	
Toluene	ND	0.5	ug/L	04/26/2005 17:45	
Ethylbenzene	ND	0.5	ug/L	04/26/2005 17:45	
Total xylenes	ND	1.0	ug/L	04/26/2005 17:45	
Ethanol	ND	50	ug/L	04/26/2005 17:45	
Surrogates(s)					
1,2-Dichloroethane-d4	109.0	73-130	%	04/26/2005 17:45	
Toluene-d8	113.6	81-114	%	04/26/2005 17:45	

Gas/BTEX Fuel Oxygenates by 8260B (C6-C12)

Blaine Tech Services, Inc.
Attn.: Leon Gearhart

1680 Rogers Avenue
San Jose, CA 95112-1105
Phone: (408) 573-0555 Fax: (408) 573-7771

Project: 050412-SS3
97564701

Received: 04/13/2005 14:23

Site: 1601 Webster St., Alameda

Batch QC Report			
Prep(s): 50305			Test(s): 8260B
Method: Blank	Water		QC Batch #: 2005/04/26-2C-68
MB: 2005/04/26-2C-68-009			Date Expired: 04/26/2005 17:09

Compound	Conc.	RL	Unit	Analyzed	Flag
Gasoline [Shell]	ND	50	ug/L	04/26/2005 17:09	
tert-Butyl alcohol (TBA)	ND	5.0	ug/L	04/26/2005 17:09	
Methyl tert-butyl ether (MTBE)	ND	0.5	ug/L	04/26/2005 17:09	
Di-isopropyl Ether (DIPE)	ND	2.0	ug/L	04/26/2005 17:09	
Ethyl tert-butyl ether (ETBE)	ND	2.0	ug/L	04/26/2005 17:09	
tert-Amyl methyl ether (TAME)	ND	2.0	ug/L	04/26/2005 17:09	
1,2-DCA	ND	0.5	ug/L	04/26/2005 17:09	
EDB	ND	0.5	ug/L	04/26/2005 17:09	
Benzene	ND	0.5	ug/L	04/26/2005 17:09	
Toluene	ND	0.5	ug/L	04/26/2005 17:09	
Ethylbenzene	ND	0.5	ug/L	04/26/2005 17:09	
Total xylenes	ND	1.0	ug/L	04/26/2005 17:09	
Ethanol	ND	50	ug/L	04/26/2005 17:09	
Surrogates(s)					
1,2-Dichloroethane-d4	98.6	73-130	%	04/26/2005 17:09	
Toluene-d8	95.6	81-114	%	04/26/2005 17:09	

Gas/BTEX Fuel Oxygenates by 8260B (C6-C12)

Blaine Tech Services, Inc.

Attn.: Leon Gearhart

1680 Rogers Avenue

San Jose, CA 95112-1105

Phone: (408) 573-0555 Fax: (408) 573-7771

Project: 050412-SS3
97564701

Received: 04/13/2005 14:23

Site: 1601 Webster St., Alameda

Batch QC Report			
Prep(s): 5030B			QC Batch # 2005/04/26-2A-69
Laboratory Control Spike	Water		QC Batch # 2005/04/26-2A-69
LCS: 2005/04/26-2A-69-024	Extracted: 04/26/2005		Analyzed: 04/26/2005 17:24
LCSD			

Compound	Conc. ug/L		Exp.Conc.	Recovery %		RPD %	Ctrl.Limits %		Flags	
	LCS	LCSD		LCS	LCSD		Rec.	RPD	LCS	LCSD
Methyl tert-butyl ether (MTBE)	28.0		25	112.0			65-165	20		
Benzene	26.9		25	107.6			69-129	20		
Toluene	29.5		25	118.0			70-130	20		
Surrogates(s)										
1,2-Dichloroethane-d4	548		500	109.6			73-130			
Toluene-d8	532		500	106.4			81-114			

Gas/BTEX Fuel Oxygenates by 8260B (C6-C12)

Blaine Tech Services, Inc.
Attn.: Leon Gearhart

1680 Rogers Avenue
San Jose, CA 95112-1105
Phone: (408) 573-0555 Fax: (408) 573-7771

Project: 050412-SS3
97564701

Received: 04/13/2005 14:23

Site: 1601 Webster St., Alameda

Batch QC Report			
Prep(s): 6030B			Test(s): 8260B
Laboratory Control Spike	Water		QC Batch #: 2005/04/26-2C-68
LCS: 2005/04/26-2C-68-051	Extracted: 04/26/2005		Analyzed: 04/26/2005 16:51
LCSD			

Compound	Conc. ug/L		Exp. Conc.	Recovery %		RPD	Ctrl. Limits %		Flags	
	LCS	LCSD		LCS	LCSD		%	Rec.	RPD	LCS
Methyl tert-butyl ether (MTBE)	20.6		25	82.4			65-165	20		
Benzene	20.5		25	82.0			69-129	20		
Toluene	22.7		25	90.8			70-130	20		
Surrogates(s)										
1,2-Dichloroethane-d4	447		500	89.4			73-130			
Toluene-d8	490		500	98.0			81-114			

Severn Trent Laboratories, Inc.

STL San Francisco * 1220 Quarry Lane, Pleasanton, CA 94566

Tel 925 484 1919 Fax 925 484 1096 * www.stl-inc.com * CA DHS ELAP# 2496

04/29/2005 15:53

Page 6 of 9

Gas/BTEX Fuel Oxygenates by 8260B (C6-C12)

Blaine Tech Services, Inc.

Attn.: Leon Gearhart

1680 Rogers Avenue
San Jose, CA 95112-1105
Phone: (408) 573-0555 Fax: (408) 573-7771

Project: 050412-SS3
97564701

Received: 04/13/2005 14:23

Site: 1601 Webster St., Alameda

Batch QC Report			
Project	5030B	Test(s)	8260B
Matrix Spike (MS/MSD)		Water	QC Batch # 2005/04/26-2A-69
MS/MSD		Batch ID	2005/04/0424-003
MS	2005/04/26-2A-69-03	Extracted	04/26/2005
MSD	2005/04/26-2A-69-053	Extracted	04/26/2005
		Analyzed	04/26/2005 21:43
		Dilution	1.00
		Analyzed	04/26/2005 22:53
		Dilution	1.00

Compound	Conc. ug/L			Spk.Level ug/L	Recovery %			Limits %		Flags	
	MS	MSD	Sample		MS	MSD	RPD	Rec.	RPD	MS	MSD
Methyl tert-butyl ether	27.9	23.7	ND	25	111.6	94.8	16.3	65-165	20		
Benzene	26.7	27.9	ND	25	106.8	111.6	4.4	69-129	20		
Toluene	30.3	30.6	ND	25	121.2	122.4	1.0	70-130	20		
Surrogate(s)											
1,2-Dichloroethane-d4	491	446		500	98.2	89.2		73-130			
Toluene-d8	543	551		500	108.6	110.2		81-114			

Gas/BTEX Fuel Oxygenates by 8260B (C6-C12)

Blaine Tech Services, Inc.

Attn.: Leon Gearhart

1680 Rogers Avenue

San Jose, CA 95112-1105

Phone: (408) 573-0555 Fax: (408) 573-7771

Project: 050412-SS3

97564701

Received: 04/13/2005 14:23

Site: 1601 Webster St., Alameda

Batch QC Report			
Predictor	5030B		741(s) 8260B
Matrix Spike (MS / MSD)		Water	QC Batch # 2005/04/26-2G 68
MS/MSD			Lab ID: 2005-04-0504-004
MS	2005/04/26-2G 68-048	Extracted: 04/26/2005	Analyzed: 04/26/2005 20:48
			Dilution: 1.00
MSD	2005/04/26-2G 68-006	Extracted: 04/26/2005	Analyzed: 04/26/2005 21:06
			Dilution: 1.00

Compound	Conc. ug/L			Spk.Level	Recovery %			Limits %		Flags	
	MS	MSD	Sample		ug/L	MS	MSD	RPD	Rec.	RPD	MS
Methyl tert-butyl ether	22.4	24.2	ND	25	89.6	96.8	7.7	65-165	20		
Benzene	22.8	23.2	ND	25	91.2	92.8	1.7	69-129	20		
Toluene	25.3	25.2	ND	25	101.2	100.8	0.4	70-130	20		
Surrogate(s)											
1,2-Dichloroethane-d4	477	500		500	95.4	100.0		73-130			
Toluene-d8	504	500		500	100.8	100.0		81-114			

Severn Trent Laboratories, Inc.

STL San Francisco * 1220 Quarry Lane, Pleasanton, CA 94566

Tel 925 484 1919 Fax 925 484 1096 * www.stl-inc.com * CA DHS ELAP# 2496

04/29/2005 15:53

Gas/BTEX Fuel Oxygenates by 8260B (C6-C12)

Blaine Tech Services, Inc.

Attn.: Leon Gearhart

1680 Rogers Avenue

San Jose, CA 95112-1105

Phone: (408) 573-0555 Fax: (408) 573-7771

Project: 050412-SS3
97564701

Received: 04/13/2005 14:23

Site: 1601 Webster St., Alameda

Legend and Notes

Analysis Flag

L2

Reporting limits were raised due to high level of analyte present in the sample.

Result Flag

S7

Surrogate recoveries higher than acceptance limits.

LAB: STL

SHELL Chain Of Custody Record

114172

Lab Identification (if necessary):

Address:

City, State, Zip:

Shell Project Manager to be involved:

- SCIENCE & ENGINEERING
- TECHNICAL SERVICES
- O&E HOLDING

Denis Brown

2005-04-0406

INCIDENT NUMBER (SEE CNL 11)

9 7 5 6 4 7 0 1

SAMPLE CREDIT NUMBER (TSICRMT)

DATE: 4/12/05

PAGE: 1 of 1

SAMPLING COMPANY: Blaine Tech Services		LOF CODE: BTSS	SITE ADDRESS (Street and City): 1601 Webster St., Alameda		GLOBAL ID NO.: T0600137103
ADDRESS: 1600 Rogers Avenue, San Jose, CA 95112		SERV DELIVERABLE TO (Responsible Party or Designer): Anni Kraml		PHONE NO.: (510) 420-3335	EMAIL: ShellOaldandEDF@comtribs-env.com
PROJECT CONTACT (Principal or PO): Leon Gearhart		CONSULTANT PROJECT NO.: 050412-353		STB #:	
TELEPHONE: 408-573-8566	FAX: 408-573-7771	EMAIL: lgearhart@blainetech.com		LAB USE ONLY	

SAAMPLER NAME(S) (P/N):
Suehan Sung

TURNAROUND TIME (BUSINESS DAYS):
 10 DAYS 5 DAYS 72 HOURS 48 HOURS 24 HOURS LESS THAN 24 HOURS

LA - RWQCB REPORT FORMAT UST AGENCY:

GCMS MTBE CONFIRMATION: HIGHEST _____ HIGHEST per BORING _____ ALL _____

SPECIAL INSTRUCTIONS OR NOTES: CHECK BOX IF BDD IS NOT NEEDED:

REQUESTED ANALYSIS										FIELD NOTES: Container/Preservative or PID Readings or Laboratory Notes
TPH - Gas, Purgeable	BTEX	MTBE (20218 - 5ppb RL)	MIBK (22808 - 0.5ppb RL)	Oxygenates (A) by (22808)	Ethanol (22808)	Methanol	1,2-DCA (22808)	EDS (22808)	TEMPERATURE ON RECEIPT OF	
									3	

LAB USE ONLY	Field Sample Identification				SAMPLING		MATRIX	NO. OF BOTT.	TPH - Gas, Purgeable	BTEX	MTBE (20218 - 5ppb RL)	MIBK (22808 - 0.5ppb RL)	Oxygenates (A) by (22808)	Ethanol (22808)	Methanol	1,2-DCA (22808)	EDS (22808)	
	DATE	TIME	DATE	TIME														
	T3W-N			4/12/05	1405	GN	3	X	X				X	X			X	X

Relinquished by: (Signature) <i>[Signature]</i>	Received by: (Signature) <i>[Signature]</i>	Date: <u>4/13/05</u>	Time: <u>1736</u>
Relinquished by: (Signature) <i>[Signature]</i>	Received by: (Signature) <i>[Signature]</i>	Date: <u>4/13/05</u>	Time: <u>1736</u>
Relinquished by: (Signature)	Received by: (Signature)	Date:	Time:

FORM 17-10-2005-0722

Blaine Tech Services, Inc.

May 24, 2005

1680 Rogers Avenue
San Jose, CA 95112-1105
Attn.: Leon Gearhart
Project#: BTS#050513-MT2
Project: 97564701
Site: 1601 Webster St., Alameda

Dear Mr. Gearhart,

Attached is our report for your samples received on 05/13/2005 15:25.

This report has been reviewed and approved for release. Reproduction of this report is permitted only in its entirety.

Please note that any unused portion of the samples will be discarded after 06/27/2005 unless you have requested otherwise.

We appreciate the opportunity to be of service to you. If you have any questions,

You can also contact me via email. My email address is: mbrewer@stl-inc.com

Sincerely,



Melissa Brewer
Project Manager

Gas/BTEX Fuel Oxygenates by 8260B (C6-C12)

Blaine Tech Services, Inc.

Attn.: Leon Gearhart

1680 Rogers Avenue
San Jose, CA 95112-1105
Phone: (408) 573-0555 Fax: (408) 573-7771

Project: BTS#050513-MT2
97564701

Received: 05/13/2005 15:25

Site: 1601 Webster St., Alameda

Samples Reported

Sample Name	Date Sampled	Matrix	Lab #
TBW-N	05/13/2005 13:10	Water	1

Gas/BTEX Fuel Oxygenates by 8260B (C6-C12)

Blaine Tech Services, Inc.

Attn.: Leon Gearhart

1680 Rogers Avenue
San Jose, CA 95112-1105
Phone: (408) 573-0555 Fax: (408) 573-7771

Project: BTS#050513-MT2
97564701

Received: 05/13/2005 15:25

Site: 1601 Webster St., Alameda

Prep(s): 8260B	Test(s): 8260B
Sample ID: TBW-N	Lab ID: 2005-05-0456
Sampled: 05/13/2005 13:10	Extracted: 5/21/2005 04:20
Matrix: Water	QC Batch#: 2005/05/20/2A/62
Analysis Flag: L2 (See Legend and Note Section)	

Compound	Conc.	RL	Unit	Dilution	Analyzed	Flag
Gasoline [Shell]	42000	2500	ug/L	50.00	05/21/2005 04:20	
Benzene	130	25	ug/L	50.00	05/21/2005 04:20	
Toluene	8700	25	ug/L	50.00	05/21/2005 04:20	
Ethylbenzene	1500	25	ug/L	50.00	05/21/2005 04:20	
Total xylenes	12000	50	ug/L	50.00	05/21/2005 04:20	
tert-Butyl alcohol (TBA)	440	250	ug/L	50.00	05/21/2005 04:20	
Methyl tert-butyl ether (MTBE)	1400	25	ug/L	50.00	05/21/2005 04:20	
Di-isopropyl Ether (DIPE)	ND	100	ug/L	50.00	05/21/2005 04:20	
Ethyl tert-butyl ether (ETBE)	ND	100	ug/L	50.00	05/21/2005 04:20	
tert-Amyl methyl ether (TAME)	ND	100	ug/L	50.00	05/21/2005 04:20	
1,2-DCA	ND	25	ug/L	50.00	05/21/2005 04:20	
EDB	ND	25	ug/L	50.00	05/21/2005 04:20	
Ethanol	ND	2500	ug/L	50.00	05/21/2005 04:20	
Surrogate(s)						
1,2-Dichloroethane-d4	112.9	73-130	%	50.00	05/21/2005 04:20	
Toluene-d8	103.1	81-114	%	50.00	05/21/2005 04:20	

Gas/BTEX Fuel Oxygenates by 8260B (C6-C12)

Blaine Tech Services, Inc.

Attn.: Leon Gearhart

1680 Rogers Avenue
San Jose, CA 95112-1105
Phone: (408) 573-0555 Fax: (408) 573-7771

Project: BTS#050513-MT2
97564701

Received: 05/13/2005 15:25

Site: 1601 Webster St., Alameda

Batch QC Report			
Prep(s): 5030B			Test(s): 8260B
Method: Blank		Water	QC Batch #: 2005/05/20-2A162
MB: 2005/05/20-2A162-042			Date Extracted: 05/20/2005 18:42

Compound	Conc.	RL	Unit	Analyzed	Flag
Gasoline [Shell]	ND	50	ug/L	05/20/2005 18:42	
tert-Butyl alcohol (TBA)	ND	5.0	ug/L	05/20/2005 18:42	
Methyl tert-butyl ether (MTBE)	ND	0.5	ug/L	05/20/2005 18:42	
Di-isopropyl Ether (DIPE)	ND	2.0	ug/L	05/20/2005 18:42	
Ethyl tert-butyl ether (ETBE)	ND	2.0	ug/L	05/20/2005 18:42	
tert-Amyl methyl ether (TAME)	ND	2.0	ug/L	05/20/2005 18:42	
1,2-DCA	ND	0.5	ug/L	05/20/2005 18:42	
EDB	ND	0.5	ug/L	05/20/2005 18:42	
Benzene	ND	0.5	ug/L	05/20/2005 18:42	
Toluene	ND	0.5	ug/L	05/20/2005 18:42	
Ethylbenzene	ND	0.5	ug/L	05/20/2005 18:42	
Total xylenes	ND	1.0	ug/L	05/20/2005 18:42	
Ethanol	ND	50	ug/L	05/20/2005 18:42	
Surrogates(s)					
1,2-Dichloroethane-d4	109.6	73-130	%	05/20/2005 18:42	
Toluene-d8	100.8	81-114	%	05/20/2005 18:42	

Gas/BTEX Fuel Oxygenates by 8260B (C6-C12)

Blaine Tech Services, Inc.

Attn.: Leon Gearhart

1680 Rogers Avenue
San Jose, CA 95112-1105
Phone: (408) 573-0555 Fax: (408) 573-7771

Project: BTS#050513-MT2
97564701

Received: 05/13/2005 15:25

Site: 1601 Webster St., Alameda

Batch QC Report			
Prep(s): 6030B			Test(s): 8260B
Laboratory Control Spike	Water		QC Batch #: 2005/05/20-2A.62
LCS: 2005/05/20-2A.62.016	Extracted: 05/20/2005		Analyzed: 05/20/2005 18:16
LCSD:			

Compound	Conc. ug/L		Exp.Conc.	Recovery %		RPD	Ctrl.Limits %		Flags	
	LCS	LCSD		LCS	LCSD		%	Rec.	RPD	LCS
Methyl tert-butyl ether (MTBE)	20.5		25	82.0			65-165	20		
Benzene	22.7		25	90.8			69-129	20		
Toluene	25.4		25	101.6			70-130	20		
Surrogates(s)										
1,2-Dichloroethane-d4	494		500	98.8			73-130			
Toluene-d8	522		500	104.4			81-114			

Severn Trent Laboratories, Inc.

STL San Francisco * 1220 Quarry Lane, Pleasanton, CA 94566

Tel 925 484 1919 Fax 925 484 1096 * www.stl-inc.com * CA DHS ELAP# 2496

05/23/2005 08:54

Gas/BTEX Fuel Oxygenates by 8260B (C6-C12)

Blaine Tech Services, Inc.

Attn.: Leon Gearhart

1680 Rogers Avenue
San Jose, CA 95112-1105
Phone: (408) 573-0555 Fax: (408) 573-7771

Project: BTS#050513-MT2
97564701

Received: 05/13/2005 15:25

Site: 1601 Webster St., Alameda

Batch QC Report			
Prep(s)	50305		Test(s) 8260B
Matrix Spike (MS / MSD)		Water	QC Batch # 2005/05/20-2A.62
MS/MSD			Lab ID: 2005-05-0456-008
MS: 2005/05/20-2A.62-057		Extracted: 05/20/2005	Analyzed: 05/20/2005 20:57
			Dilution: 1.00
MSD: 2005/05/20-2A.62-023		Extracted: 05/20/2005	Analyzed: 05/20/2005 21:23
			Dilution: 1.00

Compound	Conc. ug/L			Spk.Level ug/L	Recovery %			Limits %		Flags	
	MS	MSD	Sample		MS	MSD	RPD	Rec.	RPD	MS	MSD
Methyl tert-butyl ether	20.1	22.0	ND	25	80.4	88.0	9.0	65-165	20		
Benzene	23.9	23.2	ND	25	95.6	92.8	3.0	69-129	20		
Toluene	24.4	24.6	ND	25	97.6	98.4	0.8	70-130	20		
Surrogate(s)											
1,2-Dichloroethane-d4	480	496		500	96.0	99.2		73-130			
Toluene-d8	505	482		500	101.0	96.4		81-114			

Severn Trent Laboratories, Inc.

STL San Francisco * 1220 Quarry Lane, Pleasanton, CA 94566

Tel 925 484 1919 Fax 925 484 1096 * www.stl-inc.com * CA DHS ELAP# 2496

05/23/2005 08:54

Gas/BTEX Fuel Oxygenates by 8260B (C6-C12)

Blaine Tech Services, Inc.

Attn.: Leon Gearhart

1680 Rogers Avenue

San Jose, CA 95112-1105

Phone: (408) 573-0555 Fax: (408) 573-7771

Project: BTS#050513-MT2

97564701

Received: 05/13/2005 15:25

Site: 1601 Webster St., Alameda

Legend and Notes

Analysis Flag

L2

Reporting limits were raised due to high level of analyte present in the sample.

Severn Trent Laboratories, Inc.

STL San Francisco * 1220 Quarry Lane, Pleasanton, CA 94566

Tel 925 484 1919 Fax 925 484 1096 * www.stl-inc.com * CA DHS ELAP# 2496

05/23/2005 08:54

LAB: 511

SHELL Chain Of Custody Record

115121

Lab Identification (if necessary)

Address

City, State, Zip

Shell Project Manager to be Invoiced:

- SCIENCE & ENGINEERING
- TECHNICAL SERVICES
- CREDIT HOUSTON

Denis Brown

2005-05-0456

INCIDENT NUMBER (SEE ONLY)

9 7 5 6 4 7 0 1

SAP or CRMT NUMBER (SICRMT)

DATE: 5/13/05

PAGE: 1 of

SAMPLING COMPANY: Blaine Tech Services ADDRESS: 1680 Rogers Avenue, San Jose, CA 95112 PROJECT CONTACT (Headline or PDF Report): Leon Gearhart TELEPHONE: 408-573-0555 FAX: 408-573-7771 EMAIL: lgearhart@blainetech.com	LOG CODE: BTSS	SHIP ADDRESS (Street and City): 1601 Webster St., Alameda EDF DELIVERABLE TO Responsible Party or Deliverer: Anna Friel SAMPLER (AMBER) (PRN): Mike Joll	GLOBAL ID NO.: T0600137103 PHONE NO.: (707) 260-3412 EMAIL: sonomaed@cambridge-env.com CONSULTANT PROJECT NO.: 150513-112 BTS #
--	--------------------------	---	--

TURNAROUND TIME (BUSINESS DAYS)

20 DAYS
 5 DAYS
 72 HOURS
 48 HOURS
 24 HOURS
 LESS THAN 24 HOURS

LA - HQ/QC REPORT FORMAT
 LIST AGENCY

COMS MTBE CONFIRMATION: HIGHEST _____ HIGHEST per BORING _____ ALL _____

SPECIAL INSTRUCTIONS OR NOTES: CHECK BOX IF EDF IS NOT NEEDED

REQUESTED ANALYSIS

TPH - Gas, Pirouette	BTEX	MTBE (2021B - 6 ppb RL)	MTBE (2260B - 0.6 ppb RL)	Oxygens (5) by (2300B)	Ethanol (2260B)	Methanol	1,2-DCA (2290B)	EDB (2260B)											
				X	X		X	X											

FIELD NOTES:
 Container/Preservative
 or PID Readings
 or Laboratory Notes

20

TEMPERATURE ON RECEIPT °C

LAB USE ONLY	Field Sample Identification	SAMPLING		MATRIX	NO. OF CONT.
		DATE	TIME		
✓	TBW-N	5/13/05	1310	W	3

Prepared by (Signature): <i>[Signature]</i>	Received by (Signature): <i>[Signature]</i>	Date: <u>5/13/05</u>	Time: <u>1759</u>
Prepared by (Signature): <i>[Signature]</i>	Received by (Signature): <i>[Signature]</i>	Date: <u>05/13/05</u>	Time: <u>1759</u>
Prepared by (Signature):	Received by (Signature):	Date:	Time: