



2500 Camino Diablo, Walnut Creek, CA 94597
tel 800-801-3224
fax 925-944-2895

ENVIRONMENTAL & ENGINEERING SERVICES

www.aiconsultants.com

August 1, 2009

Jerry Wickham
Environmental Health Services – Environmental Protection
1131 Harbor Bay Parkway, Suite 250
Alameda, CA 94502-6577

RECEIVED

10:49 am, Sep 08, 2009

Alameda County
Environmental Health

Subject: Well Decommissioning
20957 Baker Road
Castro Valley, California 94546
Leak Case RO0002739
AEI Project # 273928

Dear Mr. Wickham:

Per your letter of July 29, 2009, all monitoring wells at the above referenced site have been decommissioned. AEI obtained well destruction permits W2009-0720 through W2009-0724 from the Alameda County Public Works Agency.

On August 18, 2009, monitoring wells, MW-1 through MW-4 and well IN-1 were decommissioned by Exploration Geoservices, California C-57 License # 484288. The well boxes were removed and the wells were over drilled using 8 1/4-inch hollowstem augers. The PVC casing was then removed and the wells were sealed with neat cement grout. The decommissioning of the wells was carried out under the supervision of James Yoo of the Alameda County Public Works Agency.

Attached are copies of the well destruction permits, Department of Water Resources DWR-188 forms and related paperwork.

If you have any questions, I can be reached at 925-746-6000, extension 122.

Sincerely,
AEI Consultants

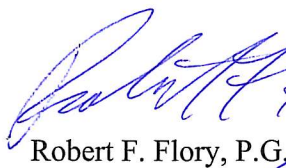
Robert F. Flory, P.G.

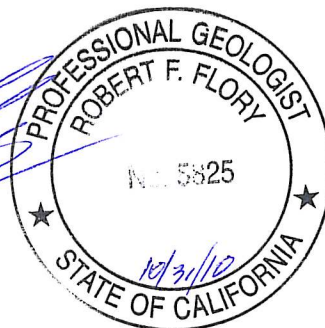

Alameda County Public Works Agency - Water Resources Well Permit



399 Elmhurst Street
Hayward, CA 94544-1395
Telephone: (510)670-6633 Fax:(510)782-1939

Application Approved on: 08/11/2009 By jamesy

Permit Numbers: W2009-0720 to W2009-0724
Permits Valid from 08/18/2009 to 08/18/2009

Application Id: 1249421363432
Site Location: 20957 Baker Road

City of Project Site:Castro Valley

Project Start Date: 08/18/2009

Completion Date:08/18/2009

Assigned Inspector: Contact James Yoo at (510) 670-6633 or jamesy@acpwa.org

Applicant: AEI Consultants - Flory Robert
2500 Camino Diablo, Walnut Creek, CA 94597

Phone: 925-746-6000 x122

Property Owner: Nat Piazza
7613 Peppertree Road, Dublin, CA 94568

Phone: 925-828-1577

Client: ** same as Property Owner **
Contact: Robert Flory

Phone: 925-746-6000 x122
Cell: 925-746-6099

Receipt Number: WR2009-0297	Total Due:	\$1985.00
Payer Name : Ronert F. Flory	Total Amount Paid:	\$1985.00
	Paid By: VISA	PAID IN FULL

Works Requesting Permits:

Well Destruction-Monitoring - 5 Wells

Driller: ExploracionGeoservices - Lic #: 484288 - Method: hstem

Work Total: \$1985.00

Specifications

Permit #	Issued Date	Expire Date	Owner Well Id	Hole Diam.	Casing Diam.	Seal Depth	Max. Depth	State Well #	Orig. Permit #	DWR #
W2009-0720	08/11/2009	11/16/2009	IN-1	8.00 in.	2.00 in.	5.00 ft	16.50 ft	3S/2W4	W2007-0968	e066655
W2009-0721	08/11/2009	11/16/2009	MW-1	8.00 in.	2.00 in.	5.00 ft	16.50 ft	3S/2W4	W2007-0964	e066631
W2009-0722	08/11/2009	11/16/2009	MW-2	8.00 in.	2.00 in.	5.00 ft	16.50 ft	3S/2W4	W2007-0965	e066635
W2009-0723	08/11/2009	11/16/2009	MW-3	8.00 in.	2.00 in.	5.00 ft	16.50 ft	3S/2W4	W2007-0966	e066637
W2009-0724	08/11/2009	11/16/2009	MW-4	8.00 in.	2.00 in.	5.00 ft	16.50 ft	3S/2W4	W2007-0967	e066649

Specific Work Permit Conditions

1. Drilling Permit(s) can be voided/ cancelled only in writing. It is the applicant's responsibility to notify Alameda County Public Works Agency, Water Resources Section in writing for an extension or to cancel the drilling permit application. No drilling permit application(s) shall be extended beyond ninety (90) days from the original start date. Applicants may not cancel a drilling permit application after the completion date of the permit issued has passed.

2. Prior to any drilling activities, it shall be the applicant's responsibility to contact and coordinate an Underground Service Alert (USA), obtain encroachment permit(s), excavation permit(s) or any other permits or agreements required for that Federal, State, County or City, and follow all City or County Ordinances. No work shall begin until all the permits and requirements have been approved or obtained. It shall also be the applicants responsibilities to provide to the Cities or to Alameda County an Traffic Safety Plan for any lane closures or detours planned. No work shall begin until all the permits and requirements have been approved or obtained.

3. Compliance with the well-sealing specifications shall not exempt the well-sealing contractor from complying with

Alameda County Public Works Agency - Water Resources Well Permit

appropriate State reporting-requirements related to well construction or destruction (Sections 13750 through 13755 (Division 7, Chapter 10, Article 3) of the California Water Code). Contractor must complete State DWR Form 188 and mail original to the Alameda County Public Works Agency, Water Resources Section, within 60 days. Including permit number and site map.

4. Applicant shall submit the copies of the approved encroachment permit to this office within 60 days.
5. Permittee shall assume entire responsibility for all activities and uses under this permit and shall indemnify, defend and save the Alameda County Public Works Agency, its officers, agents, and employees free and harmless from any and all expense, cost and liability in connection with or resulting from the exercise of this Permit including, but not limited to, property damage, personal injury and wrongful death.
6. Applicant shall contact James Yoo for an inspection time at 510-670-6633 at least five (5) working days prior to starting, once the permit has been approved. Confirm the scheduled date(s) at least 24 hours prior to drilling.
7. Permittee, permittee's contractors, consultants or agents shall be responsible to assure that all material or waters generated during drilling, boring destruction, and/or other activities associated with this Permit will be safely handled, properly managed, and disposed of according to all applicable federal, state, and local statutes regulating such. In no case shall these materials and/or waters be allowed to enter, or potentially enter, on or off-site storm sewers, dry wells, or waterways or be allowed to move off the property where work is being completed.
8. Remove the Christy box or similar structure.

Destroy well by grouting neat cement with a tremie pipe or pressure grouting (25 psi for 5min.) to the bottom of the well and by filling with neat cement to three (3-5) feet below surface grade. Allow the sealing material to spill over the top of the casing to fill any annular space between casing and soil.

After the seal has set, backfill the remaining hole with concrete or compacted material to match existing conditions.

9. Copy of approved drilling permit must be on site at all times. Failure to present or show proof of the approved permit application on site shall result in a fine of \$500.00.
-

CONFIDENTIAL

STATE OF CALIFORNIA DWR
WELL COMPLETION REPORT
(WELL LOGS)

REMOVED

LEGEND

MW-1  Monitoring Well - 10/12/07

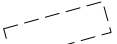
 Approximate limit of Tank Excavation, 4/24/04

 Former UST

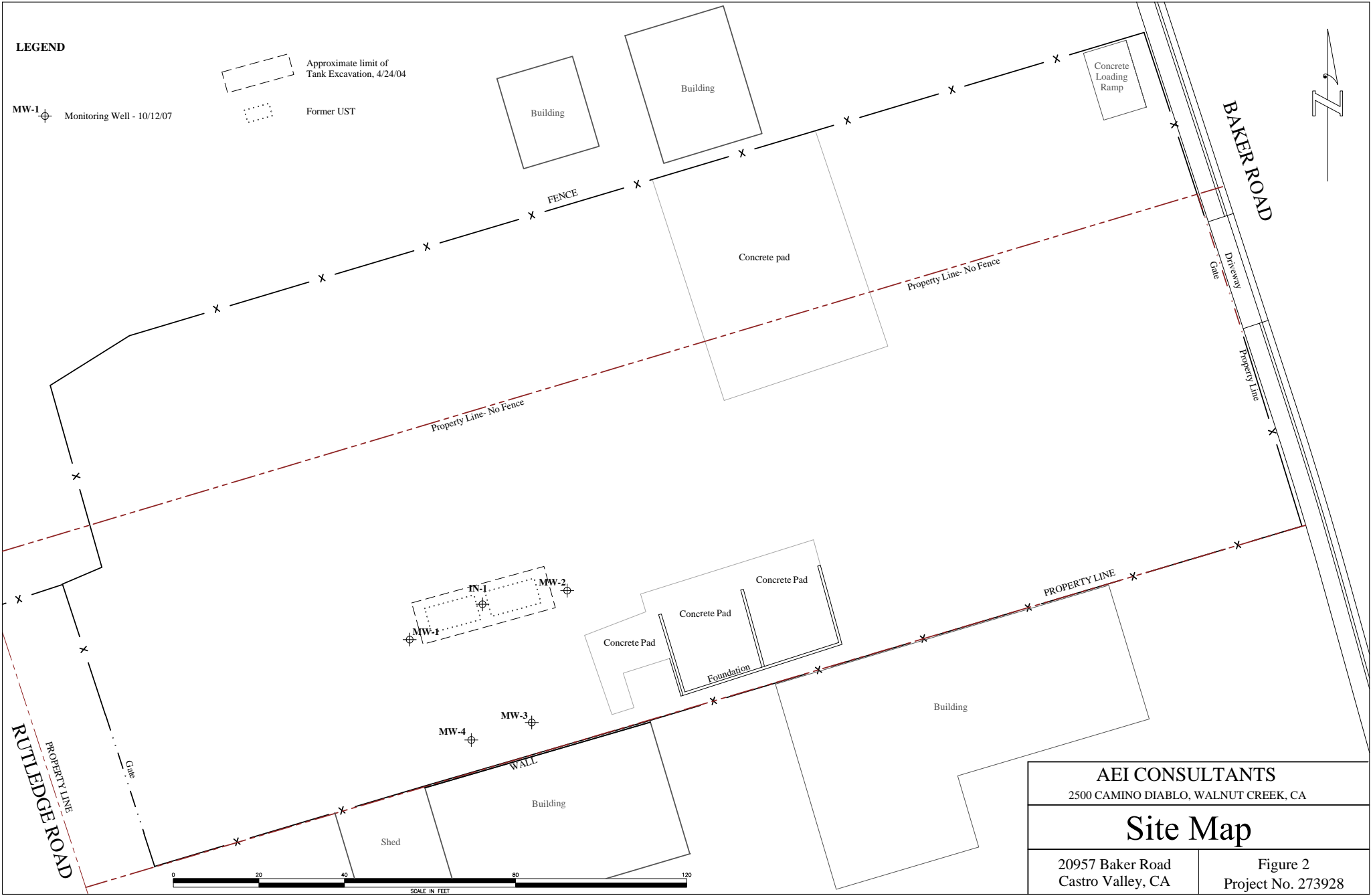

AEI CONSULTANTS 2500 CAMINO DIABLO, WALNUT CREEK, CA	
Site Map	
20957 Baker Road Castro Valley, CA	Figure 2 Project No. 273928

Project: Piazza
Project Location: 20957 Baker Road, Castro Valley, CA
Project Number: 273928

Log of Boring IN-1
 Sheet 1 of 1

Date(s) Drilled October 12, 2007	Logged By Leah Levine-Goldberg	Checked By Robert F. Flory, P.G
Drilling Method Hollow Stem Auger	Drill Bit Size/Type 8 1/4 inch	Total Depth of Borehole 16.5 feet bgs
Drill Rig Type CME-75	Drilling Contractor HEW Drilling	Surface Elevation 160.12 feet MSL
Groundwater Level and Date Measured 11.3 feet ATD	Sampling Method(s) ModCal	Permit # W2007-0968
Borehole Backfill Well Completion	Location	

X:\PROJECTS\CHARACTERIZATION & REMEDIATION\CHARACTERIZATION\273928 WI (Piazza) Castro Valley - (RFF)\Investigation\Graphics\Wells MW-1 IN-1.bgs [augenwell 20.tpl]

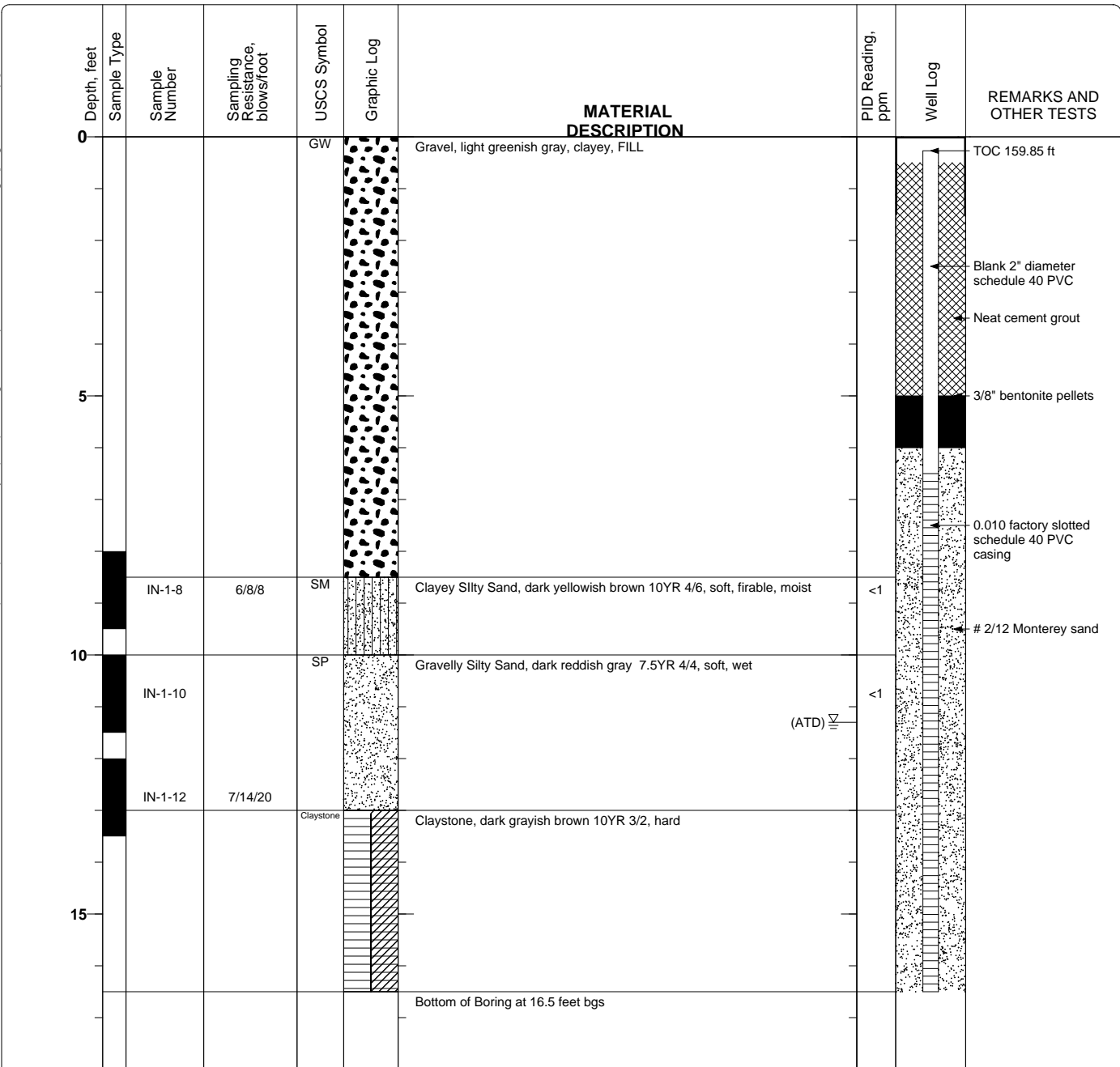

CONFIDENTIAL

STATE OF CALIFORNIA DWR
WELL COMPLETION REPORT
(WELL LOGS)

REMOVED

LEGEND

MW-1  Monitoring Well - 10/12/07

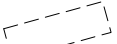
 Approximate limit of Tank Excavation, 4/24/04

 Former UST

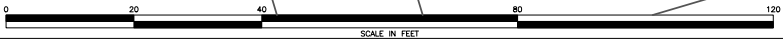
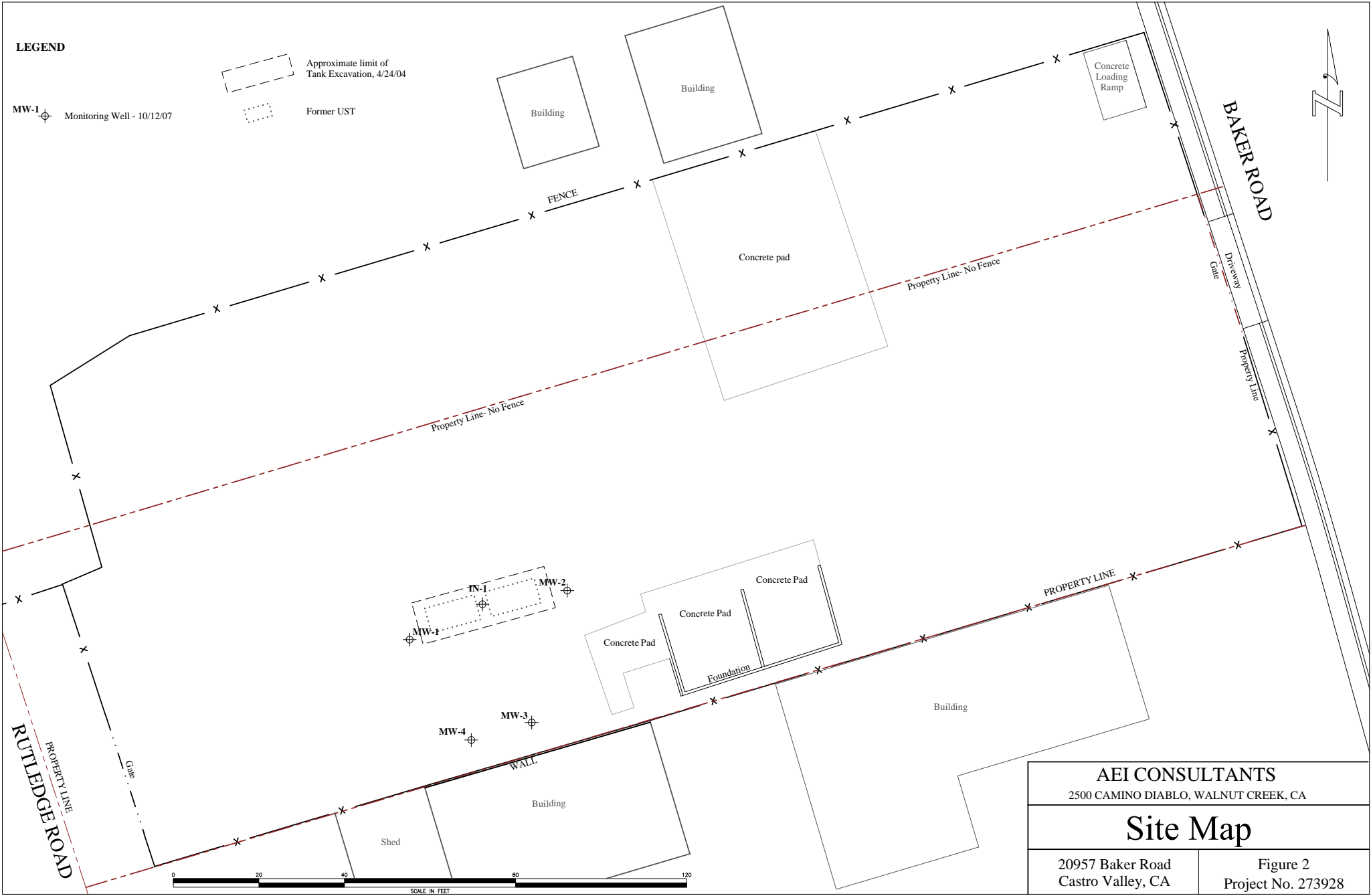

AEI CONSULTANTS 2500 CAMINO DIABLO, WALNUT CREEK, CA	
Site Map	
20957 Baker Road Castro Valley, CA	Figure 2 Project No. 273928

Project: Piazza
Project Location: 20957 Baker Road, Castro Valley, CA
Project Number: 273928

Log of Boring MW-1
 Sheet 1 of 1

Date(s) Drilled October 12, 2007	Logged By Leah Levine-Goldberg	Checked By Robert F. Flory, PG
Drilling Method Hollow Stem Auger	Drill Bit Size/Type 8 1/4 inch	Total Depth of Borehole 16.5 feet bgs
Drill Rig Type CME-75	Drilling Contractor HEW Drilling	Surface Elevation 159.84 feet MSL
Groundwater Level and Date Measured 14.75 feet ATD	Sampling Method(s) ModCal	Permit # W2007-0964
Borehole Backfill Well Completion	Location	

Depth, feet	Sample Type	Sample Number	Sampling Resistance, blows/foot	USCS Symbol	Graphic Log	MATERIAL DESCRIPTION	PID Reading, ppm	Well Log	REMARKS AND OTHER TESTS
0				Asphalt		Asphalt 2", base rock 4"			TOC 159.62 ft
				CL		Clay, black 10YR 2/1, firm, stiff, moist			MW-1 is a twin to boring 5 (SB-5)
				CL		Silty Clay, dark yellowish brown 10YR3/4 with very dark brown mottling 10YR 2/2			Blank 2" diameter schedule 40 PVC
									Neat cement grout
5		MW-1-5	5/7/7	SM-ML		Clayey Silt - Silty Sand, dark yellowish brown 10YR3/4 with some 10YR 4/6 mottling, firm, slightly moist	<1		3/8" bentonite pellets
		MW-1-8	4/6/7	SM		Sand, yellowish brown 10YR 4/6, very fine grained, clayey, firm - moderately firm, friable, very moist	<1		
10		MW-1-10	5/7/10	SP		Sand, yellowish brown 10YR 4/6, very fine grained - coarse grained, firm, wet ?	<1		
		MW-1-12	5/10/13	CL		Gravelly Clay - Silty Clay, olive - olive brown 5y 4/4 - 2.5 4/4, firm - hard, slightly moist - (saprolite)	<1		
15				Claystone		Silty Claystone, light olive brown 2.5Y 4/4, firm - hard, indurated (ATD) ∇			

X:\PROJECTS\CHARACTERIZATION & REMEDIATION\CHARACTERIZATION\273928 WI (Piazza) Castro Valley - (RFF)\Investigation\Graphics\Wells MW-1 IN-1.bgs [augenwell 20.tpl]



CONFIDENTIAL

STATE OF CALIFORNIA DWR
WELL COMPLETION REPORT
(WELL LOGS)

REMOVED

LEGEND

MW-1  Monitoring Well - 10/12/07

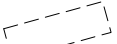
 Approximate limit of Tank Excavation, 4/24/04

 Former UST

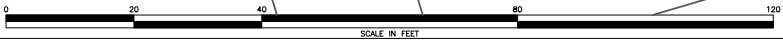
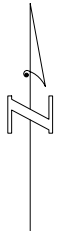
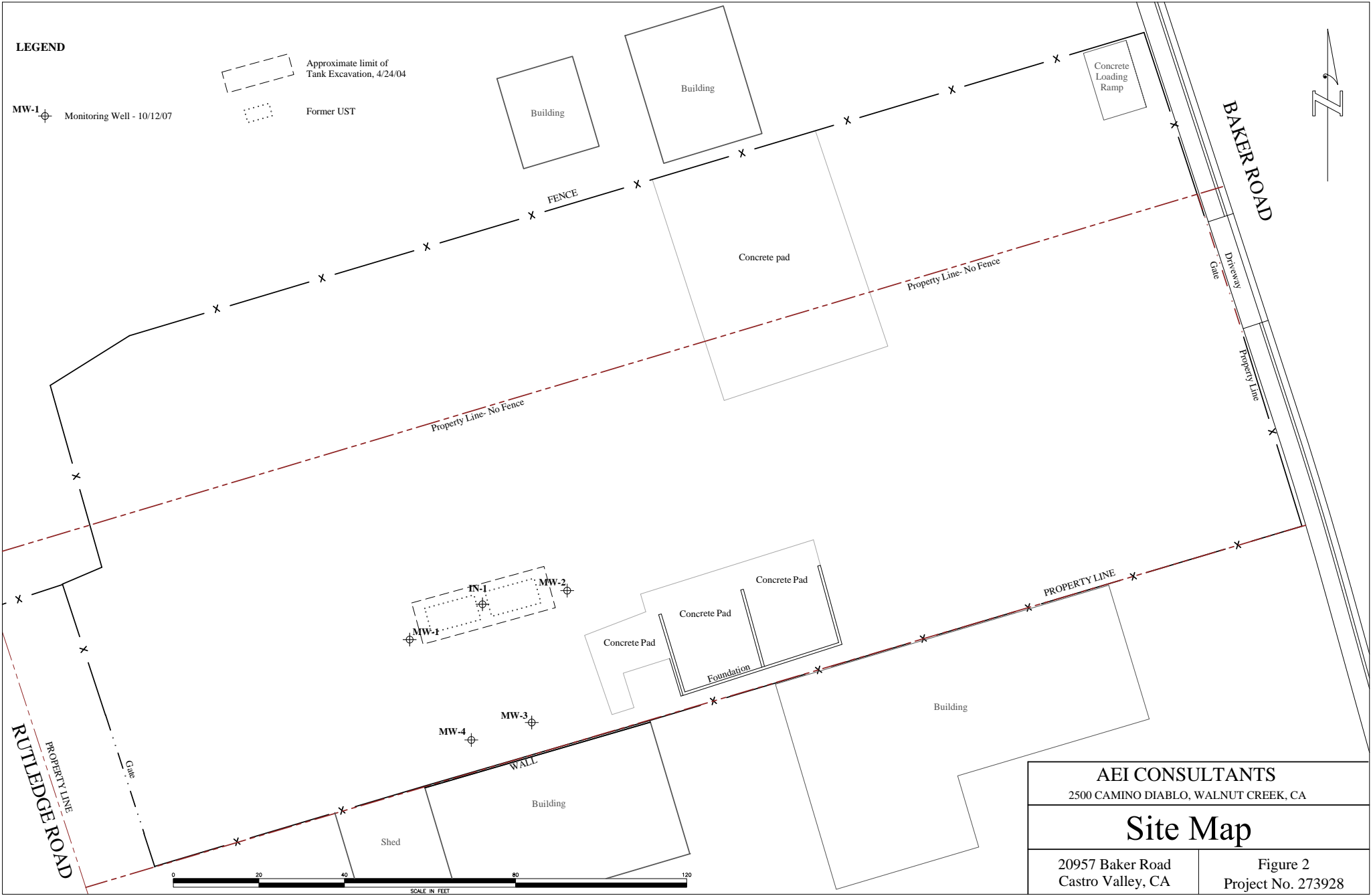

AEI CONSULTANTS 2500 CAMINO DIABLO, WALNUT CREEK, CA	
Site Map	
20957 Baker Road Castro Valley, CA	Figure 2 Project No. 273928

Project: Piazza
Project Location: 20957 Baker Road, Castro Valley, CA
Project Number: 273928

Log of Boring MW-2
 Sheet 1 of 1

Date(s) Drilled October 12, 2007	Logged By Leah Levine-Goldberg	Checked By Robert F. Flory, PG
Drilling Method Hollow Stem Auger	Drill Bit Size/Type 8 1/4 inch	Total Depth of Borehole 18 feet bgs
Drill Rig Type CME-75	Drilling Contractor HEW DRILLING	Surface Elevation 160.3 feet
Groundwater Level and Date Measured 13.7 feet ATD	Sampling Method(s) ModCal	Permit # W2007-0965
Borehole Backfill Well Completion	Location	

Depth, feet	Sample Type	Sample Number	Sampling Resistance, blows/foot	USCS Symbol	Graphic Log	MATERIAL DESCRIPTION	PID Reading, ppm	Well Log	REMARKS AND OTHER TESTS
0				GC		Clayey Gravel, black - dark yellow brown 10YR 2/1 - 3/4, firm, dry (FILL?)			TOC 160 ft
				CL		Silty Clay, black 10YR 2/1, firm, moist			Neat cement grout
5		MW-2-5	3/3/5	ML		Clayey Silt, light olive brown 2.5Y 5/6, moderately firm, moist becoming sandy downward	<1		Well twin to boring SB-2
		MW-2-8	7/14/17				<1		
10		MW-2-11.5	5/6/7	SM		Silty Sand, light olive brown 2.5Y 5/6, clayey, moderately firm, moist,			# 2/12 Monterey sand
		MW-2-12	6/7/10	SP		Silty Sand, dark greenish gray 10GY 4/1, moderately firm, very moist, becoming wet downward.	2.5		
15		MW-2-15	9/14/25	CL		Sandy Gravelly Clay, olive brown - dark grayish brown 2.5Y 4/4 - 4/2, firm, slightly moist (saprolite)	12.5		
				Claystone		Sandy Gravelly Claystone, light olive brown 2.5Y 4/4, firm - hard, indurated	(ATD) ∇		
							<1		

X:\PROJECTS\CHARACTERIZATION & REMEDIATION\CHARACTERIZATION\273928 WI (Piazza) Castro Valley - (RFF)\Investigation\Graphics\Wells MW-1 IN-1.bgs [augenwell 20.tpl]



CONFIDENTIAL

STATE OF CALIFORNIA DWR
WELL COMPLETION REPORT
(WELL LOGS)

REMOVED

LEGEND

MW-1  Monitoring Well - 10/12/07

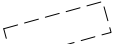
 Approximate limit of Tank Excavation, 4/24/04

 Former UST

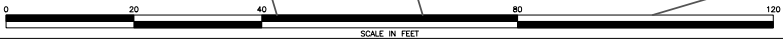
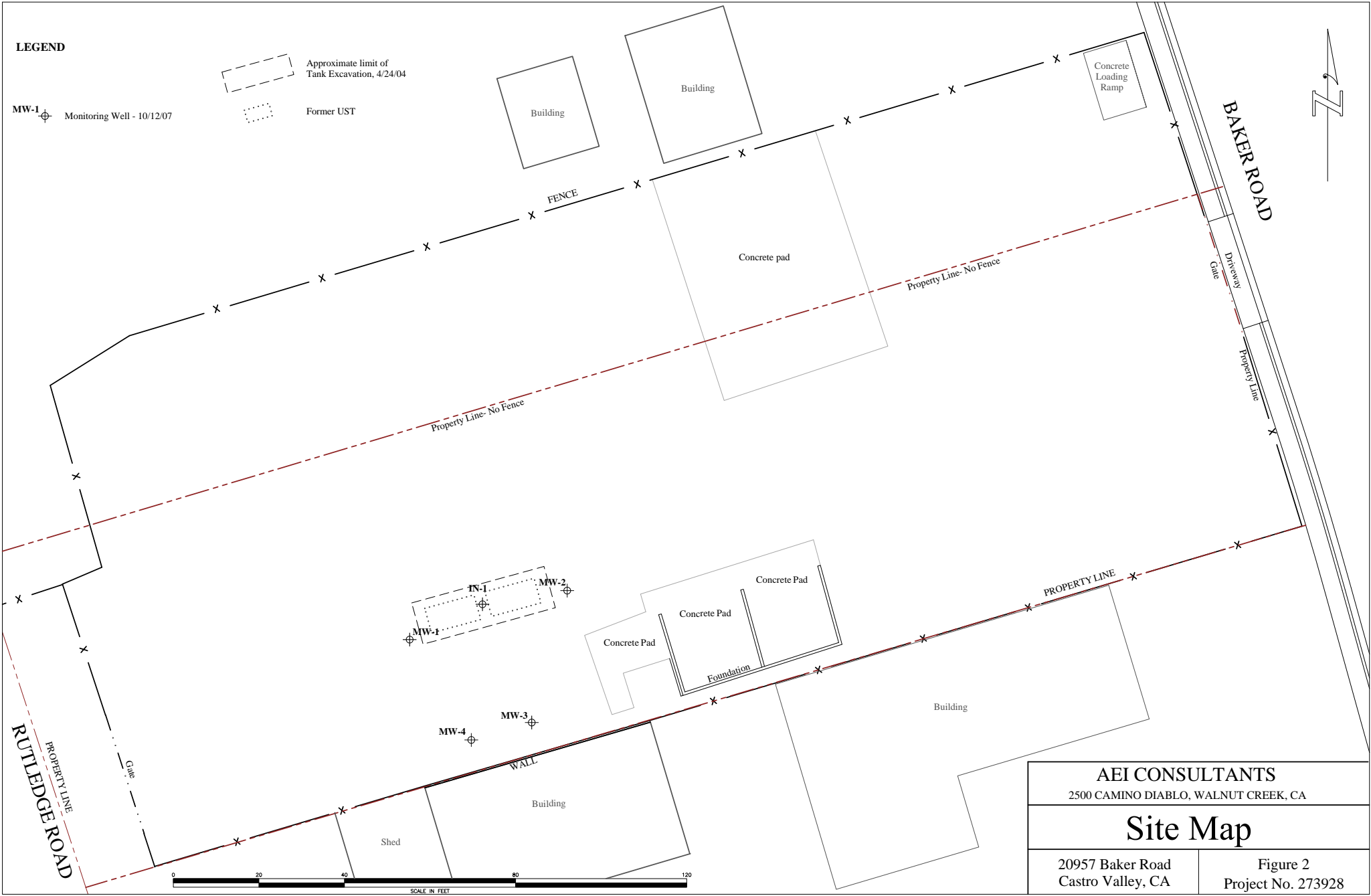

AEI CONSULTANTS 2500 CAMINO DIABLO, WALNUT CREEK, CA	
Site Map	
20957 Baker Road Castro Valley, CA	Figure 2 Project No. 273928

Project: Piazza
Project Location: 20957 Baker Road, Castro Valley, CA
Project Number: 273928

Log of Boring MW-3
 Sheet 1 of 1

Date(s) Drilled October 12, 2007	Logged By Leah Levine-Goldberg	Checked By Robert F. Flory, PG
Drilling Method Hollow Stem Auger	Drill Bit Size/Type 8 1/4 inch	Total Depth of Borehole 16.5 feet bgs
Drill Rig Type CME-75	Drilling Contractor HEW Drilling	Surface Elevation 160.04 feet MSL
Groundwater Level and Date Measured 13.3 feet ATD	Sampling Method(s) ModCal	Permit # W2007-0966
Borehole Backfill Well Completion	Location	

Depth, feet	Sample Type	Sample Number	Sampling Resistance, blows/foot	USCS Symbol	Graphic Log	MATERIAL DESCRIPTION	PID Reading, ppm	Well Log	REMARKS AND OTHER TESTS
0				Asphalt GC		Asphalt			TOC 159.79 ft
						Clayey Gravel, gray, FILL			
				CL		Clay, black 10YR 2/1, soft, moist			Blank 2" diameter schedule 40 PVC
				CL		Silty Clay, dark yellowish brown 10YR3/4 with very dark brown mottling 10YR 2/2			Neat cement grout
5		MW-3-5	3/5/5	CL-ML		Sandy Silty Clay - Clayey Silt, dark yellowish brown 10YR3/4 with some 10YR 4/6 mottling, firm, moist	<1		3/8" bentonite pellets
				SM		Silty Sand, dark brown 10YR 5/8, very fine grained, slightly clayey, firm - moderately firm, friable, moist			
10		MW-3-8	3/7/11			Sandy Gravel, yellowish brown 10YR 5/4, well graded, moderately firm, moist	<1		
		MW-3-10	6/7/8	SP		Gravelly Sand, yellowish brown 10YR 5/4, well graded, moderately firm, wet.	<1		
		MW-3-12	7/11/14	SW		Clayey Gravel - Gravelly Clay, olive gray - olive 4/2 - 5/3, firm, wet, (saprolite)	<1		
15				GC-CL					(ATD) ▽
						Bottom of Boring at 16.5 feet bgs			

X:\PROJECTS\CHARACTERIZATION & REMEDIATION\CHARACTERIZATION\273928 WI (Piazza) Castro Valley - (RFF)\Investigation\Graphics\Wells MW-1 IN-1.bgs [augenwell 20.tpl]



CONFIDENTIAL

STATE OF CALIFORNIA DWR
WELL COMPLETION REPORT
(WELL LOGS)

REMOVED

LEGEND

MW-1  Monitoring Well - 10/12/07

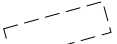
 Approximate limit of Tank Excavation, 4/24/04

 Former UST

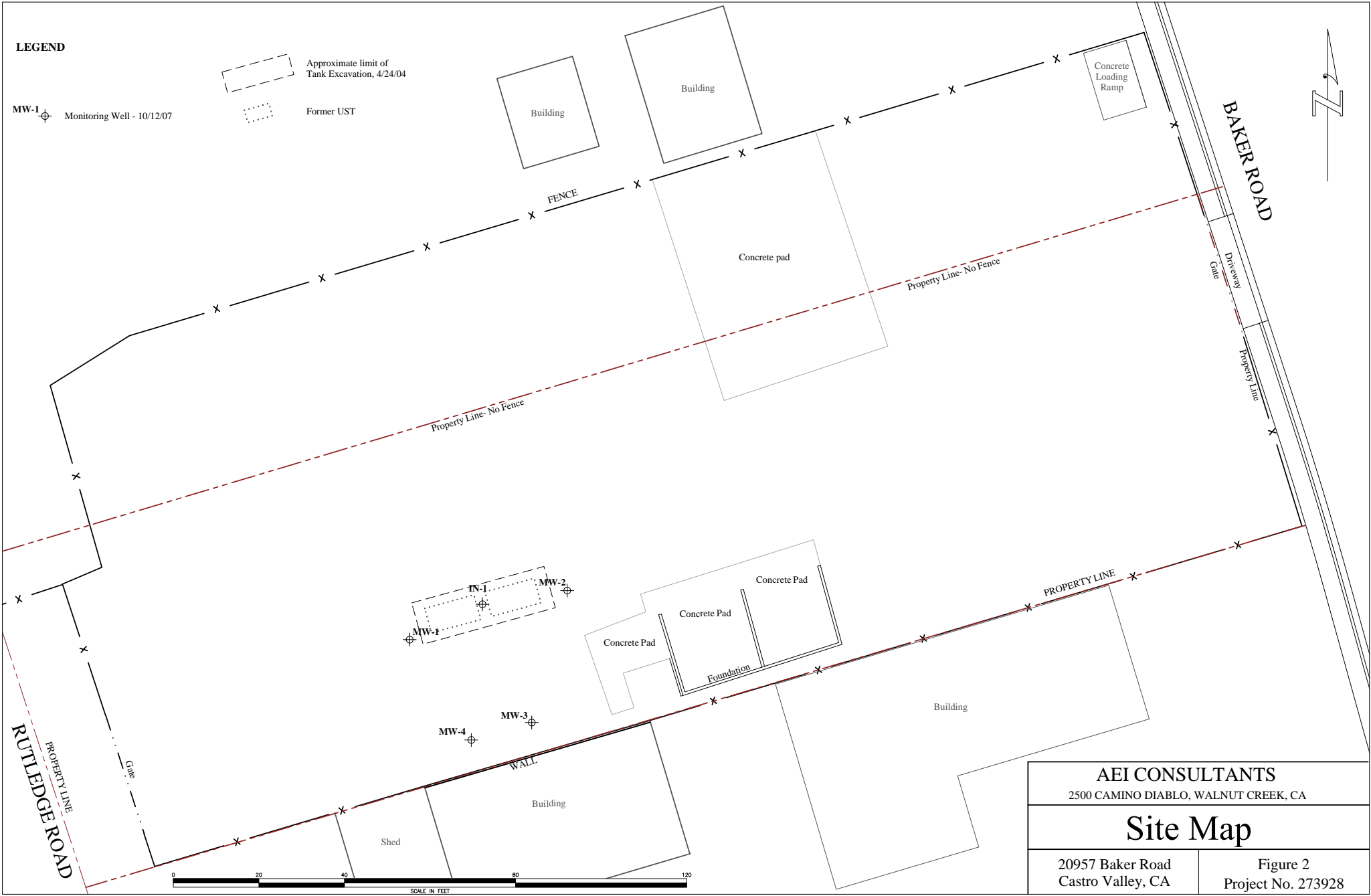

AEI CONSULTANTS
2500 CAMINO DIABLO, WALNUT CREEK, CA

Site Map

20957 Baker Road
Castro Valley, CA

Figure 2
Project No. 273928

Project: Piazza
Project Location: 20957 Baker Road, Castro Valley, CA
Project Number: 273928

Log of Boring MW-4
 Sheet 1 of 1

Date(s) Drilled October 12, 2007	Logged By Leah Levine-Goldberg	Checked By Robert F. Flory, P.G
Drilling Method Hollow Stem Auger	Drill Bit Size/Type 8 1/4 inch	Total Depth of Borehole 16.5 feet bgs
Drill Rig Type CME-75	Drilling Contractor HEW Drilling	Surface Elevation 159.95 feet MSL
Groundwater Level and Date Measured 15.4 feet ATD	Sampling Method(s) ModCal	Permit # W2007-0967
Borehole Backfill Well Completion	Location	

Depth, feet	Sample Type	Sample Number	Sampling Resistance, blows/root	USCS Symbol	Graphic Log	MATERIAL DESCRIPTION	PID Reading, ppm	Well Log	REMARKS AND OTHER TESTS
0				Asphalt					
				GC		Clayey Gravel, gray, FILL			TOC 159.69 ft
				CL		Clay, Black 10YR 2/1			Blank 2" diameter schedule 40 PVC Neat cement grout
5		MW-4-6	5/8/9	CL		Sandy Silty Clay, dark brown, 10YR 3/6, moist, firm	<1		
		MW-4-8	5/7/10	SC		Clayey Silty Sand, dark olive brown - light olive brown 2.5Y 3/3 - 5/6, moderately firm, moist	<1		
10		MW-4-11	3/8/11	CL		Gravelly Clay, light brownish gray, weathered claystone with green siltstone clasts, firm, moist	<1		
		MW-4-12	6/8/12				<1		
15		MW-4-16	5/7/10	Claystone		Silty Claystone, grayish brown 2.5Y 5/2, saprolitic with purplish black clasts, firm, moist	<1		(ATD) ∇
						Bottom of Boring at 16.5 feet bgs			

X:\PROJECTS\CHARACTERIZATION & REMEDIATION\CHARACTERIZATION\273928 WI (Piazza) Castro Valley - (RFF)\Investigation\Graphics\Wells MW-1 IN-1.bgs [augenwell 20.tpl]

