

ALAMEDA COUNTY
HEALTH CARE SERVICES



AGENCY

DAVID J. KEARS, Agency Director

DELETE

*ADJUST
CASE NAME*

R02721

14 September 1990

Ty Campbell
Clarke & Cramer, Incorporated
401 Roland Way
Oakland, CA 94621

DEPARTMENT OF ENVIRONMENTAL HEALTH
Hazardous Materials Program
80 Swan Way, Rm. 200
Oakland, CA 94621
(415)

Subject: Assessment Report of 2500 Kirkham Street, Oakland.

Dear Mr. Campbell:

Thank you for the report, dated 7 August 1990, prepared by Earth Metrics Incorporated for the site listed above. A review of this report has been completed. The Earth Metrics report states that Total Oil and Grease contamination of up to 170 parts per million was measured in composite samples obtained from borings drilled on your property. Based upon this information, some follow-up action is required. *

Guidelines established by the San Francisco Bay Regional Water Quality Control Board require that a ground water investigation be conducted on a property whenever soil contamination is detected indicating that an impact on ground water quality may have occurred. Such an investigation needs to be conducted at 2500 Kirkham Street. To fulfill all of the requirements of the Regional Board, this investigation should include defining the ground water gradient at the site and analyzing the water for the presence of Total Petroleum Hydrocarbons-Diesel (EPA Method GCFID 3510), Benzene, Toluene, Xylene and Ethylbenzene (EPA Method 602, 624 or 8260) and Total Oil and Grease (EPA Method 5520 C&F). During well installation soil samples should be collected for analysis at five foot depth intervals until ground water is reached. A copy of all data and boring logs should be submitted to this office for review and inclusion into our records.

The contents of this letter have been discussed with Chris Zouboulakis of Earth Metrics. If you have any question concerning this matter, please contact me at (415) 271-4320.

Sincerely,

Dennis J. Byrne
Hazardous Materials Specialist

cc: Lester Feldman, SFBRWQCB
Rafat Shahid, Assistant Director, Alameda County Department of Environmental Health.
Chris Zouboulakis, Earth Metrics Inc.

"9/18/90"
Leak Discovery date
Ar T0600100187.

ENVIRONMENTAL
PROTECTION

96 JUL 18 AM 9:41

ENGEO
INCORPORATED

2401 Crow Canyon Road
Suite 200
San Ramon, CA 94583
(510) 838-1600
Fax (510) 838-7425

LETTER OF TRANSMITTAL

DATE: July 15, 1996

ENGEO PROJECT NO.: 4139-F1

TO: Alameda County Department of Environmental Health
1131 Harbor Bay Parkway
Alameda, CA 94502

ATTENTION: Jennifer Eberle

SUBJECT: Asbury Graphite - 2500 Kirkham Street, Oakland, California

TRANSMITTED HEREWITH: 1. Earth Metrics report dated 8/7/90; 2. Earth Metrics report dated 12/17/90; 3. ACDEH letter dated 9/14/90.

REMARKS: Real Estate transaction pending. Need to determine necessary steps to achieve site closure. Would like to set-up meeting with you and purchaser to discuss additional characterization/remediation.

ENGEO INCORPORATED
BY: Shawn Munger CHG 413
COPIES:

- x FOR YOUR INFORMATION
- x FOR YOUR REVIEW
- RETURNING
- x COPIES AT YOUR REQUEST

RWDCB listed as
LUST.
No gw invest.
Newer an UST.
Adj to Findley Adhesive
He reviewed " file.
Will excavate hot spots.
We may req Geoprobe.

7hr x 94 = \$658
drum storage
graphite Mfg - hub oil
∴ SLIC site
Seller is Asbury Graphite
His Phase I is in Draft.
It will be here by Mon.

COPYRIGHT © 1996 BY ENGEO INCORPORATED. THIS DOCUMENT MAY NOT BE REPRODUCED IN WHOLE OR IN PART BY ANY MEANS WHATSOEVER, NOR MAY IT BE QUOTED OR REPRODUCED WITHOUT THE EXPRESS WRITTEN CONSENT OF ENGEO INCORPORATED.

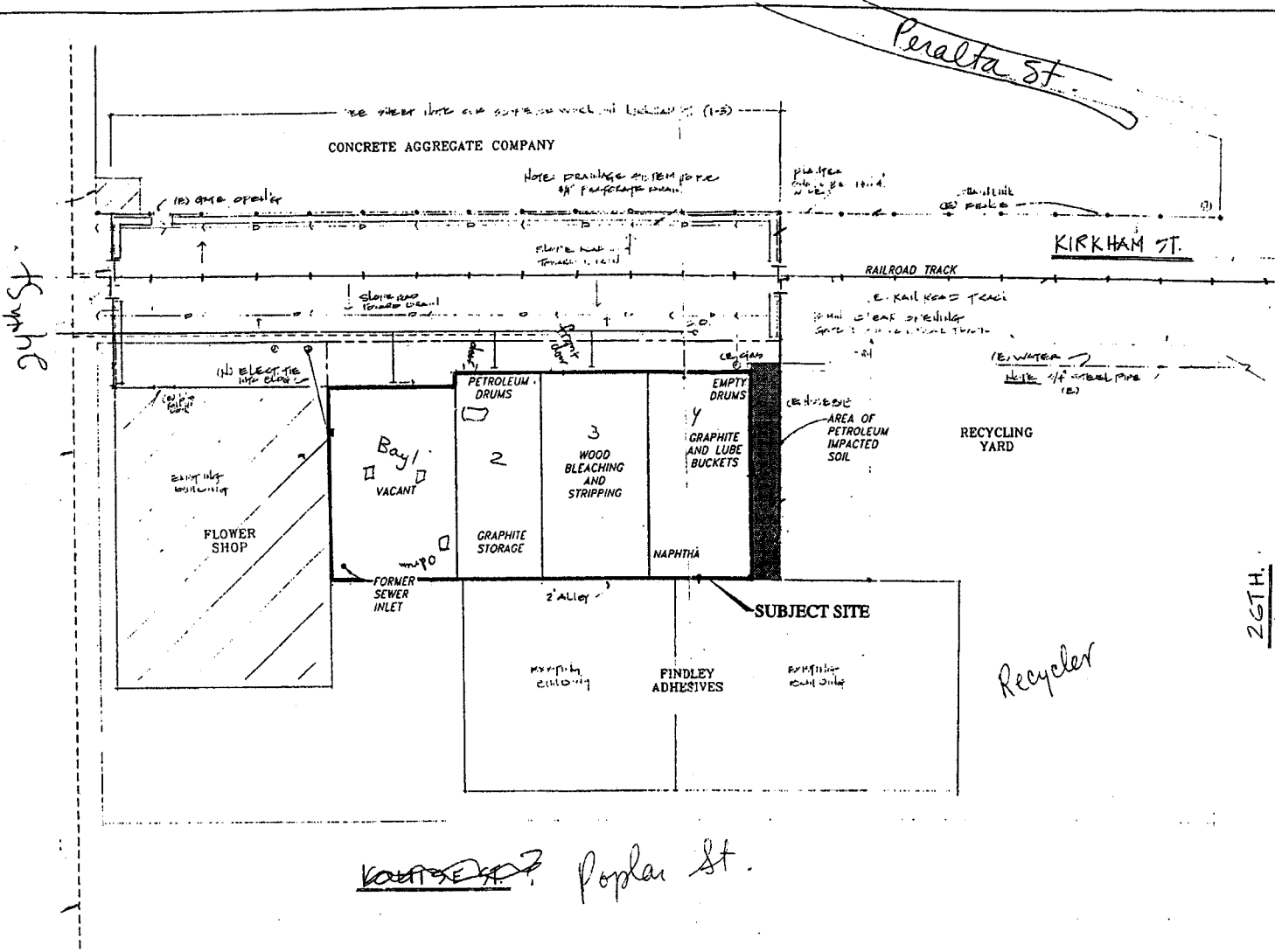

ENGEO INCORPORATED	SITE PLAN 2426-2500 KIRKHAM STREET OAKLAND, CALIFORNIA		N.T.S.	JOB NO.: 4139-F1	FIGURE NO. 2
				DATE: JUNE 1996	
				DRAWN BY: [Signature]	CHECKED BY:

AC-68