

100 Pine Street, 10th Floor
San Francisco, CA 94111
(415) 434-9400 • FAX (415) 434-1365

ENVIRONMENTAL
PROTECTION



14 March 1995
Project No. 2530.02

95 MAR 23 PM 1:46

Ms. Madhulla Logan
Alameda County Health Care Services Agency
1131 Harbour Bay Parkway
Alameda, California 94502

Subject: Work Plan for Soil Excavation and Sampling
2020 Sherman Avenue
Alameda, California

Dear Ms. Logan:

On behalf of Encinal Real Estate, Inc., Geomatrix Consultants, Inc. (Geomatrix) has prepared this work plan to conduct soil excavation and sampling at the subject site (Figure 1). As outlined in our 8 December 1994 letter to you, additional characterization activities were proposed at the southeast corner of the warehouse once it was demolished. The warehouse will be demolished, and excavation in the assumed source area can be accomplished.

To address concerns regarding potential future health risks from residual VOCs in soil, Encinal's earthwork contractor will conduct a limited excavation of soil in the vicinity of soil boring EB-1 (Figure 2). Approximately 150 to 200 cubic yards of soil (in-situ) will be excavated using a rubber-tired backhoe and stockpiled on plastic sheeting. The proposed plan area of the excavation toe is 20 feet by 30 feet with sidewalls sloped, if necessary, to provide for a safe excavation. The excavation will be advanced to remove fill soils located above the natural sediments, a dark gray silty clay, but not deeper than static groundwater level which is expected to be encountered at six to eight feet.

Geomatrix will observe excavation activities, monitor with a PID, and collect soil samples of the excavation sidewalls and bottom. Up to six sidewall soil samples and two bottom samples will be collected from the backhoe bucket. Soil samples will be analyzed by a state-certified, analytical laboratory for volatile organic compounds by EPA Method 8240.

The excavation will be backfilled with suitable material borrowed from the site. Encinal's earthwork contractor will aerate the stockpiled soil for approximately one month by turning the stockpile weekly with earthwork equipment. Geomatrix will then collect a composite soil sample for analysis by a state-certified, analytical laboratory for volatile organic compounds by EPA Method 8240. After completion of aeration, the excavated soil will be reused as on-site fill material.

Geomatrix Consultants, Inc.
Engineers, Geologists, and Environmental Scientists

Ms. Madhulla Logan
Alameda County Health Care Services Agency
14 March 1995
Page 2

A summary of our observations and analytical results will be submitted for your review within four weeks after receipt of the analytical results. If you have any questions regarding this proposed approach to characterize and remediate soil in the vicinity of boring EB-1, please call either of the undersigned or Ms. Cheri Page.

Sincerely,

GEOMATRIX CONSULTANTS, INC.

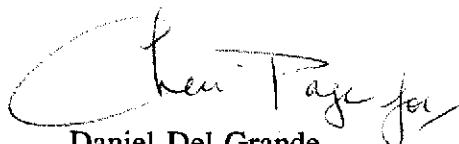

Daniel Del Grande
Project Engineer

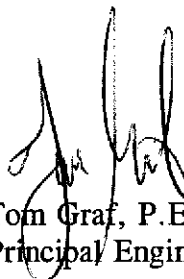

Tom Graf, P.E.
Principal Engineer

TEG/DDG/dmm
CONTR\2530SOIL.LTR

cc: Sum Arigala, RWQCB
Peter Wang, Encinal Real Estate

Attachments: Figure 1 - Location Map
Figure 2 - Excavation Plan

ENVIRONMENTAL
PROTECTION
95 MAR 23 PM 1:46

[Faint handwritten notes]

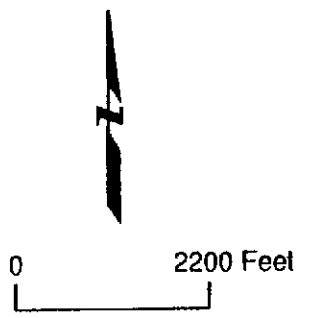
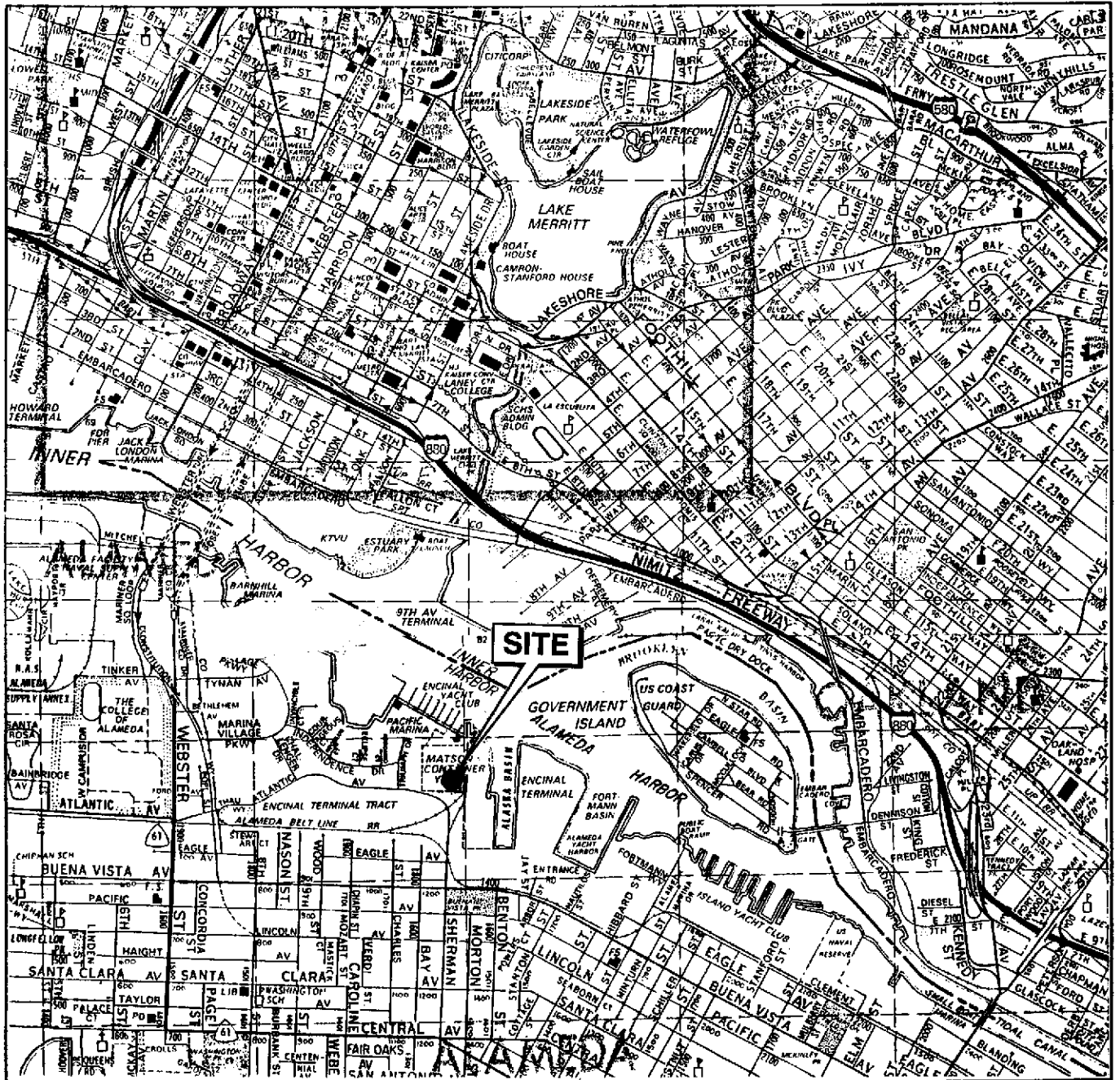

	SITE LOCATION MAP 2020 Sherman Alameda, California		Figure 1
			Project No. 2530

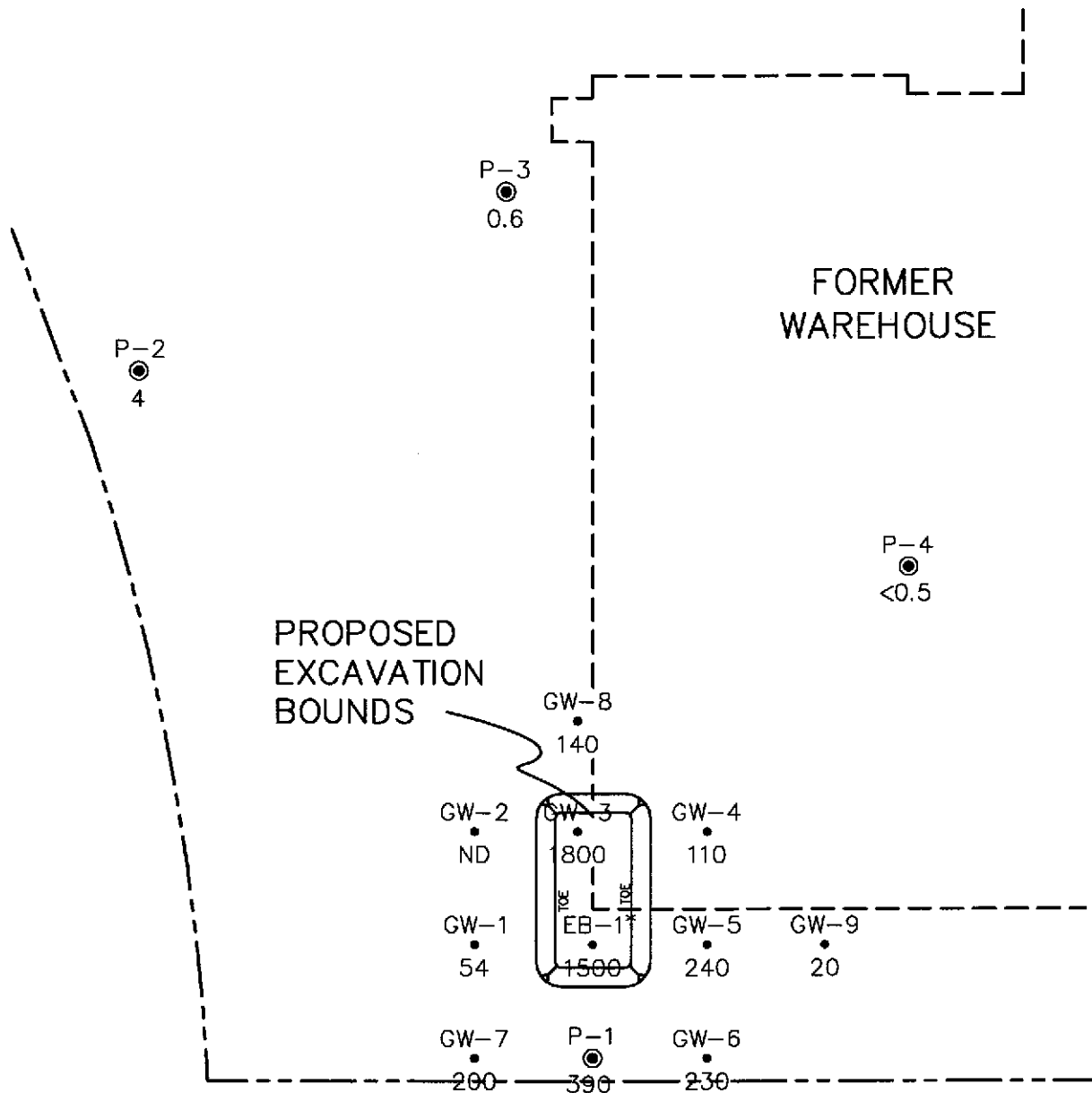

EXPLANATION

P-1 ● 390 TEMPORARY PIEZOMETER LOCATION AND 1,1 - DICHLOROETHANE CONCENTRATION (1,1 - DCA) IN GROUNDWATER GRAB SAMPLE IN PARTS PER BILLION.

GW-1 ● 54 SHALLOW GROUNDWATER SURVEY POINT AND 1,1 - DCA CONCENTRATION IN GROUNDWATER GRAB SAMPLE IN PARTS PER BILLION

*GROUNDWATER GRAB SAMPLE FROM BORING EB-1 WAS COLLECTED AND ANALYZED BY OTHERS IN 1990.

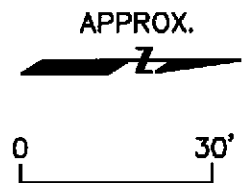

SUBMITTAL DATE: MAR 20, 2008 TIME: 2:55 PM



**EXCAVATION PLAN
 ENCINAL REAL ESTATE - 2020 SHERMAN AVE.
 ALAMEDA, CALIFORNIA**

Figure 2

Project No. 2530.02