

November 2, 1995

Ms. Madhulla Logan
Hazardous Materials Specialist
Alameda County Health Care Services Agency
1131 Harbor Bay Parkway, Suite 250
Alameda, CA 94502

RE: Summary of Work Completed for Site Development,
and Request for Final Site Closure at the
Former Island Gun Club, 500 Maitland Drive, Alameda, CA

Dear Ms. Logan:

ACC Environmental Consultants, Inc. (ACC), presents this letter report documenting the work completed to date in anticipation for final site closure at the property known as the Former Island Gun Club, 500 Maitland Drive, Alameda, California. The work was completed in anticipation of development of the site.

INTRODUCTION

The Former Island Gun Club site consists of a 5-acre parcel of land located at the northwest corner of Maitland Drive and Harbor Bay Parkway on the Bay Farm Island portion of the City of Alameda, illustrated on Figure 1. The site was used as a gun shooting and practice range from 1926 until June 20, 1982. The Gun Club was disbanded in 1982 and the site has remained vacant since that time. Currently the site is open and unpaved. The site is proposed to be capped and used as a Recreational Vehicle (RV) and self storage facility.

BACKGROUND

During a subsurface investigation in 1990, analytical results of shallow soil samples collected from the site indicated detectable concentrations of lead, copper and polynuclear aromatic hydrocarbons (PNAs) which were determined to have been generated from the previous use of the site as a shooting range (Exceltech, 1990, Kleinfelder, 1990, and RESNA, 1992). Three monitoring wells were installed onsite in 1992 to investigate the extent of impact in the soil and the groundwater conditions. Analysis of water samples collected from the groundwater monitoring wells indicated concentrations of lead and copper.

An additional subsurface investigation was conducted in May 1994 by ACC. The investigation included the installation of two additional monitoring wells to establish background groundwater quality data to evaluate cleanup levels of lead, copper and PNAs, conduct a tidal study, and evaluate the potential human health risk assessment for the proposed site usage. Based on the concentrations of lead, PNAs, and copper reported in the fill material, the elevated concentrations of constituents occur only in limited areas and have not degraded the groundwater for the proposed site usage. The concentrations of constituents reported in the groundwater were considered to be within background concentrations and elevated levels of constituents were found to be limited to small areas onsite.

ENVIRONMENTAL
PHOTOGRAPHY
50 NOV - 6 PM 3:19

Former Island Gun Club
Summary Report
November 2, 1995
Page 2

In 1994, ACC evaluated the human health risk associated with proposed development of the site as a mini-storage and RV facility. Findings of the risk assessment indicated that three areas onsite had concentrations of lead in excess of 1,000 mg/kg, defined as "hot spots". These areas were recommended for removal to provide protection of public health, prior to site development. Figure 2 illustrates the locations of the hot spots. The risk assessment verified reported concentrations of copper and PNAs onsite were within acceptable concentrations for the intended development of the site and were not required to be remediated or removed. The risk assessment and recommendations were accepted by Alameda County Health Care Services Agency in a letter dated February 21, 1995.

REMEDIAL ACTION

Prior to removal of the hot spots, additional soil samples were collected for disposal profiling. Analytical results of the hot spot samples indicated that a portion of the soil was considered a RCRA waste. The remaining soil was considered to be non-RCRA hazardous waste. On June 28, 1995, US Ecology, hazardous materials contractor, removed the soil from the hot spot areas. Remedial action included excavation of the hot spots to 18 inches in depth and approximately 5 feet laterally around each hot spot. A total of 102.025 tons of impacted soil was removed from the site and delivered to US Ecology in Beatty, Nevada for stabilization and disposal. Weight tags and disposal manifests are included in Attachment A. After the impacted soil was removed, verification soil samples were collected from each area. Two discrete soil samples were collected for each 25 linear feet of excavation, within each remediated area. The soil samples were collected with the use of a pre-cleaned 25-pound slide hammer equipped with one six-inch stainless steel tube. The slide-hammer was then driven six inches into the newly excavated surface to obtain a relatively undisturbed sample of the shallow material. Upon collection, the ends of the sample was immediately covered with Teflon sheeting, capped, and labeled with a self-adhesive label identifying the sample number, location, date and time of collection. The samples were submitted to Chromalab, a state-certified laboratory for composite analysis of each 25 foot area for total lead by Environmental Protection Agency (EPA) test method 6010.

Results of the verification analysis indicated detectable concentrations of lead up to 15 mg/kg which were considered to be within background limits. Laboratory results with chain of custody for the verification soil samples are attached in Appendix B. The remedial efforts were determined successful in removing all material containing hazardous concentrations of lead as required prior to site development.

DEMOLITION

In August 1995, after remedial action was complete, the site was prepared for construction including building demolition, grubbing, and clearing. Decon Environmental Services, contractor, prepared the site for construction. Buildings and vegetation were removed as non-hazardous construction waste and the site was graded in preparation for construction. Planned development is illustrated on Figure 3.

Former Island Gun Club
Summary Report
November 2, 1995
Page 3

WORK TO BE COMPLETED

The site is currently vacant, cleared, and graded in preparation for construction. A ditch which bisects the site will be channeled into a subsurface culvert to reduce surface drainage. The site will have designated areas for parking, RV storage and landscaping. Figure 3 illustrated the proposed site development plan. The areas designated for parking and RV storage will be sealed with a 4 inch thick asphalt cap and buildings will be constructed. The areas designated for landscaping will not receive an asphalt cap, but various types of vegetation will be planted. Prior to landscaping, six inches of fill material will be added to the areas designated for landscaping. The six inch fill cap and vegetation designated for the landscape areas are adequate to reduce human health risk for possible exposure to constituents left onsite. After removal of the lead hot spots, inhalation of lead in near-surface soil from dust and cracks in the asphalt was evaluated in the human health risk assessment. The risk assessment determined that only minimal risk will be associated with the inhalation of dust for long-term workers onsite. Therefore, landscaped areas are acceptable for the proposed site usage.

CONCLUSIONS

Work has been completed to date in accordance with requirements of the Alameda County Health Care Services Agency for final site closure. The site has been adequately investigated and designated hot spots removed in accordance with the human health risk assessment recommendations. The proposed site development plan and ultimate site usage are within the designated parameters for minimal human health risk. Therefore, on behalf of Harbor Bay Village Five Associates and the City of Alameda, ACC recommends that no further investigation, remediation action, or assessment be performed at the Former Island Gun Club and the proposed construction plan be approved.

If you have any comments regarding this report, please call me at (510) 638-8400.

Sincerely,

Misty C. Kaltreider
Project Geologist

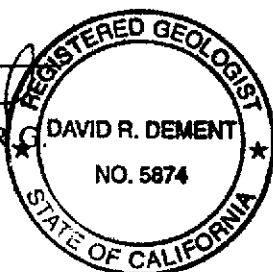

David DeMont, R.G.
Senior Geologist

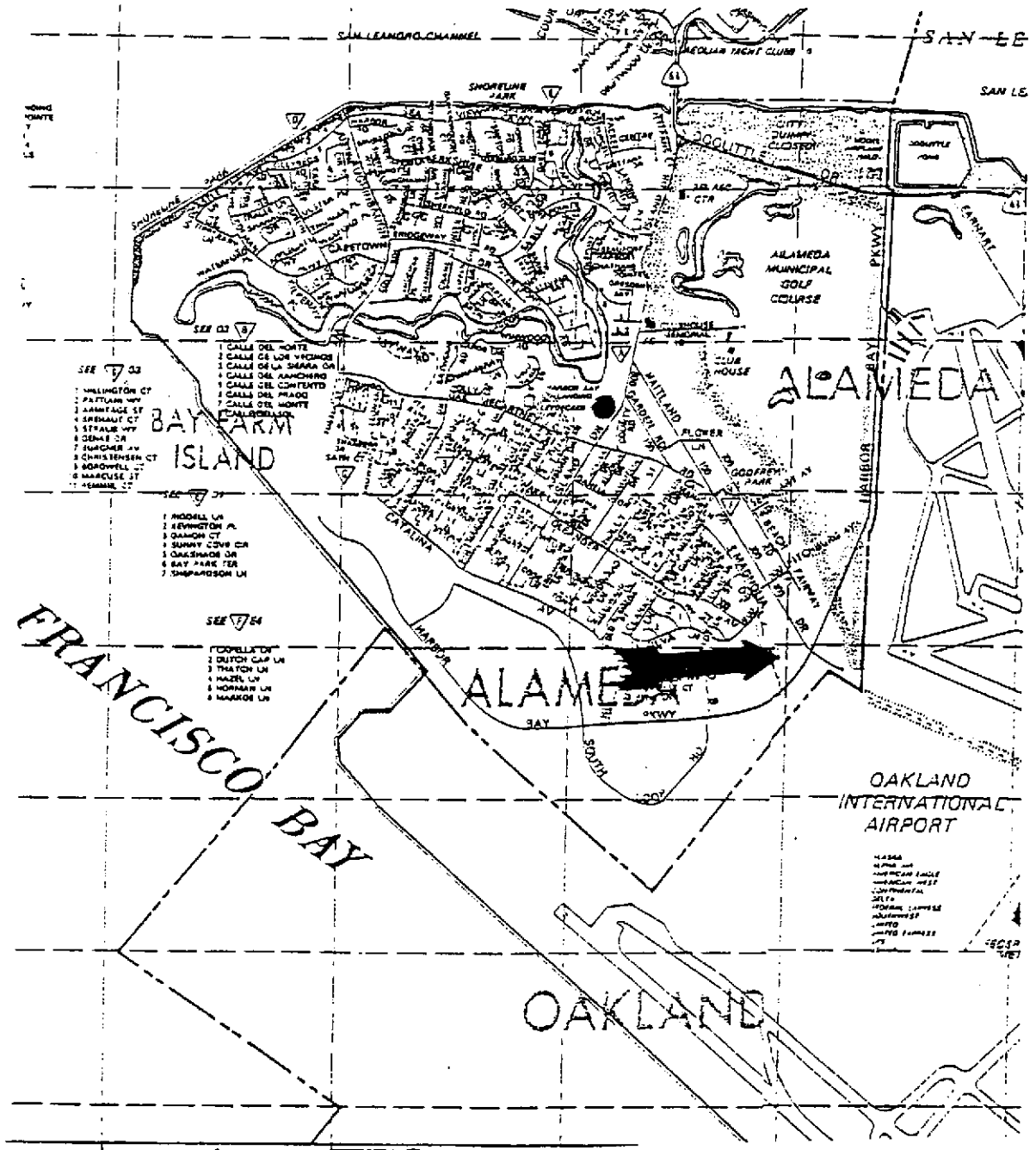

cc: Mr. Aidan Barry - Harbor Bay Isle Associates
Mr. Bob Warnick / Mr. Dick Rudloff - City of Alameda

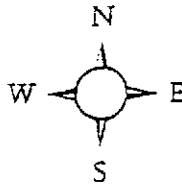

- SEE 17 03
- 1 WASHINGTON CT
 - 2 PATRIOT HWY
 - 3 ARMITAGE ST
 - 4 SPRING CT
 - 5 ST PAUL HWY
 - 6 DENAL DR
 - 7 SARGENT AV
 - 8 CHRIS JENSEN CT
 - 9 BROADWELL CT
 - 10 MARCUS ST
 - 11 HERMAN CT
- SEE 17 04
- 1 PROCELL LN
 - 2 KEVIN TOMPKINS PL
 - 3 QUINCY CT
 - 4 SUNNY CREEK DR
 - 5 OAKSHADE DR
 - 6 BAY PARK TER
 - 7 SIMPSON LN
- SEE 17 05
- 1 COVELL CT
 - 2 DUTCH GAP LN
 - 3 TRAYTON LN
 - 4 HAZEL LN
 - 5 MORROW LN
 - 6 MARKER LN



Location Map
Former Gun Club
500 Maitland Drive, Alameda

Source: Thomas Brothers

Scale: 1" = 2200'

1/27/1994	Drawn By: CS	Project: 6140-1	Figure 1
ACC Environmental Consultants • 1000 Atlantic Avenue, Suite 110 • Alameda, CA 94501 • (510) 522-3188 Fax: (510) 865-5731			

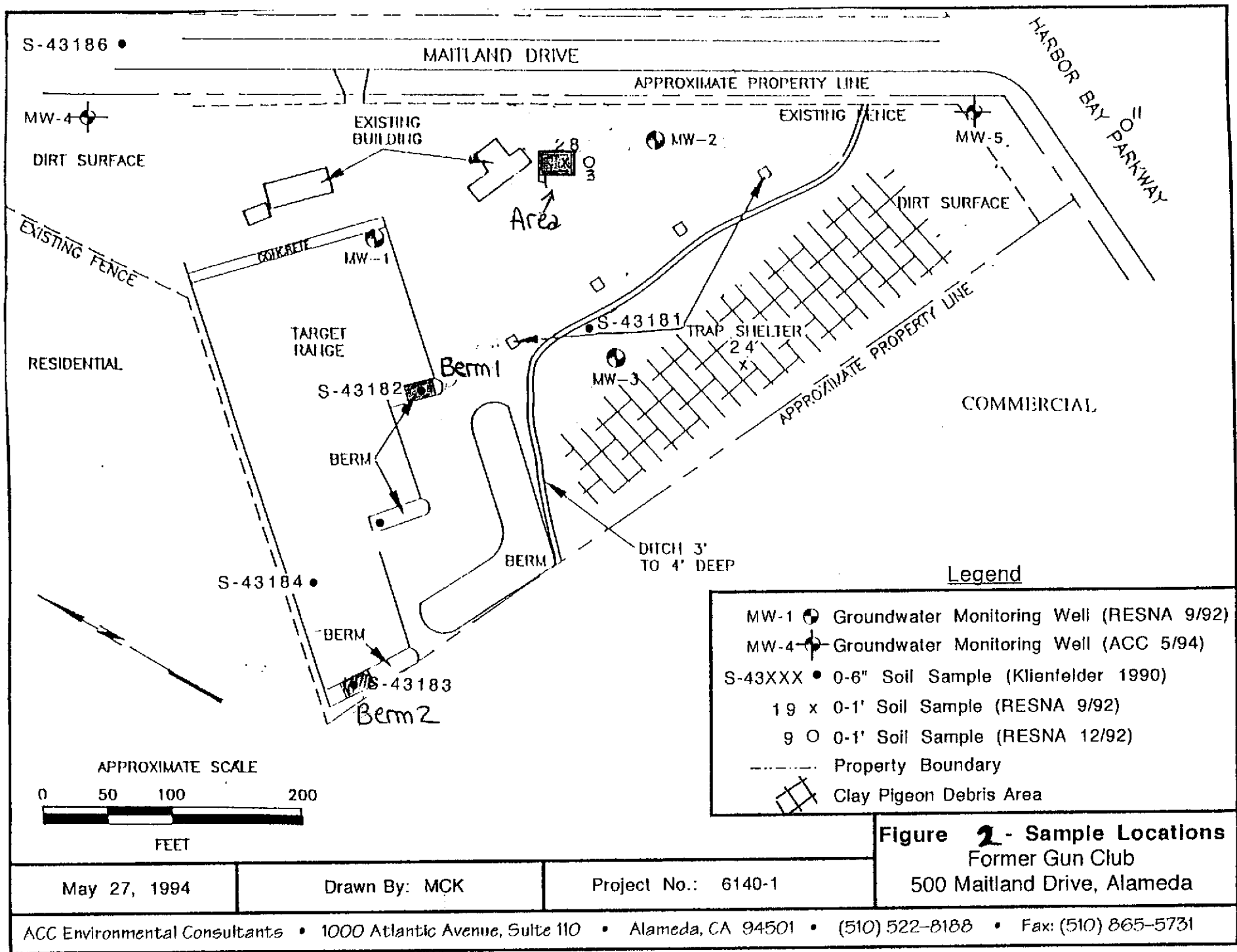

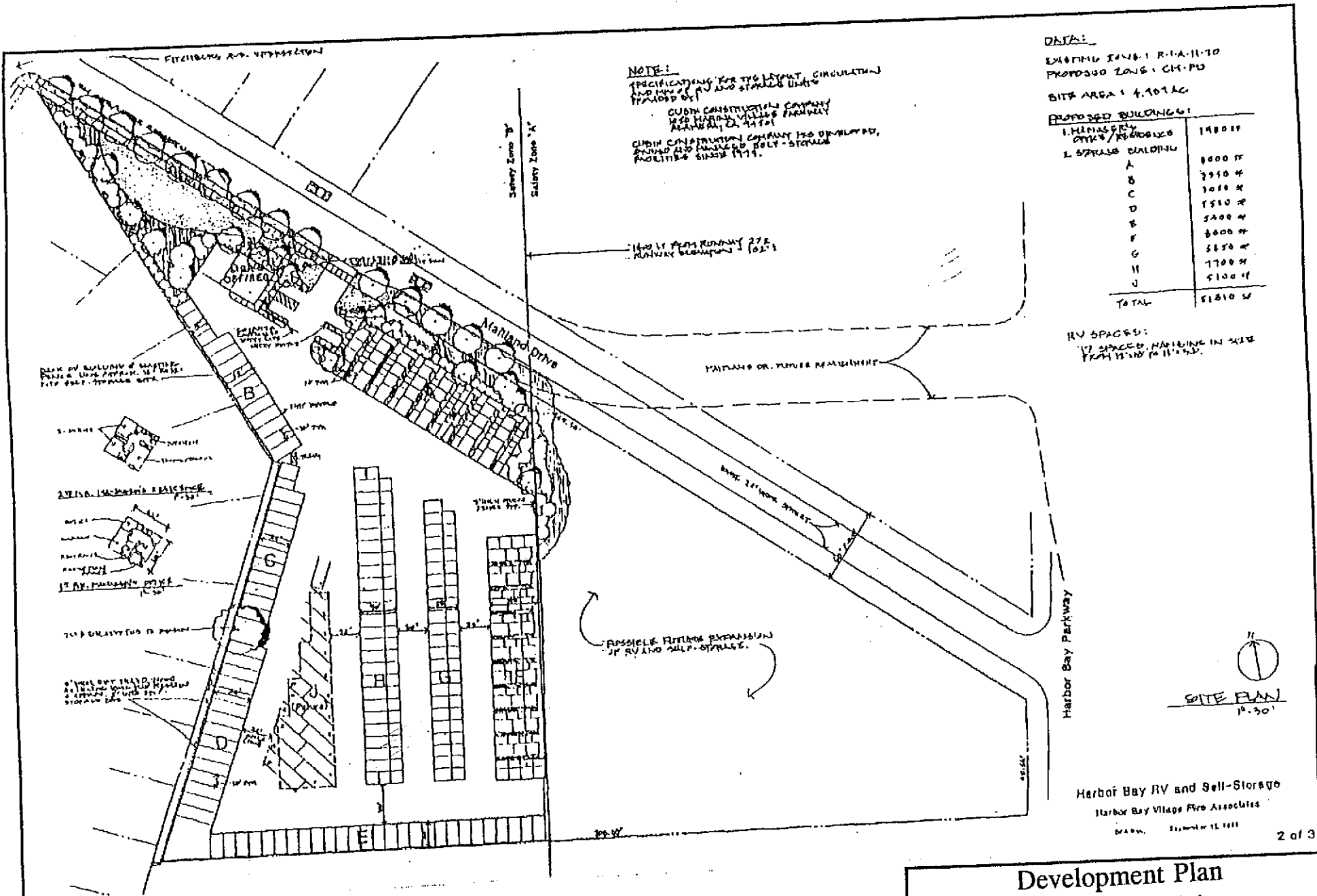

NOTE:
 SPECIFICATIONS FOR THE LAYOUT, CIRCULATION AND RAMPING OF RV AND STORAGE UNITS TRAFFIC BY:
 CUSH CONSTRUCTION COMPANY
 1230 HARRISVILLE PARKWAY
 ALAMEDA, CA 94501
 CUSH CONSTRUCTION COMPANY HAS DEVELOPED, OWNED AND MANAGED SELF-STORAGE FACILITIES SINCE 1975.

DATA:
 EXISTING ZONE: R-1A-11-70
 PROPOSED ZONE: CH-PO
 SITE AREA: 4.907 AC

PROPOSED BUILDINGS:

ITEMS PER OFFICE/RELOCATED	1980 SF
L OFFICE BUILDING	
A	8000 SF
B	3950 SF
C	3050 SF
D	1950 SF
E	3400 SF
F	8000 SF
G	2850 SF
H	1700 SF
J	5100 SF
TOTAL	51810 SF

RV SPACES:
 17 SPACES, MARKING IN SIZE FROM 12'x10' TO 11'x14'.

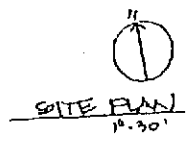

Harbor Bay RV and Self-Storage
 Harbor Bay Village Fire Associates
 DRAWN: 11/11/94

Development Plan
Former Gun Club
500 Maitland Drive, Alameda

September 12, 1994

Drawn By: MCK

Project: 94-6140-1

Figure: 3

ACC Environmental Consultants • 1000 Atlantic Avenue, Suite 110 • Alameda, CA 94501 • (510) 522-8188 Fax: (510) 865-5731

US Ecology Realty, NY 0700-078 87031

01/17/77

5:00 PM
5:12 PM
ID 20461190

12/11/77

Fairbanks Scales

WEIGHMASTER

SIGNATURE _____

GROSS LB.
TARE LB.
NET LB.

74240 1b GP
32120 1b TA
42120 1b NT

74240 1b IN

US Ecology Realty, Inc. 0702 500 0000

45.3370

11:30 AM

LEON B. H.

0:15PM

10 20461435

Fairbanks Scales

WEIGHMASTER

SIGNATURE _____

GROSS	LB.	77840	16	GR
TARE	LB.	30520	16	TA
NET	LB.	47320	16	NT

77840 16 IN

US Ecology Realty, Inc. 1750 57th Street

10/11/77

6:30 PM
10:00 AM
10 00451499

10/11/77

Fairbanks Scales

WEIGHMASTER

SIGNATURE _____

GROSS	LB.	53200	1b	OR
TARE	LB.	31880	1b	TA
NET	LB.	31320	1b	NT

53200 1b IN

US Geology Rept. No. 1702-150-0207

10/10/10

10:30 AM
10:30M
JB 00461434

10:30 AM

Fairbanks Scales

WEIGHMASTER

SIGNATURE _____

GROSS	LB.	72900	1b	GR
TARE	LB.	31620	1b	TO
NET	LB.	41280	1b	NT

72900 1b IN

US Ecology Health, Hy (2010-0715-0013)

000-100

6-30-95
1013201
ID 30461497

1001 701

Fairbanks Scales

WEIGHMASTER

SIGNATURE _____

GROSS	LB.	73400	1b	GR
TARE	LB.	31440	1b	TA
NET	LB.	42040	1b	NT

73480 1b 1H

IN CASE OF AN EMERGENCY OR SPILL, CALL THE NATIONAL RESPONSE CENTER 1-800-424-8802; WITHIN CALIFORNIA CALL 1-800-424-7000

UNIFORM HAZARDOUS WASTE MANIFEST		1. Generator's US EPA ID No. CA1C1010109111161018		Manifest Document No. 0101014		2. Page 1 1 of 1		Information in the shaded areas is not required by Federal law.					
3. Generator's Name and Mailing Address City of Alameda Santa Clara/Oak St., Alameda, CA 94501						A. State Manifest Document Number 90461496							
4. Generator's Phone (510-522-8188						B. State Generator's ID							
5. Transporter 1 Company Name Dwight Trucking				6. US EPA ID Number CAAD9810694723		C. State Transporter's ID 604100							
7. Transporter 2 Company Name						D. Transporter's Phone							
8. US EPA ID Number						E. State Transporter's ID							
9. Designated Facility Name and Site Address US Ecology Nevada Hwy 95, 12 miles So. of Beatty Beatty, NV 89003						F. Transporter's Phone 3991877							
10. US EPA ID Number NV1T3310101101010						G. State Facility's ID							
11. US DOT Description (Including Proper Shipping Name, Hazard Class, and ID Number)						12. Containers No. Type		13. Total Quantity		14. Unit Wt/Vol		I. Waste No.	
a. Non RCRA Hazardous Waste Solid (Lead Soil)						001 RT000204				State 611		EPA/Other N/A	
b.										State		EPA/Other	
c.										State		EPA/Other	
d.										State		EPA/Other	
J. Additional Descriptions for Materials Listed Above Nevada Waste Stream #07 012 4435 Emergency Contact #702-553-2203						K. Handling Codes for Wastes Listed Above a. b. c. d.							
15. Special Handling Instructions and Additional Information Site Address : 500 Maitland Avenue Alameda CA 94501													
16. GENERATOR'S CERTIFICATION: I hereby declare that the contents of this consignment are fully and accurately described above by proper shipping name and are classified, packed, marked, and labeled, and are in all respects in proper condition for transport by highway according to applicable international and national government regulations. If I am a large quantity generator, I certify that I have a program in place to reduce the volume and toxicity of waste generated to the degree I have determined to be economically practicable and that I have selected the practicable method of treatment, storage, or disposal currently available to me which minimizes the present and future threat to human health and the environment; OR, if I am a small quantity generator, I have made a good faith effort to minimize my waste generation and select the best waste management method that is available to me and that I can afford.													
17. Transporter 1 Acknowledgement of Receipt of Materials						Printed/Typed Name Aidan Barry P.M. A092-1		Signature <i>[Signature]</i>		Month Day Year 062895			
18. Transporter 2 Acknowledgement of Receipt of Materials						Printed/Typed Name Jerry Parkinson		Signature <i>[Signature]</i>		Month Day Year 10612895			
19. Discrepancy Indication Space						Printed/Typed Name		Signature		Month Day Year			
20. Facility Owner or Operator Certification of receipt of hazardous materials covered by this manifest except as noted in Item 19.													
Printed/Typed Name LORI TAGUCHI						Signature <i>[Signature]</i>		Month Day Year 1063095					

Do Not Write Below This Line

Please print or type. Form designed for use on elite (12-pitch typewriter).

IN CASE OF AN EMERGENCY OR SPILL, CALL THE NATIONAL RESPONSE CENTER 1-800-424-8802; WITHIN CALIFORNIA CALL 1-800-852-7550

UNIFORM HAZARDOUS WASTE MANIFEST		1. Generator's US EPA ID No. CACI00009116080100015			Manifest Document No. 1 of 1		2. Page 1 Information in the shaded areas is not required by Federal law.		
		3. Generator's Name and Mailing Address City of Alameda Santa Clara/Oak St., Alameda, CA 94501 4. Generator's Phone (510-522-8188						A. State Manifest Document Number 90461495	
5. Transporter 1 Company Name Dwight		6. US EPA ID Number CA09801694723		C. State Transporter's ID 604160		D. Transporter's Phone 805-3991877		B. State Generator's ID CACI000911608	
7. Transporter 2 Company Name		8. US EPA ID Number		E. State Transporter's ID		F. Transporter's Phone		G. State Facility's ID	
9. Designated Facility Name and Site Address US Ecology Nevada Hwy 95, 12 miles So. of Beatty Beatty, NV 89003		10. US EPA ID Number NV133101101010		H. Facility's Phone 702-553-2203					
11. US DOT Description (Including Proper Shipping Name, Hazard Class, and ID Number)				12. Containers	13. Total Quantity	14. Unit	15. Waste No.		
a. Non RCRA Hazardous Waste Solid (Lead Soil)				No. Type		Wt/Vol	State Waste No.		
							EPA/Other		
b.							State		
c.							EPA/Other		
d.							State		
							EPA/Other		
J. Additional Descriptions for Materials Listed Above Nevada Waste Stream #07 012 4435 Emergency Contact #702-553-2203				K. Handling Codes for Wastes Listed Above					
				a.		b.			
				c.		d.			
15. Special Handling Instructions and Additional Information Site Address : 500 Maitland Avenue Alameda CA 94501									
16. GENERATOR'S CERTIFICATION: I hereby declare that the contents of this consignment are fully and accurately described above by proper shipping name and are classified, packed, marked, and labeled, and are in all respects in proper condition for transport by highway according to applicable international and national government regulations. If I am a large quantity generator, I certify that I have a program in place to reduce the volume and toxicity of waste generated to the degree I have determined to be economically practicable and that I have selected the practicable method of treatment, storage, or disposal currently available to me which minimizes the present and future threat to human health and the environment; OR, if I am a small quantity generator, I have made a good faith effort to minimize my waste generation and select the best waste management method that is available to me and that I can afford.									
Printed/Typed Name AIGAN BAXLEY P.M. A092-1				Signature 				Month Day Year 06 28 95	
17. Transporter 1 Acknowledgement of Receipt of Materials									
Printed/Typed Name BRUCE BOERMAN				Signature 				Month Day Year 10 6 28 95	
18. Transporter 2 Acknowledgement of Receipt of Materials									
Printed/Typed Name				Signature				Month Day Year	
19. Discrepancy Indication Space									
20. Facility Owner or Operator Certification of receipt of hazardous materials covered by this manifest except as noted in Item 19.									
Printed/Typed Name LORI TAGUCHI				Signature 				Month Day Year 06 30 95	

Do Not Write Below This Line

Please print or type. Form designed for use on a 12-pitch typewriter.

UNIFORM HAZARDOUS WASTE MANIFEST		1. Generator's US EPA ID No. CA 9000911608		Manifest Document No. 010083	2. Page 1 1 of 1		Information in the shaded areas is not required by Federal law.	
3. Generator's Name and Mailing Address City of Alameda Santa Clara/Oak St., Alameda, CA 94501					A. State Manifest Document Number 90461490			
4. Generator's Phone (510-522-8188)					B. State Generator's ID CAC009911608			
5. Transporter 1 Company Name Suzanne Tabor Road Mill		8. US EPA ID Number CA 0001022466		C. State Transporter's ID CA 0001022466 340		D. Transporter's Phone 710 571 1979		
7. Transporter 2 Company Name		8. US EPA ID Number		E. State Transporter's ID		F. Transporter's Phone		
9. Designated Facility Name and Site Address US Ecology Nevada Hwy 95, 12 miles So. of Beatty Beatty, NV 89003					10. US EPA ID Number NV T333001101010		G. State Facility's ID	
					H. Facility's Phone 702-553-2203			
11. US DOT Description (Including Proper Shipping Name, Hazard Class, and ID Number)				12. Containers No. Type	13. Total Quantity	14. Unit Wt/Vol	1. Waste No.	
a. Non RCRA Hazardous Waste Solid (Lead Soil)				0,01 QT	00,020	Y	State 611	EPA/Other N/A
b.							State	EPA/Other
c.							State	EPA/Other
d.							State	EPA/Other
J. Additional Descriptions for Materials Listed Above Nevada Waste Stream #07 012 4435 Emergency Contact #702-553-2203					K. Handling Codes for Wastes Listed Above a. b. c. d.			
15. Special Handling Instructions and Additional Information Site Address : 500 Maitland Avenue Alameda CA 94501								
16. GENERATOR'S CERTIFICATION: I hereby declare that the contents of this consignment are fully and accurately described above by proper shipping name and are classified, packed, marked, and labeled, and are in all respects in proper condition for transport by highway according to applicable international and national government regulations. If I am a large quantity generator, I certify that I have a program in place to reduce the volume and toxicity of waste generated to the degree I have determined to be economically practicable and that I have selected the practicable method of treatment, storage, or disposal currently available to me which minimizes the present and future threat to human health and the environment; OR, if I am a small quantity generator, I have made a good faith effort to minimize my waste generation and select the best waste management method that is available to me and that I can afford.								
Printed/Typed Name AIDA BARRY P.M. AD 92-1				Signature <i>[Signature]</i>		Month Day Year 06/28/95		
17. Transporter 1 Acknowledgement of Receipt of Materials								
Printed/Typed Name Suzanne Tabor Road Mill				Signature <i>[Signature]</i>		Month Day Year 06/28/95		
18. Transporter 2 Acknowledgement of Receipt of Materials								
Printed/Typed Name				Signature		Month Day Year		
19. Discrepancy Indication Space								
20. Facility Owner or Operator Certification of receipt of hazardous materials covered by this manifest except as noted in item 19.								
Printed/Typed Name DAN SHAMM				Signature <i>[Signature]</i>		Month Day Year 10/30/95		

IN CASE OF AN EMERGENCY OR SPILL, CALL THE NATIONAL RESPONSE CENTER 1-800-424-8802. WITHIN CALIFORNIA CALL 1-800-802-7353

Do Not Write Below This Line

Please print or type. Form designed for use on elite (12-pitch typewriter).

UNIFORM HAZARDOUS WASTE MANIFEST		1. Generator's US EPA ID No. CA1C19009111608		Manifest Document No. 00992		2. Page 1 1 of 1		Information in the shaded areas is not required by Federal law.		
3. Generator's Name and Mailing Address City of Alameda Santa Clara/Oak St., Alameda, CA 94501						A. State Manifest Document Number 90461494				
4. Generator's Phone (510-522-8188)						B. State Generator's ID CA999911608				
5. Transporter 1 Company Name JENSEN TRUCKING				8. US EPA ID Number CAF 930965920		C. State Transporter's ID 600585		D. Transporter's Phone 916-677-8394		
7. Transporter 2 Company Name				8. US EPA ID Number		E. State Transporter's ID		F. Transporter's Phone		
9. Designated Facility Name and Site Address US Ecology Nevada Hwy 95, 12 miles So. of Beatty Beatty, NV 89003						10. US EPA ID Number NVT1330101101010		G. State Facility's ID		
						H. Facility's Phone 702-553-2203				
11. US DOT Description (Including Proper Shipping Name, Hazard Class, and ID Number)						12. Containers		13. Total Quantity	14. Unit Wt/Vol	15. Waste No.
a. Non RCRA Hazardous Waste Solid (Lead Soil)						611 DT		0.0020	Y	State 611 EPA/Other N/A
b.										State EPA/Other
c.										State EPA/Other
d.										State EPA/Other
J. Additional Descriptions for Materials Listed Above Nevada Waste Stream #07 012 4435 Emergency Contact #702-553-2203						K. Handling Codes for Wastes Listed Above a. b. c. d.				
15. Special Handling Instructions and Additional Information Site Address : 500 Maitland Avenue Alameda CA 94501										
16. GENERATOR'S CERTIFICATION: I hereby declare that the contents of this consignment are fully and accurately described above by proper shipping name and are classified, packed, marked, and labeled, and are in all respects in proper condition for transport by highway according to applicable international and national government regulations. If I am a large quantity generator, I certify that I have a program in place to reduce the volume and toxicity of waste generated to the degree I have determined to be economically practicable and that I have selected the practicable method of treatment, storage, or disposal currently available to me which minimizes the present and future threat to human health and the environment; OR, if I am a small quantity generator, I have made a good faith effort to minimize my waste generation and select the best waste management method that is available to me and that I can afford.										
Printed/Typed Name ALON BARRY P.M. AD 92-1						Signature <i>[Signature]</i>		Month Day Year 06 28 95		
17. Transporter 1 Acknowledgement of Receipt of Materials										
Printed/Typed Name DONALD C JENSEN						Signature <i>[Signature]</i>		Month Day Year 10 16 28 95		
18. Transporter 2 Acknowledgement of Receipt of Materials										
Printed/Typed Name ALON BARRY						Signature [Signature]		Month Day Year 06 28 95		
19. Discrepancy Indication Space										
20. Facility Owner or Operator Certification of receipt of hazardous materials covered by this manifest except as noted in Item 19.										
Printed/Typed Name Don Stewart						Signature <i>[Signature]</i>		Month Day Year 10 16 30 95		

IN CASE OF AN EMERGENCY OR SPILL, CALL THE NATIONAL RESPONSE CENTER 1-800-424-8802; WITHIN CALIFORNIA CALL 1-800-852-7550

Do Not Write Below This Line

Please print or type. Form designed for use on elite (12-pitch typewriter).

IN CASE OF AN EMERGENCY OR SPILL, CALL THE NATIONAL RESPONSE CENTER 1-800-424-8802; WITHIN CALIFORNIA CALL 1-800-852-7550

UNIFORM HAZARDOUS WASTE MANIFEST		1. Generator's US EPA ID No. CA C 0 0 0 9 1 1 6 0 8		Manifest Document No. 010991	2. Page 1 1 of 1		Information in the shaded areas is not required by Federal law.		
3. Generator's Name and Mailing Address City of Alameda Santa Clara/Oak St., Alameda, CA 94501					A. State Manifest Document Number 90461497				
4. Generator's Phone (510-522-8188)					B. State Generator's ID CA C 0 0 0 9 1 1 6 0 8				
5. Transporter 1 Company Name ANTIOCH ENVIRONMENTAL			8. US EPA ID Number CA 40 983 615147		C. State Transporter's ID 430739				
7. Transporter 2 Company Name					D. Transporter's Phone				
9. Designated Facility Name and Site Address US Ecology Nevada Hwy 95, 12 miles So. of Beatty Beatty, NV 89003					10. US EPA ID Number NV T 3 3 1 0 0 1 0 0 0 0		G. State Facility's ID		
					H. Facility's Phone 702-553-2203				
11. US DOT Description (Including Proper Shipping Name, Hazard Class, and ID Number)					12. Containers No. Type		13. Total Quantity		14. Unit Wt/Vol
a. Non RCRA Hazardous Waste Solid (Lead Soil)					001 DT 00020 Y				I. Waste No. State 611 EPA/Other N/A
b.									State EPA/Other
c.									State EPA/Other
d.									State EPA/Other
J. Additional Descriptions for Materials Listed Above Nevada Waste Stream # 07012 4435 Emergency Contact #702-553-2203					K. Handling Codes for Wastes Listed Above a. b. c. d.				
15. Special Handling Instructions and Additional Information Site Address : 500 Maitland Avenue Alameda CA 94501									
16. GENERATOR'S CERTIFICATION: I hereby declare that the contents of this consignment are fully and accurately described above by proper shipping name and are classified, packed, marked, and labeled, and are in all respects in proper condition for transport by highway according to applicable international and national government regulations. If I am a large quantity generator, I certify that I have a program in place to reduce the volume and toxicity of waste generated to the degree I have determined to be economically practicable and that I have selected the practicable method of treatment, storage, or disposal currently available to me which minimizes the present and future threat to human health and the environment; OR, if I am a small quantity generator, I have made a good faith effort to minimize my waste generation and select the best waste management method that is available to me and that I can afford.									
Printed/Typed Name AIGON BARRY P. T. AD92-1					Signature 			Month Day Year 06/28/95	
17. Transporter 1 Acknowledgement of Receipt of Materials									
Printed/Typed Name NICK DEPAOLA					Signature 			Month Day Year 06/28/95	
18. Transporter 2 Acknowledgement of Receipt of Materials									
Printed/Typed Name					Signature			Month Day Year	
19. Discrepancy Indication Space									
20. Facility Owner or Operator Certification of receipt of hazardous materials covered by this manifest except as noted in Item 19.									
Printed/Typed Name DAN SHEARER					Signature 			Month Day Year 06/23/95	

Do Not Write Below This Line

CHROMALAB, INC.

Environmental Services (SOB)

Submission #: 9507019

July 6, 1995

ACC ENVIRONMENTAL CONSULTANTS

Atten: Misty Kaltreider

Project#: 6140-1.2

Project: GUN CLUB
Received: July 5, 1995

re: 4 samples for Lead analysis.
Method: EPA 3050M/7420

Sampled: July 5, 1995

Matrix: SOIL
Run: 7512-D

Extracted: July 6, 1995
Analyzed: July 6, 1995

Spl #	Client Sample ID	LEAD (mg/Kg)	REPORTING LIMIT (mg/Kg)	BLANK RESULT (mg/Kg)	BLANK SPIKE RESULT (%)
94920	BERM 1A-B	14	5.0	N.D.	100
94921	BERM 2A-B	9.6	5.0	N.D.	100
94922	AREA 3A-B	15	5.0	N.D.	100
94923	AREA 3C-D	5.3	5.0	N.D.	100

Doina Danet
Chemist

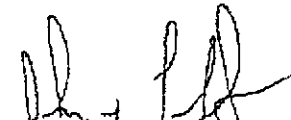
John S. Labash
Inorganic Supervisor

CHROMALAB, INC.

1220 Quarry Lane • Pleasanton, California 94566-4756
510/484-1919 • Facsimile 510/484-1096

Chain of Custody

Environmental Services (SDB) (DOHS 1094)

DATE _____ PAGE _____ OF _____

PROJ. MGR Misty Koltreider
 COMPANY ACC Environmental
 ADDRESS 1000 Atlantic Ave Suite 110
Alameda, CA 94501

SAMPLERS (SIGNATURE) Misty Koltreider (PHONE NO.) (510) 522-8188
 (FAX NO.) (510) 865-5731

ANALYSIS REPORT

SAMPLE ID.	DATE	TIME	MATRIX	PRESERV.	TPH - Gasoline (EPA 5030, 8015)	TPH - Gasoline (5030, 8015) w/BTEX (EPA 602, 8020)	TPH - Diesel, TEPH (EPA 3510/3550, 8015)	PURCEABLE AROMATICS BTEX (EPA 602, 8020)	PURCEABLE HALOCARBONS (EPA 601, 8010)	VOLATILE ORGANICS (EPA 624, 8240, 524.2)	BASE/NEUTRALS, ACIDS (EPA 625/627, 8270, 525)	TOTAL OIL & GREASE (EPA 5520, B+F, E+F)	PCB (EPA 608, 8080)	PESTICIDES (EPA 608, 8080)	TOTAL RECOVERABLE HYDROCARBONS (EPA 418.1)	LUFT METALS: Cd, Cr, Pb, Zn, Ni	CAM METALS (17)	PRIORITY POLLUTANT METALS (13)	TOTAL LEAD	EXTRACTION (TCLP, STLC)	NUMBER OF CONTAINERS
Berm 1A-B	7/5/85		S																X		1
Berm 2A-B																			X		1
Area 3A-B																			X		1
Area 3C-D																			X		1

PROJECT INFORMATION				SAMPLE RECEIPT			
PROJECT NAME: <u>Gun Club</u>		TOTAL NO. OF CONTAINERS <u>4</u>		HEAD SPACE		REC'D GOOD CONDITION/COLD	
PROJECT NUMBER <u>6140-1.2</u>		CONFORMS TO RECORD		TAT		STANDARD 5-DAY	
P.O. # <u>6140-1.2</u>		24		48		72	
SPECIAL INSTRUCTIONS/COMMENTS:		OTHER					

RELINQUISHED BY		RELINQUISHED BY		RELINQUISHED BY	
<u>Misty Koltreider</u> (SIGNATURE)	<u>7/5/85</u> (TIME)				
<u>Misty Koltreider</u> (PRINTED NAME)	<u>7/5/85</u> (DATE)				
<u>ACC Environmental</u> (COMPANY)					
<u>[Signature]</u> (SIGNATURE)	<u>7-5-85</u> (TIME)				
<u>[Signature]</u> (PRINTED NAME)	<u>7-5-85</u> (DATE)				
<u>Chromalab</u> (COMPANY)					