

LEGEND

- EXISTING MONITORING WELLS
- FORMER LEADED GAS UST'S
- LIMITS OF PIT EXCAVATION AT GRADE SURFACE
- LIMITS OF PIT BOTTOM
- WAREHOUSE AND OFFICE BUILDING

FIGURE 3

GEOSOLV, INC.

643 Oregon Street, Sonoma, California 95476

MAP OF FORMER UST EXCAVATIONS
WITH SOIL ANALYTICAL TEST RESULTS

THE HILL LUMBER COMPANY
1259 BRIGHTON AVENUE
ALBANY, CALIFORNIA

Project No. 0001.96

May 2, 1996

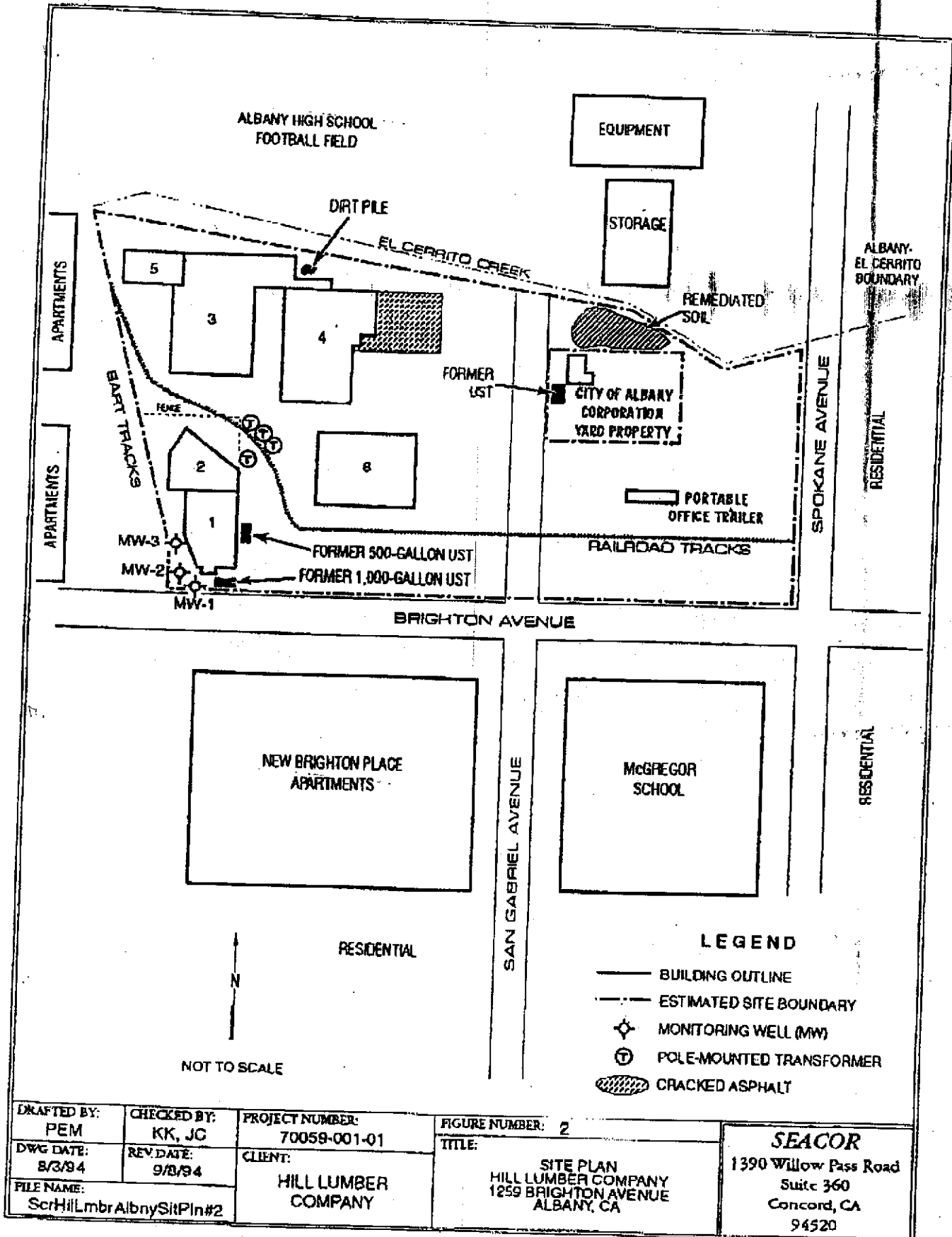

- LEGEND**
- BUILDING OUTLINE
 - - - ESTIMATED SITE BOUNDARY
 - ◆ MONITORING WELL (MW)
 - Ⓣ POLE-MOUNTED TRANSFORMER
 - ▨ CRACKED ASPHALT

DRAFTED BY: PEM	CHECKED BY: KK, JC	PROJECT NUMBER: 70059-001-01	FIGURE NUMBER: 2	SEACOR 1390 Willow Pass Road Suite 360 Concord, CA 94520
DWG DATE: 8/3/94	REV. DATE: 9/8/94	CLIENT: HILL LUMBER COMPANY	TITLE: SITE PLAN HILL LUMBER COMPANY 1259 BRIGHTON AVENUE ALBANY, CA	
FILE NAME: ScrHilLmbrAlbnySitPln#2				

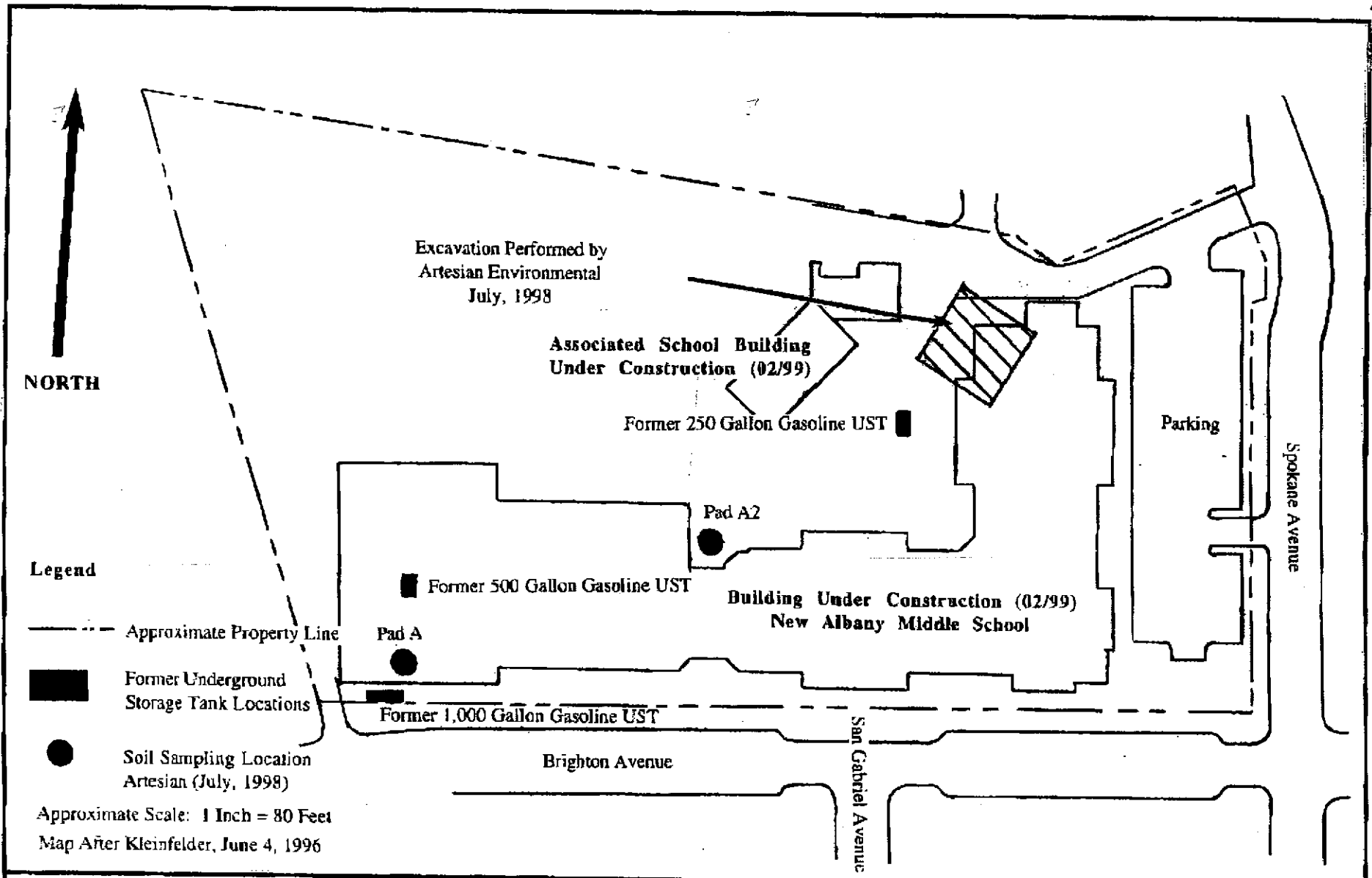

ARTESIAN ENVIRONMENTAL CONSULTANTS
 229 Tewksbury Avenue
 Pt. Richmond, California 94801
 Phone (510) 232-2728 Fax (510) 232-2823

NEW ALBANY MIDDLE SCHOOL: SITE PLAN
 Vila Construction Company
 Brighton and Spokane Avenues
 Albany, California

Project No.: 378-001-01

Date: 8/7/98

Prepared by: J. Jacobs

Figure 2