

URS Greiner Woodward Clyde

A Division of URS Corporation

500 12th Street, Suite 200
Oakland, CA 94607-4014
Tel: 510.893.3600
Fax: 510.874.3268
Offices Worldwide

ENVIRONMENTAL
PROTECTION
99 NOV 19 PM 2:09

November 18, 1999

Mr. Larry Seto
Alameda County Environmental Health Services
1131 Harbor Bay Parkway
Alameda, CA 94502-6577

Subject: Parcel T9 - 1155 Clay Street, Oakland
Project No. 510996706000

Dear Mr. Seto:

Pursuant to your letter dated November 5, 1999 and following up on our telephone conversation on November 18, 1999, URS Greiner Woodward Clyde (URSGWC) is pleased to provide the following clarifications and additional information:

1. A site map is enclosed. As you can see, the underground parking structure will cover the entire parcel.
2. As discussed by telephone, sampling locations have not been pre-selected since it is more prudent to select sampling locations based on field observations (e.g., PID measurements, odors, staining of soil, etc.) during the excavation. Furthermore, sampling of the walls of the excavation may not be possible since protective shoring may prohibit access to the excavation sidewalls. However, if it is technically feasible, then we would endeavor to collect excavation floor and sidewall samples on the basis of approximately one sample per 5,000 square feet of excavation surface (i.e., one sample approximately every 70 feet). Sidewall samples would be collected just above the water table where there is the potential to represent an off-site migration source, particularly in the southwest corner of the parcel.
3. Sampling of groundwater will be limited to the sampling required for the operation of the treatment system for site dewatering. This system will be operated under an NPDES permit that will likely require sampling of the groundwater prior to and after treatment. The results of such sampling will be conveyed to the County in a final report. Sampling of groundwater in the southwest corner of the parcel was performed in August 1999 (letter report dated August 27, 1999). No other sampling of groundwater targeted on the southwest corner of the parcel is envisioned at this time.
4. Groundwater analyses for the extracted groundwater from the dewatering system will be analyzed according to the terms of the NPDES permit. It is anticipated that this sampling will include TPH(d), TPH(g), BTEX and MTBE, as well as potentially other analyses.

With the submittal of this information, we are assuming that the County has no further environmental concerns with the redevelopment plans for this parcel.

Mr. Larry Seto
Alameda County Environmental Health Services
November 18, 1999
Page 2

We appreciate your attention to this subject matter. Please feel free to call me if you have any questions.

Sincerely,

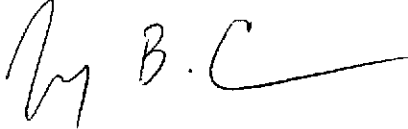
A handwritten signature in black ink, appearing to read "Jay B. Clare". The signature is fluid and cursive, with the first name "Jay" being the most prominent.

Jay B. Clare, P.E.
Project Manager

Enclosure

cc: Nicholas Loukianoff, Shorestein

OAKLAND
CITY CENTER
BLOCK T9



SHORENSTEIN
COMPANY, LLP.

KORTH
SUNSERI
HAGEY
ARCHITECTS
650 CALIFORNIA STREET
SAN FRANCISCO, CA 94108
415.954.1960
FAX 415.954.1970

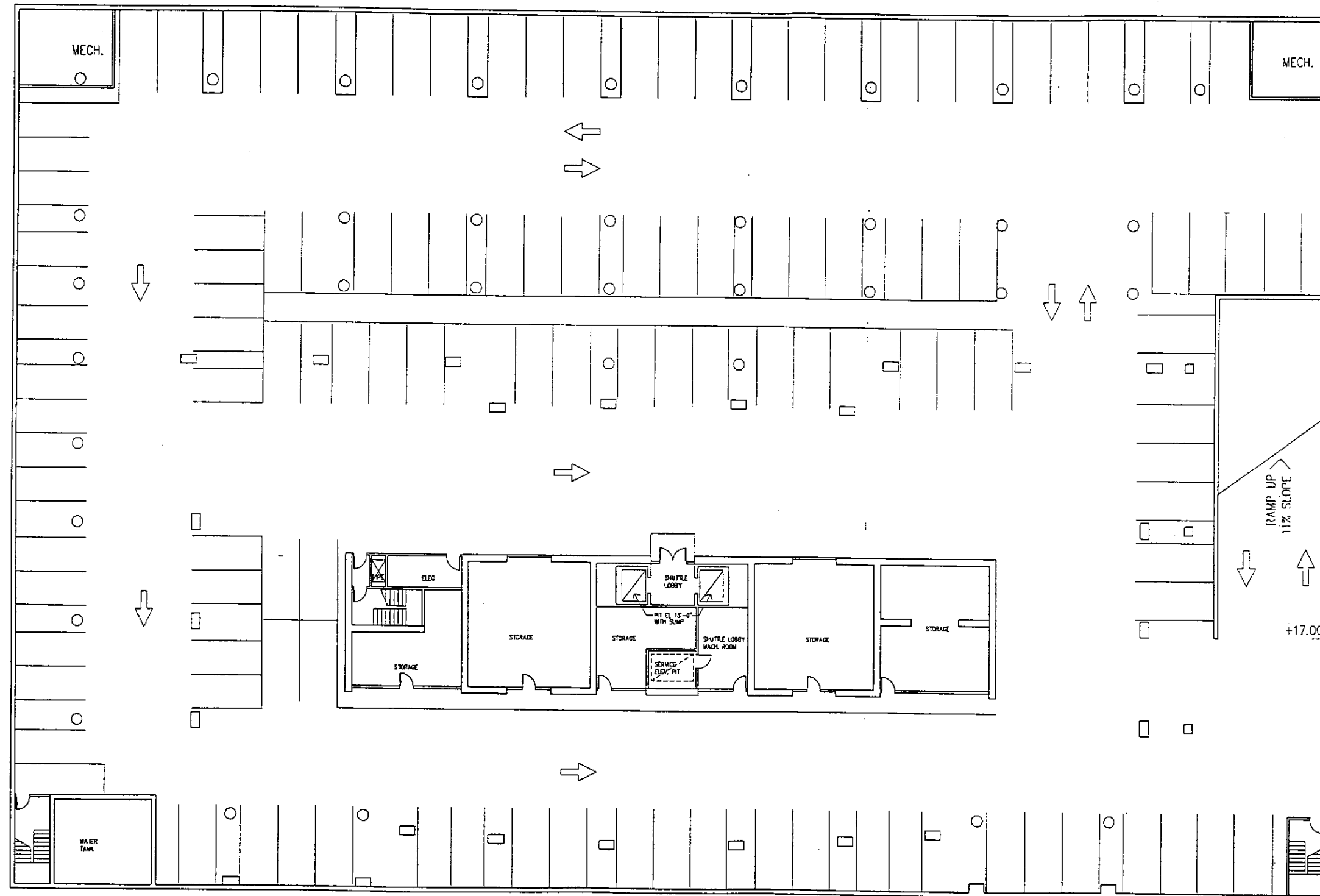

ISSUES AND REVISIONS
NO. DATE DESCRIPTION

PROJECT NUMBER

SHEET TITLE
P2 LEVEL: PARKING

SCALE
1/16" = 1'-0"

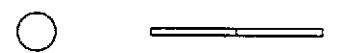

SHEET NUMBER

A2.01

OAKLAND
CITY CENTER
BLOCK T9



SHORENSTEIN
COMPANY, LLP.

KORTH
SUNSERI
HAGEY
ARCHITECTS
650 CALIFORNIA STREET
SAN FRANCISCO, CA 94108
415.954.1960
FAX 415.954.1970

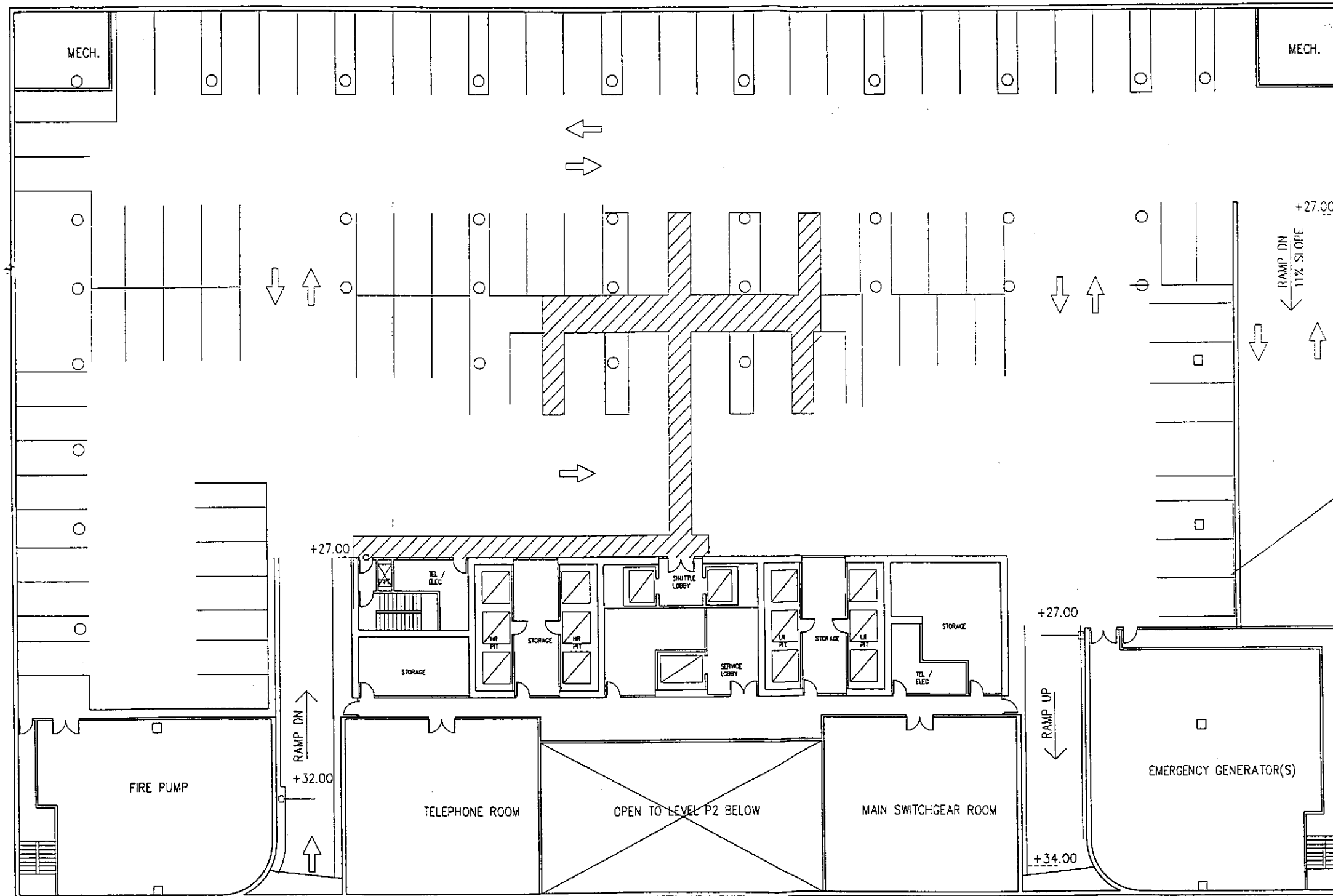

ISSUES AND REVISIONS		
NO.	DATE	DESCRIPTION

PROJECT NUMBER

SHEET TITLE
P1 LEVEL: PARKING

SCALE
1/16" = 1'-0"



SHEET NUMBER

A2.02

PROGRESS SET 01.00.00

ALL DIMENSIONS AND NOTATIONS SHOWN APPLYING HEREON CONSTITUTE ORIGINAL AND UNREVISED WORK OF THE ARCHITECT AND MAY NOT BE REPRODUCED, USED OR MODIFIED WITHOUT WRITTEN CONSENT OF THE ARCHITECT.

OAKLAND
CITY CENTER
BLOCK T9

SHORENSTEIN
SHORENSTEIN
COMPANY, LLP.

KORTH
SUNSERI
HAGEY
ARCHITECTS
650 CALIFORNIA STREET
SAN FRANCISCO, CA 94108
415.954.1980
FAX 415.954.1970

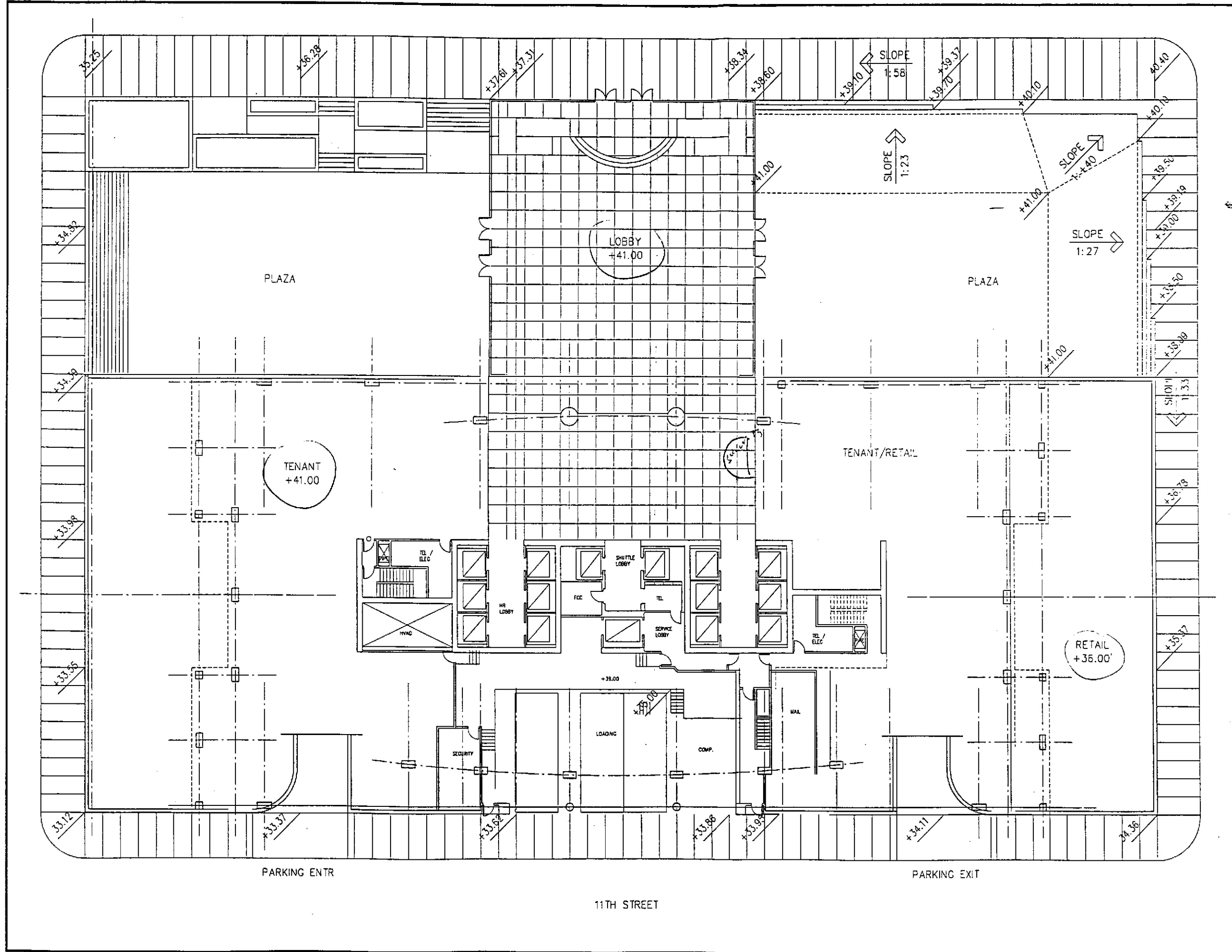

ISSUES AND REVISIONS

NO.	DATE	DESCRIPTION

PROJECT NUMBER

SHEET TITLE
GROUND FLOOR PLAN

SCALE
1/16" = 1'-0"

SHEET NUMBER

A2.03

PROGRESS SET 01.00.00

ALL CHANGES AND REVISIONS SHALL BE APPROVED BY THE ARCHITECT AND SHALL NOT BE REPLACED UNLESS SO INDICATED BY THE ARCHITECT'S WRITTEN CONSENT.