

Well	Chemical	11/90	4/91	7/91	2/93	4/94	10/94	2/95	5/95	11/95	
MW-10	Benzene				210	3600				82	
	Toluene				480	3200				22	
	Ethylbenzene				510	1200				37	
	Xylenes				1200	5300				47	
	1,2-DCA				ND	13				<0.5	
	1,1-DCE					<2				<0.5	
	cis-1,2-DCE									<0.5	
	trans-1,2-DCE					2				<0.5	
	"DCE"				ND						
	PCE				ND	3.9					<0.5
	TCE				9.5	<2					<0.5
	Chloroform										<0.5
	1,1,2-TCA										
Bromoforn											
Chlorobenzene						<1					

Well	Chemical	11/90	4/91	7/91	2/93	4/94	10/94	2/95	5/95	11/95
MW-25	Benzene				100	<0.5				NA
	Toluene				230	<0.5				NA
	Ethylbenzene				270	<0.5				NA
	Xylenes				500	<0.5	<1			NA
	1,2-DCA				ND	9.3	5.2	NA	NA	NA
	1,1-DCE									
	cis-1,2-DCE					NR	<0.5	NA	NA	NA
	trans-1,2-DCE					<1	<0.5	NA	NA	NA
	"DCE"				ND					
	PCE				ND	3.9	<0.5	NA	NA	NA
	TCE				11	<2	<0.5	NA	NA	NA
	Chloroform					<1	1.3	NA	NA	NA
	1,1,2-TCA									
Bromoforn										
Chlorobenzene					<1	<0.5	NA	NA		

Well	Chemical	11/90	4/91	7/91	2/93	4/94	10/94	2/95	5/95	11/95	
MW-11	Benzene				NA	<0.5				<0.5	
	Toluene				NA	<0.5				<0.5	
	Ethylbenzene				NA	<0.5				<0.5	
	Xylenes				NA	<0.5				<0.5	
	1,2-DCA				ND	<2				1.4	
	1,1-DCE					<2					
	cis-1,2-DCE									<0.5	
	trans-1,2-DCE					1.5				<0.5	
	"DCE"				ND						
	PCE				5.8	2.5					1.3
	TCE				2	4.2					3
	Chloroform										<0.5
	1,1,2-TCA										
Bromoforn											
Chlorobenzene						<1					

Well	Chemical	11/90	4/91	7/91	2/93	4/94	10/94	2/95	2/95	5/95	11/95
MW-24	Benzene				ND	<0.5		7700	53	71	NA
	Toluene				ND	<0.5		1600	21	130	NA
	Ethylbenzene				ND	<0.5		1200	20	110	NA
	Xylenes				ND	<0.5		2100	46	200	NA
	1,2-DCA				ND	<2		6.5		3	NA
	1,1-DCE										
	cis-1,2-DCE					NR		<0.5		1.1	1.1
	trans-1,2-DCE					<1		<0.5		<0.5	<0.5
	"DCE"				ND						
	PCE				ND	1.9		<0.5		<0.5	<0.5
	TCE				ND	<1		<0.5		<0.5	<0.5
	Chloroform					<1		<0.5		<0.5	<0.5
	1,1,2-TCA										
	Bromoform										
	Chlorobenzene					<1		<0.5		<0.5	

Well	Chemical	11/90	4/91	7/91	2/93	4/94	10/94	2/95	2/95	5/95	11/95
MW-12	Benzene				620	1300	5200	1100	120	71	NA
	Toluene				1900	6300	6200	6200	200	130	NA
	Ethylbenzene				2200	1400	13000	2000	180	110	NA
	Xylenes				6000	12000	22000	15000	710	200	NA
	1,2-DCA				ND	<2	NA	<2		3	NA
	1,1-DCE										
	cis-1,2-DCE					NR	<0.5	<2		<0.5	NA
	trans-1,2-DCE					<1	NA	<2		<0.5	NA
	"DCE"				ND						
	PCE				ND	1.9	NA	<2		<0.5	NA
	TCE				2.4	<2	NA	<2		<0.5	NA
	Chloroform					<1	NA	<2		<0.5	NA
	1,1,2-TCA										
	Bromoform										
	Chlorobenzene					<1	NA	<2		<0.5	

Well	Chemical	11/90	4/91	7/91	2/93	4/94	10/94	2/95	5/95	11/95
MW-23	Benzene				ND	<0.5				
	Toluene				ND	<0.5				
	Ethylbenzene				ND	<0.5				
	Xylenes				ND	<0.5				
	1,2-DCA				ND	<2	0.53	<0.5	0.99	NA
	1,1-DCE									
	cis-1,2-DCE					NR	<0.5	<0.5	<0.5	NA
	trans-1,2-DCE					<1	<0.5	<0.5	<0.5	NA
	"DCE"				ND					
	PCE				ND	<1	<0.5	<0.5	<0.5	NA
	TCE				ND	<1	<0.5	<0.5	<0.5	NA
	Chloroform					<1	<0.5	<0.5	<0.5	NA
	1,1,2-TCA									
	Bromoform									
	Chlorobenzene					<1	<0.5	<0.5	<0.5	

Well	Chemical	11/90	4/91	7/91	2/93	4/94	10/94	2/95	5/95	11/95	
MW-20	Benzene				NA	21				<0.5	
	Toluene				NA	<0.5				<0.5	
	Ethylbenzene				NA	<0.5				<0.5	
	Xylenes				NA	<0.5				<0.5	
	1,2-DCA				ND	<2				<0.5	
	1,1-DCE					<2					
	cis-1,2-DCE									16	
	trans-1,2-DCE					58				0.61	
	"DCE"				NA						
	PCE				ND	57					<0.5
	TCE				ND	32					3.7
	Chloroform										<0.5
	1,1,2-TCA										
Bromoform											
Chlorobenzene						<1					

Well	Chemical	11/90	4/91	7/91	2/93	4/94	10/94	2/95	5/95	11/95
MW-19	Benzene				NA	<0.5	<0.5	<0.5	<0.5	NA
	Toluene				NA	<0.5	<0.5	<0.5	<0.5	NA
	Ethylbenzene				NA	<0.5	<0.5	<0.5	<0.5	NA
	Xylenes				NA	<0.5	<0.5	<0.5	<0.5	NA
	1,2-DCA				ND	<2	<0.5	<0.5	<0.5	NA
	1,1-DCE									
	cis-1,2-DCE					NR	<0.5	<0.5	<0.5	NA
	trans-1,2-DCE					<1	<0.5	<0.5	<0.5	NA
	"DCE"				NA					
	PCE				ND	1.1	<0.5	<0.5	<0.5	NA
	TCE				ND	<2	<0.5	<0.5	<0.5	NA
	Chloroform					<1	4.6	<0.5	<0.5	NA
	1,1,2-TCA									
Bromoform										
Chlorobenzene						<1	<0.5	<0.5	<0.5	

Well	Chemical	11/90	4/91	7/91	2/93	4/94	10/94	2/95	5/95	11/95	
MW-21	Benzene				NA	<0.5				<0.5	
	Toluene				NA	<0.5				<0.5	
	Ethylbenzene				NA	<0.5				<0.5	
	Xylenes				NA	<0.5				<0.5	
	1,2-DCA				ND	<2				<0.5	
	1,1-DCE					<2					
	cis-1,2-DCE									<0.5	
	trans-1,2-DCE					<1				<0.5	
	"DCE"				NA						
	PCE				ND	<1					<0.5
	TCE				ND	<1					<0.5
	Chloroform										<0.5
	1,1,2-TCA										
Bromoform											
Chlorobenzene						<1					

Well	Chemical	11/90	4/91	7/91	2/93	4/94	10/94	2/95	5/95	11/95	
MW-18	Benzene				NA	<0.5					
	Toluene				NA	<0.5					
	Ethylbenzene				NA	<0.5					
	Xylenes				NA	<0.5					
	1,2-DCA				ND	<2					
	1,1-DCE					<2					
	cis-1,2-DCE										
	trans-1,2-DCE					<1					
	"DCE"				NA						
	PCE				ND	1.4					
	TCE				ND	<2					
	Chloroform										
	1,1,2-TCA										
Bromoform											
Chlorobenzene						<1					

Well	Chemical	11/90	4/91	7/91	2/93	4/94	10/94	2/95	5/95	11/95	
MW-7 & 7B	Benzene	ND	ND	NA	NA	190				1.1	
	Toluene	ND	ND	NA	NA	<0.5				<0.5	
	Ethylbenzene	ND	ND	NA	NA	<0.5				<0.5	
	Xylenes	ND	ND	NA	NA	27				1.9	
	1,2-DCA	ND	ND	<0.3	ND	<2				<50	
	1,1-DCE	ND	ND	4.6		5.8					
	cis-1,2-DCE	440	90	170						1200	
	trans-1,2-DCE			2.6		13				<50	
	"DCE"	440	90	170	150						
	PCE	1900	1600	7800	5800	190					2100
	TCE	520	200	660	540	12					1200
	Chloroform										<50
	1,1,2-TCA				0.8						
Bromoform				1.7							
Chlorobenzene				4.8		31					

Well	Chemical	11/90	4/91	7/91	2/93	4/94	10/94	2/95	5/95	11/95
MW-17	Benzene				NA	<0.5	<0.5	<0.5	<0.5	NA
	Toluene				NA	<0.5	<0.5	<0.5	<0.5	NA
	Ethylbenzene				NA	<0.5	<0.5	<0.5	<0.5	NA
	Xylenes				NA	<0.5	<0.5	<0.5	<0.5	NA
	1,2-DCA				ND	<2	<0.5	<0.5	<0.5	NA
	1,1-DCE									
	cis-1,2-DCE									
	trans-1,2-DCE									
	"DCE"				NA					
	PCE				ND	2.4	<0.5	<0.5	<0.5	NA
	TCE				ND	<2	<0.5	<0.5	<0.5	NA
	Chloroform					<1	4	<0.5	<0.5	NA
	1,1,2-TCA									
Bromoform										
Chlorobenzene						<1	<0.5	<0.5	<0.5	

Well	Chemical
MW-8	Benzene
	Toluene
	Ethylbenzene
	Xylenes
	1,2-DCA
	1,1-DCE
	cis-1,2-DCE
	trans-1,2-DCE
	"DCE"
	PCE
	TCE
	Chloroform
	1,1,2-TCA
Bromoform	
Chlorobenzene	

©1996, by Kleinfelder, Inc.

1.4
 Δ 0.5
 Δ 0.5
 1.3
 3
 Δ 0.5

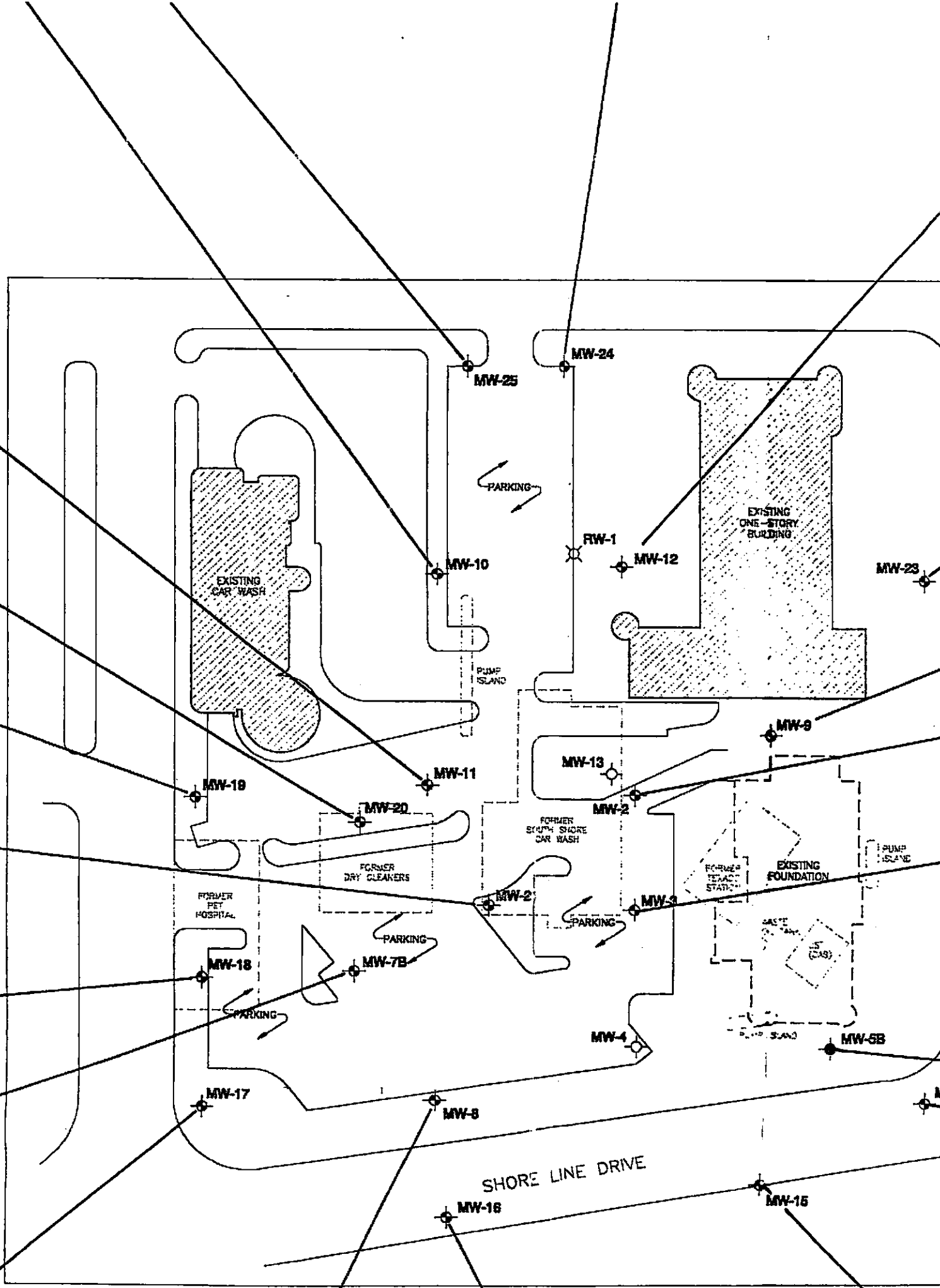

Chemical	11/90	4/91	7/91	2/93	4/94	10/94	2/95	5/95	11/95
Benzene	ND	ND	NA	NA	92				<0.5
Toluene	ND	ND	NA	NA	<0.5				<0.5
Ethylbenzene	ND	ND	NA	NA	<0.5				<0.5
Xylenes	ND	ND	NA	NA	<0.5				<0.5
1,2-DCA	ND	ND	Δ 0.3	ND	<2				<0.5
1,1-DCE	ND	ND	Δ 0.2		<2				
cis-1,2-DCE	1.2	6.8	1						44
trans-1,2-DCE			Δ 0.4		23				1.9
"DCE"	1.2	6.8	1	9					8
PCE	0.9	1.1	0.9	5	70				22
TCE	3	7.7	19	14	57				<0.5
Chloroform									
1,1,2-TCA			Δ 0.6						
Bromoform			Δ 0.7						
Chlorobenzene			Δ 0.7		<1				

Well	Chemical	11/90	4/91	7/91	2/93	4/94	10/94	2/95	5/95	11/95	
MW-16	Benzene				ND	<0.5	<0.5	<0.5	<0.5	NA	
	Toluene				ND	<0.5	<0.5	<0.5	<0.5	NA	
	Ethylbenzene				ND	<0.5	<0.5	<0.5	<0.5	NA	
	Xylenes				ND	<0.5	<0.5	<0.5	<0.5	NA	
	1,2-DCA				ND	Δ	<0.5	<0.5	<0.5	NA	
	1,1-DCE										
	cis-1,2-DCE					NR	<0.5	<0.5	<0.5	NA	
	trans-1,2-DCE					<1	<0.5	<0.5	<0.5	NA	
	"DCE"					ND					
	PCE					ND	<1	<0.5	<0.5	<0.5	NA
	TCE					ND	<2	<0.5	<0.5	<0.5	NA
	Chloroform						<1	6.1	<0.5	<0.5	NA
	1,1,2-TCA										
Bromoform											
Chlorobenzene						<1	<0.5	<0.5	<0.5		

Well	Chemical	11/90	4/91
MW-15	Benzene		
	Toluene		
	Ethylbenzene		
	Xylenes		
	1,2-DCA		
	1,1-DCE		
	cis-1,2-DCE		
	trans-1,2-DCE		
	"DCE"		
	PCE		
TCE			
Chloroform			
1,1,2-TCA			
Bromoform			
Chlorobenzene			

Well	Chemical	11/90	4/91	7/91	2/93	4/94	10/94	2/95	5/95	11/95
MW-23	Benzene				ND	<0.5				
	Toluene				ND	<0.5				
	Ethylbenzene				ND	<0.5				
	Xylenes				ND	<0.5				
	1,2-DCA				ND	<2	0.53	<0.5	0.99	NA
	1,1-DCE									
	cis-1,2-DCE					NR	<0.5	<0.5	<0.5	NA
	trans-1,2-DCE					<1	<0.5	<0.5	<0.5	NA
	"DCE"				ND					
	PCE				ND	<1	<0.5	<0.5	<0.5	NA
	TCE				ND	<2	<0.5	<0.5	<0.5	NA
	Chloroform					<1	<0.5	<0.5	<0.5	NA
	1,1,2-TCA									
	Bromoform									
Chlorobenzene					<1	<0.5	<0.5	<0.5		

Well	Chemical	11/90	4/91	7/91	2/93	4/94	10/94	2/95	5/95	11/95
MW-9	Benzene	ND	ND	<0.4		520				1.8
	Toluene	ND	ND	<0.3		2.8				5.6
	Ethylbenzene	ND	ND	<0.3		35				1.1
	Xylenes	ND	ND	<0.4		<0.5				5.8
	1,2-DCA	ND	ND	<0.3		<0.5				<0.5
	1,1-DCE	ND	ND	<0.2		<0.5				<0.5
	cis-1,2-DCE	ND	ND	<0.4		<0.5				<0.5
	trans-1,2-DCE	ND	ND	<0.4		<0.5				<0.5
	"DCE"	ND	ND	<0.4		<0.5				<0.5
	PCE	1.5	3.3	<0.5		<0.5				<0.5
	TCE	ND	ND	<0.3		<0.5				<0.5
	Chloroform			<0.6		<0.5				<0.5
	1,1,2-TCA			<0.7		<0.5				<0.5
	Bromoform			<0.7		<0.5				<0.5
Chlorobenzene			<0.7		<0.5				<0.5	

Well	Chemical	11/90	4/91	7/91	2/93	4/94	10/94	2/95	5/95	11/95
MW-2	Benzene	ND	ND	<0.4		<0.5				<0.5
	Toluene	ND	ND	<0.3		<0.5				<0.5
	Ethylbenzene	ND	ND	<0.3		<0.5				<0.5
	Xylenes	ND	ND	<0.4		<0.5				<0.5
	1,2-DCA	ND	ND	<0.3		<0.5				<0.5
	1,1-DCE	ND	ND	<0.2		<0.5				<0.5
	cis-1,2-DCE	ND	ND	<0.4		<0.5				<0.5
	trans-1,2-DCE	ND	ND	<0.4		<0.5				<0.5
	"DCE"	ND	ND	<0.4		<0.5				<0.5
	PCE	ND	ND	<0.5		<0.5				<0.5
	TCE	ND	ND	<0.3		<0.5				<0.5
	Chloroform			<0.6		<0.5				<0.5
	1,1,2-TCA			<0.7		<0.5				<0.5
	Bromoform			<0.7		<0.5				<0.5
Chlorobenzene			<0.7		<0.5				<0.5	

Well	Chemical	11/90	4/91	7/91	2/93	4/94	10/94	2/95	5/95	11/95
MW-3	Benzene	ND	ND	<0.4		<0.5				<0.5
	Toluene	0.5	ND	<0.3		<0.5				<0.5
	Ethylbenzene	ND	ND	<0.3		<0.5				<0.5
	Xylenes	ND	ND	<0.4		<0.5				<0.5
	1,2-DCA	ND	ND	<0.3		<0.5				<0.5
	1,1-DCE	ND	ND	<0.2		<0.5				<0.5
	cis-1,2-DCE	ND	ND	<0.4		<0.5				<0.5
	trans-1,2-DCE	ND	ND	<0.4		<0.5				<0.5
	"DCE"	ND	ND	<0.4		<0.5				<0.5
	PCE	ND	3	<0.5		8.2				20
	TCE	0.5	ND	<0.3		1.4				4
	Chloroform			<0.6		<0.5				<0.5
	1,1,2-TCA			<0.7		<0.5				<0.5
	Bromoform			<0.7		<0.5				<0.5
Chlorobenzene			<0.7		<0.5				<0.5	

Well	Chemical	11/90	4/91	7/91	2/93	4/94	10/94	2/95	5/95	11/95
MW-5B	Benzene	800	1300	3.1	210	<0.5				
	Toluene	12	45	3.7	4.2	<0.5				
	Ethylbenzene	320	370	13	1.9	<0.5				
	Xylenes	66	100	2.2	2	<0.5				
	1,2-DCA	ND	ND	<0.3	0.4	<0.5				
	1,1-DCE	ND	ND	<0.2	<0.5	<0.5				
	cis-1,2-DCE	ND	ND	<0.4	<0.5	<0.5				
	trans-1,2-DCE	ND	ND	<0.4	<0.5	<0.5				
	"DCE"	ND	ND	<0.4	5	<0.5				
	PCE	ND	ND	<0.5	ND	1.2				
	TCE	ND	ND	<0.3	3.4	10				
	Chloroform			<0.6	<0.5	<0.5				
	1,1,2-TCA			<0.7	<0.5	<0.5				
	Bromoform			<0.7	<0.5	<0.5				
Chlorobenzene			<0.7	<0.5	<0.5					

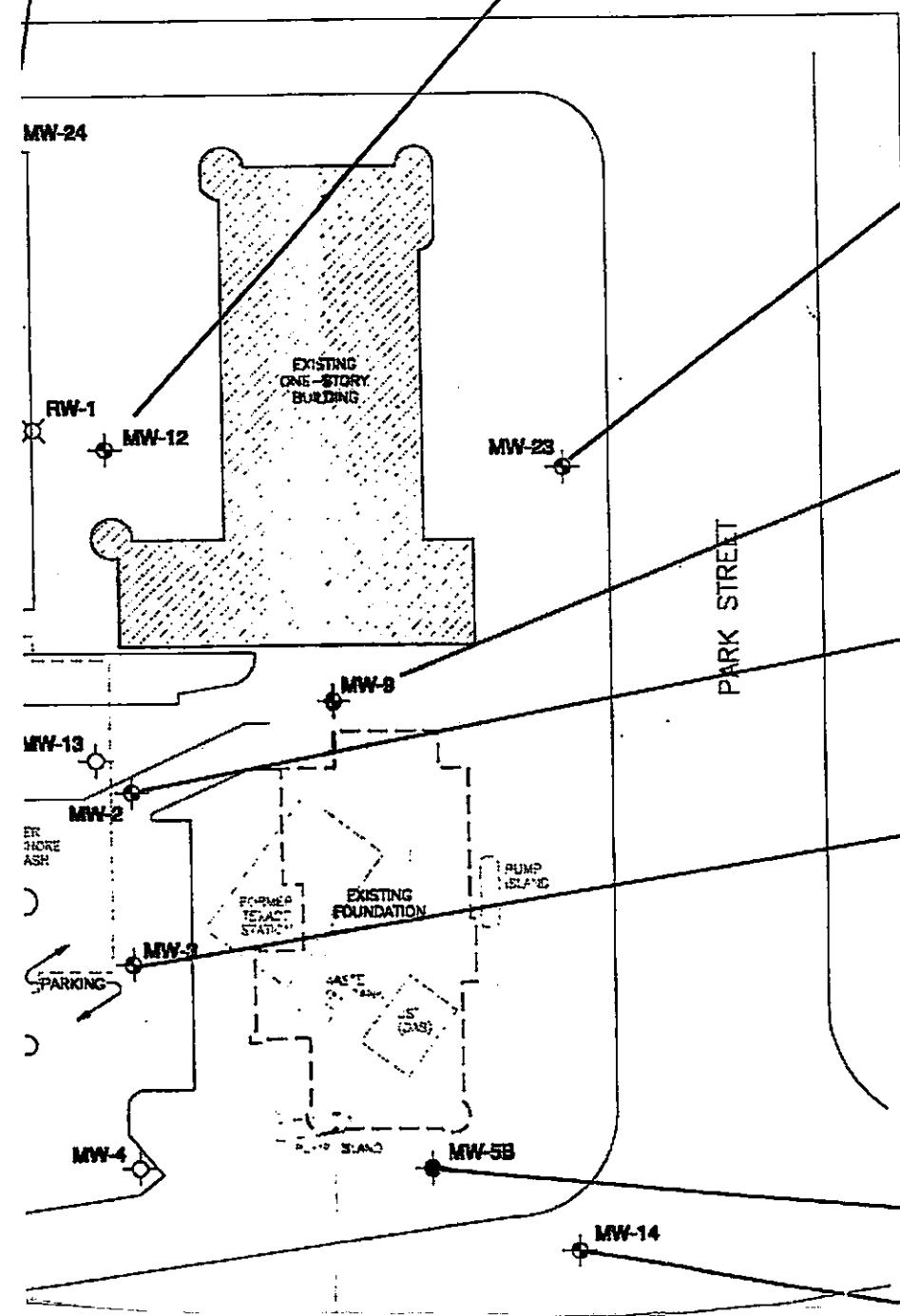

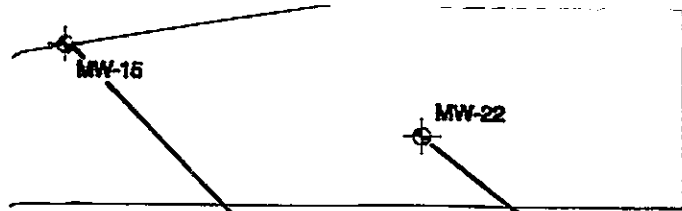

Well	Chemical	11/90	4/91	7/91	2/93	4/94	4/94	10/94	2/95	5/95	11/95
MW-14	Benzene		2.9	0.8	ND	0.95	0.96				
	Toluene		ND	0.8	ND	<0.5	<0.5				
	Ethylbenzene		ND	<0.3	ND	3.3	3.4				
	Xylenes		0.5	0.8	ND	15	15				
	1,2-DCA		4.6	0.6	3.4	8.4	9.7				
	1,1-DCE		0.5	<0.2		<2	<2				
	cis-1,2-DCE		ND	<0.4		<1	<1				
	trans-1,2-DCE			<0.4							
	"DCE"		ND	<0.4		ND					
	PCE		16	<1.5		ND	<1	<1			
	TCE		0.4	<1.3		ND	<2	<2			
	Chloroform										
	1,1,2-TCA			<1.6							
	Bromoform			<1.7							
Chlorobenzene			<0.7			<1	<1				

Well	Chemical	11/90	4/91	7/91	2/93	7/93	10/94	2/95	5/95	11/95
MW-22	Benzene				ND	<0.5	<0.5	<0.5	<0.5	NA
	Toluene				ND	<0.5	<0.5	<0.5	<0.5	NA
	Ethylbenzene				ND	<0.5	<0.5	<0.5	<0.5	NA
	Xylenes				ND	<0.5	<0.5	<0.5	<0.5	NA
	1,2-DCA				22	15	14	8.2	11	NA
	1,1-DCE					<2				
	cis-1,2-DCE					NR	<0.5	<0.5	<0.5	NA
	trans-1,2-DCE					<1	<0.5	<0.5	<0.5	NA
	"DCE"				ND					
	PCE				ND	<1	<0.5	<0.5	<0.5	NA
	TCE				ND	<2	<0.5	<0.5	<0.5	NA
	Chloroform					<1	0.65	<0.5	<0.5	NA
	1,1,2-TCA									
	Bromoform									
Chlorobenzene					<1	<0.5	<0.5	<0.5	NA	

Well	Chemical	11/90	4/91	7/91	2/93	4/94	10/94	2/95	5/95	11/95
MW-15	Benzene				ND	<0.5				
	Toluene				ND	<0.5				
	Ethylbenzene				ND	<0.5				
	Xylenes				ND	<0.5				
	1,2-DCA				ND	<2				
	1,1-DCE					<2				
	cis-1,2-DCE									
	trans-1,2-DCE					<1				
	"DCE"									
	PCE				ND	<1				
	TCE				ND	<2				
	Chloroform									
	1,1,2-TCA									
	Bromoform									
Chlorobenzene						<1				

LEGEND

- MONITORING WELL
- MONITORING/VAPOR EXTRACTION WELL
- RECOVERY WELL
- MONITORING WELL (DAMAGED)

NOTES:

Blank cells mean that nothing was reported for the given chemical.

"NA" means the chemical was reported as "Not Analyzed"

"ND" means the chemical was analyzed, but "Not Detected"

"<" means the chemical was analyzed and reported below the given detection limit

"DCE" means either total DCE, or DCE not differentiated into cis- or trans-isomers.

All values in micrograms per liter.

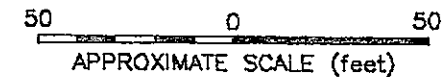

REFERENCE:
EVAX Technologies, Inc., "As-Built Site Map,
2375 Shore Line Drive, Alameda, California,"
dated 6-13-91.



**DATA COMPILATION,
SOUTH SHORE SHOPPING CENTER**

FIGURE

2

DRAFTED BY: L. Sue/G. Jett DATE: 6-13-96

HARSCH SOUTH SHORE
2375 SHORE LINE DRIVE
ALAMEDA, CALIFORNIA

CHECKED BY: E. Leach DATE: 6-13-96

PROJECT NO. 10-300301-003

MW-10						
Chemical	4/81	7/81	2/83	4/84	11/85	12/86
Benzene	11000	14000	210	3800	82	180
Toluene	20000	7000	480	3200	22	330
Ethylbenzene	3200	2700	510	1200	37	140
Xylenes	18000	8300	1200	5300	47	300
1,2-DCA	350	290	ND	NA	<0.5	NA
1,1-DCE	ND	ND	ND	NA		
cis-1,2-DCE	1	ND	ND	NA	<0.5	NA
trans-1,2-DCE	ND	ND	ND	NA	<0.5	NA
"DCE"	1	ND	ND	NA		
PCE	0.9	ND	ND	NA	<0.5	NA
TCE	4	ND	9.5	NA	<0.5	NA
Chloroform	ND	ND	ND	NA	<0.5	NA
1,1,2-TCA	0.5	ND	ND	NA		
Bromoform	ND	ND	ND	NA		
Chlorobenzene	ND	ND	ND	NA		
TPH-g	180000	58000	66000	90000	18000	46000
MTBE	NA	NA	NA	NA	NA	ND

MW-25							
Chemical	2/83	4/84	10/84	2/88	5/88	11/88	12/88
Benzene	ND	ND	ND	ND	NA	NA	ND
Toluene	ND	ND	ND	ND	NA	NA	ND
Ethylbenzene	ND	ND	ND	ND	NA	NA	0.8
Xylenes	ND	ND	ND	ND	NA	NA	4.8
1,2-DCA	ND	<2		6.6	3	NA	
1,1-DCE	ND						
cis-1,2-DCE	ND	ND		<0.5	1.1	1.1	
trans-1,2-DCE	ND	<1		<0.5	<0.5	<0.5	
"DCE"	ND						
PCE	ND	1.9		<0.5	<0.5	<0.5	
TCE	ND	<2		<0.5	<0.5	<0.5	
Chloroform	ND	<1		<0.5	<0.5	<0.5	
1,1,2-TCA	ND						
Bromoform	ND						
Chlorobenzene	ND	<1		<0.5	<0.5		
TPH-g	ND	ND					330
MTBE	NA	NA	NA	NA	NA	NA	ND

MW-11					
Chemical	4/81	7/81	4/84	11/85	12/86
Benzene	ND	ND	<0.5	<0.5	ND
Toluene	0.4	ND	<0.5	<0.5	ND
Ethylbenzene	ND	ND	<0.5	<0.5	ND
Xylenes	0.5	ND	<0.5	<0.5	ND
1,2-DCA	8	ND	NA	1.4	NA
1,1-DCE	ND	ND	NA		
cis-1,2-DCE	ND	ND	NA	<0.5	NA
trans-1,2-DCE	ND	ND	NA	<0.5	NA
"DCE"	ND	ND	NA		
PCE	27	1.8	NA	1.3	NA
TCE	4	1.3	NA	3	NA
Chloroform	ND	ND	NA	<0.5	NA
1,1,2-TCA	ND	ND	NA		
Bromoform	ND	ND	NA		
Chlorobenzene	ND	ND	NA		
TPH-g	ND	ND	ND		
MTBE	NA	NA	NA	NA	ND

MW-20			
Chemical	2/83	4/84	11/85
Benzene	NA	21	<0.5
Toluene	NA	<0.5	<0.5
Ethylbenzene	NA	<0.5	<0.5
Xylenes	NA	<0.5	<0.5
1,2-DCA	ND	<2	<0.5
1,1-DCE		<2	
cis-1,2-DCE			16
trans-1,2-DCE		58	0.61
"DCE"	NA		
PCE	ND	57	<0.5
TCE	ND	32	3.7
Chloroform			<0.5
1,1,2-TCA			
Bromoform			
Chlorobenzene		<1	
TPH-g			

MW-19						
Chemical	2/83	4/84	10/84	2/88	5/88	11/88
Benzene	NA	<0.5	<0.5	<0.5	<0.5	NA
Toluene	NA	<0.5	<0.5	<0.5	<0.5	NA
Ethylbenzene	NA	<0.5	<0.5	<0.5	<0.5	NA
Xylenes	NA	<0.5	<0.5	<0.5	<0.5	NA
1,2-DCA	ND	<2	<0.5	<0.5	<0.5	NA
1,1-DCE						
cis-1,2-DCE		NR	<0.5	<0.5	<0.5	NA
trans-1,2-DCE		<1	<0.5	<0.5	<0.5	NA
"DCE"	NA					
PCE	ND	1.1	<0.5	<0.5	<0.5	NA
TCE	ND	<2	<0.5	<0.5	<0.5	NA
Chloroform		<1	4.8	<0.5	<0.5	NA
1,1,2-TCA						
Bromoform						
Chlorobenzene		<1	<0.5	<0.5	<0.5	
TPH-g						

MW-21	
Chemical	11/88
Chlorobenzene	

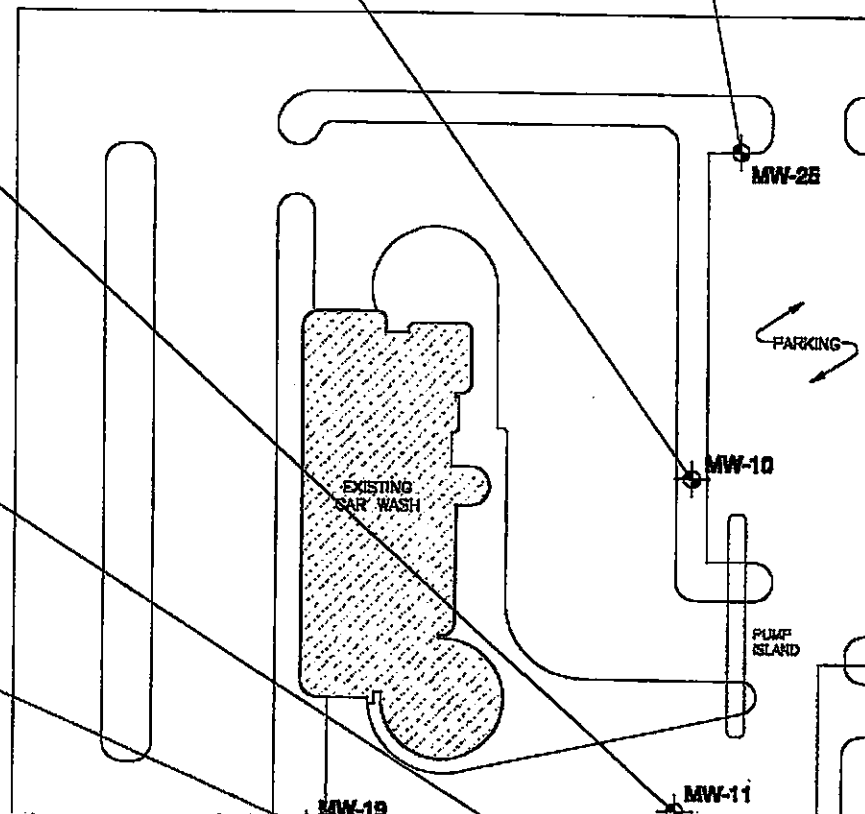

MW-24							
Chemical	2/83	4/84	10/84	2/85	5/85	11/85	12/86
Benzene	100	3000	NA	53	180	26	54
Toluene	230	1200	NA	21	48	1.7	27
Ethylbenzene	270	710	NA	20	81	11	22
Xylenes	500	2000	NA	48	150	4.7	31
1,2-DCA	ND	9.3	5.2	NA	NA	NA	NA
1,1-DCE	ND						
cis-1,2-DCE	ND	NA	<0.5	NA	NA	NA	NA
trans-1,2-DCE	ND	<1	<0.5	NA	NA	NA	NA
"DCE"	ND						
PCE	ND	3.9	<0.5	NA	NA	NA	NA
TCE	11	<2	<0.5	NA	NA	NA	NA
Chloroform	ND	<1	1.3	NA	NA	NA	NA
1,1,2-TCA	ND						
Bromoform	ND						
Chlorobenzene	ND	<1	<0.5	NA	NA		
TPH-g	33000	38000	NA	4100	8900	6000	20000
MTBE	NA	NA	NA	NA	NA	NA	ND

MW-12										
Chemical	4/81	7/81	2/83	4/84	10/84	2/85	5/85	11/85	12/86	
Benzene	20000	11000	620	1300	5200	120	71	NA	15	
Toluene	34000	17000	1900	6300	6200	200	130	NA	45	
Ethylbenzene	3800	1900	2200	1400	2200	180	110	NA	26	
Xylenes	19000	8900	6000	12000	13000	710	200	NA	59	
1,2-DCA	450	ND	ND	NA	NA		3	NA	NA	
1,1-DCE	ND	ND	ND	NA	NA					
cis-1,2-DCE	ND	ND	ND	NA	<0.5		<0.5	NA	NA	
trans-1,2-DCE	ND	ND	ND	NA	NA		<0.5	NA	NA	
"DCE"	ND	ND	ND	NA	NA					
PCE	ND	ND	ND	NA	NA		<0.5	NA	NA	
TCE	ND	2.30	2.4	NA	NA		<0.5	NA	NA	
Chloroform	ND	ND	ND	NA	NA		<0.5	NA	NA	
1,1,2-TCA	ND	ND	ND	NA	NA					
Bromoform	ND	ND	ND	NA	NA					
Chlorobenzene	ND	ND	ND	NA	NA		<0.5			
TPH-g	260000	88000	330000	180000	77000	68000	16000	NA	20000	
MTBE	NA	NA	NA	NA	NA	NA	NA	NA	NA	ND

MW-23						
Chemical	2/83	4/84	10/84	2/85	5/85	11/85
Benzene	ND	<0.5				
Toluene	ND	<0.5				
Ethylbenzene	ND	<0.5				
Xylenes	ND	<0.5				
1,2-DCA	ND	<2	0.53	<0.5	0.99	NA
1,1-DCE						
cis-1,2-DCE		NR	<0.5	<0.5	<0.5	NA
trans-1,2-DCE		<1	<0.5	<0.5	<0.5	NA
"DCE"						
PCE	ND	<1	<0.5	<0.5	<0.5	NA
TCE	ND	<2	<0.5	<0.5	<0.5	NA
Chloroform	ND	<1	<0.5	<0.5	<0.5	NA
1,1,2-TCA						
Bromoform						
Chlorobenzene		<1	<0.5	<0.5	<0.5	
TPH-g						

MW-9					
Chemical	11/80	4/81	7/81	4/84	11/85
Benzene	ND	ND	<0.4	520	1.8
Toluene	ND	ND	<0.3	2.8	5.6
Ethylbenzene	ND	ND	<0.3	35	1.1
Xylenes	ND	ND	<0.4	<0.5	5.8
1,2-DCA	ND	ND	<0.3	<2	<0.5
1,1-DCE	ND	ND	<0.2	<2	
cis-1,2-DCE	ND	ND	<0.4		<0.5
trans-1,2-DCE			<0.4	<1	<0.5
"DCE"	ND	ND	<0.4		
PCE	1.5	3.3	<0.5	<1	<0.5
TCE	ND	ND	<0.3	<2	<0.5
Chloroform					<0.5
1,1,2-TCA			<0.6		
Bromoform			<0.7		
Chlorobenzene			<0.7	<1	
TPH-g					

MW-2					
Chemical	11/80	4/81	7/81	4/84	11/85
Benzene	ND	ND	<0.4	<0.5	<0.5
Toluene	ND	ND	<0.3	<0.5	<0.5
Ethylbenzene	ND	ND	<0.3	<0.5	<0.5
Xylenes	ND	ND	<0.4	<0.5	<0.5
1,2-DCA	ND	ND	<0.3	<2	<0.5
1,1-DCE	ND	ND	<0.2	<2	
cis-1,2-DCE	ND	ND	<0.4		<0.5
trans-1,2-DCE			<0.4	<1	<0.5
"DCE"	ND	ND	<0.4		
PCE	ND	ND	<0.5	<1	<0.5
TCE	ND	ND	<0.3	<2	<0.5
Chloroform					<0.5
1,1,2-TCA			<0.6		
Bromoform			<0.7		
Chlorobenzene			<0.7	<1	
TPH-g					

MW-3					
Chemical	11/80	4/81	7/81	4/84	11/85
Benzene	ND	ND	<0.4	<0.5	<0.5
Toluene	0.5	ND	<0.3	<0.5	<0.5
Ethylbenzene	ND	ND	<0.3	<0.5	<0.5
Xylenes	ND	ND	<0.4	<0.5	<0.5
1,2-DCA	ND	ND	<0.3	<2	<0.5
1,1-DCE	ND	ND	<0.2	<2	
cis-1,2-DCE	ND	ND	<0.4		0.77
trans-1,2-DCE			<0.4	<1	<0.5
"DCE"	ND		<0.4		
PCE	ND	3	<0.5	8.2	20
TCE	0.5	ND	<0.3	1.4	4
Chloroform					<0.5
1,1,2-TCA			<0.6		

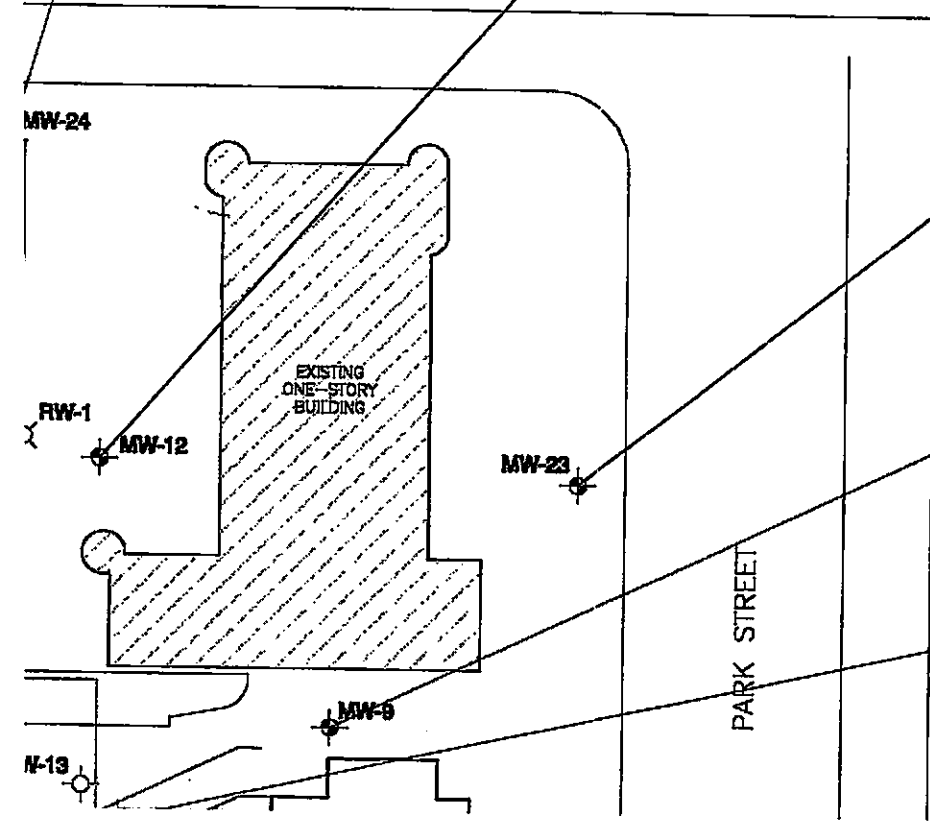

MW-21			
Chemical	2/83	4/84	11/85
Benzene	NA	<0.5	<0.5
Toluene	NA	<0.5	<0.5
Ethylbenzene	NA	<0.5	<0.5
Xylenes	NA	<0.5	<0.5
1,2-DCA	ND	<2	<0.5
1,1-DCE		<2	
cis-1,2-DCE			<0.5
trans-1,2-DCE		<1	<0.5
"DCE"	NA		
PCE	ND	<1	<0.5
TCE	ND	<1	<0.5
Chloroform			<0.5
1,1,2-TCA			
Bromoform			
Chlorobenzene			
TPH-g			

MW-18		
Chemical	2/83	4/84
Benzene	NA	<0.5
Toluene	NA	<0.5
Ethylbenzene	NA	<0.5
Xylenes	NA	<0.5
1,2-DCA	ND	<2
1,1-DCE		<2
cis-1,2-DCE		
trans-1,2-DCE		<1
"DCE"	NA	
PCE	ND	1.4
TCE	ND	<2
Chloroform		
1,1,2-TCA		
Bromoform		
Chlorobenzene		
TPH-g		

MW-7 & 7B							
Chemical	11/80	4/81	7/81	2/83	4/84	11/85	8/88
Benzene	ND	ND	NA	NA	190	1.1	<0.5
Toluene	ND	ND	NA	NA	<0.5	<0.5	<0.5
Ethylbenzene	ND	ND	NA	NA	<0.5	<0.5	<0.5
Xylenes	ND	ND	NA	NA	27	1.9	<0.5
1,2-DCA	ND	ND	<0.3	ND	<2	<50	<1
1,1-DCE	ND	ND	4.6		5.8		<1
cis-1,2-DCE	440	90	170			1200	1100
trans-1,2-DCE			2.6		13	<30	<35
"DCE"	440	90	170	150			
PCE	1900	1600	7800	5800	190	2100	820
TCE	520	200	680	540	12	1200	890
Chloroform						<50	<35
1,1,2-TCA			0.8				<35
Bromoform			1.7				<35
Chlorobenzene			4.8		31		<35
TPH-g							780

MW-17						
Chemical	2/83	4/84	10/84	2/85	6/85	11/85
Benzene	NA	<0.5	<0.5	<0.5	<0.5	NA
Toluene	NA	<0.5	<0.5	<0.5	<0.5	NA
Ethylbenzene	NA	<0.5	<0.5	<0.5	<0.5	NA
Xylenes	NA	<0.5	<0.5	<0.5	<0.5	NA
1,2-DCA	ND	<2	<0.5	<0.5	<0.5	NA
1,1-DCE						
cis-1,2-DCE		NR	<0.5	<0.5	<0.5	NA
trans-1,2-DCE		<1	<0.5	<0.5	<0.5	NA
"DCE"	NA					
PCE	ND	2.4	<0.5	<0.5	<0.5	NA
TCE	ND	<2	<0.5	<0.5	<0.5	NA
Chloroform		<1	4	<0.5	<0.5	NA
1,1,2-TCA						
Bromoform						
Chlorobenzene		<1	<0.5	<0.5	<0.5	
TPH-g						

MW-8							
Chemical	11/80	4/81	7/81	2/83	4/84	11/85	8/88
Benzene	ND	ND	NA	NA	92	<0.5	<0.5
Toluene	ND	ND	NA	NA	<0.5	<0.5	<0.5
Ethylbenzene	ND	ND	NA	NA	<0.5	<0.5	<0.5
Xylenes	ND	ND	NA	NA	<0.5	<0.5	<0.5
1,2-DCA	ND	ND	<0.3	ND	<2	<0.5	<1
1,1-DCE	ND	ND	<0.2		<2		<1
cis-1,2-DCE	1.2	6.8	11			44	40
trans-1,2-DCE			<0.4		23	1.9	1.4
"DCE"	1.2	6.8	11	9			
PCE	0.9	1.1	0.9	5	70	8	1.4
TCE	3	7.7	19	14	57	22	44
Chloroform						<0.5	<1
1,1,2-TCA			<0.5				<1
Bromoform			<0.7				<1
Chlorobenzene			<0.7		<1		<1
TPH-g							<50

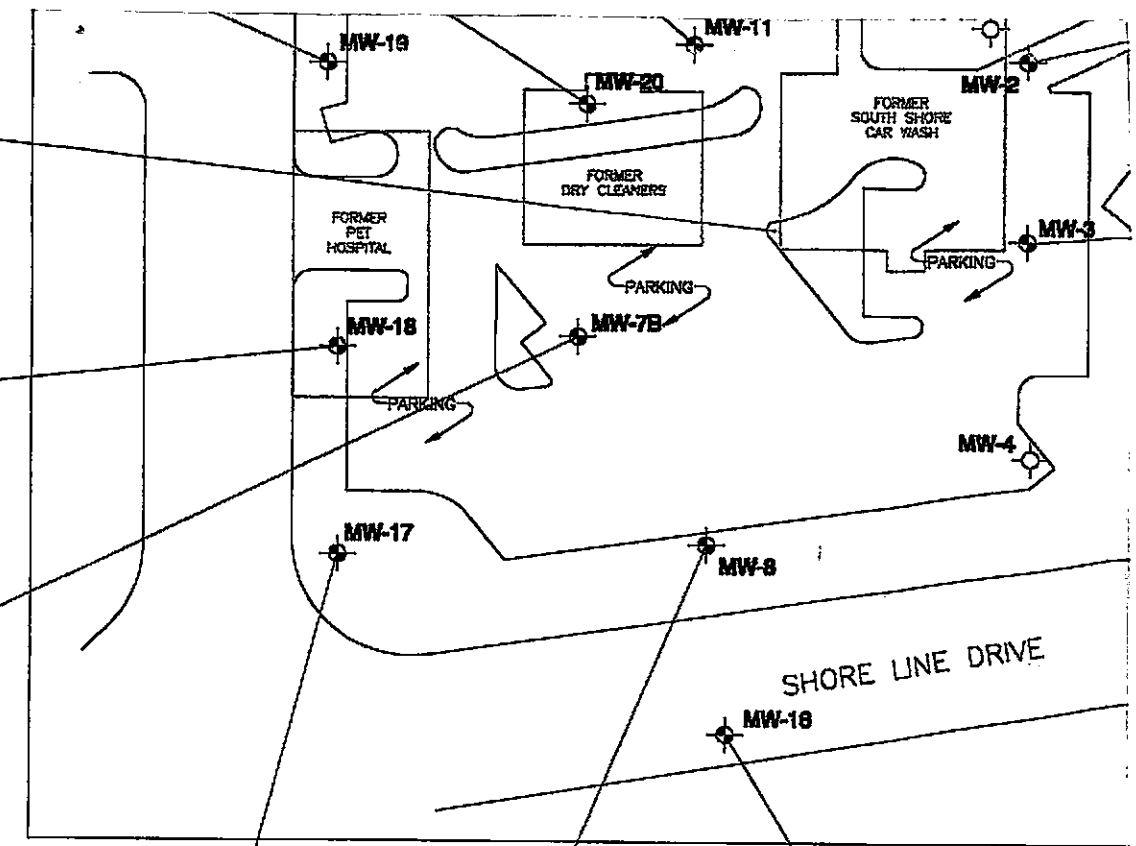

©1996, by Kleinfelder, Inc.

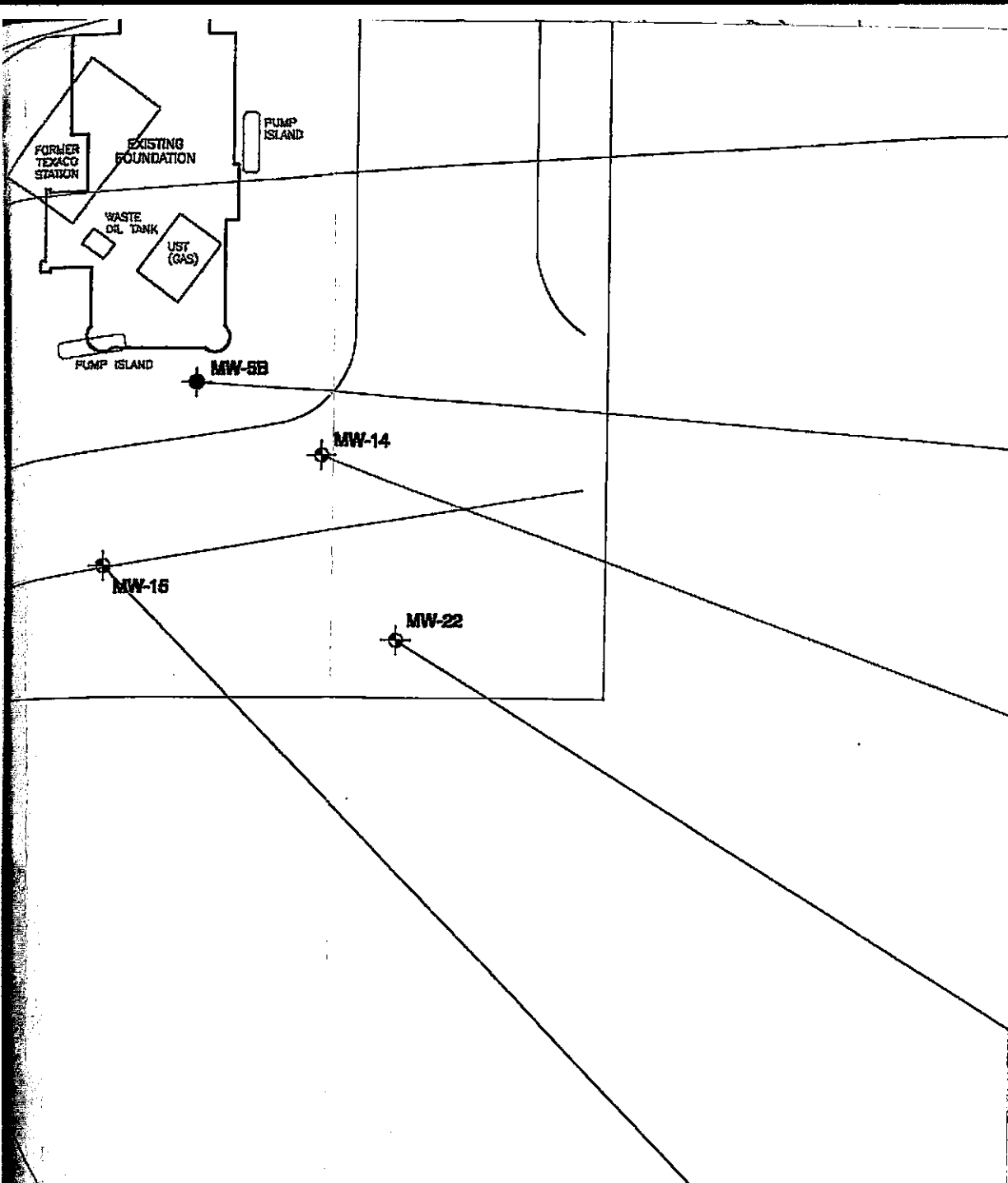

1,1,2-TCA	<0.6	<0.5	<0.5	<1	<1
Bromoform	<0.7				
Chlorobenzene	<0.7	<1			
TPH-g					

Chemical	11/80	4/81	7/81	2/83	4/84
Benzene	800	300	3.1	210	<0.5
Toluene	12	45	3.7	4.2	<0.5
Ethylbenzene	320	370	13	1.9	<0.5
Xylenes	66	100	2.2	2	<0.5
1,2-DCA	ND	ND	<0.3	0.4	<2
1,1-DCE	ND	ND	<0.2		<2
cis-1,2-DCE	ND	ND	<0.4		
trans-1,2-DCE	ND	ND	<0.4		14
"DCE"	ND	ND	<0.4	5	
PCE	ND	ND	<0.5	ND	1.2
TCE	ND	ND	<0.3	3.4	10
Chloroform					
1,1,2-TCA			<0.6		
Bromoform			<0.7		
Chlorobenzene			<0.7	<1	<1
TPH-g					

Chemical	4/81	7/81	2/83	4/84	4/84	4/87
Benzene	2.9	0.8	ND	0.95	0.96	0.77
Toluene	ND	0.8	ND	<0.5	<0.5	<0.5
Ethylbenzene	ND	<0.3	ND	3.3	3.4	0.73
Xylenes	0.5	0.8	ND	15	15	<0.5
1,2-DCA	4.6	6.6	3.4	8.4	9.7	1.4
1,1-DCE	0.5	<0.2		<2	<2	<1
cis-1,2-DCE	ND	<0.4				<1
trans-1,2-DCE		<0.4		<1	<1	<1
"DCE"	ND	<0.4	ND			<1
PCE	16	<0.5	ND	<1	<1	<1
TCE	0.4	<0.3	ND	<2	<2	<1
Chloroform						<1
1,1,2-TCA		<0.6				<1
Bromoform		<0.7				<1
Chlorobenzene		<0.7		<1	<1	<1
TPH-g						<50
MTBE	NA	NA	NA	NA	NA	<30

Chemical	2/83	4/84	10/84	2/85	5/85	4/87
Benzene	ND	<0.5	<0.5	<0.5	<0.5	<0.5
Toluene	ND	<0.5	<0.5	<0.5	<0.5	<0.5
Ethylbenzene	ND	<0.5	<0.5	<0.5	<0.5	<0.5
Xylenes	ND	<0.5	<0.5	<0.5	<0.5	<0.5
1,2-DCA	22	15	14	8.2	11	<1
1,1-DCE		<2				<1
cis-1,2-DCE		NR	<0.5	<0.5	<0.5	<1
trans-1,2-DCE		<1	<0.5	<0.5	<0.5	<1
"DCE"	ND					
PCE	ND	<1	<0.5	<0.5	<0.5	<1
TCE	ND	<2	<0.5	<0.5	<0.5	<1
Chloroform		<1	0.85	<0.5	<0.5	<1
1,1,2-TCA						
Bromoform						
Chlorobenzene		<1	<0.5	<0.5		<1
TPH-g						<50
MTBE	NA	NA	NA	NA	NA	<30

Chemical	2/83	4/84	10/84	2/85	5/85	11/85
Benzene	ND	<0.5	<0.5	<0.5	<0.5	NA
Toluene	ND	<0.5	<0.5	<0.5	<0.5	NA
Ethylbenzene	ND	<0.5	<0.5	<0.5	<0.5	NA
Xylenes	ND	<0.5	<0.5	<0.5	<0.5	NA
1,2-DCA	ND	<2	<0.5	<0.5	<0.5	NA
1,1-DCE						
cis-1,2-DCE		NR	<0.5	<0.5	<0.5	NA
trans-1,2-DCE		<1	<0.5	<0.5	<0.5	NA
"DCE"	ND					
PCE	ND	<1	<0.5	<0.5	<0.5	NA
TCE	ND	<2	<0.5	<0.5	<0.5	NA
Chloroform		<1	8.1	<0.5	<0.5	NA
1,1,2-TCA						
Bromoform						
Chlorobenzene		<1	<0.5	<0.5	<0.5	
TPH-g						

Chemical	2/83	4/84	4/87
Benzene	ND	<0.5	<0.5
Toluene	ND	<0.5	<0.5
Ethylbenzene	ND	<0.5	<0.5
Xylenes	ND	<0.5	<0.5
1,2-DCA	ND	<2	<1
1,1-DCE		<2	<1
cis-1,2-DCE			<1
trans-1,2-DCE		<1	<1
"DCE"	ND		<1
PCE	ND	<1	<1
TCE	ND	<2	<1
Chloroform			<1
1,1,2-TCA			<1
Bromoform			<1
Chlorobenzene			<1
TPH-g			<50
MTBE	NA	NA	<30

LEGEND

- MONITORING WELL
- MONITORING/VAPOR EXTRACTION WELL
- RECOVERY WELL
- MONITORING WELL (DAMAGED)

NOTES:

Blank cells mean that nothing was reported for the given chemical.

"NA" means the chemical was reported as "Not Analyzed"

"ND" means the chemical was analyzed, but "Not Detected"

"<" means the chemical was analyzed and reported below the given detection limit

"DCE" means either total DCE, or DCE not differentiated into cis- or trans-isomers.

All values in micrograms per liter.

Analytical data for monitoring wells MW-10, MW-11, MW-12, MW-13, MW-24, AND MW-25 modified by Soil Tech Engineering, Inc.

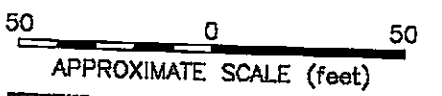

REFERENCE:
 EVAX Technologies, Inc., "As-Built Site Map, 2375 Shore Line Drive, Alameda, California," dated 8-13-91.

Plate revised 10-27-97.

	DATA COMPILATION, SOUTH SHORE SHOPPING CENTER		FIGURE 2
	HARSCH SOUTH SHORE 2375 SHORE LINE DRIVE ALAMEDA, CALIFORNIA		
DRAFTED BY: L. Sue	DATE: 11-14-96	PROJECT NO. 10-300301-006	
CHECKED BY: A. Gibbs	DATE: 11-14-96		