

ALAMEDA MARINA

RECEIVED

9:56 am, Dec 10, 2010

Alameda County
Environmental Health

December 9, 2010

Project 0147400000

Mr. Jerry Wickham
Alameda County Environmental Health
1131 Harbor Bay Parkway
Alameda, CA 94502-6577

Re: **Well Destruction Report**
Pacific Shops, Inc.
1829 Clement Avenue
Alameda, California
SLIC Case No. RO0002624 and GeoTracker Global ID T2O00414

Dear Mr. Wickham:

Attached please find the *Well Destruction Report* dated December 9, 2010 for the Pacific Shops Site, SLIC Case No. RO0002624. This report was prepared by AMEC Geomatrix, Inc. (AMEC) on behalf of Pacific Shops. The wells were destroyed as requested in your November 3, 2010 letter to Pacific Shops.

I declare under penalty of perjury, that the information and/or recommendations contained in the attached document or report is true and correct to the best of my knowledge.

Sincerely yours,

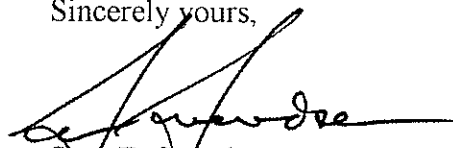

Sean E. Svendsen
Chief Operating Officer

Attachment: Well Destruction Report



December 9, 2010

Project 014740000.00004

Mr. Sean Svendsen
Pacific Shops, Inc.
1829 Clement Avenue
Alameda, California 94501

Subject: Well Destruction Report

Pacific Shops, Inc.
1829 Clement Avenue
Alameda, California
SLIC Case No. RO0002624 and GeoTracker Global ID SLT2O00414

Dear Mr. Svendsen:

On behalf of Pacific Shops Inc., AMEC Geomatrix, Inc. (AMEC), has prepared this *Well Destruction Report* to document well destruction activities at Pacific Shops Inc., located at 1829 Clement Avenue in Alameda, California (the site, Figure 1). As requested in the letter from the Alameda County Environmental Health Department (ACEHD) letter to Mr. Sean Svendsen of Pacific Shops Inc., dated November 3, 2010, groundwater monitoring wells MW-1, MW-2, and MW-3 (Figure 2) were destroyed on November 19, 2010. We understand that ACEHD will prepare a closure letter for SLIC Case No. RO0002624 upon receipt of this well destruction report.

Prior to performing well destruction activities, AMEC obtained well destruction permits from the Alameda County Public Works Agency (ACPWA). Copies of the permits are presented in Attachment A.

AMEC contracted with PeneCore Drilling, of Woodland, California, a California-licensed driller, to destroy monitoring wells MW-1, MW-2, and MW-3. The well destruction activities were observed by an AMEC geologist, under the supervision of a California Professional Geologist. Monitoring well construction and destruction information for the three wells that were destroyed is presented in Table 1.

Each well was destroyed by pressure grouting, using the following methodology. The driller first ensured that the well was free of sediment and obstructions and confirmed the total depth of the well casing using a weighted measuring tape. The well casing was then filled with Type I-II neat cement grout from the bottom of the well to ground surface using a tremie pipe. The volume of the well casing was calculated prior to emplacement of the grout to ensure that the volume of grout emplaced was at least as great as the volume of the well casing (Table 1). The neat cement grout was then placed under a minimum pressure of 25 pounds per square inch for a minimum of 5 minutes and grout was allowed to spill over the top of the well casing.

AMEC Geomatrix, Inc.
2101 Webster Street, 12th Floor
Oakland, California
USA 94612-3066
Tel (510) 663-4100
Fax (510) 663-4141
www.amecgeomatrixinc.com

Mr. Sean Svendsen
Pacific Shops Inc.
December 9, 2010
Page 2



Following pressure grouting, the well box at each location was removed using a jackhammer. Following removal of the well boxes, each location was backfilled with cement to the ground surface.

An ACPWA inspector observed the pressure grouting of well MW-3 and approved use of the same methodology for wells MW-1 and MW-2. The ACPWA inspector was not present for the destruction of wells MW-1 and MW-2.

Following well destruction activities, a State of California Well Completion Report for each well was prepared, signed by PeneCore Drilling, and submitted to ACPWA as required. It is ACPWA's policy that well completion reports are to be submitted to ACPWA, which in turns submits them to the Department of Water Resources. Copies of the well completion reports for the destroyed wells are included in Attachment B.

Investigation derived waste from the well destruction activities, consisting of displaced well water, concrete, and 3 well boxes, was disposed of by Pacific Shops in accordance with applicable regulations. Disposal documentation for the displaced well water is presented in Attachment C.

Please feel free to call either of the undersigned if you have any questions.

Sincerely yours,
AMEC Geomatrix, Inc.

A handwritten signature in black ink, appearing to read "Darren Croteau".

Darren Croteau, PG, #7495
Senior Geologist

A handwritten signature in black ink, appearing to read "Edward P. Conti".

Edward P. Conti, CEG, CHG
Principal Geologist

DRC/EPC/jd
\\Oad-fs1\doc_safe\14000s\14740.000\4000 REGULATORY\Well Destruction Report\Text\Text.doc

Attachments: Table 1 – Monitoring Well Construction and Destruction Details
Figure 1 – Site Location Map
Figure 2 – Destroyed Monitoring Well Location Map
Attachment A – Well Destruction Permits
Attachment B – State of California Well Completion Reports
Attachment C – Waste Disposal Documentation

TABLE

TABLE 1

MONITORING WELL CONSTRUCTION AND DESTRUCTION DETAILS

Pacific Shops Inc.
1829 Clement Avenue
Alameda, California

Well ID	Date Installed	Date Destroyed ¹	Boring Diameter (inches)	Top of Casing Elevation (feet MSL)	Total Depth of Well (feet bgs)	Casing Diameter (inches)	Screened Interval ² (feet bgs)	Sand Pack Interval (feet bgs)	Bentonite Seal Interval (feet bgs)	Surface Seal interval	Depth Pressure-Grouted for Destruction (feet bgs)	Calculated Well Casing Volume (gallons)	Volume of Grout Emplaced (gallons)
MW-1	9/11/1990	11/19/2010	8	91.52	15.0	2	5.0 - 15.0	4.5 - 15.0	4.0 - 4.5	0.5 - 4.0	0.5 - 15.0	2.5	10.0
MW-2	9/11/1990	11/19/2010	8	91.36	15.0	2	5.0 - 15.0	4.5 - 15.0	4.0 - 4.5	0.5 - 4.0	0.5 - 15.0	2.5	10.0
MW-3	9/11/1990	11/19/2010	8	90.81	15.0	2	5.0 - 15.0	4.5 - 15.0	4.0 - 4.5	0.5 - 4.0	0.5 - 15.0	2.5	10.0

Notes

1. Wells were destroyed by Penecore Drilling, of Woodland, California by pressure grouting.
2. Schedule 40 PVC casing with 0.010-inch slots.

Abbreviations

feet bgs = feet below ground surface
MSL = Mean Sea Level

FIGURES

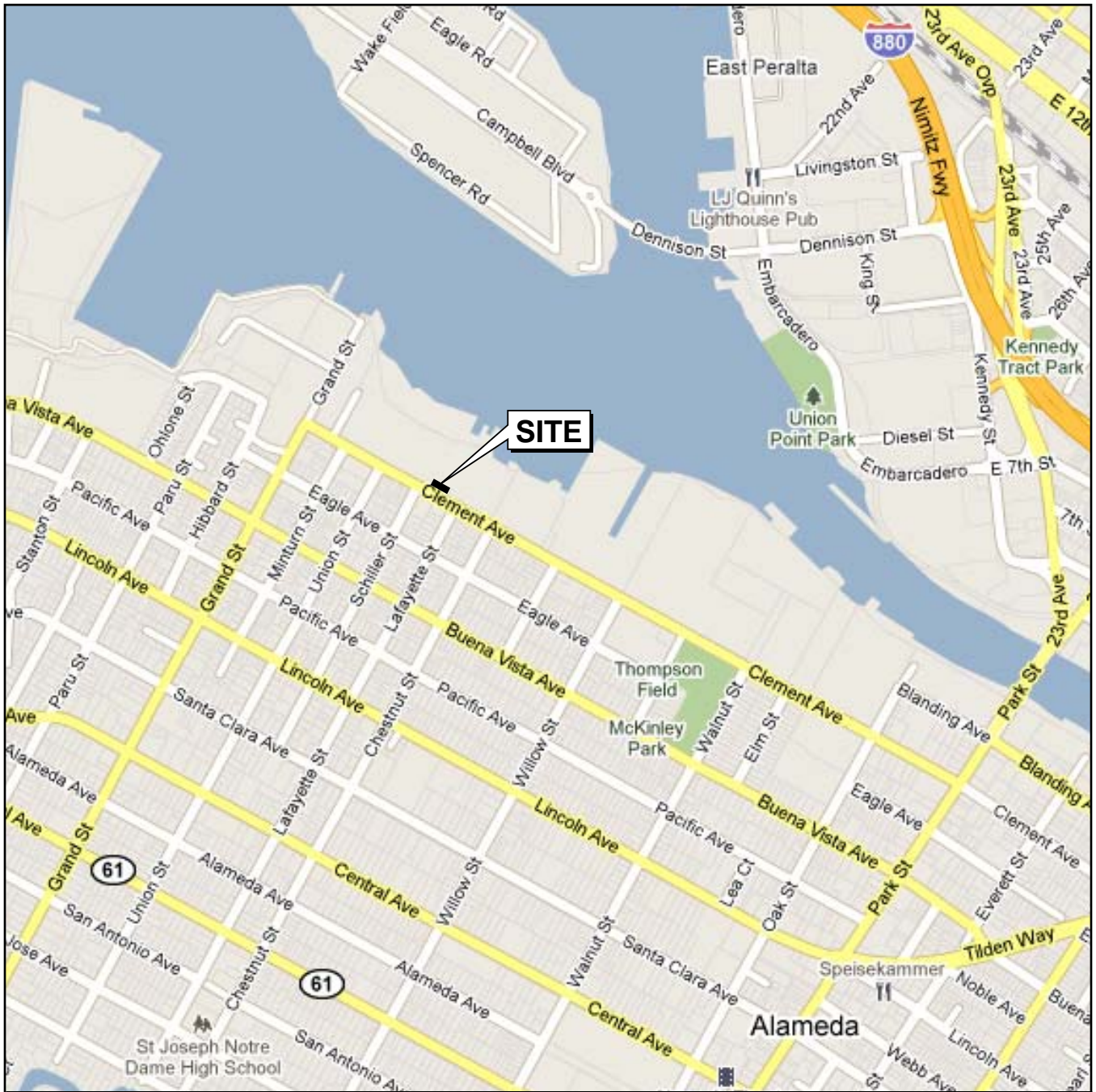

Base map from Google Maps 2010.

S:\14700\14740\14740.000\task_210_0810_awpl_fig_02(02).ai

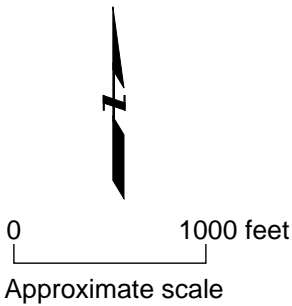

SITE LOCATION MAP Pacific Shops, Inc. 1829 Clement Avenue Alameda, California		
By: AP	Date: 08/11/2010	Project No. 14740.000
AMEC Geomatrix		Figure 1

Plot Date: 12/01/10 - 12:05pm, Plotted by: jim.graul
 Drawing Path: S:\14700\14740\14740.000\task_4110_1204_wdr\ Drawing Name: fig_02.dwg

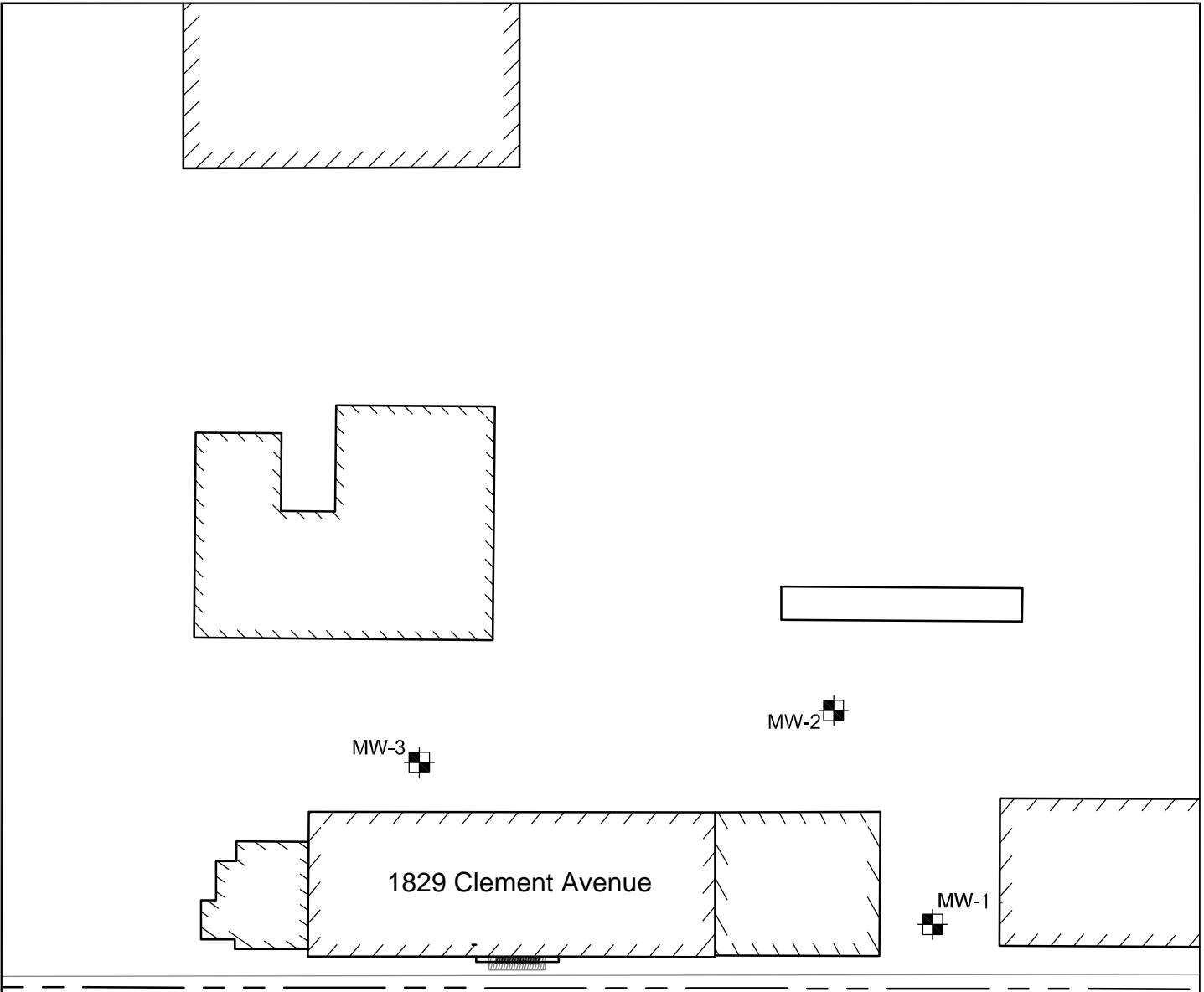

Clement Avenue

Shiller Street



EXPLANATION

- MW-2 Approximate location and identification of destroyed monitoring well
- — — — — Property boundary

DESTROYED MONITORING WELL
 LOCATION MAP
 Pacific Shops, Inc.
 1829 Clement Avenue
 Alameda, California

By: DC	Date: 12/01/10	Project No. 14740.000
AMEC Geomatrix		Figure 2



ATTACHMENT A

Well Destruction Permits

Alameda County Public Works Agency - Water Resources Well Permit



399 Elmhurst Street
Hayward, CA 94544-1395
Telephone: (510)670-6633 Fax:(510)782-1939

Application Approved on: 11/12/2010 By jamesy

**Permit Numbers: W2010-0844 to W2010-0846
Permits Valid from 11/17/2010 to 11/17/2010**

Application Id: 1289344508173
Site Location: 1829 Clement Avenue
Project Start Date: 11/17/2010
Assigned Inspector: Contact Vicky Hamlin at (510) 670-5443 or vickyh@acpwa.org

City of Project Site: Alameda

Completion Date: 11/17/2010

Applicant: AMEC Geomatrix - Chuck Payne
2101 Webster Street, 12th floor, Oakland, CA 94612
Property Owner: Sean Svendsen
1815 Clement Avenue, Alameda, CA 94501
Client: Sean Svendsen
1815 Clement Avenue, Alameda, CA 94501
Contact: Chuck Payne

Phone: 510-663-4177

Phone: --

Phone: --

Phone: --
Cell: 510-379-8800

Total Due: \$1191.00
Receipt Number: WR2010-0381 **Total Amount Paid:** \$1191.00
Payer Name : charles w payne **Paid By: MC** **PAID IN FULL**

Works Requesting Permits:

Well Destruction-Monitoring - 3 Wells
Driller: Penecore Drilling - Lic #: 906899 - Method: press

Work Total: \$1191.00

Specifications

Permit #	Issued Date	Expire Date	Owner Well Id	Hole Diam.	Casing Diam.	Seal Depth	Max. Depth	State Well #	Orig. Permit #	DWR #
W2010-0844	11/12/2010	02/15/2011	MW-1	8.00 in.	2.00 in.	4.50 ft	15.00 ft	2S/4W12B2	90549	No Records
W2010-0845	11/12/2010	02/15/2011	MW-2	8.00 in.	2.00 in.	4.50 ft	15.00 ft	2S/4W12B3	90549	No Records
W2010-0846	11/12/2010	02/15/2011	MW-3	8.00 in.	2.00 in.	4.50 ft	15.00 ft	2S/4W12B4	90549	No Records

Specific Work Permit Conditions

1. Drilling Permit(s) can be voided/ cancelled only in writing. It is the applicant's responsibility to notify Alameda County Public Works Agency, Water Resources Section in writing for an extension or to cancel the drilling permit application. No drilling permit application(s) shall be extended beyond ninety (90) days from the original start date. Applicants may not cancel a drilling permit application after the completion date of the permit issued has passed.

2. Prior to any drilling activities, it shall be the applicant's responsibility to contact and coordinate an Underground Service Alert (USA), obtain encroachment permit(s), excavation permit(s) or any other permits or agreements required for that Federal, State, County or City, and follow all City or County Ordinances. No work shall begin until all the permits and requirements have been approved or obtained. It shall also be the applicants responsibilities to provide to the Cities or to Alameda County an Traffic Safety Plan for any lane closures or detours planned. No work shall begin until all the permits and requirements have been approved or obtained.

3. Compliance with the well-sealing specifications shall not exempt the well-sealing contractor from complying with appropriate State reporting-requirements related to well construction or destruction (Sections 13750 through 13755 (Division 7, Chapter 10, Article 3) of the California Water Code). Contractor must complete State DWR Form 188 and mail original to the Alameda County Public Works Agency, Water Resources Section, within 60 days. Including permit number and site map.

Alameda County Public Works Agency - Water Resources Well Permit

4. Applicant shall submit the copies of the approved encroachment permit to this office within 60 days.
5. Permittee shall assume entire responsibility for all activities and uses under this permit and shall indemnify, defend and save the Alameda County Public Works Agency, its officers, agents, and employees free and harmless from any and all expense, cost and liability in connection with or resulting from the exercise of this Permit including, but not limited to, property damage, personal injury and wrongful death.
6. Applicant shall contact Vicky Hamlin for an inspection time at 510-670-5443 or email to vickyh@acpwa.org at least five (5) working days prior to starting, once the permit has been approved. Confirm the scheduled date(s) at least 24 hours prior to drilling.
7. Permittee, permittee's contractors, consultants or agents shall be responsible to assure that all material or waters generated during drilling, boring destruction, and/or other activities associated with this Permit will be safely handled, properly managed, and disposed of according to all applicable federal, state, and local statutes regulating such. In no case shall these materials and/or waters be allowed to enter, or potentially enter, on or off-site storm sewers, dry wells, or waterways or be allowed to move off the property where work is being completed.
8. Remove the Christy box or similar structure.

Destroy well by grouting neat cement with a tremie pipe or pressure grouting (25 psi for 5min.) to the bottom of the well and by filling with neat cement to three (3-5) feet below surface grade. Allow the sealing material to spill over the top of the casing to fill any annular space between casing and soil.

After the seal has set, backfill the remaining hole with concrete or compacted material to match existing conditions.

9. Copy of approved drilling permit must be on site at all times. Failure to present or show proof of the approved permit application on site shall result in a fine of \$500.00.
-



ATTACHMENT B

State of California Well Completion Reports

CONFIDENTIAL

STATE OF CALIFORNIA DWR
WELL COMPLETION REPORT
(WELL LOGS)

REMOVED

CONFIDENTIAL

STATE OF CALIFORNIA DWR
WELL COMPLETION REPORT
(WELL LOGS)

REMOVED

CONFIDENTIAL

**STATE OF CALIFORNIA DWR
WELL COMPLETION REPORT
(WELL LOGS)**

REMOVED



ATTACHMENT C

Waste Disposal Documentation

NON-HAZARDOUS WASTE MANIFEST	1. Generator ID Number E X E M P T	2. Page 1 of 1	3. Emergency Response Phone NRCS 510 740-1300	4. Waste Tracking Number 5 5 5 0 7
5. Generator's Name and Mailing Address PACIFIC SHOPS, INC. (SEAN SVENDSEN) 1828 CLEMENT AVENUE ALAMEDA MO 94501 Generator's Phone: 510 521-1133				
6. Transporter 1 Company Name NRC ENVIRONMENTAL SERVICES INC.				
7. Transporter 2 Company Name				
8. Designated Facility Name and Address Crash & Motors Shop 1030 W. 17th Street Long Beach CA 90813 Facility's Phone: 562 432-5445				
Generator's Site Address (if different than mailing address)				
U.S. EPA ID Number C A R 0 0 0 3 0 1 1 4				
U.S. EPA ID Number C A D 0 2 8 4 0 8 0 1 8				
9. Waste Shipping Name and Description				
10. Containers				
11. Total Quantity				
12. Unit Wt./Vol.				
1. NON-HAZARDOUS WASTE LIQUID (PURGE WATER)				
2.				
3.				
4.				
13. Special Handling Instructions and Additional Information WEAR APPROPRIATE PERSON PROTECTIVE EQUIPMENT JOB#/PO#: 55507 PROFILE# 51545 CONSULTANT: AMEC-GEOMATRIX 2101 WEBSTER STREET 12TH FLOOR OAKLAND, CA. NRCS 1605 FERRY POINT, ALAMEDA, CA.				
14. GENERATOR'S/OFFEROR'S CERTIFICATION: I hereby declare that the contents of this consignment are fully and accurately described above by the proper shipping name, and are classified, packaged, marked and labeled/placarded, and are in all respects in proper condition for transport according to applicable international and national governmental regulations.				
Generator's/Offoror's Printed/Typed Name Kevin Sanracino				
Signature <i>Kevin Sanracino</i>				
Month Day Year 12 8 2010				
15. International Shipments <input type="checkbox"/> Import to U.S. <input type="checkbox"/> Export from U.S. Port of entry/exit: Date leaving U.S.:				
16. Transporter Acknowledgment of Receipt of Materials				
Transporter 1 Printed/Typed Name Robert Rodriguez				
Signature <i>Robert Rodriguez</i>				
Month Day Year 12 8 10				
Transporter 2 Printed/Typed Name				
Signature				
Month Day Year				
17. Discrepancy				
17a. Discrepancy Indication Space <input type="checkbox"/> Quantity <input type="checkbox"/> Type <input type="checkbox"/> Residue <input type="checkbox"/> Partial Rejection <input type="checkbox"/> Full Rejection				
Manifest Reference Number:				
17b. Alternate Facility (or Generator) U.S. EPA ID Number				
Facility's Phone:				
17c. Signature of Alternate Facility (or Generator) Month Day Year				
18. Designated Facility Owner or Operator: Certification of receipt of materials covered by the manifest except as noted in Item 17a				
Printed/Typed Name				
Signature				
Month Day Year				

GENERATOR
 INTL
 TRANSPORTER
 DESIGNATED FACILITY