

ALAMEDA COUNTY
HEALTH CARE SERVICES
AGENCY

DAVID J. KEARS, Agency Director



RAFAT A. SHAHID, Director

DEPARTMENT OF ENVIRONMENTAL HEALTH
Environmental Protection Division
1131 Harbor Bay Parkway, #250
Alameda, CA 94502-6577
(510) 567-6700

July 14, 1995

Mr. Mark Crutcher
700 Larkspur Landing Circle, St 100
Larkspur, CA - 94939

Subject: Altamont Raceway Prohect, 17001 Midway Road, Tracy,
Alameda County, California

Dear Mr. Crutcher:

I am in receipt of the workplan dated May 12, 1995, prepared by Paul Studemeister of Lee Incorporated for the property located at the above referenced address. The workplan has been reviewed by this Department and is acceptable with the following changes:

The boring locations should be changed as per the attached revised copy of the sample location map. Soil samples should be collected at the surface, and at 5 feet intervals upto 20 feet. However one boring marked "x" in the sample location map should be drilled upto 35 feet if groundwater is not encountered at the other 20 feet borings. If groundwater is encountered, then one groudwater sample should be collected from each boring.

The soil and groundwater samples should be analyzed (using silica-gel) for total oil and grease, benzene, toluene, ethyl Benzene, and xylene (BTEX), naphthalene and benzopyrene. Based on this initial results, samples may have to be analyzed using a wet test to determine the leaching potential of the contaminants. It is important that the initial sample results are submitted to this Department as soon they are received so that decisions regarding the wet test (number of samples, the constituent to be analyzed) can be made before the holding time expires.

The soil and groundwater sample analytical resutls will be evaluated by this Department using the Tier 1 criteria of the ASTM's Risk Based Corrective Action and guidelines related to water quality. Based on the analysis, future course of action for this project will then be determined.

Prior notification should be given before field work begins. If you have any questions, call me at (510) 567-6764.

Sincerely,



Madhulla Logan



Hazardous Material Specialist

CC: Paul Studemeister, Lee Incorporated, 1153 Bordeaux Drive,
St 103, Sunnyvale, CA - 94089

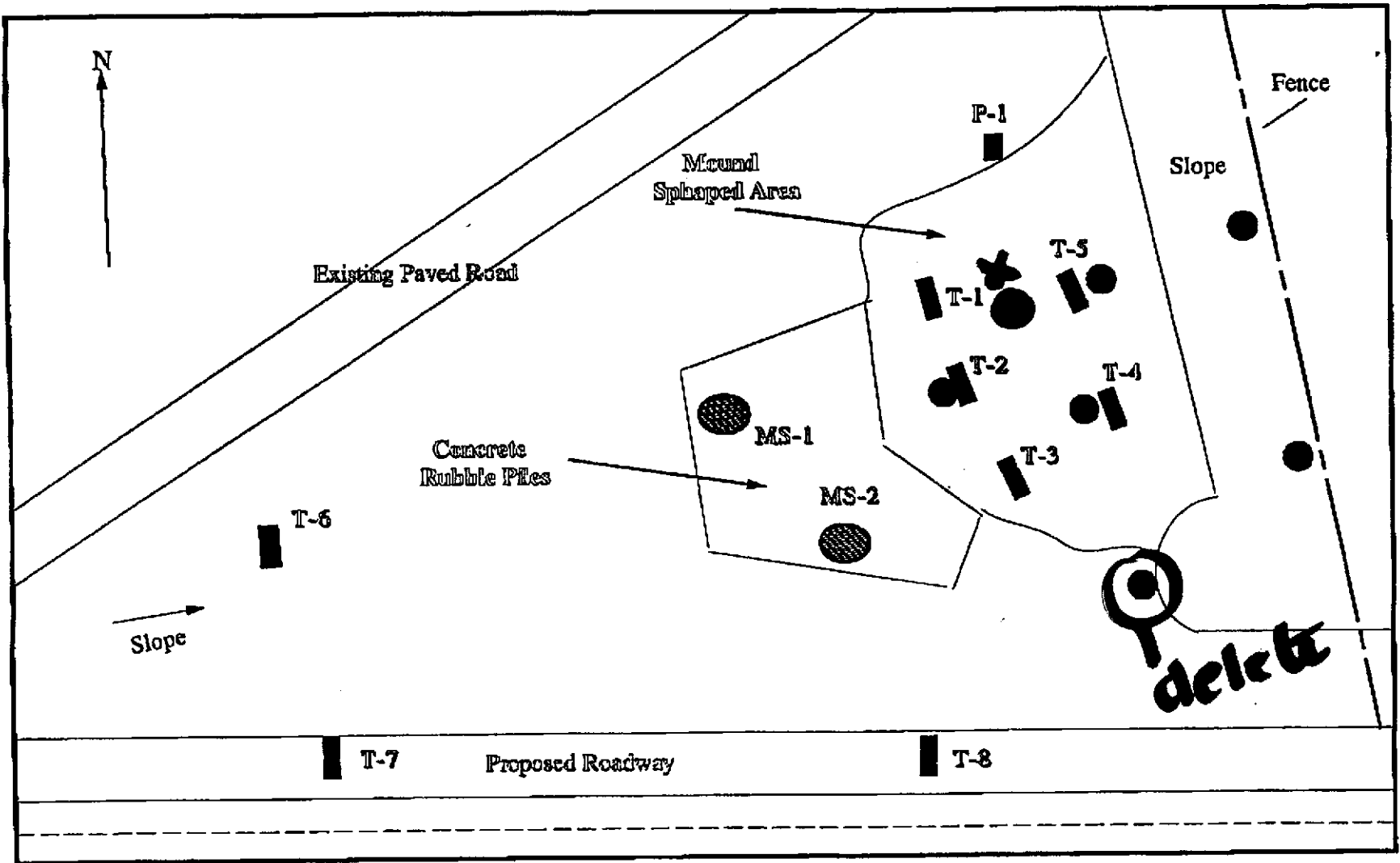
Ron Gee, Alameda County Planning Department, 399 Elmhurst
Street, Hayward, CA - 94544.

Gary Moore, Altamont Raceway, 17001 Midway Rd, Livermore,
California.



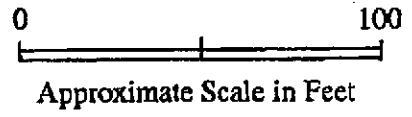

-   Areas sampled
-  Proposed Boring Locations

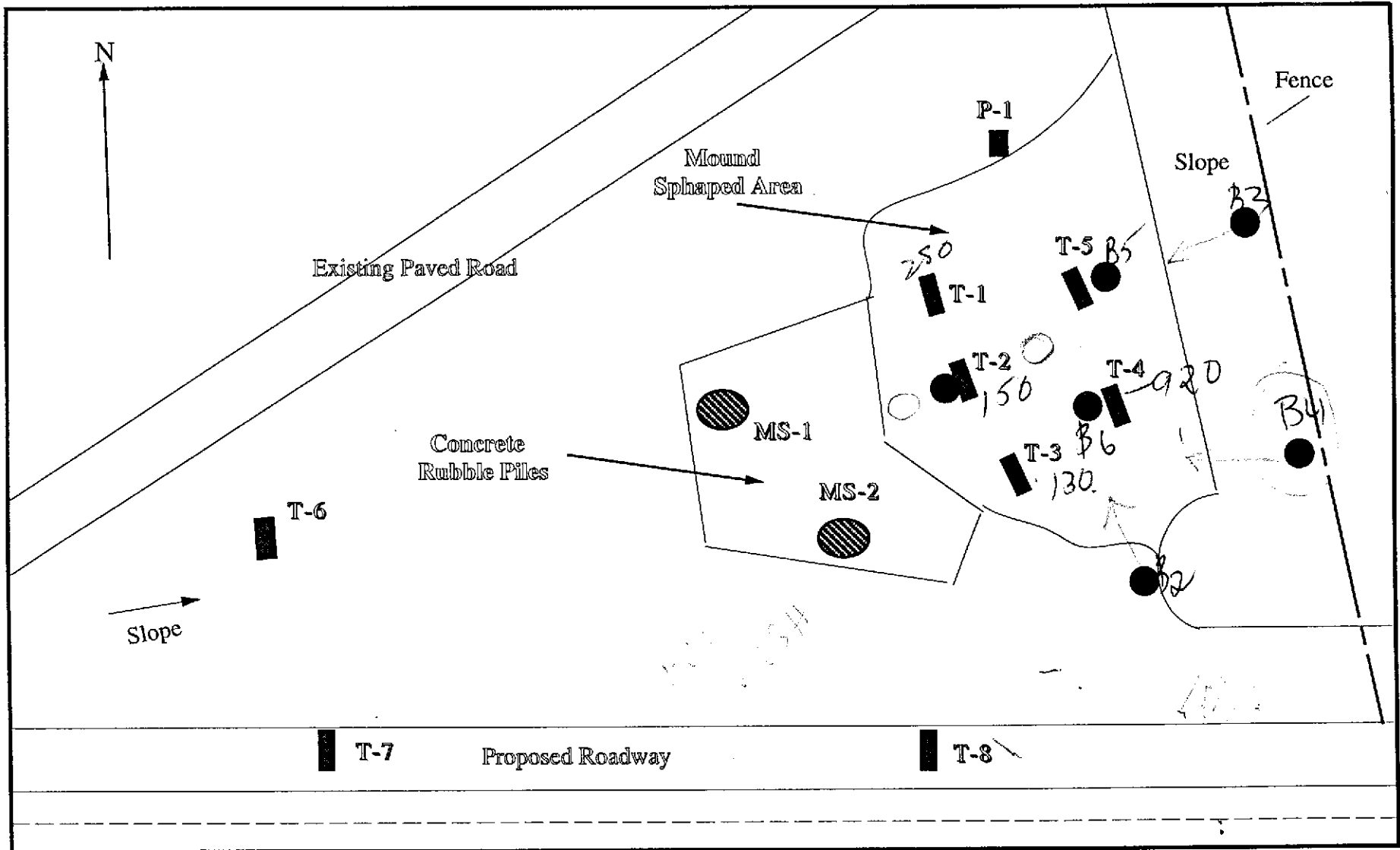

Study Area Map
Altamont Racetrack Project
17001 Midway Road
Tracy, CA 95376



- 
 Areas sampled
-  Proposed Boring Locations

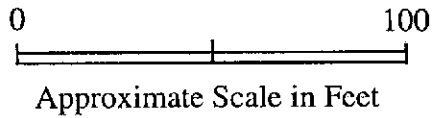

Study Area Map
Altamont Racetrack Project
17001 Midway Road
Tracy, CA 95376