

# hydrologue, Inc.

Consulting Engineers & Geologists

<http://www.hydrologue.com>

Remediation Engineering

Hazardous Substances

Geology and Hydrogeology

Geotechnical Engineering

## VIA U.S. MAIL AND EMAIL

July 13, 2006

Project No. 3034-00

Mr. Steven Plunkett  
Hazardous Materials Specialist  
Alameda County Environmental Health  
1131 Harbor Bay Parkway Ste 250  
Alameda, CA 94502

**SUBJECT: Pacific Bell Telephone Co CTVYCA60 (P5200) Facility  
2610 Norbridge Ave, Castro Valley, CA 94546  
SITE NO. RO0002610**

Dear Mr. Plunkett:

Hydrologue Inc. (HI) has been retained by AT&T Services Inc. (AT&T), formerly SBC Services, Inc. (SBC), the Site Operator to conduct a well search as per your email of June 13, 2006 for the Pacific Bell Telephone Co CTVYCA60 (P5200) Facility at 2610 Norbridge Ave, Castro Valley, CA 94546 (hereinafter referred to as "Site") (Figure 1).

Well information was obtained from both Alameda County Public Works Agency (ACPWA) and the State of California Department of Water Resources (DWR). As per your July 12, 2006 amendment to the scope of work, only the domestic and irrigation wells have been located on the attached map. A table is also attached which was originally prepared by the ACPWA; was cross-checked with the DWR information and updated as necessary. On this table, the domestic and irrigation wells are highlighted in yellow.

Please review this Site for closure at your earliest convenience.

Very truly yours,  
HYDROLOGUE, INC.

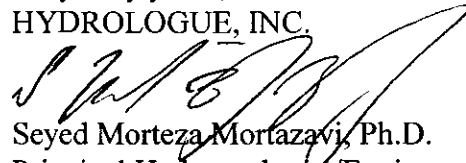

Seyed Morteza Mortazavi, Ph.D.  
Principal Hydrogeologist/Engineer  
C.H.G. No. 516

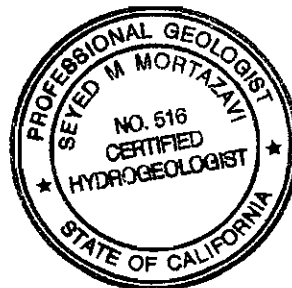

cc: DELANO, LOUISE (SBCSI)

\\triton\projects\REPORTS\SBC\Castrova\FinalSubmission-Well Search.doc

## **FIGURES**

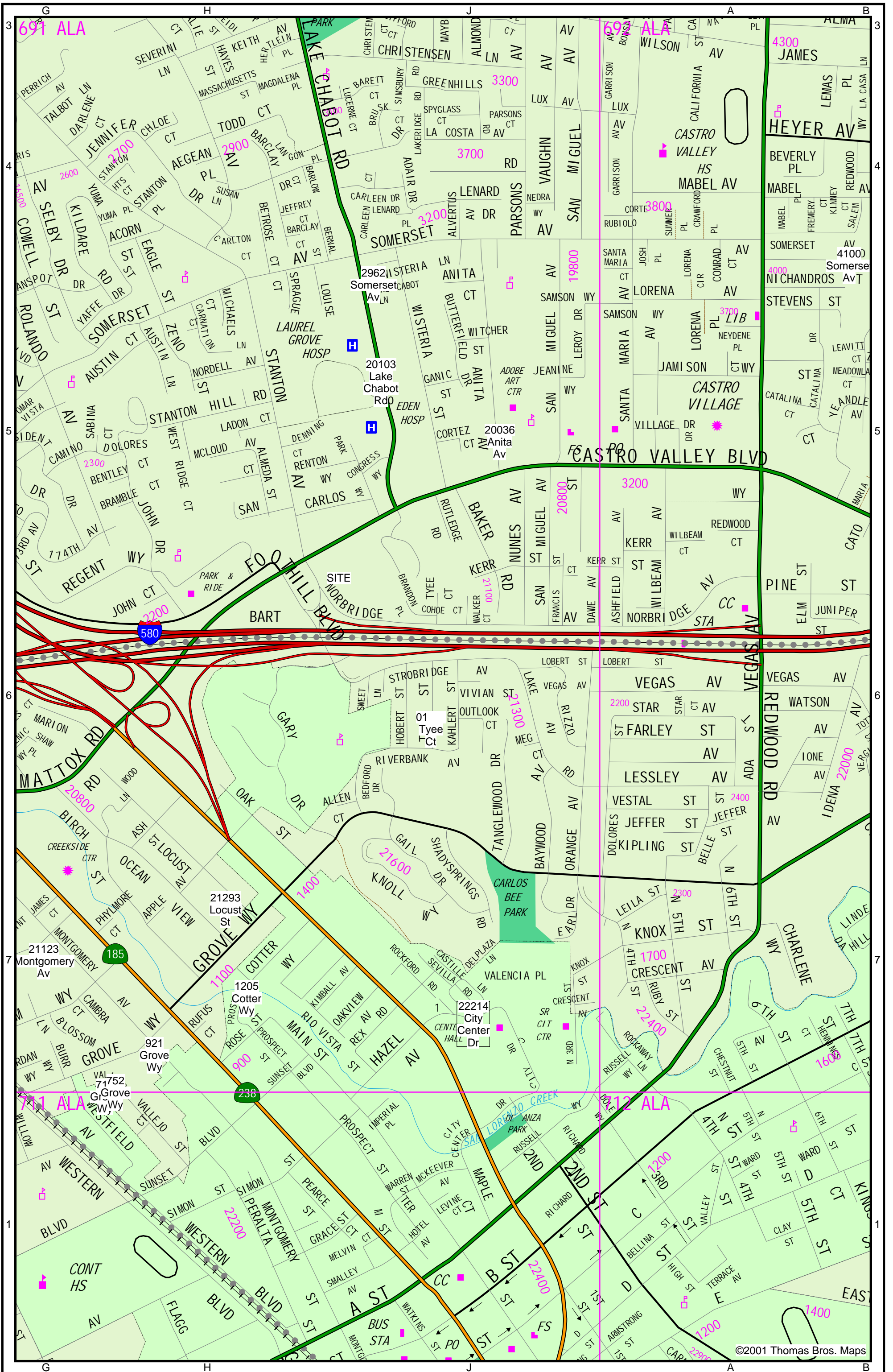

# **APPENDIX A**

Well Search Table

Permit	Tr	Section	Address	Longcity	Owner	Update	Xcoord	Ycoord	Matchlevel	Tsrqg	Rec_code	Phone	City	Drilldate	Elevation	Totaldepth	Waterdepth	Diameter	Use
	3S/2W	4H 2	27210 FAIRVIEW	Castro Valley	BILL JENSEN	8/3/1984	1.22E+08	37701647	9	3S/2W 4H	4243	0	CSV	8/80	0	220	36	6	DOM
	3S/2W	4H 1	7400 SOMERSET AVE	Castro Valley	REES	8/2/1984	1.22E+08	37701647	9	3S/2W 4H	4242	0	CSV	8/64	0	76	0	6	DOM
	3S/2W	4J 1	20036 ANITA AVE	Castro Valley	LOUIS FLOYD	8/3/1984	1.22E+08	37699549	0	3S/2W 4J	4244	0	CSV	2/53	0	51	0	6	IRR
	3S/2W	4K 1	20103 LAKE CHABOT RD	Castro Valley	EDEN TOWNSHIP HOSP.	8/3/1984	1.22E+08	37698177	9	3S/2W 4K	4245	0	CSV	9/53	0	150	110	10	IND* ??????
	3S/2W	9A 1	TYEE CT.	Castro Valley	SAM WALLACE	2/2/1988	1.22E+08	37691200	2	3S/2W 9A	4437	0	CSV	7/53	0	52	0	0	?
	3S/2W	9K 1	1205 COTTER WAY	Hayward	LUIZ ORNELAS CONSTANTINO	8/3/1984	1.22E+08	37681661	0	3S/2W 9K	4440	0	HAY	8/77	0	86	13	6	IRR
	3S/2W	9L 2	2983 EVERGLADE ST	Hayward	MARTINEZ	8/3/1984	1.22E+08	37683740	9	3S/2W 9L	4444	0	HAY	7/77	0	30	22	4	IRR
	3S/2W	9L 3	21293 LOCUST ST	Hayward	M. VERANDES	8/3/1984	1.22E+08	37683740	9	3S/2W 9L	4445	0	HAY	8/77	0	58	17	6	IRR
	3S/2W	9N 1	21123 MONTGOMERY	Hayward	AL SANTUCCI	8/3/1984	1.22E+08	37680182	9	3S/2W 9N	4447	0	HAY	8/77	0	83	44	6	IRR
	3S/2W	9N 2	710 GROVE WAY	Hayward	ELLIOT BABO	8/3/1984	1.22E+08	37680182	9	3S/2W 9N	4448	0	HAY	Nov-77	0	97	50	0	IRR
	3S/2W	9N 3	752 GROVE WAY	Hayward	PAUL SHARP	8/3/1984	1.22E+08	37680182	9	3S/2W 9N	4449	0	HAY	Nov-77	0	98	50	6	IRR
	3S/2W	9P 2	921 GROVE WAY	Hayward	DALE DAVIS	8/3/1984	1.22E+08	37680205	9	3S/2W 9P	4452	0	HAY	7/77	0	91	58	6	IRR
	3S/2W	9P 1	10 MAIN ST	Hayward	GEO. SIMMONDS	8/3/1984	1.22E+08	37680205	9	3S/2W 9P	4451	0	HAY	4/51	0	83	18	6	DOM
			2962 Somerset Ave City Center Drive	Castro Valley Hayward	Foothill Baptist Church Hayward City Hall?								CSV	Jun-88 2/15/1991		80 208		6	?? ??
	3S/2W	4B 1	19101 LAKE CHABOT RD.	Castro Valley	HENRY HERTLIEN		1.22E+08	37705105	9	3S/2W 4B	4239	0	CSV	Dec-88	0	21	10	2	MON
	3S/2W	4E 1	?	Castro Valley	WILLIAM DUNCAN	1/18/1985	1.22E+08	37679450	2	3S/2W 4E	4240	0	CSV	?	0	98	0	5	?
	3S/2W	4F 1	19652 BETROSE CT	Castro Valley	CARL POMBERG	8/2/1984	1.22E+08	37701251	0	3S/2W 4F	4241	0	CSV	7/77	0	52	0	0	TES
	3S/2W	4G 1	3962 Somerset Ave	Castro Valley			0	0	9	3S/2W 4G	7138	0	CSV	Jan-88	0	0	0	0	BOR
	3S/2W	4K 2	20103 Lake Chabot Rd	Castro Valley	Eden Hospital	8/20/1997	1.22E+08	37699390	1	3S/2W 4K	0	0	CSV	3/95	0	20	12	2	MON
	3S/2W	4K 3	20103 Lake Chabot Rd	Castro Valley	Eden Hospital	8/20/1997	1.22E+08	37699390	1	3S/2W 4K	0	0	CSV	3/95	0	25	17	2	MON
	3S/2W	4L	19757&19759 STANTON AVE	Castro Valley	?	9/17/1985	1.22E+08	37699627	0	3S/2W 4L	4246	0	CSV	Aug-85	0	18	10	0	BOR
	3S/2W	4L		Castro Valley			0	0	9	3S/2W 4L	7139	0		Aug-85	0	16	16	0	BOR
	3S/2W	4Q11	20697 Park Way	Castro Valley	Castro Valley Auto Haus	8/1/1991	1.22E+08	37694522	0	3S/2W 4Q	1855	0	CSV	4/91	5	22	11	2	MON
	3S/2W	4Q	2896 CASTRO VALLEY BLVD	Castro Valley	DICK BIGLOW	10/20/1986	1.22E+08	37695244	0	3S/2W 4Q	4247	0	CSV	Sep-86	0	11	0	0	BOR
95584	3S/2W	4Q12	2504 Castro Valley Blvd	Castro Valley	Thrifty Oil Company	10/27/1998	1.22E+08	37693061	1	3S/2W 4Q	0	0	CSV	9/95	0	26	10	2	MON
	3S/2W	4Q 8	2504 Castro Valley Blvd	Castro Valley	Thrifty Oil Company	7/30/1991	1.22E+08	37693067	0	3S/2W 4Q	1765	0	CSV	4/91	0	11	7	2	MON
	3S/2W	4Q 9	2504 Castro Valley Blvd	Castro Valley	Thrifty Oil Company	7/30/1991	1.22E+08	37693067	0	3S/2W 4Q	1766	0	CSV	4/91	0	11	6	2	MON
	3S/2W	4Q10	2504 Castro Valley Blvd	Castro Valley	Thrifty Oil Company	7/30/1991	1.22E+08	37693067	0	3S/2W 4Q	1767	0	CSV	5/91	0	25	13	2	MON
	3S/2W	4Q 1	2504 CASTRO VALLEY RD	Castro Valley	THRIFTY OIL COMPANY	6/1/1988	1.22E+08	37694640	9	3S/2W 4Q	4248	0	CSV	Feb-88	0	26	10	4	MON
	3S/2W	4Q 2	2504 CASTRO VALLEY RD	Castro Valley	THRIFTY OIL COMPANY	6/1/1988	1.22E+08	37694640	9	3S/2W 4Q	4249	0	CSV	Feb-88	0	17	13	4	MON

Permit	Tr	Section	Address	Longcity	Owner	Update	Xcoord	Ycoord	Matchlevel	Tsrqg	Rec_c ode	Phone	City	Drilldate	Elevat ion	Totale pth	Water depth	Diam eter	Use
	3S/2W	4Q 3	2504 CASTRO VALLEY RD	Castro Valley	THRIFTY OIL COMPANY	6/1/1988	1.22E+08	37694640	9	3S/2W 4Q	4250	0	CSV	Feb-88	0	19	0	4	MON
	3S/2W	4Q 4	2504 CASTRO VALLEY RD	Castro Valley	THRIFTY OIL COMPANY	6/1/1988	1.22E+08	37694640	9	3S/2W 4Q	4251	0	CSV	Feb-88	0	16	10	4	MON
	3S/2W	4Q 5		Castro Valley	THRIFTY OIL COMPANY	6/1/1988	1.22E+08	37694640	9	3S/2W 4Q	4252	0	CSV	Feb-88	0	21	10	4	MON
	3S/2W	4Q 6	2504 CASTRO VALLEY RD	Castro Valley	THRIFTY OIL COMPANY	6/1/1988	1.22E+08	37694640	9	3S/2W 4Q	4253	0	CSV	Feb-88	0	15	0	4	MON
	3S/2W	4Q 7	2504 CASTRO VALLEY RD	Castro Valley	THRIFTY OIL COMPANY	6/1/1988	1.22E+08	37694640	9	3S/2W 4Q	4254	0	CSV	Feb-88	0	15	10	4	MON
	3S/2W	4R28	2728 Castro Valley Blvd	Castro Valley	Castro Valley Florist	8/30/1997	1.22E+08	37694472	1	3S/2W 4R	0	0	CSV	8/94	0	16	0	2	MON
	3S/2W	4R14	2920 Castro Valley Blvd	Castro Valley	Chevron USA #9-6991 MW-1	9/30/1992	1.22E+08	37695330	1	3S/2W 4R	8198	0	CSV	9/91	0	21	11	2	MON
	3S/2W	4R15	2920 Castro Valley Blvd	Castro Valley	Chevron USA #9-6991 MW-2	9/30/1992	1.22E+08	37695330	1	3S/2W 4R	8199	0	CSV	9/91	0	21	11	2	MON
	3S/2W	4R16	2920 Castro Valley Blvd	Castro Valley	Chevron USA #9-6991 MW-3	9/30/1992	1.22E+08	37695330	1	3S/2W 4R	8200	0	CSV	9/91	0	20	0	2	MON
	3S/2W	4R25	2920 Castro Valley Blvd.	Castro Valley	Chevron USA #9-6991 MW-4	7/23/1993	1.22E+08	37695332	1	3S/2W 4R	0	0	CSV	9/92	169	20	11	2	MON
	3S/2W	4R26	2920 Castro Valley Blvd.	Castro Valley	Chevron USA #9-6991 MW-5	7/23/1993	1.22E+08	37695332	1	3S/2W 4R	0	0	CSV	9/92	168	20	10	2	MON
	3S/2W	4R27	2920 Castro Valley Blvd.	Castro Valley	Chevron USA #9-6991 MW-6	7/23/1993	1.22E+08	37695332	1	3S/2W 4R	0	0	CSV	9/92	167	24	13	2	MON
95548	3S/2W	4R29	2920 Castro Valley Blvd	Castro Valley	Chevron USA Products Co.	2/4/1998	1.22E+08	37695347	1	3S/2W 4R	0	0	CSV	8/95	0	20	12	2	MON
	3S/2W	4R 5	2896 Castro Valley Blvd	Castro Valley	Lakeshore Financial	4/17/1991	1.22E+08	37695244	0	3S/2W 4R	1611	0	CSV	9/90	0	20	12	2	MON
	3S/2W	4R 6	2896 Castro Valley Blvd	Castro Valley	Lakeshore Financial	4/17/1991	1.22E+08	37695244	0	3S/2W 4R	1612	0	CSV	9/90	0	20	12	2	MON
	3S/2W	4R 7	2896 Castro Valley Blvd	Castro Valley	Lakeshore Financial	4/17/1991	1.22E+08	37695244	0	3S/2W 4R	1613	0	CSV	9/90	0	20	12	2	MON
	3S/2W	4R11	2724 Castro Valley	Castro Valley	Shell Oil Co OMW6	8/14/1992	1.22E+08	37694456	1	3S/2W 4R	7689	0	CSV	7/91	0	23	9	4	MON
	3S/2W	4R12	2724 Castro Valley	Castro Valley	Shell Oil Co OMW7	8/14/1992	1.22E+08	37694456	1	3S/2W 4R	7690	0	CSV	7/91	0	20	9	4	MON
	3S/2W	4R13	2724 Castro Valley	Castro Valley	Shell Oil Co OMW8	8/14/1992	1.22E+08	37694456	1	3S/2W 4R	7691	0	CSV	7/91	0	22	9	4	MON
	3S/2W	4R17	2724 Castro Valley	Castro Valley	Shell Oil Co OMW9	4/16/1993	1.22E+08	37694448	1	3S/2W 4R	0	0	CSV	2/93	0	14	9	3	MON
	3S/2W	4R21	2724 Castro Valley Blvd.	Castro Valley	Shell Oil Co. P-1	6/23/1993	1.22E+08	37694510	1	3S/2W 4R	0	0	CSV	4/92	0	15	0	2	MON
	3S/2W	4R22	2724 Castro Valley Blvd.	Castro Valley	Shell Oil Co. P-2	6/23/1993	1.22E+08	37694510	1	3S/2W 4R	0	0	CSV	4/92	0	15	0	2	MON
	3S/2W	4R23	2724 Castro Valley Blvd.	Castro Valley	Shell Oil Co. P-3	6/23/1993	1.22E+08	37694510	1	3S/2W 4R	0	0	CSV	4/92	0	15	0	2	MON
	3S/2W	4R24	2724 Castro Valley Blvd.	Castro Valley	Shell Oil Co. P-4	6/23/1993	1.22E+08	37694510	1	3S/2W 4R	0	0	CSV	4/92	0	13	12	2	MON
	3S/2W	4R 1	2724 Castro Valley Blvd.	Castro Valley	Shell Oil Company	6/22/1990	1.22E+08	37694456	0	3S/2W 4R	344	0	CSV	1/90	91	16	9	4	MON
	3S/2W	4R 2	2724 Castro Valley Blvd.	Castro Valley	Shell Oil Company	6/22/1990	1.22E+08	37694456	0	3S/2W 4R	345	0	CSV	1/90	94	15	9	4	MON

Permit	Tr	Section	Address	Longcity	Owner	Update	Xcoord	Ycoord	Matchlevel	Tsrqg	Rec code	Phone	City	Drilldate	Elevation	Totaldepth	Water depth	Diameter	Use
	3S/2W	4R 3	2724 Castro Valley Blvd.	Castro Valley	Shell Oil Company	6/22/1990	1.22E+08	37694456	0	3S/2W 4R	346	0	CSV	1/90	93	25	9	4	MON
	3S/2W	4R	2724 Castro Valley Blvd.	Castro Valley	Shell Oil Company	6/22/1990	1.22E+08	37694456	0	3S/2W 4R	347	0	CSV	1/90	0	25	9	12	BOR
	3S/2W	4R 4	2724 Castro Valley Blvd.	Castro Valley	Shell Oil Company	6/22/1990	1.22E+08	37694456	0	3S/2W 4R	348	0	CSV	1/90	91	23	9	4	MON
	3S/2W	4R18	2780 Castro Valley Blvd.	Castro Valley	Side B Corp. MW-1	6/22/1993	1.22E+08	37694926	1	3S/2W 4R	0	0	CSV	5/92	0	25	11	2	MON
	3S/2W	4R19	2780 Castro Valley Blvd.	Castro Valley	Side B Corp. MW-2	6/22/1993	1.22E+08	37694926	1	3S/2W 4R	0	0	CSV	5/92	0	20	11	2	MON
	3S/2W	4R20	2780 Castro Valley Blvd.	Castro Valley	Side B Corp. MW-3	6/22/1993	1.22E+08	37694926	1	3S/2W 4R	0	0	CSV	5/92	0	25	9	2	MON
	3S/2W	9B	22771 MAIN ST	Castro Valley	ANTHONY B. VARNI	12/14/1988	1.22E+08	37690926	9	3S/2W 9B	6705	0	CSV	Aug-88	0	205	0	0	BOR
	3S/2W	9B 6	2620 Norbridge Ave	Castro Valley	Clark's Woodworking MW-1	9/23/1992	1.22E+08	37691847	1	3S/2W 9B	7968	0	CSV	1/92	0	53	0	0	MON
	3S/2W	9B 7	2610 Norbridge Av	Castro Valley	Pacific Bell	7/24/1997	1.22E+08	37691342	1	3S/2W 9B	0	0	CSV	2/94	0	16	5	4	MON
	3S/2W	9B	2445 Castro Valley Blvd	Castro Valley	Unocal Corp.	7/31/1990	1.22E+08	37692102	0	3S/2W 9B	796	0	CSV	Apr-90	0	15	14	8	BOR
	3S/2W	9B 1	2445 Castro Valley Blvd.	Castro Valley	Unocal Corporation	6/8/1990	1.22E+08	37692102	0	3S/2W 9B	248	0	CSV	1/90	0	26	14	2	MON
	3S/2W	9B 2	2445 Castro Valley Blvd.	Castro Valley	Unocal Corporation	6/8/1990	1.22E+08	37692102	0	3S/2W 9B	249	0	CSV	1/90	0	25	20	2	MON
	3S/2W	9B 3	2445 Castro Valley Blvd.	Castro Valley	Unocal Corporation	6/8/1990	1.22E+08	37692102	0	3S/2W 9B	250	0	CSV	1/90	0	22	10	2	MON
	3S/2W	9B 4	2445 Castro Valley Blvd	Castro Valley	Unocal Corporation	3/14/1991	1.22E+08	37692102	0	3S/2W 9B	1253	0	CSV	8/90	0	25	17	2	MON
	3S/2W	9B 5	2445 Castro Valley Blvd	Castro Valley	Unocal Corporation	3/14/1991	1.22E+08	37692102	0	3S/2W 9B	1254	0	CSV	8/90	182	21	10	2	MON
	3S/2W	9B					0	0	9	3S/2W 9B	7148	0		Aug-88	0	205	0	0	BOR
	3S/2W	9E 1	1312 WEBB ST	Castro Valley	CAL. DIVISION OF HIGHWAYS	8/3/1984	1.22E+08	37687210	9	3S/2W 9E	4438	0	CSV	?	0	80	0	36	DES
	3S/2W	9F	21065 Foothill Blvd	Hayward	Bretenbach B-1	9/23/1992	1.22E+08	37686746	1	3S/2W 9F	7959	0	HAY	4/92	0	20	0	0	BOR*
	3S/2W	9F 1	21065 Foothill	Hayward	ROY BREITENBACH	6/3/1992	1.22E+08	37686746	1	3S/2W 9F	7396	0	HAY	1/92	0	44	37	2	MON
	3S/2W	9H 1	BOYWOOD AVE	Hayward	TENNYSON DISTRICT	8/3/1984	1.22E+08	37687210	9	3S/2W 9H	4439	0	HAY	8/49	0	48	0	8	?
	3S/2W	9K 4	21732 FOOTHILL BLVD.	Hayward	/	6/15/1989	1.22E+08	37682484	0	3S/2W 9K	4443	0	HAY	Dec-88	0	27	15	2	MON
	3S/2W	9K 5	21494 Foothill Blvd	Hayward	BP Oil co. SS #11131	9/11/1990	1.22E+08	37684002	0	3S/2W 9K	882	0	HAY	Jun-90	0	44	23	4	MON
	3S/2W	9K 6	21494 Foothill Blvd	Hayward	BP Oil Co. SS #11131	9/11/1990	1.22E+08	37684002	0	3S/2W 9K	883	0	HAY	May-90	0	24	4	4	MON
	3S/2W	9K 7	21494 Foothill Blvd	Hayward	BP Oil Co. SS#11131	9/11/1990	1.22E+08	37684002	0	3S/2W 9K	884	0	HAY	May-90	0	25	15	4	MON
	3S/2W	9K 2	GROVE WAY	Hayward	EBMUD	8/3/1984	1.22E+08	37682750	2	3S/2W 9K	4441	0	HAY	7/82	0	65	0	0	CAT
	3S/2W	9K 8	21732 FOOTHILL BLVD.	Hayward	Emmons Trust	6/16/1993	1.22E+08	37682499	1	3S/2W 9K	0	0	HAY	6/92	0	25	15	2	MON
	3S/2W	9K 3	21501 FOOTHILL BLVD	Hayward	JERRY'S TEXACO	4/30/1986	1.22E+08	37683506	0	3S/2W 9K	4442	0	HAY	Jan-86	0	30	15	2	MON
	3S/2W	9L 4	Locust & Apple St	Hayward	PG&E	9/30/1992	1.22E+08	37684199	1	3S/2W 9L	8183	0	HAY	Dec-91	0	120	0	0	CAT
	3S/2W	9M 1	OCEAN VIEW & ASH	San Leandro	LAVWMA	8/3/1984	1.22E+08	37683740	9	3S/2W 9M	4446	0	SLE	5/79	0	125	0	0	CAT
	3S/2W	9N	834 Blossom Way	Hayward	George Haywood	7/14/1993	1.22E+08	37680143	1	3S/2W 9N	0	0	HAY	3/93	72	45	37	0	BOR
	3S/2W	9N 4	21001 MONTGOMERY AV.	Hayward	WARREN MUNSON	6/15/1989	1.22E+08	37680182	9	3S/2W 9N	4450	0	HAY	Sep-88	0	50	38	2	MON
	3S/2W	9Q 1	21732 FOOTHILL BLVD	Hayward	?	1/10/1990	1.22E+08	37682484	0	3S/2W 9Q	4453	0	HAY	Jun-89	102	27	15	2	MON
	3S/2W	9Q 2	21732 FOOTHILL BLVD	Hayward	?	1/10/1990	1.22E+08	37682484	0	3S/2W 9Q	4454	0	HAY	Jun-89	100	25	14	2	MON

Permit	Tr	Section	Address	Longcity	Owner	Update	Xcoord	Ycoord	Matchlevel	Tsrqg	Rec_c	Phone	City	Drilldate	Elevation	Totaldepth	Waterdepth	Diameter	Use
	3S/2W	9Q 3	21732 FOOTHILL BLVD	Hayward	?	1/10/1990	1.22E+08	37682484	0	3S/2W 9Q	4455	0	HAY	Jun-89	0	20	0	2	MON
	3S/2W	9Q 4	Sunset & Main/SLrz Crk	Hayward	CHEVRON USA MW17	9/4/1992	1.22E+08	37679112	1	3S/2W 9Q	7763	0	HAY	Aug-92	0	38	23	2	MON
	3S/2W	9Q 5	Sunset & Main/SLZ CR	San Lorenzo	Chevron USA Prod. P-1	6/23/1993	1.22E+08	37679158	1	3S/2W 9Q	0	0	SLZ	8/92	87	22	10	2	MON
	3S/2W	9Q 6	21799 Foothill Blvd	Hayward	Foreign Auto Service	8/21/1997	1.22E+08	37681790	1	3S/2W 9Q	0	0	HAY	8/93	0	16	10	2	MON
	3S/2W	9Q 7	21799 Foothill Blvd	Hayward	Foreign Auto Service	8/21/1997	1.22E+08	37681790	1	3S/2W 9Q	0	0	HAY	8/93	0	23	20	2	MON
	3S/2W	9Q 8	21799 Foothill Blvd	Hayward	Foreign Auto Service	8/21/1997	1.22E+08	37681790	1	3S/2W 9Q	0	0	HAY	8/93	0	25	20	2	MON
	3S/2W	9R20	21995 Foothill Blvd	Hayward	Chevron	3/26/1991	1.22E+08	37680670	0	3S/2W 9R	1457	0	HAY	8/90	0	43	32	2	MON
	3S/2W	9R21	21995 Foothill Blvd	Hayward	Chevron	3/26/1991	1.22E+08	37680670	0	3S/2W 9R	1458	0	HAY	8/90	0	42	23	2	MON
	3S/2W	9R22	21995 Foothill Blvd	Hayward	Chevron	3/26/1991	1.22E+08	37680670	0	3S/2W 9R	1459	0	HAY	8/90	0	23	18	2	MON
	3S/2W	9R14	21995 FOOTHILL BLVD.	Hayward	CHEVRON STATION #90260	10/1/1989	1.22E+08	37680670	0	3S/2W 9R	4466	0	HAY	Jun-89	0	25	15	4	MON
	3S/2W	9R15	21995 FOOTHILL BLVD.	Hayward	CHEVRON STATION #90260	10/1/1989	1.22E+08	37680670	0	3S/2W 9R	4467	0	HAY	Jun-89	0	25	15	4	MON
	3S/2W	9R16	21995 FOOTHILL BLVD.	Hayward	CHEVRON STATION #90260	10/1/1989	1.22E+08	37680670	0	3S/2W 9R	4468	0	HAY	Jun-89	0	22	14	4	MON
	3S/2W	9R 9	21995 FOOTHILL BLVD.	Hayward	CHEVRON U.S.A.	6/15/1989	1.22E+08	37680670	0	3S/2W 9R	4463	0	HAY	Oct-88	0	24	14	4	MON
	3S/2W	9R10	21995 FOOTHILL BLVD.	Hayward	CHEVRON U.S.A.	6/15/1989	1.22E+08	37680670	0	3S/2W 9R	4464	0	HAY	Oct-88	0	24	14	4	MON
	3S/2W	9R11	21995 FOOTHILL BLVD.	Hayward	CHEVRON U.S.A.	6/15/1989	1.22E+08	37680670	0	3S/2W 9R	4465	0	HAY	Oct-88	0	32	23	4	MON
	3S/2W	9R18	21995 FOOTHILL BLVD	Hayward	CHEVRON USA	1/19/1990	1.22E+08	37680670	0	3S/2W 9R	4469	0	HAY	Jun-89	0	25	15	4	MON
	3S/2W	9R 5	21995 FOOTHILL BLVD	Hayward	CHEVRON USA INC	6/3/1988	1.22E+08	37680670	0	3S/2W 9R	4459	0	HAY	Jan-88	0	27	11	4	MON
	3S/2W	9R 6	21995 FOOTHILL BLVD	Hayward	CHEVRON USA INC	6/3/1988	1.22E+08	37680670	0	3S/2W 9R	4460	0	HAY	Jan-88	0	25	13	4	MON
	3S/2W	9R 7	21995 FOOTHILL BLVD	Hayward	CHEVRON USA INC	6/3/1988	1.22E+08	37680670	0	3S/2W 9R	4461	0	HAY	Jan-88	0	22	14	4	MON
	3S/2W	9R 8	21995 FOOTHILL BLVD	Hayward	CHEVRON USA INC	6/3/1988	1.22E+08	37680670	0	3S/2W 9R	4462	0	HAY	Jan-88	0	23	13	4	MON
	3S/2W	9R	21995 FOOTHILL BLVD	Hayward	CHEVRON USA INC	6/3/1988	1.22E+08	37680670	0	3S/2W 9R	6707	0	HAY	Jan-88	0	11	0	0	BOR
	3S/2W	9R	FOOTHILL BLVD	Hayward	CITY CENTER OFFICE TOWER	10/22/1985	1.22E+08	37709500	2	3S/2W 9R	6706	0	HAY	Aug-85	0	40	28	0	BOR
	3S/2W	9R	City Center Dr	Hayward	Hayward City Hall	8/2/1991	1.22E+08	37680248	9	3S/2W 9R	1938	0	HAY	2/91	30	47	23	2	MON
	3S/2W	9R 2	HAZEL ST & FOOTHILL BLVD	Hayward	SHELL OIL CO.	8/3/1984	1.22E+08	37680100	0	3S/2W 9R	4456	0	HAY	Nov-73	0	50	0	0	CAT
98WR197	3S/2W	9R23	22253 Foothill Blvd	Hayward	World Oil Marketing Corpo	9/29/1998	1.22E+08	37679594	1	3S/2W 9R	0	0	HAY	5/98	104	30	17	2	MON
98WR197	3S/2W	9R24	22253 Foothill Blvd	Hayward	World Oil Marketing Corpo	9/29/1998	1.22E+08	37679594	1	3S/2W 9R	0	0	HAY	5/98	108	30	17	2	MON
98WR197	3S/2W	9R25	22253 Foothill Blvd	Hayward	World Oil Marketing Corpo	9/29/1998	1.22E+08	37679594	1	3S/2W 9R	0	0	HAY	5/98	107	30	17	2	MON
98WR197	3S/2W	9R26	22253 Foothill Blvd	Hayward	World Oil Marketing Corpo	9/29/1998	1.22E+08	37679594	1	3S/2W 9R	0	0	HAY	5/98	110	30	17	2	MON
	3S/2W	9R 3	22253 FOOTHILL BLVD	Hayward	WORLD OIL STA 76	4/30/1986	1.22E+08	37679596	0	3S/2W 9R	4457	0	HAY	Dec-85	0	40	19	2	MON
	3S/2W	9R 4	22253 FOOTHILL BLVD	Hayward	WORLD OIL STA 76	4/30/1986	1.22E+08	37679596	0	3S/2W 9R	4458	0	HAY	Dec-85	0	36	14	2	MON



## **Well Legend**

DOM=Domestic well (HIGHLIGHTED IN YELLOW AND SHOWN ON MAP)

IRR=Irrigation well (HIGHLIGHTED IN YELLOW AND SHOWN ON MAP)

MUN= Municipal well

IND=Industrial well

CAT=Cathodic well

DES=well destroyed (through permit)

ABN=Abandoned and not being used (but has not been destroyed through permit process)

TES=Test well

BOR= Geotechnical investigation

MON= Monitoring well

EXT=Extraction/ Vapor wells

PIE=Piezometers

REC=Recovery well (extraction/ vapor)

? = Unknown or no information found or given

## **APPENDIX B**

DWR Information for Only  
Domestic & Irrigation Wells

Lic. # 234579

01-4190  
RECEIVED

JAN 06 1989

ZONE 7, ACFC&WCD

Emmett O. Baker  
Water Permit #88296

35/ RW 4G  
Jan 5, 1988 01-4190

Water Resources Management  
General Manager  
J. Killingstad, Chief:

Dear Sir:

I am in no way a professional well driller. You seem to want more information than I am able to give. I will give you a summary of my experiences at trying to find water on the church property at 2962 Somerset Ave. in Castro Valley. I trust this will be enough, maybe you could send me some blank logs to be filled out should I try again to dig another post hole of sufficient depth to hopefully find water.

In June 1988 the church decided we should dig a water well. Since my brother owns a well drill which wasn't being used, I was given permission to dig the well. With almost no experience I began asking for help as to how to go about it. Everybody gave plenty of ideas. I went to Maderia and brought the well drill here. I repaired the drill as necessary to make it operable. I purchased casing-pump-tank and everything that I thought I needed, then started to drill my first post hole. I drilled a 10" hole 80 feet deep, placed my 6" casing and pea gravel into the hole. I left approx. 20 feet above pea gravel for well seal. I rented an air compressor and used air pressure to blow mud and water from well to clean out before placing pump in hole. I placed the pump into hole and was able to pump approx. 100 gallons of water after 24 hours. After one hour I could pump approx. 6 gallons.

I was told that the amount of water would increase by continual pumping so I started to seal the top off and found sand had caved in on top of the pea gravel to a height 10 feet from the top of the ground. After trying several different ways to remove the sand to allow for the seal and not being able to, and with the possibility of finding more water at a different location, I decided to drill a new well doing everything right this time. We had the Water Witch to come back and show us where to drill a second time and how deep. We removed the casing from the first hole and filled it in. We damaged some of the casing and purchased another 10 feet for the depth of the second hole. We drilled the second hole 89 feet deep to accommodate the casing length and more than needed according to the Water Witch. We found about the same type and same depth of different material as we drilled each hole (4 of them) We found rock at about 15-18 feet. We found hard blue clay at about 20-22 feet. We found rock or gravel from 35-42 feet. We found hard blue clay from about 42-45 feet. We found easy drilling from about 45-65 feet. We found more rock or gravel from about 65-to 75 feet. We found sand from 75-84 feet. We found gravel from 84-bottom at 89 feet.

Upon reaching 89 feet, we placed the casing into hole, poured pea gravel up to 20 feet from top of ground, and sealed the top 20 feet off with cement. We rented a more powerful air compressor and blew out the well. We placed the pump into the well and were able to pump approx. the same amount of water as the first hole! I asked the Water Witch to come back to discuss the options available. We decided to go inside the 6" casing with a 6" drill, and drill 20 feet more. Drilling went easy and fast. At 109' I placed the pump into the well and found no more water than at 89 feet.

I placed the drill back into the hole and drilled another 18 feet, at the point of adding another section of drill shaft the bottom of the hole caved in on the drill bit up to the bottom of the casing. Not being able to reverse the drill which might have helped get it out, I used jacks, and was able to move it some, but not to free it. I rented a tow truck which the operator said would lift 60 tons. The drill moved approx. 5 feet before the 2" drill shaft pulled apart at 50 feet from the top of the ground. The shaft is still there and the amount of water is still about 100 gallons after 24 hours. With such a slow recovery it seemed foolish to bother with it. We still have a pump in it with the jet at about 87 feet.

We decided to have another Water Witch check to see if he could agree with another spot the first one had suggested might be another place we could find water. He did not agree at all, but found another spot about 100 feet from the last one, so we were off again.

We started our third post hole. Since money was now becoming a problem, our Pastor wanted to know if we could place the pump into the hole to see if we had water before buying the casing and gravel etc. We discussed the hazard involved but decided to try anyway. We were able to get the pump out. The sand caved in to a level of 10 feet from the top of the ground. There was more than sand in the cave in. We put the drill back into the hole to flush the sand out after buying a casing and gravel. The drill kept hitting something, maybe a rock which kept falling lower into the hole as we removed the sand. At about 60' the threads stripped on the drill shaft about 5 feet above the bit. We pumped the water out to try and get a hold onto the shaft. As soon as the water was removed the sand caved in, covering the bit and filling the hole to a level 10 feet from the top of the ground. (At least we didn't have much trouble filling in the rest of the hole.)

Now we have casing and gravel and cement so we drill another hole about 30 feet from the third one at the next suggested spot. Drilling went very well (experience helps). The suggested depth was 72 feet, the length of our casing. We finished the well off and placed the pump into the well. The amount of water was (is) approx.  $\frac{1}{2}$  the amount of the first two wells. Our Pastor wants to pump from both wells in order to salvage something from all the work and expense. I tried to convince him that it was not worth the time and effort since there was not enough water to make it worthwhile. I suggested that it would be better to drill another well if we could find a better place to drill. The Pastor finally agreed. We are now waiting on the Water Witch to come from Sacramento with another type of tool to show us where to drill next. I am hoping he does not find a place, he is satisfied with. However, I would like to keep the permit open in case he does.

352w-4G  
3. 01-4190

( These notes are from the last well to date and may be of interest to you.) R

First 5 feet is filled with rocks and concrete  
Next 15 feet is easy drilling  
Hard blue clay at 20 feet for one foot  
Next 5 feet easy drilling  
From 26-37 feet very soft (sand)?  
Three feet of gravel, 37-40 feet  
One half foot hard blue clay at 40 feet  
Next 15 feet easy drilling with gravel at 46 and again at 54 feet.  
Hard blue clay at 55-56 feet.  
Some gravel at 63 feet then  
Hard clay at 63 and  $\frac{1}{2}$  feet for  $\frac{1}{2}$  foot.  
Gravel and then hard clay again at 65 feet.  
Slow drilling to 74 feet then,  
Gravel and soft sand for 3 feet.  
Stopped drilling well #4 at 77 feet.

Sincerely Yours,  
Emmett O. Baker  
Foothill Baptist Church 537-0414

*Emmett O. Baker*

Custodian



01-4198

555

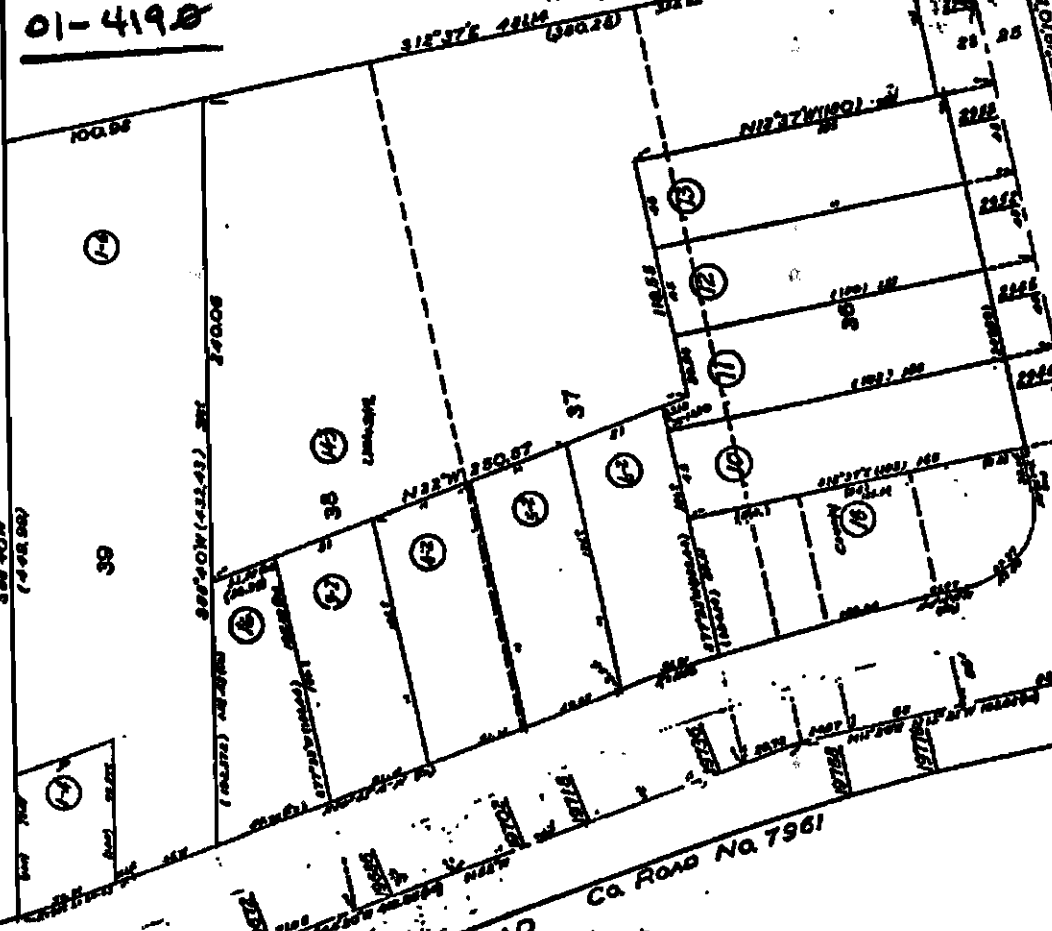

LAKE CHABOT ROAD  
Co. Road No. 7961

STREET) 37733W N77°16'30\"/>

(WILLIAM AVENUE)  
SOMERSET

64A

50'

**CONFIDENTIAL**

STATE OF CALIFORNIA DWR  
WELL COMPLETION REPORT  
(WELL LOGS)

**REMOVED**



**CONFIDENTIAL**

STATE OF CALIFORNIA DWR  
WELL COMPLETION REPORT  
(WELL LOGS)

**REMOVED**

**CONFIDENTIAL**

STATE OF CALIFORNIA DWR  
WELL COMPLETION REPORT  
(WELL LOGS)

**REMOVED**

**CONFIDENTIAL**

STATE OF CALIFORNIA DWR  
WELL COMPLETION REPORT  
(WELL LOGS)

**REMOVED**

**CONFIDENTIAL**

STATE OF CALIFORNIA DWR  
WELL COMPLETION REPORT  
(WELL LOGS)

**REMOVED**

**CONFIDENTIAL**

STATE OF CALIFORNIA DWR  
WELL COMPLETION REPORT  
(WELL LOGS)

**REMOVED**

**CONFIDENTIAL**

STATE OF CALIFORNIA DWR  
WELL COMPLETION REPORT  
(WELL LOGS)

**REMOVED**

**CONFIDENTIAL**

STATE OF CALIFORNIA DWR  
WELL COMPLETION REPORT  
(WELL LOGS)

**REMOVED**

**CONFIDENTIAL**

STATE OF CALIFORNIA DWR  
WELL COMPLETION REPORT  
(WELL LOGS)

**REMOVED**



33298

33298

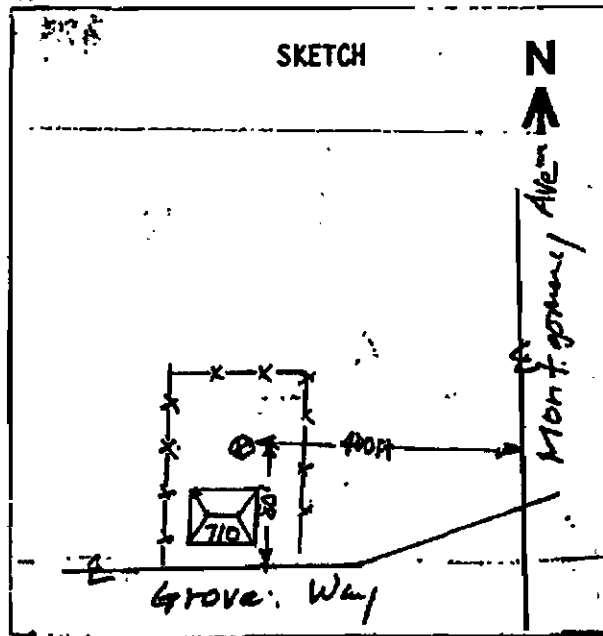

1978 FEB 6 PM 1 42

DEPT. OF WATER RESOURCES

01-1474

35/2W 9R

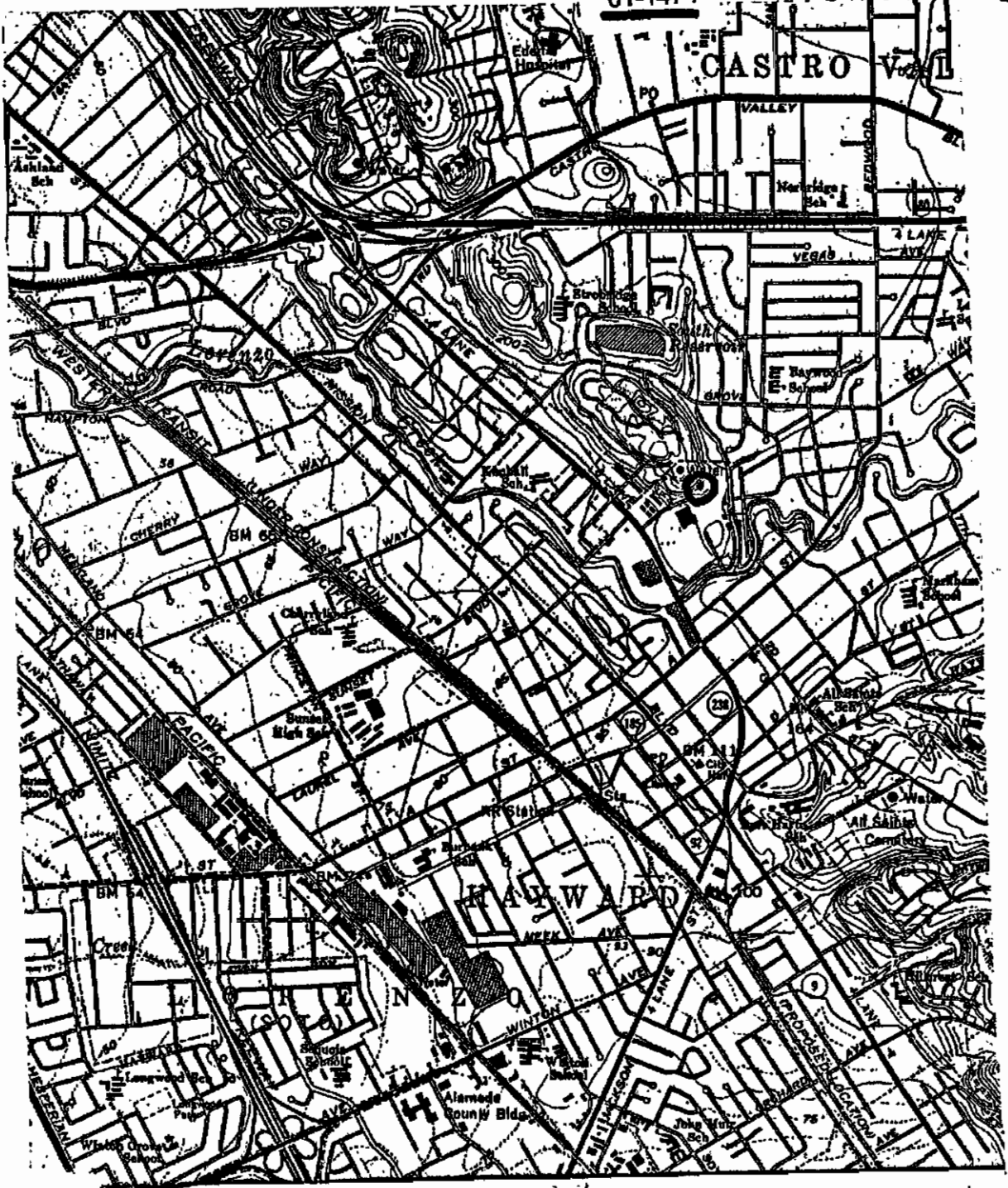

SCALE 1:24 000

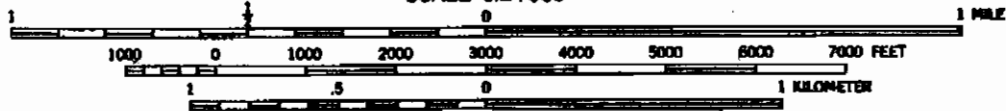

Location Map for City Center Drive, Hayward 91033  
 # 91033

01-1474  
35/2W 9R

#91033

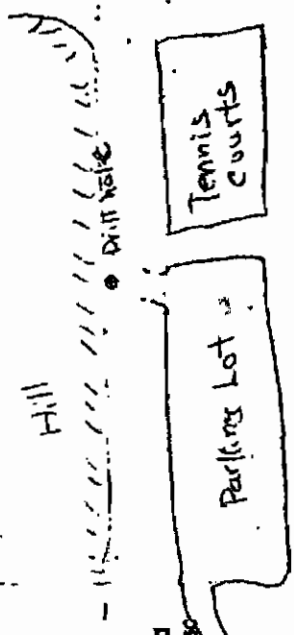

SMA 430

SMA 431  
HAYWARD CITY CENTER

SMA 432

CITY CENTER DRIVE

SAN LORENZO CREEK

FOOTHILL BLVD.

# 91033

FIELD LOG 01-1474 35/2W 9R

LOCATION

DATE:

HAYNARD CITY HALL

2/5/91

DEPTH S.# LITH DESCRIPTION

0 -

dk brown 10YR 3/3

Gravelly sandy loam

4 -

yellowish brown 10YR 5/6

rocky - deeply weathered rock (rhyolite)

8 -

hard

12 -

softer

v closely fractured some sheared seams

16 -

PETTER DRILLING CO.

FIELD LOG

35/2W 9R

LOCATION

DATE:

01-14-74

DEPTH S.# LITH DESCRIPTION.

16

20

24

28

32

hard

moderately fractured

yellowish brown 10YR 5/6 to

dk yellowish brown 10YR 4/4

v fine grained rock (rhyolite?)

FIELD LOG

35/2W 9R

LOCATION

DATE:

01-1474

DEPTH S.# LITH DESCRIPTION.

32 -

36 -

40 -

44 -

48 -



FIELD LOG

3S/2W 9R

LOCATION

DATE:

01-1474

DEPTH S.# LITH DESCRIPTION.

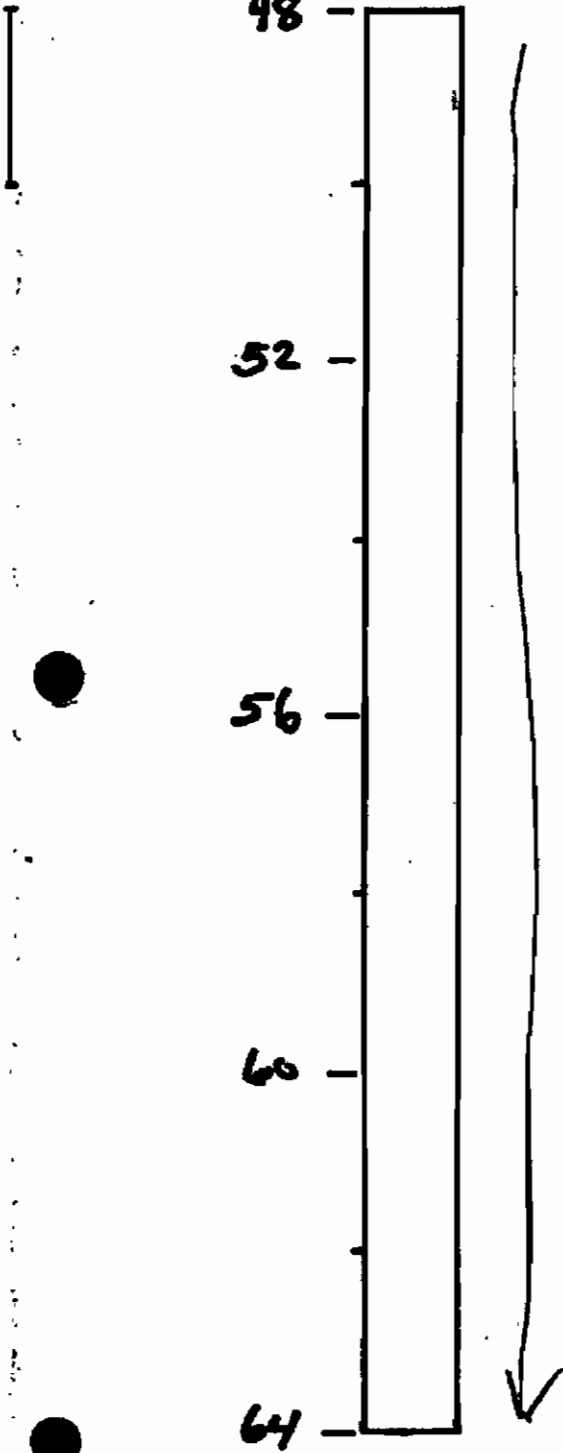

FIELD LOG

3S/2W9R

LOCATION

DATE: 01-14-74

DEPTH S.# LITH DESCRIPTION.

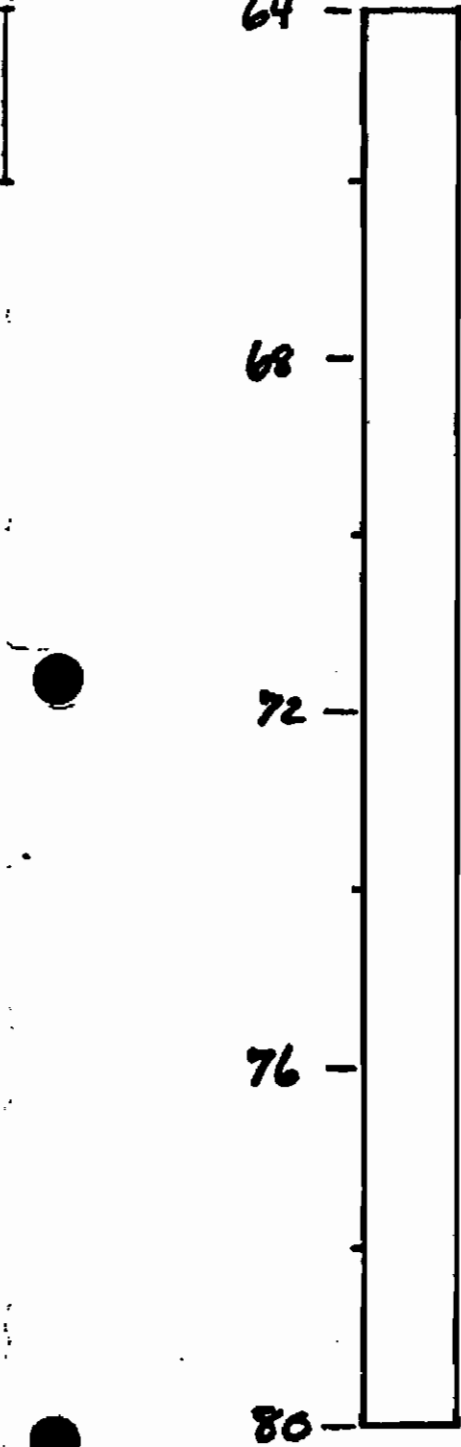



FIELD LOG

3S/2W9R

LOCATION

DATE:

01-14-74

DEPTH

S.#

LITH

DESCRIPTION.

80 -

dk greenish grey s<sup>-</sup> G<sup>+</sup>/<sub>1</sub>  
v-fine grained rock  
extremely hard

84 -

88 -

92 -

96 -

FIELD LOG

35/2W 9R

LOCATION

DATE:

01-1474

DEPTH S.# LITH DESCRIPTION.

96

100

104

108

112

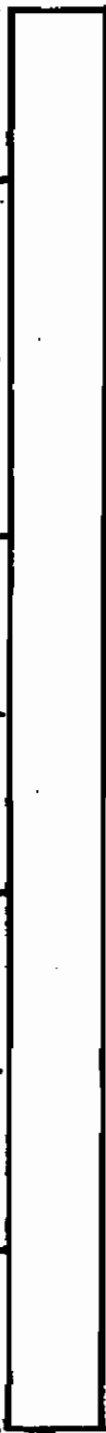

FIELD LOG

3S/2W 9R

LOCATION	DATE:
----------	-------

01-1474

DEPTH S.# LITH DESCRIPTION.

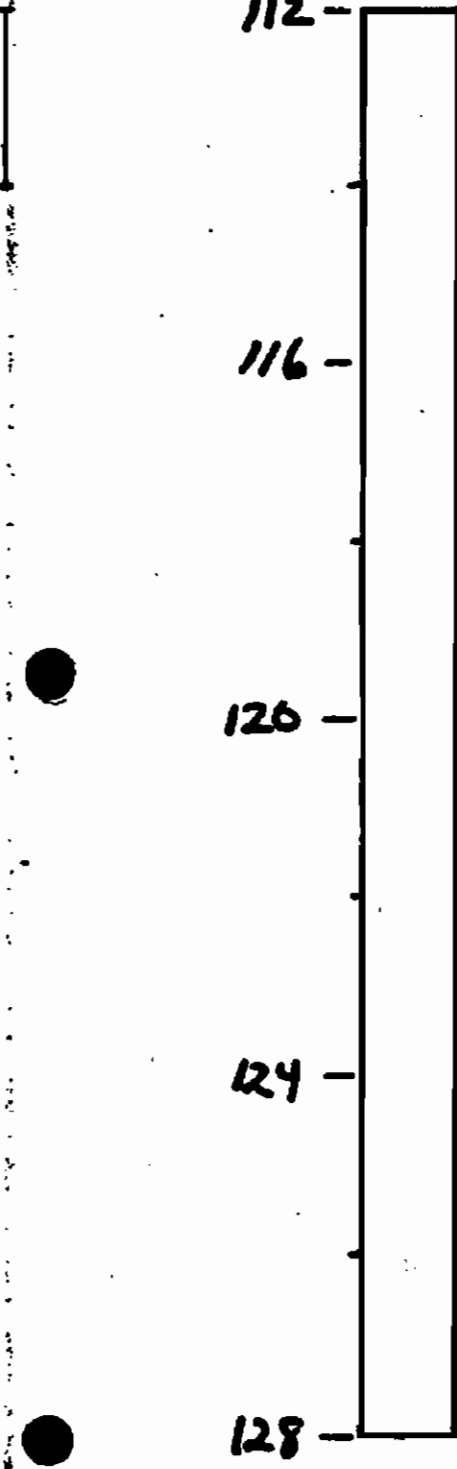

FIELD LOG

3512W 9R

LOCATION

DATE:

01-1474

DEPTH S.# LITH DESCRIPTION.

128 -

132 -

136 -

140 -

144 -



FIELD LOG

3S/2W 9R

LOCATION

DATE:

01-1474

DEPTH S.# LITH DESCRIPTION.

144

148

152

156

160



FIELD LOG

3S/2W 9R

LOCATION

DATE:

01-1474

DEPTH S.# LITH DESCRIPTION.

160

164

168

172

176

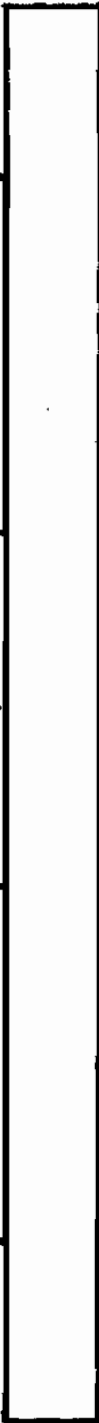

FIELD LOG

35/2W 9R

LOCATION

DATE:

01-1474

DEPTH S.# LITH DESCRIPTION.

176

180

184

188

192



FIELD LOG

35/2W 9R

LOCATION

DATE:

01-14-74

DEPTH S.# LITH DESCRIPTION.

192 -

196 -

200 -

204 -

208 -





Borings performed by Judd Hull Associates (8/85)

Approximate Location of Borings Performed by Judd Hull & Associates (2/84)

Proposed Location of Multi-Story Office Building

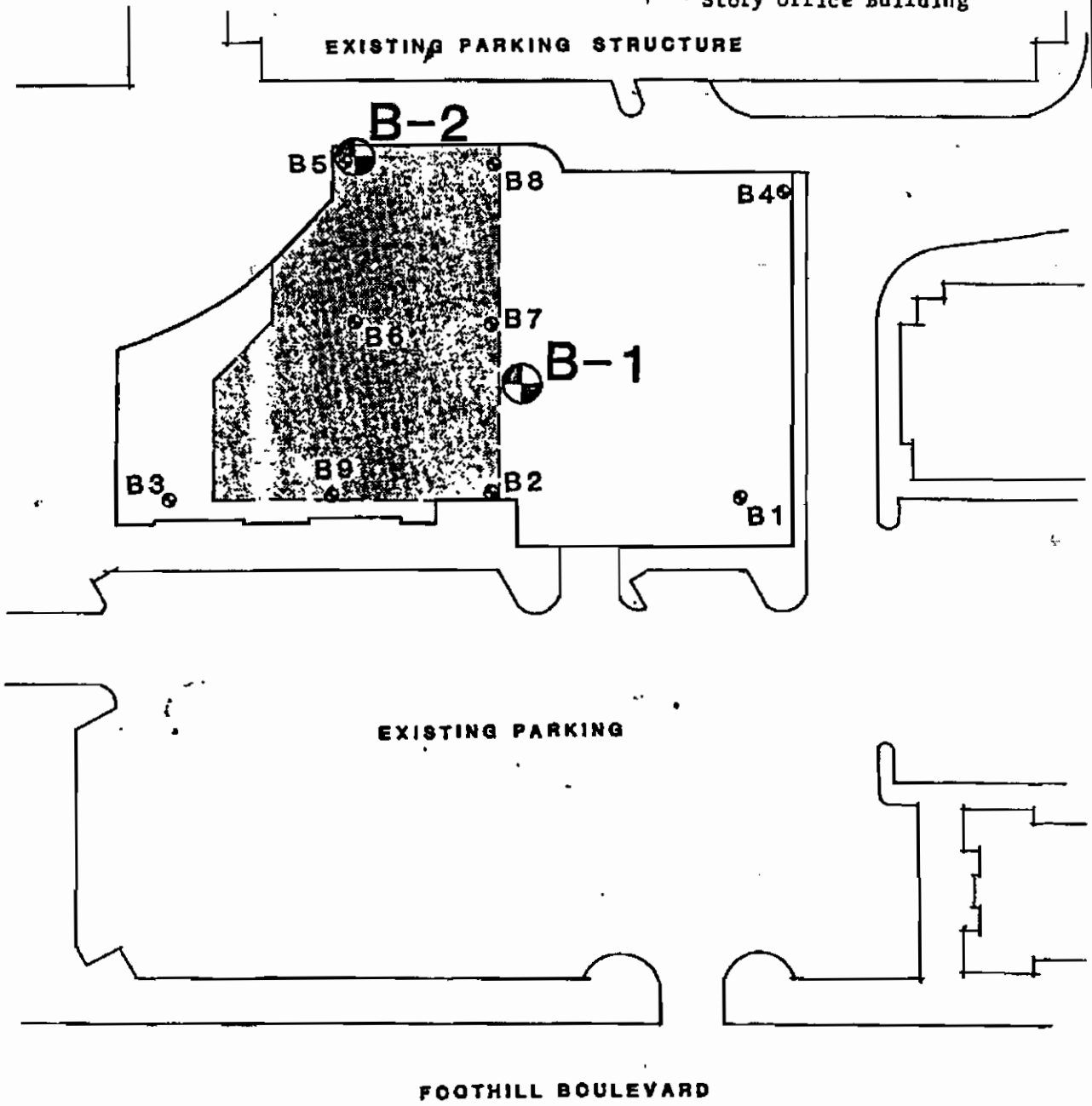

FIG 1 SITE PLAN

SCALE: 1" = 64'

Jha

Judd Hull Associates

-24-	SILTY CLAY: OLIVE-GROWN TO GREEN, MOIST, AND very stiff.	FIGURE No. 2	Jha
Stratification lines represent the approximate boundary between the engineer's description of material types and the actual transitions may be gradual and vary with time or location.			

PROJECT NAME: City Center Office Tower		PROJECT NO.: H85046							
Logged By: HDB		Date: 8/12/8	Equipment: 8" Hollow Stem Auger			Log of: B-1			
Depth, ft.	Sample No. and Type	Symbol	MATERIAL DESCRIPTION	Unified Soil Classification	Blows/foot 350 ft-lbs.	Qu - t. s. l. Penetrometer	Dry Density p. c. l.	Moisture % dry wt.	MISC. LAB RESULTS
- Continued -									
24	VL		SILTY CLAY: olive-brown to green; moist; very stiff.	CL	100/ 6.5"		94	27	Qu = 7060psf
25									
26									
27	VL		WEATHERED SERPENTINITE: olive-green with tan streaks.		100/ 4"				
28									
29									
30									
31									
32									
33	No Recovery				100/ 6.5"				
34									
35									
36	T				50/ 1.5"				
37									
38									
39									
40			Drilling terminated at 40'. Groundwater encountered at approximately 28' at time of drilling. Groundwater at 28' after drilling.						
41									
42									
43									
44									
45									
46									
47									

Stratification lines represent the approximate boundary between the engineer's description of material types and the actual transitions may be gradual and vary with time or location

G.P.O. # 89150

Hayward City Center  
Foothill Boulevard

01-096.B

33/2w 9R

Project No. H85046-A28E7

LEGEND

- ⊕ Approximate Location of Borings Performed by Judd Hull Associates (8/85)
- ⊙ Approximate Location of Borings Performed by Judd Hull & Associates (2/84)
- Proposed Location of Multi-Story Office Building



EXISTING PARKING STRUCTURE

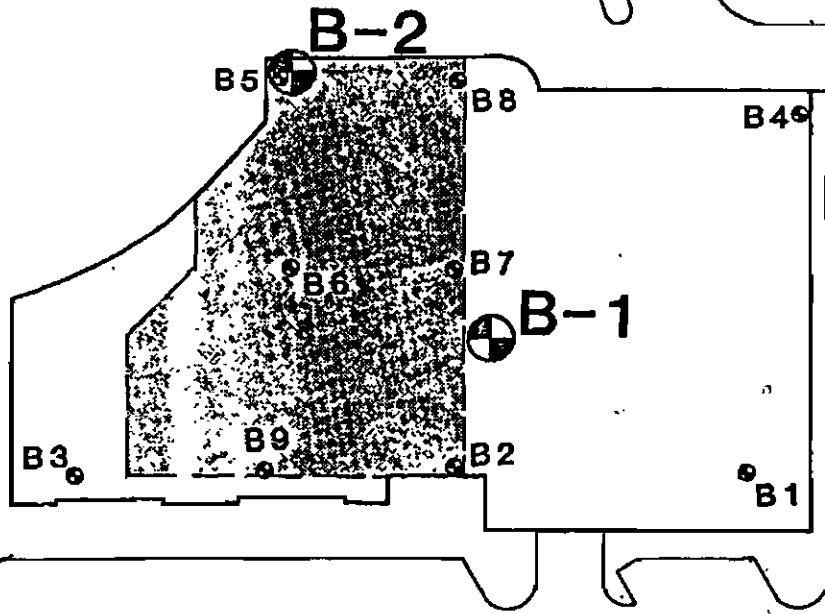

EXISTING PARKING

FOOTHILL BOULEVARD

**FIG 1 SITE PLAN**

SCALE: 1" = 64'

Jha

Scale of 1/4" = 100'

PROJECT NAME:		City Center Office Tower		PROJECT NO.:		H85046			
Logged by:		HDB		Date:		8/13/85			
Equipment:		8" Hollow Stem Auger		Log of:		B-2			
Depth, ft.	Sample No. and Type	Symbol	MATERIAL DESCRIPTION	Unified Soil Classification	Blows/foot @50 ft-lbs.	Qu - t.s.t. Penetrometer	Dry Density p.c.f.	Moisture % dry wt.	MISC. LAB RESULTS
			Ground Elevation: 126'±						
1			SILTY CLAY: brown; moist; very stiff to hard.	CL		3.5-4.5+			
2									
3									
4									
5									
6	VL								
7					92/11"		112	18	Qu = 8730psf
8			SILTY SAND: brown; damp; trace of clay.	SM					
9									
10									
11	VL								
12									
13									
14									
15	VL								
16			CLAYEY SILT: brown; damp; hard; seams of silty clay.	ML/CL		85	4.5+	93	30
17									
18									
19									
20									
21	VL								
22			WEATHERED SERPENTINITE: green with brown oxidation stains; damp; fractured; changing to decomposed with seams of clayey silt, brown and tan.			100/5"		140	10
23									
24									

Stratification lines represent the approximate boundary between the engineer's description of material types and the actual transitions may be gradual and vary with time or location.

FIGURE No. 3

Jhā

PROJECT NAME: City Center Office Tower		PROJECT NO.: H85046							
Logged By: HDB		Date: 8/13/85			Equipment: 8" Hollow Stem Auger		Log of: B-2		
Depth, ft.	Sample No. and Type	Symbol	MATERIAL DESCRIPTION	Unified Soil Classification	Blows/foot 950 ft-lbs.	Qu - L. s. t. Penetrometer	Dry Density p. o. f.	Moisture % dry wt.	MISC. LAB RESULTS
- Continued -									
24	VL		WEATHERED SERPENTINITE: green with brown oxidation stains; damp; fractured; changing to decomposed with seams of clayey silt, brown and tan.		100/ 3"		106	23	
25									
26									
27	VL				100/ 5.5'				
28									
29									
30	No Recovery		FRACTURED SERPENTINITE: dark olive-green; occasional seams of blue-gray silty clay.		100/ 4.5'				
31									
32									
33	No Recovery				100/ 1"				
34									
35									
36	Core								
37									
38									
39	No Recovery								
40									
41									
42	Core		Drilling terminated at 42'. Groundwater encountered at 25' at time of drilling.						
43									
44									
45	No Recovery								
46									
47									

Stratification lines represent the approximate boundary between the engineer's description of material types and the actual transitions may be gradual and vary with time or location

Figure No. 3

JDC

**CONFIDENTIAL**

STATE OF CALIFORNIA DWR  
WELL COMPLETION REPORT  
(WELL LOGS)

**REMOVED**

**CONFIDENTIAL**

STATE OF CALIFORNIA DWR  
WELL COMPLETION REPORT  
(WELL LOGS)

**REMOVED**

**APPENDIX C**  
Well Search Authorization



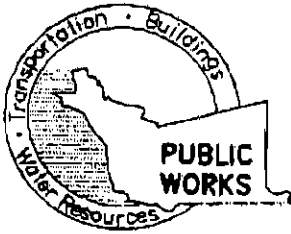

**COUNTY OF ALAMEDA  
PUBLIC WORKS AGENCY  
WATER RESOURCES SECTION**  
399 Elmhurst Street, Hayward, CA 94544-1395  
James Yoo PH: (510) 670-6633 FAX: (510) 782-1939  
FOR GENERAL DRILLING PERMIT INFO:  
**www.acgov.org/pwa/wells**

**WELL COMPLETION REPORT RELEASE AGREEMENT—AGENCY**  
(Government and Regulatory Agencies and their Authorized Agents)

Project No/ Site Address: 2610 Norbridge Ave, City Castro Valley 94546

Township, Range, and Section \_\_\_\_\_ Radius 0.5 MILE  
(Must include entire study area and a map that shows the area of interest.)

Under California Water Code Section 13752, the agency named below requests permission from Department of Water Resources to inspect or copy, or for our authorized agent named below to inspect or copy, Well Completion Reports filed pursuant to Section 13751 to (check one):

- Make a study, or,
- Perform an environmental cleanup study associated with an unauthorized release of a contaminant within a distance of 2 miles.

In accordance with Section 13752, information obtained from these reports shall be kept confidential and shall not be disseminated, published, or made available for inspection by the public without written authorization from the owner(s) of the well(s). The information shall be used only for the purpose of conducting the study. Copies obtained shall be stamped **CONFIDENTIAL** and shall be kept in a restricted file accessible only to agency staff or the authorized agent.

Hydrologue Inc. Attn: Chris d'Sa

\_\_\_\_\_  
Authorized Agent  
2793 E Foothill Blvd  
\_\_\_\_\_  
Address  
Pasadena, CA 91107  
\_\_\_\_\_  
City, State, and Zip Code

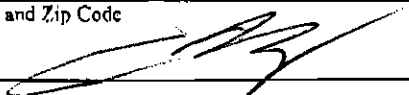
\_\_\_\_\_  
Signature   
Senior Project Manager

\_\_\_\_\_  
Title

Telephone ( ) 626 595 9696

Fax ( ) 626 585 0046

6/14/06  
\_\_\_\_\_  
Date

chris@hydrologue.com  
\_\_\_\_\_  
E-mail

Alameda County Env Health: Steven Plunkett

\_\_\_\_\_  
Government or Regulatory Agency  
1131 Harbor Bay Parkway Ste 250  
\_\_\_\_\_  
Address  
Alameda, CA 94502  
\_\_\_\_\_  
City, State, and Zip Code

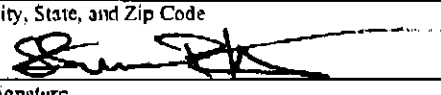
\_\_\_\_\_  
Signature   
Engineering Geologist

\_\_\_\_\_  
Title

Telephone ( ) (510) 383-1767

Fax ( ) 510-337-9335

6/14/06  
\_\_\_\_\_  
Date

steven.plunkett@acgov.org  
\_\_\_\_\_  
E-mail

STATE OF CALIFORNIA - THE RESOURCES AGENCY

ARNOLD SCHWARZENEGGER, Governor

DEPARTMENT OF WATER RESOURCES

CENTRAL DISTRICT

3251 S Street  
Sacramento, CA 95816  
(916) 227-7632  
(916) 227-7600(Fax)

NORTHERN DISTRICT

2440 Main Street  
Red Bluff, CA 96080  
(530) 529-7300  
(530) 529-7322 (Fax)

SAN JOAQUIN DISTRICT

3374 East Shields Avenue  
Fresno, CA 93726  
(559) 230-3300  
(559) 230-3301 (Fax)

SOUTHERN DISTRICT

770 Fairmont Avenue  
Glendale, CA 91203  
(818) 543-4600  
(818) 543-4604 (Fax)

WELL COMPLETION REPORT RELEASE AGREEMENT--AGENCY  
(Government and Regulatory Agencies and their Authorized Agents)

Project/Contract No. ALAMEDA County

Township, Range, and Section 2610 Norbridge Ave, Castro Valley 94546 Radius

(Must include entire study area and a map that shows the area of interest.)

Under California Water Code Section 13752, the a gency named below requests permission from Department of Water Resources to inspect or copy, or for our authorized agent named below to inspect or copy, Well Completion Reports filed pursuant to Section 13751 to (check one):

Make a study, or,

Perform an environmental cleanup study associated with an unauthori zed release of a contaminant within a distance of 2 miles.

In accordance with Section 13752, information obtained from these reports shall be kept confidential and shall not be disseminated, published, or made available for inspection by the public without written authorization from the owner(s) of the well(s). The information shall be used only for the purpose of conducting the study. Copies obtained shall be stam ped CONFIDENTIAL and shall be kept in a restricted file accessible only to agency staff or the authorized agent.

Hydrologue Inc. Attn: Chris d'Sa

Alameda County Env Health : Steven Plunkett

Authorized Agent

Government or Regulatory Agency

2793 E Foothill Blvd

1131 Harbor Bay Parkway Ste 250

Address

Address

Pasadena, CA 91107

Alameda, CA 94502

City, State, and Zip Code

City, State, and Zip Code

Signature 

Signature 

Title Senior Project Manager

Title Engineering Geologist

Telephone (626) 585 9696

Telephone (510) 383-1767

Fax 626 585 0046

Fax (510) 337-9335

Date 6/14/06

Date 6/14/06

E-mail chris@hydrologue.com

E-mail steven.plunkett@acgov.org

6 June 2001

RO ~~311~~  
2610

ALAMEDA COUNTY ENVIRONMENTAL HEALTH DEPARTMENT  
Division of Environmental Protection

1131 HARBOR BAY PARKWAY, SUITE 250  
ALAMEDA, CA 94502-6577  
Telephone (510) 567-6700 FAX (510) 337-9335

F A C S I M I L E C O V E R S H E E T

To: Chris d'sa

From: Steven Plunkett

626-585-0046

Date: 4/11/06

Notes: Chris, here are the signed well  
survey documents that you emailed today

If you have any questions please call me  
at 383-1767