

1300

Rancho Santa Rita
(J. D. Pacheco) (Pat. Bk. A Pg. 194)

Record OF SURVEY 316 (RS. Bk. 7 Pg. 9)

P.M. 2566 116/66

P.M. 3707 137/10

P.M. 4199 146/60

Scale: 1" = 600'

1401 1400
STATE HIGHWAY U.S. 50 WEST

- Rev. 5-13-84 NVE 3-24-95 CSL
- 10-27-80 CSL
- 8-15-89 JT
- 12-15-89 JCR
- 1-29-90 JCR
- 10-4-84 MT
- 5-16-85 BT
- 11-6-88 BT
- 4-26-92 BT

Family Bk 95 Bk 110
Final Ass Bk 1280 7-89

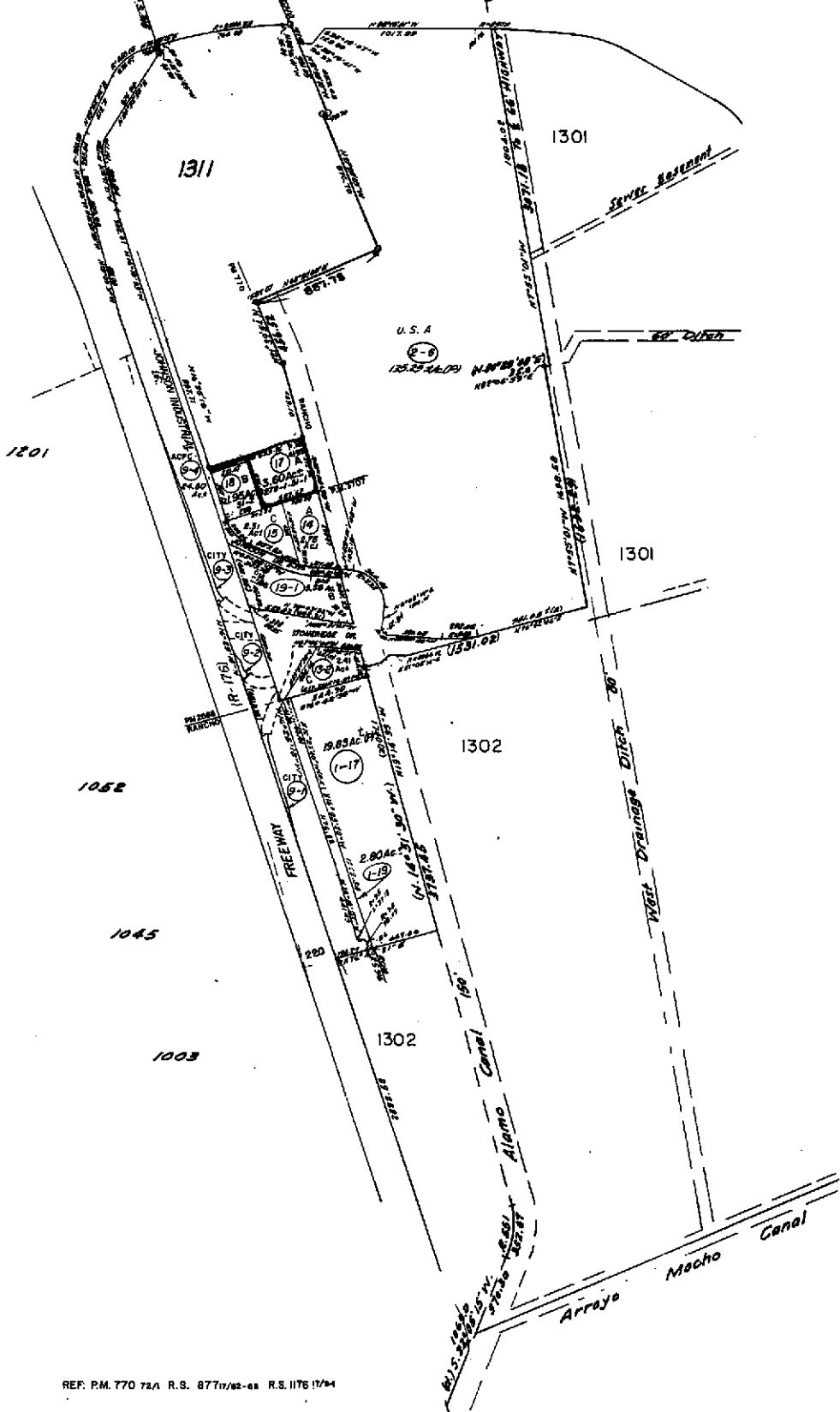

R02609



COUNTY OF ALAMEDA
Assessor's Office

Property Value System

History

Value

Transfer

[New Query](#)

Parcel Number: **941-1300-17** Inactive: **N** Lien Date: **01/01/2006** Owner: **P T & T CO 279-1-51-1**

Property Address: **JOHNSON DR , PLEASANTON, CA 94566**

[Parcel History](#)

Mailing Name	Historical Mailing Address	Document Date	Document Number	Value From Trans Tax	Parcel Count	Use
P T & T CO 279-1-51-1	1521 FRANKLIN ST , OAKLAND, CA 94612- 2803	11/16/1982	1982-174576		3	0500

All information on this site is to be assumed accurate for property assessment purposes only, and is based upon the Assessor's knowledge of each property. Caution is advised for use other than its intended purpose.

The Alameda County Intranet site is best viewed in Internet Explorer Version 5.5 or later.
Click [here](#) for more information regarding supported browsers.

Copyright © 2001 Alameda County

Property Detail

Alameda, CA Ron Thomsen, Assessor

SEP 07 2004

Parcel # (APN): 941 -1300-017-00

Use Description:

Parcel Status:

Owner Name: PTT CX 279 1 51 1

941-1300-017 *
941-1300-018

Mailing Address: 1521 S F, Oakland CA 94612-2803

Situs Address: JOHNSON DR, PLEASANTON CA 94566

Legal
Description:* SITE IS COMPRISED OF
BOTH APN #'S. RELEASE
HAPPENED AT THE
FIRST ONE. REGL**ASSESSMENT**

Total Value:	Use Code:	050	
Land Value:	Tax Rate Area:	19006	
Impr Value:	Year Assd:	2003	Improve Type:
Other Value:	Property Tax:		Price/SqFt:
% Improved:	Delinquent Yr:		
Exempt Amt:	Exempt Codes:		

SALES HISTORYSale 1Sale 2Sale 3Transfer

Recording Date:				11/16/1982
Recorded Doc #:				82 174576
Recorded Doc Type:				
Transfer Amount:				
Sale 1 Seller (Grantor):				
1st Trst Dd Amt:	Code1:	2nd Trst Dd Amt:	Code2:	

PROPERTY CHARACTERISTICS

Lot Acres:	3.600A	Year Built:	Fireplace:
Lot SqFt:	156,817	Effective Yr:	A/C:
Bldg/Liv Area:			Heating:
Units:		Total Rooms:	Pool:
Buildings:		Bedrooms:	Flooring:
Stories:		Baths (Full):	Park Type:
Style:		Baths (Half):	Spaces:
Construct:		Bsmt SqFt:	Site Inlfnce:
Quality:		Garage SqFt:	
Building Class:			Timber Preserve:
Condition:			Ag Preserve:
Other:			
Other Rooms:			



COUNTY OF ALAMEDA

Assessor's Office**Property Value System****History****Value****Transfer**New Query

Parcel Number: 941-1300-17 Lien Date: 01/01/2005 Owner: P T & T CO 279-1-51-1

Property Address: JOHNSON DR , PLEASANTON, CA 94566

Parcel History

Mailing Name	Mailing Address	Document Date	Document Number	Value From Trans Tax	Parcel Count	Use
P T & T CO 279-1-51-1	1521 FRANKLIN ST , OAKLAND, CA 94612- 2803	11/16/1982	1982-174576		3	0500

All information on this site is to be assumed accurate for property assessment purposes only, and is based upon the Assessor's knowledge of each property. Caution is advised for use other than its intended purpose.

The Alameda County Intranet site is best viewed in Internet Explorer Version 5.5 or later.
Click [here](#) for more information regarding supported browsers.

Copyright © 2001 Alameda County



COUNTY OF ALAMEDA
Assessor's Office

Property Value System

History

Value

Transfer

New Query

Parcel Number: **941-1300-18** Lien Date: **01/01/2006** Owner: **P T & T CO 279-1-51-2**

Property Address: **JOHNSON DR , PLEASANTON, CA 94566**

Parcel History

Mailing Name	Mailing Address	Document Date	Document Number	Value From Trans Tax	Parcel Count	Use
P T & T CO 279-1-51-2	1521 FRANKLIN ST , OAKLAND, CA 94612- 2803	11/16/1982	1982-174576		3	0500

All information on this site is to be assumed accurate for property assessment purposes only, and is based upon the Assessor's knowledge of each property. Caution is advised for use other than its intended purpose.

The Alameda County Intranet site is best viewed in Internet Explorer Version 5.5 or later.
 Click [here](#) for more information regarding supported browsers.

Copyright © 2001 Alameda County