

CAMBRIA



Fax

| | |
|----------|--------------|
| To: | ROSANNA |
| Company: | ACHCSA |
| Fax: | 510-337-9335 |
| Phone: | |

| | |
|--------|----------------------------------|
| From: | [REDACTED] |
| Phone: | [REDACTED] |
| Pages: | 2 including cover |
| Date: | 3/24/04 |
| Re: | 2834 East 7th St. Oakland, Ca |

Hard Copy- to Follow? Yes No

ROSANNA,

HERE IS PAGE 5 OF THE "SUBSURFACE INVESTIGATION REPORT" DATED JANUARY 23, 2004 FOR THE ABOVE REFERENCED SITE AS WE DISCUSSED.

PLEASE CALL ME WITH ANY FURTHER QUESTIONS.

THANKS,

Matt

This fax transmittal is intended solely for use by the person or entity identified above. Any copying or distribution of this document by anyone other than the intended recipient is strictly prohibited. If you are not the intended recipient, please telephone us immediately and return the original transmittal to us at the address listed below.

Cambria Environmental Technology, Inc., 5900 Hollis Street, Suite A, Emeryville, CA 94608 Tel (510) 420-0700 Fax (510) 420-9170

CITY OF OAKLAND FIRE DEPARTMENT
Office Of Emergency Services
 1605 Martin Luther King Jr. Way, Oakland, CA 94612

Hazardous Materials Program

Contaminated Site Case Transfer Form

Alameda County
 MAR 03 2004
Environmental Health

Referral To:

| | |
|------------------|---------------------------------------------------------------------------------|
| Date | 1/30/2004 |
| Agency | Alameda County Environmental Health, 1131 Harbor Bay Parkway, Alameda, CA 94502 |
| Attention | Donna L. Drogos, LOP/SLIC Program Manager |

Site Information:

| | |
|-------------------------------------------|-----------------------------------------------|
| Site Responsible Party(s) | |
| Site Name | Hans and Gunter Roofing Company |
| Site Address | 2834 East 7th Street |
| Site Phone | (510)357- 6991 |
| Site Contractor/Consultant (if available) | Cambria Environmental Technology, Inc. |
| Site DBA | N/A |

Site Conditions:

| | |
|-----------------------------------------------------------------------------------------------------------------------------|---------------------------------------------------------------------|
| UST | |
| USTs removed? Yes # removed: 1 Date removed: approximately 2 years ago | Yes <input checked="" type="checkbox"/> No <input type="checkbox"/> |
| Contents (circle): <u>gasoline</u> diesel waste oil heating oil solvents kerosene stoddard solvent other (specify) _____ | Yes <input checked="" type="checkbox"/> No <input type="checkbox"/> |
| Observations of system (holes, leaks)? <u>unknown</u> | Yes <input type="checkbox"/> No <input type="checkbox"/> |
| Observed contamination (free product, smell, soil/water discoloration)? | Yes <input checked="" type="checkbox"/> No <input type="checkbox"/> |
| Detectable concentrations of soil and/or groundwater contamination? | Yes <input checked="" type="checkbox"/> No <input type="checkbox"/> |
| o Highest Concentration Detected in Soil Contaminant (specify) <u>TPH(g)</u> Concentration <u>270</u> ppm | |
| o Highest Concentration Detected in Water Contaminant (specify) <u>N/A</u> Concentration <u>N/A</u> ppb | |
| Unauthorized Release Form filed? | Yes <input type="checkbox"/> No <input checked="" type="checkbox"/> |
| Future intended use if known? Specify <u>industrial</u> | Yes <input type="checkbox"/> No <input type="checkbox"/> |
| NON-UST | |
| Former industrial use? | Yes <input type="checkbox"/> No <input type="checkbox"/> |
| Detectable concentrations of soil and/or groundwater contamination? | Yes <input type="checkbox"/> No <input type="checkbox"/> |
| o Highest Concentration Detected in Soil Contaminant (specify) _____ Concentration _____ ppm | |
| o Highest Concentration Detected in Water Contaminant (specify) _____ Concentration _____ ppb | |
| Future intended use if known? Specify _____ | Yes <input type="checkbox"/> No <input type="checkbox"/> |
| <i>If available, attach pertinent reports</i> | |

Transferred as: LOP SLIC

Level of Update requested: distribution list all meetings all site visits closure sign off all the above

Transfer requested by Inspector: [Signature] Date: March 1, 2004

Transfer accepted by (ACEH): _____ Date: _____

**OAKLAND FIRE DEPARTMENT/OFFICE OF EMERGENCY SERVICES
HAZARDOUS MATERIALS UNIT**

1605 Martin Luther King Jr. Way, Oakland, CA 94612 • (510) 238-3938

HAZARDOUS MATERIALS INSPECTION REPORT

| | | | |
|-------------|-------------------------|------------------|----------|
| Site Number | Facility Name | Facility Address | Zip Code |
| | Gambren & Kitch Roofing | 2834 E. 7th St | 06 |

Inspection Report

PERMISSION TO INSPECT GRANTED

Cambria Environmental performing 2 ca. 16 ft bgs sample borings i.e., B₂ / B₃.

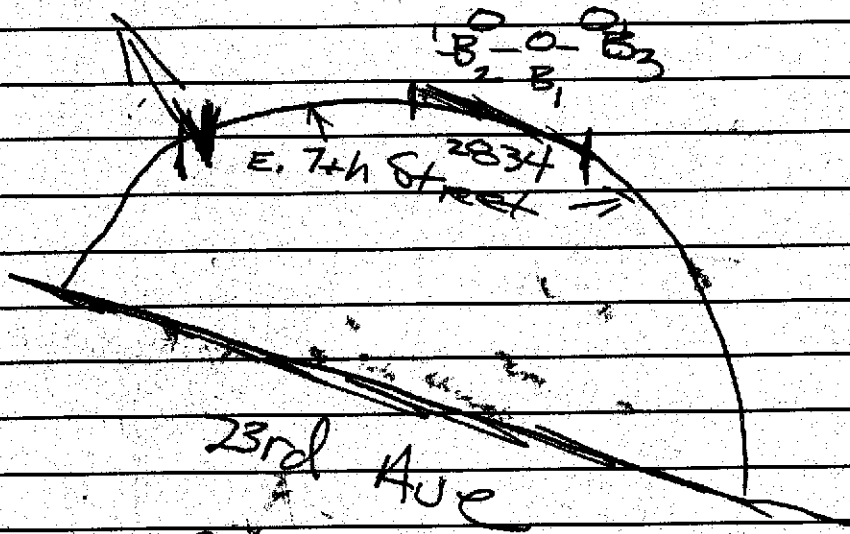

2 - Borings taken ~ 6 years after actual removal of TK to support results of B₁.
B₁ was acquired @ time: 28 Jul 03

| | | | |
|------------------------------|----------------|----------------------------------------------------|----------|
| Facility Contact/Print Name: | Inspected By: | <input type="checkbox"/> Insp. Griffin | 238-7759 |
| Matt Meyers, 510-420-3314 | <i>HM</i> | <input checked="" type="checkbox"/> Insp. Matthews | 238-2396 |
| Facility Contact/Signature: | | <input type="checkbox"/> Insp. Craford | 238-7758 |
| <i>[Signature]</i> | | <input type="checkbox"/> Insp. Gomez | 238-7253 |
| | Date: 5 Dec 03 | | |