

GIBSON, DUNN & CRUTCHER LLP

LAWYERS

A REGISTERED LIMITED LIABILITY PARTNERSHIP
INCLUDING PROFESSIONAL CORPORATIONS

ONE MONTGOMERY STREET

TELESIS TOWER

SAN FRANCISCO, CALIFORNIA 94104-4505

(415) 393-8200

FACSIMILE: (415) 986-5309

June 11, 1996

NEW YORK
200 PARK AVENUE
NEW YORK, NEW YORK 10166-0193

WASHINGTON
1050 CONNECTICUT AVENUE, N.W.
WASHINGTON, D.C. 20036-5306

PARIS
104 AVENUE RAYMOND POINCARÉ
75116 PARIS, FRANCE

LONDON
30/35 PALL MALL
LONDON SW1Y 5LP

HONG KONG
10TH FLOOR, TWO PACIFIC PLACE
88 QUEENSWAY
HONG KONG

AFFILIATED SAUDI ARABIA OFFICE
JARIR PLAZA, OLAYA STREET
P.O. BOX 15870
RIYADH 11454, SAUDI ARABIA

OUR FILE NUMBER

JAS. A. GIBSON, 1852-1922
W. E. DUNN, 1861-1925
ALBERT CRUTCHER, 1860-1931

LOS ANGELES
333 SOUTH GRAND AVENUE
LOS ANGELES, CALIFORNIA 90071-3197

CENTURY CITY
2029 CENTURY PARK EAST
LOS ANGELES, CALIFORNIA 90067-3026

ORANGE COUNTY
4 PARK PLAZA
IRVINE, CALIFORNIA 92714-8557

SAN DIEGO
750 B STREET
SAN DIEGO, CALIFORNIA 92101-4605

DALLAS
1717 MAIN STREET
DALLAS, TEXAS 75201-7390

DENVER
1801 CALIFORNIA STREET
DENVER, COLORADO 80202-2641

WRITER'S DIRECT DIAL NUMBER

(415) 393-8342

T 64324-00012

VIA OVERNIGHT DELIVERY

Gilbert A. Jensen
Sr. Deputy District Attorney
District Attorney's Office
7677 Oakport Street, Suite 400
Oakland, Calif. 94621

Re: People v. National Airmotive Corporation
Alameda County Sup. Court, Case No. H-179506-2

Dear Mr. Jensen:

Per our telephone conversation yesterday, enclosed please find two (2) copies of the Accounting Letter and Proposal Re Trust Fund for Remaining Credit in connection with the above-referenced matter. I have signed both copies on behalf of National Airmotive Corporation ("NAC").

Please review the enclosed at your earliest convenience. If you have any questions, please call. If everything appears appropriate, please sign the copies and return one of them to me. AS I mentioned on the telephone, I have changed the date for getting the check from NAC to your office to June 24, 1996. Accordingly, I am hopeful that we can get this finalized by then.

42:8 WA 91 11-23
AM 8:29

GIBSON, DUNN & CRUTCHER LLP

Gilbert A. Jensen, Esq.
June 11, 1996
Page 2

Thank you for your continuing cooperation in
bringing this matter to a resolution.

Very truly yours,

A handwritten signature in black ink, appearing to read "Bill Connell", with a long horizontal flourish extending to the right.

William D. Connell

Enclosures

cc: Scott O. Seery, CHMM (with enclosure)
National Airmotive Corporation (with enclosure)

FA961630.055/-1+

GIBSON, DUNN & CRUTCHER LLP

JAS. A. GIBSON, 1852-1922
W. E. DUNN, 1861-1925
ALBERT CRUTCHER, 1860-1931

LAWYERS

NEW YORK
200 PARK AVENUE
NEW YORK, NEW YORK 10166-0193

LOS ANGELES
333 SOUTH GRAND AVENUE
LOS ANGELES, CALIFORNIA 90071-3197

A REGISTERED LIMITED LIABILITY PARTNERSHIP
INCLUDING PROFESSIONAL CORPORATIONS

WASHINGTON
1050 CONNECTICUT AVENUE, N.W.
WASHINGTON, D.C. 20036-5306

ONE MONTGOMERY STREET

TELESIS TOWER

SAN FRANCISCO, CALIFORNIA 94104-4505

PARIS
104 AVENUE RAYMOND POINCARÉ
75116 PARIS, FRANCE

(415) 393-8200

FACSIMILE: (415) 986-5309

LONDON
30/35 PALL MALL
LONDON SW1Y 5LP

June 10, 1996

HONG KONG
10TH FLOOR, TWO PACIFIC PLACE
88 QUEENSWAY
HONG KONG

AFFILIATED SAUDI ARABIA OFFICE
JARIR PLAZA, OLAYA STREET
P.O. BOX 15870
RIYADH 11454, SAUDI ARABIA

OUR FILE NUMBER

CENTURY CITY
2029 CENTURY PARK EAST
LOS ANGELES, CALIFORNIA 90067-3026

ORANGE COUNTY
4 PARK PLAZA
IRVINE, CALIFORNIA 92714-8557

SAN DIEGO
750 B STREET
SAN DIEGO, CALIFORNIA 92101-4805

DALLAS
1717 MAIN STREET
DALLAS, TEXAS 75201-7390

DENVER
1801 CALIFORNIA STREET
DENVER, COLORADO 80202-2641

WRITER'S DIRECT DIAL NUMBER

(415) 393-8342

T 64324-00012

Gilbert A. Jensen
Sr. Deputy District Attorney
District Attorney's Office
7677 Oakport Street, Suite 400
Oakland, Calif. 94621

Re: People v. National Airmotive Corporation
Alameda County Sup. Court, Case No. H-179506-2

Dear Mr. Jensen:

1. INTRODUCTION

This letter is written pursuant to Section (5)(I) of the Stipulation for Consent Judgment ("Stipulation") entered in the above-referenced matter on or about October 21, 1994. The following, including the attachments hereto, is an accounting for amounts spent or presently contracted by National Airmotive Corporation ("NAC") in connection with its performance of work required to comply with paragraphs (5)(C), (5)(D), and (5)(F) of the Stipulation.¹ NAC is entitled to a credit for these expenditures of up to \$125,000 towards the

¹ You should also be aware that NAC has spent substantial additional amounts in performance of work to comply with other sections of the Stipulation (e.g., Section (5)(G) relating to development and presentation of a training curriculum). However, according to the terms of the Stipulation, those amounts have not been included in determining the amount of Section (5)(I) credit available.

56 JUN 14 1996
FBI PROTECTION
FBI PROTECTION

Gilbert A. Jensen, Esq.
June 10, 1996
Page 2

\$125,000 "additional costs" to be paid to the Treasurer of Alameda County.

In addition, pursuant to discussions between the parties, this letter also sets forth the parties' understanding regarding handling of the currently unused credit amount of \$20,705.78 pending anticipated completion of the ongoing monitoring activities at the Test Cell Facility.

2. ACCOUNTING FOR AMOUNTS SPENT/CONTRACTED

Attached as Exhibit A hereto is a spreadsheet detailing the amounts already spent or currently contracted by NAC in connection with work performed on: (1) the investigation and monitoring of the Jet-A fuel spill effects at the Test Cell Facility (Stipulation §(5)(C)); (2) the investigation and monitoring of the oil-containing water discharges at the Test Cell Facility (Stipulation §(5)(D)); and, (3) the Environmental Compliance Audit (Stipulation §(5)(F)). Attached as numbered exhibits to Exhibit A are invoices detailing the amounts reflected on the spreadsheet.

As indicated in Exhibit A, NAC has, to date, spent or contracted to spend \$104,294.22, for which it is entitled to credit under the Stipulation.

The amount of the credit remaining unused at this time is \$20,705.78.

3. REMAINING CREDIT - TRUST FUND

On February 21, 1996, the Alameda County Department of Environmental Health ("the County") outlined in a letter its requirements for a monitoring program "to complete the Jet-A fuel release and 'gray water' investigations at the Test Cell Facility." A copy of that letter is attached as Exhibit B hereto. Pursuant to that letter, NAC submitted a proposal for such a program, which has been approved by the County. A copy of that proposal is attached as Exhibit C.

NAC has already contracted for and commenced the monitoring described in Exhibit C. In the event no further work is required as a result of findings made during the course of the monitoring, that work is scheduled to be completed by in or about June, 1998, with no additional expenditures involved beyond the current contract amount (which is already included in the accounting set forth in Exhibit A).

Gilbert A. Jensen, Esq.
June 10, 1996
Page 3

It is possible, however, that the monitoring program, or other presently contemplated work at the Test Cell Facility (specifically, work related to removal or replacement of the underground fuel tanks) to be completed by the end of 1998, may reveal residual effects from the Jet-A fuel spill or the "gray water" discharge with respect to which the County may require NAC to conduct additional investigation, prolonged or additional monitoring, or remediation work. In that event, the parties have agreed that NAC shall be entitled to use some or all of the remaining credit amount of \$20,705.78 for expenditures for such additional investigation, prolonged or additional monitoring, or remediation work.

Accordingly, the parties agree to the following with respect to the remaining credit amount of \$20,705.78:

(1) On or before June 24, 1996, NAC shall deliver to the District Attorneys' Office a check in the amount of \$20,705.78, made payable to "Alameda County Hazardous Materials Training and Resource Trust Account." This check shall then be deposited forthwith in a sub-account of the Alameda County Hazardous Materials Training and Resource Trust Account, which shall be designated as the "NAC Oakland Airport Remediation Sub-Account" ("Sub-Account").

(2) In the event that, on or before December 31, 1998, NAC is required to incur and pay expenses, not already provided for in the Envirometrix Proposal, dated March 1, 1996, and attached as exhibit 13 to Exhibit A hereto, in connection with work performed to comply with Stipulation Sections (5)(C) or (5)(D), NAC shall be entitled to reimbursement of such expenditures from the Sub-Account up to the amount of the funds remaining in the Sub-Account at the time reimbursement is sought according to the procedures set forth below.

(3) To obtain reimbursement from the Sub-Account, NAC shall submit to the Alameda County District Attorneys' Office (Attention: Gilbert Jensen, or such other person as Mr. Jensen may designate) a description of the work performed and copies of all related invoices paid by NAC for which reimbursement from the Sub-Account is sought.

(4) Within thirty (30) days of NAC's submission of a request for reimbursement, the District Attorneys' Office shall: (1) deliver to NAC a check, drawn on the Sub-Account, for the amount sought or for such portion of that amount as the County does not dispute (not to exceed the balance

Gilbert A. Jensen, Esq.
June 10, 1996
Page 4

remaining in the Sub-Account), and/or (2) in the event that the County disputes all or any portion of the amount sought, deliver to NAC a statement, in writing, setting forth the specific grounds upon which the County disputes that such amount should be paid.

(5) In the event of any dispute, following the County's submission of its detailed statement and pursuant to Sections (5)(I) and (7) of the Stipulation and Consent Order thereon, either party may submit the matter to the Court by noticed motion for determination of the proper amount to be paid from the Sub-Account, if any. Any such motions shall be noticed for hearing no later than November 30, 1998.

(6) If, at any time on or before December 31, 1998, as a result of reimbursements paid to NAC, the balance of the Sub-Account shall decrease to zero, the Sub-Account shall be closed, and the provisions of Section (5)(I) of the Stipulation shall be deemed fulfilled. In any event, on January 1, 1999, or the first business day thereafter, any and all funds remaining in the Sub-Account shall be paid over to the Treasurer of Alameda County, the Sub-Account shall be closed, and the provisions of Section (5)(I) of the Stipulation shall be deemed fulfilled.

By their signatures below, the undersigned, on behalf of the respective parties, agree to the foregoing accounting and to the terms for handling and disbursement of the remaining credit amount.

JOHN J. MEEHAN
GILBERT A. JENSEN
OFFICE OF THE DISTRICT ATTORNEY
COUNTY OF ALAMEDA

WILLIAM D. CONNELL
GIBSON, DUNN & CRUTCHER LLP

By: _____
Gilbert A. Jensen

By: _____
William D. Connell

Attachments

cc: Scott O. Seery, CHMM (with attachments)
National Airmotive Corporation (with attachments)

COMPLIANCE AUDIT -- EMCON ASSOCIATES				
Consent Order, Section 5(F)				
INVOICE DATE	AMOUNT	TOTAL	EXH. NO.	
6/30/94	\$1,159.98	\$1,159.98	1	
12/30/94	\$572.90	\$1,732.88	2	
1/30/95	\$9,914.19	\$11,647.07	3	
2/28/95	\$8,761.27	\$20,408.34	4	
5/25/95	\$190.96	\$20,599.30	5	
	TOTAL	\$20,599.30		

TEST CELL -- SOIL AND GROUNDWATER CHARACTERIZATION -- EMCON				
Consent Order, Sections 5(C) and 5(D)				
INVOICE DATE	AMOUNT	TOTAL	EXH. NO.	
3/31/95	\$1,378.66	\$1,378.66	6	
4/20/95	\$1,504.83	\$2,883.49	7	
5/25/95	\$5,175.87	\$8,059.36	7A	
6/22/95	\$6,251.90	\$14,311.26	8	
10/18/95	\$276.43	\$14,587.69	9	
11/20/95	\$1,373.18	\$15,960.87	10	
1/22/96	\$21,316.59	\$37,277.46	11	
2/23/96	\$757.46	\$38,034.92	12	
	TOTAL	\$38,034.92		

TEST CELL -- GROUNDWATER MONITORING -- ENVIROMETRIX				
Consent Order, Sections 5(C) and 5(D)				
INVOICE DATE	AMOUNT	TOTAL	EXH. NO.	
3/1/96	\$42,060.00	\$42,060.00	13	

TEST CELL INVESTIGATION -- COUNTY OVERSIGHT FEES				
Consent Order, Sections 5(C) and 5(D)				
PAYMENT DATE	AMOUNT	TOTAL	EXH. NO.	
1/18/95	\$2,500.00	\$2,500.00	14	
2/21/96	\$1,100.00	\$3,600.00	15	
	TOTAL	\$3,600.00		

TOTAL CREDIT SPENT/COMMITTED \$104,294.22

TOTAL CREDIT ALLOWED (Sec. 5(l)) \$125,000.00

TRUST FUND AMOUNT \$20,705.78



EMCON Associates

Please Remit To: P.O. Box 45009, San Francisco, CA 94145

Inquiries To: 1921 Ringwood Avenue, San Jose, California 95131, 408-453-7300

129226

RECEIVED

JUN 29 1994

JUNE 30, 1994
INVOICE NO. 05013
PROJECT NO. 2057-002.01

WDC

GIBSON DUNN & CRUTCHER
ONE MONTGOMERY STREET
SAN FRANCISCO, CA 94104

ATTN: BILL CONNELL

FOR: NATIONAL AIRMOTIVE
7200 LOCKHEED STREET

PROFESSIONAL SERVICES FOR THE PERIOD ENDING JUNE 5, 1994



PROFESSIONAL PERSONNEL

	HOURS	RATE	AMOUNT
PROJECT MANAGER SMOLLEY, MARK	3.7	107.00	395.90
PROJECT STAFF GALLAGHER, LYNN	9.3	71.00	660.30
TECH WRITER/EDIT KELLER, EDWARD	0.4	66.00	26.40
OFFICE SERVICES BERNAL, NAOMA	0.2	49.00	9.80
CARLSON, JO ANN	0.5	53.00	26.50
RODRIGUEZ, JIM	0.5	53.00	26.50
TOTAL	14.6		

TOTAL LABOR 1,145.40

UNIT BILLINGS

IN-HOUSE REPRODUCTION
COPIES

40 COPIES @ .15 6.00

TOTAL UNIT BILLING

PAID

6.00

REIMBURSABLE EXPENSES
MATERIALS & OTHER

8.58

TOTAL REIMBURSABLES

8.58

8.58

TOTAL THIS INVOICE \$ 1,159.98

32900-1
07/12/94
B

EXHIBIT 1



EMCON Associates

Please Remit To: P.O. Box 45009, San Francisco, CA 94145

Inquiries To: 1921 Ringwood Avenue, San Jose, California 95131, 408-453-7300

145693

DECEMBER 30, 1994
INVOICE NO. 11099
PROJECT NO. 22077-001.002

NATIONAL AIRMOTIVE SERVICES
ATTN ROGER BASTIEN
7200 LOCKHEED STREET
OAKLAND CA 94621 4504

Mail this copy, with
check to payee

FOR: COMPLIANCE AUDIT
OAKLAND

PROFESSIONAL SERVICES FOR THE PERIOD ENDING DECEMBER 4, 1994

PROFESSIONAL PERSONNEL	HOURS	RATE	AMOUNT
PROJECT MANAGER			
SMOLLEY, MARK	4.0	116.00	464.00
OFFICE SERVICES			
BERNAL, NAOMA	1.0	49.00	49.00
ROBY, JO	1.0	53.00	53.00
TOTAL	6.0		
		TOTAL LABOR	566.00
UNIT BILLINGS			
IN-HOUSE REPRODUCTION		46 COPIES @ .15	6.90
COPIES			
TOTAL UNIT BILLING			6.90
		TOTAL THIS INVOICE	\$ 572.90

32930
01/17/94
RB

PLEASE INCLUDE PROJECT AND INVOICE NUMBER WHEN REMITTING PAYMENT.
THANK YOU!

EXHIBIT 2



EMCON

Please Remit To: P.O. Box 45009, San Francisco, CA 94145

Inquiries To: 1921 Ringwood Avenue, San Jose, California 95131, 408-453-7300

149182

JANUARY 30, 1995
INVOICE NO. 12135
PROJECT NO. 22077-001.002

NATIONAL AIRMOTIVE CORPORATION
ATTN ROGER BASTIEN
7200 LOCKHEED STREET
OAKLAND CA 94621 4504

We've shortened our name! Effective January 1, 1995, please send all payments and invoices to EMCOR. Our new Federal tax ID# is: 94-1738964. Our address has not changed. Thank you for updating our records.

FOR: COMPLIANCE AUDIT
OAKLAND

PROFESSIONAL SERVICES FOR THE PERIOD ENDING JANUARY 1, 1995

PROFESSIONAL PERSONNEL

	HOURS	RATE	AMOUNT
PROJECT MANAGER			
MURPHY, LAUREL	40.0	97.00	3,880.00
SMOLLEY, MARK	6.7	116.00	777.20
SR TECH STAFF			
MCCULLOUGH, STEVEN	25.0	99.00	2,475.00
PROJECT STAFF			
STRENG, YASHINE	36.5	71.00	2,591.50
OFFICE SERVICES			
BERNAL, NAOMA	0.5	49.00	24.50
RODRIGUEZ, JIM	0.2	53.00	10.60
TOTAL	108.9		

TOTAL LABOR 9,758.80

UNIT BILLINGS

MILEAGE	301 MILES @ .47	141.47
IN-HOUSE REPRODUCTION COPIES	14 COPIES @ .15	2.10
IN-HOUSE REPRODUCTION BLUEPRINTS	6 SQ. FT. @ .13	.78

TOTAL UNIT BILLING 144.35

REIMBURSABLE EXPENSES

COMMUNICATION	11.04	
TOTAL REIMBURSABLES	11.04	11.04

Handwritten notes: 32930, 02/21/95, B

EXHIBIT 3

TERMS: NET DUE UPON RECEIPT OF INVOICE 1.5% interest per month (18% per year) charge on past due accounts

PAGE 2

INVOICE NO. 12135
PROJECT NO. 22077-001.002

TOTAL THIS INVOICE \$ 9,914.19
=====

OUR RECORDS INDICATE THE ITEM(S) SHOWN BELOW TO BE PAST DUE.
WE WOULD APPRECIATE YOUR PROMPT PAYMENT BY RETURN MAIL. IF
PAYMENT HAS BEEN MADE, PLEASE DISREGARD THIS NOTICE.

OUTSTANDING INVOICES

NO. 11099 DATE 12/30/94	572.90	
TOTAL	572.90	572.90

TOTAL NOW DUE \$ 10,487.09

PLEASE INCLUDE PROJECT AND INVOICE NUMBER WHEN REMITTING PAYMENT.
THANK YOU!



EMCON

1921 Ringwood Avenue • San Jose, California 95131-1721 • (408) 453-7300 • Fax (408) 437-9526

INVOICE 12135
PROJECT NO. 22077-001.002

SERVICES PROVIDED

- Prepared pre-audit questionnaire and obtained information from NAC
- Conducted pre-audit walk-through and discussed audit format with Roger Bastien
- Conducted facility compliance audit on December 27 through 29
- Conducted post-audit debriefing with NAC personnel





EMCON

Please Remit To: P.O. Box 45009, San Francisco, CA 94145

Inquiries To: 1921 Ringwood Avenue, San Jose, California 95131, 408-453-7300

FEBRUARY 28, 1995
INVOICE NO. 1094
PROJECT NO. 22077-001.002

153304

NATIONAL AIRMOTIVE CORPORATION
ATTN ROGER BASTIEN
7200 LOCKHEED STREET
OAKLAND CA 94621 4504

FOR: COMPLIANCE AUDIT
OAKLAND

PROFESSIONAL SERVICES FOR THE PERIOD ENDING FEBRUARY 3, 1995

PROFESSIONAL PERSONNEL

	HOURS	RATE	AMOUNT
SR MGR/TECH REV			
LIDDIE, DOUG	1.0	148.00	148.00
PROJ MGR/SR TECH			
MCCULLOUGH, STEVEN	9.0	104.00	936.00
MOTRONI, CATHERINE	1.5	104.00	156.00
MURPHY, LAUREL	13.0	97.00	1,261.00
SNOLLEY, MARK	6.9	122.00	841.80
PROJECT STAFF			
REVELEY, DAVID	2.5	65.00	162.50
STRENK, YASMINE	54.0	78.00	4,212.00
TECH WRITER/EDIT			
KELLER, EDWARD	1.2	70.00	84.00
OFFICE SERVICES			
BERNAL, NAOMA	1.0	45.00	45.00
CARLSON, JO ANN	7.5	55.00	412.50
TREOLO, LOIS	4.0	55.00	220.00
TOTAL	101.6		

*delete pay
to be deleted
april*

TOTAL LABOR 8,478.80

*ACCOUNT
32930
03/31/95
B*

UNIT BILLINGS

IN-HOUSE REPRODUCTION BLUEPRINTS	6 SQ. FT. @ .25	1.50
TOTAL UNIT BILLING		1.50

OVER

EXHIBIT 4

TERMS: NET DUE UPON RECEIPT OF INVOICE 1.5% interest per month (18% per year) charge on past due accounts

PAGE 2
INVOICE NO. 1094
PROJECT NO. 22077-001.002

REIMBURSABLE EXPENSES		
COMMUNICATION	26.61	
TOTAL REIMBURSABLES	26.61	26.61

COMMUNICATION FEE		
3% OF LABOR OF \$8,478.80		254.36

TOTAL THIS INVOICE	\$ 8,761.27
--------------------	-------------

PLEASE INCLUDE PROJECT AND INVOICE NUMBER WHEN REMITTING PAYMENT.
THANK YOU!



EMCON

Please Remit To: P.O. Box 45009, San Francisco, CA 94145

Inquiries To: 1921 Ringwood Avenue, San Jose, California 95131, 408-453-7300

158816

MAY 25, 1995
INVOICE NO. 04085
PROJECT NO. 22077-001.002

NATIONAL AIRMOTIVE CORPORATION
ATTN ROGER BASTIEN
7200 LOCKHEED STREET
OAKLAND CA 94621 4504

FOR: COMPLIANCE AUDIT
OAKLAND

PROFESSIONAL SERVICES FOR THE PERIOD ENDING MAY 5, 1995

PROFESSIONAL PERSONNEL

	HOURS	RATE	AMOUNT
PROJ MGR/SR TECH			
SMOLLEY, MARK	0.7	122.00	85.40
OFFICE SERVICES			
CARLSON, JO ANN	1.0	55.00	55.00
SINCLAIR, JOAN	1.0	45.00	45.00
TOTAL	2.7		

TOTAL LABOR 185.40

COMMUNICATION FEE
3% OF LABOR OF \$185.40 5.56

TOTAL THIS INVOICE \$ 190.96

PLEASE INCLUDE PROJECT AND INVOICE NUMBER WHEN REMITTING PAYMENT.
THANK YOU!

6/1/95
32930-01
C. S. Mump

EXHIBIT 5



EMCON

Please Remit To: P.O. Box 45009, San Francisco, CA 94145

Inquiries To: 1921 Ringwood Avenue, San Jose, California 95131, 408-453-7300

153305

MARCH 31, 1995
INVOICE NO. 02087
PROJECT NO. 22077-001.001

NATIONAL AIRMOTIVE CORPORATION
ATTN ROGER BASTIEN
7200 LOCKHEED STREET
OAKLAND CA 94621 4504

FOR: SOIL AND GROUNDWATER CHARACTERIZATION
EARHART ROAD OAKLAND

PROFESSIONAL SERVICES FOR THE PERIOD ENDING MARCH 3, 1995

PROFESSIONAL PERSONNEL

	HOURS	RATE	AMOUNT
PROJ MGR/SR TECH			
KAMINSKY, RAY	2.0	112.00	224.00
SMOLLEY, MARK	5.3	122.00	646.60
SUBTOTALS	7.3		870.60
PROJECT STAFF			
GALLAGHER, LYNN	1.0	78.00	78.00
FIELD TECHNICIAN			
DAVIS, ROBERT	5.7	62.00	353.40
OFFICE SERVICES			
BERNAL, NAOMA	0.2	45.00	9.00
ROBY, JO	0.5	55.00	27.50
SUBTOTALS	0.7		36.50
TOTAL	14.7		

*ACCOUNT
320730
3/31/95
B*

TOTAL LABOR 1,338.50

COMMUNICATION FEE
3% OF LABOR OF \$1,338.50 40.16

TOTAL THIS INVOICE \$ 1,378.66

PLEASE INCLUDE PROJECT AND INVOICE NUMBER WHEN REMITTING PAYMENT.
THANK YOU!

EXHIBIT 6

APRIL 20, 1995
 INVOICE NO. 03083
 PROJECT NO. 22077-001.001

NATIONAL AIRMOTIVE CORPORATION
 ATTN ROGER BASTIEN
 7200 LOCKHEED STREET
 OAKLAND CA 94621 4504

FOR: SOIL AND GROUNDWATER CHARACTERIZATION
 EARHART ROAD OAKLAND

PROFESSIONAL SERVICES FOR THE PERIOD ENDING MARCH 31, 1995

PROFESSIONAL PERSONNEL	HOURS	RATE	AMOUNT
PROJ MGR/SR TECH			
GRAHAM, PHILLIP	0.5	104.00	52.00
SMOLLEY, MARK	1.7	122.00	207.40
SUBTOTALS	2.2		259.40
PROJECT STAFF			
GALLAGHER, LYNN	14.2	78.00	1,107.60
TECH WRITER/EDIT			
KELLER, EDWARD	0.3	70.00	21.00
OFFICE SERVICES			
BERNAL, NAOMA	0.4	45.00	18.00
CARLSON, JO ANN	0.5	55.00	27.50
TREOLO, LOIS	0.5	55.00	27.50
SUBTOTALS	1.4		73.00
TOTAL	18.1		
		TOTAL LABOR	1,461.00
COMMUNICATION FEE			43.83
3% OF LABOR OF \$1,461.00			
		TOTAL THIS INVOICE	\$ 1,504.83

OUR RECORDS INDICATE THE ITEM(S) SHOWN BELOW TO BE PAST DUE.
 WE WOULD APPRECIATE YOUR PROMPT PAYMENT BY RETURN MAIL. IF
 PAYMENT HAS BEEN MADE, PLEASE DISREGARD THIS NOTICE.

EXHIBIT 7

INVOICE NO. 03083
PROJECT NO. 22077-001.001

OUTSTANDING INVOICES

NO. 2087 DATE 03/31/95 1,378.66

TOTAL 1,378.66 1,378.66

TOTAL NOW DUE \$ 2,883.49

PLEASE INCLUDE PROJECT AND INVOICE NUMBER WHEN REMITTING PAYMENT.
THANK YOU!

April 30, 1995

INVOICE 03083
PROJECT NO. 22077-001.001

SERVICES PROVIDED

- Prepared revised cost estimate to reflect additional analytical costs incurred by ACHA request for additional analysis
- Prefield preparation for soil and groundwater investigation of jet-fuel spill area including scheduling of the drilling contractor
- Prepared a letter response to Alameda County's request for additional analyses



EMCON

Please Remit To: P.O. Box 45009, San Francisco, CA 94145

Inquiries To: 1921 Ringwood Avenue, San Jose, California 95131, 408-453-7300

158817

MAY 25, 1995
INVOICE NO. 04110
PROJECT NO. 22077-001.001

NATIONAL AIRMOTIVE CORPORATION
ATTN ROGER BASTIEN
7200 LOCKHEED STREET
OAKLAND CA 94621 4504

FOR: SOIL AND GROUNDWATER CHARACTERIZATION
EARHART ROAD OAKLAND

PROFESSIONAL SERVICES FOR THE PERIOD ENDING MAY 5, 1995

PROFESSIONAL PERSONNEL

	HOURS	RATE	AMOUNT
PROJ MGR/SR TECH			
KAMINSKY, RAY	2.5	112.00	280.00
SMOLLEY, MARK	5.9	122.00	719.80
SUBTOTALS	8.4		999.80
PROJECT STAFF			
GALLAGHER, LYNN	44.6	78.00	3,478.80
DRAFTER/CAD OPER			
DUAN, DEYAN	2.0	70.00	140.00
MOTRONI, CATHERINE	0.5	85.00	42.50
SUBTOTALS	2.5		182.50
OFFICE SERVICES			
CARLSON, JO ANN	1.0	55.00	55.00
RODRIGUEZ, JIM	0.5	45.00	22.50
SUBTOTALS	1.5		77.50
TOTAL	57.0		

TOTAL LABOR 4,738.60

6/1/95
32930-01
Chf S. Mays
\$ 6,680.70

TOTAL ON NEXT PAGE

EXHIBIT 7A

INVOICE NO. 04110
PROJECT NO. 22077-001.001

UNIT BILLINGS

MILEAGE 180 MILES @ .42 75.60

COMPUTER SUPPORT SERVICES 3.4 HOURS @ 15.00 51.00
CADD CONNECT TIME

TOTAL UNIT BILLING 126.60

REIMBURSABLE EXPENSES

MATERIALS & OTHER 23.51
EQUIPMENT RENTAL 145.00
TOTAL REIMBURSABLES 168.51 168.51

COMMUNICATION FEE

3% OF LABOR OF \$4,738.60 142.16

TOTAL THIS INVOICE \$ 5,175.87
=====

OUR RECORDS INDICATE THE ITEM(S) SHOWN BELOW TO BE PAST DUE.
WE WOULD APPRECIATE YOUR PROMPT PAYMENT BY RETURN MAIL. IF
PAYMENT HAS BEEN MADE, PLEASE DISREGARD THIS NOTICE.

OUTSTANDING INVOICES

NO. 3083 DATE 04/20/95 1,504.83
TOTAL 1,504.83 1,504.83

TOTAL NOW DUE \$ 6,680.70

PLEASE INCLUDE PROJECT AND INVOICE NUMBER WHEN REMITTING PAYMENT.
THANK YOU!



EMCON

Please Remit To: P.O. Box 45009, San Francisco, CA 94145

Inquiries To: 1921 Ringwood Avenue, San Jose, California 95131, 408-453-7300

160855

JUNE 22, 1995
INVOICE NO. 05166
PROJECT NO. 22077-001.001

NATIONAL AIRMOTIVE CORPORATION
ATTN ROGER BASTIEN
7200 LOCKHEED STREET
OAKLAND CA 94621 4504

FOR: SOIL AND GROUNDWATER CHARACTERIZATION
EARHART ROAD OAKLAND

PROFESSIONAL SERVICES FOR THE PERIOD ENDING JUNE 2, 1995

PROFESSIONAL PERSONNEL			
	HOURS	RATE	AMOUNT
PROJ MGR/SR TECH SMOLLEY, MARK	1.4	122.00	170.80
PROJECT STAFF GALLAGHER, LYNN	10.5	78.00	819.00
TOTAL	11.9		
		TOTAL LABOR	989.80
OUTSIDE SERVICES			
OUTSIDE SERVICES-OTHER			
AP 05373 06/02 WEST HAZMAT DRILLING		2,350.31	
LAB SERVICES-CAS			
AP 55768 06/02 COLUMBIA ANALYTICAL		2,880.00	
TOTAL OUTSIDE SERVICES		5,230.31	5,230.31
UNIT BILLINGS			
MILEAGE		5 MILES @ .42	2.10
TOTAL UNIT BILLING			2.10

6/27/95
32930-01
Cliff S. Mungin

TOTAL ON NEXT PAGE

EXHIBIT 8

INVOICE NO. 05166
PROJECT NO. 22077-001.001

COMMUNICATION FEE
3% OF LABOR OF \$989.80

29.69

TOTAL THIS INVOICE \$ 6,251.90
=====

PLEASE INCLUDE PROJECT AND INVOICE NUMBER WHEN REMITTING PAYMENT.
THANK YOU!



EMCON

Please Remit To: P.O. Box 45009, San Francisco, CA 94145

Inquiries To: 1921 Ringwood Avenue, San Jose, California 95131, 408-453-7300

24255

OCTOBER 18, 1995
INVOICE NO. 09153
PROJECT NO. 22077-001.001

NATIONAL AIRMOTIVE CORPORATION
ATTN ROGER BASTIEN
7200 LOCKHEED STREET
OAKLAND CA 94621 4504

FOR: SOIL AND GROUNDWATER CHARACTERIZATION
EARHART ROAD OAKLAND

PROFESSIONAL SERVICES FOR THE PERIOD ENDING SEPTEMBER 29, 1995

PROFESSIONAL PERSONNEL

	HOURS	RATE	AMOUNT
PROJ MGR/SR TECH SMOLLEY, MARK	1.4	122.00	170.80
PROJECT STAFF GALLAGHER, LYNN	2.8	78.00	218.40
OFFICE SERVICES BERNAL, NAOMA	1.0	45.00	45.00
TOTALS	5.2		434.20
		TOTAL LABOR	434.20

*cred. +
Per Mark Smolley*

FEE
3% OF LABOR OF \$434.20 13.03

TOTAL THIS INVOICE \$ 447.23

276.43

PLEASE INCLUDE PROJECT AND INVOICE NUMBER WHEN REMITTING PAYMENT.
THANK YOU!

*10/26/95
32930-01
Chiff S. Murray*

EXHIBIT 9



21 Ringwood Avenue • San Jose, California 95131-1721 • (408) 453-7300 • Fax (408) 437-9526

INVOICE 09153
PROJECT NO. 22077-001.001

SERVICES PROVIDED

- Quality check and revision of boring logs from previous field work
- Discussed terms of Port of Oakland access agreement with risk management staff and sent insurance certificates to the Port of Oakland





EMCON

177673

Please Remit To: P.O. Box 45009, San Francisco, CA 94145
Inquiries To: 1921 Ringwood Avenue, San Jose, California 95131, 408-453-7300

NOVEMBER 20, 1995
INVOICE NO. 09572
PROJECT NO. 22077-001.001

NATIONAL AIRMOTIVE CORPORATION
ATTN ROGER BASTIEN
7200 LOCKHEED STREET
OAKLAND CA 94621 4504

FOR: SOIL AND GROUNDWATER CHARACTERIZATION
EARHART ROAD OAKLAND

PROFESSIONAL SERVICES FOR THE PERIOD ENDING NOVEMBER 3, 1995

PROFESSIONAL PERSONNEL

	HOURS	RATE	AMOUNT
PROJ MGR/SR TECH SMOLLEY, MARK	0.1	122.00	12.20
PROJECT STAFF GALLAGHER, LYNN	16.5	78.00	1,287.00
TOTALS	16.6		1,299.20
		TOTAL LABOR	1,299.20

REIMBURSABLE EXPENSES

CHARGEABLE EQUIPMENT	35.00	
TOTAL REIMBURSABLES	35.00	35.00

FEE

3% COMMUNICATIONS FEE \$1,299.20 38.98

TOTAL THIS INVOICE \$ 1,373.18

OUR RECORDS INDICATE THE ITEM(S) SHOWN BELOW TO BE PAST DUE.
WE WOULD APPRECIATE YOUR PROMPT PAYMENT BY RETURN MAIL. IF
PAYMENT HAS BEEN MADE, PLEASE DISREGARD THIS NOTICE.

11/28/95
32930-01
Chad S. Mungie

EXHIBIT 10



EMCON

Please Remit To: P.O. Box 45009, San Francisco, CA 94145

Inquiries To: 1921 Ringwood Avenue, San Jose, California 95131, 408-453-7300

JANUARY 22, 1996
INVOICE NO. 12765
PROJECT NO. 22077-001.001

NATIONAL AIRMOTIVE CORPORATION
ATTN ROGER BASTIEN
7200 LOCKHEED STREET
OAKLAND CA 94621 4504

FOR: SOIL AND GROUNDWATER CHARACTERIZATION
EARHART ROAD OAKLAND

PROFESSIONAL SERVICES FOR THE PERIOD ENDING DECEMBER 29, 1995

PROFESSIONAL PERSONNEL

	HOURS	RATE	AMOUNT
PROJ MGR/SR TECH			
KAMINSKY, RAY	0.5	112.00	56.00
SMOLLEY, MARK	6.0	122.00	732.00
SUBTOTALS	6.5		788.00
PROJECT STAFF			
GALLAGHER, LYNN	38.9	78.00	3,034.20
DRAFTER/CAD OPER			
JOHNSON, KAREN	4.0	70.00	280.00
TROYER, KATHRYN	0.5	70.00	35.00
SUBTOTALS	4.5		315.00
TECH WRITER/EDIT			
KELLER, EDWARD	1.5	70.00	105.00
PROJECT ASST			
FERNANDEZ, ELIZABETH	0.5	78.00	39.00
OFFICE SERVICES			
BERNAL, NAOMA	0.5	45.00	22.50
CARLSON, JO ANN	7.5	55.00	412.50
SUBTOTALS	8.0		435.00
TOTALS	59.9		4,716.20

TOTAL LABOR 4,716.20

*1/29/96
32930-01
Chil E. Mungie*

TOTAL ON NEXT PAGE

EXHIBIT 11



EMCON

Please Remit To: P.O. Box 45009, San Francisco, CA 94145

Inquiries To: 1921 Ringwood Avenue, San Jose, California 95131, 408-453-7300

INVOICE NO. 12765
PROJECT NO. 22077-001.001

OUTSIDE SERVICES

CONTRACTED SERVICES

AP 27783 12/29 GREGG DRILLING & TES 2,225.25

CAS EXPENSE

AP 11177 12/29 COLUMBIA ANALYTICAL 6,085.00

AP 11178 12/29 COLUMBIA ANALYTICAL 7,960.00

SUBTOTAL 14,045.00

TOTAL OUTSIDE SERVICES 16,270.25

UNIT BILLINGS

COMPUTER SUPPORT SERVICES 0.2 HOURS @ 15.00 3.00
CADD CONNECT TIME

MILEAGE 135 MILES @ .42 56.70

TOTAL UNIT BILLING 59.70

REIMBURSABLE EXPENSES

MATERIALS & OTHER 9.95

CHARGEABLE EQUIPMENT 119.00

TOTAL REIMBURSABLES 128.95

FEE

3% COMMUNICATIONS FEE \$4,716.20 141.49

TOTAL THIS INVOICE \$ 21,316.59
=====

OUR RECORDS INDICATE THE ITEM(S) SHOWN BELOW TO BE PAST DUE.
WE WOULD APPRECIATE YOUR PROMPT PAYMENT BY RETURN MAIL. IF
PAYMENT HAS BEEN MADE, PLEASE DISREGARD THIS NOTICE.

OUTSTANDING INVOICES

NO. 9153 DATE 10/18/95 170.80

TOTAL 170.80

TOTAL NOW DUE \$ 21,487.39

PLEASE INCLUDE PROJECT AND INVOICE NUMBER WHEN REMITTING PAYMENT.

TERMS: NET DUE UPON RECEIPT OF INVOICE 1.5% interest per month (18% per year) charge on past due accounts

187762



EMCON

Please Remit To: P.O. Box 45009, San Francisco, CA 94145

Inquiries To: 1921 Ringwood Avenue, San Jose, California 95131, 408-453-7300

FEBRUARY 23, 1996
 INVOICE NO. 15127
 PROJECT NO. 22077-001.001

NATIONAL AIRMOTIVE CORPORATION
 ATTN ROGER BASTIEN
 7200 LOCKHEED STREET
 OAKLAND CA 94621 4504

3/5/96
 32930-01
 W. E. Murray

FOR: SOIL AND GROUNDWATER CHARACTERIZATION
 EARHART ROAD OAKLAND

PROFESSIONAL SERVICES FOR THE PERIOD ENDING FEBRUARY 2, 1996

PROFESSIONAL PERSONNEL

	HOURS	RATE	AMOUNT
SR MGR/TECH REV SMOLLEY, MARK	1.8	124.00	223.20
TECHNICAL STAFF GALLAGHER, LYNN	5.2	79.00	410.80
DRAFTER/CAD OPER DUAN, DEYAN	0.4	71.00	28.40
OFFICE SERVICES BERNAL, NAOMA	1.0	45.00	45.00
CARLSON, JO ANN	0.5	56.00	28.00
SUBTOTALS	1.5		73.00
TOTALS	8.9		735.40
		TOTAL LABOR	735.40

FEE

3% COMMUNICATIONS FEE \$735.40 22.06

TOTAL THIS INVOICE \$ 757.46

OUR RECORDS INDICATE THE ITEM(S) SHOWN BELOW TO BE PAST DUE.

TOTAL ON NEXT PAGE

EXHIBIT 12



**Table 1
Groundwater Monitoring Fees
NAC Facility
Oakland, California**

Workplan		\$1,500
Permit Applications		500
Utility Clearance		800
Concrete Coring		400
Surveying of Wells (3 events)		2,250
EMC Project Management for arranging clearances, fieldwork, meetings, waste profiling, waste transportation, and project oversight		3,500
Well Installation		
Mob/Demob Drill Rig	350	
Drilling	1,900	
Equipment	650	
Supplies	1,750	
EMC Labor	<u>700</u>	
		5,350
Well Development and Sampling		
Supplies	590	
EMC Labor	<u>560</u>	
	1,150	
3 sampling events	<u>3 @ 1,150</u>	
		3,450

(continued)



Table 1 (continued)
Groundwater Monitoring Fees
NAC Facility
Oakland, California

Laboratory Analysis (assumed normal turnaround)		
Soil (Waste Profile for Disposal):		
TPH-G/BTEX	1 @ \$175 = \$175	
TPH-D/MO/K/JF	1 @ 115 = 115	
RCI	1 @ 150 = 150	
CAM 17 Metals (TTLC)	1 @ 350 = 350	
CAM 17 Metals (STLC)	<u>1 @ 350 = 350</u>	
		1,140
Groundwater:		
TPH-JF	3 @ 115 = 345	
BTEX	3 @ 115 = 345	
SVOC	<u>3 @ 375 = 1,125</u>	
		1,815
3 Sampling Events	<u>3 @ 1,815 = 5,445</u>	
		6,585

Well Destruction (on completion of third sampling event)		
Permit Application	300	
Mob/Demob	400	
Earthwork	1,600	
Equipment	650	
Supplies	200	
EMC Labor	700	
Disposal of Well Materials	<u>200</u>	
		4,050

Transportation and Disposal of Soil Cuttings with EMC oversight	2,000
Transportation of Disposal of Purged Groundwater (3 sampling events) with EMC oversight	3,675

(continued)



Table 1 (continued)
Groundwater Monitoring Fees
NAC Facility
Oakland, California

Report Preparation		
Initial		2,500
2 Progress Reports	2 @ 1,500 =	3,000
Closure Report		<u>2,500</u>
		<u>8,000</u>
TOTAL		\$42,060

01/18/95

5	#H-179506-2	INV	2500.00	2500.00
				2500.00

01/18/95 079253

NONB OF NORTH CAROLINA 68-728
ASHEVILLE, NORTH CAROLINA 581

ALAMEDA COUNTY 1900 LOCUST STREET
OAKLAND, CALIFORNIA 94612-0088
TEL: 415-763-3000

BY TWO THOUSAND FIVE HUNDRED DOLLARS AND NO CENTS

THE ALAMEDA COUNTY \$2,500.00
ORDER OF

NOT NEGOTIABLE
AUTHORIZED SIGNATURE

⑆079253⑆ ⑆053107989⑆ 480024488⑆

1 1 *[Signature]*

INVOICE NUMBER	INVOICE DATE	AMOUNT PAID	DISCOUNT TAKEN	NET CHECK AMOUNT
12696	TEST CELL	INVOICE	1100.00	1100.00
				1100.00

03/05/96 090154

DEPARTMENT OF ENVIRONMENTAL HEALTH
 1131 HARBOR BAY PARKWAY
 ALAMEDA, CA 94502-6577

NCHS OF NORTH CAROLINA
 ASHEVILLE, NORTH CAROLINA

88-798
 531

PAY TO THE ORDER OF: ONE THOUSAND ONE HUNDRED DOLLARS AND NO CENTS

\$1,100.00

JAG

NOT NEGOTIABLE
 AUTHORIZED SIGNATURE

⑈090154⑈ ⑆053107989⑆ 480024488⑈

EXHIBIT 15

ALAMEDA COUNTY
HEALTH CARE SERVICES



AGENCY
DAVID J. KEARS, Agency Director

RAFAT A. SHAHID, DIRECTOR

February 21, 1996

DEPARTMENT OF ENVIRONMENTAL HEALTH
1131 Harbor Bay Parkway
Alameda, CA 94502-6577
(510) 567-6700

Mr. Roger Bastien
National Airmotive Corporation
7200 Lockheed Street
Oakland, CA 94521-4504

RE: ENVIRONMENTAL INVESTIGATIONS - NATIONAL AIRMOTIVE
CORPORATION (NAC) TEST SITE, EARHART ROAD, OAKLAND AIRPORT

Dear Mr. Bastien:

This letter is intended to summarize particular facts and final actions agreed upon during our meeting today attended by yourself and Mr. Cliff Maupin of NAC, Mr. William Connell of the law firm of Gibson, Dunn & Crutcher, NAC's legal representative on this matter, and Mr. Gil Jensen, Alameda County District Attorney's Office. Our meeting convened following this office's receipt and my review of the January 16, 1996 EMCON report entitled "Soil and Groundwater Investigation, National Airmotive Corporation Facility, Oakland, California" in order to discuss what final actions may be needed to complete the Jet-A fuel release and "gray water" investigations at the subject NAC site.

We understand that it is NAC's intent to upgrade the underground storage tank (UST) complex where appropriate in order to comply with UST standards that will take affect December 1998. We also understand that EMCON has recommended that NAC monitor for the presence of free-phase product in the UST pit at that time, and to remove such product if observed. This action is acceptable to this office.

In order to ensure the jet fuel plume is stable and not migrating towards the tidal marsh immediately east of the test site, and to move this case towards final closure, we request that three (3) monitoring wells (aka "guardian" wells) be installed in the general locations we discussed today. I have enclosed an annotated site map on which these generalized well locations are illustrated.

Ground water samples shall be collected from each well on an annual basis for two years after installation, for a total of three (3) sampling events (initial, 1st annual, and 2nd annual). Should concentrations of targeted jet fuel constituents in sampled water suggest that the plume is stable and not discharging into the tidal marsh, or plume constituents are below levels of concern based on toxicity values for estuarine organisms, no further action will be required.

EXHIBIT B

Mr. Roger Bastien
RE: National Airmotive Corp. Test Site
February 21, 1996
Page 2 of 2

Please have your consultant submit a brief work plan for the installation of the noted monitoring wells which incorporates, among others, the following elements:

- 1) Target compounds for analysis of sampled ground water shall be TPH characterized as jet fuel (TPH-Jf), and BTEX. Should "hits" for TPH be identified in any samples, also analyze for SVOC.
- 2) Soil samples need not be collected for chemical analysis, although you may choose to collect such samples for routine lithologic determination.
- 3) Water elevation and flow direction/gradient shall be determined from well gauging during the initial and subsequent sampling events.
- 4) Subsequent annual sampling events shall occur during the 1st quarter of each sample year.

As we additionally discussed, the current account established in January 1995 to offset costs incurred by this agency during its oversight of your case is presently in arrears. Please remit an additional draft, made payable to Alameda County, in the amount of \$1100. I anticipate that this additional deposit should be sufficient to make up the current deficit and fund the project to closure.

Thank you for your attention to these issues. Please call me at 510/567-6793 should you have any questions or comments.

Sincerely,



Scott O. Seery CHMM
Senior Hazardous Materials Specialist

enclosure

cc: Jun Makishima, Acting Director
Gil Jensen, Alameda County District Attorney's Office
William Connell, Esq., Gibson, Dunn & Crutcher
One Montgomery St., Telesis Tower
San Francisco, CA 94104-4505



Environmental Consultants

National Airmotive Corporation
7200 Lockheed Street
Oakland, California 94521-4504

March 1, 1996

Attention: Mr. Cliff Maupin

***GROUNDWATER INVESTIGATION WORKPLAN
NAC TEST CELL FACILITY
EARHART ROAD
OAKLAND, CALIFORNIA
EMC JOB No. 196332***

Envirometrix Corporation (EMC) has prepared this workplan to address concerns of groundwater contamination at the National Airmotive Corporation (NAC) test facility at Oakland Airport (Plate 1). This workplan is to address issues discussed by the Alameda County, Department of Environmental Health (ACDEH) in its letter dated February 21, 1996.

SITE INVESTIGATION

In order to monitor for migration of groundwater contaminants offsite, EMC plans to drill three soil borings in the locations marked on Plate 2 and convert them to groundwater monitoring wells. The actual boring locations may vary from the proposed locations depending on the results of field observations, utility locations, and permission from appropriate agencies.

Prior to drilling, the site and surrounding area will be cleared by a licensed utility surveyor and through Underground Service Alert (USA). Appropriate permits will be obtained from the ACDEH. The ACDEH will be notified 72 hours in advance of drilling.

The soil borings will be advanced with a truck-mounted hollow-stem auger drill rig by a licensed drilling contractor. The borings will be drilled to a depth of approximately 10 feet, and logged by an EMC field geologist. No soil samples will be collected for laboratory analysis. Between borings, all drilling auger will be decontaminated using either

BIT C



National Airmotive Corporation
Mr. Cliff Maupin

March 1, 1996
Page 2 of 3

a steam cleaner or a Trisodium Phosphate (TSP) solution and tap water to avoid cross contamination. Decontamination water will be collected and placed in 55-gallon drums.

Soil cuttings will also be stored in 55-gallon drums onsite. To evaluate disposal options for the soil, EMC will collect four soil samples of the cuttings in pre-cleaned 6-inch sampling tubes. Samples collected for analysis will be sealed with Teflon tape and plastic end caps, labeled, and placed in an iced cooler for transportation under Chain-of-Custody protocol to a State-certified analytical laboratory. Samples will be prepared in the laboratory as one composite sample for waste profiling for disposal. Samples will be analyzed for total petroleum hydrocarbons as gasoline (TPH-G), diesel, motor oil, kerosene, and jet fuel (TPH-D/MO/K/JF) by EPA Method 8015M, benzene, toluene, ethylbenzene, and xylenes (BTEX) by EPA Method 8020, reactivity, corrosivity, and ignitibility (RCI) and CAM-17 metals by EPA Method 6010 and, if necessary, by the EPA WET test. After waste profiling and acceptance, EMC will transport this material to an appropriate waste disposal facility.

Upon completion, each soil boring will be converted to a groundwater monitoring well. The monitoring wells will be constructed of 2-inch diameter Schedule 40 PVC well casing, and screened from 2 to 10 feet. The depth of the well and screened interval will be adjusted to accommodate the groundwater elevation recorded at the time of drilling. Well screens will have factory milled 0.020-inch perforations. A sandpack of Lonestar #2 or equivalent sand will be placed in the annular space between the borehole and the well screen to approximately one-half foot above the slotted casing. The well will be sealed with a one-foot bentonite seal and finished with cement grouted to the surface. The wellhead will be protected with a water-tight well cap and flush-mounted surface cover. A schematic diagram of a typical monitoring well installation is presented on Plate 3. Locations and elevations of these three wells will be surveyed by a California licensed surveyor.

EMC will develop the wells and collect one groundwater sample from each well for analysis for TPH-JF, BTEX and, if necessary, Semi-Volatile Organic Compounds (SVOCs) by EPA Method 8270 at a state-certified laboratory. Purged groundwater will be stored temporarily in drums onsite until arrangements can be made for its transport to an appropriate disposal facility for recycling.

REPORT PREPARATION

Upon completion of the groundwater investigation, EMC will prepare a report presenting the results of the investigation. As required by the ACDEH, EMC will conduct this groundwater monitoring on an annual basis for a total of three sampling events. The initial report will discuss the extent of groundwater contamination and will include a scaled site plan with groundwater contours and a schematic diagram of the monitoring wells. Results of the chemical analysis will be presented with laboratory reports and QA/QC reports. The report will be signed by a registered geologist or engineer for presentation to the ACDEH



National Airmotive Corporation
Mr. Cliff Maupin

March 1, 1996
Page 3 of 3

for review and approval. Results of the subsequent sampling events will be provided in the form of progress reports. At the conclusion of these three sampling events, EMC will arrange for the destruction of these three wells in accordance with the requirements of ACDEH and submit a closure report documenting these activities.

EMC is prepared to begin the investigation immediately upon approval of the workplan and can begin field work promptly upon receiving authorization. Field operations are expected to take two days for the drilling, well installation and development. Subsequent monitoring is anticipated to take one day for each sampling event. Report preparation will begin upon receipt of the laboratory results and will take approximately two weeks to complete.

EMC hopes this workplan presents the information you require at this time. If you have any questions or require additional information, please contact either of the undersigned.

Yours very truly,

ENVIROMETRIX CORPORATION

A handwritten signature in cursive script that reads "Norman T. Shopay".

Norman T. Shopay
Principal Hydrogeologist

A handwritten signature in cursive script that reads "Carol D. Wilson".

Carol D. Wilson, R.G.
Senior Geologist

cc: Alameda County Health Care Services Agency
Department of Environmental Health
1131 Harbor Bay Parkway
Alameda, California 94502-6577
Attention: Mr. Scott O. Seery

Attachments: Plate 1 - Site Location Map
Plate 2 - Site Plan with Proposed Well Locations
Plate 3 - Well Construction Detail



DRAWN BCC	JOB NUMBER 196332	
APPROVED CDW	DATE 3/96	
REVISED	DATE	

SITE LOCATION MAP
 National Airmotive Corporation
 Oakland Facilities
 Oakland, California

PLATE
1

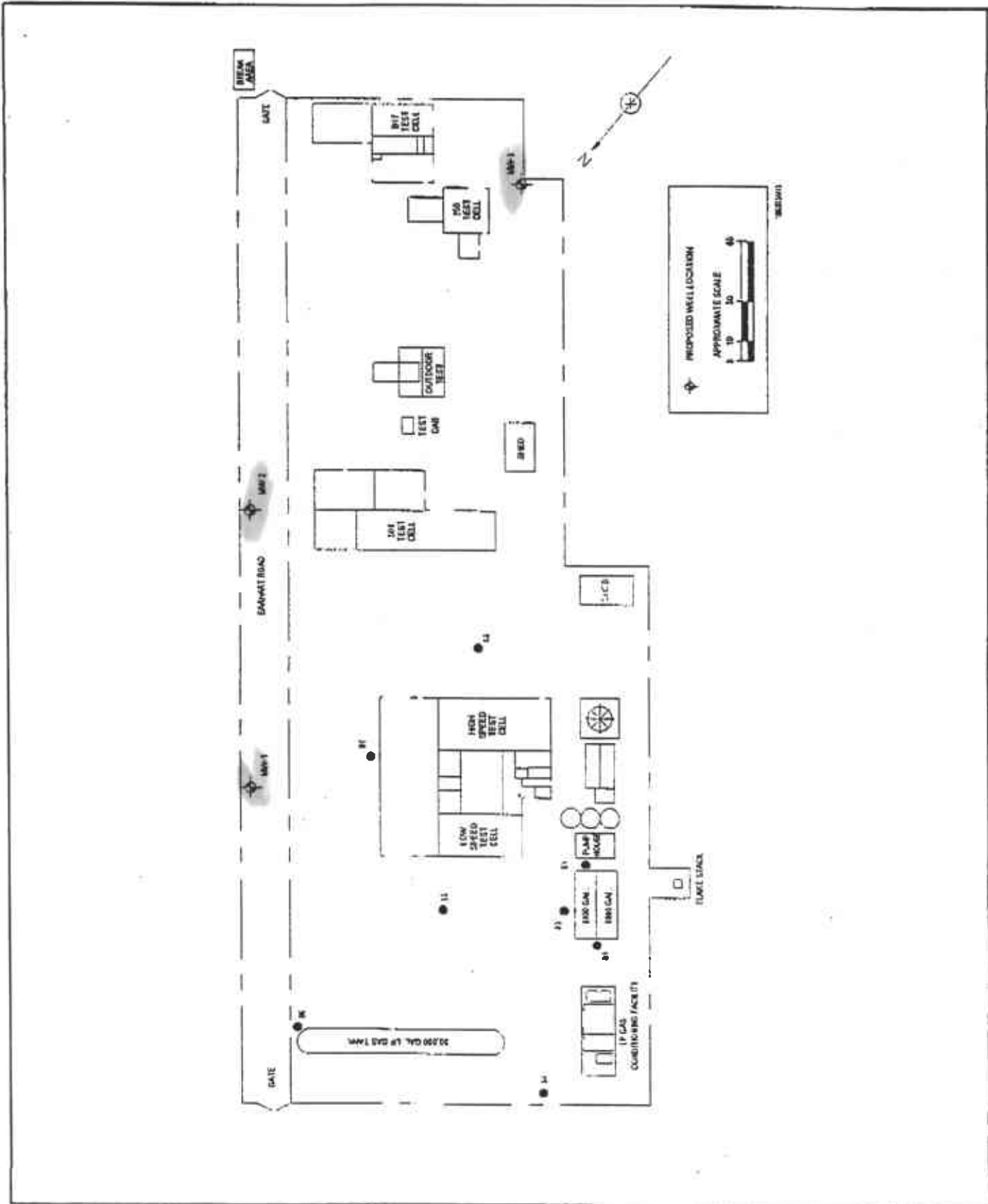

DRAWN BCC	JOB NUMBER 196332
APPROVED CDW	DATE 3/96
REVISED	DATE

SITE PLAN WITH PROPOSED WELL LOCATIONS
 National Airmotive Corporation
 Oakland Facilities
 Oakland, California

PLATE
2

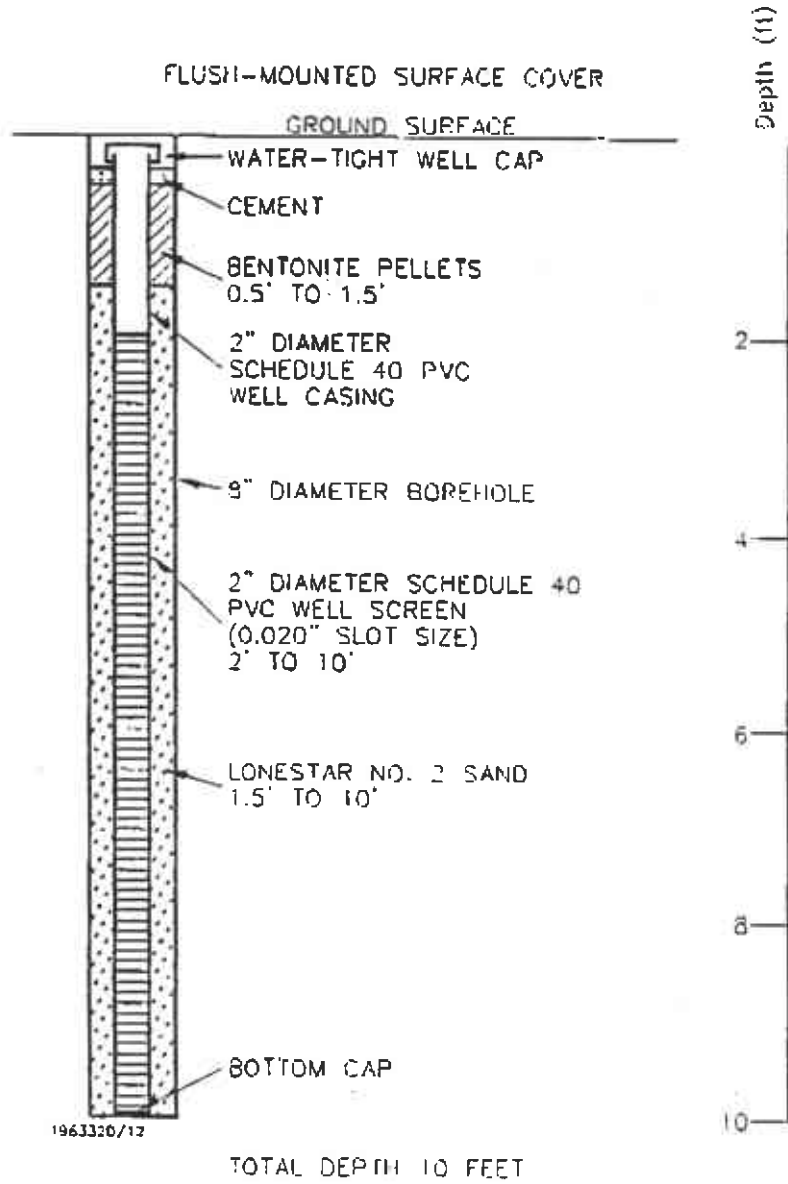

DRAWN BCC	JOB NUMBER 196332
APPROVED CDW	DATE 3/96
REVISED	DATE

WELL CONSTRUCTION DETAIL
 National Airmotive Corporation
 Oakland Facilities
 Oakland, California

PLATE
3

ALAMEDA COUNTY
HEALTH CARE SERVICES



AGENCY
DAVID J. KEARS, Agency Director

RAFAT A. SHAHID, DIRECTOR

March 7, 1996

DEPARTMENT OF ENVIRONMENTAL HEALTH
1131 Harbor Bay Parkway
Alameda, CA 94502-6577
(510)567-6700

Mr. Roger Bastien
National Airmotive Corporation
7200 Lockheed Street
Oakland, CA 94521-4504

RE: NATIONAL AIRMOTIVE CORPORATION (NAC) TEST SITE, EARHART
ROAD, OAKLAND AIRPORT

Dear Mr. Bastien:

Thank you for the recent submittal of the March 1, 1996
Envirometrix Groundwater Investigation Workplan for the
installation, sampling and monitoring of three (3) wells at the
subject site. This workplan has been accepted as submitted.

Please call me at 510/567-6783 when field work associated with
well installation has been scheduled.

Sincerely,

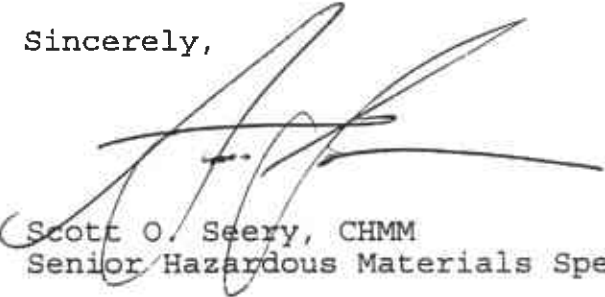

Scott O. Seery, CHMM
Senior Hazardous Materials Specialist

cc: Jun Makishima, Acting Director
Gil Jensen, Alameda County District Attorney's Office
William Connell, Esq., Gibson, Dunn & Crutcher
One Montgomery St., Telesis Tower
San Francisco, CA 94104-4505
Norman Shopay, Envirometrix, 3950 Industrial Bl., Ste. 200C
West Sacramento, CA 95691