

BASELINE

ENVIRONMENTAL CONSULTING

FAX TRANSMITTAL

Date: 6/22/00 Fax No.: _____

Time: _____

To: Susan Hugo 337-9335
Doug Herman - P of O

From: YML

Subject: _____

Project No.: _____ Total Pages: 22

(including transmittal)

Original to follow: Yes No



Comments: _____

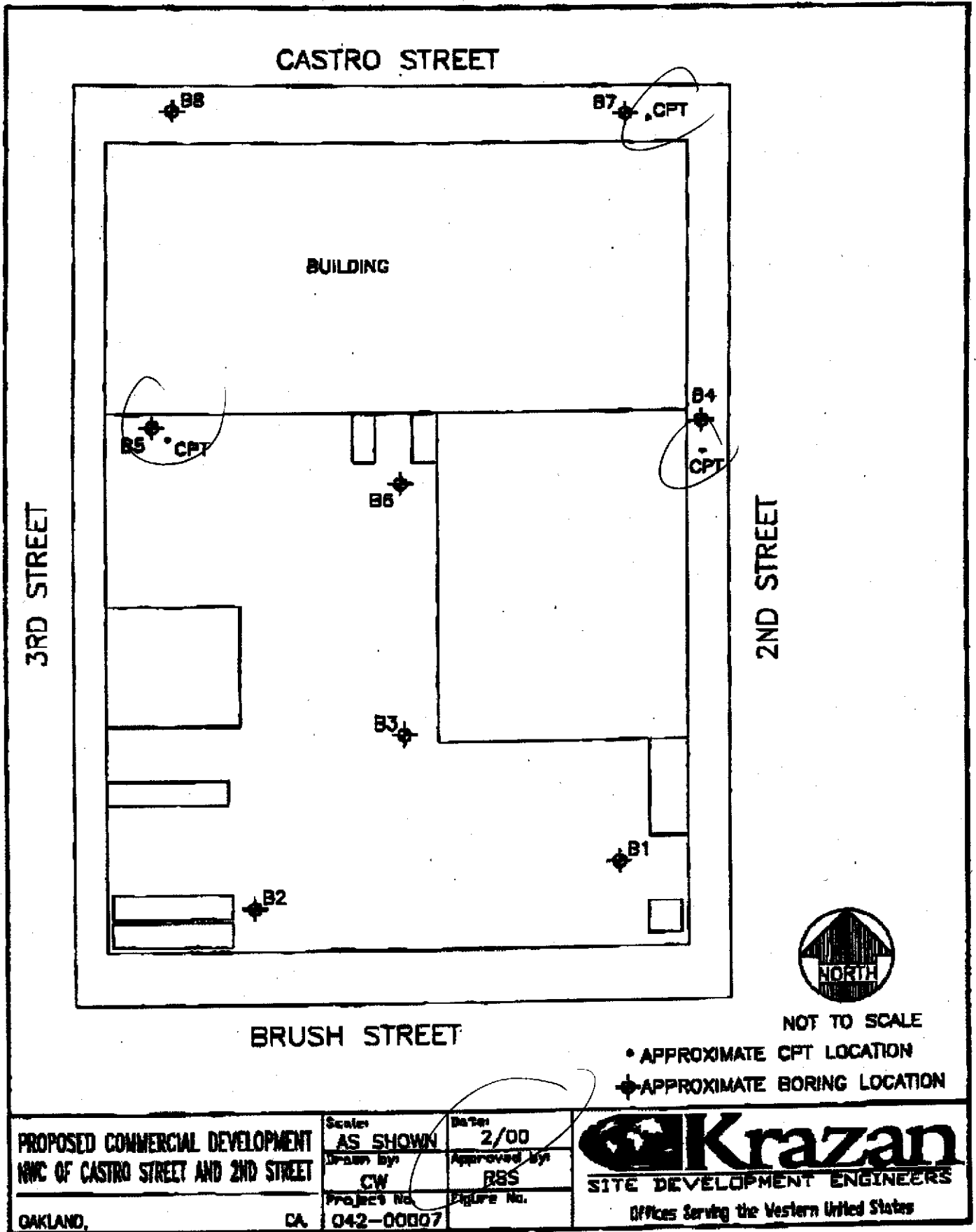

NOT TO SCALE

- APPROXIMATE CPT LOCATION
- ◆ APPROXIMATE BORING LOCATION

PROPOSED COMMERCIAL DEVELOPMENT NWC OF CASTRO STREET AND 2ND STREET OAKLAND, CA	Scale:	Date:
	AS SHOWN	2/00
	Drawn by:	Approved by:
	CW	BBS
Project No.	Figure No.	
042-00007		

Krazan
 SITE DEVELOPMENT ENGINEERS
 Offices Serving the Western United States

Log of Drill Hole B-1

Project: Proposed Commercial Development

Project No: 042-00007

Client: Mortenson Company

Figure No: A-1

Location: NWC of Castro & 2nd Streets, Oakland CA

Logged By: Marty Groth

Depth to Water >

Initial: 12 feet

At Completion: 6 feet

SUBSURFACE PROFILE			SAMPLE				Penetration Test blows/ft			Water Content (%)				
Depth (ft)	Symbol	Description	Dry Density (pcf)	Moisture (%)	Type	Blows/ft.	Penetration Test blows/ft			Water Content (%)				
							20	40	60	Wp	—	0	—	Wl
0		Ground Surface												
0		SANDY GRAVEL (GP) ± 2 inches; brown, moist, drills easily												
2		GRAVELLY SAND (SP) FILL - Fine- to coarse-grained with trace of fines; black, moist, drills easily	89.7	46.2		10								
4		SILTY SAND (SM) FILL - Fine- to medium-grained; dark brownish-black, moist, drills easily												
6		SAND (SP) Loose, fine- to medium-grained with thin interbeds of trace to fine SILT; brown, very moist, drills easily	115.2	16.7		13								
8		SAND (SP) Medium dense, fine- to medium-grained with little fines; brown with light gray mottling, moist, drills easily												
10			112.7	18.8		21								
12		CLAYEY SAND (SC) Loose, fine- to medium-grained; orangish-brown with light gray mottling, moist, drills easily												
16			118.0	17.8		12								
18														
20														

Drill Method: Solid Flight

Krazan and Associates

Drill Date: 1-31-00

Drill Rig: CME 45C

Hole Size: 4 1/2"

Driller: Brent Snyder

Sheet: 1 of 1

Log of Drill Hole B-2

Project: Proposed Commercial Development

Project No: 042-00007

Client: Mortenson Company

Figure No.: A-2

Location: NWC of Castro & 2nd Streets, Oakland CA

Logged By: Marty Groth

Depth to Water:

Initial: 10 feet

At Completion: 7.5 feet

SUBSURFACE PROFILE		SAMPLE				Penetration Test			Water Content (%)					
Depth (ft)	Symbol	Description	Dry Density (pcf)	Moisture (%)	Type	Elev./ft	blows/ft			Wp ---0--- Wl				
							20	40	60	10	20	30	40	
0		Ground Surface												
0		PAVEMENT SECTION												
		ASPHALTIC CONCRETE = 1/2 inch												
		AGGREGATE BASE = 6 inches												
2		GRAVELLY SAND (SP)												
		FILL - Fine- to coarse-grained with trace of fines, and METAL and GLASS DEBRIS; black, moist, drills easily	99.5	12.4		9								
4		SILTY SAND (SM)												
		FILL - Fine- to medium-grained with thin lenses of increased SAND; black, moist, drills easily				7								
6		SAND (SP)												
		Loose, fine- to medium-grained with little SILT; brown, very moist, drills easily (Possible Fill)												
8		SAND (SP)												
		Loose, fine- to medium-grained with little fines; brown with light gray mottling, moist, drills easily	115.4	17.5		18								
10		CLAYEY SAND (SC)												
		Loose, fine- to medium-grained; orangish-brown with light gray mottling, moist, drills easily												
12		SAND (SP)												
		Dense, fine- to medium-grained with trace to little fines; brown, moist, drills firmly	115.2	18.5		8								
14		SAND (SP)												
		Dense, fine- to medium-grained with trace to little fines; brown, moist, drills firmly												
16		SAND (SP)												
		Dense, fine- to medium-grained with trace to little fines; brown, moist, drills firmly												
18		SAND (SP)												
		Dense, fine- to medium-grained with trace to little fines; brown, moist, drills firmly												
20		SAND (SP)												
		Dense, fine- to medium-grained with trace to little fines; brown, moist, drills firmly												

Drill Method: Solid Flight

Krazan and Associates

Drill Date: 1-31-00

Drill Rig: Mobil B61

Hole Size: 4 1/2"

Driller: Richard Lawrence

Sheet: 1 of 3

Log of Drill Hole B-2

Project: Proposed Commercial Development

Project No: 042-00007

Client: Mortenson Company

Figure No.: A-2

Location: NWC of Castro & 2nd Streets, Oakland CA

Logged By: Marty Groth

Depth to Water:

Water: 10 feet

At Completion: 7.5 feet

SUBSURFACE PROFILE			SAMPLE				Penetration Test blows/ft	Water Content (%) Wp 0 Wl
Depth (ft)	Symbol	Description	Dry Density (pcf)	Moisture (%)	Type	Blows/ft.		
22		SAND (SP) Dense, fine- to medium-grained with trace to little fines; brown, moist, drills firmly	118.2	16.7		48		
24		SAND (SP) Very dense, fine- to medium-grained; brown, moist, drills firmly to very firmly						
26			113.8	18.2		50+		
28								
30		SAND (SP) Very dense, fine- to medium-grained; brown, moist, drills firmly to very firmly	106.7	22.0		88		
32								
34								
36			107.9	22.0		50+		
38								
40								

Drill Method: Solid Flight

Krazan and Associates

Drill Date: 1-31-00

Drill Rig: Mobil B61

Hole Size: 4 1/2"

Driller: Richard Lawrence

Sheet: 2 of 3

Log of Drill Hole B-3

Project: Proposed Commercial Development
Client: Mortenson Company
Location: NWC of Castro & 2nd Streets, Oakland CA
Depth to Water: Initial 12 feet

Project No: 042-00007
Figure No.: A-3
Logged By: Marty Groth
At Completion: 7 feet

SUBSURFACE PROFILE		SAMPLE				Penetration Test blows/ft 20 40 60	Water Content (%) Wp — 0 — Wt 10 20 30 40
Depth (ft)	Symbol	Description	Dry Density (pcf)	Moisture (%)	Type		
0		Ground Surface					
0		SPRINKLY SAND (SP) FL-2. Fine- to coarse-grained with trace fines and GLASS debris; black, moist, drils easily					
2		SILTY SAND (SA) FL-2. Fine- to medium-grained; black, moist, drils easily	114.1	11.5	13	4	■
4		SAND (SP) Loose, fine- to medium-grained with little SILT; brown, very moist, drils easily	114.4	13.3	12	4	■
6		CLAYEY SAND (SC) Loose, fine- to medium-grained; brown with light gray mottling, moist, drils easily Medium dense at 10 feet					
10			116.3	16.8	22	4	■
12		With thick interbed of increased and decreased fines below 12 feet					
14		SAND (SP) Medium dense, fine- to medium-grained with little to trace fines; brown, moist, drils firm	114.0	16.1	15	4	■
18							
18							
20							

Drill Method: Solid Flight **Krazan and Associates** **Drill Date:** 2-1-00
Drill Rig: Mobil B61 **Hole Size:** 3 1/4"
Driller: Brent Snyder **Sheet:** 1 of 3



Drill Method: Solid Flight **Krazan and Associates** **Drill Date:** 1-31-00
Drill Rig: Mobil B61 **Hole Size:** 4 1/2"
Driller: Richard Lawrence **Sheet:** 2 of 3

Log of Drill Hole B-3

Project: Proposed Commercial Development

Project No: 042-00007

Client: Mortenson Company

Figure No.: A-3

Location: NWC of Castro & 2nd Streets, Oakland CA

Logged By: Marty Groth

Depth to Water:

Initial: 12 feet

At Completion: 7 feet

SUBSURFACE PROFILE			SAMPLE				Penetration Test blow/ft	Water Content (%)									
Depth (ft)	Symbol	Description	Dry Density (pcf)	Moisture (%)	Type	Blow/ft.		Wp 0 Wl									
								20	40	60	10	20	30	40			
22		SAND (SP) Medium dense, fine- to medium-grained with 10% to trace fines; brown, moist, drills firmly	115.5	17.8		31											
24		SAND (SP) Very dense, fine- to medium-grained; brown, moist, drills very firmly															
25			112.0	20.6		50+											
30			109.6	21.4		70											
36		With thin interbeds of fine- to coarse-grained SAND below 35 feet	108.8	20.8		50+											
40																	

Drill Method: Solid Flight

Krazan and Associates

Drill Date: 2-1-00

Drill Rig: Mobile 951

Hole Size: 3 1/2"

Driller: Brent Snyder

Sheet: 2 of 3

Log of Drill Hole B-3

Project: Proposed Commercial Development

Project No: 042-00007

Client: Mortenson Company

Figure No.: A-3

Location: NVC of Castro & 2nd Streets, Oakland CA

Logged By: Marty Groth

Depth to water:

Initial: 12 feet

At Completion: 7 feet

SUBSURFACE PROFILE			SAMPLE				Penetration Test blows/ft			Water Content (%)		
Depth (ft)	Symbol	Description	Dry Density (pcf)	Moisture (%)	Type	Blows/ft.	20 40 60			Wp 0 Wt 10 20 30 40		
							3			111.1	19.5	
4												
46			109.9	21.0		76						
50			108.5	21.4		80+						
52		End of Borehole										
54												
56												
58												
60												

Drill Method: Solid Flight

Krazan and Associates

Drill Date: 2-1-00

Drill Rig: Mobile 861

Hole Size: 3 1/2"

Driller: Brent Snyder

Sheet: 3 of 3

Log of Drill Hole B-4

Project: Proposed Commercial Development

Project No: 042-00007

Client: Mortenson Company

Figure No.: A-4

Location: NWC of Castro & 2nd Streets, Oakland CA

Logged By: Marty Groth

Depth to Water:

Initial: 12 feet

At Completion: 7 feet

SUBSURFACE PROFILE			SAMPLE				Penetration Test			Water Content (%)				
Depth (ft)	Symbol	Description	Dry Density (pcf)	Moisture (%)	Type	Blows/ft.	blows/ft.			Wp --- Wl				
							20	40	60	10	20	30	40	
0		Ground Surface												
		PAVEMENT SECTION												
		ASPHALTIC CONCRETE = 2 inches												
		AGGREGATE BASE = 4 inches												
2		SILTY SAND/SAND (SM/SP)												
		FILL - Fine- to medium-grained; brown, moist, drills easily												
4		SILTY SAND (SM)		14.4										
		FILL - Fine- to medium-grained; dark brownish-black, moist, drills easily												
6		SILTY SAND/SAND (SM/SP)												
		Loose, fine- to medium-grained; brown, very moist, drills easily												
8		CLAYEY SAND (SC)		17.2										
		Medium dense, fine- to medium-grained with little SILT; orangish-brown, very moist, drills easily												
10														
12														
14		With interbeds of increased and decreased fines and SAND below 13 feet		18.1										
16														
18														
20				18.2										

Drill Method: Solid Flight

Krazan and Associates

Drill Date: 2-2-00

Drill Rig: B61

Hole Size: 4 1/2"

Driller: Richard Lawrence

Sheet: 1 of 1

Log of Drill Hole B-5

Project: Proposed Commercial Development

Project No: 042-00087

Client: Mortenson Company

Figure No.: A-5

Location: NWC of Castro & 2nd Streets, Oakland CA

Logged By: Dave Jarosz

Depth to Water:

Water: 14 feet

At Completion: 7 feet

SUBSURFACE PROFILE			SAMPLE				Penetration Test blows/ft	Water Content (%) Wp —0— Wl 10 20 30 40
Depth (ft)	Symbol	Description	Dry Density (pcf)	Moisture (%)	Type	Blows/ft.		
0		Ground Surface						
0		SILTY SAND/SAND (SM/SP) (FILL) - Fine- to medium-grained; dark brownish-black, moist, drills easily						
2		SILTY SAND (SM) (FILL) - Fine- to medium-grained; brown, moist, drills easily	107.8	18.5		B		
4		Medium dense at 6 feet						
6				14.0		20		
6		SILTY SAND/SAND (SM/SP) Medium dense, fine- to medium-grained with traces of CLAY; brown with light gray mottling, moist, drills easily						
10			110.8	18.1		31		
14		SILTY SAND (SM) Very dense, fine- to medium-grained with traces of CLAY; olive brown with light gray mottling, moist, drills easily	114.1	20.9		15		
16								
18								
20		Very dense below 20.5 feet						

Drill Method: Solid Flight

Krazen and Associates

Drill Date: 2-3-00

Drill Rig: CME 45C

Hole Size: 4½"

Driller: Richard Lawrence

Sheet: 1 of 3

Log of Drill Hole B-5

Project: Proposed Commercial Development

Project No: 042-00007

Client: Mortenson Company

Figure No.: A-5

Location: NWC of Castro & 2nd Streets, Oakland CA

Logged By: Dave Jarnoz

Depth to Water:

Initial: 14 feet

At Completion: 7 feet

SUBSURFACE PROFILE			SAMPLE				Penetration Test blows/ft	Water Content (%) Wp — 0 — Wl
Depth (ft)	Symbol	Description	Dry Density (pcf)	Moisture (%)	Type	Blow/ft.		
22		SILTY SAND (SM) Very dense, fine- to medium-grained with traces of CLAY; olive brown with light gray mottling, moist, drills easily	111.0	21.0		70		
24		With thin interbeds of SILTY SAND BAND below 23 feet						
26			108.8	28.0		50+		
28		SAND (SP) Very dense, fine- to medium-grained; grayish-brown, saturated, drills easily						
30			108.7	19.5		50+		
32								
34								
36			112.6	16.5		62		
38								
40		With thin lenses of SILTY SAND below 39 feet						

Drill Method: Solid Flight

Krazan and Associates

Drill Date: 2-3-00

Drill Rig: CME 45C

Hole Size: 4 1/2"

Driller: Richard Lawrence

Sheet: 2 of 3

Log of Drill Hole B-5

Project: Proposed Commercial Development

Project No: 042-00007

Client: Mortenson Company

Figure No.: A-5

Location: NWC of Castro & 2nd Streets, Oakland CA

Logged By: Dave Jarosz

Depth to Water:

Initial: 14 feet

At Completion: 7 feet

SUBSURFACE PROFILE			SAMPLE				Penetration Test blows/R	Water Content (%) Wp ——— Wl 10 20 30 40
Depth (ft)	Symbol	Description	Dry Density (pcf)	Moisture (%)	Type	Blows/ft.		
42			112.6			50+		
44		SILTY SAND (SM) Medium dense, fine- to medium-grained; brown, saturated, drills easily		21.7		23		
48		SAND (SP) Very dense, fine- to coarse-grained; brown, saturated, drills easily	106.2	23.7		50+		
50		End of Borehole						
52								
54								
56								
58								
60								

Drill Method: Solid Flight

Drill Rig: CME 45C

Driller: Richard Lawrence

Krazan and Associates

Drill Date: 2-3-00

Hole Size: 4 1/2"

Sheet: 3 of 3

Log of Drill Hole B-6

Project: Proposed Commercial Development

Project No: 042-00007

Client: Martenson Company

Figure No.: A-6

Location: NWC of Castro & 2nd Streets, Oakland CA

Logged By: Dave Jarosz

Depth to Water:

Initial: 15 feet

At Completion: 5 feet

SUBSURFACE PROFILE			SAMPLE				Penetration Test blows/ft			Water Content (%)				
Depth (ft)	Symbol	Description	Dry Density (pcf)	Moisture (%)	Type	Blows/ft.	Penetration Test blows/ft			Water Content (%)				
							20	40	60	Wp	—	—	Wt	
0		Ground Surface												
0		PAVEMENT SECTION												
0		ASPHALTIC CONCRETE = 4 inches												
0		AGGREGATE BASE = 3 inches												
2		ASPHALTIC CONCRETE FILL = 3 inches												
2		SILTY SAND (SM)												
2		Loose, fine- to medium-grained with												
2		GRAVEL; black, moist, drills easily												
4		With BRICK debris below 2 feet												
4		With thin lenses of BRICK at 3 feet												
6		SILTY SAND (SM)				6								
6		Loose, fine- to coarse-grained; brown, moist, drills easily												
8														
10		Medium dense below 10 feet												
10			23.0			19								
12		SILTY SAND (SM)												
12		Medium dense, fine- to medium-grained with CLAY; brown, moist, drills easily												
14														
16		Saturated below 15 feet												
16						10								
18														
20		Medium dense below 20 feet												

Drill Method: Solid Flight

Krazan and Associates

Drill Date: 2-3-00

Drill Rig: CME 450

Hole Size: 4 1/2"

Driller: Richard Lawrence

Sheet: 1 of 4

Log of Drill Hole B-6

Project: Proposed Commercial Development

Project No: 042-00007

Client: Mortenson Company

Figure No.: A-8

Location: NWC of Castro & 2nd Streets, Oakland CA

Logged By: Dave Jaresz

Depth to Water:

static: 15 feet

At Completion: 6 feet

SUBSURFACE PROFILE			SAMPLE				Penetration Test blowft	Water Content (%)	
Depth (ft)	Symbol	Description	Dry Density (pcf)	Moisture (%)	Type	Blowft.		Wp	Wl
22		SILTY SAND (SM) Medium dense, fine- to medium-grained with CLAY; brown, moist, drills easily	111.4	18.2		25			
24		SILTY SAND/SAND (SM/SP) Very dense, fine- to medium-grained; grayish-brown, saturated, drills easily							
26		WITH thin lenses of SAND below 25 feet	110.5	20.8		50+			
30		SAND (SP) Very dense, fine- to medium-grained; brown, saturated, drills easily	111.0	20.7		50			
36			112.4	19.0		50+			
38		SILTY SAND (SM) Very dense, fine- to medium-grained; brown, saturated, drills easily							
40		With thin interbedded lenses of SILTY SAND/SAND below 40 feet							

Drill Method: Solid Flight

Krazan and Associates

Drill Date: 2-3-00

Drill Rig: CME 45C

Hole Size: 4 1/2"

Driller: Richard Lawrence

Sheet: 2 of 4

Log of Drill Hole B-6

Project: Proposed Commercial Development

Project No: 042-00007

Client: Mortenson Company

Figure No.: A-8

Location: NYC of Castro & 2nd Streets, Oakland CA

Logged By: Dave Jeroaz

Depth to Water >

Initial: 15 feet

At Completion: 6 feet

SUBSURFACE PROFILE			SAMPLE				Penetration Test blowft			Water Content (%)				
Depth (ft)	Symbol	Description	Dry Density (pcf)	Moisture (%)	Type	Blowft.	Penetration Test blowft			Water Content (%)				
							20	40	60	Wp	0	Wt	30	40
42		SILTY SAND (SM) Very dense, fine- to medium-grained; brown, saturated, drills easily	109.8	20.7		81								
44		SILTY SAND/SAND (SM/SP) Dense, fine- to medium-grained; brown, saturated, drills easily												
46			111.8	23.0		58								
50		SAND (SP) Very dense, fine- to coarse-grained; grayish-brown, saturated, drills easily	110.4	18.7		50+								

Drill Method: Solid Flight

Krazean and Associates

Drill Date: 2-3-00

Drill Rig: CME 45C

Hole Size: 4 1/2"

Driller: Richard Lawrence

Sheet: 3 of 4

Log of Drill Hole B-6

Project: Proposed Commercial Development

Project No: 042-00007

Client: Mortenson Company

Figure No.: A-6

Location: NWC of Castro & 2nd Streets, Oakland CA

Logged By: Dave Jarosz

Depth to Water:

Initial: 15 feet

At Completion: 8 feet

SUBSURFACE PROFILE			SAMPLE				Penetration Test blows/ft	Water Content (%) Wp — 0 — Wl 10 20 30 40
Depth (ft)	Symbol	Description	Dry Density (pcf)	Moisture (%)	Type	Blows/ft.		
62		SANDY CLAY (CL) Firm, fine- to medium-grained; bluish-gray saturated, drills firmly						
64		With interbedded lenses of CLAYEY SAND below 65 feet		19.8		26		
68		With thin lenses of fine-grained SANDY CLAY , bluish-gray, moist, moist, drills firmly below 69 feet					24	
70		End of Borehole						
72								
74								
76								
78								
80								

Drill Method: Solid Flight

Krazan and Associates

Drill Date: 2-3-00

Drill Rig: CME 45C

Hole Size: 4 1/2"

Driller: Richard Lawrence

Sheet 4 of 4

Log of Drill Hole B-7

Project: Proposed Commercial Development

Project No: 042-00007

Client: Mortenson Company

Figure No.: A-7

Location: NWC of Castro & 2nd Streets, Oakland CA

Logged By: Marty Groth

Depth to Water:

tidal: 13 feet

As Completion: 5 feet

SUBSURFACE PROFILE			SAMPLE				Penetration Test			Water Content (%)				
Depth (ft)	Symbol	Description	Dry Density (pcf)	Moisture (%)	Type	Blows/ft.	blows/ft			Wp 0 Wl				
							20	40	60	10	20	30	40	
0		Ground Surface												
		PAVEMENT SECTION												
		ASPHALTIC CONCRETE ≈ 4 inches												
		GRAVELLY SAND (SP)												
2		FILL - Fine- to coarse-grained; black, moist, drills easily	111.0	8.8		9								
		SAND (SP)												
4		FILL - Fine- to medium-grained; brown, moist, drills easily												
		SILTY SANDSAND (SM/SP)				14								
6		FILL - Fine- to medium-grained; dark brownish black, moist, drills easily												
		SAND (SP)												
8		FILL - Fine- to medium-grained with trace fines; brown, moist, drills easily With dark brown lenses below 8 feet												
		SAND (SP)												
10		Loose, fine- to medium-grained with trace to little fines; brown, very moist, drills easily	114.5	17.9		21								
		CLAYEY SAND (SC)												
12		Medium dense, fine- to medium-grained; orange-brown with light gray mottling, moist, drills easily With thick interbeds of decreased fines below 12.5 feet												
		SAND (SP)												
14		Loose, fine- to medium-grained with trace to little fines; brown, moist, drills firmly	117.1	17.0		9								
16														
18														
20														

Drill Method: Solid Flight

Krazan and Associates

Drill Date: 2-2-00

Drill Rig: CME 45C

Hole Size: 4 1/2"

Driller: Brent Snyder

Sheet: 1 of 3

Log of Drill Hole B-7

Project: Proposed Commercial Development

Project No: 042-00007

Client: Mortenson Company

Figure No.: A-7

Location: NWC of Castro & 2nd Streets, Oakland CA

Logged By: Marty Groth

Depth to Water:

Initial: 13 feet

At Completion: 5 feet

SUBSURFACE PROFILE		SAMPLE				Penetration Test blows/ft 20 40 60	Water Content (%) Wp 0 Ws 10 20 30 40
Depth (ft)	Symbol	Dry Density (pcf)	Moisture (%)	Type	Blows/ft.		
22	[Symbol]	113.7	18.5	20	20	10	
24		111.5	19.8	25+	20	10	
30	[Symbol]	112.1	20.8	30	20	10	
36		110.1	21.5	50+	20	10	
40	[Symbol]						

Drill Method: Solid Flight

Krazan and Associates

Drill Date: 2-2-00

Drill Rig: CME 45C

Hole Size: 4 1/2"

Driller: Brent Snyder

Sheet: 2 of 3

Log of Drill Hole B-7

Project: Proposed Commercial Development

Project No: 042-00007

Client: Mortenson Company

Figure No.: A-7

Location: NWC of Castro & 2nd Streets, Oakland CA

Logged By: Marty Groth

Depth to Water:

Initial: 13 feet

At Completion: 6 feet

SUBSURFACE PROFILE			SAMPLE				Penetration Test			Water Content (%)		
Depth (ft)	Symbol	Description	Dry Density (pcf)	Moisture (%)	Type	Blows/ft.	blows/ft			Wp 0 Wl		
							20	40	60	10	20	30
42		SAND (SP) Very dense, fine- to medium-grained with trace to little fines; grayish-brown, moist, drills firmly	110.8	20.8		88						
44		CLAYEY SAND (SC) Medium dense, fine- to medium-grained; gray, moist, drills firmly										
45		With thin lenses of increased CLAY or SAND below 48 feet	110.9	20.3		26						
48		SAND (SP) Very dense, fine- to medium-grained with trace fines; gray, moist, drills very firmly										
50						80+						
52		End of Borehole				100+						
54												
56												
58												
60												

Drill Method: Solid Flight

Krazan and Associates

Drill Date: 2-2-00

Drill Rig: CME 45C

Hole Size: 4 1/2"

Driller: Brent Snyder

Sheet: 3 of 3

Log of Drill Hole B-8

Project: Proposed Commercial Development

Project No: 042-00007

Client: Mortenson Company

Figure No.: A-8

Location: NWC of Castro & 2nd Streets, Oakland CA

Logged By: Dave Jarosz

Depth to Water:

Initial: 14 feet

At Completion: 7 feet

SUBSURFACE PROFILE		SAMPLE				Penetration Test blow/ft			Water Content (%)					
Depth (ft)	Symbol	Description	Dry Density (pcf)	Moisture (%)	Type	Blow/ft.	Penetration Test blow/ft			Water Content (%)				
							20	40	60	Wp	—0—	Wl	10	20
0		Ground Surface												
0		PAVEMENT SECTION ASPHALTIC CONCRETE = 4 inches												
2		GRAVELLY SAND (SP) FILL - Fine- to coarse-grained; black, moist, drills easily		27.8		8								
4		SILTY SAND (SM) FILL - Fine- to medium-grained; brown, moist, drills easily												
4		CONCRETE at 3 feet												
6		SAND (SP) FILL - Fine- to coarse-grained; brown, moist, drills easily		22.9		9								
8		SILTY SAND/SAND (SM/SP) Medium dense, fine- to medium-grained; brown, moist, drills easily												
10				23.2		27								
12		SAND (SP) Loose, fine- to coarse-grained; brown, saturated, drills easily												
14		Saturated below 14 feet												
16				21.6		11								
18		SILTY SAND (SM) Medium dense, fine- to medium-grained; brown, saturated, drills easily												
20		Dense below 20.5 feet												

Drill Method: Solid Flight

Krazan and Associates

Drill Date: 2-2-00

Drill Rig: B61

Hole Size: 4 1/2"

Driller: Richard Lawrence

Sheet: 1 of 3

Log of Drill Hole B-8

Project: Proposed Commercial Development

Project No: 042-00007

Client: Mortenson Company

Figure No.: A-8

Location: NWC of Castro & 2nd Streets, Oakland CA

Logged By: Dave Janasz

Depth to Water:

Initial: 14 feet

At Completion: 7 feet

SUBSURFACE PROFILE		SAMPLE				Penetration Test blows/ft	Water Content (%)	
Depth (ft)	Symbol	Description	Dry Density (pcf)	Moisture (%)	Type		Blows/ft.	Wp
22		SILTY SAND (SM) Medium dense, fine- to medium-grained; brown, saturated, drills easily		21.8		42		
24		SAND (SP) Very dense, fine- to medium-grained; brown, saturated, drills easily						
26				22.2		60+		
28		SILTY SAND (SM) Very dense, fine- to medium-grained; brown, saturated, drills easily						
30				14.2		50+		
32		With interbedded lenses of SILTY SAND/SAND below 33 feet						
34				21.2		50+		
36								
38								
40								

Drill Method: Solid Flight

Krazan and Associates

Drill Date: 2-2-00

Drill Rig: B61

Hole Size: 4 1/2"

Driller: Richard Lawrence

Sheet: 2 of 3

Log of Drill Hole B-8

Project: Proposed Commercial Development

Project No: 042-00007

Client: Mortenson Company

Figure No.: A-8

Location: NWC of Castro & 2nd Streets, Oakland CA

Logged By: Dave Jarosz

Depth to Water:

In/Back: 14 feet

At Completion: 7 feet

SUBSURFACE PROFILE			SAMPLE				Penetration Test blowft	Water Content (%) Wp 0 Wl 10 20 30 40
Depth (ft)	Symbol	Description	Dry Density (pcf)	Moisture (%)	Type	Blowft.		
38		CLAYEY SILT (ML) Very dense with fine- to medium-grained SAND; gray, saturated, drills easily		25.0		95+	45	25
44								
46		SILTY SAND (SM) Very dense, fine- to medium-grained; brown, saturated, drills easily		22.7		70	50	30
48								
50		End of Borehole		15.9		60+	60	15
52								
54								
56								
58								
60								

Drill Method: Solid Flight

Krazan and Associates

Drill Date: 2-2-00

Drill Rig: B61

Hole Size: 4 1/2"

Driller: Richard Lawrence

Sheet: 3 of 3