



ENVIRONMENTAL
PROTECTION
86 NOV 32 AM 10:44

A Report Prepared For:

Jay-Phares Corporation
10700 MacArthur Blvd., Suite 200
Oakland, California 94605-5260

Attention: Mr. Hugh K. Phares, III
Mr. John Jay

**QUARTERLY MONITORING REPORT
FORMER YOUNG'S CLEANERS
FOOTHILL SQUARE SHOPPING CENTER
OAKLAND, CALIFORNIA**

NOVEMBER 19, 1996

By:

Donald J. Seymour
Senior Staff Engineer

William W. Mast, R.G.
Senior Engineer

502.0101.003

TABLE OF CONTENTS

LIST OF TABLES	iii
LIST OF ILLUSTRATIONS	iii
1.0 INTRODUCTION	1
2.0 BACKGROUND INFORMATION	1
3.0 WATER-LEVEL MEASUREMENTS.....	2
4.0 GROUNDWATER SAMPLING	3
5.0 DISCUSSION OF MONITORING RESULTS.....	3
5.1 Water-Level Measurements.....	3
5.2 Groundwater Chemistry.....	4
6.0 QUALITY ASSURANCE/QUALITY CONTROL (QA/AC).....	4
7.0 REFERENCES.....	5

TABLES

ILLUSTRATIONS

- APPENDICES
- A - WATER-LEVEL DATA FORM
 - B - GROUNDWATER SAMPLING REPORT
 - C - LABORATORY REPORT AND CHAIN-OF-CUSTODY RECORDS

DISTRIBUTION

LIST OF TABLES

Table 1	Monitoring Well Completion Details
Table 2	Water-Level Elevation Data Through July 1996
Table 3	Summary of Analytical Results for Groundwater Samples Through July 1996

LIST OF ILLUSTRATIONS

Plate 1	Location Map
Plate 2	Site Plan and Monitoring Well Location Map
Plate 3	Water-Level Elevations - Shallow Groundwater Zone
Plate 4	Water-Level Elevations - Deep Groundwater Zone
Plate 5	PCE Concentrations - Shallow Groundwater Zone
Plate 6	PCE Concentrations - Deep Groundwater Zone

1.0 INTRODUCTION

This report presents the results of the second quarterly groundwater monitoring performed by PES Environmental, Inc. (PES) during July 1996 at Foothill Square Shopping Center (Site) in Oakland, California (Plate 1). PES has been retained by Jay-Phares Corporation to conduct the quarterly groundwater monitoring at the site. The current groundwater monitoring program consists of measuring the depth to groundwater in 14 onsite monitoring wells on a quarterly basis, and purging and sampling 12 of the monitoring wells (Wells WGR MW-2 through 4, AMW-1, AMW-4 through 9, MW-6, and MW-7).

The purpose of the groundwater monitoring program at the site is to: (1) evaluate the presence of volatile organic compounds (VOCs) in groundwater; and (2) monitor water-level variations at the site. The quarterly monitoring program was performed in accordance with the procedures outlined in the *Proposal, Groundwater Monitoring, Former Young Cleaners, Foothill Square Shopping Center, Oakland, California* dated April 8, 1996 prepared by PES (PES, 1996).

2.0 BACKGROUND INFORMATION

The site is located in a residential and commercial area in Oakland, California. The site is presently used as a shopping center, which was developed in the early 1960's. Prior to the development of the Foothill Square Shopping Center, the site was a truck manufacturing plant. Young's Cleaners, located in the center of the shopping center near Well AMW-6, operated at the site between 1984 and 1995. Prior to Young's Cleaners, a coin operated dry cleaner, Norge Cleaners, operated at the location between 1962 and 1980. The cleaners have been on the CALSITES database list since 1980.

Beginning in January 1989, Western Geologic Resources (WGR) installed and monitored Wells WGR MW-1 through WGR MW-5 on the property to characterize the subsurface conditions due to the presence of the adjacent ARCO gas station, northwest of the site. Wells WGR MW-1, WGR MW-2, WGR MW-3, and WGR MW-5 were installed in what WGR defined as the shallow groundwater bearing zone, and Well WGR MW-4 was installed in the deep groundwater bearing zone. Monitoring well locations in the vicinity of the site are shown on Plate 2.

Between 1991 and 1993, RESNA Consultants (RESNA) conducted an investigation on behalf of ARCO for the service station site in order to define the extent of gasoline contamination caused by leakage of petroleum fuels. During their investigation, RESNA reported detectable concentrations of chlorinated solvents in several soil borings. As a result, Alameda County Health Care Services Agency (ACHSA) requested an investigation of the vertical and lateral extent of tetrachloroethylene (PCE) on both the ARCO site and the Foothill Square Shopping Center by ARCO as documented in the March 23, 1993 letter.

*I don't
think so.*

In order to verify the source and extent of the PCE contamination, Augeas Corporation (Augeas) installed Wells AMW-1 through AMW-3 in September through November of 1994, Wells AMW-4 and AMW-5 in March 1995, and Wells AMW-6 through AMW-9 in July through August of 1995. Using groundwater bearing zones defined by the WGR wells, Augeas installed Wells AMW-1 through AMW-7 in the shallow groundwater bearing zone, and Wells AMW-8 and AMW-9 in the deep groundwater bearing zone. A summary of the monitoring well completion details is provided in Table 1.

Augeas began performing groundwater monitoring of the AMW wells in October 1994. During September 1995, the last monitoring event conducted by Augeas, Wells WGR MW-1 through WGR MW-5, and MW-6 and MW-7 (installed on Foothill Square property by ARCO) were monitored in addition to the AMW wells (Augeas, 1995). The groundwater investigations conducted by Augeas concluded that the PCE contamination on the site was caused by a release of solvents from the dry cleaner and the associated underground sanitary sewer lateral. From October 1995 to January 1996, All Environmental, Inc. (AEI) excavated the contaminated soil and backfilled the excavation with clean fill material. During the excavation process, Wells AMW-2 and AMW-3 were accidentally destroyed (AEI, 1996). Soil from the excavation was spread over the southeast corner of the property for treatment by aeration under a permit from the Bay Area Air Quality Management District. Well WGR MW-5 was covered by the soil and has not been accessible since that time.

3.0 WATER-LEVEL MEASUREMENTS

Water levels in 12 onsite groundwater monitoring wells (Wells WGR MW-2 through WGR MW-4, AMW-1, AMW-4 through AMW-9, MW-6, and MW-7) were measured by PES prior to sampling on July 17, 1996. Monitoring data was not collected from WGR MW-1 because the vault was inaccessible after being accidentally paved over with asphalt in the few preceding weeks. Well WGR MW-5 has been inaccessible since 1995 when it was covered by the stockpile of excavated soil. Depth-to-water in the monitoring wells was measured from the top-of-casing (TOC) reference benchmark to a precision of 0.01-feet using an electronic water-level indicator/interface probe. Depth-to-water measurements were converted to water-level elevations referenced to mean sea level (MSL) by subtracting the depth to water from the TOC reference elevation. Free product was not observed in any of the monitoring wells. The Water Level Data Form completed by PES is presented in Appendix A.

To prevent cross-contamination between wells, the portion of the water-level indicator that was submerged in the well was cleaned between well measurements using a phosphate-free detergent/deionized water solution and double rinsed with deionized water.

4.0 GROUNDWATER SAMPLING

Groundwater samples were collected from Wells WGR MW-2 through WGR MW-4, AMW-1, AMW-4 through AMW-9, MW-6, and MW-7 on July 17, 1996, by Blaine Tech Services, Inc. (Blaine Tech) of San Jose, California, under the direct supervision of PES.

Groundwater samples were collected from each well after removing approximately three well volumes of water using either a positive displacement pump or disposable bailers. During well purging, the discharged water was monitored for pH, temperature, electrical conductivity, and turbidity. Following purging, samples were collected from the wells using a stainless steel or teflon disposable bailer and transferred to the appropriate laboratory sample containers. The sample containers were filled slowly to minimize sample volatilization and to ensure that the sample was free of air bubbles. The samples were labeled to designate sample number, time and date collected, and analysis required. The samples were immediately placed in a chilled, thermally-insulated cooler. To prevent cross-contamination between wells, the pump and the bailer were decontaminated using a high pressure steam cleaner prior to or after sampling at each well. Sampling procedures are documented in the groundwater sampling report prepared by Blaine Tech and included in Appendix B.

Groundwater samples were transported under chain-of-custody protocol to American Environmental Network (AEN), a state-certified laboratory in Pleasant Hill, California. Samples collected from the 12 wells were analyzed for VOCs using EPA Test Method 8010. The AEN laboratory reports and chain-of-custody records are included in Appendix C.

5.0 DISCUSSION OF MONITORING RESULTS

This section presents a summary of water-level measurements and groundwater analyses results from the July 1996 sampling event.

5.1 Water-Level Measurements

Depth-to-water measurements for July, 1996, for the shallow groundwater zone ranged from 12.42 feet (AMW-4) to 22.71 feet (WGR MW-2) below the top-of-casing (TOC). Shallow groundwater zone water-level elevations ranged from 37.54 feet MSL (MW-7) to 52.37 feet MSL (AMW-4). Depth-to-water measurements for the deep groundwater zone ranged from 15.02 feet (AMW-7) to 32.36 feet (MW-6) below TOC. Deep groundwater zone water-level elevations ranged from 29.42 feet MSL (MW-6) to 47.95 feet MSL (AMW-8). Depth-to-water measurements and calculated water-level elevations are presented in Table 2.

Plates 3 and 4 present water-level elevation contours developed from water levels measured on July 17, 1996, for the shallow and the deep groundwater zones, respectively. The contoured water-level elevations indicate that groundwater flow in both the shallow and the deep groundwater zones is generally west to northwest. The groundwater gradients in the shallow

and deep groundwater zones were approximately 0.044 and 0.078 foot per foot (ft/ft), respectively.

5.2 Groundwater Chemistry

A summary of laboratory chemical analyses results is presented in Table 3; only those chemicals that were detected in at least one sample are listed. The complete analytical laboratory reports and chain-of-custody forms are presented in Appendix C.

In the shallow groundwater zone, the highest concentrations of VOCs were detected in Wells AMW-6, located near the former dry cleaners, and AMW-7, located adjacent to the onsite sanitary sewer lateral. During this monitoring period, PCE was detected at concentrations ranging from 0.6 to 3,300 micrograms per liter ($\mu\text{g/L}$) in Wells AMW-4, AMW-5, AMW-6 and AMW-7. PCE concentrations in wells completed in the shallow groundwater zone are presented on Plate 5. Trichloroethylene (TCE), cis-1,2-dichloroethylene (c-1,2-DCE), trans-1,2-dichloroethylene (t-1,2-DCE), and Freon-12 were also detected in Wells WGR MW-3, AMW-6 and AMW-7, but generally at much lower concentrations than PCE. No VOCs were detected in Wells WGR MW-2 and AMW-1.

In the deep groundwater zone, PCE was detected in Wells AMW-8, AMW-9, and MW-6 at concentrations ranging from 1.6 to 590 $\mu\text{g/L}$. PCE concentrations in deep wells are presented on Plate 6. Low concentrations of TCE and Freon-12 were detected in Wells AMW-9 and MW-6, respectively. No VOCs were detected in Well WGR MW-4.

6.0 QUALITY ASSURANCE/QUALITY CONTROL (QA/QC)

Chemical data obtained from groundwater sample analyses were validated according to accuracy, precision, and completeness criteria. For the quantity of samples analyzed this quarter, the QA/QC program evaluated chemical data on the basis of one trip blank and one field equipment blank.

The evaluation procedure for blanks includes a qualitative review of the chemical analyses data reported by the laboratory. The trip blank was prepared by AEN and submitted for EPA Test Method 8010. The field equipment blank was prepared in the field using deionized water supplied by AEN and analyzed using EPA Test Method 8010. No VOCs were detected in the trip blank or the field equipment blank. The data from AEN are considered to be representative and of good quality.

7.0 REFERENCES

All Environmental, Inc. (AED), 1996. *Soil Remedial Investigation and Excavation Project Summary, Young's Cleaners, Foothill Shopping Center, 10700 MacArthur Boulevard, Oakland, California, 94605.* February 7.

Augeas Corporation (Augeas), 1995. *Report of Subsurface Investigation, Young's Cleaners, 10700 MacArthur Boulevard, Oakland, California.* December.

PES Environmental, Inc. (PES), 1996. *Proposal, Groundwater Monitoring, Former Young Cleaners, Foothill Square Shopping Center, Oakland, California.* April 8.

Table 1. Monitoring Well Completion Details
 Former Young's Cleaners
 Foothill Square Shopping Center
 Oakland, California

Well Number	Date Installed	Installed By	Total Depth (feet bgs)	Screened Interval (feet bgs)	Top-of-Casing Elevation (feet MSL)	Groundwater Zone Monitored
WGR MW-1 ⁽¹⁾	12/5/88	WGR	33.5	23.5 - 28.5	65.97	Shallow
WGR MW-2	12/6/88	WGR	40.5	23 - 28	63.18	Shallow
WGR MW-3	12/7/88	WGR	42	22 - 27	58.34	Shallow
WGR MW-4	12/7/88	WGR	50.5	23 - 45	60.02	Deep
WGR MW-5 ⁽²⁾	12/8/88	WGR	31.5	23.5 - 31.5	68.94	Shallow
AMW-1	9/12/94	Augeas	34	24 - 34	64.51	Shallow
AMW-2 ⁽³⁾	9/30/94	Augeas	29	19 - 29	65.33	Shallow
AMW-3 ⁽³⁾	11/18/94	Augeas	29	19 - 29	65.09	Shallow
AMW-4	3/22/95	Augeas	25	15 - 25	64.79	Shallow
AMW-5	3/22/95	Augeas	30	20 - 30	64.97	Shallow
AMW-6	NA	Augeas	25	NA	65.10	Shallow
AMW-7	NA	Augeas	25	NA	64.24	Shallow
AMW-8	NA	Augeas	48	NA	64.55	Deep
AMW-9	NA	Augeas	53	NA	63.48	Deep
MW-6	6/16/92	RESNA	56	37.5 - 56	61.78	Deep
MW-7	6/16/92	RESNA	37.5	17.5 - 37.5	58.64	Shallow

Note:

feet bgs = Feet below ground surface

feet MSL = Feet above mean sea level

WGR = Western Geologic Resources, Inc.

Augeas = Augeas Corporation

RESNA = RESNA Consultants

(1) = Well accidentally covered by asphalt paving in June 1996.

(2) = Well covered by soil remediation stockpile in 1995.

(3) = Well abandoned during site remediation activities in 1995.

NA = Not available

*Screen interval
 is necessary*

Table 2. Water-Level Elevation Data Through July, 1996
 Former Young's Cleaners
 Foothill Square Shopping Center
 Oakland, California

Well Number	Date Measured	Measured by	Top of Casing Elevation (feet MSL)	Depth to Water (feet bgs)	Water Table Elevation (feet MSL)
WGR MW-1 (Shallow Zone)	9/7/95	Augeas	65.97	5.82	60.15
	4/16/96	PES	65.97	3.88	62.09
	7/17/96	PES	65.97	NM	--
WGR MW-2 (Shallow Zone)	11/3/94	WGR	63.18	25.70	37.48
	3/23/95	Augeas	63.18	21.32	41.86
	6/21/95	Augeas	63.18	21.55	41.63
	9/7/95	Augeas	63.18	23.37	39.81
	4/16/96	PES	63.18	20.97	42.21
	7/17/96	PES	63.18	22.71	40.47
WGR MW-3 (Shallow Zone)	5/2/94	Resna	58.34	20.06	38.28
	8/3/94	Resna	58.34	22.30	36.04
	12/6/94	EMCON	58.34	17.52	40.82
	3/10/95	EMCON	58.34	15.20	43.14
	6/5/95	EMCON	58.34	19.25	39.09
	8/29/95	EMCON	58.34	21.41	36.93
	9/7/95	Augeas	58.34	21.55	36.79
	11/16/95	EMCON	58.34	22.50	35.84
	2/28/96	EMCON	58.34	14.90	43.44
	4/16/96	PES	58.34	18.49	39.85
	5/28/96	EMCON	58.34	18.33	40.01
7/17/96	PES	58.34	20.49	37.85	
WGR MW-4 (Deep Zone)	9/7/95	Augeas	60.02	27.20	32.82
	4/16/96	PES	60.02	23.26	36.76
	7/17/96	PES	60.02	25.89	34.13
WGR MW-5 (Shallow Zone)	1/11/89	WGR	68.94	19.00	49.94
	9/7/95	Augeas	68.94	NM	--
	4/16/96	PES	68.94	NM	--
	7/17/96	PES	68.94	NM	--
AMW-1 (Shallow Zone)	10/4/94	Augeas	64.51	24.82	39.69
	11/3/94	Augeas	64.51	25.08	39.43
	3/23/95	Augeas	64.51	21.42	43.09
	6/21/95	Augeas	64.51	23.50	41.01
	9/7/95	Augeas	64.51	23.01	41.50
	4/16/96	PES	64.51	21.99	42.52
	7/17/96	PES	64.51	22.65	41.86

Table 2. Water-Level Elevation Data Through July, 1996
 Former Young's Cleaners
 Foothill Square Shopping Center
 Oakland, California

Well Number	Date Measured	Measured by	Top of Casing Elevation (feet MSL)	Depth to Water (feet bgs)	Water Table Elevation (feet MSL)
AMW-2 (Shallow Zone)	10/4/94	Augeas	65.33	16.57	48.76
	10/18/94	Augeas	65.33	16.70	48.63
	11/3/94	Augeas	65.33	16.83	48.50
	3/23/95	Augeas	65.33	13.12	52.21
	6/21/95	Augeas	65.33	13.00	52.33
Well abandoned during site remediation.					
AMW-3 (Shallow Zone)	11/28/94	Augeas	65.09	14.84	50.25
	3/23/95	Augeas	65.09	12.20	52.89
	6/21/95	Augeas	65.09	11.80	53.29
Well abandoned during site remediation.					
AMW-4 (Shallow Zone)	5/15/95	Augeas	64.79	12.60	52.19
	6/21/95	Augeas	64.79	12.50	52.29
	9/7/95	Augeas	64.79	13.45	51.34
	4/16/96	PES	64.79	11.00	53.79
	7/17/96	PES	64.79	12.42	52.37
AMW-5 (Shallow Zone)	5/15/95	Augeas	64.97	13.71	51.26
	6/21/95	Augeas	64.97	13.85	51.12
	9/7/95	Augeas	64.97	14.70	50.27
	4/16/96	PES	64.97	13.04	51.93
	7/17/96	PES	64.97	14.48	50.49
AMW-6 (Shallow Zone)	9/7/95	Augeas	65.10	14.32	50.78
	4/16/96	PES	65.10	12.10	53.00
	7/17/96	PES	65.10	13.59	51.51
AMW-7 (Shallow Zone)	9/7/95	Augeas	64.24	15.30	48.94
	4/16/96	PES	64.24	14.31	49.93
	7/17/96	PES	64.24	15.02	49.22
AMW-8 (Deep Zone)	9/7/95	Augeas	64.55	17.90	46.65
	4/16/96	PES	64.55	15.06	49.49
	7/17/96	PES	64.55	16.60	47.95
AMW-9 (Deep Zone)	9/7/95	Augeas	63.48	23.02	40.46
	4/16/96	PES	63.48	20.98	42.50
	7/17/96	PES	63.48	22.74	40.74

Table 2. Water-Level Elevation Data Through July, 1996
 Former Young's Cleaners
 Foothill Square Shopping Center
 Oakland, California

Well Number	Date Measured	Measured by	Top of Casing Elevation (feet MSL)	Depth to Water (feet bgs)	Water Table Elevation (feet MSL)
MW-6 (Deep Zone)	6/30/92	RESNA	61.21	35.50	25.71
	7/15/92	RESNA	61.21	39.89	21.32
	8/25/92	RESNA	61.21	34.90	26.31
	9/9/92	RESNA	61.21	NM	--
	10/31/92	RESNA	61.21	NM	--
	11/20/92	RESNA	61.21	NM	--
	12/16/92	RESNA	61.21	NM	--
	1/22/93	RESNA	61.21	36.52	24.69
	2/12/93	RESNA	61.21	35.65	25.56
	3/28/93	RESNA	61.21	33.33	27.88
	4/30/93	RESNA	61.21	33.56	27.65
	5/12/93	RESNA	61.21	33.95	27.26
	6/17/93	RESNA	61.21	34.90	26.31
	8/18/93	RESNA	61.21	36.72	24.49
	11/10/93	RESNA	61.21	38.64	22.57
	2/4/94	RESNA	61.21	38.48	22.73
	5/2/94	RESNA	61.21	37.02	24.19
	8/3/94	RESNA	61.21	37.97	23.24
	12/6/94	EMCON	61.21	37.33	23.88
	3/10/95	EMCON	61.21	31.54	29.67
	6/5/95	EMCON	61.21	31.15	30.06
	8/29/95	EMCON	61.21	34.03	27.18
	9/7/95	Augeas	61.78*	34.09	27.69
	11/16/95	EMCON	61.78	36.40	25.38
	2/28/96	EMCON	61.78	30.18	31.60
	4/16/96	PES	61.78	29.40	32.38
	5/28/96	EMCON	61.78	30.29	31.49
	7/17/96	PES	61.78	32.36	29.42
MW-7 (Shallow Zone)	6/30/92	RESNA	58.22	23.70	34.52
	7/15/92	RESNA	58.22	23.10	35.12
	8/25/92	RESNA	58.22	34.23	23.99
	9/9/92	RESNA	58.22	26.30	31.92
	10/31/92	RESNA	58.22	35.44	22.78
	11/20/92	RESNA	58.22	23.47	34.75
	12/16/92	RESNA	58.22	19.07	39.15
	1/22/93	RESNA	58.22	16.56	41.66
	2/12/93	RESNA	58.22	18.22	40.00
	3/28/93	RESNA	58.22	18.04	40.18
	4/30/93	RESNA	58.22	19.34	38.88
	5/12/93	RESNA	58.22	19.80	38.42
	6/17/93	RESNA	58.22	22.63	35.59
8/18/93	RESNA	58.22	22.44	35.78	

Table 2. Water-Level Elevation Data Through July, 1996
 Former Young's Cleaners
 Foothill Square Shopping Center
 Oakland, California

Well Number	Date Measured	Measured by	Top of Casing Elevation (feet MSL)	Depth to Water (feet bgs)	Water Table Elevation (feet MSL)
MW-7 (Shallow Zone) (continued)	11/10/93	RESNA	58.22	24.51	33.71
	2/4/94	RESNA	58.22	20.78	37.44
	5/2/94	RESNA	58.22	20.51	37.71
	8/3/94	RESNA	58.22	22.66	35.56
	12/6/94	EMCON	58.22	18.37	39.85
	3/10/95	EMCON	58.22	17.69	40.53
	6/5/95	EMCON	58.22	19.68	38.54
	8/29/95	EMCON	58.22	21.70	36.52
	9/7/95	Augeas	58.64*	21.86	36.78
	11/16/95	EMCON	58.64	23.02	35.62
	2/28/96	EMCON	58.64	16.54	42.10
	4/16/96	PES	58.64	19.26	39.38
	5/28/96	EMCON	58.64	19.29	39.35
	7/17/96	PES	58.64	21.10	37.54

Notes:

feet MSL = Feet above mean sea level

NA = Not accessible

WGR = Western Geologic Resources, Inc.

Augeas = Augeas Corporation

PES = PES Environmental, Inc.

RESNA = RESNA Consultants

* = Top of casing elevations were resurveyed by Augeas Corporation in March 1995.

Table 3. Summary of Analytical Results for Groundwater Samples Through July 1996
 Former Young's Cleaners
 Foothill Square Shopping Center
 Oakland, California

Well Number	Date Sampled	Sampled by	Concentrations expressed in micrograms per liter (µg/L)				
			PCE	TCE	c-1,2-DCE	t-1,2-DCE	Freon-12
WGR MW-1 (Shallow Zone)	12/13/88	WGR	<0.1	<0.1	<0.1	<0.1	<0.1
	9/12/95	Augeas	<0.5	<0.5	<0.5	<0.5	<0.5
	7/17/96	PES	NS	NS	NS	NS	NS
WGR MW-2 (Shallow Zone)	12/13/88	WGR	<0.1	<0.1	<0.1	<0.1	<0.1
	2/10/94	WGR	<0.5	<0.5	<0.5	<0.5	<0.5
	3/23/95	Augeas	<0.5	<0.5	<0.5	<0.5	<0.5
	6/21/95	Augeas	<0.5	<0.5	<0.5	<0.5	<0.5
	9/11/95	Augeas	<0.5	<0.5	<0.5	<0.5	<0.5
	4/16/96	PES	<0.5	<0.5	<0.5	<0.5	<2
	7/17/96	PES	<0.5	<0.5	<0.5	<0.5	<2
WGR MW-3 (Shallow Zone)	12/13/88	WGR	<0.1	<0.1	<0.1	<0.1	<0.1
	5/2/94	EMCON	<1	<1	<1	NS	NS
	8/3/94	EMCON	<1	<1	<1	NS	NS
	12/6/94	EMCON	4	<1	<1	NS	NS
	3/11/95	EMCON	<1	<1	<1	<1	-
	6/5/95	EMCON	<1	<1	<1	<1	-
	8/29/95	EMCON	<1	<1	<1	<1	-
	9/11/95	Augeas	<0.5	<0.5	<0.5	<0.5	<0.5
	11/16/95	EMCON	<1	<1	<1	<1	-
	4/16/96	PES	0.6	0.5	<0.5	<0.5	11
	2/28/96	EMCON	<1	<1	<1	<1	-
	5/28/96	EMCON	<1	<1	<1	<1	-
7/17/96	PES	<0.5	0.7	<0.5	<0.5	<2	
WGR MW-4 (Deep Zone)	12/13/88	WGR	<0.1	<0.1	<0.1	<0.1	<0.1
	4/16/96	PES	<0.5	<0.5	<0.5	<0.5	<2
	7/17/96	PES	<0.5	<0.5	<0.5	<0.5	<2
WGR MW-5 (Shallow Zone)	12/5/88	WGR	<0.1	<0.1	<0.1	<0.1	<0.1
	7/17/96	PES	NS	NS	NS	NS	NS
AMW-1 (Shallow Zone)	10/4/94	Augeas	<0.2	<0.2	0.5	<0.5	<0.5
	3/23/95	Augeas	<0.5	<0.5	<0.5	<0.5	<0.5
	6/21/95	Augeas	<0.5	<0.5	<0.5	<0.5	<0.5
	9/11/95	Augeas	<0.5	<0.5	<0.5	<0.5	<0.5
	4/16/96	PES	<0.5	<0.5	<0.5	<0.5	<2
	7/17/96	PES	<0.5	<0.5	<0.5	<0.5	<2
AMW-2 (Shallow Zone)	10/4/94	Augeas	28,000	320	110	50	<0.5
	10/18/94	Augeas	18,000	<250	<250	<250	<250
	11/8/94	Augeas	35,000	<0.5	<0.5	<0.5	<0.5
	3/23/95	Augeas	13,000	<250	<250	<250	<250

Table 3. Summary of Analytical Results for Groundwater Samples Through July 1996
 Former Young's Cleaners
 Foothill Square Shopping Center
 Oakland, California

Well Number	Date Sampled	Sampled by	Concentrations expressed in micrograms per liter (µg/L)				
			PCE	TCE	c-1,2-DCE	t-1,2-DCE	Freon-12
AMW-2 (continued)	6/21/95	Augeas	36,000	<500	<500	<500	<500
	9/12/95	Augeas	Well abandoned during site remediation				
AMW-3 (Shallow Zone)	11/28/94	Augeas	22	<0.5	<0.5	<0.5	<0.5
	3/23/95	Augeas	45	<5.0	<5.0	<5.0	<5.0
	6/21/95	Augeas	<0.5	<0.5	<0.5	<0.5	<0.5
	9/12/95	Augeas	Well abandoned during site remediation				
AMW-4 (Shallow Zone)	5/15/95	Augeas	2,400	<50	<50	<50	<50
	6/21/95	Augeas	2,500	<50	<50	<50	<50
	9/13/95	Augeas	1,100	<25	<25	<25	<25
	4/16/96	PES	1,200	10	<10	<10	<40
	7/17/96	PES	860	<10	<10	<10	<40
AMW-5 (Shallow Zone)	5/15/95	Augeas	1.2	<0.5	<0.5	<0.5	<0.5
	6/21/95	Augeas	<0.5	<0.5	<0.5	<0.5	<0.5
	9/12/95	Augeas	<0.5	<0.5	<0.5	<0.5	<0.5
	4/16/96	PES	<0.5	<0.5	<0.5	<0.5	<2
	7/17/96	PES	0.6	<0.5	<0.5	<0.5	<2
AMW-6 (Shallow Zone)	9/13/95	Augeas	930	<25	<25	<25	<25
	4/16/96	PES	1,900	110	20	<10	<40
	7/17/96	PES	3,300	280	<30	<30	<100
AMW-7 (Shallow Zone)	9/12/95	Augeas	2,350	340	<25	<25	<25
	4/16/96	PES	2,300	500	2,200	60	<100
	7/17/96	PES	2,400	530	2,100	<30	<100
AMW-8 (Deep Zone)	9/11/95	Augeas	95	<25	<25	<25	<25
	4/16/96	PES	0.8	<0.5	<0.5	<0.5	<2
	7/17/96	PES	1.6	<0.5	<0.5	<0.5	<2
AMW-9 (Deep Zone)	9/13/95	Augeas	170	<25	<25	<25	<25
	4/16/96	PES	170	4	7	<3	<10
	7/17/96	PES	190	4	<3	<3	<10
MW-6 (Deep Zone)	6/30/92	RESNA	2,400	<0.5	<0.5	<0.5	<0.5
	9/9/92	RESNA	NS	NS	NS	NS	NS
	11/20/92	RESNA	NS	NS	NS	NS	NS
	2/12/93	RESNA	4,200	<0.5	<0.5	<0.5	<0.5
	5/12/93	RESNA	3,500	<0.5	<0.5	<0.5	<0.5
	8/18/93	RESNA	3,000	<0.5	<0.5	<0.5	<0.5
	11/10/93	RESNA	3,900	<0.5	<0.5	<0.5	<0.5
	2/4/94	RESNA	2,900	<50	<50	<0.5	<0.5
5/2/94	RESNA	2,000	<50	<50	<0.5	<0.5	

Table 3. Summary of Analytical Results for Groundwater Samples Through July 1996
 Former Young's Cleaners
 Foothill Square Shopping Center
 Oakland, California

Well Number	Date Sampled	Sampled by	Concentrations expressed in micrograms per liter (µg/L)				
			PCE	TCE	c-1,2-DCE	t-1,2-DCE	Freon-12
MW-6 (continued)	8/3/94	RESNA	1,400	<50	<50	<0.5	<0.5
	12/6/94	EMCON	2,000	<50	<50	<0.5	<0.5
	3/11/95	EMCON	1,300	<20	<20	<0.5	-
	6/5/95	EMCON	2,000	<20	<20	<20	-
	8/29/95	EMCON	1,300	<20	<20	<20	-
	9/11/95	Augeas	2,000	<50	<50	<50	<50
	11/16/95	EMCON	1,300	<20	<20	<20	-
	2/28/96	EMCON	960	<20	<20	<20	-
	4/16/96	PES	1,400	10	<10	<10	100
	5/28/96	EMCON	970	<20	<20	<20	-
7/17/96	PES	590	<5	<5	<5	30	
MW-7 (Shallow Zone)	6/30/92	RESNA	<1000	<1000	<1000	<1000	<1000
	9/9/92	RESNA	Not sampled: well contained floating product				
	11/20/92	RESNA	Not sampled: well contained floating product				
	2/12/93	RESNA	Not sampled: well contained floating product				
	5/12/93	RESNA	Not sampled: well contained floating product				
	8/18/93	RESNA	Not sampled: well contained floating product				
	11/10/93	RESNA	Not sampled: floating product entering the well during purging				
	2/4/94	RESNA	<50	<50	<50	<50	<50
	5/2/94	RESNA	<50	<50	<50	<50	<50
	8/3/94	RESNA	<50	<50	<50	<50	<50
	12/6/94	EMCON	<50	<50	<50	<50	<50
	3/11/95	EMCON	Not sampled: floating product entering the well during purging				
	6/5/95	EMCON	<10	<10	<10	<10	<10
	8/29/95	EMCON	<10	<10	<10	<10	-
	9/11/95	Augeas	85	<50	<50	<50	<50
	11/16/95	EMCON	<20	<20	<200	<200	-
	2/28/96	EMCON	<10	<10	<10	<10	-
	4/16/96	PES	<0.5	<0.5	<0.5	<0.5	8
	5/28/96	EMCON	<10	<10	<10	<10	-
7/17/96	PES	<0.5	0.6	0.6	<0.5	<2	

Notes:

- PCE = Tetrachloroethene
- TCE = Trichloroethene
- c-1,2-DCE = cis-1,2-dichloroethene
- t-1,2-DCE = trans-1,2-dichloroethene
- Freon 12 = Dichlorodifluoromethane
- WGR = Western Geologic Resources, Inc.
- Augeas = Augeas Corporation
- EMCON = EMCON Associates
- PES = PES Environmental, Inc.
- RESNA = RESNA Consultants
- <0.1 = Concentration not detected at or above the indicated detection limit
- NS = Not sampled because well was inaccessible

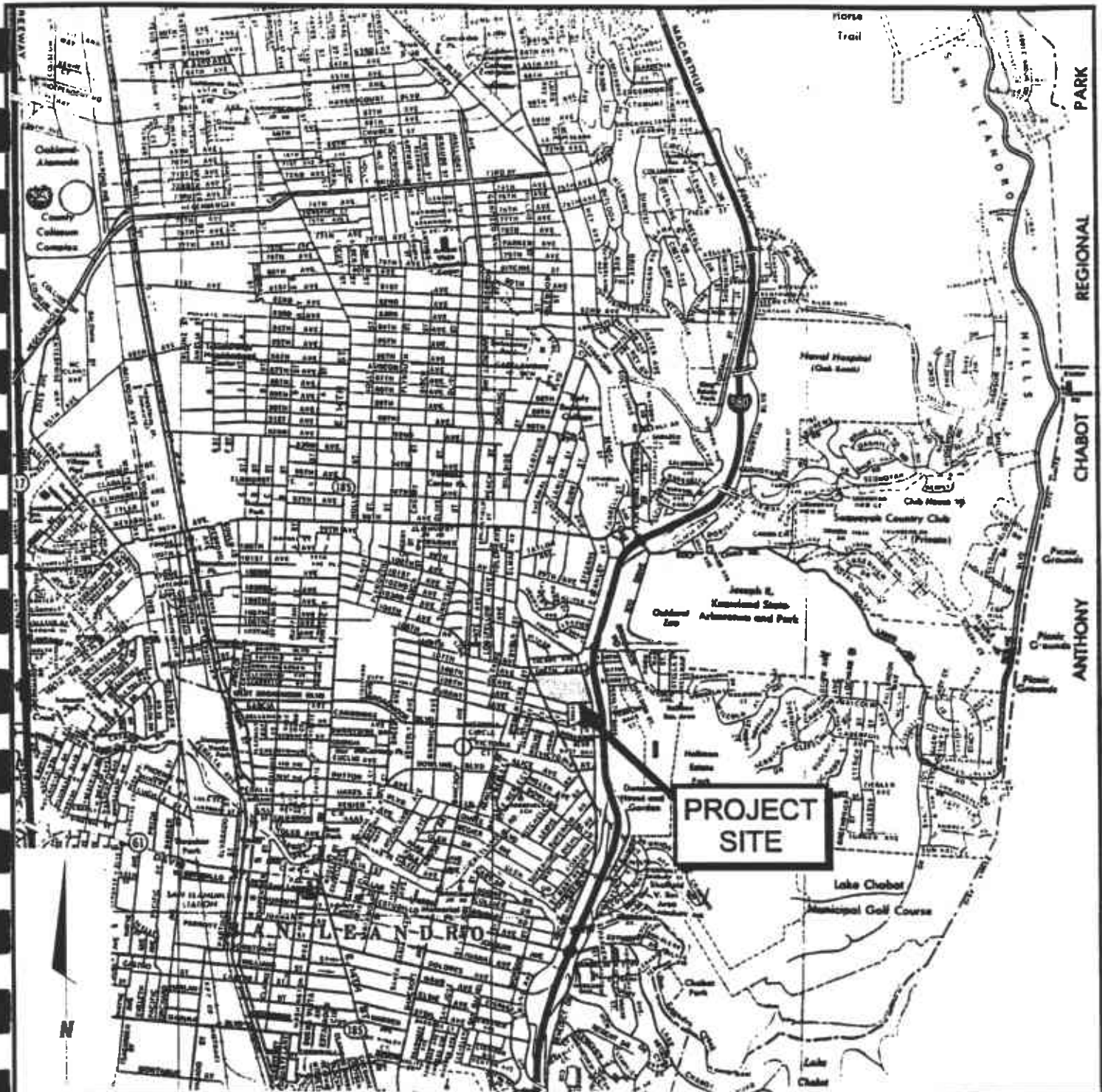

Ref: Oakland and East Bay Cities Street Map, Alameda County, California



PES Environmental, Inc.
Engineering & Environmental Services

Site Location Map
Foothill Square Shopping Center
10700 MacArthur Boulevard
Oakland, California

PLATE
1

502.0101.001
JOB NUMBER

502011V1.CDR
DRAWING NUMBER

PJS
REVIEWED BY

8/88
DATE

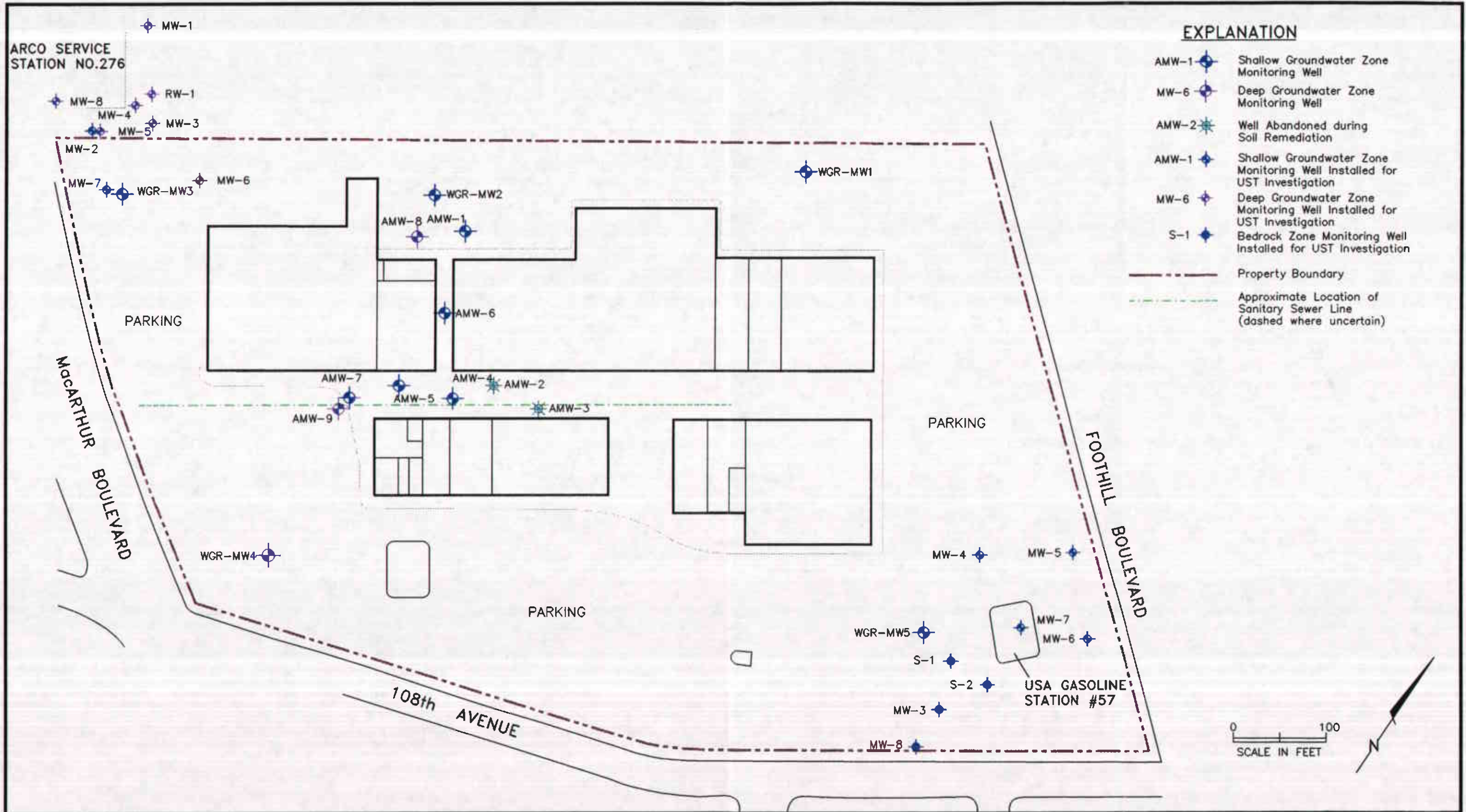

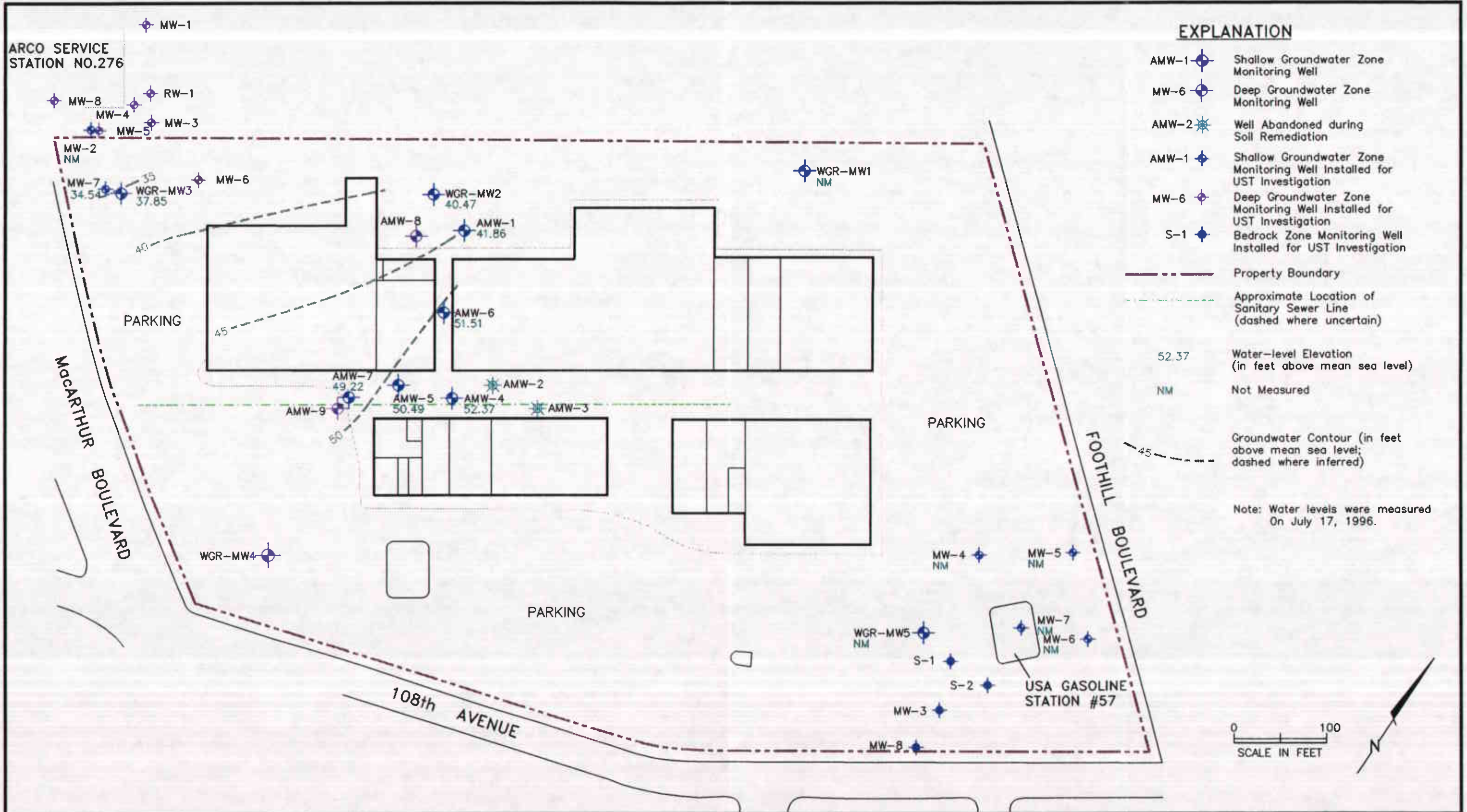

EXPLANATION

- AMW-1 Shallow Groundwater Zone Monitoring Well
- MW-6 Deep Groundwater Zone Monitoring Well
- AMW-2 Well Abandoned during Soil Remediation
- AMW-1 Shallow Groundwater Zone Monitoring Well Installed for UST Investigation
- MW-6 Deep Groundwater Zone Monitoring Well Installed for UST Investigation
- S-1 Bedrock Zone Monitoring Well Installed for UST Investigation
- Property Boundary
- Approximate Location of Sanitary Sewer Line (dashed where uncertain)
- 52.37 Water-level Elevation (in feet above mean sea level)
- NM Not Measured
- Groundwater Contour (in feet above mean sea level; dashed where inferred)

Note: Water levels were measured On July 17, 1996.

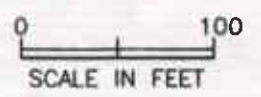

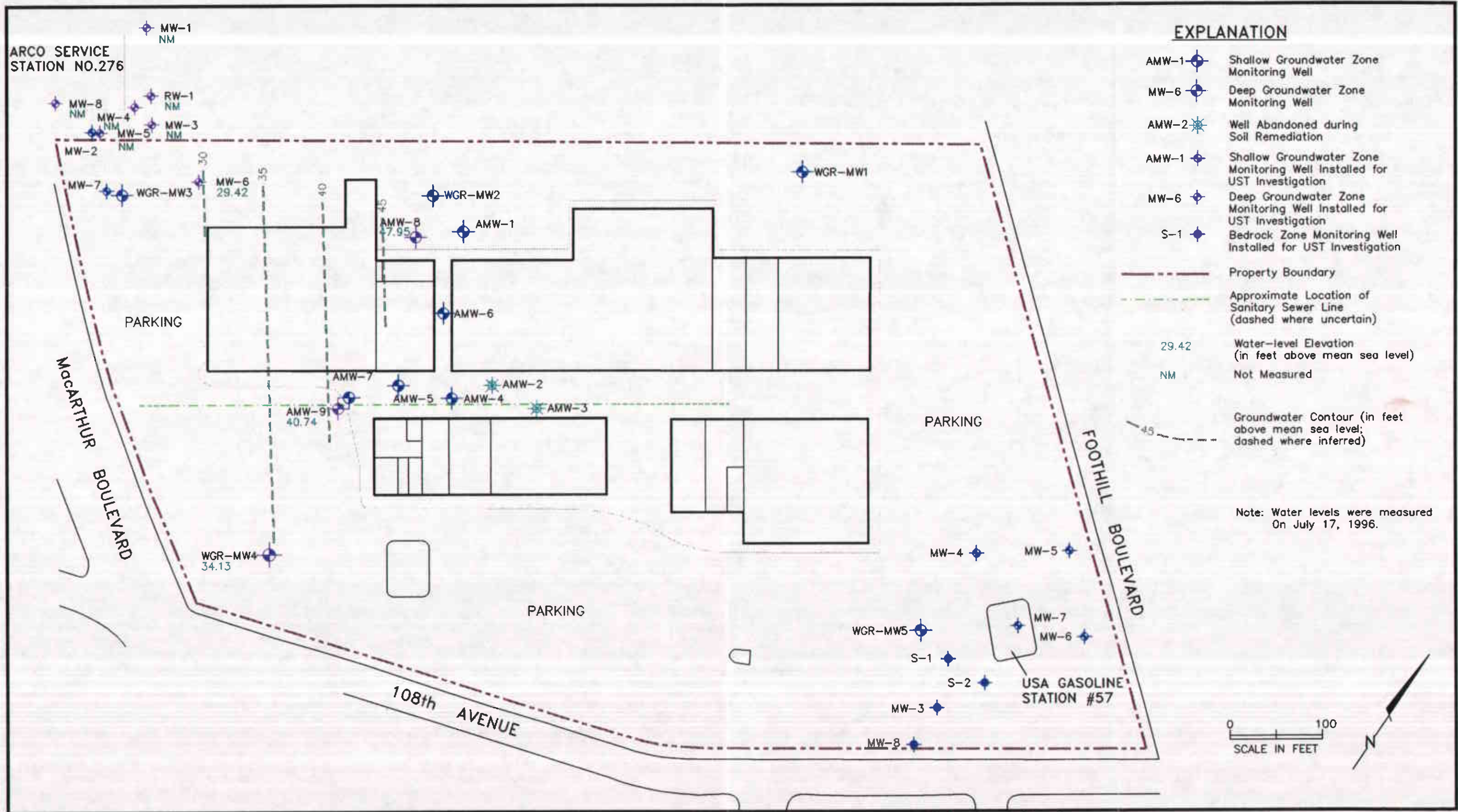

EXPLANATION

- AMW-1 Shallow Groundwater Zone Monitoring Well
- MW-6 Deep Groundwater Zone Monitoring Well
- AMW-2 Well Abandoned during Soil Remediation
- AMW-1 Shallow Groundwater Zone Monitoring Well Installed for UST Investigation
- MW-6 Deep Groundwater Zone Monitoring Well Installed for UST Investigation
- S-1 Bedrock Zone Monitoring Well Installed for UST Investigation
- Property Boundary
- Approximate Location of Sanitary Sewer Line (dashed where uncertain)
- 29.42 Water-level Elevation (in feet above mean sea level)
- NM Not Measured
- Groundwater Contour (in feet above mean sea level; dashed where inferred)

Note: Water levels were measured On July 17, 1996.

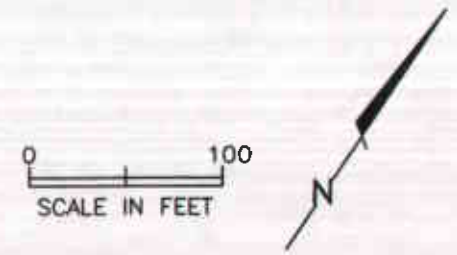

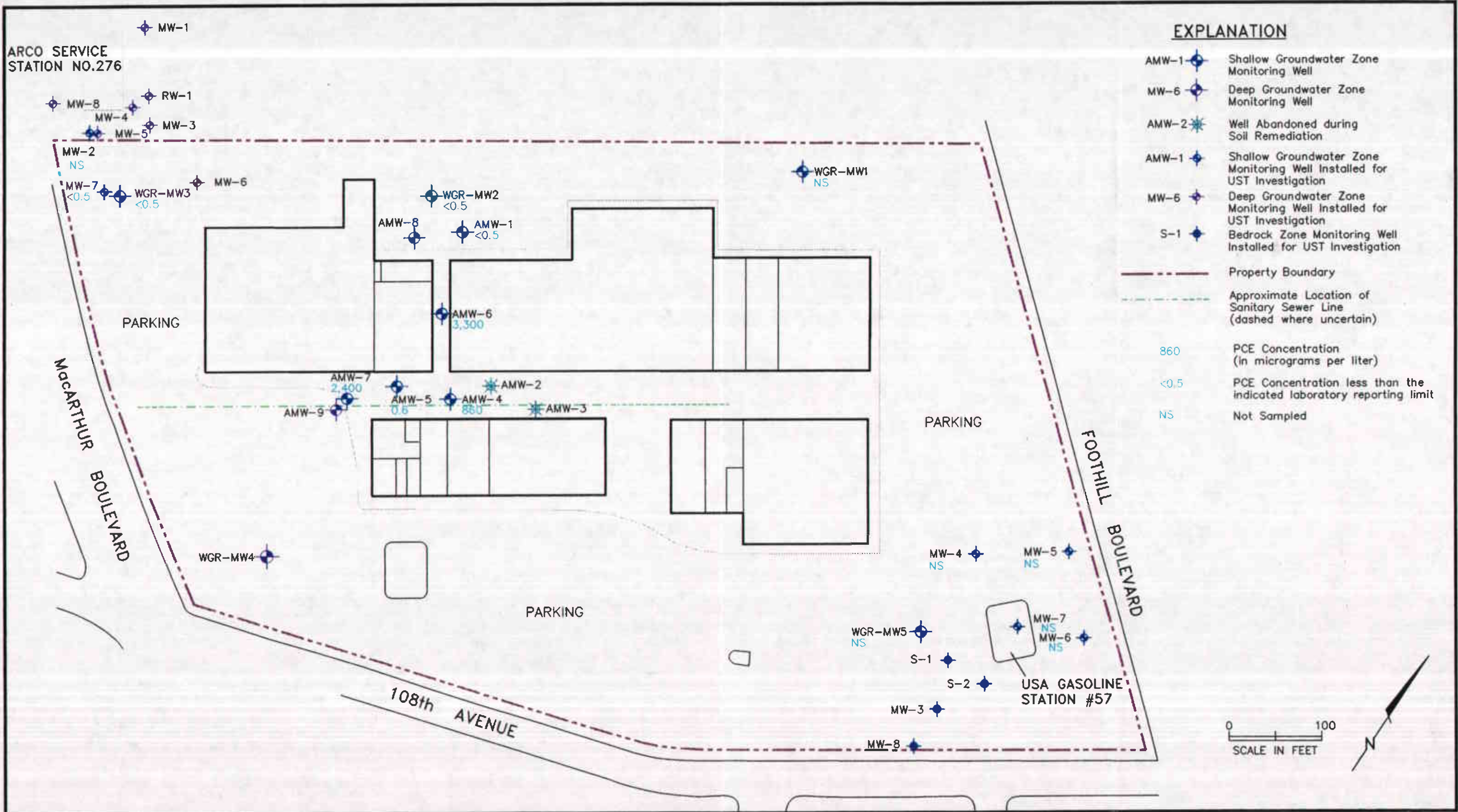

EXPLANATION

- AMW-1 Shallow Groundwater Zone Monitoring Well
- MW-6 Deep Groundwater Zone Monitoring Well
- AMW-2 Well Abandoned during Soil Remediation
- AMW-1 Shallow Groundwater Zone Monitoring Well Installed for UST Investigation
- MW-6 Deep Groundwater Zone Monitoring Well Installed for UST Investigation
- S-1 Bedrock Zone Monitoring Well Installed for UST Investigation
- Property Boundary
- Approximate Location of Sanitary Sewer Line (dashed where uncertain)
- 860 PCE Concentration (in micrograms per liter)
- <0.5 PCE Concentration less than the indicated laboratory reporting limit
- NS Not Sampled

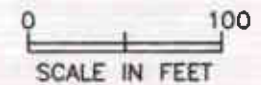

ARCO SERVICE STATION NO.276

EXPLANATION

- AMW-1 Shallow Groundwater Zone Monitoring Well
- MW-6 Deep Groundwater Zone Monitoring Well
- AMW-2 Well Abandoned during Soil Remediation
- AMW-1 Shallow Groundwater Zone Monitoring Well Installed for UST Investigation
- MW-6 Deep Groundwater Zone Monitoring Well Installed for UST Investigation
- S-1 Bedrock Zone Monitoring Well Installed for UST Investigation
- Property Boundary
- Approximate Location of Sanitary Sewer Line (dashed where uncertain)
- 590 PCE Concentration (in micrograms per liter)
- NS Not Sampled

Note: Wells were sampled On July 17, 1996.

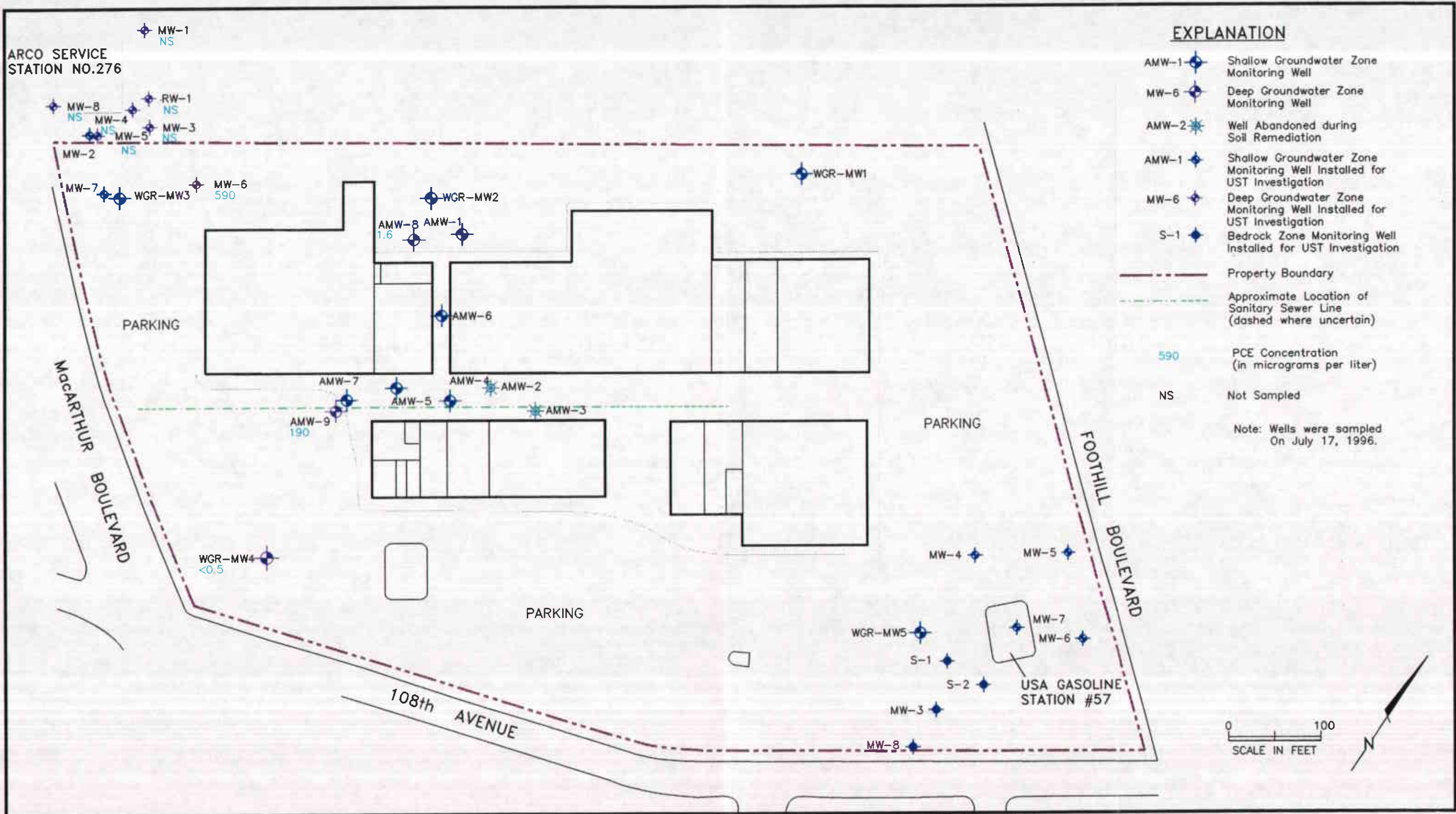

PES Environmental, Inc.
Engineering & Environmental Services

PCE Concentrations -
Deep Groundwater Zone
Foothill Square Shopping Center
10700 MacArthur Boulevard
Oakland, California

PLATE
6

APPENDIX A

WATER-LEVEL DATA FORM

APPENDIX B

GROUNDWATER SAMPLING REPORT

BLAINE TECH SERVICES INC.

985 TIMOTHY DRIVE
SAN JOSE, CA 95133
(408) 995-5535
FAX (408) 293-8773

July 26, 1996

PES Environmental, Inc.
1682 Novato Blvd., Suite 100
Novato, CA 94947

ATTN: Will Mast

Site:
10700 MacArthur Blvd.
Oakland, California

Date:
July 17, 1996

GROUNDWATER SAMPLING REPORT 960717-K-1

Blaine Tech Services, Inc. performs specialized environmental sampling and documentation as an independent third party. In order to avoid compromising the objectivity necessary for the proper and disinterested performance of this work, Blaine Tech Services, Inc. does not participate in the interpretation of analytical results, or become involved with the marketing or installation of remedial systems.

This report deals with the groundwater well sampling performed by our firm in response to your request. Data collected in the course of our work at the site are presented in the TABLE OF WELL MONITORING DATA. This information was collected during our inspection, well evacuation and sample collection. Measurements include the total depth of the well and the depth to water. Water surfaces were further inspected for the presence of immiscibles. A series of electrical conductivity, pH, and temperature readings were obtained during well evacuation and at the time of sample collection.

STANDARD PRACTICES

Evacuation and Sampling Equipment

As shown in the TABLE OF WELL MONITORING DATA, the wells at this site were evacuated according to a protocol requirement for the removal of three case volumes of water, before sampling. The wells were evacuated using bailers, middleburg, and electric submersible pumps.

Samples were collected using bailers.

Bailers: A bailer, in its simplest form, is a hollow tube which has been fitted with a check valve at the lower end. The device can be lowered into a well by means of a cord. When the bailer enters the water, the check valve opens and liquid flows into the interior of the bailer. The bottom check valve prevents water from escaping when the bailer is drawn up and out of the well.

Two types of bailers are used in groundwater wells at sites where fuel hydrocarbons are of concern. The first type of bailer is made of a clear material such as acrylic plastic and is used to obtain a sample of the surface and the near surface liquids, in order to detect the presence of visible or measurable fuel hydrocarbon floating on the surface. The second type of bailer is made of Teflon or stainless steel, and is used as an evacuation and/or sampling device.

Bailers are inexpensive and relatively easy to clean. Because they are manually operated, variations in operator technique may have a greater influence than would be found with more automated sampling equipment. Also, where fuel hydrocarbons are involved, the bailer may include near surface contaminants that are not representative of water deeper in the well.

USGS/Middleburg Positive Displacement Sampling Pumps: USGS/Middleburg positive displacement sampling pumps are EPA approved pumps appropriate for use in wells down to two inches in diameter and depths up to several hundred feet. The pump contains a flexible Teflon bladder which is alternately allowed to fill with well water and then collapsed. Actuation of the pump is accomplished with compressed air supplied by a single hose to one side of the Teflon membrane. Water on the other side of the membrane is squeezed out of the pump and up a Teflon conductor pipe to the surface. Evacuation and sampling are accomplished as a continuum. The rate of water removal is relatively slow and loss of volatiles almost non-existent. There is only positive pressure on the water being sampled and there is no impeller cavitation or suction. The pumps can be placed at any location within the well, can draw water from the very bottom of the well case, and are virtually immune to the erosive effects of silt or lack of water which destroy other types of pumps.

Disadvantages associated with Middleburg pumps include their high cost, low flow rate, temperamental operation, and cleaning requirements which are both elaborate and time consuming.

Electric Submersible Pumps: Electric submersible pumps are appropriate for the high volume evacuation of wells of any depth provided the well diameter is large enough to admit the pump. Four inch and three inch diameter wells will readily accept electric submersible pumps, while two inch wells do not. In operation, the pump is lowered into the well with a pipe train above it. A checkvalve immediately above the pump and below the first section of pipe prevents water that has entered the pipe from flowing back into the well. Electricity is provided to the pump via an electrical cable and the action of the pump is to push water up out of the well.

Electric submersible pumps are often used as well evacuation devices, which are then supplanted with a more specialized sample collection device (such as a bailer) at the time of sampling. An alternative is to use the pump for both evacuation and sampling. When a bailer is used to collect the sample, interpretation of results by the consultant should allow for variations attributable to near surface contamination entering the bailer. When the electric submersible is, itself, used for sample collection it should be operated with the output restricted to a point where the loss of volatiles becomes indistinguishable from the level obtained with true sampling pumps. It should be noted that when the pump is used for both evacuation and sample collection that it is possible to perform these operations as an uninterrupted continuum. This contrasts with the variations in elapsed time between evacuation and sample collection that occur when field personnel cease one mode of operation and must bring other apparatus into use.

Decontamination

All apparatus is brought to the site in clean and serviceable condition. The equipment is decontaminated after each use and before leaving the site.

Effluent Materials

The evacuation process creates a volume of effluent water which must be contained. Blaine Tech Services, Inc. will place this water in appropriate containers of the client's choice or bring new 55 gallon DOT 17 E drums to the site, which are appropriate for the containment of the effluent materials. The determination of how to properly dispose of the effluent water must usually await the results of laboratory analyses of the sample collected from the groundwater well. If that sample does not establish whether or not the effluent water is contaminated, or if effluent from more than one source has been combined in the same container, it may be necessary to conduct additional analyses on the effluent material.

Sampling Methodology

Samples were obtained by standardized sampling procedures that follow an evacuation and sample collection protocol. The sampling methodology conforms to both State and Regional Water Quality Control Board standards and specifically adheres to EPA requirements for apparatus, sample containers and sample handling as specified in publication SW 846 and T.E.G.D. which is published separately.

Sample Containers

Sample containers are supplied by the laboratory performing the analyses.

Sample Handling Procedures

Following collection, samples are promptly placed in an ice chest containing deionized ice or an inert ice substitute such as Blue Ice or Super Ice. The samples are maintained in either an ice chest or a refrigerator until delivered into the custody of the laboratory.

Sample Designations

All sample containers are identified with both a sampling event number and a discrete sample identification number. Please note that the sampling event number is the number that appears on our chain of custody. It is roughly equivalent to a job number, but applies only to work done on a particular day of the year rather than spanning several days, as jobs and projects often do.

Chain of Custody

Samples are continuously maintained in an appropriate cooled container while in our custody and until delivered to the laboratory under our standard chain of custody. If the samples are taken charge of by a different party (such as another person from our office, a courier, etc.) prior to being delivered to the laboratory, appropriate release and acceptance records are made on the chain of custody (time, date and signature of person accepting custody of the samples).

Hazardous Materials Testing Laboratory

The samples obtained at this site were delivered to American Environmental Network in Pleasant Hill, California. AEN is certified by the California Department of Health Services as a Hazardous Materials Testing Laboratory, and is listed as DOHS HMTL #1172.

Personnel

All Blaine Tech Services, Inc. personnel receive 29 CFR 1910.120(e)(2) training as soon after being hired as is practical. In addition, many of our personnel have additional certifications that include specialized training in level B supplied air apparatus and the supervision of employees working on hazardous materials sites. Employees are not sent to a site unless we are confident they can adhere to any site safety provisions in force at the site and unless we know that they can follow the written provisions of an SSP and the verbal directions of an SSO.

In general, employees sent to a site to perform groundwater well sampling will assume an OSHA level D (wet) environment exists unless otherwise informed. The use of gloves and double glove protocols protects both our employees and the integrity of the samples being collected. Additional protective gear and procedures for higher OSHA levels of protection are available.

Reportage

Submission to the Regional Water Quality Control Board and the local implementing agency should include copies of the sampling report, the chain of custody and the certified analytical report issued by the Hazardous Materials Testing Laboratory.

The following addresses have been listed here for your convenience:

Water Quality Control Board
San Francisco Bay Region
2101 Webster Street
5th Floor
Oakland, CA 94612
ATTN: John West

Oakland Fire Prevention Bureau
One City Hall Plaza
Oakland, CA 94612
ATTN: Stanley Y. Chi

Please call if we can be of any further assistance.

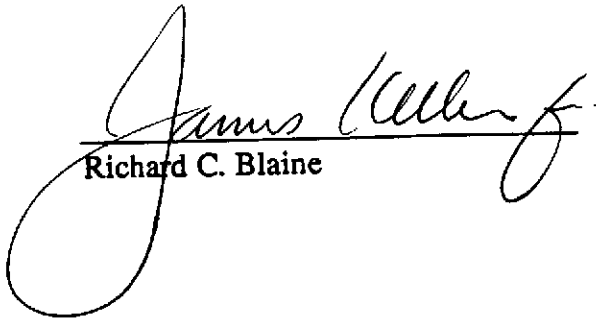
Richard C. Blaine

RCB/mc

attachments: table of well monitoring data
chain of custody

TABLE OF WELL MONITORING DATA

Well I.D.	AMW-1			AMW-4			AMW-5			AMW-6		
Date Sampled	07/17/96			07/17/96			07/17/96			07/17/96		
Well Diameter (in.)	2			2			2			2		
Total Well Depth (ft.)	33.95			24.59			30.15			25.02		
Depth To Water (ft.)	22.68			15.46			14.45			13.57		
Free Product (in.)	NONE			NONE			NONE			NONE		
Reason If Not Sampled	--			--			--			--		
1 Case Volume (gal.)	1.8			1.4			2.5			1.8		
Did Well Dewater?	NO			NO			NO			NO		
Gallons Actually Evacuated	5.5			4.5			7.5			5.5		
Purging Device	BAILER			BAILER			BAILER			BAILER		
Sampling Device	BAILER			BAILER			BAILER			BAILER		
Time	10:05	10:08	10:12	12:15	12:18	12:21	11:55	11:59	12:03	09:35	09:39	09:43
Temperature (Fahrenheit)	66.6	67.0	67.0	62.6	63.4	64.0	67.0	68.6	68.6	65.0	64.8	65.0
pH	7.3	7.1	7.0	7.4	7.1	7.0	7.0	7.0	7.0	7.0	7.0	7.0
Conductivity (micromhos/cm)	1700	1600	1600	1700	1600	1700	1700	1700	1700	2000	2000	2000
Nephelometric Turbidity Units	>200	>200	>200	>200	>200	>200	>200	>200	>200	>200	>200	>200
BTS Chain of Custody	960717-K-1			960717-K-1			960717-K-1			960717-K-1		
BTS Sample I.D.	AMW-1			AMW-4			AMW-5			AMW-6		
DOHS HMTL Laboratory	AEN			AEN			AEN			AEN		
Analysis	EPA 8010			EPA 8010			EPA 8010			EPA 8010		

TABLE OF WELL MONITORING DATA

Well I.D.	AMW-7			AMW-8			AMW-9			MW-6		
Date Sampled	07/17/96			07/17/96			07/17/96			07/17/96		
Well Diameter (in.)	2			2			2			2		
Total Well Depth (ft.)	24.76			48.44			54.28			49.02		
Depth To Water (ft.)	15.00			16.60			22.69			32.32		
Free Product (in.)	NONE			NONE			NONE			NONE		
Reason If Not Sampled	--			--			--			--		
1 Case Volume (gal.)	1.5			5.1			5.1			2.7		
Did Well Dewater?	NO			NO			NO			NO		
Gallons Actually Evacuated	4.5			15.5			15.5			8.5		
Purging Device	BAILER			MIDDLEBURG			MIDDLEBURG			MIDDLEBURG		
Sampling Device	BAILER			BAILER			BAILER			BAILER		
Time	11:33	11:36	11:38	09:03	09:09	09:15	11:06	11:14	11:21	08:36	08:39	08:42
Temperature (Fahrenheit)	70.2	68.8	68.6	65.4	66.2	66.0	68.6	68.0	68.4	64.6	65.2	65.6
pH	6.7	6.8	6.8	7.5	7.6	7.6	6.8	6.8	6.8	6.7	6.8	6.8
Conductivity (micromhos/cm)	1200	1100	1200	480	380	390	1700	1600	1600	1400	1500	1500
Nephelometric Turbidity Units	>200	>200	>200	>200	>200	>200	86.4	51.2	44.7	>200	123.7	76.6
BTS Chain of Custody	960717-K-1			960717-K-1			960717-K-1			960717-K-1		
BTS Sample I.D.	AMW-7			AMW-8			AMW-9			MW-6		
DOHS HMTL Laboratory	AEN			AEN			AEN			AEN		
Analysis	EPA 8010			EPA 8010			EPA 8010			EPA 8010		

TABLE OF WELL MONITORING DATA

Well I.D.	MW-7			WGR/MW-2			WGR/MW-3*			WGR/MW-4		
Date Sampled	07/17/96			07/17/96			07/17/96			07/17/96		
Well Diameter (in.)	2			4			4			4		
Total Well Depth (ft.)	36.62			27.96			26.93			44.93		
Depth To Water (ft.)	21.06			22.70			20.96			25.85		
Free Product (in.)	NONE			NONE			NONE			NONE		
Reason If Not Sampled	--			--			--			--		
1 Case Volume (gal.)	2.5			3.4			3.9			12.4		
Did Well Dewater?	NO			NO			NO			NO		
Gallons Actually Evacuated	7.5			12.0			12.0			39.0		
Purging Device	MIDDLEBURG/ ELECTRIC SUBMERSIBLE			ELECTRIC SUBMERSIBLE			ELECTRIC SUBMERSIBLE			ELECTRIC SUBMERSIBLE		
Sampling Device	BAILER			BAILER			BAILER			BAILER		
Time	07:45	07:48	07:51	10:20	10:23	10:25	08:15	08:17	08:20	10:44	10:46	10:47
Temperature (Fahrenheit)	67.2	67.0	67.4	67.4	68.0	68.2	67.2	67.8	67.8	70.6	71.8	71.6
pH	6.6	6.5	6.6	7.2	7.2	7.2	6.6	6.4	6.4	6.7	6.6	6.6
Conductivity (micromhos/cm)	1000	680	670	1400	1400	1400	600	580	580	1000	940	980
Nephelometric Turbidity Units	>200	>200	120.2	198.5	>200	41.7	68.1	146.1	>200	80.5	102.8	74.6
BTS Chain of Custody	960717-K-1			960717-K-1			960717-K-1			960717-K-1		
BTS Sample I.D.	MW-7			WGR-MW2			WGR-MW3			WGR-MW4		
DOHS HMTL Laboratory	AEN			AEN			AEN			AEN		
Analysis	EPA 8010			EPA 8010			EPA 8010			EPA 8010		

* Sample EB is an equipment blank taken before sampling WGR/MW-3 and after sampling MW-7.

LAB GEN

ALL ANALYSES MUST MEET SPECIFICATIONS AND DETECTION LIMITS SET BY CALIFORNIA DHS AND

EPA RWQCB REGION _____
 LIA
 OTHER

CHAIN OF CUSTODY 760717-161

CLIENT PES ENVIRONMENTAL

SITE FOOTHILL SQUARE SHOPPING CENTER
10700 MACARTHUR BLVD.
OAKLAND, CA.

C = COMPOSITE ALL CONTAINERS

SPECIAL INSTRUCTIONS INVOICE of Report
to PES ENVIRONMENTAL.
ATTN: JENNY HAN
Project #: 502,0101,003

SAMPLE I.D.	MATRIX		CONTAINERS	C = COMPOSITE ALL CONTAINERS	ADD'L INFORMATION	STATUS	CONDITION	LAB SAMPLE #
	S = SOIL	W = H2O						
<u>WGR-MW2 1035</u>	<u>W</u>		<u>3</u>	XXXXXX XXXXXX XXXXXX XXXXXX XXXXXX XXXXXX XXXXXX XXXXXX XXXXXX				
<u>WGR-MW3 830</u>								
<u>WGR-MW4 655</u>								
<u>AMW1 1015</u>								
<u>AMW4 1225</u>								
<u>AMW5 1210</u>								
<u>AMW6 950</u>								
<u>AMW7 1145</u>								
<u>AMW8 925</u>								
<u>AMW9 1125</u>								

SAMPLING COMPLETED 7/17/96 | DATE | TIME 1300 | SAMPLING PERFORMED BY Keith Brown | RESULTS NEEDED NO LATER THAN Standard TAT

RELEASED BY [Signature] | DATE 7/18/96 | TIME 1420 | RECEIVED BY [Signature] | DATE 7/18/96 | TIME 1420

RELEASED BY _____ | DATE _____ | TIME _____ | RECEIVED BY _____ | DATE _____ | TIME _____

RELEASED BY _____ | DATE _____ | TIME _____ | RECEIVED BY _____ | DATE _____ | TIME _____

SHIPPED VIA _____ | DATE SENT _____ | TIME SENT _____ | COOLER # _____

ALL ANALYSES MUST MEET SPECIFICATIONS AND DETECTION LIMITS SET BY CALIFORNIA DHS AND

- EPA
- LIA
- OTHER

RWQCB REGION _____

CHAIN OF CUSTODY

960717-161

CLIENT PES Environmental
SITE Foothill Square Shopping Center
10700 MacArthur Blvd.
Oakland, CA.

SPECIAL INSTRUCTIONS Invoice & Report
to PES Environmental.
ATTN: JENNY HAN
Project #: 502.0101.003

SAMPLE I.D.	MATRIX		TOTAL	CONTAINERS
	S = SOIL	W = H2O		
<u>NW6</u>	<u>850</u>	<u>W</u>	<u>3</u>	<u>XXX</u>
<u>NW7</u>	<u>800</u>	<u>↓</u>	<u>↓</u>	
<u>EB</u>	<u>-</u>	<u>↓</u>	<u>↓</u>	
<u>TB</u>	<u>-</u>	<u>↓</u>	<u>2</u>	

C = COMPOSITE ALL CONTAINERS

XXX
6010

ADD'L INFORMATION	STATUS	CONDITION	LAB SAMPLE #

SAMPLING COMPLETED | DATE 7/17/96 | TIME 1300 | SAMPLING PERFORMED BY Keith Brown | RESULTS NEEDED NO LATER THAN Standard TAT

RELEASED BY [Signature] | DATE 7/18/96 | TIME 1420 | RECEIVED BY [Signature] | DATE 7/18/96 | TIME 1420

RELEASED BY _____ | DATE _____ | TIME _____ | RECEIVED BY _____ | DATE _____ | TIME _____

RELEASED BY _____ | DATE _____ | TIME _____ | RECEIVED BY _____ | DATE _____ | TIME _____

SHIPPED VIA _____ | DATE SENT _____ | TIME SENT _____ | COOLER # _____

APPENDIX C

**LABORATORY REPORT
AND
CHAIN-OF-CUSTODY RECORDS**

American Environmental Network

Certificate of Analysis

OHS Certification: 1172

AIHA Accreditation: 11134

PAGE 1

RECEIVED JUL 31 1996

PES ENVIRONMENTAL, INC.
1682 NOVATO BLVD.
SUITE 100
NOVATO, CA 94947

ATTN: JENNY HAN
CLIENT PROJ. ID: 502.0101.003
CLIENT PROJ. NAME: FOOTHILL SQ.
C.O.C. NUMBER: 960717-K1

REPORT DATE: 07/29/96

DATE(S) SAMPLED: 07/17/96-07/18/96

DATE RECEIVED: 07/18/96

AEN WORK ORDER: 9607225

PROJECT SUMMARY:

On July 18, 1996, this laboratory received 14 water sample(s).

Client requested sample(s) be analyzed for chemical parameters. Results of analysis are summarized on the following page(s). Please see quality control report for a summary of QC data pertaining to this project.

Samples will be stored for 30 days after completion of analysis, then disposed of in accordance with State and Federal regulations. Samples may be archived by prior arrangement.

If you have any questions, please contact Client Services at (510) 930-9090.

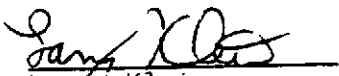
Larry Klein
Laboratory Director

PES ENVIRONMENTAL, INC.

SAMPLE ID: WGR-MW2
 AEN LAB NO: 9607225-01
 AEN WORK ORDER: 9607225
 CLIENT PROJ. ID: 502.0101.003

DATE SAMPLED: 07/17/96
 DATE RECEIVED: 07/18/96
 REPORT DATE: 07/29/96

ANALYTE	METHOD/ CAS#	RESULT	REPORTING LIMIT	UNITS	DATE ANALYZED
EPA 8010 - Water matrix	EPA 8010				
Bromodichloromethane	75-27-4	ND	0.5	ug/L	07/20/96
Bromoform	75-25-2	ND	0.5	ug/L	07/20/96
Bromomethane	74-83-9	ND	2	ug/L	07/20/96
Carbon Tetrachloride	56-23-5	ND	0.5	ug/L	07/20/96
Chlorobenzene	108-90-7	ND	0.5	ug/L	07/20/96
Chloroethane	75-00-3	ND	2	ug/L	07/20/96
2-Chloroethyl Vinyl Ether	110-75-8	ND	0.5	ug/L	07/20/96
Chloroform	67-66-3	ND	0.5	ug/L	07/20/96
Chloromethane	74-87-3	ND	2	ug/L	07/20/96
Dibromochloromethane	124-48-1	ND	0.5	ug/L	07/20/96
1,2-Dichlorobenzene	95-50-1	ND	0.5	ug/L	07/20/96
1,3-Dichlorobenzene	541-73-1	ND	0.5	ug/L	07/20/96
1,4-Dichlorobenzene	106-46-7	ND	0.5	ug/L	07/20/96
Dichlorodifluoromethane	75-71-8	ND	2	ug/L	07/20/96
1,1-Dichloroethane	75-34-3	ND	0.5	ug/L	07/20/96
1,2-Dichloroethane	107-06-2	ND	0.5	ug/L	07/20/96
1,1-Dichloroethene	75-35-4	ND	0.5	ug/L	07/20/96
cis-1,2-Dichloroethene	156-59-2	ND	0.5	ug/L	07/20/96
trans-1,2-Dichloroethene	156-60-5	ND	0.5	ug/L	07/20/96
1,2-Dichloropropane	78-87-5	ND	0.5	ug/L	07/20/96
cis-1,3-Dichloropropene	10061-01-5	ND	0.5	ug/L	07/20/96
trans-1,3-Dichloropropene	10061-02-6	ND	0.5	ug/L	07/20/96
Methylene Chloride	75-09-2	ND	2	ug/L	07/20/96
1,1,2,2-Tetrachloroethane	79-34-5	ND	0.5	ug/L	07/20/96
Tetrachloroethene	127-18-4	ND	0.5	ug/L	07/20/96
1,1,1-Trichloroethane	71-55-6	ND	0.5	ug/L	07/20/96
1,1,2-Trichloroethane	79-00-5	ND	0.5	ug/L	07/20/96
Trichloroethene	79-01-6	ND	0.5	ug/L	07/20/96
Trichlorofluoromethane	75-69-4	ND	2	ug/L	07/20/96
1,1,2Trichlorotrifluoroethane	76-13-1	ND	0.5	ug/L	07/20/96
Vinyl Chloride	75-01-4	ND	2	ug/L	07/20/96

Reporting limits elevated due to high levels of target compounds. Sample run at dilution.

ND = Not detected at or above the reporting limit
 * = Value at or above reporting limit

PES ENVIRONMENTAL, INC.

SAMPLE ID: WGR-MW3
 AEN LAB NO: 9607225-02
 AEN WORK ORDER: 9607225
 CLIENT PROJ. ID: 502.0101.003

DATE SAMPLED: 07/17/96
 DATE RECEIVED: 07/18/96
 REPORT DATE: 07/29/96

ANALYTE	METHOD/ CAS#	RESULT	REPORTING LIMIT	UNITS	DATE ANALYZED
EPA 8010 - Water matrix	EPA 8010				
Bromodichloromethane	75-27-4	ND	0.5	ug/L	07/22/96
Bromoform	75-25-2	ND	0.5	ug/L	07/22/96
Bromomethane	74-83-9	ND	2	ug/L	07/22/96
Carbon Tetrachloride	56-23-5	ND	0.5	ug/L	07/22/96
Chlorobenzene	108-90-7	ND	0.5	ug/L	07/22/96
Chloroethane	75-00-3	ND	2	ug/L	07/22/96
2-Chloroethyl Vinyl Ether	110-75-8	ND	0.5	ug/L	07/22/96
Chloroform	67-66-3	ND	0.5	ug/L	07/22/96
Chloromethane	74-87-3	ND	2	ug/L	07/22/96
Dibromochloromethane	124-48-1	ND	0.5	ug/L	07/22/96
1,2-Dichlorobenzene	95-50-1	ND	0.5	ug/L	07/22/96
1,3-Dichlorobenzene	541-73-1	ND	0.5	ug/L	07/22/96
1,4-Dichlorobenzene	106-46-7	ND	0.5	ug/L	07/22/96
Dichlorodifluoromethane	75-71-8	ND	2	ug/L	07/22/96
1,1-Dichloroethane	75-34-3	ND	0.5	ug/L	07/22/96
1,2-Dichloroethane	107-06-2	ND	0.5	ug/L	07/22/96
1,1-Dichloroethene	75-35-4	ND	0.5	ug/L	07/22/96
cis-1,2-Dichloroethene	156-59-2	ND	0.5	ug/L	07/22/96
trans-1,2-Dichloroethene	156-60-5	ND	0.5	ug/L	07/22/96
1,2-Dichloropropane	78-87-5	ND	0.5	ug/L	07/22/96
cis-1,3-Dichloropropene	10061-01-5	ND	0.5	ug/L	07/22/96
trans-1,3-Dichloropropene	10061-02-6	ND	0.5	ug/L	07/22/96
Methylene Chloride	75-09-2	ND	2	ug/L	07/22/96
1,1,2,2-Tetrachloroethane	79-34-5	ND	0.5	ug/L	07/22/96
Tetrachloroethene	127-18-4	ND	0.5	ug/L	07/22/96
1,1,1-Trichloroethane	71-55-6	ND	0.5	ug/L	07/22/96
1,1,2-Trichloroethane	79-00-5	ND	0.5	ug/L	07/22/96
Trichloroethene	79-01-6	0.7 *	0.5	ug/L	07/22/96
Trichlorofluoromethane	75-69-4	ND	2	ug/L	07/22/96
1,1,2Trichlorotrifluoroethane	76-13-1	ND	0.5	ug/L	07/22/96
Vinyl Chloride	75-01-4	ND	2	ug/L	07/22/96

Reporting limits elevated due to high levels of target compounds. Sample run at dilution.

ND = Not detected at or above the reporting limit

* = Value at or above reporting limit

PES ENVIRONMENTAL, INC.

SAMPLE ID: WGR-MW4
 AEN LAB NO: 9607225-03
 AEN WORK ORDER: 9607225
 CLIENT PROJ. ID: 502.0101.003

DATE SAMPLED: 07/17/96
 DATE RECEIVED: 07/18/96
 REPORT DATE: 07/29/96

ANALYTE	METHOD/ CAS#	RESULT	REPORTING LIMIT	UNITS	DATE ANALYZED
EPA 8010 - Water matrix	EPA 8010				
Bromodichloromethane	75-27-4	ND	0.5	ug/L	07/20/96
Bromoform	75-25-2	ND	0.5	ug/L	07/20/96
Bromomethane	74-83-9	ND	2	ug/L	07/20/96
Carbon Tetrachloride	56-23-5	ND	0.5	ug/L	07/20/96
Chlorobenzene	108-90-7	ND	0.5	ug/L	07/20/96
Chloroethane	75-00-3	ND	2	ug/L	07/20/96
2-Chloroethyl Vinyl Ether	110-75-8	ND	0.5	ug/L	07/20/96
Chloroform	67-66-3	ND	0.5	ug/L	07/20/96
Chloromethane	74-87-3	ND	2	ug/L	07/20/96
Dibromochloromethane	124-48-1	ND	0.5	ug/L	07/20/96
1,2-Dichlorobenzene	95-50-1	ND	0.5	ug/L	07/20/96
1,3-Dichlorobenzene	541-73-1	ND	0.5	ug/L	07/20/96
1,4-Dichlorobenzene	106-46-7	ND	0.5	ug/L	07/20/96
Dichlorodifluoromethane	75-71-8	ND	2	ug/L	07/20/96
1,1-Dichloroethane	75-34-3	ND	0.5	ug/L	07/20/96
1,2-Dichloroethane	107-06-2	ND	0.5	ug/L	07/20/96
1,1-Dichloroethene	75-35-4	ND	0.5	ug/L	07/20/96
cis-1,2-Dichloroethene	156-59-2	ND	0.5	ug/L	07/20/96
trans-1,2-Dichloroethene	156-60-5	ND	0.5	ug/L	07/20/96
1,2-Dichloropropane	78-87-5	ND	0.5	ug/L	07/20/96
cis-1,3-Dichloropropene	10061-01-5	ND	0.5	ug/L	07/20/96
trans-1,3-Dichloropropene	10061-02-6	ND	0.5	ug/L	07/20/96
Methylene Chloride	75-09-2	ND	2	ug/L	07/20/96
1,1,2,2-Tetrachloroethane	79-34-5	ND	0.5	ug/L	07/20/96
Tetrachloroethene	127-18-4	ND	0.5	ug/L	07/20/96
1,1,1-Trichloroethane	71-55-6	ND	0.5	ug/L	07/20/96
1,1,2-Trichloroethane	79-00-5	ND	0.5	ug/L	07/20/96
Trichloroethene	79-01-6	ND	0.5	ug/L	07/20/96
Trichlorofluoromethane	75-69-4	ND	2	ug/L	07/20/96
1,1,2Trichlorotrifluoroethane	76-13-1	ND	0.5	ug/L	07/20/96
Vinyl Chloride	75-01-4	ND	2	ug/L	07/20/96

ND = Not detected at or above the reporting limit

* = Value at or above reporting limit

PES ENVIRONMENTAL, INC.

SAMPLE ID: AMW1
 AEN LAB NO: 9607225-04
 AEN WORK ORDER: 9607225
 CLIENT PROJ. ID: 502.0101.003

DATE SAMPLED: 07/17/96
 DATE RECEIVED: 07/18/96
 REPORT DATE: 07/29/96

ANALYTE	METHOD/ CAS#	RESULT	REPORTING LIMIT	UNITS	DATE ANALYZED
EPA 8010 - Water matrix	EPA 8010				
Bromodichloromethane	75-27-4	ND	0.5	ug/L	07/20/96
Bromoform	75-25-2	ND	0.5	ug/L	07/20/96
Bromomethane	74-83-9	ND	2	ug/L	07/20/96
Carbon Tetrachloride	56-23-5	ND	0.5	ug/L	07/20/96
Chlorobenzene	108-90-7	ND	0.5	ug/L	07/20/96
Chloroethane	75-00-3	ND	2	ug/L	07/20/96
2-Chloroethyl Vinyl Ether	110-75-8	ND	0.5	ug/L	07/20/96
Chloroform	67-66-3	ND	0.5	ug/L	07/20/96
Chloromethane	74-87-3	ND	2	ug/L	07/20/96
Dibromochloromethane	124-48-1	ND	0.5	ug/L	07/20/96
1,2-Dichlorobenzene	95-50-1	ND	0.5	ug/L	07/20/96
1,3-Dichlorobenzene	541-73-1	ND	0.5	ug/L	07/20/96
1,4-Dichlorobenzene	106-46-7	ND	0.5	ug/L	07/20/96
Dichlorodifluoromethane	75-71-8	ND	2	ug/L	07/20/96
1,1-Dichloroethane	75-34-3	ND	0.5	ug/L	07/20/96
1,2-Dichloroethane	107-06-2	ND	0.5	ug/L	07/20/96
1,1-Dichloroethene	75-35-4	ND	0.5	ug/L	07/20/96
cis-1,2-Dichloroethene	156-59-2	ND	0.5	ug/L	07/20/96
trans-1,2-Dichloroethene	156-60-5	ND	0.5	ug/L	07/20/96
1,2-Dichloropropane	78-87-5	ND	0.5	ug/L	07/20/96
cis-1,3-Dichloropropene	10061-01-5	ND	0.5	ug/L	07/20/96
trans-1,3-Dichloropropene	10061-02-6	ND	0.5	ug/L	07/20/96
Methylene Chloride	75-09-2	ND	2	ug/L	07/20/96
1,1,2,2-Tetrachloroethane	79-34-5	ND	0.5	ug/L	07/20/96
Tetrachloroethene	127-18-4	ND	0.5	ug/L	07/20/96
1,1,1-Trichloroethane	71-55-6	ND	0.5	ug/L	07/20/96
1,1,2-Trichloroethane	79-00-5	ND	0.5	ug/L	07/20/96
Trichloroethene	79-01-6	ND	0.5	ug/L	07/20/96
Trichlorofluoromethane	75-69-4	ND	2	ug/L	07/20/96
1,1,2Trichlorotrifluoroethane	76-13-1	ND	0.5	ug/L	07/20/96
Vinyl Chloride	75-01-4	ND	2	ug/L	07/20/96

ND = Not detected at or above the reporting limit

* = Value at or above reporting limit

PES ENVIRONMENTAL, INC.

SAMPLE ID: AMW4
 AEN LAB NO: 9607225-05
 AEN WORK ORDER: 9607225
 CLIENT PROJ. ID: 502.0101.003

DATE SAMPLED: 07/17/96
 DATE RECEIVED: 07/18/96
 REPORT DATE: 07/29/96

ANALYTE	METHOD/ CAS#	RESULT	REPORTING LIMIT	UNITS	DATE ANALYZED
EPA 8010 - Water matrix	EPA 8010				
Bromodichloromethane	75-27-4	ND	10	ug/L	07/24/96
Bromoform	75-25-2	ND	10	ug/L	07/24/96
Bromomethane	74-83-9	ND	40	ug/L	07/24/96
Carbon Tetrachloride	56-23-5	ND	10	ug/L	07/24/96
Chlorobenzene	108-90-7	ND	10	ug/L	07/24/96
Chloroethane	75-00-3	ND	40	ug/L	07/24/96
2-Chloroethyl Vinyl Ether	110-75-8	ND	10	ug/L	07/24/96
Chloroform	67-66-3	ND	10	ug/L	07/24/96
Chloromethane	74-87-3	ND	40	ug/L	07/24/96
Dibromochloromethane	124-48-1	ND	10	ug/L	07/24/96
1,2-Dichlorobenzene	95-50-1	ND	10	ug/L	07/24/96
1,3-Dichlorobenzene	541-73-1	ND	10	ug/L	07/24/96
1,4-Dichlorobenzene	106-46-7	ND	10	ug/L	07/24/96
Dichlorodifluoromethane	75-71-8	ND	40	ug/L	07/24/96
1,1-Dichloroethane	75-34-3	ND	10	ug/L	07/24/96
1,2-Dichloroethane	107-06-2	ND	10	ug/L	07/24/96
1,1-Dichloroethene	75-35-4	ND	10	ug/L	07/24/96
cis-1,2-Dichloroethene	156-59-2	ND	10	ug/L	07/24/96
trans-1,2-Dichloroethene	156-60-5	ND	10	ug/L	07/24/96
1,2-Dichloropropane	78-87-5	ND	10	ug/L	07/24/96
cis-1,3-Dichloropropene	10061-01-5	ND	10	ug/L	07/24/96
trans-1,3-Dichloropropene	10061-02-6	ND	10	ug/L	07/24/96
Methylene Chloride	75-09-2	ND	40	ug/L	07/24/96
1,1,2,2-Tetrachloroethane	79-34-5	ND	10	ug/L	07/24/96
Tetrachloroethene	127-18-4	860 *	10	ug/L	07/24/96
1,1,1-Trichloroethane	71-55-6	ND	10	ug/L	07/24/96
1,1,2-Trichloroethane	79-00-5	ND	10	ug/L	07/24/96
Trichloroethene	79-01-6	ND	10	ug/L	07/24/96
Trichlorofluoromethane	75-69-4	ND	40	ug/L	07/24/96
1,1,2Trichlorotrifluoroethane	76-13-1	ND	10	ug/L	07/24/96
Vinyl Chloride	75-01-4	ND	40	ug/L	07/24/96

Reporting limits elevated due to high levels of target compounds. Sample run at dilution.

ND = Not detected at or above the reporting limit

* = Value at or above reporting limit

PES ENVIRONMENTAL, INC.

SAMPLE ID: AMW5
 AEN LAB NO: 9607225-06
 AEN WORK ORDER: 9607225
 CLIENT PROJ. ID: 502.0101.003

DATE SAMPLED: 07/17/96
 DATE RECEIVED: 07/18/96
 REPORT DATE: 07/29/96

ANALYTE	METHOD/ CAS#	RESULT	REPORTING LIMIT	UNITS	DATE ANALYZED
EPA 8010 - Water matrix	EPA 8010				
Bromodichloromethane	75-27-4	ND	0.5	ug/L	07/22/96
Bromoform	75-25-2	ND	0.5	ug/L	07/22/96
Bromomethane	74-83-9	ND	2	ug/L	07/22/96
Carbon Tetrachloride	56-23-5	ND	0.5	ug/L	07/22/96
Chlorobenzene	108-90-7	ND	0.5	ug/L	07/22/96
Chloroethane	75-00-3	ND	2	ug/L	07/22/96
2-Chloroethyl Vinyl Ether	110-75-8	ND	0.5	ug/L	07/22/96
Chloroform	67-66-3	ND	0.5	ug/L	07/22/96
Chloromethane	74-87-3	ND	2	ug/L	07/22/96
Dibromochloromethane	124-48-1	ND	0.5	ug/L	07/22/96
1,2-Dichlorobenzene	95-50-1	ND	0.5	ug/L	07/22/96
1,3-Dichlorobenzene	541-73-1	ND	0.5	ug/L	07/22/96
1,4-Dichlorobenzene	106-46-7	ND	0.5	ug/L	07/22/96
Dichlorodifluoromethane	75-71-8	ND	2	ug/L	07/22/96
1,1-Dichloroethane	75-34-3	ND	0.5	ug/L	07/22/96
1,2-Dichloroethane	107-06-2	ND	0.5	ug/L	07/22/96
1,1-Dichloroethene	75-35-4	ND	0.5	ug/L	07/22/96
cis-1,2-Dichloroethene	156-59-2	ND	0.5	ug/L	07/22/96
trans-1,2-Dichloroethene	156-60-5	ND	0.5	ug/L	07/22/96
1,2-Dichloropropane	78-87-5	ND	0.5	ug/L	07/22/96
cis-1,3-Dichloropropene	10061-01-5	ND	0.5	ug/L	07/22/96
trans-1,3-Dichloropropene	10061-02-6	ND	0.5	ug/L	07/22/96
Methylene Chloride	75-09-2	ND	2	ug/L	07/22/96
1,1,2,2-Tetrachloroethane	79-34-5	ND	0.5	ug/L	07/22/96
Tetrachloroethene	127-18-4	0.6 *	0.5	ug/L	07/22/96
1,1,1-Trichloroethane	71-55-6	ND	0.5	ug/L	07/22/96
1,1,2-Trichloroethane	79-00-5	ND	0.5	ug/L	07/22/96
Trichloroethene	79-01-6	ND	0.5	ug/L	07/22/96
Trichlorofluoromethane	75-69-4	ND	2	ug/L	07/22/96
1,1,2Trichlorotrifluoroethane	76-13-1	ND	0.5	ug/L	07/22/96
Vinyl Chloride	75-01-4	ND	2	ug/L	07/22/96

ND = Not detected at or above the reporting limit

* = Value at or above reporting limit

PES ENVIRONMENTAL, INC.

SAMPLE ID: AMW6
 AEN LAB NO: 9607225-07
 AEN WORK ORDER: 9607225
 CLIENT PROJ. ID: 502.0101.003

DATE SAMPLED: 07/17/96
 DATE RECEIVED: 07/18/96
 REPORT DATE: 07/29/96

ANALYTE	METHOD/ CAS#	RESULT	REPORTING LIMIT	UNITS	DATE ANALYZED
EPA 8010 - Water matrix	EPA 8010				
Bromodichloromethane	75-27-4	ND	30	ug/L	07/24/96
Bromoform	75-25-2	ND	30	ug/L	07/24/96
Bromomethane	74-83-9	ND	100	ug/L	07/24/96
Carbon Tetrachloride	56-23-5	ND	30	ug/L	07/24/96
Chlorobenzene	108-90-7	ND	30	ug/L	07/24/96
Chloroethane	75-00-3	ND	100	ug/L	07/24/96
2-Chloroethyl Vinyl Ether	110-75-8	ND	30	ug/L	07/24/96
Chloroform	67-66-3	ND	30	ug/L	07/24/96
Chloromethane	74-87-3	ND	100	ug/L	07/24/96
Dibromochloromethane	124-48-1	ND	30	ug/L	07/24/96
1,2-Dichlorobenzene	95-50-1	ND	30	ug/L	07/24/96
1,3-Dichlorobenzene	541-73-1	ND	30	ug/L	07/24/96
1,4-Dichlorobenzene	106-46-7	ND	30	ug/L	07/24/96
Dichlorodifluoromethane	75-71-8	ND	100	ug/L	07/24/96
1,1-Dichloroethane	75-34-3	ND	30	ug/L	07/24/96
1,2-Dichloroethane	107-06-2	ND	30	ug/L	07/24/96
1,1-Dichloroethene	75-35-4	ND	30	ug/L	07/24/96
cis-1,2-Dichloroethene	156-59-2	ND	30	ug/L	07/24/96
trans-1,2-Dichloroethene	156-60-5	ND	30	ug/L	07/24/96
1,2-Dichloropropane	78-87-5	ND	30	ug/L	07/24/96
cis-1,3-Dichloropropene	10061-01-5	ND	30	ug/L	07/24/96
trans-1,3-Dichloropropene	10061-02-6	ND	30	ug/L	07/24/96
Methylene Chloride	75-09-2	ND	100	ug/L	07/24/96
1,1,2,2-Tetrachloroethane	79-34-5	ND	30	ug/L	07/24/96
Tetrachloroethene	127-18-4	3,300 *	30	ug/L	07/24/96
1,1,1-Trichloroethane	71-55-6	ND	30	ug/L	07/24/96
1,1,2-Trichloroethane	79-00-5	ND	30	ug/L	07/24/96
Trichloroethene	79-01-6	280 *	30	ug/L	07/24/96
Trichlorofluoromethane	75-69-4	ND	100	ug/L	07/24/96
1,1,2Trichlorotrifluoroethane	76-13-1	ND	30	ug/L	07/24/96
Vinyl Chloride	75-01-4	ND	100	ug/L	07/24/96

Reporting limits elevated due to high levels of target compounds. Sample run at dilution.

ND = Not detected at or above the reporting limit

* = Value at or above reporting limit

PES ENVIRONMENTAL, INC.

SAMPLE ID: AMW7
 AEN LAB NO: 9607225-08
 AEN WORK ORDER: 9607225
 CLIENT PROJ. ID: 502.0101.003

DATE SAMPLED: 07/17/96
 DATE RECEIVED: 07/18/96
 REPORT DATE: 07/29/96

ANALYTE	METHOD/ CAS#	RESULT	REPORTING LIMIT	UNITS	DATE ANALYZED
EPA 8010 - Water matrix	EPA 8010				
Bromodichloromethane	75-27-4	ND	30	ug/L	07/24/96
Bromoform	75-25-2	ND	30	ug/L	07/24/96
Bromomethane	74-83-9	ND	100	ug/L	07/24/96
Carbon Tetrachloride	56-23-5	ND	30	ug/L	07/24/96
Chlorobenzene	108-90-7	ND	30	ug/L	07/24/96
Chloroethane	75-00-3	ND	100	ug/L	07/24/96
2-Chloroethyl Vinyl Ether	110-75-8	ND	30	ug/L	07/24/96
Chloroform	67-66-3	ND	30	ug/L	07/24/96
Chloromethane	74-87-3	ND	100	ug/L	07/24/96
Dibromochloromethane	124-48-1	ND	30	ug/L	07/24/96
1,2-Dichlorobenzene	95-50-1	ND	30	ug/L	07/24/96
1,3-Dichlorobenzene	541-73-1	ND	30	ug/L	07/24/96
1,4-Dichlorobenzene	106-46-7	ND	30	ug/L	07/24/96
Dichlorodifluoromethane	75-71-8	ND	100	ug/L	07/24/96
1,1-Dichloroethane	75-34-3	ND	30	ug/L	07/24/96
1,2-Dichloroethane	107-06-2	ND	30	ug/L	07/24/96
1,1-Dichloroethene	75-35-4	ND	30	ug/L	07/24/96
cis-1,2-Dichloroethene	156-59-2	2,100 *	30	ug/L	07/24/96
trans-1,2-Dichloroethene	156-60-5	ND	30	ug/L	07/24/96
1,2-Dichloropropane	78-87-5	ND	30	ug/L	07/24/96
cis-1,3-Dichloropropene	10061-01-5	ND	30	ug/L	07/24/96
trans-1,3-Dichloropropene	10061-02-6	ND	30	ug/L	07/24/96
Methylene Chloride	75-09-2	ND	100	ug/L	07/24/96
1,1,2,2-Tetrachloroethane	79-34-5	ND	30	ug/L	07/24/96
Tetrachloroethene	127-18-4	2,400 *	30	ug/L	07/24/96
1,1,1-Trichloroethane	71-55-6	ND	30	ug/L	07/24/96
1,1,2-Trichloroethane	79-00-5	ND	30	ug/L	07/24/96
Trichloroethene	79-01-6	530 *	30	ug/L	07/24/96
Trichlorofluoromethane	75-69-4	ND	100	ug/L	07/24/96
1,1,2Trichlorotrifluoroethane	76-13-1	ND	30	ug/L	07/24/96
Vinyl Chloride	75-01-4	ND	100	ug/L	07/24/96

Reporting limits elevated due to high levels of target compounds. Sample run at dilution.

ND = Not detected at or above the reporting limit
 * = Value at or above reporting limit

PES ENVIRONMENTAL, INC.

SAMPLE ID: AMW8
 AEN LAB NO: 9607225-09
 AEN WORK ORDER: 9607225
 CLIENT PROJ. ID: 502.0101.003

DATE SAMPLED: 07/17/96
 DATE RECEIVED: 07/18/96
 REPORT DATE: 07/29/96

ANALYTE	METHOD/ CAS#	RESULT	REPORTING LIMIT	UNITS	DATE ANALYZED
EPA 8010 - Water matrix	EPA 8010				
Bromodichloromethane	75-27-4	ND	0.5	ug/L	07/22/96
Bromoform	75-25-2	ND	0.5	ug/L	07/22/96
Bromomethane	74-83-9	ND	2	ug/L	07/22/96
Carbon Tetrachloride	56-23-5	ND	0.5	ug/L	07/22/96
Chlorobenzene	108-90-7	ND	0.5	ug/L	07/22/96
Chloroethane	75-00-3	ND	2	ug/L	07/22/96
2-Chloroethyl Vinyl Ether	110-75-8	ND	0.5	ug/L	07/22/96
Chloroform	67-66-3	ND	0.5	ug/L	07/22/96
Chloromethane	74-87-3	ND	2	ug/L	07/22/96
Dibromochloromethane	124-48-1	ND	0.5	ug/L	07/22/96
1,2-Dichlorobenzene	95-50-1	ND	0.5	ug/L	07/22/96
1,3-Dichlorobenzene	541-73-1	ND	0.5	ug/L	07/22/96
1,4-Dichlorobenzene	106-46-7	ND	0.5	ug/L	07/22/96
Dichlorodifluoromethane	75-71-8	ND	2	ug/L	07/22/96
1,1-Dichloroethane	75-34-3	ND	0.5	ug/L	07/22/96
1,2-Dichloroethane	107-06-2	ND	0.5	ug/L	07/22/96
1,1-Dichloroethene	75-35-4	ND	0.5	ug/L	07/22/96
cis-1,2-Dichloroethene	156-59-2	ND	0.5	ug/L	07/22/96
trans-1,2-Dichloroethene	156-60-5	ND	0.5	ug/L	07/22/96
1,2-Dichloropropane	78-87-5	ND	0.5	ug/L	07/22/96
cis-1,3-Dichloropropene	10061-01-5	ND	0.5	ug/L	07/22/96
trans-1,3-Dichloropropene	10061-02-6	ND	0.5	ug/L	07/22/96
Methylene Chloride	75-09-2	ND	2	ug/L	07/22/96
1,1,2,2-Tetrachloroethane	79-34-5	ND	0.5	ug/L	07/22/96
Tetrachloroethene	127-18-4	1.6 *	0.5	ug/L	07/22/96
1,1,1-Trichloroethane	71-55-6	ND	0.5	ug/L	07/22/96
1,1,2-Trichloroethane	79-00-5	ND	0.5	ug/L	07/22/96
Trichloroethene	79-01-6	ND	0.5	ug/L	07/22/96
Trichlorofluoromethane	75-69-4	ND	2	ug/L	07/22/96
1,1,2Trichlorotrifluoroethane	76-13-1	ND	0.5	ug/L	07/22/96
Vinyl Chloride	75-01-4	ND	2	ug/L	07/22/96

ND = Not detected at or above the reporting limit

* = Value at or above reporting limit

PES ENVIRONMENTAL, INC.

SAMPLE ID: AMW9
 AEN LAB NO: 9607225-10
 AEN WORK ORDER: 9607225
 CLIENT PROJ. ID: 502.0101.003

DATE SAMPLED: 07/17/96
 DATE RECEIVED: 07/18/96
 REPORT DATE: 07/29/96

ANALYTE	METHOD/ CAS#	RESULT	REPORTING LIMIT	UNITS	DATE ANALYZED
EPA 8010 - Water matrix	EPA 8010				
Bromodichloromethane	75-27-4	ND	3	ug/L	07/24/96
Bromoform	75-25-2	ND	3	ug/L	07/24/96
Bromomethane	74-83-9	ND	10	ug/L	07/24/96
Carbon Tetrachloride	56-23-5	ND	3	ug/L	07/24/96
Chlorobenzene	108-90-7	ND	3	ug/L	07/24/96
Chloroethane	75-00-3	ND	10	ug/L	07/24/96
2-Chloroethyl Vinyl Ether	110-75-8	ND	3	ug/L	07/24/96
Chloroform	67-66-3	ND	3	ug/L	07/24/96
Chloromethane	74-87-3	ND	10	ug/L	07/24/96
Dibromochloromethane	124-48-1	ND	3	ug/L	07/24/96
1,2-Dichlorobenzene	95-50-1	ND	3	ug/L	07/24/96
1,3-Dichlorobenzene	541-73-1	ND	3	ug/L	07/24/96
1,4-Dichlorobenzene	106-46-7	ND	3	ug/L	07/24/96
Dichlorodifluoromethane	75-71-8	ND	10	ug/L	07/24/96
1,1-Dichloroethane	75-34-3	ND	3	ug/L	07/24/96
1,2-Dichloroethane	107-06-2	ND	3	ug/L	07/24/96
1,1-Dichloroethene	75-35-4	ND	3	ug/L	07/24/96
cis-1,2-Dichloroethene	156-59-2	ND	3	ug/L	07/24/96
trans-1,2-Dichloroethene	156-60-5	ND	3	ug/L	07/24/96
1,2-Dichloropropane	78-87-5	ND	3	ug/L	07/24/96
cis-1,3-Dichloropropene	10061-01-5	ND	3	ug/L	07/24/96
trans-1,3-Dichloropropene	10061-02-6	ND	3	ug/L	07/24/96
Methylene Chloride	75-09-2	ND	10	ug/L	07/24/96
1,1,2,2-Tetrachloroethane	79-34-5	ND	3	ug/L	07/24/96
Tetrachloroethene	127-18-4	190 *	3	ug/L	07/24/96
1,1,1-Trichloroethane	71-55-6	ND	3	ug/L	07/24/96
1,1,2-Trichloroethane	79-00-5	ND	3	ug/L	07/24/96
Trichloroethene	79-01-6	ND	3	ug/L	07/24/96
Trichlorofluoromethane	75-69-4	ND	10	ug/L	07/24/96
1,1,2Trichlorotrifluoroethane	76-13-1	ND	3	ug/L	07/24/96
Vinyl Chloride	75-01-4	ND	10	ug/L	07/24/96

Reporting limits elevated due to high levels of target compounds. Sample run at dilution.

ND = Not detected at or above the reporting limit
 * = Value at or above reporting limit

PES ENVIRONMENTAL, INC.

SAMPLE ID: MW6
 AEN LAB NO: 9607225-11
 AEN WORK ORDER: 9607225
 CLIENT PROJ. ID: 502.0101.003

DATE SAMPLED: 07/17/96
 DATE RECEIVED: 07/18/96
 REPORT DATE: 07/29/96

ANALYTE	METHOD/ CAS#	RESULT	REPORTING LIMIT	UNITS	DATE ANALYZED
EPA 8010 - Water matrix	EPA 8010				
Bromodichloromethane	75-27-4	ND	5	ug/L	07/24/96
Bromoform	75-25-2	ND	5	ug/L	07/24/96
Bromomethane	74-83-9	ND	20	ug/L	07/24/96
Carbon Tetrachloride	56-23-5	ND	5	ug/L	07/24/96
Chlorobenzene	108-90-7	ND	5	ug/L	07/24/96
Chloroethane	75-00-3	ND	20	ug/L	07/24/96
2-Chloroethyl Vinyl Ether	110-75-8	ND	5	ug/L	07/24/96
Chloroform	67-66-3	ND	5	ug/L	07/24/96
Chloromethane	74-87-3	ND	20	ug/L	07/24/96
Dibromochloromethane	124-48-1	ND	5	ug/L	07/24/96
1,2-Dichlorobenzene	95-50-1	ND	5	ug/L	07/24/96
1,3-Dichlorobenzene	541-73-1	ND	5	ug/L	07/24/96
1,4-Dichlorobenzene	106-46-7	ND	5	ug/L	07/24/96
Dichlorodifluoromethane	75-71-8	30 *	20	ug/L	07/24/96
1,1-Dichloroethane	75-34-3	ND	5	ug/L	07/24/96
1,2-Dichloroethane	107-06-2	ND	5	ug/L	07/24/96
1,1-Dichloroethene	75-35-4	ND	5	ug/L	07/24/96
cis-1,2-Dichloroethene	156-59-2	ND	5	ug/L	07/24/96
trans-1,2-Dichloroethene	156-60-5	ND	5	ug/L	07/24/96
1,2-Dichloropropane	78-87-5	ND	5	ug/L	07/24/96
cis-1,3-Dichloropropene	10061-01-5	ND	5	ug/L	07/24/96
trans-1,3-Dichloropropene	10061-02-6	ND	5	ug/L	07/24/96
Methylene Chloride	75-09-2	ND	20	ug/L	07/24/96
1,1,2,2-Tetrachloroethane	79-34-5	ND	5	ug/L	07/24/96
Tetrachloroethene	127-18-4	590 *	5	ug/L	07/24/96
1,1,1-Trichloroethane	71-55-6	ND	5	ug/L	07/24/96
1,1,2-Trichloroethane	79-00-5	ND	5	ug/L	07/24/96
Trichloroethene	79-01-6	ND	5	ug/L	07/24/96
Trichlorofluoromethane	75-69-4	ND	20	ug/L	07/24/96
1,1,2Trichlorotrifluoroethane	76-13-1	ND	5	ug/L	07/24/96
Vinyl Chloride	75-01-4	ND	20	ug/L	07/24/96

Reporting limits elevated due to high levels of target compounds. Sample run at dilution.

ND = Not detected at or above the reporting limit
 * = Value at or above reporting limit

PES ENVIRONMENTAL, INC.

SAMPLE ID: MW7
 AEN LAB NO: 9607225-12
 AEN WORK ORDER: 9607225
 CLIENT PROJ. ID: 502.0101.003

DATE SAMPLED: 07/17/96
 DATE RECEIVED: 07/18/96
 REPORT DATE: 07/29/96

ANALYTE	METHOD/ CAS#	RESULT	REPORTING LIMIT	UNITS	DATE ANALYZED
EPA 8010 - Water matrix	EPA 8010				
Bromodichloromethane	75-27-4	ND	0.5	ug/L	07/22/96
Bromoform	75-25-2	ND	0.5	ug/L	07/22/96
Bromomethane	74-83-9	ND	2	ug/L	07/22/96
Carbon Tetrachloride	56-23-5	ND	0.5	ug/L	07/22/96
Chlorobenzene	108-90-7	ND	0.5	ug/L	07/22/96
Chloroethane	75-00-3	ND	2	ug/L	07/22/96
2-Chloroethyl Vinyl Ether	110-75-8	ND	0.5	ug/L	07/22/96
Chloroform	67-66-3	ND	0.5	ug/L	07/22/96
Chloromethane	74-87-3	ND	2	ug/L	07/22/96
Dibromochloromethane	124-48-1	ND	0.5	ug/L	07/22/96
1,2-Dichlorobenzene	95-50-1	ND	0.5	ug/L	07/22/96
1,3-Dichlorobenzene	541-73-1	ND	0.5	ug/L	07/22/96
1,4-Dichlorobenzene	106-46-7	ND	0.5	ug/L	07/22/96
Dichlorodifluoromethane	75-71-8	ND	2	ug/L	07/22/96
1,1-Dichloroethane	75-34-3	ND	0.5	ug/L	07/22/96
1,2-Dichloroethane	107-06-2	ND	0.5	ug/L	07/22/96
1,1-Dichloroethene	75-35-4	ND	0.5	ug/L	07/22/96
cis-1,2-Dichloroethene	156-59-2	0.6 *	0.5	ug/L	07/22/96
trans-1,2-Dichloroethene	156-60-5	ND	0.5	ug/L	07/22/96
1,2-Dichloropropane	78-87-5	ND	0.5	ug/L	07/22/96
cis-1,3-Dichloropropene	10061-01-5	ND	0.5	ug/L	07/22/96
trans-1,3-Dichloropropene	10061-02-6	ND	0.5	ug/L	07/22/96
Methylene Chloride	75-09-2	ND	2	ug/L	07/22/96
1,1,2,2-Tetrachloroethane	79-34-5	ND	0.5	ug/L	07/22/96
Tetrachloroethene	127-18-4	ND	0.5	ug/L	07/22/96
1,1,1-Trichloroethane	71-55-6	ND	0.5	ug/L	07/22/96
1,1,2-Trichloroethane	79-00-5	ND	0.5	ug/L	07/22/96
Trichloroethene	79-01-6	0.6 *	0.5	ug/L	07/22/96
Trichlorofluoromethane	75-69-4	ND	2	ug/L	07/22/96
1,1,2Trichlorotrifluoroethane	76-13-1	ND	0.5	ug/L	07/22/96
Vinyl Chloride	75-01-4	ND	2	ug/L	07/22/96

ND = Not detected at or above the reporting limit

* = Value at or above reporting limit

PES ENVIRONMENTAL, INC.

SAMPLE ID: EB
 AEN LAB NO: 9607225-13
 AEN WORK ORDER: 9607225
 CLIENT PROJ. ID: 502.0101.003

DATE SAMPLED: 07/17/96
 DATE RECEIVED: 07/18/96
 REPORT DATE: 07/29/96

ANALYTE	METHOD/ CAS#	RESULT	REPORTING LIMIT	UNITS	DATE ANALYZED
EPA 8010 - Water matrix	EPA 8010				
Bromodichloromethane	75-27-4	ND	0.5	ug/L	07/22/96
Bromoform	75-25-2	ND	0.5	ug/L	07/22/96
Bromomethane	74-83-9	ND	2	ug/L	07/22/96
Carbon Tetrachloride	56-23-5	ND	0.5	ug/L	07/22/96
Chlorobenzene	108-90-7	ND	0.5	ug/L	07/22/96
Chloroethane	75-00-3	ND	2	ug/L	07/22/96
2-Chloroethyl Vinyl Ether	110-75-8	ND	0.5	ug/L	07/22/96
Chloroform	67-66-3	ND	0.5	ug/L	07/22/96
Chloromethane	74-87-3	ND	2	ug/L	07/22/96
Dibromochloromethane	124-48-1	ND	0.5	ug/L	07/22/96
1,2-Dichlorobenzene	95-50-1	ND	0.5	ug/L	07/22/96
1,3-Dichlorobenzene	541-73-1	ND	0.5	ug/L	07/22/96
1,4-Dichlorobenzene	106-46-7	ND	0.5	ug/L	07/22/96
Dichlorodifluoromethane	75-71-8	ND	2	ug/L	07/22/96
1,1-Dichloroethane	75-34-3	ND	0.5	ug/L	07/22/96
1,2-Dichloroethane	107-06-2	ND	0.5	ug/L	07/22/96
1,1-Dichloroethene	75-35-4	ND	0.5	ug/L	07/22/96
cis-1,2-Dichloroethene	156-59-2	ND	0.5	ug/L	07/22/96
trans-1,2-Dichloroethene	156-60-5	ND	0.5	ug/L	07/22/96
1,2-Dichloropropane	78-87-5	ND	0.5	ug/L	07/22/96
cis-1,3-Dichloropropene	10061-01-5	ND	0.5	ug/L	07/22/96
trans-1,3-Dichloropropene	10061-02-6	ND	0.5	ug/L	07/22/96
Methylene Chloride	75-09-2	ND	2	ug/L	07/22/96
1,1,2,2-Tetrachloroethane	79-34-5	ND	0.5	ug/L	07/22/96
Tetrachloroethene	127-18-4	ND	0.5	ug/L	07/22/96
1,1,1-Trichloroethane	71-55-6	ND	0.5	ug/L	07/22/96
1,1,2-Trichloroethane	79-00-5	ND	0.5	ug/L	07/22/96
Trichloroethene	79-01-6	ND	0.5	ug/L	07/22/96
Trichlorofluoromethane	75-69-4	ND	2	ug/L	07/22/96
1,1,2Trichlorotrifluoroethane	76-13-1	ND	0.5	ug/L	07/22/96
Vinyl Chloride	75-01-4	ND	2	ug/L	07/22/96

ND = Not detected at or above the reporting limit

* = Value at or above reporting limit

PES ENVIRONMENTAL, INC.

SAMPLE ID: TB
 AEN LAB NO: 9607225-14
 AEN WORK ORDER: 9607225
 CLIENT PROJ. ID: 502.0101.003

DATE SAMPLED: 07/18/96
 DATE RECEIVED: 07/18/96
 REPORT DATE: 07/29/96

ANALYTE	METHOD/ CAS#	RESULT	REPORTING LIMIT	UNITS	DATE ANALYZED
EPA 8010 - Water matrix	EPA 8010				
Bromodichloromethane	75-27-4	ND	0.5	ug/L	07/20/96
Bromoform	75-25-2	ND	0.5	ug/L	07/20/96
Bromomethane	74-83-9	ND	2	ug/L	07/20/96
Carbon Tetrachloride	56-23-5	ND	0.5	ug/L	07/20/96
Chlorobenzene	108-90-7	ND	0.5	ug/L	07/20/96
Chloroethane	75-00-3	ND	2	ug/L	07/20/96
2-Chloroethyl Vinyl Ether	110-75-8	ND	0.5	ug/L	07/20/96
Chloroform	67-66-3	ND	0.5	ug/L	07/20/96
Chloromethane	74-87-3	ND	2	ug/L	07/20/96
Dibromochloromethane	124-48-1	ND	0.5	ug/L	07/20/96
1,2-Dichlorobenzene	95-50-1	ND	0.5	ug/L	07/20/96
1,3-Dichlorobenzene	541-73-1	ND	0.5	ug/L	07/20/96
1,4-Dichlorobenzene	106-46-7	ND	0.5	ug/L	07/20/96
Dichlorodifluoromethane	75-71-8	ND	2	ug/L	07/20/96
1,1-Dichloroethane	75-34-3	ND	0.5	ug/L	07/20/96
1,2-Dichloroethane	107-06-2	ND	0.5	ug/L	07/20/96
1,1-Dichloroethene	75-35-4	ND	0.5	ug/L	07/20/96
cis-1,2-Dichloroethene	156-59-2	ND	0.5	ug/L	07/20/96
trans-1,2-Dichloroethene	156-60-5	ND	0.5	ug/L	07/20/96
1,2-Dichloropropane	78-87-5	ND	0.5	ug/L	07/20/96
cis-1,3-Dichloropropene	10061-01-5	ND	0.5	ug/L	07/20/96
trans-1,3-Dichloropropene	10061-02-6	ND	0.5	ug/L	07/20/96
Methylene Chloride	75-09-2	ND	2	ug/L	07/20/96
1,1,2,2-Tetrachloroethane	79-34-5	ND	0.5	ug/L	07/20/96
Tetrachloroethene	127-18-4	ND	0.5	ug/L	07/20/96
1,1,1-Trichloroethane	71-55-6	ND	0.5	ug/L	07/20/96
1,1,2-Trichloroethane	79-00-5	ND	0.5	ug/L	07/20/96
Trichloroethene	79-01-6	ND	0.5	ug/L	07/20/96
Trichlorofluoromethane	75-69-4	ND	2	ug/L	07/20/96
1,1,2Trichlorotrifluoroethane	76-13-1	ND	0.5	ug/L	07/20/96
Vinyl Chloride	75-01-4	ND	2	ug/L	07/20/96

ND = Not detected at or above the reporting limit
 * = Value at or above reporting limit

AEN (CALIFORNIA)
QUALITY CONTROL REPORT

AEN JOB NUMBER: 9507225

CLIENT PROJECT ID: 502.0101.003

Quality Control and Project Summary

All laboratory quality control parameters were found to be within established limits.

Definitions

Laboratory Control Sample (LCS)/Method Spike(s): Control samples of known composition. LCS and Method Spike data are used to validate batch analytical results.

Matrix Spike(s): Aliquot of a sample (aqueous or solid) with added quantities of specific compounds and subjected to the entire analytical procedure. Matrix spike and matrix spike duplicate QC data are advisory.

Method Blank: An analytical control consisting of all reagents, internal standards, and surrogate standards carried through the entire analytical process. Used to monitor laboratory background and reagent contamination.

Not Detected (ND): Not detected at or above the reporting limit.

Relative Percent Difference (RPD): An indication of method precision based on duplicate analysis.

Reporting Limit (RL): The lowest concentration routinely determined during laboratory operations. The RL is generally 1 to 10 times the Method Detection Limit (MDL). Reporting limits are matrix, method, and analyte dependent and take into account any dilutions performed as part of the analysis.

Surrogates: Organic compounds which are similar to analytes of interest in chemical behavior, but are not found in environmental samples. Surrogates are added to all blanks, calibration and check standards, samples, and spiked samples. Surrogate recovery is monitored as an indication of acceptable sample preparation and instrumental performance.

D: Surrogates diluted out.

#: Indicates result outside of established laboratory QC limits.

QUALITY CONTROL DATA

METHOD: EPA 8010

AEN JOB NO: 9507225
INSTRUMENT: G. I.
MATRIX: WATER

Surrogate Standard Recovery Summary

Date Analyzed	Client Id.	Lab Id.	Percent Recovery	
			Bromochloro-methane	1-Bromo-3-chloro-propane
07/20/96	WGR-MW2	01	79	88
07/22/96	WGR-MW3	02	88	87
07/20/96	WGR-MW4	03	77	87
07/20/96	AMW1	04	78	87
07/24/96	AMW4	05	73	87
07/22/96	AMW5	06	84	81
07/24/96	AMW6	07	83	90
07/24/96	AMW7	08	95	91
07/22/96	AMW8	09	82	87
07/24/96	AMW9	10	88	103
07/24/96	MW6	11	84	93
07/22/96	MW7	12	92	84
07/22/96	EB	13	92	86
07/20/96	TB	14	72	82
QC Limits:			70-130	70-130

CONDUCT ANALYSIS TO DETECT

LAB AEN 9607225 DHS # _____

ALL ANALYSES MUST MEET SPECIFICATIONS AND DETECTION LIMITS SET BY CALIFORNIA DHS AND

- EPA
- LIA
- OTHER
- RWQCB REGION _____

CHAIN OF CUSTODY
 CLIENT PES ENVIRONMENTAL
 SITE FOOTBALL SQUARE SHOPPING CENTER
16700 MACARTHUR BLVD.
OAKLAND, CA.

C - COMPOSITE ALL CONTAINERS

SPECIAL INSTRUCTIONS INVOICE & Report
to PES ENVIRONMENTAL.
ATTN: JENNY HAN
Project #: 502.0101.003

SAMPLE I.D.	MATRIX		TOTAL	CONTAINERS	C - COMPOSITE ALL CONTAINERS	ADD'L INFORMATION	STATUS	CONDITION	LAB SAMPLE #
	S - SOIL	W - H2O							
<u>UBR-MW2 1035</u>	<u>W</u>	<u>W</u>	<u>3</u>		<u>XXXX</u>				<u>01AC</u>
<u>UBR-MW3 830</u>					<u>XXXX</u>				<u>02AC</u>
<u>UBR-MW4 1055</u>					<u>XXXX</u>				<u>03AC</u>
<u>AMW1 1015</u>					<u>XXXX</u>				<u>04AC</u>
<u>AMW4 1225</u>					<u>XXXX</u>				<u>05AC</u>
<u>AMW5 1210</u>					<u>XXXX</u>				<u>06AC</u>
<u>AMW6 950</u>					<u>XXXX</u>				<u>07AC</u>
<u>AMW7 1145</u>					<u>XXXX</u>				<u>08AC</u>
<u>AMW8 925</u>					<u>XXXX</u>				<u>09AC</u>
<u>AMW9 1125</u>					<u>XXXX</u>				<u>10A-C</u>

SAMPLING COMPLETED	DATE	TIME	SAMPLING PERFORMED BY	RESULTS NEEDED NO LATER THAN	
	<u>7/17/96</u>	<u>1300</u>	<u>Keith Brown</u>	<u>Standard TAT</u>	
RELEASED BY	DATE	TIME	RECEIVED BY	DATE	TIME
<u>[Signature]</u>	<u>7/18/96</u>	<u>1420</u>	<u>[Signature]</u>	<u>7/18/96</u>	<u>1420</u>
RELEASED BY	DATE	TIME	RECEIVED BY	DATE	TIME
<u>[Signature]</u>	<u>7/18/96</u>	<u>1600</u>	<u>[Signature]</u>	<u>7-18-96</u>	<u>1600</u>
RELEASED BY	DATE	TIME	RECEIVED BY	DATE	TIME

SHIPPED VIA	DATE SENT	TIME SENT	COOLER #

CONDUCT ANALYSIS TO DETECT

LAB HEN 460722S DHS # _____

ALL ANALYSES MUST MEET SPECIFICATIONS AND DETECTION LIMITS SET BY CALIFORNIA DHS AND

- EPA RWQCB REGION _____
 LIA
 OTHER

CHAIN OF CUSTODY

960719-101
 CLIENT PES ENVIRONMENTAL
 SITE Foothill Square Shopping Center
10700 MacArthur Blvd.
Oakland, CA.

C = COMPOSITE ALL CONTAINERS

SAMPLE I.D.	MATRIX S = SOIL W = H2O	CONTAINERS	
		TOTAL	
<u>NW6 850</u>	<u>W</u>	<u>3</u>	<u>X</u>
<u>NW7 800</u>	<u>↓</u>	<u>↓</u>	<u>X</u>
<u>EB -</u>	<u>↓</u>	<u>↓</u>	<u>X</u>
<u>TB -</u>	<u>↓</u>	<u>2</u>	<u>X</u>

SPECIAL INSTRUCTIONS INVOICE & Report
to PES ENVIRONMENTAL.
ATTN: JENNY HAN
Project #: 502.0101.003

ADD'L INFORMATION	STATUS	CONDITION	LAB SAMPLE #
			<u>11AC</u>
			<u>12AC</u>
			<u>13AC</u>
			<u>14AB</u>

SAMPLING COMPLETED	DATE <u>7/17/96</u>	TIME <u>1300</u>	SAMPLING PERFORMED BY <u>Keith Brown</u>	RESULTS NEEDED NO LATER THAN	<u>Standard TAT</u>
RELEASED BY <u>[Signature]</u>	DATE <u>7/18/96</u>	TIME <u>1420</u>	RECEIVED BY <u>[Signature]</u>	DATE <u>7/18/96</u>	TIME <u>1420</u>
RELEASED BY <u>[Signature]</u>	DATE <u>7/18/96</u>	TIME <u>1600</u>	RECEIVED BY <u>[Signature]</u>	DATE <u>7-18-96</u>	TIME <u>1600</u>
RELEASED BY	DATE	TIME	RECEIVED BY	DATE	TIME

SHIPPED VIA	DATE SENT	TIME SENT	COOLER #

DISTRIBUTION

QUARTERLY MONITORING REPORT
FORMER YOUNG'S CLEANERS
FOOTHILL SQUARE SHOPPING CENTER
OAKLAND, CALIFORNIA

NOVEMBER 19, 1996

COPY NO. _____

		<u>Copy No.</u>
2 Copies	Jay-Phares Corporation 10700 MacArthur Boulevard, Suite 200 Oakland, California 94605-5260 Attention: Mr. Hugh K. Phares, III Mr. John Jay	1-2
1 Copy	Drake Builders 5201 Sacramento Avenue Richmond, California 94804 Attention: Mr. Richard Gilcrease	3
1 Copy	Alameda County Health Care Service Agency Department of Environmental Health 1131 Harbor Bay Parkway, Suite 250 Alameda, California 94502-6577 Attention: Mr. Barney Chan	4
3 Copies	PES Job File	5-7
1 Copy	Unbound Original	8

Quality Control Reviewer

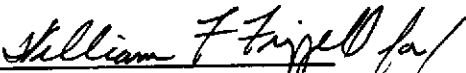
Robert S. Creps, P.E.