



JAY-PHARES CORPORATION

Real Estate Broker's License No. 993880

General Contractor's License No. 841307

www.jayphares.com

August 18, 2015

Mr. Jerry Wickham
Alameda County Environmental Health
1131 Harbor Bay Parkway, Suite 250
Alameda, California 94502

RECEIVED

By Alameda County Environmental Health 11:31 am, Aug 21, 2015

**Subject: Perjury Statement and Report Transmittal
Groundwater Monitoring Report – 1st Semester 2015**
10700 MacArthur Blvd.
Oakland, California
AEI Project # 261829
Toxics Case No. RO0002580

Dear Mr. Wickham:

I declare under penalty of perjury, that the information and/or recommendations contained in the attached report for the above-referenced site are true and correct to the best of my knowledge.

If you have any questions or need additional information, please do not hesitate to call me at (510) 562-9500, or Mr. Peter McIntyre at AEI Consultants, (925) 746-6004.

Sincerely,

MACARTHUR BOULEVARD ASSOCIATES
(a California limited partnership)

BY: JAY-PHARES CORPORATION
(Its Management Agent)

By: _____
John Jay, President

cc: Mr. Peter McIntyre, AEI Consultants, 2500 Camino Diablo, Walnut Creek, CA 94597

10700 MacArthur Blvd., Suite 200, Oakland, CA 94605-5260

Telephone: (510) 562-9500/Fax: (510) 562-9505



AEI Consultants

Environmental & Engineering Services

August 18, 2015

GROUNDWATER MONITORING REPORT- 1st SEMESTER 2015

Property Identification:

10700 MacArthur Boulevard
Oakland, California 94605

AEI Project No. 261829
Toxics Case No. RO0002580

Prepared for:

Jay-Phares Corporation
Attn: Mr. John Jay
10700 MacArthur Blvd., Suite 200
Oakland, CA 94605

Prepared by:

AEI Consultants
2500 Camino Diablo
Walnut Creek, CA 94597
(925) 746-6000

San Francisco HQ

Atlanta

Chicago

Costa Mesa

Dallas

Denver

Los Angeles

Miami

New York

Phoenix

Portland

San Jose

National Presence

Regional Focus

Local Solutions



August 18, 2015

Jay-Phares Corporation
Attn: Mr. John Jay
10700 MacArthur Blvd., Suite 200
Oakland, CA 94605

Subject: Groundwater Monitoring Report – 1st Semester, 2015
10700 MacArthur Boulevard
Oakland, California 94605
AEI Project No. 261829
Toxics Case No. RO0002580

Dear Mr. Jay:

AEI Consultants (AEI) has prepared this groundwater monitoring report on behalf of The Jay-Phares Corporation, the manager of the Foothill Square Shopping Center. Groundwater monitoring was performed to document groundwater quality beneath and around the Site and to monitor the stability of the chlorinated volatile organic compound (VOC) plume beneath the property.

This report was prepared in accordance with the requirements of the Alameda County Health Care Services Agency (ACHCSA). This report summarizes the activities and results of the semi-annual monitoring activities conducted on May 7, 2015.

Background

The subject property (hereinafter referred to as the site or property) is located at 10700 MacArthur Boulevard (see Figure 1). The site is approximately 13.5 acres in size and is currently developed with the Foothill Square Shopping Center. The shopping center consists of five buildings, totaling approximately 155,600 square feet. The area of concern is the former Young's Cleaners, located on the north side of the property.

The site is situated in a mixed commercial and residential area of Oakland. It is bounded by MacArthur Boulevard to the west, Foothill Boulevard to the east, and 108th Avenue to the south. An ARCO gasoline station is located adjacent to the northwest and residences to the north. Refer to Figure 2 for a site plan of the western section of the Foothill Square Shopping Center property.

To date, extensive site assessment activities have been conducted, including the installation of monitoring wells, soil borings, and soil vapor borings, as well as source removal excavation. The most recent investigation included additional soil vapor borings, which were completed for vapor phase contaminant delineation. An approval for pilot study site mitigation activities was

obtained from the ACHCSA, and the pilot study activities are currently ongoing. For a complete history of previous site investigation activities, please refer to AEI's *Supplemental Soil Vapor Investigation Report* dated June 25, 2008.

Summary of Monitoring Activities

On May 7, 2015, AEI gauged the groundwater levels in each of the accessible active groundwater monitoring wells at the site (including Wells AMW-1, AMW-6R, AMW-8, AMW-9, FHS MW-10, and FHS MW-11). Groundwater samples were collected from each of the wells (AMW-1, AMW-6R, AMW-9, FHS MW-10, and FHS MW-11) in accordance with the approved sampling schedule except for well AMW-8, which was not sampled during this monitoring event. All accessible wells were first opened and water levels allowed to equilibrate with atmospheric pressure. The depth to water from the top of the well casings was measured with an electric water level indicator prior to sampling. Upon equilibration, the wells were then purged of at least three well volumes either using a battery-powered submersible pump or bailed by hand. Field data sheets are included in Appendix A.

During well purging, groundwater parameters, including temperature, pH, specific conductivity, dissolved oxygen, and oxidation-reduction potential (ORP), were measured and the turbidity was visually noted. Once the above parameters had stabilized, and the wells were allowed to recharge to a minimum of 90% of their original standing water volume, a groundwater sample was collected. Groundwater samples were collected from each well using clean, disposable, plastic bailers.

Upon collection, groundwater samples were transferred into three 40-milliliter volatile organic analysis (VOA) vials. These sample containers were capped so that no headspace or air bubbles were visible. The samples were labeled with unique identifiers, stored over ice inside a chilled ice chest. The samples were transported under chain-of-custody documentation to McCampbell Analytical, Inc. of Pittsburg, California (Department of Health Services Certification #1644). Groundwater samples were analyzed for halogenated volatile organic compounds (HVOCs) using EPA Method 8260.

Field Results

Generally, the wells at the site are categorized as being screened either within a shallow water-bearing zone or a deeper water-bearing zone. Shallow zone wells (AMW-1 and AMW-6R) are screened at depths between approximately 16 and 25 feet below ground surface (bgs). Deeper water-bearing zone wells (AMW-8, AMW-9, and FHS MW-10 and FHS MW-11) are generally screened at depths between approximately 21 and 33 feet bgs. Well screen intervals, where known, are presented in Table 1.

Since the last monitoring event, groundwater elevations in the shallow water-bearing zone (only for Well AMW-1) increased by 0.72 feet. Groundwater elevations in the deeper water-bearing zone increased between approximately 0.60 and 6.59 feet. Of the deeper zone monitoring wells, well AMW-8 significantly decreased by 6.59 feet since the previous monitoring event. The groundwater elevation in shallow zone Well AMW-1 was measured at at 40.50 feet above mean sea level (msl). Because only one groundwater monitoring well (AMW-1) was monitored for the shallow zone, sufficient data was not available to generating a groundwater elevation

map for the shallow zone. Historically, shallow zone groundwater typically flows to the west. Groundwater elevations in the deeper water-bearing zone ranged from 25.55 to 37.86 feet msl. The differences in groundwater elevations between the shallow and deeper water-bearing zones suggests that the deeper water-bearing zone occurs under semi-confined/confined conditions. Groundwater flow in the deeper zone is to the west-southwest at a gradient of approximately 0.02 feet per foot (ft/ft), which is relatively consistent with previous findings.

Historical groundwater level data, including the data obtained during this event, is summarized in Table 1. Groundwater elevation contours for deeper zone monitoring wells are shown in Figure 3. Refer to Appendix A for Groundwater Monitoring Well Field Sampling Forms.

Groundwater Quality

Tetrachloroethene (PCE), trichloroethene (TCE), and cis-1,2 dichloroethene (cis-1,2 DCE) were detected in groundwater in shallow well AMW-6R at concentrations of 690 micrograms per liter ($\mu\text{g/L}$), 140 $\mu\text{g/L}$, and 120 $\mu\text{g/L}$ respectively. Concentrations of these constituents were relatively consistent and within the same order of magnitude as those detected during the previous monitoring event. PCE was detected in well AMW-1 at a concentration of 0.50 $\mu\text{g/L}$. No other HVOCs were detected in AMW-1 at or above the laboratory detection limits. PCE was detected in only one of the deeper zone wells (AMW-9) at a concentration of 15 $\mu\text{g/L}$. Chloroform was detected in well FHS MW-11 at a concentration of 0.76 $\mu\text{g/L}$. No cis-1,2-DCE or trans-1,2-dichloroethene (trans-1,2-DCE) was detected at or above the laboratory detection limit in any of the deeper zone groundwater samples. PCE was not detected in either of the down-gradient, offsite wells (FHS MW-10 and FHS MW-11). The distribution of HVOCs detected in groundwater during this event are shown on Figure 4.

Historical groundwater quality data, including the results obtained during this event, is presented in Table 2. Certified analytical laboratory reports and chain of custody documentation are provided in Appendix B.

Summary

The report presents the findings of the first semester groundwater monitoring event at the site, conducted during the 2nd Quarter 2015. The ACHCSA, in a letter dated July 10, 2008, concurred that no further characterization is necessary to investigate shallow soil vapor beneath the site and AEI may commence with the pilot testing activities at the site. Construction work for implementation of the pilot study activities commenced in July 2012. This included the installation of horizontal extraction piping, conveyance piping, and a soil vapor extraction well. Subsequently, the sub-slab depressurization system and soil vapor extraction system commenced operation in January 2014 and is currently operational.

In response to ACHCSA's letter dated April 23, 2015, AEI prepared and submitted a system installation startup and operations report entitled, *Interim Remediation Status Report*, dated June 10, 2015. As planned, the groundwater monitoring well network will continue to be sampled by AEI in accordance with the ACHCSA-approved sampling schedule. The next groundwater monitoring event is scheduled for October 2015.

Report Limitations and Signatures

This report presents a summary of work completed by AEI Consultants. The completed work includes observations and descriptions of the site conditions encountered. Where appropriate, it includes analytical results for samples taken during the course of the work. The number and location of samples are chosen to provide the requested information, but it cannot be assumed that they are representative of areas not sampled. All conclusions and/or recommendations are based on these analyses and observations, and the governing regulations. Conclusions beyond those stated and reported herein should not be inferred from this document.

These services were performed in accordance with generally accepted practices in the environmental engineering and consulting field, which existed at the time and location of the work. If you have any questions regarding our investigation, please do not hesitate to contact one of us at (925) 746-6000.

Sincerely,
AEI Consultants

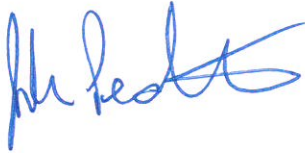

John Mark Pendleton
Staff Geologist



Peter J. McIntyre, P.G.
Executive Vice President
Principal Geologist

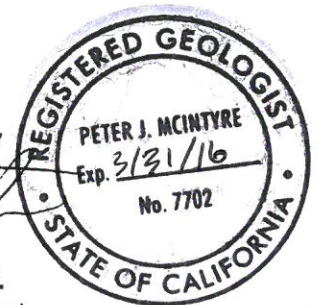

Figures

- Figure 1: Site Location Map
- Figure 2: Site Plan
- Figure 3: Groundwater Elevation Map – Deep Wells (5/7/15)
- Figure 4: Groundwater Analytical Data (5/7/15)

Tables

- Table 1: Groundwater Level Data
- Table 2: Groundwater Sample Analytical Data

Appendix A: Groundwater Monitoring Well Field Sampling Forms

Appendix B: Laboratory Analyses with Chain of Custody Documentation

Distribution:

Mr. Jerry Wickham, Alameda County Health Care Services Agency, 1131 Harbor Bay Parkway, Suite 250,
Alameda, CA 94502 (electronic copy)

Jay-Phares Corporation, Attn; John Jay, 10700 MacArthur Blvd., Oakland, California 94605

Geotracker electronic upload

FIGURES

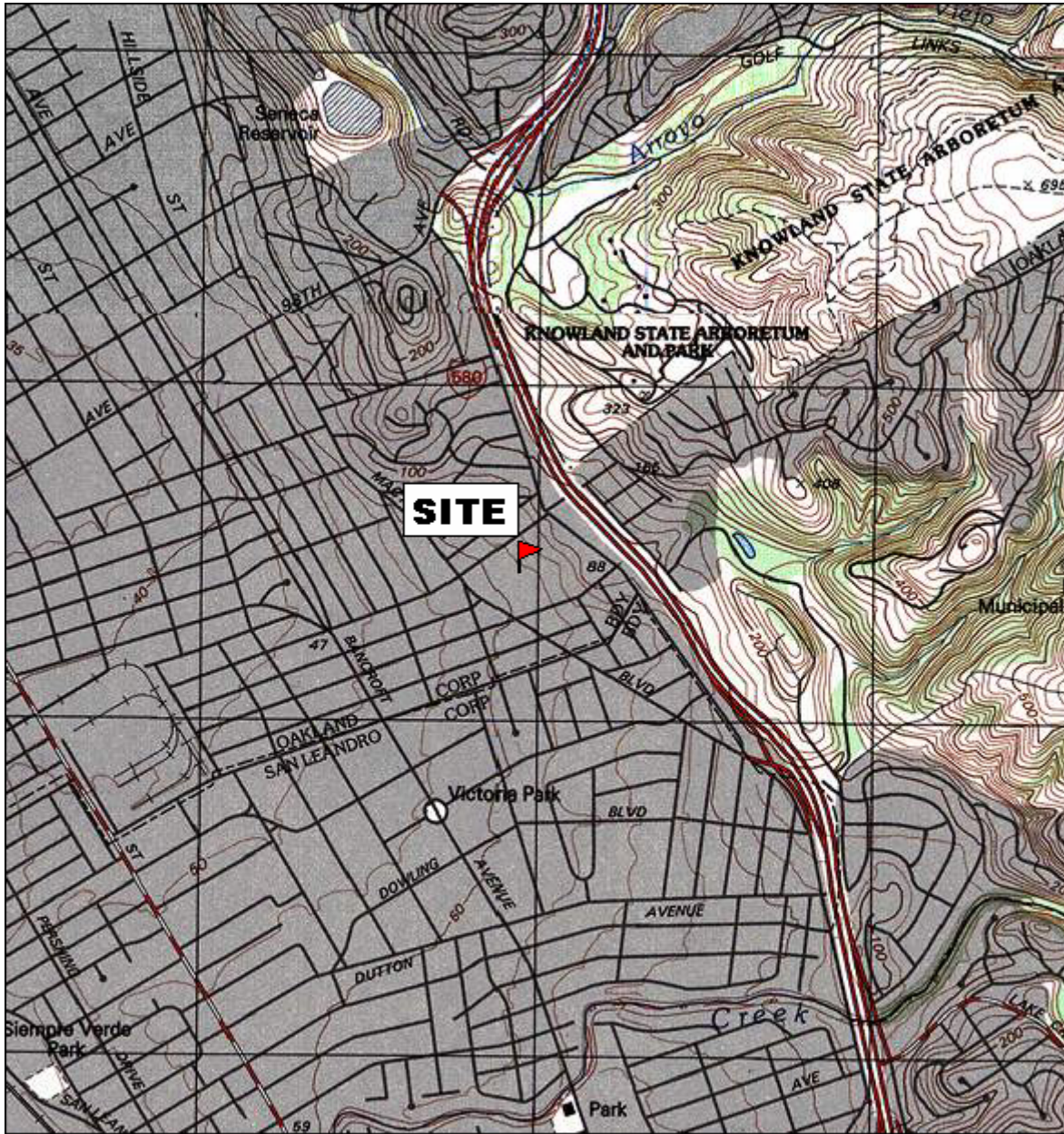

TN \star MN
15 $\frac{1}{2}$ $^{\circ}$

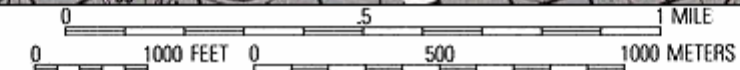

Printed from TOPO! ©2001 National Geographic Holdings (www.topo.com)

AEI CONSULTANTS 2500 Camino Diablo, Suite 200, Walnut Creek, CA 94597	
SITE LOCATION MAP	
10700 MACARTHUR BLVD OAKLAND, CALIFORNIA	FIGURE 1 PROJECT No. 261829

106 th AVENUE

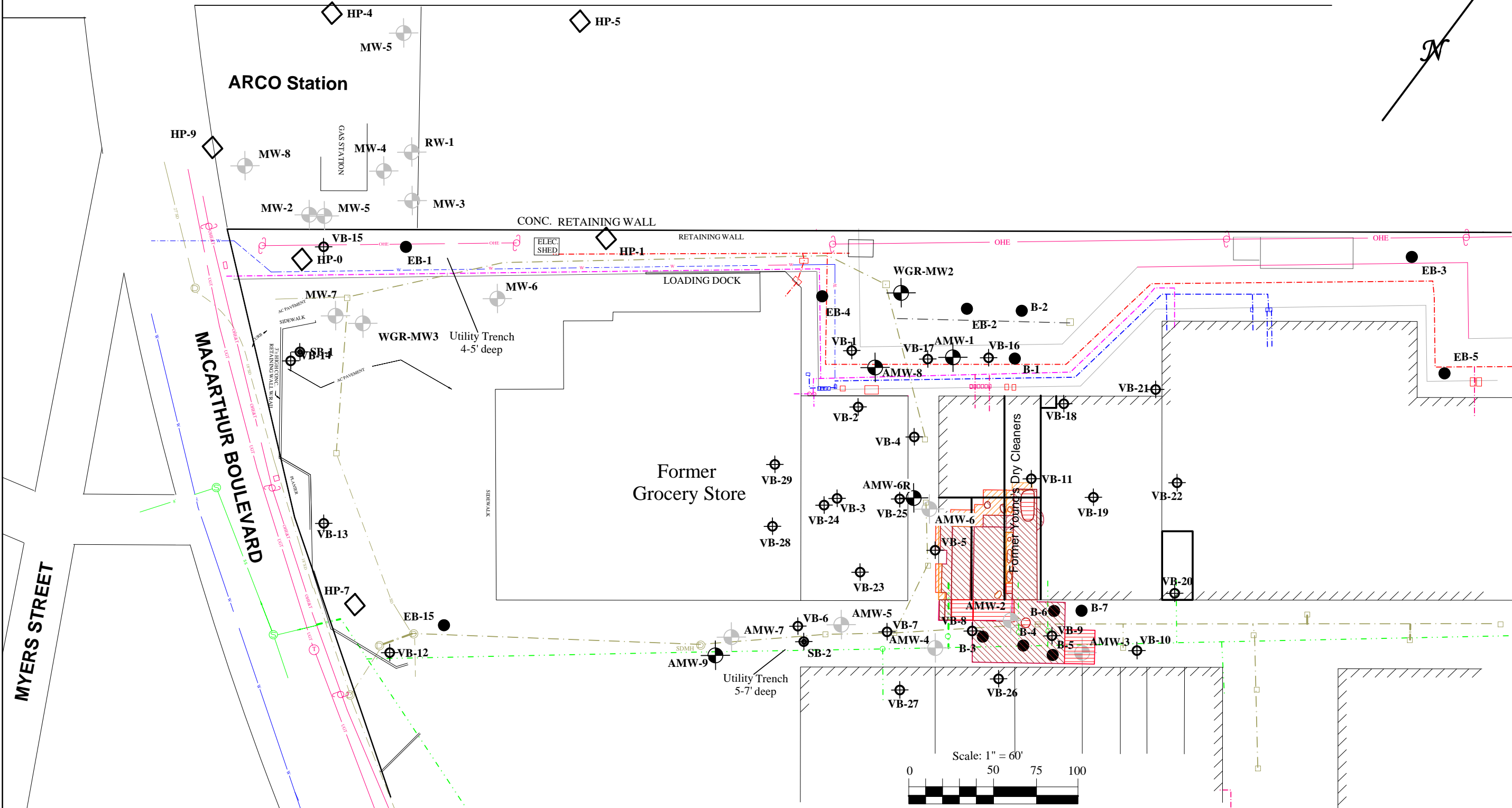
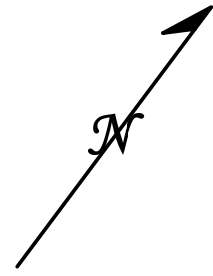

- KEY**
- EB-1 ● Soil Boring - Kaldveer 1988
 - B-1 ● Soil Boring - Augeas 1994
 - HP-8 ◊ CPT Boring/HydroPunch Sample - PES 1997
 - MW4 ⊕ Groundwater Monitoring Well
 - ⊕ Soil Vapor Sample
 - ⊙ Soil Boring - AEI 2006

- Excavated to depth of 5 to 7 feet bgs
- Excavated to depth of 8 to 13 feet bgs
- Excavated to depth of 14 to 18 feet bgs
- Abandoned Monitoring Well

- On Site Storm Drain
 - Off Site Storm Drain
 - On Site Sanitary Sewer
 - Off Site Sanitary Sewer
 - On Site Underground Power
 - On Site Gas Line
- Scale: 1" = 60'
- 0 50 75 100
- Drafted 6/30/05 - RFF on Dirk Slooten base
Revised 05/08 by J.SMITH

AEI CONSULTANTS
2500 CAMINO DIABLO, WALNUT CREEK, CA



SITE PLAN

10700 MACARTHUR BLVD.
OAKLAND, CALIFORNIA

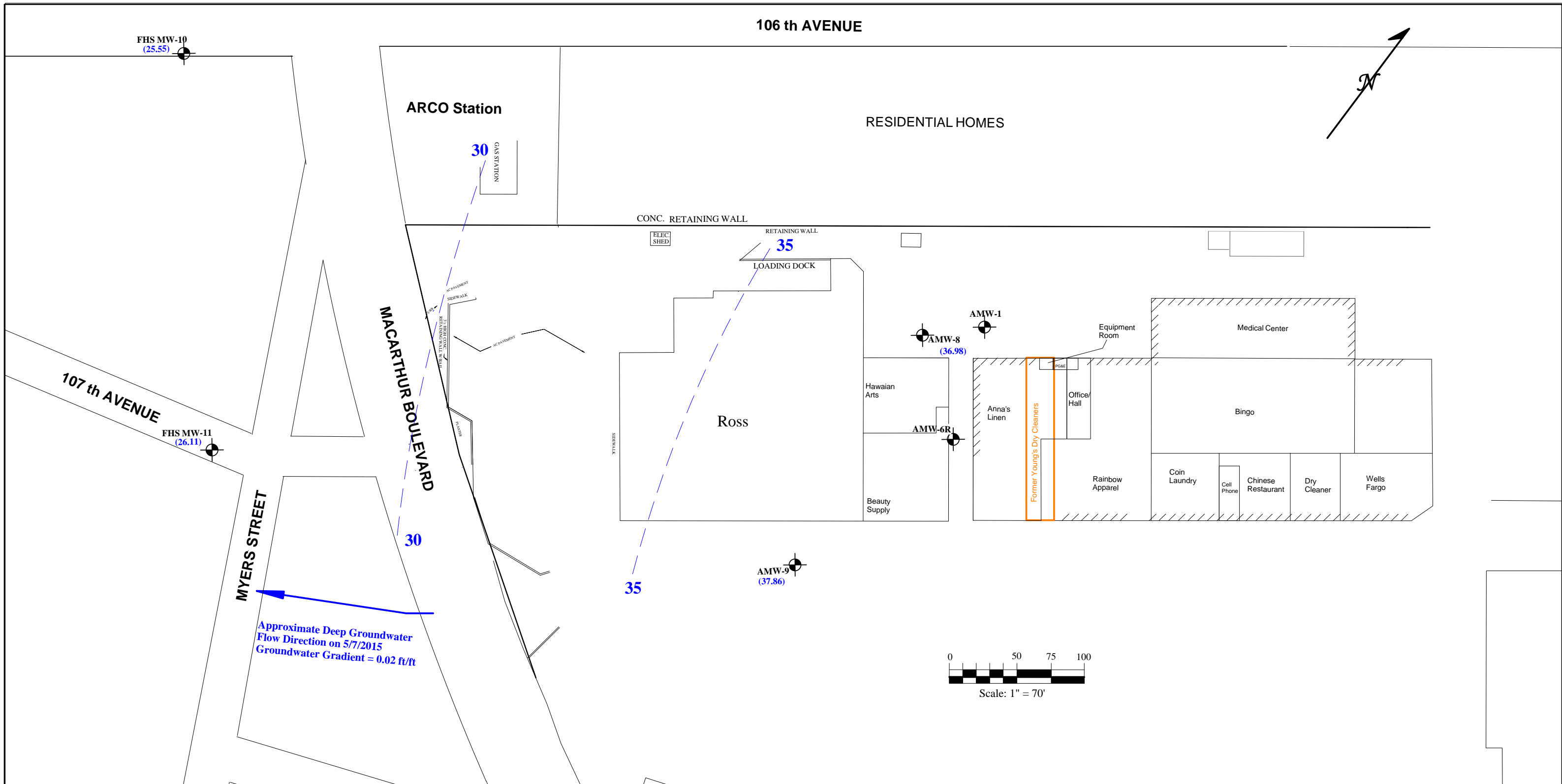
FIGURE 2
PROJECT NO. 261829



KEY

-  Groundwater Monitoring Well
- AMW-9
- (37.86) = Groundwater Elevation (msl)
-  Groundwater Elevation Contour (feet, msl)

AEI CONSULTANTS

2500 CAMINO DIABLO, WALNUT CREEK, CA

**Groundwater Elevation Map -
Deep Wells (5/7/15)**

10700 MACARTHUR BLVD.
OAKLAND, CALIFORNIA

FIGURE 3
PROJECT NO. 261829

(25.55) Groundwater Elevation (NAVD88)

106 th AVENUE

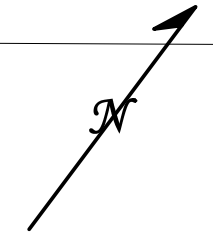

FHS MW-10	ug/L
PCE	ND<0.5
TCE	ND<0.5
cis-DCE	ND<0.5

FHS MW-11	ug/L
PCE	ND<0.5
TCE	ND<0.5
cis-DCE	ND<0.5

AMW-9	ug/L
PCE	15
TCE	ND<0.5
cis-DCE	ND<0.5

AMW-6R	ug/L
PCE	690
TCE	140
cis-DCE	120

AMW-1	ug/L
PCE	0.50
TCE	ND<0.5
cis-DCE	ND<0.5

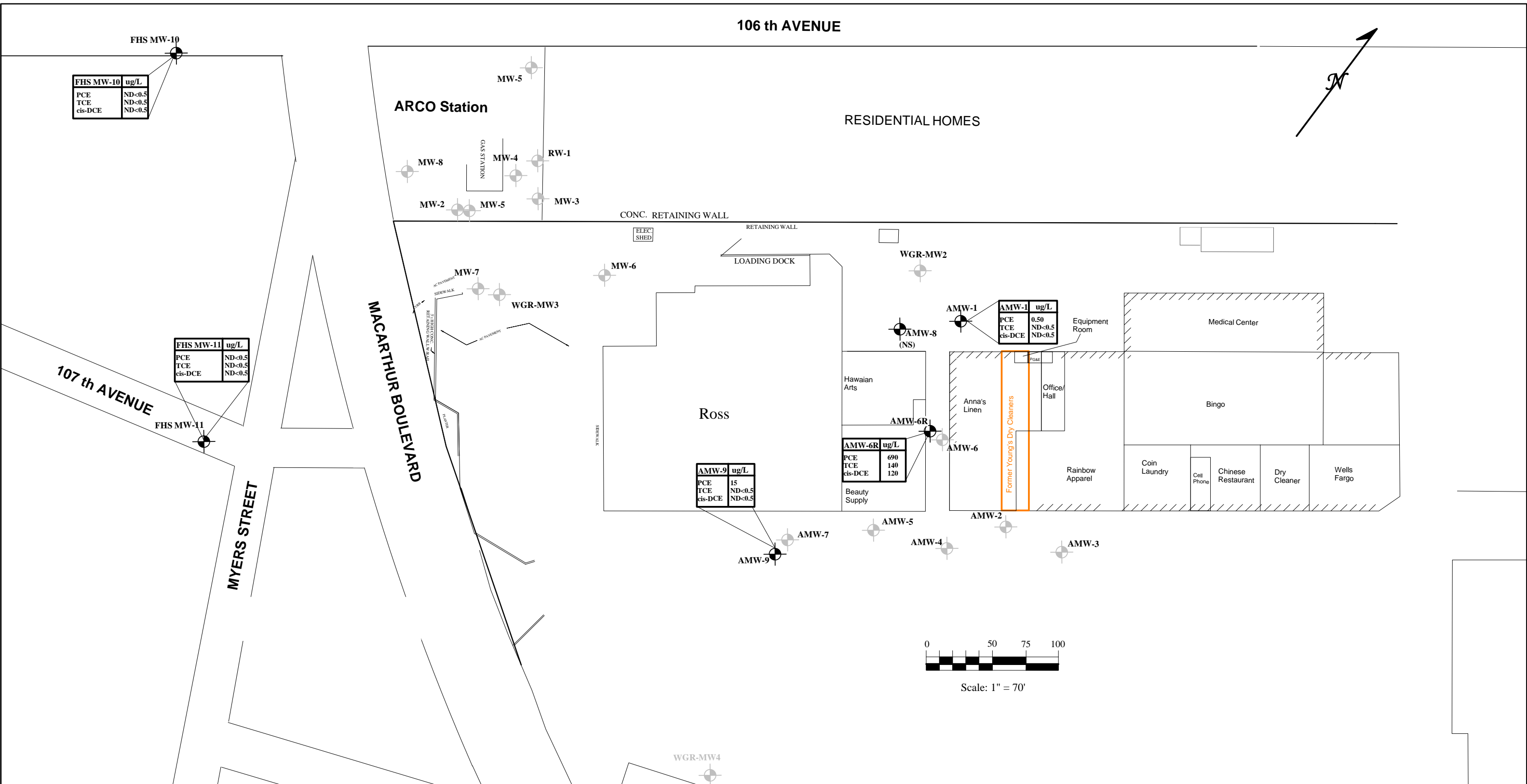

- KEY**
- Abandoned Monitoring Well
 - Groundwater Monitoring Well

PCE = tetrachloroethene
 TCE = trichloroethene
 cis-DCE = cis 1,2-Dichloroethene
 ug/L = micrograms per liter (ppb)
 NS = not sampled

AEI CONSULTANTS
 2500 CAMINO DIABLO, WALNUT CREEK, CA

Groundwater Analytical Data
 (5/7/15)

10700 MACARTHUR BLVD.
 OAKLAND, CALIFORNIA

FIGURE 4
 PROJECT NO. 261829

TABLES

Table 1
Groundwater Level Data
10700 MacArthur Blvd., Oakland, California

Well ID (Aquifer zone)	Date	Screen Interval (ft bgs)	Well Elevation (ft msl)	Depth to Water (ft)	Groundwater Elevation (ft msl)
AMW-1 (Shallow)	1/29/1999	24-34	64.51	23.01	41.50
	5/5/1999		64.51	21.25	43.26
	10/9/1999		64.51	24.14	40.37
	1/20/2000		64.51	24.66	39.85
	8/8/2000		64.51	23.30	41.21
	2/15/2001		64.51	23.22	41.29
	8/29/2001		64.51	24.38	40.13
	3/12/2002		64.51	21.29	43.22
	9/27/2002		64.51	23.62	40.89
	3/25/2003		64.51	22.45	42.06
	10/2/2003		64.51	24.31	40.20
	10/17/2006		64.51	22.91	41.60
	5/3/2007		64.51	18.61	45.90
	10/17/2007		64.51	23.97	40.54
	4/1/2008		64.51	22.02	42.49
	10/2/2008		64.51	24.21	40.30
	4/2/2009		64.51	22.49	42.02
	10/2/2009		64.51	24.38	40.13
	4/9/2010		64.51	21.68	42.83
	11/10/2010		64.51	24.11	40.40
	5/27/2011		64.51	20.98	43.53
	10/19/2011		64.51	23.41	41.10
	4/30/2012		64.51	22.19	42.32
	10/29/2012		64.51	24.31	40.20
	4/26/2013		64.51	22.39	42.12
	10/11/2013		64.51	24.37	40.14
4/16/2014	64.51	23.01	41.50		
10/14/2014	64.51	24.73	39.78		
	5/7/2015		64.51	24.01	40.50
AMW-4 (Shallow)	1/29/1999	15-25	64.79	11.51	53.28
	5/5/1999		64.79	10.14	54.65
	10/9/1999		64.79	12.04	52.75
	1/20/2000		64.79	13.50	51.29
	8/8/2000		64.79	11.74	53.05
	2/15/2001		64.79	12.32	52.47
	8/29/2001		64.79	12.40	52.39
	3/12/2002		64.79	10.13	54.66
	9/27/2002		64.79	12.14	52.65
	3/25/2003		64.79	11.03	53.76
	10/2/2003		64.79	12.33	52.46
	10/17/2006		64.79	12.76	52.03
	5/3/2007		64.79	11.11	53.68
	10/17/2007		64.79	12.64	52.15
	4/1/2008		64.79	11.49	53.30
	10/2/2008		64.79	13.34	51.45
	4/2/2009		64.79	12.21	52.58
	10/2/2009		64.79	13.91	50.88
	4/9/2010		64.79	11.23	53.56
	11/10/2010		64.79	12.85	51.94
5/27/2011	64.79	10.25	54.54		
10/19/2011	64.79	12.42	52.37		
4/30/2012	64.79	11.49	53.30		
10/29/2012			Well Destroyed during Constructor		

Table 1
Groundwater Level Data
10700 MacArthur Blvd., Oakland, California

Well ID (Aquifer zone)	Date	Screen Interval (ft bgs)	Well Elevation (ft msl)	Depth to Water (ft)	Groundwater Elevation (ft msl)
AMW-5 (Shallow)	1/29/1999	20-30	64.97	13.87	51.10
	5/5/1999		64.97	12.83	52.14
	10/9/1999		64.97	14.25	50.72
	1/20/2000		64.97	14.91	50.06
	8/8/2000		64.97	14.14	50.83
	2/15/2001		64.97	14.32	50.65
	8/29/2001		64.97	14.72	50.25
	3/12/2002		64.97	13.12	51.85
	9/27/2002		64.97	14.62	50.35
	3/25/2003		64.97	13.45	51.52
	10/2/2003		64.97	14.74	50.23
	10/17/2006		64.97	14.15	50.82
	5/3/2007		64.97	13.92	51.05
	10/17/2007		64.97	15.06	49.91
	4/1/2008		64.97	14.14	50.83
	10/2/2008		64.97	15.72	49.25
	4/2/2009		64.97	14.62	50.35
	10/2/2009		64.97	16.18	48.79
	4/9/2010		64.97	13.98	50.99
	11/10/2010		64.97	15.78	49.19
5/27/2011	64.97	13.65	51.32		
10/19/2011	64.97	14.68	50.29		
4/30/2012	64.97	14.87	50.10		
10/29/2012	Well Destroyed during Constructor				
AMW-6 (Shallow)	1/29/1999	? - 25	65.10	12.74	52.36
	5/5/1999		65.10	11.30	53.80
	10/9/1999		65.10	13.29	51.81
	1/20/2000		65.10	14.21	50.89
	8/8/2000		65.10	12.95	52.15
	2/15/2001		65.10	12.64	52.46
	8/29/2001		65.10	13.65	51.45
	3/12/2002		65.10	11.41	53.69
	9/27/2002		65.10	13.25	51.85
	3/25/2003		65.10	12.22	52.88
	10/2/2003		65.10	14.74	50.36
	10/17/2006		65.10	11.46	53.64
	5/3/2007		65.10	13.04	52.06
	10/17/2007		65.10	13.87	51.23
	4/1/2008		65.10	12.64	52.46
	10/2/2008		65.10	14.54	50.56
	4/2/2009		65.10	13.38	51.72
	10/2/2009		65.10	16.03	49.07
	4/9/2010		65.10	12.75	52.35
	11/10/2010		65.10	14.56	50.54
5/27/2011	Well Destroyed and Replaced with AMW-6R				
AMW-6R (Shallow)	5/27/2011	13-23	NA	14.70	NA
	10/19/2011		NA	14.50	NA
	4/30/2012		NA	15.94	NA
	10/29/2012		NA	14.54	NA
	4/26/2013		NA	14.18	NA
	10/11/2013		NA	14.58	NA
	4/16/2014		NA	13.84	NA
	10/14/2014		NA	16.31	NA
5/7/2015	NA	7.18	NA		

Table 1
Groundwater Level Data
10700 MacArthur Blvd., Oakland, California

Well ID (Aquifer zone)	Date	Screen Interval (ft bgs)	Well Elevation (ft msl)	Depth to Water (ft)	Groundwater Elevation (ft msl)
AMW-7 (Shallow)	1/29/1999	Unknown	64.24	14.91	49.33
	5/5/1999		Well Covered during construction		
AMW-8 (Deep)	1/29/1999	? - 45	64.55	16.86	47.69
	5/5/1999		64.55	14.46	50.09
	10/9/1999		64.55	17.10	47.45
	1/20/2000		64.55	18.51	46.04
	8/8/2000		64.55	16.71	47.84
	2/15/2001		64.55	17.31	47.24
	8/29/2001		64.55	18.30	46.25
	3/12/2002		64.55	16.03	48.52
	9/27/2002		64.55	18.03	46.52
	3/25/2003		64.55	17.31	47.24
	10/2/2003		64.55	21.54	43.01
	10/17/2006		64.55	16.05	48.5
	5/3/2007		64.55	23.01	41.54
	10/17/2007		64.55	18.34	46.21
	4/1/2008		64.55	17.49	47.06
	10/2/2008		64.55	19.10	45.45
	4/2/2009		64.55	18.18	46.37
	10/2/2009		64.55	19.75	44.80
	4/9/2010		64.55	17.76	46.79
	11/10/2010		64.55	19.41	45.14
	5/27/2011		64.55	15.92	48.63
	10/19/2011		64.55	17.15	47.40
	4/30/2012		64.55	17.16	47.39
10/29/2012	64.55	18.72	45.83		
4/26/2013	64.55	17.61	46.94		
10/11/2013	64.55	19.11	45.44		
4/16/2014	64.55	18.02	46.53		
10/14/2014	64.55	20.98	43.57		
	5/7/2015		64.55	27.57	36.98
AMW-9 (Deep)	1/29/1999	? - 55	63.48	23.22	40.26
	5/5/1999		63.48	21.40	42.08
	10/9/1999		63.48	23.74	39.74
	1/20/2000		63.48	24.92	38.56
	8/8/2000		63.48	23.01	40.47
	2/15/2001		63.48	21.20	42.28
	8/29/2001		63.48	22.59	40.89
	3/12/2002		63.48	21.94	41.54
	9/27/2002		63.48	24.16	39.32
	3/25/2003		63.48	23.00	40.48
	10/2/2003		63.48	23.80	39.68
	10/17/2006		63.48	23.07	40.41
	5/3/2007		63.48	23.17	40.31
	10/17/2007		63.48	24.97	38.51
	4/1/2008		63.48	22.97	40.51
	10/2/2008		63.48	25.65	37.83
	4/2/2009		63.48	23.80	39.68
	10/2/2009		63.48	25.98	37.50
	4/9/2010		63.48	22.80	40.68
	11/10/2010		63.48	25.36	38.12
	5/27/2011		63.48	21.73	41.75
	10/19/2011		63.48	24.07	39.41
	4/30/2012		63.48	22.90	40.58
10/29/2012	63.48	25.49	37.99		
4/26/2013	63.48	23.49	39.99		
10/11/2013	63.48	25.33	38.15		
4/16/2014	63.48	24.53	38.95		
10/14/2014	63.48	26.22	37.26		
	5/7/2015		63.48	25.62	37.86

Table 1
Groundwater Level Data
10700 MacArthur Blvd., Oakland, California

Well ID (Aquifer zone)	Date	Screen Interval (ft bgs)	Well Elevation (ft msl)	Depth to Water (ft)	Groundwater Elevation (ft msl)
WGR MW-2 (Shallow)	1/29/1999	23-28	63.18	23.41	39.77
	5/5/1999		63.18	21.41	41.77
	10/9/1999		63.18	24.62	38.56
	1/20/2000		63.18	25.24	37.94
	8/8/2000		63.18	23.41	39.77
	8/29/2001		63.18	25.09	38.09
	3/12/2002		63.18	21.86	41.32
	9/27/2002		63.18	24.69	38.49
	3/25/2003		63.18	23.71	39.47
	10/2/2003		63.18	25.13	38.05
	10/17/2006		63.18	23.91	39.27
	5/3/2007		63.18	24.11	39.07
	10/17/2007		63.18	NA	NA
	4/1/2008		63.18	22.83	40.35
	10/2/2008		63.18	25.53	37.65
	4/2/2009		63.18	23.23	39.95
	10/2/2009		63.18	25.70	37.48
	4/9/2010		63.18	22.36	40.82
	11/10/2010		63.18	24.79	38.39
	5/27/2011		63.18	21.56	41.62
	10/19/2011		63.18	24.06	39.12
	4/30/2012		63.18	NA	NA
	10/29/2012		63.18	29.05	34.13
4/26/2013	63.18	23.54	39.64		
10/11/2013	63.18	25.72	37.46		
4/16/2014	63.18	24.42	38.76		
		Destroyed/ Covered with Black Top			
WGR MW-3 (Shallow)	1/29/1999	22-27	58.34	15.81	42.53
	5/5/1999		58.34	18.43	39.91
	10/9/1999		58.34	21.38	36.96
	1/20/2000		58.34	19.76	38.58
	8/8/2000		58.34	20.88	37.46
	8/29/2001		58.34	21.22	37.12
	3/12/2002		58.34	14.80	43.54
	9/27/2002		58.34	22.32	36.02
	3/25/2003		58.34	18.07	40.27
	10/2/2003		58.34	22.22	36.12
	10/17/2006		58.34	21.85	36.49
	5/3/2007		58.34	18.37	39.97
	10/17/2007		58.34	NA	NA
	4/1/2008		58.34	18.74	39.60
	10/2/2008		58.34	23.62	34.72
	4/2/2009		58.34	17.89	40.45
	10/2/2009		58.34	22.16	36.18
	4/9/2010		58.34	15.71	42.63
11/10/2010	58.34	21.75	36.59		
5/27/2011	Well Destroyed by ARCO; Case Closure at 10600 MacArthur Blvd				

Table 1
Groundwater Level Data
10700 MacArthur Blvd., Oakland, California

Well ID (Aquifer zone)	Date	Screen Interval (ft bgs)	Well Elevation (ft msl)	Depth to Water (ft)	Groundwater Elevation (ft msl)
WGR MW-4 (Deep)	1/29/1999	23-45	60.02	26.23	33.79
	5/5/1999		60.02	23.80	36.22
	10/9/1999		60.02	27.73	32.29
	1/20/2000		60.02	27.97	32.05
	8/8/2000		60.02	26.00	34.02
	2/15/2001		60.02	26.55	33.47
	8/29/2001		60.02	27.14	32.88
	3/12/2002		60.02	24.90	35.12
	9/27/2002		60.02	27.09	32.93
	3/25/2003		60.02	25.75	34.27
	10/2/2003		60.02	27.41	32.61
	10/17/2006		60.02	26.31	33.71
	5/3/2007		60.02	26.13	33.89
	10/17/2007		60.02	28.33	31.69
	4/1/2008		60.02	25.91	34.11
	10/2/2008		60.02	28.85	31.17
	4/2/2009		60.02	25.77	34.25
	10/2/2009		60.02	28.81	31.21
	4/9/2010		60.02	25.01	35.01
	11/10/2010		60.02	28.14	31.88
	5/27/2011		60.02	24.51	35.51
	10/19/2011		60.02	26.97	33.05
	4/30/2012		60.02	24.48	35.54
10/29/2012	60.02	28.23	31.79		
4/26/2013	Well Destroyed during Construction				
FHS MW-10 (Deep)	1/29/1999	42-52	52.34	23.91	28.43
	5/5/1999		52.34	20.55	31.79
	10/9/1999		52.34	25.00	27.34
	1/20/2000		52.34	27.23	25.11
	8/8/2000		52.34	24.06	28.28
	2/15/2001		52.34	24.16	28.18
	8/29/2001		52.34	26.11	26.23
	3/12/2002		52.34	23.94	28.40
	9/27/2003		52.34	25.86	26.48
	3/25/2003		52.34	23.20	29.14
	10/6/2003		52.34	26.39	25.95
	10/17/2006		52.34	24.35	27.99
	5/3/2007		52.34	23.97	28.37
	10/17/2007		52.34	27.71	24.63
	4/1/2008		52.34	23.79	28.55
	10/2/2008		52.34	28.40	23.94
	4/2/2009		52.34	23.80	28.54
	10/2/2009		52.34	28.51	23.83
	4/9/2010		52.34	22.04	30.30
	11/10/2010		52.34	NA	NA
	5/27/2011		52.34	21.28	31.06
	10/19/2011		52.34	24.18	28.16
	4/30/2012		52.34	22.41	29.93
10/29/2012	52.34	25.25	27.09		
4/26/2013	52.34	25.49	26.85		
10/11/2013	52.34	28.83	23.51		
4/16/2014	52.34	28.12	24.22		
10/14/2014	52.34	31.15	21.19		
5/7/2015	52.34	26.79	25.55		

Table 1
Groundwater Level Data
10700 MacArthur Blvd., Oakland, California

Well ID (Aquifer zone)	Date	Screen Interval (ft bgs)	Well Elevation (ft msl)	Depth to Water (ft)	Groundwater Elevation (ft msl)	
FHS MW-11 (Deep)	1/29/1999	59-64	54.06	26.38	27.68	
	5/5/1999		54.06	22.72	31.34	
	10/9/1999		54.06	27.42	26.64	
	1/20/2000		54.06	29.31	24.75	
	8/8/2000		54.06	26.11	27.95	
	2/15/2001		54.06	26.43	27.63	
	8/29/2001		54.06	28.28	25.78	
	3/12/2002		54.06	21.61	32.45	
	9/27/2002		54.06	27.93	26.13	
	3/25/2003		54.06	45.21	8.85	
	10/2/2003				Well Inaccessible	
	10/17/2006		54.06	26.54	27.52	
	5/3/2007		54.06	26.25	27.81	
	10/17/2007		54.06	29.88	24.18	
	4/1/2008		54.06	26.02	28.04	
	10/2/2008		54.06	30.61	23.45	
	4/2/2009		54.06	26.09	27.97	
	10/5/2009*		54.06	30.80	23.26	
	4/9/2010		54.06	21.51	32.55	
	11/10/2010		54.06	NA	NA	
	5/27/2011		54.06	23.38	30.68	
	10/19/2011		54.06	27.23	26.83	
	4/30/2012		54.06	24.60	29.46	
	10/29/2012		54.06	28.29	25.77	
	4/26/2013		54.06	29.02	25.04	
	10/11/2013		54.06	30.94	23.12	
	4/16/2014		54.06	29.19	24.87	
	10/14/2014		54.06	32.23	21.83	
	5/7/2015		54.06	27.95	26.11	
	MW-6 (Deep)		1/29/1999	37.5-56	61.78	32.87
5/5/1999		61.78	29.41		32.37	
9/10/1999		61.78	33.98		27.80	
1/20/2000		61.78	36.02		25.76	
8/8/2000		61.78	32.73		29.05	
2/15/2001		61.78	33.34		28.44	
8/29/2001		61.78	34.98		26.80	
3/12/2002		61.78	30.72		31.06	
9/27/2002		61.78	34.50		27.28	
3/25/2003		61.78	32.08		29.70	
10/2/2003		61.78	34.86		26.92	
10/17/2006		61.78	32.58		29.20	
5/3/2007		61.78	32.54		29.24	
10/17/2007		61.78	36.20		25.58	
4/1/2008		61.78	32.39		29.39	
10/2/2008		61.78	36.86		24.92	
4/2/2009		61.78	32.67		29.11	
10/2/2009		61.78	36.98		24.80	
4/9/2010		61.78	30.09		31.69	
11/10/2010		61.78	35.87		25.91	
5/27/2011		Well Destroyed by ARCO; Case Closure at 10600 MacArthur Blvd.				

Table 1
Groundwater Level Data
10700 MacArthur Blvd., Oakland, California

Well ID (Aquifer zone)	Date	Screen Interval (ft bgs)	Well Elevation (ft msl)	Depth to Water (ft)	Groundwater Elevation (ft msl)
MW-7 (Shallow)	1/20/2000	17.5-37.5	58.64	20.32	38.32
	8/8/2000		58.64	20.50	38.14
	2/15/2001		58.64	16.95	41.69
	8/29/2001		58.64	21.61	37.03
	3/12/2002		58.64	17.03	41.61
	9/27/2002		58.64	22.73	35.91
	3/25/2003		58.64	19.09	39.55
	10/2/2003		58.64	22.46	36.18
	10/17/2006		58.64	22.19	36.45
	5/3/2007		58.64	19.52	39.12
	10/17/2007		58.64	21.49	37.15
	4/1/2008		58.64	19.73	38.91
	10/2/2008		58.64	24.64	34.00
	4/2/2009		58.64	18.60	40.04
	10/2/2009		58.64	22.60	36.04
	4/9/2010		58.64	17.57	41.07
	11/10/2010		58.64	22.16	36.48
5/27/2011	Well Destroyed by ARCO; Case Closure at 10600 MacArthur Blvd.				

Notes: All well elevations are measured from the top of casing not from the ground surface.
ft msl = feet above mean sea level
* = Car parked over well, reading taken 3 days later than other wells.
NA = not available

Table 2
Groundwater Sample Analytical Data
10700 MacArthur Blvd., Oakland, California

Well (aquifer zone)	Date	Consultant	cis 1,2 DCE µg/L	trans 1,2 DCE µg/L	PCE µg/L	TCE µg/L	VHCs* µg/L	
AMW-1 (shallow)	3/23/95	Augeus	-	ND<0.5	ND<0.5	ND<0.5	ND<0.5	
	6/21/95	Augeus	-	ND<0.5	ND<0.5	ND<0.5	ND<0.5	
	9/11/95	Augeus	-	ND<0.5	ND<0.5	ND<0.5	ND<0.5	
	4/16/96	PES	ND<0.5	ND<0.5	ND<0.5	ND<0.5	ND<0.5	
	7/17/96	PES	ND<0.5	ND<0.5	ND<0.5	ND<0.5	ND<0.5	
	10/23/96	PES	ND<0.5	ND<0.5	ND<0.5	ND<0.5	ND<0.5	
	9/29/97	PES	NS	NS	NS	NS	NS	
	1/20/00	AEI	ND<0.5	ND<0.5	ND<0.5	ND<0.5	ND<0.5	
	8/8/00	AEI	NS	NS	NS	NS	NS	
	2/15/01	AEI	ND<0.5	ND<0.5	ND<0.5	ND<0.5	ND<0.5	
	8/29/01	AEI	NS	NS	NS	NS	NS	
	3/12/02	AEI	ND<0.5	ND<0.5	ND<0.5	ND<0.5	ND<0.5	
	9/27/02	AEI	NS	NS	NS	NS	NS	
	3/25/03	AEI	ND<0.5	ND<0.5	1.8	ND<0.5	ND<0.5	
	10/2/03	AEI	NS	NS	NS	NS	NS	
	10/17/06	AEI	ND<0.5	ND<0.5	2.2	ND<0.5	ND<RL	
	5/2/07	AEI	ND<0.5	ND<0.5	ND<0.5	0.69	ND<RL	
	10/17/07	AEI	ND<0.5	ND<0.5	ND<0.5	ND<0.5	ND<RL	
	4/1/08	AEI	ND<0.5	ND<0.5	ND<0.5	ND<0.5	ND<RL	
	10/2/08	AEI	ND<0.5	ND<0.5	0.60	ND<0.5	ND<RL	
	4/2/09	AEI	ND<0.5	ND<0.5	ND<0.5	ND<0.5	ND<RL	
	10/2/09	AEI	ND<0.5	ND<0.5	ND<0.5	ND<0.5	ND<RL	
	4/9/10	AEI	ND<0.5	ND<0.5	ND<0.5	ND<0.5	ND<RL	
	10/25/10	AEI	ND<0.5	ND<0.5	ND<0.5	ND<0.5	ND<RL	
	5/27/11	AEI	ND<0.5	ND<0.5	ND<0.5	ND<0.5	ND<RL	
	10/19/11	AEI	ND<0.5	ND<0.5	ND<0.5	ND<0.5	ND<RL	
	4/30/12	AEI	ND<0.5	ND<0.5	ND<0.5	ND<0.5	ND<RL	
	10/29/12	AEI	ND<0.5	ND<0.5	ND<0.5	ND<0.5	ND<RL	
	04/26/13	AEI	ND<0.5	ND<0.5	ND<0.5	ND<0.5	ND<RL	
	10/11/13	AEI	ND<0.5	ND<0.5	0.62	ND<0.5	ND<RL	
	04/16/14	AEI	ND<0.5	ND<0.5	0.68	ND<0.5	ND<RL	
	10/14/14	AEI	ND<0.5	ND<0.5	0.69	ND<0.5	ND<RL	
	05/07/15	AEI	ND<0.5	ND<0.5	0.50	ND<0.5	ND<RL	
AMW-4 (shallow)	5/15/95	Augeus	NR	ND<50	2400	ND<50	NR	
	6/21/95	Augeus	NR	ND<50	2500	ND<50	NR	
	9/13/95	Augeus	NR	ND<25	1100	ND<25	NR	
	4/16/96	PES	ND<10	ND<10	1200	10	NR	
	7/17/96	PES	ND<10	ND<10	860	ND<10	NR	
	10/23/96	PES	ND<0.5	ND<0.5	22	0.5	NR	
	9/29/97	PES	ND<3	ND<3	340	3	NR	
	1/29/99	AEI	ND<3	ND<3	100	ND<3	ND<3	
	5/5/99	AEI	ND<5	ND<5	210	ND<5	ND<5	
	9/10/99	AEI	10	ND<5	240	18	ND<5	
	1/20/00	AEI	46	ND<2.5	97	6.2	ND<2.5	
	8/8/00	AEI	ND<5	ND<5	440	8	ND<5	
	2/15/01	AEI	ND<2.5	ND<2.5	81	2.6	ND<2.5	
	8/29/01	AEI	ND<2.5	ND<2.5	230	4.6	ND<2.5	
	3/12/02	AEI	ND<5.0	ND<5.0	190	ND<5.0	ND<5.0	
	9/27/02	AEI	ND<5.0	ND<5.0	220	ND<5.0	10***	
	3/25/03	AEI	1.2	ND<1.0	22	1.9	ND<1.0	
	10/2/03	AEI	2.8	ND<0.5	50	2.8	ND<0.5	
	10/17/06	AEI	9.9	ND<0.5	6.5	ND<0.5	ND<RL	
	5/3/07	AEI	2.7	ND<0.5	5.1	1.2	ND<RL**	
10/17/07	AEI	4.0	ND<0.5	6.2	ND<0.5	ND<RL		
4/1/08	AEI	3.3	ND<0.5	5.8	2.6	0.85**		
10/2/08	AEI	11.0	ND<1.0	34	2.9	ND<RL ³		
4/2/09	AEI	2.8	ND<0.5	8.0	0.76	ND<RL ⁴		
10/2/09	AEI	11	ND<0.5	4.3	0.89	ND<RL ⁵		
4/9/10	AEI	1.9	ND<0.5	11	1.6	ND<RL ⁷		
10/22/10	AEI	ND<0.5	ND<0.5	0.76	0.53	ND<RL		
5/27/11	AEI	ND<0.5	ND<0.5	1.9	0.75	ND<RL		
10/19/11	AEI	6.0	ND<0.5	1.2	0.68	ND<RL		
4/30/12	AEI	0.73	ND<0.5	1.0	0.82	ND<RL		
10/29/12			Well Destroyed During Construction					

Table 2
Groundwater Sample Analytical Data
10700 MacArthur Blvd., Oakland, California

Well (aquifer zone)	Date	Consultant	cis 1,2 DCE µg/L	trans 1,2 DCE µg/L	PCE µg/L	TCE µg/L	VHCs* µg/L	
AMW-5 (shallow)	5/15/95	Augeus	NR	ND<0.5	1.2	ND<0.5	NR	
	6/21/95	Augeus	NR	ND<0.5	ND<0.5	ND<0.5	NR	
	9/13/95	Augeus	NR	ND<0.5	ND<0.5	ND<0.5	NR	
	4/16/96	PES	ND<0.5	ND<0.5	ND<0.5	ND<0.5	NR	
	7/17/96	PES	ND<0.5	ND<0.5	0.6	ND<0.5	NR	
	10/23/96	PES	ND<0.5	ND<0.5	0.8	ND<0.5	NR	
	9/29/97	PES	ND<0.5	ND<0.5	13	ND<0.5	NR	
	1/29/99	AEI	NA	NA	NA	NA	NA	
	5/5/99	AEI	ND<1	ND<1	36	ND<1	ND<1	
	9/10/99	AEI	ND<1	ND<1	35	ND<1	ND<1	
	1/20/00	AEI	ND<1	ND<1	36	ND<1	ND<1	
	8/8/00	AEI	ND<0.5	ND<0.5	50	0.72	ND<0.5	
	2/15/01	AEI	ND<0.5	ND<0.5	26	0.76	ND<0.5	
	8/29/01	AEI	ND<0.5	ND<0.5	28	0.87	ND<0.5	
	3/12/02	AEI	ND<0.5	ND<0.5	25	0.75	ND<0.5	
	9/27/02	AEI	ND<0.5	ND<0.5	17	ND<0.5	ND<0.5	
	3/25/03	AEI	ND<1.0	ND<1.0	23	ND<1.0	ND<1.0	
	10/2/03	AEI	ND<0.5	ND<0.5	20	0.58	ND<0.5	
	10/17/06	AEI	0.68	ND<0.5	22	0.88	ND<RL	
	5/3/07	AEI	0.91	ND<0.5	42	2.0	ND<RL	
	10/17/07	AEI	1.2	ND<0.5	42	2.0	ND<RL	
	4/1/08	AEI	1.7	ND<0.5	50	2.8	ND<RL	
	10/2/08	AEI	1.5	ND<1.0	46	2.3	ND<RL	
	4/2/09	AEI	ND<1.7	ND<1.7	56	2.9	ND<RL	
	10/2/09	AEI	0.87	ND<0.5	31	1.4	ND<RL	
	4/9/10	AEI	ND<1.0	ND<1.0	35	2.1	ND<RL	
	10/22/10	AEI	0.93	ND<1.0	29	2.0	ND<RL	
	5/27/11	AEI	0.76	ND<0.5	23	1.9	ND<RL	
	10/19/11	AEI	ND<0.5	ND<0.5	20	1.5	ND<RL	
	4/30/12	AEI	0.59	ND<0.5	8.1	1.2	ND<RL	
	10/29/12	Well Destroyed During Construction						
	AMW-6 (shallow)	9/13/95	Augeus	NR	ND<25	930	ND<25	NR
		4/16/96	PES	20	ND<10	1900	110	NR
7/17/96		PES	ND<30	ND<30	3300	280	NR	
10/23/96		PES	ND<30	ND<30	2900	140	NR	
9/29/97		PES	220	70	4600	580	NR	
1/29/99		AEI	270	77	2400	390	ND<63	
5/5/99		AEI	370	110	2700	470	ND<71	
9/10/99		AEI	190	49	1400	250	ND<36	
1/20/00		AEI	210	ND<35	1600	270	ND<35	
8/8/00		AEI	150	56	1100	180	ND<25	
2/15/01		AEI	190	40	930	200	ND<25	
8/29/01		AEI	77	17	780	110	ND<10	
3/12/02		AEI	150	37	1300	170	ND<25	
9/27/02		AEI	67	ND<17	490	91	ND<17	
3/25/2003		AEI	94	ND<33	740	110	ND<33	
10/2/2003		AEI	66	13	440	60	ND<10	
10/17/2006		AEI	32	4.9	98	14	ND<RL	
5/3/2007		AEI	32	ND<5.0	120	22	ND<RL	
10/17/2007		AEI	48	8.4	140	27	ND<RL ²	
4/1/2008		AEI	39	6.2	140	24	ND<RL	
10/2/2008	AEI	43	7.1	130	26	ND<RL		
4/2/2009	AEI	50	8.1	250	37	ND<RL		
10/2/2009	AEI	55	11	240	44	ND<RL ⁶		
4/9/2010	AEI	56	ND<25	530	61	ND<RL		
10/22/2010	AEI	48	10	260	42	ND<RL		
5/27/2011	Destroyed and Replaced with Well AMW-6R							

Table 2
Groundwater Sample Analytical Data
10700 MacArthur Blvd., Oakland, California

Well (aquifer zone)	Date	Consultant	cis 1,2 DCE µg/L	trans 1,2 DCE µg/L	PCE µg/L	TCE µg/L	VHCs* µg/L
AMW-6R (shallow)	5/27/2011	AEI	54	7.5	210	45	ND<RL
	10/19/2011	AEI	86	ND<12	570	86	ND<RL
	4/30/2012	AEI	74	8.6	220	65	ND<RL
	10/29/12	AEI	93	14	520	92	ND<RL
	04/26/13	AEI	92	<25	410	98	ND<RL
	10/11/13	AEI	100	15	540	110	ND<RL
	04/16/14	AEI	110	ND<12	540	110	ND<RL
	10/14/14	AEI	120	ND<25	490	110	ND<RL
	05/07/15	AEI	120	ND<25	690	140	ND<RL
AMW-7 (shallow)	9/13/95	Augeus	NR	ND<25	2350	340	NR
	4/16/96	PES	2200	60	2300	500	NR
	7/17/96	PES	2100	ND<30	2400	530	NR
	10/23/96	PES	3100	50	3400	610	NR
	9/29/97	PES	33	20	520	100	NR
	1/29/99	AEI	22	ND<3	95	12	ND<3
	5/5/99	AEI	Well Covered During Construction				
AMW-8 (deep)	9/13/95	Augeus	-	ND<25	95	ND<25	ND<25
	4/16/96	PES	ND<0.5	ND<0.5	0.8	ND<0.5	ND<0.5
	7/17/96	PES	ND<0.5	ND<0.5	1.6	ND<0.5	ND<0.5
	10/23/96	PES	ND<0.5	ND<0.5	ND<0.5	ND<0.5	ND<0.5
	9/29/97	PES	ND<0.5	ND<0.5	0.7	ND<0.5	ND<0.5
	1/20/00	AEI	ND<0.5	ND<0.5	0.73	ND<0.5	ND<0.5
	8/8/00	AEI	NS	NS	NS	NS	NS
	2/15/01	AEI	ND<0.5	ND<0.5	1.7	ND<0.5	ND<0.5
	8/29/01	AEI	NS	NS	NS	NS	NS
	3/12/02	AEI	ND<0.5	ND<0.5	7.5	ND<0.5	ND<0.5
	9/27/02	AEI	NS	NS	NS	NS	NS
	3/25/03	AEI	ND<0.5	ND<0.5	ND<0.5	ND<0.5	ND<0.5
	10/2/03	AEI	NS	NS	NS	NS	NS
	10/17/06	AEI	ND<0.5	ND<0.5	ND<0.5	ND<0.5	ND<RL
	5/3/07	AEI	NS	NS	NS	NS	NS
	10/17/07	AEI	ND<0.5	ND<0.5	1.6	ND<0.5	ND<RL
	4/1/08	AEI	NS	NS	NS	NS	NS
	10/2/08	AEI	ND<0.5	ND<0.5	1.3	ND<0.5	ND<RL
	4/2/09	AEI	NS	NS	NS	NS	NS
	10/2/09	AEI	ND<0.5	ND<0.5	1.4	ND<0.5	ND<RL
	4/9/10	AEI	NS	NS	NS	NS	NS
	10/25/10	AEI	ND<0.5	ND<0.5	2.2	ND<0.5	ND<RL
	5/27/11	AEI	NS	NS	NS	NS	NS
10/19/11	AEI	ND<0.5	ND<0.5	ND<0.5	ND<0.5	ND<RL	
4/30/12	AEI	NS	NS	NS	NS	NS	
10/29/12	AEI	ND<0.5	ND<0.5	ND<0.5	ND<0.5	ND<RL	
04/26/13	AEI	NS	NS	NS	NS	NS	
10/11/13	AEI	ND<0.5	ND<0.5	ND<0.5	ND<0.5	ND<RL	
04/16/14	AEI	NS	NS	NS	NS	NS	
10/14/14	AEI	ND<0.5	ND<0.5	ND<0.5	ND<0.5	ND<RL	
05/07/15	AEI	Well Not Sampled					

Table 2
Groundwater Sample Analytical Data
10700 MacArthur Blvd., Oakland, California

Well (aquifer zone)	Date	Consultant	cis 1,2 DCE µg/L	trans 1,2 DCE µg/L	PCE µg/L	TCE µg/L	VHCs* µg/L	
AMW-9 (deep)	9/13/95	Augeus	NR	ND<25	170	ND<25	NR	
	4/16/96	PES	7	ND<3	170	4	NR	
	7/17/96	PES	ND<3	ND<3	190	4	NR	
	10/23/96	PES	ND<3	ND<3	190	ND<3	NR	
	9/29/97	PES	ND<3	ND<3	110	ND<3	NR	
	1/29/99	AEI	ND<4	ND<4	90	ND<4	ND<4	
	5/5/99	AEI	ND<2.5	ND<2.5	94	ND<2.5	ND<2.5	
	9/10/99	AEI	ND<2.1	ND<2.1	99	ND<2.1	ND<2.1	
	1/20/00	AEI	ND<0.5	ND<0.5	100	ND<0.5	ND<0.5	
	8/8/00	AEI	ND<2.5	ND<2.5	130	ND<2.5	ND<2.5	
	2/15/01	AEI	ND<1.0	ND<1.0	69	ND<1.0	ND<1.0	
	8/29/01	AEI	ND<2.5	ND<2.5	98	ND<2.5	ND<2.5	
	3/12/02	AEI	ND<2.5	ND<2.5	100	ND<2.5	ND<2.5	
	9/27/02	AEI	ND<5.0	ND<5.0	80	ND<5.0	ND<5.0	
	3/25/03	AEI	4.1	ND<2.5	48	ND<2.5	ND<2.5	
	10/2/03	AEI	4.8	<0.5	36	1.1	ND<0.5	
	10/17/06	AEI	ND<1.7	ND<1.7	73	ND<1.7	ND<RL	
	5/3/07	AEI	ND<2.5	ND<2.5	86	ND<2.5	ND<RL	
	10/17/07	AEI	ND<2.5	ND<2.5	130	ND<2.5	ND<RL	
	4/1/08	AEI	ND<2.5	ND<2.5	130	ND<2.5	ND<RL	
	10/2/08	AEI	ND<2.5	ND<2.5	110	ND<2.5	ND<RL	
	4/2/09	AEI	ND<2.5	ND<2.5	180	ND<2.5	ND<RL	
	10/2/09	AEI	ND<2.5	ND<2.5	140	ND<2.5	ND<RL	
	4/9/10	AEI	ND<5.0	ND<5.0	160	ND<5.0	ND<RL	
	10/22/10	AEI	ND<1.7	ND<1.7	93	ND<1.7	ND<RL	
	5/27/11	AEI	ND<1.2	ND<1.2	53	ND<1.2	ND<RL	
	10/19/11	AEI	ND<0.5	ND<0.5	30	ND<0.5	ND<RL	
	4/30/12	AEI	ND<0.5	ND<0.5	3.4	ND<0.5	ND<RL	
	10/29/12	AEI	ND<0.5	ND<0.5	14	ND<0.5	ND<RL	
	04/26/13	AEI	ND<0.5	ND<0.5	6.9	ND<0.5	ND<RL	
	10/11/13	AEI	ND<0.5	ND<0.5	18	ND<0.5	ND<RL	
	04/16/14	AEI	ND<0.5	ND<0.5	13	ND<0.5	ND<RL	
	10/14/14	AEI	ND<0.5	ND<0.5	25	ND<0.5	ND<RL	
	5/7/15	AEI	ND<0.5	ND<0.5	15	ND<0.5	ND<RL	
	FHS MW-10 (deep)	10/9/97	PES	ND<0.5	ND<0.5	ND<0.5	ND<0.5	NR
		1/29/99	AEI	ND<0.5	ND<0.5	ND<0.5	ND<0.5	ND<0.5
		5/5/99	AEI	ND<0.5	ND<0.5	ND<0.5	ND<0.5	ND<0.5
		9/10/99	AEI	ND<0.5	ND<0.5	ND<0.5	ND<0.5	ND<0.5
		1/20/00	AEI	ND<0.5	ND<0.5	ND<0.5	ND<0.5	ND<0.5
		8/8/00	AEI	NS	NS	NS	NS	NS
2/15/01		AEI	ND<0.5	ND<0.5	ND<0.5	ND<0.5	ND<0.5	
8/29/01		AEI	NS	NS	NS	NS	NS	
3/12/02		AEI	ND<0.5	ND<0.5	ND<0.5	ND<0.5	ND<0.5	
9/27/02		AEI	NS	NS	NS	NS	NS	
3/25/03		AEI	1.7	ND<1.0	18	2.5	5.0**	
10/6/03		AEI	ND<0.5	ND<0.5	1.4	ND<0.5	1.0**	
10/17/06		AEI	ND<0.5	ND<0.5	ND<0.5	ND<0.5	ND<RL	
5/3/2007 ¹		AEI	ND<0.5	ND<0.5	ND<0.5	ND<0.5	ND<RL	
10/17/07		AEI	ND<0.5	ND<0.5	ND<0.5	ND<0.5	ND<RL	
4/1/08		AEI	ND<0.5	ND<0.5	0.88	ND<0.5	ND<RL	
10/2/08		AEI	ND<0.5	ND<0.5	3.4	ND<0.5	1.4**	
4/2/09		AEI	ND<0.5	ND<0.5	ND<0.5	ND<0.5	ND<RL	
10/2/09		AEI	ND<0.5	ND<0.5	ND<0.5	ND<0.5	ND<RL	
4/9/10		AEI	ND<0.5	ND<0.5	ND<0.5	ND<0.5	ND<RL	
10/22/10		AEI	NS	NS	NS	NS	NS	
5/27/11		AEI	ND<0.5	ND<0.5	ND<0.5	ND<0.5	ND<RL	
10/19/11		AEI	ND<0.5	ND<0.5	ND<0.5	ND<0.5	ND<RL ⁸	
4/30/12		AEI	ND<0.5	ND<0.5	ND<0.5	ND<0.5	ND<RL	
10/29/12		AEI	ND<0.5	ND<0.5	ND<0.5	ND<0.5	ND<RL	
04/26/13	AEI	ND<0.5	ND<0.5	ND<0.5	ND<0.5	ND<RL		
10/11/13	AEI	ND<0.5	ND<0.5	ND<0.5	ND<0.5	ND<RL		
04/16/14	AEI	ND<0.5	ND<0.5	27	0.55	ND<RL		
10/14/14	AEI	ND<0.5	ND<0.5	25	ND<0.5	ND<RL		
05/07/15	AEI	ND<0.5	ND<0.5	ND<0.5	ND<0.5	ND<RL		

Table 2
Groundwater Sample Analytical Data
10700 MacArthur Blvd., Oakland, California

Well (aquifer zone)	Date	Consultant	cis 1,2 DCE µg/L	trans 1,2 DCE µg/L	PCE µg/L	TCE µg/L	VHCs* µg/L	
FHS MW-11 (deep)	9/29/97	PES	ND<0.5	ND<0.5	4	ND<0.5	NR	
	1/29/99	AEI	ND<0.5	ND<0.5	7	ND<0.5	ND<0.5	
	5/5/99	AEI	ND<0.5	ND<0.5	7.1	ND<0.5	ND<0.5	
	9/10/99	AEI	ND<0.5	ND<0.5	7.5	ND<0.5	ND<0.5	
	1/20/00	AEI	ND<0.5	ND<0.5	7.5	ND<0.5	ND<0.5	
	8/8/00	AEI	ND<0.5	ND<0.5	38	ND<0.5	ND<0.5	
	2/15/01	AEI	ND<0.5	ND<0.5	18	ND<0.5	ND<0.5	
	8/29/01	AEI	ND<0.5	ND<0.5	16	ND<0.5	ND<0.5	
	3/12/02	AEI	ND<0.5	ND<0.5	13	ND<0.5	0.77**	
	9/27/02	AEI	ND<1	ND<1	13	ND<1	6.4** 1.1***	
	3/25/03	AEI	0.78	ND<0.5	12	0.88	4.0** 1.0****	
	10/2/03			Well Inaccessible				
	10/17/06	AEI	ND<0.5	ND<0.5	20	ND<0.5	ND<RL	
	5/3/2007 ¹	AEI	ND<0.5	ND<0.5	25	1.1	ND<RL	
	10/17/07	AEI	ND<0.5	ND<0.5	31	0.71	ND<RL	
	4/1/08	AEI	ND<0.5	ND<0.5	26	0.61	ND<RL	
	10/2/08	AEI	ND<0.5	ND<0.5	31	0.74	ND<RL	
	4/2/09	AEI	ND<0.5	ND<0.5	32	0.71	ND<RL	
	10/5/09	AEI	ND<0.5	ND<0.5	32	0.70	ND<RL	
	4/9/10	AEI	ND<1.0	ND<1.0	32	ND<1.0	ND<RL	
	10/22/10	AEI	NS	NS	NS	NS	NS	
	5/27/11	AEI	ND<1.7	ND<1.7	63	1.9	NS	
	10/19/11	AEI	ND<1.0	ND<1.0	49	ND<1.0	ND<RL	
	4/30/12	AEI	ND<0.5	ND<0.5	ND<0.5	ND<0.5	ND<RL	
	10/29/12	AEI	ND<0.5	ND<0.5	ND<0.5	ND<0.5	ND<RL	
	04/26/13	AEI	ND<0.5	ND<0.5	ND<0.5	ND<0.5	ND<RL	
	10/11/13	AEI	ND<0.5	ND<0.5	26	ND<0.5	ND<RL	
	4/16/2014	AEI	ND<0.5	ND<0.5	22	ND<0.5	ND<RL ⁹	
	10/14/2014	AEI	ND<0.5	ND<0.5	17	ND<0.5	ND<RL ¹⁰	
5/7/2015	AEI	ND<0.5	ND<0.5	ND<0.5	ND<0.5	ND<RL¹¹		
MW-6 (deep)	3/11/95	EMCON	ND<20	ND<0.5	1300	ND<20	NR	
	6/5/95	EMCON	ND<20	ND<20	2000	ND<20	NR	
	8/29/95	EMCON	ND<20	ND<20	1300	ND<20	NR	
	9/11/95	Augeus	NR	ND<50	2000	ND<50	NR	
	11/16/95	EMCON	ND<20	ND<20	1300	ND<20	NR	
	2/28/96	EMCON	ND<20	ND<20	960	ND<20	NR	
	4/16/96	PES	10	10	1400	10	NR	
	5/28/96	EMCON	ND<20	ND<20	970	ND<20	NR	
	7/17/96	PES	ND<5	ND<5	590	ND<5	NR	
	8/19/96	EMCON	ND<20	ND<20	820	ND<20	NR	
	10/23/96	PES	ND<5	ND<5	680	ND<5	NR	
	11/21/96	EMCON	ND<20	ND<20	680	ND<20	NR	
	3/26/97	EMCON	ND<40	ND<40	830	ND<40	NR	
	5/20/97	EMCON	ND<5	ND<5	270	ND<5	NR	
	9/29/97	PES	ND<10	ND<10	670	ND<10	NR	
	1/29/99	AEI	1.4	ND<1.3	49	3	ND<1.3	
	5/5/99	AEI	19	ND<11	530	38	ND<11	
	9/10/99	AEI	27	ND<12	560	53	ND<12	
	1/20/00	AEI	18	ND<8.5	660	31	ND<8.5	
	8/8/00	AEI	98	16	1700	170	ND<5	
	2/15/01	AEI	64	ND<10	650	87	ND<10	
	8/29/01	AEI	19	ND<5.0	550	38	ND<5.0	
	3/12/02	AEI	61	ND<20	1200	99	ND<20	
	9/27/02	AEI	ND<12	ND<12	300	27	ND<12	
	3/25/03	AEI	2.6	ND<2.5	49	3.8	ND<2.5	
	10/2/03	AEI	13	ND<5.0	340	21	ND<5.0	
	10/17/06	AEI	16	ND<5.0	320	18	ND<RL	
	5/3/07	AEI	0.92	ND<0.5	39	2.1	ND<RL	
	10/17/07	AEI	10	ND<5.0	310	18	ND<RL	
	4/1/08	AEI	6.8	ND<1.7	76	9.2	ND<RL	
	10/2/08	AEI	21	ND<12	380	33	ND<RL	
	4/2/09	AEI	17	ND<10	420	28	ND<RL	
10/2/09	AEI	22	ND<10	410	29	ND<RL		
4/9/10	AEI	5.5	ND<5.0	160	10	ND<RL		
10/25/10	AEI	26	ND<10	400	30	ND<RL		
5/27/11			Well Destroyed by ARCO; Case Closure at 10600 MacArthur Blvd.					

Table 2
Groundwater Sample Analytical Data
10700 MacArthur Blvd., Oakland, California

Well (aquifer zone)	Date	Consultant	cis 1,2 DCE µg/L	trans 1,2 DCE µg/L	PCE µg/L	TCE µg/L	VHCs* µg/L
MW-7 (shallow)	3/11/95	EMCON	NS	NS	NS	NS	NS
	6/5/95	EMCON	ND<10	ND<10	ND<10	ND<10	ND<10
	8/29/95	EMCON	ND<10	ND<10	ND<10	ND<10	ND<10
	9/11/95	Augeus	85	ND<50	-	ND<50	ND<50
	11/16/95	EMCON	ND<20	ND<20	ND<20	ND<20	ND<20
	2/28/96	EMCON	ND<10	ND<10	ND<10	ND<10	ND<10
	4/16/96	PES	ND<0.5	ND<0.5	ND<0.5	ND<0.5	ND<0.5
	5/28/96	EMCON	ND<10	ND<10	ND<10	ND<10	ND<10
	7/17/96	PES	0.6	ND<0.5	ND<0.5	0.6	ND<0.5
	8/19/96	EMCON	ND<1	ND<1	ND<1	ND<1	ND<1
	10/23/96	PES	0.6	ND<0.5	ND<0.5	ND<0.5	ND<0.5
	11/21/96	EMCON	ND<10	ND<10	ND<10	ND<10	ND<10
	3/26/97	EMCON	ND<20	ND<20	ND<20	ND<20	ND<20
	5/20/97	EMCON	ND<10	ND<10	ND<10	ND<10	ND<10
	9/29/97	PES	ND<10	ND<10	ND<10	ND<10	ND<10
	1/20/00	AEI	ND<6.5	ND<6.5	ND<6.5	ND<6.5	ND<6.5
	8/8/00	AEI	NS	NS	NS	NS	NS
	2/15/01	AEI	ND<0.5	ND<0.5	ND<0.5	ND<0.5	ND<0.5
	8/29/01	AEI	NS	NS	NS	NS	NS
	3/12/02	AEI	ND<0.5	ND<0.5	ND<0.5	ND<0.5	ND<0.5
	9/27/02	AEI	NS	NS	NS	NS	NS
	3/25/03	AEI	ND<0.5	ND<0.5	ND<0.5	ND<0.5	ND<0.5
	10/2/03	AEI	NS	NS	NS	NS	NS
	10/17/06	AEI	ND<0.5	ND<0.5	ND<0.5	ND<0.5	ND<RL****
	5/3/07	AEI	NS	NS	NS	NS	NS
	10/17/07	AEI	ND<10	ND<10	ND<10	ND<10	ND<RL
	4/1/08	AEI	NS	NS	NS	NS	NS
10/2/08	AEI	ND<1.0	ND<1.0	2.2	ND<1.0	ND<RL	
4/2/09	AEI	NS	NS	NS	NS	NS	
10/2/09	AEI	ND<0.5	ND<0.5	ND<0.5	ND<0.5	ND<RL	
4/9/10	AEI	NS	NS	NS	NS	NS	
10/22/10	AEI	ND<0.5	ND<0.5	ND<0.5	ND<0.5	ND<RL	
5/27/11	Well Destroyed by ARCO; Case Closure at 10600 MacArthur Blvd.						
WGR MW-2 (Shallow)	10/17/06	AEI	ND<0.5	ND<0.5	ND<0.5	ND<0.5	ND<RL
	5/3/07	AEI	NS	NS	NS	NS	NS
	10/17/07	AEI	NS	NS	NS	NS	NS
	4/1/08	AEI	NS	NS	NS	NS	NS
	10/2/08	AEI	NS	NS	NS	NS	NS
	4/2/09	AEI	NS	NS	NS	NS	NS
	10/2/09	AEI	NS	NS	NS	NS	NS
	4/9/10	AEI	NS	NS	NS	NS	NS
	10/22/10	AEI	NS	NS	NS	NS	NS
	5/27/11	AEI	NS	NS	NS	NS	NS
	10/19/11	AEI	NS	NS	NS	NS	NS
	4/30/12	AEI	NS	NS	NS	NS	NS
	4/26/13	AEI	NS	NS	NS	NS	NS
	10/11/13	AEI	NS	NS	NS	NS	NS
	04/16/14	AEI	NS	NS	NS	NS	NS
10/14/14	Well Destroyed during construction activities						
WGR MW-3 (Shallow)	10/17/06	AEI	ND<0.5	ND<0.5	ND<0.5	ND<0.5	ND<RL
	5/3/07	AEI	NS	NS	NS	NS	NS
	10/17/07	AEI	NS	NS	NS	NS	NS
	4/1/08	AEI	NS	NS	NS	NS	NS
	10/2/08	AEI	NS	NS	NS	NS	NS
	4/2/09	AEI	NS	NS	NS	NS	NS
	10/2/09	AEI	NS	NS	NS	NS	NS
	4/9/10	AEI	NS	NS	NS	NS	NS
	10/22/10	AEI	NS	NS	NS	NS	NS
	5/27/11	Well Destroyed by ARCO; Case Closure at 10600 MacArthur Blvd.					

Table 2
Groundwater Sample Analytical Data
10700 MacArthur Blvd., Oakland, California

Well (aquifer zone)	Date	Consultant	cis 1,2 DCE µg/L	trans 1,2 DCE µg/L	PCE µg/L	TCE µg/L	VHCs* µg/L	
WGR MW-4 (deep)	4/16/96	PES	ND<0.5	ND<0.5	ND<0.5	ND<0.5	ND<0.5	
	7/17/96	PES	ND<0.5	ND<0.5	ND<0.5	ND<0.5	ND<0.5	
	10/23/96	PES	ND<0.5	ND<0.5	ND<0.5	ND<0.5	ND<0.5	
	9/29/97	PES	ND<0.5	ND<0.5	ND<0.5	ND<0.5	ND<0.5	
	2/15/01	AEI	ND<0.5	ND<0.5	ND<0.5	ND<0.5	ND<0.5	
	8/29/01	AEI	NS	NS	NS	NS	NS	
	3/12/02	AEI	ND<0.5	ND<0.5	ND<0.5	ND<0.5	ND<0.5	
	9/27/02	AEI	NS	NS	NS	NS	NS	
	3/25/03	AEI	ND<0.5	ND<0.5	ND<0.5	ND<0.5	ND<0.5	
	10/2/03	AEI	NS	NS	NS	NS	NS	
	10/17/06	AEI	ND<0.5	ND<0.5	0.62	ND<0.5	ND<RL	
	5/3/07	AEI	NS	NS	NS	NS	NS	
	10/17/07	AEI	ND<0.5	ND<0.5	ND<0.5	ND<0.5	ND<RL	
	4/1/08	AEI	NS	NS	NS	NS	NS	
	10/2/08	AEI	ND<0.5	ND<0.5	0.55	ND<0.5	ND<RL	
	4/2/09	AEI	NS	NS	NS	NS	NS	
	10/2/09	AEI	ND<0.5	ND<0.5	ND<0.5	ND<0.5	ND<RL	
	4/9/10	AEI	NS	NS	NS	NS	NS	
	10/22/10	AEI	ND<0.5	ND<0.5	ND<0.5	ND<0.5	ND<RL	
	5/27/11	AEI	NS	NS	NS	NS	NS	
10/19/11	AEI	ND<0.5	ND<0.5	ND<0.5	ND<0.5	ND<RL		
4/30/12	AEI	NS	NS	NS	NS	NS		
10/29/12	AEI	ND<0.5	ND<0.5	ND<0.5	ND<0.5	ND<RL		
04/26/13	AEI	Well Destroyed During Onsite Construction Activities						

Table 2 Notes:
Please refer to the Laboratory Analytical Data for further detailed lab information including Reporting Limits and Dilution Factors
*VHCs = All other chemicals by EPA method 601/8010 or 8260
** Chloroform (trichloromethane) NS = Well not sampled
*** Dibromochloromethane NR = Not Reported
**** Methylene Chloride µg/L = micrograms per liter (parts per billion)
***** bromodichloromethane Tetrachloroethene (PCE)
cis 1,2-Dichloroethene (cis 1,2 DCE) Trichloroethene (TCE)
trans 1,2-Dichloroethene (trans 1,2 DCE)
¹ = Reported by laboratory without letters FHS as prefix
² = Vinyl Chloride detected at a concentration of 1.9 ug/L
³ = Vinyl Chloride detected at a concentration of 2.0 ug/L
⁴ = Vinyl Chloride detected at a concentration of 0.66 ug/L
⁵ = Vinyl Chloride detected at a concentration of 4.0 ug/L
⁶ = Vinyl Chloride detected at a concentration of 11 ug/L
⁷ = Chloroform detected at a concentration of 0.69 ug/L
⁸ = Chloroform detected at a concentration of 0.64 ug/L
⁹ = Chloroform detected at a concentration of 1.2 ug/L
¹⁰ = Chloroform detected at a concentration of 8.3 ug/L
¹¹ = Chloroform detected at a concentration of 0.76 ug/L
* Available data from AMW-7 is presented although this well was covered during 1999 construction activities
RL = Reporting Limit

APPENDIX A

GROUNDWATER MONITORING WELL FIELD SAMPLING FORMS

AEI CONSULTANTS
GROUNDWATER MONITORING WELL FIELD SAMPLING FORM

Monitoring Well Number: AMW-1

Project Name:	Foothill Square	Date of Sampling:	5/7/2015
Job Number:	261829	Name of Sampler:	J. Sigg
Project Address:	10700 MacArthur Blvd., Oakland		

MONITORING WELL DATA

Well Casing Diameter (2"/4"/6")	2		
Wellhead Condition	OK ▼		
Elevation of Top of Casing (feet above msl)	64.51		
Depth of Well	45.00		
Depth to Water (from top of casing)	24.01		
Water Elevation (feet above msl)	40.50		
Well Volumes Purged	3		
Gallons Purged: formula valid only for casing sizes of 2" (.16 gal/ft), 4" (.65 gal/ft), and 6" (1.44 gal/ft)	10.1		
Actual Volume Purged (gallons)	10.0		
Appearance of Purge Water	clear		
Free Product Present?	na	Thickness (ft):	-

GROUNDWATER SAMPLES

Number of Samples/Container Size				3-VOAs			
Time	Vol Removed (gal)	Temperature (deg C)	pH	Conductivity (μ sec/cm)	DO (mg/L)	ORP (meV)	Comments
6:34	2	20.78	7.58	1,295	2.95	-121.5	
	4	20.81	7.55	1,287	2.62	-117.3	
	6	20.83	7.53	1,280	1.95	-110.4	
6:40	8	20.83	7.57	1,293	1.63	-107.2	
	10	20.85	7.55	1,287	1.42	-105.1	

COMMENTS (i.e., sample odor, well recharge time & percent, etc.)

AEI CONSULTANTS
GROUNDWATER MONITORING WELL FIELD SAMPLING FORM

Monitoring Well Number: AMW-6R

Project Name:	Foothill Square	Date of Sampling:	5/7/2015
Job Number:	261829	Name of Sampler:	J. Sigg
Project Address:	10700 MacArthur Blvd., Oakland		

MONITORING WELL DATA

Well Casing Diameter (2"/4"/6")	2		
Wellhead Condition	OK <input type="button" value="▼"/>		
Elevation of Top of Casing (feet above msl)			
Depth of Well	23.00		
Depth to Water (from top of casing)	15.82		
Water Elevation (feet above msl)	7.18		
Well Volumes Purged	3		
Gallons Purged: formula valid only for casing sizes of 2" (.16 gal/ft), 4" (.65 gal/ft), and 6" (1.44 gal/ft)	3.4		
Actual Volume Purged (gallons)	3.0		
Appearance of Purge Water	Clear		
Free Product Present?	na	Thickness (ft):	-

GROUNDWATER SAMPLES

Number of Samples/Container Size				3 VOAs			
Time	Vol Removed (gal)	Temperature (deg C)	pH	Conductivity (μ sec/cm)	DO (mg/L)	ORP (meV)	Comments
7:08	1	21.05	7.65	1,384	3.73	-171.8	
	2	21.13	7.67	1,362	2.35	-168.5	
7:10	3	21.20	7.69	1,357	1.92	-155.4	

COMMENTS (i.e., sample odor, well recharge time & percent, etc.)

Depth to water measurement is an estimation

AEI CONSULTANTS
GROUNDWATER MONITORING WELL FIELD SAMPLING FORM

Monitoring Well Number: AMW-8

Project Name:	Foothill Square	Date of Sampling:	5/7/2015
Job Number:	261829	Name of Sampler:	J. Sigg
Project Address:	10700 MacArthur Blvd., Oakland		

MONITORING WELL DATA

Well Casing Diameter (2"/4"/6")	2		
Wellhead Condition	OK ▼		
Elevation of Top of Casing (feet above msl)	64.55		
Depth of Well	45.00		
Depth to Water (from top of casing)	27.57		
Water Elevation (feet above msl)	36.98		
Well Volumes Purged	NA		
Gallons Purged: formula valid only for casing sizes of 2" (.16 gal/ft), 4" (.65 gal/ft), and 6" (1.44 gal/ft)	NA		
Actual Volume Purged (gallons)	NA		
Appearance of Purge Water	NA		
Free Product Present?	na	Thickness (ft):	-

GROUNDWATER SAMPLES

Number of Samples/Container Size				NA			
Time	Vol Removed (gal)	Temperature (deg C)	pH	Conductivity (μ sec/cm)	DO (mg/L)	ORP (meV)	Comments

COMMENTS (i.e., sample odor, well recharge time & percent, etc.)

Well not sampled; Gauged Only.

AEI CONSULTANTS
GROUNDWATER MONITORING WELL FIELD SAMPLING FORM

Monitoring Well Number: AMW-9

Project Name:	Foothill Square	Date of Sampling:	5/7/2015
Job Number:	261829	Name of Sampler:	J. Sigg
Project Address:	10700 MacArthur Blvd., Oakland		

MONITORING WELL DATA

Well Casing Diameter (2"/4"/6")	2		
Wellhead Condition	OK		
Elevation of Top of Casing (feet above msl)	63.48		
Depth of Well	54.30		
Depth to Water (from top of casing)	25.62		
Water Elevation (feet above msl)	37.86		
Well Volumes Purged	3		
Gallons Purged: formula valid only for casing sizes of 2" (.16 gal/ft), 4" (.65 gal/ft), and 6" (1.44 gal/ft)	13.8		
Actual Volume Purged (gallons)	14.0		
Appearance of Purge Water	Clear		
Free Product Present?	na	Thickness (ft):	-

GROUNDWATER SAMPLES

Number of Samples/Container Size				3 VOAs			
Time	Vol Removed (gal)	Temperature (deg C)	pH	Conductivity (μ sec/cm)	DO (mg/L)	ORP (meV)	Comments
6:02	3	20.84	7.22	1,024	3.25	205.4	
	6	20.92	7.70	1,038	2.95	199.1	
	9	20.97	7.68	1,041	2.64	190.7	
6:10	12	21.04	7.68	1,044	2.07	183.2	
	14	21.02	7.67	1,039	1.83	179.6	

COMMENTS (i.e., sample odor, well recharge time & percent, etc.)

--

AEI CONSULTANTS
GROUNDWATER MONITORING WELL FIELD SAMPLING FORM

Monitoring Well Number: FHS MW-10

Project Name:	Foothill Square	Date of Sampling:	5/7/2015
Job Number:	261829	Name of Sampler:	J. Sigg
Project Address:	10700 MacArthur Blvd., Oakland		

MONITORING WELL DATA

Well Casing Diameter (2"/4"/6")	2		
Wellhead Condition	OK		
Elevation of Top of Casing (feet above msl)	52.34		
Depth of Well	51.94		
Depth to Water (from top of casing)	26.79		
Water Elevation (feet above msl)	25.55		
Well Volumes Purged	3		
Gallons Purged: formula valid only for casing sizes of 2" (.16 gal/ft), 4" (.65 gal/ft), and 6" (1.44 gal/ft)	12.1		
Actual Volume Purged (gallons)	12.0		
Appearance of Purge Water	Clear		
Free Product Present?	n/a	Thickness (ft):	-

GROUNDWATER SAMPLES

Number of Samples/Container Size				3 VOAs			
Time	Vol Removed (gal)	Temperature (deg C)	pH	Conductivity (μ sec/cm)	DO (mg/L)	ORP (meV)	Comments
4:58	3	21.42	7.73	1217	2.94	-172.4	
	6	21.38	7.70	1210	2.71	-168.6	
	9	21.30	7.70	1207	2.43	-163.2	
5:05	12	21.24	7.68	1192	2.21	-159.7	

COMMENTS (i.e., sample odor, well recharge time & percent, etc.)

--

AEI CONSULTANTS
GROUNDWATER MONITORING WELL FIELD SAMPLING FORM

Monitoring Well Number: FHS MW-11

Project Name:	Foothill Square	Date of Sampling:	5/7/2015
Job Number:	261829	Name of Sampler:	J. Sigg
Project Address:	10700 MacArthur Blvd., Oakland		

MONITORING WELL DATA

Well Casing Diameter (2"/4"/6")	2		
Wellhead Condition	OK		
Elevation of Top of Casing (feet above msl)	54.06		
Depth of Well	64.07		
Depth to Water (from top of casing)	27.95		
Water Elevation (feet above msl)	26.11		
Well Volumes Purged	3		
Gallons Purged: formula valid only for casing sizes of 2" (.16 gal/ft), 4" (.65 gal/ft), and 6" (1.44 gal/ft)	17.3		
Actual Volume Purged (gallons)	17.0		
Appearance of Purge Water	Clear		
Free Product Present?	na	Thickness (ft):	-

GROUNDWATER SAMPLES

Number of Samples/Container Size				3 VOAs			
Time	Vol Removed (gal)	Temperature (deg C)	pH	Conductivity (μ sec/cm)	DO (mg/L)	ORP (meV)	Comments
5:28	5	21.49	7.62	1024	3.90	-165.2	
	10	21.40	7.60	1017	3.17	-160.7	
	15	21.37	7.56	1011	2.73	-152.3	
5:40	17	21.32	7.54	1009	2.37	-147.8	

COMMENTS (i.e., sample odor, well recharge time & percent, etc.)

--

APPENDIX B

LABORATORY ANALYSES WITH CHAIN OF CUSTODY DOCUMENTATION



McC Campbell Analytical, Inc.

"When Quality Counts"

Analytical Report

WorkOrder: 1505281

Report Created for: AEI Consultants

2500 Camino Diablo, Ste.#200
Walnut Creek, CA 94597

Project Contact: Jeremy Smith

Project P.O.: 82769

Project Name: #261829; Foothill Square

Project Received: 05/07/2015

Analytical Report reviewed & approved for release on 05/13/2015 by:

Angela Rydelius,
Laboratory Manager

The report shall not be reproduced except in full, without the written approval of the laboratory. The analytical results relate only to the items tested. Results reported conform to the most current NELAP standards, where applicable, unless otherwise stated in the case narrative.





Glossary of Terms & Qualifier Definitions

Client: AEI Consultants
Project: #261829; Foothill Square
WorkOrder: 1505281

Glossary Abbreviation

95% Interval	95% Confident Interval
DF	Dilution Factor
DI WET	(DISTLC) Waste Extraction Test using DI water
DISS	Dissolved (direct analysis of 0.45 µm filtered and acidified water sample)
DUP	Duplicate
EDL	Estimated Detection Limit
ITEF	International Toxicity Equivalence Factor
LCS	Laboratory Control Sample
MB	Method Blank
MB % Rec	% Recovery of Surrogate in Method Blank, if applicable
MDL	Method Detection Limit
ML	Minimum Level of Quantitation
MS	Matrix Spike
MSD	Matrix Spike Duplicate
N/A	Not Applicable
ND	Not detected at or above the indicated MDL or RL
NR	Data Not Reported due to matrix interference or insufficient sample amount.
PF	Prep Factor
RD	Relative Difference
RL	Reporting Limit (The RL is the lowest calibration standard in a multipoint calibration.)
RPD	Relative Percent Deviation
RRT	Relative Retention Time
SPK Val	Spike Value
SPKRef Val	Spike Reference Value
SPLP	Synthetic Precipitation Leachate Procedure
TCLP	Toxicity Characteristic Leachate Procedure
TEQ	Toxicity Equivalents
WET (STLC)	Waste Extraction Test (Soluble Threshold Limit Concentration)

Quality Control Qualifiers

F2 LCS recovery for this compound is outside of acceptance limits.



Analytical Report

Client: AEI Consultants
Project: #261829; Foothill Square
Date Received: 5/7/15 20:52
Date Prepared: 5/12/15

WorkOrder: 1505281
Extraction Method: SW5030B
Analytical Method: SW8260B
Unit: µg/L

Halogenated Volatile Organics by P&T and GC-MS (8010 Basic Target List)

Client ID	Lab ID	Matrix/ExtType	Date Collected	Instrument	Batch ID
AMW-1	1505281-001A	Water	05/07/2015 06:45	GC28	104711

Analytes	Result	RL	DF	Date Analyzed
Bromobenzene	ND	0.50	1	05/12/2015 05:07
Bromochloromethane	ND	0.50	1	05/12/2015 05:07
Bromodichloromethane	ND	0.50	1	05/12/2015 05:07
Bromoform	ND	0.50	1	05/12/2015 05:07
Bromomethane	ND	0.50	1	05/12/2015 05:07
Carbon Tetrachloride	ND	0.50	1	05/12/2015 05:07
Chlorobenzene	ND	0.50	1	05/12/2015 05:07
Chloroethane	ND	0.50	1	05/12/2015 05:07
Chloroform	ND	0.50	1	05/12/2015 05:07
Chloromethane	ND	0.50	1	05/12/2015 05:07
2-Chlorotoluene	ND	0.50	1	05/12/2015 05:07
4-Chlorotoluene	ND	0.50	1	05/12/2015 05:07
Dibromochloromethane	ND	0.50	1	05/12/2015 05:07
1,2-Dibromo-3-chloropropane	ND	0.20	1	05/12/2015 05:07
1,2-Dibromoethane (EDB)	ND	0.50	1	05/12/2015 05:07
Dibromomethane	ND	0.50	1	05/12/2015 05:07
1,2-Dichlorobenzene	ND	0.50	1	05/12/2015 05:07
1,3-Dichlorobenzene	ND	0.50	1	05/12/2015 05:07
1,4-Dichlorobenzene	ND	0.50	1	05/12/2015 05:07
Dichlorodifluoromethane	ND	0.50	1	05/12/2015 05:07
1,1-Dichloroethane	ND	0.50	1	05/12/2015 05:07
1,2-Dichloroethane (1,2-DCA)	ND	0.50	1	05/12/2015 05:07
1,1-Dichloroethene	ND	0.50	1	05/12/2015 05:07
cis-1,2-Dichloroethene	ND	0.50	1	05/12/2015 05:07
trans-1,2-Dichloroethene	ND	0.50	1	05/12/2015 05:07
1,2-Dichloropropane	ND	0.50	1	05/12/2015 05:07
1,3-Dichloropropane	ND	0.50	1	05/12/2015 05:07
2,2-Dichloropropane	ND	0.50	1	05/12/2015 05:07
1,1-Dichloropropene	ND	0.50	1	05/12/2015 05:07
cis-1,3-Dichloropropene	ND	0.50	1	05/12/2015 05:07
trans-1,3-Dichloropropene	ND	0.50	1	05/12/2015 05:07
Freon 113	ND	0.50	1	05/12/2015 05:07
Hexachlorobutadiene	ND	0.50	1	05/12/2015 05:07
Hexachloroethane	ND	0.50	1	05/12/2015 05:07
Methylene chloride	ND	0.50	1	05/12/2015 05:07
1,1,1,2-Tetrachloroethane	ND	0.50	1	05/12/2015 05:07
1,1,2,2-Tetrachloroethane	ND	0.50	1	05/12/2015 05:07
Tetrachloroethene	0.50	0.50	1	05/12/2015 05:07

(Cont.)



Analytical Report

Client: AEI Consultants
Project: #261829; Foothill Square
Date Received: 5/7/15 20:52
Date Prepared: 5/12/15

WorkOrder: 1505281
Extraction Method: SW5030B
Analytical Method: SW8260B
Unit: µg/L

Halogenated Volatile Organics by P&T and GC-MS (8010 Basic Target List)

Client ID	Lab ID	Matrix/ExtType	Date Collected	Instrument	Batch ID
AMW-1	1505281-001A	Water	05/07/2015 06:45	GC28	104711

Analytes	Result	RL	DF	Date Analyzed
1,2,3-Trichlorobenzene	ND	0.50	1	05/12/2015 05:07
1,2,4-Trichlorobenzene	ND	0.50	1	05/12/2015 05:07
1,1,1-Trichloroethane	ND	0.50	1	05/12/2015 05:07
1,1,2-Trichloroethane	ND	0.50	1	05/12/2015 05:07
Trichloroethene	ND	0.50	1	05/12/2015 05:07
Trichlorofluoromethane	ND	0.50	1	05/12/2015 05:07
1,2,3-Trichloropropane	ND	0.50	1	05/12/2015 05:07
Vinyl Chloride	ND	0.50	1	05/12/2015 05:07

Surrogates	REC (%)	Limits	Date Analyzed
Dibromofluoromethane	114	72-117	05/12/2015 05:07
Toluene-d8	106	73-131	05/12/2015 05:07
4-BFB	101	74-116	05/12/2015 05:07

Analyst(s): KF



Analytical Report

Client: AEI Consultants
Project: #261829; Foothill Square
Date Received: 5/7/15 20:52
Date Prepared: 5/12/15

WorkOrder: 1505281
Extraction Method: SW5030B
Analytical Method: SW8260B
Unit: µg/L

Halogenated Volatile Organics by P&T and GC-MS (8010 Basic Target List)

Client ID	Lab ID	Matrix/ExtType	Date Collected	Instrument	Batch ID
AMW-6R	1505281-002A	Water	05/07/2015 07:15	GC28	104779

Analytes	Result	RL	DF	Date Analyzed
Bromobenzene	ND	25	50	05/12/2015 21:03
Bromochloromethane	ND	25	50	05/12/2015 21:03
Bromodichloromethane	ND	25	50	05/12/2015 21:03
Bromoform	ND	25	50	05/12/2015 21:03
Bromomethane	ND	25	50	05/12/2015 21:03
Carbon Tetrachloride	ND	25	50	05/12/2015 21:03
Chlorobenzene	ND	25	50	05/12/2015 21:03
Chloroethane	ND	25	50	05/12/2015 21:03
Chloroform	ND	25	50	05/12/2015 21:03
Chloromethane	ND	25	50	05/12/2015 21:03
2-Chlorotoluene	ND	25	50	05/12/2015 21:03
4-Chlorotoluene	ND	25	50	05/12/2015 21:03
Dibromochloromethane	ND	25	50	05/12/2015 21:03
1,2-Dibromo-3-chloropropane	ND	10	50	05/12/2015 21:03
1,2-Dibromoethane (EDB)	ND	25	50	05/12/2015 21:03
Dibromomethane	ND	25	50	05/12/2015 21:03
1,2-Dichlorobenzene	ND	25	50	05/12/2015 21:03
1,3-Dichlorobenzene	ND	25	50	05/12/2015 21:03
1,4-Dichlorobenzene	ND	25	50	05/12/2015 21:03
Dichlorodifluoromethane	ND	25	50	05/12/2015 21:03
1,1-Dichloroethane	ND	25	50	05/12/2015 21:03
1,2-Dichloroethane (1,2-DCA)	ND	25	50	05/12/2015 21:03
1,1-Dichloroethene	ND	25	50	05/12/2015 21:03
cis-1,2-Dichloroethene	120	25	50	05/12/2015 21:03
trans-1,2-Dichloroethene	ND	25	50	05/12/2015 21:03
1,2-Dichloropropane	ND	25	50	05/12/2015 21:03
1,3-Dichloropropane	ND	25	50	05/12/2015 21:03
2,2-Dichloropropane	ND	25	50	05/12/2015 21:03
1,1-Dichloropropene	ND	25	50	05/12/2015 21:03
cis-1,3-Dichloropropene	ND	25	50	05/12/2015 21:03
trans-1,3-Dichloropropene	ND	25	50	05/12/2015 21:03
Freon 113	ND	25	50	05/12/2015 21:03
Hexachlorobutadiene	ND	25	50	05/12/2015 21:03
Hexachloroethane	ND	25	50	05/12/2015 21:03
Methylene chloride	ND	25	50	05/12/2015 21:03
1,1,1,2-Tetrachloroethane	ND	25	50	05/12/2015 21:03
1,1,2,2-Tetrachloroethane	ND	25	50	05/12/2015 21:03
Tetrachloroethene	690	25	50	05/12/2015 21:03

(Cont.)



Analytical Report

Client: AEI Consultants
Project: #261829; Foothill Square
Date Received: 5/7/15 20:52
Date Prepared: 5/12/15

WorkOrder: 1505281
Extraction Method: SW5030B
Analytical Method: SW8260B
Unit: µg/L

Halogenated Volatile Organics by P&T and GC-MS (8010 Basic Target List)

Client ID	Lab ID	Matrix/ExtType	Date Collected	Instrument	Batch ID
AMW-6R	1505281-002A	Water	05/07/2015 07:15	GC28	104779

Analytes	Result	RL	DF	Date Analyzed
1,2,3-Trichlorobenzene	ND	25	50	05/12/2015 21:03
1,2,4-Trichlorobenzene	ND	25	50	05/12/2015 21:03
1,1,1-Trichloroethane	ND	25	50	05/12/2015 21:03
1,1,2-Trichloroethane	ND	25	50	05/12/2015 21:03
Trichloroethene	140	25	50	05/12/2015 21:03
Trichlorofluoromethane	ND	25	50	05/12/2015 21:03
1,2,3-Trichloropropane	ND	25	50	05/12/2015 21:03
Vinyl Chloride	ND	25	50	05/12/2015 21:03

Surrogates	REC (%)	Limits	Date Analyzed
Dibromofluoromethane	110	72-117	05/12/2015 21:03
Toluene-d8	109	73-131	05/12/2015 21:03
4-BFB	99	74-116	05/12/2015 21:03

Analyst(s): KF



Analytical Report

Client: AEI Consultants
Project: #261829; Foothill Square
Date Received: 5/7/15 20:52
Date Prepared: 5/12/15

WorkOrder: 1505281
Extraction Method: SW5030B
Analytical Method: SW8260B
Unit: µg/L

Halogenated Volatile Organics by P&T and GC-MS (8010 Basic Target List)

Client ID	Lab ID	Matrix/ExtType	Date Collected	Instrument	Batch ID
AMW-9	1505281-003A	Water	05/07/2015 06:15	GC28	104779

Analytes	Result	RL	DF	Date Analyzed
Bromobenzene	ND	0.50	1	05/12/2015 21:40
Bromochloromethane	ND	0.50	1	05/12/2015 21:40
Bromodichloromethane	ND	0.50	1	05/12/2015 21:40
Bromoform	ND	0.50	1	05/12/2015 21:40
Bromomethane	ND	0.50	1	05/12/2015 21:40
Carbon Tetrachloride	ND	0.50	1	05/12/2015 21:40
Chlorobenzene	ND	0.50	1	05/12/2015 21:40
Chloroethane	ND	0.50	1	05/12/2015 21:40
Chloroform	ND	0.50	1	05/12/2015 21:40
Chloromethane	ND	0.50	1	05/12/2015 21:40
2-Chlorotoluene	ND	0.50	1	05/12/2015 21:40
4-Chlorotoluene	ND	0.50	1	05/12/2015 21:40
Dibromochloromethane	ND	0.50	1	05/12/2015 21:40
1,2-Dibromo-3-chloropropane	ND	0.20	1	05/12/2015 21:40
1,2-Dibromoethane (EDB)	ND	0.50	1	05/12/2015 21:40
Dibromomethane	ND	0.50	1	05/12/2015 21:40
1,2-Dichlorobenzene	ND	0.50	1	05/12/2015 21:40
1,3-Dichlorobenzene	ND	0.50	1	05/12/2015 21:40
1,4-Dichlorobenzene	ND	0.50	1	05/12/2015 21:40
Dichlorodifluoromethane	ND	0.50	1	05/12/2015 21:40
1,1-Dichloroethane	ND	0.50	1	05/12/2015 21:40
1,2-Dichloroethane (1,2-DCA)	ND	0.50	1	05/12/2015 21:40
1,1-Dichloroethene	ND	0.50	1	05/12/2015 21:40
cis-1,2-Dichloroethene	ND	0.50	1	05/12/2015 21:40
trans-1,2-Dichloroethene	ND	0.50	1	05/12/2015 21:40
1,2-Dichloropropane	ND	0.50	1	05/12/2015 21:40
1,3-Dichloropropane	ND	0.50	1	05/12/2015 21:40
2,2-Dichloropropane	ND	0.50	1	05/12/2015 21:40
1,1-Dichloropropene	ND	0.50	1	05/12/2015 21:40
cis-1,3-Dichloropropene	ND	0.50	1	05/12/2015 21:40
trans-1,3-Dichloropropene	ND	0.50	1	05/12/2015 21:40
Freon 113	ND	0.50	1	05/12/2015 21:40
Hexachlorobutadiene	ND	0.50	1	05/12/2015 21:40
Hexachloroethane	ND	0.50	1	05/12/2015 21:40
Methylene chloride	ND	0.50	1	05/12/2015 21:40
1,1,1,2-Tetrachloroethane	ND	0.50	1	05/12/2015 21:40
1,1,2,2-Tetrachloroethane	ND	0.50	1	05/12/2015 21:40
Tetrachloroethene	15	0.50	1	05/12/2015 21:40

(Cont.)



Analytical Report

Client: AEI Consultants
Project: #261829; Foothill Square
Date Received: 5/7/15 20:52
Date Prepared: 5/12/15

WorkOrder: 1505281
Extraction Method: SW5030B
Analytical Method: SW8260B
Unit: µg/L

Halogenated Volatile Organics by P&T and GC-MS (8010 Basic Target List)

Client ID	Lab ID	Matrix/ExtType	Date Collected	Instrument	Batch ID
AMW-9	1505281-003A	Water	05/07/2015 06:15	GC28	104779

Analytes	Result	RL	DF	Date Analyzed
1,2,3-Trichlorobenzene	ND	0.50	1	05/12/2015 21:40
1,2,4-Trichlorobenzene	ND	0.50	1	05/12/2015 21:40
1,1,1-Trichloroethane	ND	0.50	1	05/12/2015 21:40
1,1,2-Trichloroethane	ND	0.50	1	05/12/2015 21:40
Trichloroethene	ND	0.50	1	05/12/2015 21:40
Trichlorofluoromethane	ND	0.50	1	05/12/2015 21:40
1,2,3-Trichloropropane	ND	0.50	1	05/12/2015 21:40
Vinyl Chloride	ND	0.50	1	05/12/2015 21:40

Surrogates	REC (%)	Limits	Date Analyzed
Dibromofluoromethane	110	72-117	05/12/2015 21:40
Toluene-d8	110	73-131	05/12/2015 21:40
4-BFB	101	74-116	05/12/2015 21:40

Analyst(s): KF



Analytical Report

Client: AEI Consultants
Project: #261829; Foothill Square
Date Received: 5/7/15 20:52
Date Prepared: 5/12/15

WorkOrder: 1505281
Extraction Method: SW5030B
Analytical Method: SW8260B
Unit: µg/L

Halogenated Volatile Organics by P&T and GC-MS (8010 Basic Target List)

Client ID	Lab ID	Matrix/ExtType	Date Collected	Instrument	Batch ID
FHS MW-10	1505281-004A	Water	05/07/2015 05:10	GC28	104779

Analytes	Result	RL	DF	Date Analyzed
Bromobenzene	ND	0.50	1	05/12/2015 16:01
Bromochloromethane	ND	0.50	1	05/12/2015 16:01
Bromodichloromethane	ND	0.50	1	05/12/2015 16:01
Bromoform	ND	0.50	1	05/12/2015 16:01
Bromomethane	ND	0.50	1	05/12/2015 16:01
Carbon Tetrachloride	ND	0.50	1	05/12/2015 16:01
Chlorobenzene	ND	0.50	1	05/12/2015 16:01
Chloroethane	ND	0.50	1	05/12/2015 16:01
Chloroform	ND	0.50	1	05/12/2015 16:01
Chloromethane	ND	0.50	1	05/12/2015 16:01
2-Chlorotoluene	ND	0.50	1	05/12/2015 16:01
4-Chlorotoluene	ND	0.50	1	05/12/2015 16:01
Dibromochloromethane	ND	0.50	1	05/12/2015 16:01
1,2-Dibromo-3-chloropropane	ND	0.20	1	05/12/2015 16:01
1,2-Dibromoethane (EDB)	ND	0.50	1	05/12/2015 16:01
Dibromomethane	ND	0.50	1	05/12/2015 16:01
1,2-Dichlorobenzene	ND	0.50	1	05/12/2015 16:01
1,3-Dichlorobenzene	ND	0.50	1	05/12/2015 16:01
1,4-Dichlorobenzene	ND	0.50	1	05/12/2015 16:01
Dichlorodifluoromethane	ND	0.50	1	05/12/2015 16:01
1,1-Dichloroethane	ND	0.50	1	05/12/2015 16:01
1,2-Dichloroethane (1,2-DCA)	ND	0.50	1	05/12/2015 16:01
1,1-Dichloroethene	ND	0.50	1	05/12/2015 16:01
cis-1,2-Dichloroethene	ND	0.50	1	05/12/2015 16:01
trans-1,2-Dichloroethene	ND	0.50	1	05/12/2015 16:01
1,2-Dichloropropane	ND	0.50	1	05/12/2015 16:01
1,3-Dichloropropane	ND	0.50	1	05/12/2015 16:01
2,2-Dichloropropane	ND	0.50	1	05/12/2015 16:01
1,1-Dichloropropene	ND	0.50	1	05/12/2015 16:01
cis-1,3-Dichloropropene	ND	0.50	1	05/12/2015 16:01
trans-1,3-Dichloropropene	ND	0.50	1	05/12/2015 16:01
Freon 113	ND	0.50	1	05/12/2015 16:01
Hexachlorobutadiene	ND	0.50	1	05/12/2015 16:01
Hexachloroethane	ND	0.50	1	05/12/2015 16:01
Methylene chloride	ND	0.50	1	05/12/2015 16:01
1,1,1,2-Tetrachloroethane	ND	0.50	1	05/12/2015 16:01
1,1,2,2-Tetrachloroethane	ND	0.50	1	05/12/2015 16:01
Tetrachloroethene	ND	0.50	1	05/12/2015 16:01

(Cont.)



Analytical Report

Client: AEI Consultants
Project: #261829; Foothill Square
Date Received: 5/7/15 20:52
Date Prepared: 5/12/15

WorkOrder: 1505281
Extraction Method: SW5030B
Analytical Method: SW8260B
Unit: µg/L

Halogenated Volatile Organics by P&T and GC-MS (8010 Basic Target List)

Client ID	Lab ID	Matrix/ExtType	Date Collected	Instrument	Batch ID
FHS MW-10	1505281-004A	Water	05/07/2015 05:10	GC28	104779

Analytes	Result	RL	DF	Date Analyzed
1,2,3-Trichlorobenzene	ND	0.50	1	05/12/2015 16:01
1,2,4-Trichlorobenzene	ND	0.50	1	05/12/2015 16:01
1,1,1-Trichloroethane	ND	0.50	1	05/12/2015 16:01
1,1,2-Trichloroethane	ND	0.50	1	05/12/2015 16:01
Trichloroethene	ND	0.50	1	05/12/2015 16:01
Trichlorofluoromethane	ND	0.50	1	05/12/2015 16:01
1,2,3-Trichloropropane	ND	0.50	1	05/12/2015 16:01
Vinyl Chloride	ND	0.50	1	05/12/2015 16:01

Surrogates	REC (%)	Limits	Date Analyzed
Dibromofluoromethane	115	72-117	05/12/2015 16:01
Toluene-d8	104	73-131	05/12/2015 16:01
4-BFB	99	74-116	05/12/2015 16:01

Analyst(s): KF



Analytical Report

Client: AEI Consultants
Project: #261829; Foothill Square
Date Received: 5/7/15 20:52
Date Prepared: 5/12/15

WorkOrder: 1505281
Extraction Method: SW5030B
Analytical Method: SW8260B
Unit: µg/L

Halogenated Volatile Organics by P&T and GC-MS (8010 Basic Target List)

Client ID	Lab ID	Matrix/ExtType	Date Collected	Instrument	Batch ID
FHS MW-11	1505281-005A	Water	05/07/2015 05:45	GC28	104779

Analytes	Result	RL	DF	Date Analyzed
Bromobenzene	ND	0.50	1	05/12/2015 16:38
Bromochloromethane	ND	0.50	1	05/12/2015 16:38
Bromodichloromethane	ND	0.50	1	05/12/2015 16:38
Bromoform	ND	0.50	1	05/12/2015 16:38
Bromomethane	ND	0.50	1	05/12/2015 16:38
Carbon Tetrachloride	ND	0.50	1	05/12/2015 16:38
Chlorobenzene	ND	0.50	1	05/12/2015 16:38
Chloroethane	ND	0.50	1	05/12/2015 16:38
Chloroform	0.76	0.50	1	05/12/2015 16:38
Chloromethane	ND	0.50	1	05/12/2015 16:38
2-Chlorotoluene	ND	0.50	1	05/12/2015 16:38
4-Chlorotoluene	ND	0.50	1	05/12/2015 16:38
Dibromochloromethane	ND	0.50	1	05/12/2015 16:38
1,2-Dibromo-3-chloropropane	ND	0.20	1	05/12/2015 16:38
1,2-Dibromoethane (EDB)	ND	0.50	1	05/12/2015 16:38
Dibromomethane	ND	0.50	1	05/12/2015 16:38
1,2-Dichlorobenzene	ND	0.50	1	05/12/2015 16:38
1,3-Dichlorobenzene	ND	0.50	1	05/12/2015 16:38
1,4-Dichlorobenzene	ND	0.50	1	05/12/2015 16:38
Dichlorodifluoromethane	ND	0.50	1	05/12/2015 16:38
1,1-Dichloroethane	ND	0.50	1	05/12/2015 16:38
1,2-Dichloroethane (1,2-DCA)	ND	0.50	1	05/12/2015 16:38
1,1-Dichloroethene	ND	0.50	1	05/12/2015 16:38
cis-1,2-Dichloroethene	ND	0.50	1	05/12/2015 16:38
trans-1,2-Dichloroethene	ND	0.50	1	05/12/2015 16:38
1,2-Dichloropropane	ND	0.50	1	05/12/2015 16:38
1,3-Dichloropropane	ND	0.50	1	05/12/2015 16:38
2,2-Dichloropropane	ND	0.50	1	05/12/2015 16:38
1,1-Dichloropropene	ND	0.50	1	05/12/2015 16:38
cis-1,3-Dichloropropene	ND	0.50	1	05/12/2015 16:38
trans-1,3-Dichloropropene	ND	0.50	1	05/12/2015 16:38
Freon 113	ND	0.50	1	05/12/2015 16:38
Hexachlorobutadiene	ND	0.50	1	05/12/2015 16:38
Hexachloroethane	ND	0.50	1	05/12/2015 16:38
Methylene chloride	ND	0.50	1	05/12/2015 16:38
1,1,1,2-Tetrachloroethane	ND	0.50	1	05/12/2015 16:38
1,1,2,2-Tetrachloroethane	ND	0.50	1	05/12/2015 16:38
Tetrachloroethene	ND	0.50	1	05/12/2015 16:38

(Cont.)



Analytical Report

Client: AEI Consultants
Project: #261829; Foothill Square
Date Received: 5/7/15 20:52
Date Prepared: 5/12/15

WorkOrder: 1505281
Extraction Method: SW5030B
Analytical Method: SW8260B
Unit: µg/L

Halogenated Volatile Organics by P&T and GC-MS (8010 Basic Target List)

Client ID	Lab ID	Matrix/ExtType	Date Collected	Instrument	Batch ID
FHS MW-11	1505281-005A	Water	05/07/2015 05:45	GC28	104779

Analytes	Result	RL	DF	Date Analyzed
1,2,3-Trichlorobenzene	ND	0.50	1	05/12/2015 16:38
1,2,4-Trichlorobenzene	ND	0.50	1	05/12/2015 16:38
1,1,1-Trichloroethane	ND	0.50	1	05/12/2015 16:38
1,1,2-Trichloroethane	ND	0.50	1	05/12/2015 16:38
Trichloroethene	ND	0.50	1	05/12/2015 16:38
Trichlorofluoromethane	ND	0.50	1	05/12/2015 16:38
1,2,3-Trichloropropane	ND	0.50	1	05/12/2015 16:38
Vinyl Chloride	ND	0.50	1	05/12/2015 16:38

Surrogates	REC (%)	Limits	Date Analyzed
Dibromofluoromethane	113	72-117	05/12/2015 16:38
Toluene-d8	104	73-131	05/12/2015 16:38
4-BFB	101	74-116	05/12/2015 16:38

Analyst(s): KF



Quality Control Report

Client: AEI Consultants
Date Prepared: 5/11/15
Date Analyzed: 5/11/15
Instrument: GC28
Matrix: Water
Project: #261829; Foothill Square

WorkOrder: 1505281
BatchID: 104711
Extraction Method: SW5030B
Analytical Method: SW8260B
Unit: µg/L
Sample ID: MB/LCS-104711
 1505168-004CMS/MSD

QC Summary Report for SW8260B

Analyte	MB Result	LCS Result	RL	SPK Val	MB SS %REC	LCS %REC	LCS Limits
Acetone	ND	-	10	-	-	-	-
tert-Amyl methyl ether (TAME)	ND	-	0.50	-	-	-	-
Benzene	ND	-	0.50	-	-	-	-
Bromobenzene	ND	-	0.50	-	-	-	-
Bromochloromethane	ND	-	0.50	-	-	-	-
Bromodichloromethane	ND	-	0.50	-	-	-	-
Bromoform	ND	-	0.50	-	-	-	-
Bromomethane	ND	-	0.50	-	-	-	-
2-Butanone (MEK)	ND	-	2.0	-	-	-	-
t-Butyl alcohol (TBA)	ND	-	2.0	-	-	-	-
n-Butyl benzene	ND	-	0.50	-	-	-	-
sec-Butyl benzene	ND	-	0.50	-	-	-	-
tert-Butyl benzene	ND	-	0.50	-	-	-	-
Carbon Disulfide	ND	-	0.50	-	-	-	-
Carbon Tetrachloride	ND	-	0.50	-	-	-	-
Chlorobenzene	ND	8.77	0.50	10	-	88	43-157
Chloroethane	ND	-	0.50	-	-	-	-
Chloroform	ND	-	0.50	-	-	-	-
Chloromethane	ND	-	0.50	-	-	-	-
2-Chlorotoluene	ND	-	0.50	-	-	-	-
4-Chlorotoluene	ND	-	0.50	-	-	-	-
Dibromochloromethane	ND	-	0.50	-	-	-	-
1,2-Dibromo-3-chloropropane	ND	-	0.20	-	-	-	-
1,2-Dibromoethane (EDB)	ND	9.24	0.50	10	-	92	44-155
Dibromomethane	ND	-	0.50	-	-	-	-
1,2-Dichlorobenzene	ND	-	0.50	-	-	-	-
1,3-Dichlorobenzene	ND	-	0.50	-	-	-	-
1,4-Dichlorobenzene	ND	-	0.50	-	-	-	-
Dichlorodifluoromethane	ND	-	0.50	-	-	-	-
1,1-Dichloroethane	ND	-	0.50	-	-	-	-
1,2-Dichloroethane (1,2-DCA)	ND	9.39	0.50	10	-	94	66-125
1,1-Dichloroethene	ND	9.28	0.50	10	-	93	47-149
cis-1,2-Dichloroethene	ND	-	0.50	-	-	-	-
trans-1,2-Dichloroethene	ND	-	0.50	-	-	-	-
1,2-Dichloropropane	ND	-	0.50	-	-	-	-
1,3-Dichloropropane	ND	-	0.50	-	-	-	-
2,2-Dichloropropane	ND	-	0.50	-	-	-	-
1,1-Dichloropropene	ND	-	0.50	-	-	-	-
cis-1,3-Dichloropropene	ND	-	0.50	-	-	-	-
trans-1,3-Dichloropropene	ND	-	0.50	-	-	-	-

(Cont.)



Quality Control Report

Client: AEI Consultants
Date Prepared: 5/11/15
Date Analyzed: 5/11/15
Instrument: GC28
Matrix: Water
Project: #261829; Foothill Square

WorkOrder: 1505281
BatchID: 104711
Extraction Method: SW5030B
Analytical Method: SW8260B
Unit: µg/L
Sample ID: MB/LCS-104711
 1505168-004CMS/MSD

QC Summary Report for SW8260B

Analyte	MB Result	LCS Result	RL	SPK Val	MB SS %REC	LCS %REC	LCS Limits
Diisopropyl ether (DIPE)	ND	-	0.50	-	-	-	-
Ethylbenzene	ND	-	0.50	-	-	-	-
Ethyl tert-butyl ether (ETBE)	ND	-	0.50	-	-	-	-
Freon 113	ND	-	0.50	-	-	-	-
Hexachlorobutadiene	ND	-	0.50	-	-	-	-
Hexachloroethane	ND	-	0.50	-	-	-	-
2-Hexanone	ND	-	0.50	-	-	-	-
Isopropylbenzene	ND	-	0.50	-	-	-	-
4-Isopropyl toluene	ND	-	0.50	-	-	-	-
Methyl-t-butyl ether (MTBE)	ND	-	0.50	-	-	-	-
Methylene chloride	ND	-	0.50	-	-	-	-
4-Methyl-2-pentanone (MIBK)	ND	-	0.50	-	-	-	-
Naphthalene	ND	-	0.50	-	-	-	-
n-Propyl benzene	ND	-	0.50	-	-	-	-
Styrene	ND	-	0.50	-	-	-	-
1,1,1,2-Tetrachloroethane	ND	-	0.50	-	-	-	-
1,1,2,2-Tetrachloroethane	ND	-	0.50	-	-	-	-
Tetrachloroethene	ND	-	0.50	-	-	-	-
Toluene	ND	-	0.50	-	-	-	-
1,2,3-Trichlorobenzene	ND	-	0.50	-	-	-	-
1,2,4-Trichlorobenzene	ND	-	0.50	-	-	-	-
1,1,1-Trichloroethane	ND	-	0.50	-	-	-	-
1,1,2-Trichloroethane	ND	-	0.50	-	-	-	-
Trichloroethene	ND	8.96	0.50	10	-	90	43-157
Trichlorofluoromethane	ND	-	0.50	-	-	-	-
1,2,3-Trichloropropane	ND	-	0.50	-	-	-	-
1,2,4-Trimethylbenzene	ND	-	0.50	-	-	-	-
1,3,5-Trimethylbenzene	ND	-	0.50	-	-	-	-
Vinyl Chloride	ND	-	0.50	-	-	-	-
Xylenes, Total	ND	-	0.50	-	-	-	-

Surrogate Recovery

Dibromofluoromethane	27.4	27.5		25	110	110	65-135
Toluene-d8	27.0	27.5		25	108	110	64-127
4-BFB	2.61	2.56		2.5	104	102	59-139

(Cont.)



Quality Control Report

Client: AEI Consultants
Date Prepared: 5/11/15
Date Analyzed: 5/11/15
Instrument: GC28
Matrix: Water
Project: #261829; Foothill Square

WorkOrder: 1505281
BatchID: 104711
Extraction Method: SW5030B
Analytical Method: SW8260B
Unit: µg/L
Sample ID: MB/LCS-104711
 1505168-004CMS/MSD

QC Summary Report for SW8260B

Analyte	MS Result	MSD Result	SPK Val	SPKRef Val	MS %REC	MSD %REC	MS/MSD Limits	RPD	RPD Limit
Chlorobenzene	9.55	9.50	10	ND	95	95	77-120	0	20
1,2-Dibromoethane (EDB)	10.1	10.0	10	ND	101	100	76-135	0.432	20
1,2-Dichloroethane (1,2-DCA)	10.6	10.5	10	ND	106	105	73-139	0.612	20
1,1-Dichloroethene	10.2	10.0	10	ND	102	100	59-140	1.82	20
Trichloroethene	10.6	10.4	10	0.6832	99	97	64-132	1.82	20
Surrogate Recovery									
Dibromofluoromethane	28.0	28.3	25		112	113	73-131	0.990	20
Toluene-d8	27.4	28.0	25		110	112	72-117	2.33	20
4-BFB	2.50	2.56	2.5		100	102	74-116	2.19	20

(Cont.)



Quality Control Report

Client: AEI Consultants
Date Prepared: 5/13/15
Date Analyzed: 5/12/15
Instrument: GC28
Matrix: Water
Project: #261829; Foothill Square

WorkOrder: 1505281
BatchID: 104779
Extraction Method: SW5030B
Analytical Method: SW8260B
Unit: µg/L
Sample ID: MB/LCS-104779
 1505281-004AMS/MSD

QC Summary Report for SW8260B

Analyte	MB Result	LCS Result	RL	SPK Val	MB SS %REC	LCS %REC	LCS Limits
Acetone	ND	-	10	-	-	-	-
tert-Amyl methyl ether (TAME)	ND	-	0.50	-	-	-	-
Benzene	ND	-	0.50	-	-	-	-
Bromobenzene	ND	-	0.50	-	-	-	-
Bromochloromethane	ND	-	0.50	-	-	-	-
Bromodichloromethane	ND	-	0.50	-	-	-	-
Bromoform	ND	-	0.50	-	-	-	-
Bromomethane	ND	-	0.50	-	-	-	-
2-Butanone (MEK)	ND	-	2.0	-	-	-	-
t-Butyl alcohol (TBA)	ND	-	2.0	-	-	-	-
n-Butyl benzene	ND	-	0.50	-	-	-	-
sec-Butyl benzene	ND	-	0.50	-	-	-	-
tert-Butyl benzene	ND	-	0.50	-	-	-	-
Carbon Disulfide	ND	-	0.50	-	-	-	-
Carbon Tetrachloride	ND	-	0.50	-	-	-	-
Chlorobenzene	ND	9.14	0.50	10	-	91	43-157
Chloroethane	ND	-	0.50	-	-	-	-
Chloroform	ND	-	0.50	-	-	-	-
Chloromethane	ND	-	0.50	-	-	-	-
2-Chlorotoluene	ND	-	0.50	-	-	-	-
4-Chlorotoluene	ND	-	0.50	-	-	-	-
Dibromochloromethane	ND	-	0.50	-	-	-	-
1,2-Dibromo-3-chloropropane	ND	-	0.20	-	-	-	-
1,2-Dibromoethane (EDB)	ND	9.51	0.50	10	-	95	44-155
Dibromomethane	ND	-	0.50	-	-	-	-
1,2-Dichlorobenzene	ND	-	0.50	-	-	-	-
1,3-Dichlorobenzene	ND	-	0.50	-	-	-	-
1,4-Dichlorobenzene	ND	-	0.50	-	-	-	-
Dichlorodifluoromethane	ND	-	0.50	-	-	-	-
1,1-Dichloroethane	ND	-	0.50	-	-	-	-
1,2-Dichloroethane (1,2-DCA)	ND	10.2	0.50	10	-	102	66-125
1,1-Dichloroethene	ND	10.3	0.50	10	-	103	47-149
cis-1,2-Dichloroethene	ND	-	0.50	-	-	-	-
trans-1,2-Dichloroethene	ND	-	0.50	-	-	-	-
1,2-Dichloropropane	ND	-	0.50	-	-	-	-
1,3-Dichloropropane	ND	-	0.50	-	-	-	-
2,2-Dichloropropane	ND	-	0.50	-	-	-	-
1,1-Dichloropropene	ND	-	0.50	-	-	-	-
cis-1,3-Dichloropropene	ND	-	0.50	-	-	-	-
trans-1,3-Dichloropropene	ND	-	0.50	-	-	-	-

(Cont.)



Quality Control Report

Client: AEI Consultants
Date Prepared: 5/13/15
Date Analyzed: 5/12/15
Instrument: GC28
Matrix: Water
Project: #261829; Foothill Square

WorkOrder: 1505281
BatchID: 104779
Extraction Method: SW5030B
Analytical Method: SW8260B
Unit: µg/L
Sample ID: MB/LCS-104779
 1505281-004AMS/MSD

QC Summary Report for SW8260B

Analyte	MB Result	LCS Result	RL	SPK Val	MB SS %REC	LCS %REC	LCS Limits
Diisopropyl ether (DIPE)	ND	-	0.50	-	-	-	-
Ethylbenzene	ND	-	0.50	-	-	-	-
Ethyl tert-butyl ether (ETBE)	ND	-	0.50	-	-	-	-
Freon 113	ND	-	0.50	-	-	-	-
Hexachlorobutadiene	ND	-	0.50	-	-	-	-
Hexachloroethane	ND	-	0.50	-	-	-	-
2-Hexanone	ND	-	0.50	-	-	-	-
Isopropylbenzene	ND	-	0.50	-	-	-	-
4-Isopropyl toluene	ND	-	0.50	-	-	-	-
Methyl-t-butyl ether (MTBE)	ND	-	0.50	-	-	-	-
Methylene chloride	ND	-	0.50	-	-	-	-
4-Methyl-2-pentanone (MIBK)	ND	-	0.50	-	-	-	-
Naphthalene	ND	-	0.50	-	-	-	-
n-Propyl benzene	ND	-	0.50	-	-	-	-
Styrene	ND	-	0.50	-	-	-	-
1,1,1,2-Tetrachloroethane	ND	-	0.50	-	-	-	-
1,1,2,2-Tetrachloroethane	ND	-	0.50	-	-	-	-
Tetrachloroethene	ND	-	0.50	-	-	-	-
Toluene	ND	-	0.50	-	-	-	-
1,2,3-Trichlorobenzene	ND	-	0.50	-	-	-	-
1,2,4-Trichlorobenzene	ND	-	0.50	-	-	-	-
1,1,1-Trichloroethane	ND	-	0.50	-	-	-	-
1,1,2-Trichloroethane	ND	-	0.50	-	-	-	-
Trichloroethene	ND	9.89	0.50	10	-	99	43-157
Trichlorofluoromethane	ND	-	0.50	-	-	-	-
1,2,3-Trichloropropane	ND	-	0.50	-	-	-	-
1,2,4-Trimethylbenzene	ND	-	0.50	-	-	-	-
1,3,5-Trimethylbenzene	ND	-	0.50	-	-	-	-
Vinyl Chloride	ND	-	0.50	-	-	-	-
Xylenes, Total	ND	-	0.50	-	-	-	-

Surrogate Recovery

Dibromofluoromethane	28.1	27.9		25	112	112	65-135
Toluene-d8	26.6	27.2		25	106	109	64-127
4-BFB	2.55	2.37		2.5	102	95	59-139

(Cont.)



Quality Control Report

Client: AEI Consultants
Date Prepared: 5/13/15
Date Analyzed: 5/12/15
Instrument: GC28
Matrix: Water
Project: #261829; Foothill Square

WorkOrder: 1505281
BatchID: 104779
Extraction Method: SW5030B
Analytical Method: SW8260B
Unit: µg/L
Sample ID: MB/LCS-104779
 1505281-004AMS/MSD

QC Summary Report for SW8260B

Analyte	MS Result	MSD Result	SPK Val	SPKRef Val	MS %REC	MSD %REC	MS/MSD Limits	RPD	RPD Limit
Chlorobenzene	9.88	10.1	10	ND	99	101	77-120	1.89	20
1,2-Dibromoethane (EDB)	11.0	11.2	10	ND	111	112	76-135	0.930	20
1,2-Dichloroethane (1,2-DCA)	11.4	11.8	10	ND	114	118	73-139	2.84	20
1,1-Dichloroethene	10.9	11.0	10	ND	109	110	59-140	1.01	20
Trichloroethene	10.6	10.8	10	ND	106	108	64-132	1.87	20
Surrogate Recovery									
Dibromofluoromethane	28.4	28.2	25		113	113	73-131	0	20
Toluene-d8	26.6	26.6	25		106	106	72-117	0	20
4-BFB	2.30	2.31	2.5		92	92	74-116	0	20



1534 Willow Pass Rd
Pittsburg, CA 94565-1701
(925) 252-9262

CHAIN-OF-CUSTODY RECORD

WorkOrder: 1505281

ClientCode: AEL

WaterTrax
 WriteOn
 EDF
 Excel
 EQuIS
 Email
 HardCopy
 ThirdParty
 J-flag

Report to:
 Jeremy Smith
 AEI Consultants
 2500 Camino Diablo, Ste.#200
 Walnut Creek, CA 94597
 (925) 283-6000 FAX: (925) 944-2895

Email: jasmith@aeiconsultants.com
 cc/3rd Party:
 PO: 82769
 ProjectNo: #261829; Foothill Square

Bill to:
 Accounts Payable
 AEI Consultants
 2500 Camino Diablo, Ste. #200
 Walnut Creek, CA 94597
 AccountsPayable@AEIConsultants.com

Requested TAT: 5 days

Date Received: 05/07/2015
Date Printed: 05/13/2015

Lab ID	Client ID	Matrix	Collection Date	Hold	Requested Tests (See legend below)												
					1	2	3	4	5	6	7	8	9	10	11	12	
1505281-001	AMW-1	Water	5/7/2015 6:45	<input type="checkbox"/>	A	A											
1505281-002	AMW-6R	Water	5/7/2015 7:15	<input type="checkbox"/>	A												
1505281-003	AMW-9	Water	5/7/2015 6:15	<input type="checkbox"/>	A												
1505281-004	FHS MW-10	Water	5/7/2015 5:10	<input type="checkbox"/>	A												
1505281-005	FHS MW-11	Water	5/7/2015 5:45	<input type="checkbox"/>	A												

Test Legend:

1	8010BMS_W	2	PREDF REPORT	3		4		5	
6		7		8		9		10	
11		12							

Prepared by: Agustina Venegas

Comments:

NOTE: Soil samples are discarded 60 days after results are reported unless other arrangements are made (Water samples are 30 days). Hazardous samples will be returned to client or disposed of at client expense.



WORK ORDER SUMMARY

Client Name: AEI CONSULTANTS
Project: #261829; Foothill Square
Comments:

QC Level: LEVEL 2
Client Contact: Jeremy Smith
Contact's Email: jasmith@aeiconsultants.com

Work Order: 1505281
Date Received: 5/7/2015

WaterTrax WriteOn EDF Excel Fax Email HardCopy ThirdParty J-flag

Lab ID	Client ID	Matrix	Test Name	Containers /Composites	Bottle & Preservative	De-chlorinated	Collection Date & Time	TAT	Sediment Content	Hold	SubOut
1505281-001A	AMW-1	Water	SW8260B (HVOCs List)	3	VOA w/ HCl	<input type="checkbox"/>	5/7/2015 6:45	5 days	Present	<input type="checkbox"/>	
1505281-002A	AMW-6R	Water	SW8260B (HVOCs List)	3	VOA w/ HCl	<input type="checkbox"/>	5/7/2015 7:15	5 days	Present	<input type="checkbox"/>	
1505281-003A	AMW-9	Water	SW8260B (HVOCs List)	3	VOA w/ HCl	<input type="checkbox"/>	5/7/2015 6:15	5 days	None	<input type="checkbox"/>	
1505281-004A	FHS MW-10	Water	SW8260B (HVOCs List)	3	VOA w/ HCl	<input type="checkbox"/>	5/7/2015 5:10	5 days	None	<input type="checkbox"/>	
1505281-005A	FHS MW-11	Water	SW8260B (HVOCs List)	3	VOA w/ HCl	<input type="checkbox"/>	5/7/2015 5:45	5 days	None	<input type="checkbox"/>	

NOTES: - STLC and TCLP extractions require 2 days to complete; therefore, all TATs begin after the extraction is completed (i.e., One-day TAT yields results in 3 days from sample submission).

- MAI assumes that all material present in the provided sampling container is considered part of the sample - MAI does not exclude any material from the sample prior to sample preparation unless requested in writing by the client.

1505281

McCAMPBELL ANALYTICAL INC.
 1534 Willow Pass Road
 Pittsburg, CA 94565
 Telephone: (925) 252-9262 Fax: (925) 252-9269

CHAIN OF CUSTODY RECORD
TURN AROUND TIME
 EDF Required? Yes No RUSH 24 HR 48 HR 72 HR 5 DAY

Report To: Jeremy Smith Bill To: same P.O. 82769
 Company: AEI Consultants
 2500 Camino Diablo
 Walnut Creek, CA 94597 E-Mail: jasmith@aeiconsultants.com
 Tele: (925) 746-6000 Fax: (925) 746-6099
 Project #: 261829 Project Name: Foothill Square
 Project Location: 10700 MacArthur Blvd. Oakland, CA
 Sampler Signature: *John Gray*

Analysis Request											Other	Comments				
BTEX & TPH as Gas (602/8020 + 8015)/MTBE	TPH as Diesel (8015) w/silica Gel Cleanup	Total Petroleum Oil & Grease (5520 E&F/B&F)	Total Petroleum Hydrocarbons (418.1)	HVOCs EPA 8260	BTEX ONLY (EPA 602 / 8020)	EPA 608 / 8080	EPA 608 / 8080 PCB's ONLY	EPA 624 / 8260	EPA 625 / 8270	PAH's / PNA's by EPA 625 / 8270 / 8310	CAM-17 Metals	LUFT 5 Metals	Lead (7240/7421/239.2/6010)	RCI		
				X												
				X												
				X												
				X												
				X												

SAMPLE ID (Field Point Name)	LOCATION	SAMPLING		# Containers	Type Containers	MATRIX				METHOD PRESERVED					
		Date	Time			Water	Soil	Air	Sludge	Other	Ice	HCl	HNO ₃	Other	
AMW-1		5-7-15	0645	3	V6A	X					X	X			
AMW-6R			0715	3	V6A	X					X	X			
AMW-9			0615	3	V6A	X					X	X			
FHS MW-10			0510	3	V6A	X					X	X			
FHS MW-11			0545	3	V6A	X					X	X			

Relinquished By: *John Gray* Date: 5-7-15 Time: 1215 Received By: *[Signature]*
 Relinquished By: *[Signature]* Date: 5-7-15 Time: 1740 Received By: *Agustina V.*
 Relinquished By: *[Signature]* Date: _____ Time: _____ Received By: _____

ICE/t° 5' PRESERVATION VOAS | O&G | METALS | OTHER
 GOOD CONDITION _____ APPROPRIATE _____
 HEAD SPACE ABSENT _____ CONTAINERS _____
 DECHLORINATED IN LAB _____ PERSERVED IN LAB _____



Sample Receipt Checklist

Client Name: **AEI Consultants** Date and Time Received: **5/7/2015 8:52:36 PM**
 Project Name: **#261829; Foothill Square** LogIn Reviewed by: **Agustina Venegas**
 WorkOrder No: **1505281** Matrix: Water Carrier: Bernie Cummins (MAI Courier)

Chain of Custody (COC) Information

Chain of custody present? Yes No
 Chain of custody signed when relinquished and received? Yes No
 Chain of custody agrees with sample labels? Yes No
 Sample IDs noted by Client on COC? Yes No
 Date and Time of collection noted by Client on COC? Yes No
 Sampler's name noted on COC? Yes No

Sample Receipt Information

Custody seals intact on shipping container/cooler? Yes No NA
 Shipping container/cooler in good condition? Yes No
 Samples in proper containers/bottles? Yes No
 Sample containers intact? Yes No
 Sufficient sample volume for indicated test? Yes No

Sample Preservation and Hold Time (HT) Information

All samples received within holding time? Yes No
 Sample/Temp Blank temperature Temp: 5°C NA
 Water - VOA vials have zero headspace / no bubbles? Yes No NA
 Sample labels checked for correct preservation? Yes No
 pH acceptable upon receipt (Metal: <2; 522: <4; 218.7: >8)? Yes No NA
 Samples Received on Ice? Yes No

(Ice Type: WET ICE)

UCMR3 Samples:

Total Chlorine tested and acceptable upon receipt for EPA 522? Yes No NA
 Free Chlorine tested and acceptable upon receipt for EPA 218.7, 300.1, 537, 539? Yes No NA

* NOTE: If the "No" box is checked, see comments below.

 Comments: