

RECEIVED

By dehloptoxic at 1:16 pm, Aug 22, 2006



August 18, 2006

Don Hwang
Hazardous Materials Specialist
Alameda County Health Care Services Agency
1131 Harbor Bay Parkway
Alameda, California 94502-6577

Dear Mr. Hwang:

Subject: *Work Plan Addendum for Soil and Groundwater Quality Investigation*

Reference: **Earthgrains Baking Companies, Inc.**
955 Kennedy Street
Oakland, California 94606
RO #0002569

On behalf of Earthgrains Baking Companies, Inc., PSC Environmental Services (PSC) is pleased to submit the enclosed *Work Plan Addendum for Soil and Groundwater Quality Investigation* for the above-referenced facility. PSC subcontracted ETIC Engineering, Inc. (ETIC) to prepare this work plan addendum in response to your phone conversation with Thomas Neely of ETIC on August 3, 2006. This work plan addendum modifies the original work plan that PSC submitted to the Alameda County Health Care Services Agency on April 14, 2006.

If you have any questions concerning this work plan addendum, then please contact Mr. Neely of ETIC at (925) 602-4710 (x 17).

Respectfully,

PSC Environmental Services

A handwritten signature in blue ink that reads 'Scott Jander'.

Scott Jander
Project Manager

cc: Melvin Siegel - Earthgrains Baking Companies, Inc.
Thomas Neely - ETIC Engineering, Inc.

PSC ENVIRONMENTAL SERVICES

210 West Sand Bank Road
Columbia, Illinois 62236
Phone (618) 281-1546
Fax (618) 281-7020



August 11, 2006

Mr. Scott Jander
Project Manager
PSC Environmental Services
210 West Sand Bank Road
Columbia, Illinois 62236

Subject: *Work Plan Addendum for Soil and Groundwater Quality Investigation*
Earthgrains Baking Companies, Inc., 955 Kennedy Street, Oakland, California 94606
RO #0002569

Dear Mr. Jander:

At your request, ETIC Engineering, Inc. is submitting the enclosed *Work Plan Addendum for Soil and Groundwater Quality Investigation* for the site located at 955 Kennedy Street in Oakland, California. The location of the site and former 10,000-gallon diesel underground storage tank (UST) system are shown on Figures 1 and 2. This work plan addendum is being submitted pursuant to our conversation with Don Hwang of Alameda County Health Care Services Agency (ACHCSA) on August 3, 2006, and amends our work plan dated April 14, 2006.

Based on our telephone conversation, Mr. Hwang indicated that he would like additional characterization of soil and groundwater quality near the former location of the 10,000-gallon diesel UST system. To address this request, ETIC proposes to drill 40 soil borings (E1 through E40) for the collection of soil and groundwater samples. The sampling locations are shown on Figure 3. Tables 1 and 2 present historical soil and groundwater analytical data, respectively. Tables 3 and 4 present the proposed plan for sampling and analyzing soil and groundwater, respectively. The additional soil borings will be drilled within and near the perimeter of the former 10,000-gallon diesel UST excavation and the former dispenser island. Samples will be collected from the borings to evaluate the extent of diesel in soil and groundwater. We have enclosed an original and four copies of the work plan addendum for you to distribute accordingly. Should you have any questions or comments about the work plan addendum, contact me at (925) 602-4710, extension 17.

Respectfully yours,

Thomas E. Neely, PG, CHG, REA II
Program Manager

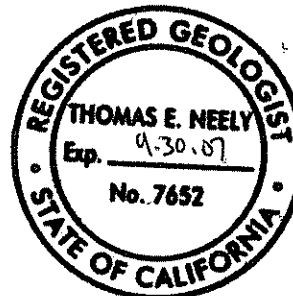

Attachments

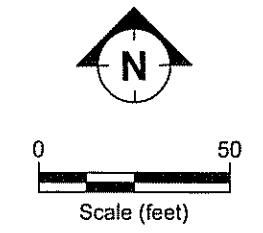
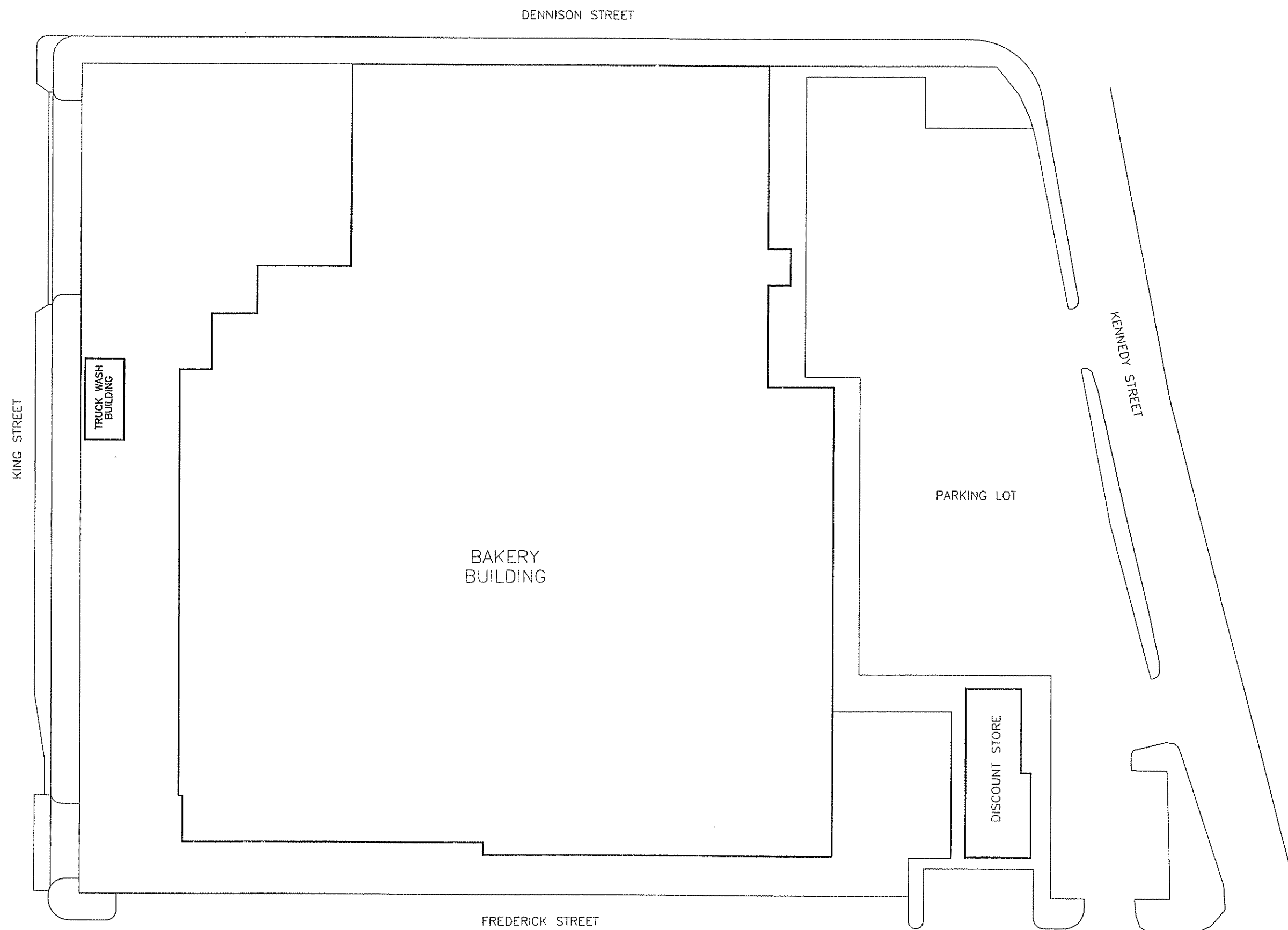

FILENAME: PROP0205.DWG 03/22/2005



SITE LOCATION MAP
EARTHGRAINS BAKING COMPANIES, INC.
955 KENNEDY STREET
OAKLAND, CALIFORNIA

Basemap Source: PSC

FIGURE:
1

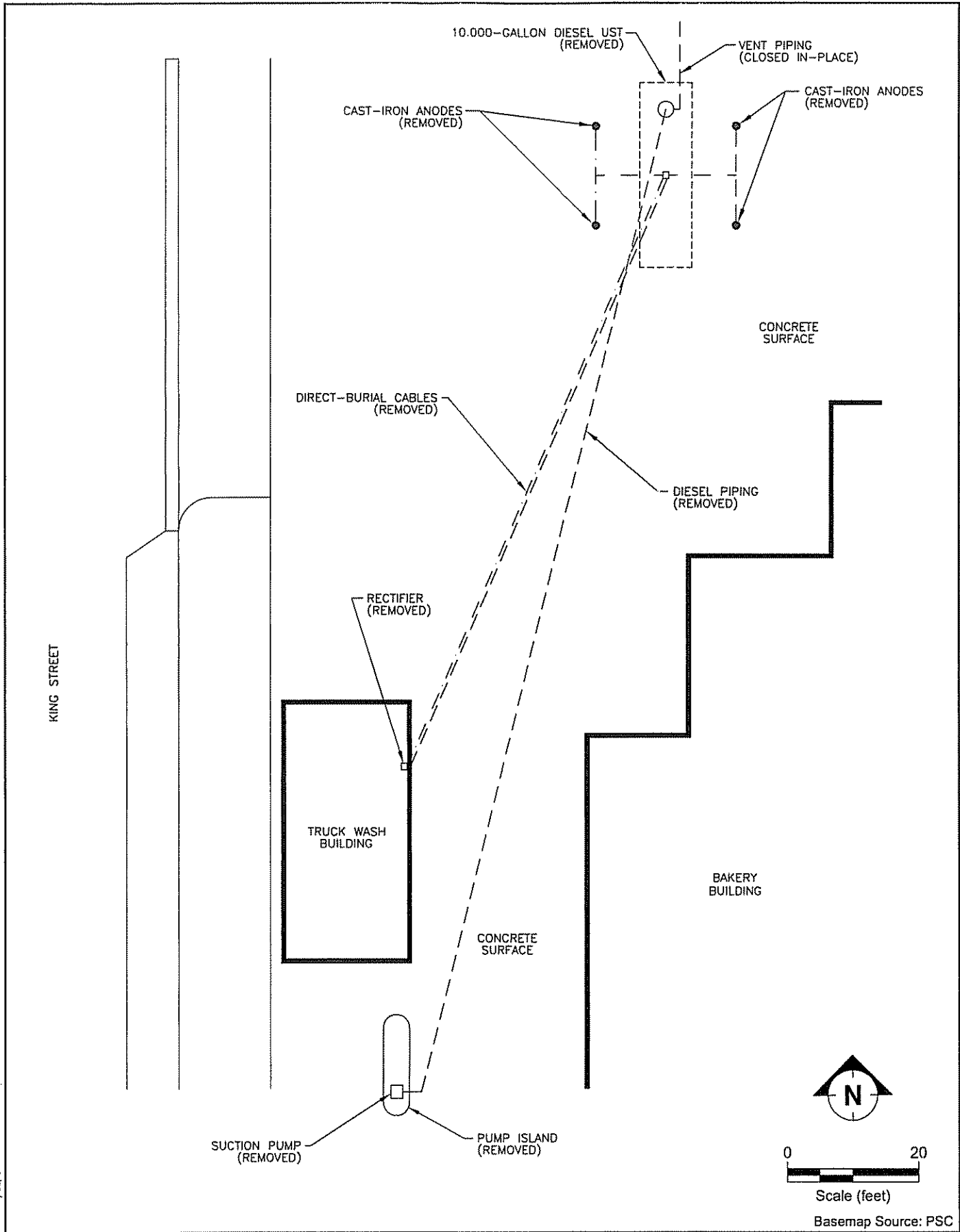

FILENAME: PROP0206.DWG 03/22/2006



SITE MAP SHOWING FORMER UST SYSTEM
 EARTHGRAINS BAKING COMPANIES, INC.
 955 KENNEDY STREET
 OAKLAND, CALIFORNIA

FIGURE:

2

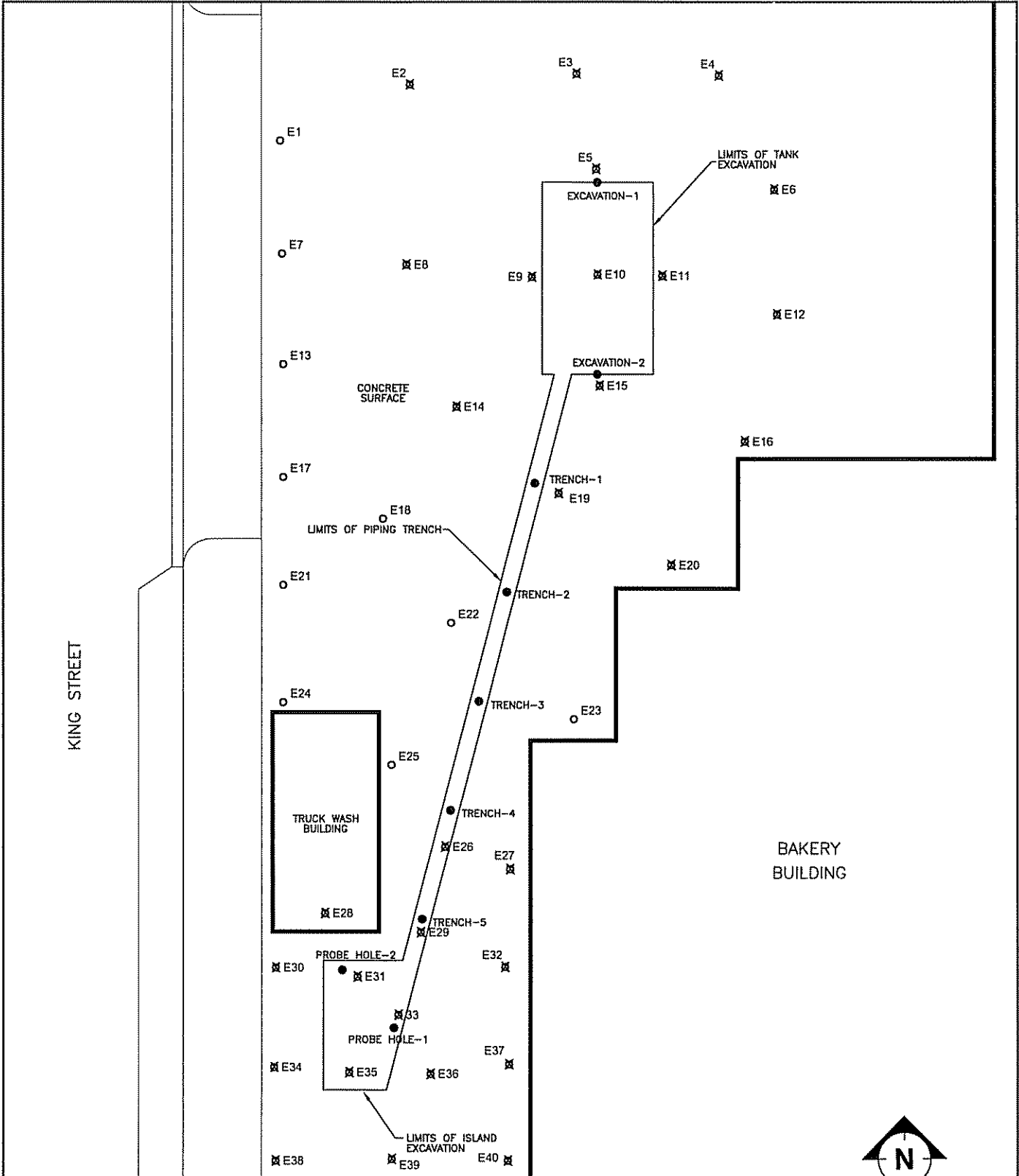

LEGEND

- Previous Soil Sampling Location
- X Proposed Soil Sampling Location
- Proposed Groundwater Sampling Location
- ⊠ Proposed Soil and Groundwater Sampling Location

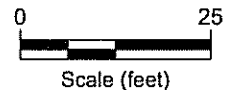

Basemap Source: PSC

FILENAME: PROPO806.DWG 08/11/2006



SITE MAP SHOWING PROPOSED SAMPLING LOCATIONS
EARTHGRAINS BAKING COMPANIES, INC.
 955 KENNEDY STREET
 OAKLAND, CALIFORNIA

FIGURE:

3

TABLE 1. SOIL SAMPLE ANALYTICAL DATA
Earthgrains Baking Companies, Inc.
955 Kennedy Street
Oakland, California 94606

Sampling Location	Date	Concentration (mg/kg)													
		Benzene	Toluene	Ethyl-benzene	Total Xylenes	TPH-g	TPH-d	TPH-mo	DIPE	ETBE	MTBE	TAME	TBA	EDB	EDC
PROBE HOLE-1	4/9/03	<0.62	<0.62	<0.62	<0.62	NA	3,300*	NA	NA	NA	NA	NA	NA	NA	NA
PROBE HOLE-2	4/9/03	NA	NA	NA	NA	NA	NA	<50	NA	NA	NA	NA	NA	NA	NA
TRENCH-1	3/8/05	<0.0050	<0.0050	<0.0050	<0.0050	<1.0	<1.0	NA	<0.010	<0.010	<0.010	<0.010	<0.80	<0.010	<0.010
TRENCH-2	3/8/05	<0.0050	<0.0050	<0.0050	<0.0050	<1.0	<1.0	NA	<0.010	<0.010	<0.010	<0.010	<0.80	<0.010	<0.010
TRENCH-3	3/8/05	<0.0050	<0.0050	<0.0050	<0.0050	<1.0	<1.0	NA	<0.010	<0.010	<0.010	<0.010	<0.80	<0.010	<0.010
TRENCH-4	3/8/05	<0.0050	<0.0050	<0.0050	<0.0050	<1.0	<1.0	NA	<0.010	<0.010	<0.010	<0.010	<0.80	<0.010	<0.010
TRENCH-5	3/8/05	<0.050	<0.050	<0.050	<0.050	48†	1,700	NA	<0.010	<0.010	<0.010	<0.010	<0.80	<0.010	<0.010
EXCAVATION-1	3/9/05	<0.0050	<0.0050	<0.0050	<0.0050	<1.0	<1.0	NA	<0.010	<0.010	<0.010	<0.010	<0.80	NA	NA
EXCAVATION-2	3/9/05	<0.0050	<0.0050	<0.0050	<0.0050	<1.0	<1.0	NA	<0.010	<0.010	<0.010	<0.010	<0.80	NA	NA

TPH-g Total petroleum hydrocarbons quantified as gasoline.
TPH-d Total petroleum hydrocarbons quantified as diesel.
TPH-mo Total petroleum hydrocarbons quantified as motor oil.
DIPE Di-isopropyl ether.
ETBE Ethyl tertiary butyl ether.
MTBE Methyl tertiary butyl ether.
TAME Tertiary amyl methyl ether.
TBA Tertiary butyl alcohol.
EDB Ethylene dibromide (1,2-dibromoethane or 1,2-DBA).
EDC Ethylene dichloride (1,2-dichloroethane or 1,2-DCA).
* The pattern exhibited by the hydrocarbons detected did not match the laboratory's diesel standard.
† The laboratory indicated a "non-gasoline pattern; appears to be diesel."
NA Not analyzed.
mg/kg Milligrams per kilogram.

TABLE 2. GROUNDWATER SAMPLE ANALYTICAL DATA
 Earthgrains Baking Companies, Inc.
 955 Kennedy Street
 Oakland, California 94606

Sampling Location	Date	Concentration (µg/L)													
		Benzene	Toluene	Ethyl-benzene	Total Xylenes	TPH-g	TPH-d	TPH-mo	DIPE	ETBE	MTBE	TAME	TBA	EDB	EDC
Excavation Water	3/8/05	<0.50	<0.50	<0.50	<0.50	130*	6,100	NA	<0.50	<0.50	2.7†	<0.50	<20	<0.50	<0.50

TPH-g Total petroleum hydrocarbons quantified as gasoline.
 TPH-d Total petroleum hydrocarbons quantified as diesel.
 TPH-mo Total petroleum hydrocarbons quantified as motor oil.
 DIPE Di-isopropyl ether.
 ETBE Ethyl tertiary butyl ether.
 MTBE Methyl tertiary butyl ether.
 TAME Tertiary amyl methyl ether.
 TBA Tertiary butyl alcohol.
 EDB Ethylene dibromide (1,2-dibromoethane or 1,2-DBA).
 EDC Ethylene dichloride (1,2-dichloroethane or 1,2-DCA).
 * The laboratory indicated a "non-gasoline pattern; appears to be diesel."
 † The concentration of MTBE in the sample was 2.7 µg/L when analyzed by EPA Method 8020 and 1.9 µg/L when analyzed by EPA Method 8260.
 NA Not analyzed.
 µg/L Micrograms per liter.

TABLE 3. PROPOSED SOIL SAMPLING AND ANALYSIS
Earthgrains Baking Companies, Inc.
955 Kennedy Street
Oakland, California 94606

Proposed Sampling Location	Approximate Depth (feet)	Diesel w/silica gel cleanup EPA Method 8015M	BTEX and MTBE EPA Method 8260B
E2	8	X	X
E3	4	X	X
E3	8	X	X
E4	4	X	X
E4	8	X	X
E5	4	X	X
E5	8	X	X
E5	12	X	X
E5	16	X	X
E6	8	X	X
E8	8	X	X
E9	4	X	X
E9	8	X	X
E9	12	X	X
E9	16	X	X
E10	20	X	X
E10	24	X	X
E10	28	X	X
E10	32	X	X
E11	4	X	X
E11	8	X	X
E11	12	X	X
E11	16	X	X
E12	8	X	X
E14	4	X	X
E14	8	X	X
E15	4	X	X
E15	8	X	X
E15	12	X	X
E15	16	X	X

TABLE 3. PROPOSED SOIL SAMPLING AND ANALYSIS
 Earthgrains Baking Companies, Inc.
 955 Kennedy Street
 Oakland, California 94606

Proposed Sampling Location	Approximate Depth (feet)	Diesel w/silica gel cleanup EPA Method 8015M	BTEX and MTBE EPA Method 8260B
E16	8	X	X
E19	4	X	X
E19	8	X	X
E20	8	X	X
E26	4	X	X
E26	8	X	X
E27	4	X	X
E27	8	X	X
E28	4	X	X
E28	8	X	X
E29	4	X	X
E29	8	X	X
E30	4	X	X
E30	8	X	X
E31	4	X	X
E31	8	X	X
E32	4	X	X
E32	8	X	X
E33	4	X	X
E33	8	X	X
E33	12	X	X
E33	16	X	X
E34	4	X	X
E34	8	X	X
E35	4	X	X
E35	8	X	X
E35	12	X	X
E35	16	X	X
E36	4	X	X
E36	8	X	X

TABLE 3. PROPOSED SOIL SAMPLING AND ANALYSIS
 Earthgrains Baking Companies, Inc.
 955 Kennedy Street
 Oakland, California 94606

Proposed Sampling Location	Approximate Depth (feet)	Diesel w/silica gel cleanup EPA Method 8015M	BTEX and MTBE EPA Method 8260B
E36	12	X	X
E36	16	X	X
E37	4	X	X
E37	8	X	X
E38	4	X	X
E38	8	X	X
E39	4	X	X
E39	8	X	X
E39	12	X	X
E39	16	X	X
E40	4	X	X
E40	8	X	X

TABLE 4. PROPOSED GROUNDWATER SAMPLING AND ANALYSIS
 Earthgrains Baking Companies, Inc.
 955 Kennedy Street
 Oakland, California 94606

Proposed Sampling Location	Diesel w/silica gel cleanup EPA Method 8015M	BTEX and MTBE EPA Method 8260B
E1	X	X
E2	X	X
E3	X	X
E4	X	X
E5	X	X
E6	X	X
E7	X	X
E8	X	X
E9	X	X
E10	X	X
E11	X	X
E12	X	X
E13	X	X
E14	X	X
E15	X	X
E16	X	X
E17	X	X
E18	X	X
E19	X	X
E20	X	X
E21	X	X
E22	X	X
E23	X	X
E24	X	X
E25	X	X
E26	X	X
E27	X	X
E28	X	X
E29	X	X
E30	X	X

TABLE 4. PROPOSED GROUNDWATER SAMPLING AND ANALYSIS
 Earthgrains Baking Companies, Inc.
 955 Kennedy Street
 Oakland, California 94606

Proposed Sampling Location	Diesel w/silica gel cleanup EPA Method 8015M	BTEX and MTBE EPA Method 8260B
E31	X	X
E32	X	X
E33	X	X
E34	X	X
E35	X	X
E36	X	X
E37	X	X
E38	X	X
E39	X	X
E40	X	X