



April 28, 2003

Alameda County  
MAY 07 2003  
Environmental Health

REPORT  
of  
SUBSURFACE SOIL ASSESSMENT  
ASE JOB NO. 3788  
at  
1455 5th Street  
Oakland, California

Submitted by:  
AQUA SCIENCE ENGINEERS, INC.  
208 West El Pintado Road  
Danville, CA 94526  
(925) 820-9391

## TABLE OF CONTENTS

<b>SECTION</b>		<b>PAGE</b>
1.0	INTRODUCTION	1
2.0	BACKGROUND INFORMATION	1
3.0	SCOPE OF WORK	2
4.0	DRILL SOIL BORINGS AND COLLECT SAMPLES	2
5.0	ANALYTICAL RESULTS FOR SOIL	3
6.0	CONCLUSIONS AND RECOMMENDATIONS	4
7.0	REPORT LIMITATIONS	4

### **LIST OF FIGURES**

FIGURE 1      LOCATION MAP

FIGURE 2      SOIL BORING LOCATION MAP

### **LIST OF TABLES**

TABLE ONE      TOTAL LEAD IN SOIL

### **LIST OF APPENDICES**

APPENDIX A      DRILLING PERMIT

APPENDIX B      ANALYTICAL REPORT AND CHAIN OF CUSTODY FORMS  
FOR SOIL SAMPLES

## **1.0 INTRODUCTION**

This report presents the methods and findings of Aqua Science Engineers, Inc. (ASE)'s subsurface soil assessment at 1455 5th Street in Oakland, California (Figures 1 and 2). The site assessment activities were initiated by the property owners, Mr. Andy Hall and Ms. Jean Hall, in an effort to further define elevated concentrations of lead in soil that were previously identified by ASE and others.

## **2.0 BACKGROUND INFORMATION**

The subject site currently exists as a vacant property with two wooden structures, a concrete pad, and areas of weed covered dirt. The site is within a mixed residential and commercial area, just south of the 5th Street BART Station. The site is completely fenced.

In July 2001, a prospective purchaser of the property hired Lowney Associates of Mountain View, California to conduct a limited soil assessment. Two soil borings were drilled, and analysis of the soil samples identified elevated concentrations of lead, up to 410 parts per million (ppm).

In January 2001, ASE was hired by the property owners to perform a subsurface soil assessment at the site to confirm the results of the Lowney assessment. On January 4, 2001, ASE drilled soil borings B-1 and B-2 at the site using a hand auger. Vironex, Inc of San Leandro, California drilled soil borings B-3, B-4 and B-5 using a Geoprobe hydraulic sampling rig (Figure 2). Soil samples were collected from each boring at 12-inches, 24-inches, 36-inches and 48-inches below ground surface (bgs). The 12-inch and 24-inch soil sample from each boring was analyzed at a CA-DHS certified laboratory for hydrocarbons and total lead. Several of the 12-inch deep soil samples contained elevated concentration of total lead, ranging from 390 ppm to 1,800 ppm. All of the 24-inch deep soil samples contained only very low concentrations of total lead. None of the soil samples contained hydrocarbons at or above levels of concern.

Based on the data rendered during the ASE January 2001 site assessment, it was obvious that the site contained soil contaminated with lead, and that excavation and off-site disposal would be required. In order to identify the volume, location, and concentration of the lead in soil at the site, ASE recommended to our client that soil borings be drilled in a grid-like manner over the site. Soil samples from each borehole could then be

systematically analyzed for total lead, until complete horizontal and vertical delineation of the lead in soil could be achieved.

### **3.0 SCOPE OF WORK (SOW)**

In order to identify the volume, location, and concentration of the lead in soil at the site, ASE's scope of work was as follows:

- 1) Obtain an Alameda County Public Works Agency (ACPWA) drilling permit.
- 2) Using a Geoprobe drill rig or hand auger, drill fifteen (15) 4-foot deep soil samples in equally-spaced locations on the site. Collect a 1-foot, 2-foot, 3-foot and 4-foot bgs soil sample from each location.
- 3) Analyze the shallow soil sample from each of these fifteen borings detailed in #2 above at a CA-DHS certified analytical laboratory for total lead by EPA Method 6010. The other soil samples will be sealed and placed on HOLD at the laboratory for possible future analyses, as necessary.
- 4) Backfill the borings with neat cement.
- 5) Prepare a report detailing the methods and findings of this assessment.

### **4.0 DRILL SOIL BORINGS AND COLLECT SAMPLES**

Prior to drilling, ASE obtained a drilling permit from the ACPWA (permit #W03-0190) to drill the soil borings at the site. A copy of this permit is presented in Appendix A.

On March 18, 2003, soil borings B-6 through B-20 were drilled in equally-spaced locations on the property and within the rear building. Vironex, Inc. of San Leandro, California drilled twelve of the soil borings using a Geoprobe hydraulic sampling rig. ASE used a hand auger to drill soil borings B-12, B-16 and B-20 (Figure 2).

Undisturbed soil samples were collected continuously as drilling progressed for lithologic and hydrogeologic description and for possible chemical analysis. The Geoprobe samples were collected by driving a sampler lined with acetate tubes using hydraulic direct push methods.

Selective soil samples were immediately cut, trimmed, sealed with Teflon tape, plastic end caps and duct tape. The hand-augered soil samples were collected in glass sample jars directly from the auger bucket. All of the samples were labeled and stored on ice for transport to STL San Francisco (STL) of Pleasanton, California (CA DHS ELAP #2496) under chain of custody. Soil from the remaining tubes was described using the Unified Soil Classification System.

Drilling equipment was cleaned with a TSP solution between sampling intervals and between borings to prevent potential cross-contamination. Sediments encountered during the drilling appeared to be of native silty sand, dark brown in color.

## **5.0 ANALYTICAL RESULTS FOR SOIL**

The soil samples collected from 1 and 2-feet from all fifteen soil borings were analyzed by STL for total lead by EPA Method 6010. Due to the results of these samples, the 3-foot soil sample from three of the soil borings and the 4-foot sample from one of the soil borings were also analyzed for total lead. The tabulated analytical results can be found in Table One. The certified analytical report and chain of custody forms are included in Appendix B.

A detail of the analytical results are as follows:

### 1-foot soil samples

In soil borings B-7, B-8, B-10, B-17 and B-18, the lead concentrations in the 1-foot soil samples were at or below the Risk-Based Screening Level (RBSL) for surface soil with residential use permitted as presented in the California Regional Water Quality Control Board, San Francisco Bay Region "Application of Risk-Based Screening Levels and Decision Making to Sites with Impacted Soil and Groundwater" document dated December 2001. The soil samples collected from 1-foot bgs in the remaining borings contained lead at concentrations exceeding RBSLs.

### 2-foot samples

The lead concentrations in the 2-foot soil samples were at or below the RBSL for surface soil with residential use permitted in all of the soil borings except B-6 and B-14.

### 3-foot samples

In soil borings B-14 and B-15, the 3-foot soil samples contained lead concentrations below the RBSL for surface soil with residential use permitted. The soil sample collected from 3-foot bgs in boring B-6 still contained lead at a concentration above the RBSL.

### 4-foot sample

In soil boring B-6, the 4-foot soil sample contained a lead concentration below the RBSL for surface soil with residential use permitted.

## **6.0 CONCLUSIONS AND RECOMMENDATIONS**

- Elevated concentrations of total lead exist in the soil over the majority of the property.
- By 2-foot bgs, a majority of the on-site soil contained lead concentrations well below the acceptable levels for development and usage of the property for residential purposes.
- In two locations on the property (B-6 and B-14), acceptable levels of lead are not achieved until depths of 3 and 4-foot bgs.

In order to make the site suitable for development and usage for residential purposes, the buildings, pads, and concrete surface will need to be removed and soil excavation ranging from 2-feet to 4-feet below current ground surface will be required. Lead-laden soil will require off-site disposal at a landfill suitable for its acceptance.

## **7.0 REPORT LIMITATIONS**

The results presented in this report represent conditions at the time of the soil sampling, at the specific locations where the samples were collected, and for the specific parameters analyzed by the laboratory.

This report does not fully characterize the site for contamination resulting from unknown sources or for parameters not analyzed by the laboratory. All of the laboratory work cited in this report was prepared under the direction of an independent CAL-DHS certified laboratory. The independent laboratory is solely responsible for the contents and conclusions of the chemical analysis data.

Aqua Science Engineers appreciates the opportunity provide environmental consulting services for this project. Should you have any questions or comments, please feel free to call us at (925) 820-9391.

Respectfully submitted,

AQUA SCIENCE ENGINEERS, INC.

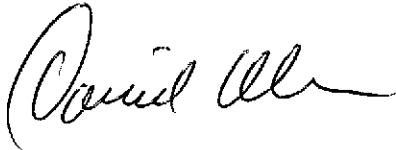

David Allen, R.E.A.  
Senior Project Manager

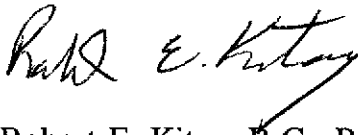

Robert E. Kitay, R.G., R.E.A.  
Senior Geologist



Attachments: Figures 1 and 2  
Table One  
Appendices A and B

Cc: Mr. Andy Hall, 791 66th Avenue, Oakland, CA 94621  
Ms. Jean Hall, 277 Castle Hill Ranch Road, Walnut Creek, CA 94595  
Ms. Donna Drogos, Alameda County Health Care Services Agency,  
1131 Harbor Bay Parkway, Suite 250, Alameda, CA 94502

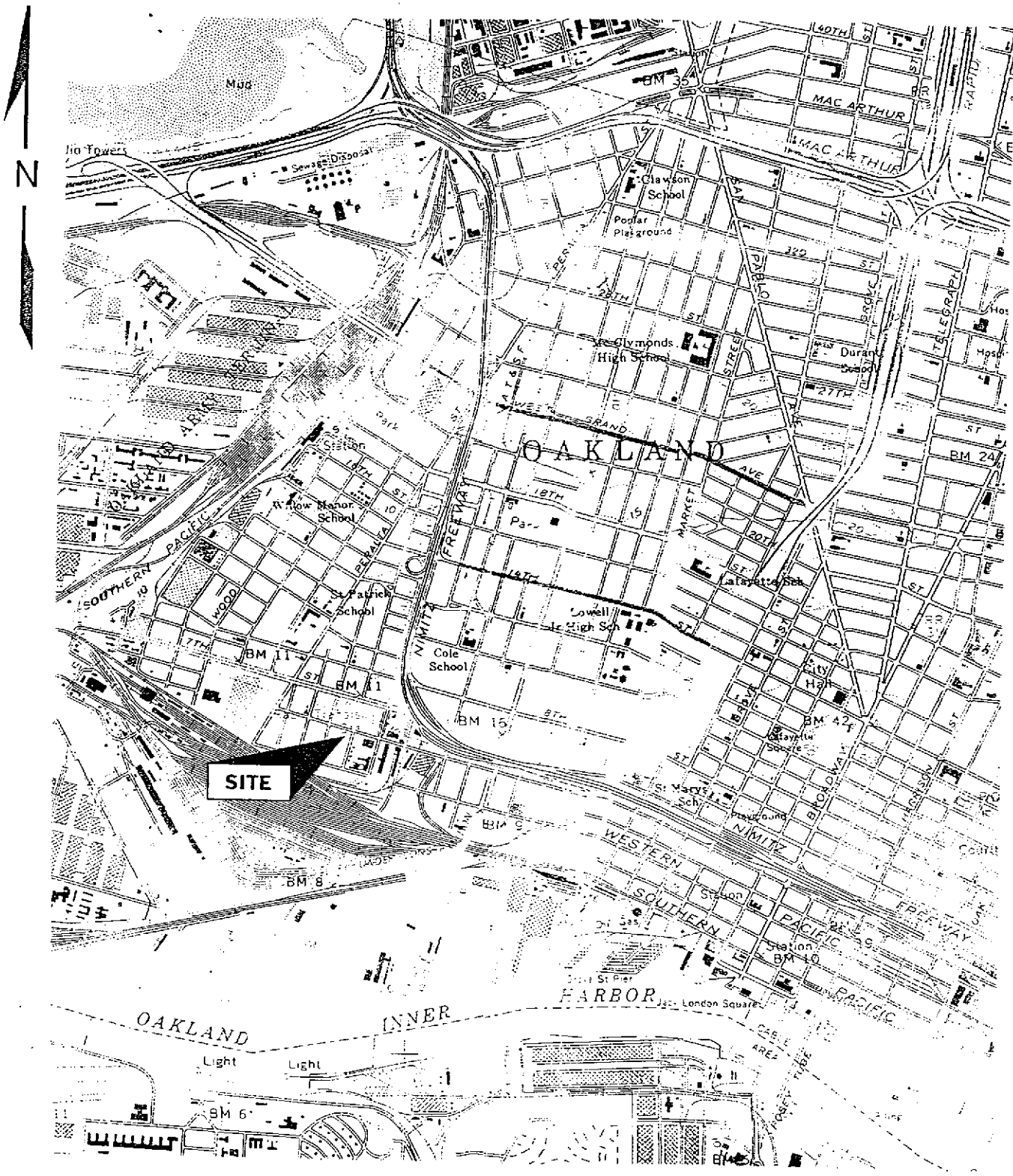

# SITE LOCATION MAP

1455 5th Street  
Oakland, CA 94621

Aqua Science Engineers

Figure 1

Scale: 1 inch = 2,000 feet





NORTH

Approx. Scale  
1" = 20'

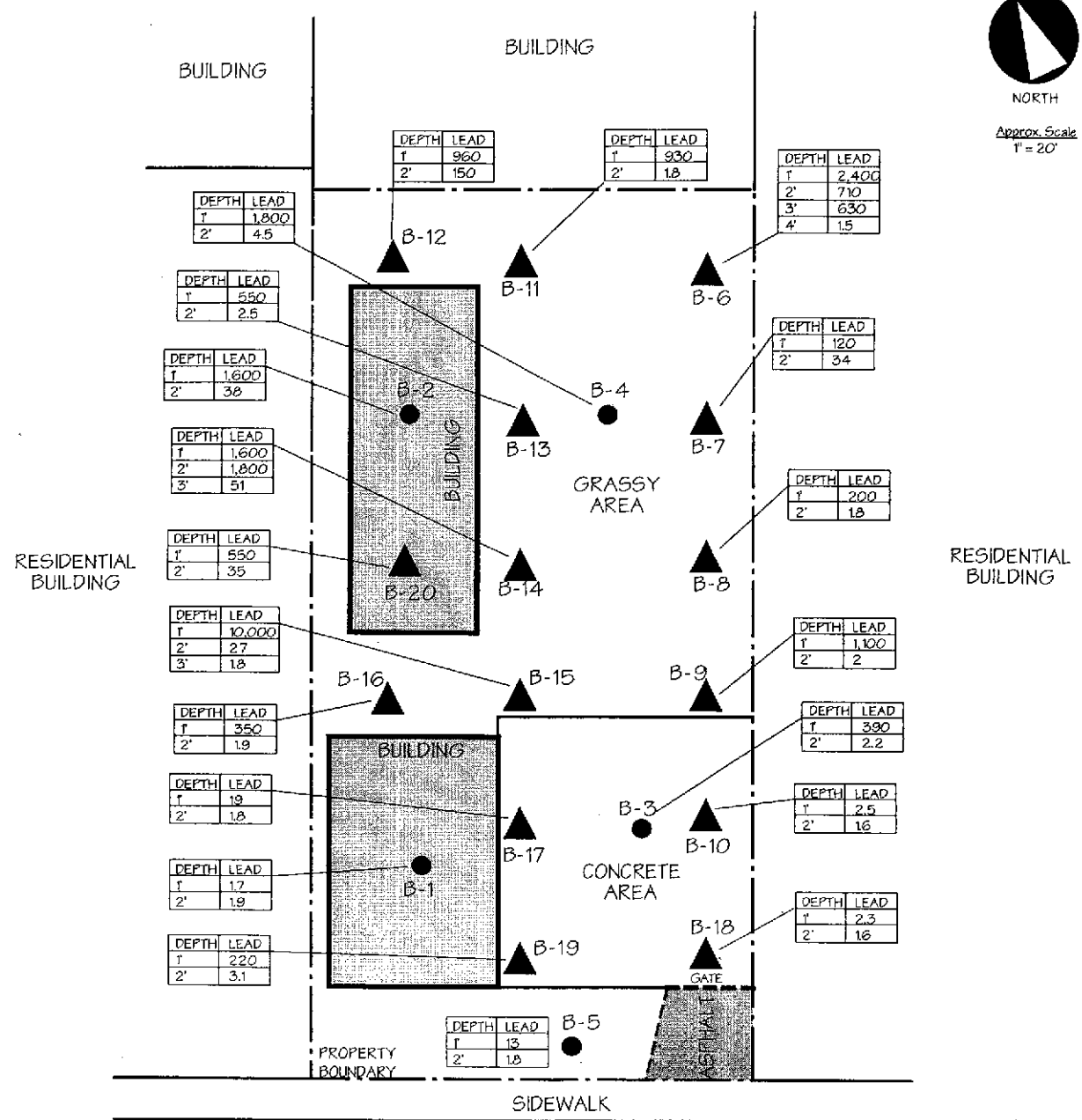

LEGEND

- B-1 PREVIOUS BORING LOCATION
- B-20 CURRENT BORING LOCATION

SOIL BORING  
LOCATION MAP

VACANT PROPERTY  
1455 5TH STREET  
OAKLAND, CA

# TABLE ONE

Total Lead Concentrations In Soil  
Hall Property  
1455 5th Street, Oakland, California  
All Results in Parts Per Million

SAMPLE IDENTIFICATION	TOTAL LEAD
B-6-1'	2400
B-6-2'	710
B-6-3'	630
B-6-4'	1.5
B-7-1'	120
B-7-2'	34
B-8-1'	200
B-8-2'	1.8
B-9-1'	1100
B-9-2'	2.0
B-10-1'	2.5
B-10-2'	1.6
B-11-1'	930
B-11-2'	1.8
B-12-1'	960
B-12-2'	150
B-13-1'	550
B-13-2'	2.5
B-14-1'	1600
B-14-2'	1800
B-14-3'	51
B-15-1'	10000
B-15-2'	27
B-15-3'	1.8
B-16-1'	350
B-16-2'	1.9
B-17-1'	19
B-17-2'	1.8
B-18-1'	2.3
B-18-2'	1.6
B-19-1'	220
B-19-2'	3.1
B-20-1'	550
B-20-2'	35
EPA Method	6010

# **APPENDIX A**

Drilling Permit



### ALAMEDA COUNTY PUBLIC WORKS AGENCY

**WATER RESOURCES SECTION**  
399 ELMHURST ST. HAYWARD CA. 94544-1395  
PHONE (510) 670-6631 James Van  
FAX (510) 782-1939

APPLICANTS: PLEASE ATTACH A SITE MAP FOR ALL DRILLING PERMIT APPLICATIONS  
DESTRUCTION OF WELLS OVER 45 FEET REQUIRES A SEPARATE PERMIT APPLICATION

## DRILLING PERMIT APPLICATION

FOR APPLICANT TO COMPLETE

LOCATION OF PROJECT \_\_\_\_\_  
1455 SHERBROOK  
DANFORTH, CA

CLIENT  
Name Mr. Andy Hall  
Address 221 W. Alameda Phone 510-130-2742  
City Danforth Zip 94601

APPLICANT  
Name John Seismic Engineers, Inc.  
Address 208 W. Elgin Ave Phone 925-827-4453  
City Danforth, CA Zip 94526

TYPE OF PROJECT  
Well Construction  Geotechnical Investigation   
Cathodic Protection  General   
Water Supply  Contamination   
Monitoring  Well Destruction

PROPOSED WATER SUPPLY WELL USE  
New Domestic  Replacement Domestic   
Municipal  Irrigation   
Industrial  Other

DRILLING METHOD:  
Mud Rotary  Air Rotary  Auger   
Cable  Other

DRILLER'S NAME Vironex

DRILLER'S LICENSE NO. 705927

WELL PROJECTS  
Drill Hole Diameter \_\_\_\_\_ in. Maximum \_\_\_\_\_  
Casing Diameter \_\_\_\_\_ in. Depth \_\_\_\_\_ ft.  
Surface Seal Depth \_\_\_\_\_ ft. Owner's Well Number \_\_\_\_\_

GEO TECHNICAL PROJECTS  
Number of Borings \_\_\_\_\_ Maximum \_\_\_\_\_  
Hole Diameter \_\_\_\_\_ in. Depth \_\_\_\_\_ ft.

STARTING DATE 3/18/03

COMPLETION DATE 3/18/03

I hereby agree to comply with all requirements of this permit and Alameda County Ordinance No. 73-68.

APPLICANT'S SIGNATURE E. Paddock DATE 3/12/03

PLEASE PRINT NAME Erik Paddock Rev 9-18-01

FOR OFFICE USE

PERMIT NUMBER W03-0190  
WELL NUMBER \_\_\_\_\_  
APN \_\_\_\_\_

### PERMIT CONDITIONS

Circled Permit Requirements Apply

#### A. GENERAL

1. A permit application should be submitted so as to arrive at the ACPWA office five days prior to proposed starting date.
2. Submit to ACPWA within 60 days after completion of permitted original Department of Water Resources-Well Completion Report.
3. Permit is void if project not begun within 90 days of approval date.

#### B. WATER SUPPLY WELLS

1. Minimum surface seal thickness is two inches of cement grout placed by tremie.
2. Minimum seal depth is 50 feet for municipal and industrial wells or 20 feet for domestic and irrigation wells unless a lesser depth is specially approved.

#### C. GROUNDWATER MONITORING WELLS INCLUDING PIEZOMETERS

1. Minimum surface seal thickness is two inches of cement grout placed by tremie.
2. Minimum seal depth for monitoring wells is the maximum depth practicable or 20 feet.

#### D. GEOTECHNICAL

Backfill bore hole by tremie with cement grout or cement grout/sand mixture. Apply two inches of cement grout to bottom of all compressed casings.

#### E. CATHODIC

Fill hole made zone with concrete placed by tremie.

#### F. WELL DESTRUCTION

Send a map of work site. A separate permit is required for wells deeper than 45 feet.

#### G. SPECIAL CONDITIONS

NOTE: One application must be submitted for each well or well destruction. Multiple borings on one application are acceptable for geotechnical and contamination investigations.

APPROVED

DATE

3-12-03

## **APPENDIX B**

Analytical Report and Chain of Custody Forms  
For Soil Samples

**Total Lead**

Aqua Science Engineers, Inc.

Attn.: Dave Allen

208 West El Pintado Road

Danville, CA 94526

Phone: (925) 820-9391 Fax: (925) 837-4853

Project: Andy Hall 1455 5th Street Oakland

Received: 03/19/2003 16:25

**Samples Reported**

Sample Name	Date Sampled	Matrix	Lab #
B-6-1'	03/18/2003 12:29	Soil	1
B-7-1'	03/18/2003 12:33	Soil	5
B-8-1'	03/18/2003 12:38	Soil	9
B-9-1'	03/18/2003 12:43	Soil	13
B-10-1'	03/18/2003 12:54	Soil	17
B-11-1'	03/18/2003 13:02	Soil	21
B-12-1'	03/18/2003 13:09	Soil	25
B-13-1'	03/18/2003 13:10	Soil	29
B-14-1'	03/18/2003 13:15	Soil	33
B-15-1'	03/18/2003 13:20	Soil	37
B-16-1'	03/18/2003 13:22	Soil	41
B-17-1'	03/18/2003 13:30	Soil	45
B-18-1'	03/18/2003 13:36	Soil	49
B-19-1'	03/18/2003 13:44	Soil	53
B-20-1'	03/18/2003	Soil	57

Severn Trent Laboratories, Inc.

STL San Francisco \* 1220 Quarry Lane, Pleasanton, CA 94566

Tel 925 484 1919 Fax 925 484 1096 \* www.stl-inc.com \* CA DHS ELAP# 2496

03/26/2003 11:40

**Total Lead**

Aqua Science Engineers, Inc.

Attn.: Dave Allen

208 West El Pintado Road

Danville, CA 94526

Phone: (925) 820-9391 Fax: (925) 837-4853

Project: Andy Hall 1455 5th Street Oakland

Received: 03/19/2003 16:25

Prep(s):	3050B	Test(s):	6010B
Sample ID:	B-6-1	Lab ID:	2003-03-0405 - 1
Sampled:	03/18/2003 12:29	Extracted:	3/20/2003 13:21
Matrix:	Soil	QC Batch#:	2003/03/20-06.15

Compound	Conc.	RL	Unit	Dilution	Analyzed	Flag
Lead	2400	1.0	mg/Kg	1.00	03/24/2003 17:58	

Severn Trent Laboratories, Inc.

STL San Francisco \* 1220 Quarry Lane, Pleasanton, CA 94566

Tel 925 484 1919 Fax 925 484 1096 \* www.stl-inc.com \* CA DHS ELAP# 2496

03/26/2003 11:40

**Total Lead**

Aqua Science Engineers, Inc.  
Attn.: Dave Allen

208 West El Pintado Road  
Danville, CA 94526  
Phone: (925) 820-9391 Fax: (925) 837-4853  
Project: Andy Hall 1455 5th Street Oakland

Received: 03/19/2003 16:25

Prep(s): 3050B	Test(s): 6010B
Sample ID: B-7-1	Lab ID: 2003-03-0405 - 5
Sampled: 03/18/2003 12:33	Extracted: 3/20/2003 13:21
Matrix: Soil	QC Batch#: 2003/03/20-06.15

Compound	Conc.	RL	Unit	Dilution	Analyzed	Flag
Lead	120	1.0	mg/Kg	1.00	03/24/2003 18:10	



**Total Lead**

Aqua Science Engineers, Inc.  
Attn.: Dave Allen

208 West El Pintado Road  
Danville, CA 94526  
Phone: (925) 820-9391 Fax: (925) 837-4853

Project: Andy Hall 1455 5th Street Oakland

Received: 03/19/2003 16:25

Prep(s):	3050B	Test(s):	6010B
Sample ID:	B-8-1	Lab ID:	2003-03-0405-9
Sampled:	03/18/2003 12:38	Extracted:	3/20/2003 13:21
Matrix:	Soil	QC Batch#:	2003/03/20-06.15

Compound	Conc.	RL	Unit	Dilution	Analyzed	Flag
Lead	200	1.0	mg/Kg	1.00	03/24/2003 18:26	

**Total Lead**

Aqua Science Engineers, Inc.

Attn.: Dave Allen

208 West El Pintado Road  
Danville, CA 94526  
Phone: (925) 820-9391 Fax: (925) 837-4853

Project: Andy Hall 1455 5th Street Oakland

Received: 03/19/2003 16:25

Prep(s): 3050B	Test(s): 6010B
Sample ID: B-9-1	Lab ID: 2003-03-0405-13
Sampled: 03/18/2003 12:43	Extracted: 3/20/2003 13:21
Matrix: Soil	QC Batch#: 2003/03/20-06.15

Compound	Conc.	RL	Unit	Dilution	Analyzed	Flag
Lead	1100	1.0	mg/Kg	1.00	03/24/2003 18:30	

Severn Trent Laboratories, Inc.

STL San Francisco \* 1220 Quarry Lane, Pleasanton, CA 94566

Tel 925 484 1919 Fax 925 484 1096 \* www.stl-inc.com \* CA DHS ELAP# 2496

03/26/2003 11:40

**Total Lead**

Aqua Science Engineers, Inc.  
Attn.: Dave Allen

208 West El Pintado Road  
Danville, CA 94526  
Phone: (925) 820-9391 Fax: (925) 837-4853  
Project: Andy Hall 1455 5th Street Oakland

Received: 03/19/2003 16:25

Prep(s):	3050B	Test(s):	6010B
Sample ID:	B-10-1	Lab ID:	2003-03-0405 - 17
Sampled:	03/18/2003 12:54	Extracted:	3/20/2003 13:21
Matrix:	Soil	QC Batch#:	2003/03/20-06.15

Compound	Conc.	RL	Unit	Dilution	Analyzed	Flag
Lead	2.5	1.0	mg/Kg	1.00	03/24/2003 18:34	

**Total Lead**

Aqua Science Engineers, Inc.  
Attn.: Dave Allen

208 West El Pintado Road  
Danville, CA 94526  
Phone: (925) 820-9391 Fax: (925) 837-4853  
Project: Andy Hall 1455 5th Street Oakland

Received: 03/19/2003 16:25

Prep(s):	3050B	Test(s):	6010B
Sample ID:	B-11-1	Lab ID:	2003-03-0405 - 21
Sampled:	03/18/2003 13:02	Extracted:	3/20/2003 13:21
Matrx:	Soil	QC Batch#:	2003/03/20-06.15

Compound	Conc.	RL	Unit	Dilution	Analyzed	Flag
Lead	930	1.0	mg/Kg	1.00	03/24/2003 18:38	

**Total Lead**

Aqua Science Engineers, Inc.

Attn.: Dave Allen

208 West El Pintado Road  
Danville, CA 94526  
Phone: (925) 820-9391 Fax: (925) 837-4853

Project: Andy Hall 1455 5th Street Oakland

Received: 03/19/2003 16:25

Prep(s):	3050B	Test(s):	6010B
Sample ID:	B-12-1	Lab ID:	2003-03-0405 - 25
Sampled:	03/18/2003 13:09	Extracted:	3/20/2003 13:21
Matrix:	Soil	QC Batch#:	2003/03/20-06.15

Compound	Conc.	RL	Unit	Dilution	Analyzed	Flag
Lead	960	1.0	mg/Kg	1.00	03/24/2003 18:42	

Severn Trent Laboratories, Inc.

STL San Francisco \* 1220 Quarry Lane, Pleasanton, CA 94566

Tel 925 484 1919 Fax 925 484 1096 \* www.stl-inc.com \* CA DHS ELAP# 2496

03/26/2003 11:40

**Total Lead**

Aqua Science Engineers, Inc.

Attn.: Dave Allen

208 West El Pintado Road

Danville, CA 94526

Phone: (925) 820-9391 Fax: (925) 837-4853

Project: Andy Hall 1455 5th Street Oakland

Received: 03/19/2003 16:25

Prep(s): 3050B	Test(s): 6010B
Sample ID: B-13-1	Lab ID: 2003-03-0405-29
Sampled: 03/18/2003 13:10	Extracted: 3/20/2003 13:21
Matrix: Soil	QC Batch#: 2003/03/20-06.15

Compound	Conc.	RL	Unit	Dilution	Analyzed	Flag
Lead	550	1.0	mg/Kg	1.00	03/24/2003 18:46	

Severn Trent Laboratories, Inc.

STL San Francisco \* 1220 Quarry Lane, Pleasanton, CA 94566

Tel 925 484 1919 Fax 925 484 1096 \* www.stl-inc.com \* CA DHS ELAP# 2496

03/26/2003 11:40

**Total Lead**

Aqua Science Engineers, Inc.

Attn.: Dave Allen

208 West El Pintado Road  
Danville, CA 94526  
Phone: (925) 820-9391 Fax: (925) 837-4853

Project: Andy Hall 1455 5th Street Oakland

Received: 03/19/2003 16:25

Prep(s):	3050B	Test(s):	6010B
Sample ID:	B-14-1	Lab ID:	2003-03-0405 - 33
Sampled:	03/18/2003 13:15	Extracted:	3/20/2003 13:21
Matrix:	Soil	QC Batch#:	2003/03/20-06:15

Compound	Conc.	RL	Unit	Dilution	Analyzed	Flag
Lead	1600	1.0	mg/Kg	1.00	03/24/2003 18:50	

Severn Trent Laboratories, Inc.

STL San Francisco \* 1220 Quarry Lane, Pleasanton, CA 94566

Tel 925 484 1919 Fax 925 484 1096 \* www.stl-inc.com \* CA DHS ELAP# 2496

03/26/2003 11:40

**Total Lead**

Aqua Science Engineers, Inc.

Attn.: Dave Allen

208 West El Pintado Road

Danville, CA 94526

Phone: (925) 820-9391 Fax: (925) 837-4853

Project: Andy Hall 1455 5th Street Oakland

Received: 03/19/2003 16:25

Prep(s): 3050B	Test(s): 6010B
Sample ID: B-15-1	Lab ID: 2003-03-0405 - 37
Sampled: 03/18/2003 13:20	Extracted: 3/25/2003 05:07
Matrix: Soil	QC Batch#: 2003/03/20-06:15

Compound	Conc.	RL	Unit	Dilution	Analyzed	Flag
Lead	10000	10	mg/Kg	10.00	03/25/2003 11:15	

Severn Trent Laboratories, Inc.

STL San Francisco \* 1220 Quarry Lane, Pleasanton, CA 94566

Tel 925 484 1919 Fax 925 484 1096 \* www.stl-inc.com \* CA DHS ELAP# 2496

03/26/2003 11:40



**Total Lead**

Aqua Science Engineers, Inc.

Attn.: Dave Allen

208 West El Pintado Road

Danville, CA 94526

Phone: (925) 820-9391 Fax: (925) 837-4853

Project: Andy Hall 1455 5th Street Oakland

Received: 03/19/2003 16:25

Prep(s): 3050B	Test(s): 6010B
Sample ID: B-16-1	Lab ID: 2003-03-0405 - 41
Sampled: 03/18/2003 13:22	Extracted: 3/20/2003 15:14
Matrix: Soil	QC Batch#: 2003/03/20-07:15

Compound	Conc.	RL	Unit	Dilution	Analyzed	Flag
Lead	350	1.0	mg/Kg	1.00	03/21/2003 08:18	

Severn Trent Laboratories, Inc.

STL San Francisco \* 1220 Quarry Lane, Pleasanton, CA 94566

Tel 925 484 1919 Fax 925 484 1096 \* www.stl-inc.com \* CA DHS ELAP# 2496

03/26/2003 11:40

**Total Lead**

Aqua Science Engineers, Inc.

Attn.: Dave Allen

208 West El Pintado Road

Danville, CA 94526

Phone: (925) 820-9391 Fax: (925) 837-4853

Project: Andy Hall 1455 5th Street Oakland

Received: 03/19/2003 16:25

Prep(s):	3050B	Test(s):	6010B
Sample ID:	B-17-1	Lab ID:	2003-03-0405 - 45
Sampled:	03/18/2003 13:30	Extracted:	3/20/2003 15:14
Matrix:	Soil	QC Batch#:	2003/03/20-07:15

Compound	Conc.	RL	Unit	Dilution	Analyzed	Flag
Lead	19	1.0	mg/Kg	1.00	03/21/2003 08:22	

Severn Trent Laboratories, Inc.

STL San Francisco \* 1220 Quarry Lane, Pleasanton, CA 94566

Tel 925 484 1919 Fax 925 484 1096 \* www.stl-inc.com \* CA DHS ELAP# 2496

03/26/2003 11:40

**Total Lead**

Aqua Science Engineers, Inc.

Attn.: Dave Allen

208 West El Pintado Road

Danville, CA 94526

Phone: (925) 820-9391 Fax: (925) 837-4853

Project: Andy Hall 1455 5th Street Oakland

Received: 03/19/2003 16:25

Prep(s):	3050B	Test(s):	6010B
Sample ID:	B-18-1	Lab ID:	2003-03-0405 - 49
Sampled:	03/18/2003 13:36	Extracted:	3/20/2003 15:14
Matrix:	Soil	QC Batch#:	2003/03/20-07.15

Compound	Conc.	RL	Unit	Dilution	Analyzed	Flag
Lead	2.3	1.0	mg/Kg	1.00	03/21/2003 08:26	

Severn Trent Laboratories, Inc.

STL San Francisco \* 1220 Quarry Lane, Pleasanton, CA 94566

Tel 925 484 1919 Fax 925 484 1096 \* www.stl-inc.com \* CA DHS ELAP# 2496

03/26/2003 11:40

**Total Lead**

Aqua Science Engineers, Inc.  
Attn.: Dave Allen

208 West El Pintado Road  
Danville, CA 94526  
Phone: (925) 820-9391 Fax: (925) 837-4853  
Project: Andy Hall 1455 5th Street Oakland

Received: 03/19/2003 16:25

Prep(s): 3050B	Test(s): 6010B
Sample ID: B-19-1	Lab ID: 2003-03-0405 - 53
Sampled: 03/18/2003 13:44	Extracted: 3/20/2003 15:14
Matrix: Soil	QC Batch#: 2003/03/20-07:15

Compound	Conc.	RL	Unit	Dilution	Analyzed	Flag
Lead	220	1.0	mg/Kg	1.00	03/21/2003 08:30	

**Total Lead**

Aqua Science Engineers, Inc.

Attn.: Dave Allen

208 West El Pintado Road

Danville, CA 94526

Phone: (925) 820-9391 Fax: (925) 837-4853

Project: Andy Hall 1455 5th Street Oakland

Received: 03/19/2003 16:25

Prep(s): 3050B	Test(s): 6010B
Sample ID: B-20-1	Lab ID: 2003-03-0405 - 57
Sampled: 03/18/2003	Extracted: 3/20/2003 15:14
Matrix: Soil	QC Batch#: 2003/03/20-07:15

Compound	Conc.	RL	Unit	Dilution	Analyzed	Flag
Lead	550	1.0	mg/Kg	1.00	03/21/2003 08:34	

Severn Trent Laboratories, Inc.

STL San Francisco \* 1220 Quarry Lane, Pleasanton, CA 94566

Tel 925 484 1919 Fax 925 484 1096 \* www.stl-inc.com \* CA DHS ELAP# 2496

03/26/2003 11:40

**Total Lead**

Aqua Science Engineers, Inc.

Attn.: Dave Allen

208 West El Pintado Road

Danville, CA 94526

Phone: (925) 820-9391 Fax: (925) 837-4853

Project: Andy Hall 1455 5th Street Oakland

Received: 03/19/2003 16:25

Batch QC Report					
Prep(s): 3050B				Test(s): 6010B	
Method Blank		Soil		QC Batch # 2003/03/20-06.15	
MB: 2003/03/20-06.15-074				Date Extracted: 03/20/2003 13:21	

Compound	Conc.	RL	Unit	Analyzed	Flag
Lead	ND	1.0	mg/Kg	03/24/2003 17:46	

Severn Trent Laboratories, Inc.

STL San Francisco \* 1220 Quarry Lane, Pleasanton, CA 94566

Tel 925 484 1919 Fax 925 484 1096 \* www.stl-inc.com \* CA DHS ELAP# 2496

03/26/2003 11:40

**Total Lead**

Aqua Science Engineers, Inc.  
Attn.: Dave Allen

208 West El Pintado Road  
Danville, CA 94526  
Phone: (925) 820-9391 Fax: (925) 837-4853  
Project: Andy Hall 1455 5th Street Oakland

Received: 03/19/2003 16:25

Batch QC Report					
Prep(s): 3050B		Soil		Test(s): 6010B	
Method Blank				QC Batch # 2003/03/20-07.15	
MB: 2003/03/20-07.15-011				Date Extracted: 03/20/2003 15:14	
Compound	Conc.	RL	Unit	Analyzed	Flag
Lead	ND	1.0	mg/Kg	03/21/2003 06:38	

**Total Lead**

Aqua Science Engineers, Inc.

Attn.: Dave Allen

208 West El Pintado Road

Danville, CA 94526

Phone: (925) 820-9391 Fax: (925) 837-4853

Project: Andy Hall 1455 5th Street Oakland

Received: 03/19/2003 16:25

Batch QC Report										
Prep(s): 3050B						Test(s): 6010B				
Laboratory Control Spike			Soil			QC Batch # 2003/03/20-06.15				
LCS	2003/03/20-06.15-075		Extracted: 03/20/2003			Analyzed: 03/24/2003 17:51				
LCSD	2003/03/20-06.15-076		Extracted: 03/20/2003			Analyzed: 03/24/2003 17:55				
Compound	Conc. mg/Kg		Exp.Conc.	Recovery		RPD	Ctrl.Limits %		Flags	
	LCS	LCSD		LCS	LCSD		%	Rec.	RPD	LCS
Lead	105	104	100.0	105.0	104.0	1.0	80-120	20		

Severn Trent Laboratories, Inc.

STL San Francisco \* 1220 Quarry Lane, Pleasanton, CA 94566

Tel 925 484 1919 Fax 925 484 1096 \* www.stl-inc.com \* CA DHS ELAP# 2496

03/26/2003 11:40



**Total Lead**

Aqua Science Engineers, Inc.  
Attn.: Dave Allen

208 West El Pintado Road  
Danville, CA 94526  
Phone: (925) 820-9391 Fax: (925) 837-4853

Project: Andy Hall 1455 5th Street Oakland

Received: 03/19/2003 16:25

Batch QC Report										
Prep(s): 3050B						Test(s): 6010B				
Laboratory Control Spike				Soil			QC Batch # 2003/03/20-07.15			
LCS	2003/03/20-07.15-012			Extracted: 03/20/2003			Analyzed: 03/21/2003 06:43			
LCSD	2003/03/20-07.15-013			Extracted: 03/20/2003			Analyzed: 03/21/2003 06:47			
Compound	Conc. mg/Kg		Exp. Conc.	Recovery		RPD	Ctrl. Limits %		Flags	
	LCS	LCSD		LCS	LCSD		%	Rec.	RPD	LCS
Lead	97.9	98.3	100.0	97.9	98.3	0.4	80-120	20		



**STL San Francisco**  
Chain of Custody

1220 Quarry Lane • Pleasanton CA 94566-4756  
Phone: (925) 484-1919 • Fax: (925) 484-1096  
Email: info@stl.com/lab.com

**2003-03-0405**

Reference #: 72734

Date 3/18/03 Page 1 of 6

Apr 29 03 03:55P  
STL Onsite  
9256003002  
P. 2

**Report To**      **Analysis Request**

Attn: D. Allen  
Company: ASE  
Address: Danville, CA  
Phone: 925-820-9391 Email:  
Bill To:  
Attn:  
Sampled By:  
Phone:

- TPH EPA -  8015/8021  8260B
- Gas w/  BTEX  MTBE
- Purgable Aromatics
- BTEX EPA -  8021  8260B
- TEPH EPA 8015M  Solica Gel
- Diesel  Motor Oil  Other
- Fuel Tests EPA 8260B  Gas  BTEX
- Five Oxygenates  DCA, EDB  Ethanol
- Purgable Halocarbons (HVCs) EPA 8021
- Volatile Organics GC/MS (VOCs)
- EPA 8260B  624
- Semivolatiles GC/MS
- EPA 8270  625
- Oil and Grease  Petroleum (EPA 1684)  Total
- Pesticides  EPA 8081  608
- PCBs  EPA 8082  608
- PNAs by  8270  8310
- CAM17 Metals (EPA 6010/7470/7471)
- Metals:  Lead  LUFT  RCRA  Other:
- W.E.T (STLC)
- TCLP
- Hexavalent Chromium
- pH (24h hold time for H<sub>2</sub>O)
- Spec Cond.  Alkalinity
- TSS  TDS
- Anions:  Cl  SO<sub>4</sub>  NO<sub>3</sub>  F  Br  NO<sub>2</sub>  PO<sub>4</sub>

Sample ID	Date	Time	Mat. rx.	Pres. env.	TPH EPA	BTEX EPA	TEPH EPA	Fuel Tests	Purgable Halocarbons	Volatile Organics	Semivolatiles	Oil and Grease	Pesticides	PCBs	PNAs	CAM17 Metals	Metals	W.E.T	TCLP	Hexavalent Chromium	pH	Spec Cond.	TSS	Alkalinity	Anions	Number of Containers
1 B-6-1'	3/18/03	1229	S	-																						
2 B-6-2'		1223																								
3 B-6-3'		1222																								X
4 B-6-4'		1221																								X
5 B-7-1'		1233																								X
6 B-7-2'		1232																								X
7 B-7-3'		1231																								X
8 B-7-4'		1230																								X
9 B-8-1'		1238																								X
10 B-8-2'		1237																								X

**Project Info.**  
Project Name: 1455 5th street  
Andy Hall Oakland  
Project#: \_\_\_\_\_  
PO#: \_\_\_\_\_  
Credit Card#: \_\_\_\_\_  
TAT: Std 5 Day    72h    48h    24h  
Report:  Routine  Level 3  Level 4  EDD  State Tank Fund EDF  Global ID  
Special Instructions / Comments:

**Sample Receipt**  
# of Containers: \_\_\_\_\_  
Head Space: \_\_\_\_\_  
Temp: 4.5°C  
Conforms to record: \_\_\_\_\_  
Other: \_\_\_\_\_

1) Relinquished by:  
E. Paddock  
Signature \_\_\_\_\_ Time \_\_\_\_\_  
E. Paddock  
Printed Name \_\_\_\_\_ Date \_\_\_\_\_  
ASE  
Company \_\_\_\_\_

1) Received by:  
M. Villanueva  
Signature \_\_\_\_\_ Time \_\_\_\_\_  
M. Villanueva 3/19/03  
Printed Name \_\_\_\_\_ Date \_\_\_\_\_  
STL-SF  
Company \_\_\_\_\_

2) Relinquished by:  
Signature \_\_\_\_\_ Time \_\_\_\_\_  
Printed Name \_\_\_\_\_ Date \_\_\_\_\_  
Company \_\_\_\_\_

2) Received by:  
Signature \_\_\_\_\_ Time \_\_\_\_\_  
Printed Name \_\_\_\_\_ Date \_\_\_\_\_  
Company \_\_\_\_\_

3) Relinquished by:  
E. Paddock  
Signature \_\_\_\_\_ Time 16:25  
M. Villanueva 3/19/03  
Printed Name \_\_\_\_\_ Date \_\_\_\_\_  
STL-SF  
Company \_\_\_\_\_

3) Received by:  
M. Villanueva  
Signature \_\_\_\_\_ Time 16:25  
M. Villanueva 3/19/03  
Printed Name \_\_\_\_\_ Date \_\_\_\_\_  
STL-SF  
Company \_\_\_\_\_



# STL San Francisco

Chain of Custody

1220 Quarry Lane • Pleasanton CA 94566-4756  
Phone: (925) 484-1919 Fax: (925) 484-0066  
Email: info@chronalab.com

# 03-03-0405

Reference #: 72734  
Date 3/18/03 Page 2 of 6

Apr 29 03 03:55P  
STL Onsite

9256003002

P.3

## Report To

Attn: D Allen  
Company: ASE  
Address: Danville, CA  
Phone: 925-820-9891 Email:  
Bill To:  
Atrn:  
Sampled By:  
Phone:

## Analysis Request

<input type="checkbox"/> TPH EPA - 80150021	<input type="checkbox"/> 8260B	<input type="checkbox"/> Gas w/	<input type="checkbox"/> STEX	<input type="checkbox"/> MTBE
<input type="checkbox"/> Purgeable Aromatics	<input type="checkbox"/> STEX EPA - 8021	<input type="checkbox"/> 8260B		
<input type="checkbox"/> TEPH EPA 8015M	<input type="checkbox"/> Silica Gel	<input type="checkbox"/> Diesel	<input type="checkbox"/> Motor Oil	<input type="checkbox"/> Other
<input type="checkbox"/> Fuel Tests EPA 8260B:	<input type="checkbox"/> Gas	<input type="checkbox"/> STEX	<input type="checkbox"/> Fire Cytovels	<input type="checkbox"/> DCA, E26
<input type="checkbox"/> Ethand				
<input type="checkbox"/> Purgeable Halocarbons (HVOCs) EPA 8021				
<input type="checkbox"/> Volatile Organics GC/MS (VOCs)	<input type="checkbox"/> EPA 8260B	<input type="checkbox"/> 924		
<input type="checkbox"/> Semivolatiles GC/MS	<input type="checkbox"/> EPA 8270	<input type="checkbox"/> 625		
<input type="checkbox"/> Oil and Grease	<input type="checkbox"/> Petroleum (EPA 1664)	<input type="checkbox"/> Total		
<input type="checkbox"/> Pesticides	<input type="checkbox"/> EPA 8081	<input type="checkbox"/> 808	<input type="checkbox"/> EPA 8082	<input type="checkbox"/> 606
<input type="checkbox"/> PCBs				
<input type="checkbox"/> PNAs by	<input type="checkbox"/> 8270	<input type="checkbox"/> 8310		
<input type="checkbox"/> CAM17 Metals (EPA 601074707471)				
<input type="checkbox"/> Metals:	<input type="checkbox"/> Lead	<input type="checkbox"/> LUFT	<input type="checkbox"/> RCRA	<input type="checkbox"/> Other:
<input type="checkbox"/> W.E.T (STLC)	<input type="checkbox"/> TCLP			
<input type="checkbox"/> Hexavalent Chromium	<input type="checkbox"/> pH (24h acid time for H <sub>2</sub> O)			
<input type="checkbox"/> Spec Cond	<input type="checkbox"/> Alkalinity	<input type="checkbox"/> TDS		
<input type="checkbox"/> Anions:	<input type="checkbox"/> Cl	<input type="checkbox"/> SO <sub>4</sub>	<input type="checkbox"/> NO <sub>3</sub>	<input type="checkbox"/> F
	<input type="checkbox"/> Br	<input type="checkbox"/> NO <sub>2</sub>	<input type="checkbox"/> PO <sub>4</sub>	

Sample ID	Date	Time	Mat	Pres	Grav
11 B-8-3'	3/18/03	1236	>	-	
12 B-8-4'		1235			
13 B-9-1'		1243			
14 B-9-2'		1241			
15 B-9-3'		1241			
16 B-9-4'		1240			
17 B-10-1'		1254			
18 B-10-2'		1252			
19 B-10-3'		1250			
20 B-10-4'		1247			

## Project Info.

Project Name: 1455 5th street  
Andy Hall Oakland  
Project#: \_\_\_\_\_  
Head Space: \_\_\_\_\_  
PO#: \_\_\_\_\_  
Temp: \_\_\_\_\_  
Credit Card#: \_\_\_\_\_  
Conforms to record: \_\_\_\_\_  
Other: \_\_\_\_\_

1) Relinquished by:  
E Paddock  
Signature \_\_\_\_\_ Time \_\_\_\_\_  
E Paddock  
Printed Name \_\_\_\_\_ Date \_\_\_\_\_  
ASE  
Company \_\_\_\_\_

2) Relinquished by:  
Signature \_\_\_\_\_ Time \_\_\_\_\_  
Printed Name \_\_\_\_\_ Date \_\_\_\_\_  
Company \_\_\_\_\_

3) Relinquished by:  
[Signature] 16:25  
Signature \_\_\_\_\_ Time \_\_\_\_\_  
B. Moron 3/19/03  
Printed Name \_\_\_\_\_ Date \_\_\_\_\_  
STL-SF  
Company \_\_\_\_\_

Report:  Routine  Level 3  Level 4  EDD  State Tank Fund EDF  Global ID  
Special Instructions / Comments:

1) Received by:  
[Signature] 16:25  
Signature \_\_\_\_\_ Time \_\_\_\_\_  
B. Moron 3/19/03  
Printed Name \_\_\_\_\_ Date \_\_\_\_\_  
STL-SF  
Company \_\_\_\_\_

2) Received by:  
Signature \_\_\_\_\_ Time \_\_\_\_\_  
Printed Name \_\_\_\_\_ Date \_\_\_\_\_  
Company \_\_\_\_\_

3) Received by:  
[Signature] 16:25  
Signature \_\_\_\_\_ Time \_\_\_\_\_  
M. Villanuda 3/19/03  
Printed Name \_\_\_\_\_ Date \_\_\_\_\_  
STL SF  
Company \_\_\_\_\_



**STL San Francisco**  
Chain of Custody

1220 Quarry Lane • Pleasanton CA 94566-4756  
Phone: (925) 84-1900 Fax: (925) 44-1095  
Email: info@chronolab.com

**03 03 0405**

Reference #: 72734

Date 3/18/03 Page 3 of 6

**Report To**

Attn: D Allen  
Company: ASE  
Address: Danville, CA  
Phone: 925-820-9291 Email:  
Bill To: \_\_\_\_\_  
Attn: \_\_\_\_\_  
Phone: \_\_\_\_\_

**Analysis Request**

Sample ID	Date	Time	Mat tik	Pres ev	TPH EPA - <input type="checkbox"/> 8015/8021 <input type="checkbox"/> 8262/8 <input type="checkbox"/> Gas w/ <input type="checkbox"/> BTEX <input type="checkbox"/> MTBE	Purgeable Aromatics STEX EPA - <input type="checkbox"/> 8021 <input type="checkbox"/> 8252/8	TEPH EPA 8015/8 <input type="checkbox"/> Silica Gel <input type="checkbox"/> Diesel <input type="checkbox"/> Motor Oil <input type="checkbox"/> Other	Fuel Tests EPA 8262/8: <input type="checkbox"/> Gas <input type="checkbox"/> BTEX <input type="checkbox"/> Five Cyanides <input type="checkbox"/> DCA, EDB <input type="checkbox"/> Ethanol	Purgeable Halocarbons (VOCs) EPA 8021	Volatile Organics GC/MS (VOCs) <input type="checkbox"/> EPA 8260/8 <input type="checkbox"/> 824	Semivolatiles GC/MS <input type="checkbox"/> EPA 8270 <input type="checkbox"/> 825	Oil and Grease <input type="checkbox"/> Petroleum (EPA 1664) <input type="checkbox"/> Total	Pesticides <input type="checkbox"/> EPA 8081 <input type="checkbox"/> 808 PCBs <input type="checkbox"/> EPA 8082 <input type="checkbox"/> 808	PNAs by <input type="checkbox"/> 8270 <input type="checkbox"/> 8310	CAM17 Metals (EPA 6010/7470/7471)	Metals: <input type="checkbox"/> Lead <input type="checkbox"/> LUFT <input type="checkbox"/> RCRA <input type="checkbox"/> Other:	WLE.T (STLC) TCUP	Hexavalent Chromium pH (24h hold time for H <sub>2</sub> O)	Spec Cond. <input type="checkbox"/> Alkalinity TSS <input type="checkbox"/> TDS	Anions: <input type="checkbox"/> Cl <input type="checkbox"/> SO <sub>4</sub> <input type="checkbox"/> NO <sub>3</sub> <input type="checkbox"/> F <input type="checkbox"/> Br <input type="checkbox"/> NO <sub>2</sub> <input type="checkbox"/> PO <sub>4</sub>																		
<u>21</u> B-11-1'	<u>3/18/03</u>	<u>1302</u>	<u>S</u>	<u>-</u>																																		
<u>22</u> B-11-2'		<u>1301</u>																																				
<u>23</u> B-11-3'		<u>1259</u>																																				
<u>24</u> B-11-4'		<u>1257</u>																																				
<u>25</u> B-12-1'		<u>1309</u>																																				
<u>26</u> B-12-2'		<u>1308</u>																																				
<u>27</u> B-12-3'		<u>1307</u>																																				
<u>28</u> B-12-4'		<u>1306</u>																																				
<u>29</u> B-13-1'		<u>1310</u>																																				
<u>30</u> B-13-2'		<u>1308</u>																																				

Number of Containers  
**11 Onsite**

9256003002

P. 4

**Project Info.**

Project Name: Andy Hall 1455 5th street  
Project#: \_\_\_\_\_  
PO#: \_\_\_\_\_  
Credit Card#: \_\_\_\_\_

**Sample Receipt**

# of Containers: \_\_\_\_\_  
Head Space: \_\_\_\_\_  
Temp: \_\_\_\_\_  
Conforms to record: \_\_\_\_\_

Report:  Routine  Level 3  Level 4  EDD  State Tank Fund EDF  
Special Instructions / Comments: \_\_\_\_\_

1) Relinquished by:  
E Peckold  
Signature \_\_\_\_\_ Time \_\_\_\_\_  
E Peckold  
Printed Name \_\_\_\_\_ Date \_\_\_\_\_  
Company: ASE

2) Relinquished by:  
Signature \_\_\_\_\_ Time \_\_\_\_\_  
Printed Name \_\_\_\_\_ Date \_\_\_\_\_  
Company \_\_\_\_\_

3) Relinquished by:  
[Signature]  
Signature \_\_\_\_\_ Time \_\_\_\_\_  
B Morrison 3/19/03  
Printed Name \_\_\_\_\_ Date \_\_\_\_\_  
Company: STL-SF

1) Received by:  
[Signature]  
Signature \_\_\_\_\_ Time \_\_\_\_\_  
B Morrison 3/19/03  
Printed Name \_\_\_\_\_ Date \_\_\_\_\_  
Company: STL-SF

2) Received by:  
Signature \_\_\_\_\_ Time \_\_\_\_\_  
Printed Name \_\_\_\_\_ Date \_\_\_\_\_  
Company \_\_\_\_\_

3) Received by:  
[Signature]  
Signature \_\_\_\_\_ Time \_\_\_\_\_  
M. Villanueva 3/19/03  
Printed Name \_\_\_\_\_ Date \_\_\_\_\_  
Company: STL SF



# STL San Francisco

Chain of Custody

1220 Quarry Lane • Pleasanton CA 94566-4756  
 Phone: (925) 499-1919 Fax: (925) 494-1086  
 Email: info@chronolab.com

Reference #: 72734

**03-03-0405**

Date 3/18/03 Page 4 of 6

### Report To

Attn: D Allen  
 Company: ASE  
 Address: Danville, CA  
 Phone: 925-820-9391 Email:  
 Bill To:  
 Sampled By:  
 Attn:  
 Phone:

### Analysis Request

<input type="checkbox"/> TPH EPA - 8015/8021 <input type="checkbox"/> 8260B <input type="checkbox"/> Gas w/ <input type="checkbox"/> BTEX <input type="checkbox"/> MTBE	<input type="checkbox"/> Purgeable Aromatics BTEX EPA - 8021 <input type="checkbox"/> 8260B	<input type="checkbox"/> TEPH EPA 8015M <input type="checkbox"/> Silica Gel <input type="checkbox"/> Diesel <input type="checkbox"/> Motor Oil <input type="checkbox"/> Other	<input type="checkbox"/> Fuel Tests EPA 8280B: <input type="checkbox"/> Gas <input type="checkbox"/> BTEX <input type="checkbox"/> Free Compounds <input type="checkbox"/> DCA, EDB <input type="checkbox"/> Ethanol	<input type="checkbox"/> Purgeable Halocarbons (HVOCs) EPA 8021	<input type="checkbox"/> Volatile Organics GC/MS (VOCs) <input type="checkbox"/> EPA 8260B <input type="checkbox"/> 624	<input type="checkbox"/> Semivolatiles GC/MS <input type="checkbox"/> EPA 8270 <input type="checkbox"/> 625	<input type="checkbox"/> Oil and Grease <input type="checkbox"/> Petroleum (EPA 1664) <input type="checkbox"/> Total	<input type="checkbox"/> Pesticides <input type="checkbox"/> EPA 8081 <input type="checkbox"/> 808 <input type="checkbox"/> PCBs <input type="checkbox"/> EPA 8082 <input type="checkbox"/> 808	<input type="checkbox"/> PNAs by <input type="checkbox"/> 8270 <input type="checkbox"/> 8310	<input type="checkbox"/> CAM17 Metals (EPA 8010/7470/7471)	<input type="checkbox"/> Metals: <input type="checkbox"/> Lead <input type="checkbox"/> LUFT <input type="checkbox"/> RCRA <input type="checkbox"/> Other:	<input type="checkbox"/> W.E.T.(STLC) <input type="checkbox"/> TCLP	<input type="checkbox"/> Hexavalent Chromium pH (24h hold time for H <sub>2</sub> O)	<input type="checkbox"/> Spec Cond. <input type="checkbox"/> Alkalinity <input type="checkbox"/> TSS <input type="checkbox"/> TDS	Anions: <input type="checkbox"/> Cl <input type="checkbox"/> SO <sub>4</sub> <input type="checkbox"/> NO <sub>3</sub> <input type="checkbox"/> F <input type="checkbox"/> Br <input type="checkbox"/> NO <sub>2</sub> <input type="checkbox"/> PO <sub>4</sub>	<u>TTU lead</u>	<u>HOLD</u>
--	--	--	---	---	--	--	--	--	--	--	---	--	---	--	---	-----------------	-------------

Sample ID	Date	Time	Mat	Pres
31 B-13-3'	<u>3/18/03</u>	<u>1307</u>	<u>S</u>	<u>-</u>
32 B-13-4'	<u>3/18/03</u>	<u>1306</u>		
33 B-14-1'		<u>1315</u>		
34 B-14-2'		<u>1314</u>		
35 B-14-3'		<u>1313</u>		
36 B-14-4'		<u>1312</u>		
37 B-15-1'		<u>1320</u>		
38 B-15-2'		<u>1319</u>		
39 B-15-3'		<u>1318</u>		
40 B-15-4'		<u>1317</u>		

Apr 29 03 03:56p  
 510inside  
 9256003002  
 P. 5

### Project Info.

Project Name: 1455 5th street  
Andy Hall Oakland  
 Project#: \_\_\_\_\_  
 PO#: \_\_\_\_\_  
 Credit Card#: \_\_\_\_\_  
 Other:  Std 5 Day  72h  48h  24h

### Sample Receipt

# of Containers: \_\_\_\_\_  
 Head Space: \_\_\_\_\_  
 Temp: \_\_\_\_\_  
 Conforms to record: \_\_\_\_\_

1) Relinquished by:  
E Paddock  
 Signature \_\_\_\_\_ Time \_\_\_\_\_  
E Paddock  
 Printed Name \_\_\_\_\_ Date \_\_\_\_\_  
ASE  
 Company \_\_\_\_\_

2) Relinquished by:  
 Signature \_\_\_\_\_ Time \_\_\_\_\_  
 Printed Name \_\_\_\_\_ Date \_\_\_\_\_  
 Company \_\_\_\_\_

3) Relinquished by:  
E Paddock  
 Signature \_\_\_\_\_ Time \_\_\_\_\_  
V. Mauer 3/19/03  
 Printed Name \_\_\_\_\_ Date \_\_\_\_\_  
STL-SF  
 Company \_\_\_\_\_

1) Received by:  
M. Villaverde  
 Signature \_\_\_\_\_ Time \_\_\_\_\_  
V. Mauer 3/19/03  
 Printed Name \_\_\_\_\_ Date \_\_\_\_\_  
STL-SF  
 Company \_\_\_\_\_

2) Received by:  
 Signature \_\_\_\_\_ Time \_\_\_\_\_  
 Printed Name \_\_\_\_\_ Date \_\_\_\_\_  
 Company \_\_\_\_\_

3) Received by:  
M. Villaverde  
 Signature \_\_\_\_\_ Time \_\_\_\_\_  
M. Villaverde 3/19/03  
 Printed Name \_\_\_\_\_ Date \_\_\_\_\_  
STL-SF  
 Company \_\_\_\_\_

Report:  Routine  Level 3  Level 4  EDD  State Tank Fund EDD  
 Special Instructions / Comments:  Global ID



# STL San Francisco

Chain of Custody

1220 Quarry Lane • Pleasanton CA 94566-4756  
 Phone: (925) 484-1919 • Fax: (925) 484-1096  
 Email: info@chromat.com

Reference #: 72434

Date 3/18/03 Page 5 of 6

**03-03-0405**

Apr 29 03 03:56p

STI Onsite

9256003002

P.6

## Report To

Attn: D Allen  
 Company: ASE  
 Address: Danville, CA  
 Phone: 925-820-9391 Email: \_\_\_\_\_  
 Bill To: \_\_\_\_\_  
 Attn: \_\_\_\_\_  
 Phone: \_\_\_\_\_

Sample ID	Date	Time	Mat rix	Pres erv	TPH EPA - <input type="checkbox"/> 80150021 <input type="checkbox"/> 82608 <input type="checkbox"/> Gas w/ <input type="checkbox"/> BTEX <input type="checkbox"/> MTBE	Purgeable Aromatics STEX EPA - <input type="checkbox"/> B271 <input type="checkbox"/> 82608	TEPH EPA 8015M <input type="checkbox"/> Silica Gel <input type="checkbox"/> Diesel <input type="checkbox"/> Motor Oil <input type="checkbox"/> Other	Fuel Tests EPA 82608: <input type="checkbox"/> Gas <input type="checkbox"/> BTEX <input type="checkbox"/> Five Oxygenates <input type="checkbox"/> DCA, ED8 <input type="checkbox"/> Ethanol	Purgeable Halocarbons (HVOCs) EPA 8021	Volatile Organics GC/MS (VOCs) <input type="checkbox"/> EPA 8260B <input type="checkbox"/> 824	Semivolatiles GC/MS <input type="checkbox"/> EPA 8270 <input type="checkbox"/> 825	Oil and Grease <input type="checkbox"/> Petroleum (EPA 1631) <input type="checkbox"/> Total	Pesticides <input type="checkbox"/> EPA 8081 <input type="checkbox"/> 608 <input type="checkbox"/> PCBs <input type="checkbox"/> EPA 8082 <input type="checkbox"/> 606	PAHs by <input type="checkbox"/> 8270 <input type="checkbox"/> 8310	CAM17 Metals (EPA 8010/4707/71)	Metals: <input type="checkbox"/> Lead <input type="checkbox"/> LUFT <input type="checkbox"/> RCRA <input type="checkbox"/> Other	W.E.T (STLO) TCLP	Hexavalent Chromium pH (24h hold time for H <sub>2</sub> O)	Spec Cond. <input type="checkbox"/> Alkalinity TSS <input type="checkbox"/> TDS	Anions: <input type="checkbox"/> Cl <input type="checkbox"/> SO <sub>4</sub> <input type="checkbox"/> NO <sub>3</sub> <input type="checkbox"/> F <input type="checkbox"/> Br <input type="checkbox"/> NO <sub>2</sub> <input type="checkbox"/> PO <sub>4</sub>	Notes	Hold		
11 B-16-1'	3/18/03	1322	S	-																	X			
12 B-16-2'		1324																				X		
13 B-16-3'		1326																						
14 B-16-4'		1328																						
15 B-17-1'		1330																						
16 B-17-2'		1329																						
17 B-17-3'		1327																						
18 B-17-4		1326																						
19 B-18-1'		1336																						
20 B-18-2'		1335																						

### Project Info

Project Name: 1455 5th street  
 Andy Hall Oakley  
 Project#: \_\_\_\_\_  
 PO#: \_\_\_\_\_  
 Credit Card#: \_\_\_\_\_

### Sample Receipt

# of Containers: \_\_\_\_\_  
 Head Space: \_\_\_\_\_  
 Temp: \_\_\_\_\_  
 Conforms to record: \_\_\_\_\_  
 Other: \_\_\_\_\_

<p>1) Relinquished by:                    Signature _____ Time _____                  Printed Name <u>E Paddenford</u> Date _____                  Company <u>ASE</u></p>	<p>2) Relinquished by:                  Signature _____ Time _____                  Printed Name _____ Date _____                  Company _____</p>	<p>3) Relinquished by:                    Signature _____ Time _____                  Printed Name <u>B. Molina</u> Date <u>3/19/03</u>                  Company <u>STL-5F</u></p>
<p>1) Received by:                    Signature _____ Time _____                  Printed Name <u>M. Villanueva</u> Date <u>3/19/03</u>                  Company <u>STL-5F</u></p>	<p>2) Received by:                  Signature _____ Time _____                  Printed Name _____ Date _____                  Company _____</p>	<p>3) Received by:                    Signature _____ Time _____                  Printed Name <u>M. Villanueva</u> Date <u>3/19/03</u>                  Company <u>STL 8F</u></p>

Report:  Routine  Level 3  Level 4  EDD  State Tank Fund EDF  
 Special Instructions / Comments:

Report:  Routine  Level 3  Level 4  EDD  State Tank Fund EDF  
 Global ID

Rev 01/02



# STL San Francisco

Chain of Custody

1220 Quarry Lane • Pleasanton CA 94566-4756  
 Phone: (925) 484-1919 Fax: (925) 484-1000  
 Email: info@stlmemlab.com

Reference #: 72734

Date 3/18/03 Page 6 of 6

**03-03-0405**

## Report To: Analysis Request

Attn: D. Allen  
 Company: ASE  
 Address: Danville, CA  
 Phone: 925-820-9391 Email:  
 Bill To:  
 Attn:  
 Sampled By:  
 Phone:

TPH EPA - <input type="checkbox"/> 80158021 <input type="checkbox"/> 82605 <input type="checkbox"/> Gas w/ <input type="checkbox"/> BTEX <input type="checkbox"/> MTBE	Purgeable Aromatics BTEX EPA - <input type="checkbox"/> 8021 <input type="checkbox"/> 82606	TEPH EPA 8015M <input type="checkbox"/> Silica Gel <input type="checkbox"/> Diesel <input type="checkbox"/> Motor Oil <input type="checkbox"/> Other	Fuel Tests EPA 82608: <input type="checkbox"/> Gas <input type="checkbox"/> BTEX <input type="checkbox"/> Five Oxygenates <input type="checkbox"/> DCA, EDB <input type="checkbox"/> Ethanol	Purgeable Halocarbons (MVOCs) EPA 8021	Volatile Organics GC/MS (VOCs) <input type="checkbox"/> EPA 82608 <input type="checkbox"/> 624	Semi-volatiles GC/MS <input type="checkbox"/> EPA 8270 <input type="checkbox"/> 825	Oil and Grease <input type="checkbox"/> Petroleum (EPA 1664) <input type="checkbox"/> Total	Pesticides <input type="checkbox"/> EPA 8081 <input type="checkbox"/> 608 <input type="checkbox"/> PCBs <input type="checkbox"/> EPA 8082 <input type="checkbox"/> 608	PAHs by <input type="checkbox"/> 8270 <input type="checkbox"/> 8310	CAM17 Metals (EPA 60107/4707/471)	Metals: <input type="checkbox"/> Lead <input type="checkbox"/> LUFT <input type="checkbox"/> RCRA <input type="checkbox"/> Other	WET (STLC): <input type="checkbox"/> TCLP	Hexavalent Chromium pH (24h hold time for H <sub>2</sub> O)	Spec Cond. <input type="checkbox"/> Alkalinity TSS <input type="checkbox"/> TDS	Arsenic: <input type="checkbox"/> Cl <input type="checkbox"/> SO <sub>4</sub> <input type="checkbox"/> NO <sub>3</sub> <input type="checkbox"/> F <input type="checkbox"/> Br <input type="checkbox"/> NO <sub>2</sub> <input type="checkbox"/> PO <sub>4</sub>
---	--	---	---	---	---	--	--	---	---	--------------------------------------	---	--	--	--	--

Sample ID	Date	Time	Mat rix	Pres erv.	TPH	Purgeable Aromatics	TEPH	Fuel Tests	Purgeable Halocarbons	Volatile Organics	Semi-volatiles	Oil and Grease	Pesticides	PAHs	CAM17 Metals	Metals	WET (STLC)	Hexavalent Chromium	Spec Cond.	Arsenic	Other			
51 B-18-3'	3/18/03	1334	S	-																				
52 B-18-4'		1333																						
53 B-19-1'		1344																						X
54 B-19-2'		1341																						X
55 B-19-3'		1340																						X
56 B-19-4'		1339																						X
57 B-20-1'																								X
58 B-20-2'																								X
59 B-20-3'																								X
60 B-20-4'																								X

*TTCC lead*

*HOLY*

Number of Containers: 51 Onsite

**Project Info:**  
 Project Name: 1455 5th street  
 Project#: Andy Hall Oakland  
 PO#: \_\_\_\_\_  
 Credit Card#: \_\_\_\_\_  
 T  Std 5 Day 72h 48h 24h  
 A  Routine  Level 3  Level 4  EOD  State Tank Fund EDF  
 T  Special Instructions / Comments:  Global ID \_\_\_\_\_

**Sample Receipt:**  
 # of Containers: \_\_\_\_\_  
 Head Space: \_\_\_\_\_  
 Temp: \_\_\_\_\_  
 Conforms to record: \_\_\_\_\_  
 Other: \_\_\_\_\_

1) Relinquished by:  
 Signature: E. Paddock Time: \_\_\_\_\_  
 Printed Name: E. Paddock Date: \_\_\_\_\_  
 Company: ASE

1) Received by:  
 Signature: [Signature] Time: \_\_\_\_\_  
 Printed Name: [Name] Date: \_\_\_\_\_  
 Company: STL - SF

2) Relinquished by:  
 Signature: \_\_\_\_\_ Time: \_\_\_\_\_  
 Printed Name: \_\_\_\_\_ Date: \_\_\_\_\_  
 Company: \_\_\_\_\_

2) Received by:  
 Signature: \_\_\_\_\_ Time: \_\_\_\_\_  
 Printed Name: \_\_\_\_\_ Date: \_\_\_\_\_  
 Company: \_\_\_\_\_

3) Relinquished by:  
 Signature: [Signature] Time: 16:25  
 Printed Name: [Name] Date: 3/19/03  
 Company: STL - SF

3) Received by:  
 Signature: [Signature] Time: 16:25  
 Printed Name: M. Villanueva Date: 3/19/03  
 Company: STL 9P

9256003002

P. 7

**Total Lead**

Aqua Science Engineers, Inc.

Attn.: Dave Allen

208 West El Pintado Road

Danville, CA 94526

Phone: (925) 820-9391 Fax: (925) 837-4853

Project: Andy Hall

Received: 03/19/2003

Site: 1455 5th Street

Oakland, CA

**Samples Reported**

Sample Name	Date Sampled	Matrix	Lab #
B-6-2	03/18/2003 12:23	Soil	1
B-7-2	03/18/2003 12:32	Soil	2
B-8-2	03/18/2003 12:37	Soil	3
B-9-2	03/18/2003 12:41	Soil	4
B-10-2	03/18/2003 12:52	Soil	5
B-11-2	03/18/2003 13:01	Soil	6
B-12-2	03/18/2003 13:08	Soil	7
B-13-2	03/18/2003 13:08	Soil	8
B-14-2	03/18/2003 13:14	Soil	9
B-15-2	03/18/2003 13:19	Soil	10
B-16-2	03/18/2003 13:29	Soil	11
B-17-2	03/18/2003 13:29	Soil	12
B-18-2	03/18/2003 13:35	Soil	13
B-19-2	03/18/2003 13:41	Soil	14
B-20-2	03/18/2003	Soil	15

Severn Trent Laboratories, Inc.

STL San Francisco \* 1220 Quarry Lane, Pleasanton, CA 94566

Tel 925 484 1919 Fax 925 484 1096 \* www.stl-inc.com \* CA DHS ELAP# 2496

04/03/2003 12:00



**Total Lead**

Aqua Science Engineers, Inc.

Attn.: Dave Allen

208 West El Pintado Road

Danville, CA 94526

Phone: (925) 820-9391 Fax: (925) 837-4853

Project: Andy Hall

Received: 03/19/2003

Site: 1455 5th Street  
Oakland, CA

Prep(s):	3050B	Test(s):	6010B
Sample ID:	B-6-2	Lab ID:	2003-03-0687 - 1
Sampled:	03/18/2003 12:23	Extracted:	3/31/2003 12:51
Matrix:	Soil	QC Batch#:	2003/03/31-08.15

Compound	Conc.	RL	Unit	Dilution	Analyzed	Flag
Lead	710	1.0	mg/Kg	1.00	04/01/2003 13:59	

Severn Trent Laboratories, Inc.

STL San Francisco \* 1220 Quarry Lane, Pleasanton, CA 94566

Tel 925 484 1919 Fax 925 484 1096 \* www.stl-inc.com \* CA DHS ELAP# 2496

04/03/2003 12:00

**Total Lead**

Aqua Science Engineers, Inc.  
Attn.: Dave Allen

208 West El Pintado Road  
Danville, CA 94526  
Phone: (925) 820-9391 Fax: (925) 837-4853

Project: Andy Hall

Received: 03/19/2003

Site: 1455 5th Street  
Oakland, CA

Prep(s): 3050B	Test(s): 6010B
Sample ID: B-7-2	Lab ID: 2003-03-0687 - 2
Sampled: 03/18/2003 12:32	Extracted: 3/31/2003 12:51
Matrix: Soil	QC Batch#: 2003/03/31-08.15

Compound	Conc.	RL	Unit	Dilution	Analyzed	Flag
Lead	34	1.0	mg/Kg	1.00	04/01/2003 14:22	

**Total Lead**

Aqua Science Engineers, Inc.  
Attn.: Dave Allen

208 West El Pintado Road  
Danville, CA 94526  
Phone: (925) 820-9391 Fax: (925) 837-4853

Project: Andy Hall

Received: 03/19/2003

Site: 1455 5th Street  
Oakland, CA

Prep(s):	3050B	Test(s):	6010B
Sample ID:	B-8-2	Lab ID:	2003-03-0687 - 3
Sampled:	03/18/2003 12:37	Extracted:	3/31/2003 12:51
Matrix:	Soil	QC Batch#:	2003/03/31-08.15

Compound	Conc.	RL	Unit	Dilution	Analyzed	Flag
Lead	1.8	1.0	mg/Kg	1.00	04/01/2003 14:25	

**Total Lead**

Aqua Science Engineers, Inc.

Attn.: Dave Allen

208 West El Pintado Road

Danville, CA 94526

Phone: (925) 820-9391 Fax: (925) 837-4853

Project: Andy Hall

Received: 03/19/2003

Site: 1455 5th Street  
Oakland, CA

Prep(s)	3050B	Test(s)	6010B
Sample ID	B-9-2	Lab ID	2003-03-0687 - 4
Sampled	03/18/2003 12:41	Extracted	3/31/2003 12:51
Matrix	Soil	QC Batch#	2003/03/31-08:15

Compound	Conc.	RL	Unit	Dilution	Analyzed	Flag
Lead	2.0	1.0	mg/Kg	1.00	04/01/2003 14:29	

Severn Trent Laboratories, Inc.

STL San Francisco \* 1220 Quarry Lane, Pleasanton, CA 94566

Tel 925 484 1919 Fax 925 484 1096 \* www.stl-inc.com \* CA DHS ELAP# 2496

04/03/2003 12:00

**Total Lead**

Aqua Science Engineers, Inc.

Attn.: Dave Allen

208 West El Pintado Road

Danville, CA 94526

Phone: (925) 820-9391 Fax: (925) 837-4853

Project: Andy Hall

Received: 03/19/2003

Site: 1455 5th Street  
Oakland, CA

Prep(s):	3050B	Test(s):	6010B
Sample ID:	B-10-2	Lab ID:	2003-03-0687-5
Sampled:	03/18/2003 12:52	Extracted:	3/31/2003 12:51
Matrix:	Soil	QC Batch#:	2003/03/31-08.15

Compound	Conc.	RL	Unit	Dilution	Analyzed	Flag
Lead	1.6	1.0	mg/Kg	1.00	04/01/2003 14:32	

Severn Trent Laboratories, Inc.

STL San Francisco \* 1220 Quarry Lane, Pleasanton, CA 94566

Tel 925 484 1919 Fax 925 484 1096 \* www.stl-inc.com \* CA DHS ELAP# 2496

04/03/2003 12:00

**Total Lead**

Aqua Science Engineers, Inc.

Attn.: Dave Allen

208 West El Pintado Road

Danville, CA 94526

Phone: (925) 820-9391 Fax: (925) 837-4853

Project: Andy Hall

Received: 03/19/2003

Site: 1455 5th Street  
Oakland, CA

Prep(s): 3050B	Test(s): 6010B
Sample ID: B-11-2	Lab ID: 2003-03-0687 - 6
Sampled: 03/18/2003 13:01	Extracted: 3/31/2003 12:51
Matrix: Soil	QC Batch#: 2003/03/31-08:15

Compound	Conc.	RL	Unit	Dilution	Analyzed	Flag
Lead	1.8	1.0	mg/Kg	1.00	04/01/2003 14:35	

Severn Trent Laboratories, Inc.

STL San Francisco \* 1220 Quarry Lane, Pleasanton, CA 94566

Tel 925 484 1919 Fax 925 484 1096 \* www.stl-inc.com \* CA DHS ELAP# 2496

04/03/2003 12:00

**Total Lead**

Aqua Science Engineers, Inc.  
Attn.: Dave Allen

208 West El Pintado Road  
Danville, CA 94526  
Phone: (925) 820-9391 Fax: (925) 837-4853

Project: Andy Hall

Received: 03/19/2003

Site: 1455 5th Street  
Oakland, CA

Prep(s): 3050B	Test(s): 6010B
Sample ID: B-12-2	Lab ID: 2003-03-0687-7
Sampled: 03/18/2003 13:08	Extracted: 3/31/2003 12:51
Matrix: Soil	QC Batch#: 2003/03/31-08 15

Compound	Conc.	RL	Unit	Dilution	Analyzed	Flag
Lead	150	1.0	mg/Kg	1.00	04/01/2003 14:39	

**Total Lead**

Aqua Science Engineers, Inc.  
Attn.: Dave Allen

208 West El Pintado Road  
Danville, CA 94526  
Phone: (925) 820-9391 Fax: (925) 837-4853

Project: Andy Hall

Received: 03/19/2003

Site: 1455 5th Street  
Oakland, CA

Prep(s):	3050B	Test(s):	6010B
Sample ID:	B-13-2	Lab ID:	2003-03-0687 - 8
Sampled:	03/18/2003 13:08	Extracted:	3/31/2003 12:51
Matrix:	Soil	QC Batch#:	2003/03/31-08-15

Compound	Conc.	RL	Unit	Dilution	Analyzed	Flag
Lead	2.5	1.0	mg/Kg	1.00	04/01/2003 14:42	

Severn Trent Laboratories, Inc.

STL San Francisco \* 1220 Quarry Lane, Pleasanton, CA 94566

Tel 925 484 1919 Fax 925 484 1096 \* www.stl-inc.com \* CA DHS ELAP# 2496

04/03/2003 12:00



**Total Lead**

Aqua Science Engineers, Inc.

Attn.: Dave Allen

208 West El Pintado Road

Danville, CA 94526

Phone: (925) 820-9391 Fax: (925) 837-4853

Project: Andy Hall

Received: 03/19/2003

Site: 1455 5th Street  
Oakland, CA

Prep(s):	3050B	Test(s):	6010B
Sample ID:	B-14-2	Lab ID:	2003-03-0687 - 9
Sampled:	03/18/2003 13:14	Extracted:	3/31/2003 12:51
Matrix:	Soil	QC Batch#:	2003/03/31-08.15

Compound	Conc.	RL	Unit	Dilution	Analyzed	Flag
Lead	1800	1.0	mg/Kg	1.00	04/01/2003 14:46	

Severn Trent Laboratories, Inc.

STL San Francisco \* 1220 Quarry Lane, Pleasanton, CA 94566

Tel 925 484 1919 Fax 925 484 1096 \* www.stl-inc.com \* CA DHS ELAP# 2496

04/03/2003 12:00

**Total Lead**

Aqua Science Engineers, Inc.  
Attn.: Dave Allen

208 West El Pintado Road  
Danville, CA 94526  
Phone: (925) 820-9391 Fax: (925) 837-4853  
Project: Andy Hall

Received: 03/19/2003  
Site: 1455 5th Street  
Oakland, CA

Prep(s):	3050B	Test(s):	6010B
Sample ID:	B-15-2	Lab ID:	2003-03-0687-10
Sampled:	03/18/2003 13:19	Extracted:	3/31/2003 12:51
Matrix:	Soil	QC Batch#:	2003/03/31-08:15

Compound	Conc.	RL	Unit	Dilution	Analyzed	Flag
Lead	27	1.0	mg/Kg	1.00	04/01/2003 15:01	



**Total Lead**

Aqua Science Engineers, Inc.  
 Attn.: Dave Allen

208 West El Pintado Road  
 Danville, CA 94526  
 Phone: (925) 820-9391 Fax: (925) 837-4853  
 Project: Andy Hall

Received: 03/19/2003  
 Site: 1455 5th Street  
 Oakland, CA

Prep(s):	3050B	Test(s):	6010B
Sample ID:	B-16-2	Lab ID:	2003-03-0687 - 11
Sampled:	03/18/2003 13:29	Extracted:	3/31/2003 12:51
Matrix:	Soil	QC Batch#:	2003/03/31-08.15

Compound	Conc.	RL	Unit	Dilution	Analyzed	Flag
Lead	1.9	1.0	mg/Kg	1.00	04/01/2003 15:05	

**Total Lead**

Aqua Science Engineers, Inc.

Attn.: Dave Allen

208 West El Pintado Road

Danville, CA 94526

Phone: (925) 820-9391 Fax: (925) 837-4853

Project: Andy Hall

Received: 03/19/2003

Site: 1455 5th Street  
Oakland, CA

Prep(s):	3050B	Test(s):	6010B
Sample ID:	B-17-2	Lab ID:	2003-03-0687 - 12
Sampled:	03/18/2003 13:29	Extracted:	3/31/2003 12:51
Matrix:	Soil	QC Batch#:	2003/03/31-08.15

Compound	Conc.	RL	Unit	Dilution	Analyzed	Flag
Lead	1.8	1.0	mg/Kg	1.00	04/01/2003 15:08	

04/03/2003 12:00

Severn Trent Laboratories, Inc.

STL San Francisco \* 1220 Quarry Lane, Pleasanton, CA 94566

Tel 925 484 1919 Fax 925 484 1096 \* www.stl-inc.com \* CA DHS ELAP# 2496

Page 13 of 18

**Total Lead**

Aqua Science Engineers, Inc.  
Attn.: Dave Allen

208 West El Pintado Road  
Danville, CA 94526  
Phone: (925) 820-9391 Fax: (925) 837-4853  
Project: Andy Hall

Received: 03/19/2003  
Site: 1455 5th Street  
Oakland, CA

Prep(s):	3050B	Test(s):	6010B
Sample ID:	B-18-2	Lab ID:	2003-03-0687 - 13
Sampled:	03/18/2003 13:35	Extracted:	3/31/2003 12:51
Matrix:	Soil	QC Batch#:	2003/03/31-08:15

Compound	Conc.	RL	Unit	Dilution	Analyzed	Flag
Lead	1.6	1.0	mg/Kg	1.00	04/01/2003 15:11	

**Total Lead**

Aqua Science Engineers, Inc.

Attn.: Dave Allen

208 West El Pintado Road

Danville, CA 94526

Phone: (925) 820-9391 Fax: (925) 837-4853

Project: Andy Hall

Received: 03/19/2003

Site: 1455 5th Street

Oakland, CA

Prep(s):	3050B	Test(s):	6010B
Sample ID:	B-19-2	Lab ID:	2003-03-0687 - 14
Sampled:	03/18/2003 13:41	Extracted:	3/31/2003 12:51
Matrix:	Soil	QC Batch#:	2003/03/31-08:15

Compound	Conc.	RL	Unit	Dilution	Analyzed	Flag
Lead	3.1	1.0	mg/Kg	1.00	04/01/2003 15:15	

Severn Trent Laboratories, Inc.

STL San Francisco \* 1220 Quarry Lane, Pleasanton, CA 94566

Tel 925 484 1919 Fax 925 484 1096 \* www.stl-inc.com \* CA DHS ELAP# 2496

04/03/2003 12:00

**Total Lead**

Aqua Science Engineers, Inc.  
Attn.: Dave Allen

208 West El Pintado Road  
Danville, CA 94526  
Phone: (925) 820-9391 Fax: (925) 837-4853

Project: Andy Hall

Received: 03/19/2003

Site: 1455 5th Street  
Oakland, CA

Prep(s): 3050B	Test(s): 6010B
Sample ID: B-20-2	Lab ID: 2003-03-0687 - 15
Sampled: 03/18/2003	Extracted: 3/31/2003 12:51
Matrix: Soil	QC Batch#: 2003/03/31-08:15

Compound	Conc.	RL	Unit	Dilution	Analyzed	Flag
Lead	35	1.0	mg/Kg	1.00	04/01/2003 15:18	

**Total Lead**

Aqua Science Engineers, Inc.  
Attn.: Dave Allen

208 West El Pintado Road  
Danville, CA 94526  
Phone: (925) 820-9391 Fax: (925) 837-4853

Project: Andy Hall

Received: 03/19/2003

Site: 1455 5th Street  
Oakland, CA

Batch QC Report		
Prep(s): 3050B		Test(s): 6010B
Method Blank	Soil	QC Batch # 2003/03/31-08.15
MB: 2003/03/31-08.15-076		Date Extracted: 03/31/2003 12:51

Compound	Conc.	RL	Unit	Analyzed	Flag
Lead	ND	1.0	mg/Kg	04/01/2003 13:44	



**Total Lead**

Aqua Science Engineers, Inc.  
Attn.: Dave Allen

208 West El Pintado Road  
Danville, CA 94526  
Phone: (925) 820-9391 Fax: (925) 837-4853

Project: Andy Hall

Received: 03/19/2003

Site: 1455 5th Street  
Oakland, CA

Batch QC Report									
Prep(s): 3050B					Test(s): 6010B				
Laboratory Control Spike			Soil			QC Batch # 2003/03/31-08.15			
LCS	2003/03/31-08.15-077		Extracted: 03/31/2003			Analyzed: 04/01/2003 13:49			
LCSD	2003/03/31-08.15-078		Extracted: 03/31/2003			Analyzed: 04/01/2003 13:52			

Compound	Conc. mg/Kg		Exp.Conc.	Recovery		RPD	Ctrl.Limits %		Flags	
	LCS	LCSD		LCS	LCSD		%	Rec.	RPD	LCS
Lead	98.4	95.5	100.0	98.4	95.5	3.0	80-120	20		

Severn Trent Laboratories, Inc.

STL San Francisco \* 1220 Quarry Lane, Pleasanton, CA 94566

Tel 925 484 1919 Fax 925 484 1096 \* www.stl-inc.com \* CA DHS ELAP# 2496

04/03/2003 12:00



STL ChromaLab

ADD ON/CHANGE ORDER

2003-03-0687

New Submission No.:

Reference No.: 73032

ORIGINAL SUBMISSION INFORMATION

Client Name: Aqua Science Engineers

Project Mgr.:

Project Name: Andy Hall 1465 S 4th St. Oakland

Name of Caller: Dave Allen

Call Date: 3-27-03

Add on Due Date: 4-3-03

Comments:

Project No.:

PO#:

Date Received: 3-19-03

Submission No.: 2003-03-0405

ANALYSIS REQUEST

Sample ID	Date	Time	Mat rix	Prev. Spl. #	TPH (EPA 8015, 8020A/C21) <input type="checkbox"/> Gas W/ <input type="checkbox"/> BTEX <input type="checkbox"/> MTBE	Fluorinated Aromatics BTX (EPA 8020B/C21)	TEPH (EPA 8015M) <input type="checkbox"/> Silica Gel <input type="checkbox"/> Diesel <input type="checkbox"/> Motor Oil <input type="checkbox"/> Other	Fuel Oxygenates (EPA 8015) <input type="checkbox"/> SOA, EDE <input type="checkbox"/> Fuel Oxygenates List <input type="checkbox"/> MTBE <input type="checkbox"/> BTEX	Purposable Halocarbons (H-VOCs) (EPA 8010/8021)	Volatile Organics GC/MS (VOCs) (EPA 8260A/E230B)	Semivolatiles GC/MS (EPA 8270)	Oil & Grease <input type="checkbox"/> Petrol (EPA 1664) <input type="checkbox"/> Total	<input type="checkbox"/> Pesticides (EPA 8061) <input type="checkbox"/> PCBs (EPA 8062)	PMAs by <input type="checkbox"/> 8270 <input type="checkbox"/> 8510	CAM 17 Metals (EPA 8010/4707/471)	Metalloids <input type="checkbox"/> Lead <input type="checkbox"/> LUFT <input type="checkbox"/> RCRA <input type="checkbox"/> Other	<input type="checkbox"/> WET (STLD) <input type="checkbox"/> TOLP	<input type="checkbox"/> Hexavalent Chromium <input type="checkbox"/> pH (24 hr. hold time for H <sub>2</sub> O)	<input type="checkbox"/> Spec. Cond. <input type="checkbox"/> Alkalinity <input type="checkbox"/> TSS <input type="checkbox"/> TDS	Anions: <input type="checkbox"/> F <input type="checkbox"/> NO <sub>2</sub> <input type="checkbox"/> PO <sub>4</sub> <input type="checkbox"/> F <input type="checkbox"/> SO <sub>4</sub> <input type="checkbox"/> NO <sub>3</sub>
B-6-2-	3-18	1223	S	-02																
B-7-2-		1232		-06													X			
B-8-2-		1237		-10																
B-9-2-		1241		-14																
B-10-2-		1252		-18																
B-11-2-		1301		-22																
B-12-2-		1308		-26																
B-13-2-		1308		-30																
B-14-2-		1314		-34																
B-15-2-		1319		-38																
B-16-2-		1324		-42																
B-17-2-		1329		-46																
B-18-2-		1335		-50																
B-19-2-		1341		-54																
B-20-2-				-58																

NUMBERS OF CONTAINERS

Ref

P.2

9255003002

STLUNSIDE

HPF 25 US U4:U/P

**Total Lead**

Aqua Science Engineers, Inc.

Attn.: Dave Allen

208 West El Pintado Road

Danville, CA 94526

Phone: (925) 820-9391 Fax: (925) 837-4853

Project: Andy Hall

Received: 03/19/2003

**Samples Reported**

Sample Name	Date Sampled	Matrix	Lab #
BH-6-3	03/18/2003 12:22	Soil	1
BH-14-3	03/18/2003 13:13	Soil	2
BH-15-3	03/18/2003 13:18	Soil	3

Severn Trent Laboratories, Inc.

STL San Francisco \* 1220 Quarry Lane, Pleasanton, CA 94566

Tel 925 484 1919 Fax 925 484 1096 \* www.stl-inc.com \* CA DHS ELAP# 2496

04/09/2003 07:48

**Total Lead**

Aqua Science Engineers, Inc.

Attn.: Dave Allen

208 West El Pintado Road

Danville, CA 94526

Phone: (925) 820-9391 Fax: (925) 837-4853

Project: Andy Hall

Received: 03/19/2003

Prep(s): 3050B	Test(s): 6010B
Sample ID: BH-6-3	Lab ID: 2003-04-0175-1
Sampled: 03/18/2003 12:22	Extracted: 4/7/2003 16:43
Matrix: Soil	QC Batch#: 2003/04/07-07-15

Compound	Conc.	RL	Unit	Dilution	Analyzed	Flag
Lead	630	1.0	mg/Kg	1.00	04/08/2003 23:10	

Severn Trent Laboratories, Inc.

STL San Francisco \* 1220 Quarry Lane, Pleasanton, CA 94566

Tel 925 484 1919 Fax 925 484 1096 \* www.stl-inc.com \* CA DHS ELAP# 2496

04/09/2003 07:48

**Total Lead**

Aqua Science Engineers, Inc.

Attn.: Dave Allen

208 West El Pintado Road  
Danville, CA 94526  
Phone: (925) 820-9391 Fax: (925) 837-4853

Project: Andy Hall

Received: 03/19/2003

Prep(s):	3050B	Test(s):	6010B
Sample ID:	BH-14-3	Lab ID:	2003-04-0175 - 2
Sampled:	03/18/2003 13:13	Extracted:	4/7/2003 16:43
Matrix:	Soil	QC Batch#:	2003/04/07-07-15

Compound	Conc.	RL	Unit	Dilution	Analyzed	Flag
Lead	51	1.0	mg/Kg	1.00	04/08/2003 23:13	

Severn Trent Laboratories, Inc.

STL San Francisco \* 1220 Quarry Lane, Pleasanton, CA 94566

Tel 925 484 1919 Fax 925 484 1096 \* www.stl-inc.com \* CA DHS ELAP# 2496

04/09/2003 07:48

**Total Lead**

Aqua Science Engineers, Inc.  
Attn.: Dave Allen

208 West El Pintado Road  
Danville, CA 94526  
Phone: (925) 820-9391 Fax: (925) 837-4853

Project: Andy Hall

Received: 03/19/2003

Prep(s):	3050B	Test(s):	6010B
Sample ID:	BH-15-3	Lab ID:	2003-04-0175-3
Sampled:	03/18/2003 13:18	Extracted:	4/7/2003 16:43
Matrix:	Soil	QC Batch#:	2003/04/07-07 15

Compound	Conc.	RL	Unit	Dilution	Analyzed	Flag
Lead	1.8	1.0	mg/Kg	1.00	04/08/2003 23:37	

Severn Trent Laboratories, Inc.

STL San Francisco \* 1220 Quarry Lane, Pleasanton, CA 94566

Tel 925 484 1919 Fax 925 484 1096 \* www.stl-inc.com \* CA DHS ELAP# 2496

04/09/2003 07:48

**Total Lead**

Aqua Science Engineers, Inc.

Attn.: Dave Allen

208 West El Pintado Road

Danville, CA 94526

Phone: (925) 820-9391 Fax: (925) 837-4853

Project: Andy Hall

Received: 03/19/2003

Batch QC Report					
Prep(s): 3050B		Soil		Test(s): 6010B	
Method Blank				QC Batch # 2003/04/07-07.15	
MB: 2003/04/07-07.15-030				Date Extracted: 04/07/2003 16:43	

Compound	Conc.	RL	Unit	Analyzed	Flag
Lead	ND	1.0	mg/Kg	04/08/2003 21:49	

Severn Trent Laboratories, Inc.

STL San Francisco \* 1220 Quarry Lane, Pleasanton, CA 94566

Tel 925 484 1919 Fax 925 484 1096 \* www.stl-inc.com \* CA DHS ELAP# 2496

04/09/2003 07:48

**Total Lead**

Aqua Science Engineers, Inc.

Attn.: Dave Allen

208 West El Pintado Road

Danville, CA 94526

Phone: (925) 820-9391 Fax: (925) 837-4853

Project: Andy Hall

Received: 03/19/2003

Batch QC Report										
Prep(s): 3050B						Test(s): 6010B				
Laboratory Control Spike				Soil			QC Batch # 2003/04/07-07.15			
LCS	2003/04/07-07.15-031			Extracted: 04/07/2003			Analyzed: 04/08/2003 21:53			
LCSD	2003/04/07-07.15-032			Extracted: 04/07/2003			Analyzed: 04/08/2003 21:57			
Compound	Conc. mg/Kg		Exp.Conc.	Recovery		RPD	Ctrl.Limits %		Flags	
	LCS	LCSD		LCS	LCSD		%	Rec.	RPD	LCS
Lead	99.3	95.8	100.0	99.3	95.8	3.6	80-120	20		

Severn Trent Laboratories, Inc.

STL San Francisco \* 1220 Quarry Lane, Pleasanton, CA 94566

Tel 925 484 1919 Fax 925 484 1096 \* www.stl-inc.com \* CA DHS ELAP# 2496

04/09/2003 07:48





STL San Francisco

2003-04-0175

ADD ON/CHANGE ORDER

New Submission No: \_\_\_\_\_

Reference No: 73229

ORIGINAL SUBMISSION INFORMATION

Client Name: Aqua Sphere

Name of Caller: Dave Allen

Bill To: \_\_\_\_\_

Project Mgr: Dave Allen

Call Date: 4-7-03

Attn: \_\_\_\_\_

Project Name: Andy Hall

Add on Due Date: 4-14-03

Comments: \_\_\_\_\_

Project No.: \_\_\_\_\_

PO#: \_\_\_\_\_

Date Received: 3-19-03

Submission No.: 2003-03-040X

ANALYSIS REQUEST

Sample ID	Date	Time	Mat rix	Prev. Spl #	TPH (EPA 8015, 8020, 8021) <input type="checkbox"/> Gas w/ <input type="checkbox"/> BTEX <input type="checkbox"/> MTBE	Purgeable Aromatics BTEX (EPA 8020, 8021)	TEPH (EPA 8015M) <input type="checkbox"/> Silica On <input type="checkbox"/> Diesel <input type="checkbox"/> Motor Oil <input type="checkbox"/> Other	Fuel Components (22818) <input type="checkbox"/> OCA, EOP <input type="checkbox"/> Fuel Oxygenates <input type="checkbox"/> MTBE <input type="checkbox"/> BTEX	Purgeable Hydrocarbons (NVOCS) (EPA 8010, 8021)	Volatiles Organics GC/MS (VOCs) (EPA 8260A, 8260B)	Semi-volatiles GC/MS (EPA 8270)	Oil & Grease <input type="checkbox"/> Petrol (EPA 1664) <input type="checkbox"/> Total	Pesticides (EPA 8031) <input type="checkbox"/> PCBs (EPA 8082)	PHAs by <input type="checkbox"/> 8270 <input type="checkbox"/> 8030	SEM 17 Metals (EPA 8017, 8017A, 8017B)	Metals <input type="checkbox"/> Lead <input type="checkbox"/> UFT <input type="checkbox"/> ROPA <input type="checkbox"/> Chk	WET (STLC) <input type="checkbox"/> TCLP	Resistant Chromium <input type="checkbox"/> pH (24-hr. hold time for H <sub>2</sub> O)	Silica Cont. <input type="checkbox"/> Alkalinity <input type="checkbox"/> TSS <input type="checkbox"/> TDS	Anions <input type="checkbox"/> Bi <input type="checkbox"/> NO <sub>3</sub> <input type="checkbox"/> PO <sub>4</sub> <input type="checkbox"/> F <input type="checkbox"/> Cl <input type="checkbox"/> SO <sub>4</sub> <input type="checkbox"/> NO <sub>2</sub>	NUMBER OF CONTAINERS	
BH 6-3	3/19/03	12:32	S	003																		
BH 14-3	↓	13:13	↓	035																		
BH 15-3	↓	13:14	↓	034																		

XX

**Total Lead**

Aqua Science Engineers, Inc.

Attn.: Dave Allen

208 West El Pintado Road

Danville, CA 94526

Phone: (925) 820-9391 Fax: (925) 837-4853

Project: Andy Hall

Received: 03/19/2003 13:43

**Samples Reported**

Sample Name	Date Sampled	Matrix	Lab #
B-6-4	03/18/2003 12:21	Soil	1

Severn Trent Laboratories, Inc.

STL San Francisco \* 1220 Quarry Lane, Pleasanton, CA 94566

Tel 925 484 1919 Fax 925 484 1096 \* www.stl-inc.com \* CA DHS ELAP# 2496

A part of Severn Trent Plc

04/17/2003 09:35

Page 1 of 4

**Total Lead**

Aqua Science Engineers, Inc.

Attn.: Dave Allen

208 West El Pintado Road

Danville, CA 94526

Phone: (925) 820-9391 Fax: (925) 837-4853

Project: Andy Hall

Received: 03/19/2003 13:43

Prep(s): 3050B	Test(s): 6010B
Sample ID: B-6-4	Lab ID: 2003-04-0260 - 1
Sampled: 03/18/2003 12:21	Extracted: 4/11/2003 10:53
Matrix: Soil	QC Batch#: 2003/04/11-04:15

Compound	Conc.	RL	Unit	Dilution	Analyzed	Flag
Lead	1.5	1.0	mg/Kg	1.00	04/11/2003 21:58	

Severn Trent Laboratories, Inc.

STL San Francisco \* 1220 Quarry Lane, Pleasanton, CA 94566

Tel 925 484 1919 Fax 925 484 1096 \* www.stl-inc.com \* CA DHS ELAP# 2496

04/17/2003 09:35

**Total Lead**

Aqua Science Engineers, Inc.

Attn.: Dave Allen

208 West El Pintado Road

Danville, CA 94526

Phone: (925) 820-9391 Fax: (925) 837-4853

Project: Andy Hall

Received: 03/19/2003 13:43

Batch QC Report					
Prep(s): 3050B				Test(s): 6010B	
Method Blank		Soil		QC Batch # 2003/04/11-04.15	
MB: 2003/04/11-04.15-050				Date Extracted: 04/11/2003 10:53	

Compound	Conc.	RL	Unit	Analyzed	Flag
Lead	ND	1.0	mg/Kg	04/11/2003 20:51	

Severn Trent Laboratories, Inc.

STL San Francisco \* 1220 Quarry Lane, Pleasanton, CA 94566

Tel 925 484 1919 Fax 925 484 1096 \* www.stl-inc.com \* CA DHS ELAP# 2496

04/17/2003 09:35

**Total Lead**

Aqua Science Engineers, Inc.  
Attn.: Dave Allen

208 West El Pintado Road  
Danville, CA 94526  
Phone: (925) 820-9391 Fax: (925) 837-4853  
Project: Andy Hall

Received: 03/19/2003 13:43

Batch QC Report										
Prep(s): 3050B						Test(s): 6010B				
Laboratory Control Spike				Soil			QC Batch # 2003/04/11-04.15			
LCS	2003/04/11-04.15-053			Extracted: 04/11/2003			Analyzed: 04/11/2003 21:03			
LCSD	2003/04/11-04.15-054			Extracted: 04/11/2003			Analyzed: 04/11/2003 21:07			
Compound	Conc. mg/Kg		Exp. Conc.	Recovery		RPD	Ctrl.Limits %		Flags	
	LCS	LCSD		LCS	LCSD		%	Rec.	RPD	LCS
Lead	99.0	97.2	100.0	99.0	97.2	1.8	80-120	20		

Severn Trent Laboratories, Inc.

STL San Francisco \* 1220 Quarry Lane, Pleasanton, CA 94566

Tel 925 484 1919 Fax 925 484 1096 \* www.stl-inc.com \* CA DHS ELAP# 2496

04/17/2003 09:35



STL San Francisco

2003-04-0260

ADD ON/CHANGE ORDER

New Submission No.: \_\_\_\_\_

Reference No.: 73291

ORIGINAL SUBMISSION INFORMATION

Client Name: Aqua Science

Project Mgr.: Dave Allen

Project Name: Andy Hall

Project No.: \_\_\_\_\_

PO#: \_\_\_\_\_

Date Received: 03-19-03

Submission No.: 2003-030405

Name of Caller: Dave Allen

Call Date: 4/10/03

Add on Due Date: 4-17-03

Bill To: \_\_\_\_\_

Attn.: \_\_\_\_\_

Comments: \_\_\_\_\_

Sample ID		Date	Time	Mat rix	Prev. Spl. #	ANALYSIS REQUEST												NUMBER OF CONTAINERS									
						TPH (EPA 8015, 8020/8021) <input type="checkbox"/> Gas w/ <input type="checkbox"/> BTEX <input type="checkbox"/> MTBE	Purgeable Aromatics BTEX (EPA 8020/8021)	TEPH (EPA 8015M) <input type="checkbox"/> Silica Gel <input type="checkbox"/> Diesel <input type="checkbox"/> Motor Oil <input type="checkbox"/> Other	Fuel Oxygenates (8260B): <input type="checkbox"/> DCA, EDB <input type="checkbox"/> Full Oxygenate List <input type="checkbox"/> MTBE <input type="checkbox"/> BTEX	Purgeable Halocarbons (HVOCs) (EPA 8010/8021)	Volatile Organics GC/MS (VOCs) (EPA 8260A/8260B)	Semivolatiles GC/MS (EPA 8270)	Oil & Grease <input type="checkbox"/> Petrol (EPA 1664) <input type="checkbox"/> Total	<input type="checkbox"/> Pesticides (EPA 8081) <input type="checkbox"/> PCBs (EPA 8082)	PNA's by <input type="checkbox"/> 8270 <input type="checkbox"/> 8310	CAM 17 Metals (EPA 8010/4707/471)	Metals: <input checked="" type="checkbox"/> Lead <input type="checkbox"/> LUFT <input type="checkbox"/> RCRA <input type="checkbox"/> Other		<input type="checkbox"/> WEL (STLC) <input type="checkbox"/> TCLP	<input type="checkbox"/> Hexavalent Chromium <input type="checkbox"/> pH (24 hr. hold time for H <sub>2</sub> O)	<input type="checkbox"/> Spec. Cond. <input type="checkbox"/> Alkalinity <input type="checkbox"/> TSS <input type="checkbox"/> TDS	Anions: <input type="checkbox"/> Br <input type="checkbox"/> NO <sub>2</sub> <input type="checkbox"/> PO <sub>4</sub> <input type="checkbox"/> F <input type="checkbox"/> Cl <input type="checkbox"/> SO <sub>4</sub> <input type="checkbox"/> NO <sub>3</sub>					
B-6-4		3-18-03	12:24	S	004												X										